

Case Number 13-C319-016-GRS	Case Title Newton Township – Well Water Contamination
Activity Interview of Nancy Voelker and Susan DeBauch	Date of Activity October 7, 2015

Narrative¹

At 10:35 AM on Wednesday, October 7, 2015, Special Investigative Warden Robert Stroess, in plain clothes, met with Nancy Voelker and Susan DeBauch at Voelker’s residence, [REDACTED], Manitowoc, WI as part of a pre-arranged meeting to discuss Voelker’s knowledge of the City of Manitowoc Hecker Road former dump site (site) near her residence. Stroess had been asked by Tauren Beggs of Wisconsin DNR to conduct the interview. Stroess had telephoned Voelker several days earlier to arrange the interview. Stroess was unaware that DeBauch would be there as Stroess and Voelker had not discussed DeBauch’s knowledge of the site or that she would be part of the interview.

Stroess was greeted at the garage entry door by Nancy Voelker. They walked into the house and sat around the dining room table. Voelker introduced DeBauch, and Stroess introduced himself. Stroess identified himself as a law enforcement officer and provided his business card to both Voelker and DeBauch. Voelker and DeBauch identified themselves verbally as follows:

Nancy L. Voelker
D.O.B. [REDACTED]
[REDACTED]
Manitowoc, WI 54220
[REDACTED]

Susan “Sue” M. DeBauch
D.O.B. [REDACTED]
[REDACTED]
Manitowoc, WI 54220
[REDACTED]

Stroess explained his role in the investigation and asked Voelker and DeBauch to explain their knowledge of dumping at a nearby site. Stroess explained that he normally does not interview multiple witnesses at the same time as he does not want the recollection of one person to influence the other person’s recollection. Voelker and DeBauch explained that although they are sisters, Voelker was 18 years old at the time DeBauch was born. Therefore, their knowledge of the site

1

Warden Reporting Robert Stroess	Date of Report October 8, 2015	Exhibit Reference
---	--	-------------------

This document was produced as a result of an official Law Enforcement investigation. Contents, in whole or part, are privileged by s. 905.09, Wis. Stats., and may not be used without express permission of the Wisconsin Warden service or appropriate prosecutor.

was from different time periods (their childhoods) and that they would both be able to independently explain their recollections, even if they differed/conflicted with the other's recollection. They provided the following information:

Nancy Voelker

- Nancy lived at [REDACTED] from approximately 1949-1956. She married in 1956. She and her husband moved away until 1961 when they moved to [REDACTED], the home they continue to reside at.
- Her home from 1949-1956 was the home across the road from the main entrance to the site.
- Her home from 1961 to the present was north of the site. From her current home she can see the north border of the site, a building that she referred to as being at the site of the former shooting range, and the stop sign at the main entrance to the site.
- She spent much time playing at the site as a child.
- Adam Schelthelm was the caretaker of the site in 1949 and he lived in the home on the site with his wife and seven children.
- Nancy drew a diagram of the layout of the site from the time period of 1949-1956 but she also added two new buildings for reference points, one being the one visible from her residence that she described as being at the location of the former shooting range and one being the current new building/shooting range area.
- The current main entrance was the same main entrance that existed during her childhood.
- The currently barricaded entrance just slightly north of the driveway to [REDACTED] was the driveway she labeled as "path" on her diagram.
- There was an area near the NW corner of the site that used to be an area where sewage trucks (which she referred to as "honey wagons") dumped sewage. She never saw the sewage trucks actually dump there, but she often saw sewage trucks entering the site and she saw the area that contained raw sewage.
- There was a pit that Schelthelm used to slaughter and leave the dead dogs in.
- There was a dump area that the public could come to dump garbage. Schelthelm would burn this dump area. She labeled it as "Burn area" on the diagram. She thought the dump area was open on Saturdays for anyone to dump. She never saw Schelthelm burn the dump area, but she saw the dump area on fire and she knew from her interactions with the Schelthelm family that Schelthelm was the one responsible for burning the dump area.
- She never saw dumping of chemicals at the site. She did see Mirro trucks at the site during the time period she lived on Hecker Road and then during the time period since she lived on Viebahn Street.

Susan DeBauch

- DeBauch lived at [REDACTED] from 1956-1973.
- She spent much time playing at the site as a child. She started playing at the site around the age of 10, but possibly earlier.
- The last time she was at the site was in approximately 1970.
- She left home in 1973 or 1974.
- Andy Junk, his wife Mardel, and their children Joanie, Jaret, Tony, possibly Andrew, and possibly one more daughter lived in the home on the site when DeBauch was a child.
- Joanie is approximately 60 years old, is married to Lee Meyer, lives at [REDACTED] [REDACTED] [REDACTED] [REDACTED]
- Andy Junk worked for the City of Manitowoc.
- The dump area open to the public for dumping was accessible directly off the gravel pit road that ran through the site.
- DeBauch helped the Junk family a little with taking care of some animals at the dog kennel on the site. While DeBauch was helping with the animals she would see sewage trucks coming and going.
- She saw City of Manitowoc trucks dumping snow in the field near the east end of the site.
- She didn't remember any other company trucks on site.

- She did not see dumping of chemicals at the site.
- She drew a diagram of the layout of the site from the time period of approximately 1965-1970.
- There was an area near the NW corner of the site where raw sewage was dumped.

Voelker and DeBauch agreed to visit the site with Stroess to help determine where certain locations had been during the times they had been familiar with the site. Stroess explained that it was important for them to independently recall where things had been located. Stroess explained that it was OK if they recollected locations differently and said that if that were the case, it could be that there were different locations where similar things occurred. They said they understood and that they could provide independent and possibly conflicting information. Stroess drove them in his squad. They both explained the main entrance road was in the same location as during their childhoods and that it used to go straight at the point where there is currently a berm at the first turn in the main entrance road.

Voelker saw the barn/shed-like building at the NW corner of the bridge over Silver Creek and said that was the building she marked as the “Grainery” on her diagram. She remembered there being a lower level entrance door on the creek side of the building. She remembered the dog kennel being just north of where the blue barrels were currently located, which was just north of the “Grainery”. DeBauch said the building that Voelker referred to as the “Grainery” was the one DeBauch referred to on her diagram as the building that “held city fireworks”.

Voelker and DeBauch directed Stroess to drive to different locations on site. DeBauch identified the following location – **Photo 1** – (marked with a pin drop on an aerial photograph from Stroess’ i-Phone) as being where the raw sewage was located:



Voelker said it was hard to remember the exact location of the sewage area due to landscape changes on site. The location indicated by DeBauch appeared to have a significant amount of fill compared to what appeared to be a historic elevation level.

Voelker identified the following location – **Photo 2** – (marked with a pin drop on an aerial photograph from Stroess' i-Phone) as being in between the areas she had marked as “Burn area” and “Pit – Slaughtered the dogs” on her diagram. Stroess asked her to estimate the location on the diagram that she thought they were located at, so she marked “X nlv gps” for “X”, her initials, and a GPS pin drop:

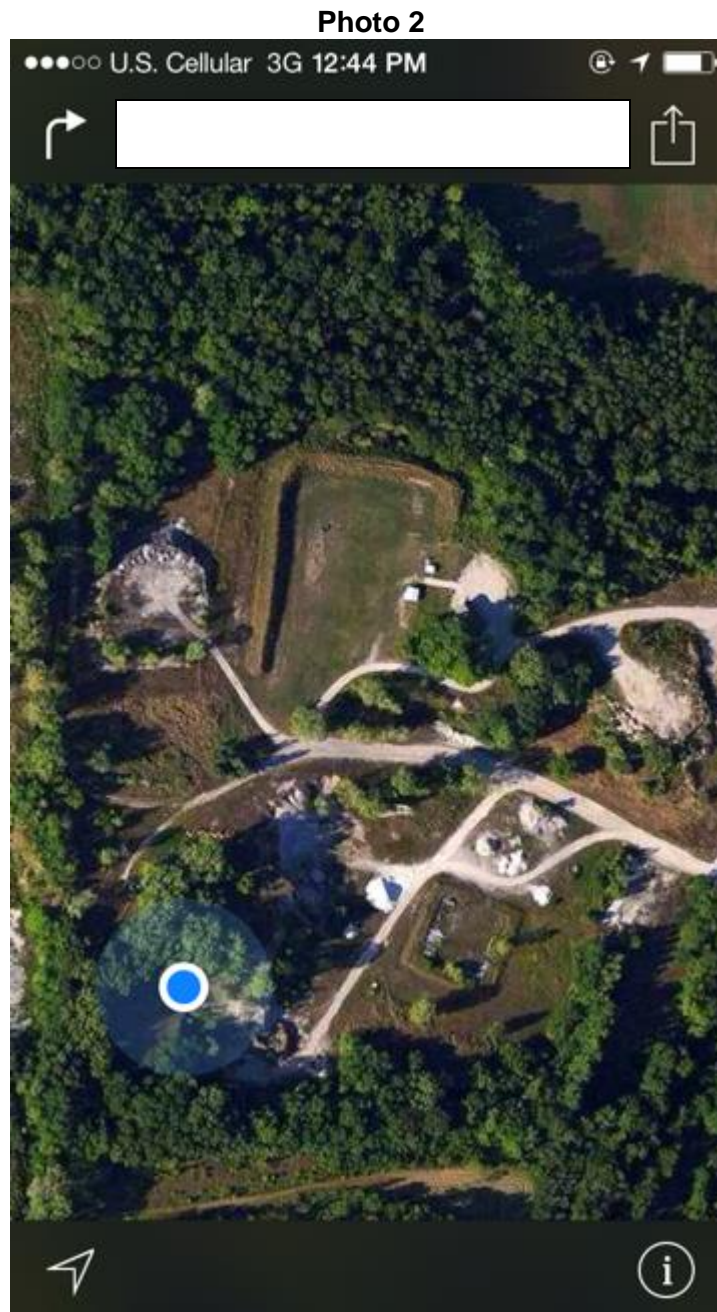

DeBauch identified the following location – **Photo 3** – (marked with a pin drop on an aerial photograph from Stroess’ i-Phone) as being where the dump site was located, which she had marked as “dump” on her diagram:



Stroess drove Voelker and DeBauch back to Voelker’s residence. Stroess thanked them and the interviews ended at approximately 1:00 PM. Voelker showed Stroess woodworking projects, landscaping, tools, etc. and made small talk. Voelker’s husband Doug arrived and he and Stroess spoke about woodworking before Stroess left at 1:16 PM.

~~1969-1970~~
1968-1970

Andy Jank's Home

dump

Farthest Corner
MEASURE pit

Raw sewage

Open gravel

Gravel
Circular ROAD

dog kennel

held city fireworks

Silver Creek

Creek

Gravel pit

Old Road

field

grass

gravel trucks
gravel Road

gravel piles

City snow

000 Lane

entrance today

3503 Hecker Rd.

1050
10-15

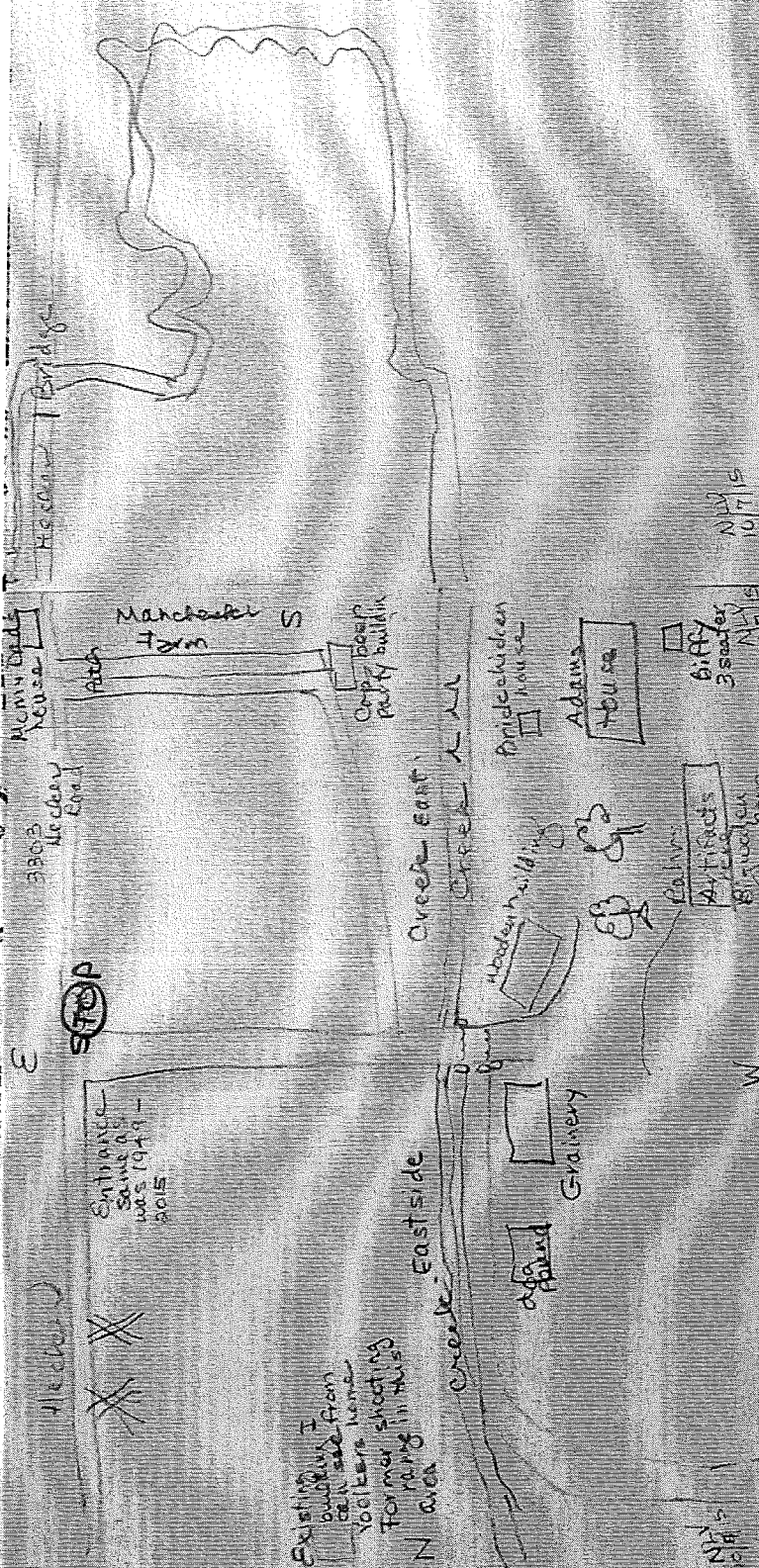

MOOSE HOUSE

3303
Hickory Road

STOP

Entrance same as was 1949 - 2015

Hickory

N Area

Manchucki Wrt

Crane Post
P&M building

Creeke East

Wooden building

Grainery

Adams House

Biffy 3300

Horse and carriage

Nov 10/715

Nov 10/715

Existing building from 1901 same name as before former shooting range in this area

Nov 10/715

Nov 10/715

Nov 10/715

Nov 10/715

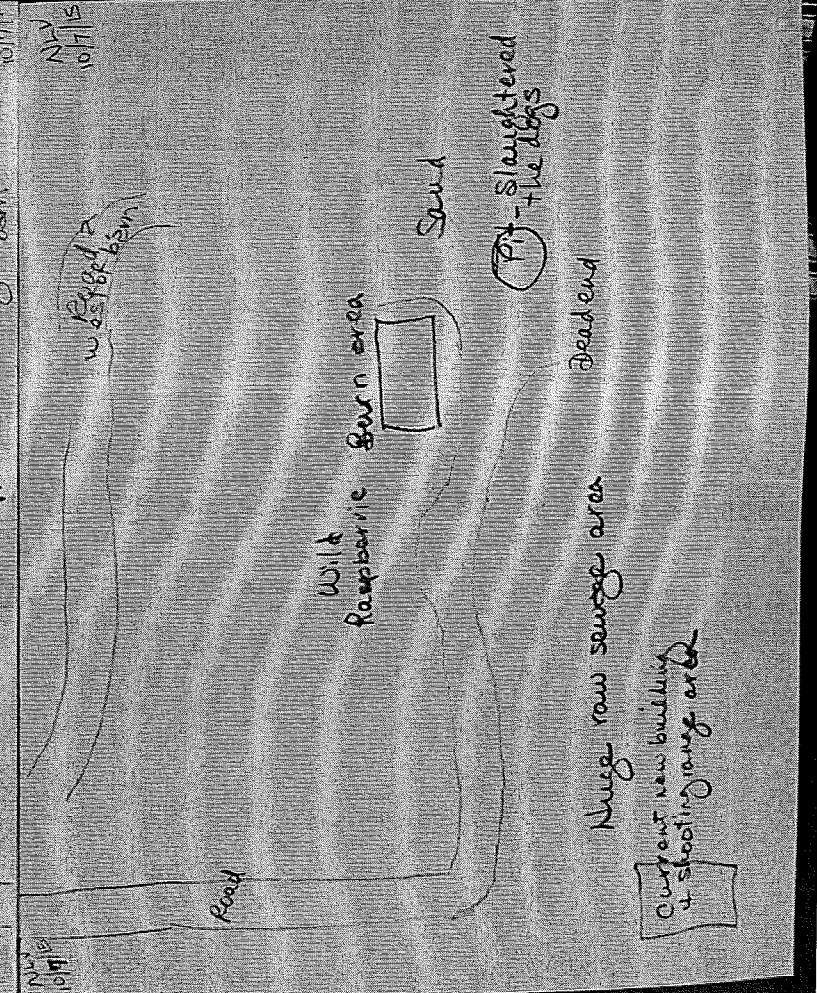

Nov 10/715

Nov 10/715

Nov 10/715

Nov 10/715

Nov 10/715

Nov 10/715

Road

Wild Raspberry Burn area

Sand

Pit - Slaughtered the dogs

Nuge row sewage area

Dead end

Current new building & shooting range area

Nov 10/715

Nov 10/715

Nov 10/715

W