

241469250
02-41-000269



service disabled veteran owned small business

June 30, 2009

Mr. Stavros Emmanouil
On-Scene Coordinator
Emergency Response Branch
U.S. Environmental Protection Agency
77 West Jackson Boulevard
Chicago, IL 60604

**Subject: Final Removal Action Letter Report
St. Francis Auto Wreckers Site
St. Francis, Milwaukee County, Wisconsin
Technical Direction Document No. S05-0809-001
EPA Contract No. EP-S5-06-03**

Dear Mr. Emmanouil:

The STN Environmental JV (STN) Superfund Technical Assessment and Response Team (START) has prepared this removal action letter report in accordance with the requirements of U.S. Environmental Protection Agency (EPA) Technical Direction Document (TDD) No. S05-0809-001 for the St. Francis Auto Wrecker's Site (Site). The scope of this TDD included (1) preparing a quality assurance action plan, (2) completion and maintenance of documentation of all contractor actions and costs, (3) conducting air monitoring, (4) CERCLA documentation, (5) soil and air sampling, and (6) assisting EPA with the removal action. Removal activities were conducted by the EPA under Stavros Emmanouil as the On-Scene Coordinator, and the Emergency and Rapid Response Services (ERRS) contractor, Environmental Quality Management, Inc. (EQM) with its subcontractor Veolia Environmental Services. START activities were performed by STN Environmental.

This removal action letter report summarizes the site background; discusses the removal action activities, including sampling activities; and provides a summary of the removal action. Appendix A of this letter report presents a photographic log of removal action activities and Appendix B provides sample analytical

results. Analytical services were procured by ERRS, EQM, and START received the results later from ERRS.

Site Background

The Site is an active auto salvage yard located in a populated, mixed residential and commercial area within the City of St. Francis, Milwaukee County, Wisconsin. The Site is located at 4043 South Pennsylvania Avenue (Figure 1). The auto salvage and recycling operations were being conducted at the Site for the past 40 years and were primarily confined to the southern half of the Site area. Previous records and inspections of the site indicate that the northern portion of the Site was once part of a landfill for the Town of Lake, Wisconsin, and was purchased by the Site owner for expanding the auto salvage yard. The area of the removal is to the north of the main building and is presently not being used by the salvage yard. The removal area is approximately 230 feet by 200 feet.

Wisconsin Department of Transportation (WDOT) purchased the western portion of the property from the site owners to develop the Lake Parkway freeway. In 1997, WDOT removed buried drums containing solid and semi-solid material identified as paint, resin or adhesive solids, foundry sand and slag, asphaltic tar solids, metal parts, plated debris, and firebricks. Wisconsin Department of Natural Resources (WDNR) soil sampling at the site revealed the presence of polychlorinated biphenyls (PCBs), volatile organic chemicals (VOCs) and metals in site soils. WDNR monitoring well sampling results indicated detected concentrations of VOCs above the WDNR groundwater enforcement standards. U.S. EPA site assessment results from two sample locations on the west side of the Site bordering the Lake Parkway freeway construction area were above the regulatory limits for PCBs, toxicity characteristic leaching procedure (TCLP) lead, and TCLP VOCs. Sample results showed lead, chromium and PCB contamination above Resource Conservation and Recovery Act (RCRA) limits in surface soil sample SS-1 (refer to Site Assessment Report prepared by STN Environmental, dated June 5, 2008). Trace levels of PCBs (>1 mg/kg) were found in SS-2 and SS-3. Historical WDNR and WDOT sample results show the presence of trichloroethylene (TCE) above RCRA limits within the areas of the test pits, along with flashpoint results of <140°F, showing that some soil may be considered ignitable. Based on these results, an action memo to conduct a time-critical removal action was approved.

Removal Action Activities

Removal action activities at the site included excavating the site to remove PCB-contaminated soil, drums and contaminated sludge from the property.

During the week of October 20, 2008, EPA, ERRS, START, and the ERRS Subcontractor mobilized to the site to conduct removal activities. Based on field screening, PCB-contaminated soil and drums and containers were excavated to a depth of four feet below grade surface (bgs) and stockpiled on the site. Initial separation of soil and drums were based on visual assessment of the materials as they were excavated. Three categories of stockpiles were used including (1) soils that appear to be hazardous, (2) soils that appear to be non-hazardous, and (3) drums, containers, and paint sludge.

A soil sample was collected from each stockpile by ERRS and submitted to Test America Laboratories for PCBs, TCLP lead, and TCE analyses. START received the analytical results from ERRS. The action levels for each of these contaminants of concern (COC) are 50 parts per million (ppm) for total PCBs, 0.5 milligrams per liter (mg/L) for TCLP lead, and 0.5 mg/L for TCE. The soil sample analytical results are shown in Table 1.

If the analytical results for a soil sample exceeded the action level for PCBs, the soil was removed from the site and disposed of at Wayne Disposal Facility in Belleville, Michigan as hazardous materials. If the analytical results for a soil sample exceeded the action level for TCLP lead, the soil was treated with quick lime.

Five test pits were excavated within the access roads along the north and east site boundaries to a depth of 10 feet bgs. The test pits were to identify subsurface materials and collect soil samples at two separate depths for contaminant delineation. A composite soil sample was collected from a depth of five feet bgs and a composite soil sample was collected from the floor of the test pit. The soil samples collected from five feet bgs were submitted to a laboratory for COC analyses. If the analytical results exceeded the action levels, then the samples collected from the 10 feet depth would be submitted to the laboratory for COC analyses. Analytical results from the five feet depth were below action levels, therefore no further excavation was required along the north

and east site boundaries. Analytical results are shown in Table 1. Sample locations are shown on Figure 1.

During excavation activities START donned Level C personal protection equipment to provide air monitoring for the site and the site perimeters for VOC vapors and particulates. A photoionization detection meter and a personal data RAM meter were used to monitor for VOCs and particulates, respectively.

A total of 4,575 cubic yards of PCB-contaminated soil, 490 drums and 67 paint cans was excavated and transported from the site to Wayne Disposal. Prior to placing a cap on the excavated area, confirmation samples were collected from the surface of the work zone. Eight composite soil samples were submitted to a laboratory for COC analyses. Sample locations can be found on Figure 1. Analytical results for all samples are shown on Table 1.

The cap consisted of a geomembrane fabric covered with two feet of gravel fines, graded and compacted, and six inches of topsoil and grass seed. Removal activities were completed on April 17, 2009.

If you have any questions or comments regarding this letter report or require any additional information, please call me at (312) 443-0550 or send an e-mail to tkoach@onesullivan.com.

Sincerely,



Tracey L. Koach

Project Geologist, STN Environmental JV

Attachments

cc: Stavros Emmanouil, EPA START On-Scene Coordinator
Craig Thomas, EPA START On-Scene Coordinator
Gail Stanuch, EPA START Project Officer
Raghu Nagam, STN START Program Manager

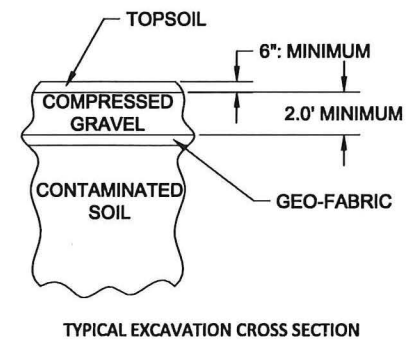
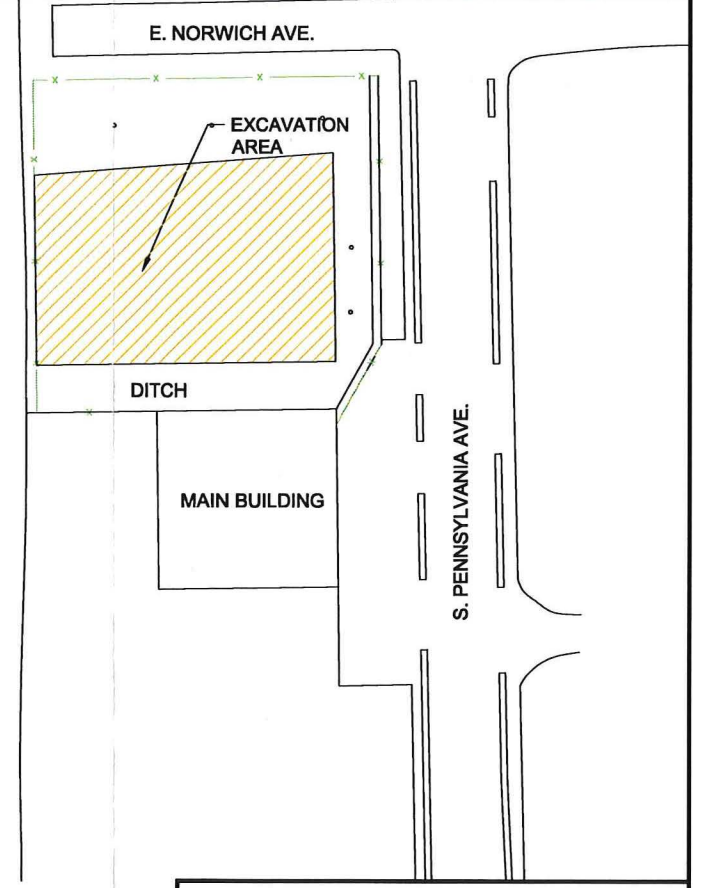
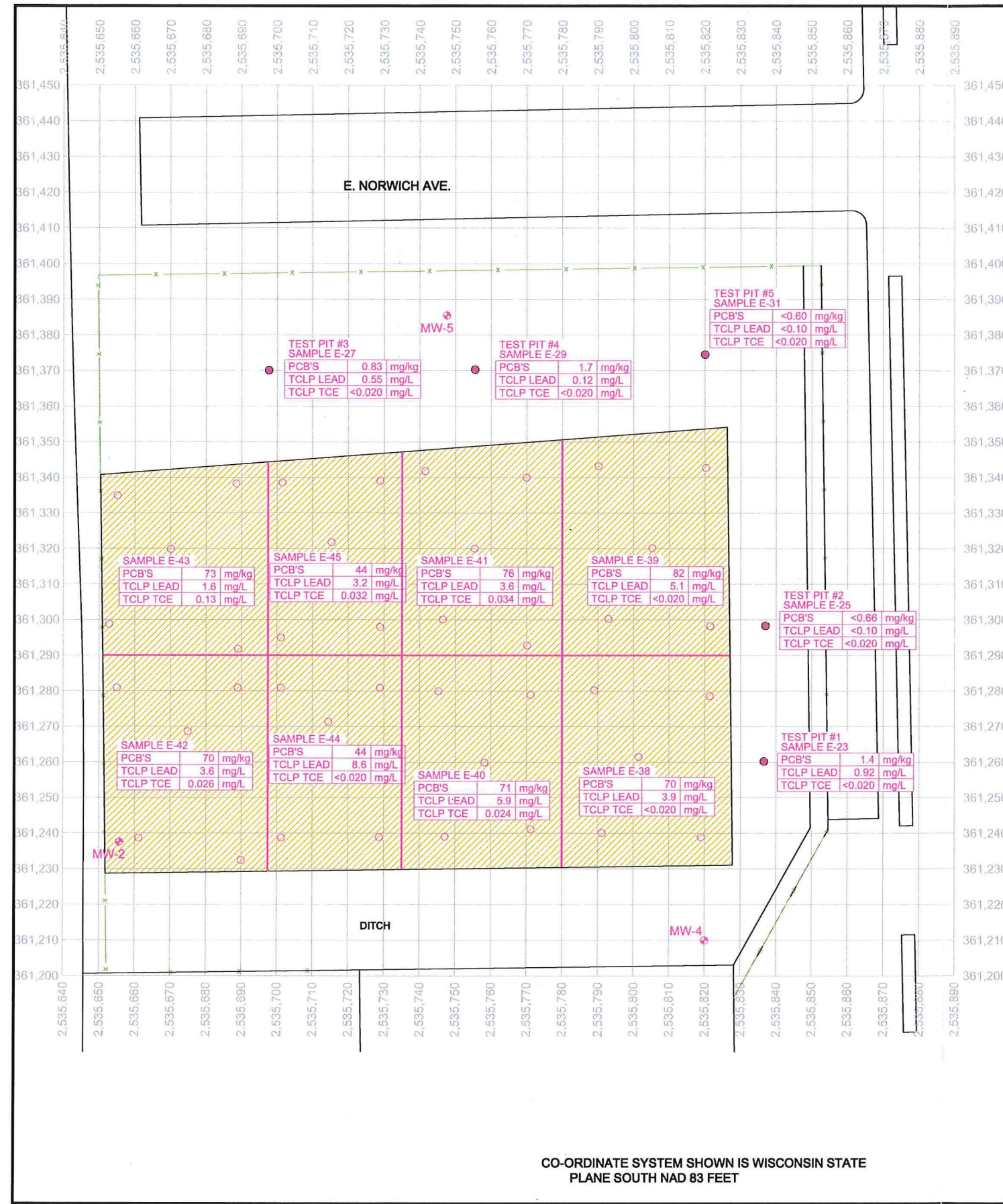

ENVIRONMENTAL QUALITY
 MANAGEMENT, INC.
 1800 CARILLON BLVD.
 CINCINNATI, OHIO 45240
 P (513)825-7500
 F (513)825-7495

**ST. FRANCIS AUTO SITE
 SITE MAP**

DRAWN	D.TOMO	1-19-09
CHECKED		
APPROVED		
SCALE:	NONE	

ORIGINAL SIZE	PROJECT NO.	DWG NO.	REV
D	030281.0015		0

Table 1
St. Francis Auto Wreckers Removal Action
Soil Sample Analytical Results Summary

Sample ID	Sample Date	Sample Location	ppm	mg/L	
			Total PCBs	TCLP Lead	TCE
		Action Level	50	0.5	0.5
E-1	10/23/2008	Stockpile 1	16	0.38	NA
E-2	10/23/2008	Stockpile 2	980	1.8	NA
E-3	10--30-08	Stockpile 2, Section 2	810	NA	NA
E-4	10/31/2008	Stockpile 1, Section 2	76	NA	NA
E-5 South	12/3/2008	Material left in hole, southwest	143	2.2	0.062
E-6 North	12/3/2008	Material left in hole, northwest	89	20	<0.040
E-5	11/5/2008	Roll Off Boxes of Drums and Drum Contents	1240	0.37	2.5
E-7	12/10/2008	Treated Stockpile #2, Section 2A	NA	ND	0.27
E-8	12/15/2008	Treated Stockpile #2, Section 2B	NA	0.97	0.061
E-9	12/16/2008	Treated Stockpile #2, Section 2C	NA	0.27	0.061
E-10	12/18/2008	Excavation Floor, SW Section of Site	ND	0.23	ND
E-11	12/23/2008	Pre-Treated Soil Stockpile #3	145	8.00	24.00
E-13	1/9/2009	Post-Treated Soil Stockpile #3, Section 1	NA	ND	0.088
E-14	1/23/2009	Post-Treated Soil Stockpile #3, Section 2	NA	ND	0.072
E-15	1/23/2009	Stockpile #4 No Treatment	44	1.2	0.13
E-16 (1)	2/2/2009	Stockpile #7 No Treatment	126	2.2	0.096
E-17 (2)	2/2/2009	Stockpile #5 No Treatment	114	3.5	ND
E-18 (3)	2/2/2009	Stockpile #6 No Treatment	126	2.00	0.042
E-19 (1)	2/5/2009	Stockpile #8 No Treatment	52.5	2.2	0.015
E-20 (3)	2/5/2009	Stockpile #10 No Treatment	199	2.4	0.27
E-21	2/9/2009	Stockpiles #5, #6, #7 No Treatment	NA	1.2	NA

Table 1
St. Francis Auto Wreckers Removal Action
Soil Sample Analytical Results Summary

Sample ID	Sample Date	Sample Location	ppm	mg/L	
			Total PCBs	TCLP Lead	TCE
		Action Level	50	0.5	0.5
E-22	2/9/2009	Stockpile #9 No Treatment	380	2.9	0.11
E-23	2/12/2009	Test Pit #1	1.4	0.92	ND
E-24 (4)	2/12/2009	Test Pit #1			
E-25	2/12/2009	Test Pit #2	ND	ND	ND
E-26 (4)	2/12/2009	Test Pit #2			
E-27	2/12/2009	Test Pit #3	0.83	0.55	ND
E-28 (4)	2/12/2009	Test Pit #3			
E-29	2/12/2009	Test Pit #4	1.7	0.12	ND
E-30 (4)	2/12/2009	Test Pit #4			
E-31	2/12/2009	Test Pit #5	ND	ND	ND
E-32 (4)	2/12/2009	Test Pit #5			
E-33 (1)	2/13/2009	Stockpile #11 No Treatment	110	3.5	0.02
E-34 (2)	2/13/2009	Stockpile #12 No Treatment	110	1.5	0.02
E-35 (3)	2/13/2009	Stockpile #13 No Treatment	150	2.2	0.066
E-36	2/12/2009	Grease	NA	ND	NA
E-37	No sample collected.				
E-38	3/27/2009	Confirmation Sample	70	3.9	<0.02
E-39	3/27/2009	Confirmation Sample	82	5.1	<0.02
E-40	3/27/2009	Confirmation Sample	71	5.9	0.024
E-41	3/27/2009	Confirmation Sample	76	3.6	0.034
E-42	4/1/2009	Confirmation Sample	70	3.6	0.026
E-43	4/1/2009	Confirmation Sample	73	1.6	0.13
E-44	3/31/2009	Confirmation Sample	44	8.6	<0.02
E-45	3/31/2009	Confirmation Sample	44	3.2	0.032

Notes: Removal activities were conducted under TDD number S05-0809-001 and analytical services were provided through ERRS.

- (1) Stockpiled material judged to be non-hazardous.
- (2) Stockpiled material judged to be contaminated.
- (3) Stockpiled drums and paint sludge.
- (4) Sample collected from floor of test pit (approximately 10 feet bgs), but not analyzed.

Bolded results exceed action levels.

ppm - parts per million

mg/L - milligrams per liter

ID - Identification

PCBs - polychlorinated biphenyls

TCLP - toxicity characteristic leaching procedure

TCE - trichloroethylene

ND - Non-detect

NA - Not analyzed

**United States Environmental Protection Agency
Region V
POLLUTION REPORT**

Date: Friday, April 17, 2009

From: Stavros Emmanouil/Craig Thomas, OSC

To:	Craig Thomas, USEPA/ERB/RS III	Stavros Emmanouil, U.S. EPA/ERB/RS III
	Jason El-Zein, U.S. EPA, ERB 1	David Chung, U.S. EPA
	Melinda Dejewskie, City of St. Francis	Andrew Boettcher, Wisconsin DNR
	Franklin Lockwood, City of St. Francis	Nola Hicks, U.S. EPA
	John Maritote, U.S. EPA	Bill Ryczek, U.S. EPA
	Roxanne Chronert, WDNR	Linda Nachowicz, U.S. EPA
	Charles Gebien, ERB/RS III	

Subject: Final POLREP
St. Francis Auto Wreckers
4043 South Pennsylvania Avenue, St. Francis, WI
Latitude: 45.9714
Longitude: -87.88

POLREP No.:	17	Site #:	B5LD
Reporting Period:	4/13/2009 through 4/17/2009	D.O. #:	0015
Start Date:	10/20/2008	Response Authority:	CERCLA
Mob Date:	10/20/2008	Response Type:	Time-Critical
Completion Date:	4/17/2009	NPL Status:	Non NPL
CERCLIS ID #:	WID988639068	Incident Category:	Removal Action
RCRIS ID #:		Contract #	EP-S5-08-02

Site Description

See initial POLREP

Current Activities

Continued and completed the backfilling of the site with two feet of compacted gravel fines on top of the geofabric.

Collected one composite soil sample from clean backfill material.

Placed six inches of topsoil over the entire site. Obtained and spread seed, fertilizer, and straw.

Placed silt fence around three sides of work zone.

Decontaminated and de-mobilized all equipment from the site.

De-mobilized decon trailer.

Planned Removal Actions

All planned removal actions are completed.

Next Steps

None.

Key Issues

None.

Estimated Costs *

	Budgeted	Total To Date	Remaining	% Remaining
Extramural Costs				
ERRS - Cleanup Contractor	\$1,392,963.00	\$1,325,449.64	\$67,513.36	4.85%
RST/START	\$96,620.00	\$89,333.93	\$7,286.07	7.54%
Intramural Costs				
Total Site Costs	\$1,489,583.00	\$1,414,783.57	\$74,799.43	5.02%

* The above accounting of expenditures is an estimate based on figures known to the OSC at the time this report was written. The OSC does not necessarily receive specific figures on final payments made to any contractor(s). Other financial data which the OSC must rely upon may not be entirely up-to-date. The cost accounting provided in this report does not necessarily represent an exact monetary figure which the government may include in any claim for cost recovery.

Disposition of Wastes

Waste Stream	Quantity	Manifest #	Disposal Facility
Non-Hazardous Tires - for recycling	6.07 tons	Not Applicable; no paperwork required for recyclables	Auburndale Recycling Facility, Auburndale, WI
PCB Contaminated Soils	4,575 Tons	004659943JJK through 004659968JJK; 006213887JJK through 006213926JJK	Wayne Disposal, Belleville, MI

epaosc.org/stfrancisautowreckers

**United States Environmental Protection Agency
Region V
POLLUTION REPORT**

Date: Thursday, April 09, 2009
From: Stavros Emmanouil/Craig Thomas, OSC

To: Craig Thomas, USEPA/ERB/RS III Jason El-Zein, U.S. EPA, ERB 1 Melinda Dejewskie, City of St. Francis Franklin Lockwood, City of St. Francis John Maritote, U.S. EPA Roxanne Chronert, WDNR Charles Gebien, ERB/RS III	Stavros Emmanouil, U.S. EPA/ERB/RS III David Chung, U.S. EPA Andrew Boettcher, Wisconsin DNR Nola Hicks, U.S. EPA Bill Ryczek, U.S. EPA Linda Nachowicz, U.S. EPA
--	--

Subject: Continuation of Removal Action
St. Francis Auto Wreckers
4043 South Pennsylvania Avenue, St. Francis, WI
Latitude: 45.9714
Longitude: -87.88

POLREP No.: 16	Site #: B5LD
Reporting Period: 4/6/2009 through 4/10/2009	D.O. #: 0015
Start Date: 10/20/2008	Response Authority: CERCLA
Mob Date: 10/20/2008	Response Type: Time-Critical
Completion Date:	NPL Status: Non NPL
CERCLIS ID #: WID988639068	Incident Category: Removal Action
RCRIS ID #:	Contract #: EP-S5-08-02

Site Description

See initial POLREP

Current Activities

Continued the air monitoring of both the perimeter and the work area.

Continued delivery of gravel fines for backfill; continued spreading gravel fines on top of the geofabric and compacted.

Received confirmation samples analytical results from laboratory.

Planned Removal Actions

Document the post-removal site conditions.

Complete backfilling with gravel fines material.

Obtain and backfill topsoil on top of the gravel fines and complete grass seeding.

Restore Site, as necessary.

Next Steps

Complete site restoration and demobilize.

Key Issues

Secure funding for the continuation and completion of the project.

Estimated Costs *

	Budgeted	Total To Date	Remaining	% Remaining
Extramural Costs				
ERRS - Cleanup Contractor	\$1,392,963.00	\$1,312,508.49	\$80,454.51	5.78%
RST/START	\$96,620.00	\$85,301.58	\$11,318.42	11.71%
Intramural Costs				
Total Site Costs	\$1,489,583.00	\$1,397,810.07	\$91,772.93	6.16%

* The above accounting of expenditures is an estimate based on figures known to the OSC at the time this report was written. The OSC does not necessarily receive specific figures on final payments made to any contractor(s). Other financial data which the OSC must rely upon may not be entirely up-to-date. The cost accounting provided in this report does not necessarily represent an exact monetary figure which the government may include in any claim for cost recovery.

www.epaosc.net/stfrancisautowreckers

**United States Environmental Protection Agency
Region V
POLLUTION REPORT**

Date: Friday, April 03, 2009

From: Stavros Emmanouil/Craig Thomas, OSC

To:	Craig Thomas, USEPA/ERB/RS III Jason El-Zein, U.S. EPA, ERB 1 Melinda Dejewskie, City of St. Francis Franklin Lockwood, City of St. Francis John Maritote, U.S. EPA Roxanne Chronert, WDNR Charles Gebien, ERB/RS III Tracey Koach, Sullivan	Stavros Emmanouil, U.S. EPA/ERB/RS III David Chung, U.S. EPA Andrew Boettcher, Wisconsin DNR Nola Hicks, U.S. EPA Bill Ryczek, U.S. EPA Linda Nachowicz, U.S. EPA Naren Babu, TN & Associates, Inc.
------------	---	---

Subject: Continuation of Removal Action
St. Francis Auto Wreckers
4043 South Pennsylvania Avenue, St. Francis, WI
Latitude: 45.9714
Longitude: -87.88

POLREP No.: 15	Site #: B5LD
Reporting Period: 3/30/2009 through 4/3/2009	D.O. #: 0015
Start Date: 10/20/2008	Response Authority: CERCLA
Mob Date: 10/20/2008	Response Type: Time-Critical
Completion Date:	NPL Status: Non NPL
CERCLIS ID #: WID988639068	Incident Category: Removal Action
RCRIS ID #:	Contract # EP-S5-08-02

Site Description

See initial POLREP

Current Activities

Continued the air monitoring of both the perimeter and the work area.

Decontaminated tires and shipped one roll-off box of tires (6.07 tons) for recycling.

Confirmation samples were collected from the western side of the site and completed confirmation soil sampling. ERRS sent eight (8) confirmation samples to outside lab for analysis.

Completed neutralizing the excess lime material obtained for soil treatment by spreading and covering with soil.

Completed grading, compacting and installation of geofabric on top of excavated areas.

Obtained gravel fines for backfill; spread gravel fines on top of the geofabric and compacted.

Planned Removal Actions

Await confirmation sample results and document the post-removal site conditions.

Complete backfilling with gravel fines material.

Obtain and backfill topsoil on top of the gravel fines and complete grass seeding.

Restore Site, as necessary.

Next Steps

Continue the air monitoring activities.

Key Issues

Secure funding for the continuation and completion of the project.

Estimated Costs *

	Budgeted	Total To Date	Remaining	% Remaining
Extramural Costs				
ERRS - Cleanup Contractor	\$1,292,963.00	\$1,250,261.49	\$42,701.51	3.30%
RST/START	\$96,620.00	\$81,878.11	\$14,741.89	15.26%
Intramural Costs				
Total Site Costs	\$1,389,583.00	\$1,332,139.60	\$57,443.40	4.13%

* The above accounting of expenditures is an estimate based on figures known to the OSC at the time this report was written. The OSC does not necessarily receive specific figures on final payments made to any contractor(s). Other financial data which the OSC must rely upon may not be entirely up-to-date. The cost accounting provided in this report does not necessarily represent an exact monetary figure which the government may include in any claim for cost recovery.

Disposition of Wastes

Waste Stream	Quantity	Manifest #	Disposal Facility
Non-Hazardous Tires - for recycling	6.07 tons	Not Applicable; no paperwork required for recyclables	Auburndale Recycling Facility, Auburndale, WI
PCB Contaminated Soils	4,575 Tons	004659943JJK through 004659968JJK; 006213887JJK through 006213926JJK	Auburndale Recycling Facility, Auburndale, WI

epaossc.org/stfrancisautowreckers

**United States Environmental Protection Agency
Region V
POLLUTION REPORT**

Date: Wednesday, April 01, 2009

From: Stavros Emmanouil/Craig Thomas, OSC

<p>To: Craig Thomas, USEPA/ERB/RS III Jason El-Zein, U.S. EPA, ERB 1 Melinda Dejewskie, City of St. Francis Franklin Lockwood, City of St. Francis John Maritote, U.S. EPA Roxanne Chronert, WDNR Charles Gebien, ERB/RS III</p>	<p>Stavros Emmanouil, U.S. EPA/ERB/RS III David Chung, U.S. EPA Andrew Boettcher, Wisconsin DNR Nola Hicks, U.S. EPA Bill Ryczek, U.S. EPA Linda Nachowicz, U.S. EPA Naren Babu, TN & Associates, Inc.</p>
---	--

Subject: Continuation of Removal Action
St. Francis Auto Wreckers
4043 South Pennsylvania Avenue, St. Francis, WI
Latitude: 45.9714
Longitude: -87.88

POLREP No.: 14	Site #: B5LD
Reporting Period: 3/23/2009 through 3/27/2009	D.O. #: 0015
Start Date: 10/20/2008	Response Authority: CERCLA
Mob Date: 10/20/2008	Response Type: Time-Critical
Completion Date:	NPL Status: Non NPL
CERCLIS ID #: WID988639068	Incident Category: Removal Action
RCRIS ID #:	Contract #: EP-S5-08-02

Site Description

See initial POLREP

Current Activities

Continued the air monitoring of both the perimeter and the work area.

Received final analytical results for samples collected from test pits excavated in the access roads along the east and north site boundaries. Final results indicated that the soils beneath the access roads are not hazardous.

Received final analytical results for samples collected from the stockpiles #11, #12 and #13. Final results indicated that no further treatment for lead is required.

Transported and disposed of approximately 1,650 tons of PCB-contaminated soils (approximately 4,575 total tons).

ERRS began neutralizing the excess lime material obtained for soil treatment by spreading and covering with soil.

The whole excavation area was split into eight (8) grids of approximately 2,500 sq. feet each to collect confirmation soil samples. Confirmation samples were collected from four grids on the eastern side of the site.

Planned Removal Actions

Collect samples on the western side of the site and complete confirmation soil sampling. Send confirmation samples to outside lab for analysis.

Complete lime neutralization operation.

Backfill & Grade Excavated Areas.

Restore Site, as necessary.

Next Steps

Continue the air monitoring activities.

Key Issues

Secure funding for the continuation and completion of the project.

Estimated Costs *

	Budgeted	Total To Date	Remaining	% Remaining
Extramural Costs				
ERRS - Cleanup Contractor	\$1,292,963.00	\$1,232,872.05	\$60,090.95	4.65%
RST/START	\$79,420.00	\$76,992.26	\$2,427.74	3.06%
Intramural Costs				
Total Site Costs	\$1,372,383.00	\$1,309,864.31	\$62,518.69	4.56%

* The above accounting of expenditures is an estimate based on figures known to the OSC at the time this report was written. The OSC does not necessarily receive specific figures on final payments made to any contractor(s). Other financial data which the OSC must rely upon may not be entirely up-to-date. The cost accounting provided in this report does not necessarily represent an exact monetary figure which the government may include in any claim for cost recovery.

Disposition of Wastes

Waste Stream	Quantity	Manifest #	Disposal Facility
PCB Contaminated Soils	4,575 tons	004659943JJK through 004659968JJK; 006213887JJK through 006213926JJK	Wayne Disposal, Belleville, MI

www.epaosc.net/stfrancisautowreckers

**United States Environmental Protection Agency
Region V
POLLUTION REPORT**

Date: Friday, February 20, 2009

From: Stavros Emmanouil/Craig Thomas, OSC

To:	Craig Thomas, USEPA/ERB/RS III Jason El-Zein, U.S. EPA, ERB 1 Melinda Dejewskie, City of St. Francis Franklin Lockwood, City of St. Francis John Maritote, U.S. EPA Roxanne Chronert, WDNR Charles Gebien, ERB/RS III	Stavros Emmanouil, U.S. EPA/ERB/RS III David Chung, U.S. EPA Andrew Boettcher, Wisconsin DNR Nola Hicks, U.S. EPA Bill Ryczek, U.S. EPA Linda Nachowicz, U.S. EPA
------------	---	--

Subject: Continuation of Removal Action
St. Francis Auto Wreckers
4043 South Pennsylvania Avenue, St. Francis, WI
Latitude: 45.9714
Longitude: -87.88

POLREP No.:	13	Site #:	B5LD
Reporting Period:	2/16/2009 thru 2/20/2009	D.O. #:	0015
Start Date:	10/20/2008	Response Authority:	CERCLA
Mob Date:	10/20/2008	Response Type:	Time-Critical
Completion Date:		NPL Status:	Non NPL
CERCLIS ID #:	WID988639068	Incident Category:	Removal Action
RCRIS ID #:		Contract #	EP-S5-08-02

Site Description

See initial PolRep

Current Activities

Continued the air monitoring of both the perimeter and the work area.

Transported and disposed of approximately 450 tons of PCB-contaminated soils (approximately 2925 total tons).

Received draft analytical results for samples collected from test pits excavated in the access roads along the east and north site boundaries. Draft results indicated that the soils beneath the access roads are not hazardous.

Received draft analytical results for samples collected from the stockpiled soils from the site. Draft results indicated that no further treatment for lead is required.

Secured the site and de-mobilized pending final excavation-area test pit sample results and conclusion of Regional On-Scene Coordinator training.

Planned Removal Actions

Continue sampling soil stockpile & generate waste profiles.

Excavate/Treat Impacted Soils, as necessary.

Transport/Dispose Drums & Impacted Soils.

Backfill & Grade Excavated Areas.

Restore Site, as necessary.

Next Steps

Transport and dispose of treated soils, and untreated PCB-contaminated soils.

Await final test pit sample results collected in roads along the east and north boundaries of the excavation-area.

Continue the excavation of contaminated soils and buried drums to four feet below the surface, pending final excavation-area test pit sample results.

Continue the air monitoring and waste characterization sampling activities.

Continue the treatment of mixed PCB waste, pending final test pit and stockpiled soil sampling results.

Key Issues

Secure funding for the continuation and completion of the project.

Estimated Costs *

	Budgeted	Total To Date	Remaining	% Remaining
Extramural Costs				
ERRS - Cleanup Contractor	\$992,963.00	\$913,652.19	\$79,310.81	7.99%
RST/START	\$79,420.00	\$68,537.83	\$10,882.17	13.70%
Intramural Costs				
Total Site Costs	\$1,072,383.00	\$982,190.02	\$90,192.98	8.41%

* The above accounting of expenditures is an estimate based on figures known to the OSC at the time this report was written. The OSC does not necessarily receive specific figures on final payments made to any contractor(s). Other financial data which the OSC must rely upon may not be entirely up-to-date. The cost accounting provided in this report does not necessarily represent an exact monetary figure which the government may include in any claim for cost recovery.

Disposition of Wastes

Waste Stream	Quantity	Manifest #	Disposal Facility
PCB Contaminated	2925	000193530VES thru 000193538VES; 004659708JJK thru 004659710JJK; 004659934JJK thru	Wayne Disposal

Soils		004659942JJK	Belleville, MI
-------	--	--------------	-------------------

epaossc.org/stfrancisautowreckers

**United States Environmental Protection Agency
Region V
POLLUTION REPORT**

Date: Tuesday, February 17, 2009
From: Stavros Emmanouil/Craig Thomas, OSC

To:	Craig Thomas, USEPA/ERB/RS III Jason El-Zein, U.S. EPA, ERB 1 Melinda Dejewskie, City of St. Francis Franklin Lockwood, City of St. Francis John Maritote, U.S. EPA Roxanne Chronert, WDNR Charles Gebien, ERB/RS III	Stavros Emmanouil, U.S. EPA/ERB/RS III David Chung, U.S. EPA Andrew Boettcher, Wisconsin DNR Nola Hicks, U.S. EPA Bill Ryczek, U.S. EPA Linda Nachowicz, U.S. EPA
------------	---	--

Subject: Continuation of Removal Action
St. Francis Auto Wreckers
4043 South Pennsylvania Avenue, St. Francis, WI
Latitude: 45.9714
Longitude: -87.88

POLREP No.:	12	Site #:	B5LD
Reporting Period:	2/9/2009 thru 2/13/2009	D.O. #:	0015
Start Date:	10/20/2008	Response Authority:	CERCLA
Mob Date:	10/20/2008	Response Type:	Time-Critical
Completion Date:		NPL Status:	Non NPL
CERCLIS ID #:	WID988639068	Incident Category:	Removal Action
RCRIS ID #:		Contract #	EP-S5-08-02

Site Description

See initial PolRep

Current Activities

Continued the air monitoring of both the perimeter and the work area.

Transported and disposed of approximately 250 tons of PCB-contaminated soils (approximately 2475 total tons).

Continued the excavation of areas of concern. Approximately 490 cubic yards of contaminated soils (3325 total cubic yards), 39 drums (490 total drums) and 0 paint cans (67 total paint cans) were excavated.

Collected samples of excavated soils and sent to an outside lab for analysis.

Five test pits were excavated in the access roads along the east and north site property boundaries. Samples were collected and sent to an outside lab for analysis.

Planned Removal Actions

Remove and Sample Drums & Containers.

Sample soil stockpile & generate waste profiles.

Perform Hazard Categorization.

Excavate/Treat Impacted Soils, as necessary.

Transport/Dispose Drums & Impacted Soils.

Backfill & Grade Excavated Areas.

Restore Site, as necessary.

Next Steps

Transportation and disposal of treated soils.

Continue the excavation of contaminated soils and buried drums to four feet below the surface.

Continue the air monitoring and sampling activities.

Continue the treatment of the mixed PCB waste.

Key Issues

Secure funding for the continuation and completion of the project.

Estimated Costs *

	Budgeted	Total To Date	Remaining	% Remaining
Extramural Costs				
ERRS - Cleanup Contractor	\$892,963.00	\$811,965.76	\$80,997.24	9.07%
RST/START	\$79,420.00	\$66,230.70	\$13,189.30	16.61%
Intramural Costs				
Total Site Costs	\$972,383.00	\$878,196.46	\$94,186.54	9.69%

* The above accounting of expenditures is an estimate based on figures known to the OSC at the time this report was written. The OSC does not necessarily receive specific figures on final payments made to any contractor(s). Other financial data which the OSC must rely upon may not be entirely up-to-date. The cost accounting provided in this report does not necessarily represent an exact monetary figure which the government may include in any claim for cost recovery.

Disposition of Wastes

Waste Stream	Quantity	Manifest #	Disposal Facility
PCB Contaminated Soil	2475	004659676JJK thru 004659683JJK; 004659706JJK; 004659707JJK	Wayne Disposal, Belleville, MI

www.epaosc.net/stfrancisautowreckers

**United States Environmental Protection Agency
Region V
POLLUTION REPORT**

Date: Tuesday, February 10, 2009
From: Stavros Emmanouil/Craig Thomas, OSC

To: Craig Thomas, USEPA/ERB/RS III Jason El-Zein, U.S. EPA, ERB 1 Melinda Dejewskie, City of St. Francis Franklin Lockwood, City of St. Francis John Maritote, U.S. EPA Roxanne Chronert, WDNR Charles Gebien, ERB/RS III	Stavros Emmanouil, U.S. EPA/ERB/RS III David Chung, U.S. EPA Andrew Boettcher, Wisconsin DNR Nola Hicks, U.S. EPA Bill Ryczek, U.S. EPA Linda Nachowicz, U.S. EPA
--	--

Subject: Continuation of Removal Action
St. Francis Auto Wreckers
4043 South Pennsylvania Avenue, St. Francis, WI
Latitude: 45.9714
Longitude: -87.88

POLREP No.: 11	Site #: B5LD
Reporting Period: 2/2/2009 thru 2/6/2009	D.O. #: 0015
Start Date: 10/20/2008	Response Authority: CERCLA
Mob Date: 10/20/2008	Response Type: Time-Critical
Completion Date:	NPL Status: Non NPL
CERCLIS ID #: WID988639068	Incident Category: Removal Action
RCRIS ID #:	Contract #: EP-S5-08-02

Site Description

See initial PolRep

Current Activities

Continued the air monitoring of both the perimeter and the work area.

Transported and disposed of approximately 425 tons of PCB-contaminated soils (approximately 2225 total tons).

Continued the excavation of areas of concern. Approximately 415 cubic yards of contaminated soils (2835 total cubic yards), 74 drums (392 total drums) and 13 paint cans (67 total paint cans) were excavated.

Collected samples of excavated soils and sent to an outside lab for analysis.

Planned Removal Actions

Remove and Sample Drums & Containers.

Sample soil stockpile & generate waste profiles.

Perform Hazard Categorization.

Excavate/Treat Impacted Soils, as necessary.

Transport/Dispose Drums & Impacted Soils.

Backfill & Grade Excavated Areas.

Restore Site, as necessary.

Next Steps

Transportation and disposal of treated soils.

Continue the excavation of contaminated soils and buried drums to four feet below surface.

Continue the air monitoring and sampling activities.

Continue the treatment of the mixed PCB waste.

Key Issues

Secure funding for the continuation and completion of the project.

Estimated Costs *

	Budgeted	Total To Date	Remaining	% Remaining
Extramural Costs				
ERRS - Cleanup Contractor	\$892,963.00	\$737,969.73	\$154,993.27	17.36%
RST/START	\$64,370.00	\$62,097.45	\$2,272.55	3.53%
Intramural Costs				
Total Site Costs	\$957,333.00	\$800,067.18	\$157,265.82	16.43%

* The above accounting of expenditures is an estimate based on figures known to the OSC at the time this report was written. The OSC does not necessarily receive specific figures on final payments made to any contractor(s). Other financial data which the OSC must rely upon may not be entirely up-to-date. The cost accounting provided in this report does not necessarily represent an exact monetary figure which the government may include in any claim for cost recovery.

Disposition of Wastes

Waste Stream	Quantity	Manifest #	Disposal Facility
PCB Contaminated Soils	2225 Tons	004659684JJK thru 004659692JJK; 004659696JJK thru 004659702JJK	Wayne Disposal; Belleville, MI

www.epaosc.net/stfrancisautowreckers

**United States Environmental Protection Agency
Region V
POLLUTION REPORT**

Date: Wednesday, February 04, 2009
From: Stavros Emmanouil/Craig Thomas, OSC

To:	Craig Thomas, USEPA/ERB/RS III Jason El-Zein, U.S. EPA, ERB 1 Melinda Dejewskie, City of St. Francis Franklin Lockwood, City of St. Francis John Maritote, U.S. EPA Roxanne Chronert, WDNR Charles Gebien, ERB/RS III	Stavros Emmanouil, U.S. EPA/ERB/RS III David Chung, U.S. EPA Andrew Boettcher, Wisconsin DNR Nola Hicks, U.S. EPA Bill Ryczek, U.S. EPA Linda Nachowicz, U.S. EPA
------------	---	--

Subject: Continuation of Removal Action
St. Francis Auto Wreckers
4043 South Pennsylvania Avenue, St. Francis, WI
Latitude: 45.9714
Longitude: -87.88

POLREP No.:	10	Site #:	B5LD
Reporting Period:	1/26/2009 thru 1/30/2009	D.O. #:	0015
Start Date:	10/20/2008	Response Authority:	CERCLA
Mob Date:	10/20/2008	Response Type:	Time-Critical
Completion Date:		NPL Status:	Non NPL
CERCLIS ID #:	WID988639068	Incident Category:	Removal Action
RCRIS ID #:		Contract #	EP-S5-08-02

Site Description

See initial PolRep

Current Activities

Continued the air monitoring of both the perimeter and the work area.

Continued the excavation of areas of concern. Approximately 395 cubic yards of contaminated soils (2420 total cubic yards), 27 drums (318 total drums) and 6 paint cans (54 total paint cans) were excavated.

Relocated Command Post due to loss of lease.

Planned Removal Actions

Remove and Sample Drums & Containers.

Sample soil stockpile & generate waste profiles.

Perform Hazard Categorization.

Excavate/Treat Impacted Soils, as necessary.

Transport/Dispose Drums & Impacted Soils.

Backfill & Grade Excavated Areas.

Restore Site, as necessary.

Next Steps

Transportation and disposal of treated soils.

Continue the excavation of contaminated soils and buried drums.

Continue the air monitoring and sampling activities.

Continue the treatment of the mixed PCB waste.

Key Issues

Secure funding for the continuation and completion of the project.

Estimated Costs *

	Budgeted	Total To Date	Remaining	% Remaining
Extramural Costs				
ERRS - Cleanup Contractor	\$892,963.00	\$637,968.65	\$254,994.35	28.56%
RST/START	\$64,370.00	\$58,072.55	\$6,297.45	9.78%
Intramural Costs				
Total Site Costs	\$957,333.00	\$696,041.20	\$261,291.80	27.29%

* The above accounting of expenditures is an estimate based on figures known to the OSC at the time this report was written. The OSC does not necessarily receive specific figures on final payments made to any contractor(s). Other financial data which the OSC must rely upon may not be entirely up-to-date. The cost accounting provided in this report does not necessarily represent an exact monetary figure which the government may include in any claim for cost recovery.

Disposition of Wastes

Waste Stream	Quantity	Manifest #	Disposal Facility
PCB Contaminated Soils	1180 Tons		Wayne Disposal; Belleville, MI

www.epaosc.net/stfrancisautowreckers

**United States Environmental Protection Agency
Region V
POLLUTION REPORT**

Date: Thursday, January 29, 2009
From: Stavros Emmanouil/Craig Thomas, OSC

To:	Craig Thomas, USEPA/ERB/RS III Jason El-Zein, U.S. EPA, ERB 1 Melinda Dejewskie, City of St. Francis Franklin Lockwood, City of St. Francis John Maritote, U.S. EPA Roxanne Chronert, WDNR Charles Gebien, ERB/RS III	Stavros Emmanouil, U.S. EPA/ERB/RS III David Chung, U.S. EPA Andrew Boettcher, Wisconsin DNR Nola Hicks, U.S. EPA Bill Ryczek, U.S. EPA Linda Nachowicz, U.S. EPA
------------	---	--

Subject: Continuation of Removal Action
St. Francis Auto Wreckers
4043 South Pennsylvania Avenue, St. Francis, WI
Latitude: 45.9714
Longitude: -87.88

POLREP No.:	9	Site #:	B5LD
Reporting Period:	1/19/2009 thru 1/23/2009	D.O. #:	0015
Start Date:	10/20/2008	Response Authority:	CERCLA
Mob Date:	10/20/2008	Response Type:	Time-Critical
Completion Date:		NPL Status:	Non NPL
CERCLIS ID #:	WID988639068	Incident Category:	Removal Action
RCRIS ID #:		Contract #	EP-S5-08-02

Site Description

See initial PolRep

Current Activities

Continued the on-site treatment of contaminated soils by using quick lime, in order to reduce the TCLP levels of lead. Approximately 160 cubic yards of materials were treated (approximately 890 total cubic yards).

Continued the air monitoring of both the perimeter and the work area.

Collected one composite sample from the treated soils and one composite sample from pre-treated stockpiled soils for analysis by an outside lab. Analytical test results indicated that the soil treatment was successful.

Continued the excavation of areas of concern. Approximately 400 cubic yards of contaminated soils (2025 total cubic yards), 40 drums (291 total drums) and 2 paint cans (48 total paint cans) were removed.

Planned Removal Actions

Remove and Sample Drums & Containers

Sample soil stockpiles & generate waste profiles

Perform Hazard Categorization

Overpack/Repack Drums & Impacted Soils

Excavate/Treat Impacted Soils, as necessary

Transport/Dispose Drums & Impacted Soils

Backfill & Grade Excavated Areas

Restore Site, as necessary

Next Steps

Transportation and disposal of treated soils.

Continue the excavation of contaminated soils and buried drums.

Continue the air monitoring and sampling activities.

Continue the treatment of the mixed PCB waste.

Key Issues

Secure funding for the continuation and completion of the project.

Estimated Costs *

	Budgeted	Total To Date	Remaining	% Remaining
Extramural Costs				
ERRS - Cleanup Contractor	\$892,000.00	\$598,488.75	\$293,511.25	32.90%
RST/START	\$64,370.00	\$54,682.21	\$9,687.79	15.05%
Intramural Costs				
Total Site Costs	\$956,370.00	\$653,170.96	\$303,199.04	31.70%

* The above accounting of expenditures is an estimate based on figures known to the OSC at the time this report was written. The OSC does not necessarily receive specific figures on final payments made to any contractor(s). Other financial data which the OSC must rely upon may not be entirely up-to-date. The cost accounting provided in this report does not necessarily represent an exact monetary figure which the government may include in any claim for cost recovery.

Disposition of Wastes

Waste Stream	Quantity	Manifest #	Disposal Facility
PCB Contaminated Soils	1180 Tons		Wayne Disposal; Belleville, MI

www.epaosc.net/stfrancisautowreckers

**United States Environmental Protection Agency
Region V
POLLUTION REPORT**

Date: Thursday, January 15, 2009
From: Stavros Emmanouil/Craig Thomas, OSC

To: Craig Thomas, USEPA/ERB/RS III Stavros Emmanouil, U.S. EPA/ERB/RS III
Jason El-Zein, U.S. EPA, ERB 1 David Chung, U.S. EPA
Melinda Dejewskie, City of St. Francis Andrew Boettcher, Wisconsin DNR
Franklin Lockwood, City of St. Francis Nola Hicks, U.S. EPA
John Maritote, U.S. EPA Bill Ryczek, U.S. EPA
Roxanne Chronert, WDNR Linda Nachowicz, U.S. EPA
Charles Gebien, ERB/RS III

Subject: Continuation of Removal Action
St. Francis Auto Wreckers
4043 South Pennsylvania Avenue, St. Francis, WI
Latitude: 45.9714
Longitude: -87.88

POLREP No.:	8	Site #:	B5LD
Reporting Period:	1/5/2009 thru 1/9/2009	D.O. #:	0015
Start Date:	10/20/2008	Response Authority:	CERCLA
Mob Date:	10/20/2008	Response Type:	Time-Critical
Completion Date:		NPL Status:	Non NPL
CERCLIS ID #:	WID988639068	Incident Category:	Removal Action
RCRIS ID #:		Contract #	EP-S5-08-02

Site Description

See initial PolRep.

Current Activities

Continued the on-site treatment of contaminated soils by using quick lime, in order to reduce the TCLP levels of lead. Approximately 220 cubic yards of materials were treated (approximately 730 total cubic yards).

Continued the air monitoring of both the perimeter and the work area.

Collected one composite sample from the treated soils for analysis by an outside lab. Analytical test results indicated that the soil treatment was successful.

Transported and disposed off approximately 625 tons of PCB-contaminated soils (approximately 1800 total tons).

Continued the excavation of areas of concern. Approximately 75 cubic yards of contaminated soil (1700 total cubic yards), 5 drums (256 total drums) and 32 paint cans (46 total paint cans) were removed.

Secured the site for the annual OSC training.

Planned Removal Actions

Remove and Sample Drums & Containers

Sample soil stockpiles & generate waste profiles

Perform Hazard Categorization

Overpack/Repack Drums & Impacted Soils

Excavate/Treat Impacted Soils, as necessary

Transport/Dispose Drums & Impacted Soils

Backfill & Grade Excavated Areas

Restore Site, as necessary

Next Steps

Return to site after training on January 20th, 2009.

Transportation and disposal of treated soils.

Continue the excavation of contaminated soils and buried drums.

Continue the air monitoring and sampling activities.

Continue the treatment of the mixed PCB waste.

Key Issues

Secure funding for the continuation and completion of the project.

Estimated Costs *

	Budgeted	Total To Date	Remaining	% Remaining
Extramural Costs				
ERRS - Cleanup Contractor	\$892,000.00	\$482,419.58	\$409,580.42	45.92%
RST/START	\$64,370.00	\$50,274.05	\$14,095.95	21.90%
Intramural Costs				
Total Site Costs	\$956,370.00	\$532,693.63	\$423,676.37	44.30%

* The above accounting of expenditures is an estimate based on figures known to the OSC at the time this report was written. The OSC does not necessarily receive specific figures on final payments made to any contractor(s). Other financial data which the OSC must rely upon may not be entirely up-to-date. The cost accounting provided in this report does not necessarily represent an exact monetary figure which the government may include in any claim for cost recovery.

Disposition of Wastes

Waste Stream	Quantity	Manifest #	Disposal Facility
PCB-Contaminated Soils	1180 Tons	004697427, 004697428 through 004697446; 000193526 and 000193529; 004697003JJK; 004697482JJK thru 004697499JJK; 004659669JJK thru 004659675JJK	Wayne Disposal; Belleville, MI

www.epaossc.net/stfrancisautowreckers

**United States Environmental Protection Agency
Region V
POLLUTION REPORT**

Date: Friday, December 19, 2008

From: Stavros Emmanouil/Craig Thomas, OSC

To:	Craig Thomas, USEPA/ERB/RS III Jason El-Zein, U.S. EPA, ERB 1 Melinda Dejewskie, City of St. Francis Franklin Lockwood, City of St. Francis John Maritote, U.S. EPA Roxanne Chronert, WDNR Charles Gebien, ERB/RS III	Stavros Emmanouil, U.S. EPA/ERB/RS III David Chung, U.S. EPA Andrew Boettcher, Wisconsin DNR Nola Hicks, U.S. EPA Bill Ryczek, U.S. EPA Linda Nachowicz, U.S. EPA
------------	---	--

Subject: Continuation of Removal Action
St. Francis Auto Wreckers
4043 South Pennsylvania Avenue, St. Francis, WI
Latitude: 45.9714
Longitude: -87.88

POLREP No.: 7	Site #: B5LD
Reporting Period: 12/15/2008 thru 12/23/2008	D.O. #: 0015
Start Date: 10/20/2008	Response Authority: CERCLA
Mob Date: 10/20/2008	Response Type: Time-Critical
Completion Date:	NPL Status: Non NPL
CERCLIS ID #: WID988639068	Incident Category: Removal Action
RCRIS ID #:	Contract #: EP-S5-08-02

Site Description

See initial PolRep.

Current Activities

Continued the on-site treatment of contaminated soils by using quick lime, in order to reduce the TCLP levels of lead. Approximately 30 cubic yards of materials were treated.

Continued removing the contents of the excavated drums.

Continued the air monitoring of both the perimeter and the work area.

Collected one composite sample from the treated soils for analysis by an outside lab. Analytical test results indicated that the soil treatment was successful.

Transported and disposed off approximately 575 tons of PCB-contaminated soils (approximately 1175 total tons).

Verified that all drums were removed from sections of the excavation zone and started backfilling the area. Confirmation samples were taken from these areas prior to backfilling.

Continued the excavation of areas of concern. Approximately 225 cubic yards of contaminated soils (1625 total cubic yards), 61 drums (251 total drums) and 14 paint cans (14 total paint cans)

were removed.

Secured the site for the Holiday Break.

Planned Removal Actions

Remove and Sample Drums & Containers

Sample soil stockpiles & generate waste profiles

Perform Hazard Categorization

Overpack/Repack Drums & Containers

Excavate/Treat Impacted Soils, as necessary

Transport/Dispose Drums & Impacted Soils

Backfill & Grade Excavated Areas

Restore Site, as necessary

Next Steps

Return to site after Holiday Break on January 5th, 2009.

Transportation and disposal of treated soils.

Continue the excavation of contaminated soils and buried drums.

Continue the air monitoring and the sampling activities.

Continue the treatment of the mixed PCB waste.

Key Issues

Secure funding for the continuation and completion of the project.

Estimated Costs *

	Budgeted	Total To Date	Remaining	% Remaining
Extramural Costs				
ERRS - Cleanup Contractor	\$892,000.00	\$391,816.00	\$500,184.00	56.07%
RST/START	\$50,980.00	\$46,343.33	\$4,636.67	9.10%
Intramural Costs				
Total Site Costs	\$942,980.00	\$438,159.33	\$504,820.67	53.53%

* The above accounting of expenditures is an estimate based on figures known to the OSC at the time this report was written. The OSC does not necessarily receive specific figures on final payments made to any contractor(s). Other financial data which the OSC must rely upon may not be entirely up-to-date. The cost accounting provided in this report does not necessarily represent an

exact monetary figure which the government may include in any claim for cost recovery.

Disposition of Wastes

Waste Stream	Quantity	Manifest #	Disposal Facility
PCB-Contaminated Soils	1175 Tons	004697003 thru 7012JJK; 004697015JJK; 004697016JJK; 004697428 thru 7446JJK; 004697469 thru 7481JJK; 000193526, 000193527, & 000193529VES	Wayne Disposal; Belleville, MI

epaossc.org/stfrancisautowreckers

**United States Environmental Protection Agency
Region V
POLLUTION REPORT**

Date: Friday, December 19, 2008
From: Stavros Emmanouil/Craig Thomas, OSC

To: Jason El-Zein, U.S. EPA, ERB 1
David Chung, U.S. EPA
Andrew Boettcher, Wisconsin DNR
Nola Hicks, U.S. EPA
Roxanne Chronert, WDNR

Tom Geishecker, U.S. EPA
Melinda Dejewskie, City of St. Francis
Franklin Lockwood, City of St. Francis
Bill Ryczek, U.S. EPA

Subject: Continuation of Removal Action
St. Francis Auto Wreckers
4043 South Pennsylvania Avenue, St. Francis, WI
Latitude: 45.9714
Longitude: -87.88

POLREP No.:	6	Site #:	B5LD
Reporting Period:	12/8/2008 thru 12/12/2008	D.O. #:	0015
Start Date:	10/20/2008	Response Authority:	CERCLA
Mob Date:	10/20/2008	Response Type:	Time-Critical
Completion Date:		NPL Status:	Non NPL
CERCLIS ID #:	WID988639068	Incident Category:	Removal Action
RCRIS ID #:		Contract #	EP-S5-08-02

Site Description

See initial PolRep.

Current Activities

Continued the on-site treatment of contaminated soils by using quick lime, in order to reduce the TCLP levels of lead. Approximately 300 cubic yards of materials were treated.

Began removing the contents of the excavated drums.

Continued the air monitoring of both the perimeter and the work area.

Collected one composite sample from the treated soils for analysis by an outside lab. Analytical test results indicated that the soil treatment was successful.

Transported and disposed off approximately 75 tons of PCB-contaminated soils.

Planned Removal Actions

Remove and Sample Drums & Containers

Sample soil stockpiles & generate waste profiles

Perform Hazard Categorization

Overpack/Repack Drums & Containers

Excavate/Treat Impacted Soils, as necessary

Transport/Dispose Drums & Impacted Soils

Backfill & Grade Excavated Areas

Restore Site, as necessary

Next Steps

Continue the on-site treatment of contaminated soils.

Sample the treated material and arrange for disposal.

On-site treatment of the materials that were removed from the excavated drums.

Transportation and disposal of the treated PCB contaminated soils.

Key Issues

Secure funding for the continuation and completion of the project.

Estimated Costs *

	Budgeted	Total To Date	Remaining	% Remaining
Extramural Costs				
ERRS - Cleanup Contractor	\$892,000.00	\$285,370.00	\$606,630.00	68.01%
RST/START	\$50,980.00	\$39,387.79	\$11,592.21	22.74%
Intramural Costs				
Total Site Costs	\$942,980.00	\$324,757.79	\$618,222.21	65.56%

* The above accounting of expenditures is an estimate based on figures known to the OSC at the time this report was written. The OSC does not necessarily receive specific figures on final payments made to any contractor(s). Other financial data which the OSC must rely upon may not be entirely up-to-date. The cost accounting provided in this report does not necessarily represent an exact monetary figure which the government may include in any claim for cost recovery.

Disposition of Wastes

Waste Stream	Quantity	Manifest #	Disposal Facility
PCB-Contaminated Soils	600 Tons	004697003 JJK; 004697004 JJK; 004697428 through 004697446 JJK; 000193526 VES; 000193526 VES; 000193529 VES	Wayne Disposal; Belleville, MI

www.epaosc.org/stfrancisautowreckers

**United States Environmental Protection Agency
Region V
POLLUTION REPORT**

Date: Friday, December 05, 2008

From: Stavros Emmanouil/Craig Thomas, OSC

To: Jason El-Zein, U.S. EPA, ERB 1 David Chung, U.S. EPA Andrew Boettcher, Wisconsin DNR Nola Hicks, U.S. EPA Roxanne Chronert, WDNR	Tom Geishecker, U.S. EPA Melinda Dejewskie, City of St. Francis Franklin Lockwood, City of St. Francis Bill Ryczek, U.S. EPA
---	---

Subject: Continuation of Removal Action
St. Francis Auto Wreckers
4043 South Pennsylvania Avenue, St. Francis, WI
Latitude: 45.9714
Longitude: -87.88

POLREP No.: 5	Site #: B5LD
Reporting Period: 12/3/2008 thru 12/5/2008	D.O. #: 0015
Start Date: 10/20/2008	Response Authority: CERCLA
Mob Date: 10/20/2008	Response Type: Time-Critical
Completion Date:	NPL Status: Non NPL
CERCLIS ID #: WID988639068	Incident Category: Removal Action
RCRIS ID #:	Contract #: EP-S5-08-02

Site Description

See initial PolRep.

Current Activities

Began the on-site soil treatment of the contaminated soils by using quick lime, in order to reduce the TCLP levels of lead. Approximately 200 cubic yards of materials were treated.

Continued the air monitoring of both the perimeter and the work area.

Collected two soil samples for analysis by an outside lab.

Planned Removal Actions

Remove and Sample Drums & Containers

Sample soil stockpiles & generate waste profiles

Perform Hazard Categorization

Overpack/Repack Drums & Containers

Excavate/Treat Impacted Soils, as necessary

Transport/Dispose Drums & Impacted Soils

Backfill & Grade Excavated Areas

Restore Site, as necessary

Next Steps

Continue the on-site treatment of contaminated soils.

Sample the treated material and arrange for disposal.

Transportation and disposal of PCB contaminated soils with TCLP lead levels below the regulatory limit.

Prepare for the treatment of the contents of the drums.

Key Issues

Secure funding for the continuation and completion of the project.

Estimated Costs *

	Budgeted	Total To Date	Remaining	% Remaining
Extramural Costs				
ERRS - Cleanup Contractor	\$892,000.00	\$231,714.00	\$660,286.00	74.02%
RST/START	\$50,980.00	\$35,264.00	\$15,716.00	30.83%
Intramural Costs				
Total Site Costs	\$942,980.00	\$266,978.00	\$676,002.00	71.69%

* The above accounting of expenditures is an estimate based on figures known to the OSC at the time this report was written. The OSC does not necessarily receive specific figures on final payments made to any contractor(s). Other financial data which the OSC must rely upon may not be entirely up-to-date. The cost accounting provided in this report does not necessarily represent an exact monetary figure which the government may include in any claim for cost recovery.

www.epaosc.org/stfrancisautowreckers

**United States Environmental Protection Agency
Region V
POLLUTION REPORT**

Date: Monday, November 24, 2008
From: Stavros Emmanouil/Craig Thomas, OSC

To: Jason El-Zein, U.S. EPA, ERB 1
 David Chung, U.S. EPA
 Andrew Boettcher, Wisconsin DNR
 Nola Hicks, U.S. EPA
 Roxanne Chronert, WDNR

Tom Geishecker, U.S. EPA
 Melinda Dejewskie, City of St. Francis
 Franklin Lockwood, City of St. Francis
 Bill Ryczek, U.S. EPA

Subject: Continuation of Removal Action
 St. Francis Auto Wreckers
 4043 South Pennsylvania Avenue, St. Francis, WI
 Latitude: 45.9714
 Longitude: -87.88

POLREP No.:	4	Site #:	B5LD
Reporting Period:	11/17/2008 thru 11/21/2008	D.O. #:	0015
Start Date:	10/20/2008	Response Authority:	CERCLA
Mob Date:	10/20/2008	Response Type:	Time-Critical
Completion Date:		NPL Status:	Non NPL
CERCLIS ID #:	WID988639068	Incident Category:	Removal Action
RCRIS ID #:		Contract #	EP-S5-08-02

Site Description

See initial PolRep.

Current Activities

Continued the transportation and disposal of the PCB-contaminated soils. Approximately 500 tons of PCB-contaminated soil were shipped to Wayne Disposal facility in Detroit for landfilling.

Continued the segregation of the drums and containers. A total of 190 drums have been removed to date.

Continued the air monitoring of both the perimeter and the work area.

Conducted a treatability study for lead, and samples were sent to an outside lab, for analysis.

Prepared and secured the site for the holiday break.

Planned Removal Actions

Remove and Sample Drums & Containers

Sample soil stockpiles & generate waste profiles

Perform Hazard Categorization

Overpack/Repack Drums & Containers

Excavate/Treat Impacted Soils, as necessary

Transport/Dispose Drums & Impacted Soils

Backfill & Grade Excavated Areas

Restore Site, as necessary

Next Steps

Receive analytical test results from the treatability study. Determine the proper concentration of quick lime needed to treat the lead. Plan the on site treatment operations.

Continue hauling excavated and treated soils from the site, to the proper disposal facility.

Continue excavation operations.

Key Issues

Secure funding for the continuation and completion of the project.

Estimated Costs *

	Budgeted	Total To Date	Remaining	% Remaining
Extramural Costs				
ERRS - Cleanup Contractor	\$892,000.00	\$195,553.00	\$696,447.00	78.08%
RST/START	\$27,000.00	\$26,223.00	\$777.00	2.88%
Intramural Costs				
Total Site Costs	\$919,000.00	\$221,776.00	\$697,224.00	75.87%

* The above accounting of expenditures is an estimate based on figures known to the OSC at the time this report was written. The OSC does not necessarily receive specific figures on final payments made to any contractor(s). Other financial data which the OSC must rely upon may not be entirely up-to-date. The cost accounting provided in this report does not necessarily represent an exact monetary figure which the government may include in any claim for cost recovery.

Disposition of Wastes

Waste Stream	Quantity	Manifest #	Disposal Facility
PCB-Contaminated Soils	525 Tons	004697428 through 004697446, 000193526 and 000193529	WAYNE DISPOSAL; BELLEVILLE, MI

www.epaosc.org/stfrancisautowreckers

**United States Environmental Protection Agency
Region V
POLLUTION REPORT**

Date: Friday, November 14, 2008

From: Stavros Emmanouil/Craig Thomas, OSC

To:	Jason El-Zein, U.S. EPA, ERB 1	Tom Geishecker, U.S. EPA
	David Chung, U.S. EPA	Melinda Dejewskie, City of St. Francis
	Andrew Boettcher, Wisconsin DNR	Franklin Lockwood, City of St. Francis
	Nola Hicks, U.S. EPA	Bill Ryczek, U.S. EPA
	Roxanne Chronert, WDNR	

Subject: St. Francis Auto Wreckers
4043 South Pennsylvania Avenue, St. Francis, WI
Latitude: 45.9714
Longitude: -87.88

POLREP No.:	3	Site #:	B5LD
Reporting Period:	11/3/2008 thru 11/6/2008	D.O. #:	0015
Start Date:	10/20/2008	Response Authority:	CERCLA
Mob Date:	10/20/2008	Response Type:	Time-Critical
Completion Date:		NPL Status:	Non NPL
CERCLIS ID #:	WID988639068	Incident Category:	Removal Action
RCRIS ID #:		Contract #	EP-S5-08-02

Site Description

See initial PolRep.

Current Activities

Continued the excavation of the contaminated areas.

Approximately 1200 cubic yards of PCB-contaminated soils and 450 cubic yards on non-PCB-contaminated soils have been excavated and stockpiled so far.

Continued the segregation of the drums and containers.

190 drums have been removed to date.

Began setting up for transportation and disposal of the contaminated soils.

Continued the air monitoring of both the perimeter and the work area.

Loaded and hauled 25 tons of PCB-contaminated soil to the disposal facility for landfilling.

Planned Removal Actions

- Remove and Sample Drums & Containers
- Sample soil stockpiles & generate waste profiles
- Perform Hazard Categorization
- Overpack/Repack Drums & Containers

- Excavate/Treat Impacted Soils, as necessary
- Transport/Dispose Drums & Impacted Soils
- Backfill & Grade Excavated Areas
- Restore Site, as necessary

Next Steps

- Continue hauling excavated soils from site, once a proper disposal facility has been coordinated.
- Continue excavation operations.

Key Issues

The disposal facility analytical indicated high levels of lead and TCE for some of the waste. As a result of this, this portion of the waste will either have to be treated on site or incinerated.

Estimated Costs *

	Budgeted	Total To Date	Remaining	% Remaining
Extramural Costs				
ERRS - Cleanup Contractor	\$250,000.00	\$82,287.00	\$167,713.00	67.09%
RST/START	\$27,000.00	\$14,661.00	\$12,339.00	45.70%
Intramural Costs				
Total Site Costs	\$277,000.00	\$96,948.00	\$180,052.00	65.00%

* The above accounting of expenditures is an estimate based on figures known to the OSC at the time this report was written. The OSC does not necessarily receive specific figures on final payments made to any contractor(s). Other financial data which the OSC must rely upon may not be entirely up-to-date. The cost accounting provided in this report does not necessarily represent an exact monetary figure which the government may include in any claim for cost recovery.

Disposition of Wastes

Waste Stream	Quantity	Manifest #	Disposal Facility
PCB CONTAMINATED SOILS	25 TONS	004697427	WAYNE DISPOSAL, BELLEVILLE, MI

www.epaosc.org/stfrancisautowreckers

**United States Environmental Protection Agency
Region V
POLLUTION REPORT**

Date: Wednesday, November 05, 2008

From: Stavros Emmanouil/Craig Thomas, OSC

To: Jason El-Zein, U.S. EPA, ERB 1
David Chung, U.S. EPA
Andrew Boettcher, Wisconsin DNR
Nola Hicks, U.S. EPA
Roxanne Chronert, WDNR

Tom Geishecker, U.S. EPA
Melinda Dejewskie, City of St. Francis
Franklin Lockwood, City of St. Francis
Bill Ryczek, U.S. EPA

Subject: Continuation of Removal Action
St. Francis Auto Wreckers
4043 South Pennsylvania Avenue, St. Francis, WI
Latitude: 45.9714
Longitude: -87.88

POLREP No.:	2	Site #:	B5LD
Reporting Period:	10/27/2008 to 10/31/2008	D.O. #:	0015
Start Date:	10/20/2008	Response Authority:	CERCLA
Mob Date:	10/20/2008	Response Type:	Time-Critical
Completion Date:		NPL Status:	Non NPL
CERCLIS ID #:	WID988639068	Incident Category:	Removal Action
RCRIS ID #:		Contract #	EP-S5-08-02

Site Description

See initial PolRep.

Current Activities

Continued the excavation of the contaminated areas.

Approximately 900 cubic yards of PCB-contaminated soils and 300 cubic yards on non-PCB-contaminated soils have been removed and stockpiled so far.

Continued the segregation of the drums and containers.

Approximately 140 drums have been removed to date.

Collected two soil samples from the stockpiles for disposal analysis.

Began setting up for transportation and disposal of the contaminated soils.

Continued the air sampling of both the perimeter and the work area.

Planned Removal Actions

- Remove and Sample Drums & Containers
- Sample soil stockpiles & generate waste profiles
- Perform Hazard Categorization

- Overpack/Repack Drums & Containers
- Excavate/Treat Impacted Soils, as necessary
- Transport/Dispose Drums & Impacted Soils
- Backfill & Grade Excavated Areas
- Restore Site, as necessary

Next Steps

- Begin hauling excavated soils from site.
- Continue excavation operations.
-

Key Issues

None.

Estimated Costs *

	Budgeted	Total To Date	Remaining	% Remaining
Extramural Costs				
ERRS - Cleanup Contractor	\$250,000.00	\$59,553.00	\$190,447.00	76.18%
RST/START	\$27,000.00	\$6,987.00	\$20,013.00	74.12%
Intramural Costs				
Total Site Costs	\$277,000.00	\$66,540.00	\$210,460.00	75.98%

* The above accounting of expenditures is an estimate based on figures known to the OSC at the time this report was written. The OSC does not necessarily receive specific figures on final payments made to any contractor(s). Other financial data which the OSC must rely upon may not be entirely up-to-date. The cost accounting provided in this report does not necessarily represent an exact monetary figure which the government may include in any claim for cost recovery.

www.epaosc.net/stfrancisautowreckers

**United States Environmental Protection Agency
Region V
POLLUTION REPORT**

Date: Friday, October 24, 2008

From: Stavros Emmanouil/Craig Thomas, OSC

To: Jason El-Zein, U.S. EPA, ERB 1
David Chung, U.S. EPA
Andrew Boettcher, Wisconsin DNR
Nola Hicks, U.S. EPA
Roxanne Chronert, WDNR

Tom Geishecker, U.S. EPA
Melinda Dejewskie, City of St. Francis
Franklin Lockwood, City of St. Francis
Bill Ryczek, U.S. EPA

Subject: INITIATION OF ACTION
St. Francis Auto Wreckers
4043 South Pennsylvania Avenue, St. Francis, WI
Latitude: 45.9714
Longitude: -87.88

POLREP No.:	1	Site #:	B5LD
Reporting Period:	10/20/2008 - 10/24/2008	D.O. #:	
Start Date:	10/20/2008	Response Authority:	CERCLA
Mob Date:	10/20/2008	Response Type:	Time-Critical
Completion Date:		NPL Status:	Non NPL
CERCLIS ID #:	WID988639068	Incident Category:	Removal Action
RCRIS ID #:		Contract #	

Site Description

The St. Francis Autowreckers Site is an active auto salvage yard located in a populated, mixed residential and commercial area within the city of St. Francis, Wisconsin. The Site is located at 4043 South Pennsylvania Avenue and covers approximately 115,000 square feet. A trench/drainage area runs east to west directly north of the St. Francis Auto Wrecker's office.

Auto salvage and recycling operations were conducted at the site for the past 40 years. The operations were primarily confined to the southern half of the site area. Previous records and inspections indicate that the northern portion of the site was once a portion of a landfill for the Town of Lake, Wisconsin, and was purchased by the site owner to expand his business. The area of concern is approximately 230 feet by 200 feet on the northern portion of the property.

Based on previous sampling by the Wisconsin Department of Natural Resources (WDNR) and the Wisconsin Department of Transportation (WDOT), elevated levels of PCBs, volatile organic compounds and evidence of buried drums were detected. In October 2007, at the request of the WDNR, U.S. EPA performed a site assessment.

Sampling activities were conducted in the previous WDNR test pit areas consisting of two samples, SS-1 and SS-2. A third sample, SS-3 was collected from the drainage/trench area that runs in an east to west direction, north of the St. Francis Auto Wreckers main building.

Sample results showed lead, chromium and PCB contamination above RCRA limits in SS-1 (refer to Site Assessment Report prepared by STN Environmental, dated June 5, 2008). Trace levels of PCB's (>1 mg/kg) were found in SS-2 and SS-3. Historical WDNR and WDOT sample results show the presence of TCE above RCRA limits within the areas of the test pits, along with TCLP

VOC flashpoint results of <140°, showing that some soil may be considered ignitable. Based on these a results, an action memo to conduct a time-critical removal action was approved.

Current Activities

- Mobilized personnel & equipment
- Began excavating area of concern; based on field screening excavated approximately 300 yards of potentially PCB-contaminated soil and approximately 95 yards of non-PCB-contaminated soil.
- Stockpiled soil from excavation
- Segregated drums and containers; approximately 55 drums have been removed to date
- Submitted two soil samples from two soil stockpiles
- Began setting up soil disposal

Planned Removal Actions

- Remove Drums & Containers
- Sample Drums & Containers
- Sample soil stockpiles & generate waste profiles
- Perform Hazard Categorization
- Overpack/Repack Drums & Containers
- Excavate/Treat Impacted Soils, as necessary
- Transport/Dispose Drums & Impacted Soils
- Backfill & Grade Excavated Areas
- Restore Site, as necessary

Next Steps

Evaluate the use of an on-site lab or a local lab with rapid turn-around time.

Continue conducting planned removal actions.

Key Issues

None

Estimated Costs *

	Budgeted	Total To Date	Remaining	% Remaining
Extramural Costs				
Intramural Costs				
Total Site Costs	\$0.00	\$0.00	\$0.00	0.00%

* The above accounting of expenditures is an estimate based on figures known to the OSC at the time this report was written. The OSC does not necessarily receive specific figures on final

payments made to any contractor(s). Other financial data which the OSC must rely upon may not be entirely up-to-date. The cost accounting provided in this report does not necessarily represent an exact monetary figure which the government may include in any claim for cost recovery.

www.epaosc.net/stfrancisautowreckers