

December 4, 2019

Keith Kutzt  
Kutzt Properties, LLC  
151441 Jonquil Lane  
Wausau, WI 54401-8212

**Subject: Sub-Slab Confirmation Vapor Sampling Results  
For Building Located Next To Former Kraft Cleaners Site  
301 S. Second Avenue  
Wausau, Wisconsin  
WDNR BRRTS No. 02-37-000294  
AECOM Project No. 60299959**

Dear Mr. Kutzt:

On February 4 and June 24, 2019, AECOM performed sub-slab confirmation vapor sampling within your small commercial building located at 301 S. Second Avenue. The confirmation sampling and laboratory analysis for chlorinated volatile organic compounds (CVOCs) was completed for the purpose of supporting a forthcoming regulatory case closure request for the Former Kraft Cleaners site.

Laboratory analytical results for the sub-slab confirmation vapor samples compared to Wisconsin's small commercial and residential sub-slab Vapor Risk Screening Levels (VRSLs) are summarized in the enclosed table. The confirmation laboratory results for your building are also depicted on the enclosed site figure. Low-level tetrachloroethene (PCE), trichloroethene (TCE) and cis 1,2-Dichloroethene (cis 1,2-DCE) were detected below their respective Wisconsin small commercial and residential VRSLs. Therefore, no further sampling is planned or has been authorized by the Wausau Community Development Authority, responsible party for the Former Kraft Cleaners site.

Thank you for your continued cooperation in this matter. Please contact me at (715) 342-3038 if you have any questions.

Sincerely,



Kyle Wagoner, P.G, CHMM  
Project Manager

Enclosures: As Noted

c/encl: Christian Schock, Director, Wausau Community Development Authority (electronic only)  
Kevin Fabel, Environmental Coordinator, City of Wausau (electronic only)  
Matthew Thompson, Wisconsin DNR – Eau Claire office (electronic only)

**Sub-Slab Vapor Confirmation Sampling Results**  
**Former Kraft Cleaners Site**  
**Wausau, WI**  
**BRRTS No. 02-37-000294**

			<b>Sample Location:</b>		<b>301 S. 2nd Ave</b>		
			<b>Sample ID:</b>		<b>VP-7</b>		
			<b>Date Collected:</b>		<b>2/4/2019</b>	<b>6/24/2019</b>	
			<b>Sample Type:</b>		<b>Sub-Slab</b>	<b>Sub-Slab</b>	
<b>Analyte</b>	<b>Small Commercial Sub-Slab VRSL (<math>\mu\text{g}/\text{m}^3</math>)</b>	<b>Residential Sub-Slab VRSL (<math>\mu\text{g}/\text{m}^3</math>)</b>	<b>Results</b>				
<b>TO-15 Short List CVOCs (<math>\mu\text{g}/\text{m}^3</math>)</b>							
cis 1,2-Dichloroethene (cis 1,2-DCE)	NE	NE	<0.92	<0.40			
trans-1,2-Dichloroethene (trans 1,2-DCE)	NE	NE	<1.2	<0.52			
Tetrachloroethene (PCE)	6,000	1,400	72.7	757			
Trichloroethene (TCE)	290	70	<1.1	1.3			
Vinyl Chloride (VC)	930	57	<0.53	<0.23			

**Notes:**

NE = not established

VRSL = Vapor Risk Screening levels

Small Commercial and Residential Sub-slab Vapor Risk Screening Levels (VRSLs) are taken from the WDNR Quick Look-up Table and are based on U.S. EPA Regional Screening Levels, updated November 2017.

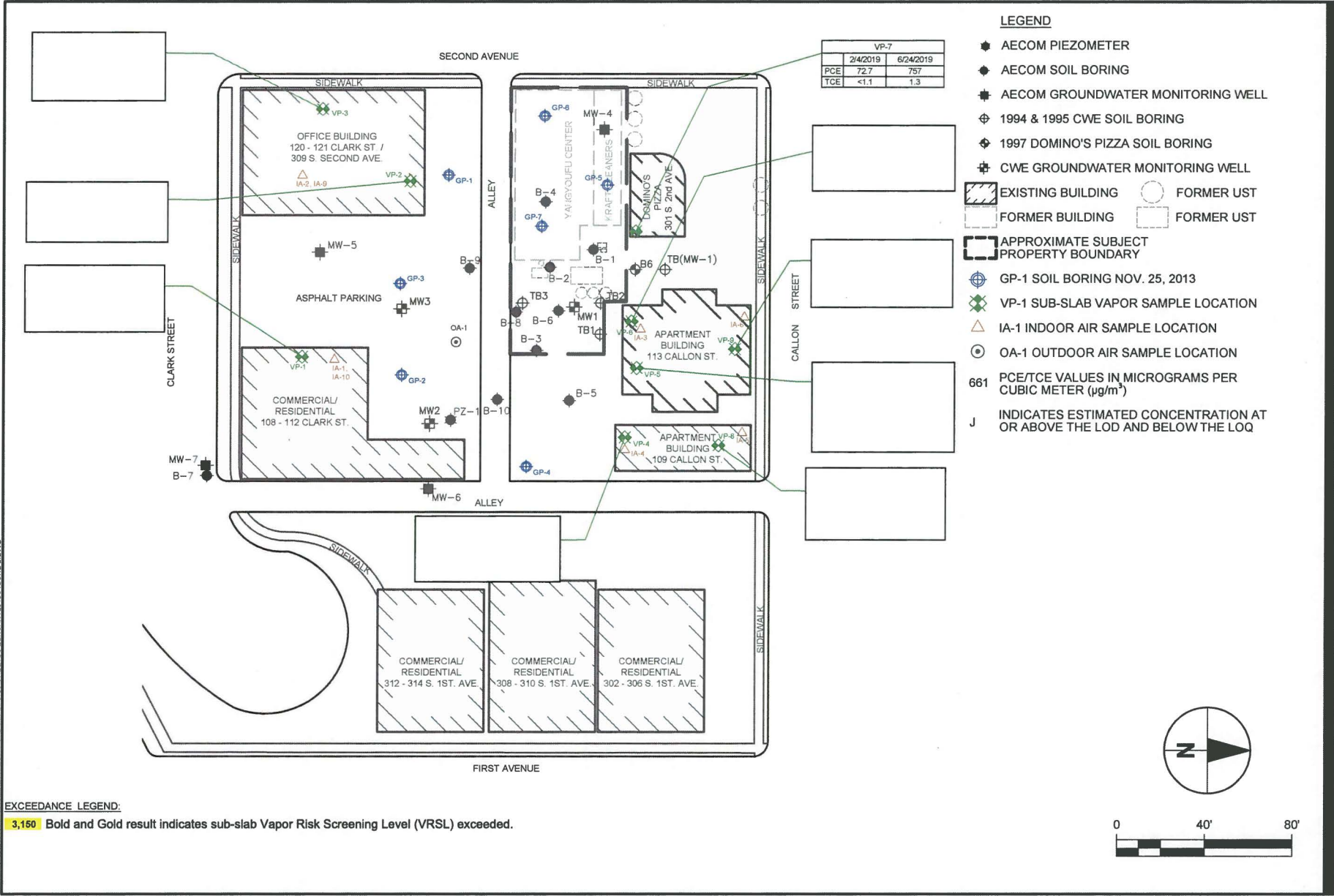

**EXCEEDANCE LEGEND:**  
**3,150** Bold and Gold result indicates sub-slab Vapor Risk Screening Level (VRSL) exceeded.

VP-7	
2/4/2019	6/24/2019
PCE 72.7	757
TCE <1.1	1.3

- LEGEND**
- ◆ AECOM PIEZOMETER
  - ◆ AECOM SOIL BORING
  - ◆ AECOM GROUNDWATER MONITORING WELL
  - ⊕ 1994 & 1995 CWE SOIL BORING
  - ◆ 1997 DOMINO'S PIZZA SOIL BORING
  - ◆ CWE GROUNDWATER MONITORING WELL
  - ▨ EXISTING BUILDING
  - ▭ FORMER BUILDING
  - FORMER UST
  - FORMER UST
  - ▭ APPROXIMATE SUBJECT PROPERTY BOUNDARY
  - ⊕ GP-1 SOIL BORING NOV. 25, 2013
  - ⊗ VP-1 SUB-SLAB VAPOR SAMPLE LOCATION
  - △ IA-1 INDOOR AIR SAMPLE LOCATION
  - ⊙ OA-1 OUTDOOR AIR SAMPLE LOCATION
  - 661 PCE/TCE VALUES IN MICROGRAMS PER CUBIC METER (µg/m<sup>3</sup>)
  - J INDICATES ESTIMATED CONCENTRATION AT OR ABOVE THE LOD AND BELOW THE LOQ

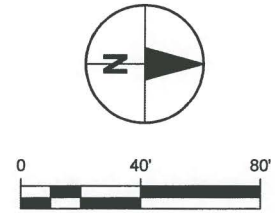

December 4, 2019

Arden J. Emmerich  
Emmerich & Associates, Inc.  
453 Grand Avenue  
Schofield, WI 54476-1088

**Subject: Sub-Slab Confirmation Vapor Sampling Results  
For Buildings Located Next To Former Kraft Cleaners Site  
108 - 112 Clark Street and 309 S. Second Avenue/120 Clark Street  
Wausau, Wisconsin  
WDNR BRRTS No. 02-37-000294  
AECOM Project No. 60299959**

Dear Mr. Emmerich:

On February 4 and June 24, 2019, AECOM performed sub-slab confirmation vapor sampling within the basements of your small commercial and residential buildings located at 108 - 112 Clark Street and 309 S. Second Avenue/120 Clark Street. The confirmation sampling and laboratory analysis for chlorinated volatile organic compounds (CVOCs) was completed for the purpose of supporting a forthcoming regulatory case closure request for the Former Kraft Cleaners site.

Laboratory analytical results for the sub-slab confirmation vapor samples compared to Wisconsin's small commercial and residential sub-slab Vapor Risk Screening Levels (VRSLs) are summarized in the enclosed table. The confirmation laboratory results for your buildings are also depicted on the enclosed site figure. Low-level tetrachloroethene (PCE) and trichloroethene (TCE) were detected below their respective Wisconsin residential VRSLs. Therefore, no further sampling is planned or has been authorized by the Wausau Community Development Authority, responsible party for the Former Kraft Cleaners site.

Thank you for your continued cooperation in this matter. Please contact me at (715) 342-3038 if you have any questions.

Sincerely,



Kyle Wagoner, P.G, CHMM  
Project Manager

Enclosures: As Noted

c/encl: Christian Schock, Director, Wausau Community Development Authority (electronic only)  
Kevin Fabel, Environmental Coordinator, City of Wausau (electronic only)  
Matthew Thompson, Wisconsin DNR – Eau Claire office (electronic only)



**Sub-Slab Vapor Confirmation Sampling Results**  
**Former Kraft Cleaners Site**  
**Wausau, WI**  
**BRRTS No. 02-37-000294**

			Sample Location:		108-112 Clark Street		309 S. 2nd Ave./120 Clark Street			
			Sample ID:		VP-1		VP-2		VP-3	
			Date Collected:		2/4/2019	6/24/2019	2/4/2019	6/24/2019	2/4/2019	6/24/2019
			Sample Type:		Sub-Slab		Sub-Slab		Sub-Slab	
Analyte	Small Commercial Sub-Slab VRSL ( $\mu\text{g}/\text{m}^3$ )	Residential Sub-Slab VRSL ( $\mu\text{g}/\text{m}^3$ )	Results							
<b>TO-15 Short List CVOCs (<math>\mu\text{g}/\text{m}^3</math>)</b>										
cis 1,2-Dichloroethene (cis 1,2-DCE)	NE	NE	<0.39	<0.38	<0.37	<0.40	<0.36	<0.40		
trans-1,2-Dichloroethene (trans 1,2-DCE)	NE	NE	<0.51	<0.50	<0.48	<0.52	<0.47	<0.52		
Tetrachloroethene (PCE)	6,000	1,400	232	200	349	455	13.5	31.1		
Trichloroethene (TCE)	290	70	<0.46	<0.45	<0.43	<0.47	<0.42	3.1		
Vinyl Chloride (VC)	930	57	<0.23	<0.22	<0.21	<0.23	<0.21	<0.23		

**Notes:**

NE = not established

VRSL = Vapor Risk Screening Level

Small Commercial and Residential Sub-slab Vapor Risk Screening Levels (VRSLs) are taken from the WDNR Quick Look-up Table and are based on U.S. EPA Regional Screening Levels, updated November 2017.

ANSI B 11 \* 1.7  
 Approved DSS  
 Checked RSR  
 Designer: KAM  
 Project Management Initials:  
 Last saved by: WILLIAM MAHON(2018-07-18) Last Printed: 2018-07-18 Layout Name: JUN-FIGURE 1 312 - 314 S. FIRST AVE  
 Filename: P:\22285559\2018\WORKING\DOCS-CAD\10-CAD\10-SHET\FEBRUARY 2019\FIGURE 2.DWG

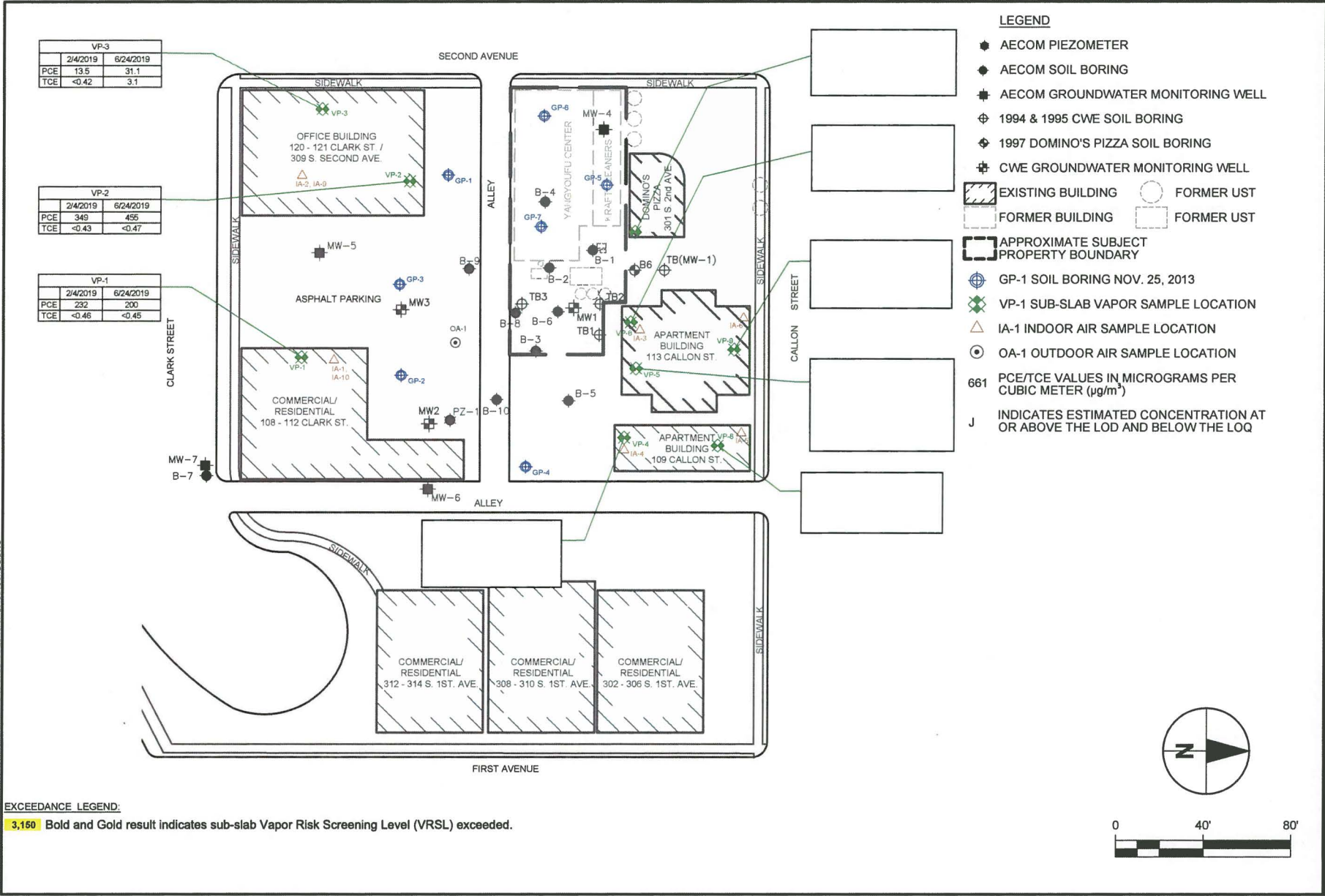

December 4, 2019

Craig Filiatreux  
Filiatreux Investments, LLC  
2301 5<sup>th</sup> Avenue  
Edgar, WI 54426-9430

**Subject: Sub-Slab Confirmation Vapor Sampling Results  
For Building Located Next To Former Kraft Cleaners Site  
109 Callon Street  
Wausau, Wisconsin  
WDNR BRRTS No. 02-37-000294  
AECOM Project No. 60299959**

Dear Mr. Filiatreux:

On February 4 and June 24, 2019, AECOM performed sub-slab confirmation vapor sampling within the basement of your apartment building located at 109 Callon Street. The confirmation sampling and laboratory analysis for chlorinated volatile organic compounds (CVOCs) was completed for the purpose of supporting a forthcoming regulatory case closure request for the Former Kraft Cleaners site.

Laboratory analytical results for the sub-slab confirmation vapor samples compared to Wisconsin's residential sub-slab Vapor Risk Screening Levels (VRSLs) are summarized in the enclosed table. The confirmation laboratory results for your building are also depicted on the enclosed site figure. Low-level tetrachloroethene (PCE), trichloroethene (TCE) and cis 1,2-Dichloroethene (cis 1,2-DCE) were detected below their respective Wisconsin residential VRSLs. Therefore, no further sampling is planned or has been authorized by the Wausau Community Development Authority, responsible party for the Former Kraft Cleaners site.

Thank you for your continued cooperation in this matter. Please contact me at (715) 342-3038 if you have any questions.

Sincerely,



Kyle Wagoner, P.G, CHMM  
Project Manager

Enclosures: As Noted

c/encl: Christian Schock, Director, Wausau Community Development Authority (electronic only)  
Kevin Fabel, Environmental Coordinator, City of Wausau (electronic only)  
Matthew Thompson, Wisconsin DNR – Eau Claire office (electronic only)

**Sub-Slab Vapor Confirmation Sampling Results**  
**Former Kraft Cleaners Site**  
**Wausau, WI**  
**BRRTS No. 02-37-000294**

		<b>Sample Location:</b>		<b>109 Callon Street</b>			
		<b>Sample ID:</b>		<b>VP-4</b>		<b>VP-8</b>	
		<b>Date Collected:</b>		2/4/2019	6/24/2019	2/4/2019	6/24/2019
		<b>Sample Type:</b>		Sub-Slab		Sub-Slab	
<b>Analyte</b>		<b>Residential Sub-Slab VRSL (<math>\mu\text{g}/\text{m}^3</math>)</b>		<b>Results</b>			
<b>TO-15 Short List CVOCs (<math>\mu\text{g}/\text{m}^3</math>)</b>							
cis 1,2-Dichloroethene (cis 1,2-DCE)		NE		<0.37	<0.42	<0.38	1.7
trans-1,2-Dichloroethene (trans 1,2-DCE)		NE		<0.48	<0.55	<0.50	<0.55
Tetrachloroethene (PCE)		1,400		21.6	638	<0.55	123
Trichloroethene (TCE)		70		0.63J	20.7	<0.45	1.1
Vinyl Chloride (VC)		57		<0.21	<0.24	<0.22	<0.24

**Notes:**

NE = not established

VRSL = Vapor Risk Screening levels

Residential Sub-slab Vapor Risk Screening Levels (VRSLs) are taken from the WDNR Quick Look-up Table and are based on U.S. EPA Regional Screening Levels, updated November 2017.



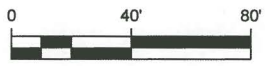
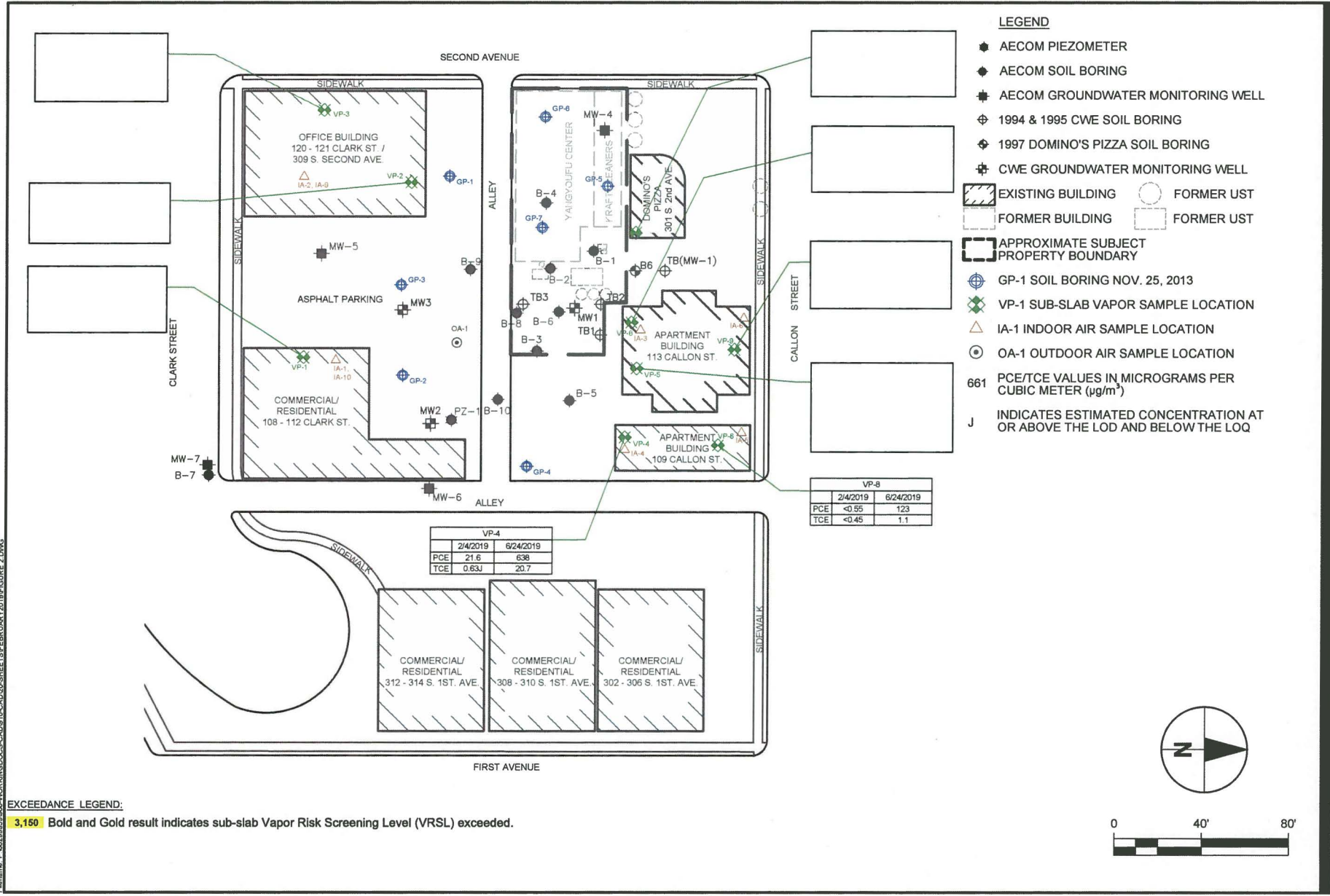

December 4, 2019

Robert & Karen Voigt  
RKV Income Trust  
1819 North 7<sup>th</sup> Avenue  
Wausau, WI 54401-1884

**Subject: Sub-Slab Confirmation Vapor Sampling Results  
For Building Next To Former Kraft Cleaners Site  
113 Callon Street  
Wausau, Wisconsin  
WDNR BRRTS No. 02-37-000294  
AECOM Project No. 60299959**

Dear Mr. and Mrs. Voigt:

On February 4 and June 24, 2019, AECOM performed sub-slab confirmation vapor sampling within the basement of your apartment building located at 113 Callon Street. The confirmation sampling and laboratory analysis for chlorinated volatile organic compounds (CVOCs) was completed for the purpose of supporting a forthcoming regulatory case closure request for the Former Kraft Cleaners site. The vapor mitigation system operating inside your building was temporarily shut off on January 28, 2019, then restarted on July 10, 2019, and confirmation sample analytical results are representative ambient conditions beneath the basement floor slab.

Laboratory analytical results for the sub-slab confirmation vapor samples compared to Wisconsin's residential sub-slab Vapor Risk Screening Levels (VRSLs) are summarized in the enclosed table. The confirmation laboratory results for your building are also depicted on the enclosed site figure. Low-level tetrachloroethene (PCE) and trichloroethene (TCE) were detected below their respective Wisconsin residential VRSLs in the three-sample set collected on February 4, 2019.

PCE and TCE exceeded their respective VRSLs in one sample (VP-5) collected on June 24, 2019, while low-level PCE and TCE were detected below their VRSLs in the other two samples (VP-6 and VP-9) collected on the same date. Consequently, AECOM contacted you by telephone and requested that you restart the vapor mitigation system on July 10, 2019. No further sampling is planned or has been authorized by the Wausau Community Development Authority, responsible party for the Former Kraft Cleaners site.

Thank you for your continued cooperation in this matter. Please contact me at (715) 342-3038 if you have any questions.

Sincerely,



Kyle Wagoner, P.G, CHMM  
Project Manager

Enclosures: As Noted

c/encl: Christian Schock, Director, Wausau Community Development Authority (electronic only)  
Kevin Fabel, Environmental Coordinator, City of Wausau (electronic only)  
Matthew Thompson, Wisconsin DNR – Eau Claire office (electronic only)

**Sub-Slab Vapor Confirmation Sampling Results**  
**Former Kraft Cleaners Site**  
**Wausau, WI**  
**BRRTS No. 02-37-000294**

Sample Location:		113 Callon Street							
		Sample ID:		VP-5		VP-6		VP-9	
		Date Collected:		2/4/2019	6/24/2019	2/4/2019	6/24/2019	2/4/2019	6/24/2019
		Sample Type:		Sub-Slab		Sub-Slab		Sub-Slab	
Analyte	Residential Sub-Slab VRSL ( $\mu\text{g}/\text{m}^3$ )	Results							
<b>TO-15 Short List CVOCs (<math>\mu\text{g}/\text{m}^3</math>)</b>									
cis 1,2-Dichloroethene (cis 1,2-DCE)	NE	0.39J	<0.41	<0.38	<0.40	<0.37	<0.37		
trans-1,2-Dichloroethene (trans 1,2-DCE)	NE	<0.46	<0.53	<0.50	<0.52	<0.48	<0.48		
Tetrachloroethene (PCE)	1,400	193	<b>3,520</b>	13.8	524	2.9	342		
Trichloroethene (TCE)	70	15.7	<b>111</b>	<0.45	2.1	<0.43	0.79J		
Vinyl Chloride (VC)	57	<0.20	<0.24	<0.22	<0.23	<0.21	<0.21		

**Notes:**

NE = not established

VRSL = Vapor Risk Screening levels

**Bold** data indicates regulatory standard exceeded.

J indicates estimated concentration at or above the LOD and below the LOQ.

Residential Sub-slab Vapor Risk Screening Levels (VRSLs) are taken from the WDNR Quick Look-up Table and are based on U.S. EPA Regional Screening Levels, updated November 2017.

The vapor mitigation system operating inside the apartment building at 113 Callon Street was temporarily shut off on January 28, 2019, and restarted on July 10, 2019.



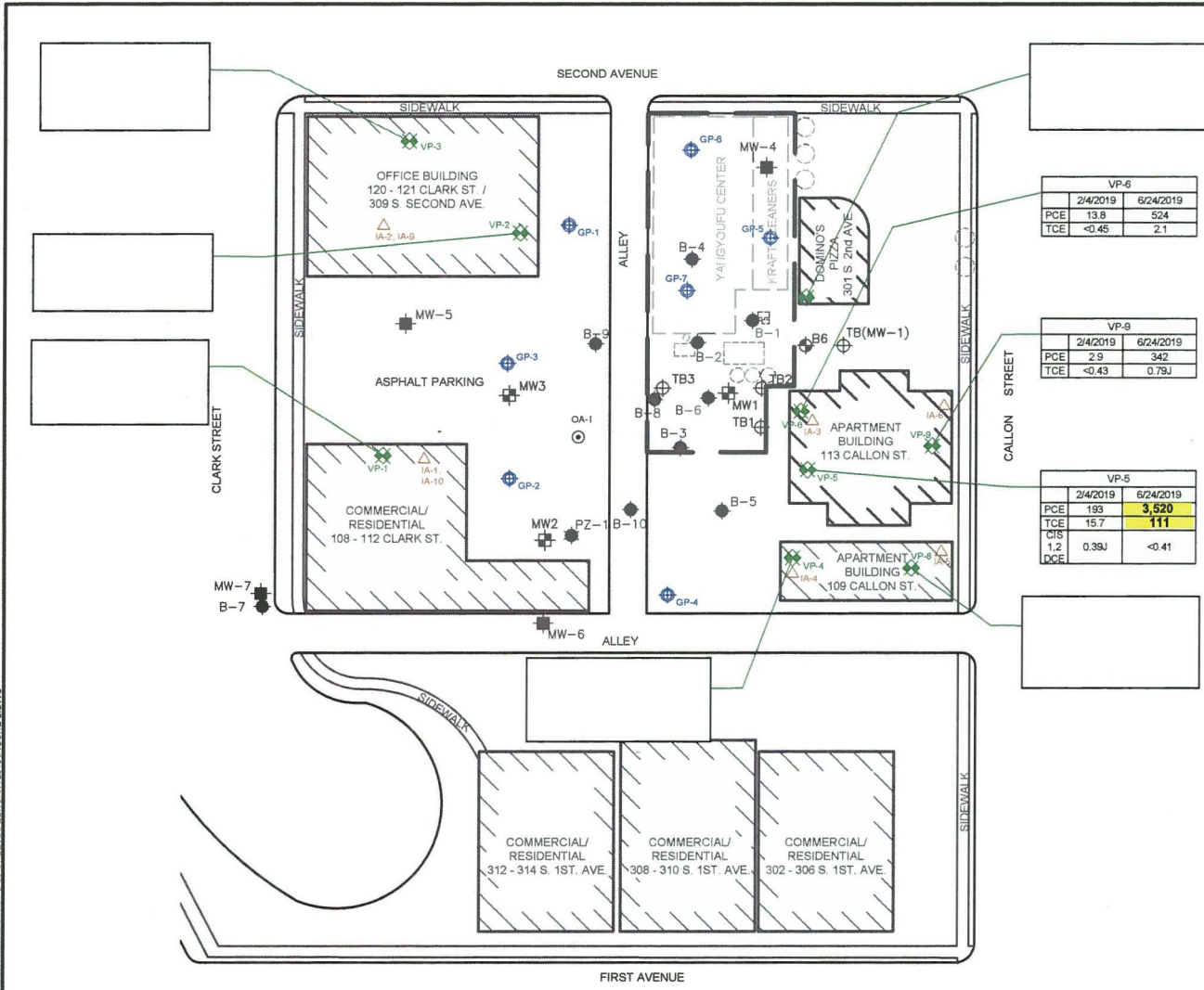

LEGEND

- ◆ AECOM PIEZOMETER
- ◆ AECOM SOIL BORING
- ◆ AECOM GROUNDWATER MONITORING WELL
- ⊕ 1994 & 1995 CWE SOIL BORING
- ◆ 1997 DOMINO'S PIZZA SOIL BORING
- ◆ CWE GROUNDWATER MONITORING WELL
- ▨ EXISTING BUILDING
- FORMER BUILDING
- FORMER UST
- FORMER UST
- ▭ APPROXIMATE SUBJECT PROPERTY BOUNDARY
- ⊕ GP-1 SOIL BORING NOV. 25, 2013
- ◆ VP-1 SUB-SLAB VAPOR SAMPLE LOCATION
- △ IA-1 INDOOR AIR SAMPLE LOCATION
- ⊙ OA-1 OUTDOOR AIR SAMPLE LOCATION
- 661 PCE/TCE VALUES IN MICROGRAMS PER CUBIC METER (µg/m³)
- J INDICATES ESTIMATED CONCENTRATION AT OR ABOVE THE LOD AND BELOW THE LOQ

VP-6		
	2/4/2019	6/24/2019
PCE	13.8	524
TCE	<0.45	2.1

VP-9		
	2/4/2019	6/24/2019
PCE	2.9	342
TCE	<0.43	0.79J

VP-5		
	2/4/2019	6/24/2019
PCE	193	<b>3,520</b>
TCE	15.7	<b>111</b>
CIS 1,2	0.39J	<0.41
PCE		

EXCEEDANCE LEGEND:

**3,150** Bold and Gold result indicates sub-slab Vapor Risk Screening Level (VRSL) exceeded.

