



REI

**CIVIL & ENVIRONMENTAL
ENGINEERING, SURVEYING**

**UPDATE REPORT
FORMER JUDGE'S DRY CLEANERS
257 DIVISION STREET
STEVENS POINT, WI**

**BRRTS #02-50-000298
REI PROJECT #11078**



**COMPREHENSIVE
SERVICES WITH
PRACTICAL
SOLUTIONS**



UPDATE REPORT

**FORMER JUDGE'S DRY CLEANERS
257 DIVISION STREET
STEVENS POINT, WI**

**BRRTS #02-50-000298
REI PROJECT #11078**



**PREPARED FOR:
THOMAS J. JUDGE REMEDIATION TRUST
ATTN: MS. STEPHANIE JUDGE**

FEBRUARY 2024

UPDATE REPORT

**FORMER JUDGE'S DRY CLEANERS
257 DIVISION STREET
STEVENS POINT, WI**

**BRRTS #02-50-000298
REI PROJECT #11078**

The recommendations contained in this report are based on the information obtained from our study of the site and were arrived at in accordance with accepted hydrogeologic and engineering practices at this time and location.

"I, Kaylin Felix, hereby certify that I am a hydrogeologist as that term is defined in s. NR 712.03 (1), Wis. Adm. Code, am registered in accordance with the requirements of Ch. GHSS 2, Wis. Adm. Code, or licensed in accordance with the requirements of Ch. GHSS 3, Wis. Admn. Code, and that to the best of my knowledge, all the information contained in this document is correct and the document was prepared in compliance with all applicable requirements in chs. NR 700 to 726, Wis. Adm. Code."



Hydrogeologist

2/5/2024

Date

"I, David Larsen, hereby certify that I am a hydrogeologist as that term is defined in s. NR 712.03 (1), Wis. Adm. Code, am registered in accordance with the requirements of Ch. GHSS 2, Wis. Adm. Code, or licensed in accordance with the requirements of Ch. GHSS 3, Wis. Admn. Code, and that to the best of my knowledge, all the information contained in this document is correct and the document was prepared in compliance with all applicable requirements in chs. NR 700 to 726, Wis. Adm. Code."

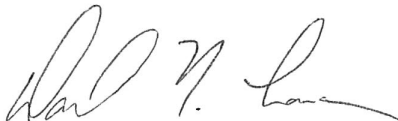

Hydrogeologist

2/5/2024

Date

February 5, 2024



Wisconsin Department of Natural Resources

Attn: Mr. Matt Thompson
1300 West Clairemont Avenue
Eau Claire, WI 54701



Subject:

Former Judge's Dry Cleaners - Update Report
257 Division Street
Stevens Point, WI
BRRTS# 02-50-000298

Dear Mr. Thompson:

BACKGROUND

The Former Judge's Dry Cleaner property is located at 257 Division Street, in the City of Stevens Point, Portage County, Wisconsin (Figure 1). The site has been the subject of an environmental investigation since 1992.

Site investigation activities have identified Chlorinated Volatile Organic Compounds (CVOCs) including tetrachloroethylene (PCE), trichloroethylene (TCE) and daughter compounds cis-1,2-dichloroethylene (cis 1,2 DCE) and vinyl chloride (VC) in the groundwater. Remedial actions have included the installation of a vapor mitigation system at the source property. Groundwater monitoring shows that enforcement standard (ES) and preventive action limit (PAL) exceedances persist at the source property and multiple off-site properties.

REI Engineering, Inc. (REI) was retained as Environmental Consultant in 2023 and was approved to conduct a single round of groundwater sampling and inspect the vapor mitigation system.

SUMMARY OF FIELDWORK

Field activities were completed on December 22, 2023. Groundwater sampling was limited to existing groundwater monitoring wells J-1, J-3, J-3D, UWSP-1, UWSP-1D, UWSP-2, UWSP-3, UWSP-3D, UWSP-4, UWSP-4D, UWSP-5 and UWSP-5D. Figure 2 presents the locations of the groundwater monitoring well network. Completed field activities included obtaining groundwater elevations, purging of each monitoring well before sampling, measuring and recording of field parameters including temperature, specific conductance, dissolved oxygen, pH, and ORP, and collecting groundwater samples from the twelve (12) wells in accordance with Wis. Admin. Code chs. NR 140 and NR 141.

REI personnel mobilized to the site on December 22, 2023, to conduct low-flow groundwater sampling across the groundwater monitoring well network. REI collected groundwater samples from the twelve (12) wells we were granted access to sample. All samples were placed on ice in laboratory provided containers and submitted to a State Certified Laboratory, Pace Analytical, for analysis of for laboratory analysis of Chlorinated Volatile Organic Compounds (CVOCs) following proper chain of custody procedures.



RESPONSIVE. EFFICIENT. INNOVATIVE.

4080 N. 20th Avenue Wausau, WI 54401
715-675-9784 REIengineering.com

REI obtained groundwater elevations from each monitoring well prior to purging and purged each well before sampling according to Wis. Admin. Code § NR 140.16. Purge water was properly containerized and disposed of. REI measured field parameters (temperature, specific conductance, dissolved oxygen, pH and ORP) using a multi-meter with a flow-through cell when parameters had stabilized and before samples were collected for lab analyses.

REI also conducted an evaluation of monitoring well condition and completed field repairs when possible.

Condition of monitoring wells and proposed repairs include:

- J-1 was filled with dirt/sediment for most of the water column. The well should be cleaned and redeveloped. PVC also needs to be cut down.
- J-2 appears to have been previously abandoned.
- J-3 needs a replacement compression cap on the well.
- J-3D needs a replacement compression cap and PVC needs to be cut down.
- UWSP-1 was in acceptable condition.
- UWSP-1D was in acceptable condition.
- UWSP-2 needs a replacement compression cap, PVC needs to be cut down and a flushmount bolt was broken.
- UWSP-3 needs a replacement compression cap.
- UWSP-3D needs a replacement compression cap and PVC needs to be cut down.
- UWSP-4 needs a replacement compression cap and PVC needs to be cut down.
- UWSP-4D needs a replacement compression cap.
- UWSP-5 needs a replacement compression cap.
- UWSP-5D was in acceptable condition.

Additionally, KFC-3 and KFC-4R, both located in the neighboring KFC drive-thru were completed with flushmount construction. Both wells were missing the flushmount covers and compression caps. Additionally, both were subject to frost heaving and the PVC well casings were exposed at the ground surface. Both wells are likely compromised and were approved for abandonment by the WDNR. Access to the property to complete the abandonment has not been granted.

According to University of Wisconsin Stevens Point (UWSP) facilities, redevelopment in the area of monitoring wells UWSP-4, UWSP-4D, UWSP-5 and UWSP-5D is scheduled for the spring of 2024. The location of the UWSP-4 well nest will become an asphalt covered parking lot and the location of the UWSP-5 well nest will become a building addition. The UWSP-4 well nest can likely remain but the UWSP-5 well nest will need to be abandoned prior to initiating site work on the redevelopment. A determination on whether a replacement well nest will be required will need to be completed. If so, the location would likely be south of the current location, near Fourth Avenue. Once all well repairs have been completed, all remaining wells should be resurveyed to a common datum.

Methods and Procedures for low-flow sample collection are included as Appendix A. Documentation for proper disposal of purge water at the City of Wausau Wastewater Treatment Plant is included in Appendix B.

GROUNDWATER ANALYTICAL RESULTS

As discussed above, REI collected groundwater samples from twelve (12) wells for laboratory analysis of CVOCs. Field parameters including temperature, specific conductance, dissolved oxygen, pH, and ORP were collected from each well. The laboratory analytical report is included as Appendix C. Groundwater analytical results are summarized on Tables 1A-1L, and groundwater elevation data is summarized on Table 2.

Groundwater flow direction was previously determined to be from the northwest to the southeast across the site in both the water table wells and the piezometers. Groundwater contour maps were not prepared as the reference elevations are likely no longer valid due to frost heaving of the well casings.

Shallow CVOC groundwater contamination was greatest in wells located proximal to the source property, with the highest concentrations in J-3 followed by UWSP-2 and J-1. Daughter compounds were also reported in J-3 and UWSP-2. The remaining shallow water table wells were either non-detect or had laboratory qualified detections.

UWSP-5 and UWSP-5D have reported very consistent analytical results between the wells which is in stark contrast to the results from the other well nests.

CVOC groundwater contamination in the piezometers was also greatest in wells located nearest the source property, with the highest concentrations in J-3D followed by UWSP-1D and UWSP-3D. Daughter compounds were also reported in each of the wells which indicate reductive dichlorination is likely occurring. The remaining piezometers, with the exception of UWSP-5D, were either non-detect or had laboratory qualified detections.

SUB-SLAB DEPRESSURIZATION SYSTEM

According to previously submitted documentation, the sub-slab depressurization system was installed in 2006 and operated through at least April 2010. The system was inspected by MSA personnel in 2021 and determined the power was shut off to the building and the fan was not functioning.

REI personnel inspected the sub-slab depressurization system on November 20, 2023 and determined that the depressurization fan and exhaust stack remain in place on the exterior of the building, but all piping internal to the building has been removed. According to the current tenant of the building, a representative of the City of Stevens Point approved the removal of the internal workings of the depressurization system as part of a remodel project undertaken by the tenant in late 2022.

CONCLUSIONS AND RECOMMENDATIONS

With the removal of the internal components of the sub-slab depressurization system, testing the system is no longer a feasible option. REI recommends the installation of a sub-slab vapor point to be installed near the rear of the building and a sub-slab vapor sample be collected and analyzed for TO-15 parameters. Results will determine if additional sampling or mitigation is warranted.

A total of seventeen (17) rounds of groundwater samples have been collected from 1996 through 2023. Analytical results have been relatively inconsistent over this time period but appear to be trending towards overall reduced concentrations over time. Concentrations in J-3, J-3D and UWSP-

1D appear to be increasing since 2010, which warrants further investigation. A determination should also be made regarding the potential replacement of the UWSP-5 and UWSP-5D well nest.

There are many groundwater monitoring wells in the investigation area. Not all monitoring wells were sampled under the management of the previous environmental consulting firm and a determination of the actual wells assigned to this investigation should be completed and those wells should be incorporated into the investigation going forward.

Access agreements with the offsite property owners have proven to be very challenging. Wells KFC-3 and KFC-4R should be abandoned, but REI has been unable to gain access to the property to conduct the abandonment. If the other wells in the area are assigned to this investigation, but are not integral to the investigation, REI is recommending those wells be abandoned to limit future access challenges.

If you have any questions or concerns, please contact our office at (715) 675-9784 or electronically at dlarsen@reiengineering.com.

Sincerely,
REI Engineering, Inc.

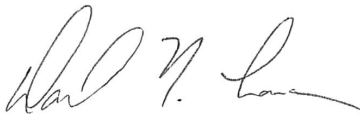

David Larsen, P.G.
Senior Hydrogeologist

Attachments:	Tables 1A-1L	Groundwater Analytical Results
	Table 2	Groundwater Elevation Data
	Figure 1	Site Vicinity Map
	Figure 2	Site Map
	Appendix A	Methods and Procedures
	Appendix B	Waste Disposal Documentation
	Appendix C	Laboratory Analytical Report

**Table 1A
Groundwater Analytical Results
J-1
Former Judges Dry Cleaners
257 Division Street
Stevens Point, WI**

Reported/Collected By-->				MSA										
Date-->				27-Jul-95	15-Feb-96	1-Oct-98	14-Oct-99	7-Feb-02	4-Dec-02	27-Mar-03	15-Jul-04	23-Nov-04	14-Sep-05	11-Sep-07
VOC's (µg/L)	CAS Number	Enforcement Standard (ES)	Preventive Action Limit (PAL)											
Tetrachloroethene (PCE)	127-18-4	5	0.5	630	150	110	140	140	360	890	4,300	660	45	28
Trichloroethene (TCE)	79-01-6	5	0.5	400	<i>2.0</i>	<i>1.4</i>	<1.0	<i>0.71¹</i>	<i>1.2</i>	<i>4.2</i>	<i>22¹</i>	<10	<0.32	<0.76
Vinyl chloride	75-01-4	0.2	0.02	<30	<1.0	<1.0	<1.0	<0.23	<0.25	<4.0	<7.7	<7.7	<0.50	<0.36
Dichlorodifluoromethane	75-71-8	1,000	200	<30	<3.0	X	<1.0	<0.27	<0.25	<4.0	<8.6	<8.6	<0.69	<0.28
1,2-Dichloroethane	107-06-2	5	0.5	X	X	X	X	X	X	X	X	X	X	X
1,1-Dichloroethene	75-35-4	7	0.7	<20	<2.0	X	<1.0	<0.36	<0.25	<4.0	<9.1	<9.1	<0.48	<0.42
cis-1,2-Dichloroethene	156-59-2	70	7	<10	2.0	<1.0	<1.0	<1	<0.25	<4.0	<i>12¹</i>	<7.3	1.7	<0.52
trans-1,2-Dichloroethene	156-60-5	100	20	<10	<1.0	X	<1.0	<0.23	<0.25	<4.0	<8.4	<8.4	<0.52	<0.26
Benzene	71-43-2	5	0.5	<10	<0.50	X	<0.40	<0.25	<0.10	<2.0	<9.0	<9.0	<0.36	<0.21
Toluene	108-88-3	800	160	<10	<1.0	X	<0.40	<0.22	<0.10	<2.0	<10	<10	<0.62	<0.47
Naphthalene	91-20-3	100	10	<10	<1.0	X	<1.0	<0.68	<0.25	<2.0	<12	<12	<0.63	<0.62

Reported/Collected By-->				MSA					REI
Date-->				15-Dec-07	12-Apr-10	19-Nov-19	27-Oct-21	20-Jan-22	22-Dec-23
VOC's (µg/L)	CAS Number	Enforcement Standard (ES)	Preventive Action Limit (PAL)						
Tetrachloroethene (PCE)	127-18-4	5	0.5	Not Sampled Well Dry	1,000	5.7	15	4.7	7.4
Trichloroethene (TCE)	79-01-6	5	0.5		<i>0.76¹</i>	<i>0.51</i>	<0.39	<0.39	<0.32
Vinyl chloride	75-01-4	0.2	0.02		<0.43	<0.14	<0.15	<0.15	<0.17
Dichlorodifluoromethane	75-71-8	1,000	200		<0.34	<0.40	<0.63	<0.63	<0.46
1,2-Dichloroethane	107-06-2	5	0.5		X	X	X	X	<0.29
1,1-Dichloroethene	75-35-4	7	0.7		<0.38	<0.40	<0.49	<0.49	<0.30
cis-1,2-Dichloroethene	156-59-2	70	7		<0.30	<0.30	<0.41	<0.41	<0.47
trans-1,2-Dichloroethene	156-60-5	100	20		<0.31	<0.30	<0.35	<0.35	<0.53
Benzene	71-43-2	5	0.5		<0.33	<0.40	<0.47	<0.47	<0.30
Toluene	108-88-3	800	160		<0.39	<0.21	<0.27	<0.27	<0.29
Naphthalene	91-20-3	100	10	<0.77	<0.30	<0.35	<0.35	<1.9	

Notes:

µg/L - Parts Per Billion (ppb)

< = Concentration Below Laboratory Detection Limit

-- = No Standard/Not Applicable

- = Not Sampled

X = Results Not Reported

¹ = Estimated concentration at or above the Limit of Detection (LOD) and below the Limit of Quantitation (LOQ)

Bold	= Exceeds NR140.10 Enforcement Standard
<i>Italic</i>	= Exceeds NR140.10 Preventive Action Limit

**Table 1B
Groundwater Analytical Results
J-3
Former Judges Dry Cleaners
257 Division Street
Stevens Point, WI**

Reported/Collected By-->				MSA									
Date-->				14-Feb-96	1-Oct-98	14-Oct-99	7-Feb-02	14-May-02	4-Dec-02	27-Mar-03	15-Jul-04	23-Nov-04	14-Sep-05
VOC's (µg/L)	CAS Number	Enforcement Standard (ES)	Preventive Action Limit (PAL)										
Tetrachloroethene (PCE)	127-18-4	5	0.5	2,100	750	2,300	1,600	120	570	1,700	390	1,200	360
Trichloroethene (TCE)	79-01-6	5	0.5	8.4	30	27	22¹	4.8	12	11	<12	27¹	<6.4
Vinyl chloride	75-01-4	0.2	0.02	<1.0	4.1	<12	<12	<0.25	<0.50	<5.0	<5.3	<7.7	<10
Dichlorodifluoromethane	75-71-8	1,000	200	<3.0	<3.0		<0.25	<0.27	<0.25	<0.25	<0.50	<0.17	<0.17
1,2-Dichloroethane	107-06-2	5	0.5	Results Not Reported									
1,1-Dichloroethane	75-35-4	7	0.7	<2.0		<12	<18	<0.25	<0.50	<5.0	<21	<9.1	<9.6
cis-1,2-Dichloroethene	156-59-2	70	7	5.5	110	30	<50	5.2	11	9.3	22¹	21¹	<9.0
trans-1,2-Dichloroethene	156-60-5	100	20	<1.0		<12	<12	<0.25	<0.50	<5.0	<17	<8.4	<10
Benzene	71-43-2	5	0.5	<0.50		<5.0	<13	<0.10	<0.20	<2.5	<15	<9.0	<7.1
Toluene	108-88-3	800	160	<1.0		<5.0	<11	<0.10	<0.20	<2.5	<17	<10	<12
Naphthalene	91-20-3	100	10	<1.0		<5.0	<34	<0.25	2.4	<2.5	<20	<12	<13

Reported/Collected By-->				MSA						REI
Date-->				15-Dec-07	27-Apr-08	13-Apr-10	19-Nov-19	27-Oct-21	20-Jan-22	22-Dec-23
VOC's (µg/L)	CAS Number	Enforcement Standard (ES)	Preventive Action Limit (PAL)							
Tetrachloroethene (PCE)	127-18-4	5	0.5	280	240	1,200	1,300	3,200	Not Sampled Under Ice	100
Trichloroethene (TCE)	79-01-6	5	0.5	3.5	2.0	5.7¹	17	19		16.7
Vinyl chloride	75-01-4	0.2	0.02	23	<0.095	<4.3	1.7	2.1		<0.17
Dichlorodifluoromethane	75-71-8	1,000	200	<0.28	<0.15	<0.13	<0.40	<0.63		<2.6
1,2-Dichloroethane	107-06-2	5	0.5	X	X	X	X	X		<0.29
1,1-Dichloroethane	75-35-4	7	0.7	<0.24	<0.34	<3.8	<0.40	<0.49		<0.58
cis-1,2-Dichloroethene	156-59-2	70	7	14	1.5	4.0¹	9.1	9.4		15.2
trans-1,2-Dichloroethene	156-60-5	100	20	<0.22	<0.47	<3.1	0.45	<0.35		<0.53
Benzene	71-43-2	5	0.5	<0.21	<0.42	<3.3	<0.40	<0.47		<0.30
Toluene	108-88-3	800	160	<0.20	<0.37	<3.9	<0.21	<0.27		<0.29
Naphthalene	91-20-3	100	10	<0.25	<0.37	<7.7	<0.30	<0.35	<1.9	

Notes:

µg/L - Parts Per Billion (ppb)

< = Concentration Below Laboratory Detection Limit

-- = No Standard/Not Applicable

- = Not Sampled

X = Results Not Reported

¹ = Estimated concentration at or above the Limit of Detection (LOD) and below the Limit of Quantitation (LOQ)

Bold	= Exceeds NR140.10 Enforcement Standard
<i>Italic</i>	= Exceeds NR140.10 Preventive Action Limit

**Table 1C
Groundwater Analytical Results
J-3D
Former Judges Dry Cleaners
257 Division Street
Stevens Point, WI**

Reported/Collected By-->				MSA									
Date-->				14-Oct-99	7-Feb-02	14-May-02	4-Dec-02	27-Mar-03	15-Jul-04	23-Nov-04	14-Sep-05	11-Sep-07	15-Dec-07
VOC's (µg/L)	CAS Number	Enforcement Standard (ES)	Preventive Action Limit (PAL)										
Tetrachloroethene (PCE)	127-18-4	5	0.5	7,100	3,800	810	2,900	6,800	2,000	5,500	2,700	190	3,500
Trichloroethene (TCE)	79-01-6	5	0.5	<50		<20	9.3	<12	<12	<25	<16	<3.8	11^J
Vinyl chloride	75-01-4	0.2	0.02	<50	<12	<18	<4.0	<25	<5.3	<19	<25	<1.8	<3.4
Dichlorodifluoromethane	75-71-8	1,000	200	<3.0		<12	<14	<0.25	<0.50	<5.0	<8.9	<8.6	<14
1,2-Dichloroethane	107-06-2	5	0.5	Results Not Reported									
1,1-Dichloroethene	75-35-4	7	0.7	<50	<18	<29	<4.0	<25	<21	<23	<24	2.3^J	<4.8
cis-1,2-Dichloroethene	156-59-2	70	7	<50	<50	<9.2	<4.0	<25	<20	<18	<22	84	<4.2
trans-1,2-Dichloroethene	156-60-5	100	20	<50	<12	<16	<4.0	<25	<17	<21	<26	<1.3	<4.4
Benzene	71-43-2	5	0.5	<20	<13	<12	<1.6	<12	<15	<23	<18	<1.1	<4.2
Toluene	108-88-3	800	160	<20	<11	<16	<1.6	<12	<17	<26	<31	<2.4	<4.0
Naphthalene	91-20-3	100	10	<20	<34	<14	5.9	<12	<20	<30	<31	<3.1	<4.9

Reported/Collected By-->				MSA					REI	
Date-->				15-Dec-07	27-Apr-08	13-Apr-10	19-Nov-19	27-Oct-21	20-Jan-22	22-Dec-23
VOC's (µg/L)	CAS Number	Enforcement Standard (ES)	Preventive Action Limit (PAL)							
Tetrachloroethene (PCE)	127-18-4	5	0.5	3,500	49	180	2,000	2,500	Not Sampled Under Ice	1,870
Trichloroethene (TCE)	79-01-6	5	0.5	11^J	45	<2.0	32	16		4.7
Vinyl chloride	75-01-4	0.2	0.02	<3.4	2.3^J	<2.2	0.59	0.28		<0.17
Dichlorodifluoromethane	75-71-8	1,000	200	<14	<0.15	<0.22	<3.4	<0.40		<0.46
1,2-Dichloroethane	107-06-2	5	0.5	X	X	X	X	X		<0.29
1,1-Dichloroethene	75-35-4	7	0.7	<4.8	<6.8	<1.9	<0.40	<0.49		<0.58
cis-1,2-Dichloroethene	156-59-2	70	7	<4.2	150	<1.5	31	4.9		1.7
trans-1,2-Dichloroethene	156-60-5	100	20	<4.4	<9.4	<1.6	2.0	<0.35		<0.53
Benzene	71-43-2	5	0.5	<4.2	<8.4	<1.6	<0.40	<0.47		<0.30
Toluene	108-88-3	800	160	<4.0	<7.4	<2.0	<0.21	<0.27		<0.29
Naphthalene	91-20-3	100	10	<4.9	<7.4	<3.8	<0.30	<0.35	<1.9	

Notes:

µg/L - Parts Per Billion (ppb)

< = Concentration Below Laboratory Detection Limit

-- = No Standard/Not Applicable

- = Not Sampled

X = Results Not Reported

^J = Estimated concentration at or above the Limit of Detection (LOD) and below the Limit of Quantitation (LOQ)

Bold	= Exceeds NR140.10 Enforcement Standard
<i>Italic</i>	= Exceeds NR140.10 Preventive Action Limit

Table 1D
Groundwater Analytical Results
UWSP-1
Former Judges Dry Cleaners
257 Division Street
Stevens Point, WI

Reported/Collected By-->				MSA										REI
Date-->				15-Jul-04	23-Nov-04	14-Sep-05	11-Sep-07	15-Dec-07	27-Apr-08	12-Apr-10	19-Nov-19	28-Oct-21	19-Jan-22	22-Dec-23
VOC's (µg/L)	CAS Number	Enforcement Standard (ES)	Preventive Action Limit (PAL)											
Tetrachloroethene (PCE)	127-18-4	5	0.5	<i>2.4</i>	<i>3.3</i>	<i>0.19^j</i>	<0.26	<i>2.5</i>	<0.31	<0.18	<0.27	<0.55	<i>0.67</i>	<0.41
Trichloroethene (TCE)	79-01-6	5	0.5	21	26	<i>1.8</i>	<0.38	18	<0.43	<i>0.39^j</i>	<0.30	<0.39	<0.39	<0.32
Vinyl chloride	75-01-4	0.2	0.02	5.8	7.4	0.37^j	<0.18	10	<0.095	<0.17	<0.14	<0.15	<0.15	<0.17
Dichlorodifluoromethane	75-71-8	1,000	200	<0.34	<0.42	<0.28	<0.14	<0.16	<0.22	<0.13	<0.40	<0.63	<0.63	<0.46
1,2-Dichloroethane	107-06-2	5	0.5	X	X	X	X	X	X	X	X	X	X	<0.29
1,1-Dichloroethene	75-35-4	7	0.7	<i>1.0^j</i>	<i>1.6</i>	<0.19	<0.21	<i>0.16</i>	<0.34	<0.15	<0.40	<0.49	<0.49	<0.30
cis-1,2-Dichloroethene	156-59-2	70	7	<i>16</i>	<i>20</i>	<i>1.3</i>	<0.26	<i>22</i>	<0.40	<i>0.25^j</i>	<0.30	<0.41	<0.41	<0.47
trans-1,2-Dichloroethene	156-60-5	100	20	<0.34	<0.34	<0.21	<0.13	<i>0.37^j</i>	<0.47	<0.13	<0.30	<0.35	<0.35	<0.53
Benzene	71-43-2	5	0.5	<0.36	<0.36	<0.14	<0.11	<0.19	<0.42	<0.13	<0.40	<0.47	<0.47	<0.30
Toluene	108-88-3	800	160	<0.42	<0.42	<0.25	<0.24	<0.17	<0.37	<0.16	<0.21	<0.27	<0.27	<0.29
Naphthalene	91-20-3	100	10	<0.48	<0.48	<0.25	<0.31	<0.37	<0.37	<0.31	<0.30	<0.35	<0.35	<1.9

Notes:
 µg/L - Parts Per Billion (ppb)
 < = Concentration Below Laboratory Detection Limit
 - - = No Standard/Not Applicable
 - = Not Sampled
 X = Results Not Reported
^j = Estimated concentration at or above the Limit of Detection (LOD) and below the Limit of Quantitation (LOQ)

Bold	= Exceeds NR140.10 Enforcement Standard
<i>Italic</i>	= Exceeds NR140.10 Preventive Action Limit

**Table 1E
Groundwater Analytical Results
UWSP-1D
Former Judges Dry Cleaners
257 Division Street
Stevens Point, WI**

Reported/Collected By-->				MSA									REI	
Date-->				15-Jul-04	23-Nov-04	14-Sep-05	11-Sep-07	15-Dec-07	27-Apr-08	12-Apr-10	20-Nov-19	28-Oct-21	19-Jan-22	22-Dec-23
VOC's (µg/L)	CAS Number	Enforcement Standard (ES)	Preventive Action Limit (PAL)											
Tetrachloroethene (PCE)	127-18-4	5	0.5	16	13	10	4.0 ^j	16	17	7.1	71	240	Not Sampled Under Ice	368
Trichloroethene (TCE)	79-01-6	5	0.5	38	41	50	49	68	52	71	42	51		54.7
Vinyl chloride	75-01-4	0.2	0.02	29	25	24	17	26	24	23	11	8.8		6.8
Dichlorodifluoromethane	75-71-8	1,000	200	<1.7	<0.42	<0.28	<0.14	<0.16	<0.22	<0.13	<0.40	<0.63		<0.46
1,2-Dichloroethane	107-06-2	5	0.5	<2.8	X	X	X	X	X	X	X	X		<0.29
1,1-Dichloroethene	75-35-4	7	0.7	<1.4	3.2 ^j	2.9 ^j	2.3 ^j	4.1 ^j	<3.4	2.8 ^j	1.6	1.4		1.4
cis-1,2-Dichloroethene	156-59-2	70	7	<1.6	99	110	84	95	80	80	40	46		73.7
trans-1,2-Dichloroethene	156-60-5	100	20	<2.2	<1.7	<2.1	<1.3	<1.7	<4.7	1.1 ^j	0.73	0.75		1.1
Benzene	71-43-2	5	0.5	<1.8	<1.8	<1.4	<1.1	<1.9	<4.2	<1.0	<0.40	<0.47		<0.30
Toluene	108-88-3	800	160	<1.7	<2.1	<2.5	<2.4	<1.7	<3.7	<1.2	<0.21	<0.27		<0.29
Naphthalene	91-20-3	100	10	<0.63	<2.4	<2.5	<3.1	<3.7	<0.37	<2.5	<0.30	<0.35	<1.9	

Notes:
µg/L - Parts Per Billion (ppb)
< = Concentration Below Laboratory Detection Limit
-- = No Standard/Not Applicable
- = Not Sampled
X = Results Not Reported
^j = Estimated concentration at or above the Limit of Detection (LOD) and below the Limit of Quantitation (LOQ)

Bold	= Exceeds NR140.10 Enforcement Standard
<i>Italic</i>	= Exceeds NR140.10 Preventive Action Limit

**Table 1F
Groundwater Analytical Results
UWSP-2
Former Judges Dry Cleaners
257 Division Street
Stevens Point, WI**

Reported/Collected By-->				MSA									REI	
Date-->				15-Jul-04	23-Nov-04	14-Sep-05	11-Sep-07	15-Dec-07	27-Apr-08	12-Apr-10	20-Nov-19	28-Oct-21	19-Jan-22	22-Dec-23
VOC's (µg/L)	CAS Number	Enforcement Standard (ES)	Preventive Action Limit (PAL)											
Tetrachloroethene (PCE)	127-18-4	5	0.5	620	600	840	780	820	1,100	630	47	Well Sealed Shut Unable To Sample	Well Sealed Shut Unable To Sample	36
Trichloroethene (TCE)	79-01-6	5	0.5	240	190	200	66^J	140	120^J	100	20			13
Vinyl chloride	75-01-4	0.2	0.02	12^J	20^J	15^J	<14	<17	<9.5	<8.7	0.67			<0.17
Dichlorodifluoromethane	75-71-8	1,000	200	<8.6	<8.6	<14	<11	<15	<22	<6.7	<0.40			<0.46
1,2-Dichloroethane	107-06-2	5	0.5	X	X	X	X	X	X	X	X			<0.29
1,1-Dichloroethene	75-35-4	7	0.7	<9.1	<9.1	<9.6	<17	<24	<0.34	<7.6	<0.40			<0.58
cis-1,2-Dichloroethene	156-59-2	70	7	140	180	130	<21	27^J	<40	23	9.6			8.2
trans-1,2-Dichloroethene	156-60-5	100	20	<8.4	<8.4	<10	<10	<22	<47	<6.3	<0.30			<0.53
Benzene	71-43-2	5	0.5	<9.0	<9.0	<7.1	<8.5	<21	<42	<6.6	<0.40			<0.30
Toluene	108-88-3	800	160	<10	<10	<12	<19	<20	<37	<7.8	<0.21			<0.29
Naphthalene	91-20-3	100	10	<12	<12	<13	<25	<25	<37	<15	<0.30	<1.9		

Notes:
µg/L - Parts Per Billion (ppb)
< = Concentration Below Laboratory Detection Limit
- - = No Standard/Not Applicable
- = Not Sampled
X = Results Not Reported
^J = Estimated concentration at or above the Limit of Detection (LOD) and below the Limit of Quantitation (LOQ)

Bold	= Exceeds NR140.10 Enforcement Standard
<i>Italic</i>	= Exceeds NR140.10 Preventive Action Limit

Table 1G
Groundwater Analytical Results
UWSP-3
Former Judges Dry Cleaners
257 Division Street
Stevens Point, WI

Reported/Collected By-->				MSA									REI
Date-->				15-Jul-04	23-Nov-04	14-Sep-05	11-Sep-07	15-Dec-07	12-Apr-10	20-Nov-19	28-Oct-21	19-Jan-22	22-Dec-23
VOC's (µg/L)	CAS Number	Enforcement Standard (ES)	Preventive Action Limit (PAL)										
Tetrachloroethene (PCE)	127-18-4	5	0.5	<0.20	<0.20	<0.18	<0.26	0.59	<0.18	<0.27	<0.55	<0.55	<0.41
Trichloroethene (TCE)	79-01-6	5	0.5	0.43 ^j	0.49 ^j	<0.13	<0.38	0.81	<0.16	<0.30	<0.39	0.51	<0.32
Vinyl chloride	75-01-4	0.2	0.02	0.22 ^j	0.65	<0.20	<0.18	1.1	<0.17	<0.14	<0.15	<0.15	<0.17
Dichlorodifluoromethane	75-71-8	1,000	200	<0.17	<0.17	<0.28	<0.14	<0.16	<0.13	<0.40	<0.63	<0.63	<0.46
1,2-Dichloroethane	107-06-2	5	0.5	X	X	X	X	X	X	X	X	X	<0.29
1,1-Dichloroethene	75-35-4	7	0.7	<0.18	<0.18	<0.19	<0.21	<0.17	<0.15	<0.40	<0.49	<0.49	<0.30
cis-1,2-Dichloroethene	156-59-2	70	7	2.1	2.8	0.45 ^j	0.93	4.7	0.14 ^j	<0.30	<0.41	1.2	<0.47
trans-1,2-Dichloroethene	156-60-5	100	20	<0.17	<0.17	<0.21	<0.13	<0.17	<0.13	<0.30	<0.35	<0.35	<0.53
Benzene	71-43-2	5	0.5	<0.18	<0.18	<0.14	<0.11	<0.19	<0.13	<0.40	<0.47	<0.47	<0.30
Toluene	108-88-3	800	160	<0.21	<0.21	<0.25	<0.24	<0.17	<0.16	<0.21	<0.27	<0.27	<0.29
Naphthalene	91-20-3	100	10	<0.24	<0.24	<0.25	<0.31	<0.37	<0.31	<0.30	<0.35	<0.35	<1.9

Notes:
 µg/L - Parts Per Billion (ppb)
 < = Concentration Below Laboratory Detection Limit
 - - = No Standard/Not Applicable
 - = Not Sampled
 X = Results Not Reported
^j = Estimated concentration at or above the Limit of Detection (LOD) and below the Limit of Quantitation (LOQ)

Bold	= Exceeds NR140.10 Enforcement Standard
<i>Italic</i>	= Exceeds NR140.10 Preventive Action Limit

**Table 1H
Groundwater Analytical Results
UWSP-3D
Former Judges Dry Cleaners
257 Division Street
Stevens Point, WI**

Reported/Collected By-->				MSA										REI
Date-->				15-Jul-04	23-Nov-04	14-Sep-05	11-Sep-07	15-Dec-07	27-Apr-08	12-Apr-10	19-Nov-19	28-Oct-21	19-Jan-22	22-Dec-23
VOC's (µg/L)	CAS Number	Enforcement Standard (ES)	Preventive Action Limit (PAL)											
Tetrachloroethene (PCE)	127-18-4	5	0.5	58	59	57	51	45	1,000	42	26	26	23	21.9
Trichloroethene (TCE)	79-01-6	5	0.5	57	57	55	58	50	<5.3	62	33	35	29	25.2
Vinyl chloride	75-01-4	0.2	0.02	<3.2	3.7^j	<2.5	<2.3	<2.5	<1.2	2.8^j	3.5	3.8	3.9	2.2
Dichlorodifluoromethane	75-71-8	1,000	200	<3.4	<3.4	<3.5	<1.7	<2.0	<2.8	<1.7	<0.40	<0.63	<0.63	<0.46
1,2-Dichloroethane	107-06-2	5	0.5	X	X	X	X	X	X	X	X	X	X	<0.29
1,1-Dichloroethene	75-35-4	7	0.7	<3.6	<3.6	<2.4	<2.6	<2.2	<4.3	<1.9	<i>0.98</i>	<i>1.1</i>	<i>1.0</i>	<i>0.81^j</i>
cis-1,2-Dichloroethene	156-59-2	70	7	180	180	170	150	160	<5.0	150	75	88	79	66.8
trans-1,2-Dichloroethene	156-60-5	100	20	<3.4	<i>3.8^j</i>	<i>3.0^j</i>	<i>2.8^j</i>	<i>4.7^j</i>	<5.9	<i>2.7^j</i>	1.6	1.6	1.6	1.2
Benzene	71-43-2	5	0.5	<3.6	<3.6	<1.8	<1.3	<2.3	<5.2	<1.6	<0.40	<0.47	<0.47	<0.30
Toluene	108-88-3	800	160	<4.2	<4.2	<3.1	<3.0	<2.1	<4.6	<2.0	<0.21	<0.27	<0.27	<0.29
Naphthalene	91-20-3	100	10	<4.8	<4.8	<3.1	<3.9	<4.7	<4.6	<3.8	<0.30	<0.35	<0.35	<1.9

Notes:
 µg/L - Parts Per Billion (ppb)
 < = Concentration Below Laboratory Detection Limit
 - - = No Standard/Not Applicable
 - = Not Sampled
 X = Results Not Reported
^j = Estimated concentration at or above the Limit of Detection (LOD) and below the Limit of Quantitation (LOQ)

Bold	= Exceeds NR140.10 Enforcement Standard
<i>Italic</i>	= Exceeds NR140.10 Preventive Action Limit

Table 11
Groundwater Analytical Results
UWSP-4
Former Judges Dry Cleaners
257 Division Street
Stevens Point, WI

<i>Reported/Collected By--></i>				MSA						REI
<i>Date--></i>				15-Dec-07	27-Apr-08	13-Apr-10	20-Nov-19	27-Oct-21	19-Jan-22	22-Dec-23
VOC's (µg/L)	CAS Number	Enforcement Standard (ES)	Preventive Action Limit (PAL)							
Tetrachloroethene (PCE)	127-18-4	5	0.5	<0.21	<0.31	<0.18	<0.27	<0.55	<0.55	<0.41
Trichloroethene (TCE)	79-01-6	5	0.5	<0.20	<0.43	<0.16	<0.30	<0.39	<0.39	<0.32
Vinyl chloride	75-01-4	0.2	0.02	<0.17	<0.095	<0.17	<0.14	<0.15	<0.15	<0.17
Dichlorodifluoromethane	75-71-8	1,000	200	0.63	9.2	0.62	2.1	7.5	3.6	0.80 ^j
1,2-Dichloroethane	107-06-2	5	0.5	X	X	X	X	X	X	<0.29
1,1-Dichloroethene	75-35-4	7	0.7	<0.24	<0.34	<0.15	<0.40	<0.49	<0.49	<0.30
cis-1,2-Dichloroethene	156-59-2	70	7	<0.21	<0.40	<0.12	<0.30	<0.41	<0.41	<0.47
trans-1,2-Dichloroethene	156-60-5	100	20	<0.22	<0.47	<0.13	<0.30	<0.35	<0.35	<0.53
Benzene	71-43-2	5	0.5	<0.21	<0.42	<0.13	<0.40	<0.47	<0.47	<0.30
Toluene	108-88-3	800	160	<0.20	<0.37	<0.16	<0.21	<0.27	<0.27	<0.29
Naphthalene	91-20-3	100	10	<0.25	<0.37	<0.31	<0.30	<0.35	<0.35	<1.9

Notes:

µg/L - Parts Per Billion (ppb)

< = Concentration Below Laboratory Detection Limit

-- = No Standard/Not Applicable

- = Not Sampled

X = Results Not Reported

^j = Estimated concentration at or above the Limit of Detection (LOD) and below the Limit of Quantitation (LOQ)

Bold	= Exceeds NR140.10 Enforcement Standard
<i>Italic</i>	= Exceeds NR140.10 Preventive Action Limit

Table 1J
Groundwater Analytical Results
UWSP-4D
Former Judges Dry Cleaners
257 Division Street
Stevens Point, WI

<i>Reported/Collected By--></i>				MSA						REI
<i>Date--></i>				15-Dec-07	27-Apr-08	13-Apr-10	20-Nov-19	27-Oct-21	19-Jan-22	22-Dec-23
VOC's (µg/L)	CAS Number	Enforcement Standard (ES)	Preventive Action Limit (PAL)							
Tetrachloroethene (PCE)	127-18-4	5	0.5	500	37	44	87	230	220	<0.41
Trichloroethene (TCE)	79-01-6	5	0.5	11	<i>0.73</i>	<i>1.4</i>	<i>3.9</i>	6.3	6.8	<0.32
Vinyl chloride	75-01-4	0.2	0.02	0.51	<0.095	<0.17	0.27	<i>0.18</i>	<1.5	<0.17
Dichlorodifluoromethane	75-71-8	1,000	200	0.66	3.3	3.4	2.0	2.5	<6.3	0.66 ^J
1,2-Dichloroethane	107-06-2	5	0.5	X	X	X	X	X	X	<0.29
1,1-Dichloroethene	75-35-4	7	0.7	0.20 ^J	<0.34	<0.15	<0.40	<0.49	<4.9	<0.30
cis-1,2-Dichloroethene	156-59-2	70	7	<i>9.1</i>	0.55 ^J	0.82	3.3	3.0	<4.1	<0.47
trans-1,2-Dichloroethene	156-60-5	100	20	0.17 ^J	<0.47	<0.13	<0.30	<0.35	<3.5	<0.53
Benzene	71-43-2	5	0.5	<0.19	<0.42	<0.13	<0.40	<0.47	<4.7	<0.30
Toluene	108-88-3	800	160	<0.17	<0.37	<0.16	<0.21	<0.27	<2.7	<0.29
Naphthalene	91-20-3	100	10	<0.37	<0.37	<0.31	<0.30	<0.35	<3.5	<1.9

Notes:

µg/L - Parts Per Billion (ppb)

< = Concentration Below Laboratory Detection Limit

-- = No Standard/Not Applicable

- = Not Sampled

X = Results Not Reported

^J = Estimated concentration at or above the Limit of Detection (LOD) and below the Limit of Quantitation (LOQ)

Bold	= Exceeds NR140.10 Enforcement Standard
<i>Italic</i>	= Exceeds NR140.10 Preventive Action Limit

Table 1K
Groundwater Analytical Results
UWSP-5
Former Judges Dry Cleaners
257 Division Street
Stevens Point, WI

<i>Reported/Collected By--></i>				MSA						REI
<i>Date--></i>				15-Dec-07	27-Apr-08	12-Apr-10	20-Nov-19	27-Oct-21	19-Jan-22	22-Dec-23
VOC's (µg/L)	CAS Number	Enforcement Standard (ES)	Preventive Action Limit (PAL)							
Tetrachloroethene (PCE)	127-18-4	5	0.5	0.43	6.6	<0.18	<0.27	<i>2.7</i>	Not Sampled Under Ice	<i>1.1</i>
Trichloroethene (TCE)	79-01-6	5	0.5	<0.19	<0.43	<0.16	<0.30	<i>1.4</i>		0.71 ^J
Vinyl chloride	75-01-4	0.2	0.02	<0.20	<0.095	<0.17	<0.14	<0.15		<0.17
Dichlorodifluoromethane	75-71-8	1,000	200	<0.16	<0.22	<0.13	<0.40	<0.63		<0.46
1,2-Dichloroethane	107-06-2	5	0.5	X	X	X	X	X		<0.29
1,1-Dichloroethene	75-35-4	7	0.7	<0.17	<0.34	<0.15	<0.40	<0.49		<0.30
cis-1,2-Dichloroethene	156-59-2	70	7	<0.18	<0.40	<0.12	<0.30	<0.41		<0.47
trans-1,2-Dichloroethene	156-60-5	100	20	<0.23	<0.47	<0.13	<0.30	<0.35		<0.53
Benzene	71-43-2	5	0.5	<0.19	<0.42	<0.13	<0.40	<0.47		<0.30
Toluene	108-88-3	800	160	<0.17	<0.37	<0.16	<0.21	<0.27		<0.29
Naphthalene	91-20-3	100	10	0.47 ^J	<0.37	<0.31	<0.30	<0.35	<1.9	

Notes:

µg/L - Parts Per Billion (ppb)

< = Concentration Below Laboratory Detection Limit

-- = No Standard/Not Applicable

- = Not Sampled

X = Results Not Reported

^J = Estimated concentration at or above the Limit of Detection (LOD) and below the Limit of Quantitation (LOQ)

Bold	= Exceeds NR140.10 Enforcement Standard
<i>Italic</i>	= Exceeds NR140.10 Preventive Action Limit

Table 1L
Groundwater Analytical Results
UWSP-5D
Former Judges Dry Cleaners
257 Division Street
Stevens Point, WI

Reported/Collected By-->				MSA						REI
Date-->				15-Dec-07	27-Apr-08	12-Apr-10	20-Nov-19	27-Oct-21	19-Jan-22	22-Dec-23
VOC's (µg/L)	CAS Number	Enforcement Standard (ES)	Preventive Action Limit (PAL)							
Tetrachloroethene (PCE)	127-18-4	5	0.5	<i>1.3</i>	0.45 ^J	<0.18	<i>3.4</i>	<i>1.7</i>	Not Sampled Under Ice	<i>1.6</i>
Trichloroethene (TCE)	79-01-6	5	0.5	0.26 ^J	<0.43	<0.16	<i>0.54</i>	<i>0.77</i>		<i>0.95^I</i>
Vinyl chloride	75-01-4	0.2	0.02	<0.20	<0.095	<0.17	<0.14	<0.15		<0.17
Dichlorodifluoromethane	75-71-8	1,000	200	<0.16	<0.22	<0.13	<0.40	<0.63		<0.46
1,2-Dichloroethane	107-06-2	5	0.5	X	X	X	X	X		<0.29
1,1-Dichloroethene	75-35-4	7	0.7	<0.16	<0.34	<0.15	<0.40	<0.49		<0.30
cis-1,2-Dichloroethene	156-59-2	70	7	0.26 ^J	<0.40	<0.12	0.48	<0.41		<0.47
trans-1,2-Dichloroethene	156-60-5	100	20	<0.17	<0.47	<0.13	<0.30	<0.35		<0.53
Benzene	71-43-2	5	0.5	<0.19	<0.42	<0.13	<0.40	<0.47		<0.30
Toluene	108-88-3	800	160	<0.17	<0.37	<0.16	<0.21	<0.27		<0.29
Naphthalene	91-20-3	100	10	<0.37	<0.37	<0.31	<0.30	<0.35	<1.9	

Notes:

µg/L - Parts Per Billion (ppb)

< = Concentration Below Laboratory Detection Limit

-- = No Standard/Not Applicable

- = Not Sampled

X = Results Not Reported

^J = Estimated concentration at or above the Limit of Detection (LOD) and below the Limit of Quantitation (LOQ)

Bold	= Exceeds NR140.10 Enforcement Standard
<i>Italic</i>	= Exceeds NR140.10 Preventive Action Limit

**Table 2
Groundwater Elevation Data
Former Judges Cleaners
257 Division Street
Stevens Point, WI**

Depth to Water (feet) below Reference Elevation

Date	J-1	J-3	J-3D	UWSP-1	UWSP-1D	UWSP-2	UWSP-3	UWSP-3D	UWSP-4	UWSP-4D	UWSP-5	UWSP-5D
7/27/1995	6.09											
2/15/1996	7.60	5.60										
10/1/1998												
10/14/1999	4.96	4.71	4.78									
2/7/2002	7.29	5.03	5.11									
12/4/2002	6.85	2.77	2.88									
3/27/2003	7.22	4.29	4.47									
7/15/2004	5.90	4.77	4.78	6.47	7.92	3.56	5.60	6.33				
11/23/2004	5.72	3.05	3.30	7.43	8.37	4.05	6.43	7.36				
9/14/2005	6.54	4.35	4.65	6.95	8.09	3.54	7.11	9.36				
9/11/2007	6.41	3.97	4.39	6.78	7.45	4.15	4.39	6.67				
12/15/2007		4.59	5.30	6.84	7.51	4.02	5.75	6.56	7.04	6.88	6.79	6.48
4/27/2008			4.83	4.36	5.49	2.26		4.53	5.24	5.51	6.21	5.89
4/12/2010	5.12	2.37	2.41	5.75	6.45	2.05	3.62	5.51	6.38	6.39	6.65	6.26
11/19/2019	6.41	3.56	3.64	8.24	8.78	7.60	6.32	7.12	6.95	6.64	7.21	6.95
10/27/2021	6.19	5.34	5.96	8.11	8.35		6.19	6.97	6.95	5.00	5.73	5.46
1/20/2022	6.81	5.22	7.02	8.63			6.72	7.42	7.34	6.84		
12/22/2023	6.41	5.52	6.02	8.24	8.54	7.35	6.35	7.08	7.05	6.59	6.10	5.91

Measuring Point Elevations (top of well casing)

Initial Survey	1,099.90	1,097.74	1,097.74	1,091.85	1,092.37	1,093.44	1,090.08	1,090.28	1,087.75	1,087.59	1,087.59	1,087.21
Resurvey (December 2007)	1,101.14	1,098.94	1,098.94									

Depth to Water (feet) below Top of Casing

Average	6.37	4.34	4.64	7.07	7.69	4.29	5.85	6.81	6.71	6.26	6.45	6.16
Maximum	7.60	5.60	7.02	8.63	8.78	7.60	7.11	9.36	7.34	6.88	7.21	6.95
Minimum	4.96	2.37	2.41	4.36	5.49	2.05	3.62	4.53	5.24	5.00	5.73	5.46
Range	2.64	3.23	4.61	4.27	3.29	5.55	3.49	4.83	2.10	1.88	1.48	1.49

Water Level Elevation (feet MSL)

Date	J-1	J-3	J-3D	UWSP-1	UWSP-1D	UWSP-2	UWSP-3	UWSP-3D	UWSP-4	UWSP-4D	UWSP-5	UWSP-5D
7/27/1995	1,093.81											
2/15/1996	1,092.30	1,092.14										
10/1/1998												
10/14/1999	1,094.94	1,093.03	1,092.96									
2/7/2002	1,092.61	1,092.71	1,092.63									
12/4/2002	1,093.05	1,094.97	1,094.86									
3/27/2003	1,092.68	1,093.45	1,093.27									
7/15/2004	1,094.00	1,092.97	1,092.96	1,085.38	1,084.45	1,089.88	1,084.48	1,083.95				
11/23/2004	1,094.18	1,094.69	1,094.44	1,084.42	1,084.00	1,089.39	1,083.65	1,082.92				
9/14/2005	1,093.36	1,093.39	1,093.09	1,084.90	1,084.28	1,089.90	1,082.97	1,080.92				
9/11/2007	1,093.49	1,093.77	1,093.35	1,085.07	1,084.92	1,089.29	1,085.69	1,083.61				
12/15/2007		1,094.35	1,093.64	1,085.01	1,084.86	1,089.42	1,084.33	1,083.72	1,080.71	1,080.71	1,080.80	1,080.73
4/27/2008			1,094.11	1,087.49	1,086.88	1,091.18		1,085.75	1,082.51	1,082.08	1,081.38	1,081.32
4/12/2010	1,096.02	1,096.57	1,096.53	1,086.10	1,085.92	1,091.39	1,086.46	1,084.77	1,081.37	1,081.20	1,080.94	1,080.95
11/19/2019	1,094.73	1,095.38	1,095.30	1,083.61	1,083.59	1,085.84	1,083.76	1,083.16	1,080.80	1,080.95	1,080.38	1,080.26
10/27/2021	1,094.95	1,093.60	1,092.98	1,083.74	1,084.02		1,083.89	1,083.31	1,080.80	1,082.59	1,081.86	1,081.75
1/20/2022	1,094.33	1,093.72	1,091.92	1,083.22			1,083.36	1,082.86	1,080.41	1,080.75		
12/22/2023	1,094.73	1,093.42	1,092.92	1,083.61	1,083.83	1,086.09	1,083.73	1,083.20	1,080.70	1,081.00	1,081.49	1,081.30

Notes:

Frost heaving of monitoring wells was observed during the REI sampling event on December 22, 2023.

DRAWING FILE: Q:\11000-11099\11078 - JUDGE'S CLEANERS - STEVENS POINT.DWG\11078-VICN(US Top).DWG LAYOUT: VICN PLOTTED: JAN 31, 2024 - 10:52AM PLOTTED BY: KAYLINF

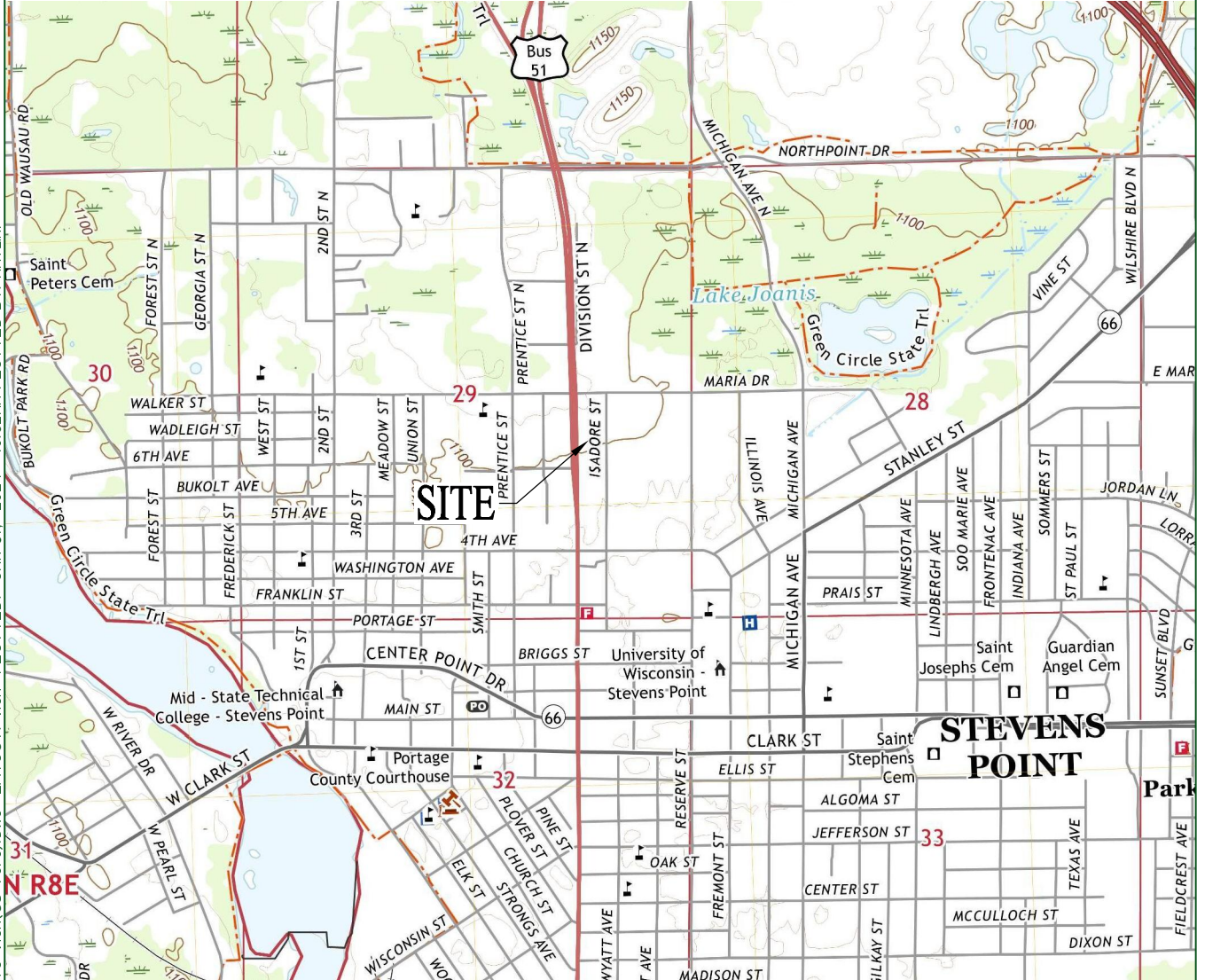

SCALE 1:24 000

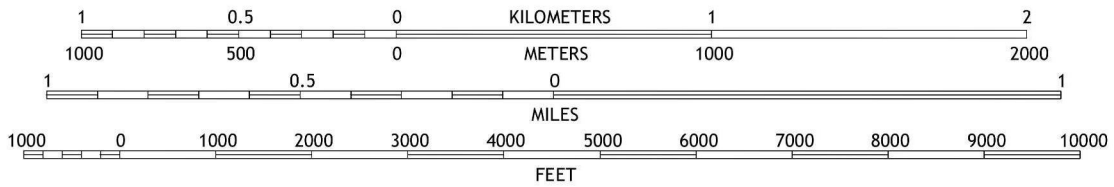

CONTOUR INTERVAL 10 FEET
NORTH AMERICAN VERTICAL DATUM OF 1988



STEVENS POINT QUADRANGLE
WISCONSIN - PORTAGE COUNTY
7.5-MINUTE SERIES



QUADRANGLE LOCATION

UTM GRID AND 2019 MAGNETIC NORTH
DECLINATION AT CENTER OF SHEET

STEVENS POINT, WI
2022
REI ENGINEERING, INC.

FORMER JUDGE'S DRY CLEANERS
257 DIVISION STREET
STEVENS POINT, WI 54481



FIGURE 1 : SITE VICINITY MAP

PROJECT NO.
11078

DRAWN BY:
KF

DATE:
01/31/2024

DRAWING FILE: Q:\11000-11099\11078 - JUDGE'S CLEANERS - STEVENS POINT\DWG\11078-SITE.DWG LAYOUT: ENW_VERT-1\17 PLOTTED: JAN 31, 2024 - 10:50AM PLOTTED BY: KAYLINF

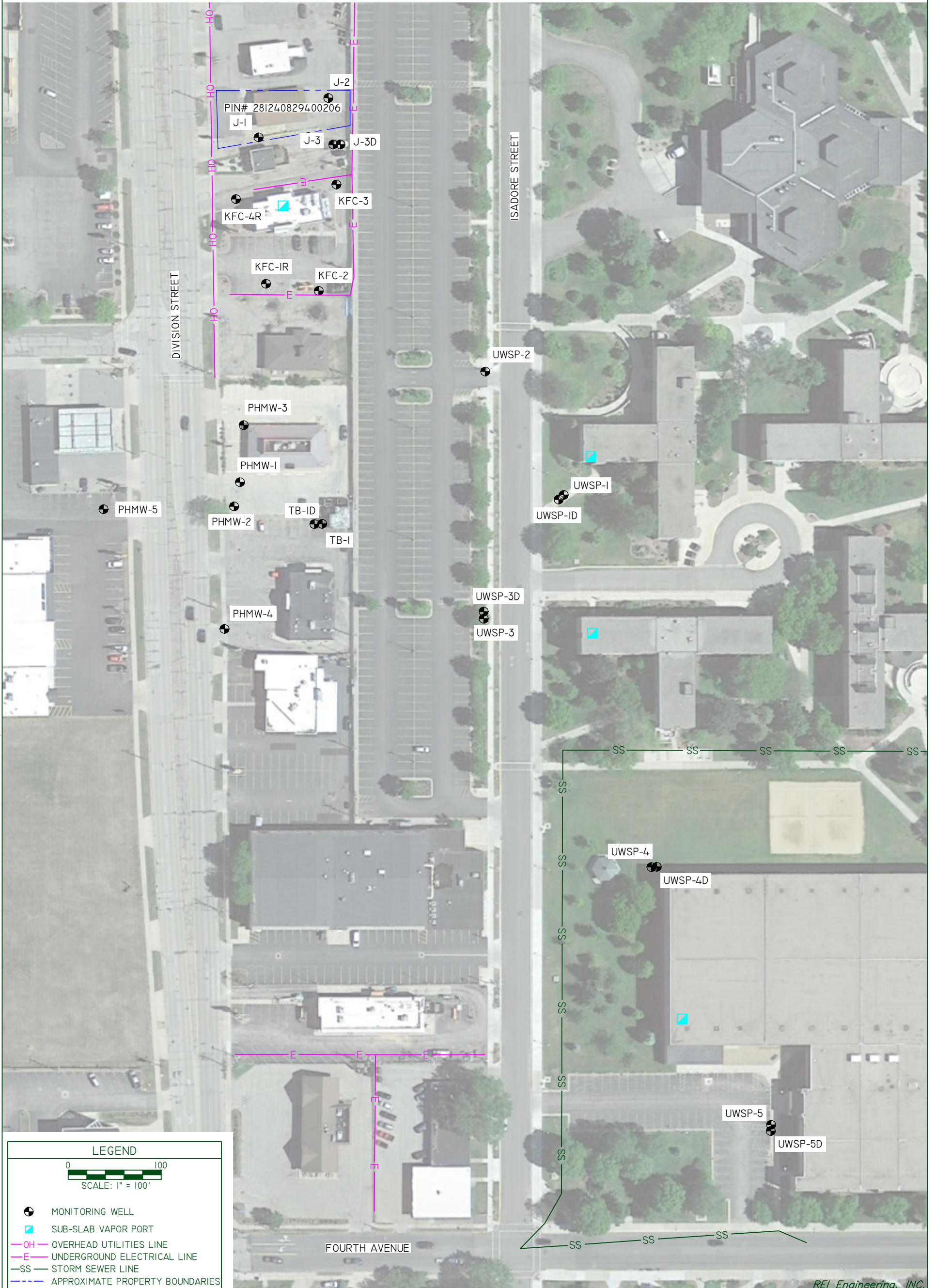

LEGEND

0 100
SCALE: 1" = 100'

- MONITORING WELL
- SUB-SLAB VAPOR PORT
- OVERHEAD UTILITIES LINE
- UNDERGROUND ELECTRICAL LINE
- STORM SEWER LINE
- APPROXIMATE PROPERTY BOUNDARIES

FORMER JUDGE'S DRY CLEANERS
257 DIVISION STREET
STEVENS POINT, WI 54481



FIGURE 2 : DETAILED SITE MAP

PROJECT No. 11078	DRAWN BY: KF	DATE: 01/31/2024
----------------------	-----------------	---------------------

REI Engineering, INC.

APPENDIX A

METHODS AND PROCEDURES



METHODS AND PROCEDURES
FOR
LOW-FLOW GROUNDWATER SAMPLING

WATER LEVEL

Groundwater level measurements were obtained by using an electronic measuring device which indicated when a probe is in contact by lowering the probe into the well until the instrument indicated that the water surface has been encountered, and the distance from the top of the well to the probe was measured. All measurements were reported to the nearest 0.01 foot.

PURGING, SAMPLING AND CHAIN OF CUSTODY

Disposable ¼” polyethylene tubing is inserted to the screen and connected to a peristaltic pump. The tubing is connected to a flow cell where a YSI Multi-meter is inserted. The YSI measures temperature, conductivity, dissolved oxygen, pH and redox potential. Water is pumped slowly and samples are collected after field measurements stabilize.

Water samples are collected directly from the tubing. If the well is purged dry, it is allowed to recharge and then sampled. Samples are labeled and placed in a cooler to be preserved at approximately 4 degrees C. Samples are accompanied by Chain of Custody records.

Upon completion of a sample, a chain of custody log is initiated. The chain of custody record includes the following information: project name, work order number, shipped by, shipped to, sampling point, location, field ID number, date and time taken, sample type, number of containers, analysis required, sampler (s) signature (s), etc. As few people as possible handle the samples.

The sample tubing is discarded after each sample and new tubing is used on each well.

APPENDIX B

WASTE DISPOSAL DOCUMENTATION





REI Water Disposal

Discharge to Wausau Waste Water Treatment Plant (WWTP) under the August 8, 2007 discharge agreement between the City of Wausau and REI Engineering, Inc.

Project Number:	11078
Project Name:	Former Judge's Cleaners
Disposed of Material:	Purge Water
Disposal Location:	Wausau WWTP
Name of Waste Hauler:	REI Engineering, Inc.
Quantity of Water Dicharged:	20

Sum of Volume (Gallons)		JobNumber
Disposal Location	DateOut	11078
WWTP		
	1/16/2024	20
WWTP Total (Gallons)		20

APPENDIX C

LABORATORY ANALYTICAL REPORT





January 04, 2024

DAVID LARSEN
REI
4080 NORTH 20TH AVENUE
Wausau, WI 54401

RE: Project: 11078 JUDGE'S CLEANERS
Pace Project No.: 40272591

Dear DAVID LARSEN:

Enclosed are the analytical results for sample(s) received by the laboratory on December 27, 2023. The results relate only to the samples included in this report. Results reported herein conform to the applicable TNI/NELAC Standards and the laboratory's Quality Manual, where applicable, unless otherwise noted in the body of the report.

The test results provided in this final report were generated by each of the following laboratories within the Pace Network:

- Pace Analytical Services - Green Bay

If you have any questions concerning this report, please feel free to contact me.

Sincerely,

Brian Basten
brian.basten@pacelabs.com
(920)469-2436
Project Manager

Enclosures

cc: Brian Bailey, REI Engineering



REPORT OF LABORATORY ANALYSIS

This report shall not be reproduced, except in full,
without the written consent of Pace Analytical Services, LLC.



CERTIFICATIONS

Project: 11078 JUDGE'S CLEANERS

Pace Project No.: 40272591

Pace Analytical Services Green Bay

1241 Bellevue Street, Green Bay, WI 54302

Florida/NELAP Certification #: E87948

Illinois Certification #: 200050

Kentucky UST Certification #: 82

Louisiana Certification #: 04168

Minnesota Certification #: 055-999-334

New York Certification #: 12064

North Dakota Certification #: R-150

South Carolina Certification #: 83006001

Texas Certification #: T104704529-21-8

Virginia VELAP Certification ID: 11873

Wisconsin Certification #: 405132750

Wisconsin DATCP Certification #: 105-444

USDA Soil Permit #: P330-21-00008

Federal Fish & Wildlife Permit #: 51774A

REPORT OF LABORATORY ANALYSIS

This report shall not be reproduced, except in full,
without the written consent of Pace Analytical Services, LLC.



SAMPLE SUMMARY

Project: 11078 JUDGE'S CLEANERS

Pace Project No.: 40272591

Lab ID	Sample ID	Matrix	Date Collected	Date Received
40272591001	UWSP-5	Water	12/22/23 15:00	12/27/23 07:55
40272591002	UWSP-5D	Water	12/22/23 15:30	12/27/23 07:55
40272591003	UWSP-4	Water	12/22/23 14:15	12/27/23 07:55
40272591004	UWSP-4D	Water	12/22/23 14:45	12/27/23 07:55
40272591005	UWSP-3	Water	12/22/23 13:30	12/27/23 07:55
40272591006	UWSP-3D	Water	12/22/23 13:45	12/27/23 07:55
40272591007	UWSP-1	Water	12/22/23 13:00	12/27/23 07:55
40272591008	UWSP-1D	Water	12/22/23 12:45	12/27/23 07:55
40272591009	UWSP-2	Water	12/22/23 12:00	12/27/23 07:55
40272591010	J-1	Water	12/22/23 11:00	12/27/23 07:55
40272591011	J-3	Water	12/22/23 09:45	12/27/23 07:55
40272591012	J-3D	Water	12/22/23 10:15	12/27/23 07:55

REPORT OF LABORATORY ANALYSIS

This report shall not be reproduced, except in full,
without the written consent of Pace Analytical Services, LLC.



SAMPLE ANALYTE COUNT

Project: 11078 JUDGE'S CLEANERS

Pace Project No.: 40272591

Lab ID	Sample ID	Method	Analysts	Analytes Reported
40272591001	UWSP-5	EPA 8260	EIB	64
40272591002	UWSP-5D	EPA 8260	EIB	64
40272591003	UWSP-4	EPA 8260	EIB	64
40272591004	UWSP-4D	EPA 8260	EIB	64
40272591005	UWSP-3	EPA 8260	EIB	64
40272591006	UWSP-3D	EPA 8260	EIB	64
40272591007	UWSP-1	EPA 8260	EIB	64
40272591008	UWSP-1D	EPA 8260	EIB	64
40272591009	UWSP-2	EPA 8260	EIB	64
40272591010	J-1	EPA 8260	EIB	64
40272591011	J-3	EPA 8260	EIB	64
40272591012	J-3D	EPA 8260	EIB	64

PASI-G = Pace Analytical Services - Green Bay

REPORT OF LABORATORY ANALYSIS

This report shall not be reproduced, except in full,
without the written consent of Pace Analytical Services, LLC.



ANALYTICAL RESULTS

Project: 11078 JUDGE'S CLEANERS

Pace Project No.: 40272591

Sample: UWSP-5 Lab ID: 40272591001 Collected: 12/22/23 15:00 Received: 12/27/23 07:55 Matrix: Water

Parameters	Results	Units	LOQ	LOD	DF	Prepared	Analyzed	CAS No.	Qual
8260 MSV									
Analytical Method: EPA 8260									
Pace Analytical Services - Green Bay									
Benzene	<0.30	ug/L	1.0	0.30	1		01/02/24 12:21	71-43-2	
Bromobenzene	<0.36	ug/L	1.0	0.36	1		01/02/24 12:21	108-86-1	
Bromochloromethane	<0.36	ug/L	1.0	0.36	1		01/02/24 12:21	74-97-5	
Bromodichloromethane	<0.42	ug/L	1.0	0.42	1		01/02/24 12:21	75-27-4	
Bromoform	<0.43	ug/L	1.0	0.43	1		01/02/24 12:21	75-25-2	
Bromomethane	<1.2	ug/L	5.0	1.2	1		01/02/24 12:21	74-83-9	
n-Butylbenzene	<0.86	ug/L	1.0	0.86	1		01/02/24 12:21	104-51-8	
sec-Butylbenzene	<0.42	ug/L	1.0	0.42	1		01/02/24 12:21	135-98-8	
tert-Butylbenzene	<0.59	ug/L	1.0	0.59	1		01/02/24 12:21	98-06-6	
Carbon tetrachloride	<0.37	ug/L	1.0	0.37	1		01/02/24 12:21	56-23-5	
Chlorobenzene	<0.86	ug/L	1.0	0.86	1		01/02/24 12:21	108-90-7	
Chloroethane	<1.4	ug/L	5.0	1.4	1		01/02/24 12:21	75-00-3	
Chloroform	<0.50	ug/L	5.0	0.50	1		01/02/24 12:21	67-66-3	
Chloromethane	<1.6	ug/L	5.0	1.6	1		01/02/24 12:21	74-87-3	
2-Chlorotoluene	<0.89	ug/L	5.0	0.89	1		01/02/24 12:21	95-49-8	
4-Chlorotoluene	<0.89	ug/L	5.0	0.89	1		01/02/24 12:21	106-43-4	
1,2-Dibromo-3-chloropropane	<2.4	ug/L	5.0	2.4	1		01/02/24 12:21	96-12-8	
Dibromochloromethane	<2.6	ug/L	5.0	2.6	1		01/02/24 12:21	124-48-1	
1,2-Dibromoethane (EDB)	<0.31	ug/L	1.0	0.31	1		01/02/24 12:21	106-93-4	
Dibromomethane	<0.99	ug/L	5.0	0.99	1		01/02/24 12:21	74-95-3	
1,2-Dichlorobenzene	<0.33	ug/L	1.0	0.33	1		01/02/24 12:21	95-50-1	
1,3-Dichlorobenzene	<0.35	ug/L	1.0	0.35	1		01/02/24 12:21	541-73-1	
1,4-Dichlorobenzene	<0.89	ug/L	1.0	0.89	1		01/02/24 12:21	106-46-7	
Dichlorodifluoromethane	<0.46	ug/L	5.0	0.46	1		01/02/24 12:21	75-71-8	
1,1-Dichloroethane	<0.30	ug/L	1.0	0.30	1		01/02/24 12:21	75-34-3	
1,2-Dichloroethane	<0.29	ug/L	1.0	0.29	1		01/02/24 12:21	107-06-2	
1,1-Dichloroethene	<0.58	ug/L	1.0	0.58	1		01/02/24 12:21	75-35-4	
cis-1,2-Dichloroethene	<0.47	ug/L	1.0	0.47	1		01/02/24 12:21	156-59-2	
trans-1,2-Dichloroethene	<0.53	ug/L	1.0	0.53	1		01/02/24 12:21	156-60-5	
1,2-Dichloropropane	<0.45	ug/L	1.0	0.45	1		01/02/24 12:21	78-87-5	
1,3-Dichloropropane	<0.30	ug/L	1.0	0.30	1		01/02/24 12:21	142-28-9	
2,2-Dichloropropane	<0.42	ug/L	1.0	0.42	1		01/02/24 12:21	594-20-7	
1,1-Dichloropropene	<0.41	ug/L	1.0	0.41	1		01/02/24 12:21	563-58-6	
cis-1,3-Dichloropropene	<0.24	ug/L	1.0	0.24	1		01/02/24 12:21	10061-01-5	
trans-1,3-Dichloropropene	<0.27	ug/L	1.0	0.27	1		01/02/24 12:21	10061-02-6	
Diisopropyl ether	<1.1	ug/L	5.0	1.1	1		01/02/24 12:21	108-20-3	
Ethylbenzene	<0.33	ug/L	1.0	0.33	1		01/02/24 12:21	100-41-4	
Hexachloro-1,3-butadiene	<2.7	ug/L	5.0	2.7	1		01/02/24 12:21	87-68-3	
Isopropylbenzene (Cumene)	<1.0	ug/L	5.0	1.0	1		01/02/24 12:21	98-82-8	
p-Isopropyltoluene	<1.0	ug/L	5.0	1.0	1		01/02/24 12:21	99-87-6	
Methylene Chloride	<0.32	ug/L	5.0	0.32	1		01/02/24 12:21	75-09-2	
Methyl-tert-butyl ether	<1.1	ug/L	5.0	1.1	1		01/02/24 12:21	1634-04-4	
Naphthalene	<1.9	ug/L	5.0	1.9	1		01/02/24 12:21	91-20-3	
n-Propylbenzene	<0.35	ug/L	1.0	0.35	1		01/02/24 12:21	103-65-1	
Styrene	<0.36	ug/L	1.0	0.36	1		01/02/24 12:21	100-42-5	

REPORT OF LABORATORY ANALYSIS

This report shall not be reproduced, except in full,
without the written consent of Pace Analytical Services, LLC.



ANALYTICAL RESULTS

Project: 11078 JUDGE'S CLEANERS

Pace Project No.: 40272591

Sample: UWSP-5 Lab ID: 40272591001 Collected: 12/22/23 15:00 Received: 12/27/23 07:55 Matrix: Water

Parameters	Results	Units	LOQ	LOD	DF	Prepared	Analyzed	CAS No.	Qual
8260 MSV									
Analytical Method: EPA 8260									
Pace Analytical Services - Green Bay									
1,1,1,2-Tetrachloroethane	<0.36	ug/L	1.0	0.36	1		01/02/24 12:21	630-20-6	
1,1,1,2-Tetrachloroethane	<0.38	ug/L	1.0	0.38	1		01/02/24 12:21	79-34-5	
Tetrachloroethene	1.1	ug/L	1.0	0.41	1		01/02/24 12:21	127-18-4	
Toluene	<0.29	ug/L	1.0	0.29	1		01/02/24 12:21	108-88-3	
1,2,3-Trichlorobenzene	<1.0	ug/L	5.0	1.0	1		01/02/24 12:21	87-61-6	
1,2,4-Trichlorobenzene	<0.95	ug/L	5.0	0.95	1		01/02/24 12:21	120-82-1	
1,1,1-Trichloroethane	<0.30	ug/L	1.0	0.30	1		01/02/24 12:21	71-55-6	
1,1,2-Trichloroethane	<0.34	ug/L	1.0	0.34	1		01/02/24 12:21	79-00-5	
Trichloroethene	0.71J	ug/L	1.0	0.32	1		01/02/24 12:21	79-01-6	
Trichlorofluoromethane	<0.42	ug/L	1.0	0.42	1		01/02/24 12:21	75-69-4	
1,2,3-Trichloropropane	<0.56	ug/L	1.0	0.56	1		01/02/24 12:21	96-18-4	
1,2,4-Trimethylbenzene	<0.45	ug/L	1.0	0.45	1		01/02/24 12:21	95-63-6	
1,3,5-Trimethylbenzene	<0.36	ug/L	1.0	0.36	1		01/02/24 12:21	108-67-8	
Vinyl chloride	<0.17	ug/L	1.0	0.17	1		01/02/24 12:21	75-01-4	
m&p-Xylene	<0.70	ug/L	2.0	0.70	1		01/02/24 12:21	179601-23-1	
o-Xylene	<0.35	ug/L	1.0	0.35	1		01/02/24 12:21	95-47-6	
Surrogates									
4-Bromofluorobenzene (S)	96	%	70-130		1		01/02/24 12:21	460-00-4	
1,2-Dichlorobenzene-d4 (S)	103	%	70-130		1		01/02/24 12:21	2199-69-1	
Toluene-d8 (S)	98	%	70-130		1		01/02/24 12:21	2037-26-5	

Sample: UWSP-5D Lab ID: 40272591002 Collected: 12/22/23 15:30 Received: 12/27/23 07:55 Matrix: Water

Parameters	Results	Units	LOQ	LOD	DF	Prepared	Analyzed	CAS No.	Qual
8260 MSV									
Analytical Method: EPA 8260									
Pace Analytical Services - Green Bay									
Benzene	<0.30	ug/L	1.0	0.30	1		01/02/24 12:40	71-43-2	
Bromobenzene	<0.36	ug/L	1.0	0.36	1		01/02/24 12:40	108-86-1	
Bromochloromethane	<0.36	ug/L	1.0	0.36	1		01/02/24 12:40	74-97-5	
Bromodichloromethane	<0.42	ug/L	1.0	0.42	1		01/02/24 12:40	75-27-4	
Bromoform	<0.43	ug/L	1.0	0.43	1		01/02/24 12:40	75-25-2	
Bromomethane	<1.2	ug/L	5.0	1.2	1		01/02/24 12:40	74-83-9	
n-Butylbenzene	<0.86	ug/L	1.0	0.86	1		01/02/24 12:40	104-51-8	
sec-Butylbenzene	<0.42	ug/L	1.0	0.42	1		01/02/24 12:40	135-98-8	
tert-Butylbenzene	<0.59	ug/L	1.0	0.59	1		01/02/24 12:40	98-06-6	
Carbon tetrachloride	<0.37	ug/L	1.0	0.37	1		01/02/24 12:40	56-23-5	
Chlorobenzene	<0.86	ug/L	1.0	0.86	1		01/02/24 12:40	108-90-7	
Chloroethane	<1.4	ug/L	5.0	1.4	1		01/02/24 12:40	75-00-3	
Chloroform	<0.50	ug/L	5.0	0.50	1		01/02/24 12:40	67-66-3	
Chloromethane	<1.6	ug/L	5.0	1.6	1		01/02/24 12:40	74-87-3	
2-Chlorotoluene	<0.89	ug/L	5.0	0.89	1		01/02/24 12:40	95-49-8	
4-Chlorotoluene	<0.89	ug/L	5.0	0.89	1		01/02/24 12:40	106-43-4	

REPORT OF LABORATORY ANALYSIS

This report shall not be reproduced, except in full,
without the written consent of Pace Analytical Services, LLC.



ANALYTICAL RESULTS

Project: 11078 JUDGE'S CLEANERS

Pace Project No.: 40272591

Sample: UWSP-5D Lab ID: 40272591002 Collected: 12/22/23 15:30 Received: 12/27/23 07:55 Matrix: Water

Parameters	Results	Units	LOQ	LOD	DF	Prepared	Analyzed	CAS No.	Qual
8260 MSV									
Analytical Method: EPA 8260									
Pace Analytical Services - Green Bay									
1,2-Dibromo-3-chloropropane	<2.4	ug/L	5.0	2.4	1		01/02/24 12:40	96-12-8	
Dibromochloromethane	<2.6	ug/L	5.0	2.6	1		01/02/24 12:40	124-48-1	
1,2-Dibromoethane (EDB)	<0.31	ug/L	1.0	0.31	1		01/02/24 12:40	106-93-4	
Dibromomethane	<0.99	ug/L	5.0	0.99	1		01/02/24 12:40	74-95-3	
1,2-Dichlorobenzene	<0.33	ug/L	1.0	0.33	1		01/02/24 12:40	95-50-1	
1,3-Dichlorobenzene	<0.35	ug/L	1.0	0.35	1		01/02/24 12:40	541-73-1	
1,4-Dichlorobenzene	<0.89	ug/L	1.0	0.89	1		01/02/24 12:40	106-46-7	
Dichlorodifluoromethane	<0.46	ug/L	5.0	0.46	1		01/02/24 12:40	75-71-8	
1,1-Dichloroethane	<0.30	ug/L	1.0	0.30	1		01/02/24 12:40	75-34-3	
1,2-Dichloroethane	<0.29	ug/L	1.0	0.29	1		01/02/24 12:40	107-06-2	
1,1-Dichloroethene	<0.58	ug/L	1.0	0.58	1		01/02/24 12:40	75-35-4	
cis-1,2-Dichloroethene	<0.47	ug/L	1.0	0.47	1		01/02/24 12:40	156-59-2	
trans-1,2-Dichloroethene	<0.53	ug/L	1.0	0.53	1		01/02/24 12:40	156-60-5	
1,2-Dichloropropane	<0.45	ug/L	1.0	0.45	1		01/02/24 12:40	78-87-5	
1,3-Dichloropropane	<0.30	ug/L	1.0	0.30	1		01/02/24 12:40	142-28-9	
2,2-Dichloropropane	<0.42	ug/L	1.0	0.42	1		01/02/24 12:40	594-20-7	
1,1-Dichloropropene	<0.41	ug/L	1.0	0.41	1		01/02/24 12:40	563-58-6	
cis-1,3-Dichloropropene	<0.24	ug/L	1.0	0.24	1		01/02/24 12:40	10061-01-5	
trans-1,3-Dichloropropene	<0.27	ug/L	1.0	0.27	1		01/02/24 12:40	10061-02-6	
Diisopropyl ether	<1.1	ug/L	5.0	1.1	1		01/02/24 12:40	108-20-3	
Ethylbenzene	<0.33	ug/L	1.0	0.33	1		01/02/24 12:40	100-41-4	
Hexachloro-1,3-butadiene	<2.7	ug/L	5.0	2.7	1		01/02/24 12:40	87-68-3	
Isopropylbenzene (Cumene)	<1.0	ug/L	5.0	1.0	1		01/02/24 12:40	98-82-8	
p-Isopropyltoluene	<1.0	ug/L	5.0	1.0	1		01/02/24 12:40	99-87-6	
Methylene Chloride	<0.32	ug/L	5.0	0.32	1		01/02/24 12:40	75-09-2	
Methyl-tert-butyl ether	<1.1	ug/L	5.0	1.1	1		01/02/24 12:40	1634-04-4	
Naphthalene	<1.9	ug/L	5.0	1.9	1		01/02/24 12:40	91-20-3	
n-Propylbenzene	<0.35	ug/L	1.0	0.35	1		01/02/24 12:40	103-65-1	
Styrene	<0.36	ug/L	1.0	0.36	1		01/02/24 12:40	100-42-5	
1,1,1,2-Tetrachloroethane	<0.36	ug/L	1.0	0.36	1		01/02/24 12:40	630-20-6	
1,1,1,2,2-Tetrachloroethane	<0.38	ug/L	1.0	0.38	1		01/02/24 12:40	79-34-5	
Tetrachloroethene	1.6	ug/L	1.0	0.41	1		01/02/24 12:40	127-18-4	
Toluene	<0.29	ug/L	1.0	0.29	1		01/02/24 12:40	108-88-3	
1,2,3-Trichlorobenzene	<1.0	ug/L	5.0	1.0	1		01/02/24 12:40	87-61-6	
1,2,4-Trichlorobenzene	<0.95	ug/L	5.0	0.95	1		01/02/24 12:40	120-82-1	
1,1,1-Trichloroethane	<0.30	ug/L	1.0	0.30	1		01/02/24 12:40	71-55-6	
1,1,2-Trichloroethane	<0.34	ug/L	1.0	0.34	1		01/02/24 12:40	79-00-5	
Trichloroethene	0.95J	ug/L	1.0	0.32	1		01/02/24 12:40	79-01-6	
Trichlorofluoromethane	<0.42	ug/L	1.0	0.42	1		01/02/24 12:40	75-69-4	
1,2,3-Trichloropropane	<0.56	ug/L	1.0	0.56	1		01/02/24 12:40	96-18-4	
1,2,4-Trimethylbenzene	<0.45	ug/L	1.0	0.45	1		01/02/24 12:40	95-63-6	
1,3,5-Trimethylbenzene	<0.36	ug/L	1.0	0.36	1		01/02/24 12:40	108-67-8	
Vinyl chloride	<0.17	ug/L	1.0	0.17	1		01/02/24 12:40	75-01-4	
m&p-Xylene	<0.70	ug/L	2.0	0.70	1		01/02/24 12:40	179601-23-1	
o-Xylene	<0.35	ug/L	1.0	0.35	1		01/02/24 12:40	95-47-6	

REPORT OF LABORATORY ANALYSIS

This report shall not be reproduced, except in full,
without the written consent of Pace Analytical Services, LLC.



ANALYTICAL RESULTS

Project: 11078 JUDGE'S CLEANERS

Pace Project No.: 40272591

Sample: UWSP-5D Lab ID: 40272591002 Collected: 12/22/23 15:30 Received: 12/27/23 07:55 Matrix: Water

Parameters	Results	Units	LOQ	LOD	DF	Prepared	Analyzed	CAS No.	Qual
8260 MSV									
Analytical Method: EPA 8260									
Pace Analytical Services - Green Bay									
Surrogates									
4-Bromofluorobenzene (S)	90	%	70-130		1		01/02/24 12:40	460-00-4	
1,2-Dichlorobenzene-d4 (S)	102	%	70-130		1		01/02/24 12:40	2199-69-1	
Toluene-d8 (S)	97	%	70-130		1		01/02/24 12:40	2037-26-5	

Sample: UWSP-4 Lab ID: 40272591003 Collected: 12/22/23 14:15 Received: 12/27/23 07:55 Matrix: Water

Parameters	Results	Units	LOQ	LOD	DF	Prepared	Analyzed	CAS No.	Qual
8260 MSV									
Analytical Method: EPA 8260									
Pace Analytical Services - Green Bay									
Benzene	<0.30	ug/L	1.0	0.30	1		01/02/24 13:00	71-43-2	
Bromobenzene	<0.36	ug/L	1.0	0.36	1		01/02/24 13:00	108-86-1	
Bromochloromethane	<0.36	ug/L	1.0	0.36	1		01/02/24 13:00	74-97-5	
Bromodichloromethane	<0.42	ug/L	1.0	0.42	1		01/02/24 13:00	75-27-4	
Bromoform	<0.43	ug/L	1.0	0.43	1		01/02/24 13:00	75-25-2	
Bromomethane	<1.2	ug/L	5.0	1.2	1		01/02/24 13:00	74-83-9	
n-Butylbenzene	<0.86	ug/L	1.0	0.86	1		01/02/24 13:00	104-51-8	
sec-Butylbenzene	<0.42	ug/L	1.0	0.42	1		01/02/24 13:00	135-98-8	
tert-Butylbenzene	<0.59	ug/L	1.0	0.59	1		01/02/24 13:00	98-06-6	
Carbon tetrachloride	<0.37	ug/L	1.0	0.37	1		01/02/24 13:00	56-23-5	
Chlorobenzene	<0.86	ug/L	1.0	0.86	1		01/02/24 13:00	108-90-7	
Chloroethane	<1.4	ug/L	5.0	1.4	1		01/02/24 13:00	75-00-3	
Chloroform	<0.50	ug/L	5.0	0.50	1		01/02/24 13:00	67-66-3	
Chloromethane	<1.6	ug/L	5.0	1.6	1		01/02/24 13:00	74-87-3	
2-Chlorotoluene	<0.89	ug/L	5.0	0.89	1		01/02/24 13:00	95-49-8	
4-Chlorotoluene	<0.89	ug/L	5.0	0.89	1		01/02/24 13:00	106-43-4	
1,2-Dibromo-3-chloropropane	<2.4	ug/L	5.0	2.4	1		01/02/24 13:00	96-12-8	
Dibromochloromethane	<2.6	ug/L	5.0	2.6	1		01/02/24 13:00	124-48-1	
1,2-Dibromoethane (EDB)	<0.31	ug/L	1.0	0.31	1		01/02/24 13:00	106-93-4	
Dibromomethane	<0.99	ug/L	5.0	0.99	1		01/02/24 13:00	74-95-3	
1,2-Dichlorobenzene	<0.33	ug/L	1.0	0.33	1		01/02/24 13:00	95-50-1	
1,3-Dichlorobenzene	<0.35	ug/L	1.0	0.35	1		01/02/24 13:00	541-73-1	
1,4-Dichlorobenzene	<0.89	ug/L	1.0	0.89	1		01/02/24 13:00	106-46-7	
Dichlorodifluoromethane	0.80J	ug/L	5.0	0.46	1		01/02/24 13:00	75-71-8	
1,1-Dichloroethane	<0.30	ug/L	1.0	0.30	1		01/02/24 13:00	75-34-3	
1,2-Dichloroethane	<0.29	ug/L	1.0	0.29	1		01/02/24 13:00	107-06-2	
1,1-Dichloroethene	<0.58	ug/L	1.0	0.58	1		01/02/24 13:00	75-35-4	
cis-1,2-Dichloroethene	<0.47	ug/L	1.0	0.47	1		01/02/24 13:00	156-59-2	
trans-1,2-Dichloroethene	<0.53	ug/L	1.0	0.53	1		01/02/24 13:00	156-60-5	
1,2-Dichloropropane	<0.45	ug/L	1.0	0.45	1		01/02/24 13:00	78-87-5	
1,3-Dichloropropane	<0.30	ug/L	1.0	0.30	1		01/02/24 13:00	142-28-9	
2,2-Dichloropropane	<0.42	ug/L	1.0	0.42	1		01/02/24 13:00	594-20-7	

REPORT OF LABORATORY ANALYSIS

This report shall not be reproduced, except in full,
without the written consent of Pace Analytical Services, LLC.



ANALYTICAL RESULTS

Project: 11078 JUDGE'S CLEANERS

Pace Project No.: 40272591

Sample: UWSP-4 Lab ID: 40272591003 Collected: 12/22/23 14:15 Received: 12/27/23 07:55 Matrix: Water

Parameters	Results	Units	LOQ	LOD	DF	Prepared	Analyzed	CAS No.	Qual
8260 MSV									
Analytical Method: EPA 8260									
Pace Analytical Services - Green Bay									
1,1-Dichloropropene	<0.41	ug/L	1.0	0.41	1		01/02/24 13:00	563-58-6	
cis-1,3-Dichloropropene	<0.24	ug/L	1.0	0.24	1		01/02/24 13:00	10061-01-5	
trans-1,3-Dichloropropene	<0.27	ug/L	1.0	0.27	1		01/02/24 13:00	10061-02-6	
Diisopropyl ether	<1.1	ug/L	5.0	1.1	1		01/02/24 13:00	108-20-3	
Ethylbenzene	<0.33	ug/L	1.0	0.33	1		01/02/24 13:00	100-41-4	
Hexachloro-1,3-butadiene	<2.7	ug/L	5.0	2.7	1		01/02/24 13:00	87-68-3	
Isopropylbenzene (Cumene)	<1.0	ug/L	5.0	1.0	1		01/02/24 13:00	98-82-8	
p-Isopropyltoluene	<1.0	ug/L	5.0	1.0	1		01/02/24 13:00	99-87-6	
Methylene Chloride	<0.32	ug/L	5.0	0.32	1		01/02/24 13:00	75-09-2	
Methyl-tert-butyl ether	<1.1	ug/L	5.0	1.1	1		01/02/24 13:00	1634-04-4	
Naphthalene	<1.9	ug/L	5.0	1.9	1		01/02/24 13:00	91-20-3	
n-Propylbenzene	<0.35	ug/L	1.0	0.35	1		01/02/24 13:00	103-65-1	
Styrene	<0.36	ug/L	1.0	0.36	1		01/02/24 13:00	100-42-5	
1,1,1,2-Tetrachloroethane	<0.36	ug/L	1.0	0.36	1		01/02/24 13:00	630-20-6	
1,1,2,2-Tetrachloroethane	<0.38	ug/L	1.0	0.38	1		01/02/24 13:00	79-34-5	
Tetrachloroethene	<0.41	ug/L	1.0	0.41	1		01/02/24 13:00	127-18-4	
Toluene	<0.29	ug/L	1.0	0.29	1		01/02/24 13:00	108-88-3	
1,2,3-Trichlorobenzene	<1.0	ug/L	5.0	1.0	1		01/02/24 13:00	87-61-6	
1,2,4-Trichlorobenzene	<0.95	ug/L	5.0	0.95	1		01/02/24 13:00	120-82-1	
1,1,1-Trichloroethane	<0.30	ug/L	1.0	0.30	1		01/02/24 13:00	71-55-6	
1,1,2-Trichloroethane	<0.34	ug/L	1.0	0.34	1		01/02/24 13:00	79-00-5	
Trichloroethene	<0.32	ug/L	1.0	0.32	1		01/02/24 13:00	79-01-6	
Trichlorofluoromethane	<0.42	ug/L	1.0	0.42	1		01/02/24 13:00	75-69-4	
1,2,3-Trichloropropane	<0.56	ug/L	1.0	0.56	1		01/02/24 13:00	96-18-4	
1,2,4-Trimethylbenzene	<0.45	ug/L	1.0	0.45	1		01/02/24 13:00	95-63-6	
1,3,5-Trimethylbenzene	<0.36	ug/L	1.0	0.36	1		01/02/24 13:00	108-67-8	
Vinyl chloride	<0.17	ug/L	1.0	0.17	1		01/02/24 13:00	75-01-4	
m&p-Xylene	<0.70	ug/L	2.0	0.70	1		01/02/24 13:00	179601-23-1	
o-Xylene	<0.35	ug/L	1.0	0.35	1		01/02/24 13:00	95-47-6	
Surrogates									
4-Bromofluorobenzene (S)	92	%	70-130		1		01/02/24 13:00	460-00-4	
1,2-Dichlorobenzene-d4 (S)	103	%	70-130		1		01/02/24 13:00	2199-69-1	
Toluene-d8 (S)	97	%	70-130		1		01/02/24 13:00	2037-26-5	

Sample: UWSP-4D Lab ID: 40272591004 Collected: 12/22/23 14:45 Received: 12/27/23 07:55 Matrix: Water

Parameters	Results	Units	LOQ	LOD	DF	Prepared	Analyzed	CAS No.	Qual
8260 MSV									
Analytical Method: EPA 8260									
Pace Analytical Services - Green Bay									
Benzene	<0.30	ug/L	1.0	0.30	1		01/02/24 13:19	71-43-2	
Bromobenzene	<0.36	ug/L	1.0	0.36	1		01/02/24 13:19	108-86-1	
Bromochloromethane	<0.36	ug/L	1.0	0.36	1		01/02/24 13:19	74-97-5	

REPORT OF LABORATORY ANALYSIS

This report shall not be reproduced, except in full,
without the written consent of Pace Analytical Services, LLC.



ANALYTICAL RESULTS

Project: 11078 JUDGE'S CLEANERS

Pace Project No.: 40272591

Sample: UWSP-4D Lab ID: 40272591004 Collected: 12/22/23 14:45 Received: 12/27/23 07:55 Matrix: Water

Parameters	Results	Units	LOQ	LOD	DF	Prepared	Analyzed	CAS No.	Qual
8260 MSV									
Analytical Method: EPA 8260									
Pace Analytical Services - Green Bay									
Bromodichloromethane	<0.42	ug/L	1.0	0.42	1		01/02/24 13:19	75-27-4	
Bromoform	<0.43	ug/L	1.0	0.43	1		01/02/24 13:19	75-25-2	
Bromomethane	<1.2	ug/L	5.0	1.2	1		01/02/24 13:19	74-83-9	
n-Butylbenzene	<0.86	ug/L	1.0	0.86	1		01/02/24 13:19	104-51-8	
sec-Butylbenzene	<0.42	ug/L	1.0	0.42	1		01/02/24 13:19	135-98-8	
tert-Butylbenzene	<0.59	ug/L	1.0	0.59	1		01/02/24 13:19	98-06-6	
Carbon tetrachloride	<0.37	ug/L	1.0	0.37	1		01/02/24 13:19	56-23-5	
Chlorobenzene	<0.86	ug/L	1.0	0.86	1		01/02/24 13:19	108-90-7	
Chloroethane	<1.4	ug/L	5.0	1.4	1		01/02/24 13:19	75-00-3	
Chloroform	<0.50	ug/L	5.0	0.50	1		01/02/24 13:19	67-66-3	
Chloromethane	<1.6	ug/L	5.0	1.6	1		01/02/24 13:19	74-87-3	
2-Chlorotoluene	<0.89	ug/L	5.0	0.89	1		01/02/24 13:19	95-49-8	
4-Chlorotoluene	<0.89	ug/L	5.0	0.89	1		01/02/24 13:19	106-43-4	
1,2-Dibromo-3-chloropropane	<2.4	ug/L	5.0	2.4	1		01/02/24 13:19	96-12-8	
Dibromochloromethane	<2.6	ug/L	5.0	2.6	1		01/02/24 13:19	124-48-1	
1,2-Dibromoethane (EDB)	<0.31	ug/L	1.0	0.31	1		01/02/24 13:19	106-93-4	
Dibromomethane	<0.99	ug/L	5.0	0.99	1		01/02/24 13:19	74-95-3	
1,2-Dichlorobenzene	<0.33	ug/L	1.0	0.33	1		01/02/24 13:19	95-50-1	
1,3-Dichlorobenzene	<0.35	ug/L	1.0	0.35	1		01/02/24 13:19	541-73-1	
1,4-Dichlorobenzene	<0.89	ug/L	1.0	0.89	1		01/02/24 13:19	106-46-7	
Dichlorodifluoromethane	0.66J	ug/L	5.0	0.46	1		01/02/24 13:19	75-71-8	
1,1-Dichloroethane	<0.30	ug/L	1.0	0.30	1		01/02/24 13:19	75-34-3	
1,2-Dichloroethane	<0.29	ug/L	1.0	0.29	1		01/02/24 13:19	107-06-2	
1,1-Dichloroethene	<0.58	ug/L	1.0	0.58	1		01/02/24 13:19	75-35-4	
cis-1,2-Dichloroethene	<0.47	ug/L	1.0	0.47	1		01/02/24 13:19	156-59-2	
trans-1,2-Dichloroethene	<0.53	ug/L	1.0	0.53	1		01/02/24 13:19	156-60-5	
1,2-Dichloropropane	<0.45	ug/L	1.0	0.45	1		01/02/24 13:19	78-87-5	
1,3-Dichloropropane	<0.30	ug/L	1.0	0.30	1		01/02/24 13:19	142-28-9	
2,2-Dichloropropane	<0.42	ug/L	1.0	0.42	1		01/02/24 13:19	594-20-7	
1,1-Dichloropropene	<0.41	ug/L	1.0	0.41	1		01/02/24 13:19	563-58-6	
cis-1,3-Dichloropropene	<0.24	ug/L	1.0	0.24	1		01/02/24 13:19	10061-01-5	
trans-1,3-Dichloropropene	<0.27	ug/L	1.0	0.27	1		01/02/24 13:19	10061-02-6	
Diisopropyl ether	<1.1	ug/L	5.0	1.1	1		01/02/24 13:19	108-20-3	
Ethylbenzene	<0.33	ug/L	1.0	0.33	1		01/02/24 13:19	100-41-4	
Hexachloro-1,3-butadiene	<2.7	ug/L	5.0	2.7	1		01/02/24 13:19	87-68-3	
Isopropylbenzene (Cumene)	<1.0	ug/L	5.0	1.0	1		01/02/24 13:19	98-82-8	
p-Isopropyltoluene	<1.0	ug/L	5.0	1.0	1		01/02/24 13:19	99-87-6	
Methylene Chloride	<0.32	ug/L	5.0	0.32	1		01/02/24 13:19	75-09-2	
Methyl-tert-butyl ether	<1.1	ug/L	5.0	1.1	1		01/02/24 13:19	1634-04-4	
Naphthalene	<1.9	ug/L	5.0	1.9	1		01/02/24 13:19	91-20-3	
n-Propylbenzene	<0.35	ug/L	1.0	0.35	1		01/02/24 13:19	103-65-1	
Styrene	<0.36	ug/L	1.0	0.36	1		01/02/24 13:19	100-42-5	
1,1,1,2-Tetrachloroethane	<0.36	ug/L	1.0	0.36	1		01/02/24 13:19	630-20-6	
1,1,2,2-Tetrachloroethane	<0.38	ug/L	1.0	0.38	1		01/02/24 13:19	79-34-5	
Tetrachloroethene	<0.41	ug/L	1.0	0.41	1		01/02/24 13:19	127-18-4	

REPORT OF LABORATORY ANALYSIS

This report shall not be reproduced, except in full,
without the written consent of Pace Analytical Services, LLC.



ANALYTICAL RESULTS

Project: 11078 JUDGE'S CLEANERS

Pace Project No.: 40272591

Sample: UWSP-4D Lab ID: 40272591004 Collected: 12/22/23 14:45 Received: 12/27/23 07:55 Matrix: Water

Parameters	Results	Units	LOQ	LOD	DF	Prepared	Analyzed	CAS No.	Qual
8260 MSV									
Analytical Method: EPA 8260									
Pace Analytical Services - Green Bay									
Toluene	<0.29	ug/L	1.0	0.29	1		01/02/24 13:19	108-88-3	
1,2,3-Trichlorobenzene	<1.0	ug/L	5.0	1.0	1		01/02/24 13:19	87-61-6	
1,2,4-Trichlorobenzene	<0.95	ug/L	5.0	0.95	1		01/02/24 13:19	120-82-1	
1,1,1-Trichloroethane	<0.30	ug/L	1.0	0.30	1		01/02/24 13:19	71-55-6	
1,1,2-Trichloroethane	<0.34	ug/L	1.0	0.34	1		01/02/24 13:19	79-00-5	
Trichloroethene	<0.32	ug/L	1.0	0.32	1		01/02/24 13:19	79-01-6	
Trichlorofluoromethane	<0.42	ug/L	1.0	0.42	1		01/02/24 13:19	75-69-4	
1,2,3-Trichloropropane	<0.56	ug/L	1.0	0.56	1		01/02/24 13:19	96-18-4	
1,2,4-Trimethylbenzene	<0.45	ug/L	1.0	0.45	1		01/02/24 13:19	95-63-6	
1,3,5-Trimethylbenzene	<0.36	ug/L	1.0	0.36	1		01/02/24 13:19	108-67-8	
Vinyl chloride	<0.17	ug/L	1.0	0.17	1		01/02/24 13:19	75-01-4	
m&p-Xylene	<0.70	ug/L	2.0	0.70	1		01/02/24 13:19	179601-23-1	
o-Xylene	<0.35	ug/L	1.0	0.35	1		01/02/24 13:19	95-47-6	
Surrogates									
4-Bromofluorobenzene (S)	94	%	70-130		1		01/02/24 13:19	460-00-4	
1,2-Dichlorobenzene-d4 (S)	102	%	70-130		1		01/02/24 13:19	2199-69-1	
Toluene-d8 (S)	96	%	70-130		1		01/02/24 13:19	2037-26-5	

Sample: UWSP-3 Lab ID: 40272591005 Collected: 12/22/23 13:30 Received: 12/27/23 07:55 Matrix: Water

Parameters	Results	Units	LOQ	LOD	DF	Prepared	Analyzed	CAS No.	Qual
8260 MSV									
Analytical Method: EPA 8260									
Pace Analytical Services - Green Bay									
Benzene	<0.30	ug/L	1.0	0.30	1		01/02/24 13:39	71-43-2	
Bromobenzene	<0.36	ug/L	1.0	0.36	1		01/02/24 13:39	108-86-1	
Bromochloromethane	<0.36	ug/L	1.0	0.36	1		01/02/24 13:39	74-97-5	
Bromodichloromethane	<0.42	ug/L	1.0	0.42	1		01/02/24 13:39	75-27-4	
Bromoform	<0.43	ug/L	1.0	0.43	1		01/02/24 13:39	75-25-2	
Bromomethane	<1.2	ug/L	5.0	1.2	1		01/02/24 13:39	74-83-9	
n-Butylbenzene	<0.86	ug/L	1.0	0.86	1		01/02/24 13:39	104-51-8	
sec-Butylbenzene	<0.42	ug/L	1.0	0.42	1		01/02/24 13:39	135-98-8	
tert-Butylbenzene	<0.59	ug/L	1.0	0.59	1		01/02/24 13:39	98-06-6	
Carbon tetrachloride	<0.37	ug/L	1.0	0.37	1		01/02/24 13:39	56-23-5	
Chlorobenzene	<0.86	ug/L	1.0	0.86	1		01/02/24 13:39	108-90-7	
Chloroethane	<1.4	ug/L	5.0	1.4	1		01/02/24 13:39	75-00-3	
Chloroform	<0.50	ug/L	5.0	0.50	1		01/02/24 13:39	67-66-3	
Chloromethane	<1.6	ug/L	5.0	1.6	1		01/02/24 13:39	74-87-3	
2-Chlorotoluene	<0.89	ug/L	5.0	0.89	1		01/02/24 13:39	95-49-8	
4-Chlorotoluene	<0.89	ug/L	5.0	0.89	1		01/02/24 13:39	106-43-4	
1,2-Dibromo-3-chloropropane	<2.4	ug/L	5.0	2.4	1		01/02/24 13:39	96-12-8	
Dibromochloromethane	<2.6	ug/L	5.0	2.6	1		01/02/24 13:39	124-48-1	
1,2-Dibromoethane (EDB)	<0.31	ug/L	1.0	0.31	1		01/02/24 13:39	106-93-4	

REPORT OF LABORATORY ANALYSIS

This report shall not be reproduced, except in full,
without the written consent of Pace Analytical Services, LLC.



ANALYTICAL RESULTS

Project: 11078 JUDGE'S CLEANERS

Pace Project No.: 40272591

Sample: UWSP-3 Lab ID: 40272591005 Collected: 12/22/23 13:30 Received: 12/27/23 07:55 Matrix: Water

Parameters	Results	Units	LOQ	LOD	DF	Prepared	Analyzed	CAS No.	Qual
8260 MSV									
Analytical Method: EPA 8260									
Pace Analytical Services - Green Bay									
Dibromomethane	<0.99	ug/L	5.0	0.99	1		01/02/24 13:39	74-95-3	
1,2-Dichlorobenzene	<0.33	ug/L	1.0	0.33	1		01/02/24 13:39	95-50-1	
1,3-Dichlorobenzene	<0.35	ug/L	1.0	0.35	1		01/02/24 13:39	541-73-1	
1,4-Dichlorobenzene	<0.89	ug/L	1.0	0.89	1		01/02/24 13:39	106-46-7	
Dichlorodifluoromethane	<0.46	ug/L	5.0	0.46	1		01/02/24 13:39	75-71-8	
1,1-Dichloroethane	<0.30	ug/L	1.0	0.30	1		01/02/24 13:39	75-34-3	
1,2-Dichloroethane	<0.29	ug/L	1.0	0.29	1		01/02/24 13:39	107-06-2	
1,1-Dichloroethene	<0.58	ug/L	1.0	0.58	1		01/02/24 13:39	75-35-4	
cis-1,2-Dichloroethene	<0.47	ug/L	1.0	0.47	1		01/02/24 13:39	156-59-2	
trans-1,2-Dichloroethene	<0.53	ug/L	1.0	0.53	1		01/02/24 13:39	156-60-5	
1,2-Dichloropropane	<0.45	ug/L	1.0	0.45	1		01/02/24 13:39	78-87-5	
1,3-Dichloropropane	<0.30	ug/L	1.0	0.30	1		01/02/24 13:39	142-28-9	
2,2-Dichloropropane	<0.42	ug/L	1.0	0.42	1		01/02/24 13:39	594-20-7	
1,1-Dichloropropene	<0.41	ug/L	1.0	0.41	1		01/02/24 13:39	563-58-6	
cis-1,3-Dichloropropene	<0.24	ug/L	1.0	0.24	1		01/02/24 13:39	10061-01-5	
trans-1,3-Dichloropropene	<0.27	ug/L	1.0	0.27	1		01/02/24 13:39	10061-02-6	
Diisopropyl ether	<1.1	ug/L	5.0	1.1	1		01/02/24 13:39	108-20-3	
Ethylbenzene	<0.33	ug/L	1.0	0.33	1		01/02/24 13:39	100-41-4	
Hexachloro-1,3-butadiene	<2.7	ug/L	5.0	2.7	1		01/02/24 13:39	87-68-3	
Isopropylbenzene (Cumene)	<1.0	ug/L	5.0	1.0	1		01/02/24 13:39	98-82-8	
p-Isopropyltoluene	<1.0	ug/L	5.0	1.0	1		01/02/24 13:39	99-87-6	
Methylene Chloride	<0.32	ug/L	5.0	0.32	1		01/02/24 13:39	75-09-2	
Methyl-tert-butyl ether	<1.1	ug/L	5.0	1.1	1		01/02/24 13:39	1634-04-4	
Naphthalene	<1.9	ug/L	5.0	1.9	1		01/02/24 13:39	91-20-3	
n-Propylbenzene	<0.35	ug/L	1.0	0.35	1		01/02/24 13:39	103-65-1	
Styrene	<0.36	ug/L	1.0	0.36	1		01/02/24 13:39	100-42-5	
1,1,1,2-Tetrachloroethane	<0.36	ug/L	1.0	0.36	1		01/02/24 13:39	630-20-6	
1,1,2,2-Tetrachloroethane	<0.38	ug/L	1.0	0.38	1		01/02/24 13:39	79-34-5	
Tetrachloroethene	<0.41	ug/L	1.0	0.41	1		01/02/24 13:39	127-18-4	
Toluene	<0.29	ug/L	1.0	0.29	1		01/02/24 13:39	108-88-3	
1,2,3-Trichlorobenzene	<1.0	ug/L	5.0	1.0	1		01/02/24 13:39	87-61-6	
1,2,4-Trichlorobenzene	<0.95	ug/L	5.0	0.95	1		01/02/24 13:39	120-82-1	
1,1,1-Trichloroethane	<0.30	ug/L	1.0	0.30	1		01/02/24 13:39	71-55-6	
1,1,2-Trichloroethane	<0.34	ug/L	1.0	0.34	1		01/02/24 13:39	79-00-5	
Trichloroethene	<0.32	ug/L	1.0	0.32	1		01/02/24 13:39	79-01-6	
Trichlorofluoromethane	<0.42	ug/L	1.0	0.42	1		01/02/24 13:39	75-69-4	
1,2,3-Trichloropropane	<0.56	ug/L	1.0	0.56	1		01/02/24 13:39	96-18-4	
1,2,4-Trimethylbenzene	<0.45	ug/L	1.0	0.45	1		01/02/24 13:39	95-63-6	
1,3,5-Trimethylbenzene	<0.36	ug/L	1.0	0.36	1		01/02/24 13:39	108-67-8	
Vinyl chloride	<0.17	ug/L	1.0	0.17	1		01/02/24 13:39	75-01-4	
m&p-Xylene	<0.70	ug/L	2.0	0.70	1		01/02/24 13:39	179601-23-1	
o-Xylene	<0.35	ug/L	1.0	0.35	1		01/02/24 13:39	95-47-6	
Surrogates									
4-Bromofluorobenzene (S)	95	%	70-130		1		01/02/24 13:39	460-00-4	
1,2-Dichlorobenzene-d4 (S)	105	%	70-130		1		01/02/24 13:39	2199-69-1	

REPORT OF LABORATORY ANALYSIS

This report shall not be reproduced, except in full,
without the written consent of Pace Analytical Services, LLC.



ANALYTICAL RESULTS

Project: 11078 JUDGE'S CLEANERS

Pace Project No.: 40272591

Sample: UWSP-3 Lab ID: 40272591005 Collected: 12/22/23 13:30 Received: 12/27/23 07:55 Matrix: Water

Parameters	Results	Units	LOQ	LOD	DF	Prepared	Analyzed	CAS No.	Qual
8260 MSV									
Analytical Method: EPA 8260									
Pace Analytical Services - Green Bay									
Surrogates									
Toluene-d8 (S)	97	%	70-130		1		01/02/24 13:39	2037-26-5	

Sample: UWSP-3D Lab ID: 40272591006 Collected: 12/22/23 13:45 Received: 12/27/23 07:55 Matrix: Water

Parameters	Results	Units	LOQ	LOD	DF	Prepared	Analyzed	CAS No.	Qual
8260 MSV									
Analytical Method: EPA 8260									
Pace Analytical Services - Green Bay									
Benzene	<0.30	ug/L	1.0	0.30	1		01/02/24 13:59	71-43-2	
Bromobenzene	<0.36	ug/L	1.0	0.36	1		01/02/24 13:59	108-86-1	
Bromochloromethane	<0.36	ug/L	1.0	0.36	1		01/02/24 13:59	74-97-5	
Bromodichloromethane	<0.42	ug/L	1.0	0.42	1		01/02/24 13:59	75-27-4	
Bromoform	<0.43	ug/L	1.0	0.43	1		01/02/24 13:59	75-25-2	
Bromomethane	<1.2	ug/L	5.0	1.2	1		01/02/24 13:59	74-83-9	
n-Butylbenzene	<0.86	ug/L	1.0	0.86	1		01/02/24 13:59	104-51-8	
sec-Butylbenzene	<0.42	ug/L	1.0	0.42	1		01/02/24 13:59	135-98-8	
tert-Butylbenzene	<0.59	ug/L	1.0	0.59	1		01/02/24 13:59	98-06-6	
Carbon tetrachloride	<0.37	ug/L	1.0	0.37	1		01/02/24 13:59	56-23-5	
Chlorobenzene	<0.86	ug/L	1.0	0.86	1		01/02/24 13:59	108-90-7	
Chloroethane	<1.4	ug/L	5.0	1.4	1		01/02/24 13:59	75-00-3	
Chloroform	<0.50	ug/L	5.0	0.50	1		01/02/24 13:59	67-66-3	
Chloromethane	<1.6	ug/L	5.0	1.6	1		01/02/24 13:59	74-87-3	
2-Chlorotoluene	<0.89	ug/L	5.0	0.89	1		01/02/24 13:59	95-49-8	
4-Chlorotoluene	<0.89	ug/L	5.0	0.89	1		01/02/24 13:59	106-43-4	
1,2-Dibromo-3-chloropropane	<2.4	ug/L	5.0	2.4	1		01/02/24 13:59	96-12-8	
Dibromochloromethane	<2.6	ug/L	5.0	2.6	1		01/02/24 13:59	124-48-1	
1,2-Dibromoethane (EDB)	<0.31	ug/L	1.0	0.31	1		01/02/24 13:59	106-93-4	
Dibromomethane	<0.99	ug/L	5.0	0.99	1		01/02/24 13:59	74-95-3	
1,2-Dichlorobenzene	<0.33	ug/L	1.0	0.33	1		01/02/24 13:59	95-50-1	
1,3-Dichlorobenzene	<0.35	ug/L	1.0	0.35	1		01/02/24 13:59	541-73-1	
1,4-Dichlorobenzene	<0.89	ug/L	1.0	0.89	1		01/02/24 13:59	106-46-7	
Dichlorodifluoromethane	<0.46	ug/L	5.0	0.46	1		01/02/24 13:59	75-71-8	
1,1-Dichloroethane	<0.30	ug/L	1.0	0.30	1		01/02/24 13:59	75-34-3	
1,2-Dichloroethane	<0.29	ug/L	1.0	0.29	1		01/02/24 13:59	107-06-2	
1,1-Dichloroethene	0.81J	ug/L	1.0	0.58	1		01/02/24 13:59	75-35-4	
cis-1,2-Dichloroethene	66.8	ug/L	1.0	0.47	1		01/02/24 13:59	156-59-2	
trans-1,2-Dichloroethene	1.2	ug/L	1.0	0.53	1		01/02/24 13:59	156-60-5	
1,2-Dichloropropane	<0.45	ug/L	1.0	0.45	1		01/02/24 13:59	78-87-5	
1,3-Dichloropropane	<0.30	ug/L	1.0	0.30	1		01/02/24 13:59	142-28-9	
2,2-Dichloropropane	<0.42	ug/L	1.0	0.42	1		01/02/24 13:59	594-20-7	
1,1-Dichloropropene	<0.41	ug/L	1.0	0.41	1		01/02/24 13:59	563-58-6	
cis-1,3-Dichloropropene	<0.24	ug/L	1.0	0.24	1		01/02/24 13:59	10061-01-5	

REPORT OF LABORATORY ANALYSIS

This report shall not be reproduced, except in full,
without the written consent of Pace Analytical Services, LLC.



ANALYTICAL RESULTS

Project: 11078 JUDGE'S CLEANERS

Pace Project No.: 40272591

Sample: UWSP-3D Lab ID: 40272591006 Collected: 12/22/23 13:45 Received: 12/27/23 07:55 Matrix: Water

Parameters	Results	Units	LOQ	LOD	DF	Prepared	Analyzed	CAS No.	Qual
8260 MSV									
Analytical Method: EPA 8260									
Pace Analytical Services - Green Bay									
trans-1,3-Dichloropropene	<0.27	ug/L	1.0	0.27	1		01/02/24 13:59	10061-02-6	
Diisopropyl ether	<1.1	ug/L	5.0	1.1	1		01/02/24 13:59	108-20-3	
Ethylbenzene	<0.33	ug/L	1.0	0.33	1		01/02/24 13:59	100-41-4	
Hexachloro-1,3-butadiene	<2.7	ug/L	5.0	2.7	1		01/02/24 13:59	87-68-3	
Isopropylbenzene (Cumene)	<1.0	ug/L	5.0	1.0	1		01/02/24 13:59	98-82-8	
p-Isopropyltoluene	<1.0	ug/L	5.0	1.0	1		01/02/24 13:59	99-87-6	
Methylene Chloride	<0.32	ug/L	5.0	0.32	1		01/02/24 13:59	75-09-2	
Methyl-tert-butyl ether	<1.1	ug/L	5.0	1.1	1		01/02/24 13:59	1634-04-4	
Naphthalene	<1.9	ug/L	5.0	1.9	1		01/02/24 13:59	91-20-3	
n-Propylbenzene	<0.35	ug/L	1.0	0.35	1		01/02/24 13:59	103-65-1	
Styrene	<0.36	ug/L	1.0	0.36	1		01/02/24 13:59	100-42-5	
1,1,1,2-Tetrachloroethane	<0.36	ug/L	1.0	0.36	1		01/02/24 13:59	630-20-6	
1,1,2,2-Tetrachloroethane	<0.38	ug/L	1.0	0.38	1		01/02/24 13:59	79-34-5	
Tetrachloroethene	12.9	ug/L	1.0	0.41	1		01/02/24 13:59	127-18-4	
Toluene	<0.29	ug/L	1.0	0.29	1		01/02/24 13:59	108-88-3	
1,2,3-Trichlorobenzene	<1.0	ug/L	5.0	1.0	1		01/02/24 13:59	87-61-6	
1,2,4-Trichlorobenzene	<0.95	ug/L	5.0	0.95	1		01/02/24 13:59	120-82-1	
1,1,1-Trichloroethane	<0.30	ug/L	1.0	0.30	1		01/02/24 13:59	71-55-6	
1,1,2-Trichloroethane	<0.34	ug/L	1.0	0.34	1		01/02/24 13:59	79-00-5	
Trichloroethene	25.2	ug/L	1.0	0.32	1		01/02/24 13:59	79-01-6	
Trichlorofluoromethane	<0.42	ug/L	1.0	0.42	1		01/02/24 13:59	75-69-4	
1,2,3-Trichloropropane	<0.56	ug/L	1.0	0.56	1		01/02/24 13:59	96-18-4	
1,2,4-Trimethylbenzene	<0.45	ug/L	1.0	0.45	1		01/02/24 13:59	95-63-6	
1,3,5-Trimethylbenzene	<0.36	ug/L	1.0	0.36	1		01/02/24 13:59	108-67-8	
Vinyl chloride	2.2	ug/L	1.0	0.17	1		01/02/24 13:59	75-01-4	
m&p-Xylene	<0.70	ug/L	2.0	0.70	1		01/02/24 13:59	179601-23-1	
o-Xylene	<0.35	ug/L	1.0	0.35	1		01/02/24 13:59	95-47-6	
Surrogates									
4-Bromofluorobenzene (S)	89	%	70-130		1		01/02/24 13:59	460-00-4	
1,2-Dichlorobenzene-d4 (S)	102	%	70-130		1		01/02/24 13:59	2199-69-1	
Toluene-d8 (S)	97	%	70-130		1		01/02/24 13:59	2037-26-5	

Sample: UWSP-1 Lab ID: 40272591007 Collected: 12/22/23 13:00 Received: 12/27/23 07:55 Matrix: Water

Parameters	Results	Units	LOQ	LOD	DF	Prepared	Analyzed	CAS No.	Qual
8260 MSV									
Analytical Method: EPA 8260									
Pace Analytical Services - Green Bay									
Benzene	<0.30	ug/L	1.0	0.30	1		01/02/24 14:18	71-43-2	
Bromobenzene	<0.36	ug/L	1.0	0.36	1		01/02/24 14:18	108-86-1	
Bromochloromethane	<0.36	ug/L	1.0	0.36	1		01/02/24 14:18	74-97-5	
Bromodichloromethane	<0.42	ug/L	1.0	0.42	1		01/02/24 14:18	75-27-4	
Bromoform	<0.43	ug/L	1.0	0.43	1		01/02/24 14:18	75-25-2	

REPORT OF LABORATORY ANALYSIS

This report shall not be reproduced, except in full,
without the written consent of Pace Analytical Services, LLC.



ANALYTICAL RESULTS

Project: 11078 JUDGE'S CLEANERS

Pace Project No.: 40272591

Sample: UWSP-1 Lab ID: 40272591007 Collected: 12/22/23 13:00 Received: 12/27/23 07:55 Matrix: Water

Parameters	Results	Units	LOQ	LOD	DF	Prepared	Analyzed	CAS No.	Qual
8260 MSV									
Analytical Method: EPA 8260									
Pace Analytical Services - Green Bay									
Bromomethane	<1.2	ug/L	5.0	1.2	1		01/02/24 14:18	74-83-9	
n-Butylbenzene	<0.86	ug/L	1.0	0.86	1		01/02/24 14:18	104-51-8	
sec-Butylbenzene	<0.42	ug/L	1.0	0.42	1		01/02/24 14:18	135-98-8	
tert-Butylbenzene	<0.59	ug/L	1.0	0.59	1		01/02/24 14:18	98-06-6	
Carbon tetrachloride	<0.37	ug/L	1.0	0.37	1		01/02/24 14:18	56-23-5	
Chlorobenzene	<0.86	ug/L	1.0	0.86	1		01/02/24 14:18	108-90-7	
Chloroethane	<1.4	ug/L	5.0	1.4	1		01/02/24 14:18	75-00-3	
Chloroform	<0.50	ug/L	5.0	0.50	1		01/02/24 14:18	67-66-3	
Chloromethane	<1.6	ug/L	5.0	1.6	1		01/02/24 14:18	74-87-3	
2-Chlorotoluene	<0.89	ug/L	5.0	0.89	1		01/02/24 14:18	95-49-8	
4-Chlorotoluene	<0.89	ug/L	5.0	0.89	1		01/02/24 14:18	106-43-4	
1,2-Dibromo-3-chloropropane	<2.4	ug/L	5.0	2.4	1		01/02/24 14:18	96-12-8	
Dibromochloromethane	<2.6	ug/L	5.0	2.6	1		01/02/24 14:18	124-48-1	
1,2-Dibromoethane (EDB)	<0.31	ug/L	1.0	0.31	1		01/02/24 14:18	106-93-4	
Dibromomethane	<0.99	ug/L	5.0	0.99	1		01/02/24 14:18	74-95-3	
1,2-Dichlorobenzene	<0.33	ug/L	1.0	0.33	1		01/02/24 14:18	95-50-1	
1,3-Dichlorobenzene	<0.35	ug/L	1.0	0.35	1		01/02/24 14:18	541-73-1	
1,4-Dichlorobenzene	<0.89	ug/L	1.0	0.89	1		01/02/24 14:18	106-46-7	
Dichlorodifluoromethane	<0.46	ug/L	5.0	0.46	1		01/02/24 14:18	75-71-8	
1,1-Dichloroethane	<0.30	ug/L	1.0	0.30	1		01/02/24 14:18	75-34-3	
1,2-Dichloroethane	<0.29	ug/L	1.0	0.29	1		01/02/24 14:18	107-06-2	
1,1-Dichloroethene	<0.58	ug/L	1.0	0.58	1		01/02/24 14:18	75-35-4	
cis-1,2-Dichloroethene	<0.47	ug/L	1.0	0.47	1		01/02/24 14:18	156-59-2	
trans-1,2-Dichloroethene	<0.53	ug/L	1.0	0.53	1		01/02/24 14:18	156-60-5	
1,2-Dichloropropane	<0.45	ug/L	1.0	0.45	1		01/02/24 14:18	78-87-5	
1,3-Dichloropropane	<0.30	ug/L	1.0	0.30	1		01/02/24 14:18	142-28-9	
2,2-Dichloropropane	<0.42	ug/L	1.0	0.42	1		01/02/24 14:18	594-20-7	
1,1-Dichloropropene	<0.41	ug/L	1.0	0.41	1		01/02/24 14:18	563-58-6	
cis-1,3-Dichloropropene	<0.24	ug/L	1.0	0.24	1		01/02/24 14:18	10061-01-5	
trans-1,3-Dichloropropene	<0.27	ug/L	1.0	0.27	1		01/02/24 14:18	10061-02-6	
Diisopropyl ether	<1.1	ug/L	5.0	1.1	1		01/02/24 14:18	108-20-3	
Ethylbenzene	<0.33	ug/L	1.0	0.33	1		01/02/24 14:18	100-41-4	
Hexachloro-1,3-butadiene	<2.7	ug/L	5.0	2.7	1		01/02/24 14:18	87-68-3	
Isopropylbenzene (Cumene)	<1.0	ug/L	5.0	1.0	1		01/02/24 14:18	98-82-8	
p-Isopropyltoluene	<1.0	ug/L	5.0	1.0	1		01/02/24 14:18	99-87-6	
Methylene Chloride	<0.32	ug/L	5.0	0.32	1		01/02/24 14:18	75-09-2	
Methyl-tert-butyl ether	<1.1	ug/L	5.0	1.1	1		01/02/24 14:18	1634-04-4	
Naphthalene	<1.9	ug/L	5.0	1.9	1		01/02/24 14:18	91-20-3	
n-Propylbenzene	<0.35	ug/L	1.0	0.35	1		01/02/24 14:18	103-65-1	
Styrene	<0.36	ug/L	1.0	0.36	1		01/02/24 14:18	100-42-5	
1,1,1,2-Tetrachloroethane	<0.36	ug/L	1.0	0.36	1		01/02/24 14:18	630-20-6	
1,1,1,2,2-Tetrachloroethane	<0.38	ug/L	1.0	0.38	1		01/02/24 14:18	79-34-5	
Tetrachloroethene	<0.41	ug/L	1.0	0.41	1		01/02/24 14:18	127-18-4	
Toluene	<0.29	ug/L	1.0	0.29	1		01/02/24 14:18	108-88-3	
1,2,3-Trichlorobenzene	<1.0	ug/L	5.0	1.0	1		01/02/24 14:18	87-61-6	

REPORT OF LABORATORY ANALYSIS

This report shall not be reproduced, except in full,
without the written consent of Pace Analytical Services, LLC.



ANALYTICAL RESULTS

Project: 11078 JUDGE'S CLEANERS

Pace Project No.: 40272591

Sample: UWSP-1 Lab ID: 40272591007 Collected: 12/22/23 13:00 Received: 12/27/23 07:55 Matrix: Water

Parameters	Results	Units	LOQ	LOD	DF	Prepared	Analyzed	CAS No.	Qual
8260 MSV									
Analytical Method: EPA 8260									
Pace Analytical Services - Green Bay									
1,2,4-Trichlorobenzene	<0.95	ug/L	5.0	0.95	1		01/02/24 14:18	120-82-1	
1,1,1-Trichloroethane	<0.30	ug/L	1.0	0.30	1		01/02/24 14:18	71-55-6	
1,1,2-Trichloroethane	<0.34	ug/L	1.0	0.34	1		01/02/24 14:18	79-00-5	
Trichloroethene	<0.32	ug/L	1.0	0.32	1		01/02/24 14:18	79-01-6	
Trichlorofluoromethane	<0.42	ug/L	1.0	0.42	1		01/02/24 14:18	75-69-4	
1,2,3-Trichloropropane	<0.56	ug/L	1.0	0.56	1		01/02/24 14:18	96-18-4	
1,2,4-Trimethylbenzene	<0.45	ug/L	1.0	0.45	1		01/02/24 14:18	95-63-6	
1,3,5-Trimethylbenzene	<0.36	ug/L	1.0	0.36	1		01/02/24 14:18	108-67-8	
Vinyl chloride	<0.17	ug/L	1.0	0.17	1		01/02/24 14:18	75-01-4	
m&p-Xylene	<0.70	ug/L	2.0	0.70	1		01/02/24 14:18	179601-23-1	
o-Xylene	<0.35	ug/L	1.0	0.35	1		01/02/24 14:18	95-47-6	
Surrogates									
4-Bromofluorobenzene (S)	91	%	70-130		1		01/02/24 14:18	460-00-4	
1,2-Dichlorobenzene-d4 (S)	100	%	70-130		1		01/02/24 14:18	2199-69-1	
Toluene-d8 (S)	96	%	70-130		1		01/02/24 14:18	2037-26-5	

Sample: UWSP-1D Lab ID: 40272591008 Collected: 12/22/23 12:45 Received: 12/27/23 07:55 Matrix: Water

Parameters	Results	Units	LOQ	LOD	DF	Prepared	Analyzed	CAS No.	Qual
8260 MSV									
Analytical Method: EPA 8260									
Pace Analytical Services - Green Bay									
Benzene	<0.30	ug/L	1.0	0.30	1		01/02/24 14:38	71-43-2	
Bromobenzene	<0.36	ug/L	1.0	0.36	1		01/02/24 14:38	108-86-1	
Bromochloromethane	<0.36	ug/L	1.0	0.36	1		01/02/24 14:38	74-97-5	
Bromodichloromethane	<0.42	ug/L	1.0	0.42	1		01/02/24 14:38	75-27-4	
Bromoform	<0.43	ug/L	1.0	0.43	1		01/02/24 14:38	75-25-2	
Bromomethane	<1.2	ug/L	5.0	1.2	1		01/02/24 14:38	74-83-9	
n-Butylbenzene	<0.86	ug/L	1.0	0.86	1		01/02/24 14:38	104-51-8	
sec-Butylbenzene	<0.42	ug/L	1.0	0.42	1		01/02/24 14:38	135-98-8	
tert-Butylbenzene	<0.59	ug/L	1.0	0.59	1		01/02/24 14:38	98-06-6	
Carbon tetrachloride	<0.37	ug/L	1.0	0.37	1		01/02/24 14:38	56-23-5	
Chlorobenzene	<0.86	ug/L	1.0	0.86	1		01/02/24 14:38	108-90-7	
Chloroethane	<1.4	ug/L	5.0	1.4	1		01/02/24 14:38	75-00-3	
Chloroform	<0.50	ug/L	5.0	0.50	1		01/02/24 14:38	67-66-3	
Chloromethane	<1.6	ug/L	5.0	1.6	1		01/02/24 14:38	74-87-3	
2-Chlorotoluene	<0.89	ug/L	5.0	0.89	1		01/02/24 14:38	95-49-8	
4-Chlorotoluene	<0.89	ug/L	5.0	0.89	1		01/02/24 14:38	106-43-4	
1,2-Dibromo-3-chloropropane	<2.4	ug/L	5.0	2.4	1		01/02/24 14:38	96-12-8	
Dibromochloromethane	<2.6	ug/L	5.0	2.6	1		01/02/24 14:38	124-48-1	
1,2-Dibromoethane (EDB)	<0.31	ug/L	1.0	0.31	1		01/02/24 14:38	106-93-4	
Dibromomethane	<0.99	ug/L	5.0	0.99	1		01/02/24 14:38	74-95-3	
1,2-Dichlorobenzene	<0.33	ug/L	1.0	0.33	1		01/02/24 14:38	95-50-1	

REPORT OF LABORATORY ANALYSIS

This report shall not be reproduced, except in full,
without the written consent of Pace Analytical Services, LLC.



ANALYTICAL RESULTS

Project: 11078 JUDGE'S CLEANERS

Pace Project No.: 40272591

Sample: UWSP-1D Lab ID: 40272591008 Collected: 12/22/23 12:45 Received: 12/27/23 07:55 Matrix: Water

Parameters	Results	Units	LOQ	LOD	DF	Prepared	Analyzed	CAS No.	Qual
8260 MSV									
Analytical Method: EPA 8260									
Pace Analytical Services - Green Bay									
1,3-Dichlorobenzene	<0.35	ug/L	1.0	0.35	1		01/02/24 14:38	541-73-1	
1,4-Dichlorobenzene	<0.89	ug/L	1.0	0.89	1		01/02/24 14:38	106-46-7	
Dichlorodifluoromethane	<0.46	ug/L	5.0	0.46	1		01/02/24 14:38	75-71-8	
1,1-Dichloroethane	<0.30	ug/L	1.0	0.30	1		01/02/24 14:38	75-34-3	
1,2-Dichloroethane	<0.29	ug/L	1.0	0.29	1		01/02/24 14:38	107-06-2	
1,1-Dichloroethene	1.4	ug/L	1.0	0.58	1		01/02/24 14:38	75-35-4	
cis-1,2-Dichloroethene	73.7	ug/L	1.0	0.47	1		01/02/24 14:38	156-59-2	
trans-1,2-Dichloroethene	1.1	ug/L	1.0	0.53	1		01/02/24 14:38	156-60-5	
1,2-Dichloropropane	<0.45	ug/L	1.0	0.45	1		01/02/24 14:38	78-87-5	
1,3-Dichloropropane	<0.30	ug/L	1.0	0.30	1		01/02/24 14:38	142-28-9	
2,2-Dichloropropane	<0.42	ug/L	1.0	0.42	1		01/02/24 14:38	594-20-7	
1,1-Dichloropropene	<0.41	ug/L	1.0	0.41	1		01/02/24 14:38	563-58-6	
cis-1,3-Dichloropropene	<0.24	ug/L	1.0	0.24	1		01/02/24 14:38	10061-01-5	
trans-1,3-Dichloropropene	<0.27	ug/L	1.0	0.27	1		01/02/24 14:38	10061-02-6	
Diisopropyl ether	<1.1	ug/L	5.0	1.1	1		01/02/24 14:38	108-20-3	
Ethylbenzene	<0.33	ug/L	1.0	0.33	1		01/02/24 14:38	100-41-4	
Hexachloro-1,3-butadiene	<2.7	ug/L	5.0	2.7	1		01/02/24 14:38	87-68-3	
Isopropylbenzene (Cumene)	<1.0	ug/L	5.0	1.0	1		01/02/24 14:38	98-82-8	
p-Isopropyltoluene	<1.0	ug/L	5.0	1.0	1		01/02/24 14:38	99-87-6	
Methylene Chloride	<0.32	ug/L	5.0	0.32	1		01/02/24 14:38	75-09-2	
Methyl-tert-butyl ether	<1.1	ug/L	5.0	1.1	1		01/02/24 14:38	1634-04-4	
Naphthalene	<1.9	ug/L	5.0	1.9	1		01/02/24 14:38	91-20-3	
n-Propylbenzene	<0.35	ug/L	1.0	0.35	1		01/02/24 14:38	103-65-1	
Styrene	<0.36	ug/L	1.0	0.36	1		01/02/24 14:38	100-42-5	
1,1,1,2-Tetrachloroethane	<0.36	ug/L	1.0	0.36	1		01/02/24 14:38	630-20-6	
1,1,2,2-Tetrachloroethane	<0.38	ug/L	1.0	0.38	1		01/02/24 14:38	79-34-5	
Tetrachloroethene	368	ug/L	5.0	2.0	5		01/03/24 11:38	127-18-4	
Toluene	<0.29	ug/L	1.0	0.29	1		01/02/24 14:38	108-88-3	
1,2,3-Trichlorobenzene	<1.0	ug/L	5.0	1.0	1		01/02/24 14:38	87-61-6	
1,2,4-Trichlorobenzene	<0.95	ug/L	5.0	0.95	1		01/02/24 14:38	120-82-1	
1,1,1-Trichloroethane	<0.30	ug/L	1.0	0.30	1		01/02/24 14:38	71-55-6	
1,1,2-Trichloroethane	<0.34	ug/L	1.0	0.34	1		01/02/24 14:38	79-00-5	
Trichloroethene	54.7	ug/L	1.0	0.32	1		01/02/24 14:38	79-01-6	
Trichlorofluoromethane	<0.42	ug/L	1.0	0.42	1		01/02/24 14:38	75-69-4	
1,2,3-Trichloropropane	<0.56	ug/L	1.0	0.56	1		01/02/24 14:38	96-18-4	
1,2,4-Trimethylbenzene	<0.45	ug/L	1.0	0.45	1		01/02/24 14:38	95-63-6	
1,3,5-Trimethylbenzene	<0.36	ug/L	1.0	0.36	1		01/02/24 14:38	108-67-8	
Vinyl chloride	6.8	ug/L	1.0	0.17	1		01/02/24 14:38	75-01-4	
m&p-Xylene	<0.70	ug/L	2.0	0.70	1		01/02/24 14:38	179601-23-1	
o-Xylene	<0.35	ug/L	1.0	0.35	1		01/02/24 14:38	95-47-6	
Surrogates									
4-Bromofluorobenzene (S)	90	%	70-130		1		01/02/24 14:38	460-00-4	
1,2-Dichlorobenzene-d4 (S)	101	%	70-130		1		01/02/24 14:38	2199-69-1	
Toluene-d8 (S)	99	%	70-130		1		01/02/24 14:38	2037-26-5	

REPORT OF LABORATORY ANALYSIS

This report shall not be reproduced, except in full,
without the written consent of Pace Analytical Services, LLC.



ANALYTICAL RESULTS

Project: 11078 JUDGE'S CLEANERS

Pace Project No.: 40272591

Sample: UWSP-2 Lab ID: 40272591009 Collected: 12/22/23 12:00 Received: 12/27/23 07:55 Matrix: Water

Parameters	Results	Units	LOQ	LOD	DF	Prepared	Analyzed	CAS No.	Qual
8260 MSV									
Analytical Method: EPA 8260									
Pace Analytical Services - Green Bay									
Benzene	<0.30	ug/L	1.0	0.30	1		01/02/24 15:17	71-43-2	
Bromobenzene	<0.36	ug/L	1.0	0.36	1		01/02/24 15:17	108-86-1	
Bromochloromethane	<0.36	ug/L	1.0	0.36	1		01/02/24 15:17	74-97-5	
Bromodichloromethane	<0.42	ug/L	1.0	0.42	1		01/02/24 15:17	75-27-4	
Bromoform	<0.43	ug/L	1.0	0.43	1		01/02/24 15:17	75-25-2	
Bromomethane	<1.2	ug/L	5.0	1.2	1		01/02/24 15:17	74-83-9	
n-Butylbenzene	<0.86	ug/L	1.0	0.86	1		01/02/24 15:17	104-51-8	
sec-Butylbenzene	<0.42	ug/L	1.0	0.42	1		01/02/24 15:17	135-98-8	
tert-Butylbenzene	<0.59	ug/L	1.0	0.59	1		01/02/24 15:17	98-06-6	
Carbon tetrachloride	<0.37	ug/L	1.0	0.37	1		01/02/24 15:17	56-23-5	
Chlorobenzene	<0.86	ug/L	1.0	0.86	1		01/02/24 15:17	108-90-7	
Chloroethane	<1.4	ug/L	5.0	1.4	1		01/02/24 15:17	75-00-3	
Chloroform	<0.50	ug/L	5.0	0.50	1		01/02/24 15:17	67-66-3	
Chloromethane	<1.6	ug/L	5.0	1.6	1		01/02/24 15:17	74-87-3	
2-Chlorotoluene	<0.89	ug/L	5.0	0.89	1		01/02/24 15:17	95-49-8	
4-Chlorotoluene	<0.89	ug/L	5.0	0.89	1		01/02/24 15:17	106-43-4	
1,2-Dibromo-3-chloropropane	<2.4	ug/L	5.0	2.4	1		01/02/24 15:17	96-12-8	
Dibromochloromethane	<2.6	ug/L	5.0	2.6	1		01/02/24 15:17	124-48-1	
1,2-Dibromoethane (EDB)	<0.31	ug/L	1.0	0.31	1		01/02/24 15:17	106-93-4	
Dibromomethane	<0.99	ug/L	5.0	0.99	1		01/02/24 15:17	74-95-3	
1,2-Dichlorobenzene	<0.33	ug/L	1.0	0.33	1		01/02/24 15:17	95-50-1	
1,3-Dichlorobenzene	<0.35	ug/L	1.0	0.35	1		01/02/24 15:17	541-73-1	
1,4-Dichlorobenzene	<0.89	ug/L	1.0	0.89	1		01/02/24 15:17	106-46-7	
Dichlorodifluoromethane	<0.46	ug/L	5.0	0.46	1		01/02/24 15:17	75-71-8	
1,1-Dichloroethane	<0.30	ug/L	1.0	0.30	1		01/02/24 15:17	75-34-3	
1,2-Dichloroethane	<0.29	ug/L	1.0	0.29	1		01/02/24 15:17	107-06-2	
1,1-Dichloroethene	<0.58	ug/L	1.0	0.58	1		01/02/24 15:17	75-35-4	
cis-1,2-Dichloroethene	8.2	ug/L	1.0	0.47	1		01/02/24 15:17	156-59-2	
trans-1,2-Dichloroethene	<0.53	ug/L	1.0	0.53	1		01/02/24 15:17	156-60-5	
1,2-Dichloropropane	<0.45	ug/L	1.0	0.45	1		01/02/24 15:17	78-87-5	
1,3-Dichloropropane	<0.30	ug/L	1.0	0.30	1		01/02/24 15:17	142-28-9	
2,2-Dichloropropane	<0.42	ug/L	1.0	0.42	1		01/02/24 15:17	594-20-7	
1,1-Dichloropropene	<0.41	ug/L	1.0	0.41	1		01/02/24 15:17	563-58-6	
cis-1,3-Dichloropropene	<0.24	ug/L	1.0	0.24	1		01/02/24 15:17	10061-01-5	
trans-1,3-Dichloropropene	<0.27	ug/L	1.0	0.27	1		01/02/24 15:17	10061-02-6	
Diisopropyl ether	<1.1	ug/L	5.0	1.1	1		01/02/24 15:17	108-20-3	
Ethylbenzene	<0.33	ug/L	1.0	0.33	1		01/02/24 15:17	100-41-4	
Hexachloro-1,3-butadiene	<2.7	ug/L	5.0	2.7	1		01/02/24 15:17	87-68-3	
Isopropylbenzene (Cumene)	<1.0	ug/L	5.0	1.0	1		01/02/24 15:17	98-82-8	
p-Isopropyltoluene	<1.0	ug/L	5.0	1.0	1		01/02/24 15:17	99-87-6	
Methylene Chloride	<0.32	ug/L	5.0	0.32	1		01/02/24 15:17	75-09-2	
Methyl-tert-butyl ether	<1.1	ug/L	5.0	1.1	1		01/02/24 15:17	1634-04-4	
Naphthalene	<1.9	ug/L	5.0	1.9	1		01/02/24 15:17	91-20-3	
n-Propylbenzene	<0.35	ug/L	1.0	0.35	1		01/02/24 15:17	103-65-1	
Styrene	<0.36	ug/L	1.0	0.36	1		01/02/24 15:17	100-42-5	

REPORT OF LABORATORY ANALYSIS

This report shall not be reproduced, except in full,
without the written consent of Pace Analytical Services, LLC.



ANALYTICAL RESULTS

Project: 11078 JUDGE'S CLEANERS

Pace Project No.: 40272591

Sample: UWSP-2 Lab ID: 40272591009 Collected: 12/22/23 12:00 Received: 12/27/23 07:55 Matrix: Water

Parameters	Results	Units	LOQ	LOD	DF	Prepared	Analyzed	CAS No.	Qual
8260 MSV									
Analytical Method: EPA 8260									
Pace Analytical Services - Green Bay									
1,1,1,2-Tetrachloroethane	<0.36	ug/L	1.0	0.36	1		01/02/24 15:17	630-20-6	
1,1,1,2-Tetrachloroethane	<0.38	ug/L	1.0	0.38	1		01/02/24 15:17	79-34-5	
Tetrachloroethene	36.0	ug/L	1.0	0.41	1		01/02/24 15:17	127-18-4	
Toluene	<0.29	ug/L	1.0	0.29	1		01/02/24 15:17	108-88-3	
1,2,3-Trichlorobenzene	<1.0	ug/L	5.0	1.0	1		01/02/24 15:17	87-61-6	
1,2,4-Trichlorobenzene	<0.95	ug/L	5.0	0.95	1		01/02/24 15:17	120-82-1	
1,1,1-Trichloroethane	<0.30	ug/L	1.0	0.30	1		01/02/24 15:17	71-55-6	
1,1,2-Trichloroethane	<0.34	ug/L	1.0	0.34	1		01/02/24 15:17	79-00-5	
Trichloroethene	13.0	ug/L	1.0	0.32	1		01/02/24 15:17	79-01-6	
Trichlorofluoromethane	<0.42	ug/L	1.0	0.42	1		01/02/24 15:17	75-69-4	
1,2,3-Trichloropropane	<0.56	ug/L	1.0	0.56	1		01/02/24 15:17	96-18-4	
1,2,4-Trimethylbenzene	<0.45	ug/L	1.0	0.45	1		01/02/24 15:17	95-63-6	
1,3,5-Trimethylbenzene	<0.36	ug/L	1.0	0.36	1		01/02/24 15:17	108-67-8	
Vinyl chloride	<0.17	ug/L	1.0	0.17	1		01/02/24 15:17	75-01-4	
m&p-Xylene	<0.70	ug/L	2.0	0.70	1		01/02/24 15:17	179601-23-1	
o-Xylene	<0.35	ug/L	1.0	0.35	1		01/02/24 15:17	95-47-6	
Surrogates									
4-Bromofluorobenzene (S)	94	%	70-130		1		01/02/24 15:17	460-00-4	
1,2-Dichlorobenzene-d4 (S)	104	%	70-130		1		01/02/24 15:17	2199-69-1	
Toluene-d8 (S)	98	%	70-130		1		01/02/24 15:17	2037-26-5	

Sample: J-1 Lab ID: 40272591010 Collected: 12/22/23 11:00 Received: 12/27/23 07:55 Matrix: Water

Parameters	Results	Units	LOQ	LOD	DF	Prepared	Analyzed	CAS No.	Qual
8260 MSV									
Analytical Method: EPA 8260									
Pace Analytical Services - Green Bay									
Benzene	<0.30	ug/L	1.0	0.30	1		01/02/24 15:36	71-43-2	
Bromobenzene	<0.36	ug/L	1.0	0.36	1		01/02/24 15:36	108-86-1	
Bromochloromethane	<0.36	ug/L	1.0	0.36	1		01/02/24 15:36	74-97-5	
Bromodichloromethane	<0.42	ug/L	1.0	0.42	1		01/02/24 15:36	75-27-4	
Bromoform	<0.43	ug/L	1.0	0.43	1		01/02/24 15:36	75-25-2	
Bromomethane	<1.2	ug/L	5.0	1.2	1		01/02/24 15:36	74-83-9	
n-Butylbenzene	<0.86	ug/L	1.0	0.86	1		01/02/24 15:36	104-51-8	
sec-Butylbenzene	<0.42	ug/L	1.0	0.42	1		01/02/24 15:36	135-98-8	
tert-Butylbenzene	<0.59	ug/L	1.0	0.59	1		01/02/24 15:36	98-06-6	
Carbon tetrachloride	<0.37	ug/L	1.0	0.37	1		01/02/24 15:36	56-23-5	
Chlorobenzene	<0.86	ug/L	1.0	0.86	1		01/02/24 15:36	108-90-7	
Chloroethane	<1.4	ug/L	5.0	1.4	1		01/02/24 15:36	75-00-3	
Chloroform	<0.50	ug/L	5.0	0.50	1		01/02/24 15:36	67-66-3	
Chloromethane	<1.6	ug/L	5.0	1.6	1		01/02/24 15:36	74-87-3	
2-Chlorotoluene	<0.89	ug/L	5.0	0.89	1		01/02/24 15:36	95-49-8	
4-Chlorotoluene	<0.89	ug/L	5.0	0.89	1		01/02/24 15:36	106-43-4	

REPORT OF LABORATORY ANALYSIS

This report shall not be reproduced, except in full,
without the written consent of Pace Analytical Services, LLC.



ANALYTICAL RESULTS

Project: 11078 JUDGE'S CLEANERS

Pace Project No.: 40272591

Sample: J-1 Lab ID: 40272591010 Collected: 12/22/23 11:00 Received: 12/27/23 07:55 Matrix: Water

Parameters	Results	Units	LOQ	LOD	DF	Prepared	Analyzed	CAS No.	Qual
8260 MSV									
Analytical Method: EPA 8260									
Pace Analytical Services - Green Bay									
1,2-Dibromo-3-chloropropane	<2.4	ug/L	5.0	2.4	1		01/02/24 15:36	96-12-8	
Dibromochloromethane	<2.6	ug/L	5.0	2.6	1		01/02/24 15:36	124-48-1	
1,2-Dibromoethane (EDB)	<0.31	ug/L	1.0	0.31	1		01/02/24 15:36	106-93-4	
Dibromomethane	<0.99	ug/L	5.0	0.99	1		01/02/24 15:36	74-95-3	
1,2-Dichlorobenzene	<0.33	ug/L	1.0	0.33	1		01/02/24 15:36	95-50-1	
1,3-Dichlorobenzene	<0.35	ug/L	1.0	0.35	1		01/02/24 15:36	541-73-1	
1,4-Dichlorobenzene	<0.89	ug/L	1.0	0.89	1		01/02/24 15:36	106-46-7	
Dichlorodifluoromethane	<0.46	ug/L	5.0	0.46	1		01/02/24 15:36	75-71-8	
1,1-Dichloroethane	<0.30	ug/L	1.0	0.30	1		01/02/24 15:36	75-34-3	
1,2-Dichloroethane	<0.29	ug/L	1.0	0.29	1		01/02/24 15:36	107-06-2	
1,1-Dichloroethene	<0.58	ug/L	1.0	0.58	1		01/02/24 15:36	75-35-4	
cis-1,2-Dichloroethene	<0.47	ug/L	1.0	0.47	1		01/02/24 15:36	156-59-2	
trans-1,2-Dichloroethene	<0.53	ug/L	1.0	0.53	1		01/02/24 15:36	156-60-5	
1,2-Dichloropropane	<0.45	ug/L	1.0	0.45	1		01/02/24 15:36	78-87-5	
1,3-Dichloropropane	<0.30	ug/L	1.0	0.30	1		01/02/24 15:36	142-28-9	
2,2-Dichloropropane	<0.42	ug/L	1.0	0.42	1		01/02/24 15:36	594-20-7	
1,1-Dichloropropene	<0.41	ug/L	1.0	0.41	1		01/02/24 15:36	563-58-6	
cis-1,3-Dichloropropene	<0.24	ug/L	1.0	0.24	1		01/02/24 15:36	10061-01-5	
trans-1,3-Dichloropropene	<0.27	ug/L	1.0	0.27	1		01/02/24 15:36	10061-02-6	
Diisopropyl ether	<1.1	ug/L	5.0	1.1	1		01/02/24 15:36	108-20-3	
Ethylbenzene	<0.33	ug/L	1.0	0.33	1		01/02/24 15:36	100-41-4	
Hexachloro-1,3-butadiene	<2.7	ug/L	5.0	2.7	1		01/02/24 15:36	87-68-3	
Isopropylbenzene (Cumene)	<1.0	ug/L	5.0	1.0	1		01/02/24 15:36	98-82-8	
p-Isopropyltoluene	<1.0	ug/L	5.0	1.0	1		01/02/24 15:36	99-87-6	
Methylene Chloride	<0.32	ug/L	5.0	0.32	1		01/02/24 15:36	75-09-2	
Methyl-tert-butyl ether	<1.1	ug/L	5.0	1.1	1		01/02/24 15:36	1634-04-4	
Naphthalene	<1.9	ug/L	5.0	1.9	1		01/02/24 15:36	91-20-3	
n-Propylbenzene	<0.35	ug/L	1.0	0.35	1		01/02/24 15:36	103-65-1	
Styrene	<0.36	ug/L	1.0	0.36	1		01/02/24 15:36	100-42-5	
1,1,1,2-Tetrachloroethane	<0.36	ug/L	1.0	0.36	1		01/02/24 15:36	630-20-6	
1,1,2,2-Tetrachloroethane	<0.38	ug/L	1.0	0.38	1		01/02/24 15:36	79-34-5	
Tetrachloroethene	7.4	ug/L	1.0	0.41	1		01/02/24 15:36	127-18-4	
Toluene	<0.29	ug/L	1.0	0.29	1		01/02/24 15:36	108-88-3	
1,2,3-Trichlorobenzene	<1.0	ug/L	5.0	1.0	1		01/02/24 15:36	87-61-6	
1,2,4-Trichlorobenzene	<0.95	ug/L	5.0	0.95	1		01/02/24 15:36	120-82-1	
1,1,1-Trichloroethane	<0.30	ug/L	1.0	0.30	1		01/02/24 15:36	71-55-6	
1,1,2-Trichloroethane	<0.34	ug/L	1.0	0.34	1		01/02/24 15:36	79-00-5	
Trichloroethene	<0.32	ug/L	1.0	0.32	1		01/02/24 15:36	79-01-6	
Trichlorofluoromethane	<0.42	ug/L	1.0	0.42	1		01/02/24 15:36	75-69-4	
1,2,3-Trichloropropane	<0.56	ug/L	1.0	0.56	1		01/02/24 15:36	96-18-4	
1,2,4-Trimethylbenzene	<0.45	ug/L	1.0	0.45	1		01/02/24 15:36	95-63-6	
1,3,5-Trimethylbenzene	<0.36	ug/L	1.0	0.36	1		01/02/24 15:36	108-67-8	
Vinyl chloride	<0.17	ug/L	1.0	0.17	1		01/02/24 15:36	75-01-4	
m&p-Xylene	<0.70	ug/L	2.0	0.70	1		01/02/24 15:36	179601-23-1	
o-Xylene	<0.35	ug/L	1.0	0.35	1		01/02/24 15:36	95-47-6	

REPORT OF LABORATORY ANALYSIS

This report shall not be reproduced, except in full,
without the written consent of Pace Analytical Services, LLC.



ANALYTICAL RESULTS

Project: 11078 JUDGE'S CLEANERS

Pace Project No.: 40272591

Sample: J-1 Lab ID: 40272591010 Collected: 12/22/23 11:00 Received: 12/27/23 07:55 Matrix: Water

Parameters	Results	Units	LOQ	LOD	DF	Prepared	Analyzed	CAS No.	Qual
8260 MSV									
Analytical Method: EPA 8260									
Pace Analytical Services - Green Bay									
Surrogates									
4-Bromofluorobenzene (S)	92	%	70-130		1		01/02/24 15:36	460-00-4	
1,2-Dichlorobenzene-d4 (S)	104	%	70-130		1		01/02/24 15:36	2199-69-1	
Toluene-d8 (S)	96	%	70-130		1		01/02/24 15:36	2037-26-5	

Sample: J-3 Lab ID: 40272591011 Collected: 12/22/23 09:45 Received: 12/27/23 07:55 Matrix: Water

Parameters	Results	Units	LOQ	LOD	DF	Prepared	Analyzed	CAS No.	Qual
8260 MSV									
Analytical Method: EPA 8260									
Pace Analytical Services - Green Bay									
Benzene	<0.30	ug/L	1.0	0.30	1		01/02/24 15:56	71-43-2	
Bromobenzene	<0.36	ug/L	1.0	0.36	1		01/02/24 15:56	108-86-1	
Bromochloromethane	<0.36	ug/L	1.0	0.36	1		01/02/24 15:56	74-97-5	
Bromodichloromethane	<0.42	ug/L	1.0	0.42	1		01/02/24 15:56	75-27-4	
Bromoform	<0.43	ug/L	1.0	0.43	1		01/02/24 15:56	75-25-2	
Bromomethane	<1.2	ug/L	5.0	1.2	1		01/02/24 15:56	74-83-9	
n-Butylbenzene	<0.86	ug/L	1.0	0.86	1		01/02/24 15:56	104-51-8	
sec-Butylbenzene	<0.42	ug/L	1.0	0.42	1		01/02/24 15:56	135-98-8	
tert-Butylbenzene	<0.59	ug/L	1.0	0.59	1		01/02/24 15:56	98-06-6	
Carbon tetrachloride	<0.37	ug/L	1.0	0.37	1		01/02/24 15:56	56-23-5	
Chlorobenzene	<0.86	ug/L	1.0	0.86	1		01/02/24 15:56	108-90-7	
Chloroethane	<1.4	ug/L	5.0	1.4	1		01/02/24 15:56	75-00-3	
Chloroform	<0.50	ug/L	5.0	0.50	1		01/02/24 15:56	67-66-3	
Chloromethane	<1.6	ug/L	5.0	1.6	1		01/02/24 15:56	74-87-3	
2-Chlorotoluene	<0.89	ug/L	5.0	0.89	1		01/02/24 15:56	95-49-8	
4-Chlorotoluene	<0.89	ug/L	5.0	0.89	1		01/02/24 15:56	106-43-4	
1,2-Dibromo-3-chloropropane	<2.4	ug/L	5.0	2.4	1		01/02/24 15:56	96-12-8	
Dibromochloromethane	<2.6	ug/L	5.0	2.6	1		01/02/24 15:56	124-48-1	
1,2-Dibromoethane (EDB)	<0.31	ug/L	1.0	0.31	1		01/02/24 15:56	106-93-4	
Dibromomethane	<0.99	ug/L	5.0	0.99	1		01/02/24 15:56	74-95-3	
1,2-Dichlorobenzene	<0.33	ug/L	1.0	0.33	1		01/02/24 15:56	95-50-1	
1,3-Dichlorobenzene	<0.35	ug/L	1.0	0.35	1		01/02/24 15:56	541-73-1	
1,4-Dichlorobenzene	<0.89	ug/L	1.0	0.89	1		01/02/24 15:56	106-46-7	
Dichlorodifluoromethane	<0.46	ug/L	5.0	0.46	1		01/02/24 15:56	75-71-8	
1,1-Dichloroethane	<0.30	ug/L	1.0	0.30	1		01/02/24 15:56	75-34-3	
1,2-Dichloroethane	<0.29	ug/L	1.0	0.29	1		01/02/24 15:56	107-06-2	
1,1-Dichloroethene	<0.58	ug/L	1.0	0.58	1		01/02/24 15:56	75-35-4	
cis-1,2-Dichloroethene	15.2	ug/L	1.0	0.47	1		01/02/24 15:56	156-59-2	
trans-1,2-Dichloroethene	<0.53	ug/L	1.0	0.53	1		01/02/24 15:56	156-60-5	
1,2-Dichloropropane	<0.45	ug/L	1.0	0.45	1		01/02/24 15:56	78-87-5	
1,3-Dichloropropane	<0.30	ug/L	1.0	0.30	1		01/02/24 15:56	142-28-9	
2,2-Dichloropropane	<0.42	ug/L	1.0	0.42	1		01/02/24 15:56	594-20-7	

REPORT OF LABORATORY ANALYSIS

This report shall not be reproduced, except in full,
without the written consent of Pace Analytical Services, LLC.



ANALYTICAL RESULTS

Project: 11078 JUDGE'S CLEANERS

Pace Project No.: 40272591

Sample: J-3 Lab ID: 40272591011 Collected: 12/22/23 09:45 Received: 12/27/23 07:55 Matrix: Water

Parameters	Results	Units	LOQ	LOD	DF	Prepared	Analyzed	CAS No.	Qual
8260 MSV									
Analytical Method: EPA 8260									
Pace Analytical Services - Green Bay									
1,1-Dichloropropene	<0.41	ug/L	1.0	0.41	1		01/02/24 15:56	563-58-6	
cis-1,3-Dichloropropene	<0.24	ug/L	1.0	0.24	1		01/02/24 15:56	10061-01-5	
trans-1,3-Dichloropropene	<0.27	ug/L	1.0	0.27	1		01/02/24 15:56	10061-02-6	
Diisopropyl ether	<1.1	ug/L	5.0	1.1	1		01/02/24 15:56	108-20-3	
Ethylbenzene	<0.33	ug/L	1.0	0.33	1		01/02/24 15:56	100-41-4	
Hexachloro-1,3-butadiene	<2.7	ug/L	5.0	2.7	1		01/02/24 15:56	87-68-3	
Isopropylbenzene (Cumene)	<1.0	ug/L	5.0	1.0	1		01/02/24 15:56	98-82-8	
p-Isopropyltoluene	<1.0	ug/L	5.0	1.0	1		01/02/24 15:56	99-87-6	
Methylene Chloride	<0.32	ug/L	5.0	0.32	1		01/02/24 15:56	75-09-2	
Methyl-tert-butyl ether	<1.1	ug/L	5.0	1.1	1		01/02/24 15:56	1634-04-4	
Naphthalene	<1.9	ug/L	5.0	1.9	1		01/02/24 15:56	91-20-3	
n-Propylbenzene	<0.35	ug/L	1.0	0.35	1		01/02/24 15:56	103-65-1	
Styrene	<0.36	ug/L	1.0	0.36	1		01/02/24 15:56	100-42-5	
1,1,1,2-Tetrachloroethane	<0.36	ug/L	1.0	0.36	1		01/02/24 15:56	630-20-6	
1,1,2,2-Tetrachloroethane	<0.38	ug/L	1.0	0.38	1		01/02/24 15:56	79-34-5	
Tetrachloroethene	100	ug/L	1.0	0.41	1		01/02/24 15:56	127-18-4	
Toluene	<0.29	ug/L	1.0	0.29	1		01/02/24 15:56	108-88-3	
1,2,3-Trichlorobenzene	<1.0	ug/L	5.0	1.0	1		01/02/24 15:56	87-61-6	
1,2,4-Trichlorobenzene	<0.95	ug/L	5.0	0.95	1		01/02/24 15:56	120-82-1	
1,1,1-Trichloroethane	<0.30	ug/L	1.0	0.30	1		01/02/24 15:56	71-55-6	
1,1,2-Trichloroethane	<0.34	ug/L	1.0	0.34	1		01/02/24 15:56	79-00-5	
Trichloroethene	16.7	ug/L	1.0	0.32	1		01/02/24 15:56	79-01-6	
Trichlorofluoromethane	<0.42	ug/L	1.0	0.42	1		01/02/24 15:56	75-69-4	
1,2,3-Trichloropropane	<0.56	ug/L	1.0	0.56	1		01/02/24 15:56	96-18-4	
1,2,4-Trimethylbenzene	<0.45	ug/L	1.0	0.45	1		01/02/24 15:56	95-63-6	
1,3,5-Trimethylbenzene	<0.36	ug/L	1.0	0.36	1		01/02/24 15:56	108-67-8	
Vinyl chloride	<0.17	ug/L	1.0	0.17	1		01/02/24 15:56	75-01-4	
m&p-Xylene	<0.70	ug/L	2.0	0.70	1		01/02/24 15:56	179601-23-1	
o-Xylene	<0.35	ug/L	1.0	0.35	1		01/02/24 15:56	95-47-6	
Surrogates									
4-Bromofluorobenzene (S)	92	%	70-130		1		01/02/24 15:56	460-00-4	
1,2-Dichlorobenzene-d4 (S)	103	%	70-130		1		01/02/24 15:56	2199-69-1	
Toluene-d8 (S)	98	%	70-130		1		01/02/24 15:56	2037-26-5	

Sample: J-3D Lab ID: 40272591012 Collected: 12/22/23 10:15 Received: 12/27/23 07:55 Matrix: Water

Parameters	Results	Units	LOQ	LOD	DF	Prepared	Analyzed	CAS No.	Qual
8260 MSV									
Analytical Method: EPA 8260									
Pace Analytical Services - Green Bay									
Benzene	<0.30	ug/L	1.0	0.30	1		01/02/24 16:15	71-43-2	
Bromobenzene	<0.36	ug/L	1.0	0.36	1		01/02/24 16:15	108-86-1	
Bromochloromethane	<0.36	ug/L	1.0	0.36	1		01/02/24 16:15	74-97-5	

REPORT OF LABORATORY ANALYSIS

This report shall not be reproduced, except in full,
without the written consent of Pace Analytical Services, LLC.



ANALYTICAL RESULTS

Project: 11078 JUDGE'S CLEANERS

Pace Project No.: 40272591

Sample: J-3D Lab ID: 40272591012 Collected: 12/22/23 10:15 Received: 12/27/23 07:55 Matrix: Water

Parameters	Results	Units	LOQ	LOD	DF	Prepared	Analyzed	CAS No.	Qual
8260 MSV									
Analytical Method: EPA 8260									
Pace Analytical Services - Green Bay									
Bromodichloromethane	<0.42	ug/L	1.0	0.42	1		01/02/24 16:15	75-27-4	
Bromoform	<0.43	ug/L	1.0	0.43	1		01/02/24 16:15	75-25-2	
Bromomethane	<1.2	ug/L	5.0	1.2	1		01/02/24 16:15	74-83-9	
n-Butylbenzene	<0.86	ug/L	1.0	0.86	1		01/02/24 16:15	104-51-8	
sec-Butylbenzene	<0.42	ug/L	1.0	0.42	1		01/02/24 16:15	135-98-8	
tert-Butylbenzene	<0.59	ug/L	1.0	0.59	1		01/02/24 16:15	98-06-6	
Carbon tetrachloride	<0.37	ug/L	1.0	0.37	1		01/02/24 16:15	56-23-5	
Chlorobenzene	<0.86	ug/L	1.0	0.86	1		01/02/24 16:15	108-90-7	
Chloroethane	<1.4	ug/L	5.0	1.4	1		01/02/24 16:15	75-00-3	
Chloroform	<0.50	ug/L	5.0	0.50	1		01/02/24 16:15	67-66-3	
Chloromethane	<1.6	ug/L	5.0	1.6	1		01/02/24 16:15	74-87-3	
2-Chlorotoluene	<0.89	ug/L	5.0	0.89	1		01/02/24 16:15	95-49-8	
4-Chlorotoluene	<0.89	ug/L	5.0	0.89	1		01/02/24 16:15	106-43-4	
1,2-Dibromo-3-chloropropane	<2.4	ug/L	5.0	2.4	1		01/02/24 16:15	96-12-8	
Dibromochloromethane	<2.6	ug/L	5.0	2.6	1		01/02/24 16:15	124-48-1	
1,2-Dibromoethane (EDB)	<0.31	ug/L	1.0	0.31	1		01/02/24 16:15	106-93-4	
Dibromomethane	<0.99	ug/L	5.0	0.99	1		01/02/24 16:15	74-95-3	
1,2-Dichlorobenzene	<0.33	ug/L	1.0	0.33	1		01/02/24 16:15	95-50-1	
1,3-Dichlorobenzene	<0.35	ug/L	1.0	0.35	1		01/02/24 16:15	541-73-1	
1,4-Dichlorobenzene	<0.89	ug/L	1.0	0.89	1		01/02/24 16:15	106-46-7	
Dichlorodifluoromethane	<0.46	ug/L	5.0	0.46	1		01/02/24 16:15	75-71-8	
1,1-Dichloroethane	<0.30	ug/L	1.0	0.30	1		01/02/24 16:15	75-34-3	
1,2-Dichloroethane	<0.29	ug/L	1.0	0.29	1		01/02/24 16:15	107-06-2	
1,1-Dichloroethene	<0.58	ug/L	1.0	0.58	1		01/02/24 16:15	75-35-4	
cis-1,2-Dichloroethene	1.7	ug/L	1.0	0.47	1		01/02/24 16:15	156-59-2	
trans-1,2-Dichloroethene	<0.53	ug/L	1.0	0.53	1		01/02/24 16:15	156-60-5	
1,2-Dichloropropane	<0.45	ug/L	1.0	0.45	1		01/02/24 16:15	78-87-5	
1,3-Dichloropropane	<0.30	ug/L	1.0	0.30	1		01/02/24 16:15	142-28-9	
2,2-Dichloropropane	<0.42	ug/L	1.0	0.42	1		01/02/24 16:15	594-20-7	
1,1-Dichloropropene	<0.41	ug/L	1.0	0.41	1		01/02/24 16:15	563-58-6	
cis-1,3-Dichloropropene	<0.24	ug/L	1.0	0.24	1		01/02/24 16:15	10061-01-5	
trans-1,3-Dichloropropene	<0.27	ug/L	1.0	0.27	1		01/02/24 16:15	10061-02-6	
Diisopropyl ether	<1.1	ug/L	5.0	1.1	1		01/02/24 16:15	108-20-3	
Ethylbenzene	<0.33	ug/L	1.0	0.33	1		01/02/24 16:15	100-41-4	
Hexachloro-1,3-butadiene	<2.7	ug/L	5.0	2.7	1		01/02/24 16:15	87-68-3	
Isopropylbenzene (Cumene)	<1.0	ug/L	5.0	1.0	1		01/02/24 16:15	98-82-8	
p-Isopropyltoluene	<1.0	ug/L	5.0	1.0	1		01/02/24 16:15	99-87-6	
Methylene Chloride	<0.32	ug/L	5.0	0.32	1		01/02/24 16:15	75-09-2	
Methyl-tert-butyl ether	<1.1	ug/L	5.0	1.1	1		01/02/24 16:15	1634-04-4	
Naphthalene	<1.9	ug/L	5.0	1.9	1		01/02/24 16:15	91-20-3	
n-Propylbenzene	<0.35	ug/L	1.0	0.35	1		01/02/24 16:15	103-65-1	
Styrene	<0.36	ug/L	1.0	0.36	1		01/02/24 16:15	100-42-5	
1,1,1,2-Tetrachloroethane	<0.36	ug/L	1.0	0.36	1		01/02/24 16:15	630-20-6	
1,1,2,2-Tetrachloroethane	<0.38	ug/L	1.0	0.38	1		01/02/24 16:15	79-34-5	
Tetrachloroethene	1870	ug/L	40.0	16.3	40		01/03/24 11:19	127-18-4	

REPORT OF LABORATORY ANALYSIS

This report shall not be reproduced, except in full,
without the written consent of Pace Analytical Services, LLC.



ANALYTICAL RESULTS

Project: 11078 JUDGE'S CLEANERS

Pace Project No.: 40272591

Sample: J-3D Lab ID: 40272591012 Collected: 12/22/23 10:15 Received: 12/27/23 07:55 Matrix: Water

Parameters	Results	Units	LOQ	LOD	DF	Prepared	Analyzed	CAS No.	Qual
8260 MSV									
Analytical Method: EPA 8260									
Pace Analytical Services - Green Bay									
Toluene	<0.29	ug/L	1.0	0.29	1		01/02/24 16:15	108-88-3	
1,2,3-Trichlorobenzene	<1.0	ug/L	5.0	1.0	1		01/02/24 16:15	87-61-6	
1,2,4-Trichlorobenzene	<0.95	ug/L	5.0	0.95	1		01/02/24 16:15	120-82-1	
1,1,1-Trichloroethane	<0.30	ug/L	1.0	0.30	1		01/02/24 16:15	71-55-6	
1,1,2-Trichloroethane	<0.34	ug/L	1.0	0.34	1		01/02/24 16:15	79-00-5	
Trichloroethene	4.7	ug/L	1.0	0.32	1		01/02/24 16:15	79-01-6	
Trichlorofluoromethane	<0.42	ug/L	1.0	0.42	1		01/02/24 16:15	75-69-4	
1,2,3-Trichloropropane	<0.56	ug/L	1.0	0.56	1		01/02/24 16:15	96-18-4	
1,2,4-Trimethylbenzene	<0.45	ug/L	1.0	0.45	1		01/02/24 16:15	95-63-6	
1,3,5-Trimethylbenzene	<0.36	ug/L	1.0	0.36	1		01/02/24 16:15	108-67-8	
Vinyl chloride	<0.17	ug/L	1.0	0.17	1		01/02/24 16:15	75-01-4	
m&p-Xylene	<0.70	ug/L	2.0	0.70	1		01/02/24 16:15	179601-23-1	
o-Xylene	<0.35	ug/L	1.0	0.35	1		01/02/24 16:15	95-47-6	
Surrogates									
4-Bromofluorobenzene (S)	88	%	70-130		1		01/02/24 16:15	460-00-4	
1,2-Dichlorobenzene-d4 (S)	100	%	70-130		1		01/02/24 16:15	2199-69-1	
Toluene-d8 (S)	96	%	70-130		1		01/02/24 16:15	2037-26-5	

REPORT OF LABORATORY ANALYSIS

This report shall not be reproduced, except in full,
without the written consent of Pace Analytical Services, LLC.



QUALITY CONTROL DATA

Project: 11078 JUDGE'S CLEANERS

Pace Project No.: 40272591

QC Batch: 463943

Analysis Method: EPA 8260

QC Batch Method: EPA 8260

Analysis Description: 8260 MSV

Laboratory: Pace Analytical Services - Green Bay

Associated Lab Samples: 40272591001, 40272591002, 40272591003, 40272591004, 40272591005, 40272591006, 40272591007, 40272591008, 40272591009, 40272591010, 40272591011, 40272591012

METHOD BLANK: 2661240

Matrix: Water

Associated Lab Samples: 40272591001, 40272591002, 40272591003, 40272591004, 40272591005, 40272591006, 40272591007, 40272591008, 40272591009, 40272591010, 40272591011, 40272591012

Table with 6 columns: Parameter, Units, Blank Result, Reporting Limit, Analyzed, Qualifiers. Lists various chemical compounds and their detection results.

Results presented on this page are in the units indicated by the "Units" column except where an alternate unit is presented to the right of the result.

REPORT OF LABORATORY ANALYSIS

This report shall not be reproduced, except in full, without the written consent of Pace Analytical Services, LLC.



QUALITY CONTROL DATA

Project: 11078 JUDGE'S CLEANERS

Pace Project No.: 40272591

METHOD BLANK: 2661240

Matrix: Water

Associated Lab Samples: 40272591001, 40272591002, 40272591003, 40272591004, 40272591005, 40272591006, 40272591007, 40272591008, 40272591009, 40272591010, 40272591011, 40272591012

Parameter	Units	Blank Result	Reporting Limit	Analyzed	Qualifiers
Diisopropyl ether	ug/L	<1.1	5.0	01/02/24 10:24	
Ethylbenzene	ug/L	<0.33	1.0	01/02/24 10:24	
Hexachloro-1,3-butadiene	ug/L	<2.7	5.0	01/02/24 10:24	
Isopropylbenzene (Cumene)	ug/L	<1.0	5.0	01/02/24 10:24	
m&p-Xylene	ug/L	<0.70	2.0	01/02/24 10:24	
Methyl-tert-butyl ether	ug/L	<1.1	5.0	01/02/24 10:24	
Methylene Chloride	ug/L	<0.32	5.0	01/02/24 10:24	
n-Butylbenzene	ug/L	<0.86	1.0	01/02/24 10:24	
n-Propylbenzene	ug/L	<0.35	1.0	01/02/24 10:24	
Naphthalene	ug/L	<1.9	5.0	01/02/24 10:24	
o-Xylene	ug/L	<0.35	1.0	01/02/24 10:24	
p-Isopropyltoluene	ug/L	<1.0	5.0	01/02/24 10:24	
sec-Butylbenzene	ug/L	<0.42	1.0	01/02/24 10:24	
Styrene	ug/L	<0.36	1.0	01/02/24 10:24	
tert-Butylbenzene	ug/L	<0.59	1.0	01/02/24 10:24	
Tetrachloroethene	ug/L	<0.41	1.0	01/02/24 10:24	
Toluene	ug/L	<0.29	1.0	01/02/24 10:24	
trans-1,2-Dichloroethene	ug/L	<0.53	1.0	01/02/24 10:24	
trans-1,3-Dichloropropene	ug/L	<0.27	1.0	01/02/24 10:24	
Trichloroethene	ug/L	<0.32	1.0	01/02/24 10:24	
Trichlorofluoromethane	ug/L	<0.42	1.0	01/02/24 10:24	
Vinyl chloride	ug/L	<0.17	1.0	01/02/24 10:24	
1,2-Dichlorobenzene-d4 (S)	%	105	70-130	01/02/24 10:24	
4-Bromofluorobenzene (S)	%	96	70-130	01/02/24 10:24	
Toluene-d8 (S)	%	99	70-130	01/02/24 10:24	

LABORATORY CONTROL SAMPLE: 2661241

Parameter	Units	Spike Conc.	LCS Result	LCS % Rec	% Rec Limits	Qualifiers
1,1,1-Trichloroethane	ug/L	50	55.7	111	70-132	
1,1,2,2-Tetrachloroethane	ug/L	50	44.9	90	70-130	
1,1,2-Trichloroethane	ug/L	50	50.4	101	70-130	
1,1-Dichloroethane	ug/L	50	52.1	104	70-130	
1,1-Dichloroethene	ug/L	50	54.0	108	73-140	
1,2,4-Trichlorobenzene	ug/L	50	50.2	100	70-130	
1,2-Dibromo-3-chloropropane	ug/L	50	42.0	84	58-130	
1,2-Dibromoethane (EDB)	ug/L	50	52.3	105	70-130	
1,2-Dichlorobenzene	ug/L	50	49.6	99	70-130	
1,2-Dichloroethane	ug/L	50	48.8	98	70-130	
1,2-Dichloropropane	ug/L	50	52.1	104	77-127	
1,3-Dichlorobenzene	ug/L	50	54.6	109	70-130	
1,4-Dichlorobenzene	ug/L	50	51.6	103	70-130	
Benzene	ug/L	50	53.2	106	70-130	

Results presented on this page are in the units indicated by the "Units" column except where an alternate unit is presented to the right of the result.

REPORT OF LABORATORY ANALYSIS

This report shall not be reproduced, except in full,
without the written consent of Pace Analytical Services, LLC.



QUALITY CONTROL DATA

Project: 11078 JUDGE'S CLEANERS

Pace Project No.: 40272591

LABORATORY CONTROL SAMPLE: 2661241

Parameter	Units	Spike Conc.	LCS Result	LCS % Rec	% Rec Limits	Qualifiers
Bromodichloromethane	ug/L	50	56.3	113	70-130	
Bromoform	ug/L	50	54.5	109	70-130	
Bromomethane	ug/L	50	34.9	70	22-141	
Carbon tetrachloride	ug/L	50	57.7	115	70-135	
Chlorobenzene	ug/L	50	53.8	108	70-130	
Chloroethane	ug/L	50	45.1	90	59-141	
Chloroform	ug/L	50	54.7	109	80-124	
Chloromethane	ug/L	50	38.6	77	29-150	
cis-1,2-Dichloroethene	ug/L	50	55.7	111	70-130	
cis-1,3-Dichloropropene	ug/L	50	53.2	106	70-130	
Dibromochloromethane	ug/L	50	55.3	111	70-130	
Dichlorodifluoromethane	ug/L	50	48.1	96	10-147	
Ethylbenzene	ug/L	50	53.9	108	80-125	
Isopropylbenzene (Cumene)	ug/L	50	55.0	110	70-130	
m&p-Xylene	ug/L	100	107	107	70-130	
Methyl-tert-butyl ether	ug/L	50	52.1	104	64-131	
Methylene Chloride	ug/L	50	55.0	110	70-137	
o-Xylene	ug/L	50	55.0	110	70-130	
Styrene	ug/L	50	55.4	111	70-130	
Tetrachloroethene	ug/L	50	57.7	115	70-130	
Toluene	ug/L	50	51.7	103	80-120	
trans-1,2-Dichloroethene	ug/L	50	52.8	106	70-131	
trans-1,3-Dichloropropene	ug/L	50	50.6	101	70-130	
Trichloroethene	ug/L	50	54.3	109	70-130	
Trichlorofluoromethane	ug/L	50	53.8	108	69-141	
Vinyl chloride	ug/L	50	45.9	92	51-145	
1,2-Dichlorobenzene-d4 (S)	%			98	70-130	
4-Bromofluorobenzene (S)	%			90	70-130	
Toluene-d8 (S)	%			98	70-130	

MATRIX SPIKE & MATRIX SPIKE DUPLICATE: 2661751 2661752

Parameter	Units	MS		MSD		MS % Rec	MSD % Rec	% Rec Limits	RPD	Max RPD	Qual	
		40272675001 Result	Spike Conc.	Spike Conc.	MS Result							MSD Result
1,1,1-Trichloroethane	ug/L	<0.30	50	50	57.4	53.7	115	107	70-132	7	20	
1,1,2,2-Tetrachloroethane	ug/L	<0.38	50	50	47.5	48.0	95	96	70-131	1	20	
1,1,2-Trichloroethane	ug/L	<0.34	50	50	51.4	51.8	103	104	70-130	1	20	
1,1-Dichloroethane	ug/L	<0.30	50	50	55.3	51.7	111	103	70-131	7	20	
1,1-Dichloroethene	ug/L	<0.58	50	50	56.3	53.3	113	107	69-146	5	20	
1,2,4-Trichlorobenzene	ug/L	<0.95	50	50	51.4	51.2	103	102	70-130	0	20	
1,2-Dibromo-3-chloropropane	ug/L	<2.4	50	50	46.7	47.0	93	94	56-130	1	20	
1,2-Dibromoethane (EDB)	ug/L	<0.31	50	50	55.7	53.5	111	107	70-130	4	20	
1,2-Dichlorobenzene	ug/L	<0.33	50	50	51.0	50.8	102	102	70-130	0	20	
1,2-Dichloroethane	ug/L	<0.29	50	50	50.8	49.2	102	98	70-130	3	20	

Results presented on this page are in the units indicated by the "Units" column except where an alternate unit is presented to the right of the result.

REPORT OF LABORATORY ANALYSIS

This report shall not be reproduced, except in full, without the written consent of Pace Analytical Services, LLC.



QUALITY CONTROL DATA

Project: 11078 JUDGE'S CLEANERS

Pace Project No.: 40272591

Parameter	Units	MATRIX SPIKE & MATRIX SPIKE DUPLICATE: 2661751		2661752		MS Result	MSD Result	MS % Rec	MSD % Rec	% Rec Limits	Max RPD	RPD	Qual
		40272675001 Result	MS Spike Conc.	MSD Spike Conc.									
1,2-Dichloropropane	ug/L	<0.45	50	50	54.8	52.9	110	106	77-129	4	20		
1,3-Dichlorobenzene	ug/L	<0.35	50	50	53.7	54.1	107	108	70-130	1	20		
1,4-Dichlorobenzene	ug/L	<0.89	50	50	51.2	50.7	102	101	70-130	1	20		
Benzene	ug/L	<0.30	50	50	55.1	52.2	110	104	70-130	5	20		
Bromodichloromethane	ug/L	<0.42	50	50	58.7	55.7	117	111	70-130	5	20		
Bromoform	ug/L	<0.43	50	50	57.6	57.0	115	114	70-130	1	20		
Bromomethane	ug/L	<1.2	50	50	37.0	35.7	74	71	12-159	4	26		
Carbon tetrachloride	ug/L	<0.37	50	50	59.1	55.9	118	112	70-135	6	20		
Chlorobenzene	ug/L	<0.86	50	50	54.8	52.9	110	106	70-130	4	20		
Chloroethane	ug/L	<1.4	50	50	55.0	54.7	110	109	56-143	0	20		
Chloroform	ug/L	<0.50	50	50	56.7	54.4	113	109	80-126	4	20		
Chloromethane	ug/L	<1.6	50	50	40.9	38.8	82	78	22-156	5	20		
cis-1,2-Dichloroethene	ug/L	47.4	50	50	104	102	114	108	70-130	3	20		
cis-1,3-Dichloropropene	ug/L	<0.24	50	50	56.8	53.2	114	106	70-130	7	20		
Dibromochloromethane	ug/L	<2.6	50	50	55.5	55.2	111	110	70-130	1	20		
Dichlorodifluoromethane	ug/L	<0.46	50	50	47.0	44.9	94	90	10-147	5	20		
Ethylbenzene	ug/L	<0.33	50	50	54.6	52.2	109	104	80-126	4	20		
Isopropylbenzene (Cumene)	ug/L	<1.0	50	50	54.0	52.8	108	106	70-130	2	20		
m&p-Xylene	ug/L	<0.70	100	100	108	105	108	105	70-130	3	20		
Methyl-tert-butyl ether	ug/L	<1.1	50	50	55.8	54.0	112	108	64-136	3	20		
Methylene Chloride	ug/L	<0.32	50	50	56.8	54.4	114	109	70-137	4	20		
o-Xylene	ug/L	<0.35	50	50	56.6	54.4	113	109	70-130	4	20		
Styrene	ug/L	<0.36	50	50	55.9	54.0	112	108	70-133	3	20		
Tetrachloroethene	ug/L	1.3	50	50	59.1	57.8	115	113	70-131	2	20		
Toluene	ug/L	<0.29	50	50	53.0	51.1	106	102	80-121	4	20		
trans-1,2-Dichloroethene	ug/L	2.1	50	50	57.1	54.5	110	105	70-135	5	20		
trans-1,3-Dichloropropene	ug/L	<0.27	50	50	51.3	51.4	103	103	70-130	0	20		
Trichloroethene	ug/L	0.73J	50	50	57.0	53.7	113	106	70-130	6	20		
Trichlorofluoromethane	ug/L	<0.42	50	50	55.0	51.6	110	103	67-142	6	20		
Vinyl chloride	ug/L	61.5	50	50	102	98.2	82	73	45-147	4	20		
1,2-Dichlorobenzene-d4 (S)	%						100	102	70-130				
4-Bromofluorobenzene (S)	%						90	93	70-130				
Toluene-d8 (S)	%						96	97	70-130				

Results presented on this page are in the units indicated by the "Units" column except where an alternate unit is presented to the right of the result.

REPORT OF LABORATORY ANALYSIS

This report shall not be reproduced, except in full,
without the written consent of Pace Analytical Services, LLC.



QUALIFIERS

Project: 11078 JUDGE'S CLEANERS

Pace Project No.: 40272591

DEFINITIONS

DF - Dilution Factor, if reported, represents the factor applied to the reported data due to dilution of the sample aliquot.

ND - Not Detected at or above LOD.

J - The reported result is an estimated value.

LOD - Limit of Detection adjusted for dilution factor, percent moisture, initial weight and final volume.

LOQ - Limit of Quantitation adjusted for dilution factor, percent moisture, initial weight and final volume.

DL - Adjusted Method Detection Limit.

S - Surrogate

1,2-Diphenylhydrazine decomposes to and cannot be separated from Azobenzene using Method 8270. The result for each analyte is a combined concentration.

Consistent with EPA guidelines, unrounded data are displayed and have been used to calculate % recovery and RPD values.

LCS(D) - Laboratory Control Sample (Duplicate)

MS(D) - Matrix Spike (Duplicate)

DUP - Sample Duplicate

RPD - Relative Percent Difference

NC - Not Calculable.

SG - Silica Gel - Clean-Up

U - Analyte was not detected and is reported as less than the LOD or as defined by the customer.

N-Nitrosodiphenylamine decomposes and cannot be separated from Diphenylamine using Method 8270. The result reported for each analyte is a combined concentration.

Pace Analytical is TNI accredited. Contact your Pace PM for the current list of accredited analytes.

TNI - The NELAC Institute.

REPORT OF LABORATORY ANALYSIS

This report shall not be reproduced, except in full,
without the written consent of Pace Analytical Services, LLC.



QUALITY CONTROL DATA CROSS REFERENCE TABLE

Project: 11078 JUDGE'S CLEANERS

Pace Project No.: 40272591

Lab ID	Sample ID	QC Batch Method	QC Batch	Analytical Method	Analytical Batch
40272591001	UWSP-5	EPA 8260	463943		
40272591002	UWSP-5D	EPA 8260	463943		
40272591003	UWSP-4	EPA 8260	463943		
40272591004	UWSP-4D	EPA 8260	463943		
40272591005	UWSP-3	EPA 8260	463943		
40272591006	UWSP-3D	EPA 8260	463943		
40272591007	UWSP-1	EPA 8260	463943		
40272591008	UWSP-1D	EPA 8260	463943		
40272591009	UWSP-2	EPA 8260	463943		
40272591010	J-1	EPA 8260	463943		
40272591011	J-3	EPA 8260	463943		
40272591012	J-3D	EPA 8260	463943		

REPORT OF LABORATORY ANALYSIS

This report shall not be reproduced, except in full, without the written consent of Pace Analytical Services, LLC.



CHAIN-OF-CUSTODY Analytical Request Document

Chain-of-Custody is a LEGAL DOCUMENT - Complete all relevant fields

LAB USE ONLY- Affix Workorder/Login Label Here or List Pace Workorder Number or MTJL Log-in Number Here

40272591

ALL SHADED AREAS are for LAB USE ONLY

Company: **REI**

Billing Information: **dansen@reihberg.com**

Address: **4080 N. 20th Ave**

Email To: **-**

Report To: **Don Lauer**

Site Collection Info/Address:

Copy To:

Customer Project Name/Number: **11078 / Sudge's Cleaners**

State: **WI** County/City: **Stevens Pt.** Time Zone Collected: **[] PT [] MT [] ET**

Phone: **715-675-9787**

Compliance Monitoring? Yes No

Collected By (print): **Kayla Kik**

Purchase Order #: **-**

Collected By (signature): **[Signature]**

Turnaround Date Required:

Sample Disposal: Dispose as appropriate Return Archive: Hold:

Rush: Same Day Next Day 2 Day 3 Day 4 Day 5 Day (Expedite Charges Apply)

* Matrix Codes (Insert in Matrix box below): Drinking Water (DW), Ground Water (GW), Wastewater (WW), Product (P), Soil/Solid (SL), Oil (OL), Wipe (WP), Air (AR), Tissue (TS), Bioassay (B), Vapor (V), Other (OT)

Customer Sample ID

Matrix *

Comp / Grab

Collected (or Composite Start)

Composite End

Res Cl

of Ctns

Date

Time

Date

Time

Time

Time

Time

Time

Time

Time

Time

Time

Time

Time

Time

Time

Time

Time

Time

Time

Time

Time

Time

Time

Time

Time

Time

Time

Time

Time

Time

Time

Time

Time

Time

Time

Time

Time

Time

Time

Time

Time

Time

Time

Time

Time

Time

Time

Time

Time

Time

Time

Time

Time

Time

Time

Time

Time

Time

Time

Time

Time

Time

Time

Container Preservative Type **

Lab Project Manager:

** Preservative Types: (1) nitric acid, (2) sulfuric acid, (3) hydrochloric acid, (4) sodium hydroxide, (5) zinc acetate, (6) methanol, (7) sodium bisulfate, (8) sodium thiosulfate, (9) hexane, (A) ascorbic acid, (B) ammonium sulfate, (C) ammonium hydroxide, (D) TSP, (U) Unpreserved, (O) Other

Analyses

Lab Profile/Line:

Lab Sample Receipt Checklist:

Custody Seals Present/Intact Y N NA

Custody Signatures Present Y N NA

Collector Signature Present Y N NA

Bottles Intact Y N NA

Correct Bottles Y N NA

Sufficient Volume Y N NA

Samples Received on Ice Y N NA

VOA - Headspace Acceptable Y N NA

USDA Regulated Soils Y N NA

Samples in Holding Time Y N NA

Residual Chlorine Present Y N NA

Cl Strips: _____

Sample pH Acceptable Y N NA

pH Strips: _____

Sulfide Present Y N NA

Lead Acetate Strips: _____

Matrix *	Comp / Grab	Collected (or Composite Start)	Composite End	Res Cl	# of Ctns
Date	Time	Date	Time		
GW	Grab	12/22	3:00		3
			3:30		
			2:15		
			2:45		
			1:30		
			1:45		
			1:00		
			12:45		
			12:00		
			11:00		

LAB USE ONLY:

Lab Sample # / Comments:

051

052

053

054

055

056

057

058

059

010

Customer Remarks / Special Conditions / Possible Hazards:

Type of Ice Used: Wet Blue Dry None

SHORT HOLDS PRESENT (<72 hours): Y N N/A

Lab Sample Temperature Info:

Packing Material Used:

Radchem sample(s) screened (<500 cpm): Y N NA

Lab Tracking #: 2730776

Temp Blank Received: Y N NA

Relinquished by/Company: (Signature)

Date/Time: 12/26/23 1400

Samples received via: FEDEX UPS Client Courier Pace Courier

Therm ID#: _____

Relinquished by/Company: (Signature)

Date/Time: 1/27/25 0755

MTJL LAB USE ONLY

Cooler 1 Temp Upon Receipt: _____ °C

Relinquished by/Company: (Signature)

Date/Time:

Table #:

Cooler 1 Therm Corr. Factor: _____ °C

Date/Time:

Received by/Company: (Signature)

Acctnum:

Cooler 1 Corrected Temp: _____ °C

Date/Time:

Date/Time:

Template:

Comments:

Date/Time:

Date/Time:

Prelogin:

Trip Blank Received: Y N NA

Date/Time:

Date/Time:

PM:

HCL MeOH TSP Other

Date/Time:

Date/Time:

PB:

Non Conformance(s): Page 31 of 34

Date/Time:

Date/Time:

Date/Time:

YES / NO of: 2

Date/Time:

Date/Time:

Date/Time:

Date/Time:

Sample Condition Upon Receipt Form (SCUR)

Project #:

Client Name: REI

WO# : 40272591



40272591

Courier: CS Logistics Fed Ex Speedee UPS ~~Waltco~~
 Client Pace Other: _____

Tracking #: 3780259

Custody Seal on Cooler/Box Present: yes no Seals intact: yes no
 Custody Seal on Samples Present: yes no Seals intact: yes no

Packing Material: Bubble Wrap Bubble Bags None Other

Thermometer Used SR - 120 Type of Ice: Wet Blue Dry None Meltwater Only

Cooler Temperature Uncorr. 1.0 /Corr. 1.0

Temp Blank Present: yes no Biological Tissue is Frozen: yes no

Person examining contents:
 Date: 12/27/23 /Initials: mtl
 Labeled By Initials: SG

Temp should be above freezing to 6°C.
 Biota Samples may be received at ≤ 0°C if shipped on Dry Ice.

Chain of Custody Present:	<input checked="" type="checkbox"/> Yes <input type="checkbox"/> No <input type="checkbox"/> N/A	1.
Chain of Custody Filled Out:	<input checked="" type="checkbox"/> Yes <input type="checkbox"/> No <input type="checkbox"/> N/A	2.
Chain of Custody Relinquished:	<input checked="" type="checkbox"/> Yes <input type="checkbox"/> No <input type="checkbox"/> N/A	3.
Sampler Name & Signature on COC:	<input checked="" type="checkbox"/> Yes <input type="checkbox"/> No <input type="checkbox"/> N/A	4.
Samples Arrived within Hold Time:	<input checked="" type="checkbox"/> Yes <input type="checkbox"/> No	5.
- DI VOA Samples frozen upon receipt	<input type="checkbox"/> Yes <input type="checkbox"/> No	Date/Time:
Short Hold Time Analysis (<72hr):	<input type="checkbox"/> Yes <input checked="" type="checkbox"/> No	6.
Rush Turn Around Time Requested:	<input type="checkbox"/> Yes <input checked="" type="checkbox"/> No	7.
Sufficient Volume.		8.
For Analysis: <input checked="" type="checkbox"/> Yes <input type="checkbox"/> No MS/MSD: <input type="checkbox"/> Yes <input checked="" type="checkbox"/> No <input type="checkbox"/> N/A		
Correct Containers Used:	<input checked="" type="checkbox"/> Yes <input type="checkbox"/> No	9.
Correct Type: <u>Pace Green Bay</u> , Pace IR, Non-Pace		
Containers Intact:	<input checked="" type="checkbox"/> Yes <input type="checkbox"/> No	10.
Filtered volume received for Dissolved tests	<input type="checkbox"/> Yes <input type="checkbox"/> No <input checked="" type="checkbox"/> N/A	11.
Sample Labels match COC:	<input checked="" type="checkbox"/> Yes <input type="checkbox"/> No <input type="checkbox"/> N/A	12.
-Includes date/time/ID/Analysis Matrix: <u>W</u>		
Trip Blank Present:	<input type="checkbox"/> Yes <input type="checkbox"/> No <input checked="" type="checkbox"/> N/A	13.
Trip Blank Custody Seals Present	<input type="checkbox"/> Yes <input type="checkbox"/> No <input checked="" type="checkbox"/> N/A	
Pace Trip Blank Lot # (if purchased):		

Client Notification/ Resolution: _____ If checked, see attached form for additional comments

Person Contacted: _____ Date/Time: _____

Comments/ Resolution: _____

PM Review is documented electronically in LIMs. By releasing the project, the PM acknowledges they have reviewed the sample log in