

Meridian Alliance Group, LLC

Rec 8/30/07
Put on BRRTS
8/30/07
(212)

August 28, 2007

Phil Richards
875 South 4th Avenue
Park Falls, WI 54552-1130

Subject: City of Webster Ground Water Sampling; 2005, 2006, 2007
Webster, Wisconsin
BRRTS 02-07-000337
Meridian No. 05C639

Dear Phil:

This letter summarizes the results of the sampling at the City of Webster.

- Ground water elevations were measured in the monitoring wells. The measurements are provided in Table 1.
- Figures 1, 2, and 3 are ground water table contour maps for each sampling event. Flow remains in a westerly direction.
- Monitoring well 91-4 was abandoned August 17, 2005. The abandonment form is provided in Appendix A.
- Ground water samples were collected from the existing monitoring well network on June 22, 2005, June 21, 2006, and June 12, 2007. The laboratory reports were provided in previous correspondence and are also included in Appendix B. Table 2 summarizes the analytical data. Figure 4 provides the estimated distribution of tetrachloroethene in the ground water based on the monitoring well data.
- Purge water from wells with reported VOC impacts were containerized and disposed (Appendix C).

Please contact us with any comments or questions.

Sincerely,
MERIDIAN ALLIANCE GROUP

Kenneth Shimko
Project Manager

TABLES

Table 1

Water Table Elevations

Village of Webster, Wisconsin

Meridian Alliance # 05C636

(Wells Installed During RREM, Inc. Investigation)													
RREM Well No.	Top of Riser Elevation	Date of Elevation Measurement (measured in feet)						6/22/2005		6/21/2006		6/12/2007	
		7/24/91	8/7/91	8/26/91	9/10/91	10/16/91	10/28/91	DTW	Elevation	DTW	Elevation	DTW	Elevation
91-1	983.22	946.70	947.00	947.20	947.23	947.39	947.40	34.18	949.04	33.66	949.56	35.01	948.21
91-2A	983.69	946.97	947.25	947.37	947.44	947.56	947.56	35.12	948.57	34.6	949.09	35.89	947.80
91-2B	984.28	946.69	947.21	947.37	947.42	947.55	947.56	34.53	949.75	34.02	950.26	35.30	948.98
91-3	982.27	946.77	947.25	947.35	947.43	947.52	947.63						
91-4	980.13	947.18	947.43	947.60	947.66	947.78	947.78	30.65	949.48	abandoned 8/17/05			
91-5A	980.49	947.52	947.63	947.76	947.82	947.93	947.94	30.98	949.51	30.32	950.17	31.53	948.96
91-5B	980.48	947.53	947.62	947.75	947.81	947.93	947.93	30.95	949.53	30.34	950.14	31.58	948.90
91-6	982.01	947.85	947.94	948.04	948.09	948.20	948.24	32.26	949.75	31.83	950.18	33.02	948.99
91-7	980.99		947.89	947.96	948.05	948.08	948.24	31.29	949.70	30.88	950.11	32.08	948.91
91-8	980.50		948.34	948.17	948.30	948.40	948.46						

(Wells Installed During Ayres Associates Investigation)															
Ayres Well No.	Top of Riser Elevation	Date of Elevation Measurement (measured in feet)								6/22/2005		6/21/2006		6/12/2007	
		Resurvey*	6/20/91	7/23/91	8/7/91	8/9/91	8/26/91	9/10/91	10/16/91	DTW	Elevation	DTW	Elevation	DTW	Elevation
OW-1	983.36	983.29	947.00	946.43	946.97		947.21	947.25	947.43	34.14	949.22	33.43	949.86	34.81	948.48
OW-2	983.48	983.46	946.99	946.30	946.97		947.21	947.25	947.40	34.24	949.24	33.62	949.84	34.99	948.47
OW-3	982.65		947.03	946.04	946.98		947.21	947.19	947.42	33.36	949.29	32.83	949.82	34.2	948.45
OW-4	981.80		946.81	945.03	946.72		946.97	946.92	947.19	32.65	949.15	32.12	949.68	33.59	948.21
OW-5	982.46	982.46	945.80	945.44	946.81		947.00	946.94	947.21	33.31	949.15	32.61	949.85	33.86	948.60
OW-6	982.59	982.51	946.87	945.92	946.84		947.05	947.06	947.29	33.42	949.17	32.7	949.81	34.14	948.37
OW-7	981.25		946.95	946.50	946.97		947.16	947.20	947.37						
OW-8	983.11		947.14	946.78	947.18		947.38	947.45	947.57	32.57	950.54	33.32	949.79	34.63	948.48
OW-9	981.00						947.19	947.36	947.41	947.56					

Top of riser elevation figure taken from Ayres and Associates report (1987)

* - OW-1, OW-2, OW-5, OW-6 cut down and resurveyed August 17, 2005

Table 10
Summary of Laboratory Analysis of Groundwater Samples
Round One Sampling (samples collected September 17-19, 1991)
Village of Webster, Wisconsin

Monitoring Well	Compound Concentration (all units $\mu\text{g/l}$)						
	Benzene	1,2-Dichloro- benzene	1,2-Dichloro- ethane	1,2-Dichloro- propane	Tetrachloro- ethylene	Toluene	Trichloro- ethylene
<i>Detection Limit</i> ⁽¹⁾	0.2	1.0	0.5	0.5	0.5	0.5	0.2
91-1	ND ⁽²⁾	ND	ND	ND	ND	ND	ND
91-2A	ND	ND	ND	ND	ND	ND	ND
91-2B	0.5	1.4	ND	0.7	112.0	ND	6.1
91-3	1.6	ND	83.6	ND	ND	ND	ND
91-4	ND	ND	2.9	ND	15.3	ND	0.2
91-5A	ND	ND	ND	ND	8.0	ND	ND
91-5A ⁽³⁾	ND	ND	ND	ND	7.7	ND	ND
91-5B	0.3	ND	0.8	ND	ND	ND	ND
91-6	ND	ND	ND	ND	31.8	ND	0.4
91-7	ND	ND	ND	ND	ND	ND	ND
91-8	ND	ND	ND	ND	ND	0.6	ND
OW-1	ND	ND	ND	ND	13.8	ND	ND
OW-2	ND	ND	4.3	ND	2.3	ND	ND
OW-3	ND	ND	ND	ND	ND	ND	ND
OW-4	ND	ND	ND	ND	ND	ND	ND
OW-5	ND	ND	ND	ND	3.5	ND	ND
OW-6	ND	ND	ND	ND	1.3	ND	ND

Table 10, continued
Summary of Laboratory Analysis of Groundwater Samples
Round One Sampling (samples collected September 17-19, 1991)
Village of Webster, Wisconsin

Monitoring Well	Compound Concentration (all units $\mu\text{g/l}$)						
	Benzene	1,2-Dichloro- benzene	1,2-Dichloro- ethane	1,2-Dichloro- propane	Tetrachloro- ethylene	Toluene	Trichloro- ethylene
<i>Detection Limit⁽¹⁾</i>	<i>0.2</i>	<i>1.0</i>	<i>0.5</i>	<i>0.5</i>	<i>0.5</i>	<i>0.5</i>	<i>0.2</i>
OW-7	ND	ND	ND	ND	1.3	ND	ND
OW-8	ND	ND	ND	ND	13.2	ND	ND
OW-9	ND	ND	ND	ND	ND	ND	ND
OW-9 ⁽³⁾	ND	ND	ND	ND	ND	ND	ND
VW-2	ND	ND	2.8	ND	ND	ND	ND

- (1) Detection limits in accordance with methods discussed on page 31.
(2) ND — Not Detected.
(3) Duplicate sample.

Table 11
Summary of Laboratory Analysis of Groundwater Samples
Round Two Sampling (samples collected October 14-16, 1991)
Village of Webster, Wisconsin

Monitoring Well	Compound Concentration (all units $\mu\text{g/l}$)									
	Benzene	1,2-Dichlorobenzene	1,2-Dichloroethane	1,2-Dichloroethylene	1,2-Dichloropropane	Ethylbenzene	Tetrachloroethylene	Toluene	Trichloroethylene	M and P Xylene
<i>Detection Limit⁽¹⁾</i>	0.2	1.0	0.5	1.0	0.5	1.0	0.5	0.5	0.2	1.0
91-1	0.6	ND	ND	ND	ND	ND	ND	1.0	ND	ND
91-2A	0.5	ND	ND	ND	ND	ND	ND	0.9	ND	ND
91-2B	ND	1.4	ND	2.2	0.6	ND	105.0	ND	7.2	ND
91-3	0.7	ND	90.2	ND	ND	ND	ND	ND	0.3	ND
91-4	0.5	ND	1.5	ND	ND	ND	11.5	0.7	ND	ND
91-5A	0.4	ND	ND	ND	ND	ND	5.1	0.8	ND	ND
91-5B	0.4	ND	0.8	ND	ND	ND	ND	ND	ND	ND
91-6	0.3	ND	ND	ND	ND	ND	32.0	ND	0.7	ND
91-6 ⁽³⁾	0.2	ND	ND	ND	ND	ND	52.5	ND	0.6	ND
91-7	ND	ND	ND	ND	ND	ND	0.6	ND	ND	ND
91-8	0.4	ND	ND	ND	ND	ND	ND	5.6	ND	ND
OW-1	1.1	ND	ND	ND	ND	3.3	9.4	0.5	ND	1.1
OW-2	0.2	ND	2.5	ND	ND	ND	1.2	ND	ND	ND
OW-3	0.2	ND	ND	ND	ND	ND	ND	ND	ND	ND
OW-4	ND	ND	ND	ND	ND	ND	ND	ND	ND	ND
OW-5	ND	ND	ND	ND	ND	ND	2.1	ND	ND	ND

Table 11, continued
Summary of Laboratory Analysis of Groundwater Samples
Round Two Sampling (samples collected October 14-16, 1991)
Village of Webster, Wisconsin

Monitoring Well	Compound Concentration (all units $\mu\text{g/l}$)									
	Benzene	1,2-Dichlorobenzene	1,2-Dichloroethane	1,2-Dichloroethylene	1,2-Dichloropropane	Ethylbenzene	Tetrachloroethylene	Toluene	Trichloroethylene	M and P Xylene
<i>Detection Limit⁽¹⁾</i>	0.2	1.0	0.5	1.0	0.5	1.0	0.5	0.5	0.2	1.0
OW-5 ⁽³⁾	ND	ND	ND	ND	ND	ND	2.1	ND	ND	ND
OW-6	ND	ND	ND	ND	ND	ND	0.9	ND	ND	ND
OW-7	0.3	ND	ND	ND	ND	ND	1.6	0.5	ND	ND
OW-8	0.2	ND	ND	ND	ND	ND	12.9	ND	ND	ND
OW-9	ND	ND	ND	ND	ND	ND	ND	ND	ND	ND
VW-2	ND	ND	2.7	ND	ND	ND	ND	ND	ND	ND
Trip Blank	ND	ND	ND	ND	ND	ND	ND	ND	ND	ND
FB-1	ND	ND	ND	ND	ND	ND	ND	ND	ND	ND
FB-2	ND	ND	ND	ND	ND	ND	ND	ND	ND	ND

⁽¹⁾ Detection limits in accordance with methods discussed on page 31.

⁽²⁾ ND — Not Detected.

⁽³⁾ Duplicate sample.

FIGURES

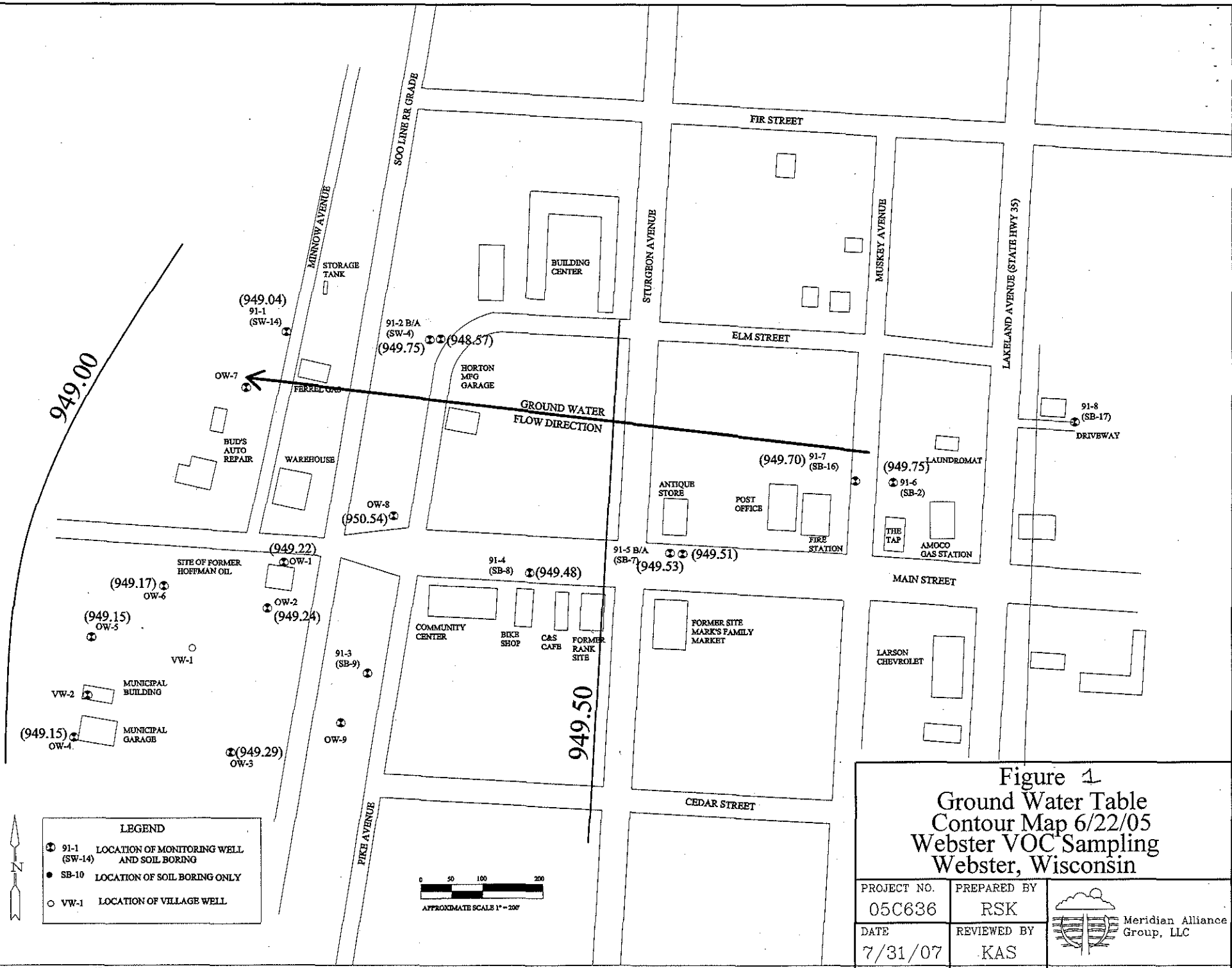

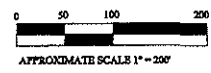

Figure 1
 Ground Water Table
 Contour Map 6/22/05
 Webster VOC Sampling
 Webster, Wisconsin

PROJECT NO. 05C636	PREPARED BY RSK	 Meridian Alliance Group, LLC
DATE 7/31/07	REVIEWED BY KAS	

LEGEND

⊕	91-1	LOCATION OF MONITORING WELL AND SOIL BORING
●	SB-10	LOCATION OF SOIL BORING ONLY
○	VW-1	LOCATION OF VILLAGE WELL



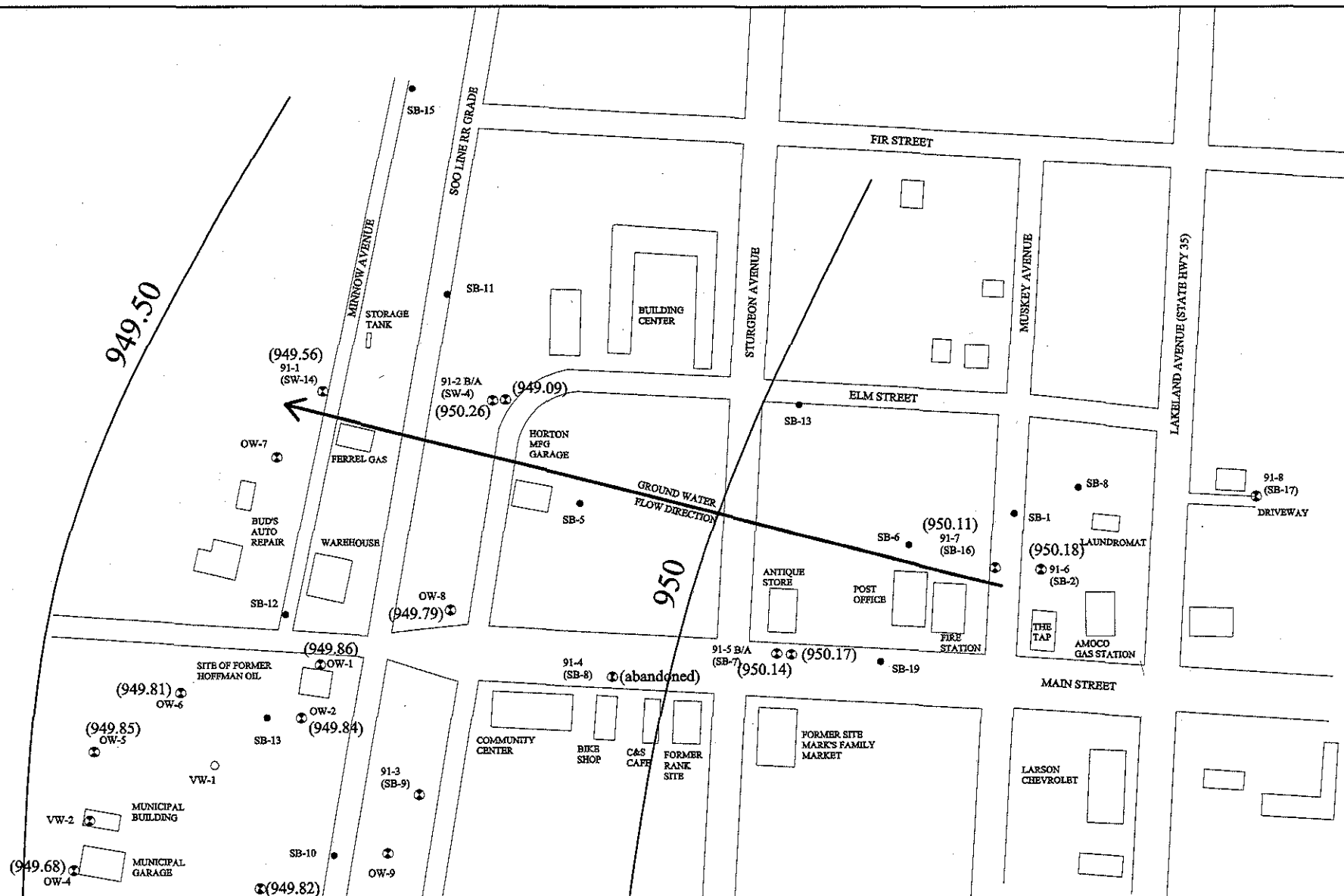
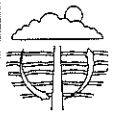
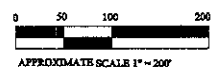

Figure 2
 Ground Water Table
 Contour Map 6/21/06
 Webster VOC Sampling
 Webster, Wisconsin

PROJECT NO. 05C636	PREPARED BY RSK	 Meridian Alliance Group, LLC
DATE 7/30/07	REVIEWED BY KAS	

LEGEND

- ⊕ 91-1 LOCATION OF MONITORING WELL AND SOIL BORING (SW-14)
- SB-10 LOCATION OF SOIL BORING ONLY
- VW-1 LOCATION OF VILLAGE WELL



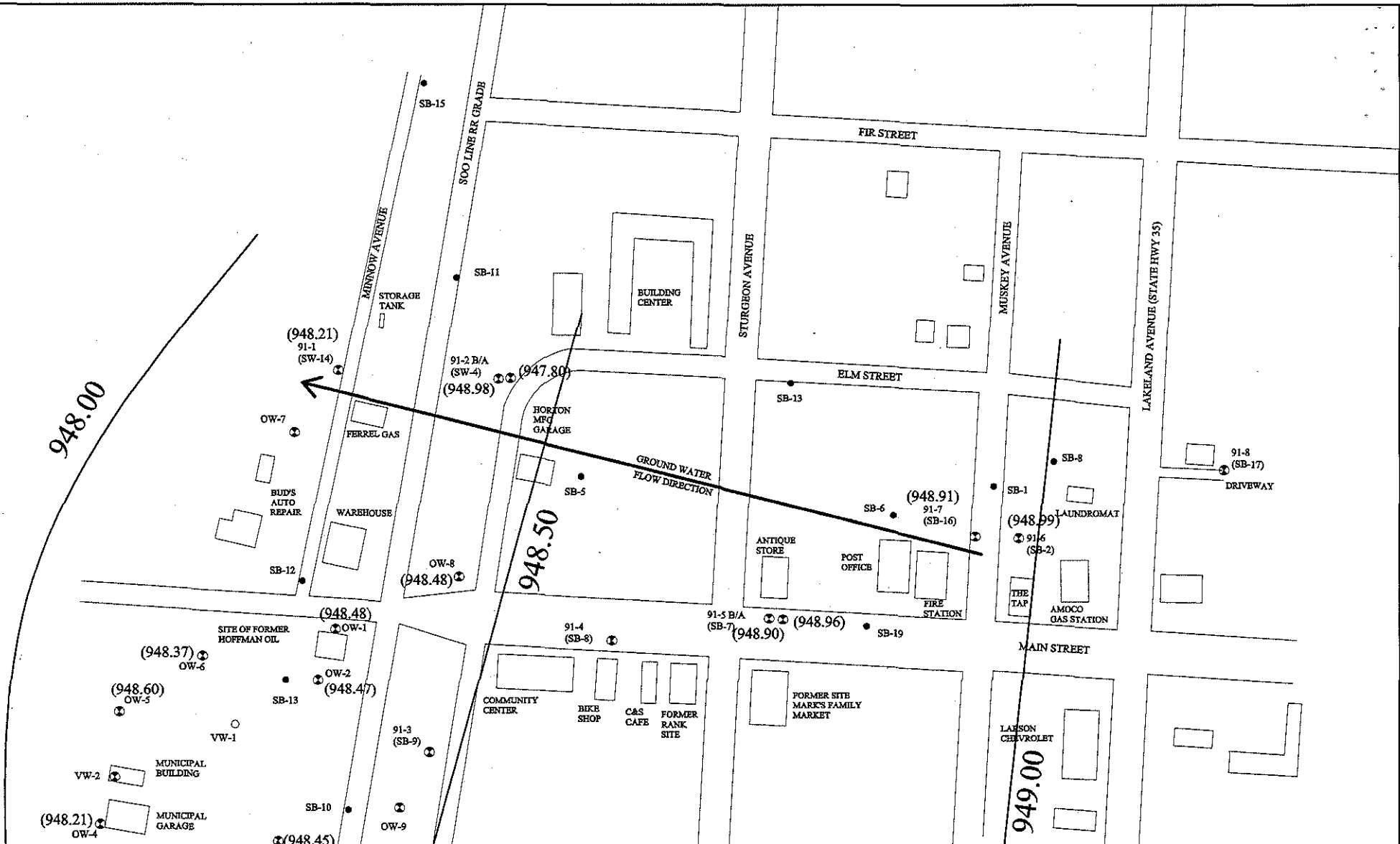

LEGEND

- ⊕ 91-1 LOCATION OF MONITORING WELL AND SOIL BORING
- SB-10 LOCATION OF SOIL BORING ONLY
- VW-1 LOCATION OF VILLAGE WELL

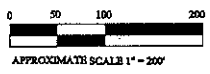



Figure 3
Ground Water Table
Contour Map 6/12/07
Webster VOC Sampling
Webster, Wisconsin

PROJECT NO. 05C636	PREPARED BY RSK	 Meridian Alliance Group, LLC
DATE 7/31/07	REVIEWED BY KAS	



LEGEND

- 91-1 (SW-14) LOCATION OF MONITORING WELL AND SOIL BORING
- SB-10 LOCATION OF SOIL BORING ONLY
- VW-1 LOCATION OF VILLAGE WELL

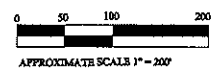
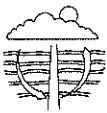

Figure 4
Estimated Tetrachloroethene
Isoconcentration Map
Webster VOC Sampling
Webster, Wisconsin

PROJECT NO. 05C639	PREPARED BY RSK	 Meridian Alliance Group, LLC
DATE 8/27/07	REVIEWED BY KAS	

~~2003~~
2004

JOB NO.	W0950-021
BOOK NO.	-
DRAWN BY	KAT
CHECKED BY	RJY
DATE	SEP 2004
REVISIONS	
REFERENCE FILE	W019base.dwg
DRAWING FILE	W019base.dwg

604 Wilson Avenue
Menomonee, Wisconsin 54751
715-235-9081
800-772-7372
500-772-7372
FAX 715-235-2727
www.cedarcorp.com

engineers, architects, planners, environmental scientists
and surveyors | landscape architects | interior designers

Wis. Dept of Natural Resources
WEBSTER GROUNDWATER MONITORING
WEBSTER, WISCONSIN
TETRACHLOROETHYLENE ISOCONCENTRATION MAP

FIGURE
1

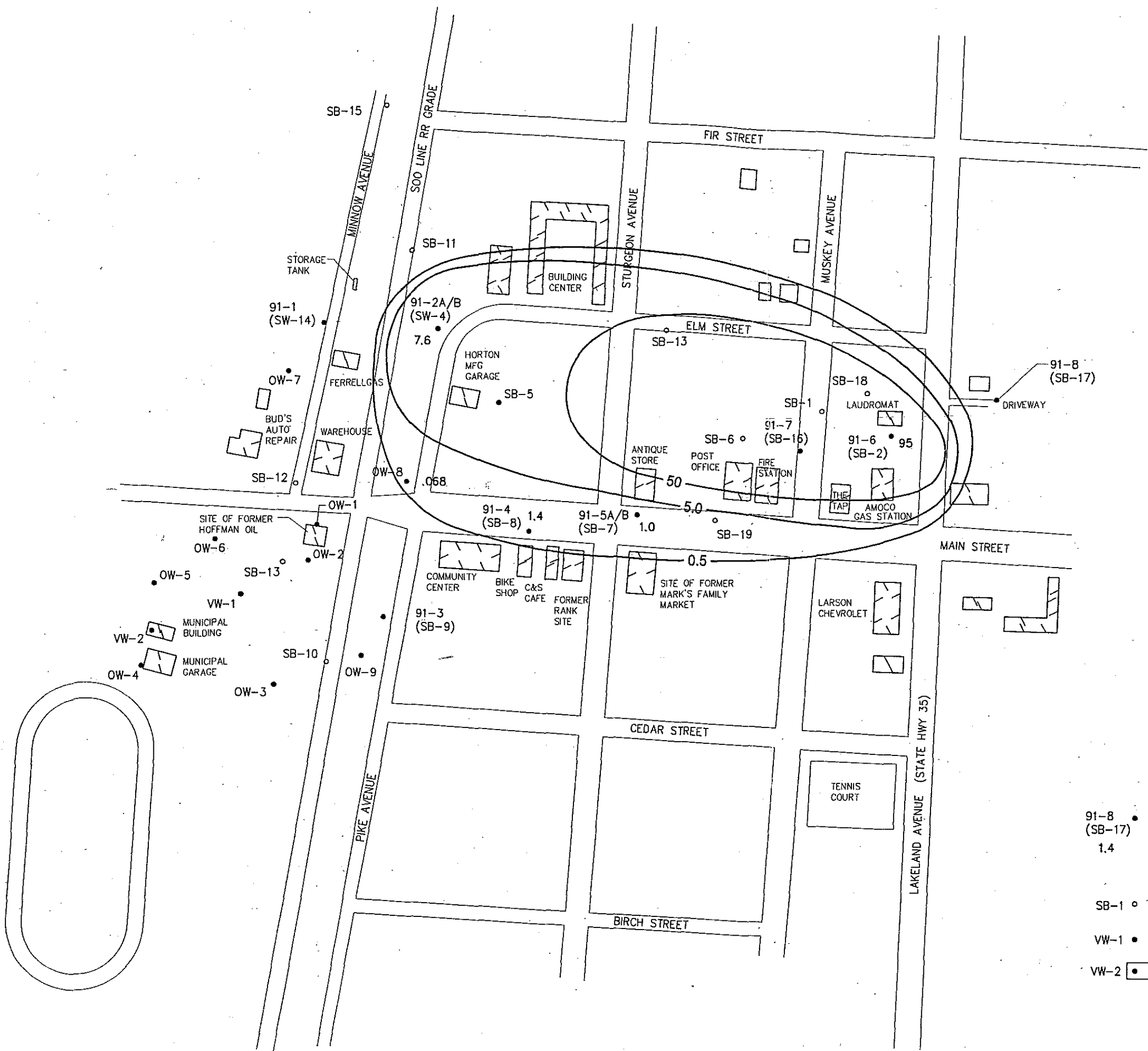

- LEGEND**
- 91-8 ● LOCATION OF MONITORING WELL AND SOIL BORING WITH TETRACHLOROETHYLENE ISOCONCENTRATION IN ppb
 - 1.4 ●
 - SB-1 ○ LOCATION OF SOIL BORING ONLY
 - VW-1 ● LOCATION OF VILLAGE WELL 1
 - VW-2 ● LOCATION OF VILLAGE WELL 2

ORIGINAL DRAWING COURTESY OF
RREM, INC - ENGINEERING AND ENVIRONMENTAL CONSULTANTS