

From: Brian Youngwirth <byoungwirth@generalengineering.net>
Sent: Friday, August 9, 2019 9:18 AM
To: Krueger, Sarah E - DNR
Subject: FW: SUSIE'S
Attachments: Fig 2 Site Plan & Sample Locations.pdf

Sarah, attached is a map showing the locations of the sub-slab vapor locations (VP), indoor ambient air locations (IA), outdoor ambient air location (OA), monitoring wells (MW), and sump in the basement of the restaurant.

Brian Youngwirth
Environmental Project Manager | General Engineering Company
916 Silver Lake Drive | PO Box 340 | Portage, WI 53901
P 608-742-2169 | Fax 608-742-2592 | C 608-697-8010
byoungwirth@generalengineering.net
www.generalengineering.net

GENERAL ENGINEERING COMPANY ELECTRONIC FILE NOTICE AND DISCLAIMER

This email and any electronic media transmitted with it are provided solely for the use of the addressee. Data, plans, specifications, reports, documents, and other information recorded on or transmitted as electronic media are subject to undetectable alteration, either intentional or unintentional, due to, among other causes, transmission, conversion, media degradation, software error, or human alteration. Accordingly, all such documents recorded on or transmitted as electronic media are being provided to the addressee for informational purposes only, and not as an end product or as a record document. Any reliance on documents recorded on or transmitted as electronic media is deemed to be unreasonable and unenforceable. The hard copy drawing(s) or other original document(s) produced by GENERAL ENGINEERING COMPANY are the only true contract documents of record. Documents recorded on or transmitted as electronic media may not be used on other projects, other additions to this project, or by third parties without the express written permission of GENERAL ENGINEERING COMPANY. Any unauthorized modification or reuse of the transmitted electronic media shall be at addressee's sole risk, and addressee agrees to defend, indemnify, and hold GENERAL ENGINEERING COMPANY harmless for all claims, injuries, damages, losses, expenses and attorneys' fees arising out of the unauthorized modification or use of such electronic media.

The addressee understands that the use of any project related electronic media constitutes acceptance of the above conditions.

If you have received this email in error please notify the system manager. Finally, the recipient should check this email and any attachments for the presence of viruses. The company accepts no liability for any damage caused by any virus transmitted by this email.

From: Karen Powers
Sent: Friday, August 09, 2019 9:13 AM
To: Brian Youngwirth <byoungwirth@generalengineering.net>
Subject: RE: SUSIE'S

Karen Powers
General Engineering Company
916 Silver Lake Drive | PO Box 340 | Portage, WI 53901
P 608-742-2169 | F 608-742-2592
kpowers@generalengineering.net
www.generalengineering.net

GENERAL ENGINEERING COMPANY ELECTRONIC FILE NOTICE AND DISCLAIMER

This email and any electronic media transmitted with it are provided solely for the use of the addressee. Data, plans, specifications, reports, documents, and other information recorded on or transmitted as electronic media are subject to undetectable alteration, either intentional or unintentional, due to, among other causes, transmission, conversion, media degradation, software error, or human alteration. Accordingly, all such documents recorded on or transmitted as electronic media are being provided to the addressee for informational purposes only, and not as an end product or as a record document. Any reliance on documents recorded on or transmitted as electronic media is deemed to be unreasonable and unenforceable. The hard copy drawing(s) or other original document(s) produced by GENERAL ENGINEERING COMPANY are the only true contract documents of record. Documents recorded on or transmitted as electronic media may not be used on other projects, other additions to this project, or by third parties without the express written permission of GENERAL ENGINEERING COMPANY. Any unauthorized modification or reuse of the transmitted electronic media shall be at addressee's sole risk, and addressee agrees to defend, indemnify, and hold GENERAL ENGINEERING COMPANY harmless for all claims, injuries, damages, losses, expenses and attorneys' fees arising out of the unauthorized modification or use of such electronic media.

The addressee understands that the use of any project related electronic media constitutes acceptance of the above conditions.

If you have received this email in error please notify the system manager. Finally, the recipient should check this email and any attachments for the presence of viruses. The company accepts no liability for any damage caused by any virus transmitted by this email.

From: Brian Youngwirth <byoungwirth@generalengineering.net>
Sent: Friday, August 09, 2019 9:03 AM
To: Karen Powers <kpowers@generalengineering.net>
Subject: RE: SUSIE'S

Karen, two changes.

Brian Youngwirth
Environmental Project Manager | General Engineering Company
916 Silver Lake Drive | PO Box 340 | Portage, WI 53901
P 608-742-2169 | Fax 608-742-2592 | C 608-697-8010
byoungwirth@generalengineering.net
www.generalengineering.net

GENERAL ENGINEERING COMPANY ELECTRONIC FILE NOTICE AND DISCLAIMER

This email and any electronic media transmitted with it are provided solely for the use of the addressee. Data, plans, specifications, reports, documents, and other information recorded on or transmitted as electronic media are subject to undetectable alteration, either intentional or unintentional, due to, among other causes, transmission, conversion, media degradation, software error, or human alteration. Accordingly, all such documents recorded on or transmitted as electronic media are being provided to the addressee for informational purposes only, and not as an end product or as a record document. Any reliance on documents recorded on or transmitted as electronic media is deemed to be unreasonable and unenforceable. The hard copy drawing(s) or other original document(s) produced by GENERAL ENGINEERING COMPANY are the only true contract documents of record. Documents recorded on or transmitted as electronic media may not be used on other projects, other additions to this project, or by third parties without the express written permission of GENERAL ENGINEERING COMPANY. Any unauthorized modification or reuse of the transmitted electronic media shall be at addressee's sole risk, and addressee agrees to defend, indemnify, and hold GENERAL ENGINEERING COMPANY harmless for all claims, injuries, damages, losses, expenses and attorneys' fees arising out of the unauthorized modification or use of such electronic media.

The addressee understands that the use of any project related electronic media constitutes acceptance of the above conditions.

If you have received this email in error please notify the system manager. Finally, the recipient should check this email and any attachments for the presence of viruses. The company accepts no liability for any damage caused by any virus transmitted by this email.

From: Karen Powers
Sent: Friday, August 09, 2019 8:57 AM
To: Brian Youngwirth <byoungwirth@generalengineering.net>
Subject: SUSIE'S

Karen Powers
General Engineering Company
916 Silver Lake Drive | PO Box 340 | Portage, WI 53901
P 608-742-2169 | F 608-742-2592
kpowers@generalengineering.net
www.generalengineering.net

GENERAL ENGINEERING COMPANY ELECTRONIC FILE NOTICE AND DISCLAIMER

This email and any electronic media transmitted with it are provided solely for the use of the addressee. Data, plans, specifications, reports, documents, and other information recorded on or transmitted as electronic media are subject to undetectable alteration, either intentional or unintentional, due to, among other causes, transmission, conversion, media degradation, software error, or human alteration. Accordingly, all such documents recorded on or transmitted as electronic media are being provided to the addressee for informational purposes only, and not as an end product or as a record document. Any reliance on documents recorded on or transmitted as electronic media is deemed to be unreasonable and unenforceable. The hard copy drawing(s) or other original document(s) produced by GENERAL ENGINEERING COMPANY are the only true contract documents of record. Documents recorded on or transmitted as electronic media may not be used on other projects, other additions to this project, or by third parties without the express written permission of GENERAL ENGINEERING COMPANY. Any unauthorized modification or reuse of the transmitted electronic media shall be at addressee's sole risk, and addressee agrees to defend, indemnify, and hold GENERAL ENGINEERING COMPANY harmless for all claims, injuries, damages, losses, expenses and attorneys' fees arising out of the unauthorized modification or use of such electronic media.

The addressee understands that the use of any project related electronic media constitutes acceptance of the above conditions.

If you have received this email in error please notify the system manager. Finally, the recipient should check this email and any attachments for the presence of viruses. The company accepts no liability for any damage caused by any virus transmitted by this email.

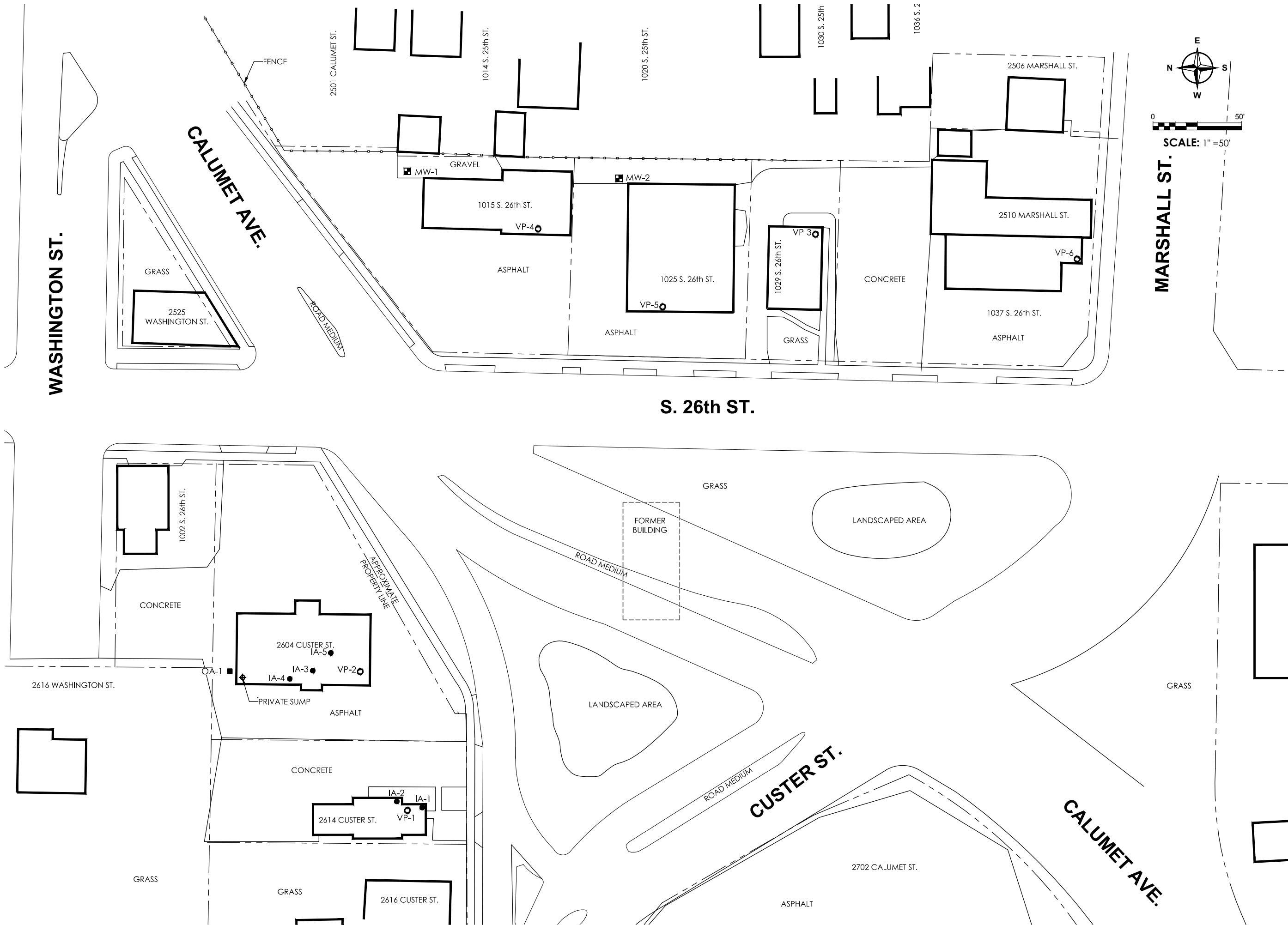

General Engineering Company
 P.O. Box 340 • 916 Silver Lake Dr. • Portage, WI 53901
 608-742-2169 (Office) • 608-742-2592 (Fax)
 www.generalengineering.net
This document contains confidential or proprietary information of General Engineering Company. Neither this document nor the information herein is to be reproduced, distributed, used or disclosed either in whole or in part except as specifically authorized by General Engineering Company.

SITE PLAN & SAMPLE LOCATIONS
SUSIE'S RESTAURANT
 CITY OF MANITOWOC
 MANITOWOC COUNTY, WI

- LEGEND**
- MOTORING WELL LOCATION
 - SUB SLAB VAPOR TESTING LOCATION
 - INDOOR AMBIENT AIR TESTING LOCATION
 - OUTDOOR AMBIENT AIR TESTING LOCATION

DRAWN BY	KSP
REVIEWED BY	LMB
ISSUE DATE	AUG 2019
GEC FILE NO.	2-0519-258
SHEET NO.	

FIGURE 2