

From: Greg Minikel <gminikel@manitowoc.org>
Sent: Friday, October 11, 2019 1:27 PM
To: Krueger, Sarah E - DNR
Cc: Chad Scheinoha; Billy Hutterer; Karen Dorow; Sue Reilly; Dan Koski
Subject: RE: Suzy's Restaurant
Attachments: 1020 S. 26th St. - Susies Restaurant - 1997 Record of Capping San. Lateral.pdf

Sarah,

I found the record drawing showing where the old Sanitary Lateral was capped off. See the attached drawing.

Does this information change the need to access the 3 additional manholes or not.

In our call earlier today, you stated that you also want to test the following 3 manholes:

San. M.H. #7-143, 7-147 & 7-149 (S. 26th & Marshall St.)

We also had another discussion about traffic control.

My thought is that the City would use a truck that has an arrow board on it.

We would probably also put out advance warning signs on all 3-4 streets ahead of the work.

Our best guess right now for say 3 hrs. of the truck and 1 man would be about \$500 plus or minus.

You were hoping that we could just bill this to the contractor, SCS, but you were still needing to confirm that with Rob.

From: Krueger, Sarah E - DNR [<mailto:sarah.krueger@wisconsin.gov>]

Sent: Tuesday, October 08, 2019 1:20 PM

To: Greg Minikel

Cc: Chad Scheinoha; Billy Hutterer; Karen Dorow; Sue Reilly; Dan Koski

Subject: RE: Suzy's Restaurant

Thank you for the update Greg,

I have forwarded the information on to Rob Langdon with SCS, and will let him decide. I will be in touch with all of you regarding the decision that is made.

Thank you for your help in this matter.

Sarah

We are committed to service excellence.

Visit our survey at <http://dnr.wi.gov/customersurvey> to evaluate how I did.

Sarah Krueger, P.G.

Phone: 920-662-5443

Sarah.Krueger@wisconsin.gov

From: Greg Minikel <gminikel@manitowoc.org>
Sent: Tuesday, October 8, 2019 1:03 PM
To: Krueger, Sarah E - DNR <sarah.krueger@wisconsin.gov>
Cc: Chad Scheinoha <cscheinoha@manitowoc.org>; Billy Hutterer <bhutterer@manitowoc.org>; Karen Dorow <kdorow@manitowoc.org>; Sue Reilly <sreilly@manitowoc.org>; Dan Koski <dkoski@manitowoc.org>
Subject: FW: Suzy's Restaurant

Sarah,

We talked about the traffic control this morning and the others feel that we need to be charging out the cost to do the traffic control as this is not for City initiated project.

Therefore, I guess either you or SCS will have to hire the City to do the traffic control and we would bill it out accordingly or SCS or DNR would have to hire a barricading company to do the work.

Let us know which way you want to go with this. Thanks.

From: Greg Minikel
Sent: Monday, October 07, 2019 4:41 PM
To: 'Krueger, Sarah E - DNR'; Billy Hutterer
Cc: Chad Scheinoha; Karen Dorow; Jill Erickson; Mike Zimmer; Michael Jaeger; Pete Dombrowski; Sue Reilly; Dan Koski; Bill Jindra
Subject: RE: Suzy's Restaurant

Hi Sarah,

Of course I found the map as soon as I got off the phone. Thank you anyway.

I have printed and scanned a similar map, but with the aerial photo attached.

Based on our conversation this afternoon, you informed me that the vapor intrusion system has been installed at the Golden Flame last week, but there is still some work to do to finish it completely. You also stated that the DNR is still trying to determine what do to with the impacted storm water from the Flame's sump pump.

The next step is that the DNR wants to test for vapor intrusion of the sanitary sewer in this area.

It is my understanding that you will want access to Sanitary Manhole #'s 7-139, 7-142, & 7-146. I have circled them in red on the attached map.

You indicated that SCS is being hired to perform the work for the DNR. The DNR is hoping that they will be able to do the work in the next 4-6 weeks and before the cold winter weather settles in.

You said that it takes about 30 minutes at each manhole to do the testing, so that all work should be completed within about a 2 hour period.

After we discussed this, it appears that the best and easiest option is to have the City set up the necessary traffic control.

For future reference, Billy Hutterer's cell phone number is: (920) 323-7842.

Billy H.,

That is why you are copied on this e-mail.

I need you to determine what lane closures would be needed and what the appropriate traffic control would be for this very busy intersection.

It will probably be best for you to work directly with the project manager or on-site person for SCS. Sarah will get you that information when it becomes available.

From: Krueger, Sarah E - DNR [<mailto:sarah.krueger@wisconsin.gov>]
Sent: Monday, October 07, 2019 4:12 PM
To: Greg Minikel
Subject: FW: Suzy's Restaurant

Greg – Attached is the map I was looking at.
Thank you again for your help!
Sarah

We are committed to service excellence.

Visit our survey at <http://dnr.wi.gov/customersurvey> to evaluate how I did.

Sarah Krueger, P.G.

Phone: 920-662-5443

Sarah.Krueger@wisconsin.gov

From: Jill Erickson <jerickson@manitowoc.org>
Sent: Friday, March 22, 2019 1:23 PM
To: Krueger, Sarah E - DNR <sarah.krueger@wisconsin.gov>
Subject: FW: Suzy's Restaurant

From: Jill Erickson
Sent: Friday, March 22, 2019 1:05 PM
To: 'sarah.krueger@wis.gov'
Cc: Greg Minikel; Dan Koski
Subject: RE: Suzy's Restaurant

Sarah,

Attached is the current map and locations of the sanitary and storm systems (sanitary is solid lines with thick blue lines for laterals-manhole information boxes are also solid- storm is dashed lines-manhole information boxes are outlined with a dashed line) at the previous location of Suzy's Restaurant. You would need to contact Manitowoc Public Utilities to get their water laterals and locations at this location. How far back do you need prior locations? The attached map does show plugged/abandoned laterals (dashed laterals/purple lines are abandoned sanitary).

You can also access our mapping via our website www.manitowoc.org and click on the maps icon. It will redirect you to our mapping website and does have both a sanitary as well as a storm layer with laterals that you can view.

If you have further questions, please feel free to email or call.

Thanks,

Jill Erickson

From: Dan Koski
Sent: Friday, March 22, 2019 11:47 AM
To: Jill Erickson
Cc: Greg Minikel
Subject: Suzy's Restaurant

Jill,

Sarah Krueger, who is the new DNR project manager for this project called. She is working on access agreements for properties adjacent to the former dry cleaner in order to perform vapor sampling.

She is looking for a map that shows the existing laterals, as well as prior lateral locations (both water and sanitary) for the facility, as well as those across the street and the residence to the north.

Do you have this info? If so, can you please provide it to her?

Her number is (920) 662-5431

sarah.krueger@wis.gov

thanks

Dan

Dan Koski, PE
Director of Public Infrastructure
City of Manitowoc
900 Quay Street
Manitowoc, WI 54220

dkoski@manitowoc.org
www.manitowoc.org

phone: (920) 686-6910
fax: (920) 686-6906

DATE 9-17-97 TIME PM TEMP. 70°

ADDRESS 1020 S. 26th ST.

NAME BUSIES REST.

PROPERTY IS ? ANEX. NEW RAZED RESID. COMM.

CONTRACTOR WANER CONST. PH. # _____

WATER SERVICE * INSTALLED RAZED

DATE _____ HOW ? TO BE DISCONTINUED BY "MPH"

SANITARY SEWER 6" V.C. INSTALLED RAZED

DATE 9-17-97 HOW ? BREN + CAPPED W/ CONCRETE 7' DOWN.

STORM SEWER None (SLAB) INSTALLED RAZED

DATE _____ HOW ? _____

SUMP PIT No SUMP PUMP No CODE COMPLYING

REQUIRIED CHANGES _____

SEPTIC TANK No PUMPED ABANDONED DATE _____

CANTRACTOR THAT PERFORMED THE WORK _____

CONTR. ADD. _____ PH. # _____

WELL No ABANDONED WELL PERMIT DATE _____

HAS THE WELL ABANDONMENT BEEN RECORDED WITH THE CITY CLERK'S OFFICE,

817 FRANKLIN ST., MTWC. ? _____

>>>>>LOCATION OF THE ABOVE FACILITIES ARE NOTED ON REVERSE SIDE<<<<<<

COMMENTS

ADDRESS: 1020 S. 26TH ST

(READ ME →)

NAME: SUBIE'S RESTAURANT

DATE: 9-17-97

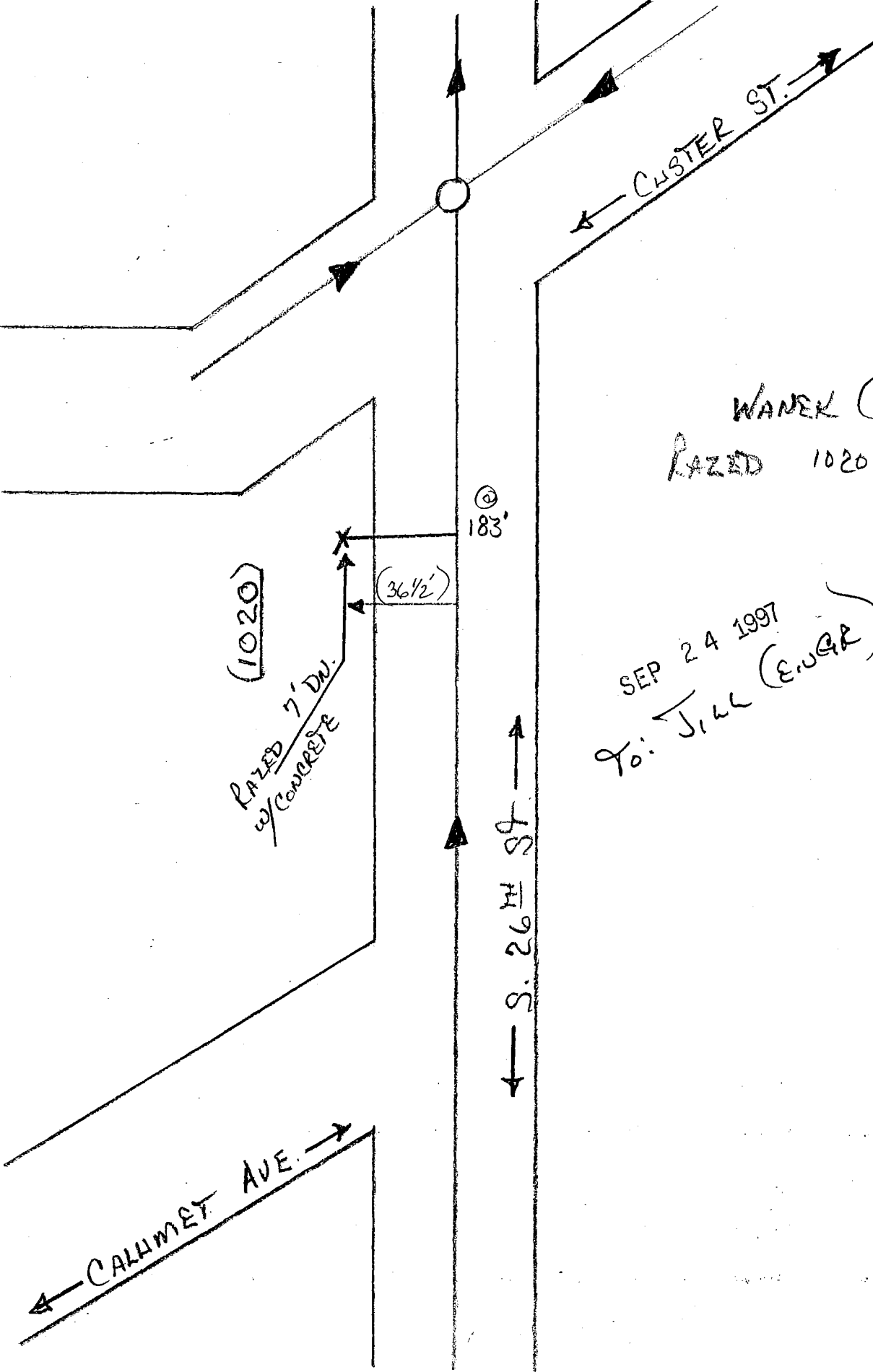
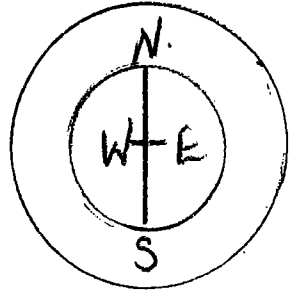

WANER CONST.
RAZED 1020 S. 26TH ST

SEP 24 1997
To: JILL (ENGR)