

Richard, Philip E - DNR

From: Ree, Timothy <Tim.Ree@ghd.com>
Sent: Tuesday, April 18, 2017 12:26 PM
To: Richard, Philip E - DNR
Subject: Penta Wood - Soil Sampling Plan ~COR-086165~
Attachments: Surface Soil Sampling Plan.pdf; 86165-03(PRES008)GN-WA002-figure 1.pdf; 086165-Surface Soil and Sediment Sample Plan Summary.xlsx

Phil,

We propose to advance a several soil borings throughout the Penta Wood site to collect soil samples. The purpose of a portion of the sampling is to confirm PCP and arsenic concentrations reported in the Remedial Action Report (CH2M HILL, 2000) and to delineate the extent of concentrations exceeding applicable criteria (GP-10 through GP-40). The purpose of the remaining portion of the sampling is to assess the groundwater protection pathway due to contaminant concentrations in surface debris at the site (borings GP-34, GP-37, GP-41 through GP-44 and GP-45 through GP-47).

The soil sample locations are shown on the attached figures and the sampling is summarized in the attached table.

We confirmed that the driller is available to start this work next week.

We will provide a notification letter to the Nelsons for the sampling work on their property (borings GP-1A, GP-7A, GP-10 through GP-13). We have contacted the Village of Siren and Daniels Township about sampling (boring GP-21) along Daniels 70 south of the Penta Wood property. They can find no record of land along Daniels 70 being turned over the village, township, or county. We are trying to confirm with Wisconsin DOT if they own the property. We will not sample at this location until we confirm whether permitting/authorization is necessary. This work can be done with a hand auger by GHD at a later date if this issue is not resolved before the drillers complete all of the other work.

Regards,

Tim Ree

GHD

D: +1 612 524 6866 | T: +1 651 639 0913 | M: +1 651 592 7697 | E: tim.ree@ghd.com
1801 Old Highway 8 NW Suite 114 St. Paul Minnesota 55112 USA | www.ghd.com

[WATER](#) | [ENERGY & RESOURCES](#) | [ENVIRONMENT](#) | [PROPERTY & BUILDINGS](#) | [TRANSPORTATION](#)

Please consider our environment before printing this email

CONFIDENTIALITY NOTICE: This email, including any attachments, is confidential and may be privileged. If you are not the intended recipient please notify the sender immediately, and please delete it; you should not copy it or use it for any purpose or disclose its contents to any other person. GHD and its affiliates reserve the right to monitor and modify all email communications through their networks.

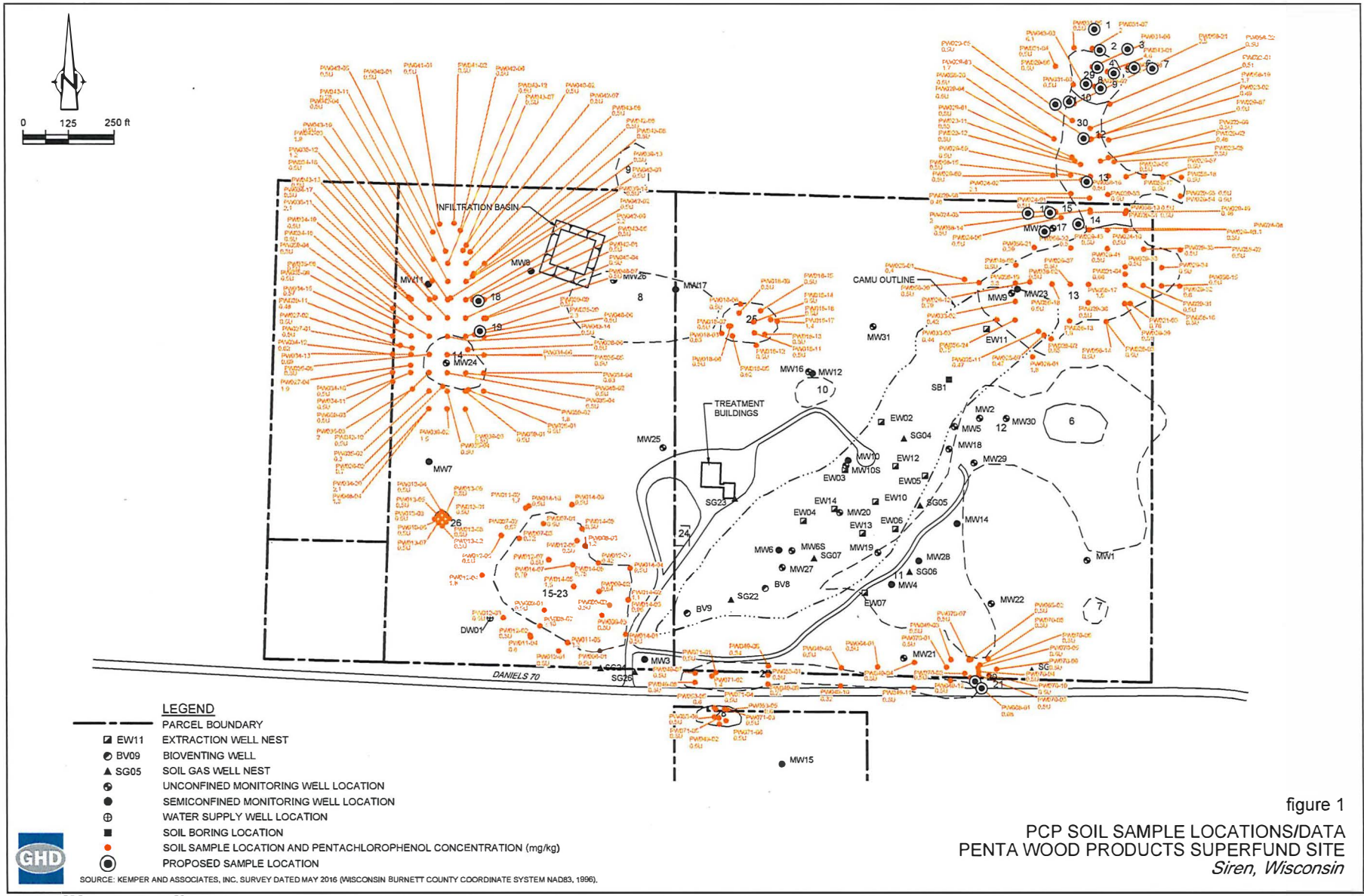
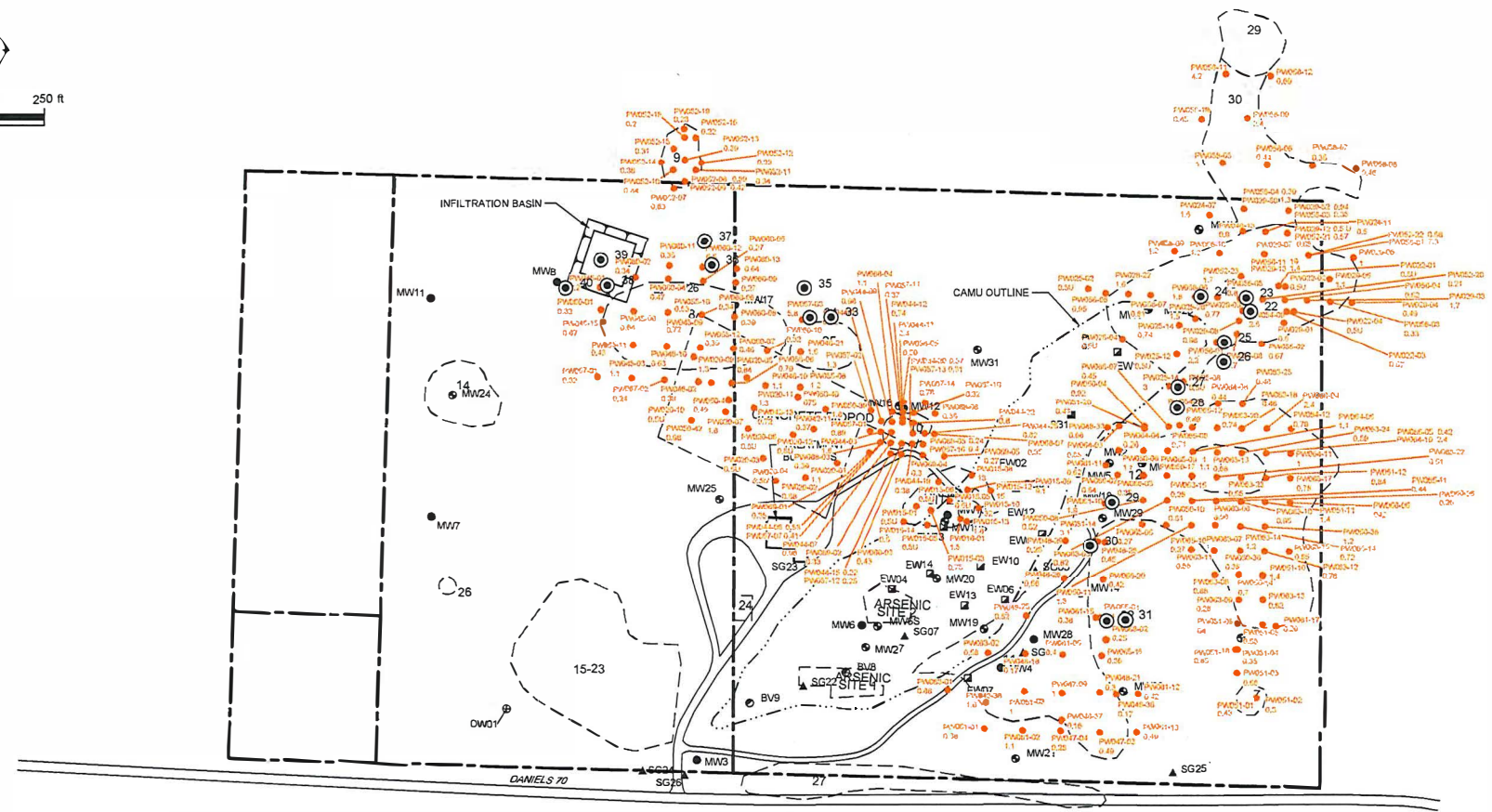
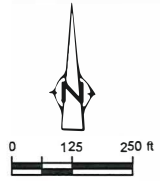

figure 1
 PCP SOIL SAMPLE LOCATIONS/DATA
 PENTA WOOD PRODUCTS SUPERFUND SITE
 Siren, Wisconsin



LEGEND

- PARCEL BOUNDARY
- EW11 EXTRACTION WELL NEST
- BV09 BIOVENTING WELL
- ▲ SG05 SOIL GAS WELL NEST
- UNCONFINED MONITORING WELL LOCATION
- ⊕ SEMICONFINED MONITORING WELL LOCATION
- ⊕ WATER SUPPLY WELL LOCATION
- SOIL BORING LOCATION
- SOIL SAMPLE LOCATION AND ARSENIC CONCENTRATION (mg/kg)
- PROPOSED SAMPLE LOCATION

SOURCE: KEMPER AND ASSOCIATES, INC. SURVEY DATED MAY 2016 (WISCONSIN BURNETT COUNTY COORDINATE SYSTEM NAD83, 1996).

figure 1
 ARSENIC SOIL SAMPLE LOCATIONS/DATA
 PENTA WOOD PRODUCTS SUPERFUND SITE
 Siren, Wisconsin

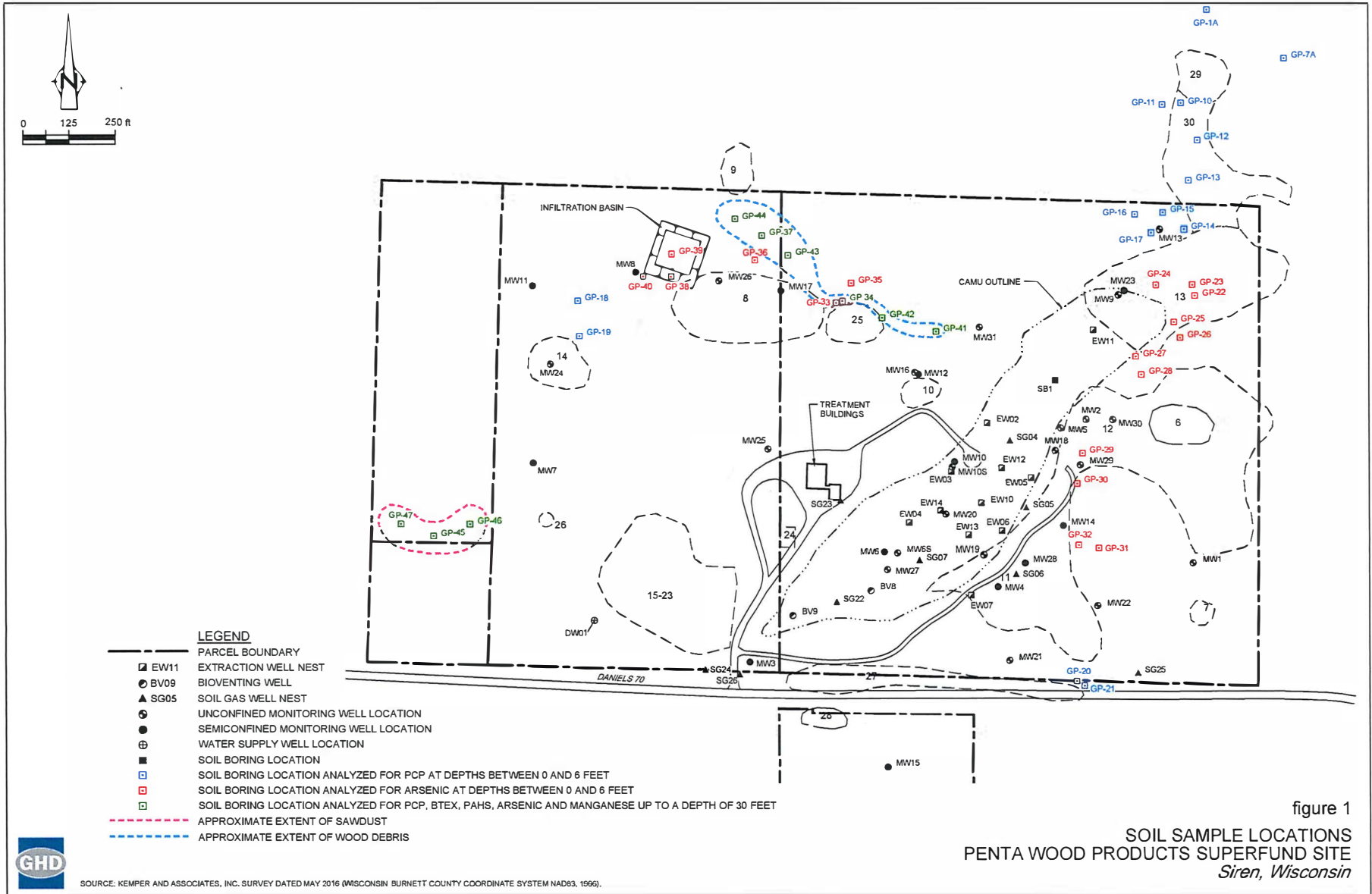

Table 1
Surface Soil/Sediment Sampling Plan Summary
Penta Wood Products Superfund Site
Siren, Wisconsin

Sample Location	Coordinates			Area	Sample Depths (ft bbs)	Sample Purpose
	X	Y				
1A	217758.6840	155156.6746	Near 29		0, 3	Delineate PCP horizontally northeast of sample location GP-1 (PCP concentration 1.2 mg/kg)
7A	217970.2183	155027.0713	Near 29		0, 3	Delineate PCP horizontally northeast of sample location GP-7 (PCP concentration 1.1 mg/kg)
10	217687.6742	154902.7405	30		0, 3, 6	Confirm PCP at former sample location PW058-21 (PCP concentration 2.5 mg/kg) and delineate PCP vertically
11	217636.8781	154900.0821	30		0, 3	Delineate PCP horizontally west of former sample location PW058-21 (PCP concentration 2.5 mg/kg)
12	217731.4255	154803.0793	30		0, 3, 6	Confirm PCP at former sample location PW029-63/PW058-19 (PCP concentration 1.7 mg/kg) and delineate PCP vertically
13	217708.6074	154691.4719	30		0, 3, 6	Confirm PCP at former sample location PW024-02 (PCP concentration 2.1 mg/kg) and delineate PCP vertically
14	217694.8206	154559.4106	30		0, 3, 6	Confirm PCP at former sample location PW024-08 (PCP concentration 1.1 mg/kg) and delineate PCP vertically
15	217636.1567	154603.6097	Near 13/30		0, 3, 6	Confirm PCP at former sample location PW024-05 (PCP concentration 2 mg/kg) and delineate PCP vertically
16	217560.3988	154599.4620	Near 13/30		0, 3	Delineate PCP horizontally west of former sample location PW024-05 (PCP concentration 2 mg/kg)
17	217605.9341	154548.7642	Near 13/30		0, 3	Delineate PCP horizontally south of former sample location PW024-05 (PCP concentration 2 mg/kg)
18	216037.3014	154361.1701	Near 14		0, 3, 6	Confirm PCP at former sample location PW042-09 (PCP concentration 2.2 mg/kg) and delineate PCP vertically
19	216042.6088	154267.0098	Near 14		0, 3, 6	Confirm PCP at former sample location PW035-20 (PCP concentration 2.3 mg/kg) and delineate PCP vertically
20	217398.9803	153321.9762	Near 12		0, 3, 6	Confirm PCP at former sample location PW068-01 (PCP concentration 0.98 mg/kg) and delineate PCP vertically
21	217420.1362	153306.8891	Near 12		0, 3	Delineate PCP horizontally south of former sample location PW068-01 (PCP concentration 0.98 mg/kg)
22	217725.2728	154375.9694	13		0, 3, 6	Confirm Arsenic at former sample location PW054-09 (Arsenic concentration 2.5 mg/kg) and delineate Arsenic vertically
23	217719.1059	154403.6902	13		0, 3, 6	Confirm Arsenic at former sample location PW056-05 (Arsenic concentration 3.8 mg/kg) and delineate Arsenic vertically
24	217619.8932	154407.0185	13		0, 3, 6	Confirm Arsenic at former sample location PW056-06 (Arsenic concentration 1.8 mg/kg) and delineate Arsenic vertically
25	217666.9062	154304.6977	13		0, 3, 6	Confirm Arsenic at former sample location PW056-01 (Arsenic concentration 2.2 mg/kg) and delineate Arsenic vertically
26	217682.6617	154261.3572	Near 13		0, 3	Delineate Arsenic horizontally south of former sample location PW056-01 (Arsenic concentration 2.2 mg/kg)
27	217562.3028	154209.0590	Near 13		0, 3, 6	Confirm Arsenic at former sample location PW028-14 (Arsenic concentration 3 mg/kg) and delineate Arsenic vertically
28	217577.8736	154160.8366	Near 13		0, 3	Delineate Arsenic horizontally south of former sample location PW028-14 (Arsenic concentration 3 mg/kg)
29	217416.7539	153945.4341	Near 11		0, 3, 6	Confirm Arsenic at former sample location PW061-10 (Arsenic concentration 1.9 mg/kg) and delineate Arsenic vertically
30	217400.5517	153860.3341	Near 11		0, 3, 6	Confirm Arsenic at former sample location PW051-14 (Arsenic concentration 3.1 mg/kg) and delineate Arsenic vertically
31	217461.4774	153684.7290	Near 11		0, 3	Delineate Arsenic horizontally east of former sample location PW066-01 (Arsenic concentration 2.1 mg/kg)
32	217405.5734	153690.4624	Near 11		0, 3, 6	Confirm Arsenic at former sample location PW066-01 (Arsenic concentration 2.1 mg/kg) and delineate Arsenic vertically
33	216744.4771	154356.2796	Near 25		0, 3, 6	Confirm Arsenic at former sample location PW057-03 (Arsenic concentration 5.8 mg/kg) and delineate Arsenic vertically
34	216761.4775	154361.5442	Near 25, Wood Debris		0, 3, to depth of 30'	Delineate Arsenic horizontally east of former sample location PW057-03 (Arsenic concentration 5.8 mg/kg); Sample soils along tree line where there is timber debris and analyze for PCP, PAHs, Arsenic, & Manganese (approximate location)
35	216785.5291	154409.5073	Near 25		0, 3	Delineate Arsenic horizontally north of former sample location PW057-03 (Arsenic concentration 5.8 mg/kg)
36	216522.3508	154472.8488	Near 8		0, 3, 6	Confirm Arsenic at former sample location PW060-12 (Arsenic concentration 6.5 mg/kg) and delineate Arsenic vertically
37	216542.2570	154540.1330	Near 8, Wood Debris		0, 3, to depth of 30'	Delineate Arsenic horizontally north of former sample location PW060-12 (Arsenic concentration 6.5 mg/kg); Sample soils underneath timbers (probe through timbers) and analyze for PCP, PAHs, Arsenic, & Manganese (approximate location)
38	216293.7952	154427.1873	Near 8		0, 3, 6	Confirm Arsenic at former sample location PW045-01 (Arsenic concentration 2.2 mg/kg) and delineate Arsenic vertically
39	216295.1619	154489.0051	Near 8		0, 3	Delineate Arsenic horizontally north of former sample location PW045-01 (Arsenic concentration 2.2 mg/kg)
40	216216.8270	154426.6320	Near 8		0, 3	Delineate Arsenic horizontally west of former sample location PW045-01 (Arsenic concentration 2.2 mg/kg)
41	217016.2960	154277.0660	Wood Debris		To depth of 30'	Sample soils along tree line where there is timber debris and analyze for PCP, PAHs, Arsenic, & Manganese (approximate location)
42	216870.4630	154316.1290	Wood Debris		To depth of 30'	Sample soils along tree line where there is timber debris and analyze for PCP, PAHs, Arsenic, & Manganese (approximate location)
43	216612.8090	154486.8860	Wood Debris		To depth of 30'	Sample soils along tree line where there is timber debris and analyze for PCP, PAHs, Arsenic, & Manganese (approximate location)
44	216468.5980	154584.9490	Wood Debris		To depth of 30'	Sample soils along tree line where there is timber debris and analyze for PCP, PAHs, Arsenic, & Manganese (approximate location)
45	215644.1540	153715.6890	Sawdust		To depth of 15'	Sample soils underneath sawdust and analyze for PCP, Arsenic, & Manganese (approximate location)
46	215741.3150	153748.9450	Sawdust		To depth of 15'	Sample soils underneath sawdust and analyze for PCP, Arsenic, & Manganese (approximate location)
47	215553.7730	153752.2130	Sawdust		To depth of 15'	Sample soils underneath sawdust and analyze for PCP, Arsenic, & Manganese (approximate location)