



State of Wisconsin

DEPARTMENT OF NATURAL RESOURCES

Carroll D. Besadny
Secretary

Box 7921
Madison, Wisconsin 53707

November 7, 1989

IN REPLY REFER TO: 4400

Jordan S. Harwood
111 East Wisconsin Ave.
Milwaukee, Wisconsin 53202-4884

Dear Mr. Harwood:

This is to notify you that the American Toy Company has been deleted from the Active and Abandoned Landfill listing. Thank you for supplying the documentation indicating that the liquid substance and surface soil near the property was properly cleaned up.

The updated Abandoned and Active Landfill listing, renamed Waste Disposal Sites in Wisconsin, will be available to the public by early December 1989. We hope this letter serves to clarify the Department's conclusion of this matter.

Sincerely,

A handwritten signature in cursive script that reads "Mark Giesfeldt".

Mark Giesfeldt, Chief
Environmental Response and Repair Section
Wisconsin Department of Natural Resources

→ CC: Doug Rossberg-Lmo

REINHART, BOERNER, VAN DEUREN, NORRIS & RIESELBACH
S. C.

ROGER L. BOERNER
RICHARD A. VAN DEUREN
RICHARD H. NORRIS III
ALLEN N. RIESELBACH
PAUL V. LUCKE
THOMAS M. STANTON
ARTHUR F. LUBKE, JR.
DONALD J. CHRISTL
THOMAS E. FUNK
DAVID A. ERNE
ROBERT E. BELLIN
WILLIAM R. STEINMETZ
GARY A. HOLLMAN
JOHN A. ERICH
JEFFREY R. FULLER
FREDERIC G. FRIEDMAN
DELOS N. LUTTON
WAYNE C. OLDENBURG
LLOYD J. DICKINSON
JOHN L. HORWICH
MARY A. BRAUER

STEPHEN T. JACOBS
CHESTER P. SCHWARTZ*
ROBERT N. SANDLER
SCOTT W. HANSEN
MICHAEL H. SIMPSON
JOHN L. SCHLIESMANN
STEVEN D. HUFF
WILLIAM F. FLYNN
PETER C. BLAIN
BRUCE T. BLOCK
JEFFREY P. CLARK
DANIEL J. BRINK
MICHAEL T. PEPKE
DAVID C. KUEHL
MICHAEL D. RECHTIN
RICHARD P. CARR
ROBERT F. HENKLE, JR.
RICHARD W. GRABER
ANNE W. REED
ROBERT K. SHOLL
KRISTIN M. BERGSTROM

ATTORNEYS AT LAW
111 EAST WISCONSIN AVENUE
MILWAUKEE, WISCONSIN 53202-4884
TELEPHONE (414) 271-1190
FACSIMILE (414) 271-2406

MADELEINE E. KELLY
LAWRENCE J. BURNETT
JOHN A. HERBERS
FRANCIS W. DEISINGER
JEROME M. JANZER
ANDREW C. TESKE
PHILIP P. MANN
KEVIN J. HOWLEY
ANTHONY J. HANDZLIK
MARK L. METZ
STEVEN P. BOGART
TIMOTHY C. McDONALD
KAREN S. STRANDHOLM
JOSEPH J. BALISTRERI
DENISE P. GOERGEN
JAMES M. BEDORE
GEORGE W. CARLIS
JILL M. KOCH
JANN L. HARLEY
STEVEN P. SCHNEIDER
MICHAEL R. SMITH

SARAH J. WILSON
CATHERINE F. CONWAY
ALBERT S. ORR
R. TIMOTHY MUTH
JOHN R. STOFFER
STEVEN J. COTTINGHAM
WILLIAM T. SHROYER
MARY C. FLANNER-STRACK
THOMAS J. NOLTE
MARTIN J. McLAUGHLIN
ANNE M. MORGAN
JOHN M. WIRTH
LARRI J. BROOMFIELD
TIMOTHY P. REARDON
DANITA A. GILBERT
CHRISTINE L. THIERFELDER
LANE R. MOYER
MICHAEL D. JANKOWSKI
MARY E. TRIGGIANO-HUNT
MARTY R. HOWARD
WILLIAM P. SCOTT

*NOT LICENSED IN WISCONSIN

August 2, 1989

RECEIVED

AUG 3 1989

BUREAU OF SOLID -
HAZARDOUS WASTE MANAGEMENT

Mark Giesfeldt, Chief
Environmental Response and
Repair Section
Wisconsin Department of
Natural Resources
P.O. Box 7921
Madison, WI 53707

Dear Mark:

Re: American Toy Company

This letter confirms our July 27, 1989 telephone conversation regarding the request to remove American Toy Company from the Wisconsin Department of Natural Resources 1988 Abandoned and Active Landfill Listing (see attached). As discussed, the property is an active manufacturing operation which supposedly had a liquid spill on the property. According to November 1980 documentation received from the Hortonville Manufacturing Division of American Toy and Furniture (see attached), a soil analysis was performed to ensure the property is clean. The results from Badger Laboratories show that only water and soil were present.

I also enclose copies of the report of a preliminary assessment performed at the site July 17, 1984 and the preliminary assessment summary. Based upon the information presented in these documents, this property was inadvertently added to the abandoned landfill listing. I believe that after reviewing the enclosed documents, you will agree with our conclusion. I would appreciate receiving a letter from you to serve as documentation to that effect.

I also talked to William Messinger at U.S. Environmental Protection Agency, Region V, as you recommended, about the possibility of removing Hortonville Manufacturing Company from the CERCLIS Listing. Mr. Messinger will be sending documentation about the procedures to be followed once a name has been added to that listing and the difficulty of being removed.

Mark Giesfeldt, Chief
Environmental Response
and Repair Section
August 2, 1989
Page 2

Once again, thank you for your assistance. I am
looking forward to your letter agreeing with our opinion.

Yours very truly,

Jordan S. Harwood, P.E.
Environmental Consultant

JSH:KE

Encs.

17-Mar-88

ACTIVE AND ABANDONED LANDFILLS IN WISCONSIN

DNR DIST.	COUNTY	FACILITY NAME	LOCATION		ID NUMBER	INFORMATION SOURCE
			TOWN/CITY	ADDRESS/LEGAL DESCRIPT.		
LM	OUTAGAMIE	TN HORTONIA	HORTONIA	NE S24 22N 15E		AREA FILES
LM	OUTAGAMIE	RAYMOUND DORCHNER	HORTONVILLE	NE SE S23 22N 15E	POST-REG	CO FILES BUREAU
LM	OUTAGAMIE	AMERICAN TOY CO	HORTONVILLE	NW SW S35 22N 15E	WID980678163	ERRIS 10-20-83
LM	OUTAGAMIE	WI CHROMIUM CORP	KAUKAUNA	CTH 00	2914 ENF	STATUS LOG
LM	OUTAGAMIE	ROLOFF FOUNDRY	KAUKAUNA	CNTY 00 & GERTRUDE ST		AREA FILES
LM 5	OUTAGAMIE	CITY NEW LONDON	LIBERTY	NW SE S15 22N 15E	1523 TEMP	AREA FILES
LM	OUTAGAMIE	TN LIBERTY	LIBERTY	NW SW S15 22N 15E	1523 TEMP	INACT. LOG 2/84
LM	OUTAGAMIE	TN MAINE	MAINE	NE SE S11 24N 16E	93 TEMP	INACT. LOG 2/84
LM	OUTAGAMIE	DNR DEER PIT	MAINE	NE NE S14 24N 16E	1187 TEMP	AREA FILES
LM	OUTAGAMIE	CURWOOD INC	NEW LONDON	718 HIGH ST	WID006144737	ERRIS 10-20-83
LM	OUTAGAMIE	CTY NEW LONDON	NEW LONDON	NW NE S18 22N 15E		AREA FILES
LM	OUTAGAMIE	FALKS BROTHERS CONST.	NEW LONDON	KRAKE PROPERTY	POST-REG	CO FILES BUREAU
LM	OUTAGAMIE	CURWOOD INC (LIQUID WASTE)	NEW LONDON	800 HIGH ST	POST-REG	UNLIC. SITE LOG
LM	OUTAGAMIE	VIL NICHOLS	NICHOLS	N1/2 SE S7 24N 17E	683 TEMP	AREA FILES
LM	OUTAGAMIE	TN ONEIDA	ONEIDA			AREA FILES
LM	OUTAGAMIE	SCHAUMANN LUMBER CO (WOOD)	ONEIDA			WOOD SURVEY 76
LM	OUTAGAMIE	TN ONEIDA	ONEIDA	NW NE S20 23N 19E	410 TEMP	INACT. LOG 2/84
LM 5	OUTAGAMIE	CITY SEYMOUR	SEYMOUR	S29 24N 18E	762 TEMP	AREA FILES
LM	OUTAGAMIE	SEYMOUR WOODENWARE (WOOD)	SEYMOUR	SEYMOUR ST		WOOD SURVEY 76
LM	OUTAGAMIE	TN SEYMOUR	SEYMOUR	SE SW 22 24N 18E	694	ACTIVE SITE
LM	OUTAGAMIE	CTY SEYMOUR	SEYMOUR	NW SW S14 04N 17E	762 TEMP	LIC LOG 1970
LM	OUTAGAMIE	VIL SHIOCTON	SHIOCTON	SW NE S29 23N 16E	541 TEMP	INACT. LOG 2/84
LM	OUTAGAMIE	VIL SHIOCTON	SHIOCTON	SW NE S29 23N 16E	541 TEMP	AREA FILES
LM	OUTAGAMIE	TN VANDENBROEK	VANDENBROEK	NE SE 02 21N 18E	506	ACTIVE SITE
LM	SHAWANO	DAN LEMHOUSE (WOOD)			WOOD	AREA FILES
LM	SHAWANO	TN ALMON	ALMON			LIC LOG 1970
LM	SHAWANO	TN ALMON	ALMON	SE SE 28 28N 12E	260	ACTIVE SITE
LM	SHAWANO	TN ANGELICA	ANGELICA	SW NE 09 26N 18E	649	ACTIVE SITE
LM	SHAWANO	HERBERT KRAUSE (WOOD)	ANGELICA	SE NE S08 26N 18E	WOOD	AREA FILES
LM	SHAWANO	CNTY SHAWANO-ANGELICA SITE	ANGELICA	NE NE 09 26N 18E	2728	ACTIVE SITE
LM	SHAWANO	TN ANIWA	ANIWA	SW NE 04 29N 11E	1243	ACTIVE SITE
LM 6	SHAWANO	TN ANIWA	ANIWA	SE NW S05 29N 11E	PRE-REG	H. SPENCER
LM	SHAWANO	VIL ANIWA	ANIWA	NE NW 07 29N 11E	566	ACTIVE SITE
LM	SHAWANO	VIL BOWLER	BARTELME	SW SW S29 28N 13E	966 TEMP	INACT. LOG 2/84

LM 5 = SITE ADDED TO LIST IN 1985.

4



HORTONVILLE MFG. CO., INC.

825 WEST MAIN STREET
HORTONVILLE, WISCONSIN 54944

November 24, 1980

Wisconsin Department National Resources
905 Bay Shore Dr.
Oshkosh, WI 54901

ATTN: Mr. Jim Chizek

Dear Mr. Chizek:

You will recall on August 26, 1980 we were involved in removing a liquid substance and surface soil from a ditch near our property. Your concern being this could be hazardous material and construed as an illegal spill.

We sent samples of the liquid substance and surface soil to Badger Laboratories in Appleton for analysis. A photo copy determining the final analysis of the two samples were submitted to you upon your request. A few weeks later I placed a phone call to you regarding disposal of this material. You informed me it was now out of your jurisdiction and a written report would have to come from Mr. Doug Rossburg, Green Bay DNR Office.

Since November 4, 1980, I have placed five phone calls to Mr. Rossburg and have yet to talk to him. Each time I leave my name and phone number for him to return my call, yet he has failed to do this. To this date we have never received any written documentation of any kind from the DNR regarding disposal of this substance. Since it has been almost three months since the DNR has received a written report of the substance and failed to contact us regarding disposal, I therefore feel the DNR does not consider this to be hazardous waste and we can dispose of this substance. If we do not receive written instructions in the very near future, we will properly dispose of this material.

Sincerely;

HORTONVILLE MFG. CO.

A large, stylized handwritten signature in black ink, appearing to read 'Thomas P. Zdrasil', is written over the typed name and title.

Thomas P. Zdrasil
Industrial Relations Manager

tpz/vs



BADGER LABORATORIES & ENGINEERING

CO.
INC.

1110 S. ONEIDA STREET • APPLETON, WISCONSIN 54911 • [414] 739-9213

Your Purchase Order No. H 17229.
One (1) Liquid Sample and
One (1) Soil Sample
Received August 26, 1980.

Our Report No. 9056.
Issued August 31, 1980.

HORTONVILLE MANUFACTURING COMPANY
825 West Main Street
Hortonville, WI 54944

Attention: Mr. Tom Zdrazil.

Request: Analyze the above samples for pollution from caustic and/or paint materials.

Results:

Liquid: (water)

Total Solids	484	ppm.
Dissolved solids	127	ppm.
Total Volatile solids	68	ppm. (14%)
Total nonvolatile solids	416	ppm. (86%)
pH	7.5	

A microscopic examination showed the ash to be light brown colored, small diameter particles. The ash was moderately soluble in 1 + 1 HCl. A strong qualitative aluminum test was noted on the resulting solution.

It is our opinion that the sample is water containing small diameter soil particles. The soil is predominantly clay. No evidence of paint or caustic was observed.

The soil sample was examined in a similar fashion. No evidence of paint or caustic was observed.

BADGER LABORATORIES & ENGINEERING

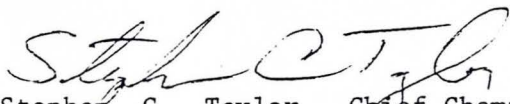
Stephen C. Taylor, Chief Chemist.

SCT:nj

Invoice enclosed.
P.O. Acknowledgment enclosed.



POTENTIAL HAZARDOUS WASTE SITE
PRELIMINARY ASSESSMENT
PART 1 - SITE INFORMATION AND ASSESSMENT

I. IDENTIFICATION

01 STATE: WI 02 SITE NUMBER: D980678163

II. SITE NAME AND LOCATION

01 SITE NAME (Legal, common, or descriptive name of site):
*(American Toy Co.)
Hortenville Mfg. Co. Inc.*

02 STREET, ROUTE NO., OR SPECIFIC LOCATION IDENTIFIER:
825 N. Main St. (Hwy. 45 & R.R.)

03 CITY: *Hortenville*

04 STATE: *WI* 05 ZIP CODE: *54944* 06 COUNTY: *Outagamie* 07 COUNTY CODE: *087* 08 CONG. DIST: *CA*

09 COORDINATES: LATITUDE: *44°20'13".0* LONGITUDE: *088°39'12".0*
*NW 1/4, SW 1/4, Sec. 35, T22N-R15E
Hortenville Quad.*

10 DIRECTIONS TO SITE (Starting from nearest public road):
Go west on U.S. Route 45, from the Town of Hortenville to the North Western R.R. It is located on the north west of this intersection.

III. RESPONSIBLE PARTIES

01 OWNER (if known): *American Toy & Furniture Co.* 02 STREET (Business, mailing, residential): *2605 N. Casaloma Dr.*

03 CITY: *Appleton* 04 STATE: *WI* 05 ZIP CODE: 06 TELEPHONE NUMBER: *(414)739-5702*

07 OPERATOR (if known and different from owner): *Tom Zdrazil, Industrial Relations Mgr.* 08 STREET (Business, mailing, residential): *825 W. Main St.*

09 CITY: *Hortenville* 10 STATE: *WI* 11 ZIP CODE: *54944* 12 TELEPHONE NUMBER: *(414)779-4661*

13 TYPE OF OWNERSHIP (Check one):
 A. PRIVATE B. FEDERAL: _____ (Agency name: _____) C. STATE D. COUNTY E. MUNICIPAL
 F. OTHER: _____ (Specify: _____) G. UNKNOWN

14 OWNER/OPERATOR NOTIFICATION ON FILE (Check all that apply):
 A. RCRA 3001 DATE RECEIVED: *8/15/80* MONTH DAY YEAR B. UNCONTROLLED WASTE SITE (CERCLA 103 c) DATE RECEIVED: _____ MONTH DAY YEAR C. NONE

IV. CHARACTERIZATION OF POTENTIAL HAZARD

01 ON SITE INSPECTION BY (Check all that apply):
 YES DATE: *11/7/80* MONTH DAY YEAR NO
 A. EPA B. EPA CONTRACTOR C. STATE D. OTHER CONTRACTOR
 E. LOCAL HEALTH OFFICIAL F. OTHER: _____ (Specify: _____)
CONTRACTOR NAME(S): _____

02 SITE STATUS (Check one):
 A. ACTIVE B. INACTIVE C. UNKNOWN

03 YEARS OF OPERATION: _____ BEGINNING YEAR _____ ENDING YEAR UNKNOWN

04 DESCRIPTION OF SUBSTANCES POSSIBLY PRESENT, KNOWN, OR ALLEGED:
Solvents (toxic/ignitable)

05 DESCRIPTION OF POTENTIAL HAZARD TO ENVIRONMENT AND/OR POPULATION:
None

V. PRIORITY ASSESSMENT

01 PRIORITY FOR INSPECTION (Check one. If high or medium is checked, complete Part 2 - Waste Information and Part 3 - Description of Hazardous Conditions and Incidents):
 A. HIGH (Inspection required promptly) B. MEDIUM (Inspection required) C. LOW (Inspect on time available basis) D. NONE (No further action needed, complete current disposition form)

VI. INFORMATION AVAILABLE FROM

01 CONTACT: *Deva Rossberg* 02 OF (Agency/Organization): *DNR/LMD* 03 TELEPHONE NUMBER: *(414)497-4047*

04 PERSON RESPONSIBLE FOR ASSESSMENT: *Mary B. Feenstra* 05 AGENCY: *DNR* 06 ORGANIZATION: *LMD* 07 TELEPHONE NUMBER: *(414)497-3228* 08 DATE: *7/17/84* MONTH DAY YEAR



POTENTIAL HAZARDOUS WASTE SITE
PRELIMINARY ASSESSMENT
PART 2 - WASTE INFORMATION

I. IDENTIFICATION

01 STATE | 02 SITE NUMBER
WI | D 980678163

II. WASTE STATES, QUANTITIES, AND CHARACTERISTICS

<p>01 PHYSICAL STATES (Check all that apply)</p> <p><input type="checkbox"/> A. SOLID <input type="checkbox"/> B. POWDER, FINES <input type="checkbox"/> C. SLUDGE <input type="checkbox"/> D. OTHER _____ (Specify)</p> <p><input type="checkbox"/> E. SLURRY <input checked="" type="checkbox"/> F. LIQUID <input type="checkbox"/> G. GAS</p>	<p>02 WASTE QUANTITY AT SITE (Measures of waste quantities must be independent)</p> <p>TONS _____</p> <p>CUBIC YARDS _____</p> <p>NO. OF DRUMS <u>4</u></p>	<p>03 WASTE CHARACTERISTICS (Check all that apply)</p> <p><input checked="" type="checkbox"/> A. TOXIC <input type="checkbox"/> B. CORROSIVE <input type="checkbox"/> C. RADIOACTIVE <input type="checkbox"/> D. PERSISTENT</p> <p><input type="checkbox"/> E. SOLUBLE <input type="checkbox"/> F. INFECTIOUS <input type="checkbox"/> G. FLAMMABLE <input checked="" type="checkbox"/> H. IGNITABLE</p> <p><input type="checkbox"/> I. HIGHLY VOLATILE <input type="checkbox"/> J. EXPLOSIVE <input type="checkbox"/> K. REACTIVE <input type="checkbox"/> L. INCOMPATIBLE <input type="checkbox"/> M. NOT APPLICABLE</p>
---	---	--

III. WASTE TYPE

CATEGORY	SUBSTANCE NAME	01 GROSS AMOUNT	02 UNIT OF MEASURE	03 COMMENTS
SLU	SLUDGE			
OLW	OILY WASTE			
SOL	SOLVENTS	approx. 300	gallons	of solvents, possibly spent
PSD	PESTICIDES			lacquer thinner.
OCC	OTHER ORGANIC CHEMICALS			0
IOC	INORGANIC CHEMICALS			
ACD	ACIDS			
BAS	BASES			
MES	HEAVY METALS			

IV. HAZARDOUS SUBSTANCES (See Appendix for most frequently cited CAS Numbers)

01 CATEGORY	02 SUBSTANCE NAME	03 CAS NUMBER	04 STORAGE/DISPOSAL METHOD	05 CONCENTRATION	06 MEASURE OF CONCENTRATION
SOH	(No analysis available)	—	spilled into standing water in ditch & pumped out.	—	—

V. FEEDSTOCKS (See Appendix for CAS Numbers)

CATEGORY	01 FEEDSTOCK NAME	02 CAS NUMBER	CATEGORY	01 FEEDSTOCK NAME	02 CAS NUMBER
FDS			FDS		
FDS			FDS		
FDS			FDS		
FDS			FDS		

VI. SOURCES OF INFORMATION (Cite specific references, e.g., state files, sample analysis, reports)

WI Dept. of Natural Resource - LMD, Oshkosh Area



POTENTIAL HAZARDOUS WASTE SITE
PRELIMINARY ASSESSMENT
PART 3 - DESCRIPTION OF HAZARDOUS CONDITIONS AND INCIDENTS

I. IDENTIFICATION
01 STATE: WI 02 SITE NUMBER: D980 678163

II. HAZARDOUS CONDITIONS AND INCIDENTS

01 A. GROUNDWATER CONTAMINATION 02 OBSERVED (DATE: _____) POTENTIAL ALLEGED
03 POPULATION POTENTIALLY AFFECTED: _____ 04 NARRATIVE DESCRIPTION

None

01 B. SURFACE WATER CONTAMINATION 02 OBSERVED (DATE: _____) POTENTIAL ALLEGED
03 POPULATION POTENTIALLY AFFECTED: _____ 04 NARRATIVE DESCRIPTION

None

01 C. CONTAMINATION OF AIR 02 OBSERVED (DATE: _____) POTENTIAL ALLEGED
03 POPULATION POTENTIALLY AFFECTED: _____ 04 NARRATIVE DESCRIPTION

None

01 D. FIRE/EXPLOSIVE CONDITIONS 02 OBSERVED (DATE: _____) POTENTIAL ALLEGED
03 POPULATION POTENTIALLY AFFECTED: _____ 04 NARRATIVE DESCRIPTION

None

01 E. DIRECT CONTACT 02 OBSERVED (DATE: _____) POTENTIAL ALLEGED
03 POPULATION POTENTIALLY AFFECTED: _____ 04 NARRATIVE DESCRIPTION

None

01 F. CONTAMINATION OF SOIL approx. 02 OBSERVED (DATE: 11-7-80) POTENTIAL ALLEGED
03 AREA POTENTIALLY AFFECTED: 0.10 (Acres.) 04 NARRATIVE DESCRIPTION

Contamination of soil may have occurred due to spill. Soil was removed.

01 G. DRINKING WATER CONTAMINATION 02 OBSERVED (DATE: _____) POTENTIAL ALLEGED
03 POPULATION POTENTIALLY AFFECTED: _____ 04 NARRATIVE DESCRIPTION

None

01 H. WORKER EXPOSURE/INJURY 02 OBSERVED (DATE: _____) POTENTIAL ALLEGED
03 WORKERS POTENTIALLY AFFECTED: _____ 04 NARRATIVE DESCRIPTION

None

01 I. POPULATION EXPOSURE/INJURY 02 OBSERVED (DATE: _____) POTENTIAL ALLEGED
03 POPULATION POTENTIALLY AFFECTED: _____ 04 NARRATIVE DESCRIPTION

None



POTENTIAL HAZARDOUS WASTE SITE
PRELIMINARY ASSESSMENT
PART 3 - DESCRIPTION OF HAZARDOUS CONDITIONS AND INCIDENTS

I. IDENTIFICATION

01 STATE 02 SITE NUMBER
WI D980678163

II. HAZARDOUS CONDITIONS AND INCIDENTS (Continued)

01 J. DAMAGE TO FLORA 02 OBSERVED (DATE: _____) POTENTIAL ALLEGED
04 NARRATIVE DESCRIPTION

None

01 K. DAMAGE TO FAUNA 02 OBSERVED (DATE: _____) POTENTIAL ALLEGED
04 NARRATIVE DESCRIPTION (include name(s) of species)

None

01 L. CONTAMINATION OF FOOD CHAIN 02 OBSERVED (DATE: _____) POTENTIAL ALLEGED
04 NARRATIVE DESCRIPTION

None

01 M. UNSTABLE CONTAINMENT OF WASTES 02 OBSERVED (DATE: 11-7-80) POTENTIAL ALLEGED
(Spills, runoff, standing liquids, leaking drums)

03 POPULATION POTENTIALLY AFFECTED: 0
04 NARRATIVE DESCRIPTION Spill of solvents into ditch,
Properly cleaned up. Spill was pumped out.

01 N. DAMAGE TO OFFSITE PROPERTY 02 OBSERVED (DATE: _____) POTENTIAL ALLEGED
04 NARRATIVE DESCRIPTION

None

01 O. CONTAMINATION OF SEWERS, STORM DRAINS, WWTPs 02 OBSERVED (DATE: _____) POTENTIAL ALLEGED
04 NARRATIVE DESCRIPTION

None

01 P. ILLEGAL/UNAUTHORIZED DUMPING 02 OBSERVED (DATE: _____) POTENTIAL ALLEGED
04 NARRATIVE DESCRIPTION

None

05 DESCRIPTION OF ANY OTHER KNOWN, POTENTIAL, OR ALLEGED HAZARDS

None

III. TOTAL POPULATION POTENTIALLY AFFECTED: 0

IV. COMMENTS

(See Preliminary Assessment Summary)

V. SOURCES OF INFORMATION (Cite specific references e.g., state files, sample analysis, reports)

WI Dept. of Natural Resources - LMD, Oshkosh Area

PRELIMINARY ASSESSMENT SUMMARY

Hortonville Mfg. Co. Inc. (American Toy Co.)

WI/D

825 W. Main Street

Background: Hortonville Mfg. Co. Inc. is a subsidiary of American Toy and Furniture Co. This facility manufactures wooden toys, kitchen accessories, home furnishings and nursery furniture.

Site Description: This facility is a generator of hazardous waste. It stores its spent lacquer thinners in 55 gallon drums outside the building near a ditch. At one time a spill occurred here, but was properly cleaned up.

Area Description: Hortonville Mfg. Co. Inc. is one of the leading industries in the Town of Hortonville, which is a small community lying in an agricultural area.

Site Priority and Comments: (None) This was a one-time spill which has been cleaned up. Because of the amount of spilled waste, removal of the spilled material and soil, it is believed that no contamination of any kind exists here. No further action is needed.

Site Inspection Contact Person: N/A

DNR District's Role on Site Inspection: N/A

Prepared by: Mary B. Feenstra DNR/LMD (414)497-3228

MBF:cs

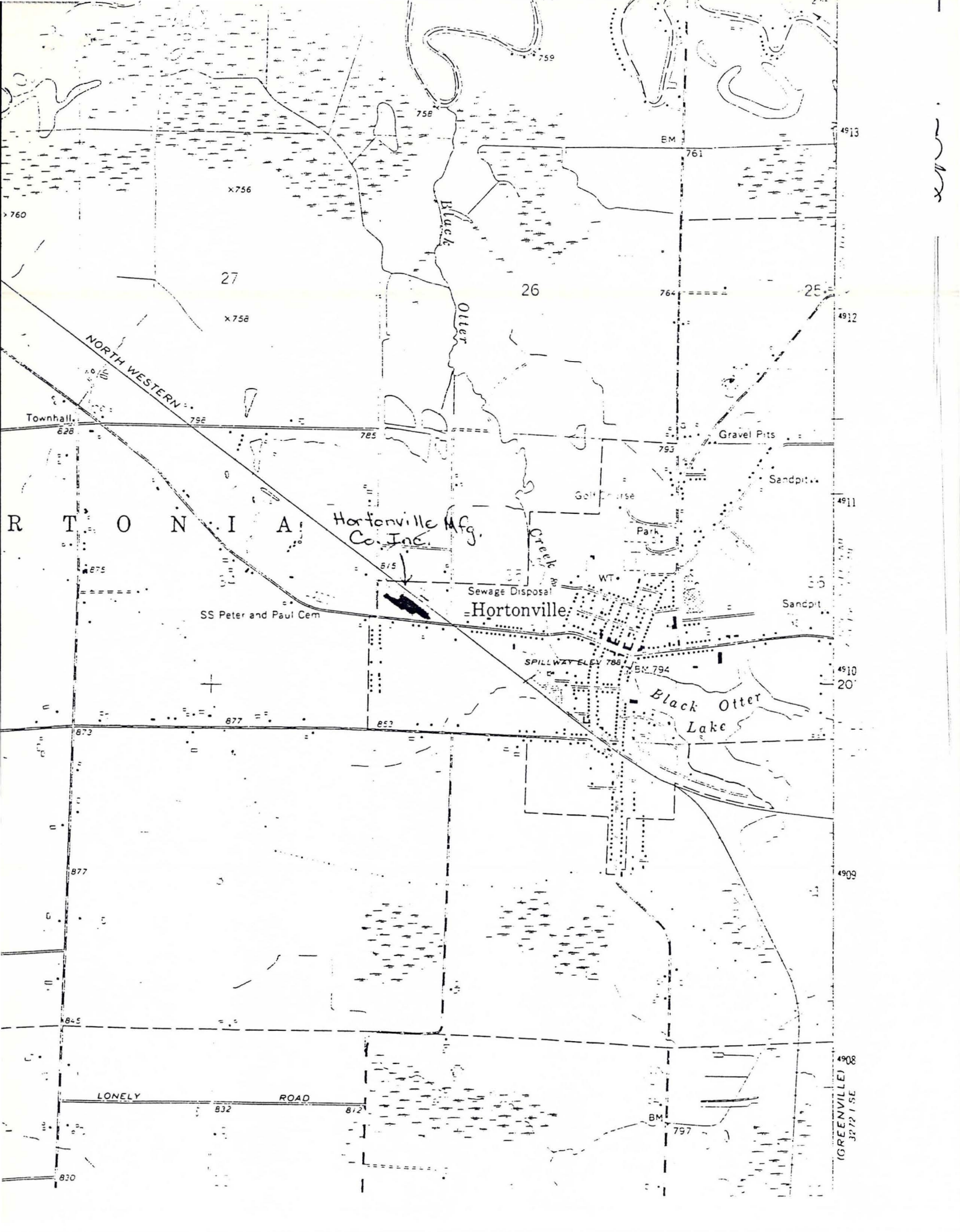

(GREENVILLE)
3272 1 SE