

246009170

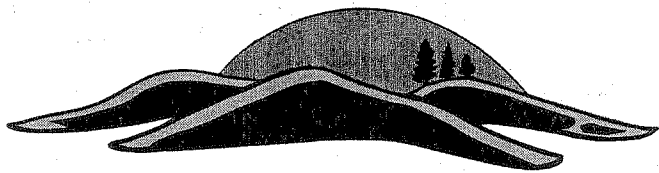

Moraine Environmental, Inc.

Environmental Management Services

Mr. Kerry DeKeyser
Environmental Manager
Tecumseh Products Company
1604 Michigan Avenue
New Holstein, WI 53061

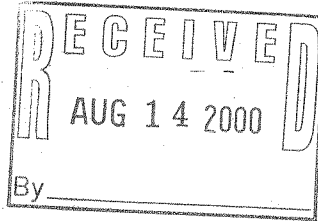

July 27, 2000
Proj. Ref. #1177

RE: Groundwater Sampling Summary Report (June / July, 2000)
Tecumseh Products Co., Grafton Operations

Dear Kerry:

Enclosed, please find a letter report (two copies) and supporting figures and documentation resulting from June / July, 2000 groundwater sample collection and analysis from specific monitoring wells located at and near the Tecumseh Products Company Operation in Grafton, Wisconsin. Repairs were made to the bladder pump controller allowing for groundwater sample collection from all of the wells in the monitoring program.

Please review the revised report and advise Moraine Environmental, Inc. of any necessary additional changes. If no changes are required, please forward a copy of the revised report to the WDNR. A copy has been sent to RMT, Inc. for review.

If you have any questions or comments, please call our office at (262) 377-9060.

Sincerely,

MORaine ENVIRONMENTAL, INC.

Steven Benton
Project Hydrogeologist

enc.

cc: Mr. Bernd Rehm - RMT, Inc.

E:\WORD\MSWTEH11\1177rep6letter.doc

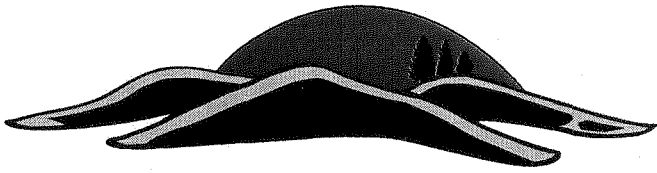

Moraine Environmental, Inc.

Environmental Management Services

July 27, 2000

Mr. John Feeney, Hydrogeologist
Wisconsin Department of Natural Resources
Southeast District - Annex Building
P.O. Box 12436
Milwaukee, WI 53212

Proj. Ref. #1177
FID#246009170

RE: **Biannual Groundwater Monitoring Results – June, 2000**
Tecumseh Products Company Facility, Grafton Operation

Dear John:

Moraine Environmental, Inc. (MEI) has been retained by the Tecumseh Products Company to provide technical field service to monitor groundwater quality on a biannual basis at the Tecumseh Products Company Grafton Operation. Consulting and engineering services continue to be provided by RMT, Inc. of Madison, Wisconsin.

This letter report was prepared to summarize the June, 2000 sampling and analysis of fourteen downgradient groundwater monitoring wells and three downgradient potable residential wells for Volatile Organic Compounds (VOCs). The analytical results are summarized in tabular form and previous sample results are provided for comparison purposes.

Accordingly, the following summarization is presented:

Sample Collection Methodologies

Sample collection from monitoring wells was performed on June 21, 2000. The following downgradient wells were purged and sampled for EPA Method 8260 VOCs analysis:

MW-3 BR	MW-18 BR(1)	MW-20 BR(2)
MW-3D	MW-18 BR(2)	MW-21 BR(1)
MW-9	MW-19 BR(1)	MW-21 BR(2)
MW-12	MW-19 BR(2)	MW-22 BR
MW-13 BR(2)	MW-20 BR(1)	

The locations of these wells are illustrated on the enclosed figure.

Private water supply wells PW-38 (Wendtland Property), PW-5 (Raess Property), and PW-30 (Heiser Property) were also sampled for VOCs on July 17, 2000.

Groundwater samples from monitoring wells MW-3D, MW-9, MW-12 and MW-22BR were purged and sampled using new, disposable teflon bailers. Samples were transferred into 40 milliliter (ml) vials, placed into an ice-filled cooler, and transported to the laboratory (EnChem, Inc.) for analysis. The remaining monitoring wells were sampled through dedicated multi-level bladder pump systems (Solinst Waterloo) installed during well construction. VOC groundwater samples were collected, stored, transported, and analyzed for 8260 VOCs by EnChem, Inc. Laboratories in Green Bay, Wisconsin. The private wells (PW-38, PW-5, and PW-30) were sampled by allowing the cold taps to run for a minimum of fifteen minutes to allow for aquifer water to enter the system, then reducing the flow volume (removing the faucet aerators) and collecting and storing the samples. During the past two sampling events, certain wells included in the monitoring program could not be sampled due to mechanical failure of the pump controller. The controller was repaired and all of the wells included in the sampling program have been sampled.

Analytical Results

All groundwater samples were analyzed for EPA Method 8260 VOCs by EnChem, Inc. of Green Bay, Wisconsin. The analytical results are summarized on the enclosed analytical results table. The laboratory reports are enclosed as Attachment A. Tables summarizing previous analytical results are enclosed as Attachment B to allow for a comparison of recent analytical results with previously acquired groundwater quality data. VOCs at concentrations exceeding Wisconsin Administrative Code Chapter NR 140 Groundwater Quality Enforcement Standards were detected in monitoring wells MW-3 BR, MW-9, MW-12, MW-13 BR (2), MW-18 BR (2), MW-19 BR(1), MW-19 BR(2), MW-20 BR (2), and MW-22 BR. Preventive Action Limits were slightly exceeded in MW-18 BR (1) and the private water supply wells (PW-38 and PW-30). The analytical results were similar to previously acquired analytical results.

Biannual samples will again be collected in December, 2000 or January, 2001. If you have any questions or concerns regarding this letter, the monitoring methodologies or results, please call our office at (262) 377-9060.

Sincerely,

MORAINÉ ENVIRONMENTAL, INC.

Steven Benton
Project Hydrogeologist



Kenneth G. Fries, P.E.
Technical Operations Manager

enc.

TECUMSEH MONITORING - GRAFTON FACILITY
GROUNDWATER LABORATORY RESULTS - JUNE 2000
(Detected Compounds Only)

Well Name	MW-3 BR	MW-3D	MW-9	MW-12	MW-13 BR (2)	MW-18 BR (1)	MW-18 BR (2)	MW-19 BR (1)	MW-19 BR (2)	MW-20 BR (1)	MW-20 BR (2)	MW-21 BR (1)	MW-21 BR (2)	MW-22 BR	Raess Residence PW-5	Wendtland Residence PW-38	Heiser Residence PW-30	Enforcement Standards	Preventive Action Limits
Sampling Date	6-21-00	6-21-00	6-21-00	6-21-00	6-21-00	6-21-00	6-21-00	6-21-00	6-21-00	6-21-00	6-21-00	6-21-00	6-21-00	6-21-00	7-17-00	7-17-00	7-17-00		
Chloroform	<0.29	<0.29	<2.9	<2.9	<0.72	<0.29	<0.29	<0.29	<0.29	<0.29	<0.29	<0.29	<0.29	<0.29	<0.29	<0.29	1.2	6.0	0.6
1,1-Dichloroethene	8.8	<0.85	74	<8.5	39	<0.85	7.8	5.1	<0.85	<0.85	<0.85	<0.85	<0.85	<0.85	<0.85	<0.85	<0.85	7.0	0.7
cis-1,2-Dichloroethene	21	<0.27	800	4.7	47	1.1	26	27	3.4	<0.27	<0.27	<0.27	<0.27	4.6	<0.27	<0.27	1.8	70	7.0
trans-1,2-Dichloroethene	<0.35	<0.35	15	<3.5	<0.87	<0.35	0.64	0.71	<0.35	<0.35	<0.35	<0.35	<0.35	<0.35	<0.35	<0.35	<0.35	100	20
1,1-Dichloroethane	44	7.1	220	10	220	2.2	43	52	6.9	<0.17	<0.17	<0.17	<0.17	1.1	<0.17	2.5	1.6	850	85
Toluene	<1.1	<1.1	<11	<11	<2.8	<1.1	<1.1	<1.1	<1.1	<1.1	<1.1	<1.1	<1.1	<1.1	<1.1	<1.1	<1.1	1,000	200
1,1,1-Trichloroethane	31	<0.21	660	61	380	<0.21	19	1.6	<0.21	<0.21	<0.21	<0.21	<0.21	<0.21	<0.21	1.8	<0.21	200	40
Trichloroethene	110	<0.32	1400	820	240	3.0	42	180	7.4	<0.32	<0.32	<0.32	<0.32	30	<0.32	1.9	2.4	5.0	0.5
Vinyl Chloride	0.60	<0.19	<1.9	<1.9	<0.47	<0.19	<0.19	0.94	2.7	<0.19	1.1	<0.19	<0.19	<0.19	<0.19	<0.19	<0.19	0.2	0.02

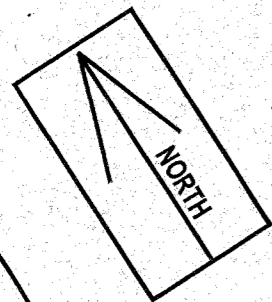
KEY: NA - Not Analyzed
NSE - No Standard Established
Bold - Exceeds PAL
Bold and Shaded - Exceeds ES
ES - Enforcement Standard
PAL - Preventive Action Limit
All results reported in ug/l (equivalent to parts per billion)



PW-38 (WENDTLAND)

PW-5 (RAESS)

MW-12 BR

MW-12 PW-30 (HEISER)

MW-13 BR

MW-9 / MW-9D

MW-3 BR

MW-3D

MW-22 BR

MW-18 BR

MW-19 BR

MW-20 BR

MW-21 BR

8th AVENUE

TECUMSEH - GRAFTON FACILITY

GREEN BAY ROAD

WASHINGTON STREET

12th AVENUE

GRAFTON AVENUE

17th AVENUE

MILWAUKEE RIVER

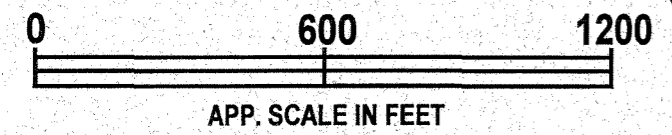

SAMPLED WELL LOCATIONS
TECUMSEH PRODUCTS CO., GRAFTON, WI

mon. well #1

Plymouth Foundry (steel factory)

Construction Forms

ATTACHMENT A
ANALYTICAL REPORTS

(Please Print Legibly)

Company Name: Morano Env. Inc.
 Branch or Location: Crafton Mt
 Project Contact: Steve Benton
 Telephone: (262) 377-4060
 Project Number: #1177
 Project Name: Tecumseh Products Co.
 Project State: Crafton Facility
 Sampled By (Print): Steve Benton



1241 Bellevue St., Suite 9
 Green Bay, WI 54302
 920-469-2436 • 1-800-736-2436
 FAX 920-469-8827

525 Science Drive
 Madison, WI 53711
 608-232-3300 • 1-888-536-2436
 FAX: 608-233-0502

1423 N. 8th Street, Suite 122
 Superior, WI 54880
 715-392-5844 • 1-800-837-8236
 FAX 715-392-5843

CHAIN OF CUSTODY

54309

Page 1 of 2

P.O. # _____ Quote # _____

Mail Report To: NET

Company: _____

Address: _____

Invoice To: NET

Company: _____

Address: _____

Mail Invoice To: NET

Data Package Options (please circle if requested)

QC Summary	Surcharge	Site-Specific QC Required?
EnChem Level II	Std. Delivery	Yes No
EnChem Level III	10% (min. \$50)	(If yes, indicate QC sample and submit triplicate volume.)
EnChem Level IV	25% (min. \$100)	

*Preservation Codes
 A=None B=HCL C=H2SO4 D=HNO3 E=EnCore F=Methanol G=NaOH

FILTERED? (YES/NO) N
 PRESERVATION (CODE)* B

ANALYSES REQUESTED
8260 VOC

LABORATORY ID (Lab Use Only)	FIELD ID	COLLECTION		MATRIX	COMMENTS	TOTAL BOTTLES (Lab Use Only)
		DATE	TIME			
001	MW-9	6-21-00		H ₂ O	C.C.	3
002	Duplicate				↓	
003	MW-13 BR(2)				2-B	
004	MW-19 BR(2)				C.C.	
005	MW-3-D				↓	
006	MW-22 BR				↓	
007	MW-12				↓	
008	MW-20 BR(1)				1-BWB	
009	MW-3 BR				C.C.	
010	MW-21 BR(2)				↓	
					NO TRIP	
					Blanks	

Turnaround Time Requested (TAT) (circle): Std (10 Bus. Days) Rush (Rush TAT subject to approval/surcharge) Quick Turn Number: _____ Date Needed: _____ Transmit Rush Results by (circle): Phone Fax Phone #: _____ Fax #: _____ Matrix Codes W=Water S=Soil A=Air C=Charcoal B=Biota Sl=Sludge Samples on HOLD are subject to special pricing and release of liability	Std. TAT Surcharge 1 day 3.0x 2 day 2.0x 3 day 1.5x 4 day 1.4x 5 day 1.3x	Relinquished By: <u>[Signature]</u> Date/Time: <u>6-20-00</u> Relinquished By: <u>[Signature]</u> Date/Time: <u>6-23-00</u> Relinquished By: <u>[Signature]</u> Date/Time: <u>6-23-00</u> Relinquished By: _____ Date/Time: _____ Relinquished By: _____ Date/Time: _____ Relinquished By: _____ Date/Time: _____	Received By: <u>[Signature]</u> Date/Time: <u>6-23-00</u> Received By: <u>[Signature]</u> Date/Time: <u>6/23/00</u> Received By: _____ Date/Time: _____ Received By: _____ Date/Time: _____ Received By: _____ Date/Time: _____	En Chem Project No. _____ Sample Receipt Temp. _____ Sample Receipt pH (Wet/Metal) _____ Custody Seal _____
--	--	--	---	--



1795 Industrial Drive
Green Bay, WI 54302
920-469-2436
800-7-ENCHEM
FAX: 920-469-8827

- Analytical Report -

Project Name : TECUMSEH PRODUCTS CO.

Project Number : #1177

Client: MORaine ENVIRONMENTAL INC

WI DNR LAB ID : 405132750

Sample No.	Field ID	Collection Date	Sample No.	Field ID	Collection Date
802943-001	MW-9	6/21/00			
802943-002	DUPLICATE	6/21/00			
802943-003	MW-13 BR(2)	6/21/00			
802943-004	MW-19 BR(2)	6/21/00			
802943-005	MW-3 D	6/21/00			
802943-006	MW-22 BR	6/21/00			
802943-007	MW-12	6/21/00			
802943-008	MW-20 BR(1)	6/21/00			
802943-009	MW-3 BR	6/21/00			
802943-010	MW-21 BR(2)	6/21/00			
802943-011	MW-21 BR(1)	6/21/00			
802943-012	MW-19 BR(1)	6/21/00			
802943-013	MW-18 BR(2)	6/21/00			
802943-014	MW-18 BR(1)	6/21/00			
802943-015	MW-20 BR(2)	6/21/00			

Please visit our Internet homepage at: www.encheminc.com

The "Q" flag is present when a parameter has been detected below the LOQ. This indicates the results are qualified due to the uncertainty of the parameter concentration between the LOD and the LOQ.

Soil VOC detects are corrected for the total solids, unless otherwise noted.

I certify that the data contained in this Final Report has been generated and reviewed in accordance with approved methods and Laboratory Standard Operating Procedure. Exceptions, if any, are discussed in the accompanying sample comments. Release of this final report is authorized by Laboratory management, as is verified by the following signature. Reported results shall not be reproduced, except in full, without the written approval of the lab. The sample results relate only to the analytes of interest tested.

Approval Signature

Date

- Analytical Report -

Project Name : TECUMSEH PRODUCTS CO.

Project Number : #1177

Client : MORaine ENVIRONMENTAL INC

Field ID : MW-9

Report Date : 7/7/00

Lab Sample Number : 802943-001

Collection Date : 6/21/00

WI DNR LAB ID : 405132750

Matrix Type : WATER

Organic Results**EPA 8260 VOLATILE LIST- WATER**

Prep Method: SW846 5030B Prep Date: 6/28/00 Analyst: HW

Analyte	Result	LOD	LOQ	EQL	Units	Code	Analysis Date	Analysis Method
Benzene	< 2.9	2.9	9.2		ug/L		6/29/00	SW846 8260B
Bromobenzene	< 3.5	3.5	11		ug/L		6/29/00	SW846 8260B
Bromochloromethane	< 5.6	5.6	18		ug/L		6/29/00	SW846 8260B
Bromodichloromethane	< 3.0	3.0	9.6		ug/L		6/29/00	SW846 8260B
Bromoform	< 2.4	2.4	7.6		ug/L		6/29/00	SW846 8260B
Bromomethane	< 6.2	6.2	20		ug/L		6/29/00	SW846 8260B
s-Butylbenzene	< 2.0	2.0	6.4		ug/L		6/29/00	SW846 8260B
t-Butylbenzene	< 2.3	2.3	7.3		ug/L		6/29/00	SW846 8260B
n-Butylbenzene	< 2.8	2.8	8.9		ug/L		6/29/00	SW846 8260B
Carbon tetrachloride	< 2.2	2.2	7.0		ug/L		6/29/00	SW846 8260B
Chloroform	< 2.9	2.9	9.2		ug/L		6/29/00	SW846 8260B
Chlorobenzene	< 1.9	1.9	6.1		ug/L		6/29/00	SW846 8260B
Chlorodibromomethane	< 28	28	89		ug/L		6/29/00	SW846 8260B
Chloroethane	< 4.6	4.6	15		ug/L		6/29/00	SW846 8260B
Chloromethane	< 4.2	4.2	13		ug/L		6/29/00	SW846 8260B
2-Chlorotoluene	< 1.9	1.9	6.1		ug/L		6/29/00	SW846 8260B
4-Chlorotoluene	< 2.1	2.1	6.7		ug/L		6/29/00	SW846 8260B
1,2-Dibromo-3-chloropropane	< 6.9	6.9	22		ug/L		6/29/00	SW846 8260B
1,2-Dibromoethane	< 4.2	4.2	13		ug/L		6/29/00	SW846 8260B
Dibromomethane	< 2.2	2.2	7.0		ug/L		6/29/00	SW846 8260B
1,3-Dichlorobenzene	< 1.2	1.2	3.8		ug/L		6/29/00	SW846 8260B
1,4-Dichlorobenzene	< 3.1	3.1	9.9		ug/L		6/29/00	SW846 8260B
1,2-Dichloroethane	< 2.1	2.1	6.7		ug/L		6/29/00	SW846 8260B
1,2-Dichlorobenzene	< 2.0	2.0	6.4		ug/L		6/29/00	SW846 8260B
1,1-Dichloroethene	74	8.5	27		ug/L		6/29/00	SW846 8260B
cis-1,2-Dichloroethene	800	2.7	8.6		ug/L		6/29/00	SW846 8260B
Dichlorodifluoromethane	< 1.2	1.2	3.8		ug/L		6/29/00	SW846 8260B
trans-1,2-Dichloroethene	15	3.5	11		ug/L		6/29/00	SW846 8260B
1,2-Dichloropropane	< 2.3	2.3	7.3		ug/L		6/29/00	SW846 8260B
1,1-Dichloroethane	220	1.7	5.4		ug/L		6/29/00	SW846 8260B
1,3-Dichloropropane	< 14	14	45		ug/L		6/29/00	SW846 8260B
2,2-Dichloropropane	< 2.8	2.8	8.9		ug/L		6/29/00	SW846 8260B

- Analytical Report -

Project Name : TECUMSEH PRODUCTS CO.

Project Number : #1177

Field ID : MW-9

Lab Sample Number : 802943-001

WI DNR LAB ID : 405132750

Client : MORaine ENVIRONMENTAL INC

Report Date : 7/7/00

Collection Date : 6/21/00

Matrix Type : WATER

1,1-Dichloropropene	< 4.6	4.6	15	ug/L	6/29/00	SW846 8260B
cis-1,3-Dichloropropene	< 2.3	2.3	7.3	ug/L	6/29/00	SW846 8260B
trans-1,3-Dichloropropene	< 2.3	2.3	7.3	ug/L	6/29/00	SW846 8260B
Diisopropyl ether	< 2.3	2.3	7.3	ug/L	6/29/00	SW846 8260B
Ethylbenzene	< 5.7	5.7	18	ug/L	6/29/00	SW846 8260B
Fluorotrichloromethane	< 3.1	3.1	9.9	ug/L	6/29/00	SW846 8260B
Hexachlorobutadiene	< 4.3	4.3	14	ug/L	6/29/00	SW846 8260B
Isopropylbenzene	< 1.9	1.9	6.1	ug/L	6/29/00	SW846 8260B
p-Isopropyltoluene	< 2.5	2.5	8.0	ug/L	6/29/00	SW846 8260B
Methylene chloride	< 3.6	3.6	11	ug/L	6/29/00	SW846 8260B
Methyl-tert-butyl-ether	< 2.0	2.0	6.4	ug/L	6/29/00	SW846 8260B
Naphthalene	< 2.7	2.7	8.6	ug/L	6/29/00	SW846 8260B
n-Propylbenzene	< 1.7	1.7	5.4	ug/L	6/29/00	SW846 8260B
Styrene	< 7.2	7.2	23	ug/L	6/29/00	SW846 8260B
1,1,2,2-Tetrachloroethane	< 2.2	2.2	7.0	ug/L	6/29/00	SW846 8260B
1,1,1,2-Tetrachloroethane	< 3.0	3.0	9.6	ug/L	6/29/00	SW846 8260B
Tetrachloroethene	< 8.5	8.5	27	ug/L	6/29/00	SW846 8260B
Toluene	< 11	11	35	ug/L	6/29/00	SW846 8260B
1,2,3-Trichlorobenzene	< 3.0	3.0	9.6	ug/L	6/29/00	SW846 8260B
1,2,4-Trichlorobenzene	< 2.4	2.4	7.6	ug/L	6/29/00	SW846 8260B
1,1,1-Trichloroethane	660	2.1	6.7	ug/L	6/29/00	SW846 8260B
1,1,2-Trichloroethane	< 3.3	3.3	11	ug/L	6/29/00	SW846 8260B
1,2,4-Trimethylbenzene	< 3.4	3.4	11	ug/L	6/29/00	SW846 8260B
Trichloroethene	1400	3.2	10	ug/L	6/29/00	SW846 8260B
1,2,3-Trichloropropane	< 8.9	8.9	28	ug/L	6/29/00	SW846 8260B
1,3,5-Trimethylbenzene	< 2.9	2.9	9.2	ug/L	6/29/00	SW846 8260B
Vinyl chloride	< 1.9	1.9	6.1	ug/L	6/29/00	SW846 8260B
Xylenes, -m, -p	< 3.5	3.5	11	ug/L	6/29/00	SW846 8260B
Xylene, -o	< 2.8	2.8	8.9	ug/L	6/29/00	SW846 8260B
4-Bromofluorobenzene	80			%Recov	6/29/00	SW846 8260B
Dibromofluoromethane	80			%Recov	6/29/00	SW846 8260B
Toluene-d8	88			%Recov	6/29/00	SW846 8260B

- Analytical Report -

Project Name : TECUMSEH PRODUCTS CO.

Project Number : #1177

Field ID : DUPLICATE

Lab Sample Number : 802943-002

WI DNR LAB ID : 405132750

Client : MORaine ENVIRONMENTAL INC

Report Date : 7/6/00

Collection Date : 6/21/00

Matrix Type : WATER

Organic Results

EPA 8260 VOLATILE LIST- WATER

Prep Method: SW846 5030B

Prep Date: 6/28/00

Analyst: HW

Analyte	Result	LOD	LOQ	EQL	Units	Code	Analysis Date	Analysis Method
Benzene	< 2.9	2.9	9.2		ug/L		6/29/00	SW846 8260B
Bromobenzene	< 3.5	3.5	11		ug/L		6/29/00	SW846 8260B
Bromochloromethane	< 5.6	5.6	18		ug/L		6/29/00	SW846 8260B
Bromodichloromethane	< 3.0	3.0	9.6		ug/L		6/29/00	SW846 8260B
Bromoform	< 2.4	2.4	7.6		ug/L		6/29/00	SW846 8260B
Bromomethane	< 6.2	6.2	20		ug/L		6/29/00	SW846 8260B
s-Butylbenzene	< 2.0	2.0	6.4		ug/L		6/29/00	SW846 8260B
t-Butylbenzene	< 2.3	2.3	7.3		ug/L		6/29/00	SW846 8260B
n-Butylbenzene	< 2.8	2.8	8.9		ug/L		6/29/00	SW846 8260B
Carbon tetrachloride	< 2.2	2.2	7.0		ug/L		6/29/00	SW846 8260B
Chloroform	< 2.9	2.9	9.2		ug/L		6/29/00	SW846 8260B
Chlorobenzene	< 1.9	1.9	6.1		ug/L		6/29/00	SW846 8260B
Chlorodibromomethane	< 28	28	89		ug/L		6/29/00	SW846 8260B
Chloroethane	< 4.6	4.6	15		ug/L		6/29/00	SW846 8260B
Chloromethane	< 4.2	4.2	13		ug/L		6/29/00	SW846 8260B
2-Chlorotoluene	< 1.9	1.9	6.1		ug/L		6/29/00	SW846 8260B
4-Chlorotoluene	< 2.1	2.1	6.7		ug/L		6/29/00	SW846 8260B
1,2-Dibromo-3-chloropropane	< 6.9	6.9	22		ug/L		6/29/00	SW846 8260B
1,2-Dibromoethane	< 4.2	4.2	13		ug/L		6/29/00	SW846 8260B
Dibromomethane	< 2.2	2.2	7.0		ug/L		6/29/00	SW846 8260B
1,3-Dichlorobenzene	< 1.2	1.2	3.8		ug/L		6/29/00	SW846 8260B
1,4-Dichlorobenzene	< 3.1	3.1	9.9		ug/L		6/29/00	SW846 8260B
1,2-Dichloroethane	< 2.1	2.1	6.7		ug/L		6/29/00	SW846 8260B
1,2-Dichlorobenzene	< 2.0	2.0	6.4		ug/L		6/29/00	SW846 8260B
1,1-Dichloroethene	120	8.5	27		ug/L		6/29/00	SW846 8260B
cis-1,2-Dichloroethene	760	2.7	8.6		ug/L		6/29/00	SW846 8260B
Dichlorodifluoromethane	< 1.2	1.2	3.8		ug/L		6/29/00	SW846 8260B
trans-1,2-Dichloroethene	13	3.5	11		ug/L		6/29/00	SW846 8260B
1,2-Dichloropropane	< 2.3	2.3	7.3		ug/L		6/29/00	SW846 8260B
1,1-Dichloroethane	290	1.7	5.4		ug/L		6/29/00	SW846 8260B
1,3-Dichloropropane	< 14	14	45		ug/L		6/29/00	SW846 8260B
2,2-Dichloropropane	< 2.8	2.8	8.9		ug/L		6/29/00	SW846 8260B

- Analytical Report -

Project Name : TECUMSEH PRODUCTS CO.

Project Number : #1177

Field ID : DUPLICATE

Lab Sample Number : 802943-002

WI DNR LAB ID : 405132750

Client : MORaine ENVIRONMENTAL INC

Report Date : 7/6/00

Collection Date : 6/21/00

Matrix Type : WATER

1,1-Dichloropropene	< 4.6	4.6	15	ug/L	6/29/00	SW846 8260B
cis-1,3-Dichloropropene	< 2.3	2.3	7.3	ug/L	6/29/00	SW846 8260B
trans-1,3-Dichloropropene	< 2.3	2.3	7.3	ug/L	6/29/00	SW846 8260B
Diisopropyl ether	< 2.3	2.3	7.3	ug/L	6/29/00	SW846 8260B
Ethylbenzene	< 5.7	5.7	18	ug/L	6/29/00	SW846 8260B
Fluorotrichloromethane	< 3.1	3.1	9.9	ug/L	6/29/00	SW846 8260B
Hexachlorobutadiene	< 4.3	4.3	14	ug/L	6/29/00	SW846 8260B
Isopropylbenzene	< 1.9	1.9	6.1	ug/L	6/29/00	SW846 8260B
p-Isopropyltoluene	< 2.5	2.5	8.0	ug/L	6/29/00	SW846 8260B
Methylene chloride	< 3.6	3.6	11	ug/L	6/29/00	SW846 8260B
Methyl-tert-butyl-ether	< 2.0	2.0	6.4	ug/L	6/29/00	SW846 8260B
Naphthalene	< 2.7	2.7	8.6	ug/L	6/29/00	SW846 8260B
n-Propylbenzene	< 1.7	1.7	5.4	ug/L	6/29/00	SW846 8260B
Styrene	< 7.2	7.2	23	ug/L	6/29/00	SW846 8260B
1,1,2,2-Tetrachloroethane	< 2.2	2.2	7.0	ug/L	6/29/00	SW846 8260B
1,1,1,2-Tetrachloroethane	< 3.0	3.0	9.6	ug/L	6/29/00	SW846 8260B
Tetrachloroethene	< 8.5	8.5	27	ug/L	6/29/00	SW846 8260B
Toluene	< 11	11	35	ug/L	6/29/00	SW846 8260B
1,2,3-Trichlorobenzene	< 3.0	3.0	9.6	ug/L	6/29/00	SW846 8260B
1,2,4-Trichlorobenzene	< 2.4	2.4	7.6	ug/L	6/29/00	SW846 8260B
1,1,1-Trichloroethane	870	2.1	6.7	ug/L	6/29/00	SW846 8260B
1,1,2-Trichloroethane	< 3.3	3.3	11	ug/L	6/29/00	SW846 8260B
1,2,4-Trimethylbenzene	< 3.4	3.4	11	ug/L	6/29/00	SW846 8260B
Trichloroethene	1500	3.2	10	ug/L	6/29/00	SW846 8260B
1,2,3-Trichloropropane	< 8.9	8.9	28	ug/L	6/29/00	SW846 8260B
1,3,5-Trimethylbenzene	< 2.9	2.9	9.2	ug/L	6/29/00	SW846 8260B
Vinyl chloride	< 1.9	1.9	6.1	ug/L	6/29/00	SW846 8260B
Xylenes, -m, -p	< 3.5	3.5	11	ug/L	6/29/00	SW846 8260B
Xylene, -o	< 2.8	2.8	8.9	ug/L	6/29/00	SW846 8260B
4-Bromofluorobenzene	78			%Recov	6/29/00	SW846 8260B
Dibromofluoromethane	81			%Recov	6/29/00	SW846 8260B
Toluene-d8	89			%Recov	6/29/00	SW846 8260B

- Analytical Report -

Project Name : TECUMSEH PRODUCTS CO.

Project Number : #1177

Client : MORaine ENVIRONMENTAL INC

Field ID : MW-13 BR(2)

Report Date : 6/29/00

Lab Sample Number : 802943-003

Collection Date : 6/21/00

WI DNR LAB ID : 405132750

Matrix Type : WATER

Organic Results

EPA 8260 VOLATILE LIST- WATER

Prep Method: SW846 5030B

Prep Date: 6/28/00

Analyst: JJB

Analyte	Result	LOD	LOQ	EQL	Units	Code	Analysis Date	Analysis Method
Benzene	< 0.72	0.72	2.3		ug/L		6/28/00	SW846 8260B
Bromobenzene	< 0.87	0.87	2.8		ug/L		6/28/00	SW846 8260B
Bromochloromethane	< 1.4	1.4	4.5		ug/L		6/28/00	SW846 8260B
Bromodichloromethane	< 0.75	0.75	2.4		ug/L		6/28/00	SW846 8260B
Bromoform	< 0.60	0.60	1.9		ug/L		6/28/00	SW846 8260B
Bromomethane	< 1.6	1.6	5.1		ug/L		6/28/00	SW846 8260B
s-Butylbenzene	< 0.50	0.50	1.6		ug/L		6/28/00	SW846 8260B
t-Butylbenzene	< 0.58	0.58	1.8		ug/L		6/28/00	SW846 8260B
n-Butylbenzene	< 0.70	0.70	2.2		ug/L		6/28/00	SW846 8260B
Carbon tetrachloride	< 0.55	0.55	1.8		ug/L		6/28/00	SW846 8260B
Chloroform	< 0.72	0.72	2.3		ug/L		6/28/00	SW846 8260B
Chlorobenzene	< 0.47	0.47	1.5		ug/L		6/28/00	SW846 8260B
Chlorodibromomethane	< 7.0	7.0	22		ug/L		6/28/00	SW846 8260B
Chloroethane	< 1.2	1.2	3.8		ug/L		6/28/00	SW846 8260B
Chloromethane	< 1.1	1.1	3.5		ug/L		6/28/00	SW846 8260B
2-Chlorotoluene	< 0.47	0.47	1.5		ug/L		6/28/00	SW846 8260B
4-Chlorotoluene	< 0.53	0.53	1.7		ug/L		6/28/00	SW846 8260B
1,2-Dibromo-3-chloropropane	< 1.7	1.7	5.4		ug/L		6/28/00	SW846 8260B
1,2-Dibromoethane	< 1.1	1.1	3.5		ug/L		6/28/00	SW846 8260B
Dibromomethane	< 0.55	0.55	1.8		ug/L		6/28/00	SW846 8260B
1,3-Dichlorobenzene	< 0.30	0.30	0.96		ug/L		6/28/00	SW846 8260B
1,4-Dichlorobenzene	< 0.78	0.78	2.5		ug/L		6/28/00	SW846 8260B
1,2-Dichloroethane	< 0.53	0.53	1.7		ug/L		6/28/00	SW846 8260B
1,2-Dichlorobenzene	< 0.50	0.50	1.6		ug/L		6/28/00	SW846 8260B
1,1-Dichloroethene	39	2.1	6.7		ug/L		6/28/00	SW846 8260B
cis-1,2-Dichloroethene	47	0.68	2.2		ug/L		6/28/00	SW846 8260B
Dichlorodifluoromethane	< 0.30	0.30	0.96		ug/L		6/28/00	SW846 8260B
trans-1,2-Dichloroethene	< 0.87	0.87	2.8		ug/L		6/28/00	SW846 8260B
1,2-Dichloropropane	< 0.58	0.58	1.8		ug/L		6/28/00	SW846 8260B
1,1-Dichloroethane	220	0.43	1.4		ug/L		6/28/00	SW846 8260B
1,3-Dichloropropane	< 3.5	3.5	11		ug/L		6/28/00	SW846 8260B
2,2-Dichloropropane	< 0.70	0.70	2.2		ug/L		6/28/00	SW846 8260B

- Analytical Report -

Project Name : TECUMSEH PRODUCTS CO.

Project Number : #1177

Field ID : MW-13 BR(2)

Lab Sample Number : 802943-003

WI DNR LAB ID : 405132750

Client : MORaine ENVIRONMENTAL INC

Report Date : 6/29/00

Collection Date : 6/21/00

Matrix Type : WATER

1,1-Dichloropropene	< 1.2	1.2	3.8	ug/L	6/28/00	SW846 8260B
cis-1,3-Dichloropropene	< 0.58	0.58	1.8	ug/L	6/28/00	SW846 8260B
trans-1,3-Dichloropropene	< 0.58	0.58	1.8	ug/L	6/28/00	SW846 8260B
Diisopropyl ether	< 0.58	0.58	1.8	ug/L	6/28/00	SW846 8260B
Ethylbenzene	< 1.4	1.4	4.5	ug/L	6/28/00	SW846 8260B
Fluorotrichloromethane	< 0.78	0.78	2.5	ug/L	6/28/00	SW846 8260B
Hexachlorobutadiene	< 1.1	1.1	3.5	ug/L	6/28/00	SW846 8260B
Isopropylbenzene	< 0.47	0.47	1.5	ug/L	6/28/00	SW846 8260B
p-Isopropyltoluene	< 0.62	0.62	2.0	ug/L	6/28/00	SW846 8260B
Methylene chloride	< 0.90	0.90	2.9	ug/L	6/28/00	SW846 8260B
Methyl-tert-butyl-ether	< 0.50	0.50	1.6	ug/L	6/28/00	SW846 8260B
Naphthalene	< 0.68	0.68	2.2	ug/L	6/28/00	SW846 8260B
n-Propylbenzene	< 0.43	0.43	1.4	ug/L	6/28/00	SW846 8260B
Styrene	< 1.8	1.8	5.7	ug/L	6/28/00	SW846 8260B
1,1,2,2-Tetrachloroethane	< 0.55	0.55	1.8	ug/L	6/28/00	SW846 8260B
1,1,1,2-Tetrachloroethane	< 0.75	0.75	2.4	ug/L	6/28/00	SW846 8260B
Tetrachloroethene	< 2.1	2.1	6.7	ug/L	6/28/00	SW846 8260B
Toluene	< 2.8	2.8	8.9	ug/L	6/28/00	SW846 8260B
1,2,3-Trichlorobenzene	< 0.75	0.75	2.4	ug/L	6/28/00	SW846 8260B
1,2,4-Trichlorobenzene	< 0.60	0.60	1.9	ug/L	6/28/00	SW846 8260B
1,1,1-Trichloroethane	380	0.53	1.7	ug/L	6/28/00	SW846 8260B
1,1,2-Trichloroethane	< 0.83	0.83	2.6	ug/L	6/28/00	SW846 8260B
1,2,4-Trimethylbenzene	< 0.85	0.85	2.7	ug/L	6/28/00	SW846 8260B
Trichloroethene	240	0.80	2.5	ug/L	6/28/00	SW846 8260B
1,2,3-Trichloropropane	< 2.2	2.2	7.0	ug/L	6/28/00	SW846 8260B
1,3,5-Trimethylbenzene	< 0.72	0.72	2.3	ug/L	6/28/00	SW846 8260B
Vinyl chloride	< 0.47	0.47	1.5	ug/L	6/28/00	SW846 8260B
Xylenes, -m, -p	< 0.87	0.87	2.8	ug/L	6/28/00	SW846 8260B
Xylene, -o	< 0.70	0.70	2.2	ug/L	6/28/00	SW846 8260B
4-Bromofluorobenzene	87			%Recov	6/28/00	SW846 8260B
Dibromofluoromethane	92			%Recov	6/28/00	SW846 8260B
Toluene-d8	91			%Recov	6/28/00	SW846 8260B

- Analytical Report -

Project Name : TECUMSEH PRODUCTS CO.

Project Number : #1177

Client : MORAIN ENVIRONMENTAL INC

Field ID : MW-19 BR(2)

Report Date : 6/28/00

Lab Sample Number : 802943-004

Collection Date : 6/21/00

WI DNR LAB ID : 405132750

Matrix Type : WATER

Organic Results

EPA 8260 VOLATILE LIST- WATER

Prep Method: SW846 5030B

Prep Date: 6/27/00

Analyst: HW

Analyte	Result	LOD	LOQ	EQL	Units	Code	Analysis Date	Analysis Method
Benzene	< 0.29	0.29	0.92		ug/L		6/27/00	SW846 8260B
Bromobenzene	< 0.35	0.35	1.1		ug/L		6/27/00	SW846 8260B
Bromochloromethane	< 0.56	0.56	1.8		ug/L		6/27/00	SW846 8260B
Bromodichloromethane	< 0.30	0.30	0.96		ug/L		6/27/00	SW846 8260B
Bromoform	< 0.24	0.24	0.76		ug/L		6/27/00	SW846 8260B
Bromomethane	< 0.62	0.62	2.0		ug/L		6/27/00	SW846 8260B
s-Butylbenzene	< 0.20	0.20	0.64		ug/L		6/27/00	SW846 8260B
t-Butylbenzene	< 0.23	0.23	0.73		ug/L		6/27/00	SW846 8260B
n-Butylbenzene	< 0.28	0.28	0.89		ug/L		6/27/00	SW846 8260B
Carbon tetrachloride	< 0.22	0.22	0.70		ug/L		6/27/00	SW846 8260B
Chloroform	< 0.29	0.29	0.92		ug/L		6/27/00	SW846 8260B
Chlorobenzene	< 0.19	0.19	0.61		ug/L		6/27/00	SW846 8260B
Chlorodibromomethane	< 2.8	2.8	8.9		ug/L		6/27/00	SW846 8260B
Chloroethane	0.74	0.46	1.5		ug/L	Q	6/27/00	SW846 8260B
Chloromethane	< 0.42	0.42	1.3		ug/L		6/27/00	SW846 8260B
2-Chlorotoluene	< 0.19	0.19	0.61		ug/L		6/27/00	SW846 8260B
4-Chlorotoluene	< 0.21	0.21	0.67		ug/L		6/27/00	SW846 8260B
1,2-Dibromo-3-chloropropane	< 0.69	0.69	2.2		ug/L		6/27/00	SW846 8260B
1,2-Dibromoethane	< 0.42	0.42	1.3		ug/L		6/27/00	SW846 8260B
Dibromomethane	< 0.22	0.22	0.70		ug/L		6/27/00	SW846 8260B
1,3-Dichlorobenzene	< 0.12	0.12	0.38		ug/L		6/27/00	SW846 8260B
1,4-Dichlorobenzene	< 0.31	0.31	0.99		ug/L		6/27/00	SW846 8260B
1,2-Dichloroethane	< 0.21	0.21	0.67		ug/L		6/27/00	SW846 8260B
1,2-Dichlorobenzene	< 0.20	0.20	0.64		ug/L		6/27/00	SW846 8260B
1,1-Dichloroethene	< 0.85	0.85	2.7		ug/L		6/27/00	SW846 8260B
cis-1,2-Dichloroethene	3.4	0.27	0.86		ug/L		6/27/00	SW846 8260B
Dichlorodifluoromethane	< 0.12	0.12	0.38		ug/L		6/27/00	SW846 8260B
trans-1,2-Dichloroethene	< 0.35	0.35	1.1		ug/L		6/27/00	SW846 8260B
1,2-Dichloropropane	< 0.23	0.23	0.73		ug/L		6/27/00	SW846 8260B
1,1-Dichloroethane	6.9	0.17	0.54		ug/L		6/27/00	SW846 8260B
1,3-Dichloropropane	< 1.4	1.4	4.5		ug/L		6/27/00	SW846 8260B
2,2-Dichloropropane	< 0.28	0.28	0.89		ug/L		6/27/00	SW846 8260B

- Analytical Report -

Project Name : TECUMSEH PRODUCTS CO.

Project Number : #1177

Field ID : MW-19 BR(2)

Lab Sample Number : 802943-004

WI DNR LAB ID : 405132750

Client : MORAINÉ ENVIRONMENTAL INC

Report Date : 6/28/00

Collection Date : 6/21/00

Matrix Type : WATER

1,1-Dichloropropene	< 0.46	0.46	1.5	ug/L	6/27/00	SW846 8260B
cis-1,3-Dichloropropene	< 0.23	0.23	0.73	ug/L	6/27/00	SW846 8260B
trans-1,3-Dichloropropene	< 0.23	0.23	0.73	ug/L	6/27/00	SW846 8260B
Diisopropyl ether	< 0.23	0.23	0.73	ug/L	6/27/00	SW846 8260B
Ethylbenzene	< 0.57	0.57	1.8	ug/L	6/27/00	SW846 8260B
Fluorotrichloromethane	< 0.31	0.31	0.99	ug/L	6/27/00	SW846 8260B
Hexachlorobutadiene	< 0.43	0.43	1.4	ug/L	6/27/00	SW846 8260B
Isopropylbenzene	< 0.19	0.19	0.61	ug/L	6/27/00	SW846 8260B
p-Isopropyltoluene	< 0.25	0.25	0.80	ug/L	6/27/00	SW846 8260B
Methylene chloride	< 0.36	0.36	1.1	ug/L	6/27/00	SW846 8260B
Methyl-tert-butyl-ether	< 0.20	0.20	0.64	ug/L	6/27/00	SW846 8260B
Naphthalene	< 0.27	0.27	0.86	ug/L	6/27/00	SW846 8260B
n-Propylbenzene	< 0.17	0.17	0.54	ug/L	6/27/00	SW846 8260B
Styrene	< 0.72	0.72	2.3	ug/L	6/27/00	SW846 8260B
1,1,2,2-Tetrachloroethane	< 0.22	0.22	0.70	ug/L	6/27/00	SW846 8260B
1,1,1,2-Tetrachloroethane	< 0.30	0.30	0.96	ug/L	6/27/00	SW846 8260B
Tetrachloroethene	< 0.85	0.85	2.7	ug/L	6/27/00	SW846 8260B
Toluene	< 1.1	1.1	3.5	ug/L	6/27/00	SW846 8260B
1,2,3-Trichlorobenzene	< 0.30	0.30	0.96	ug/L	6/27/00	SW846 8260B
1,2,4-Trichlorobenzene	< 0.24	0.24	0.76	ug/L	6/27/00	SW846 8260B
1,1,1-Trichloroethane	< 0.21	0.21	0.67	ug/L	6/27/00	SW846 8260B
1,1,2-Trichloroethane	< 0.33	0.33	1.1	ug/L	6/27/00	SW846 8260B
1,2,4-Trimethylbenzene	< 0.34	0.34	1.1	ug/L	6/27/00	SW846 8260B
Trichloroethene	7.4	0.32	1.0	ug/L	6/27/00	SW846 8260B
1,2,3-Trichloropropane	< 0.89	0.89	2.8	ug/L	6/27/00	SW846 8260B
1,3,5-Trimethylbenzene	< 0.29	0.29	0.92	ug/L	6/27/00	SW846 8260B
Vinyl chloride	2.7	0.19	0.61	ug/L	6/27/00	SW846 8260B
Xylenes, -m, -p	< 0.35	0.35	1.1	ug/L	6/27/00	SW846 8260B
Xylene, -o	< 0.28	0.28	0.89	ug/L	6/27/00	SW846 8260B
4-Bromofluorobenzene	98			%Recov	6/27/00	SW846 8260B
Dibromofluoromethane	93			%Recov	6/27/00	SW846 8260B
Toluene-d8	109			%Recov	6/27/00	SW846 8260B

- Analytical Report -

Project Name : TECUMSEH PRODUCTS CO.

Project Number : #1177

Field ID : MW-3 D

Lab Sample Number : 802943-005

WI DNR LAB ID : 405132750

Client : MORAIN ENVIRONMENTAL INC

Report Date : 6/28/00

Collection Date : 6/21/00

Matrix Type : WATER

Organic Results

EPA 8260 VOLATILE LIST- WATER

Prep Method: SW846 5030B

Prep Date: 6/27/00

Analyst: HW

Analyte	Result	LOD	LOQ	EQL	Units	Code	Analysis Date	Analysis Method
Benzene	< 0.29	0.29	0.92		ug/L		6/27/00	SW846 8260B
Bromobenzene	< 0.35	0.35	1.1		ug/L		6/27/00	SW846 8260B
Bromochloromethane	< 0.56	0.56	1.8		ug/L		6/27/00	SW846 8260B
Bromodichloromethane	< 0.30	0.30	0.96		ug/L		6/27/00	SW846 8260B
Bromoform	< 0.24	0.24	0.76		ug/L		6/27/00	SW846 8260B
Bromomethane	< 0.62	0.62	2.0		ug/L		6/27/00	SW846 8260B
s-Butylbenzene	< 0.20	0.20	0.64		ug/L		6/27/00	SW846 8260B
t-Butylbenzene	< 0.23	0.23	0.73		ug/L		6/27/00	SW846 8260B
n-Butylbenzene	< 0.28	0.28	0.89		ug/L		6/27/00	SW846 8260B
Carbon tetrachloride	< 0.22	0.22	0.70		ug/L		6/27/00	SW846 8260B
Chloroform	< 0.29	0.29	0.92		ug/L		6/27/00	SW846 8260B
Chlorobenzene	< 0.19	0.19	0.61		ug/L		6/27/00	SW846 8260B
Chlorodibromomethane	< 2.8	2.8	8.9		ug/L		6/27/00	SW846 8260B
Chloroethane	< 0.46	0.46	1.5		ug/L		6/27/00	SW846 8260B
Chloromethane	< 0.42	0.42	1.3		ug/L		6/27/00	SW846 8260B
2-Chlorotoluene	< 0.19	0.19	0.61		ug/L		6/27/00	SW846 8260B
4-Chlorotoluene	< 0.21	0.21	0.67		ug/L		6/27/00	SW846 8260B
1,2-Dibromo-3-chloropropane	< 0.69	0.69	2.2		ug/L		6/27/00	SW846 8260B
1,2-Dibromoethane	< 0.42	0.42	1.3		ug/L		6/27/00	SW846 8260B
Dibromomethane	< 0.22	0.22	0.70		ug/L		6/27/00	SW846 8260B
1,3-Dichlorobenzene	< 0.12	0.12	0.38		ug/L		6/27/00	SW846 8260B
1,4-Dichlorobenzene	< 0.31	0.31	0.99		ug/L		6/27/00	SW846 8260B
1,2-Dichloroethane	< 0.21	0.21	0.67		ug/L		6/27/00	SW846 8260B
1,2-Dichlorobenzene	< 0.20	0.20	0.64		ug/L		6/27/00	SW846 8260B
1,1-Dichloroethene	< 0.85	0.85	2.7		ug/L		6/27/00	SW846 8260B
cis-1,2-Dichloroethene	< 0.27	0.27	0.86		ug/L		6/27/00	SW846 8260B
Dichlorodifluoromethane	< 0.12	0.12	0.38		ug/L		6/27/00	SW846 8260B
trans-1,2-Dichloroethene	< 0.35	0.35	1.1		ug/L		6/27/00	SW846 8260B
1,2-Dichloropropane	< 0.23	0.23	0.73		ug/L		6/27/00	SW846 8260B
1,1-Dichloroethane	7.1	0.17	0.54		ug/L		6/27/00	SW846 8260B
1,3-Dichloropropane	< 1.4	1.4	4.5		ug/L		6/27/00	SW846 8260B
2,2-Dichloropropane	< 0.28	0.28	0.89		ug/L		6/27/00	SW846 8260B

- Analytical Report -

Project Name : TECUMSEH PRODUCTS CO.

Project Number : #1177

Client : MORAINÉ ENVIRONMENTAL INC

Field ID : MW-3 D

Report Date : 6/28/00

Lab Sample Number : 802943-005

Collection Date : 6/21/00

WI DNR LAB ID : 405132750

Matrix Type : WATER

1,1-Dichloropropene	< 0.46	0.46	1.5	ug/L	6/27/00	SW846 8260B
cis-1,3-Dichloropropene	< 0.23	0.23	0.73	ug/L	6/27/00	SW846 8260B
trans-1,3-Dichloropropene	< 0.23	0.23	0.73	ug/L	6/27/00	SW846 8260B
Diisopropyl ether	< 0.23	0.23	0.73	ug/L	6/27/00	SW846 8260B
Ethylbenzene	< 0.57	0.57	1.8	ug/L	6/27/00	SW846 8260B
Fluorotrichloromethane	< 0.31	0.31	0.99	ug/L	6/27/00	SW846 8260B
Hexachlorobutadiene	< 0.43	0.43	1.4	ug/L	6/27/00	SW846 8260B
Isopropylbenzene	< 0.19	0.19	0.61	ug/L	6/27/00	SW846 8260B
p-Isopropyltoluene	< 0.25	0.25	0.80	ug/L	6/27/00	SW846 8260B
Methylene chloride	< 0.36	0.36	1.1	ug/L	6/27/00	SW846 8260B
Methyl-tert-butyl-ether	< 0.20	0.20	0.64	ug/L	6/27/00	SW846 8260B
Naphthalene	< 0.27	0.27	0.86	ug/L	6/27/00	SW846 8260B
n-Propylbenzene	< 0.17	0.17	0.54	ug/L	6/27/00	SW846 8260B
Styrene	< 0.72	0.72	2.3	ug/L	6/27/00	SW846 8260B
1,1,2,2-Tetrachloroethane	< 0.22	0.22	0.70	ug/L	6/27/00	SW846 8260B
1,1,1,2-Tetrachloroethane	< 0.30	0.30	0.96	ug/L	6/27/00	SW846 8260B
Tetrachloroethene	< 0.85	0.85	2.7	ug/L	6/27/00	SW846 8260B
Toluene	< 1.1	1.1	3.5	ug/L	6/27/00	SW846 8260B
1,2,3-Trichlorobenzene	< 0.30	0.30	0.96	ug/L	6/27/00	SW846 8260B
1,2,4-Trichlorobenzene	< 0.24	0.24	0.76	ug/L	6/27/00	SW846 8260B
1,1,1-Trichloroethane	< 0.21	0.21	0.67	ug/L	6/27/00	SW846 8260B
1,1,2-Trichloroethane	< 0.33	0.33	1.1	ug/L	6/27/00	SW846 8260B
1,2,4-Trimethylbenzene	< 0.34	0.34	1.1	ug/L	6/27/00	SW846 8260B
Trichloroethene	< 0.32	0.32	1.0	ug/L	6/27/00	SW846 8260B
1,2,3-Trichloropropane	< 0.89	0.89	2.8	ug/L	6/27/00	SW846 8260B
1,3,5-Trimethylbenzene	< 0.29	0.29	0.92	ug/L	6/27/00	SW846 8260B
Vinyl chloride	< 0.19	0.19	0.61	ug/L	6/27/00	SW846 8260B
Xylenes, -m, -p	< 0.35	0.35	1.1	ug/L	6/27/00	SW846 8260B
Xylene, -o	< 0.28	0.28	0.89	ug/L	6/27/00	SW846 8260B
4-Bromofluorobenzene	97			%Recov	6/27/00	SW846 8260B
Dibromofluoromethane	97			%Recov	6/27/00	SW846 8260B
Toluene-d8	108			%Recov	6/27/00	SW846 8260B

- Analytical Report -

Project Name : TECUMSEH PRODUCTS CO.

Project Number : #1177

Field ID : MW-22 BR

Lab Sample Number : 802943-006

WI DNR LAB ID : 405132750

Client : MORAINÉ ENVIRONMENTAL INC

Report Date : 6/28/00

Collection Date : 6/21/00

Matrix Type : WATER

Organic Results

EPA 8260 VOLATILE LIST- WATER

Prep Method: SW846 5030B

Prep Date: 6/27/00

Analyst: JJB

Analyte	Result	LOD	LOQ	EQL	Units	Code	Analysis Date	Analysis Method
Benzene	< 0.29	0.29	0.92		ug/L		6/27/00	SW846 8260B
Bromobenzene	< 0.35	0.35	1.1		ug/L		6/27/00	SW846 8260B
Bromochloromethane	< 0.56	0.56	1.8		ug/L		6/27/00	SW846 8260B
Bromodichloromethane	< 0.30	0.30	0.96		ug/L		6/27/00	SW846 8260B
Bromoform	< 0.24	0.24	0.76		ug/L		6/27/00	SW846 8260B
Bromomethane	< 0.62	0.62	2.0		ug/L		6/27/00	SW846 8260B
s-Butylbenzene	< 0.20	0.20	0.64		ug/L		6/27/00	SW846 8260B
t-Butylbenzene	< 0.23	0.23	0.73		ug/L		6/27/00	SW846 8260B
n-Butylbenzene	< 0.28	0.28	0.89		ug/L		6/27/00	SW846 8260B
Carbon tetrachloride	< 0.22	0.22	0.70		ug/L		6/27/00	SW846 8260B
Chloroform	< 0.29	0.29	0.92		ug/L		6/27/00	SW846 8260B
Chlorobenzene	< 0.19	0.19	0.61		ug/L		6/27/00	SW846 8260B
Chlorodibromomethane	< 2.8	2.8	8.9		ug/L		6/27/00	SW846 8260B
Chloroethane	< 0.46	0.46	1.5		ug/L		6/27/00	SW846 8260B
Chloromethane	< 0.42	0.42	1.3		ug/L		6/27/00	SW846 8260B
2-Chlorotoluene	< 0.19	0.19	0.61		ug/L		6/27/00	SW846 8260B
4-Chlorotoluene	< 0.21	0.21	0.67		ug/L		6/27/00	SW846 8260B
1,2-Dibromo-3-chloropropane	< 0.69	0.69	2.2		ug/L		6/27/00	SW846 8260B
1,2-Dibromoethane	< 0.42	0.42	1.3		ug/L		6/27/00	SW846 8260B
Dibromomethane	< 0.22	0.22	0.70		ug/L		6/27/00	SW846 8260B
1,3-Dichlorobenzene	< 0.12	0.12	0.38		ug/L		6/27/00	SW846 8260B
1,4-Dichlorobenzene	< 0.31	0.31	0.99		ug/L		6/27/00	SW846 8260B
1,2-Dichloroethane	< 0.21	0.21	0.67		ug/L		6/27/00	SW846 8260B
1,2-Dichlorobenzene	< 0.20	0.20	0.64		ug/L		6/27/00	SW846 8260B
1,1-Dichloroethene	< 0.85	0.85	2.7		ug/L		6/27/00	SW846 8260B
cis-1,2-Dichloroethene	4.6	0.27	0.86		ug/L		6/27/00	SW846 8260B
Dichlorodifluoromethane	< 0.12	0.12	0.38		ug/L		6/27/00	SW846 8260B
trans-1,2-Dichloroethene	< 0.35	0.35	1.1		ug/L		6/27/00	SW846 8260B
1,2-Dichloropropane	< 0.23	0.23	0.73		ug/L		6/27/00	SW846 8260B
1,1-Dichloroethane	1.1	0.17	0.54		ug/L		6/27/00	SW846 8260B
1,3-Dichloropropane	< 1.4	1.4	4.5		ug/L		6/27/00	SW846 8260B
2,2-Dichloropropane	< 0.28	0.28	0.89		ug/L		6/27/00	SW846 8260B

- Analytical Report -

Project Name : TECUMSEH PRODUCTS CO.

Project Number : #1177

Client : MORAIN ENVIRONMENTAL INC

Field ID : MW-22 BR

Report Date : 6/28/00

Lab Sample Number : 802943-006

Collection Date : 6/21/00

WI DNR LAB ID : 405132750

Matrix Type : WATER

1,1-Dichloropropene	< 0.46	0.46	1.5	ug/L	6/27/00	SW846 8260B
cis-1,3-Dichloropropene	< 0.23	0.23	0.73	ug/L	6/27/00	SW846 8260B
trans-1,3-Dichloropropene	< 0.23	0.23	0.73	ug/L	6/27/00	SW846 8260B
Diisopropyl ether	< 0.23	0.23	0.73	ug/L	6/27/00	SW846 8260B
Ethylbenzene	< 0.57	0.57	1.8	ug/L	6/27/00	SW846 8260B
Fluorotrichloromethane	< 0.31	0.31	0.99	ug/L	6/27/00	SW846 8260B
Hexachlorobutadiene	< 0.43	0.43	1.4	ug/L	6/27/00	SW846 8260B
Isopropylbenzene	< 0.19	0.19	0.61	ug/L	6/27/00	SW846 8260B
p-Isopropyltoluene	< 0.25	0.25	0.80	ug/L	6/27/00	SW846 8260B
Methylene chloride	< 0.36	0.36	1.1	ug/L	6/27/00	SW846 8260B
Methyl-tert-butyl-ether	< 0.20	0.20	0.64	ug/L	6/27/00	SW846 8260B
Naphthalene	< 0.27	0.27	0.86	ug/L	6/27/00	SW846 8260B
n-Propylbenzene	< 0.17	0.17	0.54	ug/L	6/27/00	SW846 8260B
Styrene	< 0.72	0.72	2.3	ug/L	6/27/00	SW846 8260B
1,1,2,2-Tetrachloroethane	< 0.22	0.22	0.70	ug/L	6/27/00	SW846 8260B
1,1,1,2-Tetrachloroethane	< 0.30	0.30	0.96	ug/L	6/27/00	SW846 8260B
Tetrachloroethene	< 0.85	0.85	2.7	ug/L	6/27/00	SW846 8260B
Toluene	< 1.1	1.1	3.5	ug/L	6/27/00	SW846 8260B
1,2,3-Trichlorobenzene	< 0.30	0.30	0.96	ug/L	6/27/00	SW846 8260B
1,2,4-Trichlorobenzene	< 0.24	0.24	0.76	ug/L	6/27/00	SW846 8260B
1,1,1-Trichloroethane	< 0.21	0.21	0.67	ug/L	6/27/00	SW846 8260B
1,1,2-Trichloroethane	< 0.33	0.33	1.1	ug/L	6/27/00	SW846 8260B
1,2,4-Trimethylbenzene	< 0.34	0.34	1.1	ug/L	6/27/00	SW846 8260B
Trichloroethene	30	0.32	1.0	ug/L	6/27/00	SW846 8260B
1,2,3-Trichloropropane	< 0.89	0.89	2.8	ug/L	6/27/00	SW846 8260B
1,3,5-Trimethylbenzene	< 0.29	0.29	0.92	ug/L	6/27/00	SW846 8260B
Vinyl chloride	< 0.19	0.19	0.61	ug/L	6/27/00	SW846 8260B
Xylenes, -m, -p	< 0.35	0.35	1.1	ug/L	6/27/00	SW846 8260B
Xylene, -o	< 0.28	0.28	0.89	ug/L	6/27/00	SW846 8260B
4-Bromofluorobenzene	79			%Recov	6/27/00	SW846 8260B
Dibromofluoromethane	93			%Recov	6/27/00	SW846 8260B
Toluene-d8	86			%Recov	6/27/00	SW846 8260B

- Analytical Report -

Project Name : TECUMSEH PRODUCTS CO.

Project Number : #1177

Client : MORAINÉ ENVIRONMENTAL INC

Field ID : MW-12

Report Date : 6/29/00

Lab Sample Number : 802943-007

Collection Date : 6/21/00

WI DNR LAB ID : 405132750

Matrix Type : WATER

Organic Results

EPA 8260 VOLATILE LIST- WATER

Prep Method: SW846 5030B

Prep Date: 6/28/00

Analyst: JJB

Analyte	Result	LOD	LOQ	EQL	Units	Code	Analysis Date	Analysis Method
Benzene	< 2.9	2.9	9.2		ug/L		6/28/00	SW846 8260B
Bromobenzene	< 3.5	3.5	11		ug/L		6/28/00	SW846 8260B
Bromochloromethane	< 5.6	5.6	18		ug/L		6/28/00	SW846 8260B
Bromodichloromethane	< 3.0	3.0	9.6		ug/L		6/28/00	SW846 8260B
Bromoform	< 2.4	2.4	7.6		ug/L		6/28/00	SW846 8260B
Bromomethane	< 6.2	6.2	20		ug/L		6/28/00	SW846 8260B
s-Butylbenzene	< 2.0	2.0	6.4		ug/L		6/28/00	SW846 8260B
t-Butylbenzene	< 2.3	2.3	7.3		ug/L		6/28/00	SW846 8260B
n-Butylbenzene	< 2.8	2.8	8.9		ug/L		6/28/00	SW846 8260B
Carbon tetrachloride	< 2.2	2.2	7.0		ug/L		6/28/00	SW846 8260B
Chloroform	< 2.9	2.9	9.2		ug/L		6/28/00	SW846 8260B
Chlorobenzene	< 1.9	1.9	6.1		ug/L		6/28/00	SW846 8260B
Chlorodibromomethane	< 28	28	89		ug/L		6/28/00	SW846 8260B
Chloroethane	< 4.6	4.6	15		ug/L		6/28/00	SW846 8260B
Chloromethane	< 4.2	4.2	13		ug/L		6/28/00	SW846 8260B
2-Chlorotoluene	< 1.9	1.9	6.1		ug/L		6/28/00	SW846 8260B
4-Chlorotoluene	< 2.1	2.1	6.7		ug/L		6/28/00	SW846 8260B
1,2-Dibromo-3-chloropropane	< 6.9	6.9	22		ug/L		6/28/00	SW846 8260B
1,2-Dibromoethane	< 4.2	4.2	13		ug/L		6/28/00	SW846 8260B
Dibromomethane	< 2.2	2.2	7.0		ug/L		6/28/00	SW846 8260B
1,3-Dichlorobenzene	< 1.2	1.2	3.8		ug/L		6/28/00	SW846 8260B
1,4-Dichlorobenzene	< 3.1	3.1	9.9		ug/L		6/28/00	SW846 8260B
1,2-Dichloroethane	< 2.1	2.1	6.7		ug/L		6/28/00	SW846 8260B
1,2-Dichlorobenzene	< 2.0	2.0	6.4		ug/L		6/28/00	SW846 8260B
1,1-Dichloroethene	< 8.5	8.5	27		ug/L		6/28/00	SW846 8260B
cis-1,2-Dichloroethene	4.7	2.7	8.6		ug/L	Q	6/28/00	SW846 8260B
Dichlorodifluoromethane	< 1.2	1.2	3.8		ug/L		6/28/00	SW846 8260B
trans-1,2-Dichloroethene	< 3.5	3.5	11		ug/L		6/28/00	SW846 8260B
1,2-Dichloropropane	< 2.3	2.3	7.3		ug/L		6/28/00	SW846 8260B
1,1-Dichloroethane	10	1.7	5.4		ug/L		6/28/00	SW846 8260B
1,3-Dichloropropane	< 14	14	45		ug/L		6/28/00	SW846 8260B
2,2-Dichloropropane	< 2.8	2.8	8.9		ug/L		6/28/00	SW846 8260B

- Analytical Report -

Project Name : TECUMSEH PRODUCTS CO.

Project Number : #1177

Field ID : MW-12

Lab Sample Number : 802943-007

WI DNR LAB ID : 405132750

Client : MORAIN ENVIRONMENTAL INC

Report Date : 6/29/00

Collection Date : 6/21/00

Matrix Type : WATER

1,1-Dichloropropene	< 4.6	4.6	15	ug/L	6/28/00	SW846 8260B
cis-1,3-Dichloropropene	< 2.3	2.3	7.3	ug/L	6/28/00	SW846 8260B
trans-1,3-Dichloropropene	< 2.3	2.3	7.3	ug/L	6/28/00	SW846 8260B
Diisopropyl ether	< 2.3	2.3	7.3	ug/L	6/28/00	SW846 8260B
Ethylbenzene	< 5.7	5.7	18	ug/L	6/28/00	SW846 8260B
Fluorotrichloromethane	< 3.1	3.1	9.9	ug/L	6/28/00	SW846 8260B
Hexachlorobutadiene	< 4.3	4.3	14	ug/L	6/28/00	SW846 8260B
Isopropylbenzene	< 1.9	1.9	6.1	ug/L	6/28/00	SW846 8260B
p-Isopropyltoluene	< 2.5	2.5	8.0	ug/L	6/28/00	SW846 8260B
Methylene chloride	< 3.6	3.6	11	ug/L	6/28/00	SW846 8260B
Methyl-tert-butyl-ether	< 2.0	2.0	6.4	ug/L	6/28/00	SW846 8260B
Naphthalene	< 2.7	2.7	8.6	ug/L	6/28/00	SW846 8260B
n-Propylbenzene	< 1.7	1.7	5.4	ug/L	6/28/00	SW846 8260B
Styrene	< 7.2	7.2	23	ug/L	6/28/00	SW846 8260B
1,1,2,2-Tetrachloroethane	< 2.2	2.2	7.0	ug/L	6/28/00	SW846 8260B
1,1,1,2-Tetrachloroethane	< 3.0	3.0	9.6	ug/L	6/28/00	SW846 8260B
Tetrachloroethene	< 8.5	8.5	27	ug/L	6/28/00	SW846 8260B
Toluene	< 11	11	35	ug/L	6/28/00	SW846 8260B
1,2,3-Trichlorobenzene	< 3.0	3.0	9.6	ug/L	6/28/00	SW846 8260B
1,2,4-Trichlorobenzene	< 2.4	2.4	7.6	ug/L	6/28/00	SW846 8260B
1,1,1-Trichloroethane	61	2.1	6.7	ug/L	6/28/00	SW846 8260B
1,1,2-Trichloroethane	< 3.3	3.3	11	ug/L	6/28/00	SW846 8260B
1,2,4-Trimethylbenzene	< 3.4	3.4	11	ug/L	6/28/00	SW846 8260B
Trichloroethene	820	3.2	10	ug/L	6/28/00	SW846 8260B
1,2,3-Trichloropropane	< 8.9	8.9	28	ug/L	6/28/00	SW846 8260B
1,3,5-Trimethylbenzene	< 2.9	2.9	9.2	ug/L	6/28/00	SW846 8260B
Vinyl chloride	< 1.9	1.9	6.1	ug/L	6/28/00	SW846 8260B
Xylenes, -m, -p	< 3.5	3.5	11	ug/L	6/28/00	SW846 8260B
Xylene, -o	< 2.8	2.8	8.9	ug/L	6/28/00	SW846 8260B
4-Bromofluorobenzene	86			%Recov	6/28/00	SW846 8260B
Dibromofluoromethane	90			%Recov	6/28/00	SW846 8260B
Toluene-d8	91			%Recov	6/28/00	SW846 8260B

- Analytical Report -

Project Name : TECUMSEH PRODUCTS CO.
Project Number : #1177
Field ID : MW-20 BR(1)
Lab Sample Number : 802943-008
WI DNR LAB ID : 405132750

Client : MORAIN ENVIRONMENTAL INC
Report Date : 6/28/00
Collection Date : 6/21/00
Matrix Type : WATER

Organic Results

EPA 8260 VOLATILE LIST- WATER

Prep Method: SW846 5030B Prep Date: 6/27/00 Analyst: JJB

Analyte	Result	LOD	LOQ	EQL	Units	Code	Analysis Date	Analysis Method
Benzene	< 0.29	0.29	0.92		ug/L		6/27/00	SW846 8260B
Bromobenzene	< 0.35	0.35	1.1		ug/L		6/27/00	SW846 8260B
Bromochloromethane	< 0.56	0.56	1.8		ug/L		6/27/00	SW846 8260B
Bromodichloromethane	< 0.30	0.30	0.96		ug/L		6/27/00	SW846 8260B
Bromoform	< 0.24	0.24	0.76		ug/L		6/27/00	SW846 8260B
Bromomethane	< 0.62	0.62	2.0		ug/L		6/27/00	SW846 8260B
s-Butylbenzene	< 0.20	0.20	0.64		ug/L		6/27/00	SW846 8260B
t-Butylbenzene	< 0.23	0.23	0.73		ug/L		6/27/00	SW846 8260B
n-Butylbenzene	< 0.28	0.28	0.89		ug/L		6/27/00	SW846 8260B
Carbon tetrachloride	< 0.22	0.22	0.70		ug/L		6/27/00	SW846 8260B
Chloroform	< 0.29	0.29	0.92		ug/L		6/27/00	SW846 8260B
Chlorobenzene	< 0.19	0.19	0.61		ug/L		6/27/00	SW846 8260B
Chlorodibromomethane	< 2.8	2.8	8.9		ug/L		6/27/00	SW846 8260B
Chloroethane	< 0.46	0.46	1.5		ug/L		6/27/00	SW846 8260B
Chloromethane	< 0.42	0.42	1.3		ug/L		6/27/00	SW846 8260B
2-Chlorotoluene	< 0.19	0.19	0.61		ug/L		6/27/00	SW846 8260B
4-Chlorotoluene	< 0.21	0.21	0.67		ug/L		6/27/00	SW846 8260B
1,2-Dibromo-3-chloropropane	< 0.69	0.69	2.2		ug/L		6/27/00	SW846 8260B
1,2-Dibromoethane	< 0.42	0.42	1.3		ug/L		6/27/00	SW846 8260B
Dibromomethane	< 0.22	0.22	0.70		ug/L		6/27/00	SW846 8260B
1,3-Dichlorobenzene	< 0.12	0.12	0.38		ug/L		6/27/00	SW846 8260B
1,4-Dichlorobenzene	< 0.31	0.31	0.99		ug/L		6/27/00	SW846 8260B
1,2-Dichloroethane	< 0.21	0.21	0.67		ug/L		6/27/00	SW846 8260B
1,2-Dichlorobenzene	< 0.20	0.20	0.64		ug/L		6/27/00	SW846 8260B
1,1-Dichloroethene	< 0.85	0.85	2.7		ug/L		6/27/00	SW846 8260B
cis-1,2-Dichloroethene	< 0.27	0.27	0.86		ug/L		6/27/00	SW846 8260B
Dichlorodifluoromethane	< 0.12	0.12	0.38		ug/L		6/27/00	SW846 8260B
trans-1,2-Dichloroethene	< 0.35	0.35	1.1		ug/L		6/27/00	SW846 8260B
1,2-Dichloropropane	< 0.23	0.23	0.73		ug/L		6/27/00	SW846 8260B
1,1-Dichloroethane	< 0.17	0.17	0.54		ug/L		6/27/00	SW846 8260B
1,3-Dichloropropane	< 1.4	1.4	4.5		ug/L		6/27/00	SW846 8260B
2,2-Dichloropropane	< 0.28	0.28	0.89		ug/L		6/27/00	SW846 8260B

- Analytical Report -

Project Name : TECUMSEH PRODUCTS CO.

Project Number : #1177

Client : MORaine ENVIRONMENTAL INC

Field ID : MW-20 BR(1)

Report Date : 6/28/00

Lab Sample Number : 802943-008

Collection Date : 6/21/00

WI DNR LAB ID : 405132750

Matrix Type : WATER

1,1-Dichloropropene	< 0.46	0.46	1.5	ug/L	6/27/00	SW846 8260B
cis-1,3-Dichloropropene	< 0.23	0.23	0.73	ug/L	6/27/00	SW846 8260B
trans-1,3-Dichloropropene	< 0.23	0.23	0.73	ug/L	6/27/00	SW846 8260B
Diisopropyl ether	< 0.23	0.23	0.73	ug/L	6/27/00	SW846 8260B
Ethylbenzene	< 0.57	0.57	1.8	ug/L	6/27/00	SW846 8260B
Fluorotrichloromethane	< 0.31	0.31	0.99	ug/L	6/27/00	SW846 8260B
Hexachlorobutadiene	< 0.43	0.43	1.4	ug/L	6/27/00	SW846 8260B
Isopropylbenzene	< 0.19	0.19	0.61	ug/L	6/27/00	SW846 8260B
p-Isopropyltoluene	< 0.25	0.25	0.80	ug/L	6/27/00	SW846 8260B
Methylene chloride	< 0.36	0.36	1.1	ug/L	6/27/00	SW846 8260B
Methyl-tert-butyl-ether	< 0.20	0.20	0.64	ug/L	6/27/00	SW846 8260B
Naphthalene	< 0.27	0.27	0.86	ug/L	6/27/00	SW846 8260B
n-Propylbenzene	< 0.17	0.17	0.54	ug/L	6/27/00	SW846 8260B
Styrene	< 0.72	0.72	2.3	ug/L	6/27/00	SW846 8260B
1,1,2,2-Tetrachloroethane	< 0.22	0.22	0.70	ug/L	6/27/00	SW846 8260B
1,1,1,2-Tetrachloroethane	< 0.30	0.30	0.96	ug/L	6/27/00	SW846 8260B
Tetrachloroethene	< 0.85	0.85	2.7	ug/L	6/27/00	SW846 8260B
Toluene	< 1.1	1.1	3.5	ug/L	6/27/00	SW846 8260B
1,2,3-Trichlorobenzene	< 0.30	0.30	0.96	ug/L	6/27/00	SW846 8260B
1,2,4-Trichlorobenzene	< 0.24	0.24	0.76	ug/L	6/27/00	SW846 8260B
1,1,1-Trichloroethane	< 0.21	0.21	0.67	ug/L	6/27/00	SW846 8260B
1,1,2-Trichloroethane	< 0.33	0.33	1.1	ug/L	6/27/00	SW846 8260B
1,2,4-Trimethylbenzene	< 0.34	0.34	1.1	ug/L	6/27/00	SW846 8260B
Trichloroethene	< 0.32	0.32	1.0	ug/L	6/27/00	SW846 8260B
1,2,3-Trichloropropane	< 0.89	0.89	2.8	ug/L	6/27/00	SW846 8260B
1,3,5-Trimethylbenzene	< 0.29	0.29	0.92	ug/L	6/27/00	SW846 8260B
Vinyl chloride	< 0.19	0.19	0.61	ug/L	6/27/00	SW846 8260B
Xylenes, -m, -p	< 0.35	0.35	1.1	ug/L	6/27/00	SW846 8260B
Xylene, -o	< 0.28	0.28	0.89	ug/L	6/27/00	SW846 8260B
4-Bromofluorobenzene	84			%Recov	6/27/00	SW846 8260B
Dibromofluoromethane	94			%Recov	6/27/00	SW846 8260B
Toluene-d8	92			%Recov	6/27/00	SW846 8260B

- Analytical Report -

Project Name : TECUMSEH PRODUCTS CO.

Project Number : #1177

Field ID : MW-3 BR

Lab Sample Number : 802943-009

WI DNR LAB ID : 405132750

Client : MORaine ENVIRONMENTAL INC

Report Date : 6/28/00

Collection Date : 6/21/00

Matrix Type : WATER

1,1-Dichloropropene	< 0.46	0.46	1.5	ug/L		6/27/00	SW846 8260B
cis-1,3-Dichloropropene	< 0.23	0.23	0.73	ug/L		6/27/00	SW846 8260B
trans-1,3-Dichloropropene	< 0.23	0.23	0.73	ug/L		6/27/00	SW846 8260B
Diisopropyl ether	< 0.23	0.23	0.73	ug/L		6/27/00	SW846 8260B
Ethylbenzene	< 0.57	0.57	1.8	ug/L		6/27/00	SW846 8260B
Fluorotrichloromethane	< 0.31	0.31	0.99	ug/L		6/27/00	SW846 8260B
Hexachlorobutadiene	< 0.43	0.43	1.4	ug/L		6/27/00	SW846 8260B
Isopropylbenzene	< 0.19	0.19	0.61	ug/L		6/27/00	SW846 8260B
p-Isopropyltoluene	< 0.25	0.25	0.80	ug/L		6/27/00	SW846 8260B
Methylene chloride	< 0.36	0.36	1.1	ug/L		6/27/00	SW846 8260B
Methyl-tert-butyl-ether	< 0.20	0.20	0.64	ug/L		6/27/00	SW846 8260B
Naphthalene	< 0.27	0.27	0.86	ug/L		6/27/00	SW846 8260B
n-Propylbenzene	< 0.17	0.17	0.54	ug/L		6/27/00	SW846 8260B
Styrene	< 0.72	0.72	2.3	ug/L		6/27/00	SW846 8260B
1,1,2,2-Tetrachloroethane	< 0.22	0.22	0.70	ug/L		6/27/00	SW846 8260B
1,1,1,2-Tetrachloroethane	< 0.30	0.30	0.96	ug/L		6/27/00	SW846 8260B
Tetrachloroethene	< 0.85	0.85	2.7	ug/L		6/27/00	SW846 8260B
Toluene	< 1.1	1.1	3.5	ug/L		6/27/00	SW846 8260B
1,2,3-Trichlorobenzene	< 0.30	0.30	0.96	ug/L		6/27/00	SW846 8260B
1,2,4-Trichlorobenzene	< 0.24	0.24	0.76	ug/L		6/27/00	SW846 8260B
1,1,1-Trichloroethane	31	0.21	0.67	ug/L		6/27/00	SW846 8260B
1,1,2-Trichloroethane	< 0.33	0.33	1.1	ug/L		6/27/00	SW846 8260B
1,2,4-Trimethylbenzene	< 0.34	0.34	1.1	ug/L		6/27/00	SW846 8260B
Trichloroethene	110	0.32	1.0	ug/L		6/27/00	SW846 8260B
1,2,3-Trichloropropane	< 0.89	0.89	2.8	ug/L		6/27/00	SW846 8260B
1,3,5-Trimethylbenzene	< 0.29	0.29	0.92	ug/L		6/27/00	SW846 8260B
Vinyl chloride	0.60	0.19	0.61	ug/L	Q	6/27/00	SW846 8260B
Xylenes, -m, -p	< 0.35	0.35	1.1	ug/L		6/27/00	SW846 8260B
Xylene, -o	< 0.28	0.28	0.89	ug/L		6/27/00	SW846 8260B
4-Bromofluorobenzene	82			%Recov		6/27/00	SW846 8260B
Dibromofluoromethane	95			%Recov		6/27/00	SW846 8260B
Toluene-d8	90			%Recov		6/27/00	SW846 8260B

- Analytical Report -

Project Name : TECUMSEH PRODUCTS CO.

Project Number : #1177

Field ID : MW-21 BR(2)

Lab Sample Number : 802943-010

WI DNR LAB ID : 405132750

Client : MORaine ENVIRONMENTAL INC

Report Date : 7/6/00

Collection Date : 6/21/00

Matrix Type : WATER

Organic Results

EPA 8260 VOLATILE LIST- WATER

Prep Method: SW846 5030B Prep Date: 6/28/00 Analyst: HW

Analyte	Result	LOD	LOQ	EQL	Units	Code	Analysis Date	Analysis Method
Benzene	< 0.29	0.29	0.92		ug/L		6/29/00	SW846 8260B
Bromobenzene	< 0.35	0.35	1.1		ug/L		6/29/00	SW846 8260B
Bromochloromethane	< 0.56	0.56	1.8		ug/L		6/29/00	SW846 8260B
Bromodichloromethane	< 0.30	0.30	0.96		ug/L		6/29/00	SW846 8260B
Bromoform	< 0.24	0.24	0.76		ug/L		6/29/00	SW846 8260B
Bromomethane	< 0.62	0.62	2.0		ug/L		6/29/00	SW846 8260B
s-Butylbenzene	< 0.20	0.20	0.64		ug/L		6/29/00	SW846 8260B
t-Butylbenzene	< 0.23	0.23	0.73		ug/L		6/29/00	SW846 8260B
n-Butylbenzene	< 0.28	0.28	0.89		ug/L		6/29/00	SW846 8260B
Carbon tetrachloride	< 0.22	0.22	0.70		ug/L		6/29/00	SW846 8260B
Chloroform	< 0.29	0.29	0.92		ug/L		6/29/00	SW846 8260B
Chlorobenzene	< 0.19	0.19	0.61		ug/L		6/29/00	SW846 8260B
Chlorodibromomethane	< 2.8	2.8	8.9		ug/L		6/29/00	SW846 8260B
Chloroethane	< 0.46	0.46	1.5		ug/L		6/29/00	SW846 8260B
Chloromethane	< 0.42	0.42	1.3		ug/L		6/29/00	SW846 8260B
2-Chlorotoluene	< 0.19	0.19	0.61		ug/L		6/29/00	SW846 8260B
4-Chlorotoluene	< 0.21	0.21	0.67		ug/L		6/29/00	SW846 8260B
1,2-Dibromo-3-chloropropane	< 0.69	0.69	2.2		ug/L		6/29/00	SW846 8260B
1,2-Dibromoethane	< 0.42	0.42	1.3		ug/L		6/29/00	SW846 8260B
Dibromomethane	< 0.22	0.22	0.70		ug/L		6/29/00	SW846 8260B
1,3-Dichlorobenzene	< 0.12	0.12	0.38		ug/L		6/29/00	SW846 8260B
1,4-Dichlorobenzene	< 0.31	0.31	0.99		ug/L		6/29/00	SW846 8260B
1,2-Dichloroethane	< 0.21	0.21	0.67		ug/L		6/29/00	SW846 8260B
1,2-Dichlorobenzene	< 0.20	0.20	0.64		ug/L		6/29/00	SW846 8260B
1,1-Dichloroethene	< 0.85	0.85	2.7		ug/L		6/29/00	SW846 8260B
cis-1,2-Dichloroethene	< 0.27	0.27	0.86		ug/L		6/29/00	SW846 8260B
Dichlorodifluoromethane	< 0.12	0.12	0.38		ug/L		6/29/00	SW846 8260B
trans-1,2-Dichloroethene	< 0.35	0.35	1.1		ug/L		6/29/00	SW846 8260B
1,2-Dichloropropane	< 0.23	0.23	0.73		ug/L		6/29/00	SW846 8260B
1,1-Dichloroethane	< 0.17	0.17	0.54		ug/L		6/29/00	SW846 8260B
1,3-Dichloropropane	< 1.4	1.4	4.5		ug/L		6/29/00	SW846 8260B
2,2-Dichloropropane	< 0.28	0.28	0.89		ug/L		6/29/00	SW846 8260B

- Analytical Report -

Project Name : TECUMSEH PRODUCTS CO.

Project Number : #1177

Client : MORaine ENVIRONMENTAL INC

Field ID : MW-21 BR(2)

Report Date : 7/6/00

Lab Sample Number : 802943-010

Collection Date : 6/21/00

WI DNR LAB ID : 405132750

Matrix Type : WATER

1,1-Dichloropropene	< 0.46	0.46	1.5	ug/L	6/29/00	SW846 8260B
cis-1,3-Dichloropropene	< 0.23	0.23	0.73	ug/L	6/29/00	SW846 8260B
trans-1,3-Dichloropropene	< 0.23	0.23	0.73	ug/L	6/29/00	SW846 8260B
Diisopropyl ether	< 0.23	0.23	0.73	ug/L	6/29/00	SW846 8260B
Ethylbenzene	< 0.57	0.57	1.8	ug/L	6/29/00	SW846 8260B
Fluorotrichloromethane	< 0.31	0.31	0.99	ug/L	6/29/00	SW846 8260B
Hexachlorobutadiene	< 0.43	0.43	1.4	ug/L	6/29/00	SW846 8260B
Isopropylbenzene	< 0.19	0.19	0.61	ug/L	6/29/00	SW846 8260B
p-Isopropyltoluene	< 0.25	0.25	0.80	ug/L	6/29/00	SW846 8260B
Methylene chloride	< 0.36	0.36	1.1	ug/L	6/29/00	SW846 8260B
Methyl-tert-butyl-ether	< 0.20	0.20	0.64	ug/L	6/29/00	SW846 8260B
Naphthalene	< 0.27	0.27	0.86	ug/L	6/29/00	SW846 8260B
n-Propylbenzene	< 0.17	0.17	0.54	ug/L	6/29/00	SW846 8260B
Styrene	< 0.72	0.72	2.3	ug/L	6/29/00	SW846 8260B
1,1,2,2-Tetrachloroethane	< 0.22	0.22	0.70	ug/L	6/29/00	SW846 8260B
1,1,1,2-Tetrachloroethane	< 0.30	0.30	0.96	ug/L	6/29/00	SW846 8260B
Tetrachloroethene	< 0.85	0.85	2.7	ug/L	6/29/00	SW846 8260B
Toluene	< 1.1	1.1	3.5	ug/L	6/29/00	SW846 8260B
1,2,3-Trichlorobenzene	< 0.30	0.30	0.96	ug/L	6/29/00	SW846 8260B
1,2,4-Trichlorobenzene	< 0.24	0.24	0.76	ug/L	6/29/00	SW846 8260B
1,1,1-Trichloroethane	< 0.21	0.21	0.67	ug/L	6/29/00	SW846 8260B
1,1,2-Trichloroethane	< 0.33	0.33	1.1	ug/L	6/29/00	SW846 8260B
1,2,4-Trimethylbenzene	< 0.34	0.34	1.1	ug/L	6/29/00	SW846 8260B
Trichloroethene	< 0.32	0.32	1.0	ug/L	6/29/00	SW846 8260B
1,2,3-Trichloropropane	< 0.89	0.89	2.8	ug/L	6/29/00	SW846 8260B
1,3,5-Trimethylbenzene	< 0.29	0.29	0.92	ug/L	6/29/00	SW846 8260B
Vinyl chloride	< 0.19	0.19	0.61	ug/L	6/29/00	SW846 8260B
Xylenes, -m, -p	< 0.35	0.35	1.1	ug/L	6/29/00	SW846 8260B
Xylene, -o	< 0.28	0.28	0.89	ug/L	6/29/00	SW846 8260B
4-Bromofluorobenzene	78			%Recov	6/29/00	SW846 8260B
Dibromofluoromethane	78			%Recov	6/29/00	SW846 8260B
Toluene-d8	90			%Recov	6/29/00	SW846 8260B

- Analytical Report -

Project Name : TECUMSEH PRODUCTS CO.

Project Number : #1177

Client : MORAINÉ ENVIRONMENTAL INC

Field ID : MW-21 BR(1)

Report Date : 6/28/00

Lab Sample Number : 802943-011

Collection Date : 6/21/00

WI DNR LAB ID : 405132750

Matrix Type : WATER

Organic Results

EPA 8260 VOLATILE LIST- WATER

Prep Method: SW846 5030B

Prep Date: 6/27/00

Analyst: HW

Analyte	Result	LOD	LOQ	EQL	Units	Code	Analysis Date	Analysis Method
Benzene	< 0.29	0.29	0.92		ug/L		6/27/00	SW846 8260B
Bromobenzene	< 0.35	0.35	1.1		ug/L		6/27/00	SW846 8260B
Bromochloromethane	< 0.56	0.56	1.8		ug/L		6/27/00	SW846 8260B
Bromodichloromethane	< 0.30	0.30	0.96		ug/L		6/27/00	SW846 8260B
Bromoform	< 0.24	0.24	0.76		ug/L		6/27/00	SW846 8260B
Bromomethane	< 0.62	0.62	2.0		ug/L		6/27/00	SW846 8260B
s-Butylbenzene	< 0.20	0.20	0.64		ug/L		6/27/00	SW846 8260B
t-Butylbenzene	< 0.23	0.23	0.73		ug/L		6/27/00	SW846 8260B
n-Butylbenzene	< 0.28	0.28	0.89		ug/L		6/27/00	SW846 8260B
Carbon tetrachloride	< 0.22	0.22	0.70		ug/L		6/27/00	SW846 8260B
Chloroform	< 0.29	0.29	0.92		ug/L		6/27/00	SW846 8260B
Chlorobenzene	< 0.19	0.19	0.61		ug/L		6/27/00	SW846 8260B
Chlorodibromomethane	< 2.8	2.8	8.9		ug/L		6/27/00	SW846 8260B
Chloroethane	< 0.46	0.46	1.5		ug/L		6/27/00	SW846 8260B
Chloromethane	< 0.42	0.42	1.3		ug/L		6/27/00	SW846 8260B
2-Chlorotoluene	< 0.19	0.19	0.61		ug/L		6/27/00	SW846 8260B
4-Chlorotoluene	< 0.21	0.21	0.67		ug/L		6/27/00	SW846 8260B
1,2-Dibromo-3-chloropropane	< 0.69	0.69	2.2		ug/L		6/27/00	SW846 8260B
1,2-Dibromoethane	< 0.42	0.42	1.3		ug/L		6/27/00	SW846 8260B
Dibromomethane	< 0.22	0.22	0.70		ug/L		6/27/00	SW846 8260B
1,3-Dichlorobenzene	< 0.12	0.12	0.38		ug/L		6/27/00	SW846 8260B
1,4-Dichlorobenzene	< 0.31	0.31	0.99		ug/L		6/27/00	SW846 8260B
1,2-Dichloroethane	< 0.21	0.21	0.67		ug/L		6/27/00	SW846 8260B
1,2-Dichlorobenzene	< 0.20	0.20	0.64		ug/L		6/27/00	SW846 8260B
1,1-Dichloroethene	< 0.85	0.85	2.7		ug/L		6/27/00	SW846 8260B
cis-1,2-Dichloroethene	< 0.27	0.27	0.86		ug/L		6/27/00	SW846 8260B
Dichlorodifluoromethane	< 0.12	0.12	0.38		ug/L		6/27/00	SW846 8260B
trans-1,2-Dichloroethene	< 0.35	0.35	1.1		ug/L		6/27/00	SW846 8260B
1,2-Dichloropropane	< 0.23	0.23	0.73		ug/L		6/27/00	SW846 8260B
1,1-Dichloroethane	< 0.17	0.17	0.54		ug/L		6/27/00	SW846 8260B
1,3-Dichloropropane	< 1.4	1.4	4.5		ug/L		6/27/00	SW846 8260B
2,2-Dichloropropane	< 0.28	0.28	0.89		ug/L		6/27/00	SW846 8260B

- Analytical Report -

Project Name : TECUMSEH PRODUCTS CO.

Project Number : #1177

Field ID : MW-21 BR(1)

Lab Sample Number : 802943-011

WI DNR LAB ID : 405132750

Client : MORAIN ENVIRONMENTAL INC

Report Date : 6/28/00

Collection Date : 6/21/00

Matrix Type : WATER

1,1-Dichloropropene	< 0.46	0.46	1.5	ug/L	6/27/00	SW846 8260B
cis-1,3-Dichloropropene	< 0.23	0.23	0.73	ug/L	6/27/00	SW846 8260B
trans-1,3-Dichloropropene	< 0.23	0.23	0.73	ug/L	6/27/00	SW846 8260B
Diisopropyl ether	< 0.23	0.23	0.73	ug/L	6/27/00	SW846 8260B
Ethylbenzene	< 0.57	0.57	1.8	ug/L	6/27/00	SW846 8260B
Fluorotrichloromethane	< 0.31	0.31	0.99	ug/L	6/27/00	SW846 8260B
Hexachlorobutadiene	< 0.43	0.43	1.4	ug/L	6/27/00	SW846 8260B
Isopropylbenzene	< 0.19	0.19	0.61	ug/L	6/27/00	SW846 8260B
p-Isopropyltoluene	< 0.25	0.25	0.80	ug/L	6/27/00	SW846 8260B
Methylene chloride	< 0.36	0.36	1.1	ug/L	6/27/00	SW846 8260B
Methyl-tert-butyl-ether	< 0.20	0.20	0.64	ug/L	6/27/00	SW846 8260B
Naphthalene	< 0.27	0.27	0.86	ug/L	6/27/00	SW846 8260B
n-Propylbenzene	< 0.17	0.17	0.54	ug/L	6/27/00	SW846 8260B
Styrene	< 0.72	0.72	2.3	ug/L	6/27/00	SW846 8260B
1,1,2,2-Tetrachloroethane	< 0.22	0.22	0.70	ug/L	6/27/00	SW846 8260B
1,1,1,2-Tetrachloroethane	< 0.30	0.30	0.96	ug/L	6/27/00	SW846 8260B
Tetrachloroethene	< 0.85	0.85	2.7	ug/L	6/27/00	SW846 8260B
Toluene	< 1.1	1.1	3.5	ug/L	6/27/00	SW846 8260B
1,2,3-Trichlorobenzene	< 0.30	0.30	0.96	ug/L	6/27/00	SW846 8260B
1,2,4-Trichlorobenzene	< 0.24	0.24	0.76	ug/L	6/27/00	SW846 8260B
1,1,1-Trichloroethane	< 0.21	0.21	0.67	ug/L	6/27/00	SW846 8260B
1,1,2-Trichloroethane	< 0.33	0.33	1.1	ug/L	6/27/00	SW846 8260B
1,2,4-Trimethylbenzene	< 0.34	0.34	1.1	ug/L	6/27/00	SW846 8260B
Trichloroethene	< 0.32	0.32	1.0	ug/L	6/27/00	SW846 8260B
1,2,3-Trichloropropane	< 0.89	0.89	2.8	ug/L	6/27/00	SW846 8260B
1,3,5-Trimethylbenzene	< 0.29	0.29	0.92	ug/L	6/27/00	SW846 8260B
Vinyl chloride	< 0.19	0.19	0.61	ug/L	6/27/00	SW846 8260B
Xylenes, -m, -p	< 0.35	0.35	1.1	ug/L	6/27/00	SW846 8260B
Xylene, -o	< 0.28	0.28	0.89	ug/L	6/27/00	SW846 8260B
4-Bromofluorobenzene	79			%Recov	6/27/00	SW846 8260B
Dibromofluoromethane	78			%Recov	6/27/00	SW846 8260B
Toluene-d8	89			%Recov	6/27/00	SW846 8260B

- Analytical Report -

Project Name : TECUMSEH PRODUCTS CO.

Project Number : #1177

Client : MORaine ENVIRONMENTAL INC

Field ID : MW-19 BR(1)

Report Date : 6/28/00

Lab Sample Number : 802943-012

Collection Date : 6/21/00

WI DNR LAB ID : 405132750

Matrix Type : WATER

Organic Results

EPA 8260 VOLATILE LIST- WATER

Prep Method: SW846 5030B

Prep Date: 6/27/00

Analyst: JJB

Analyte	Result	LOD	LOQ	EQL	Units	Code	Analysis Date	Analysis Method
Benzene	< 0.29	0.29	0.92		ug/L		6/27/00	SW846 8260B
Bromobenzene	< 0.35	0.35	1.1		ug/L		6/27/00	SW846 8260B
Bromochloromethane	< 0.56	0.56	1.8		ug/L		6/27/00	SW846 8260B
Bromodichloromethane	< 0.30	0.30	0.96		ug/L		6/27/00	SW846 8260B
Bromoform	< 0.24	0.24	0.76		ug/L		6/27/00	SW846 8260B
Bromomethane	< 0.62	0.62	2.0		ug/L		6/27/00	SW846 8260B
s-Butylbenzene	< 0.20	0.20	0.64		ug/L		6/27/00	SW846 8260B
t-Butylbenzene	< 0.23	0.23	0.73		ug/L		6/27/00	SW846 8260B
n-Butylbenzene	< 0.28	0.28	0.89		ug/L		6/27/00	SW846 8260B
Carbon tetrachloride	< 0.22	0.22	0.70		ug/L		6/27/00	SW846 8260B
Chloroform	< 0.29	0.29	0.92		ug/L		6/27/00	SW846 8260B
Chlorobenzene	< 0.19	0.19	0.61		ug/L		6/27/00	SW846 8260B
Chlorodibromomethane	< 2.8	2.8	8.9		ug/L		6/27/00	SW846 8260B
Chloroethane	< 0.46	0.46	1.5		ug/L		6/27/00	SW846 8260B
Chloromethane	< 0.42	0.42	1.3		ug/L		6/27/00	SW846 8260B
2-Chlorotoluene	< 0.19	0.19	0.61		ug/L		6/27/00	SW846 8260B
4-Chlorotoluene	< 0.21	0.21	0.67		ug/L		6/27/00	SW846 8260B
1,2-Dibromo-3-chloropropane	< 0.69	0.69	2.2		ug/L		6/27/00	SW846 8260B
1,2-Dibromoethane	< 0.42	0.42	1.3		ug/L		6/27/00	SW846 8260B
Dibromomethane	< 0.22	0.22	0.70		ug/L		6/27/00	SW846 8260B
1,3-Dichlorobenzene	< 0.12	0.12	0.38		ug/L		6/27/00	SW846 8260B
1,4-Dichlorobenzene	< 0.31	0.31	0.99		ug/L		6/27/00	SW846 8260B
1,2-Dichloroethane	< 0.21	0.21	0.67		ug/L		6/27/00	SW846 8260B
1,2-Dichlorobenzene	< 0.20	0.20	0.64		ug/L		6/27/00	SW846 8260B
1,1-Dichloroethene	5.1	0.85	2.7		ug/L		6/27/00	SW846 8260B
cis-1,2-Dichloroethene	27	0.27	0.86		ug/L		6/27/00	SW846 8260B
Dichlorodifluoromethane	< 0.12	0.12	0.38		ug/L		6/27/00	SW846 8260B
trans-1,2-Dichloroethene	0.71	0.35	1.1		ug/L	Q	6/27/00	SW846 8260B
1,2-Dichloropropane	< 0.23	0.23	0.73		ug/L		6/27/00	SW846 8260B
1,1-Dichloroethane	52	0.17	0.54		ug/L		6/27/00	SW846 8260B
1,3-Dichloropropane	< 1.4	1.4	4.5		ug/L		6/27/00	SW846 8260B
2,2-Dichloropropane	< 0.28	0.28	0.89		ug/L		6/27/00	SW846 8260B

- Analytical Report -

Project Name : TECUMSEH PRODUCTS CO.

Project Number : #1177

Field ID : MW-19 BR(1)

Lab Sample Number : 802943-012

WI DNR LAB ID : 405132750

Client : MORAIN ENVIRONMENTAL INC

Report Date : 6/28/00

Collection Date : 6/21/00

Matrix Type : WATER

1,1-Dichloropropene	< 0.46	0.46	1.5	ug/L	6/27/00	SW846 8260B
cis-1,3-Dichloropropene	< 0.23	0.23	0.73	ug/L	6/27/00	SW846 8260B
trans-1,3-Dichloropropene	< 0.23	0.23	0.73	ug/L	6/27/00	SW846 8260B
Diisopropyl ether	< 0.23	0.23	0.73	ug/L	6/27/00	SW846 8260B
Ethylbenzene	< 0.57	0.57	1.8	ug/L	6/27/00	SW846 8260B
Fluorotrichloromethane	< 0.31	0.31	0.99	ug/L	6/27/00	SW846 8260B
Hexachlorobutadiene	< 0.43	0.43	1.4	ug/L	6/27/00	SW846 8260B
Isopropylbenzene	< 0.19	0.19	0.61	ug/L	6/27/00	SW846 8260B
p-Isopropyltoluene	< 0.25	0.25	0.80	ug/L	6/27/00	SW846 8260B
Methylene chloride	< 0.36	0.36	1.1	ug/L	6/27/00	SW846 8260B
Methyl-tert-butyl-ether	< 0.20	0.20	0.64	ug/L	6/27/00	SW846 8260B
Naphthalene	< 0.27	0.27	0.86	ug/L	6/27/00	SW846 8260B
n-Propylbenzene	< 0.17	0.17	0.54	ug/L	6/27/00	SW846 8260B
Styrene	< 0.72	0.72	2.3	ug/L	6/27/00	SW846 8260B
1,1,2,2-Tetrachloroethane	< 0.22	0.22	0.70	ug/L	6/27/00	SW846 8260B
1,1,1,2-Tetrachloroethane	< 0.30	0.30	0.96	ug/L	6/27/00	SW846 8260B
Tetrachloroethene	< 0.85	0.85	2.7	ug/L	6/27/00	SW846 8260B
Toluene	< 1.1	1.1	3.5	ug/L	6/27/00	SW846 8260B
1,2,3-Trichlorobenzene	< 0.30	0.30	0.96	ug/L	6/27/00	SW846 8260B
1,2,4-Trichlorobenzene	< 0.24	0.24	0.76	ug/L	6/27/00	SW846 8260B
1,1,1-Trichloroethane	1.6	0.21	0.67	ug/L	6/27/00	SW846 8260B
1,1,2-Trichloroethane	< 0.33	0.33	1.1	ug/L	6/27/00	SW846 8260B
1,2,4-Trimethylbenzene	< 0.34	0.34	1.1	ug/L	6/27/00	SW846 8260B
Trichloroethene	180	0.32	1.0	ug/L	6/27/00	SW846 8260B
1,2,3-Trichloropropane	< 0.89	0.89	2.8	ug/L	6/27/00	SW846 8260B
1,3,5-Trimethylbenzene	< 0.29	0.29	0.92	ug/L	6/27/00	SW846 8260B
Vinyl chloride	0.94	0.19	0.61	ug/L	6/27/00	SW846 8260B
Xylenes, -m, -p	< 0.35	0.35	1.1	ug/L	6/27/00	SW846 8260B
Xylene, -o	< 0.28	0.28	0.89	ug/L	6/27/00	SW846 8260B
4-Bromofluorobenzene	82			%Recov	6/27/00	SW846 8260B
Dibromofluoromethane	96			%Recov	6/27/00	SW846 8260B
Toluene-d8	89			%Recov	6/27/00	SW846 8260B

- Analytical Report -

Project Name : TECUMSEH PRODUCTS CO.

Project Number : #1177

Client : MORaine ENVIRONMENTAL INC

Field ID : MW-18 BR(2)

Report Date : 7/6/00

Lab Sample Number : 802943-013

Collection Date : 6/21/00

WI DNR LAB ID : 405132750

Matrix Type : WATER

Organic Results

EPA 8260 VOLATILE LIST- WATER

Prep Method: SW846 5030B

Prep Date: 6/27/00

Analyst: HW

Analyte	Result	LOD	LOQ	EQL	Units	Code	Analysis Date	Analysis Method
Benzene	< 0.29	0.29	0.92		ug/L		6/27/00	SW846 8260B
Bromobenzene	< 0.35	0.35	1.1		ug/L		6/27/00	SW846 8260B
Bromochloromethane	< 0.56	0.56	1.8		ug/L		6/27/00	SW846 8260B
Bromodichloromethane	< 0.30	0.30	0.96		ug/L		6/27/00	SW846 8260B
Bromoform	< 0.24	0.24	0.76		ug/L		6/27/00	SW846 8260B
Bromomethane	< 0.62	0.62	2.0		ug/L		6/27/00	SW846 8260B
s-Butylbenzene	< 0.20	0.20	0.64		ug/L		6/27/00	SW846 8260B
t-Butylbenzene	< 0.23	0.23	0.73		ug/L		6/27/00	SW846 8260B
n-Butylbenzene	< 0.28	0.28	0.89		ug/L		6/27/00	SW846 8260B
Carbon tetrachloride	< 0.22	0.22	0.70		ug/L		6/27/00	SW846 8260B
Chloroform	< 0.29	0.29	0.92		ug/L		6/27/00	SW846 8260B
Chlorobenzene	< 0.19	0.19	0.61		ug/L		6/27/00	SW846 8260B
Chlorodibromomethane	< 2.8	2.8	8.9		ug/L		6/27/00	SW846 8260B
Chloroethane	< 0.46	0.46	1.5		ug/L		6/27/00	SW846 8260B
Chloromethane	< 0.42	0.42	1.3		ug/L		6/27/00	SW846 8260B
2-Chlorotoluene	< 0.19	0.19	0.61		ug/L		6/27/00	SW846 8260B
4-Chlorotoluene	< 0.21	0.21	0.67		ug/L		6/27/00	SW846 8260B
1,2-Dibromo-3-chloropropane	< 0.69	0.69	2.2		ug/L		6/27/00	SW846 8260B
1,2-Dibromoethane	< 0.42	0.42	1.3		ug/L		6/27/00	SW846 8260B
Dibromomethane	< 0.22	0.22	0.70		ug/L		6/27/00	SW846 8260B
1,3-Dichlorobenzene	< 0.12	0.12	0.38		ug/L		6/27/00	SW846 8260B
1,4-Dichlorobenzene	< 0.31	0.31	0.99		ug/L		6/27/00	SW846 8260B
1,2-Dichloroethane	< 0.21	0.21	0.67		ug/L		6/27/00	SW846 8260B
1,2-Dichlorobenzene	< 0.20	0.20	0.64		ug/L		6/27/00	SW846 8260B
1,1-Dichloroethene	7.8	0.85	2.7		ug/L		6/27/00	SW846 8260B
cis-1,2-Dichloroethene	26	0.27	0.86		ug/L		6/27/00	SW846 8260B
Dichlorodifluoromethane	< 0.12	0.12	0.38		ug/L		6/27/00	SW846 8260B
trans-1,2-Dichloroethene	0.64	0.35	1.1		ug/L	Q	6/27/00	SW846 8260B
1,2-Dichloropropane	< 0.23	0.23	0.73		ug/L		6/27/00	SW846 8260B
1,1-Dichloroethane	43	0.17	0.54		ug/L		6/27/00	SW846 8260B
1,3-Dichloropropane	< 1.4	1.4	4.5		ug/L		6/27/00	SW846 8260B
2,2-Dichloropropane	< 0.28	0.28	0.89		ug/L		6/27/00	SW846 8260B

- Analytical Report -

Project Name : TECUMSEH PRODUCTS CO.

Project Number : #1177

Field ID : MW-18 BR(2)

Lab Sample Number : 802943-013

WI DNR LAB ID : 405132750

Client : MORAIN ENVIRONMENTAL INC

Report Date : 7/6/00

Collection Date : 6/21/00

Matrix Type : WATER

1,1-Dichloropropene	< 0.46	0.46	1.5	ug/L	6/27/00	SW846 8260B
cis-1,3-Dichloropropene	< 0.23	0.23	0.73	ug/L	6/27/00	SW846 8260B
trans-1,3-Dichloropropene	< 0.23	0.23	0.73	ug/L	6/27/00	SW846 8260B
Diisopropyl ether	< 0.23	0.23	0.73	ug/L	6/27/00	SW846 8260B
Ethylbenzene	< 0.57	0.57	1.8	ug/L	6/27/00	SW846 8260B
Fluorotrichloromethane	< 0.31	0.31	0.99	ug/L	6/27/00	SW846 8260B
Hexachlorobutadiene	< 0.43	0.43	1.4	ug/L	6/27/00	SW846 8260B
Isopropylbenzene	< 0.19	0.19	0.61	ug/L	6/27/00	SW846 8260B
p-Isopropyltoluene	< 0.25	0.25	0.80	ug/L	6/27/00	SW846 8260B
Methylene chloride	< 0.36	0.36	1.1	ug/L	6/27/00	SW846 8260B
Methyl-tert-butyl-ether	< 0.20	0.20	0.64	ug/L	6/27/00	SW846 8260B
Naphthalene	< 0.27	0.27	0.86	ug/L	6/27/00	SW846 8260B
n-Propylbenzene	< 0.17	0.17	0.54	ug/L	6/27/00	SW846 8260B
Styrene	< 0.72	0.72	2.3	ug/L	6/27/00	SW846 8260B
1,1,2,2-Tetrachloroethane	< 0.22	0.22	0.70	ug/L	6/27/00	SW846 8260B
1,1,1,2-Tetrachloroethane	< 0.30	0.30	0.96	ug/L	6/27/00	SW846 8260B
Tetrachloroethene	< 0.85	0.85	2.7	ug/L	6/27/00	SW846 8260B
Toluene	< 1.1	1.1	3.5	ug/L	6/27/00	SW846 8260B
1,2,3-Trichlorobenzene	< 0.30	0.30	0.96	ug/L	6/27/00	SW846 8260B
1,2,4-Trichlorobenzene	< 0.24	0.24	0.76	ug/L	6/27/00	SW846 8260B
1,1,1-Trichloroethane	19	0.21	0.67	ug/L	6/27/00	SW846 8260B
1,1,2-Trichloroethane	< 0.33	0.33	1.1	ug/L	6/27/00	SW846 8260B
1,2,4-Trimethylbenzene	< 0.34	0.34	1.1	ug/L	6/27/00	SW846 8260B
Trichloroethene	42	0.32	1.0	ug/L	6/27/00	SW846 8260B
1,2,3-Trichloropropane	< 0.89	0.89	2.8	ug/L	6/27/00	SW846 8260B
1,3,5-Trimethylbenzene	< 0.29	0.29	0.92	ug/L	6/27/00	SW846 8260B
Vinyl chloride	< 0.19	0.19	0.61	ug/L	6/27/00	SW846 8260B
Xylenes, -m, -p	< 0.35	0.35	1.1	ug/L	6/27/00	SW846 8260B
Xylene, -o	< 0.28	0.28	0.89	ug/L	6/27/00	SW846 8260B
4-Bromofluorobenzene	78			%Recov	6/27/00	SW846 8260B
Dibromofluoromethane	73			%Recov	6/27/00	SW846 8260B
Toluene-d8	86			%Recov	6/27/00	SW846 8260B

- Analytical Report -

Project Name : TECUMSEH PRODUCTS CO.

Project Number : #1177

Field ID : MW-18 BR(1)

Lab Sample Number : 802943-014

WI DNR LAB ID : 405132750

Client : MORAIN ENVIRONMENTAL INC

Report Date : 6/28/00

Collection Date : 6/21/00

Matrix Type : WATER

1,1-Dichloropropene	< 0.46	0.46	1.5	ug/L	6/27/00	SW846 8260B
cis-1,3-Dichloropropene	< 0.23	0.23	0.73	ug/L	6/27/00	SW846 8260B
trans-1,3-Dichloropropene	< 0.23	0.23	0.73	ug/L	6/27/00	SW846 8260B
Diisopropyl ether	< 0.23	0.23	0.73	ug/L	6/27/00	SW846 8260B
Ethylbenzene	< 0.57	0.57	1.8	ug/L	6/27/00	SW846 8260B
Fluorotrichloromethane	< 0.31	0.31	0.99	ug/L	6/27/00	SW846 8260B
Hexachlorobutadiene	< 0.43	0.43	1.4	ug/L	6/27/00	SW846 8260B
Isopropylbenzene	< 0.19	0.19	0.61	ug/L	6/27/00	SW846 8260B
p-Isopropyltoluene	< 0.25	0.25	0.80	ug/L	6/27/00	SW846 8260B
Methylene chloride	< 0.36	0.36	1.1	ug/L	6/27/00	SW846 8260B
Methyl-tert-butyl-ether	< 0.20	0.20	0.64	ug/L	6/27/00	SW846 8260B
Naphthalene	< 0.27	0.27	0.86	ug/L	6/27/00	SW846 8260B
n-Propylbenzene	< 0.17	0.17	0.54	ug/L	6/27/00	SW846 8260B
Styrene	< 0.72	0.72	2.3	ug/L	6/27/00	SW846 8260B
1,1,2,2-Tetrachloroethane	< 0.22	0.22	0.70	ug/L	6/27/00	SW846 8260B
1,1,1,2-Tetrachloroethane	< 0.30	0.30	0.96	ug/L	6/27/00	SW846 8260B
Tetrachloroethene	< 0.85	0.85	2.7	ug/L	6/27/00	SW846 8260B
Toluene	< 1.1	1.1	3.5	ug/L	6/27/00	SW846 8260B
1,2,3-Trichlorobenzene	< 0.30	0.30	0.96	ug/L	6/27/00	SW846 8260B
1,2,4-Trichlorobenzene	< 0.24	0.24	0.76	ug/L	6/27/00	SW846 8260B
1,1,1-Trichloroethane	< 0.21	0.21	0.67	ug/L	6/27/00	SW846 8260B
1,1,2-Trichloroethane	< 0.33	0.33	1.1	ug/L	6/27/00	SW846 8260B
1,2,4-Trimethylbenzene	< 0.34	0.34	1.1	ug/L	6/27/00	SW846 8260B
Trichloroethene	3.0	0.32	1.0	ug/L	6/27/00	SW846 8260B
1,2,3-Trichloropropane	< 0.89	0.89	2.8	ug/L	6/27/00	SW846 8260B
1,3,5-Trimethylbenzene	< 0.29	0.29	0.92	ug/L	6/27/00	SW846 8260B
Vinyl chloride	< 0.19	0.19	0.61	ug/L	6/27/00	SW846 8260B
Xylenes, -m, -p	< 0.35	0.35	1.1	ug/L	6/27/00	SW846 8260B
Xylene, -o	< 0.28	0.28	0.89	ug/L	6/27/00	SW846 8260B
4-Bromofluorobenzene	97			%Recov	6/27/00	SW846 8260B
Dibromofluoromethane	90			%Recov	6/27/00	SW846 8260B
Toluene-d8	106			%Recov	6/27/00	SW846 8260B

- Analytical Report -

Project Name : TECUMSEH PRODUCTS CO.

Project Number : #1177

Field ID : MW-20 BR(2)

Lab Sample Number : 802943-015

WI DNR LAB ID : 405132750

Client : MORaine ENVIRONMENTAL INC

Report Date : 7/6/00

Collection Date : 6/21/00

Matrix Type : WATER

Organic Results

EPA 8260 VOLATILE LIST- WATER

Prep Method: SW846 5030B

Prep Date: 6/28/00

Analyst: HW

Analyte	Result	LOD	LOQ	EQL	Units	Code	Analysis Date	Analysis Method
Benzene	< 0.29	0.29	0.92		ug/L		6/29/00	SW846 8260B
Bromobenzene	< 0.35	0.35	1.1		ug/L		6/29/00	SW846 8260B
Bromochloromethane	< 0.56	0.56	1.8		ug/L		6/29/00	SW846 8260B
Bromodichloromethane	< 0.30	0.30	0.96		ug/L		6/29/00	SW846 8260B
Bromoform	< 0.24	0.24	0.76		ug/L		6/29/00	SW846 8260B
Bromomethane	< 0.62	0.62	2.0		ug/L		6/29/00	SW846 8260B
s-Butylbenzene	< 0.20	0.20	0.64		ug/L		6/29/00	SW846 8260B
t-Butylbenzene	< 0.23	0.23	0.73		ug/L		6/29/00	SW846 8260B
n-Butylbenzene	< 0.28	0.28	0.89		ug/L		6/29/00	SW846 8260B
Carbon tetrachloride	< 0.22	0.22	0.70		ug/L		6/29/00	SW846 8260B
Chloroform	< 0.29	0.29	0.92		ug/L		6/29/00	SW846 8260B
Chlorobenzene	< 0.19	0.19	0.61		ug/L		6/29/00	SW846 8260B
Chlorodibromomethane	< 2.8	2.8	8.9		ug/L		6/29/00	SW846 8260B
Chloroethane	< 0.46	0.46	1.5		ug/L		6/29/00	SW846 8260B
Chloromethane	< 0.42	0.42	1.3		ug/L		6/29/00	SW846 8260B
2-Chlorotoluene	< 0.19	0.19	0.61		ug/L		6/29/00	SW846 8260B
4-Chlorotoluene	< 0.21	0.21	0.67		ug/L		6/29/00	SW846 8260B
1,2-Dibromo-3-chloropropane	< 0.69	0.69	2.2		ug/L		6/29/00	SW846 8260B
1,2-Dibromoethane	< 0.42	0.42	1.3		ug/L		6/29/00	SW846 8260B
Dibromomethane	< 0.22	0.22	0.70		ug/L		6/29/00	SW846 8260B
1,3-Dichlorobenzene	< 0.12	0.12	0.38		ug/L		6/29/00	SW846 8260B
1,4-Dichlorobenzene	< 0.31	0.31	0.99		ug/L		6/29/00	SW846 8260B
1,2-Dichloroethane	< 0.21	0.21	0.67		ug/L		6/29/00	SW846 8260B
1,2-Dichlorobenzene	< 0.20	0.20	0.64		ug/L		6/29/00	SW846 8260B
1,1-Dichloroethene	< 0.85	0.85	2.7		ug/L		6/29/00	SW846 8260B
cis-1,2-Dichloroethene	< 0.27	0.27	0.86		ug/L		6/29/00	SW846 8260B
Dichlorodifluoromethane	< 0.12	0.12	0.38		ug/L		6/29/00	SW846 8260B
trans-1,2-Dichloroethene	< 0.35	0.35	1.1		ug/L		6/29/00	SW846 8260B
1,2-Dichloropropane	< 0.23	0.23	0.73		ug/L		6/29/00	SW846 8260B
1,1-Dichloroethane	< 0.17	0.17	0.54		ug/L		6/29/00	SW846 8260B
1,3-Dichloropropane	< 1.4	1.4	4.5		ug/L		6/29/00	SW846 8260B
2,2-Dichloropropane	< 0.28	0.28	0.89		ug/L		6/29/00	SW846 8260B

- Analytical Report -

Project Name : TECUMSEH PRODUCTS CO.

Project Number : #1177

Field ID : MW-20 BR(2)

Lab Sample Number : 802943-015

WI DNR LAB ID : 405132750

Client : MORaine ENVIRONMENTAL INC

Report Date : 7/6/00

Collection Date : 6/21/00

Matrix Type : WATER

1,1-Dichloropropene	< 0.46	0.46	1.5	ug/L	6/29/00	SW846 8260B
cis-1,3-Dichloropropene	< 0.23	0.23	0.73	ug/L	6/29/00	SW846 8260B
trans-1,3-Dichloropropene	< 0.23	0.23	0.73	ug/L	6/29/00	SW846 8260B
Diisopropyl ether	< 0.23	0.23	0.73	ug/L	6/29/00	SW846 8260B
Ethylbenzene	< 0.57	0.57	1.8	ug/L	6/29/00	SW846 8260B
Fluorotrichloromethane	< 0.31	0.31	0.99	ug/L	6/29/00	SW846 8260B
Hexachlorobutadiene	< 0.43	0.43	1.4	ug/L	6/29/00	SW846 8260B
Isopropylbenzene	< 0.19	0.19	0.61	ug/L	6/29/00	SW846 8260B
p-Isopropyltoluene	< 0.25	0.25	0.80	ug/L	6/29/00	SW846 8260B
Methylene chloride	< 0.36	0.36	1.1	ug/L	6/29/00	SW846 8260B
Methyl-tert-butyl-ether	< 0.20	0.20	0.64	ug/L	6/29/00	SW846 8260B
Naphthalene	< 0.27	0.27	0.86	ug/L	6/29/00	SW846 8260B
n-Propylbenzene	< 0.17	0.17	0.54	ug/L	6/29/00	SW846 8260B
Styrene	< 0.72	0.72	2.3	ug/L	6/29/00	SW846 8260B
1,1,2,2-Tetrachloroethane	< 0.22	0.22	0.70	ug/L	6/29/00	SW846 8260B
1,1,1,2-Tetrachloroethane	< 0.30	0.30	0.96	ug/L	6/29/00	SW846 8260B
Tetrachloroethene	< 0.85	0.85	2.7	ug/L	6/29/00	SW846 8260B
Toluene	< 1.1	1.1	3.5	ug/L	6/29/00	SW846 8260B
1,2,3-Trichlorobenzene	< 0.30	0.30	0.96	ug/L	6/29/00	SW846 8260B
1,2,4-Trichlorobenzene	< 0.24	0.24	0.76	ug/L	6/29/00	SW846 8260B
1,1,1-Trichloroethane	< 0.21	0.21	0.67	ug/L	6/29/00	SW846 8260B
1,1,2-Trichloroethane	< 0.33	0.33	1.1	ug/L	6/29/00	SW846 8260B
1,2,4-Trimethylbenzene	< 0.34	0.34	1.1	ug/L	6/29/00	SW846 8260B
Trichloroethene	< 0.32	0.32	1.0	ug/L	6/29/00	SW846 8260B
1,2,3-Trichloropropane	< 0.89	0.89	2.8	ug/L	6/29/00	SW846 8260B
1,3,5-Trimethylbenzene	< 0.29	0.29	0.92	ug/L	6/29/00	SW846 8260B
Vinyl chloride	1.1	0.19	0.61	ug/L	6/29/00	SW846 8260B
Xylenes, -m, -p	< 0.35	0.35	1.1	ug/L	6/29/00	SW846 8260B
Xylene, -o	< 0.28	0.28	0.89	ug/L	6/29/00	SW846 8260B
4-Bromofluorobenzene	77			%Recov	6/29/00	SW846 8260B
Dibromofluoromethane	78			%Recov	6/29/00	SW846 8260B
Toluene-d8	88			%Recov	6/29/00	SW846 8260B



1795 Industrial Drive
Green Bay, WI 54302
920-469-2436
800-7-ENCHEM
FAX: 920-469-8827

- Analytical Report -

Project Name : TECUMSEH

Project Number : 1177

Client: MORaine ENVIRONMENTAL INC

WI DNR LAB ID : 405132750

Sample No.	Field ID	Collection Date	Sample No.	Field ID	Collection Date
803328-001	HEISER #1	7/17/00			
803328-002	RIESS - 935	7/17/00			
803328-003	WENDTLAND - 1355	7/17/00			

Please visit our Internet homepage at: www.enchem.com

The "Q" flag is present when a parameter has been detected below the LOQ. This indicates the results are qualified due to the uncertainty of the parameter concentration between the LOD and the LOQ.

Soil VOC detects are corrected for the total solids, unless otherwise noted.

I certify that the data contained in this Final Report has been generated and reviewed in accordance with approved methods and Laboratory Standard Operating Procedure. Exceptions, if any, are discussed in the accompanying sample comments. Release of this final report is authorized by Laboratory management, as is verified by the following signature. Reported results shall not be reproduced, except in full, without the written approval of the lab. The sample results relate only to the analytes of interest tested.

G. Duranceau
Approval Signature

7/24/00
Date

- Analytical Report -

Project Name : TECUMSEH
 Project Number : 1177
 Field ID : HEISER #1
 Lab Sample Number : 803328-001
 WI DNR LAB ID : 405132750

Client : MORAIN ENVIRONMENTAL INC
 Report Date : 7/21/00
 Collection Date : 7/17/00
 Matrix Type : WATER

Organic Results

EPA 8260 VOLATILE LIST- WATER

Prep Method: SW846 5030B

Prep Date: 7/20/00

Analyst: RJN

Analyte	Result	LOD	LOQ	EQL	Units	Code	Analysis Date	Analysis Method
Benzene	< 0.29	0.29	0.92		ug/L		7/20/00	SW846 8260B
Bromobenzene	< 0.35	0.35	1.1		ug/L		7/20/00	SW846 8260B
Bromochloromethane	< 0.56	0.56	1.8		ug/L		7/20/00	SW846 8260B
Bromodichloromethane	< 0.30	0.30	0.96		ug/L		7/20/00	SW846 8260B
Bromoform	< 0.24	0.24	0.76		ug/L		7/20/00	SW846 8260B
Bromomethane	< 0.62	0.62	2.0		ug/L		7/20/00	SW846 8260B
s-Butylbenzene	< 0.20	0.20	0.64		ug/L		7/20/00	SW846 8260B
t-Butylbenzene	< 0.23	0.23	0.73		ug/L		7/20/00	SW846 8260B
n-Butylbenzene	< 0.28	0.28	0.89		ug/L		7/20/00	SW846 8260B
Carbon tetrachloride	< 0.22	0.22	0.70		ug/L		7/20/00	SW846 8260B
Chloroform	1.2	0.29	0.92		ug/L		7/20/00	SW846 8260B
Chlorobenzene	< 0.19	0.19	0.61		ug/L		7/20/00	SW846 8260B
Chlorodibromomethane	< 2.8	2.8	8.9		ug/L		7/20/00	SW846 8260B
Chloroethane	< 0.46	0.46	1.5		ug/L		7/20/00	SW846 8260B
Chloromethane	< 0.42	0.42	1.3		ug/L		7/20/00	SW846 8260B
2-Chlorotoluene	< 0.19	0.19	0.61		ug/L		7/20/00	SW846 8260B
4-Chlorotoluene	< 0.21	0.21	0.67		ug/L		7/20/00	SW846 8260B
1,2-Dibromo-3-chloropropane	< 0.69	0.69	2.2		ug/L		7/20/00	SW846 8260B
1,2-Dibromoethane	< 0.42	0.42	1.3		ug/L		7/20/00	SW846 8260B
Dibromomethane	< 0.22	0.22	0.70		ug/L		7/20/00	SW846 8260B
1,3-Dichlorobenzene	< 0.12	0.12	0.38		ug/L		7/20/00	SW846 8260B
1,4-Dichlorobenzene	< 0.31	0.31	0.99		ug/L		7/20/00	SW846 8260B
1,2-Dichloroethane	< 0.21	0.21	0.67		ug/L		7/20/00	SW846 8260B
1,2-Dichlorobenzene	< 0.20	0.20	0.64		ug/L		7/20/00	SW846 8260B
1,1-Dichloroethene	< 0.85	0.85	2.7		ug/L		7/20/00	SW846 8260B
cis-1,2-Dichloroethene	1.8	0.27	0.86		ug/L		7/20/00	SW846 8260B
Dichlorodifluoromethane	< 0.12	0.12	0.38		ug/L		7/20/00	SW846 8260B
trans-1,2-Dichloroethene	< 0.35	0.35	1.1		ug/L		7/20/00	SW846 8260B
1,2-Dichloropropane	< 0.23	0.23	0.73		ug/L		7/20/00	SW846 8260B
1,1-Dichloroethane	1.6	0.17	0.54		ug/L		7/20/00	SW846 8260B
1,3-Dichloropropane	< 1.4	1.4	4.5		ug/L		7/20/00	SW846 8260B
2,2-Dichloropropane	< 0.28	0.28	0.89		ug/L		7/20/00	SW846 8260B

- Analytical Report -

Project Name : TECUMSEH
Project Number : 1177
Field ID : HEISER #1
Lab Sample Number : 803328-001
WI DNR LAB ID : 405132750

Client : MORaine ENVIRONMENTAL INC
Report Date : 7/21/00
Collection Date : 7/17/00
Matrix Type : WATER

1,1-Dichloropropene	< 0.46	0.46	1.5	ug/L	7/20/00	SW846 8260B
cis-1,3-Dichloropropene	< 0.23	0.23	0.73	ug/L	7/20/00	SW846 8260B
trans-1,3-Dichloropropene	< 0.23	0.23	0.73	ug/L	7/20/00	SW846 8260B
Diisopropyl ether	< 0.23	0.23	0.73	ug/L	7/20/00	SW846 8260B
Ethylbenzene	< 0.57	0.57	1.8	ug/L	7/20/00	SW846 8260B
Fluorotrichloromethane	< 0.31	0.31	0.99	ug/L	7/20/00	SW846 8260B
Hexachlorobutadiene	< 0.43	0.43	1.4	ug/L	7/20/00	SW846 8260B
Isopropylbenzene	< 0.19	0.19	0.61	ug/L	7/20/00	SW846 8260B
p-Isopropyltoluene	< 0.25	0.25	0.80	ug/L	7/20/00	SW846 8260B
Methylene chloride	< 0.36	0.36	1.1	ug/L	7/20/00	SW846 8260B
Methyl-tert-butyl-ether	< 0.20	0.20	0.64	ug/L	7/20/00	SW846 8260B
Naphthalene	< 0.27	0.27	0.86	ug/L	7/20/00	SW846 8260B
n-Propylbenzene	< 0.17	0.17	0.54	ug/L	7/20/00	SW846 8260B
Styrene	< 0.72	0.72	2.3	ug/L	7/20/00	SW846 8260B
1,1,2,2-Tetrachloroethane	< 0.22	0.22	0.70	ug/L	7/20/00	SW846 8260B
1,1,1,2-Tetrachloroethane	< 0.30	0.30	0.96	ug/L	7/20/00	SW846 8260B
Tetrachloroethene	< 0.85	0.85	2.7	ug/L	7/20/00	SW846 8260B
Toluene	< 1.1	1.1	3.5	ug/L	7/20/00	SW846 8260B
1,2,3-Trichlorobenzene	< 0.30	0.30	0.96	ug/L	7/20/00	SW846 8260B
1,2,4-Trichlorobenzene	< 0.24	0.24	0.76	ug/L	7/20/00	SW846 8260B
1,1,1-Trichloroethane	< 0.21	0.21	0.67	ug/L	7/20/00	SW846 8260B
1,1,2-Trichloroethane	< 0.33	0.33	1.1	ug/L	7/20/00	SW846 8260B
1,2,4-Trimethylbenzene	< 0.34	0.34	1.1	ug/L	7/20/00	SW846 8260B
Trichloroethene	2.4	0.32	1.0	ug/L	7/20/00	SW846 8260B
1,2,3-Trichloropropane	< 0.89	0.89	2.8	ug/L	7/20/00	SW846 8260B
1,3,5-Trimethylbenzene	< 0.29	0.29	0.92	ug/L	7/20/00	SW846 8260B
Vinyl chloride	< 0.19	0.19	0.61	ug/L	7/20/00	SW846 8260B
Xylenes, -m, -p	< 0.35	0.35	1.1	ug/L	7/20/00	SW846 8260B
Xylene, -o	< 0.28	0.28	0.89	ug/L	7/20/00	SW846 8260B
4-Bromofluorobenzene	102			%Recov	7/20/00	SW846 8260B
Dibromofluoromethane	99			%Recov	7/20/00	SW846 8260B
Toluene-d8	103			%Recov	7/20/00	SW846 8260B

- Analytical Report -

Project Name : TECUMSEH
Project Number : 1177
Field ID : RIESS - 935
Lab Sample Number : 803328-002
WI DNR LAB ID : 405132750

Client : MORAIN ENVIRONMENTAL INC
Report Date : 7/21/00
Collection Date : 7/17/00
Matrix Type : WATER

Organic Results

EPA 8260 VOLATILE LIST- WATER

Prep Method: SW846 5030B Prep Date: 7/20/00 Analyst: RJN

Analyte	Result	LOD	LOQ	EQL	Units	Code	Analysis Date	Analysis Method
Benzene	< 0.29	0.29	0.92		ug/L		7/21/00	SW846 8260B
Bromobenzene	< 0.35	0.35	1.1		ug/L		7/21/00	SW846 8260B
Bromochloromethane	< 0.56	0.56	1.8		ug/L		7/21/00	SW846 8260B
Bromodichloromethane	< 0.30	0.30	0.96		ug/L		7/21/00	SW846 8260B
Bromoform	< 0.24	0.24	0.76		ug/L		7/21/00	SW846 8260B
Bromomethane	< 0.62	0.62	2.0		ug/L		7/21/00	SW846 8260B
s-Butylbenzene	< 0.20	0.20	0.64		ug/L		7/21/00	SW846 8260B
t-Butylbenzene	< 0.23	0.23	0.73		ug/L		7/21/00	SW846 8260B
n-Butylbenzene	< 0.28	0.28	0.89		ug/L		7/21/00	SW846 8260B
Carbon tetrachloride	< 0.22	0.22	0.70		ug/L		7/21/00	SW846 8260B
Chloroform	< 0.29	0.29	0.92		ug/L		7/21/00	SW846 8260B
Chlorobenzene	< 0.19	0.19	0.61		ug/L		7/21/00	SW846 8260B
Chlorodibromomethane	< 2.8	2.8	8.9		ug/L		7/21/00	SW846 8260B
Chloroethane	< 0.46	0.46	1.5		ug/L		7/21/00	SW846 8260B
Chloromethane	< 0.42	0.42	1.3		ug/L		7/21/00	SW846 8260B
2-Chlorotoluene	< 0.19	0.19	0.61		ug/L		7/21/00	SW846 8260B
4-Chlorotoluene	< 0.21	0.21	0.67		ug/L		7/21/00	SW846 8260B
1,2-Dibromo-3-chloropropane	< 0.69	0.69	2.2		ug/L		7/21/00	SW846 8260B
1,2-Dibromoethane	< 0.42	0.42	1.3		ug/L		7/21/00	SW846 8260B
Dibromomethane	< 0.22	0.22	0.70		ug/L		7/21/00	SW846 8260B
1,3-Dichlorobenzene	< 0.12	0.12	0.38		ug/L		7/21/00	SW846 8260B
1,4-Dichlorobenzene	< 0.31	0.31	0.99		ug/L		7/21/00	SW846 8260B
1,2-Dichloroethane	< 0.21	0.21	0.67		ug/L		7/21/00	SW846 8260B
1,2-Dichlorobenzene	< 0.20	0.20	0.64		ug/L		7/21/00	SW846 8260B
1,1-Dichloroethene	< 0.85	0.85	2.7		ug/L		7/21/00	SW846 8260B
cis-1,2-Dichloroethene	< 0.27	0.27	0.86		ug/L		7/21/00	SW846 8260B
Dichlorodifluoromethane	< 0.12	0.12	0.38		ug/L		7/21/00	SW846 8260B
trans-1,2-Dichloroethene	< 0.35	0.35	1.1		ug/L		7/21/00	SW846 8260B
1,2-Dichloropropane	< 0.23	0.23	0.73		ug/L		7/21/00	SW846 8260B
1,1-Dichloroethane	< 0.17	0.17	0.54		ug/L		7/21/00	SW846 8260B
1,3-Dichloropropane	< 1.4	1.4	4.5		ug/L		7/21/00	SW846 8260B
2,2-Dichloropropane	< 0.28	0.28	0.89		ug/L		7/21/00	SW846 8260B

- Analytical Report -

Project Name : TECUMSEH
Project Number : 1177
Field ID : RIESS - 935
Lab Sample Number : 803328-002
WI DNR LAB ID : 405132750

Client : MORAIN ENVIRONMENTAL INC
Report Date : 7/21/00
Collection Date : 7/17/00
Matrix Type : WATER

1,1-Dichloropropene	< 0.46	0.46	1.5	ug/L	7/21/00	SW846 8260B
cis-1,3-Dichloropropene	< 0.23	0.23	0.73	ug/L	7/21/00	SW846 8260B
trans-1,3-Dichloropropene	< 0.23	0.23	0.73	ug/L	7/21/00	SW846 8260B
Diisopropyl ether	< 0.23	0.23	0.73	ug/L	7/21/00	SW846 8260B
Ethylbenzene	< 0.57	0.57	1.8	ug/L	7/21/00	SW846 8260B
Fluorotrichloromethane	< 0.31	0.31	0.99	ug/L	7/21/00	SW846 8260B
Hexachlorobutadiene	< 0.43	0.43	1.4	ug/L	7/21/00	SW846 8260B
Isopropylbenzene	< 0.19	0.19	0.61	ug/L	7/21/00	SW846 8260B
p-Isopropyltoluene	< 0.25	0.25	0.80	ug/L	7/21/00	SW846 8260B
Methylene chloride	< 0.36	0.36	1.1	ug/L	7/21/00	SW846 8260B
Methyl-tert-butyl-ether	< 0.20	0.20	0.64	ug/L	7/21/00	SW846 8260B
Naphthalene	< 0.27	0.27	0.86	ug/L	7/21/00	SW846 8260B
n-Propylbenzene	< 0.17	0.17	0.54	ug/L	7/21/00	SW846 8260B
Styrene	< 0.72	0.72	2.3	ug/L	7/21/00	SW846 8260B
1,1,2,2-Tetrachloroethane	< 0.22	0.22	0.70	ug/L	7/21/00	SW846 8260B
1,1,1,2-Tetrachloroethane	< 0.30	0.30	0.96	ug/L	7/21/00	SW846 8260B
Tetrachloroethene	< 0.85	0.85	2.7	ug/L	7/21/00	SW846 8260B
Toluene	< 1.1	1.1	3.5	ug/L	7/21/00	SW846 8260B
1,2,3-Trichlorobenzene	< 0.30	0.30	0.96	ug/L	7/21/00	SW846 8260B
1,2,4-Trichlorobenzene	< 0.24	0.24	0.76	ug/L	7/21/00	SW846 8260B
1,1,1-Trichloroethane	< 0.21	0.21	0.67	ug/L	7/21/00	SW846 8260B
1,1,2-Trichloroethane	< 0.33	0.33	1.1	ug/L	7/21/00	SW846 8260B
1,2,4-Trimethylbenzene	< 0.34	0.34	1.1	ug/L	7/21/00	SW846 8260B
Trichloroethene	< 0.32	0.32	1.0	ug/L	7/21/00	SW846 8260B
1,2,3-Trichloropropane	< 0.89	0.89	2.8	ug/L	7/21/00	SW846 8260B
1,3,5-Trimethylbenzene	< 0.29	0.29	0.92	ug/L	7/21/00	SW846 8260B
Vinyl chloride	< 0.19	0.19	0.61	ug/L	7/21/00	SW846 8260B
Xylenes, -m, -p	< 0.35	0.35	1.1	ug/L	7/21/00	SW846 8260B
Xylene, -o	< 0.28	0.28	0.89	ug/L	7/21/00	SW846 8260B
4-Bromofluorobenzene	99			%Recov	7/21/00	SW846 8260B
Dibromofluoromethane	99			%Recov	7/21/00	SW846 8260B
Toluene-d8	100			%Recov	7/21/00	SW846 8260B

- Analytical Report -

Project Name : TECUMSEH
Project Number : 1177
Field ID : WENDTLAND - 1355
Lab Sample Number : 803328-003
WI DNR LAB ID : 405132750

Client : MORaine ENVIRONMENTAL INC
Report Date : 7/21/00
Collection Date : 7/17/00
Matrix Type : WATER

Organic Results

EPA 8260 VOLATILE LIST- WATER

Prep Method: SW846 5030B Prep Date: 7/20/00 Analyst: RJN

Analyte	Result	LOD	LOQ	EQL	Units	Code	Analysis Date	Analysis Method
Benzene	< 0.29	0.29	0.92		ug/L		7/21/00	SW846 8260B
Bromobenzene	< 0.35	0.35	1.1		ug/L		7/21/00	SW846 8260B
Bromochloromethane	< 0.56	0.56	1.8		ug/L		7/21/00	SW846 8260B
Bromodichloromethane	< 0.30	0.30	0.96		ug/L		7/21/00	SW846 8260B
Bromoform	< 0.24	0.24	0.76		ug/L		7/21/00	SW846 8260B
Bromomethane	< 0.62	0.62	2.0		ug/L		7/21/00	SW846 8260B
s-Butylbenzene	< 0.20	0.20	0.64		ug/L		7/21/00	SW846 8260B
t-Butylbenzene	< 0.23	0.23	0.73		ug/L		7/21/00	SW846 8260B
n-Butylbenzene	< 0.28	0.28	0.89		ug/L		7/21/00	SW846 8260B
Carbon tetrachloride	< 0.22	0.22	0.70		ug/L		7/21/00	SW846 8260B
Chloroform	< 0.29	0.29	0.92		ug/L		7/21/00	SW846 8260B
Chlorobenzene	< 0.19	0.19	0.61		ug/L		7/21/00	SW846 8260B
Chlorodibromomethane	< 2.8	2.8	8.9		ug/L		7/21/00	SW846 8260B
Chloroethane	< 0.46	0.46	1.5		ug/L		7/21/00	SW846 8260B
Chloromethane	< 0.42	0.42	1.3		ug/L		7/21/00	SW846 8260B
2-Chlorotoluene	< 0.19	0.19	0.61		ug/L		7/21/00	SW846 8260B
4-Chlorotoluene	< 0.21	0.21	0.67		ug/L		7/21/00	SW846 8260B
1,2-Dibromo-3-chloropropane	< 0.69	0.69	2.2		ug/L		7/21/00	SW846 8260B
1,2-Dibromoethane	< 0.42	0.42	1.3		ug/L		7/21/00	SW846 8260B
Dibromomethane	< 0.22	0.22	0.70		ug/L		7/21/00	SW846 8260B
1,3-Dichlorobenzene	< 0.12	0.12	0.38		ug/L		7/21/00	SW846 8260B
1,4-Dichlorobenzene	< 0.31	0.31	0.99		ug/L		7/21/00	SW846 8260B
1,2-Dichloroethane	< 0.21	0.21	0.67		ug/L		7/21/00	SW846 8260B
1,2-Dichlorobenzene	< 0.20	0.20	0.64		ug/L		7/21/00	SW846 8260B
1,1-Dichloroethene	< 0.85	0.85	2.7		ug/L		7/21/00	SW846 8260B
cis-1,2-Dichloroethene	< 0.27	0.27	0.86		ug/L		7/21/00	SW846 8260B
Dichlorodifluoromethane	< 0.12	0.12	0.38		ug/L		7/21/00	SW846 8260B
trans-1,2-Dichloroethene	< 0.35	0.35	1.1		ug/L		7/21/00	SW846 8260B
1,2-Dichloropropane	< 0.23	0.23	0.73		ug/L		7/21/00	SW846 8260B
1,1-Dichloroethane	2.5	0.17	0.54		ug/L		7/21/00	SW846 8260B
1,3-Dichloropropane	< 1.4	1.4	4.5		ug/L		7/21/00	SW846 8260B
2,2-Dichloropropane	< 0.28	0.28	0.89		ug/L		7/21/00	SW846 8260B

- Analytical Report -

Project Name : TECUMSEH

Project Number : 1177

Field ID : WENDTLAND - 1355

Lab Sample Number : 803328-003

WI DNR LAB ID : 405132750

Client : MORAINÉ ENVIRONMENTAL INC

Report Date : 7/21/00

Collection Date : 7/17/00

Matrix Type : WATER

1,1-Dichloropropene	< 0.46	0.46	1.5	ug/L	7/21/00	SW846 8260B
cis-1,3-Dichloropropene	< 0.23	0.23	0.73	ug/L	7/21/00	SW846 8260B
trans-1,3-Dichloropropene	< 0.23	0.23	0.73	ug/L	7/21/00	SW846 8260B
Diisopropyl ether	< 0.23	0.23	0.73	ug/L	7/21/00	SW846 8260B
Ethylbenzene	< 0.57	0.57	1.8	ug/L	7/21/00	SW846 8260B
Fluorotrichloromethane	< 0.31	0.31	0.99	ug/L	7/21/00	SW846 8260B
Hexachlorobutadiene	< 0.43	0.43	1.4	ug/L	7/21/00	SW846 8260B
Isopropylbenzene	< 0.19	0.19	0.61	ug/L	7/21/00	SW846 8260B
p-Isopropyltoluene	< 0.25	0.25	0.80	ug/L	7/21/00	SW846 8260B
Methylene chloride	< 0.36	0.36	1.1	ug/L	7/21/00	SW846 8260B
Methyl-tert-butyl-ether	< 0.20	0.20	0.64	ug/L	7/21/00	SW846 8260B
Naphthalene	< 0.27	0.27	0.86	ug/L	7/21/00	SW846 8260B
n-Propylbenzene	< 0.17	0.17	0.54	ug/L	7/21/00	SW846 8260B
Styrene	< 0.72	0.72	2.3	ug/L	7/21/00	SW846 8260B
1,1,2,2-Tetrachloroethane	< 0.22	0.22	0.70	ug/L	7/21/00	SW846 8260B
1,1,1,2-Tetrachloroethane	< 0.30	0.30	0.96	ug/L	7/21/00	SW846 8260B
Tetrachloroethene	< 0.85	0.85	2.7	ug/L	7/21/00	SW846 8260B
Toluene	< 1.1	1.1	3.5	ug/L	7/21/00	SW846 8260B
1,2,3-Trichlorobenzene	< 0.30	0.30	0.96	ug/L	7/21/00	SW846 8260B
1,2,4-Trichlorobenzene	< 0.24	0.24	0.76	ug/L	7/21/00	SW846 8260B
1,1,1-Trichloroethane	1.8	0.21	0.67	ug/L	7/21/00	SW846 8260B
1,1,2-Trichloroethane	< 0.33	0.33	1.1	ug/L	7/21/00	SW846 8260B
1,2,4-Trimethylbenzene	< 0.34	0.34	1.1	ug/L	7/21/00	SW846 8260B
Trichloroethene	1.9	0.32	1.0	ug/L	7/21/00	SW846 8260B
1,2,3-Trichloropropane	< 0.89	0.89	2.8	ug/L	7/21/00	SW846 8260B
1,3,5-Trimethylbenzene	< 0.29	0.29	0.92	ug/L	7/21/00	SW846 8260B
Vinyl chloride	< 0.19	0.19	0.61	ug/L	7/21/00	SW846 8260B
Xylenes, -m, -p	< 0.35	0.35	1.1	ug/L	7/21/00	SW846 8260B
Xylene, -o	< 0.28	0.28	0.89	ug/L	7/21/00	SW846 8260B
4-Bromofluorobenzene	103			%Recov	7/21/00	SW846 8260B
Dibromofluoromethane	97			%Recov	7/21/00	SW846 8260B
Toluene-d8	102			%Recov	7/21/00	SW846 8260B

ATTACHMENT B

**PREVIOUS ANALYTICAL SUMMARY TABLES
(MEI and RMT, INC.)**

**TABLE 1
TECUMSEH MONITORING - GRAFTON FACILITY
GROUNDWATER LAB RESULTS (detected compounds only)**

Well Name	MW-3-D	MW-9	MW-9D	MW-12	MW-12 BR	MW-19 BR (1)	MW-19 BR (2)	MW-21 BR (1)	MW-21 BR (2)	MW-22 BR	Raess Residence PW-5	Wendtland Residence PW-38	Heiser Residence PW-30	NR140 ES	NR140 PAL
Collection Date	1/6/00	1/6/00	1/6/00	1/6/00	1/6/00	1/6/00	1/6/00	1/6/00	1/6/00	1/6/00	2/28/00	2/28/00	2/28/00		
1,1-Dichloroethene	<0.43	24	19	<4.3	10	15.0	1.4	<0.43	<0.43	<0.43	<0.43	<0.43	<0.43	7.0	0.7
cis-1,2-Dichloroethene	0.46	760	180	12	180	48.0	10	<0.28	<0.28	6.8	<0.28	<0.28	3.2	70	7.0
trans-1,2-Dichloroethene	<0.79	16	<7.9	<7.9	<0.79	<1.6	<0.79	<0.79	<0.79	<0.79	<0.79	<0.79	<0.79	100	20.0
1,1-Dichloroethane	<0.35	56	70	17	80	100	6.7	<0.35	<0.35	0.98	1.10	2.80	3.20	850	85
Diisopropyl Ether	10.0	<5.5	<5.5	<5.5	<0.55	<1.1	<0.55	<0.55	<0.55	<0.55	<0.55	<0.55	<0.55	NSE	NSE
Toluene	<0.27	<2.7	<2.7	<2.7	3.9	<0.54	<0.27	<0.27	<0.27	<0.27	<0.27	<0.27	<0.27	1,000	200
1,1,1-Trichloroethane	<0.30	310	170	110	110	3.4	<0.30	<0.30	<0.30	<0.30	1.1	1.6	1.4	200	40
Trichloroethene	9.0	2,000	910	980	2.5	320	3.7	<0.37	<0.37	33	<0.37	2.4	4.2	5.0	0.5
Vinyl Chloride	<0.20	<2.0	9.0	<2.0	<0.20	2.9	2.0	0.31	<0.20	<0.20	<0.20	<0.20	<0.20	0.2	0.02

Notes:

ug/L = micrograms per liter = parts per billion (ppb)
 NSE = No Standard Established
 ES = NR140.10 Enforcement Standard
 PAL = NR140.10 Preventative Action Limit
 Highlighted and Bold results indicate concentrations exceeding WDNR NR140 ES
 Bold results indicate concentrations exceeding WDNR NR140 PAL

**TABLE 1
TECUMSEH MONITORING - GRAFTON FACILITY
GROUNDWATER LAB RESULTS (detected compounds only)**

Well Name Collection Date	MW-3 BR (2) 7/6/99	MW-3-D 7/6/99	MW-9 7/6/99	MW-12 7/6/99	MW-12 BR (1) 7/6/99	MW-18 BR (1) 7/6/99	MW-18 BR (2) 7/6/99	MW-19 BR (1) 7/6/99	MW-19 BR (2) 7/6/99	MW-20 BR (1) 7/6/99	MW-20 BR (2) 7/6/99	MW-21 BR (1) 7/6/99	MW-21 BR (2) 7/6/99	MW-22 BR 7/6/99	Raass Residence PW-5 7/6/99	Wendland Residence PW-38 7/6/99	Heiser Residence PW-30 7/6/99	NR140 ES	NR140 PAL
Chloroform	<0.35	<0.35	<0.35	<1.7	<0.35	<0.35	<0.35	<0.35	<0.35	<0.35	<0.35	<0.35	<0.35	<0.35	<0.35	<0.35	1.4	6.0	0.6
Chloroethane	0.56Q	<0.54	<0.54	<2.7	<0.54	<0.54	<0.54	<0.54	1.8	<0.54	<0.54	<0.54	<0.54	<0.54	<0.54	<0.54	<0.54	400	80
1,2-Dichloroethane	0.60Q	<0.37	<0.37	<1.8	<0.37	<0.37	<0.37	<0.37	<0.37	<0.37	<0.37	<0.37	<0.37	<0.37	<0.37	<0.37	<0.37	5.0	0.5
1,1-Dichloroethene	<0.43	<0.43	<0.43	<2.1	2.1	0.99Q	6.9	6.2	0.89Q	<0.43	<0.43	<0.43	<0.43	<0.43	<0.43	<0.43	<0.43	7.0	0.7
cis-1,2-Dichloroethene	<0.28	0.44Q	30	3.6Q	190	4.0	25	27	4.3	<0.28	<0.28	<0.28	<0.28	2.3	<0.28	<0.28	1.0	70	7.0
1,1-Dichloroethane	66	<0.35	78	2.3Q	100	8.8	41	60	11	<0.35	<0.35	<0.35	<0.35	0.74Q	<0.35	<0.35	1.0Q	850	85
Diisopropyl Ether	<0.55	6.6	<0.55	<2.8	<0.55	<0.55	<0.55	<0.55	<0.55	<0.55	<0.55	<0.55	<0.55	<0.55	<0.55	<0.55	<0.55	NSE	NSE
Isopropylbenzene	<0.26	<0.26	<0.26	<1.3	<0.26	<0.26	<0.26	<0.26	<0.26	<0.26	<0.26	<0.26	<0.26	<0.26	<0.26	<0.26	<0.26	NSE	NSE
Methylene Chloride	<0.36	<0.36	<0.36	2.2	<0.36	<0.36	<0.36	<0.36	<0.36	<0.36	<0.36	<0.36	<0.36	<0.36	<0.36	<0.36	<0.36	5.0	0.5
n-Propylbenzene	<0.76	<0.76	<0.76	<3.8	<0.76	<0.76	<0.76	<0.76	<0.76	<0.76	<0.76	<0.76	<0.76	<0.76	<0.76	<0.76	<0.76	NSE	NSE
Methyl-tert-butyl-ether	<0.32	<0.32	<0.32	<1.6	<0.32	0.50Q	<0.32	<0.32	<0.32	<0.32	<0.32	<0.32	<0.32	<0.32	<0.32	<0.32	<0.32	60	12
Toluene	<0.27	<0.27	0.67Q	<1.4	3.5	<0.27	<0.27	<0.27	0.29Q	<0.27	<0.27	<0.27	<0.27	<0.27	<0.27	<0.27	<0.27	343	69
1,1,1-Trichloroethane	1.1	<0.30	41	36	190	4.4	30	1.4	<0.30	<0.30	<0.30	<0.30	<0.30	<0.30	<0.30	1.5	0.63Q	200	40
Trichloroethene	<0.37	<0.37	<0.37	680	70	6.2	46	150	11	<0.37	<0.37	<0.37	<0.37	<0.37	<0.37	1.6	1.7	5.0	0.5
Vinyl Chloride	0.29Q	<0.20	<0.20	<1.0	0.26Q	<0.20	<0.20	1.1	0.7	0.38Q	0.52Q	<0.20	0.25Q	<0.20	<0.20	<0.20	<0.20	0.2	0.02

Notes:
 1. All concentrations are in micrograms per liter (µg/L) unless otherwise noted.
 2. ND = Not Detected.
 3. Q = Quantitation Limit.
 4. M = Method Detection Limit.
 5. Sample Collection Date: 7/6/99.
 6. Laboratory: [illegible]
 7. [illegible]

TABLE 18

SUMMARY OF VOCs DETECTED IN ON-SITE GROUNDWATER ALONG THE EASTERN PROPERTY LINE (µg/L)¹
TECUMSEH PRODUCTS COMPANY

Well I.D.	Sample Date	1,1-DCE	1,1-DCA	cis-1,2-DCE	trans-1,2-DCE	1,1,1-TCA	TCE	Vinyl Chloride	Toluene	Ethyl-benzene	Xylenes (total)	Naphthalene	Ethene	Ethane	Methane	Other Parameters Detected
Eastern Property Line																
MW-3	8-25-94	< 1.0	< 1.0	< 1.0	< 1.0	< 1.0	39	< 1.0	< 1.0	< 1.0	< 3.0	< 5.0	NA	NA	NA	No
	6-4-96	< 1.0	< 1.0	< 1.0	< 1.0	< 1.0	10	< 1.0	< 1.0	< 1.0	< 3.0	< 5.0	NA	NA	NA	No
MW-3D	8-25-94	24	7.2	6.8	< 5.0	21	88	6.1	< 5.0	54	78	< 25	NA	NA	NA	Yes ²
	12-14-94	12	9.8	< 5.0	< 5.0	28	27	5.8	< 5.0	< 5.0	< 15	< 25	NA	NA	NA	Yes ²
	8-5-96	< 10	130	20	< 10	26	15	17	< 10	< 10	< 30	< 50	NA	NA	NA	No
	12-4-96	6.7	22	8.0	< 1.0	< 1.0	55	6.9	< 1.0	< 1.0	< 2.0	< 2.0	0.3	10.9	< 6.0	No
MW-3BR1	12-14-94	13	65	45	< 5.0	120	88	< 5.0	< 5.0	< 5.0	< 15	< 25	NA	NA	NA	No
	8-30-95	< 5.0	25	26	< 5.0	46	42	< 5.0	< 5.0	< 5.0	< 15	< 25	NA	NA	NA	No
	6-11-96 ³	13	47 D	58 D	< 1.0	75 D	100 D	3.0	1.6	< 1.0	< 3.0	< 5.0	NA	NA	NA	Yes ²
	6-11-96 ³	14	49 D	58 D	< 1.0	78 D	110 D	2.4	< 1.0	< 1.0	< 3.0	< 5.0	NA	NA	NA	No
MW-3BR2	12-14-94	56	190	20	< 10	140	310	< 10	< 10	< 10	< 30	< 50	NA	NA	NA	No
	8-30-95	< 10	48	< 10	< 10	29	100	< 10	< 10	< 10	< 30	< 50	NA	NA	NA	No
	6-11-96	32	130 D	37	< 1.0	98 D	220 D	2.0	2.0	< 1.0	< 3.0	< 5.0	NA	NA	NA	No
	12-5-96 ³	29	130	48	< 5.0	< 5.0	220	< 10	< 5.0	< 5.0	< 10	< 10	0.4	< 0.1	19.4	No
	12-5-96 ³	27	130	47	0.8 Q	82	210	1.3 Q	< 1.0	< 1.0	< 2.0	< 2.0	NA	NA	NA	No
MW-3BR3	12-14-94	8.6	39	25	< 5.0	28	270	< 5.0	< 5.0	< 5.0	< 15	< 25	NA	NA	NA	No
	8-30-95	< 5.0	31	15	< 5.0	16	170	< 5.0	< 5.0	< 5.0	< 15	< 25	NA	NA	NA	No
	6-11-96	33	58 D	19	< 1.0	110 D	250 D	1.3	2.2	< 1.0	< 3.0	< 5.0	NA	NA	NA	No
	8-24-94	< 100	100	1,500	< 100	530	3,000	< 100	< 100	< 100	< 300	< 500	NA	NA	NA	No
MW-9	8-4-96	180	190	1,200	< 100	1,100	1,900	< 100	< 100	< 100	< 300	< 500	NA	NA	NA	No
	12-4-96	51 Q	< 100	2,700	< 100	1,100	2,800	< 200	< 100	< 100	< 200	< 200	< 0.1	< 0.1	< 5.0	No
	8-24-94	< 100	290	330	< 100	700	1,200	< 100	< 100	< 100	< 300	< 500	NA	NA	NA	No
MW-9D	12-14-94	< 50	84	680	< 50	350	1,400	< 50	< 50	< 50	< 150	< 250	NA	NA	NA	No
	6-5-96	230	630	400	< 100	1,700	1,200	< 100	< 100	< 100	< 300	< 500	NA	NA	NA	No
	12-14-94	81	150	< 50	< 50	490	3,000	< 50	< 50	< 50	< 150	< 250	NA	NA	NA	No
MW-12	6-4-96 ³	< 20	< 20	< 20	< 20	77	590	< 20	< 20	< 20	< 60	< 100	NA	NA	NA	No
	6-4-96 ³	< 50	< 50	< 50	< 50	100	660	< 50	< 50	< 50	< 150	< 250	NA	NA	NA	No
	12-4-96	89	230 E	28	0.9 Q	650 E	1,600	1.0 Q	< 1.0	< 1.0	< 2.0	< 2.0	0.6	< 0.1	< 6.0	No
	12-14-94	35	180	< 10	< 10	580	84	< 10	< 10	< 10	< 30	< 50	NA	NA	NA	No
MW-12BR	8-30-95	180	620 D	75	< 10	1,900 D	320	< 10	< 10	< 10	< 30	< 50	NA	NA	NA	No
	6-4-96	51	130	< 20	< 20	400	480	< 20	< 20	< 20	< 60	< 100	NA	NA	NA	No
	12-14-94	70	190	22	< 10	530	270	< 10	< 10	< 10	< 30	< 50	NA	NA	NA	No
MW-13BR1	8-30-95	< 10	110	< 10	< 10	210	80	< 10	< 10	< 10	< 30	< 50	NA	NA	NA	No
	6-11-96	130 D	< 1.0	70 D	< 1.0	1,100 D	260 D	3.5	1.7	< 1.0	< 3.0	< 5.0	NA	NA	NA	Yes ²
	12-14-94	63	130	33	< 10	410	350	< 10	< 10	< 10	< 30	< 50	NA	NA	NA	No
	8-30-95	< 10	< 10	52	< 10	< 10	320	< 10	< 10	< 10	< 30	< 50	NA	NA	NA	No
MW-13BR2	6-10-96 ³	27	68 D	100 D	2.6	240 D	700 D	5.6	1.8	< 1.0	< 3.0	< 5.0	NA	NA	NA	Yes ²
	6-10-96 ³	31	72 D	110 D	3.0	250 D	700 D	6.0	1.8	< 1.0	< 3.0	< 5.0	NA	NA	NA	Yes ²
	12-5-96	52	130	120	< 10	470	710	< 20	< 10	< 10	< 20	< 20	1.2	0.1	125.9	No
	12-14-94	78	210	21	< 20	620	300	< 20	< 20	< 20	< 60	< 100	NA	NA	NA	No
MW-13BR3	8-30-95	< 20	< 20	42	< 20	< 20	440	< 20	< 20	< 20	< 60	< 100	NA	NA	NA	No
	6-10-96 ³	< 20	< 20	66	< 20	< 20	580	< 20	< 20	< 20	< 60	< 100	NA	NA	NA	No
	6-10-96 ³	1.4	1.5	59 D	1.7	2.1	480 D	1.8	2.0	< 1.0	< 3.0	< 5.0	NA	NA	NA	No
	NR 140 Enforcement Standard	7	850	70	100	200	5	0.2	343	700	620	40	NS	NS	NS	--
NR 140 Preventive Action Limit	0.7	85	7	20	40	0.5	0.02	68.6	140	124	8	NS	NS	NS	--	

NOTES:

¹ This table includes only those compounds listed in NR 140 that were detected in at least one sample.

² Other compounds detected in the on-site groundwater include the following:

Well MW-3D: 1,2,4-trimethylbenzene at 30 µg/L (8-25-94) and 5.9 µg/L (12-14-94)

Well MW-3BR1: chloroethane at 1.2 µg/L (6-11-96)

Well MW-13BR2: dichlorodifluoromethane at 3.8/3.8 µg/L (6-11-96)

³ Duplicate samples

BOLD Bolded values indicate constituents that exceed NR 140 Preventive Action Limits.

D Analyte value from diluted analysis.

E Estimated concentration; analyte concentration exceeds calibration range.

Q Qualitative mass spectral evidence of analyte present; concentration is less than the reporting limit.

DCE dichloroethane

DCA dichloroethane

TCA trichloroethane

TCE trichloroethane

NA Not analyzed

NS No standard or limit specified by NR 140

TABLE 21

SUMMARY OF VOCs DETECTED IN DOWNGRADIENT GROUNDWATER (µg/L)¹
TECUMSEH PRODUCTS COMPANY

Well ID	Sample Date	Vinyl Chloride	1,1-Dichloroethene	1,1-Dichloroethane	cis-1,2-Dichloroethene	1,1,1-Trichloroethane	Trichloroethene	Toluene	Ethene	Ethane	Methane
MW-14BR	12-14-94	<2.0	<1.0	<1.0	<1.0	<1.0	<1.0	<1.0	NA	NA	NA
	6-5-96	<2.0	<1.0	<1.0	<1.0	1.5	1.3	<1.0	NA	NA	NA
MW-15BR1	12-14-94	<2.0	<1.0	<1.0	<1.0	<1.0	<1.0	2.5	NA	NA	NA
	6-10-96	<2.0	<1.0	<1.0	<1.0	<1.0	<1.0	<1.0	NA	NA	NA
MW-15BR2	12-14-94	<2.0	<1.0	<1.0	<1.0	<1.0	<1.0	1.6	NA	NA	NA
	6-10-96	<2.0	<1.0	<1.0	<1.0	<1.0	<1.0	<1.0	NA	NA	NA
MW-18BR1	8-30-95	<2.0	<1.0	<1.0	<1.0	1.5	1.4	<1.0	NA	NA	NA
	6-10-96	<2.0	1.7	<1.0	<1.0	2.5	2.7	<1.0	NA	NA	NA
	12-4-96	<2.0	1.3	8.4	4.4	8.4	10	<1.0	<0.1	<0.1	6.6
MW-18BR2	8-30-95	<2.0	<1.0	4.7	2.9	5.9	6.3	<1.0	NA	NA	NA
	6-10-96	<2.0	5.7	25	18	33	33	<1.0	NA	NA	NA
	12-4-96	<2.0	5.0	30	17 ²	35	34	<1.0	0.2	<0.1	12.2
MW-19BR1	8-30-95	<20	<10	130	36	16	190	<10	NA	NA	NA
	6-10-96	<20	<20	150	54	<20	380	<20	NA	NA	NA
	12-4-96	3.6 Q	20	150	70	<5.0	380	<5.0	1.2	<0.1	23.7
MW-19BR2	8-30-95	<20	<10	110	22	<10	220	<10	NA	NA	NA
	6-10-96	<2	2.5	18	5.4	2.2	30	<1.0	NA	NA	NA
	12-4-96	<2.0	0.8 Q	6.3	1.5	<1.0	15	<1.0	0.8	<0.1	104
MW-20BR1	8-30-95	<2.0	<1.0	<1.0	<1.0	<1.0	<1.0	<1.0	NA	NA	NA
	6-10-96	<2.0	<1.0	<1.0	<1.0	<1.0	<1.0	<1.0	NA	NA	NA
	12-3-96	<2.0	<1.0	<1.0	<1.0	<1.0	<1.0	<1.0	<0.1	<0.1	22.1
MW-20BR2	8-30-95	<2.0	<1.0	<1.0	<1.0	<1.0	<1.0	1.6	NA	NA	NA
	6-10-96	<2.0	<1.0	<1.0	<1.0	<1.0	<1.0	7.8	NA	NA	NA
	12-3-96	<2.0	<1.0	<1.0	<1.0	<1.0	<1.0	<1.0	0.9	0.2	3,490
MW-21BR1	6-10-96	<2.0	<1.0	<1.0	<1.0	<1.0	<1.0	5.6	NA	NA	NA
	12-3-96	<2.0	<1.0	<1.0	<1.0	<1.0	<1.0	<1.0	<0.1	<0.1	<6.0
MW-21BR2	6-10-96	<2.0	<1.0	<1.0	<1.0	<1.0	<1.0	2.6	NA	NA	NA
	12-3-96	<2.0	<1.0	<1.0	<1.0	<1.0	<1.0	<1.0	<0.1	<0.1	<6.0
NR 140 Enforcement Standard		0.2	7	850	70	200	5	343	NS	NS	NS
NR 140 Preventive Action Limit		0.02	0.7	85	7	40	0.5	68.6	NS	NS	NS

NOTES:

- ¹ This table includes only those compounds that were detected in at least one sample.
² Qualitative mass spectral evidence of trans-1,2-dichloroethene at 0.7 µg/L; however, concentration is less than the reporting limit.
BOLD Bolded values indicate constituents that exceed NR 140 Preventive Action Limits.
 NA Not analyzed.
 NS No standard or limit specified by NR 140.
 Q Qualitative mass spectral evidence of analyte present: concentration is less than the reporting limit.

Project Number: 3084.18
 Sample Collection Date: December 1, 1994
 Chain-of-Custody Number: 053741

TABLE 23

LABORATORY RESULTS FOR SAMPLING
 OF RESIDENTIAL WELLS IN GRAFTON, WISCONSIN (µg/L)
 TECUMSEH PRODUCTS COMPANY

Parameter	Date	Station I.D. (name of resident)								PAL	ES
		Trip Blank ¹	PW-36 (Groth)	PW-5 (Raess)	PW-38 (Lauer)	PW-101 (Thiele)	PW-102 (Thiele)	PW-30 (Heiser)	Storage Blank		
Acetone	12/1 12/19	7.2 5.0 B(4)	-- --	-- --	-- --	-- --	12 --	-- --	-- --	200	1,000
Methylene chloride	12/1 12/19	0.3 Q 0.2 Q	0.1 Q --	-- --	-- --	-- --	-- --	-- --	-- 0.2 Q	0.5	5
1,1,1-Trichloroethane	12/1 12/19	-- --	0.3 Q 0.3 Q	0.9 0.6	1.8 1.0	-- --	-- --	2.3 2.1	-- --	40	200
1,1-Dichloroethane	12/1 12/19	-- --	-- 0.1 Q	0.7 0.4 Q	0.5 Q 0.2 Q	-- --	-- --	2.8 2.3	-- --	85	850
Trichloroethene	12/1 12/19	-- --	-- --	0.5 Q 0.3 Q	1.1 0.7	-- --	-- 0.1 Q	1.4 1.4	-- --	0.5	5
Chloroform	12/1 12/19	-- --	-- --	-- --	-- --	0.1 Q 0.1 Q	-- --	0.5 0.4 Q	-- --	0.6	6
Benzene	12/1 12/19	-- --	-- --	-- --	0.4 Q 0.5 Q	-- --	-- --	-- --	-- --	0.5	5
1,1-Dichloroethene	12/1 12/19	-- --	-- --	-- --	-- --	-- --	-- --	0.2 Q 0.2 Q	-- --	0.7	7
cis-1,2-Dichloroethene	12/1 12/19	-- --	-- --	-- --	-- --	-- --	-- --	2.0 1.9	-- --	7	70
Tetrachloroethene	12/1 12/19	-- --	-- --	-- --	-- --	-- --	-- --	0.2 Q 0.2 Q	-- --	0.5	5
4-Methyl-2-pentanone	12/1 12/19	-- --	-- --	-- --	-- --	-- --	2.8 Q --	-- --	-- --	50	500

NOTES:

- ¹ Toluene was also detected at 0.06 µg/L Q in the December 19, 1994, sampling round.
- B(4) Analyte was present in the method blank. If the processes that were applied to the sample were applied to the method blank, the value of the analyte (acetone) in the method blank would likely be 4 µg/L.
- Q Concentration reported is greater than the Method Detection Limit, but less than the Practical Quantitation Limit (i.e., the presence of the constituent concentration is not certain).
- ES Enforcement Standard (ES)
- PAL Preventive Action Limit (PAL)
- Not detected.

234
183

51