



Moraine Environmental, Inc.

Environmental Management Services

December 27, 2001

Mr. John Feeney, Hydrogeologist
Wisconsin Department of Natural Resources
Southeast District - Annex Building
P.O. Box 12436
Milwaukee, WI 53212

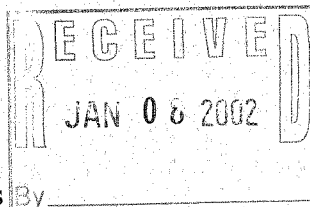

Proj. Ref. #1177
FID#246009170

RE: **Biannual Groundwater Monitoring Results – December, 2001
Tecumseh Products Company Facility, Grafton Operation**

Dear John:

Moraine Environmental, Inc. (MEI) has been retained by the Tecumseh Products Company to provide technical field service to monitor groundwater quality on a biannual basis at the Tecumseh Products Company Grafton Operation. Consulting and engineering services continue to be provided by RMT, Inc. of Madison, Wisconsin.

This letter report was prepared to summarize the December, 2001 sampling and analysis of twelve downgradient groundwater monitoring wells and two downgradient potable residential wells for Volatile Organic Compounds (VOCs). Monitoring well MW-3 BR, located on-site at the Tecumseh Products Company is damaged and will require repair or replacement. Monitoring well MW-19 BR (2) was not sampled due to mechanical problems with the nitrogen activated bladder pump. The analytical results are summarized in tabular form and previous sample results are provided for comparison purposes.

Accordingly, the following summarization is presented:

Sample Collection Methodologies

Sample collection from monitoring wells was performed on December 4, 2001. The following downgradient wells were purged and sampled for EPA Method 8260 VOCs analysis:

MW - 3D	MW-18 BR (1)	MW-20 BR(2)
MW-9	MW-18 BR (2)	MW-21 BR(1)
MW-12	MW-19 BR(1)	MW-21 BR(2)
MW-13 BR(2)	MW-20 BR(1)	MW-22 BR

The locations of these wells are illustrated on the enclosed figure.

Private water supply wells PW-38 (Wendtland Property) and PW-5 (Raess Property) were also sampled for VOCs.

Groundwater samples from monitoring wells MW-3D, MW-9, MW-12 and MW-22 BR were purged and sampled using new, disposable teflon bailers. Samples were transferred into 40 milliliter (ml) vials, placed into an ice-filled cooler, and transported to the laboratory (EnChem, Inc.) for analysis. The remaining monitoring wells were sampled through dedicated multi-level bladder pump systems (Solinst Waterloo) installed during well construction. VOC groundwater samples were collected, stored, transported, and analyzed for 8260 VOCs by EnChem, Inc. Laboratories in Green Bay, Wisconsin. The private wells (PW-38 and PW-5) were sampled by allowing the cold taps to run for a minimum of fifteen minutes to allow for aquifer water to enter the system, then reducing the flow volume (removing the faucet aerators) and collecting and storing the samples.

Analytical Results

All groundwater samples were analyzed for EPA Method 8260 VOCs by EnChem, Inc. of Green Bay, Wisconsin. The analytical results are summarized on the enclosed analytical results table. The laboratory reports are enclosed as Attachment A. Tables summarizing previous analytical results are enclosed as Attachment B to allow for a comparison of recent analytical results with previously acquired groundwater quality data. VOCs at concentrations exceeding Wisconsin Administrative Code Chapter NR 140 Groundwater Quality Enforcement Standards were detected in monitoring wells MW-9, MW-12, MW-13 BR (2), MW-18 BR (1), MW-18 BR (2), MW-19 BR(1), and MW-22 BR. The Enforcement Standard and Preventive Action Limit for Bromodichloromethane and Chloroform, respectively were slightly exceeded in the private water supply well PW-38. An increase in the concentration of 1,1-Dichloroethane (7.5 ug/l in June, 2001 to 360 ug/l in December, 2001) was noted in on-site well MW-3D. Increases in the concentrations of 1,1-Dichloroethene, cis-1,2-Dichloroethene, 1,1,1-Trichloroethane, and Trichloroethene were noted in on-site well MW-12. The analytical results from the remaining monitoring points were similar to previously acquired analytical results.

Biannual samples will again be collected in June, 2002. If you have any questions or concerns regarding this letter, the monitoring methodologies or results, please call our office at (262) 377-9060.

Sincerely,
MORaine ENVIRONMENTAL, INC.

Thomas C. Sweet
President

Steven Benton
Project Hydrogeologist

cc: Kerry DeKeyser, Tecumseh
Bernd Rehm, RMT
enc.

TABLE 1
TECUMSEH PRODUCTS CO. - GRAFTON FACILITY
DECEMBER, 2001 GROUNDWATER LAB RESULTS (detected compounds only)

Well Name	MW-3D	MW-9	MW-12	MW-13 BR (2)	MW-18 BR (1)	MW-18 BR (2)	MW-19 BR (1)	MW-20 BR (1)	MW-20 BR (2)	MW-21 BR (1)	MW-21 BR (2)	MW-22 BR	Raess Residence (PW-5)	Wendtland Residence (PW-38)	NR140 ES	NR140 PAL
Collection Date	12/4/01	12/4/01	12/4/01	12/4/01	12/4/01	12/4/01	12/4/01	12/4/01	12/4/01	12/4/01	12/4/01	12/4/01	12/4/01	12/4/01		
Bromodichloromethane	<1.2	<6.1	<6.1	<3.0	<0.61	<0.61	<1.2	<0.61	<0.61	<0.61	<0.61	<0.61	<0.61	1.2 Q	0.6	0.06
Chloroform	<1.5	<7.5	<7.5	<3.8	<0.75	<0.75	<1.5	<0.75	<0.75	<0.75	<0.75	<0.75	<0.75	2.8	6.0	0.6
Chlorodibromomethane	<0.86	<4.3	<4.3	<2.1	<0.43	<0.43	<0.86	<0.43	<0.43	<0.43	<0.43	<0.43	<0.43	0.43 Q	NSE	NSE
1,2-Dichloroethane	2.9 Q	<4.7	<4.7	<2.3	<0.47	<0.47	<0.94	<0.47	<0.47	<0.47	<0.47	<0.47	<0.47	<0.47	5.0	0.5
1,1-Dichloroethene	<1.7	22 Q	12 Q	110	1.4 Q	6.5	13	<0.85	<0.85	<0.85	<0.85	<0.85	<0.85	<0.85	7.0	0.7
cis-1,2-Dichloroethene	<1.5	830	13 Q	58	5.9	26	46	<0.73	<0.73	<0.73	<0.73	8.2	<0.73	<0.73	70	7.0
trans-1,2-Dichloroethane	1.7 Q	32	<7.9	<4.0	<0.79	0.88 Q	<1.6	<0.79	<0.79	<0.79	<0.79	<0.79	<0.79	<0.79	100	20
1,1-Dichloroethane	360	39	23	380	11	50	92	<0.48	<0.48	<0.48	<0.48	1.2 Q	0.97 Q	<0.48	850	85
1,1,1-Trichloroethane	<1.4	240	100	640	4.5	21	2.1 Q	<0.69	<0.69	<0.69	<0.69	<0.69	<0.69	<0.69	200	40
Trichloroethene	<1.8	1,200	1,200	390	11	43	300	<0.89	<0.89	<0.89	<0.89	37	<0.89	<0.89	5.0	0.5
Vinyl Chloride	<0.36	<1.8	<1.8	<0.90	<0.18	<0.18	3.1	<0.18	<0.18	<0.18	<0.18	<0.18	<0.18	<0.18	0.2	0.02

Notes:

All Concentrations and Standards Expressed as Micrograms per Liter (ug/l) (parts per billion)

Q - parameter detected below quantitative limit (qualified results)

NSE - No Standard Established

ES = NR140.10 Enforcement Standard

PAL = NR140.10 Preventative Action Limit

Highlighted and **Bold** results indicate concentrations exceeding WDNR NR140 ES

Bold results indicate concentrations exceeding WDNR NR140 PAL

E:\WORD\MSWTEH11\1177GWtable8

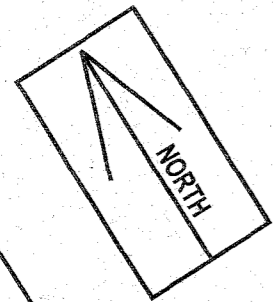

PW-38 (WENDTLAND)

PW-5 (RAESS)

MW-12 BR

MW-12 PW-30 (HEISER)

MW-13 BR

MW-9 / MW-9D

MW-3 BR

MW-3D

MW-22 BR

MW-18 BR

MW-19 BR

MW-20 BR

MW-21 BR

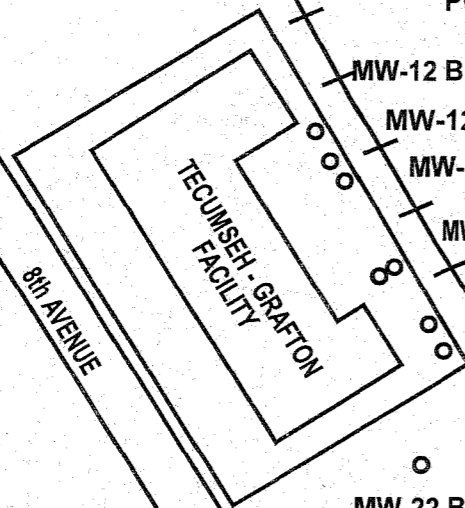

TECUMSEH - GRAFTON
FACILITY

8th AVENUE

GREEN BAY ROAD

WASHINGTON STREET

12th AVENUE

GRAFTON AVENUE

17th AVENUE

MILWAUKEE RIVER



APP. SCALE IN FEET

SAMPLED WELL LOCATIONS
TECUMSEH PRODUCTS CO., GRAFTON, WI

ATTACHMENT A
ANALYTICAL REPORTS

(Please Print Legibly)

Company Name: MORaine Env. Inc.

Branch or Location: GRAFTON WI

Project Contact: STEVEN BENTON

Telephone: (463) 377-9060

Project Number: # 1177

Project Name: TECU 456H - GRAFTON

Project State: WI

Sampled By (Print): STEVEN BENTON



1241 Bellevue St., Suite 9
Green Bay, WI 54302
920-469-2436
FAX 920-469-8827

525 Science Drive
Madison, WI 53711
608-233-3300
FAX: 608-233-0502

CHAIN OF CUSTODY

Page 1 of 1

P.O. # _____ Quote # _____

Mail Report To: 457

Company: _____

Address: _____

Invoice To: 457

Company: _____

Address: _____

Mail Invoice To: 457

*Preservation Codes
A=None B=HCL C=H2SO4 D=HNO3 E=EnCore F=Methanol G=NaOH
H = Sodium Bisulfate Solution I = Other
FILTERED? (YES/NO) NO
PRESERVATION (CODE)* B

Data Package Options
(please circle if requested)
Results Only
EnChem Level III (Subject to Surcharge)
EnChem Level IV (Subject to Surcharge)

Regulatory Program
UST
RCRA
SDWA
NPDES
CERCLA

Matrix Codes
W=Water
S=Soil
A=Air
C=Charcoal
B=Biota
Sl=Sludge

ANALYSES REQUESTED
8260 VOCs

TOTAL # OF BOTTLES SENT
3

LABORATORY ID (Lab Use Only)	FIELD ID	COLLECTION		MATRIX	ANALYSES REQUESTED	PRESERVATION (CODE)*	FILTERED? (YES/NO)	TOTAL # OF BOTTLES SENT	CLIENT COMMENTS	LAB COMMENTS (Lab Use Only)
		DATE	TIME							
001	MW-3D	12-9-01		H ₂ O				3		
002	MW-9									
003	MW-12									
004	MW-13 BR (1)									
005	MW-18 BR (1)									
006	MW-18 BR (2)									
007	MW-19 BR (1)									
008	MW-20 BR (1)									
009	MW-20 BR (2)									
010	MW-21 BR (1)									
011	MW-21 BR (2)									
012	MW-22 BR									
013	RAESS RESIDENCE									
014	WENDLAND RESIDENCE									

Rush Turnaround Time Requested (TAT) - Prelim
(Rush TAT subject to approval/surcharge)
Date Needed: _____
Transmit Prelim Rush Results by (circle):
Phone Fax E-Mail
Phone #: _____
Fax #: _____
E-Mail Address: _____

Relinquished By: _____ Date/Time: _____
Relinquished By: _____ Date/Time: _____
Relinquished By: _____ Date/Time: _____
Relinquished By: _____ Date/Time: _____
Relinquished By: _____ Date/Time: _____

Received By: _____ Date/Time: _____
Received By: _____ Date/Time: _____
Received By: _____ Date/Time: _____
Received By: _____ Date/Time: _____
Received By: _____ Date/Time: _____

En Chem Project No. _____
Sample Receipt Temp. _____
Sample Receipt pH (We/Metals) _____
Cooler Custody Seal Present / Not Present
Intact / Not Intact

Samples on HOLD are subject to special pricing and release of liability

Corporate Office & Laboratory
1241 Bellevue Street
Green Bay, WI 54302
920-469-2436 • FAX: 920-469-8827
800-7-ENCHEM



Madison Office & Laboratory
525 Science Drive
Madison, WI 53711
608-232-3300 • FAX: 608-233-0502
888-5-ENCHEM

- Analytical Report -

Project Name : TECUMSEH-GRAFTON

Project Number : 1177

Client: MORaine ENVIRONMENTAL INC

WI DNR LAB ID : 405132750

Sample No.	Field ID	Collection Date	Sample No.	Field ID	Collection Date
816107-001	MW-3D	12/4/01			
816107-002	MW-9	12/4/01			
816107-003	MW-12	12/4/01			
816107-004	MW-13 BR (2)	12/4/01			
816107-005	MW-18 BR (1)	12/4/01			
816107-006	MW-18 BR (2)	12/4/01			
816107-007	MW-19 BR (1)	12/4/01			
816107-008	MW-20 BR (1)	12/4/01			
816107-009	MW-20 BR (2)	12/4/01			
816107-010	MW-21 BR (1)	12/4/01			
816107-011	MW-21 BR (2)	12/4/01			
816107-012	MW-22 BR	12/4/01			
816107-013	RAESS RESIDENCE	12/4/01			
816107-014	WENDTLAND RESIDENCE	12/4/01			

Please visit our Internet homepage at: www.enchem.com

The "Q" flag is present when a parameter has been detected below the LOQ. This indicates the results are qualified due to the uncertainty of the parameter concentration between the LOD and the LOQ.

Soil VOC detects are corrected for the total solids, unless otherwise noted.

I certify that the data contained in this Final Report has been generated and reviewed in accordance with approved methods and Laboratory Standard Operating Procedure. Exceptions, if any, are discussed in the accompanying sample comments. Release of this final report is authorized by Laboratory management, as is verified by the following signature. Reported results shall not be reproduced, except in full, without the written approval of the lab. The sample results relate only to the analytes of interest tested.

Approval Signature

Date

En Chem, Inc. Cooler Receipt Log

Batch No. 816107

Project Name or ID 1177

No. of Coolers: 1 Temps: RAF

A. Receipt Phase: Date cooler was opened: 12-7-01 By: GD

- 1: Were samples received on ice? (Must be ≤ 6 C).....YES NO²
- 2: Was there a Temperature Blank?.....YES NO
- 3: Were custody seals present and intact? (Record on COC).....YES NO
- 4: Are COC documents present?.....YES NO²
- 5: Does this Project require quick turn around analysis?.....YES NO
- 6: Is there any sub-work?.....YES NO
- 7: Are there any short hold time tests?.....YES NO
- 8: Are any samples nearing expiration of hold-time? (Within 2 days).....YES¹ NO Contacted by/Who _____
- 9: Do any samples need to be Filtered or Preserved in the lab?.....YES¹ NO Contacted by/Who _____

B. Check-in Phase: Date samples were Checked-in: 12-7-01 By: GD

- 1: Were all sample containers listed on the COC received and intact?.....YES NO² NA
- 2: Sign the COC as received by En Chem. Completed.....YES NO
- 3: Do sample labels match the COC?YES NO²
- 4: Check sample pH of preserved samples. (Not VOCs) Completed.....YES NO NA
- 5: Do samples have correct chemical preservation?.....YES NO² NA
- 6: Are dissolved parameters field filtered?.....YES NO² NA
- 7: Are sample volumes adequate for tests requested?YES NO²
- 8: Are VOC samples free of bubbles >6mmYES NO² NA
- 9: Enter samples into logbook. Completed.....YES NO
- 10: Place laboratory sample number on all containers and COC. Completed.....YES NO
- 11: Complete Laboratory Tracking Sheet (LTS). Completed.....YES NO NA
- 12: Start Nonconformance form.YES NO NA
- 13: Initiate Subcontracting procedure. Completed.....YES NO NA
- 14: Check laboratory sample number on all containers and COC. Chw YES NO NA

Short Hold-time tests:

48 Hours or less	7 days	Footnotes 1 Notify proper lab group immediately. 2 Complete nonconformance memo.
Coliform (6 hrs)	Flashpoint	
Hexavalent Chromium (24 Hrs)	TSS	
BOD	Total Solids	
Nitrite or Nitrate	TDS	
Low Level Mercury	Sulfide	
Ortho Phosphorus	Free Liquids	
Turbidity	Total Volatile Solids	
Surfactants	Aqueous Extractable Organics- ALL	
Sulfite	Unpreserved VOC's	
En Core Preservation	Ash	
Color		

Rev. 9/5/2001, Attachment to 1-REC-5.
Subject to QA Audit.

Reviewed by/date Chw 12/16/01

**EN CHEM
SAMPLE NARRATIVE**

Volatiles: One or more samples in this package have analytes qualified with an "&" qualifier because they are associated to a Laboratory Control Sample (LCS) that had recoveries outside of the laboratory control limits. Data for these analytes is qualified, without further corrective action, because the laboratory SOP allows a limited number of analytes to be outside of the control limits based in the number of analytes spiked.

- Analytical Report -

Project Name : TECUMSEH-GRAFTON

Project Number : 1177

Client : MORAIN ENVIRONMENTAL INC

Field ID : MW-3D

Report Date : 12/14/01

Lab Sample Number : 816107-001

Collection Date : 12/4/01

WI DNR LAB ID : 405132750

Matrix Type : WATER

Organic Results**EPA 8260 VOLATILE LIST- WATER**

Prep Method: SW846 5030B

Prep Date: 12/10/01

Analyst: TLT

Analyte	Result	LOD	LOQ	EQL	Units	Code	Analysis Date	Analysis Method
Benzene	< 0.96	0.96	3.1		ug/L		12/13/01	SW846 8260B
Bromobenzene	< 0.88	0.88	2.8		ug/L		12/13/01	SW846 8260B
Bromochloromethane	< 1.2	1.2	3.8		ug/L		12/13/01	SW846 8260B
Bromodichloromethane	< 1.2	1.2	3.8		ug/L		12/13/01	SW846 8260B
Bromoform	< 1.4	1.4	4.5		ug/L		12/13/01	SW846 8260B
Bromomethane	< 1.4	1.4	4.5		ug/L	&	12/13/01	SW846 8260B
s-Butylbenzene	< 0.98	0.98	3.1		ug/L		12/13/01	SW846 8260B
t-Butylbenzene	< 1.0	1.0	3.2		ug/L		12/13/01	SW846 8260B
n-Butylbenzene	< 1.2	1.2	3.8		ug/L		12/13/01	SW846 8260B
Carbon tetrachloride	< 1.5	1.5	4.8		ug/L		12/13/01	SW846 8260B
Chloroform	< 1.5	1.5	4.8		ug/L		12/13/01	SW846 8260B
Chlorobenzene	< 1.1	1.1	3.5		ug/L		12/13/01	SW846 8260B
Chlorodibromomethane	< 0.86	0.86	2.7		ug/L		12/13/01	SW846 8260B
Chloroethane	< 1.1	1.1	3.5		ug/L		12/13/01	SW846 8260B
Chloromethane	< 1.2	1.2	3.8		ug/L		12/13/01	SW846 8260B
2-Chlorotoluene	< 0.96	0.96	3.1		ug/L		12/13/01	SW846 8260B
4-Chlorotoluene	< 1.4	1.4	4.5		ug/L		12/13/01	SW846 8260B
1,2-Dibromo-3-chloropropane	< 2.0	2.0	6.4		ug/L		12/13/01	SW846 8260B
1,2-Dibromoethane	< 1.8	1.8	5.7		ug/L		12/13/01	SW846 8260B
Dibromomethane	< 1.3	1.3	4.1		ug/L		12/13/01	SW846 8260B
1,3-Dichlorobenzene	< 1.1	1.1	3.5		ug/L		12/13/01	SW846 8260B
1,4-Dichlorobenzene	< 0.78	0.78	2.5		ug/L		12/13/01	SW846 8260B
1,2-Dichloroethane	2.9	0.94	3.0		ug/L	Q	12/13/01	SW846 8260B
1,2-Dichlorobenzene	< 1.3	1.3	4.1		ug/L		12/13/01	SW846 8260B
1,1-Dichloroethene	< 1.7	1.7	5.4		ug/L		12/13/01	SW846 8260B
cis-1,2-Dichloroethene	< 1.5	1.5	4.8		ug/L		12/13/01	SW846 8260B
Dichlorodifluoromethane	< 1.4	1.4	4.5		ug/L		12/13/01	SW846 8260B
trans-1,2-Dichloroethene	1.7	1.6	5.1		ug/L	Q	12/13/01	SW846 8260B
1,2-Dichloropropane	< 1.1	1.1	3.5		ug/L		12/13/01	SW846 8260B
1,1-Dichloroethane	360	0.96	3.1		ug/L		12/13/01	SW846 8260B
1,3-Dichloropropane	< 1.1	1.1	3.5		ug/L		12/13/01	SW846 8260B
2,2-Dichloropropane	< 1.9	1.9	6.1		ug/L		12/13/01	SW846 8260B

- Analytical Report -

Project Name : TECUMSEH-GRAFTON

Project Number : 1177

Client : MORAIN ENVIRONMENTAL INC

Field ID : MW-3D

Report Date : 12/14/01

Lab Sample Number : 816107-001

Collection Date : 12/4/01

WI DNR LAB ID : 405132750

Matrix Type : WATER

1,1-Dichloropropene	< 1.7	1.7	5.4	ug/L	12/13/01	SW846 8260B
cis-1,3-Dichloropropene	< 1.1	1.1	3.5	ug/L	12/13/01	SW846 8260B
trans-1,3-Dichloropropene	< 1.0	1.0	3.2	ug/L	12/13/01	SW846 8260B
Diisopropyl ether	< 1.2	1.2	3.8	ug/L	12/13/01	SW846 8260B
Ethylbenzene	< 0.86	0.86	2.7	ug/L	12/13/01	SW846 8260B
Fluorotrichloromethane	< 1.0	1.0	3.2	ug/L	12/13/01	SW846 8260B
Hexachlorobutadiene	< 1.7	1.7	5.4	ug/L	12/13/01	SW846 8260B
Isopropylbenzene	< 0.86	0.86	2.7	ug/L	12/13/01	SW846 8260B
p-Isopropyltoluene	< 1.1	1.1	3.5	ug/L	12/13/01	SW846 8260B
Methylene chloride	< 1.7	1.7	5.4	ug/L	12/13/01	SW846 8260B
Methyl-tert-butyl-ether	< 1.3	1.3	4.1	ug/L	12/13/01	SW846 8260B
Naphthalene	< 1.2	1.2	3.8	ug/L	12/13/01	SW846 8260B
n-Propylbenzene	< 1.3	1.3	4.1	ug/L	12/13/01	SW846 8260B
Styrene	< 0.86	0.86	2.7	ug/L	12/13/01	SW846 8260B
1,1,2,2-Tetrachloroethane	< 1.8	1.8	5.7	ug/L	12/13/01	SW846 8260B
1,1,1,2-Tetrachloroethane	< 1.5	1.5	4.8	ug/L	12/13/01	SW846 8260B
Tetrachloroethene	< 1.1	1.1	3.5	ug/L	12/13/01	SW846 8260B
Toluene	< 0.94	0.94	3.0	ug/L	12/13/01	SW846 8260B
1,2,3-Trichlorobenzene	< 1.1	1.1	3.5	ug/L	12/13/01	SW846 8260B
1,2,4-Trichlorobenzene	< 1.2	1.2	3.8	ug/L	12/13/01	SW846 8260B
1,1,1-Trichloroethane	< 1.4	1.4	4.5	ug/L	12/13/01	SW846 8260B
1,1,2-Trichloroethane	< 1.4	1.4	4.5	ug/L	12/13/01	SW846 8260B
1,2,4-Trimethylbenzene	< 1.0	1.0	3.2	ug/L	12/13/01	SW846 8260B
Trichloroethene	< 1.8	1.8	5.7	ug/L	12/13/01	SW846 8260B
1,2,3-Trichloropropane	< 1.6	1.6	5.1	ug/L	12/13/01	SW846 8260B
1,3,5-Trimethylbenzene	< 1.0	1.0	3.2	ug/L	12/13/01	SW846 8260B
Vinyl chloride	< 0.36	0.36	1.1	ug/L	12/13/01	SW846 8260B
Xylenes, -m, -p	< 2.8	2.8	8.9	ug/L	12/13/01	SW846 8260B
Xylene, -o	< 1.1	1.1	3.5	ug/L	12/13/01	SW846 8260B
4-Bromofluorobenzene	84			%Recov	12/13/01	SW846 8260B
Dibromofluoromethane	93			%Recov	12/13/01	SW846 8260B
Toluene-d8	96			%Recov	12/13/01	SW846 8260B

- Analytical Report -

Project Name : TECUMSEH-GRAFTON
Project Number : 1177
Field ID : MW-9
Lab Sample Number : 816107-002
WI DNR LAB ID : 405132750

Client : MORaine ENVIRONMENTAL INC
Report Date : 12/14/01
Collection Date : 12/4/01
Matrix Type : WATER

Organic Results**EPA 8260 VOLATILE LIST- WATER**

Prep Method: SW846 5030B

Prep Date: 12/10/01

Analyst: TLT

Analyte	Result	LOD	LOQ	EQL	Units	Code	Analysis Date	Analysis Method
Benzene	< 4.8	4.8	15		ug/L		12/13/01	SW846 8260B
Bromobenzene	< 4.4	4.4	14		ug/L		12/13/01	SW846 8260B
Bromochloromethane	< 6.1	6.1	19		ug/L		12/13/01	SW846 8260B
Bromodichloromethane	< 6.1	6.1	19		ug/L		12/13/01	SW846 8260B
Bromoform	< 7.0	7.0	22		ug/L		12/13/01	SW846 8260B
Bromomethane	< 7.1	7.1	23		ug/L	&	12/13/01	SW846 8260B
s-Butylbenzene	< 4.9	4.9	16		ug/L		12/13/01	SW846 8260B
t-Butylbenzene	< 5.0	5.0	16		ug/L		12/13/01	SW846 8260B
n-Butylbenzene	< 6.1	6.1	19		ug/L		12/13/01	SW846 8260B
Carbon tetrachloride	< 7.3	7.3	23		ug/L		12/13/01	SW846 8260B
Chloroform	< 7.5	7.5	24		ug/L		12/13/01	SW846 8260B
Chlorobenzene	< 5.5	5.5	18		ug/L		12/13/01	SW846 8260B
Chlorodibromomethane	< 4.3	4.3	14		ug/L		12/13/01	SW846 8260B
Chloroethane	< 5.7	5.7	18		ug/L		12/13/01	SW846 8260B
Chloromethane	< 6.2	6.2	20		ug/L		12/13/01	SW846 8260B
2-Chlorotoluene	< 4.8	4.8	15		ug/L		12/13/01	SW846 8260B
4-Chlorotoluene	< 7.2	7.2	23		ug/L		12/13/01	SW846 8260B
1,2-Dibromo-3-chloropropane	< 10	10	32		ug/L		12/13/01	SW846 8260B
1,2-Dibromoethane	< 9.1	9.1	29		ug/L		12/13/01	SW846 8260B
Dibromomethane	< 6.7	6.7	21		ug/L		12/13/01	SW846 8260B
1,3-Dichlorobenzene	< 5.4	5.4	17		ug/L		12/13/01	SW846 8260B
1,4-Dichlorobenzene	< 3.9	3.9	12		ug/L		12/13/01	SW846 8260B
1,2-Dichloroethane	< 4.7	4.7	15		ug/L		12/13/01	SW846 8260B
1,2-Dichlorobenzene	< 6.7	6.7	21		ug/L		12/13/01	SW846 8260B
1,1-Dichloroethene	22	8.5	27		ug/L	Q	12/13/01	SW846 8260B
cis-1,2-Dichloroethene	830	7.3	23		ug/L		12/13/01	SW846 8260B
Dichlorodifluoromethane	< 6.8	6.8	22		ug/L		12/13/01	SW846 8260B
trans-1,2-Dichloroethene	32	7.9	25		ug/L		12/13/01	SW846 8260B
1,2-Dichloropropane	< 5.3	5.3	17		ug/L		12/13/01	SW846 8260B
1,1-Dichloroethane	39	4.8	15		ug/L		12/13/01	SW846 8260B
1,3-Dichloropropane	< 5.3	5.3	17		ug/L		12/13/01	SW846 8260B
2,2-Dichloropropane	< 9.5	9.5	30		ug/L		12/13/01	SW846 8260B

- Analytical Report -

Project Name : TECUMSEH-GRAFTON

Project Number : 1177

Client : MORAIN ENVIRONMENTAL INC

Field ID : MW-9

Report Date : 12/14/01

Lab Sample Number : 816107-002

Collection Date : 12/4/01

WI DNR LAB ID : 405132750

Matrix Type : WATER

1,1-Dichloropropene	< 8.5	8.5	27	ug/L	12/13/01	SW846 8260B
cis-1,3-Dichloropropene	< 5.6	5.6	18	ug/L	12/13/01	SW846 8260B
trans-1,3-Dichloropropene	< 5.1	5.1	16	ug/L	12/13/01	SW846 8260B
Diisopropyl ether	< 6.0	6.0	19	ug/L	12/13/01	SW846 8260B
Ethylbenzene	< 4.3	4.3	14	ug/L	12/13/01	SW846 8260B
Fluorotrichloromethane	< 5.2	5.2	17	ug/L	12/13/01	SW846 8260B
Hexachlorobutadiene	< 8.4	8.4	27	ug/L	12/13/01	SW846 8260B
Isopropylbenzene	< 4.3	4.3	14	ug/L	12/13/01	SW846 8260B
p-Isopropyltoluene	< 5.7	5.7	18	ug/L	12/13/01	SW846 8260B
Methylene chloride	< 8.5	8.5	27	ug/L	12/13/01	SW846 8260B
Methyl-tert-butyl-ether	< 6.7	6.7	21	ug/L	12/13/01	SW846 8260B
Naphthalene	< 5.9	5.9	19	ug/L	12/13/01	SW846 8260B
n-Propylbenzene	< 6.4	6.4	20	ug/L	12/13/01	SW846 8260B
Styrene	< 4.3	4.3	14	ug/L	12/13/01	SW846 8260B
1,1,2,2-Tetrachloroethane	< 9.1	9.1	29	ug/L	12/13/01	SW846 8260B
1,1,1,2-Tetrachloroethane	< 7.5	7.5	24	ug/L	12/13/01	SW846 8260B
Tetrachloroethene	< 5.7	5.7	18	ug/L	12/13/01	SW846 8260B
Toluene	< 4.7	4.7	15	ug/L	12/13/01	SW846 8260B
1,2,3-Trichlorobenzene	< 5.7	5.7	18	ug/L	12/13/01	SW846 8260B
1,2,4-Trichlorobenzene	< 6.0	6.0	19	ug/L	12/13/01	SW846 8260B
1,1,1-Trichloroethane	240	6.9	22	ug/L	12/13/01	SW846 8260B
1,1,2-Trichloroethane	< 7.2	7.2	23	ug/L	12/13/01	SW846 8260B
1,2,4-Trimethylbenzene	< 5.1	5.1	16	ug/L	12/13/01	SW846 8260B
Trichloroethene	1200	8.9	28	ug/L	12/13/01	SW846 8260B
1,2,3-Trichloropropane	< 7.8	7.8	25	ug/L	12/13/01	SW846 8260B
1,3,5-Trimethylbenzene	< 5.2	5.2	17	ug/L	12/13/01	SW846 8260B
Vinyl chloride	< 1.8	1.8	5.7	ug/L	12/13/01	SW846 8260B
Xylenes, -m, -p	< 14	14	45	ug/L	12/13/01	SW846 8260B
Xylene, -o	< 5.4	5.4	17	ug/L	12/13/01	SW846 8260B
4-Bromofluorobenzene	86			%Recov	12/13/01	SW846 8260B
Dibromofluoromethane	95			%Recov	12/13/01	SW846 8260B
Toluene-d8	99			%Recov	12/13/01	SW846 8260B

- Analytical Report -

Project Name : TECUMSEH-GRAFTON
 Project Number : 1177
 Field ID : MW-12
 Lab Sample Number : 816107-003
 WI DNR LAB ID : 405132750

Client : MORAIN ENVIRONMENTAL INC
 Report Date : 12/14/01
 Collection Date : 12/4/01
 Matrix Type : WATER

Organic Results**EPA 8260 VOLATILE LIST- WATER**

Prep Method: SW846 5030B Prep Date: 12/10/01 Analyst: TLT

Analyte	Result	LOD	LOQ	EQL	Units	Code	Analysis Date	Analysis Method
Benzene	< 4.8	4.8	15		ug/L		12/13/01	SW846 8260B
Bromobenzene	< 4.4	4.4	14		ug/L		12/13/01	SW846 8260B
Bromochloromethane	< 6.1	6.1	19		ug/L		12/13/01	SW846 8260B
Bromodichloromethane	< 6.1	6.1	19		ug/L		12/13/01	SW846 8260B
Bromoform	< 7.0	7.0	22		ug/L		12/13/01	SW846 8260B
Bromomethane	< 7.1	7.1	23		ug/L	&	12/13/01	SW846 8260B
s-Butylbenzene	< 4.9	4.9	16		ug/L		12/13/01	SW846 8260B
t-Butylbenzene	< 5.0	5.0	16		ug/L		12/13/01	SW846 8260B
n-Butylbenzene	< 6.1	6.1	19		ug/L		12/13/01	SW846 8260B
Carbon tetrachloride	< 7.3	7.3	23		ug/L		12/13/01	SW846 8260B
Chloroform	< 7.5	7.5	24		ug/L		12/13/01	SW846 8260B
Chlorobenzene	< 5.5	5.5	18		ug/L		12/13/01	SW846 8260B
Chlorodibromomethane	< 4.3	4.3	14		ug/L		12/13/01	SW846 8260B
Chloroethane	< 5.7	5.7	18		ug/L		12/13/01	SW846 8260B
Chloromethane	< 6.2	6.2	20		ug/L		12/13/01	SW846 8260B
2-Chlorotoluene	< 4.8	4.8	15		ug/L		12/13/01	SW846 8260B
4-Chlorotoluene	< 7.2	7.2	23		ug/L		12/13/01	SW846 8260B
1,2-Dibromo-3-chloropropane	< 10	10	32		ug/L		12/13/01	SW846 8260B
1,2-Dibromoethane	< 9.1	9.1	29		ug/L		12/13/01	SW846 8260B
Dibromomethane	< 6.7	6.7	21		ug/L		12/13/01	SW846 8260B
1,3-Dichlorobenzene	< 5.4	5.4	17		ug/L		12/13/01	SW846 8260B
1,4-Dichlorobenzene	< 3.9	3.9	12		ug/L		12/13/01	SW846 8260B
1,2-Dichloroethane	< 4.7	4.7	15		ug/L		12/13/01	SW846 8260B
1,2-Dichlorobenzene	< 6.7	6.7	21		ug/L		12/13/01	SW846 8260B
1,1-Dichloroethene	12	8.5	27		ug/L	Q	12/13/01	SW846 8260B
cis-1,2-Dichloroethene	13	7.3	23		ug/L	Q	12/13/01	SW846 8260B
Dichlorodifluoromethane	< 6.8	6.8	22		ug/L		12/13/01	SW846 8260B
trans-1,2-Dichloroethene	< 7.9	7.9	25		ug/L		12/13/01	SW846 8260B
1,2-Dichloropropane	< 5.3	5.3	17		ug/L		12/13/01	SW846 8260B
1,1-Dichloroethane	23	4.8	15		ug/L		12/13/01	SW846 8260B
1,3-Dichloropropane	< 5.3	5.3	17		ug/L		12/13/01	SW846 8260B
2,2-Dichloropropane	< 9.5	9.5	30		ug/L		12/13/01	SW846 8260B

- Analytical Report -

Project Name : TECUMSEH-GRAFTON

Project Number : 1177

Field ID : MW-12

Lab Sample Number : 816107-003

WI DNR LAB ID : 405132750

Client : MORAIN ENVIRONMENTAL INC

Report Date : 12/14/01

Collection Date : 12/4/01

Matrix Type : WATER

1,1-Dichloropropene	< 8.5	8.5	27	ug/L	12/13/01	SW846 8260B
cis-1,3-Dichloropropene	< 5.6	5.6	18	ug/L	12/13/01	SW846 8260B
trans-1,3-Dichloropropene	< 5.1	5.1	16	ug/L	12/13/01	SW846 8260B
Diisopropyl ether	< 6.0	6.0	19	ug/L	12/13/01	SW846 8260B
Ethylbenzene	< 4.3	4.3	14	ug/L	12/13/01	SW846 8260B
Fluorotrichloromethane	< 5.2	5.2	17	ug/L	12/13/01	SW846 8260B
Hexachlorobutadiene	< 8.4	8.4	27	ug/L	12/13/01	SW846 8260B
Isopropylbenzene	< 4.3	4.3	14	ug/L	12/13/01	SW846 8260B
p-Isopropyltoluene	< 5.7	5.7	18	ug/L	12/13/01	SW846 8260B
Methylene chloride	< 8.5	8.5	27	ug/L	12/13/01	SW846 8260B
Methyl-tert-butyl-ether	< 6.7	6.7	21	ug/L	12/13/01	SW846 8260B
Naphthalene	< 5.9	5.9	19	ug/L	12/13/01	SW846 8260B
n-Propylbenzene	< 6.4	6.4	20	ug/L	12/13/01	SW846 8260B
Styrene	< 4.3	4.3	14	ug/L	12/13/01	SW846 8260B
1,1,2,2-Tetrachloroethane	< 9.1	9.1	29	ug/L	12/13/01	SW846 8260B
1,1,1,2-Tetrachloroethane	< 7.5	7.5	24	ug/L	12/13/01	SW846 8260B
Tetrachloroethene	< 5.7	5.7	18	ug/L	12/13/01	SW846 8260B
Toluene	< 4.7	4.7	15	ug/L	12/13/01	SW846 8260B
1,2,3-Trichlorobenzene	< 5.7	5.7	18	ug/L	12/13/01	SW846 8260B
1,2,4-Trichlorobenzene	< 6.0	6.0	19	ug/L	12/13/01	SW846 8260B
1,1,1-Trichloroethane	100	6.9	22	ug/L	12/13/01	SW846 8260B
1,1,2-Trichloroethane	< 7.2	7.2	23	ug/L	12/13/01	SW846 8260B
1,2,4-Trimethylbenzene	< 5.1	5.1	16	ug/L	12/13/01	SW846 8260B
Trichloroethene	1200	8.9	28	ug/L	12/13/01	SW846 8260B
1,2,3-Trichloropropane	< 7.8	7.8	25	ug/L	12/13/01	SW846 8260B
1,3,5-Trimethylbenzene	< 5.2	5.2	17	ug/L	12/13/01	SW846 8260B
Vinyl chloride	< 1.8	1.8	5.7	ug/L	12/13/01	SW846 8260B
Xylenes, -m, -p	< 14	14	45	ug/L	12/13/01	SW846 8260B
Xylene, -o	< 5.4	5.4	17	ug/L	12/13/01	SW846 8260B
4-Bromofluorobenzene	85			%Recov	12/13/01	SW846 8260B
Dibromofluoromethane	95			%Recov	12/13/01	SW846 8260B
Toluene-d8	100			%Recov	12/13/01	SW846 8260B

- Analytical Report -

Project Name : TECUMSEH-GRAFTON
 Project Number : 1177
 Field ID : MW-13 BR (2)
 Lab Sample Number : 816107-004
 WI DNR LAB ID : 405132750

Client : MORaine ENVIRONMENTAL INC
 Report Date : 12/14/01
 Collection Date : 12/4/01
 Matrix Type : WATER

Organic Results**EPA 8260 VOLATILE LIST- WATER**

Prep Method: SW846 5030B Prep Date: 12/10/01 Analyst: TLT

Analyte	Result	LOD	LOQ	EQL	Units	Code	Analysis Date	Analysis Method
Benzene	< 2.4	2.4	7.6		ug/L		12/13/01	SW846 8260B
Bromobenzene	< 2.2	2.2	7.0		ug/L		12/13/01	SW846 8260B
Bromochloromethane	< 3.0	3.0	9.6		ug/L		12/13/01	SW846 8260B
Bromodichloromethane	< 3.0	3.0	9.6		ug/L		12/13/01	SW846 8260B
Bromoform	< 3.5	3.5	11		ug/L		12/13/01	SW846 8260B
Bromomethane	< 3.5	3.5	11		ug/L	&	12/13/01	SW846 8260B
s-Butylbenzene	< 2.4	2.4	7.6		ug/L		12/13/01	SW846 8260B
t-Butylbenzene	< 2.5	2.5	8.0		ug/L		12/13/01	SW846 8260B
n-Butylbenzene	< 3.0	3.0	9.6		ug/L		12/13/01	SW846 8260B
Carbon tetrachloride	< 3.6	3.6	11		ug/L		12/13/01	SW846 8260B
Chloroform	< 3.8	3.8	12		ug/L		12/13/01	SW846 8260B
Chlorobenzene	< 2.8	2.8	8.9		ug/L		12/13/01	SW846 8260B
Chlorodibromomethane	< 2.1	2.1	6.7		ug/L		12/13/01	SW846 8260B
Chloroethane	< 2.8	2.8	8.9		ug/L		12/13/01	SW846 8260B
Chloromethane	< 3.1	3.1	9.9		ug/L		12/13/01	SW846 8260B
2-Chlorotoluene	< 2.4	2.4	7.6		ug/L		12/13/01	SW846 8260B
4-Chlorotoluene	< 3.6	3.6	11		ug/L		12/13/01	SW846 8260B
1,2-Dibromo-3-chloropropane	< 5.0	5.0	16		ug/L		12/13/01	SW846 8260B
1,2-Dibromoethane	< 4.5	4.5	14		ug/L		12/13/01	SW846 8260B
Dibromomethane	< 3.4	3.4	11		ug/L		12/13/01	SW846 8260B
1,3-Dichlorobenzene	< 2.7	2.7	8.6		ug/L		12/13/01	SW846 8260B
1,4-Dichlorobenzene	< 1.9	1.9	6.1		ug/L		12/13/01	SW846 8260B
1,2-Dichloroethane	< 2.3	2.3	7.3		ug/L		12/13/01	SW846 8260B
1,2-Dichlorobenzene	< 3.4	3.4	11		ug/L		12/13/01	SW846 8260B
1,1-Dichloroethene	110	4.2	13		ug/L		12/13/01	SW846 8260B
cis-1,2-Dichloroethene	58	3.6	11		ug/L		12/13/01	SW846 8260B
Dichlorodifluoromethane	< 3.4	3.4	11		ug/L		12/13/01	SW846 8260B
trans-1,2-Dichloroethene	< 4.0	4.0	13		ug/L		12/13/01	SW846 8260B
1,2-Dichloropropane	< 2.6	2.6	8.3		ug/L		12/13/01	SW846 8260B
1,1-Dichloroethane	380	2.4	7.6		ug/L		12/13/01	SW846 8260B
1,3-Dichloropropane	< 2.6	2.6	8.3		ug/L		12/13/01	SW846 8260B
2,2-Dichloropropane	< 4.8	4.8	15		ug/L		12/13/01	SW846 8260B

- Analytical Report -

Project Name : TECUMSEH-GRAFTON
Project Number : 1177
Field ID : MW-13 BR (2)
Lab Sample Number : 816107-004
WI DNR LAB ID : 405132750

Client : MORaine ENVIRONMENTAL INC
Report Date : 12/14/01
Collection Date : 12/4/01
Matrix Type : WATER

1,1-Dichloropropene	< 4.2	4.2	13	ug/L	12/13/01	SW846 8260B
cis-1,3-Dichloropropene	< 2.8	2.8	8.9	ug/L	12/13/01	SW846 8260B
trans-1,3-Dichloropropene	< 2.5	2.5	8.0	ug/L	12/13/01	SW846 8260B
Diisopropyl ether	< 3.0	3.0	9.6	ug/L	12/13/01	SW846 8260B
Ethylbenzene	< 2.1	2.1	6.7	ug/L	12/13/01	SW846 8260B
Fluorotrichloromethane	< 2.6	2.6	8.3	ug/L	12/13/01	SW846 8260B
Hexachlorobutadiene	< 4.2	4.2	13	ug/L	12/13/01	SW846 8260B
Isopropylbenzene	< 2.1	2.1	6.7	ug/L	12/13/01	SW846 8260B
p-Isopropyltoluene	< 2.8	2.8	8.9	ug/L	12/13/01	SW846 8260B
Methylene chloride	< 4.2	4.2	13	ug/L	12/13/01	SW846 8260B
Methyl-tert-butyl-ether	< 3.4	3.4	11	ug/L	12/13/01	SW846 8260B
Naphthalene	< 2.9	2.9	9.2	ug/L	12/13/01	SW846 8260B
n-Propylbenzene	< 3.2	3.2	10	ug/L	12/13/01	SW846 8260B
Styrene	< 2.1	2.1	6.7	ug/L	12/13/01	SW846 8260B
1,1,2,2-Tetrachloroethane	< 4.5	4.5	14	ug/L	12/13/01	SW846 8260B
1,1,1,2-Tetrachloroethane	< 3.8	3.8	12	ug/L	12/13/01	SW846 8260B
Tetrachloroethene	< 2.8	2.8	8.9	ug/L	12/13/01	SW846 8260B
Toluene	< 2.3	2.3	7.3	ug/L	12/13/01	SW846 8260B
1,2,3-Trichlorobenzene	< 2.8	2.8	8.9	ug/L	12/13/01	SW846 8260B
1,2,4-Trichlorobenzene	< 3.0	3.0	9.6	ug/L	12/13/01	SW846 8260B
1,1,1-Trichloroethane	640	3.4	11	ug/L	12/13/01	SW846 8260B
1,1,2-Trichloroethane	< 3.6	3.6	11	ug/L	12/13/01	SW846 8260B
1,2,4-Trimethylbenzene	< 2.5	2.5	8.0	ug/L	12/13/01	SW846 8260B
Trichloroethene	390	4.5	14	ug/L	12/13/01	SW846 8260B
1,2,3-Trichloropropane	< 3.9	3.9	12	ug/L	12/13/01	SW846 8260B
1,3,5-Trimethylbenzene	< 2.6	2.6	8.3	ug/L	12/13/01	SW846 8260B
Vinyl chloride	< 0.90	0.90	2.9	ug/L	12/13/01	SW846 8260B
Xylenes, -m, -p	< 7.0	7.0	22	ug/L	12/13/01	SW846 8260B
Xylene, -o	< 2.7	2.7	8.6	ug/L	12/13/01	SW846 8260B
4-Bromofluorobenzene	85			%Recov	12/13/01	SW846 8260B
Dibromofluoromethane	92			%Recov	12/13/01	SW846 8260B
Toluene-d8	98			%Recov	12/13/01	SW846 8260B

- Analytical Report -

Project Name : TECUMSEH-GRAFTON
Project Number : 1177
Field ID : MW-18 BR (1)
Lab Sample Number : 816107-005
WI DNR LAB ID : 405132750

Client : MORaine ENVIRONMENTAL INC
Report Date : 12/14/01
Collection Date : 12/4/01
Matrix Type : WATER

Organic Results**EPA 8260 VOLATILE LIST- WATER**

Prep Method: SW846 5030B Prep Date: 12/10/01 Analyst: TLT

Analyte	Result	LOD	LOQ	EQL	Units	Code	Analysis Date	Analysis Method
Benzene	< 0.48	0.48	1.5		ug/L		12/12/01	SW846 8260B
Bromobenzene	< 0.44	0.44	1.4		ug/L		12/12/01	SW846 8260B
Bromochloromethane	< 0.61	0.61	1.9		ug/L		12/12/01	SW846 8260B
Bromodichloromethane	< 0.61	0.61	1.9		ug/L		12/12/01	SW846 8260B
Bromoform	< 0.70	0.70	2.2		ug/L		12/12/01	SW846 8260B
Bromomethane	< 0.71	0.71	2.3		ug/L		12/12/01	SW846 8260B
s-Butylbenzene	< 0.49	0.49	1.6		ug/L		12/12/01	SW846 8260B
t-Butylbenzene	< 0.50	0.50	1.6		ug/L		12/12/01	SW846 8260B
n-Butylbenzene	< 0.61	0.61	1.9		ug/L		12/12/01	SW846 8260B
Carbon tetrachloride	< 0.73	0.73	2.3		ug/L		12/12/01	SW846 8260B
Chloroform	< 0.75	0.75	2.4		ug/L		12/12/01	SW846 8260B
Chlorobenzene	< 0.55	0.55	1.8		ug/L		12/12/01	SW846 8260B
Chlorodibromomethane	< 0.43	0.43	1.4		ug/L		12/12/01	SW846 8260B
Chloroethane	< 0.57	0.57	1.8		ug/L		12/12/01	SW846 8260B
Chloromethane	< 0.62	0.62	2.0		ug/L		12/12/01	SW846 8260B
2-Chlorotoluene	< 0.48	0.48	1.5		ug/L		12/12/01	SW846 8260B
4-Chlorotoluene	< 0.72	0.72	2.3		ug/L		12/12/01	SW846 8260B
1,2-Dibromo-3-chloropropane	< 1.0	1.0	3.2		ug/L		12/12/01	SW846 8260B
1,2-Dibromoethane	< 0.91	0.91	2.9		ug/L		12/12/01	SW846 8260B
Dibromomethane	< 0.67	0.67	2.1		ug/L		12/12/01	SW846 8260B
1,3-Dichlorobenzene	< 0.54	0.54	1.7		ug/L		12/12/01	SW846 8260B
1,4-Dichlorobenzene	< 0.39	0.39	1.2		ug/L		12/12/01	SW846 8260B
1,2-Dichloroethane	< 0.47	0.47	1.5		ug/L		12/12/01	SW846 8260B
1,2-Dichlorobenzene	< 0.67	0.67	2.1		ug/L		12/12/01	SW846 8260B
1,1-Dichloroethene	1.4	0.85	2.7		ug/L	Q	12/12/01	SW846 8260B
cis-1,2-Dichloroethene	5.9	0.73	2.3		ug/L		12/12/01	SW846 8260B
Dichlorodifluoromethane	< 0.68	0.68	2.2		ug/L		12/12/01	SW846 8260B
trans-1,2-Dichloroethene	< 0.79	0.79	2.5		ug/L		12/12/01	SW846 8260B
1,2-Dichloropropane	< 0.53	0.53	1.7		ug/L		12/12/01	SW846 8260B
1,1-Dichloroethane	11	0.48	1.5		ug/L		12/12/01	SW846 8260B
1,3-Dichloropropane	< 0.53	0.53	1.7		ug/L		12/12/01	SW846 8260B
2,2-Dichloropropane	< 0.95	0.95	3.0		ug/L		12/12/01	SW846 8260B

- Analytical Report -

Project Name : TECUMSEH-GRAFTON

Project Number : 1177

Client : MORAIN ENVIRONMENTAL INC

Field ID : MW-18 BR (1)

Report Date : 12/14/01

Lab Sample Number : 816107-005

Collection Date : 12/4/01

WI DNR LAB ID : 405132750

Matrix Type : WATER

1,1-Dichloropropene	< 0.85	0.85	2.7	ug/L	12/12/01	SW846 8260B
cis-1,3-Dichloropropene	< 0.56	0.56	1.8	ug/L	12/12/01	SW846 8260B
trans-1,3-Dichloropropene	< 0.51	0.51	1.6	ug/L	12/12/01	SW846 8260B
Diisopropyl ether	< 0.60	0.60	1.9	ug/L	12/12/01	SW846 8260B
Ethylbenzene	< 0.43	0.43	1.4	ug/L	12/12/01	SW846 8260B
Fluorotrichloromethane	< 0.52	0.52	1.7	ug/L	12/12/01	SW846 8260B
Hexachlorobutadiene	< 0.84	0.84	2.7	ug/L	12/12/01	SW846 8260B
Isopropylbenzene	< 0.43	0.43	1.4	ug/L	12/12/01	SW846 8260B
p-Isopropyltoluene	< 0.57	0.57	1.8	ug/L	12/12/01	SW846 8260B
Methylene chloride	< 0.85	0.85	2.7	ug/L	12/12/01	SW846 8260B
Methyl-tert-butyl-ether	< 0.67	0.67	2.1	ug/L	12/12/01	SW846 8260B
Naphthalene	< 0.59	0.59	1.9	ug/L	12/12/01	SW846 8260B
n-Propylbenzene	< 0.64	0.64	2.0	ug/L	12/12/01	SW846 8260B
Styrene	< 0.43	0.43	1.4	ug/L	12/12/01	SW846 8260B
1,1,2,2-Tetrachloroethane	< 0.91	0.91	2.9	ug/L	12/12/01	SW846 8260B
1,1,1,2-Tetrachloroethane	< 0.75	0.75	2.4	ug/L	12/12/01	SW846 8260B
Tetrachloroethene	< 0.57	0.57	1.8	ug/L	12/12/01	SW846 8260B
Toluene	< 0.47	0.47	1.5	ug/L	12/12/01	SW846 8260B
1,2,3-Trichlorobenzene	< 0.57	0.57	1.8	ug/L	12/12/01	SW846 8260B
1,2,4-Trichlorobenzene	< 0.60	0.60	1.9	ug/L	12/12/01	SW846 8260B
1,1,1-Trichloroethane	4.5	0.69	2.2	ug/L	12/12/01	SW846 8260B
1,1,2-Trichloroethane	< 0.72	0.72	2.3	ug/L	12/12/01	SW846 8260B
1,2,4-Trimethylbenzene	< 0.51	0.51	1.6	ug/L	12/12/01	SW846 8260B
Trichloroethene	11	0.89	2.8	ug/L	12/12/01	SW846 8260B
1,2,3-Trichloropropane	< 0.78	0.78	2.5	ug/L	12/12/01	SW846 8260B
1,3,5-Trimethylbenzene	< 0.52	0.52	1.7	ug/L	12/12/01	SW846 8260B
Vinyl chloride	< 0.18	0.18	0.57	ug/L	12/12/01	SW846 8260B
Xylenes, -m, -p	< 1.4	1.4	4.5	ug/L	12/12/01	SW846 8260B
Xylene, -o	< 0.54	0.54	1.7	ug/L	12/12/01	SW846 8260B
4-Bromofluorobenzene	87			%Recov	12/12/01	SW846 8260B
Dibromofluoromethane	94			%Recov	12/12/01	SW846 8260B
Toluene-d8	98			%Recov	12/12/01	SW846 8260B

- Analytical Report -

Project Name : TECUMSEH-GRAFTON
Project Number : 1177
Field ID : MW-18 BR (2)
Lab Sample Number : 816107-006
WI DNR LAB ID : 405132750

Client : MORAIN ENVIRONMENTAL INC
Report Date : 12/14/01
Collection Date : 12/4/01
Matrix Type : WATER

Organic Results**EPA 8260 VOLATILE LIST- WATER**

Prep Method: SW846 5030B

Prep Date: 12/10/01

Analyst: TLT

Analyte	Result	LOD	LOQ	EQL	Units	Code	Analysis Date	Analysis Method
Benzene	< 0.48	0.48	1.5		ug/L		12/12/01	SW846 8260B
Bromobenzene	< 0.44	0.44	1.4		ug/L		12/12/01	SW846 8260B
Bromochloromethane	< 0.61	0.61	1.9		ug/L		12/12/01	SW846 8260B
Bromodichloromethane	< 0.61	0.61	1.9		ug/L		12/12/01	SW846 8260B
Bromoform	< 0.70	0.70	2.2		ug/L		12/12/01	SW846 8260B
Bromomethane	< 0.71	0.71	2.3		ug/L		12/12/01	SW846 8260B
s-Butylbenzene	< 0.49	0.49	1.6		ug/L		12/12/01	SW846 8260B
t-Butylbenzene	< 0.50	0.50	1.6		ug/L		12/12/01	SW846 8260B
n-Butylbenzene	< 0.61	0.61	1.9		ug/L		12/12/01	SW846 8260B
Carbon tetrachloride	< 0.73	0.73	2.3		ug/L		12/12/01	SW846 8260B
Chloroform	< 0.75	0.75	2.4		ug/L		12/12/01	SW846 8260B
Chlorobenzene	< 0.55	0.55	1.8		ug/L		12/12/01	SW846 8260B
Chlorodibromomethane	< 0.43	0.43	1.4		ug/L		12/12/01	SW846 8260B
Chloroethane	< 0.57	0.57	1.8		ug/L		12/12/01	SW846 8260B
Chloromethane	< 0.62	0.62	2.0		ug/L		12/12/01	SW846 8260B
2-Chlorotoluene	< 0.48	0.48	1.5		ug/L		12/12/01	SW846 8260B
4-Chlorotoluene	< 0.72	0.72	2.3		ug/L		12/12/01	SW846 8260B
1,2-Dibromo-3-chloropropane	< 1.0	1.0	3.2		ug/L		12/12/01	SW846 8260B
1,2-Dibromoethane	< 0.91	0.91	2.9		ug/L		12/12/01	SW846 8260B
Dibromomethane	< 0.67	0.67	2.1		ug/L		12/12/01	SW846 8260B
1,3-Dichlorobenzene	< 0.54	0.54	1.7		ug/L		12/12/01	SW846 8260B
1,4-Dichlorobenzene	< 0.39	0.39	1.2		ug/L		12/12/01	SW846 8260B
1,2-Dichloroethane	< 0.47	0.47	1.5		ug/L		12/12/01	SW846 8260B
1,2-Dichlorobenzene	< 0.67	0.67	2.1		ug/L		12/12/01	SW846 8260B
1,1-Dichloroethene	6.5	0.85	2.7		ug/L		12/12/01	SW846 8260B
cis-1,2-Dichloroethene	26	0.73	2.3		ug/L		12/12/01	SW846 8260B
Dichlorodifluoromethane	< 0.68	0.68	2.2		ug/L		12/12/01	SW846 8260B
trans-1,2-Dichloroethene	0.88	0.79	2.5		ug/L	Q	12/12/01	SW846 8260B
1,2-Dichloropropane	< 0.53	0.53	1.7		ug/L		12/12/01	SW846 8260B
1,1-Dichloroethane	50	0.48	1.5		ug/L		12/12/01	SW846 8260B
1,3-Dichloropropane	< 0.53	0.53	1.7		ug/L		12/12/01	SW846 8260B
2,2-Dichloropropane	< 0.95	0.95	3.0		ug/L		12/12/01	SW846 8260B

- Analytical Report -

Project Name : TECUMSEH-GRAFTON

Project Number : 1177

Client : MORAIN ENVIRONMENTAL INC

Field ID : MW-18 BR (2)

Report Date : 12/14/01

Lab Sample Number : 816107-006

Collection Date : 12/4/01

WI DNR LAB ID : 405132750

Matrix Type : WATER

1,1-Dichloropropene	< 0.85	0.85	2.7	ug/L	12/12/01	SW846 8260B
cis-1,3-Dichloropropene	< 0.56	0.56	1.8	ug/L	12/12/01	SW846 8260B
trans-1,3-Dichloropropene	< 0.51	0.51	1.6	ug/L	12/12/01	SW846 8260B
Diisopropyl ether	< 0.60	0.60	1.9	ug/L	12/12/01	SW846 8260B
Ethylbenzene	< 0.43	0.43	1.4	ug/L	12/12/01	SW846 8260B
Fluorotrichloromethane	< 0.52	0.52	1.7	ug/L	12/12/01	SW846 8260B
Hexachlorobutadiene	< 0.84	0.84	2.7	ug/L	12/12/01	SW846 8260B
Isopropylbenzene	< 0.43	0.43	1.4	ug/L	12/12/01	SW846 8260B
p-Isopropyltoluene	< 0.57	0.57	1.8	ug/L	12/12/01	SW846 8260B
Methylene chloride	< 0.85	0.85	2.7	ug/L	12/12/01	SW846 8260B
Methyl-tert-butyl-ether	< 0.67	0.67	2.1	ug/L	12/12/01	SW846 8260B
Naphthalene	< 0.59	0.59	1.9	ug/L	12/12/01	SW846 8260B
n-Propylbenzene	< 0.64	0.64	2.0	ug/L	12/12/01	SW846 8260B
Styrene	< 0.43	0.43	1.4	ug/L	12/12/01	SW846 8260B
1,1,2,2-Tetrachloroethane	< 0.91	0.91	2.9	ug/L	12/12/01	SW846 8260B
1,1,1,2-Tetrachloroethane	< 0.75	0.75	2.4	ug/L	12/12/01	SW846 8260B
Tetrachloroethene	< 0.57	0.57	1.8	ug/L	12/12/01	SW846 8260B
Toluene	< 0.47	0.47	1.5	ug/L	12/12/01	SW846 8260B
1,2,3-Trichlorobenzene	< 0.57	0.57	1.8	ug/L	12/12/01	SW846 8260B
1,2,4-Trichlorobenzene	< 0.60	0.60	1.9	ug/L	12/12/01	SW846 8260B
1,1,1-Trichloroethane	21	0.69	2.2	ug/L	12/12/01	SW846 8260B
1,1,2-Trichloroethane	< 0.72	0.72	2.3	ug/L	12/12/01	SW846 8260B
1,2,4-Trimethylbenzene	< 0.51	0.51	1.6	ug/L	12/12/01	SW846 8260B
Trichloroethene	43	0.89	2.8	ug/L	12/12/01	SW846 8260B
1,2,3-Trichloropropane	< 0.78	0.78	2.5	ug/L	12/12/01	SW846 8260B
1,3,5-Trimethylbenzene	< 0.52	0.52	1.7	ug/L	12/12/01	SW846 8260B
Vinyl chloride	< 0.18	0.18	0.57	ug/L	12/12/01	SW846 8260B
Xylenes, -m, -p	< 1.4	1.4	4.5	ug/L	12/12/01	SW846 8260B
Xylene, -o	< 0.54	0.54	1.7	ug/L	12/12/01	SW846 8260B
4-Bromofluorobenzene	85			%Recov	12/12/01	SW846 8260B
Dibromofluoromethane	95			%Recov	12/12/01	SW846 8260B
Toluene-d8	96			%Recov	12/12/01	SW846 8260B

- Analytical Report -

Project Name : TECUMSEH-GRAFTON

Project Number : 1177

Field ID : MW-19 BR (1)

Lab Sample Number : 816107-007

WI DNR LAB ID : 405132750

Client : MORAIN ENVIRONMENTAL INC

Report Date : 12/14/01

Collection Date : 12/4/01

Matrix Type : WATER

Organic Results**EPA 8260 VOLATILE LIST- WATER**

Prep Method: SW846 5030B

Prep Date: 12/10/01

Analyst: TLT

Analyte	Result	LOD	LOQ	EQL	Units	Code	Analysis Date	Analysis Method
Benzene	< 0.96	0.96	3.1		ug/L		12/13/01	SW846 8260B
Bromobenzene	< 0.88	0.88	2.8		ug/L		12/13/01	SW846 8260B
Bromochloromethane	< 1.2	1.2	3.8		ug/L		12/13/01	SW846 8260B
Bromodichloromethane	< 1.2	1.2	3.8		ug/L		12/13/01	SW846 8260B
Bromoform	< 1.4	1.4	4.5		ug/L		12/13/01	SW846 8260B
Bromomethane	< 1.4	1.4	4.5		ug/L	&	12/13/01	SW846 8260B
s-Butylbenzene	< 0.98	0.98	3.1		ug/L		12/13/01	SW846 8260B
t-Butylbenzene	< 1.0	1.0	3.2		ug/L		12/13/01	SW846 8260B
n-Butylbenzene	< 1.2	1.2	3.8		ug/L		12/13/01	SW846 8260B
Carbon tetrachloride	< 1.5	1.5	4.8		ug/L		12/13/01	SW846 8260B
Chloroform	< 1.5	1.5	4.8		ug/L		12/13/01	SW846 8260B
Chlorobenzene	< 1.1	1.1	3.5		ug/L		12/13/01	SW846 8260B
Chlorodibromomethane	< 0.86	0.86	2.7		ug/L		12/13/01	SW846 8260B
Chloroethane	< 1.1	1.1	3.5		ug/L		12/13/01	SW846 8260B
Chloromethane	< 1.2	1.2	3.8		ug/L		12/13/01	SW846 8260B
2-Chlorotoluene	< 0.96	0.96	3.1		ug/L		12/13/01	SW846 8260B
4-Chlorotoluene	< 1.4	1.4	4.5		ug/L		12/13/01	SW846 8260B
1,2-Dibromo-3-chloropropane	< 2.0	2.0	6.4		ug/L		12/13/01	SW846 8260B
1,2-Dibromoethane	< 1.8	1.8	5.7		ug/L		12/13/01	SW846 8260B
Dibromomethane	< 1.3	1.3	4.1		ug/L		12/13/01	SW846 8260B
1,3-Dichlorobenzene	< 1.1	1.1	3.5		ug/L		12/13/01	SW846 8260B
1,4-Dichlorobenzene	< 0.78	0.78	2.5		ug/L		12/13/01	SW846 8260B
1,2-Dichloroethane	< 0.94	0.94	3.0		ug/L		12/13/01	SW846 8260B
1,2-Dichlorobenzene	< 1.3	1.3	4.1		ug/L		12/13/01	SW846 8260B
1,1-Dichloroethene	13	1.7	5.4		ug/L		12/13/01	SW846 8260B
cis-1,2-Dichloroethene	46	1.5	4.8		ug/L		12/13/01	SW846 8260B
Dichlorodifluoromethane	< 1.4	1.4	4.5		ug/L		12/13/01	SW846 8260B
trans-1,2-Dichloroethene	< 1.6	1.6	5.1		ug/L		12/13/01	SW846 8260B
1,2-Dichloropropane	< 1.1	1.1	3.5		ug/L		12/13/01	SW846 8260B
1,1-Dichloroethane	92	0.96	3.1		ug/L		12/13/01	SW846 8260B
1,3-Dichloropropane	< 1.1	1.1	3.5		ug/L		12/13/01	SW846 8260B
2,2-Dichloropropane	< 1.9	1.9	6.1		ug/L		12/13/01	SW846 8260B

- Analytical Report -

Project Name : TECUMSEH-GRAFTON
 Project Number : 1177
 Field ID : MW-19 BR (1)
 Lab Sample Number : 816107-007
 WI DNR LAB ID : 405132750

Client : MORAIN ENVIRONMENTAL INC
 Report Date : 12/14/01
 Collection Date : 12/4/01
 Matrix Type : WATER

1,1-Dichloropropene	< 1.7	1.7	5.4	ug/L		12/13/01	SW846 8260B
cis-1,3-Dichloropropene	< 1.1	1.1	3.5	ug/L		12/13/01	SW846 8260B
trans-1,3-Dichloropropene	< 1.0	1.0	3.2	ug/L		12/13/01	SW846 8260B
Diisopropyl ether	< 1.2	1.2	3.8	ug/L		12/13/01	SW846 8260B
Ethylbenzene	< 0.86	0.86	2.7	ug/L		12/13/01	SW846 8260B
Fluorotrichloromethane	< 1.0	1.0	3.2	ug/L		12/13/01	SW846 8260B
Hexachlorobutadiene	< 1.7	1.7	5.4	ug/L		12/13/01	SW846 8260B
Isopropylbenzene	< 0.86	0.86	2.7	ug/L		12/13/01	SW846 8260B
p-Isopropyltoluene	< 1.1	1.1	3.5	ug/L		12/13/01	SW846 8260B
Methylene chloride	< 1.7	1.7	5.4	ug/L		12/13/01	SW846 8260B
Methyl-tert-butyl-ether	< 1.3	1.3	4.1	ug/L		12/13/01	SW846 8260B
Naphthalene	< 1.2	1.2	3.8	ug/L		12/13/01	SW846 8260B
n-Propylbenzene	< 1.3	1.3	4.1	ug/L		12/13/01	SW846 8260B
Styrene	< 0.86	0.86	2.7	ug/L		12/13/01	SW846 8260B
1,1,2,2-Tetrachloroethane	< 1.8	1.8	5.7	ug/L		12/13/01	SW846 8260B
1,1,1,2-Tetrachloroethane	< 1.5	1.5	4.8	ug/L		12/13/01	SW846 8260B
Tetrachloroethene	< 1.1	1.1	3.5	ug/L		12/13/01	SW846 8260B
Toluene	< 0.94	0.94	3.0	ug/L		12/13/01	SW846 8260B
1,2,3-Trichlorobenzene	< 1.1	1.1	3.5	ug/L		12/13/01	SW846 8260B
1,2,4-Trichlorobenzene	< 1.2	1.2	3.8	ug/L		12/13/01	SW846 8260B
1,1,1-Trichloroethane	2.1	1.4	4.5	ug/L	Q	12/13/01	SW846 8260B
1,1,2-Trichloroethane	< 1.4	1.4	4.5	ug/L		12/13/01	SW846 8260B
1,2,4-Trimethylbenzene	< 1.0	1.0	3.2	ug/L		12/13/01	SW846 8260B
Trichloroethene	300	1.8	5.7	ug/L		12/13/01	SW846 8260B
1,2,3-Trichloropropane	< 1.6	1.6	5.1	ug/L		12/13/01	SW846 8260B
1,3,5-Trimethylbenzene	< 1.0	1.0	3.2	ug/L		12/13/01	SW846 8260B
Vinyl chloride	3.1	0.36	1.1	ug/L		12/13/01	SW846 8260B
Xylenes, -m, -p	< 2.8	2.8	8.9	ug/L		12/13/01	SW846 8260B
Xylene, -o	< 1.1	1.1	3.5	ug/L		12/13/01	SW846 8260B
4-Bromofluorobenzene	83			%Recov		12/13/01	SW846 8260B
Dibromofluoromethane	93			%Recov		12/13/01	SW846 8260B
Toluene-d8	98			%Recov		12/13/01	SW846 8260B

- Analytical Report -

Project Name : TECUMSEH-GRAFTON
 Project Number : 1177
 Field ID : MW-20 BR (1)
 Lab Sample Number : 816107-008
 WI DNR LAB ID : 405132750

Client : MORaine ENVIRONMENTAL INC
 Report Date : 12/14/01
 Collection Date : 12/4/01
 Matrix Type : WATER

Organic Results**EPA 8260 VOLATILE LIST- WATER**

Prep Method: SW846 5030B Prep Date: 12/10/01 Analyst: TLT

Analyte	Result	LOD	LOQ	EQL	Units	Code	Analysis Date	Analysis Method
Benzene	< 0.48	0.48	1.5		ug/L		12/12/01	SW846 8260B
Bromobenzene	< 0.44	0.44	1.4		ug/L		12/12/01	SW846 8260B
Bromochloromethane	< 0.61	0.61	1.9		ug/L		12/12/01	SW846 8260B
Bromodichloromethane	< 0.61	0.61	1.9		ug/L		12/12/01	SW846 8260B
Bromoform	< 0.70	0.70	2.2		ug/L		12/12/01	SW846 8260B
Bromomethane	< 0.71	0.71	2.3		ug/L		12/12/01	SW846 8260B
s-Butylbenzene	< 0.49	0.49	1.6		ug/L		12/12/01	SW846 8260B
t-Butylbenzene	< 0.50	0.50	1.6		ug/L		12/12/01	SW846 8260B
n-Butylbenzene	< 0.61	0.61	1.9		ug/L		12/12/01	SW846 8260B
Carbon tetrachloride	< 0.73	0.73	2.3		ug/L		12/12/01	SW846 8260B
Chloroform	< 0.75	0.75	2.4		ug/L		12/12/01	SW846 8260B
Chlorobenzene	< 0.55	0.55	1.8		ug/L		12/12/01	SW846 8260B
Chlorodibromomethane	< 0.43	0.43	1.4		ug/L		12/12/01	SW846 8260B
Chloroethane	< 0.57	0.57	1.8		ug/L		12/12/01	SW846 8260B
Chloromethane	< 0.62	0.62	2.0		ug/L		12/12/01	SW846 8260B
2-Chlorotoluene	< 0.48	0.48	1.5		ug/L		12/12/01	SW846 8260B
4-Chlorotoluene	< 0.72	0.72	2.3		ug/L		12/12/01	SW846 8260B
1,2-Dibromo-3-chloropropane	< 1.0	1.0	3.2		ug/L		12/12/01	SW846 8260B
1,2-Dibromoethane	< 0.91	0.91	2.9		ug/L		12/12/01	SW846 8260B
Dibromomethane	< 0.67	0.67	2.1		ug/L		12/12/01	SW846 8260B
1,3-Dichlorobenzene	< 0.54	0.54	1.7		ug/L		12/12/01	SW846 8260B
1,4-Dichlorobenzene	< 0.39	0.39	1.2		ug/L		12/12/01	SW846 8260B
1,2-Dichloroethane	< 0.47	0.47	1.5		ug/L		12/12/01	SW846 8260B
1,2-Dichlorobenzene	< 0.67	0.67	2.1		ug/L		12/12/01	SW846 8260B
1,1-Dichloroethene	< 0.85	0.85	2.7		ug/L		12/12/01	SW846 8260B
cis-1,2-Dichloroethene	< 0.73	0.73	2.3		ug/L		12/12/01	SW846 8260B
Dichlorodifluoromethane	< 0.68	0.68	2.2		ug/L		12/12/01	SW846 8260B
trans-1,2-Dichloroethene	< 0.79	0.79	2.5		ug/L		12/12/01	SW846 8260B
1,2-Dichloropropane	< 0.53	0.53	1.7		ug/L		12/12/01	SW846 8260B
1,1-Dichloroethane	< 0.48	0.48	1.5		ug/L		12/12/01	SW846 8260B
1,3-Dichloropropane	< 0.53	0.53	1.7		ug/L		12/12/01	SW846 8260B
2,2-Dichloropropane	< 0.95	0.95	3.0		ug/L		12/12/01	SW846 8260B

- Analytical Report -

Project Name : TECUMSEH-GRAFTON

Project Number : 1177

Field ID : MW-20 BR (1)

Lab Sample Number : 816107-008

WI DNR LAB ID : 405132750

Client : MORaine ENVIRONMENTAL INC

Report Date : 12/14/01

Collection Date : 12/4/01

Matrix Type : WATER

1,1-Dichloropropene	< 0.85	0.85	2.7	ug/L	12/12/01	SW846 8260B
cis-1,3-Dichloropropene	< 0.56	0.56	1.8	ug/L	12/12/01	SW846 8260B
trans-1,3-Dichloropropene	< 0.51	0.51	1.6	ug/L	12/12/01	SW846 8260B
Diisopropyl ether	< 0.60	0.60	1.9	ug/L	12/12/01	SW846 8260B
Ethylbenzene	< 0.43	0.43	1.4	ug/L	12/12/01	SW846 8260B
Fluorotrichloromethane	< 0.52	0.52	1.7	ug/L	12/12/01	SW846 8260B
Hexachlorobutadiene	< 0.84	0.84	2.7	ug/L	12/12/01	SW846 8260B
Isopropylbenzene	< 0.43	0.43	1.4	ug/L	12/12/01	SW846 8260B
p-Isopropyltoluene	< 0.57	0.57	1.8	ug/L	12/12/01	SW846 8260B
Methylene chloride	< 0.85	0.85	2.7	ug/L	12/12/01	SW846 8260B
Methyl-tert-butyl-ether	< 0.67	0.67	2.1	ug/L	12/12/01	SW846 8260B
Naphthalene	< 0.59	0.59	1.9	ug/L	12/12/01	SW846 8260B
n-Propylbenzene	< 0.64	0.64	2.0	ug/L	12/12/01	SW846 8260B
Styrene	< 0.43	0.43	1.4	ug/L	12/12/01	SW846 8260B
1,1,2,2-Tetrachloroethane	< 0.91	0.91	2.9	ug/L	12/12/01	SW846 8260B
1,1,1,2-Tetrachloroethane	< 0.75	0.75	2.4	ug/L	12/12/01	SW846 8260B
Tetrachloroethene	< 0.57	0.57	1.8	ug/L	12/12/01	SW846 8260B
Toluene	< 0.47	0.47	1.5	ug/L	12/12/01	SW846 8260B
1,2,3-Trichlorobenzene	< 0.57	0.57	1.8	ug/L	12/12/01	SW846 8260B
1,2,4-Trichlorobenzene	< 0.60	0.60	1.9	ug/L	12/12/01	SW846 8260B
1,1,1-Trichloroethane	< 0.69	0.69	2.2	ug/L	12/12/01	SW846 8260B
1,1,2-Trichloroethane	< 0.72	0.72	2.3	ug/L	12/12/01	SW846 8260B
1,2,4-Trimethylbenzene	< 0.51	0.51	1.6	ug/L	12/12/01	SW846 8260B
Trichloroethene	< 0.89	0.89	2.8	ug/L	12/12/01	SW846 8260B
1,2,3-Trichloropropane	< 0.78	0.78	2.5	ug/L	12/12/01	SW846 8260B
1,3,5-Trimethylbenzene	< 0.52	0.52	1.7	ug/L	12/12/01	SW846 8260B
Vinyl chloride	< 0.18	0.18	0.57	ug/L	12/12/01	SW846 8260B
Xylenes, -m, -p	< 1.4	1.4	4.5	ug/L	12/12/01	SW846 8260B
Xylene, -o	< 0.54	0.54	1.7	ug/L	12/12/01	SW846 8260B
4-Bromofluorobenzene	88			%Recov	12/12/01	SW846 8260B
Dibromofluoromethane	93			%Recov	12/12/01	SW846 8260B
Toluene-d8	99			%Recov	12/12/01	SW846 8260B

- Analytical Report -

Project Name : TECUMSEH-GRAFTON

Project Number : 1177

Client : MORAIN ENVIRONMENTAL INC

Field ID : MW-20 BR (2)

Report Date : 12/14/01

Lab Sample Number : 816107-009

Collection Date : 12/4/01

WI DNR LAB ID : 405132750

Matrix Type : WATER

Organic Results

EPA 8260 VOLATILE LIST- WATER

Prep Method: SW846 5030B

Prep Date: 12/10/01

Analyst: TLT

Analyte	Result	LOD	LOQ	EQL	Units	Code	Analysis Date	Analysis Method
Benzene	< 0.48	0.48	1.5		ug/L		12/12/01	SW846 8260B
Bromobenzene	< 0.44	0.44	1.4		ug/L		12/12/01	SW846 8260B
Bromochloromethane	< 0.61	0.61	1.9		ug/L		12/12/01	SW846 8260B
Bromodichloromethane	< 0.61	0.61	1.9		ug/L		12/12/01	SW846 8260B
Bromoform	< 0.70	0.70	2.2		ug/L		12/12/01	SW846 8260B
Bromomethane	< 0.71	0.71	2.3		ug/L		12/12/01	SW846 8260B
s-Butylbenzene	< 0.49	0.49	1.6		ug/L		12/12/01	SW846 8260B
t-Butylbenzene	< 0.50	0.50	1.6		ug/L		12/12/01	SW846 8260B
n-Butylbenzene	< 0.61	0.61	1.9		ug/L		12/12/01	SW846 8260B
Carbon tetrachloride	< 0.73	0.73	2.3		ug/L		12/12/01	SW846 8260B
Chloroform	< 0.75	0.75	2.4		ug/L		12/12/01	SW846 8260B
Chlorobenzene	< 0.55	0.55	1.8		ug/L		12/12/01	SW846 8260B
Chlorodibromomethane	< 0.43	0.43	1.4		ug/L		12/12/01	SW846 8260B
Chloroethane	< 0.57	0.57	1.8		ug/L		12/12/01	SW846 8260B
Chloromethane	< 0.62	0.62	2.0		ug/L		12/12/01	SW846 8260B
2-Chlorotoluene	< 0.48	0.48	1.5		ug/L		12/12/01	SW846 8260B
4-Chlorotoluene	< 0.72	0.72	2.3		ug/L		12/12/01	SW846 8260B
1,2-Dibromo-3-chloropropane	< 1.0	1.0	3.2		ug/L		12/12/01	SW846 8260B
1,2-Dibromoethane	< 0.91	0.91	2.9		ug/L		12/12/01	SW846 8260B
Dibromomethane	< 0.67	0.67	2.1		ug/L		12/12/01	SW846 8260B
1,3-Dichlorobenzene	< 0.54	0.54	1.7		ug/L		12/12/01	SW846 8260B
1,4-Dichlorobenzene	< 0.39	0.39	1.2		ug/L		12/12/01	SW846 8260B
1,2-Dichloroethane	< 0.47	0.47	1.5		ug/L		12/12/01	SW846 8260B
1,2-Dichlorobenzene	< 0.67	0.67	2.1		ug/L		12/12/01	SW846 8260B
1,1-Dichloroethene	< 0.85	0.85	2.7		ug/L		12/12/01	SW846 8260B
cis-1,2-Dichloroethene	< 0.73	0.73	2.3		ug/L		12/12/01	SW846 8260B
Dichlorodifluoromethane	< 0.68	0.68	2.2		ug/L		12/12/01	SW846 8260B
trans-1,2-Dichloroethene	< 0.79	0.79	2.5		ug/L		12/12/01	SW846 8260B
1,2-Dichloropropane	< 0.53	0.53	1.7		ug/L		12/12/01	SW846 8260B
1,1-Dichloroethane	< 0.48	0.48	1.5		ug/L		12/12/01	SW846 8260B
1,3-Dichloropropane	< 0.53	0.53	1.7		ug/L		12/12/01	SW846 8260B
2,2-Dichloropropane	< 0.95	0.95	3.0		ug/L		12/12/01	SW846 8260B

- Analytical Report -

Project Name : TECUMSEH-GRAFTON

Project Number : 1177

Field ID : MW-20 BR (2)

Lab Sample Number : 816107-009

WI DNR LAB ID : 405132750

Client : MORaine ENVIRONMENTAL INC

Report Date : 12/14/01

Collection Date : 12/4/01

Matrix Type : WATER

1,1-Dichloropropene	< 0.85	0.85	2.7	ug/L	12/12/01	SW846 8260B
cis-1,3-Dichloropropene	< 0.56	0.56	1.8	ug/L	12/12/01	SW846 8260B
trans-1,3-Dichloropropene	< 0.51	0.51	1.6	ug/L	12/12/01	SW846 8260B
Diisopropyl ether	< 0.60	0.60	1.9	ug/L	12/12/01	SW846 8260B
Ethylbenzene	< 0.43	0.43	1.4	ug/L	12/12/01	SW846 8260B
Fluorotrichloromethane	< 0.52	0.52	1.7	ug/L	12/12/01	SW846 8260B
Hexachlorobutadiene	< 0.84	0.84	2.7	ug/L	12/12/01	SW846 8260B
Isopropylbenzene	< 0.43	0.43	1.4	ug/L	12/12/01	SW846 8260B
p-Isopropyltoluene	< 0.57	0.57	1.8	ug/L	12/12/01	SW846 8260B
Methylene chloride	< 0.85	0.85	2.7	ug/L	12/12/01	SW846 8260B
Methyl-tert-butyl-ether	< 0.67	0.67	2.1	ug/L	12/12/01	SW846 8260B
Naphthalene	< 0.59	0.59	1.9	ug/L	12/12/01	SW846 8260B
n-Propylbenzene	< 0.64	0.64	2.0	ug/L	12/12/01	SW846 8260B
Styrene	< 0.43	0.43	1.4	ug/L	12/12/01	SW846 8260B
1,1,2,2-Tetrachloroethane	< 0.91	0.91	2.9	ug/L	12/12/01	SW846 8260B
1,1,1,2-Tetrachloroethane	< 0.75	0.75	2.4	ug/L	12/12/01	SW846 8260B
Tetrachloroethene	< 0.57	0.57	1.8	ug/L	12/12/01	SW846 8260B
Toluene	< 0.47	0.47	1.5	ug/L	12/12/01	SW846 8260B
1,2,3-Trichlorobenzene	< 0.57	0.57	1.8	ug/L	12/12/01	SW846 8260B
1,2,4-Trichlorobenzene	< 0.60	0.60	1.9	ug/L	12/12/01	SW846 8260B
1,1,1-Trichloroethane	< 0.69	0.69	2.2	ug/L	12/12/01	SW846 8260B
1,1,2-Trichloroethane	< 0.72	0.72	2.3	ug/L	12/12/01	SW846 8260B
1,2,4-Trimethylbenzene	< 0.51	0.51	1.6	ug/L	12/12/01	SW846 8260B
Trichloroethene	< 0.89	0.89	2.8	ug/L	12/12/01	SW846 8260B
1,2,3-Trichloropropane	< 0.78	0.78	2.5	ug/L	12/12/01	SW846 8260B
1,3,5-Trimethylbenzene	< 0.52	0.52	1.7	ug/L	12/12/01	SW846 8260B
Vinyl chloride	< 0.18	0.18	0.57	ug/L	12/12/01	SW846 8260B
Xylenes, -m, -p	< 1.4	1.4	4.5	ug/L	12/12/01	SW846 8260B
Xylene, -o	< 0.54	0.54	1.7	ug/L	12/12/01	SW846 8260B
4-Bromofluorobenzene	87			%Recov	12/12/01	SW846 8260B
Dibromofluoromethane	96			%Recov	12/12/01	SW846 8260B
Toluene-d8	97			%Recov	12/12/01	SW846 8260B

- Analytical Report -

Project Name : TECUMSEH-GRAFTON

Project Number : 1177

Client : MORaine ENVIRONMENTAL INC

Field ID : MW-21 BR (1)

Report Date : 12/14/01

Lab Sample Number : 816107-010

Collection Date : 12/4/01

WI DNR LAB ID : 405132750

Matrix Type : WATER

Organic Results**EPA 8260 VOLATILE LIST- WATER**

Prep Method: SW846 5030B

Prep Date: 12/10/01

Analyst: TLT

Analyte	Result	LOD	LOQ	EQL	Units	Code	Analysis Date	Analysis Method
Benzene	< 0.48	0.48	1.5		ug/L		12/12/01	SW846 8260B
Bromobenzene	< 0.44	0.44	1.4		ug/L		12/12/01	SW846 8260B
Bromochloromethane	< 0.61	0.61	1.9		ug/L		12/12/01	SW846 8260B
Bromodichloromethane	< 0.61	0.61	1.9		ug/L		12/12/01	SW846 8260B
Bromoform	< 0.70	0.70	2.2		ug/L		12/12/01	SW846 8260B
Bromomethane	< 0.71	0.71	2.3		ug/L		12/12/01	SW846 8260B
s-Butylbenzene	< 0.49	0.49	1.6		ug/L		12/12/01	SW846 8260B
t-Butylbenzene	< 0.50	0.50	1.6		ug/L		12/12/01	SW846 8260B
n-Butylbenzene	< 0.61	0.61	1.9		ug/L		12/12/01	SW846 8260B
Carbon tetrachloride	< 0.73	0.73	2.3		ug/L		12/12/01	SW846 8260B
Chloroform	< 0.75	0.75	2.4		ug/L		12/12/01	SW846 8260B
Chlorobenzene	< 0.55	0.55	1.8		ug/L		12/12/01	SW846 8260B
Chlorodibromomethane	< 0.43	0.43	1.4		ug/L		12/12/01	SW846 8260B
Chloroethane	< 0.57	0.57	1.8		ug/L		12/12/01	SW846 8260B
Chloromethane	< 0.62	0.62	2.0		ug/L		12/12/01	SW846 8260B
2-Chlorotoluene	< 0.48	0.48	1.5		ug/L		12/12/01	SW846 8260B
4-Chlorotoluene	< 0.72	0.72	2.3		ug/L		12/12/01	SW846 8260B
1,2-Dibromo-3-chloropropane	< 1.0	1.0	3.2		ug/L		12/12/01	SW846 8260B
1,2-Dibromoethane	< 0.91	0.91	2.9		ug/L		12/12/01	SW846 8260B
Dibromomethane	< 0.67	0.67	2.1		ug/L		12/12/01	SW846 8260B
1,3-Dichlorobenzene	< 0.54	0.54	1.7		ug/L		12/12/01	SW846 8260B
1,4-Dichlorobenzene	< 0.39	0.39	1.2		ug/L		12/12/01	SW846 8260B
1,2-Dichloroethane	< 0.47	0.47	1.5		ug/L		12/12/01	SW846 8260B
1,2-Dichlorobenzene	< 0.67	0.67	2.1		ug/L		12/12/01	SW846 8260B
1,1-Dichloroethene	< 0.85	0.85	2.7		ug/L		12/12/01	SW846 8260B
cis-1,2-Dichloroethene	< 0.73	0.73	2.3		ug/L		12/12/01	SW846 8260B
Dichlorodifluoromethane	< 0.68	0.68	2.2		ug/L		12/12/01	SW846 8260B
trans-1,2-Dichloroethene	< 0.79	0.79	2.5		ug/L		12/12/01	SW846 8260B
1,2-Dichloropropane	< 0.53	0.53	1.7		ug/L		12/12/01	SW846 8260B
1,1-Dichloroethane	< 0.48	0.48	1.5		ug/L		12/12/01	SW846 8260B
1,3-Dichloropropane	< 0.53	0.53	1.7		ug/L		12/12/01	SW846 8260B
2,2-Dichloropropane	< 0.95	0.95	3.0		ug/L		12/12/01	SW846 8260B

- Analytical Report -

Project Name : TECUMSEH-GRAFTON

Project Number : 1177

Client : MORAIN ENVIRONMENTAL INC

Field ID : MW-21 BR (1)

Report Date : 12/14/01

Lab Sample Number : 816107-010

Collection Date : 12/4/01

WI DNR LAB ID : 405132750

Matrix Type : WATER

1,1-Dichloropropene	< 0.85	0.85	2.7	ug/L	12/12/01	SW846 8260B
cis-1,3-Dichloropropene	< 0.56	0.56	1.8	ug/L	12/12/01	SW846 8260B
trans-1,3-Dichloropropene	< 0.51	0.51	1.6	ug/L	12/12/01	SW846 8260B
Diisopropyl ether	< 0.60	0.60	1.9	ug/L	12/12/01	SW846 8260B
Ethylbenzene	< 0.43	0.43	1.4	ug/L	12/12/01	SW846 8260B
Fluorotrichloromethane	< 0.52	0.52	1.7	ug/L	12/12/01	SW846 8260B
Hexachlorobutadiene	< 0.84	0.84	2.7	ug/L	12/12/01	SW846 8260B
Isopropylbenzene	< 0.43	0.43	1.4	ug/L	12/12/01	SW846 8260B
p-Isopropyltoluene	< 0.57	0.57	1.8	ug/L	12/12/01	SW846 8260B
Methylene chloride	< 0.85	0.85	2.7	ug/L	12/12/01	SW846 8260B
Methyl-tert-butyl-ether	< 0.67	0.67	2.1	ug/L	12/12/01	SW846 8260B
Naphthalene	< 0.59	0.59	1.9	ug/L	12/12/01	SW846 8260B
n-Propylbenzene	< 0.64	0.64	2.0	ug/L	12/12/01	SW846 8260B
Styrene	< 0.43	0.43	1.4	ug/L	12/12/01	SW846 8260B
1,1,2,2-Tetrachloroethane	< 0.91	0.91	2.9	ug/L	12/12/01	SW846 8260B
1,1,1,2-Tetrachloroethane	< 0.75	0.75	2.4	ug/L	12/12/01	SW846 8260B
Tetrachloroethene	< 0.57	0.57	1.8	ug/L	12/12/01	SW846 8260B
Toluene	< 0.47	0.47	1.5	ug/L	12/12/01	SW846 8260B
1,2,3-Trichlorobenzene	< 0.57	0.57	1.8	ug/L	12/12/01	SW846 8260B
1,2,4-Trichlorobenzene	< 0.60	0.60	1.9	ug/L	12/12/01	SW846 8260B
1,1,1-Trichloroethane	< 0.69	0.69	2.2	ug/L	12/12/01	SW846 8260B
1,1,2-Trichloroethane	< 0.72	0.72	2.3	ug/L	12/12/01	SW846 8260B
1,2,4-Trimethylbenzene	< 0.51	0.51	1.6	ug/L	12/12/01	SW846 8260B
Trichloroethene	< 0.89	0.89	2.8	ug/L	12/12/01	SW846 8260B
1,2,3-Trichloropropane	< 0.78	0.78	2.5	ug/L	12/12/01	SW846 8260B
1,3,5-Trimethylbenzene	< 0.52	0.52	1.7	ug/L	12/12/01	SW846 8260B
Vinyl chloride	< 0.18	0.18	0.57	ug/L	12/12/01	SW846 8260B
Xylenes, -m, -p	< 1.4	1.4	4.5	ug/L	12/12/01	SW846 8260B
Xylene, -o	< 0.54	0.54	1.7	ug/L	12/12/01	SW846 8260B
4-Bromofluorobenzene	87			%Recov	12/12/01	SW846 8260B
Dibromofluoromethane	93			%Recov	12/12/01	SW846 8260B
Toluene-d8	100			%Recov	12/12/01	SW846 8260B

- Analytical Report -

Project Name : TECUMSEH-GRAFTON
 Project Number : 1177
 Field ID : MW-21 BR (2)
 Lab Sample Number : 816107-011
 WI DNR LAB ID : 405132750

Client : MORAIN ENVIRONMENTAL INC
 Report Date : 12/14/01
 Collection Date : 12/4/01
 Matrix Type : WATER

Organic Results**EPA 8260 VOLATILE LIST- WATER**

Prep Method: SW846 5030B Prep Date: 12/10/01 Analyst: HW

Analyte	Result	LOD	LOQ	EQL	Units	Code	Analysis Date	Analysis Method
Benzene	< 0.48	0.48	1.5		ug/L		12/13/01	SW846 8260B
Bromobenzene	< 0.44	0.44	1.4		ug/L		12/13/01	SW846 8260B
Bromochloromethane	< 0.61	0.61	1.9		ug/L		12/13/01	SW846 8260B
Bromodichloromethane	< 0.61	0.61	1.9		ug/L		12/13/01	SW846 8260B
Bromoform	< 0.70	0.70	2.2		ug/L		12/13/01	SW846 8260B
Bromomethane	< 0.71	0.71	2.3		ug/L		12/13/01	SW846 8260B
s-Butylbenzene	< 0.49	0.49	1.6		ug/L		12/13/01	SW846 8260B
t-Butylbenzene	< 0.50	0.50	1.6		ug/L		12/13/01	SW846 8260B
n-Butylbenzene	< 0.61	0.61	1.9		ug/L		12/13/01	SW846 8260B
Carbon tetrachloride	< 0.73	0.73	2.3		ug/L		12/13/01	SW846 8260B
Chloroform	< 0.75	0.75	2.4		ug/L		12/13/01	SW846 8260B
Chlorobenzene	< 0.55	0.55	1.8		ug/L		12/13/01	SW846 8260B
Chlorodibromomethane	< 0.43	0.43	1.4		ug/L		12/13/01	SW846 8260B
Chloroethane	< 0.57	0.57	1.8		ug/L		12/13/01	SW846 8260B
Chloromethane	< 0.62	0.62	2.0		ug/L		12/13/01	SW846 8260B
2-Chlorotoluene	< 0.48	0.48	1.5		ug/L		12/13/01	SW846 8260B
4-Chlorotoluene	< 0.72	0.72	2.3		ug/L		12/13/01	SW846 8260B
1,2-Dibromo-3-chloropropane	< 1.0	1.0	3.2		ug/L		12/13/01	SW846 8260B
1,2-Dibromoethane	< 0.91	0.91	2.9		ug/L		12/13/01	SW846 8260B
Dibromomethane	< 0.67	0.67	2.1		ug/L		12/13/01	SW846 8260B
1,3-Dichlorobenzene	< 0.54	0.54	1.7		ug/L		12/13/01	SW846 8260B
1,4-Dichlorobenzene	< 0.39	0.39	1.2		ug/L		12/13/01	SW846 8260B
1,2-Dichloroethane	< 0.47	0.47	1.5		ug/L		12/13/01	SW846 8260B
1,2-Dichlorobenzene	< 0.67	0.67	2.1		ug/L		12/13/01	SW846 8260B
1,1-Dichloroethene	< 0.85	0.85	2.7		ug/L		12/13/01	SW846 8260B
cis-1,2-Dichloroethene	< 0.73	0.73	2.3		ug/L		12/13/01	SW846 8260B
Dichlorodifluoromethane	< 0.68	0.68	2.2		ug/L		12/13/01	SW846 8260B
trans-1,2-Dichloroethene	< 0.79	0.79	2.5		ug/L		12/13/01	SW846 8260B
1,2-Dichloropropane	< 0.53	0.53	1.7		ug/L		12/13/01	SW846 8260B
1,1-Dichloroethane	< 0.48	0.48	1.5		ug/L		12/13/01	SW846 8260B
1,3-Dichloropropane	< 0.53	0.53	1.7		ug/L		12/13/01	SW846 8260B
2,2-Dichloropropane	< 0.95	0.95	3.0		ug/L		12/13/01	SW846 8260B

- Analytical Report -

Project Name : TECUMSEH-GRAFTON
 Project Number : 1177
 Field ID : MW-21 BR (2)
 Lab Sample Number : 816107-011
 WI DNR LAB ID : 405132750

Client : MORAIN ENVIRONMENTAL INC
 Report Date : 12/14/01
 Collection Date : 12/4/01
 Matrix Type : WATER

1,1-Dichloropropene	< 0.85	0.85	2.7	ug/L	12/13/01	SW846 8260B
cis-1,3-Dichloropropene	< 0.56	0.56	1.8	ug/L	12/13/01	SW846 8260B
trans-1,3-Dichloropropene	< 0.51	0.51	1.6	ug/L	12/13/01	SW846 8260B
Diisopropyl ether	< 0.60	0.60	1.9	ug/L	12/13/01	SW846 8260B
Ethylbenzene	< 0.43	0.43	1.4	ug/L	12/13/01	SW846 8260B
Fluorotrichloromethane	< 0.52	0.52	1.7	ug/L	12/13/01	SW846 8260B
Hexachlorobutadiene	< 0.84	0.84	2.7	ug/L	12/13/01	SW846 8260B
Isopropylbenzene	< 0.43	0.43	1.4	ug/L	12/13/01	SW846 8260B
p-Isopropyltoluene	< 0.57	0.57	1.8	ug/L	12/13/01	SW846 8260B
Methylene chloride	< 0.85	0.85	2.7	ug/L	12/13/01	SW846 8260B
Methyl-tert-butyl-ether	< 0.67	0.67	2.1	ug/L	12/13/01	SW846 8260B
Naphthalene	< 0.59	0.59	1.9	ug/L	12/13/01	SW846 8260B
n-Propylbenzene	< 0.64	0.64	2.0	ug/L	12/13/01	SW846 8260B
Styrene	< 0.43	0.43	1.4	ug/L	12/13/01	SW846 8260B
1,1,2,2-Tetrachloroethane	< 0.91	0.91	2.9	ug/L	12/13/01	SW846 8260B
1,1,1,2-Tetrachloroethane	< 0.75	0.75	2.4	ug/L	12/13/01	SW846 8260B
Tetrachloroethene	< 0.57	0.57	1.8	ug/L	12/13/01	SW846 8260B
Toluene	< 0.47	0.47	1.5	ug/L	12/13/01	SW846 8260B
1,2,3-Trichlorobenzene	< 0.57	0.57	1.8	ug/L	12/13/01	SW846 8260B
1,2,4-Trichlorobenzene	< 0.60	0.60	1.9	ug/L	12/13/01	SW846 8260B
1,1,1-Trichloroethane	< 0.69	0.69	2.2	ug/L	12/13/01	SW846 8260B
1,1,2-Trichloroethane	< 0.72	0.72	2.3	ug/L	12/13/01	SW846 8260B
1,2,4-Trimethylbenzene	< 0.51	0.51	1.6	ug/L	12/13/01	SW846 8260B
Trichloroethene	< 0.89	0.89	2.8	ug/L	12/13/01	SW846 8260B
1,2,3-Trichloropropane	< 0.78	0.78	2.5	ug/L	12/13/01	SW846 8260B
1,3,5-Trimethylbenzene	< 0.52	0.52	1.7	ug/L	12/13/01	SW846 8260B
Vinyl chloride	< 0.18	0.18	0.57	ug/L	12/13/01	SW846 8260B
Xylenes, -m, -p	< 1.4	1.4	4.5	ug/L	12/13/01	SW846 8260B
Xylene, -o	< 0.54	0.54	1.7	ug/L	12/13/01	SW846 8260B
4-Bromofluorobenzene	111			%Recov	12/13/01	SW846 8260B
Dibromofluoromethane	110			%Recov	12/13/01	SW846 8260B
Toluene-d8	111			%Recov	12/13/01	SW846 8260B

- Analytical Report -

Project Name : TECUMSEH-GRAFTON
Project Number : 1177
Field ID : MW-22 BR
Lab Sample Number : 816107-012
WI DNR LAB ID : 405132750

Client : MORAIN ENVIRONMENTAL INC
Report Date : 12/14/01
Collection Date : 12/4/01
Matrix Type : WATER

Organic Results**EPA 8260 VOLATILE LIST- WATER**

Prep Method: SW846 5030B

Prep Date: 12/10/01

Analyst: HW

Analyte	Result	LOD	LOQ	EQL	Units	Code	Analysis Date	Analysis Method
Benzene	< 0.48	0.48	1.5		ug/L		12/13/01	SW846 8260B
Bromobenzene	< 0.44	0.44	1.4		ug/L		12/13/01	SW846 8260B
Bromochloromethane	< 0.61	0.61	1.9		ug/L		12/13/01	SW846 8260B
Bromodichloromethane	< 0.61	0.61	1.9		ug/L		12/13/01	SW846 8260B
Bromoform	< 0.70	0.70	2.2		ug/L		12/13/01	SW846 8260B
Bromomethane	< 0.71	0.71	2.3		ug/L		12/13/01	SW846 8260B
s-Butylbenzene	< 0.49	0.49	1.6		ug/L		12/13/01	SW846 8260B
t-Butylbenzene	< 0.50	0.50	1.6		ug/L		12/13/01	SW846 8260B
n-Butylbenzene	< 0.61	0.61	1.9		ug/L		12/13/01	SW846 8260B
Carbon tetrachloride	< 0.73	0.73	2.3		ug/L		12/13/01	SW846 8260B
Chloroform	< 0.75	0.75	2.4		ug/L		12/13/01	SW846 8260B
Chlorobenzene	< 0.55	0.55	1.8		ug/L		12/13/01	SW846 8260B
Chlorodibromomethane	< 0.43	0.43	1.4		ug/L		12/13/01	SW846 8260B
Chloroethane	< 0.57	0.57	1.8		ug/L		12/13/01	SW846 8260B
Chloromethane	< 0.62	0.62	2.0		ug/L		12/13/01	SW846 8260B
2-Chlorotoluene	< 0.48	0.48	1.5		ug/L		12/13/01	SW846 8260B
4-Chlorotoluene	< 0.72	0.72	2.3		ug/L		12/13/01	SW846 8260B
1,2-Dibromo-3-chloropropane	< 1.0	1.0	3.2		ug/L		12/13/01	SW846 8260B
1,2-Dibromoethane	< 0.91	0.91	2.9		ug/L		12/13/01	SW846 8260B
Dibromomethane	< 0.67	0.67	2.1		ug/L		12/13/01	SW846 8260B
1,3-Dichlorobenzene	< 0.54	0.54	1.7		ug/L		12/13/01	SW846 8260B
1,4-Dichlorobenzene	< 0.39	0.39	1.2		ug/L		12/13/01	SW846 8260B
1,2-Dichloroethane	< 0.47	0.47	1.5		ug/L		12/13/01	SW846 8260B
1,2-Dichlorobenzene	< 0.67	0.67	2.1		ug/L		12/13/01	SW846 8260B
1,1-Dichloroethene	< 0.85	0.85	2.7		ug/L		12/13/01	SW846 8260B
cis-1,2-Dichloroethene	8.2	0.73	2.3		ug/L		12/13/01	SW846 8260B
Dichlorodifluoromethane	< 0.68	0.68	2.2		ug/L		12/13/01	SW846 8260B
trans-1,2-Dichloroethene	< 0.79	0.79	2.5		ug/L		12/13/01	SW846 8260B
1,2-Dichloropropane	< 0.53	0.53	1.7		ug/L		12/13/01	SW846 8260B
1,1-Dichloroethane	1.2	0.48	1.5		ug/L	Q	12/13/01	SW846 8260B
1,3-Dichloropropane	< 0.53	0.53	1.7		ug/L		12/13/01	SW846 8260B
2,2-Dichloropropane	< 0.95	0.95	3.0		ug/L		12/13/01	SW846 8260B

- Analytical Report -

Project Name : TECUMSEH-GRAFTON

Project Number : 1177

Field ID : MW-22 BR

Lab Sample Number : 816107-012

WI DNR LAB ID : 405132750

Client : MORaine ENVIRONMENTAL INC

Report Date : 12/14/01

Collection Date : 12/4/01

Matrix Type : WATER

1,1-Dichloropropene	< 0.85	0.85	2.7	ug/L	12/13/01	SW846 8260B
cis-1,3-Dichloropropene	< 0.56	0.56	1.8	ug/L	12/13/01	SW846 8260B
trans-1,3-Dichloropropene	< 0.51	0.51	1.6	ug/L	12/13/01	SW846 8260B
Diisopropyl ether	< 0.60	0.60	1.9	ug/L	12/13/01	SW846 8260B
Ethylbenzene	< 0.43	0.43	1.4	ug/L	12/13/01	SW846 8260B
Fluorotrichloromethane	< 0.52	0.52	1.7	ug/L	12/13/01	SW846 8260B
Hexachlorobutadiene	< 0.84	0.84	2.7	ug/L	12/13/01	SW846 8260B
Isopropylbenzene	< 0.43	0.43	1.4	ug/L	12/13/01	SW846 8260B
p-Isopropyltoluene	< 0.57	0.57	1.8	ug/L	12/13/01	SW846 8260B
Methylene chloride	< 0.85	0.85	2.7	ug/L	12/13/01	SW846 8260B
Methyl-tert-butyl-ether	< 0.67	0.67	2.1	ug/L	12/13/01	SW846 8260B
Naphthalene	< 0.59	0.59	1.9	ug/L	12/13/01	SW846 8260B
n-Propylbenzene	< 0.64	0.64	2.0	ug/L	12/13/01	SW846 8260B
Styrene	< 0.43	0.43	1.4	ug/L	12/13/01	SW846 8260B
1,1,2,2-Tetrachloroethane	< 0.91	0.91	2.9	ug/L	12/13/01	SW846 8260B
1,1,1,2-Tetrachloroethane	< 0.75	0.75	2.4	ug/L	12/13/01	SW846 8260B
Tetrachloroethene	< 0.57	0.57	1.8	ug/L	12/13/01	SW846 8260B
Toluene	< 0.47	0.47	1.5	ug/L	12/13/01	SW846 8260B
1,2,3-Trichlorobenzene	< 0.57	0.57	1.8	ug/L	12/13/01	SW846 8260B
1,2,4-Trichlorobenzene	< 0.60	0.60	1.9	ug/L	12/13/01	SW846 8260B
1,1,1-Trichloroethane	< 0.69	0.69	2.2	ug/L	12/13/01	SW846 8260B
1,1,2-Trichloroethane	< 0.72	0.72	2.3	ug/L	12/13/01	SW846 8260B
1,2,4-Trimethylbenzene	< 0.51	0.51	1.6	ug/L	12/13/01	SW846 8260B
Trichloroethene	37	0.89	2.8	ug/L	12/13/01	SW846 8260B
1,2,3-Trichloropropane	< 0.78	0.78	2.5	ug/L	12/13/01	SW846 8260B
1,3,5-Trimethylbenzene	< 0.52	0.52	1.7	ug/L	12/13/01	SW846 8260B
Vinyl chloride	< 0.18	0.18	0.57	ug/L	12/13/01	SW846 8260B
Xylenes, -m, -p	< 1.4	1.4	4.5	ug/L	12/13/01	SW846 8260B
Xylene, -o	< 0.54	0.54	1.7	ug/L	12/13/01	SW846 8260B
4-Bromofluorobenzene	109			%Recov	12/13/01	SW846 8260B
Dibromofluoromethane	110			%Recov	12/13/01	SW846 8260B
Toluene-d8	108			%Recov	12/13/01	SW846 8260B

- Analytical Report -

Project Name : TECUMSEH-GRAFTON
 Project Number : 1177
 Field ID : RAESS RESIDENCE
 Lab Sample Number : 816107-013
 WI DNR LAB ID : 405132750

Client : MORAIN ENVIRONMENTAL INC
 Report Date : 12/14/01
 Collection Date : 12/4/01
 Matrix Type : WATER

Organic Results

EPA 8260 VOLATILE LIST- WATER

Prep Method: SW846 5030B Prep Date: 12/10/01 Analyst: HW

Analyte	Result	LOD	LOQ	EQL	Units	Code	Analysis Date	Analysis Method
Benzene	< 0.48	0.48	1.5		ug/L		12/13/01	SW846 8260B
Bromobenzene	< 0.44	0.44	1.4		ug/L		12/13/01	SW846 8260B
Bromochloromethane	< 0.61	0.61	1.9		ug/L		12/13/01	SW846 8260B
Bromodichloromethane	< 0.61	0.61	1.9		ug/L		12/13/01	SW846 8260B
Bromoform	< 0.70	0.70	2.2		ug/L		12/13/01	SW846 8260B
Bromomethane	< 0.71	0.71	2.3		ug/L		12/13/01	SW846 8260B
s-Butylbenzene	< 0.49	0.49	1.6		ug/L		12/13/01	SW846 8260B
t-Butylbenzene	< 0.50	0.50	1.6		ug/L		12/13/01	SW846 8260B
n-Butylbenzene	< 0.61	0.61	1.9		ug/L		12/13/01	SW846 8260B
Carbon tetrachloride	< 0.73	0.73	2.3		ug/L		12/13/01	SW846 8260B
Chloroform	< 0.75	0.75	2.4		ug/L		12/13/01	SW846 8260B
Chlorobenzene	< 0.55	0.55	1.8		ug/L		12/13/01	SW846 8260B
Chlorodibromomethane	< 0.43	0.43	1.4		ug/L		12/13/01	SW846 8260B
Chloroethane	< 0.57	0.57	1.8		ug/L		12/13/01	SW846 8260B
Chloromethane	< 0.62	0.62	2.0		ug/L		12/13/01	SW846 8260B
2-Chlorotoluene	< 0.48	0.48	1.5		ug/L		12/13/01	SW846 8260B
4-Chlorotoluene	< 0.72	0.72	2.3		ug/L		12/13/01	SW846 8260B
1,2-Dibromo-3-chloropropane	< 1.0	1.0	3.2		ug/L		12/13/01	SW846 8260B
1,2-Dibromoethane	< 0.91	0.91	2.9		ug/L		12/13/01	SW846 8260B
Dibromomethane	< 0.67	0.67	2.1		ug/L		12/13/01	SW846 8260B
1,3-Dichlorobenzene	< 0.54	0.54	1.7		ug/L		12/13/01	SW846 8260B
1,4-Dichlorobenzene	< 0.39	0.39	1.2		ug/L		12/13/01	SW846 8260B
1,2-Dichloroethane	< 0.47	0.47	1.5		ug/L		12/13/01	SW846 8260B
1,2-Dichlorobenzene	< 0.67	0.67	2.1		ug/L		12/13/01	SW846 8260B
1,1-Dichloroethene	< 0.85	0.85	2.7		ug/L		12/13/01	SW846 8260B
cis-1,2-Dichloroethene	< 0.73	0.73	2.3		ug/L		12/13/01	SW846 8260B
Dichlorodifluoromethane	< 0.68	0.68	2.2		ug/L		12/13/01	SW846 8260B
trans-1,2-Dichloroethene	< 0.79	0.79	2.5		ug/L		12/13/01	SW846 8260B
1,2-Dichloropropane	< 0.53	0.53	1.7		ug/L		12/13/01	SW846 8260B
1,1-Dichloroethane	0.97	0.48	1.5		ug/L	Q	12/13/01	SW846 8260B
1,3-Dichloropropane	< 0.53	0.53	1.7		ug/L		12/13/01	SW846 8260B
2,2-Dichloropropane	< 0.95	0.95	3.0		ug/L		12/13/01	SW846 8260B

- Analytical Report -

Project Name : TECUMSEH-GRAFTON

Project Number : 1177

Client : MORAIN ENVIRONMENTAL INC

Field ID : RAESS RESIDENCE

Report Date : 12/14/01

Lab Sample Number : 816107-013

Collection Date : 12/4/01

WI DNR LAB ID : 405132750

Matrix Type : WATER

1,1-Dichloropropene	< 0.85	0.85	2.7	ug/L	12/13/01	SW846 8260B
cis-1,3-Dichloropropene	< 0.56	0.56	1.8	ug/L	12/13/01	SW846 8260B
trans-1,3-Dichloropropene	< 0.51	0.51	1.6	ug/L	12/13/01	SW846 8260B
Diisopropyl ether	< 0.60	0.60	1.9	ug/L	12/13/01	SW846 8260B
Ethylbenzene	< 0.43	0.43	1.4	ug/L	12/13/01	SW846 8260B
Fluorotrichloromethane	< 0.52	0.52	1.7	ug/L	12/13/01	SW846 8260B
Hexachlorobutadiene	< 0.84	0.84	2.7	ug/L	12/13/01	SW846 8260B
Isopropylbenzene	< 0.43	0.43	1.4	ug/L	12/13/01	SW846 8260B
p-Isopropyltoluene	< 0.57	0.57	1.8	ug/L	12/13/01	SW846 8260B
Methylene chloride	< 0.85	0.85	2.7	ug/L	12/13/01	SW846 8260B
Methyl-tert-butyl-ether	< 0.67	0.67	2.1	ug/L	12/13/01	SW846 8260B
Naphthalene	< 0.59	0.59	1.9	ug/L	12/13/01	SW846 8260B
n-Propylbenzene	< 0.64	0.64	2.0	ug/L	12/13/01	SW846 8260B
Styrene	< 0.43	0.43	1.4	ug/L	12/13/01	SW846 8260B
1,1,2,2-Tetrachloroethane	< 0.91	0.91	2.9	ug/L	12/13/01	SW846 8260B
1,1,1,2-Tetrachloroethane	< 0.75	0.75	2.4	ug/L	12/13/01	SW846 8260B
Tetrachloroethene	< 0.57	0.57	1.8	ug/L	12/13/01	SW846 8260B
Toluene	< 0.47	0.47	1.5	ug/L	12/13/01	SW846 8260B
1,2,3-Trichlorobenzene	< 0.57	0.57	1.8	ug/L	12/13/01	SW846 8260B
1,2,4-Trichlorobenzene	< 0.60	0.60	1.9	ug/L	12/13/01	SW846 8260B
1,1,1-Trichloroethane	< 0.69	0.69	2.2	ug/L	12/13/01	SW846 8260B
1,1,2-Trichloroethane	< 0.72	0.72	2.3	ug/L	12/13/01	SW846 8260B
1,2,4-Trimethylbenzene	< 0.51	0.51	1.6	ug/L	12/13/01	SW846 8260B
Trichloroethene	< 0.89	0.89	2.8	ug/L	12/13/01	SW846 8260B
1,2,3-Trichloropropane	< 0.78	0.78	2.5	ug/L	12/13/01	SW846 8260B
1,3,5-Trimethylbenzene	< 0.52	0.52	1.7	ug/L	12/13/01	SW846 8260B
Vinyl chloride	< 0.18	0.18	0.57	ug/L	12/13/01	SW846 8260B
Xylenes, -m, -p	< 1.4	1.4	4.5	ug/L	12/13/01	SW846 8260B
Xylene, -o	< 0.54	0.54	1.7	ug/L	12/13/01	SW846 8260B
4-Bromofluorobenzene	111			%Recov	12/13/01	SW846 8260B
Dibromofluoromethane	108			%Recov	12/13/01	SW846 8260B
Toluene-d8	110			%Recov	12/13/01	SW846 8260B

- Analytical Report -

Project Name : TECUMSEH-GRAFTON
Project Number : 1177
Field ID : WENDTLAND RESIDENCE
Lab Sample Number : 816107-014
WI DNR LAB ID : 405132750

Client : MORAIN ENVIRONMENTAL INC
Report Date : 12/14/01
Collection Date : 12/4/01
Matrix Type : WATER

Organic Results**EPA 8260 VOLATILE LIST- WATER**

Prep Method: SW846 5030B Prep Date: 12/10/01 Analyst: HW

Analyte	Result	LOD	LOQ	EQL	Units	Code	Analysis Date	Analysis Method
Benzene	< 0.48	0.48	1.5		ug/L		12/13/01	SW846 8260B
Bromobenzene	< 0.44	0.44	1.4		ug/L		12/13/01	SW846 8260B
Bromochloromethane	< 0.61	0.61	1.9		ug/L		12/13/01	SW846 8260B
Bromodichloromethane	1.2	0.61	1.9		ug/L	Q	12/13/01	SW846 8260B
Bromoform	< 0.70	0.70	2.2		ug/L		12/13/01	SW846 8260B
Bromomethane	< 0.71	0.71	2.3		ug/L		12/13/01	SW846 8260B
s-Butylbenzene	< 0.49	0.49	1.6		ug/L		12/13/01	SW846 8260B
t-Butylbenzene	< 0.50	0.50	1.6		ug/L		12/13/01	SW846 8260B
n-Butylbenzene	< 0.61	0.61	1.9		ug/L		12/13/01	SW846 8260B
Carbon tetrachloride	< 0.73	0.73	2.3		ug/L		12/13/01	SW846 8260B
Chloroform	2.8	0.75	2.4		ug/L		12/13/01	SW846 8260B
Chlorobenzene	< 0.55	0.55	1.8		ug/L		12/13/01	SW846 8260B
Chlorodibromomethane	0.43	0.43	1.4		ug/L	Q	12/13/01	SW846 8260B
Chloroethane	< 0.57	0.57	1.8		ug/L		12/13/01	SW846 8260B
Chloromethane	< 0.62	0.62	2.0		ug/L		12/13/01	SW846 8260B
2-Chlorotoluene	< 0.48	0.48	1.5		ug/L		12/13/01	SW846 8260B
4-Chlorotoluene	< 0.72	0.72	2.3		ug/L		12/13/01	SW846 8260B
1,2-Dibromo-3-chloropropane	< 1.0	1.0	3.2		ug/L		12/13/01	SW846 8260B
1,2-Dibromoethane	< 0.91	0.91	2.9		ug/L		12/13/01	SW846 8260B
Dibromomethane	< 0.67	0.67	2.1		ug/L		12/13/01	SW846 8260B
1,3-Dichlorobenzene	< 0.54	0.54	1.7		ug/L		12/13/01	SW846 8260B
1,4-Dichlorobenzene	< 0.39	0.39	1.2		ug/L		12/13/01	SW846 8260B
1,2-Dichloroethane	< 0.47	0.47	1.5		ug/L		12/13/01	SW846 8260B
1,2-Dichlorobenzene	< 0.67	0.67	2.1		ug/L		12/13/01	SW846 8260B
1,1-Dichloroethene	< 0.85	0.85	2.7		ug/L		12/13/01	SW846 8260B
cis-1,2-Dichloroethene	< 0.73	0.73	2.3		ug/L		12/13/01	SW846 8260B
Dichlorodifluoromethane	< 0.68	0.68	2.2		ug/L		12/13/01	SW846 8260B
trans-1,2-Dichloroethene	< 0.79	0.79	2.5		ug/L		12/13/01	SW846 8260B
1,2-Dichloropropane	< 0.53	0.53	1.7		ug/L		12/13/01	SW846 8260B
1,1-Dichloroethane	< 0.48	0.48	1.5		ug/L		12/13/01	SW846 8260B
1,3-Dichloropropane	< 0.53	0.53	1.7		ug/L		12/13/01	SW846 8260B
2,2-Dichloropropane	< 0.95	0.95	3.0		ug/L		12/13/01	SW846 8260B

- Analytical Report -

Project Name : TECUMSEH-GRAFTON

Project Number : 1177

Client : MORaine ENVIRONMENTAL INC

Field ID : WENDTLAND RESIDENCE

Report Date : 12/14/01

Lab Sample Number : 816107-014

Collection Date : 12/4/01

WI DNR LAB ID : 405132750

Matrix Type : WATER

1,1-Dichloropropene	< 0.85	0.85	2.7	ug/L	12/13/01	SW846 8260B
cis-1,3-Dichloropropene	< 0.56	0.56	1.8	ug/L	12/13/01	SW846 8260B
trans-1,3-Dichloropropene	< 0.51	0.51	1.6	ug/L	12/13/01	SW846 8260B
Diisopropyl ether	< 0.60	0.60	1.9	ug/L	12/13/01	SW846 8260B
Ethylbenzene	< 0.43	0.43	1.4	ug/L	12/13/01	SW846 8260B
Fluorotrichloromethane	< 0.52	0.52	1.7	ug/L	12/13/01	SW846 8260B
Hexachlorobutadiene	< 0.84	0.84	2.7	ug/L	12/13/01	SW846 8260B
Isopropylbenzene	< 0.43	0.43	1.4	ug/L	12/13/01	SW846 8260B
p-Isopropyltoluene	< 0.57	0.57	1.8	ug/L	12/13/01	SW846 8260B
Methylene chloride	< 0.85	0.85	2.7	ug/L	12/13/01	SW846 8260B
Methyl-tert-butyl-ether	< 0.67	0.67	2.1	ug/L	12/13/01	SW846 8260B
Naphthalene	< 0.59	0.59	1.9	ug/L	12/13/01	SW846 8260B
n-Propylbenzene	< 0.64	0.64	2.0	ug/L	12/13/01	SW846 8260B
Styrene	< 0.43	0.43	1.4	ug/L	12/13/01	SW846 8260B
1,1,2,2-Tetrachloroethane	< 0.91	0.91	2.9	ug/L	12/13/01	SW846 8260B
1,1,1,2-Tetrachloroethane	< 0.75	0.75	2.4	ug/L	12/13/01	SW846 8260B
Tetrachloroethene	< 0.57	0.57	1.8	ug/L	12/13/01	SW846 8260B
Toluene	< 0.47	0.47	1.5	ug/L	12/13/01	SW846 8260B
1,2,3-Trichlorobenzene	< 0.57	0.57	1.8	ug/L	12/13/01	SW846 8260B
1,2,4-Trichlorobenzene	< 0.60	0.60	1.9	ug/L	12/13/01	SW846 8260B
1,1,1-Trichloroethane	< 0.69	0.69	2.2	ug/L	12/13/01	SW846 8260B
1,1,2-Trichloroethane	< 0.72	0.72	2.3	ug/L	12/13/01	SW846 8260B
1,2,4-Trimethylbenzene	< 0.51	0.51	1.6	ug/L	12/13/01	SW846 8260B
Trichloroethene	< 0.89	0.89	2.8	ug/L	12/13/01	SW846 8260B
1,2,3-Trichloropropane	< 0.78	0.78	2.5	ug/L	12/13/01	SW846 8260B
1,3,5-Trimethylbenzene	< 0.52	0.52	1.7	ug/L	12/13/01	SW846 8260B
Vinyl chloride	< 0.18	0.18	0.57	ug/L	12/13/01	SW846 8260B
Xylenes, -m, -p	< 1.4	1.4	4.5	ug/L	12/13/01	SW846 8260B
Xylene, -o	< 0.54	0.54	1.7	ug/L	12/13/01	SW846 8260B
4-Bromofluorobenzene	109			%Recov	12/13/01	SW846 8260B
Dibromofluoromethane	109			%Recov	12/13/01	SW846 8260B
Toluene-d8	109			%Recov	12/13/01	SW846 8260B

ATTACHMENT B

PREVIOUS ANALYTICAL SUMMARY TABLES

**TABLE 1
TECUMSEH PRODUCTS CO. - GRAFTON FACILITY
JUNE / JULY, 2001 GROUNDWATER LAB RESULTS (detected compounds only)**

Well Name	MW-3D	MW-9	MW-12	MW-13 BR (2)	MW-18 BR (1)	MW-18 BR (2)	MW-19 BR (1)	MW-20 BR (1)	MW-20 BR (2)	MW-21 BR (1)	MW-21 BR (2)	MW-22 BR	Raess Residence (PW-5)	Wendland Residence (PW-38)	NR140 ES	NR140 PAL
Collection Date	6/13/01	6/13/01	6/13/01	6/13/01	6/13/01	6/13/01	6/13/01	6/13/01	6/13/01	6/13/01	6/13/01	6/13/01	7/10/01	7/10/01		
1,1-Dichloroethene	<0.85	35	<2.1	98	1.5 Q	8.8	12	<0.85	<0.85	<0.85	<0.85	<0.85	<0.85	<0.85	7.0	0.7
cis-1,2-Dichloroethene	<0.27	670	1.8 Q	62	5.0	30	40	<0.27	<0.27	<0.27	<0.27	5.2	<0.73	<0.73	70	7.0
trans-1,2-Dichloroethane	<0.35	8.6 Q	<0.87	<1.7	<0.35	0.74 Q	0.76 Q	<0.35	<0.35	<0.35	<0.35	<0.35	<0.79	<0.79	100	20
1,1-Dichloroethane	7.5	79	1.6	360	9.7	50	82	<0.17	<0.17	<0.17	<0.17	1.5	<0.48	2.4	850	85
Methylene Chloride	<0.36	<3.6	<0.90	<1.8	0.41 Q	0.37 Q	<0.72	<0.36	0.42 Q	0.40 Q	0.42 Q	<0.36	<0.85	<0.85	5.0	0.5
Methyl-tert-butyl-ether	<0.20	<2.0	<0.50	<1.0	0.36 Q	<0.20	<0.40	<0.20	<0.20	<0.20	<0.20	<0.20	<0.67	<0.67	60	12
Toluene	<0.13	<1.3	<0.33	1.5 Q	<0.13	0.13 Q	<0.26	<0.13	0.20 Q	<0.13	<0.13	<0.13	<0.47	<0.47	1,000	200
1,1,1-Trichloroethane	<0.21	320	30	640	<0.21	30	<0.42	<0.21	<0.21	<0.21	<0.21	<0.21	<0.69	1.7 Q	200	40
Trichloroethene	<0.32	1,200	360	330	9.9	49	250	<0.32	<0.32	<0.32	<0.32	39	<0.89	2.7 Q	5.0	0.5
Vinyl Chloride	<0.19	<1.9	<0.47	<0.95	<0.19	<0.19	2.1	<0.19	<0.19	<0.19	<0.19	<0.19	<0.18	<0.18	0.2	0.02

Notes:

All Concentrations and Standards Expressed as Micrograms per Liter (ug/l) (parts per billion)
 NA - Not Analyzed ; Q - parameter detected below quantitative limit (qualified results)
 NSE - No Standard Established ; ND - No Detect ; NSC - No Sample Collected
 ES = NR140.10 Enforcement Standard
 PAL = NR140.10 Preventative Action Limit
 Highlighted and Bold results indicate concentrations exceeding WDNR NR140 ES
 Bold results indicate concentrations exceeding WDNR NR140 PAL

E:\WORD\MSWTEH1\1177GWtable7

**TECUMSEH MONITORING - GRAFTON FACILITY
GROUNDWATER LABORATORY RESULTS - DECEMBER, 2000
(Detected Compounds Only)**

Well Name	MW-3 BR		MW-3D		MW-9		MW-12		MW-13 BR (2)		MW-18 BR (1)		MW-18 BR (2)		MW-19 BR (1)		MW-19 BR (2)		MW-20 BR (1)		MW-20 BR (2)		MW-21 BR (1)		MW-21 BR (2)		MW-22 BR		Raess Residence PW-5		Wendland Residence PW-38		Hesler Residence PW-30		Enforcement Standards	Preventive Action Limits
	6-21-00	6-21-00	6-21-00	12-15-00	6-21-00	12-15-00	6-21-00	12-15-00	6-21-00	6-21-00	6-21-00	12-15-00	6-21-00	6-21-00	6-21-00	12-15-00	6-21-00	12-15-00	6-21-00	12-15-00	6-21-00	12-15-00	6-21-00	12-15-00	6-21-00	12-15-00	6-21-00	12-15-00	7-17-00	12-28-00	7-17-00	12-15-00	7-17-00	12-28-00		
Chloroform	<0.29	<0.29	<2.9	<2.9	<2.9	<2.9	<0.72	<1.4	<0.29	<0.29	<0.29	<0.58	<0.29	<0.29	<0.29	<0.29	<0.29	<0.29	<0.29	<0.29	<0.29	<0.29	<0.29	<0.29	<0.29	<0.29	<0.29	<0.29	<0.29	<0.29	<0.29	<0.29	1.2	<0.29	6.0	0.6
1,1-Dichloroethene	8.8	<0.85	74	<8.5	<8.5	<8.5	39	18	<0.85	7.8	5.1	2.1	<0.85	1.0	<0.85	<0.85	<0.85	<0.85	<0.85	<0.85	<0.85	<0.85	<0.85	<0.85	<0.85	<0.85	<0.85	<0.85	<0.85	<0.85	<0.85	<0.85	<0.85	<0.85	7.0	0.7
cis-1,2-Dichloroethene	21	<0.27	800	820	4.7	17	47	61	1.1	26	27	47	3.4	4.6	<0.27	<0.27	<0.27	<0.27	<0.27	<0.27	<0.27	<0.27	<0.27	<0.27	4.6	6.9	<0.27	<0.27	<0.27	<0.27	1.8	2.8	70	7.0		
trans-1,2-Dichloroethene	<0.35	<0.35	15	100	<3.5	<3.5	<0.87	5.6	<0.35	0.64	0.71	3.2	<0.35	<0.35	<0.35	<0.35	<0.35	<0.35	<0.35	<0.35	<0.35	<0.35	<0.35	<0.35	<0.35	<0.35	<0.35	<0.35	<0.35	<0.35	<0.35	<0.35	<0.35	<0.35	100	20
1,1-Dichloroethane	44	7.1	220	72	10	28	220	380	2.2	43	52	88	6.9	11	<0.17	<0.17	<0.17	<0.17	<0.17	<0.17	<0.17	<0.17	<0.17	<0.17	1.1	0.91	<0.17	0.65	2.5	2.7	1.6	2.6	850	85		
Toluene	<1.1	<1.1	<11	<11	<11	<11	<2.8	<5.5	<1.1	<1.1	<1.1	<2.2	<1.1	<1.1	<1.1	<1.1	<1.1	<1.1	2.7	<1.1	<1.1	<1.1	<1.1	<1.1	<1.1	<1.1	<1.1	<1.1	<0.13	<1.1	<1.1	<1.1	<0.13	1,000	200	
1,1,1-Trichloroethane	31	<0.21	660	800	61	130	380	730	<0.21	19	1.6	3.4	<0.21	<0.21	<0.21	<0.21	<0.21	<0.21	<0.21	<0.21	<0.21	<0.21	<0.21	<0.21	<0.21	<0.21	<0.21	<0.21	0.86	1.8	2.1	<0.21	1.3	200	40	
Trichloroethene	110	<0.32	1400	1900	820	1900	240	390	3.0	42	180	290	7.4	11	<0.32	<0.32	<0.32	<0.32	<0.32	<0.32	<0.32	<0.32	<0.32	<0.32	30	36	<0.32	0.48	1.9	2.7	2.4	3.8	5.0	0.5		
Vinyl Chloride	0.60	<0.19	<1.9	<1.9	<1.9	<1.9	<0.47	<0.95	<0.19	<0.19	0.94	<0.38	2.7	1.5	<0.19	<0.19	1.1	<0.19	<0.19	<0.19	<0.19	<0.19	<0.19	<0.19	0.48	<0.19	<0.19	<0.19	<0.19	<0.19	<0.19	<0.19	<0.19	<0.19	0.2	0.02

KEY: NA - Not Analyzed; NSF - No Standard Established; Bold - Exceeds PAE; Bold and Shaded - Exceeds ES; ES - Enforcement Standard; PAE - Preventive Action Limit; All results reported in ug/l (equivalent to parts per billion)

E:\w\win\ME11E011\117GW01.TBL