



Moraine Environmental, Inc.

Environmental Management Services

July 31, 2003

Mr. John Feeney, Hydrogeologist
Wisconsin Department of Natural Resources
P. O. Box 408
1155 Pilgrim Road
Plymouth, WI 53073

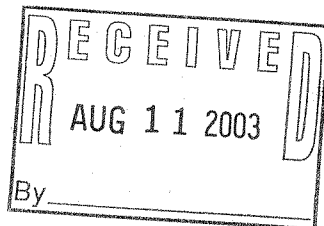

Proj. Ref. #1177
FID#246009170

RE: Biannual Groundwater Monitoring Results – July, 2002
Tecumseh Products Company Facility, Grafton Operation

Dear John:

Moraine Environmental, Inc. (MEI) has been retained by the Tecumseh Products Company to provide technical field assistance to monitor groundwater quality on a biannual basis at the Tecumseh Products Company Grafton Operation. Consulting and engineering services continue to be provided by RMT, Inc. of Madison, Wisconsin.

This letter report was prepared to summarize the July, 2002 sampling and analysis of eleven downgradient groundwater monitoring wells and two downgradient potable residential wells for Volatile Organic Compounds (VOCs). Both monitoring well MW-3D and MW-3BR, located on-site at the Tecumseh Products Company are damaged and will require repair or replacement, and were thus not sampled. Monitoring well MW-19 BR (2) was not sampled due to mechanical problems with the nitrogen activated bladder pump. The analytical results are summarized in tabular form and previous sample results are provided for comparison purposes.

Accordingly, the following summarization is presented:

Sample Collection Methodologies

Sample collection from monitoring wells was performed on July 9th, 2003. The following downgradient wells were purged and sampled for EPA Method 8260 VOCs analysis:

MW-9	MW-19 BR(1)	MW-22 BR
MW-12	MW-20 BR(1)	PW-5 (Raess)
MW-13 BR(2)	MW-20 BR(2)	PW-30 (Heiser)
MW-18 BR (1)	MW-21 BR(1)	
MW-18 BR (2)	MW-21 BR(2)	

The locations of these wells are illustrated on the enclosed figure.

Groundwater samples from monitoring wells MW-9, MW-12 and MW-22 BR were purged and sampled using new, disposable teflon bailers. Samples were transferred into 40 milliliter (ml) vials, placed into an ice-filled cooler, and transported to the laboratory (EnChem, Inc.) for analysis. The remaining monitoring wells were sampled through dedicated multi-level bladder pump systems (Solinist Waterloo) installed during well construction. VOC groundwater samples were collected, stored, transported, and analyzed for 8260 VOCs by EnChem, Inc. Laboratories in Green Bay, Wisconsin. The private wells (PW-5 and PW-30) were sampled by allowing the cold tap to run for a minimum of fifteen minutes to allow aquifer water to enter the system, then reducing the flow volume (removing the faucet aerators) and collecting and storing the samples.

Analytical Results

All groundwater samples were analyzed for EPA Method 8260 VOCs by EnChem, Inc. of Green Bay, Wisconsin. The analytical results are summarized on the enclosed analytical results table. The laboratory reports are enclosed as Attachment A. Tables summarizing previous analytical results are enclosed as Attachment B to allow for a comparison of recent analytical results with previously acquired groundwater quality data. A map depicting the groundwater monitoring well locations are enclosed as Attachment C. VOCs at concentrations exceeding Wisconsin Administrative Code Chapter NR 140 Groundwater Quality Enforcement Standards were detected in monitoring wells MW-9, MW-12, MW-13 BR (2), MW-18 BR (1), MW-18 BR (2), MW-19 BR(1), MW-22 BR and PW-30 (Heiser Property). The analytical results from the monitoring points were similar to previously acquired analytical results or slightly lower.

Biannual samples will again be collected in December, 2003. If you have any questions or concerns regarding this letter, the monitoring methodologies or results, please call our office at (262) 377-9060.

Sincerely,
MORAIN ENVIRONMENTAL, INC.

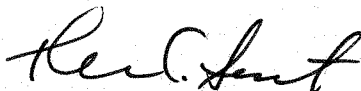

Thomas C. Sweet
President



Daniel L. Miracle
Project Hydrogeologist

cc: Bahart Shah, Tecumseh
Bernd Rehm, RMT

ATTACHMENT A
ANALYTICAL REPORTS

Per 9D?

**TABLE 1
TECUMSEH PRODUCTS CO. - GRAFTON FACILITY
JULY, 2003 GROUNDWATER LAB RESULTS**

Sample I.D.	Collection Date	Detected VOCs								
		Chloroethane	1,1-Dichloroethene	cis-1,2-Dichloroethene	trans-1,2-Dichloroethene	1,1-Dichloroethane	Methylene chloride	1,1,1-Trichloroethane	Trichloroethene	Vinyl Chloride
MW-9	7/9/03	<9.7	21.0	570.0	<8.9	61.0	<4.3	180.0	1,300.0	<1.8
MW-12	7/9/03	<9.7	<5.7	8.8 Q	<8.9	<7.5	<4.3	45.0	990.0	<1.8
MW-13BR(2)	7/9/03	<4.8	93.0	54.0	<4.4	440.0	<2.2	610.0	480.0	<0.9
MW-18BR(1)	7/9/03	<0.97	0.98 Q	4.8	<0.89	8.6 Q	<0.43	3.0	9.8	<0.18
MW-18BR(2)	7/9/03	<0.97	8.8	40.0	0.92 Q	75.0	<0.43	26.0	56.0	<0.18
MW-19BR(1)	7/9/03	<1.9	14.0	63.0	<1.8	110.0	<0.86	1.8 Q	320.0	3.20
MW-20BR(1)	7/9/03	<0.97	<0.57	<0.83	<0.89	<0.75	<0.43	<0.9	<0.48	<0.18
MW-20BR(2)	7/9/03	<0.97	<0.57	<0.83	<0.89	<0.75	<0.43	<0.9	<0.48	<0.18
MW-21BR(1)	7/9/03	<0.97	<0.57	<0.83	<0.89	<0.75	<0.43	<0.9	<0.48	<0.18
MW-21BR(2)	7/9/03	<0.97	<0.57	<0.83	<0.89	<0.75	<0.43	<0.9	<0.48	<0.18
MW-22BR	7/9/03	<0.97	<0.57	9.1	<0.89	0.93 Q	<0.43	<0.9	34.0	<0.18
PW-5 (RAESS)	7/9/03	<0.97	<0.57	<0.83	<0.89	0.93 Q	<0.43	0.98 Q	0.65 Q	<0.18
PW-30 (HEISER)	7/9/03	<0.97	<0.57	7.8	<0.89	4.8	<0.43	1.9 Q	9.6	<0.18
ESs (NR 140)		NSE	7.0	70.0	100.0	850.0	5.0	200.0	5.0	0.20
PALs (NR 140)		NSE	0.7	7.0	20.0	85.0	0.5	40.0	0.5	0.02

Notes:

All concentrations reported in ug/kg = micrograms per kilogram = parts per billion (ppb)

Q - parameter detected below quantitative limit (qualified results)

NSE - No Standard Established

Outlined and **Bold** results indicate concentrations exceeding WDNR Enforcement Standards (ESs), per NR 140

Italicized and **Bold** results indicate concentrations exceeding WDNR Preventative Action Limits (PALs), per NR 140



Corporate Office & Laboratory
1241 Bellevue Street, Suite 9, Green Bay, WI 54302
920-469-2436, 800-7-ENCHEM, Fax: 920-469-8827
www.enchem.com

Analytical Report Number: 836478

Client : MORaine ENVIRONMENTAL INC

Project Name : TECUMSEH GRAFTON

Project Number : 1177

Lab Sample Number	Field ID	Matrix	Collection Date
836478-001	MW-9	WATER	07/09/03
836478-002	MW-12	WATER	07/09/03
836478-003	MW-13 BR(2)	WATER	07/09/03
836478-004	MW-18 BR(1)	WATER	07/09/03
836478-005	MW-18 BR(2)	WATER	07/09/03
836478-006	MW-19 BR(1)	WATER	07/09/03
836478-007	MW-20 BR(1)	WATER	07/09/03
836478-008	MW-20 BR(2)	WATER	07/09/03
836478-009	MW-21 BR(1)	WATER	07/09/03
836478-010	MW-21 BR(2)	WATER	07/09/03
836478-011	MW-22 BR	WATER	07/09/03
836478-012	P-5 (RAESS)	WATER	07/09/03
836478-013	PW-30 (HEISER)	WATER	07/09/03

I certify that the data contained in this Final Report has been generated and reviewed in accordance with approved methods and Laboratory Standard Operating Procedure. Exceptions, if any, are discussed in the accompanying sample comments. Release of this final report is authorized by Laboratory management, as is verified by the following signature. Reported results shall not be reproduced, except in full, without the written approval of the lab. The sample results relate only to the analytes of interest tested.

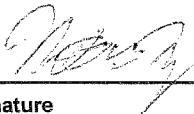
Approval Signature

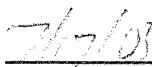
Date

Analytical Report Number: 836478

Client : MORAIN ENVIRONMENTAL INC

Matrix Type : WATER

Project Name : TECUMSEH GRAFTON

Collection Date : 07/09/03

Project Number : 1177

Report Date : 07/16/03

Field ID : MW-9

Lab Sample Number : 836478-001

VOLATILES

Prep Date: 07/15/03

Analyte	Result	LOD	LOQ	EQL	Dil.	Units	Code	Analysis Date	Prep Method	Analysis Method
1,1,1,2-Tetrachloroethane	< 9.2	9.2	29		10	ug/L		07/15/03	SW846 5030B	SW846 8260B
1,1,1-Trichloroethane	180	9.0	29		10	ug/L		07/15/03	SW846 5030B	SW846 8260B
1,1,2,2-Tetrachloroethane	< 2.0	2.0	6.4		10	ug/L		07/15/03	SW846 5030B	SW846 8260B
1,1,2-Trichloroethane	< 4.2	4.2	13		10	ug/L		07/15/03	SW846 5030B	SW846 8260B
1,1-Dichloroethane	61	7.5	24		10	ug/L		07/15/03	SW846 5030B	SW846 8260B
1,1-Dichloroethene	21	5.7	18		10	ug/L		07/15/03	SW846 5030B	SW846 8260B
1,1-Dichloropropene	< 7.5	7.5	24		10	ug/L		07/15/03	SW846 5030B	SW846 8260B
1,2,3-Trichlorobenzene	< 7.4	7.4	24		10	ug/L		07/15/03	SW846 5030B	SW846 8260B
1,2,3-Trichloropropane	< 9.9	9.9	32		10	ug/L		07/15/03	SW846 5030B	SW846 8260B
1,2,4-Trichlorobenzene	< 9.7	9.7	31		10	ug/L		07/15/03	SW846 5030B	SW846 8260B
1,2,4-Trimethylbenzene	< 9.7	9.7	31		10	ug/L		07/15/03	SW846 5030B	SW846 8260B
1,2-Dibromo-3-chloropropane	< 8.7	8.7	28		10	ug/L		07/15/03	SW846 5030B	SW846 8260B
1,2-Dibromoethane	< 5.6	5.6	18		10	ug/L		07/15/03	SW846 5030B	SW846 8260B
1,2-Dichlorobenzene	< 8.3	8.3	26		10	ug/L		07/15/03	SW846 5030B	SW846 8260B
1,2-Dichloroethane	< 3.6	3.6	11		10	ug/L		07/15/03	SW846 5030B	SW846 8260B
1,2-Dichloropropane	< 4.6	4.6	15		10	ug/L		07/15/03	SW846 5030B	SW846 8260B
1,3,5-Trimethylbenzene	< 8.3	8.3	26		10	ug/L		07/15/03	SW846 5030B	SW846 8260B
1,3-Dichlorobenzene	< 8.7	8.7	28		10	ug/L		07/15/03	SW846 5030B	SW846 8260B
1,3-Dichloropropane	< 6.1	6.1	19		10	ug/L		07/15/03	SW846 5030B	SW846 8260B
1,4-Dichlorobenzene	< 9.5	9.5	30		10	ug/L		07/15/03	SW846 5030B	SW846 8260B
2,2-Dichloropropane	< 6.2	6.2	20		10	ug/L		07/15/03	SW846 5030B	SW846 8260B
2-Chlorotoluene	< 8.5	8.5	27		10	ug/L		07/15/03	SW846 5030B	SW846 8260B
4-Chlorotoluene	< 7.4	7.4	24		10	ug/L		07/15/03	SW846 5030B	SW846 8260B
Benzene	< 4.1	4.1	13		10	ug/L		07/15/03	SW846 5030B	SW846 8260B
Bromobenzene	< 8.2	8.2	26		10	ug/L		07/15/03	SW846 5030B	SW846 8260B
Bromochloromethane	< 9.7	9.7	31		10	ug/L		07/15/03	SW846 5030B	SW846 8260B
Bromodichloromethane	< 5.6	5.6	18		10	ug/L		07/15/03	SW846 5030B	SW846 8260B
Bromoform	< 9.4	9.4	30		10	ug/L		07/15/03	SW846 5030B	SW846 8260B
Bromomethane	< 9.1	9.1	29		10	ug/L		07/15/03	SW846 5030B	SW846 8260B
Carbon Tetrachloride	< 4.9	4.9	16		10	ug/L		07/15/03	SW846 5030B	SW846 8260B
Chlorobenzene	< 4.1	4.1	13		10	ug/L		07/15/03	SW846 5030B	SW846 8260B
Chlorodibromomethane	< 8.1	8.1	26		10	ug/L		07/15/03	SW846 5030B	SW846 8260B
Chloroethane	< 9.7	9.7	31		10	ug/L		07/15/03	SW846 5030B	SW846 8260B
Chloroform	< 3.7	3.7	12		10	ug/L		07/15/03	SW846 5030B	SW846 8260B
Chloromethane	< 2.4	2.4	7.6		10	ug/L		07/15/03	SW846 5030B	SW846 8260B
cis-1,2-Dichloroethene	570	8.3	26		10	ug/L		07/15/03	SW846 5030B	SW846 8260B
cis-1,3-Dichloropropene	< 1.9	1.9	6.1		10	ug/L		07/15/03	SW846 5030B	SW846 8260B
Dibromomethane	< 6.0	6.0	19		10	ug/L		07/15/03	SW846 5030B	SW846 8260B
Dichlorodifluoromethane	< 9.9	9.9	32		10	ug/L		07/15/03	SW846 5030B	SW846 8260B
Diisopropyl Ether	< 7.6	7.6	24		10	ug/L		07/15/03	SW846 5030B	SW846 8260B
Ethylbenzene	< 5.4	5.4	17		10	ug/L		07/15/03	SW846 5030B	SW846 8260B
Fluorotrichloromethane	< 7.9	7.9	25		10	ug/L		07/15/03	SW846 5030B	SW846 8260B

Analytical Report Number: 836478

Client : MORAIN ENVIRONMENTAL INC

Matrix Type : WATER

Project Name : TECUMSEH GRAFTON

Collection Date : 07/09/03

Project Number : 1177

Report Date : 07/16/03

Field ID : MW-9

Lab Sample Number : 836478-001

VOLATILES

Prep Date: 07/15/03

Analyte	Result	LOD	LOQ	EQL	Dil.	Units	Code	Analysis Date	Prep Method	Analysis Method
Hexachlorobutadiene	< 6.7	6.7	21		10	ug/L		07/15/03	SW846 5030B	SW846 8260B
Isopropylbenzene	< 5.9	5.9	19		10	ug/L		07/15/03	SW846 5030B	SW846 8260B
Methylene Chloride	< 4.3	4.3	14		10	ug/L		07/15/03	SW846 5030B	SW846 8260B
Methyl-tert-butyl-ether	< 6.1	6.1	19		10	ug/L		07/15/03	SW846 5030B	SW846 8260B
Naphthalene	< 7.4	7.4	24		10	ug/L		07/15/03	SW846 5030B	SW846 8260B
n-Butylbenzene	< 9.3	9.3	30		10	ug/L		07/15/03	SW846 5030B	SW846 8260B
n-Propylbenzene	< 8.1	8.1	26		10	ug/L		07/15/03	SW846 5030B	SW846 8260B
p-Isopropyltoluene	< 6.7	6.7	21		10	ug/L		07/15/03	SW846 5030B	SW846 8260B
sec-Butylbenzene	< 8.9	8.9	28		10	ug/L		07/15/03	SW846 5030B	SW846 8260B
Styrene	< 8.6	8.6	27		10	ug/L		07/15/03	SW846 5030B	SW846 8260B
tert-Butylbenzene	< 9.7	9.7	31		10	ug/L		07/15/03	SW846 5030B	SW846 8260B
Tetrachloroethene	< 4.5	4.5	14		10	ug/L		07/15/03	SW846 5030B	SW846 8260B
Toluene	< 6.7	6.7	21		10	ug/L		07/15/03	SW846 5030B	SW846 8260B
trans-1,2-Dichloroethene	< 8.9	8.9	28		10	ug/L		07/15/03	SW846 5030B	SW846 8260B
trans-1,3-Dichloropropene	< 1.9	1.9	6.1		10	ug/L		07/15/03	SW846 5030B	SW846 8260B
Trichloroethene	1300	4.8	15		10	ug/L		07/15/03	SW846 5030B	SW846 8260B
Vinyl Chloride	< 1.8	1.8	5.7		10	ug/L		07/15/03	SW846 5030B	SW846 8260B
Xylene, o	< 8.3	8.3	26		10	ug/L		07/15/03	SW846 5030B	SW846 8260B
Xylenes, m + p	< 18	18	57		10	ug/L		07/15/03	SW846 5030B	SW846 8260B
4-Bromofluorobenzene	112				1	%Recov		07/15/03	SW846 5030B	SW846 8260B
Toluene-d8	116				1	%Recov		07/15/03	SW846 5030B	SW846 8260B
Dibromofluoromethane	123				1	%Recov		07/15/03	SW846 5030B	SW846 8260B

Analytical Report Number: 836478

Client : MORaine ENVIRONMENTAL INC

Matrix Type : WATER

Project Name : TECUMSEH GRAFTON

Collection Date : 07/09/03

Project Number : 1177

Report Date : 07/16/03

Field ID : MW-12

Lab Sample Number : 836478-002

VOLATILES

Prep Date: 07/15/03

Analyte	Result	LOD	LOQ	EQL	Dil.	Units	Code	Analysis Date	Prep Method	Analysis Method
1,1,1,2-Tetrachloroethane	< 9.2	9.2	29		10	ug/L		07/15/03	SW846 5030B	SW846 8260B
1,1,1-Trichloroethane	45	9.0	29		10	ug/L		07/15/03	SW846 5030B	SW846 8260B
1,1,2,2-Tetrachloroethane	< 2.0	2.0	6.4		10	ug/L		07/15/03	SW846 5030B	SW846 8260B
1,1,2-Trichloroethane	< 4.2	4.2	13		10	ug/L		07/15/03	SW846 5030B	SW846 8260B
1,1-Dichloroethane	< 7.5	7.5	24		10	ug/L		07/15/03	SW846 5030B	SW846 8260B
1,1-Dichloroethene	< 5.7	5.7	18		10	ug/L		07/15/03	SW846 5030B	SW846 8260B
1,1-Dichloropropene	< 7.5	7.5	24		10	ug/L		07/15/03	SW846 5030B	SW846 8260B
1,2,3-Trichlorobenzene	< 7.4	7.4	24		10	ug/L		07/15/03	SW846 5030B	SW846 8260B
1,2,3-Trichloropropane	< 9.9	9.9	32		10	ug/L		07/15/03	SW846 5030B	SW846 8260B
1,2,4-Trichlorobenzene	< 9.7	9.7	31		10	ug/L		07/15/03	SW846 5030B	SW846 8260B
1,2,4-Trimethylbenzene	< 9.7	9.7	31		10	ug/L		07/15/03	SW846 5030B	SW846 8260B
1,2-Dibromo-3-chloropropane	< 8.7	8.7	28		10	ug/L		07/15/03	SW846 5030B	SW846 8260B
1,2-Dibromoethane	< 5.6	5.6	18		10	ug/L		07/15/03	SW846 5030B	SW846 8260B
1,2-Dichlorobenzene	< 8.3	8.3	26		10	ug/L		07/15/03	SW846 5030B	SW846 8260B
1,2-Dichloroethane	< 3.6	3.6	11		10	ug/L		07/15/03	SW846 5030B	SW846 8260B
1,2-Dichloropropane	< 4.6	4.6	15		10	ug/L		07/15/03	SW846 5030B	SW846 8260B
1,3,5-Trimethylbenzene	< 8.3	8.3	26		10	ug/L		07/15/03	SW846 5030B	SW846 8260B
1,3-Dichlorobenzene	< 8.7	8.7	28		10	ug/L		07/15/03	SW846 5030B	SW846 8260B
1,3-Dichloropropane	< 6.1	6.1	19		10	ug/L		07/15/03	SW846 5030B	SW846 8260B
1,4-Dichlorobenzene	< 9.5	9.5	30		10	ug/L		07/15/03	SW846 5030B	SW846 8260B
2,2-Dichloropropane	< 6.2	6.2	20		10	ug/L		07/15/03	SW846 5030B	SW846 8260B
2-Chlorotoluene	< 8.5	8.5	27		10	ug/L		07/15/03	SW846 5030B	SW846 8260B
4-Chlorotoluene	< 7.4	7.4	24		10	ug/L		07/15/03	SW846 5030B	SW846 8260B
Benzene	< 4.1	4.1	13		10	ug/L		07/15/03	SW846 5030B	SW846 8260B
Bromobenzene	< 8.2	8.2	26		10	ug/L		07/15/03	SW846 5030B	SW846 8260B
Bromochloromethane	< 9.7	9.7	31		10	ug/L		07/15/03	SW846 5030B	SW846 8260B
Bromodichloromethane	< 5.6	5.6	18		10	ug/L		07/15/03	SW846 5030B	SW846 8260B
Bromoform	< 9.4	9.4	30		10	ug/L		07/15/03	SW846 5030B	SW846 8260B
Bromomethane	< 9.1	9.1	29		10	ug/L		07/15/03	SW846 5030B	SW846 8260B
Carbon Tetrachloride	< 4.9	4.9	16		10	ug/L		07/15/03	SW846 5030B	SW846 8260B
Chlorobenzene	< 4.1	4.1	13		10	ug/L		07/15/03	SW846 5030B	SW846 8260B
Chlorodibromomethane	< 8.1	8.1	26		10	ug/L		07/15/03	SW846 5030B	SW846 8260B
Chloroethane	< 9.7	9.7	31		10	ug/L		07/15/03	SW846 5030B	SW846 8260B
Chloroform	< 3.7	3.7	12		10	ug/L		07/15/03	SW846 5030B	SW846 8260B
Chloromethane	< 2.4	2.4	7.6		10	ug/L		07/15/03	SW846 5030B	SW846 8260B
cis-1,2-Dichloroethene	8.8	8.3	26		10	ug/L	Q	07/15/03	SW846 5030B	SW846 8260B
cis-1,3-Dichloropropene	< 1.9	1.9	6.1		10	ug/L		07/15/03	SW846 5030B	SW846 8260B
Dibromomethane	< 6.0	6.0	19		10	ug/L		07/15/03	SW846 5030B	SW846 8260B
Dichlorodifluoromethane	< 9.9	9.9	32		10	ug/L		07/15/03	SW846 5030B	SW846 8260B
Diisopropyl Ether	< 7.6	7.6	24		10	ug/L		07/15/03	SW846 5030B	SW846 8260B
Ethylbenzene	< 5.4	5.4	17		10	ug/L		07/15/03	SW846 5030B	SW846 8260B
Fluorotrchloromethane	< 7.9	7.9	25		10	ug/L		07/15/03	SW846 5030B	SW846 8260B

Analytical Report Number: 836478

Client : MORAIN ENVIRONMENTAL INC

Matrix Type : WATER

Project Name : TECUMSEH GRAFTON

Collection Date : 07/09/03

Project Number : 1177

Report Date : 07/16/03

Field ID : MW-12

Lab Sample Number : 836478-002

VOLATILES

Prep Date: 07/15/03

Analyte	Result	LOD	LOQ	EQL	Dil.	Units	Code	Analysis Date	Prep Method	Analysis Method
Hexachlorobutadiene	< 6.7	6.7	21		10	ug/L		07/15/03	SW846 5030B	SW846 8260B
Isopropylbenzene	< 5.9	5.9	19		10	ug/L		07/15/03	SW846 5030B	SW846 8260B
Methylene Chloride	< 4.3	4.3	14		10	ug/L		07/15/03	SW846 5030B	SW846 8260B
Methyl-tert-butyl-ether	< 6.1	6.1	19		10	ug/L		07/15/03	SW846 5030B	SW846 8260B
Naphthalene	< 7.4	7.4	24		10	ug/L		07/15/03	SW846 5030B	SW846 8260B
n-Butylbenzene	< 9.3	9.3	30		10	ug/L		07/15/03	SW846 5030B	SW846 8260B
n-Propylbenzene	< 8.1	8.1	26		10	ug/L		07/15/03	SW846 5030B	SW846 8260B
p-Isopropyltoluene	< 6.7	6.7	21		10	ug/L		07/15/03	SW846 5030B	SW846 8260B
sec-Butylbenzene	< 8.9	8.9	28		10	ug/L		07/15/03	SW846 5030B	SW846 8260B
Styrene	< 8.6	8.6	27		10	ug/L		07/15/03	SW846 5030B	SW846 8260B
tert-Butylbenzene	< 9.7	9.7	31		10	ug/L		07/15/03	SW846 5030B	SW846 8260B
Tetrachloroethene	< 4.5	4.5	14		10	ug/L		07/15/03	SW846 5030B	SW846 8260B
Toluene	< 6.7	6.7	21		10	ug/L		07/15/03	SW846 5030B	SW846 8260B
trans-1,2-Dichloroethene	< 8.9	8.9	28		10	ug/L		07/15/03	SW846 5030B	SW846 8260B
trans-1,3-Dichloropropene	< 1.9	1.9	6.1		10	ug/L		07/15/03	SW846 5030B	SW846 8260B
Trichloroethene	990	4.8	15		10	ug/L		07/15/03	SW846 5030B	SW846 8260B
Vinyl Chloride	< 1.8	1.8	5.7		10	ug/L		07/15/03	SW846 5030B	SW846 8260B
Xylene, o	< 8.3	8.3	26		10	ug/L		07/15/03	SW846 5030B	SW846 8260B
Xylenes, m + p	< 18	18	57		10	ug/L		07/15/03	SW846 5030B	SW846 8260B
4-Bromofluorobenzene	110				1	%Recov		07/15/03	SW846 5030B	SW846 8260B
Toluene-d8	116				1	%Recov		07/15/03	SW846 5030B	SW846 8260B
Dibromofluoromethane	119				1	%Recov		07/15/03	SW846 5030B	SW846 8260B

Analytical Report Number: 836478

Client : MORaine ENVIRONMENTAL INC

Matrix Type : WATER

Project Name : TECUMSEH GRAFTON

Collection Date : 07/09/03

Project Number : 1177

Report Date : 07/16/03

Field ID : MW-13 BR(2)

Lab Sample Number : 836478-003

VOLATILES

Prep Date: 07/15/03

Analyte	Result	LOD	LOQ	EQL	Dil.	Units	Code	Analysis Date	Prep Method	Analysis Method
1,1,1,2-Tetrachloroethane	< 4.6	4.6	15		5	ug/L		07/15/03	SW846 5030B	SW846 8260B
1,1,1-Trichloroethane	610	4.5	14		5	ug/L		07/15/03	SW846 5030B	SW846 8260B
1,1,2,2-Tetrachloroethane	< 1.0	1.0	3.2		5	ug/L		07/15/03	SW846 5030B	SW846 8260B
1,1,2-Trichloroethane	< 2.1	2.1	6.7		5	ug/L		07/15/03	SW846 5030B	SW846 8260B
1,1-Dichloroethane	440	3.8	12		5	ug/L		07/15/03	SW846 5030B	SW846 8260B
1,1-Dichloroethene	93	2.8	9.1		5	ug/L		07/15/03	SW846 5030B	SW846 8260B
1,1-Dichloropropene	< 3.8	3.8	12		5	ug/L		07/15/03	SW846 5030B	SW846 8260B
1,2,3-Trichlorobenzene	< 3.7	3.7	12		5	ug/L		07/15/03	SW846 5030B	SW846 8260B
1,2,3-Trichloropropane	< 5.0	5.0	16		5	ug/L		07/15/03	SW846 5030B	SW846 8260B
1,2,4-Trichlorobenzene	< 4.8	4.8	15		5	ug/L		07/15/03	SW846 5030B	SW846 8260B
1,2,4-Trimethylbenzene	< 4.8	4.8	15		5	ug/L		07/15/03	SW846 5030B	SW846 8260B
1,2-Dibromo-3-chloropropane	< 4.4	4.4	14		5	ug/L		07/15/03	SW846 5030B	SW846 8260B
1,2-Dibromoethane	< 2.8	2.8	8.9		5	ug/L		07/15/03	SW846 5030B	SW846 8260B
1,2-Dichlorobenzene	< 4.2	4.2	13		5	ug/L		07/15/03	SW846 5030B	SW846 8260B
1,2-Dichloroethane	< 1.8	1.8	5.7		5	ug/L		07/15/03	SW846 5030B	SW846 8260B
1,2-Dichloropropane	< 2.3	2.3	7.3		5	ug/L		07/15/03	SW846 5030B	SW846 8260B
1,3,5-Trimethylbenzene	< 4.2	4.2	13		5	ug/L		07/15/03	SW846 5030B	SW846 8260B
1,3-Dichlorobenzene	< 4.4	4.4	14		5	ug/L		07/15/03	SW846 5030B	SW846 8260B
1,3-Dichloropropane	< 3.0	3.0	9.7		5	ug/L		07/15/03	SW846 5030B	SW846 8260B
1,4-Dichlorobenzene	< 4.8	4.8	15		5	ug/L		07/15/03	SW846 5030B	SW846 8260B
2,2-Dichloropropane	< 3.1	3.1	9.9		5	ug/L		07/15/03	SW846 5030B	SW846 8260B
2-Chlorotoluene	< 4.2	4.2	14		5	ug/L		07/15/03	SW846 5030B	SW846 8260B
4-Chlorotoluene	< 3.7	3.7	12		5	ug/L		07/15/03	SW846 5030B	SW846 8260B
Benzene	< 2.0	2.0	6.5		5	ug/L		07/15/03	SW846 5030B	SW846 8260B
Bromobenzene	< 4.1	4.1	13		5	ug/L		07/15/03	SW846 5030B	SW846 8260B
Bromochloromethane	< 4.8	4.8	15		5	ug/L		07/15/03	SW846 5030B	SW846 8260B
Bromodichloromethane	< 2.8	2.8	8.9		5	ug/L		07/15/03	SW846 5030B	SW846 8260B
Bromoform	< 4.7	4.7	15		5	ug/L		07/15/03	SW846 5030B	SW846 8260B
Bromomethane	< 4.6	4.6	14		5	ug/L		07/15/03	SW846 5030B	SW846 8260B
Carbon Tetrachloride	< 2.4	2.4	7.8		5	ug/L		07/15/03	SW846 5030B	SW846 8260B
Chlorobenzene	< 2.0	2.0	6.5		5	ug/L		07/15/03	SW846 5030B	SW846 8260B
Chlorodibromomethane	< 4.0	4.0	13		5	ug/L		07/15/03	SW846 5030B	SW846 8260B
Chloroethane	< 4.8	4.8	15		5	ug/L		07/15/03	SW846 5030B	SW846 8260B
Chloroform	< 1.8	1.8	5.9		5	ug/L		07/15/03	SW846 5030B	SW846 8260B
Chloromethane	< 1.2	1.2	3.8		5	ug/L		07/15/03	SW846 5030B	SW846 8260B
cis-1,2-Dichloroethene	54	4.2	13		5	ug/L		07/15/03	SW846 5030B	SW846 8260B
cis-1,3-Dichloropropene	< 0.95	0.95	3.0		5	ug/L		07/15/03	SW846 5030B	SW846 8260B
Dibromomethane	< 3.0	3.0	9.6		5	ug/L		07/15/03	SW846 5030B	SW846 8260B
Dichlorodifluoromethane	< 5.0	5.0	16		5	ug/L		07/15/03	SW846 5030B	SW846 8260B
Diisopropyl Ether	< 3.8	3.8	12		5	ug/L		07/15/03	SW846 5030B	SW846 8260B
Ethylbenzene	< 2.7	2.7	8.6		5	ug/L		07/15/03	SW846 5030B	SW846 8260B
Fluorotrichloromethane	< 4.0	4.0	13		5	ug/L		07/15/03	SW846 5030B	SW846 8260B

Analytical Report Number: 836478

Client : MORAIN ENVIRONMENTAL INC

Matrix Type : WATER

Project Name : TECUMSEH GRAFTON

Collection Date : 07/09/03

Project Number : 1177

Report Date : 07/16/03

Field ID : MW-13 BR(2)

Lab Sample Number : 836478-003

VOLATILES

Prep Date: 07/15/03

Analyte	Result	LOD	LOQ	EQL	Dil.	Units	Code	Analysis Date	Prep Method	Analysis Method
Hexachlorobutadiene	< 3.4	3.4	11		5	ug/L		07/15/03	SW846 5030B	SW846 8260B
Isopropylbenzene	< 3.0	3.0	9.4		5	ug/L		07/15/03	SW846 5030B	SW846 8260B
Methylene Chloride	< 2.2	2.2	6.8		5	ug/L		07/15/03	SW846 5030B	SW846 8260B
Methyl-tert-butyl-ether	< 3.0	3.0	9.7		5	ug/L		07/15/03	SW846 5030B	SW846 8260B
Naphthalene	< 3.7	3.7	12		5	ug/L		07/15/03	SW846 5030B	SW846 8260B
n-Butylbenzene	< 4.6	4.6	15		5	ug/L		07/15/03	SW846 5030B	SW846 8260B
n-Propylbenzene	< 4.0	4.0	13		5	ug/L		07/15/03	SW846 5030B	SW846 8260B
p-Isopropyltoluene	< 3.4	3.4	11		5	ug/L		07/15/03	SW846 5030B	SW846 8260B
sec-Butylbenzene	< 4.4	4.4	14		5	ug/L		07/15/03	SW846 5030B	SW846 8260B
Styrene	< 4.3	4.3	14		5	ug/L		07/15/03	SW846 5030B	SW846 8260B
tert-Butylbenzene	< 4.8	4.8	15		5	ug/L		07/15/03	SW846 5030B	SW846 8260B
Tetrachloroethene	< 2.2	2.2	7.2		5	ug/L		07/15/03	SW846 5030B	SW846 8260B
Toluene	< 3.4	3.4	11		5	ug/L		07/15/03	SW846 5030B	SW846 8260B
trans-1,2-Dichloroethene	< 4.4	4.4	14		5	ug/L		07/15/03	SW846 5030B	SW846 8260B
trans-1,3-Dichloropropene	< 0.95	0.95	3.0		5	ug/L		07/15/03	SW846 5030B	SW846 8260B
Trichloroethene	480	2.4	7.6		5	ug/L		07/15/03	SW846 5030B	SW846 8260B
Vinyl Chloride	< 0.90	0.90	2.9		5	ug/L		07/15/03	SW846 5030B	SW846 8260B
Xylene, o	< 4.2	4.2	13		5	ug/L		07/15/03	SW846 5030B	SW846 8260B
Xylenes, m + p	< 9.0	9.0	29		5	ug/L		07/15/03	SW846 5030B	SW846 8260B
4-Bromofluorobenzene	112				1	%Recov		07/15/03	SW846 5030B	SW846 8260B
Toluene-d8	117				1	%Recov		07/15/03	SW846 5030B	SW846 8260B
Dibromofluoromethane	119				1	%Recov		07/15/03	SW846 5030B	SW846 8260B

Analytical Report Number: 836478

Client : MORAIN ENVIRONMENTAL INC

Matrix Type : WATER

Project Name : TECUMSEH GRAFTON

Collection Date : 07/09/03

Project Number : 1177

Report Date : 07/16/03

Field ID : MW-18 BR(1)

Lab Sample Number : 836478-004

VOLATILES

Prep Date: 07/15/03

Analyte	Result	LOD	LOQ	EQL	Dil.	Units	Code	Analysis Date	Prep Method	Analysis Method
1,1,1,2-Tetrachloroethane	< 0.92	0.92	2.9		1	ug/L		07/15/03	SW846 5030B	SW846 8260B
1,1,1-Trichloroethane	3.0	0.90	2.9		1	ug/L		07/15/03	SW846 5030B	SW846 8260B
1,1,2,2-Tetrachloroethane	< 0.20	0.20	0.64		1	ug/L		07/15/03	SW846 5030B	SW846 8260B
1,1,2-Trichloroethane	< 0.42	0.42	1.3		1	ug/L		07/15/03	SW846 5030B	SW846 8260B
1,1-Dichloroethane	8.6	0.75	2.4		1	ug/L		07/15/03	SW846 5030B	SW846 8260B
1,1-Dichloroethene	0.98	0.57	1.8		1	ug/L	Q	07/15/03	SW846 5030B	SW846 8260B
1,1-Dichloropropene	< 0.75	0.75	2.4		1	ug/L		07/15/03	SW846 5030B	SW846 8260B
1,2,3-Trichlorobenzene	< 0.74	0.74	2.4		1	ug/L		07/15/03	SW846 5030B	SW846 8260B
1,2,3-Trichloropropane	< 0.99	0.99	3.2		1	ug/L		07/15/03	SW846 5030B	SW846 8260B
1,2,4-Trichlorobenzene	< 0.97	0.97	3.1		1	ug/L		07/15/03	SW846 5030B	SW846 8260B
1,2,4-Trimethylbenzene	< 0.97	0.97	3.1		1	ug/L		07/15/03	SW846 5030B	SW846 8260B
1,2-Dibromo-3-chloropropane	< 0.87	0.87	2.8		1	ug/L		07/15/03	SW846 5030B	SW846 8260B
1,2-Dibromoethane	< 0.56	0.56	1.8		1	ug/L		07/15/03	SW846 5030B	SW846 8260B
1,2-Dichlorobenzene	< 0.83	0.83	2.6		1	ug/L		07/15/03	SW846 5030B	SW846 8260B
1,2-Dichloroethane	< 0.36	0.36	1.1		1	ug/L		07/15/03	SW846 5030B	SW846 8260B
1,2-Dichloropropane	< 0.46	0.46	1.5		1	ug/L		07/15/03	SW846 5030B	SW846 8260B
1,3,5-Trimethylbenzene	< 0.83	0.83	2.6		1	ug/L		07/15/03	SW846 5030B	SW846 8260B
1,3-Dichlorobenzene	< 0.87	0.87	2.8		1	ug/L		07/15/03	SW846 5030B	SW846 8260B
1,3-Dichloropropane	< 0.61	0.61	1.9		1	ug/L		07/15/03	SW846 5030B	SW846 8260B
1,4-Dichlorobenzene	< 0.95	0.95	3.0		1	ug/L		07/15/03	SW846 5030B	SW846 8260B
2,2-Dichloropropane	< 0.62	0.62	2.0		1	ug/L		07/15/03	SW846 5030B	SW846 8260B
2-Chlorotoluene	< 0.85	0.85	2.7		1	ug/L		07/15/03	SW846 5030B	SW846 8260B
4-Chlorotoluene	< 0.74	0.74	2.4		1	ug/L		07/15/03	SW846 5030B	SW846 8260B
Benzene	< 0.41	0.41	1.3		1	ug/L		07/15/03	SW846 5030B	SW846 8260B
Bromobenzene	< 0.82	0.82	2.6		1	ug/L		07/15/03	SW846 5030B	SW846 8260B
Bromochloromethane	< 0.97	0.97	3.1		1	ug/L		07/15/03	SW846 5030B	SW846 8260B
Bromodichloromethane	< 0.56	0.56	1.8		1	ug/L		07/15/03	SW846 5030B	SW846 8260B
Bromoform	< 0.94	0.94	3.0		1	ug/L		07/15/03	SW846 5030B	SW846 8260B
Bromomethane	< 0.91	0.91	2.9		1	ug/L		07/15/03	SW846 5030B	SW846 8260B
Carbon Tetrachloride	< 0.49	0.49	1.6		1	ug/L		07/15/03	SW846 5030B	SW846 8260B
Chlorobenzene	< 0.41	0.41	1.3		1	ug/L		07/15/03	SW846 5030B	SW846 8260B
Chlorodibromomethane	< 0.81	0.81	2.6		1	ug/L		07/15/03	SW846 5030B	SW846 8260B
Chloroethane	< 0.97	0.97	3.1		1	ug/L		07/15/03	SW846 5030B	SW846 8260B
Chloroform	< 0.37	0.37	1.2		1	ug/L		07/15/03	SW846 5030B	SW846 8260B
Chloromethane	< 0.24	0.24	0.76		1	ug/L		07/15/03	SW846 5030B	SW846 8260B
cis-1,2-Dichloroethene	4.8	0.83	2.6		1	ug/L		07/15/03	SW846 5030B	SW846 8260B
cis-1,3-Dichloropropene	< 0.19	0.19	0.61		1	ug/L		07/15/03	SW846 5030B	SW846 8260B
Dibromomethane	< 0.60	0.60	1.9		1	ug/L		07/15/03	SW846 5030B	SW846 8260B
Dichlorodifluoromethane	< 0.99	0.99	3.2		1	ug/L		07/15/03	SW846 5030B	SW846 8260B
Diisopropyl Ether	< 0.76	0.76	2.4		1	ug/L		07/15/03	SW846 5030B	SW846 8260B
Ethylbenzene	< 0.54	0.54	1.7		1	ug/L		07/15/03	SW846 5030B	SW846 8260B
Fluorotrichloromethane	< 0.79	0.79	2.5		1	ug/L		07/15/03	SW846 5030B	SW846 8260B

Analytical Report Number: 836478

Client : MORAIN ENVIRONMENTAL INC

Matrix Type : WATER

Project Name : TECUMSEH GRAFTON

Collection Date : 07/09/03

Project Number : 1177

Report Date : 07/16/03

Field ID : MW-18 BR(1)

Lab Sample Number : 836478-004

VOLATILES

Prep Date: 07/15/03

Analyte	Result	LOD	LOQ	EQL	Dil.	Units	Code	Analysis Date	Prep Method	Analysis Method
Hexachlorobutadiene	< 0.67	0.67	2.1		1	ug/L		07/15/03	SW846 5030B	SW846 8260B
Isopropylbenzene	< 0.59	0.59	1.9		1	ug/L		07/15/03	SW846 5030B	SW846 8260B
Methylene Chloride	< 0.43	0.43	1.4		1	ug/L		07/15/03	SW846 5030B	SW846 8260B
Methyl-tert-butyl-ether	< 0.61	0.61	1.9		1	ug/L		07/15/03	SW846 5030B	SW846 8260B
Naphthalene	< 0.74	0.74	2.4		1	ug/L		07/15/03	SW846 5030B	SW846 8260B
n-Butylbenzene	< 0.93	0.93	3.0		1	ug/L		07/15/03	SW846 5030B	SW846 8260B
n-Propylbenzene	< 0.81	0.81	2.6		1	ug/L		07/15/03	SW846 5030B	SW846 8260B
p-Isopropyltoluene	< 0.67	0.67	2.1		1	ug/L		07/15/03	SW846 5030B	SW846 8260B
sec-Butylbenzene	< 0.89	0.89	2.8		1	ug/L		07/15/03	SW846 5030B	SW846 8260B
Styrene	< 0.86	0.86	2.7		1	ug/L		07/15/03	SW846 5030B	SW846 8260B
tert-Butylbenzene	< 0.97	0.97	3.1		1	ug/L		07/15/03	SW846 5030B	SW846 8260B
Tetrachloroethene	< 0.45	0.45	1.4		1	ug/L		07/15/03	SW846 5030B	SW846 8260B
Toluene	< 0.67	0.67	2.1		1	ug/L		07/15/03	SW846 5030B	SW846 8260B
trans-1,2-Dichloroethene	< 0.89	0.89	2.8		1	ug/L		07/15/03	SW846 5030B	SW846 8260B
trans-1,3-Dichloropropene	< 0.19	0.19	0.61		1	ug/L		07/15/03	SW846 5030B	SW846 8260B
Trichloroethene	9.8	0.48	1.5		1	ug/L		07/15/03	SW846 5030B	SW846 8260B
Vinyl Chloride	< 0.18	0.18	0.57		1	ug/L		07/15/03	SW846 5030B	SW846 8260B
Xylene, o	< 0.83	0.83	2.6		1	ug/L		07/15/03	SW846 5030B	SW846 8260B
Xylenes, m + p	< 1.8	1.8	5.7		1	ug/L		07/15/03	SW846 5030B	SW846 8260B
4-Bromofluorobenzene	110				1	%Recov		07/15/03	SW846 5030B	SW846 8260B
Toluene-d8	117				1	%Recov		07/15/03	SW846 5030B	SW846 8260B
Dibromofluoromethane	118				1	%Recov		07/15/03	SW846 5030B	SW846 8260B

Analytical Report Number: 836478

Client : MORaine ENVIRONMENTAL INC

Matrix Type : WATER

Project Name : TECUMSEH GRAFTON

Collection Date : 07/09/03

Project Number : 1177

Report Date : 07/16/03

Field ID : MW-18 BR(2)

Lab Sample Number : 836478-005

VOLATILES

Prep Date: 07/14/03

Analyte	Result	LOD	LOQ	EQL	Dil.	Units	Code	Analysis Date	Prep Method	Analysis Method
1,1,1,2-Tetrachloroethane	< 0.92	0.92	2.9		1	ug/L		07/14/03	SW846 5030B	SW846 8260B
1,1,1-Trichloroethane	26	0.90	2.9		1	ug/L		07/14/03	SW846 5030B	SW846 8260B
1,1,2,2-Tetrachloroethane	< 0.20	0.20	0.64		1	ug/L		07/14/03	SW846 5030B	SW846 8260B
1,1,2-Trichloroethane	< 0.42	0.42	1.3		1	ug/L		07/14/03	SW846 5030B	SW846 8260B
1,1-Dichloroethane	75	0.75	2.4		1	ug/L		07/14/03	SW846 5030B	SW846 8260B
1,1-Dichloroethene	8.8	0.57	1.8		1	ug/L		07/14/03	SW846 5030B	SW846 8260B
1,1-Dichloropropene	< 0.75	0.75	2.4		1	ug/L		07/14/03	SW846 5030B	SW846 8260B
1,2,3-Trichlorobenzene	< 0.74	0.74	2.4		1	ug/L		07/14/03	SW846 5030B	SW846 8260B
1,2,3-Trichloropropane	< 0.99	0.99	3.2		1	ug/L		07/14/03	SW846 5030B	SW846 8260B
1,2,4-Trichlorobenzene	< 0.97	0.97	3.1		1	ug/L		07/14/03	SW846 5030B	SW846 8260B
1,2,4-Trimethylbenzene	< 0.97	0.97	3.1		1	ug/L		07/14/03	SW846 5030B	SW846 8260B
1,2-Dibromo-3-chloropropane	< 0.87	0.87	2.8		1	ug/L		07/14/03	SW846 5030B	SW846 8260B
1,2-Dibromoethane	< 0.56	0.56	1.8		1	ug/L		07/14/03	SW846 5030B	SW846 8260B
1,2-Dichlorobenzene	< 0.83	0.83	2.6		1	ug/L		07/14/03	SW846 5030B	SW846 8260B
1,2-Dichloroethane	< 0.36	0.36	1.1		1	ug/L		07/14/03	SW846 5030B	SW846 8260B
1,2-Dichloropropane	< 0.46	0.46	1.5		1	ug/L		07/14/03	SW846 5030B	SW846 8260B
1,3,5-Trimethylbenzene	< 0.83	0.83	2.6		1	ug/L		07/14/03	SW846 5030B	SW846 8260B
1,3-Dichlorobenzene	< 0.87	0.87	2.8		1	ug/L		07/14/03	SW846 5030B	SW846 8260B
1,3-Dichloropropane	< 0.61	0.61	1.9		1	ug/L		07/14/03	SW846 5030B	SW846 8260B
1,4-Dichlorobenzene	< 0.95	0.95	3.0		1	ug/L		07/14/03	SW846 5030B	SW846 8260B
2,2-Dichloropropane	< 0.62	0.62	2.0		1	ug/L		07/14/03	SW846 5030B	SW846 8260B
2-Chlorotoluene	< 0.85	0.85	2.7		1	ug/L		07/14/03	SW846 5030B	SW846 8260B
4-Chlorotoluene	< 0.74	0.74	2.4		1	ug/L		07/14/03	SW846 5030B	SW846 8260B
Benzene	< 0.41	0.41	1.3		1	ug/L		07/14/03	SW846 5030B	SW846 8260B
Bromobenzene	< 0.82	0.82	2.6		1	ug/L		07/14/03	SW846 5030B	SW846 8260B
Bromochloromethane	< 0.97	0.97	3.1		1	ug/L		07/14/03	SW846 5030B	SW846 8260B
Bromodichloromethane	< 0.56	0.56	1.8		1	ug/L		07/14/03	SW846 5030B	SW846 8260B
Bromoform	< 0.94	0.94	3.0		1	ug/L		07/14/03	SW846 5030B	SW846 8260B
Bromomethane	< 0.91	0.91	2.9		1	ug/L		07/14/03	SW846 5030B	SW846 8260B
Carbon Tetrachloride	< 0.49	0.49	1.6		1	ug/L		07/14/03	SW846 5030B	SW846 8260B
Chlorobenzene	< 0.41	0.41	1.3		1	ug/L		07/14/03	SW846 5030B	SW846 8260B
Chlorodibromomethane	< 0.81	0.81	2.6		1	ug/L		07/14/03	SW846 5030B	SW846 8260B
Chloroethane	< 0.97	0.97	3.1		1	ug/L		07/14/03	SW846 5030B	SW846 8260B
Chloroform	< 0.37	0.37	1.2		1	ug/L		07/14/03	SW846 5030B	SW846 8260B
Chloromethane	< 0.24	0.24	0.76		1	ug/L		07/14/03	SW846 5030B	SW846 8260B
cis-1,2-Dichloroethene	40	0.83	2.6		1	ug/L		07/14/03	SW846 5030B	SW846 8260B
cis-1,3-Dichloropropene	< 0.19	0.19	0.61		1	ug/L		07/14/03	SW846 5030B	SW846 8260B
Dibromomethane	< 0.60	0.60	1.9		1	ug/L		07/14/03	SW846 5030B	SW846 8260B
Dichlorodifluoromethane	< 0.99	0.99	3.2		1	ug/L		07/14/03	SW846 5030B	SW846 8260B
Diisopropyl Ether	< 0.76	0.76	2.4		1	ug/L		07/14/03	SW846 5030B	SW846 8260B
Ethylbenzene	< 0.54	0.54	1.7		1	ug/L		07/14/03	SW846 5030B	SW846 8260B
Fluorotrchloromethane	< 0.79	0.79	2.5		1	ug/L		07/14/03	SW846 5030B	SW846 8260B

Analytical Report Number: 836478

Client : MORAIN ENVIRONMENTAL INC

Matrix Type : WATER

Project Name : TECUMSEH GRAFTON

Collection Date : 07/09/03

Project Number : 1177

Report Date : 07/16/03

Field ID : MW-18 BR(2)

Lab Sample Number : 836478-005

VOLATILES

Prep Date: 07/14/03

Analyte	Result	LOD	LOQ	EQL	Dil.	Units	Code	Analysis Date	Prep Method	Analysis Method
Hexachlorobutadiene	< 0.67	0.67	2.1		1	ug/L		07/14/03	SW846 5030B	SW846 8260B
Isopropylbenzene	< 0.59	0.59	1.9		1	ug/L		07/14/03	SW846 5030B	SW846 8260B
Methylene Chloride	< 0.43	0.43	1.4		1	ug/L		07/14/03	SW846 5030B	SW846 8260B
Methyl-tert-butyl-ether	< 0.61	0.61	1.9		1	ug/L		07/14/03	SW846 5030B	SW846 8260B
Naphthalene	< 0.74	0.74	2.4		1	ug/L		07/14/03	SW846 5030B	SW846 8260B
n-Butylbenzene	< 0.93	0.93	3.0		1	ug/L		07/14/03	SW846 5030B	SW846 8260B
n-Propylbenzene	< 0.81	0.81	2.6		1	ug/L		07/14/03	SW846 5030B	SW846 8260B
p-Isopropyltoluene	< 0.67	0.67	2.1		1	ug/L		07/14/03	SW846 5030B	SW846 8260B
sec-Butylbenzene	< 0.89	0.89	2.8		1	ug/L		07/14/03	SW846 5030B	SW846 8260B
Styrene	< 0.86	0.86	2.7		1	ug/L		07/14/03	SW846 5030B	SW846 8260B
tert-Butylbenzene	< 0.97	0.97	3.1		1	ug/L		07/14/03	SW846 5030B	SW846 8260B
Tetrachloroethene	< 0.45	0.45	1.4		1	ug/L		07/14/03	SW846 5030B	SW846 8260B
Toluene	< 0.67	0.67	2.1		1	ug/L		07/14/03	SW846 5030B	SW846 8260B
trans-1,2-Dichloroethene	0.92	0.89	2.8		1	ug/L	Q	07/14/03	SW846 5030B	SW846 8260B
trans-1,3-Dichloropropene	< 0.19	0.19	0.61		1	ug/L		07/14/03	SW846 5030B	SW846 8260B
Trichloroethene	56	0.48	1.5		1	ug/L		07/14/03	SW846 5030B	SW846 8260B
Vinyl Chloride	< 0.18	0.18	0.57		1	ug/L		07/14/03	SW846 5030B	SW846 8260B
Xylene, o	< 0.83	0.83	2.6		1	ug/L		07/14/03	SW846 5030B	SW846 8260B
Xylenes, m + p	< 1.8	1.8	5.7		1	ug/L		07/14/03	SW846 5030B	SW846 8260B
4-Bromofluorobenzene	111				1	%Recov		07/14/03	SW846 5030B	SW846 8260B
Toluene-d8	118				1	%Recov		07/14/03	SW846 5030B	SW846 8260B
Dibromofluoromethane	118				1	%Recov		07/14/03	SW846 5030B	SW846 8260B

Analytical Report Number: 836478

Client : MORAIN ENVIRONMENTAL INC

Matrix Type : WATER

Project Name : TECUMSEH GRAFTON

Collection Date : 07/09/03

Project Number : 1177

Report Date : 07/16/03

Field ID : MW-19 BR(1)

Lab Sample Number : 836478-006

VOLATILES

Prep Date: 07/15/03

Analyte	Result	LOD	LOQ	EQL	Dil.	Units	Code	Analysis Date	Prep Method	Analysis Method
1,1,1,2-Tetrachloroethane	< 1.8	1.8	5.9		2	ug/L		07/15/03	SW846 5030B	SW846 8260B
1,1,1-Trichloroethane	1.8	1.8	5.7		2	ug/L	Q	07/15/03	SW846 5030B	SW846 8260B
1,1,2,2-Tetrachloroethane	< 0.40	0.40	1.3		2	ug/L		07/15/03	SW846 5030B	SW846 8260B
1,1,2-Trichloroethane	< 0.84	0.84	2.7		2	ug/L		07/15/03	SW846 5030B	SW846 8260B
1,1-Dichloroethane	110	1.5	4.8		2	ug/L		07/15/03	SW846 5030B	SW846 8260B
1,1-Dichloroethene	14	1.1	3.6		2	ug/L		07/15/03	SW846 5030B	SW846 8260B
1,1-Dichloropropene	< 1.5	1.5	4.8		2	ug/L		07/15/03	SW846 5030B	SW846 8260B
1,2,3-Trichlorobenzene	< 1.5	1.5	4.7		2	ug/L		07/15/03	SW846 5030B	SW846 8260B
1,2,3-Trichloropropane	< 2.0	2.0	6.3		2	ug/L		07/15/03	SW846 5030B	SW846 8260B
1,2,4-Trichlorobenzene	< 1.9	1.9	6.2		2	ug/L		07/15/03	SW846 5030B	SW846 8260B
1,2,4-Trimethylbenzene	< 1.9	1.9	6.2		2	ug/L		07/15/03	SW846 5030B	SW846 8260B
1,2-Dibromo-3-chloropropane	< 1.7	1.7	5.5		2	ug/L		07/15/03	SW846 5030B	SW846 8260B
1,2-Dibromoethane	< 1.1	1.1	3.6		2	ug/L		07/15/03	SW846 5030B	SW846 8260B
1,2-Dichlorobenzene	< 1.7	1.7	5.3		2	ug/L		07/15/03	SW846 5030B	SW846 8260B
1,2-Dichloroethane	< 0.72	0.72	2.3		2	ug/L		07/15/03	SW846 5030B	SW846 8260B
1,2-Dichloropropane	< 0.92	0.92	2.9		2	ug/L		07/15/03	SW846 5030B	SW846 8260B
1,3,5-Trimethylbenzene	< 1.7	1.7	5.3		2	ug/L		07/15/03	SW846 5030B	SW846 8260B
1,3-Dichlorobenzene	< 1.7	1.7	5.5		2	ug/L		07/15/03	SW846 5030B	SW846 8260B
1,3-Dichloropropane	< 1.2	1.2	3.9		2	ug/L		07/15/03	SW846 5030B	SW846 8260B
1,4-Dichlorobenzene	< 1.9	1.9	6.1		2	ug/L		07/15/03	SW846 5030B	SW846 8260B
2,2-Dichloropropane	< 1.2	1.2	3.9		2	ug/L		07/15/03	SW846 5030B	SW846 8260B
2-Chlorotoluene	< 1.7	1.7	5.4		2	ug/L		07/15/03	SW846 5030B	SW846 8260B
4-Chlorotoluene	< 1.5	1.5	4.7		2	ug/L		07/15/03	SW846 5030B	SW846 8260B
Benzene	< 0.82	0.82	2.6		2	ug/L		07/15/03	SW846 5030B	SW846 8260B
Bromobenzene	< 1.6	1.6	5.2		2	ug/L		07/15/03	SW846 5030B	SW846 8260B
Bromochloromethane	< 1.9	1.9	6.2		2	ug/L		07/15/03	SW846 5030B	SW846 8260B
Bromodichloromethane	< 1.1	1.1	3.6		2	ug/L		07/15/03	SW846 5030B	SW846 8260B
Bromoform	< 1.9	1.9	6.0		2	ug/L		07/15/03	SW846 5030B	SW846 8260B
Bromomethane	< 1.8	1.8	5.8		2	ug/L		07/15/03	SW846 5030B	SW846 8260B
Carbon Tetrachloride	< 0.98	0.98	3.1		2	ug/L		07/15/03	SW846 5030B	SW846 8260B
Chlorobenzene	< 0.82	0.82	2.6		2	ug/L		07/15/03	SW846 5030B	SW846 8260B
Chlorodibromomethane	< 1.6	1.6	5.2		2	ug/L		07/15/03	SW846 5030B	SW846 8260B
Chloroethane	< 1.9	1.9	6.2		2	ug/L		07/15/03	SW846 5030B	SW846 8260B
Chloroform	< 0.74	0.74	2.4		2	ug/L		07/15/03	SW846 5030B	SW846 8260B
Chloromethane	< 0.48	0.48	1.5		2	ug/L		07/15/03	SW846 5030B	SW846 8260B
cis-1,2-Dichloroethene	63	1.7	5.3		2	ug/L		07/15/03	SW846 5030B	SW846 8260B
cis-1,3-Dichloropropene	< 0.38	0.38	1.2		2	ug/L		07/15/03	SW846 5030B	SW846 8260B
Dibromomethane	< 1.2	1.2	3.8		2	ug/L		07/15/03	SW846 5030B	SW846 8260B
Dichlorodifluoromethane	< 2.0	2.0	6.3		2	ug/L		07/15/03	SW846 5030B	SW846 8260B
Diisopropyl Ether	< 1.5	1.5	4.8		2	ug/L		07/15/03	SW846 5030B	SW846 8260B
Ethylbenzene	< 1.1	1.1	3.4		2	ug/L		07/15/03	SW846 5030B	SW846 8260B
Fluorotrchloromethane	< 1.6	1.6	5.0		2	ug/L		07/15/03	SW846 5030B	SW846 8260B

Analytical Report Number: 836478

Client : MORAIN ENVIRONMENTAL INC
 Project Name : TECUMSEH GRAFTON
 Project Number : 1177
 Field ID : MW-19 BR(1)

Matrix Type : WATER
 Collection Date : 07/09/03
 Report Date : 07/16/03
 Lab Sample Number : 836478-006

VOLATILES

Prep Date: 07/15/03

Analyte	Result	LOD	LOQ	EQL	Dil.	Units	Code	Analysis Date	Prep Method	Analysis Method
Hexachlorobutadiene	< 1.3	1.3	4.3		2	ug/L		07/15/03	SW846 5030B	SW846 8260B
Isopropylbenzene	< 1.2	1.2	3.8		2	ug/L		07/15/03	SW846 5030B	SW846 8260B
Methylene Chloride	< 0.86	0.86	2.7		2	ug/L		07/15/03	SW846 5030B	SW846 8260B
Methyl-tert-butyl-ether	< 1.2	1.2	3.9		2	ug/L		07/15/03	SW846 5030B	SW846 8260B
Naphthalene	< 1.5	1.5	4.7		2	ug/L		07/15/03	SW846 5030B	SW846 8260B
n-Butylbenzene	< 1.9	1.9	5.9		2	ug/L		07/15/03	SW846 5030B	SW846 8260B
n-Propylbenzene	< 1.6	1.6	5.2		2	ug/L		07/15/03	SW846 5030B	SW846 8260B
p-Isopropyltoluene	< 1.3	1.3	4.3		2	ug/L		07/15/03	SW846 5030B	SW846 8260B
sec-Butylbenzene	< 1.8	1.8	5.7		2	ug/L		07/15/03	SW846 5030B	SW846 8260B
Styrene	< 1.7	1.7	5.5		2	ug/L		07/15/03	SW846 5030B	SW846 8260B
tert-Butylbenzene	< 1.9	1.9	6.2		2	ug/L		07/15/03	SW846 5030B	SW846 8260B
Tetrachloroethene	< 0.90	0.90	2.9		2	ug/L		07/15/03	SW846 5030B	SW846 8260B
Toluene	< 1.3	1.3	4.3		2	ug/L		07/15/03	SW846 5030B	SW846 8260B
trans-1,2-Dichloroethene	< 1.8	1.8	5.7		2	ug/L		07/15/03	SW846 5030B	SW846 8260B
trans-1,3-Dichloropropene	< 0.38	0.38	1.2		2	ug/L		07/15/03	SW846 5030B	SW846 8260B
Trichloroethene	320	0.96	3.1		2	ug/L		07/15/03	SW846 5030B	SW846 8260B
Vinyl Chloride	3.2	0.36	1.1		2	ug/L		07/15/03	SW846 5030B	SW846 8260B
Xylene, o	< 1.7	1.7	5.3		2	ug/L		07/15/03	SW846 5030B	SW846 8260B
Xylenes, m + p	< 3.6	3.6	11		2	ug/L		07/15/03	SW846 5030B	SW846 8260B
4-Bromofluorobenzene	111				1	%Recov		07/15/03	SW846 5030B	SW846 8260B
Toluene-d8	118				1	%Recov		07/15/03	SW846 5030B	SW846 8260B
Dibromofluoromethane	119				1	%Recov		07/15/03	SW846 5030B	SW846 8260B

Analytical Report Number: 836478

Client : MORAIN ENVIRONMENTAL INC

Matrix Type : WATER

Project Name : TECUMSEH GRAFTON

Collection Date : 07/09/03

Project Number : 1177

Report Date : 07/16/03

Field ID : MW-20 BR(1)

Lab Sample Number : 836478-007

VOLATILES

Prep Date: 07/14/03

Analyte	Result	LOD	LOQ	EQL	Dil.	Units	Code	Analysis Date	Prep Method	Analysis Method
1,1,1,2-Tetrachloroethane	< 0.92	0.92	2.9		1	ug/L		07/14/03	SW846 5030B	SW846 8260B
1,1,1-Trichloroethane	< 0.90	0.90	2.9		1	ug/L		07/14/03	SW846 5030B	SW846 8260B
1,1,2,2-Tetrachloroethane	< 0.20	0.20	0.64		1	ug/L		07/14/03	SW846 5030B	SW846 8260B
1,1,2-Trichloroethane	< 0.42	0.42	1.3		1	ug/L		07/14/03	SW846 5030B	SW846 8260B
1,1-Dichloroethane	< 0.75	0.75	2.4		1	ug/L		07/14/03	SW846 5030B	SW846 8260B
1,1-Dichloroethene	< 0.57	0.57	1.8		1	ug/L		07/14/03	SW846 5030B	SW846 8260B
1,1-Dichloropropene	< 0.75	0.75	2.4		1	ug/L		07/14/03	SW846 5030B	SW846 8260B
1,2,3-Trichlorobenzene	< 0.74	0.74	2.4		1	ug/L		07/14/03	SW846 5030B	SW846 8260B
1,2,3-Trichloropropane	< 0.99	0.99	3.2		1	ug/L		07/14/03	SW846 5030B	SW846 8260B
1,2,4-Trichlorobenzene	< 0.97	0.97	3.1		1	ug/L		07/14/03	SW846 5030B	SW846 8260B
1,2,4-Trimethylbenzene	< 0.97	0.97	3.1		1	ug/L		07/14/03	SW846 5030B	SW846 8260B
1,2-Dibromo-3-chloropropane	< 0.87	0.87	2.8		1	ug/L		07/14/03	SW846 5030B	SW846 8260B
1,2-Dibromoethane	< 0.56	0.56	1.8		1	ug/L		07/14/03	SW846 5030B	SW846 8260B
1,2-Dichlorobenzene	< 0.83	0.83	2.6		1	ug/L		07/14/03	SW846 5030B	SW846 8260B
1,2-Dichloroethane	< 0.36	0.36	1.1		1	ug/L		07/14/03	SW846 5030B	SW846 8260B
1,2-Dichloropropane	< 0.46	0.46	1.5		1	ug/L		07/14/03	SW846 5030B	SW846 8260B
1,3,5-Trimethylbenzene	< 0.83	0.83	2.6		1	ug/L		07/14/03	SW846 5030B	SW846 8260B
1,3-Dichlorobenzene	< 0.87	0.87	2.8		1	ug/L		07/14/03	SW846 5030B	SW846 8260B
1,3-Dichloropropane	< 0.61	0.61	1.9		1	ug/L		07/14/03	SW846 5030B	SW846 8260B
1,4-Dichlorobenzene	< 0.95	0.95	3.0		1	ug/L		07/14/03	SW846 5030B	SW846 8260B
2,2-Dichloropropane	< 0.62	0.62	2.0		1	ug/L		07/14/03	SW846 5030B	SW846 8260B
2-Chlorotoluene	< 0.85	0.85	2.7		1	ug/L		07/14/03	SW846 5030B	SW846 8260B
4-Chlorotoluene	< 0.74	0.74	2.4		1	ug/L		07/14/03	SW846 5030B	SW846 8260B
Benzene	< 0.41	0.41	1.3		1	ug/L		07/14/03	SW846 5030B	SW846 8260B
Bromobenzene	< 0.82	0.82	2.6		1	ug/L		07/14/03	SW846 5030B	SW846 8260B
Bromochloromethane	< 0.97	0.97	3.1		1	ug/L		07/14/03	SW846 5030B	SW846 8260B
Bromodichloromethane	< 0.56	0.56	1.8		1	ug/L		07/14/03	SW846 5030B	SW846 8260B
Bromoform	< 0.94	0.94	3.0		1	ug/L		07/14/03	SW846 5030B	SW846 8260B
Bromomethane	< 0.91	0.91	2.9		1	ug/L		07/14/03	SW846 5030B	SW846 8260B
Carbon Tetrachloride	< 0.49	0.49	1.6		1	ug/L		07/14/03	SW846 5030B	SW846 8260B
Chlorobenzene	< 0.41	0.41	1.3		1	ug/L		07/14/03	SW846 5030B	SW846 8260B
Chlorodibromomethane	< 0.81	0.81	2.6		1	ug/L		07/14/03	SW846 5030B	SW846 8260B
Chloroethane	< 0.97	0.97	3.1		1	ug/L		07/14/03	SW846 5030B	SW846 8260B
Chloroform	< 0.37	0.37	1.2		1	ug/L		07/14/03	SW846 5030B	SW846 8260B
Chloromethane	< 0.24	0.24	0.76		1	ug/L		07/14/03	SW846 5030B	SW846 8260B
cis-1,2-Dichloroethene	< 0.83	0.83	2.6		1	ug/L		07/14/03	SW846 5030B	SW846 8260B
cis-1,3-Dichloropropene	< 0.19	0.19	0.61		1	ug/L		07/14/03	SW846 5030B	SW846 8260B
Dibromomethane	< 0.60	0.60	1.9		1	ug/L		07/14/03	SW846 5030B	SW846 8260B
Dichlorodifluoromethane	< 0.99	0.99	3.2		1	ug/L		07/14/03	SW846 5030B	SW846 8260B
Diisopropyl Ether	< 0.76	0.76	2.4		1	ug/L		07/14/03	SW846 5030B	SW846 8260B
Ethylbenzene	< 0.54	0.54	1.7		1	ug/L		07/14/03	SW846 5030B	SW846 8260B
Fluorotrichloromethane	< 0.79	0.79	2.5		1	ug/L		07/14/03	SW846 5030B	SW846 8260B

Analytical Report Number: 836478

Client : MORAIN ENVIRONMENTAL INC
 Project Name : TECUMSEH GRAFTON
 Project Number : 1177
 Field ID : MW-20 BR(1)

Matrix Type : WATER
 Collection Date : 07/09/03
 Report Date : 07/16/03
 Lab Sample Number : 836478-007

VOLATILES

Prep Date: 07/14/03

Analyte	Result	LOD	LOQ	EQL	Dil.	Units	Code	Analysis Date	Prep Method	Analysis Method
Hexachlorobutadiene	< 0.67	0.67	2.1		1	ug/L		07/14/03	SW846 5030B	SW846 8260B
Isopropylbenzene	< 0.59	0.59	1.9		1	ug/L		07/14/03	SW846 5030B	SW846 8260B
Methylene Chloride	< 0.43	0.43	1.4		1	ug/L		07/14/03	SW846 5030B	SW846 8260B
Methyl-tert-butyl-ether	< 0.61	0.61	1.9		1	ug/L		07/14/03	SW846 5030B	SW846 8260B
Naphthalene	< 0.74	0.74	2.4		1	ug/L		07/14/03	SW846 5030B	SW846 8260B
n-Butylbenzene	< 0.93	0.93	3.0		1	ug/L		07/14/03	SW846 5030B	SW846 8260B
n-Propylbenzene	< 0.81	0.81	2.6		1	ug/L		07/14/03	SW846 5030B	SW846 8260B
p-Isopropyltoluene	< 0.67	0.67	2.1		1	ug/L		07/14/03	SW846 5030B	SW846 8260B
sec-Butylbenzene	< 0.89	0.89	2.8		1	ug/L		07/14/03	SW846 5030B	SW846 8260B
Styrene	< 0.86	0.86	2.7		1	ug/L		07/14/03	SW846 5030B	SW846 8260B
tert-Butylbenzene	< 0.97	0.97	3.1		1	ug/L		07/14/03	SW846 5030B	SW846 8260B
Tetrachloroethene	< 0.45	0.45	1.4		1	ug/L		07/14/03	SW846 5030B	SW846 8260B
Toluene	< 0.67	0.67	2.1		1	ug/L		07/14/03	SW846 5030B	SW846 8260B
trans-1,2-Dichloroethene	< 0.89	0.89	2.8		1	ug/L		07/14/03	SW846 5030B	SW846 8260B
trans-1,3-Dichloropropene	< 0.19	0.19	0.61		1	ug/L		07/14/03	SW846 5030B	SW846 8260B
Trichloroethene	< 0.48	0.48	1.5		1	ug/L		07/14/03	SW846 5030B	SW846 8260B
Vinyl Chloride	< 0.18	0.18	0.57		1	ug/L		07/14/03	SW846 5030B	SW846 8260B
Xylene, o	< 0.83	0.83	2.6		1	ug/L		07/14/03	SW846 5030B	SW846 8260B
Xylenes, m + p	< 1.8	1.8	5.7		1	ug/L		07/14/03	SW846 5030B	SW846 8260B
4-Bromofluorobenzene	112				1	%Recov		07/14/03	SW846 5030B	SW846 8260B
Toluene-d8	120				1	%Recov		07/14/03	SW846 5030B	SW846 8260B
Dibromofluoromethane	111				1	%Recov		07/14/03	SW846 5030B	SW846 8260B

Analytical Report Number: 836478

Client : MORaine ENVIRONMENTAL INC

Matrix Type : WATER

Project Name : TECUMSEH GRAFTON

Collection Date : 07/09/03

Project Number : 1177

Report Date : 07/16/03

Field ID : MW-20 BR(2)

Lab Sample Number : 836478-008

VOLATILES

Prep Date: 07/14/03

Analyte	Result	LOD	LOQ	EQL	Dil.	Units	Code	Analysis Date	Prep Method	Analysis Method
1,1,1,2-Tetrachloroethane	< 0.92	0.92	2.9		1	ug/L		07/14/03	SW846 5030B	SW846 8260B
1,1,1-Trichloroethane	< 0.90	0.90	2.9		1	ug/L		07/14/03	SW846 5030B	SW846 8260B
1,1,2,2-Tetrachloroethane	< 0.20	0.20	0.64		1	ug/L		07/14/03	SW846 5030B	SW846 8260B
1,1,2-Trichloroethane	< 0.42	0.42	1.3		1	ug/L		07/14/03	SW846 5030B	SW846 8260B
1,1-Dichloroethane	< 0.75	0.75	2.4		1	ug/L		07/14/03	SW846 5030B	SW846 8260B
1,1-Dichloroethene	< 0.57	0.57	1.8		1	ug/L		07/14/03	SW846 5030B	SW846 8260B
1,1-Dichloropropene	< 0.75	0.75	2.4		1	ug/L		07/14/03	SW846 5030B	SW846 8260B
1,2,3-Trichlorobenzene	< 0.74	0.74	2.4		1	ug/L		07/14/03	SW846 5030B	SW846 8260B
1,2,3-Trichloropropane	< 0.99	0.99	3.2		1	ug/L		07/14/03	SW846 5030B	SW846 8260B
1,2,4-Trichlorobenzene	< 0.97	0.97	3.1		1	ug/L		07/14/03	SW846 5030B	SW846 8260B
1,2,4-Trimethylbenzene	< 0.97	0.97	3.1		1	ug/L		07/14/03	SW846 5030B	SW846 8260B
1,2-Dibromo-3-chloropropane	< 0.87	0.87	2.8		1	ug/L		07/14/03	SW846 5030B	SW846 8260B
1,2-Dibromoethane	< 0.56	0.56	1.8		1	ug/L		07/14/03	SW846 5030B	SW846 8260B
1,2-Dichlorobenzene	< 0.83	0.83	2.6		1	ug/L		07/14/03	SW846 5030B	SW846 8260B
1,2-Dichloroethane	< 0.36	0.36	1.1		1	ug/L		07/14/03	SW846 5030B	SW846 8260B
1,2-Dichloropropane	< 0.46	0.46	1.5		1	ug/L		07/14/03	SW846 5030B	SW846 8260B
1,3,5-Trimethylbenzene	< 0.83	0.83	2.6		1	ug/L		07/14/03	SW846 5030B	SW846 8260B
1,3-Dichlorobenzene	< 0.87	0.87	2.8		1	ug/L		07/14/03	SW846 5030B	SW846 8260B
1,3-Dichloropropane	< 0.61	0.61	1.9		1	ug/L		07/14/03	SW846 5030B	SW846 8260B
1,4-Dichlorobenzene	< 0.95	0.95	3.0		1	ug/L		07/14/03	SW846 5030B	SW846 8260B
2,2-Dichloropropane	< 0.62	0.62	2.0		1	ug/L		07/14/03	SW846 5030B	SW846 8260B
2-Chlorotoluene	< 0.85	0.85	2.7		1	ug/L		07/14/03	SW846 5030B	SW846 8260B
4-Chlorotoluene	< 0.74	0.74	2.4		1	ug/L		07/14/03	SW846 5030B	SW846 8260B
Benzene	< 0.41	0.41	1.3		1	ug/L		07/14/03	SW846 5030B	SW846 8260B
Bromobenzene	< 0.82	0.82	2.6		1	ug/L		07/14/03	SW846 5030B	SW846 8260B
Bromochloromethane	< 0.97	0.97	3.1		1	ug/L		07/14/03	SW846 5030B	SW846 8260B
Bromodichloromethane	< 0.56	0.56	1.8		1	ug/L		07/14/03	SW846 5030B	SW846 8260B
Bromoform	< 0.94	0.94	3.0		1	ug/L		07/14/03	SW846 5030B	SW846 8260B
Bromomethane	< 0.91	0.91	2.9		1	ug/L		07/14/03	SW846 5030B	SW846 8260B
Carbon Tetrachloride	< 0.49	0.49	1.6		1	ug/L		07/14/03	SW846 5030B	SW846 8260B
Chlorobenzene	< 0.41	0.41	1.3		1	ug/L		07/14/03	SW846 5030B	SW846 8260B
Chlorodibromomethane	< 0.81	0.81	2.6		1	ug/L		07/14/03	SW846 5030B	SW846 8260B
Chloroethane	< 0.97	0.97	3.1		1	ug/L		07/14/03	SW846 5030B	SW846 8260B
Chloroform	< 0.37	0.37	1.2		1	ug/L		07/14/03	SW846 5030B	SW846 8260B
Chloromethane	< 0.24	0.24	0.76		1	ug/L		07/14/03	SW846 5030B	SW846 8260B
cis-1,2-Dichloroethene	< 0.83	0.83	2.6		1	ug/L		07/14/03	SW846 5030B	SW846 8260B
cis-1,3-Dichloropropene	< 0.19	0.19	0.61		1	ug/L		07/14/03	SW846 5030B	SW846 8260B
Dibromomethane	< 0.60	0.60	1.9		1	ug/L		07/14/03	SW846 5030B	SW846 8260B
Dichlorodifluoromethane	< 0.99	0.99	3.2		1	ug/L		07/14/03	SW846 5030B	SW846 8260B
Diisopropyl Ether	< 0.76	0.76	2.4		1	ug/L		07/14/03	SW846 5030B	SW846 8260B
Ethylbenzene	< 0.54	0.54	1.7		1	ug/L		07/14/03	SW846 5030B	SW846 8260B
Fluorotrichloromethane	< 0.79	0.79	2.5		1	ug/L		07/14/03	SW846 5030B	SW846 8260B

Analytical Report Number: 836478

Client : MORAIN ENVIRONMENTAL INC

Matrix Type : WATER

Project Name : TECUMSEH GRAFTON

Collection Date : 07/09/03

Project Number : 1177

Report Date : 07/16/03

Field ID : MW-20 BR(2)

Lab Sample Number : 836478-008

VOLATILES

Prep Date: 07/14/03

Analyte	Result	LOD	LOQ	EQL	Dil.	Units	Code	Analysis Date	Prep Method	Analysis Method
Hexachlorobutadiene	< 0.67	0.67	2.1		1	ug/L		07/14/03	SW846 5030B	SW846 8260B
Isopropylbenzene	< 0.59	0.59	1.9		1	ug/L		07/14/03	SW846 5030B	SW846 8260B
Methylene Chloride	< 0.43	0.43	1.4		1	ug/L		07/14/03	SW846 5030B	SW846 8260B
Methyl-tert-butyl-ether	< 0.61	0.61	1.9		1	ug/L		07/14/03	SW846 5030B	SW846 8260B
Naphthalene	< 0.74	0.74	2.4		1	ug/L		07/14/03	SW846 5030B	SW846 8260B
n-Butylbenzene	< 0.93	0.93	3.0		1	ug/L		07/14/03	SW846 5030B	SW846 8260B
n-Propylbenzene	< 0.81	0.81	2.6		1	ug/L		07/14/03	SW846 5030B	SW846 8260B
p-Isopropyltoluene	< 0.67	0.67	2.1		1	ug/L		07/14/03	SW846 5030B	SW846 8260B
sec-Butylbenzene	< 0.89	0.89	2.8		1	ug/L		07/14/03	SW846 5030B	SW846 8260B
Styrene	< 0.86	0.86	2.7		1	ug/L		07/14/03	SW846 5030B	SW846 8260B
tert-Butylbenzene	< 0.97	0.97	3.1		1	ug/L		07/14/03	SW846 5030B	SW846 8260B
Tetrachloroethene	< 0.45	0.45	1.4		1	ug/L		07/14/03	SW846 5030B	SW846 8260B
Toluene	< 0.67	0.67	2.1		1	ug/L		07/14/03	SW846 5030B	SW846 8260B
trans-1,2-Dichloroethene	< 0.89	0.89	2.8		1	ug/L		07/14/03	SW846 5030B	SW846 8260B
trans-1,3-Dichloropropene	< 0.19	0.19	0.61		1	ug/L		07/14/03	SW846 5030B	SW846 8260B
Trichloroethene	< 0.48	0.48	1.5		1	ug/L		07/14/03	SW846 5030B	SW846 8260B
Vinyl Chloride	< 0.18	0.18	0.57		1	ug/L		07/14/03	SW846 5030B	SW846 8260B
Xylene, o	< 0.83	0.83	2.6		1	ug/L		07/14/03	SW846 5030B	SW846 8260B
Xylenes, m + p	< 1.8	1.8	5.7		1	ug/L		07/14/03	SW846 5030B	SW846 8260B
4-Bromofluorobenzene	111				1	%Recov		07/14/03	SW846 5030B	SW846 8260B
Toluene-d8	118				1	%Recov		07/14/03	SW846 5030B	SW846 8260B
Dibromofluoromethane	120				1	%Recov		07/14/03	SW846 5030B	SW846 8260B

Analytical Report Number: 836478

Client : MORaine ENVIRONMENTAL INC

Matrix Type : WATER

Project Name : TECUMSEH GRAFTON

Collection Date : 07/09/03

Project Number : 1177

Report Date : 07/16/03

Field ID : MW-21 BR(1)

Lab Sample Number : 836478-009

VOLATILES

Prep Date: 07/14/03

Analyte	Result	LOD	LOQ	EQL	Dil.	Units	Code	Analysis Date	Prep Method	Analysis Method
1,1,1,2-Tetrachloroethane	< 0.92	0.92	2.9		1	ug/L		07/14/03	SW846 5030B	SW846 8260B
1,1,1-Trichloroethane	< 0.90	0.90	2.9		1	ug/L		07/14/03	SW846 5030B	SW846 8260B
1,1,2,2-Tetrachloroethane	< 0.20	0.20	0.64		1	ug/L		07/14/03	SW846 5030B	SW846 8260B
1,1,2-Trichloroethane	< 0.42	0.42	1.3		1	ug/L		07/14/03	SW846 5030B	SW846 8260B
1,1-Dichloroethane	< 0.75	0.75	2.4		1	ug/L		07/14/03	SW846 5030B	SW846 8260B
1,1-Dichloroethene	< 0.57	0.57	1.8		1	ug/L		07/14/03	SW846 5030B	SW846 8260B
1,1-Dichloropropene	< 0.75	0.75	2.4		1	ug/L		07/14/03	SW846 5030B	SW846 8260B
1,2,3-Trichlorobenzene	< 0.74	0.74	2.4		1	ug/L		07/14/03	SW846 5030B	SW846 8260B
1,2,3-Trichloropropane	< 0.99	0.99	3.2		1	ug/L		07/14/03	SW846 5030B	SW846 8260B
1,2,4-Trichlorobenzene	< 0.97	0.97	3.1		1	ug/L		07/14/03	SW846 5030B	SW846 8260B
1,2,4-Trimethylbenzene	< 0.97	0.97	3.1		1	ug/L		07/14/03	SW846 5030B	SW846 8260B
1,2-Dibromo-3-chloropropane	< 0.87	0.87	2.8		1	ug/L		07/14/03	SW846 5030B	SW846 8260B
1,2-Dibromoethane	< 0.56	0.56	1.8		1	ug/L		07/14/03	SW846 5030B	SW846 8260B
1,2-Dichlorobenzene	< 0.83	0.83	2.6		1	ug/L		07/14/03	SW846 5030B	SW846 8260B
1,2-Dichloroethane	< 0.36	0.36	1.1		1	ug/L		07/14/03	SW846 5030B	SW846 8260B
1,2-Dichloropropane	< 0.46	0.46	1.5		1	ug/L		07/14/03	SW846 5030B	SW846 8260B
1,3,5-Trimethylbenzene	< 0.83	0.83	2.6		1	ug/L		07/14/03	SW846 5030B	SW846 8260B
1,3-Dichlorobenzene	< 0.87	0.87	2.8		1	ug/L		07/14/03	SW846 5030B	SW846 8260B
1,3-Dichloropropane	< 0.61	0.61	1.9		1	ug/L		07/14/03	SW846 5030B	SW846 8260B
1,4-Dichlorobenzene	< 0.95	0.95	3.0		1	ug/L		07/14/03	SW846 5030B	SW846 8260B
2,2-Dichloropropane	< 0.62	0.62	2.0		1	ug/L		07/14/03	SW846 5030B	SW846 8260B
2-Chlorotoluene	< 0.85	0.85	2.7		1	ug/L		07/14/03	SW846 5030B	SW846 8260B
4-Chlorotoluene	< 0.74	0.74	2.4		1	ug/L		07/14/03	SW846 5030B	SW846 8260B
Benzene	< 0.41	0.41	1.3		1	ug/L		07/14/03	SW846 5030B	SW846 8260B
Bromobenzene	< 0.82	0.82	2.6		1	ug/L		07/14/03	SW846 5030B	SW846 8260B
Bromochloromethane	< 0.97	0.97	3.1		1	ug/L		07/14/03	SW846 5030B	SW846 8260B
Bromodichloromethane	< 0.56	0.56	1.8		1	ug/L		07/14/03	SW846 5030B	SW846 8260B
Bromoform	< 0.94	0.94	3.0		1	ug/L		07/14/03	SW846 5030B	SW846 8260B
Bromomethane	< 0.91	0.91	2.9		1	ug/L		07/14/03	SW846 5030B	SW846 8260B
Carbon Tetrachloride	< 0.49	0.49	1.6		1	ug/L		07/14/03	SW846 5030B	SW846 8260B
Chlorobenzene	< 0.41	0.41	1.3		1	ug/L		07/14/03	SW846 5030B	SW846 8260B
Chlorodibromomethane	< 0.81	0.81	2.6		1	ug/L		07/14/03	SW846 5030B	SW846 8260B
Chloroethane	< 0.97	0.97	3.1		1	ug/L		07/14/03	SW846 5030B	SW846 8260B
Chloroform	< 0.37	0.37	1.2		1	ug/L		07/14/03	SW846 5030B	SW846 8260B
Chloromethane	< 0.24	0.24	0.76		1	ug/L		07/14/03	SW846 5030B	SW846 8260B
cis-1,2-Dichloroethene	< 0.83	0.83	2.6		1	ug/L		07/14/03	SW846 5030B	SW846 8260B
cis-1,3-Dichloropropene	< 0.19	0.19	0.61		1	ug/L		07/14/03	SW846 5030B	SW846 8260B
Dibromomethane	< 0.60	0.60	1.9		1	ug/L		07/14/03	SW846 5030B	SW846 8260B
Dichlorodifluoromethane	< 0.99	0.99	3.2		1	ug/L		07/14/03	SW846 5030B	SW846 8260B
Diisopropyl Ether	< 0.76	0.76	2.4		1	ug/L		07/14/03	SW846 5030B	SW846 8260B
Ethylbenzene	< 0.54	0.54	1.7		1	ug/L		07/14/03	SW846 5030B	SW846 8260B
Fluorotrichloromethane	< 0.79	0.79	2.5		1	ug/L		07/14/03	SW846 5030B	SW846 8260B

Analytical Report Number: 836478

Client : MORAIN ENVIRONMENTAL INC

Matrix Type : WATER

Project Name : TECUMSEH GRAFTON

Collection Date : 07/09/03

Project Number : 1177

Report Date : 07/16/03

Field ID : MW-21 BR(1)

Lab Sample Number : 836478-009

VOLATILES

Prep Date: 07/14/03

Analyte	Result	LOD	LOQ	EQL	Dil.	Units	Code	Analysis Date	Prep Method	Analysis Method
Hexachlorobutadiene	< 0.67	0.67	2.1		1	ug/L		07/14/03	SW846 5030B	SW846 8260B
Isopropylbenzene	< 0.59	0.59	1.9		1	ug/L		07/14/03	SW846 5030B	SW846 8260B
Methylene Chloride	< 0.43	0.43	1.4		1	ug/L		07/14/03	SW846 5030B	SW846 8260B
Methyl-tert-butyl-ether	< 0.61	0.61	1.9		1	ug/L		07/14/03	SW846 5030B	SW846 8260B
Naphthalene	< 0.74	0.74	2.4		1	ug/L		07/14/03	SW846 5030B	SW846 8260B
n-Butylbenzene	< 0.93	0.93	3.0		1	ug/L		07/14/03	SW846 5030B	SW846 8260B
n-Propylbenzene	< 0.81	0.81	2.6		1	ug/L		07/14/03	SW846 5030B	SW846 8260B
p-Isopropyltoluene	< 0.67	0.67	2.1		1	ug/L		07/14/03	SW846 5030B	SW846 8260B
sec-Butylbenzene	< 0.89	0.89	2.8		1	ug/L		07/14/03	SW846 5030B	SW846 8260B
Styrene	< 0.86	0.86	2.7		1	ug/L		07/14/03	SW846 5030B	SW846 8260B
tert-Butylbenzene	< 0.97	0.97	3.1		1	ug/L		07/14/03	SW846 5030B	SW846 8260B
Tetrachloroethene	< 0.45	0.45	1.4		1	ug/L		07/14/03	SW846 5030B	SW846 8260B
Toluene	< 0.67	0.67	2.1		1	ug/L		07/14/03	SW846 5030B	SW846 8260B
trans-1,2-Dichloroethene	< 0.89	0.89	2.8		1	ug/L		07/14/03	SW846 5030B	SW846 8260B
trans-1,3-Dichloropropene	< 0.19	0.19	0.61		1	ug/L		07/14/03	SW846 5030B	SW846 8260B
Trichloroethene	< 0.48	0.48	1.5		1	ug/L		07/14/03	SW846 5030B	SW846 8260B
Vinyl Chloride	< 0.18	0.18	0.57		1	ug/L		07/14/03	SW846 5030B	SW846 8260B
Xylene, o	< 0.83	0.83	2.6		1	ug/L		07/14/03	SW846 5030B	SW846 8260B
Xylenes, m + p	< 1.8	1.8	5.7		1	ug/L		07/14/03	SW846 5030B	SW846 8260B
4-Bromofluorobenzene	111				1	%Recov		07/14/03	SW846 5030B	SW846 8260B
Toluene-d8	117				1	%Recov		07/14/03	SW846 5030B	SW846 8260B
Dibromofluoromethane	117				1	%Recov		07/14/03	SW846 5030B	SW846 8260B

Analytical Report Number: 836478

Client : MORAIN ENVIRONMENTAL INC

Matrix Type : WATER

Project Name : TECUMSEH GRAFTON

Collection Date : 07/09/03

Project Number : 1177

Report Date : 07/16/03

Field ID : MW-21 BR(2)

Lab Sample Number : 836478-010

VOLATILES

Prep Date: 07/14/03

Analyte	Result	LOD	LOQ	EQL	Dil.	Units	Code	Analysis Date	Prep Method	Analysis Method
1,1,1,2-Tetrachloroethane	< 0.92	0.92	2.9		1	ug/L		07/14/03	SW846 5030B	SW846 8260B
1,1,1-Trichloroethane	< 0.90	0.90	2.9		1	ug/L		07/14/03	SW846 5030B	SW846 8260B
1,1,2,2-Tetrachloroethane	< 0.20	0.20	0.64		1	ug/L		07/14/03	SW846 5030B	SW846 8260B
1,1,2-Trichloroethane	< 0.42	0.42	1.3		1	ug/L		07/14/03	SW846 5030B	SW846 8260B
1,1-Dichloroethane	< 0.75	0.75	2.4		1	ug/L		07/14/03	SW846 5030B	SW846 8260B
1,1-Dichloroethene	< 0.57	0.57	1.8		1	ug/L		07/14/03	SW846 5030B	SW846 8260B
1,1-Dichloropropene	< 0.75	0.75	2.4		1	ug/L		07/14/03	SW846 5030B	SW846 8260B
1,2,3-Trichlorobenzene	< 0.74	0.74	2.4		1	ug/L		07/14/03	SW846 5030B	SW846 8260B
1,2,3-Trichloropropane	< 0.99	0.99	3.2		1	ug/L		07/14/03	SW846 5030B	SW846 8260B
1,2,4-Trichlorobenzene	< 0.97	0.97	3.1		1	ug/L		07/14/03	SW846 5030B	SW846 8260B
1,2,4-Trimethylbenzene	< 0.97	0.97	3.1		1	ug/L		07/14/03	SW846 5030B	SW846 8260B
1,2-Dibromo-3-chloropropane	< 0.87	0.87	2.8		1	ug/L		07/14/03	SW846 5030B	SW846 8260B
1,2-Dibromoethane	< 0.56	0.56	1.8		1	ug/L		07/14/03	SW846 5030B	SW846 8260B
1,2-Dichlorobenzene	< 0.83	0.83	2.6		1	ug/L		07/14/03	SW846 5030B	SW846 8260B
1,2-Dichloroethane	< 0.36	0.36	1.1		1	ug/L		07/14/03	SW846 5030B	SW846 8260B
1,2-Dichloropropane	< 0.46	0.46	1.5		1	ug/L		07/14/03	SW846 5030B	SW846 8260B
1,3,5-Trimethylbenzene	< 0.83	0.83	2.6		1	ug/L		07/14/03	SW846 5030B	SW846 8260B
1,3-Dichlorobenzene	< 0.87	0.87	2.8		1	ug/L		07/14/03	SW846 5030B	SW846 8260B
1,3-Dichloropropane	< 0.61	0.61	1.9		1	ug/L		07/14/03	SW846 5030B	SW846 8260B
1,4-Dichlorobenzene	< 0.95	0.95	3.0		1	ug/L		07/14/03	SW846 5030B	SW846 8260B
2,2-Dichloropropane	< 0.62	0.62	2.0		1	ug/L		07/14/03	SW846 5030B	SW846 8260B
2-Chlorotoluene	< 0.85	0.85	2.7		1	ug/L		07/14/03	SW846 5030B	SW846 8260B
4-Chlorotoluene	< 0.74	0.74	2.4		1	ug/L		07/14/03	SW846 5030B	SW846 8260B
Benzene	< 0.41	0.41	1.3		1	ug/L		07/14/03	SW846 5030B	SW846 8260B
Bromobenzene	< 0.82	0.82	2.6		1	ug/L		07/14/03	SW846 5030B	SW846 8260B
Bromochloromethane	< 0.97	0.97	3.1		1	ug/L		07/14/03	SW846 5030B	SW846 8260B
Bromodichloromethane	< 0.56	0.56	1.8		1	ug/L		07/14/03	SW846 5030B	SW846 8260B
Bromoform	< 0.94	0.94	3.0		1	ug/L		07/14/03	SW846 5030B	SW846 8260B
Bromomethane	< 0.91	0.91	2.9		1	ug/L		07/14/03	SW846 5030B	SW846 8260B
Carbon Tetrachloride	< 0.49	0.49	1.6		1	ug/L		07/14/03	SW846 5030B	SW846 8260B
Chlorobenzene	< 0.41	0.41	1.3		1	ug/L		07/14/03	SW846 5030B	SW846 8260B
Chlorodibromomethane	< 0.81	0.81	2.6		1	ug/L		07/14/03	SW846 5030B	SW846 8260B
Chloroethane	< 0.97	0.97	3.1		1	ug/L		07/14/03	SW846 5030B	SW846 8260B
Chloroform	< 0.37	0.37	1.2		1	ug/L		07/14/03	SW846 5030B	SW846 8260B
Chloromethane	< 0.24	0.24	0.76		1	ug/L		07/14/03	SW846 5030B	SW846 8260B
cis-1,2-Dichloroethene	< 0.83	0.83	2.6		1	ug/L		07/14/03	SW846 5030B	SW846 8260B
cis-1,3-Dichloropropene	< 0.19	0.19	0.61		1	ug/L		07/14/03	SW846 5030B	SW846 8260B
Dibromomethane	< 0.60	0.60	1.9		1	ug/L		07/14/03	SW846 5030B	SW846 8260B
Dichlorodifluoromethane	< 0.99	0.99	3.2		1	ug/L		07/14/03	SW846 5030B	SW846 8260B
Diisopropyl Ether	< 0.76	0.76	2.4		1	ug/L		07/14/03	SW846 5030B	SW846 8260B
Ethylbenzene	< 0.54	0.54	1.7		1	ug/L		07/14/03	SW846 5030B	SW846 8260B
Fluorotrichloromethane	< 0.79	0.79	2.5		1	ug/L		07/14/03	SW846 5030B	SW846 8260B

Analytical Report Number: 836478

Client : MORAIN ENVIRONMENTAL INC

Matrix Type : WATER

Project Name : TECUMSEH GRAFTON

Collection Date : 07/09/03

Project Number : 1177

Report Date : 07/16/03

Field ID : MW-21 BR(2)

Lab Sample Number : 836478-010

VOLATILES

Prep Date: 07/14/03

Analyte	Result	LOD	LOQ	EQL	Dil.	Units	Code	Analysis Date	Prep Method	Analysis Method
Hexachlorobutadiene	< 0.67	0.67	2.1		1	ug/L		07/14/03	SW846 5030B	SW846 8260B
Isopropylbenzene	< 0.59	0.59	1.9		1	ug/L		07/14/03	SW846 5030B	SW846 8260B
Methylene Chloride	< 0.43	0.43	1.4		1	ug/L		07/14/03	SW846 5030B	SW846 8260B
Methyl-tert-butyl-ether	< 0.61	0.61	1.9		1	ug/L		07/14/03	SW846 5030B	SW846 8260B
Naphthalene	< 0.74	0.74	2.4		1	ug/L		07/14/03	SW846 5030B	SW846 8260B
n-Butylbenzene	< 0.93	0.93	3.0		1	ug/L		07/14/03	SW846 5030B	SW846 8260B
n-Propylbenzene	< 0.81	0.81	2.6		1	ug/L		07/14/03	SW846 5030B	SW846 8260B
p-Isopropyltoluene	< 0.67	0.67	2.1		1	ug/L		07/14/03	SW846 5030B	SW846 8260B
sec-Butylbenzene	< 0.89	0.89	2.8		1	ug/L		07/14/03	SW846 5030B	SW846 8260B
Styrene	< 0.86	0.86	2.7		1	ug/L		07/14/03	SW846 5030B	SW846 8260B
tert-Butylbenzene	< 0.97	0.97	3.1		1	ug/L		07/14/03	SW846 5030B	SW846 8260B
Tetrachloroethene	< 0.45	0.45	1.4		1	ug/L		07/14/03	SW846 5030B	SW846 8260B
Toluene	< 0.67	0.67	2.1		1	ug/L		07/14/03	SW846 5030B	SW846 8260B
trans-1,2-Dichloroethene	< 0.89	0.89	2.8		1	ug/L		07/14/03	SW846 5030B	SW846 8260B
trans-1,3-Dichloropropene	< 0.19	0.19	0.61		1	ug/L		07/14/03	SW846 5030B	SW846 8260B
Trichloroethene	< 0.48	0.48	1.5		1	ug/L		07/14/03	SW846 5030B	SW846 8260B
Vinyl Chloride	< 0.18	0.18	0.57		1	ug/L		07/14/03	SW846 5030B	SW846 8260B
Xylene, o	< 0.83	0.83	2.6		1	ug/L		07/14/03	SW846 5030B	SW846 8260B
Xylenes, m + p	< 1.8	1.8	5.7		1	ug/L		07/14/03	SW846 5030B	SW846 8260B
4-Bromofluorobenzene	111				1	%Recov		07/14/03	SW846 5030B	SW846 8260B
Toluene-d8	119				1	%Recov		07/14/03	SW846 5030B	SW846 8260B
Dibromofluoromethane	120				1	%Recov		07/14/03	SW846 5030B	SW846 8260B

Analytical Report Number: 836478

Client : MORAIN ENVIRONMENTAL INC

Matrix Type : WATER

Project Name : TECUMSEH GRAFTON

Collection Date : 07/09/03

Project Number : 1177

Report Date : 07/16/03

Field ID : MW-22 BR

Lab Sample Number : 836478-011

VOLATILES

Prep Date: 07/14/03

Analyte	Result	LOD	LOQ	EQL	Dil.	Units	Code	Analysis Date	Prep Method	Analysis Method
1,1,1,2-Tetrachloroethane	< 0.92	0.92	2.9		1	ug/L		07/14/03	SW846 5030B	SW846 8260B
1,1,1-Trichloroethane	< 0.90	0.90	2.9		1	ug/L		07/14/03	SW846 5030B	SW846 8260B
1,1,2,2-Tetrachloroethane	< 0.20	0.20	0.64		1	ug/L		07/14/03	SW846 5030B	SW846 8260B
1,1,2-Trichloroethane	< 0.42	0.42	1.3		1	ug/L		07/14/03	SW846 5030B	SW846 8260B
1,1-Dichloroethane	0.93	0.75	2.4		1	ug/L	Q	07/14/03	SW846 5030B	SW846 8260B
1,1-Dichloroethene	< 0.57	0.57	1.8		1	ug/L		07/14/03	SW846 5030B	SW846 8260B
1,1-Dichloropropene	< 0.75	0.75	2.4		1	ug/L		07/14/03	SW846 5030B	SW846 8260B
1,2,3-Trichlorobenzene	< 0.74	0.74	2.4		1	ug/L		07/14/03	SW846 5030B	SW846 8260B
1,2,3-Trichloropropane	< 0.99	0.99	3.2		1	ug/L		07/14/03	SW846 5030B	SW846 8260B
1,2,4-Trichlorobenzene	< 0.97	0.97	3.1		1	ug/L		07/14/03	SW846 5030B	SW846 8260B
1,2,4-Trimethylbenzene	< 0.97	0.97	3.1		1	ug/L		07/14/03	SW846 5030B	SW846 8260B
1,2-Dibromo-3-chloropropane	< 0.87	0.87	2.8		1	ug/L		07/14/03	SW846 5030B	SW846 8260B
1,2-Dibromoethane	< 0.56	0.56	1.8		1	ug/L		07/14/03	SW846 5030B	SW846 8260B
1,2-Dichlorobenzene	< 0.83	0.83	2.6		1	ug/L		07/14/03	SW846 5030B	SW846 8260B
1,2-Dichloroethane	< 0.36	0.36	1.1		1	ug/L		07/14/03	SW846 5030B	SW846 8260B
1,2-Dichloropropane	< 0.46	0.46	1.5		1	ug/L		07/14/03	SW846 5030B	SW846 8260B
1,3,5-Trimethylbenzene	< 0.83	0.83	2.6		1	ug/L		07/14/03	SW846 5030B	SW846 8260B
1,3-Dichlorobenzene	< 0.87	0.87	2.8		1	ug/L		07/14/03	SW846 5030B	SW846 8260B
1,3-Dichloropropane	< 0.61	0.61	1.9		1	ug/L		07/14/03	SW846 5030B	SW846 8260B
1,4-Dichlorobenzene	< 0.95	0.95	3.0		1	ug/L		07/14/03	SW846 5030B	SW846 8260B
2,2-Dichloropropane	< 0.62	0.62	2.0		1	ug/L		07/14/03	SW846 5030B	SW846 8260B
2-Chlorotoluene	< 0.85	0.85	2.7		1	ug/L		07/14/03	SW846 5030B	SW846 8260B
4-Chlorotoluene	< 0.74	0.74	2.4		1	ug/L		07/14/03	SW846 5030B	SW846 8260B
Benzene	< 0.41	0.41	1.3		1	ug/L		07/14/03	SW846 5030B	SW846 8260B
Bromobenzene	< 0.82	0.82	2.6		1	ug/L		07/14/03	SW846 5030B	SW846 8260B
Bromochloromethane	< 0.97	0.97	3.1		1	ug/L		07/14/03	SW846 5030B	SW846 8260B
Bromodichloromethane	< 0.56	0.56	1.8		1	ug/L		07/14/03	SW846 5030B	SW846 8260B
Bromoform	< 0.94	0.94	3.0		1	ug/L		07/14/03	SW846 5030B	SW846 8260B
Bromomethane	< 0.91	0.91	2.9		1	ug/L		07/14/03	SW846 5030B	SW846 8260B
Carbon Tetrachloride	< 0.49	0.49	1.6		1	ug/L		07/14/03	SW846 5030B	SW846 8260B
Chlorobenzene	< 0.41	0.41	1.3		1	ug/L		07/14/03	SW846 5030B	SW846 8260B
Chlorodibromomethane	< 0.81	0.81	2.6		1	ug/L		07/14/03	SW846 5030B	SW846 8260B
Chloroethane	< 0.97	0.97	3.1		1	ug/L		07/14/03	SW846 5030B	SW846 8260B
Chloroform	< 0.37	0.37	1.2		1	ug/L		07/14/03	SW846 5030B	SW846 8260B
Chloromethane	< 0.24	0.24	0.76		1	ug/L		07/14/03	SW846 5030B	SW846 8260B
cis-1,2-Dichloroethene	9.1	0.83	2.6		1	ug/L		07/14/03	SW846 5030B	SW846 8260B
cis-1,3-Dichloropropene	< 0.19	0.19	0.61		1	ug/L		07/14/03	SW846 5030B	SW846 8260B
Dibromomethane	< 0.60	0.60	1.9		1	ug/L		07/14/03	SW846 5030B	SW846 8260B
Dichlorodifluoromethane	< 0.99	0.99	3.2		1	ug/L		07/14/03	SW846 5030B	SW846 8260B
Diisopropyl Ether	< 0.76	0.76	2.4		1	ug/L		07/14/03	SW846 5030B	SW846 8260B
Ethylbenzene	< 0.54	0.54	1.7		1	ug/L		07/14/03	SW846 5030B	SW846 8260B
Fluorotrichloromethane	< 0.79	0.79	2.5		1	ug/L		07/14/03	SW846 5030B	SW846 8260B

Analytical Report Number: 836478

Client : MORAIN ENVIRONMENTAL INC

Matrix Type : WATER

Project Name : TECUMSEH GRAFTON

Collection Date : 07/09/03

Project Number : 1177

Report Date : 07/16/03

Field ID : MW-22 BR

Lab Sample Number : 836478-011

VOLATILES

Prep Date: 07/14/03

Analyte	Result	LOD	LOQ	EQL	Dil.	Units	Code	Analysis Date	Prep Method	Analysis Method
Hexachlorobutadiene	< 0.67	0.67	2.1		1	ug/L		07/14/03	SW846 5030B	SW846 8260B
Isopropylbenzene	< 0.59	0.59	1.9		1	ug/L		07/14/03	SW846 5030B	SW846 8260B
Methylene Chloride	< 0.43	0.43	1.4		1	ug/L		07/14/03	SW846 5030B	SW846 8260B
Methyl-tert-butyl-ether	< 0.61	0.61	1.9		1	ug/L		07/14/03	SW846 5030B	SW846 8260B
Naphthalene	< 0.74	0.74	2.4		1	ug/L		07/14/03	SW846 5030B	SW846 8260B
n-Butylbenzene	< 0.93	0.93	3.0		1	ug/L		07/14/03	SW846 5030B	SW846 8260B
n-Propylbenzene	< 0.81	0.81	2.6		1	ug/L		07/14/03	SW846 5030B	SW846 8260B
p-Isopropyltoluene	< 0.67	0.67	2.1		1	ug/L		07/14/03	SW846 5030B	SW846 8260B
sec-Butylbenzene	< 0.89	0.89	2.8		1	ug/L		07/14/03	SW846 5030B	SW846 8260B
Styrene	< 0.86	0.86	2.7		1	ug/L		07/14/03	SW846 5030B	SW846 8260B
tert-Butylbenzene	< 0.97	0.97	3.1		1	ug/L		07/14/03	SW846 5030B	SW846 8260B
Tetrachloroethene	< 0.45	0.45	1.4		1	ug/L		07/14/03	SW846 5030B	SW846 8260B
Toluene	< 0.67	0.67	2.1		1	ug/L		07/14/03	SW846 5030B	SW846 8260B
trans-1,2-Dichloroethene	< 0.89	0.89	2.8		1	ug/L		07/14/03	SW846 5030B	SW846 8260B
trans-1,3-Dichloropropene	< 0.19	0.19	0.61		1	ug/L		07/14/03	SW846 5030B	SW846 8260B
Trichloroethene	34	0.48	1.5		1	ug/L		07/14/03	SW846 5030B	SW846 8260B
Vinyl Chloride	< 0.18	0.18	0.57		1	ug/L		07/14/03	SW846 5030B	SW846 8260B
Xylene, o	< 0.83	0.83	2.6		1	ug/L		07/14/03	SW846 5030B	SW846 8260B
Xylenes, m + p	< 1.8	1.8	5.7		1	ug/L		07/14/03	SW846 5030B	SW846 8260B
4-Bromofluorobenzene	111				1	%Recov		07/14/03	SW846 5030B	SW846 8260B
Toluene-d8	117				1	%Recov		07/14/03	SW846 5030B	SW846 8260B
Dibromofluoromethane	118				1	%Recov		07/14/03	SW846 5030B	SW846 8260B

Analytical Report Number: 836478

Client : MORAIN ENVIRONMENTAL INC

Matrix Type : WATER

Project Name : TECUMSEH GRAFTON

Collection Date : 07/09/03

Project Number : 1177

Report Date : 07/16/03

Field ID : P-5 (RAESS)

Lab Sample Number : 836478-012

VOLATILES

Prep Date: 07/14/03

Analyte	Result	LOD	LOQ	EQL	Dil.	Units	Code	Analysis Date	Prep Method	Analysis Method
1,1,1,2-Tetrachloroethane	< 0.92	0.92	2.9		1	ug/L		07/14/03	SW846 5030B	SW846 8260B
1,1,1-Trichloroethane	0.98	0.90	2.9		1	ug/L	Q	07/14/03	SW846 5030B	SW846 8260B
1,1,2,2-Tetrachloroethane	< 0.20	0.20	0.64		1	ug/L		07/14/03	SW846 5030B	SW846 8260B
1,1,2-Trichloroethane	< 0.42	0.42	1.3		1	ug/L		07/14/03	SW846 5030B	SW846 8260B
1,1-Dichloroethane	0.93	0.75	2.4		1	ug/L	Q	07/14/03	SW846 5030B	SW846 8260B
1,1-Dichloroethene	< 0.57	0.57	1.8		1	ug/L		07/14/03	SW846 5030B	SW846 8260B
1,1-Dichloropropene	< 0.75	0.75	2.4		1	ug/L		07/14/03	SW846 5030B	SW846 8260B
1,2,3-Trichlorobenzene	< 0.74	0.74	2.4		1	ug/L		07/14/03	SW846 5030B	SW846 8260B
1,2,3-Trichloropropane	< 0.99	0.99	3.2		1	ug/L		07/14/03	SW846 5030B	SW846 8260B
1,2,4-Trichlorobenzene	< 0.97	0.97	3.1		1	ug/L		07/14/03	SW846 5030B	SW846 8260B
1,2,4-Trimethylbenzene	< 0.97	0.97	3.1		1	ug/L		07/14/03	SW846 5030B	SW846 8260B
1,2-Dibromo-3-chloropropane	< 0.87	0.87	2.8		1	ug/L		07/14/03	SW846 5030B	SW846 8260B
1,2-Dibromoethane	< 0.56	0.56	1.8		1	ug/L		07/14/03	SW846 5030B	SW846 8260B
1,2-Dichlorobenzene	< 0.83	0.83	2.6		1	ug/L		07/14/03	SW846 5030B	SW846 8260B
1,2-Dichloroethane	< 0.36	0.36	1.1		1	ug/L		07/14/03	SW846 5030B	SW846 8260B
1,2-Dichloropropane	< 0.46	0.46	1.5		1	ug/L		07/14/03	SW846 5030B	SW846 8260B
1,3,5-Trimethylbenzene	< 0.83	0.83	2.6		1	ug/L		07/14/03	SW846 5030B	SW846 8260B
1,3-Dichlorobenzene	< 0.87	0.87	2.8		1	ug/L		07/14/03	SW846 5030B	SW846 8260B
1,3-Dichloropropane	< 0.61	0.61	1.9		1	ug/L		07/14/03	SW846 5030B	SW846 8260B
1,4-Dichlorobenzene	< 0.95	0.95	3.0		1	ug/L		07/14/03	SW846 5030B	SW846 8260B
2,2-Dichloropropane	< 0.62	0.62	2.0		1	ug/L		07/14/03	SW846 5030B	SW846 8260B
2-Chlorotoluene	< 0.85	0.85	2.7		1	ug/L		07/14/03	SW846 5030B	SW846 8260B
4-Chlorotoluene	< 0.74	0.74	2.4		1	ug/L		07/14/03	SW846 5030B	SW846 8260B
Benzene	< 0.41	0.41	1.3		1	ug/L		07/14/03	SW846 5030B	SW846 8260B
Bromobenzene	< 0.82	0.82	2.6		1	ug/L		07/14/03	SW846 5030B	SW846 8260B
Bromochloromethane	< 0.97	0.97	3.1		1	ug/L		07/14/03	SW846 5030B	SW846 8260B
Bromodichloromethane	< 0.56	0.56	1.8		1	ug/L		07/14/03	SW846 5030B	SW846 8260B
Bromoform	< 0.94	0.94	3.0		1	ug/L		07/14/03	SW846 5030B	SW846 8260B
Bromomethane	< 0.91	0.91	2.9		1	ug/L		07/14/03	SW846 5030B	SW846 8260B
Carbon Tetrachloride	< 0.49	0.49	1.6		1	ug/L		07/14/03	SW846 5030B	SW846 8260B
Chlorobenzene	< 0.41	0.41	1.3		1	ug/L		07/14/03	SW846 5030B	SW846 8260B
Chlorodibromomethane	< 0.81	0.81	2.6		1	ug/L		07/14/03	SW846 5030B	SW846 8260B
Chloroethane	< 0.97	0.97	3.1		1	ug/L		07/14/03	SW846 5030B	SW846 8260B
Chloroform	< 0.37	0.37	1.2		1	ug/L		07/14/03	SW846 5030B	SW846 8260B
Chloromethane	< 0.24	0.24	0.76		1	ug/L		07/14/03	SW846 5030B	SW846 8260B
cis-1,2-Dichloroethene	< 0.83	0.83	2.6		1	ug/L		07/14/03	SW846 5030B	SW846 8260B
cis-1,3-Dichloropropene	< 0.19	0.19	0.61		1	ug/L		07/14/03	SW846 5030B	SW846 8260B
Dibromomethane	< 0.60	0.60	1.9		1	ug/L		07/14/03	SW846 5030B	SW846 8260B
Dichlorodifluoromethane	< 0.99	0.99	3.2		1	ug/L		07/14/03	SW846 5030B	SW846 8260B
Diisopropyl Ether	< 0.76	0.76	2.4		1	ug/L		07/14/03	SW846 5030B	SW846 8260B
Ethylbenzene	< 0.54	0.54	1.7		1	ug/L		07/14/03	SW846 5030B	SW846 8260B
Fluorotrichloromethane	< 0.79	0.79	2.5		1	ug/L		07/14/03	SW846 5030B	SW846 8260B

Analytical Report Number: 836478

Client : MORAIN ENVIRONMENTAL INC

Matrix Type : WATER

Project Name : TECUMSEH GRAFTON

Collection Date : 07/09/03

Project Number : 1177

Report Date : 07/16/03

Field ID : P-5 (RAESS)

Lab Sample Number : 836478-012

VOLATILES

Prep Date: 07/14/03

Analyte	Result	LOD	LOQ	EQL	Dil.	Units	Code	Analysis Date	Prep Method	Analysis Method
Hexachlorobutadiene	< 0.67	0.67	2.1		1	ug/L		07/14/03	SW846 5030B	SW846 8260B
Isopropylbenzene	< 0.59	0.59	1.9		1	ug/L		07/14/03	SW846 5030B	SW846 8260B
Methylene Chloride	< 0.43	0.43	1.4		1	ug/L		07/14/03	SW846 5030B	SW846 8260B
Methyl-tert-butyl-ether	< 0.61	0.61	1.9		1	ug/L		07/14/03	SW846 5030B	SW846 8260B
Naphthalene	< 0.74	0.74	2.4		1	ug/L		07/14/03	SW846 5030B	SW846 8260B
n-Butylbenzene	< 0.93	0.93	3.0		1	ug/L		07/14/03	SW846 5030B	SW846 8260B
n-Propylbenzene	< 0.81	0.81	2.6		1	ug/L		07/14/03	SW846 5030B	SW846 8260B
p-Isopropyltoluene	< 0.67	0.67	2.1		1	ug/L		07/14/03	SW846 5030B	SW846 8260B
sec-Butylbenzene	< 0.89	0.89	2.8		1	ug/L		07/14/03	SW846 5030B	SW846 8260B
Styrene	< 0.86	0.86	2.7		1	ug/L		07/14/03	SW846 5030B	SW846 8260B
tert-Butylbenzene	< 0.97	0.97	3.1		1	ug/L		07/14/03	SW846 5030B	SW846 8260B
Tetrachloroethene	< 0.45	0.45	1.4		1	ug/L		07/14/03	SW846 5030B	SW846 8260B
Toluene	< 0.67	0.67	2.1		1	ug/L		07/14/03	SW846 5030B	SW846 8260B
trans-1,2-Dichloroethene	< 0.89	0.89	2.8		1	ug/L		07/14/03	SW846 5030B	SW846 8260B
trans-1,3-Dichloropropene	< 0.19	0.19	0.61		1	ug/L		07/14/03	SW846 5030B	SW846 8260B
Trichloroethene	0.65	0.48	1.5		1	ug/L	Q	07/14/03	SW846 5030B	SW846 8260B
Vinyl Chloride	< 0.18	0.18	0.57		1	ug/L		07/14/03	SW846 5030B	SW846 8260B
Xylene, o	< 0.83	0.83	2.6		1	ug/L		07/14/03	SW846 5030B	SW846 8260B
Xylenes, m + p	< 1.8	1.8	5.7		1	ug/L		07/14/03	SW846 5030B	SW846 8260B
4-Bromofluorobenzene	112				1	%Recov		07/14/03	SW846 5030B	SW846 8260B
Toluene-d8	117				1	%Recov		07/14/03	SW846 5030B	SW846 8260B
Dibromofluoromethane	118				1	%Recov		07/14/03	SW846 5030B	SW846 8260B

Analytical Report Number: 836478

Client : MORAIN ENVIRONMENTAL INC

Matrix Type : WATER

Project Name : TECUMSEH GRAFTON

Collection Date : 07/09/03

Project Number : 1177

Report Date : 07/16/03

Field ID : PW-30 (HEISER)

Lab Sample Number : 836478-013

VOLATILES

Prep Date: 07/14/03

Analyte	Result	LOD	LOQ	EQL	Dil.	Units	Code	Analysis Date	Prep Method	Analysis Method
1,1,1,2-Tetrachloroethane	< 0.92	0.92	2.9		1	ug/L		07/14/03	SW846 5030B	SW846 8260B
1,1,1-Trichloroethane	1.9	0.90	2.9		1	ug/L	Q	07/14/03	SW846 5030B	SW846 8260B
1,1,2,2-Tetrachloroethane	< 0.20	0.20	0.64		1	ug/L		07/14/03	SW846 5030B	SW846 8260B
1,1,2-Trichloroethane	< 0.42	0.42	1.3		1	ug/L		07/14/03	SW846 5030B	SW846 8260B
1,1-Dichloroethane	4.8	0.75	2.4		1	ug/L		07/14/03	SW846 5030B	SW846 8260B
1,1-Dichloroethene	< 0.57	0.57	1.8		1	ug/L		07/14/03	SW846 5030B	SW846 8260B
1,1-Dichloropropene	< 0.75	0.75	2.4		1	ug/L		07/14/03	SW846 5030B	SW846 8260B
1,2,3-Trichlorobenzene	< 0.74	0.74	2.4		1	ug/L		07/14/03	SW846 5030B	SW846 8260B
1,2,3-Trichloropropane	< 0.99	0.99	3.2		1	ug/L		07/14/03	SW846 5030B	SW846 8260B
1,2,4-Trichlorobenzene	< 0.97	0.97	3.1		1	ug/L		07/14/03	SW846 5030B	SW846 8260B
1,2,4-Trimethylbenzene	< 0.97	0.97	3.1		1	ug/L		07/14/03	SW846 5030B	SW846 8260B
1,2-Dibromo-3-chloropropane	< 0.87	0.87	2.8		1	ug/L		07/14/03	SW846 5030B	SW846 8260B
1,2-Dibromoethane	< 0.56	0.56	1.8		1	ug/L		07/14/03	SW846 5030B	SW846 8260B
1,2-Dichlorobenzene	< 0.83	0.83	2.6		1	ug/L		07/14/03	SW846 5030B	SW846 8260B
1,2-Dichloroethane	< 0.36	0.36	1.1		1	ug/L		07/14/03	SW846 5030B	SW846 8260B
1,2-Dichloropropane	< 0.46	0.46	1.5		1	ug/L		07/14/03	SW846 5030B	SW846 8260B
1,3,5-Trimethylbenzene	< 0.83	0.83	2.6		1	ug/L		07/14/03	SW846 5030B	SW846 8260B
1,3-Dichlorobenzene	< 0.87	0.87	2.8		1	ug/L		07/14/03	SW846 5030B	SW846 8260B
1,3-Dichloropropane	< 0.61	0.61	1.9		1	ug/L		07/14/03	SW846 5030B	SW846 8260B
1,4-Dichlorobenzene	< 0.95	0.95	3.0		1	ug/L		07/14/03	SW846 5030B	SW846 8260B
2,2-Dichloropropane	< 0.62	0.62	2.0		1	ug/L		07/14/03	SW846 5030B	SW846 8260B
2-Chlorotoluene	< 0.85	0.85	2.7		1	ug/L		07/14/03	SW846 5030B	SW846 8260B
4-Chlorotoluene	< 0.74	0.74	2.4		1	ug/L		07/14/03	SW846 5030B	SW846 8260B
Benzene	< 0.41	0.41	1.3		1	ug/L		07/14/03	SW846 5030B	SW846 8260B
Bromobenzene	< 0.82	0.82	2.6		1	ug/L		07/14/03	SW846 5030B	SW846 8260B
Bromochloromethane	< 0.97	0.97	3.1		1	ug/L		07/14/03	SW846 5030B	SW846 8260B
Bromodichloromethane	< 0.56	0.56	1.8		1	ug/L		07/14/03	SW846 5030B	SW846 8260B
Bromoform	< 0.94	0.94	3.0		1	ug/L		07/14/03	SW846 5030B	SW846 8260B
Bromomethane	< 0.91	0.91	2.9		1	ug/L		07/14/03	SW846 5030B	SW846 8260B
Carbon Tetrachloride	< 0.49	0.49	1.6		1	ug/L		07/14/03	SW846 5030B	SW846 8260B
Chlorobenzene	< 0.41	0.41	1.3		1	ug/L		07/14/03	SW846 5030B	SW846 8260B
Chlorodibromomethane	< 0.81	0.81	2.6		1	ug/L		07/14/03	SW846 5030B	SW846 8260B
Chloroethane	< 0.97	0.97	3.1		1	ug/L		07/14/03	SW846 5030B	SW846 8260B
Chloroform	2.2	0.37	1.2		1	ug/L		07/14/03	SW846 5030B	SW846 8260B
Chloromethane	< 0.24	0.24	0.76		1	ug/L		07/14/03	SW846 5030B	SW846 8260B
cis-1,2-Dichloroethene	7.8	0.83	2.6		1	ug/L		07/14/03	SW846 5030B	SW846 8260B
cis-1,3-Dichloropropene	< 0.19	0.19	0.61		1	ug/L		07/14/03	SW846 5030B	SW846 8260B
Dibromomethane	< 0.60	0.60	1.9		1	ug/L		07/14/03	SW846 5030B	SW846 8260B
Dichlorodifluoromethane	< 0.99	0.99	3.2		1	ug/L		07/14/03	SW846 5030B	SW846 8260B
Diisopropyl Ether	< 0.76	0.76	2.4		1	ug/L		07/14/03	SW846 5030B	SW846 8260B
Ethylbenzene	< 0.54	0.54	1.7		1	ug/L		07/14/03	SW846 5030B	SW846 8260B
Fluorotrichloromethane	< 0.79	0.79	2.5		1	ug/L		07/14/03	SW846 5030B	SW846 8260B

Analytical Report Number: 836478

Client : MORAIN ENVIRONMENTAL INC

Matrix Type : WATER

Project Name : TECUMSEH GRAFTON

Collection Date : 07/09/03

Project Number : 1177

Report Date : 07/16/03

Field ID : PW-30 (HEISER)

Lab Sample Number : 836478-013

VOLATILES

Prep Date: 07/14/03

Analyte	Result	LOD	LOQ	EQL	Dil.	Units	Code	Analysis Date	Prep Method	Analysis Method
Hexachlorobutadiene	< 0.67	0.67	2.1		1	ug/L		07/14/03	SW846 5030B	SW846 8260B
Isopropylbenzene	< 0.59	0.59	1.9		1	ug/L		07/14/03	SW846 5030B	SW846 8260B
Methylene Chloride	< 0.43	0.43	1.4		1	ug/L		07/14/03	SW846 5030B	SW846 8260B
Methyl-tert-butyl-ether	< 0.61	0.61	1.9		1	ug/L		07/14/03	SW846 5030B	SW846 8260B
Naphthalene	< 0.74	0.74	2.4		1	ug/L		07/14/03	SW846 5030B	SW846 8260B
n-Butylbenzene	< 0.93	0.93	3.0		1	ug/L		07/14/03	SW846 5030B	SW846 8260B
n-Propylbenzene	< 0.81	0.81	2.6		1	ug/L		07/14/03	SW846 5030B	SW846 8260B
p-Isopropyltoluene	< 0.67	0.67	2.1		1	ug/L		07/14/03	SW846 5030B	SW846 8260B
sec-Butylbenzene	< 0.89	0.89	2.8		1	ug/L		07/14/03	SW846 5030B	SW846 8260B
Styrene	< 0.86	0.86	2.7		1	ug/L		07/14/03	SW846 5030B	SW846 8260B
tert-Butylbenzene	< 0.97	0.97	3.1		1	ug/L		07/14/03	SW846 5030B	SW846 8260B
Tetrachloroethene	< 0.45	0.45	1.4		1	ug/L		07/14/03	SW846 5030B	SW846 8260B
Toluene	< 0.67	0.67	2.1		1	ug/L		07/14/03	SW846 5030B	SW846 8260B
trans-1,2-Dichloroethene	< 0.89	0.89	2.8		1	ug/L		07/14/03	SW846 5030B	SW846 8260B
trans-1,3-Dichloropropene	< 0.19	0.19	0.61		1	ug/L		07/14/03	SW846 5030B	SW846 8260B
Trichloroethene	9.6	0.48	1.5		1	ug/L		07/14/03	SW846 5030B	SW846 8260B
Vinyl Chloride	< 0.18	0.18	0.57		1	ug/L		07/14/03	SW846 5030B	SW846 8260B
Xylene, o	< 0.83	0.83	2.6		1	ug/L		07/14/03	SW846 5030B	SW846 8260B
Xylenes, m + p	< 1.8	1.8	5.7		1	ug/L		07/14/03	SW846 5030B	SW846 8260B
4-Bromofluorobenzene	112				1	%Recov		07/14/03	SW846 5030B	SW846 8260B
Toluene-d8	117				1	%Recov		07/14/03	SW846 5030B	SW846 8260B
Dibromofluoromethane	119				1	%Recov		07/14/03	SW846 5030B	SW846 8260B

Qualifier Codes

Flag	Applies To	Explanation
A	Inorganic	Analyte is detected in the method blank. Method blank criteria is evaluated to the laboratory method detection limit. Additionally, method blank acceptance may be based on project specific criteria or determined from analyte concentrations in the sample and are evaluated on a sample by sample basis.
B	Inorganic	The analyte has been detected between the method detection limit and the reporting limit.
B	Organic	Analyte is present in the method blank. Method blank criteria is evaluated to the laboratory method detection limit. Additionally, method blank acceptance may be based on project specific criteria or determined from analyte concentrations in the sample and are evaluated on a sample by sample basis.
C	All	Elevated detection limit.
D	All	Analyte value from diluted analysis or surrogate result not applicable due to sample dilution.
E	Inorganic	Estimated concentration due to matrix interferences. During the metals analysis using the inductively coupled plasma (ICP), the serial dilution failed to meet the established control limits of 0-10% and the sample concentration is greater than 50 times the IDL (100 times the IDL for analysis done on the ICP-MS). The result was flagged with the E qualifier to indicate that a physical interference was observed.
E	Organic	Analyte concentration exceeds calibration range.
F	Inorganic	Due to potential interferences for this analysis by Inductively Coupled Plasma techniques (SW-846 Method 6010), this analyte has been confirmed by and reported from an alternate method.
F	Organic	Surrogate results outside control criteria.
H	All	Preservation, extraction or analysis performed past holding time.
J	Inorganic	The analyte has been detected between the method detection limit and the reporting limit.
J	Organic	Concentration detected is greater than the method detection limit but less than the reporting limit.
K	Inorganic	Sample received unpreserved. Sample was either preserved at the time of receipt or at the time of sample preparation.
K	Organic	Detection limit may be elevated due to the presence of an unrequested analyte.
L	All	Elevated detection limit due to low sample volume.
N	All	Spiked sample recovery not within control limits.
P	Organic	The relative percent difference between the two columns for detected concentrations was greater than 40%.
Q	All	The analyte has been detected between the limit of detection (LOD) and limit of quantitation (LOQ). The results are qualified due to the uncertainty of analyte concentrations within this range.
S	Organic	The relative percent difference between quantitation and confirmation columns exceeds internal quality control criteria. Because the result is unconfirmed, it has been reported as a non-detect with an elevated detection limit.
U	All	The analyte was not detected at or above the reporting limit.
V	All	Sample received with headspace.
W	All	A second aliquot of sample was analyzed from a container with headspace.
X	All	See Sample Narrative.
&	All	Laboratory Control Spike recovery not within control limits.
*	All	Precision not within control limits.
<	All	The analyte was not detected at or above the reporting limit.
1	Inorganic	Dissolved analyte or filtered analyte greater than total analyte; analyses passed QC based on precision criteria.
2	Inorganic	Dissolved analyte or filtered analyte greater than total analyte; analyses failed QC based on precision criteria.
3	Inorganic	BOD result is estimated due to the BOD blank exceeding the allowable oxygen depletion.
4	Inorganic	BOD duplicate precision not within control limits. Due to the 48 hour holding time for this test, it is not practical to reanalyze and try to correct the deficiency.
5	Inorganic	BOD result is estimated due to insufficient oxygen depletion. Due to the 48 hour holding time for this test, it is not practical to reanalyze and try to correct the deficiency.
6	Inorganic	BOD laboratory control sample not within control limits. Due to the 48 hour holding time for this test, it is not practical to reanalyze and try to correct the deficiency.
7	Inorganic	BOD result is estimated due to complete oxygen depletion. Due to the 48 hour holding time for this test, it is not practical to reanalyze and try to correct the deficiency.

Test Group Name	836478-013	836478-012	836478-011	836478-010	836478-009	836478-008	836478-007	836478-006	836478-005	836478-004	836478-003	836478-002	836478-001
VOLATILES	G	G	G	G	G	G	G	G	G	G	G	G	G

Wisconsin Certification	
G = En Chem Green Bay	405132750 / DATCP: 105 000444
K = En Chem Kimberly	445134030
S = Subcontracted Analysis	

En Chem, Inc. Cooler Receipt Log

Batch No. 836478

Project Name or ID Moraine No. of Coolers: 1 Temps: ROT

A. Receipt Phase: Date cooler was opened: 7/10/13 By: JR

- 1: Were samples received on ice? (Must be ≤ 6 C).....YES² NO²
- 2: Was there a Temperature Blank?.....YES NO
- 3: Were custody seals present and intact? (Record on COC).....YES NO
- 4: Are COC documents present?.....YES NO²
- 5: Does this Project require quick turn around analysis?.....YES NO
- 6: Is there any sub-work?.....YES NO
- 7: Are there any short hold time tests?.....YES NO
- 8: Are any samples nearing expiration of hold-time? (Within 2 days).....YES¹ NO Contacted by/Who _____
- 9: Do any samples need to be Filtered or Preserved in the lab?.....YES¹ NO Contacted by/Who _____

B. Check-in Phase: Date samples were Checked-in: 7/10/13 By: JR

- 1: Were all sample containers listed on the COC received and intact?.....YES NO² NA
- 2: Sign the COC as received by En Chem. Completed.....YES NO
- 3: Do sample labels match the COC?YES NO²
- 4: Completed pH check on preserved samples.....YES NO NA
(This statement does not apply to water: VOC, O&G, TOC, DRO, Total Rec. Phenolics)
- 5: Do samples have correct chemical preservation?.....YES NO² NA
(This statement does not apply to water: VOC, O&G, TOC, DRO, Total Rec. Phenolics)
- 6: Are dissolved parameters field filtered?.....YES NO² NA
- 7: Are sample volumes adequate for tests requested?YES NO²
- 8: Are VOC samples free of bubbles >6mmYES¹ NO² NA
- 9: Enter samples into logbook. Completed.....YES NO
- 10: Place laboratory sample number on all containers and COC. Completed.....YES NO
- 11: Complete Laboratory Tracking Sheet (LTS). Completed.....YES NO NA
- 12: Start Nonconformance form.YES NO NA
- 13: Initiate Subcontracting procedure. Completed.....YES NO NA
- 14: Check laboratory sample number on all containers and COC.CB YES NO NA

Short Hold-time tests:

48 Hours or less	7 days	Footnotes 1 Notify proper lab group immediately. 2 Complete nonconformance memo.
Coliform (6 hrs)	Flashpoint	
Hexavalent Chromium (24 Hrs)	TSS	
BOD	Total Solids	
Nitrite or Nitrate	TDS	
Low Level Mercury	Sulfide	
Ortho Phosphorus	Free Liquids	
Turbidity	Total Volatile Solids	
Surfactants	Aqueous Extractable Organics- ALL	
Sulfite	Unpreserved VOC's	
En Core Preservation	Ash	
Color		

Rev. 4/11/03, Attachment to 1-REC-5.
Subject to QA Audit.

Reviewed by/date EB 7/14/03

(Please Print Legibly)

Company Name: _____

Branch or Location: _____

Project Contact: _____

Telephone: _____

Project Number: _____

Project Name: _____

Project State: _____

Sampled By (Print): _____



1241 Bellevue St., Suite 9
Green Bay, WI 54302
920-469-2436
FAX 920-469-8827

525 Science Drive
Madison, WI 53711
608-232-3300
FAX: 608-233-0502

CHAIN OF CUSTODY

A=None B=HCL C=H2SO4 H = Sodium Bisulfate Solution
*Preservation Codes D=HNO3 E=EnCore F=Methanol G=NaOH
J = Sodium Thiosulfate I = Other
FILTERED? (YES/NO) _____
PRESERVATION (CODE)* _____

Page _____ of _____

P.O. # _____ Quote # _____

Mail Report To: _____

Company: _____

Address: _____

Invoice To: _____

Company: _____

Address: _____

Mail Invoice To: _____

Data Package Options - (please circle if requested)

Sample Results Only (no QC)
EPA Level II (Subject to Surcharge)
EPA Level III (Subject to Surcharge)
EPA Level IV (Subject to Surcharge)

Regulatory Program
UST
RCRA
SDWA
NPDES
CERCLA

Matrix Codes
W=Water
S=Soil
A=Air
C=Charcoal
B=Biota
Sl=Sludge

ANALYSES REQUESTED

TOTAL # OF BOTTLES SENT

LABORATORY ID (Lab Use Only)	FIELD ID	COLLECTION		MATRIX	ANALYSES REQUESTED	TOTAL # OF BOTTLES SENT	CLIENT COMMENTS	LAB COMMENTS (Lab Use Only)
		DATE	TIME					

Rush Turnaround Time Requested (TAT) - Prelim
(Rush TAT subject to approval/surcharge)
Date Needed: _____
Transmit Prelim Rush Results by (circle):
Phone Fax E-Mail
Phone #: _____
Fax #: _____
E-Mail Address: _____

Relinquished By: _____ Date/Time: _____
Relinquished By: _____ Date/Time: _____
Relinquished By: _____ Date/Time: _____
Relinquished By: _____ Date/Time: _____
Relinquished By: _____ Date/Time: _____

Received By: _____ Date/Time: _____
Received By: _____ Date/Time: _____
Received By: _____ Date/Time: _____
Received By: _____ Date/Time: _____
Received By: _____ Date/Time: _____

En Chem Project No.
Sample Receipt Temp.
Sample Receipt pH (Wev/Metals)
Cooler Custody Seal
Present / Not Present
Intact / Not Intact

Samples on HOLD are subject to special pricing and release of liability

(Please Print Legibly)
 Company Name: _____
 Branch or Location: _____
 Project Contact: _____
 Telephone: _____
 Project Number: _____
 Project Name: _____
 Project State: _____
 Sampled By (Print): _____



1241 Bellevue St., Suite 9
 Green Bay, WI 54302
 920-469-2436
 FAX 920-469-8827

525 Science Drive
 Madison, WI 53711
 608-232-3300
 FAX: 608-233-0502

CHAIN OF CUSTODY

A=None B=HCL C=H2SD4 *Preservation Codes
 H = Sodium Bisulfate Solution D=HNO3 E=EnCore F=Methanol G=NaOH
 I = Sodium Thiosulfate J = Other
 FILTERED? (YES/NO) _____
 PRESERVATION (CODE)* _____

ANALYSES REQUESTED

TOTAL # OF BOTTLES SENT

Data Package Options - (please circle if requested)

Sample Results Only (no QC)
 EPA Level II (Subject to Surcharge)
 EPA Level III (Subject to Surcharge)
 EPA Level IV (Subject to Surcharge)

Regulatory Program	Matrix Codes
<input type="checkbox"/> UST <input type="checkbox"/> RCRA <input type="checkbox"/> SDWA <input type="checkbox"/> NPDES <input type="checkbox"/> CERCLA	<input type="checkbox"/> W=Water <input type="checkbox"/> S=Soil <input type="checkbox"/> A=Air <input type="checkbox"/> C=Charcoal <input type="checkbox"/> B=Biota <input type="checkbox"/> Sl=Sludge

Page _____ of _____
 P.O. # _____ Quote # _____
 Mail Report To: _____
 Company: _____
 Address: _____
 Invoice To: _____
 Company: _____
 Address: _____
 Mail Invoice To: _____

LABORATORY ID (Lab Use Only)	FIELD ID	COLLECTION		MATRIX	ANALYSES REQUESTED	TOTAL # OF BOTTLES SENT	CLIENT COMMENTS	LAB COMMENTS (Lab Use Only)
		DATE	TIME					

Rush Turnaround Time Requested (TAT) - Prelim (Rush TAT subject to approval/surcharge) Date Needed: _____ Transmit Prelim Rush Results by (circle): Phone Fax E-Mail Phone #: _____ Fax #: _____ E-Mail Address: _____ Samples on HOLD are subject to special pricing and release of liability	Relinquished By: _____ Date/Time: _____	Received By: _____ Date/Time: _____	En Chem Project No. _____
	Relinquished By: _____ Date/Time: _____	Received By: _____ Date/Time: _____	Sample Receipt Temp. _____
	Relinquished By: _____ Date/Time: _____	Received By: _____ Date/Time: _____	Sample Receipt pH (Wet/Metals) _____
	Relinquished By: _____ Date/Time: _____	Received By: _____ Date/Time: _____	Cooler Custody Seal Present / Not Present _____
	Relinquished By: _____ Date/Time: _____	Received By: _____ Date/Time: _____	Intact / Not Intact _____

ATTACHMENT B

PREVIOUS ANALYTICAL SUMMARY TABLES

TABLE 2
TECUMSEH PRODUCTS CO. - GRAFTON FACILITY
DECEMBER, 2002 GROUNDWATER LAB RESULTS

Sample I.D.	Collection Date	Detected VOCs								
		Chloroethane	1,1-Dichloroethene	cis-1,2-Dichloroethene	trans-1,2-Dichloroethene	1,1-Dichloroethane	Methylene chloride	1,1,1-Trichloroethane	Trichloroethene	Vinyl Chloride
MW-3D	12/10/02	2.6 Q	<0.56	<0.81	<0.8	31.0	<0.47	<0.65	<0.39	<0.11
MW-3BR(2)	12/10/02	<0.84	6.2	31.0	<0.8	38.0	0.59 Q	15.0	120.0	1.90
MW-9	12/10/02	<8.4	34.0	370.0	<8.0	110.0	<4.7	220.0	1,500.0	24.00
MW-12	12/10/02	<17	22 Q	20 Q	<16.0	36 Q	<9.4	250.0	2,400.0	<2.2
MW-13BR(2)	12/10/02	<4.2	100.0	50.0	<4.0	370.0	<2.3	570.0	500.0	<0.55
MW-18BR(1)	12/10/02	<0.84	2.1	10.0	<0.8	18.0	<0.47	6.5	22.0	<0.11
MW-18BR(2)	12/10/02	<0.84	8.2	35.0	0.88 Q	59.0	0.65 Q	25.0	64.0	<0.11
MW-19BR(1)	12/10/02	<1.7	12.0	52.0	<1.6	84.0	<0.94	1.4 Q	280.0	2.60
MW-20BR(1)	12/10/02	<0.84	<0.56	<0.81	<0.8	<0.87	<0.47	<0.65	<0.39	<0.11
MW-20BR(2)	12/10/02	<0.84	<0.56	<0.81	<0.8	<0.87	<0.47	<0.65	<0.39	<0.11
MW-21BR(1)	12/10/02	<0.84	<0.56	<0.81	<0.8	<0.87	0.67 Q	<0.65	<0.39	<0.11
MW-21BR(2)	12/10/02	<0.84	<0.56	<0.81	<0.8	<0.87	0.54 Q	<0.65	<0.39	<0.11
MW-22BR	12/10/02	<0.84	<0.56	18.0	<0.8	<0.87	<0.47	<0.65	24.0	<0.11
PW-5 (RAESS)	12/10/02	<0.84	<0.56	<0.81	<0.8	1.1 Q	<0.47	1.2 Q	0.84 Q	<0.11
ESs (NR 140)		NSE	7.0	70.0	100.0	850.0	5.0	200.0	5.0	0.20
PALs (NR 140)		NSE	0.7	7.0	20.0	85.0	0.5	40.0	0.5	0.02

Notes:

All concentrations reported in ug/kg = micrograms per kilogram = parts per billion (ppb)

Q - parameter detected below quantitative limit (qualified results)

NSE - No Standard Established

Outlined and **Bold** results indicate concentrations exceeding WDNR Enforcement Standards (ESs), per NR 140

Italicized and **Bold** results indicate concentrations exceeding WDNR Preventative Action Limits (PALs), per NR 140

ATTACHMENT C

SAMPLED WELL LOCATIONS

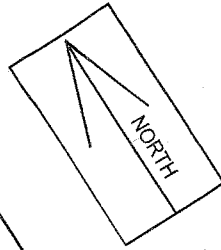

PW-38 (WENDTLAND)

PW-5 (RAESS)

MW-12

MW-12 BR PW-30 (HEISER)

MW-13 BR

MW-9 / MW-9D

MW-3 BR

MW-3D

MW-22 BR

MW-18 BR

MW-19 BR

MW-20 BR

MW-21 BR

TECUMSEH-GRAFTON
FACILITY

8th AVENUE

GREEN BAY ROAD

WASHINGTON STREET

12th AVENUE

GRAFTON AVENUE

17th AVENUE

MILWAUKEE RIVER

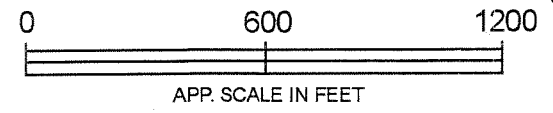

SAMPLED WELL LOCATIONS
TECUMSEH PRODUCTS CO.,
GRAFTON, WI