

EMERGENCY
RESPONSE
PLAN

Volume II

APPENDICES: PAGES 42-116+



APPENDIX A

FACILITY MAPS

1. TOPOGRAPHIC MAP
2. STORM SEWER/SURFACE DRAINAGE
3. PLANT MANHOLES
4. SANITARY SEWER SYSTEM
5. GROUNDWATER COLLECTION SYSTEM
6. SPRINKLER & WATER LINES
7. NATURAL GAS LINES
8. UNDERGROUND ELECTRICAL & TELEPHONE LINES

57°30''

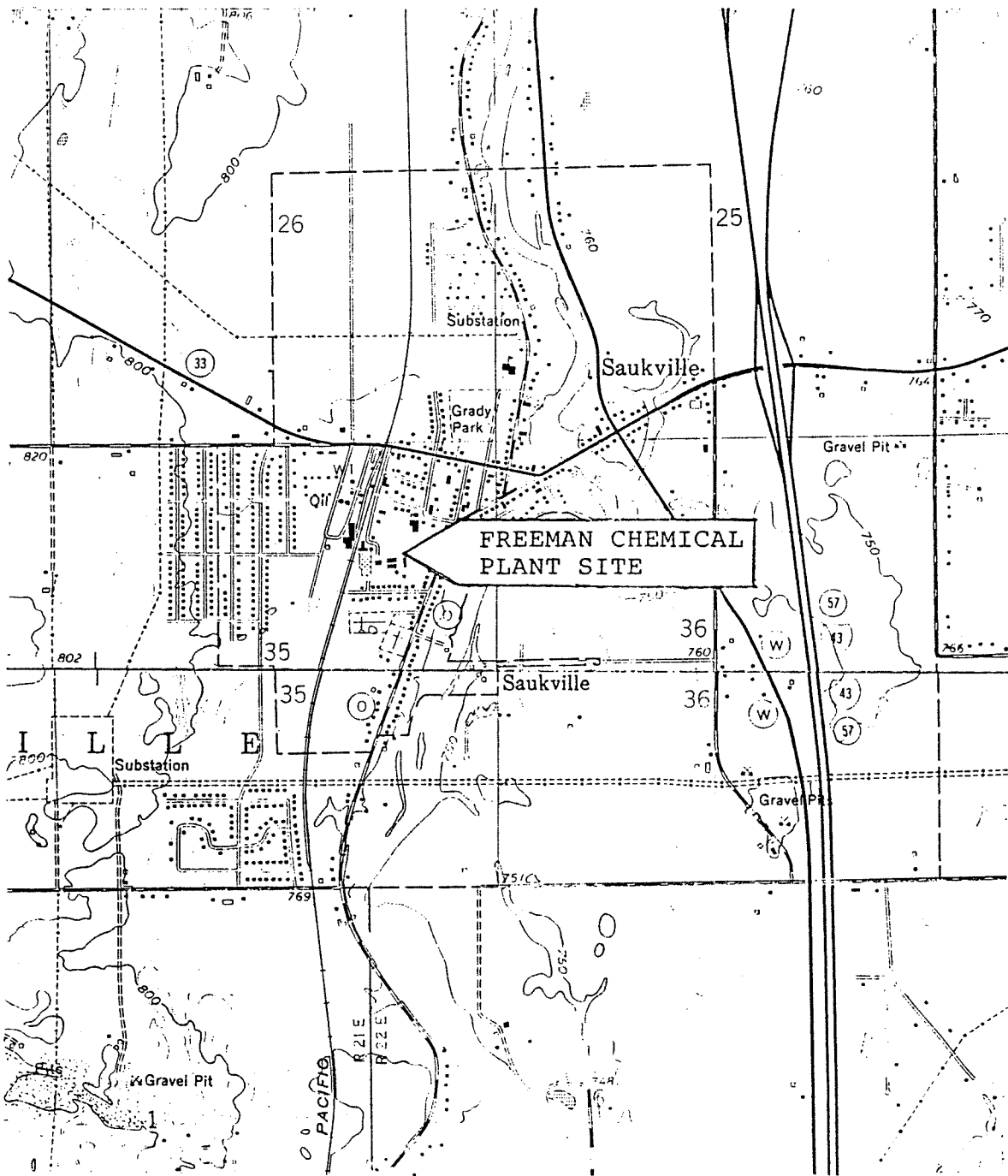

FREEMAN CHEMICAL
PLANT SITE

SCALE 1:24 000

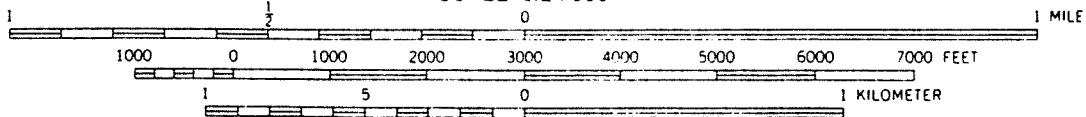

CONTOUR INTERVAL 10 FEET
NATIONAL GEODETIC VERTICAL DATUM OF 1929
DEPTH CURVES AND SOUNDINGS IN FEET—DATUM IS 578 FEET

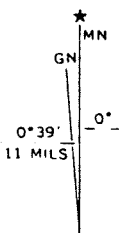

PORT WASHINGTON WEST, WIS.
NW/4 PORT WASHINGTON 15' QUADRANGLE
N4322.5—W8752.5/7.5

UTM GRID AND 1976 MAGNETIC NORTH
DECLINATION AT CENTER OF SHEET

2-3

1959
PHOTOREVISED 1971 AND 1976
AMS 3470 IV NW SERIES V861

KEY:

- | | |
|------------------------------|----------------------------------|
| 1 BOILER ROOM | 40 HOT ROOM |
| 2 STORAGE ROOM | 41 EAST LOADING DOCK |
| 3 KETTLE ROOM | 42 SHED WAREHOUSE |
| 4 THINNING ROOM | 44 WAREHOUSE |
| 5 KETTLE ROOM | 45 WAREHOUSE |
| 6 THINNING ROOM | 46 R.F.P. APPLICATION LABORATORY |
| 7 FOAM LABORATORY | 47 POLYESTER STORAGE ROOM |
| 8 TANK FARM | 48 DRUM FILLING FACILITY |
| 9 CONTROL LABORATORY | 49 FIRE EQUIPMENT SHED |
| 10 STORAGE TANK ROOM | 50 MAINTENANCE STORAGE SHED |
| 11 TANK WAGON LOADING SHED | 51 MAINTENANCE STORAGE SHED |
| 13 WAREHOUSE RAW - MATERIALS | 52 MAINTENANCE PIPE SLABS |
| 16 TANK STORAGE ROOM | 53 FOREMAN OFFICE |
| 17 TANK STORAGE ROOM | 54 ELECTRICAL CONTROL ROOM |
| 18 THINNING ROOM | 55 FOAM RAW MATERIAL |
| 18 ELECTRICAL CONTROL ROOM | 55 FOAM MFC |
| 19 SPECIAL PROCESS ROOM | 56 ELECTRICAL CONTROL ROOM |
| 20 KETTLE ROOM | 57 TECHNICAL LAB. NO. 3 & 4 |
| 20 THERMINOL BOILER ROOM | 58 GARAGE |
| 20 BOILER ROOM | 60 CONTROL ROOM |
| 20 SURGE ROOM | 61 BACKFLOW PREVENT. HSE. |
| 20 ELECTRICAL CONTROL ROOM | 64 GROUND WATER PUMP HSE |
| 31 GARAGE | 65 TANK FARM PUMP HSE |
| 31 OFFICES AND LOCKER ROOM | 66 TANK FARM RISER ROOM |
| 32 WAREHOUSE | 67 TANK FARM UNLOADING BAY |
| 33 MAINTENANCE | 68 LIQUID INCINERATOR |
| 34 WAREHOUSE | 69 INCINERATOR TANK STORAGE |
| 35 NITROGEN STORAGE | 70 INCINERATOR COMP. ROOM |
| 36 INCINERATORS | 71 RUNOFF CATCH BASIN |
| 37 LOADING DOCK | 72 TRUCK PARKING |
| 38 WATER TANK | 73 RAILROAD BASH |
| 39 ENGINEERING OFFICE | |
| 39 FIRE PUMP ROOM | |

LEGEND:

- | | |
|--------|------------------------|
| • | HYDRANT |
| ○ | DRAIN |
| ○ | MANHOLE |
| □ | CATCH BASIN |
| — | POST INDICATOR VALVE |
| --- | POLYDRAIN |
| --- | LATERAL (6" DIA.) |
| --- | SEWER NOT IN SERVICE |
| --- | PLANT STORM SEWER |
| --- | RIVER STORM SEWER |
| --- | FENCE |
| • P.H. | PUMPER HOSE CONNECTION |

UTILITY DATA

DWG. NO.	DESCRIPTION
D-256-C	PLANT
D-256-1	STORM
D-256-2	STORM
D-256-3	STORM
D-256-4	STORM
D-256-5	STORM
D-256-6	STORM
D-256-7	STORM



NOTE: THIS PLAN IS A REVISION OF THE PLAN DATED 1986 AND MADE BY THE ENGINEER IN CHARGE IN 1986.

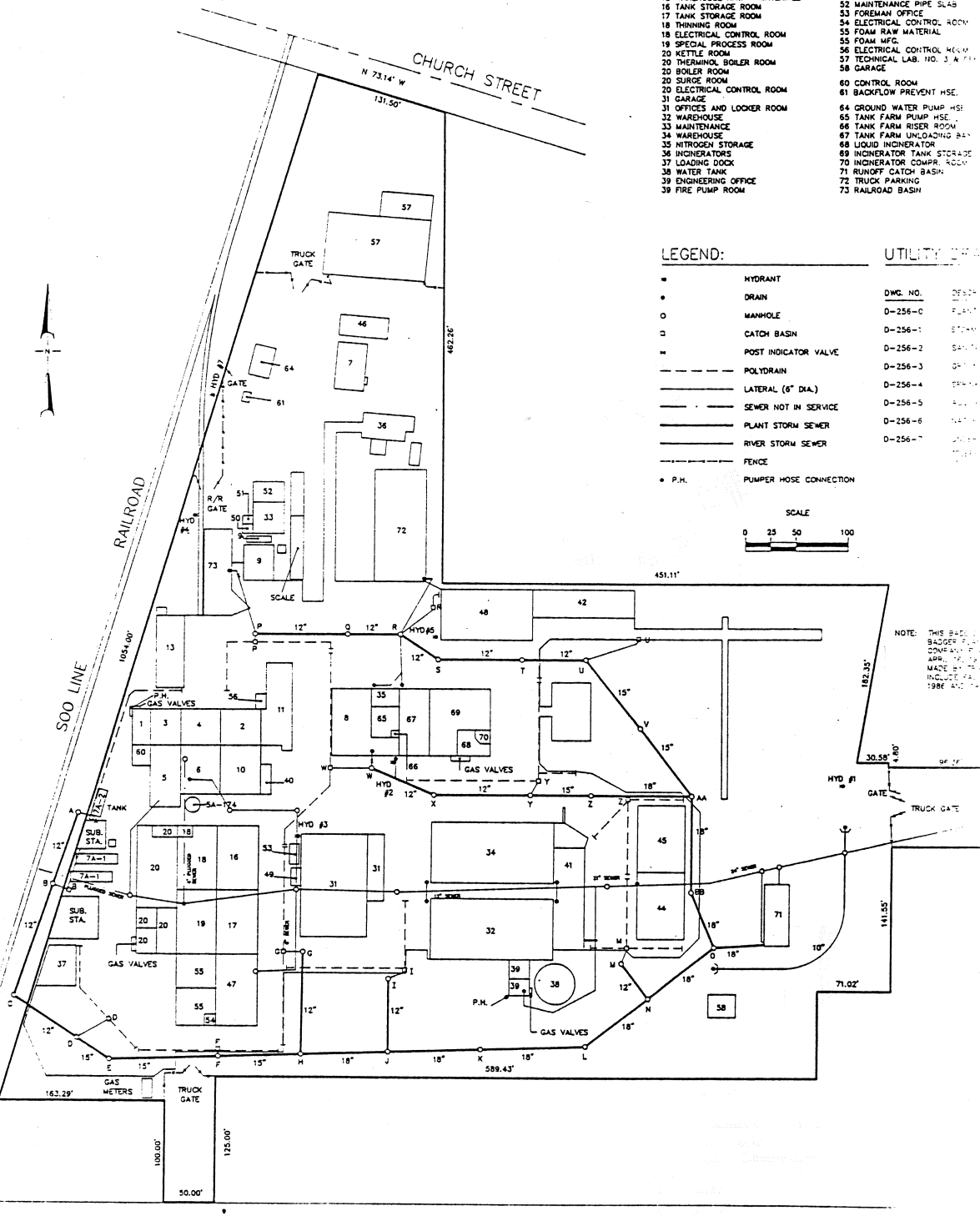

LINDEN STREET

SCALE 1" = 50'
DATE 10/7/87

STORM SEWER/SURFACE DRAINAGE

FREEMAN CHEMICAL CORP.
SAUKVILLE, WISCONSIN

TRIAD
ENGINEERING
INCORPORATED

- | | |
|----------------------------|----------------------------------|
| 1 BOILER ROOM | 40 HOT ROOM |
| 2 STORAGE ROOM | 41 EAST LOADING DOCK |
| 3 KETTLE ROOM | 42 SHED WAREHOUSE |
| 4 THINNING ROOM | 44 WAREHOUSE |
| 5 KETTLE ROOM | 45 WAREHOUSE |
| 6 THINNING ROOM | 46 R.F.P. APPLICATION LABORATORY |
| 7 FOAM LABORATORY | 47 POLYESTER STORAGE ROOM |
| 8 TANK FARM | 48 DRUM FILLING FACILITY |
| 9 CONTROL LABORATORY | 49 FIRE EQUIPMENT SHED |
| 10 STORAGE TANK ROOM | 50 MAINTENANCE STORAGE SHED |
| 11 TANK WAGON LOADING SHED | 51 MAINTENANCE STORAGE SHED |
| 13 WAREHOUSE RAW MATERIALS | 52 MAINTENANCE PIPE SLAB |
| 16 TANK STORAGE ROOM | 53 FOREMAN OFFICE |
| 17 TANK STORAGE ROOM | 54 ELECTRICAL CONTROL ROOM |
| 18 THINNING ROOM | 55 FOAM RAW MATERIAL |
| 18 ELECTRICAL CONTROL ROOM | 56 ELECTRICAL CONTROL ROOM |
| 19 SPECIAL PROCESS ROOM | 57 TECHNICAL LAB. NO. 3 & OFFICE |
| 20 KETTLE ROOM | 58 GARAGE |
| 20 THERMAL BOILER ROOM | 60 CONTROL ROOM |
| 20 BOILER ROOM | 61 BACKFLOW PREVENT. HSE. |
| 20 SURGE ROOM | 64 GROUND WATER PUMP HSE. |
| 20 ELECTRICAL CONTROL ROOM | 65 TANK FARM PUMP HSE. |
| 31 GARAGE | 66 TANK FARM RISER ROOM |
| 31 OFFICES AND LOCKER ROOM | 67 TANK FARM UNLOADING BAY |
| 32 WAREHOUSE | 68 LIQUID INCINERATOR |
| 33 MAINTENANCE | 69 INCINERATOR TANK STORAGE |
| 34 WAREHOUSE | 70 INCINERATOR COMPX. ROOM |
| 35 NITROGEN STORAGE | 71 RUNOFF CATCH BASIN |
| 36 INCINERATORS | 72 TRUCK PARKING |
| 37 LOADING DOCK | 73 RAILROAD BASIN |
| 38 WATER TANK | |
| 39 ENGINEERING OFFICE | |
| 39 FIRE PUMP ROOM | |

LEGEND:

- HYDRANT
- P.H. PUMPER HOSE CONNECTION
- S.M. SANITARY MANHOLE
- PLANT STORM SEWER MANHOLE
- RIVER STORM SEWER MANHOLE
- SHALLOW WELL
- ▲ DEEP DOLOMITE WELL
- ▲ METERING MANHOLE
- RANNEY COLLECTOR
- STORM SEWER CATCH BASIN
- FENCE

UTILITY DEPT.

- | | |
|----------|-------------|
| DWG. NO. | DESCRIPTION |
| D-256-0 | PLANT |
| D-256-1 | STORM |
| D-256-2 | SANITARY |
| D-256-3 | GRASS |
| D-256-4 | SHRUB |
| D-256-5 | ASPH. |
| D-256-6 | NAT. GAS |
| D-256-7 | UNDER |
| | TELEPH. |

SCALE

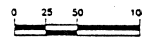

NOTE: THIS PLAN WAS MADE BY THE BADGER ENGINEERING COMPANY, INC. IN APRIL, 1987. IT INCLUDES ALL CHANGES MADE BY THE COMPANY SINCE 1986.

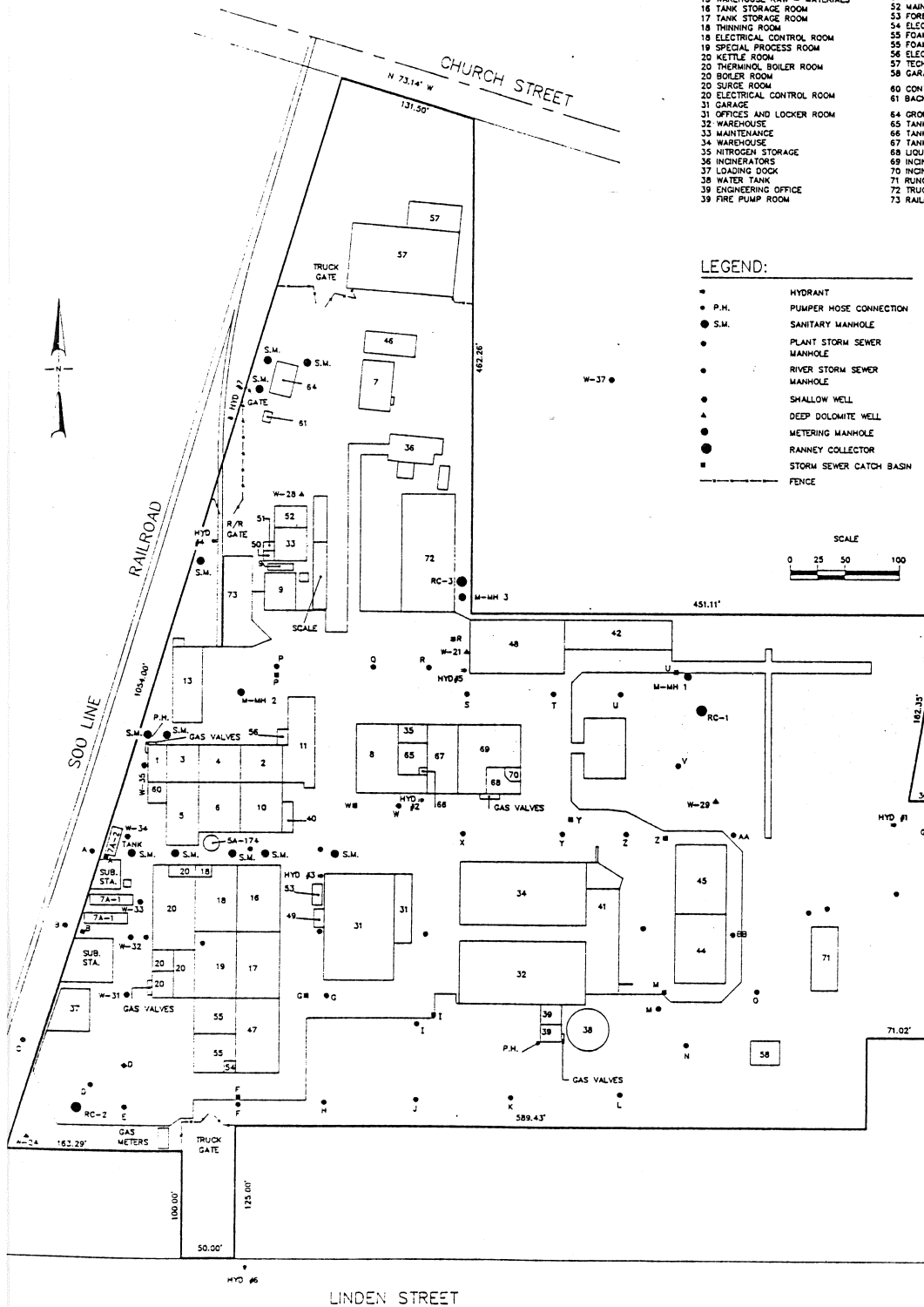

LINDEN STREET

SCALE 1"=50'
DATE 10/7/87

DESIGNED BY D.J.S.

PLANT MANHOLES

FREEMAN CHEMICAL CORP.
SAUKVILLE, WISCONSIN

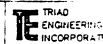

FREEMAN CHEMICAL CORPORATION

SAUKVILLE, WISCONSIN

KEY:

- | | |
|------------------------------|-------------------------------|
| 1 BOILER ROOM | 40 HOT ROOM |
| 2 STORAGE ROOM | 41 EAST LOADING DOCK |
| 3 KETTLE ROOM | 42 SHED WAREHOUSE |
| 4 THINNING ROOM | 44 WAREHOUSE |
| 5 KETTLE ROOM | 45 WAREHOUSE |
| 6 THINNING ROOM | 46 R.F.P. APPLICATION |
| 7 FOAM LABORATORY | 47 POLYESTER STORAGE |
| 8 TANK FARM | 48 DRUM FILLING FACILITY |
| 9 CONTROL LABORATORY | 49 FIRE EQUIPMENT SHED |
| 10 STORAGE TANK ROOM | 50 MAINTENANCE STORAGE |
| 11 TANK WAGON LOADING SHED | 51 MAINTENANCE STORAGE |
| 13 WAREHOUSE RAW - MATERIALS | 52 MAINTENANCE PIPE FLAG |
| 16 TANK STORAGE ROOM | 53 FOREMAN OFFICE |
| 17 TANK STORAGE ROOM | 54 ELECTRICAL CONTROL |
| 18 THINNING ROOM | 55 FOAM RAW MATERIAL |
| 18 ELECTRICAL CONTROL ROOM | 56 ELECTRICAL CONTROL |
| 19 SPECIAL PROCESS ROOM | 57 TECHNICAL LAB. INSTRUMENTS |
| 20 KETTLE ROOM | 58 GARAGE |
| 20 THERMINOL BOILER ROOM | 60 CONTROL ROOM |
| 20 BOILER ROOM | 61 BACKFLOW PREVENTION |
| 20 SURGE ROOM | 64 GROUND WATER PUMP |
| 20 ELECTRICAL CONTROL ROOM | 65 TANK FARM PUMP |
| 31 GARAGE | 66 TANK FARM RISER |
| 31 OFFICES AND LOCKER ROOM | 67 TANK FARM DISCHARGE |
| 32 WAREHOUSE | 68 LIQUID INCINERATOR |
| 33 MAINTENANCE | 69 INCINERATOR TANK |
| 34 WAREHOUSE | 70 INCINERATOR COVER |
| 35 NITROGEN STORAGE | 71 RUNOFF CATCH BASIN |
| 36 INCINERATORS | 72 TRUCK PARKING |
| 37 LOADING DOCK | 73 RAILROAD BASIN |
| 38 WATER TANK | |
| 39 ENGINEERING OFFICE | |
| 39 FIRE PUMP ROOM | |

LEGEND:

- | | | |
|-----|-----------------------|---------|
| • | HYDRANT | |
| □ | FLOOR DRAIN | DWC-NC |
| □ | ROOF DRAINS | D-256-0 |
| • | PLUGGED DRAIN | D-256-1 |
| • | SUMP PUMP | D-256-2 |
| • | SANITARY MANHOLE | D-256-3 |
| ○ | VENT | D-256-4 |
| ○ | CLEAN OUT | D-256-4 |
| ⊙ | SINK OR BUBBLER DRAIN | D-256-5 |
| --- | DISCONNECTED SEWER | D-256-6 |
| --- | SANITARY SEWER | D-256-7 |
| --- | FENCE | |

UTILITIES

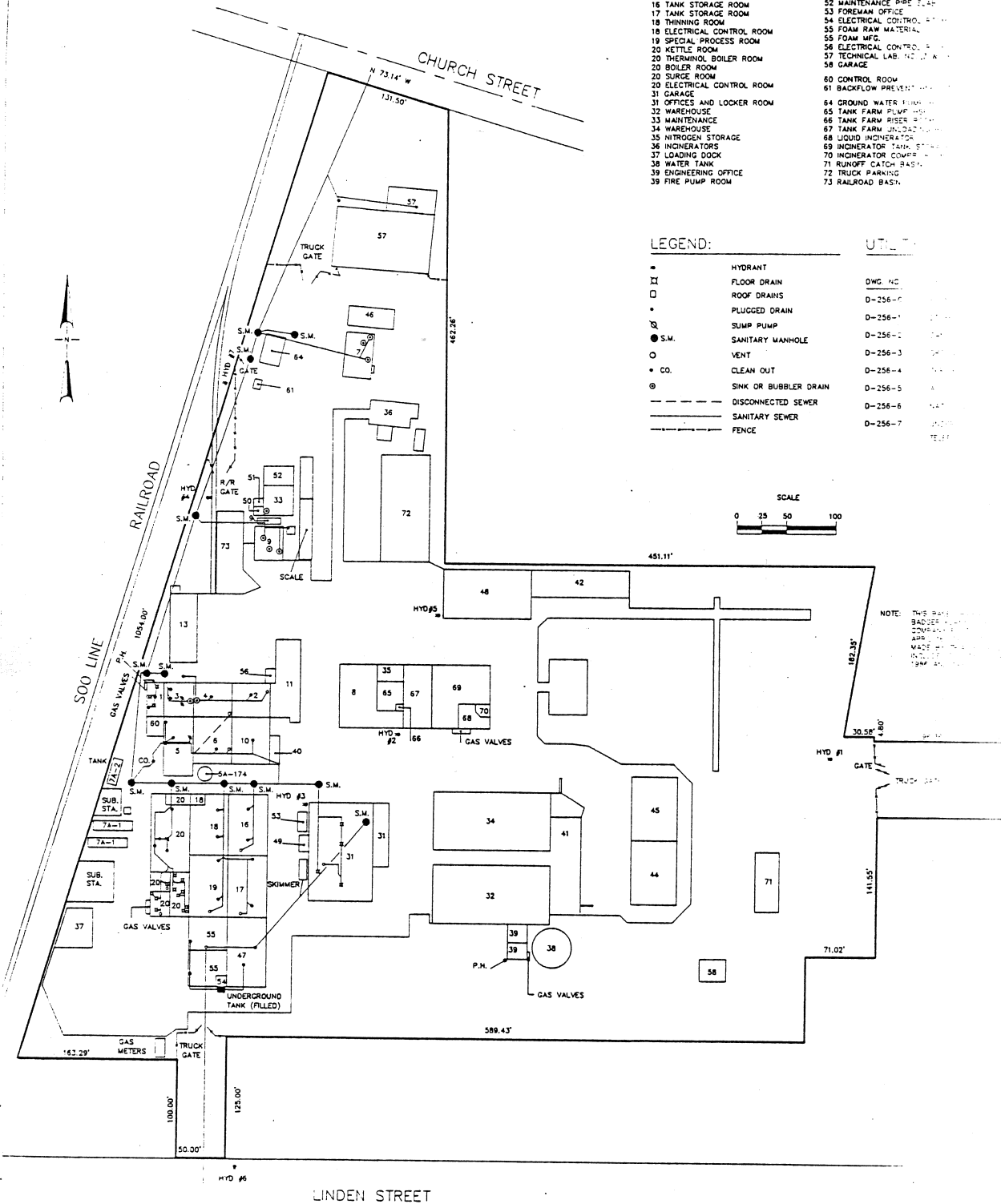

NOTE: THIS PLAN IS A REVISION OF THE SANITARY SEWER SYSTEM PLAN FOR THE FREEMAN CHEMICAL CORPORATION, SAUKVILLE, WISCONSIN, DATED 10/7/87.

SCALE: 1" = 50'	DATE: 10/7/87	DESIGNED BY: D.J.S.	FREEMAN CHEMICAL CORP. SAUKVILLE, WISCONSIN	TE TRIAD ENGINEERING INCORPORATED
SANITARY SEWER SYSTEM				

FREEMAN CHEMICAL CORPORATION

SAUKVILLE, WISCONSIN

KEY:

- | | |
|------------------------------|-----------------------------|
| 1 BOILER ROOM | 40 HOT ROOM |
| 2 STORAGE ROOM | 41 EAST LOADING DOCK |
| 3 KETTLE ROOM | 42 SHED WAREHOUSE |
| 4 THINNING ROOM | 44 WAREHOUSE |
| 5 KETTLE ROOM | 44 WAREHOUSE |
| 6 THINNING ROOM | 46 R.F.P. APPLICATION LAB |
| 7 FOAM LABORATORY | 47 POLYESTER STORAGE ROOM |
| 8 TANK FARM | 48 DRUM FILLING FACILITY |
| 9 CONTROL LABORATORY | 49 FIRE EQUIPMENT SHED |
| 10 STORAGE TANK ROOM | 50 MAINTENANCE STORAGE ROOM |
| 11 TANK WAGON LOADING SHED | 51 MAINTENANCE STORAGE ROOM |
| 13 WAREHOUSE RAW - MATERIALS | 52 MAINTENANCE PIPE SHED |
| 16 TANK STORAGE ROOM | 53 FOREMAN OFFICE |
| 17 TANK STORAGE ROOM | 54 ELECTRICAL CONTROL ROOM |
| 18 THINNING ROOM | 55 FOAM RAW MATERIAL |
| 18 ELECTRICAL CONTROL ROOM | 55 FOAM MFG. |
| 19 SPECIAL PROCESS ROOM | 56 ELECTRICAL CONTROL ROOM |
| 20 KETTLE ROOM | 57 TECHNICAL LAB. NO. 1 & 2 |
| 20 THERMAL BOILER ROOM | 58 GARAGE |
| 20 BOILER ROOM | 60 CONTROL ROOM |
| 20 SURGE ROOM | 61 BACKFLOW PREVENT. USE |
| 20 ELECTRICAL CONTROL ROOM | 64 GROUND WATER PUMP USE |
| 31 GARAGE | 65 TANK FARM PUMP USE |
| 31 OFFICES AND LOCKER ROOM | 66 TANK FARM RISER ROOM |
| 32 WAREHOUSE | 67 TANK FARM UNLOADING |
| 33 MAINTENANCE | 68 LIQUID INCINERATOR |
| 34 WAREHOUSE | 69 INCINERATOR TANK STORAGE |
| 35 NITROGEN STORAGE | 70 INCINERATOR COMP. ROOM |
| 36 INCINERATORS | 71 RUNOFF CATCH BASIN |
| 37 LOADING DOCK | 72 TRUCK PARKING |
| 38 WATER TANK | 73 RAILROAD BASIN |
| 39 ENGINEERING OFFICE | |
| 39 FIRE PUMP ROOM | |

LEGEND:

- HYDRANT
- P.H.
- SHALLOW DOLOMITE CONNECTION
- DEEP DOLOMITE WELL
- METERING MANHOLE
- S.M.
- SANITARY MANHOLE
- RAINY COLLECTOR
- 4" S.S. PERFORATED SCREEN
- DRAIN TILE - 17" TO 21"
- DEEP OR AS NOTED
- RC-TRANSFER LINES
- 6'-0" DEEP
- DEEP DOLOMITE TRANSFER LINES - 6'-0" DEEP
- FENCE
- 1 1/2" VENT LINES
- 3' DEEP

UTILITIES

- | | |
|----------|---------|
| DWG. NO. | DATE |
| D-256-0 | 10/7/87 |
| D-256-1 | 10/7/87 |
| D-256-2 | 10/7/87 |
| D-256-3 | 10/7/87 |
| D-256-4 | 10/7/87 |
| D-256-5 | 10/7/87 |
| D-256-6 | 10/7/87 |
| D-256-7 | 10/7/87 |

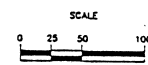

NOTE: THIS PLAN IS SUBJECT TO ALL APPLICABLE CODES AND REGULATIONS.

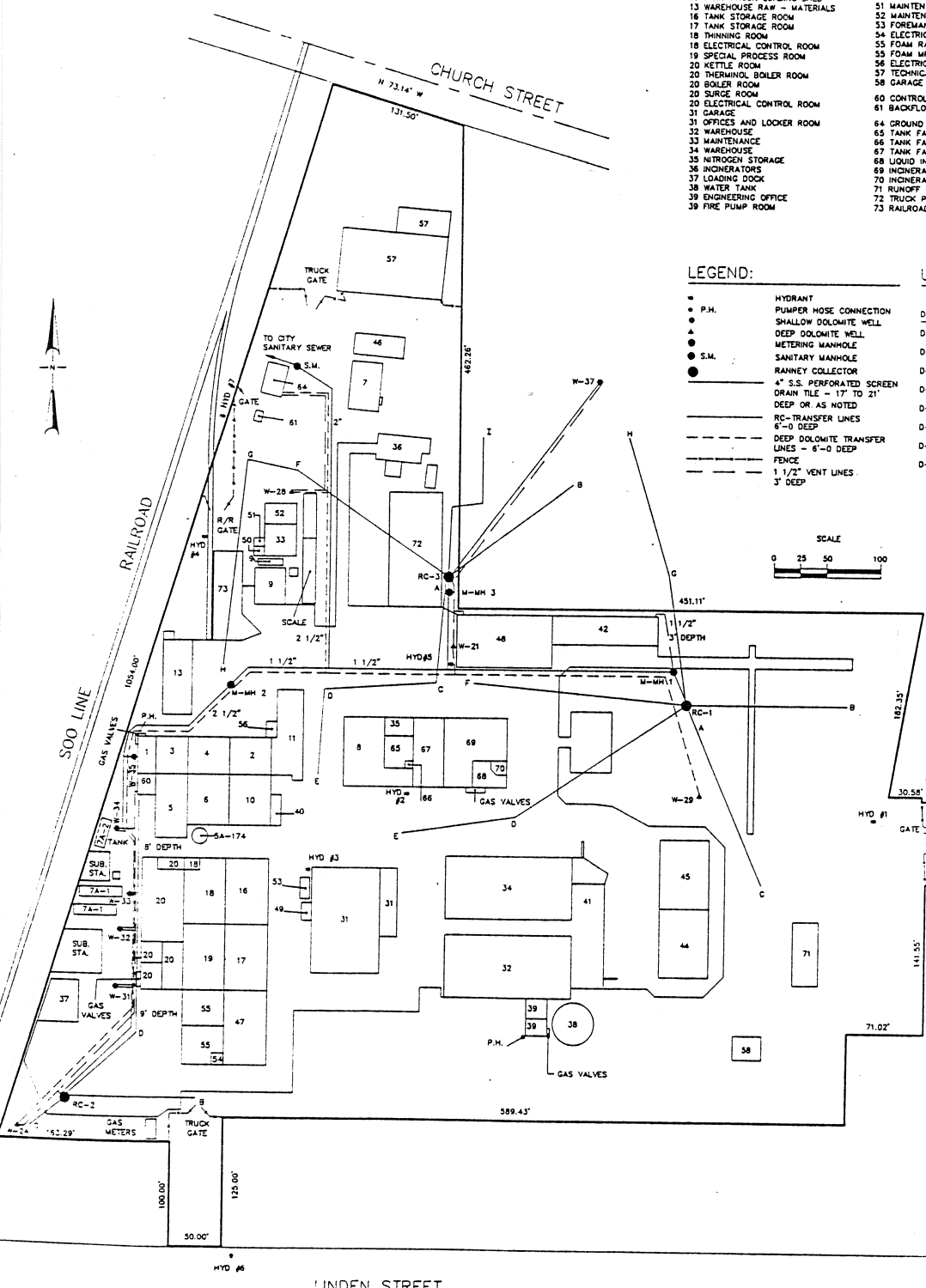

SCALE 1" = 50'
DATE 10/7/87

APPROVED BY: [Signature]
DRAWN BY: D.J.S.
GROUND WATER COLLECTION SYSTEM

FREEMAN CHEMICAL CORP.
SAUKVILLE, WISCONSIN



FREEMAN CHEMICAL CORPORATION

SAUKVILLE, WISCONSIN

KEY:

- | | |
|------------------------------|----------------------------|
| 1 BOILER ROOM | 40 HOT ROOM |
| 2 STORAGE ROOM | 41 EAST LOADING DOCK |
| 3 KETTLE ROOM | 42 SHED WAREHOUSE |
| 4 THINNING ROOM | 44 WAREHOUSE |
| 5 KETTLE ROOM | 45 WAREHOUSE |
| 6 THINNING ROOM | 46 R.F.P. APPLICATION |
| 7 FOAM LABORATORY | 47 POLYESTER STORAGE |
| 8 TANK FARM | 48 DRUM FILLING FACILITY |
| 9 CONTROL LABORATORY | 49 FIRE EQUIPMENT SHED |
| 10 STORAGE TANK ROOM | 50 MAINTENANCE STORAGE |
| 11 TANK WAGON LOADING SHED | 51 MAINTENANCE STORAGE |
| 13 WAREHOUSE RAW - MATERIALS | 52 MAINTENANCE PIPE |
| 16 TANK STORAGE ROOM | 53 FOREMAN OFFICE |
| 17 TANK STORAGE ROOM | 54 ELECTRICAL CONTROL ROOM |
| 18 THINNING ROOM | 55 FOAM RAW MATERIAL |
| 19 SPECIAL PROCESS ROOM | 55 FOAM MFG. |
| 20 KETTLE ROOM | 56 ELECTRICAL CONTROL ROOM |
| 20 THERMAL BOILER ROOM | 57 TECHNICAL LAB. HOLDING |
| 20 BOILER ROOM | 58 GARAGE |
| 20 SURGE ROOM | 60 CONTROL ROOM |
| 20 ELECTRICAL CONTROL ROOM | 61 BACKFLOW PREVENTION |
| 31 GARAGE | 64 GROUND WATER |
| 31 OFFICES AND LOCKER ROOM | 65 TANK FARM PUMP HOUSE |
| 32 WAREHOUSE | 66 TANK FARM RISER ROOM |
| 33 MAINTENANCE | 67 TANK FARM UNPLANT |
| 34 WAREHOUSE | 68 LIQUID INCINERATOR |
| 35 NITROGEN STORAGE | 69 INCINERATOR TANK |
| 36 INCINERATORS | 70 INCINERATOR COMP. ROOM |
| 37 LOADING DOCK | 71 RUNOFF CATCH BASIN |
| 38 WATER TANK | 72 TRUCK PARKING |
| 39 ENGINEERING OFFICE | 73 RAILROAD BASIN |
| 39 FIRE PUMP ROOM | |

LEGEND:

- HYDRANT
- [M] CHECK VALVE
- ⊓ SHUT OFF VALVE
- CITY WATER LINE
- SPRINKLER LINE
- FENCE
- P.H. PUMPER HOSE CONNECTION

UTILITY

- | | |
|----------|---------------------|
| DWG. NO. | DESCRIPTION |
| D-256-0 | PLANT |
| D-256-1 | STEAM |
| D-256-2 | GAS |
| D-256-3 | DRAINAGE |
| D-256-4 | SEWER |
| D-256-5 | ADD. WATER |
| D-256-6 | NAT. GAS |
| D-256-7 | UNIVERSAL TELEPHONE |

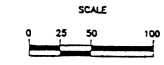
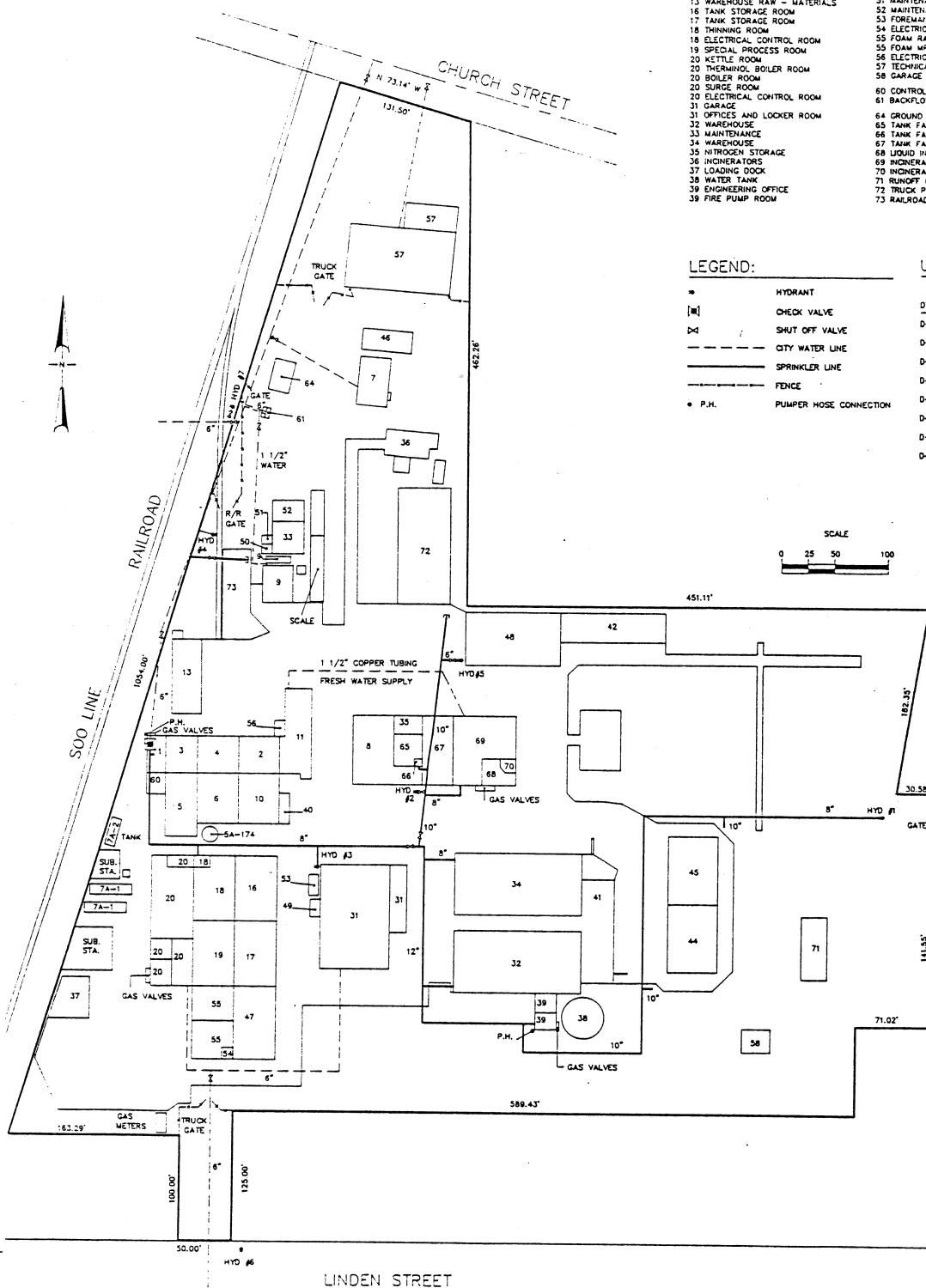

NOTE: THIS BASE MAP WAS OBTAINED FROM THE COUNTY ENGINEER'S OFFICE AND IS THE PROPERTY OF THE COUNTY ENGINEER. IT IS NOT TO BE REPRODUCED OR COPIED WITHOUT HIS WRITTEN PERMISSION.

SCALE: 1" = 50' DATE: 10/7/87	DESIGNED BY: D.J.S.	SPRINKLER & WATER LINES	FREEMAN CHEMICAL CORP. SAUKVILLE, WISCONSIN	
----------------------------------	---------------------	------------------------------------	--	--

FREEMAN CHEMICAL CORPORATION

SAUKVILLE, WISCONSIN

KEY:

- | | |
|------------------------------|----------------------------------|
| 1 BOILER ROOM | 40 HOT ROOM |
| 2 STORAGE ROOM | 41 EAST LOADING DOCK |
| 3 KETTLE ROOM | 42 SHED WAREHOUSE |
| 4 THINNING ROOM | 44 WAREHOUSE |
| 5 KETTLE ROOM | 45 WAREHOUSE |
| 6 THINNING ROOM | 46 R.F.P. APPLICATION LABORATORY |
| 7 FOAM LABORATORY | 47 POLYESTER STORAGE ROOM |
| 8 TANK FARM | 48 DRUM FILLING FACILITY |
| 9 CONTROL LABORATORY | 49 FIRE EQUIPMENT SHED |
| 10 STORAGE TANK ROOM | 50 MAINTENANCE STORAGE SHED |
| 11 TANK WAGON LOADING SHED | 51 MAINTENANCE STORAGE SHED |
| 13 WAREHOUSE RAW - MATERIALS | 52 MAINTENANCE PIPE SLAB |
| 16 TANK STORAGE ROOM | 53 FOREMAN OFFICE |
| 17 TANK STORAGE ROOM | 54 ELECTRICAL CONTROL ROOM |
| 18 THINNING ROOM | 55 FOAM RAW MATERIAL |
| 19 SPECIAL PROCESS ROOM | 56 ELECTRICAL CONTROL ROOM |
| 20 THERMINOL BOILER ROOM | 57 TECHNICAL LAB. NO. 3 & 4 |
| 20 BOILER ROOM | 58 GARAGE |
| 20 SURGE ROOM | 60 CONTROL ROOM |
| 20 ELECTRICAL CONTROL ROOM | 61 BACKFLOW PREVENT HSE. |
| 31 GARAGE | 64 GROUND WATER PUMP HSE |
| 31 OFFICES AND LOCKER ROOM | 65 TANK FARM PUMP HSE |
| 32 WAREHOUSE | 66 TANK FARM RISER ROOM |
| 33 MAINTENANCE | 67 TANK FARM UNLOADING BAY |
| 34 WAREHOUSE | 68 LIQUID INCINERATOR |
| 35 NITROGEN STORAGE | 69 INCINERATOR TANK STORAGE |
| 36 INCINERATORS | 70 INCINERATOR COMPR. ROOM |
| 37 LOADING DOCK | 71 RUNOFF CATCH BASIN |
| 38 WATER TANK | 72 TRUCK PARKING |
| 39 ENGINEERING OFFICE | 73 RAILROAD BASIN |
| 39 FIRE PUMP ROOM | |

LEGEND:

- HYDRANT
- SHUT-OFF VALVE
- CAPPED GAS LINE
- - - DISCONNECTED GAS LINE
- NATURAL GAS LINE
- FENCE
- P.H. PUMPER HOSE CONNECTION

UTILITY DRAIN

- | DWG. NO. | DESCRIPTION |
|----------|-------------|
| D-256-0 | PLANT |
| D-256-1 | STATION |
| D-256-2 | SANITARY |
| D-256-3 | SEWER |
| D-256-4 | SEWER |
| D-256-5 | ADDITONAL |
| D-256-6 | NATURAL |
| D-256-7 | UNDERGROUND |
| | TELEPHONE |

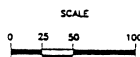

NOTE: THIS BASE MAP WAS OBTAINED FROM THE SAUKVILLE PLANT MAP, 1964, AND THE SAUKVILLE PLANT MAP, 1964.

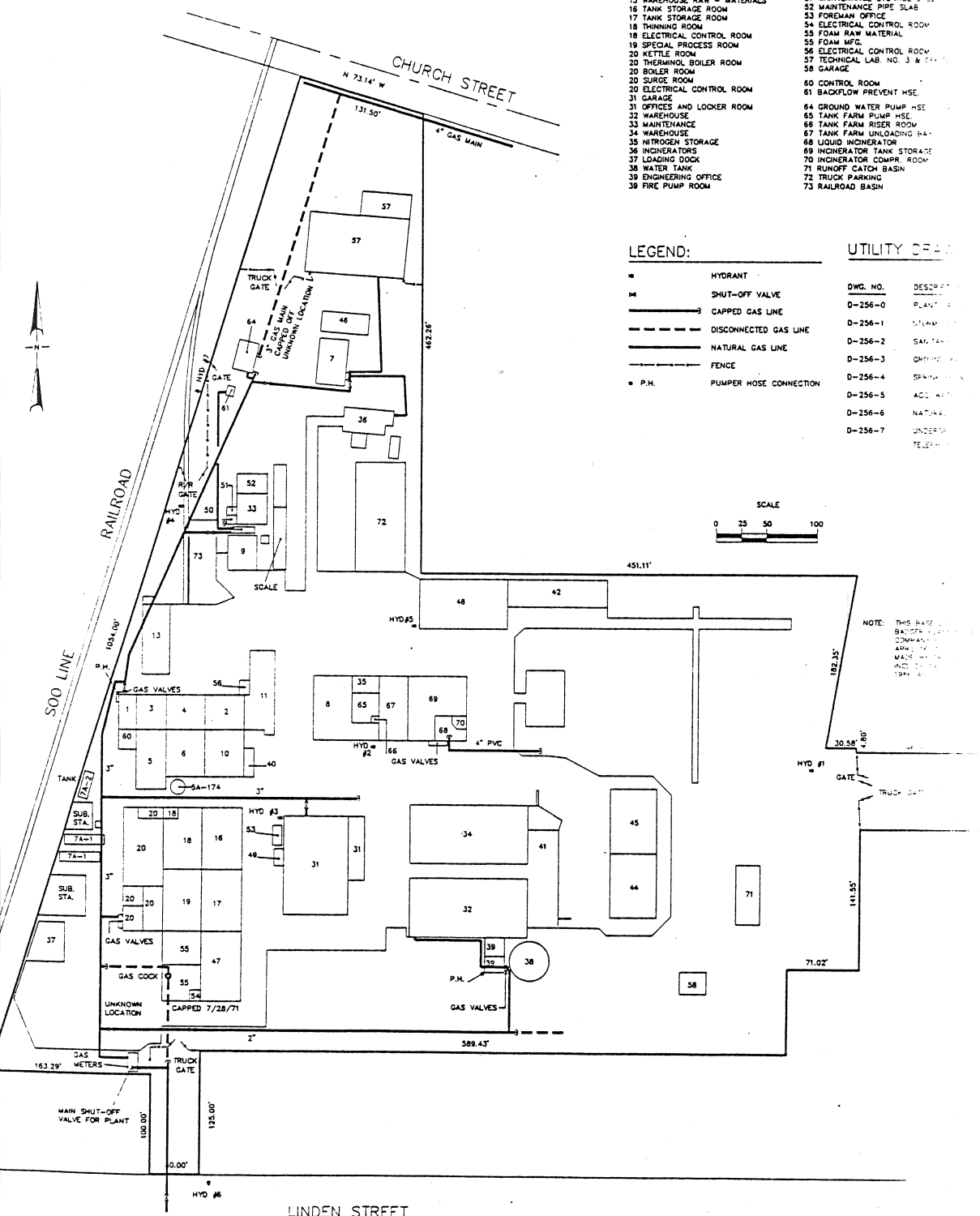

LINDEN STREET

SCALE: 1" = 50'	DATE: 10/7/87	DESIGNED BY: D.J.S.	FREEMAN CHEMICAL CORP. SAUKVILLE, WISCONSIN	TRIAD ENGINEERING INCORPORATED
-----------------	---------------	---------------------	--	--------------------------------

FREEMAN CHEMICAL CORPORATION

SAUKVILLE, WISCONSIN

KEY:

- | | |
|----------------------------|----------------------------------|
| 1 BOILER ROOM | 40 HOT ROOM |
| 2 STORAGE ROOM | 41 EAST LOADING DOCK |
| 3 KETTLE ROOM | 42 SHED WAREHOUSE |
| 4 THINNING ROOM | 44 WAREHOUSE |
| 5 KETTLE ROOM | 45 WAREHOUSE |
| 6 THINNING ROOM | 46 R.F.P. APPLICATION LABORATORY |
| 7 FOAM LABORATORY | 47 POLYESTER STORAGE ROOM |
| 8 TANK FARM | 48 DRUM FILLING FACILITY |
| 9 CONTROL LABORATORY | 49 FIRE EQUIPMENT SHED |
| 10 STORAGE TANK ROOM | 50 MAINTENANCE STREET |
| 11 TANK WAGON LOADING SHED | 51 MAINTENANCE STREET |
| 12 WAREHOUSE RAW MATERIALS | 52 MAINTENANCE STREET |
| 13 TANK STORAGE ROOM | 53 MAINTENANCE STREET |
| 14 TANK STORAGE ROOM | 54 MAINTENANCE STREET |
| 15 TANK STORAGE ROOM | 55 MAINTENANCE STREET |
| 16 TANK STORAGE ROOM | 56 ELECTRICAL CONTROL ROOM |
| 17 TANK STORAGE ROOM | 57 TECHNICAL LAB. NO. 1 & 2 |
| 18 SPECIAL PROCESS ROOM | 58 GARAGE |
| 19 KETTLE ROOM | 60 CONTROL ROOM |
| 20 THERMOLO BOILER ROOM | 61 BACKFLOW PREVENTER |
| 21 BOILER ROOM | 64 GROUND WATER PUMP HSE. |
| 22 SURGE ROOM | 65 TANK FARM PUMP HSE. |
| 23 ELECTRICAL CONTROL ROOM | 66 TANK FARM RISER ROOM |
| 24 GARAGE | 67 TANK FARM UNLOADING BAY |
| 25 OFFICES AND LOCKER ROOM | 68 LIQUID INCINERATOR |
| 26 WAREHOUSE | 69 INCINERATOR TANK STORAGE |
| 27 MAINTENANCE | 70 INCINERATOR COMP. ROOM |
| 28 WAREHOUSE | 71 RUNOFF CATCH BASIN |
| 29 NITROGEN STORAGE | 72 TRUCK PARKING |
| 30 INCINERATORS | 73 RAILROAD BASIN |
| 31 LOADING DOCK | |
| 32 WATER TANK | |
| 33 ENGINEERING OFFICE | |
| 34 FIRE PUMP ROOM | |

LEGEND:

- | | |
|-----|-----------------------------|
| • | HYDRANT |
| • | P.H. PUMPER HOSE CONNECTION |
| ○ | SHALLOW WELL |
| ● | DEEP DOLOMITE WELL |
| ○ | METERING MANHOLE |
| ● | RANEY COLLECTOR |
| △ | LIGHT POLE |
| --- | TELEPHONE LINES |
| --- | ELECTRIC CONDUIT & CABLES |
| --- | FENCE |

UTILITIES

- | DWG. NO. | DESCRIPTION |
|----------|-------------|
| D-256-0 | PLANNING |
| D-256-1 | PROVISIONS |
| D-256-2 | DETAILS |
| D-256-3 | DETAILS |
| D-256-4 | DETAILS |
| D-256-5 | DETAILS |
| D-256-6 | DETAILS |
| D-256-7 | DETAILS |

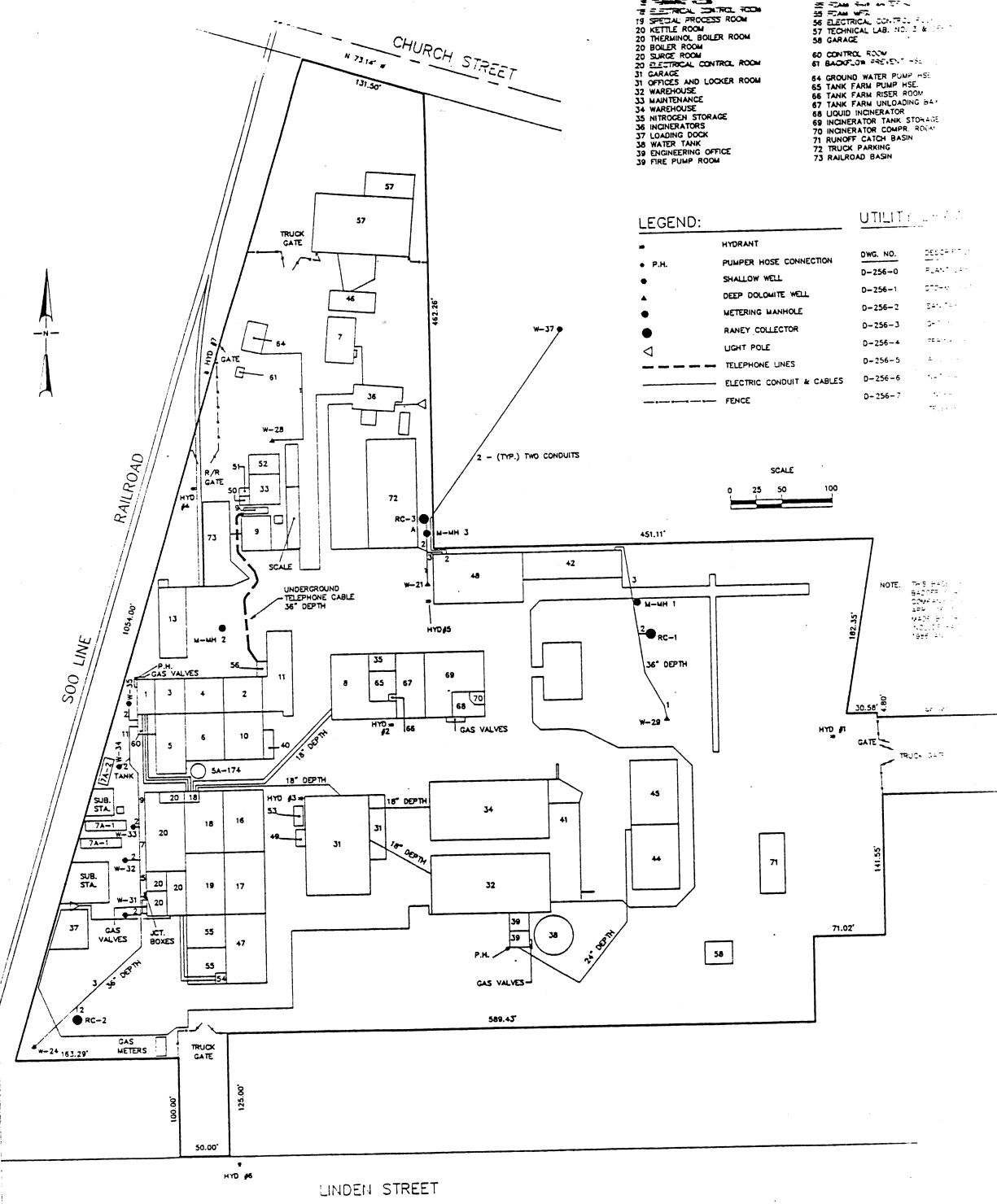

SCALE: 1"=50'	DATE: 10/7/87	DESIGNED BY: D.J.S.	UNDERGROUND ELECTRICAL & TELEPHONE LINES	FREEMAN CHEMICAL CORP. SAUKVILLE, WISCONSIN	TRIAD ENGINEERING INCORPORATED
---------------	---------------	---------------------	--	---	--------------------------------