

# DEPARTMENT OF NATURAL RESOURCES STATE OF WISCONSIN

## WALNUT STREET SITE MILWAUKEE, WISCONSIN

### DRAWING INDEX

<u>DRAWING No.</u>	<u>TITLE</u>
1	SITE PLAN
2	CROSS-SECTION INDEX OF PREVIOUS SOIL SAMPLING
3	AREA 1 CHROMIUM CONCENTRATIONS CROSS-SECTIONS A-A' TO D-D'
4	AREA 1 CHROMIUM / VOLATILE ORGANIC CONCENTRATIONS CROSS-SECTIONS E-E' TO F-F'
5	AREA 2 CHROMIUM CONCENTRATIONS CROSS-SECTIONS A-D
6	AREA 2 CHROMIUM CONCENTRATIONS CROSS-SECTIONS E, F, F-1, F-10

Beets # 02-41-000793 - 1

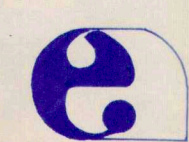

eder associates consulting engineers, p.c.

NEW YORK

MICHIGAN

WISCONSIN



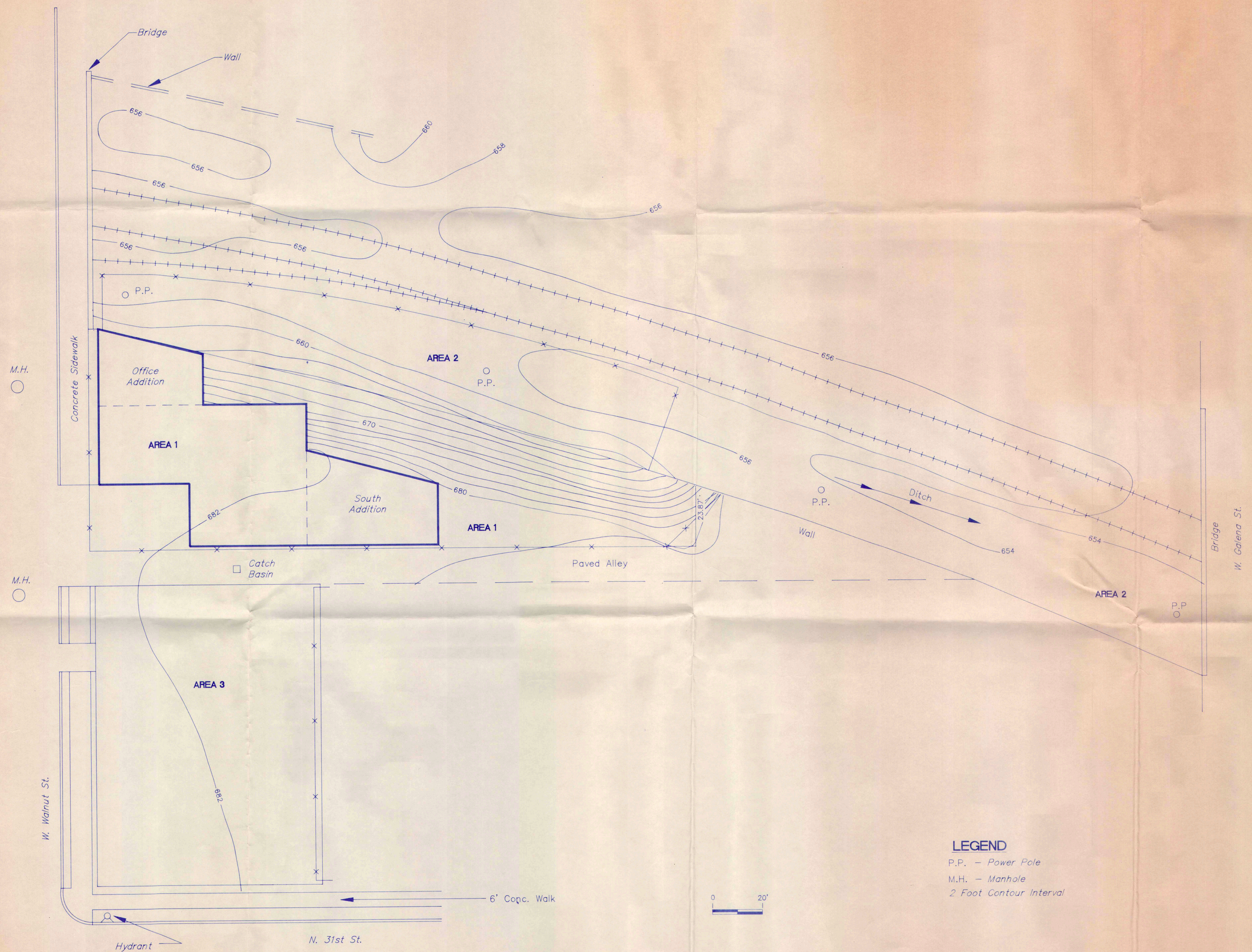
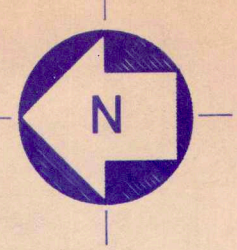

**LEGEND**  
 P.P. — Power Pole  
 M.H. — Manhole  
 2 Foot Contour Interval

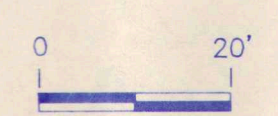

No.	REVISIONS	DATE	BY

DEPARTMENT OF NATURAL  
 RESOURCES  
 STATE OF WISCONSIN

WALNUT STREET SITE  
 MILWAUKEE, WISCONSIN



eder associates consulting engineers, p.c.  
 NEW YORK MICHIGAN WISCONSIN

Beets # 02-41-000793-2

PROJECT  
 DEPARTMENT OF NATURAL  
 RESOURCES  
 STATE OF WISCONSIN  
 WALNUT STREET SITE  
 MILWAUKEE, WISCONSIN

TITLE  
**SITE PLAN**

eder associates consulting engineers, p.c.  
 LOCUST VALLEY, NEW YORK • MADISON, WISCONSIN  
 ANN ARBOR, MICHIGAN

DRAWN BY	JJK	SCALE	1" = 20'
DESIGNED BY	DJO	PROJECT No.	685-1
APPROVED BY	WJC	DWG. No.	1
DATE	MARCH, 1990		



No.	REVISIONS	DATE	BY

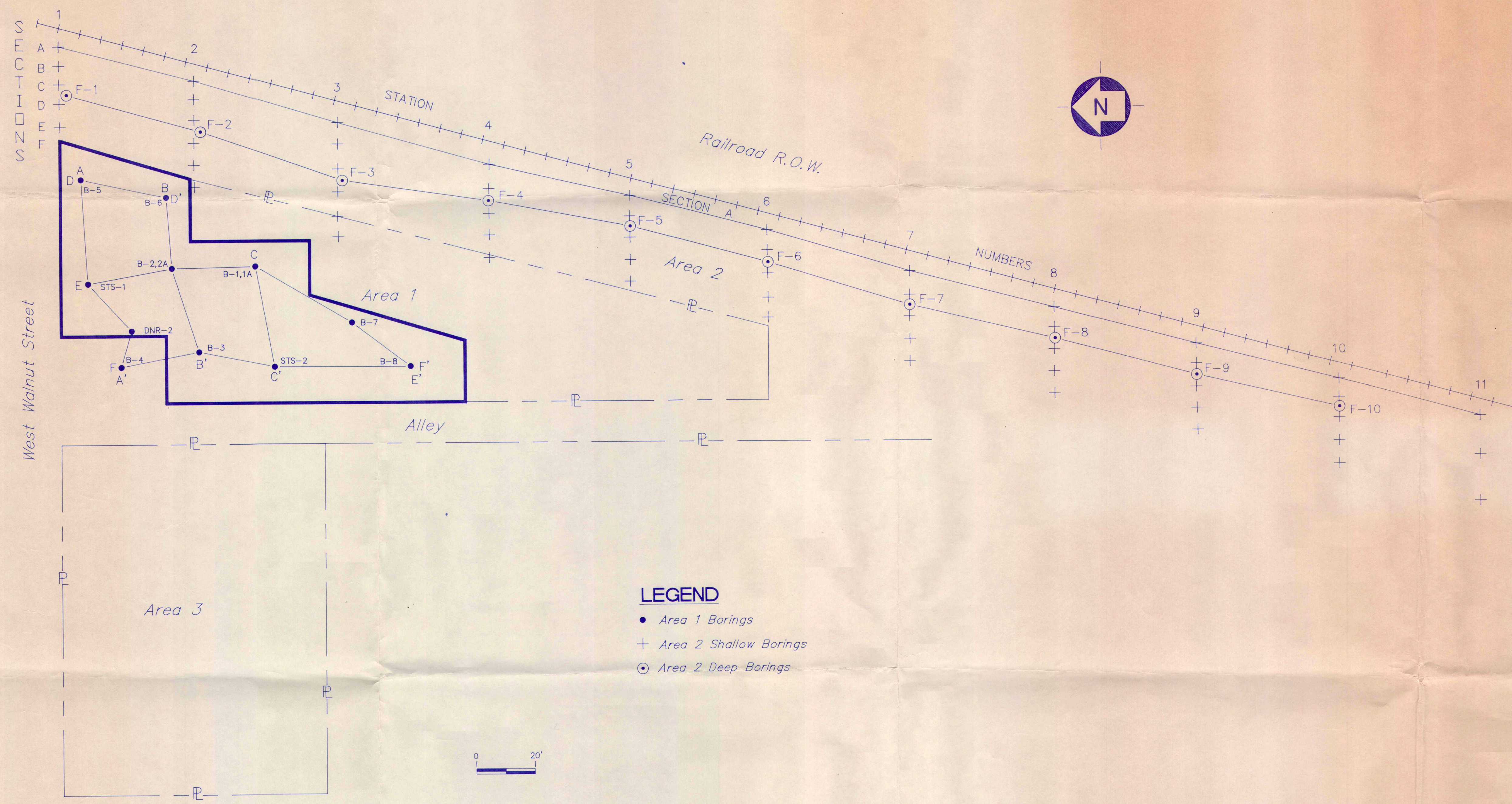

**LEGEND**

- Area 1 Borings
- + Area 2 Shallow Borings
- ⊙ Area 2 Deep Borings

**DEPARTMENT OF NATURAL  
RESOURCES  
STATE OF WISCONSIN**

WALNUT STREET SITE  
MILWAUKEE, WISCONSIN

eder associates consulting engineers, p.c.  
NEW YORK MICHIGAN WISCONSIN

REPORT # 02-41-000793-3

PROJECT  
DEPARTMENT OF NATURAL  
RESOURCES  
STATE OF WISCONSIN  
WALNUT STREET SITE  
MILWAUKEE, WISCONSIN

TITLE  
**CROSS-SECTION INDEX  
OF PREVIOUS SOIL SAMPLING**

eder associates consulting engineers, p.c.  
LOCUST VALLEY, NEW YORK • MADISON, WISCONSIN  
ANN ARBOR, MICHIGAN

DRAWN BY MJD	SCALE 1"=20'
DESIGNED BY DJO	PROJECT No. 685-1
APPROVED BY WJC	DWG. No. 2
DATE MARCH, 1990	



No.	REVISIONS	DATE	BY

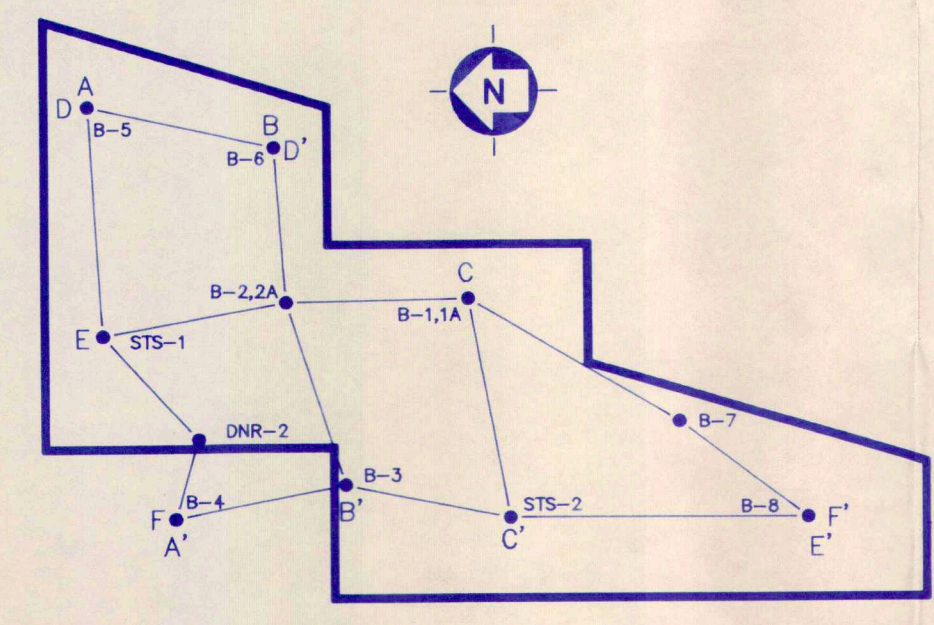
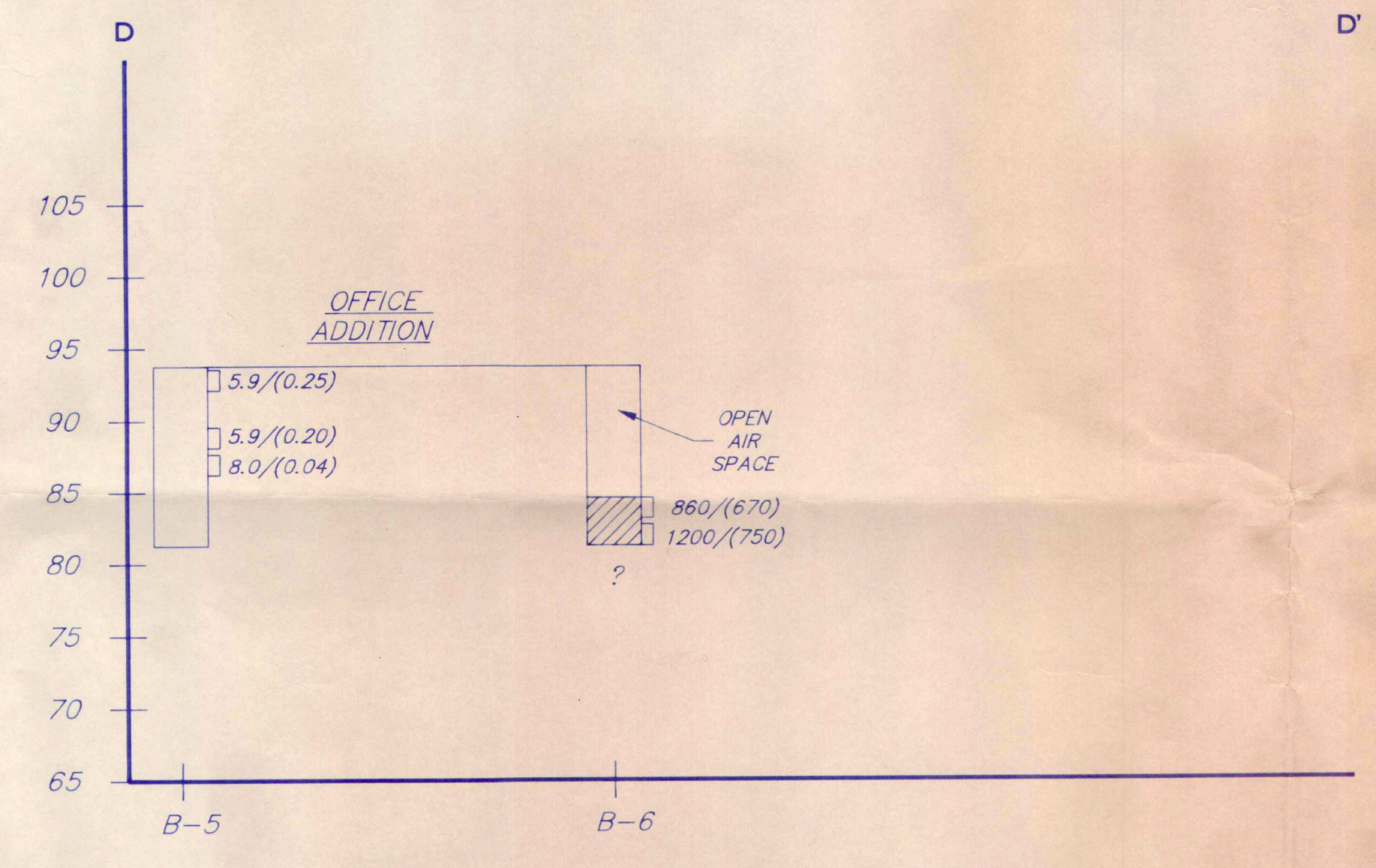
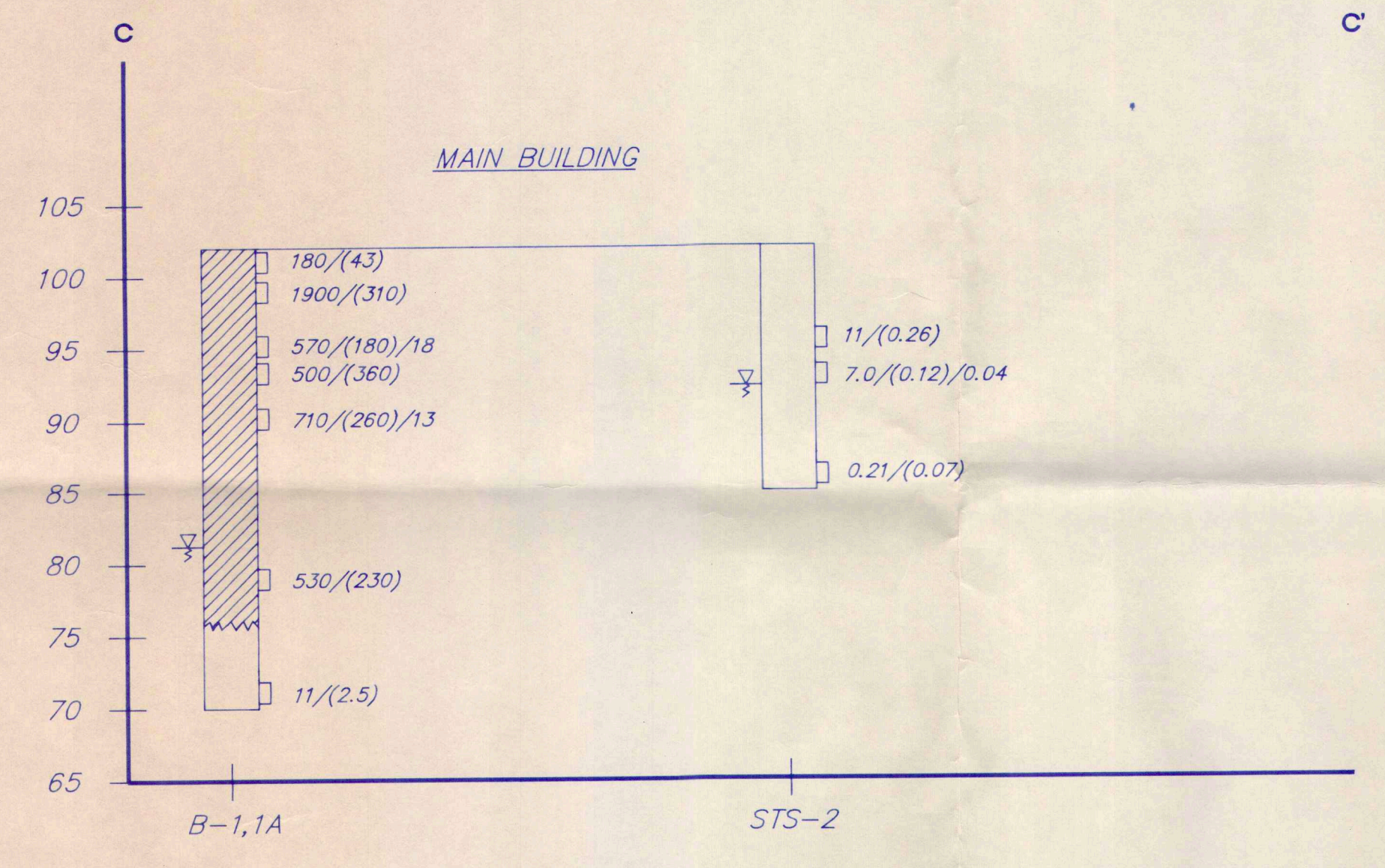
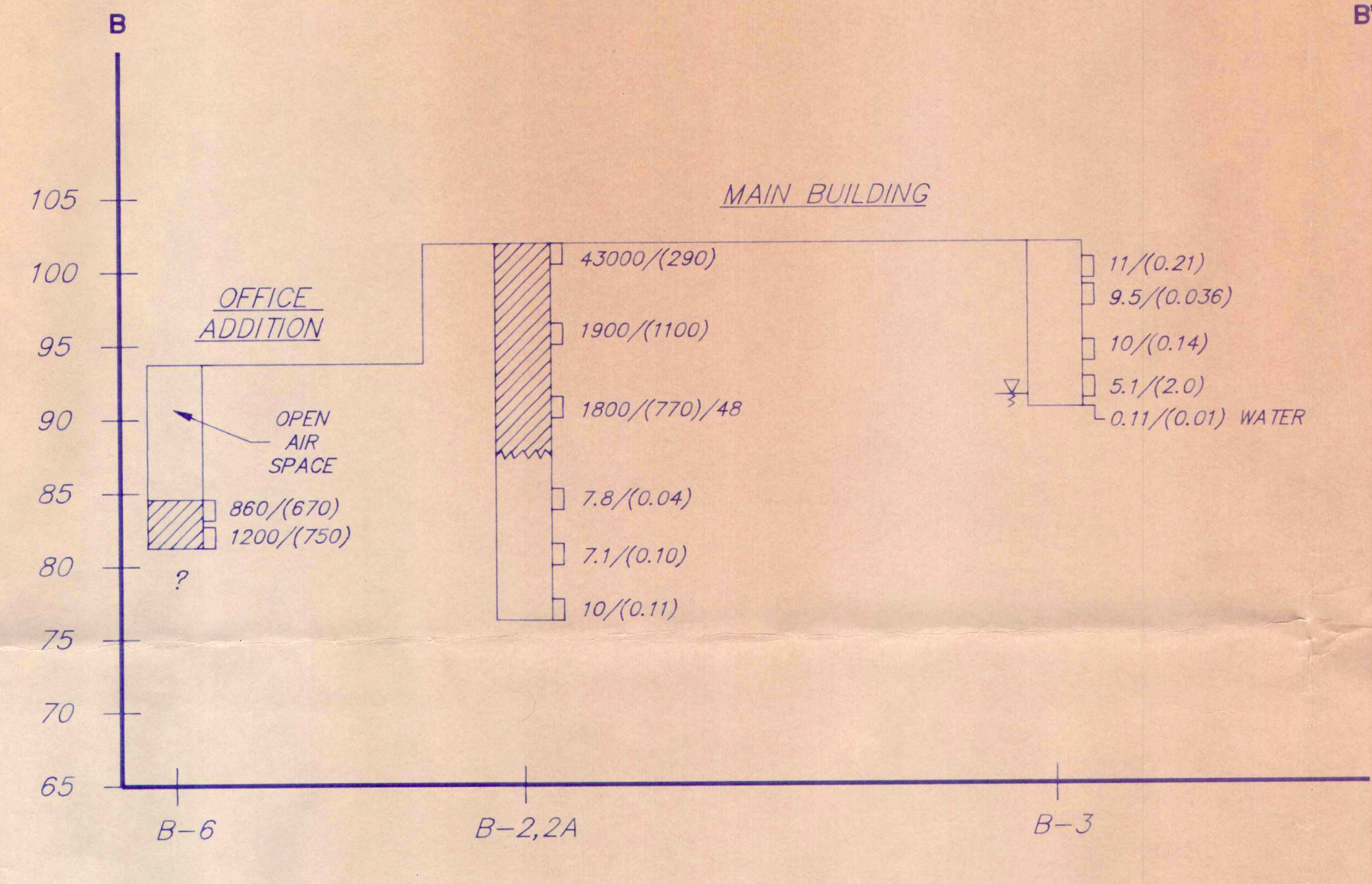
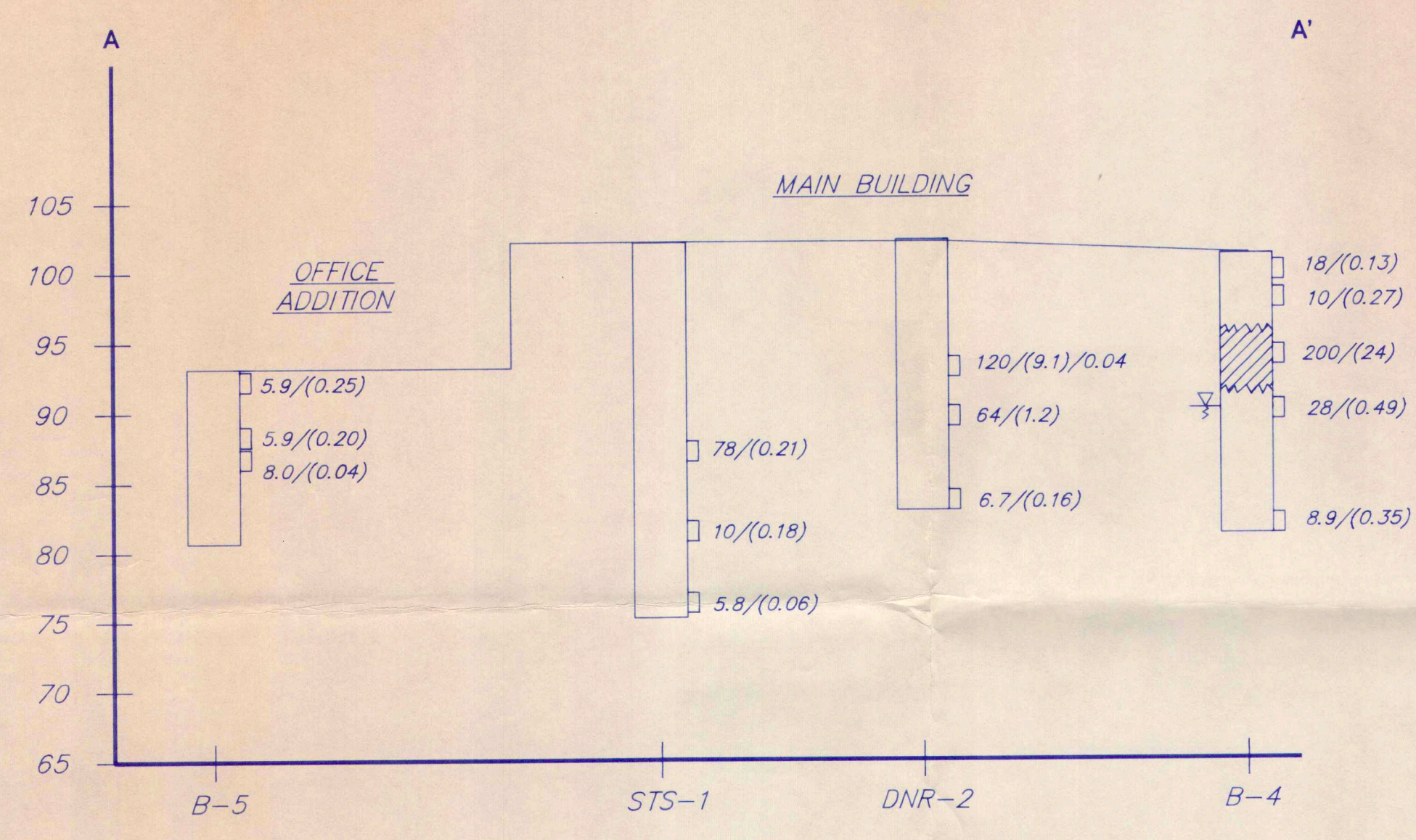

**CROSS-SECTION INDEX**

**NOTES-**

- 1) Total And Hexavalent Chromium Concentrations Reported As ppm, EP Chromium Reported As mg/l
- 2) Elevations For STS-1, STS-2 & DNR-2 Are Approximate
- 3)  $110/(1.5)/0.05 = \text{Total}/(\text{Hexavalent})/\text{EP Toxicity For Chromium}$
- 4) [Hatched Pattern] = Soil Exceeding 200 ppm Total, 20 ppm Hexavalent, Or 5 ppm EP Chromium
- 5) [Symbol] = Observed Water Level

**DEPARTMENT OF NATURAL RESOURCES**  
**STATE OF WISCONSIN**  
 WALNUT STREET SITE  
 MILWAUKEE, WISCONSIN  
 eder associates consulting engineers, p.c.  
 MILWAUKEE, WISCONSIN  
 MICHIGAN  
 NEW YORK

BRETS # 02-41-000793-4

PROJECT  
 DEPARTMENT OF NATURAL RESOURCES  
 STATE OF WISCONSIN  
 WALNUT STREET SITE  
 MILWAUKEE, WISCONSIN

TITLE  
**AREA 1**  
**CHROMIUM CONCENTRATIONS**  
**CROSS-SECTIONS A-A' TO D-D'**

eder associates consulting engineers, p.c.  
 LOCUST VALLEY, NEW YORK • MADISON, WISCONSIN  
 ANN ARBOR, MICHIGAN

DRAWN BY	JJK	SCALE	1" = 10'
DESIGNED BY	DJO	PROJECT No.	685-1
APPROVED BY	WJC	DWG. No.	3
DATE	MARCH, 1990		



No.	REVISIONS	DATE	BY

CHROMIUM CONCENTRATIONS

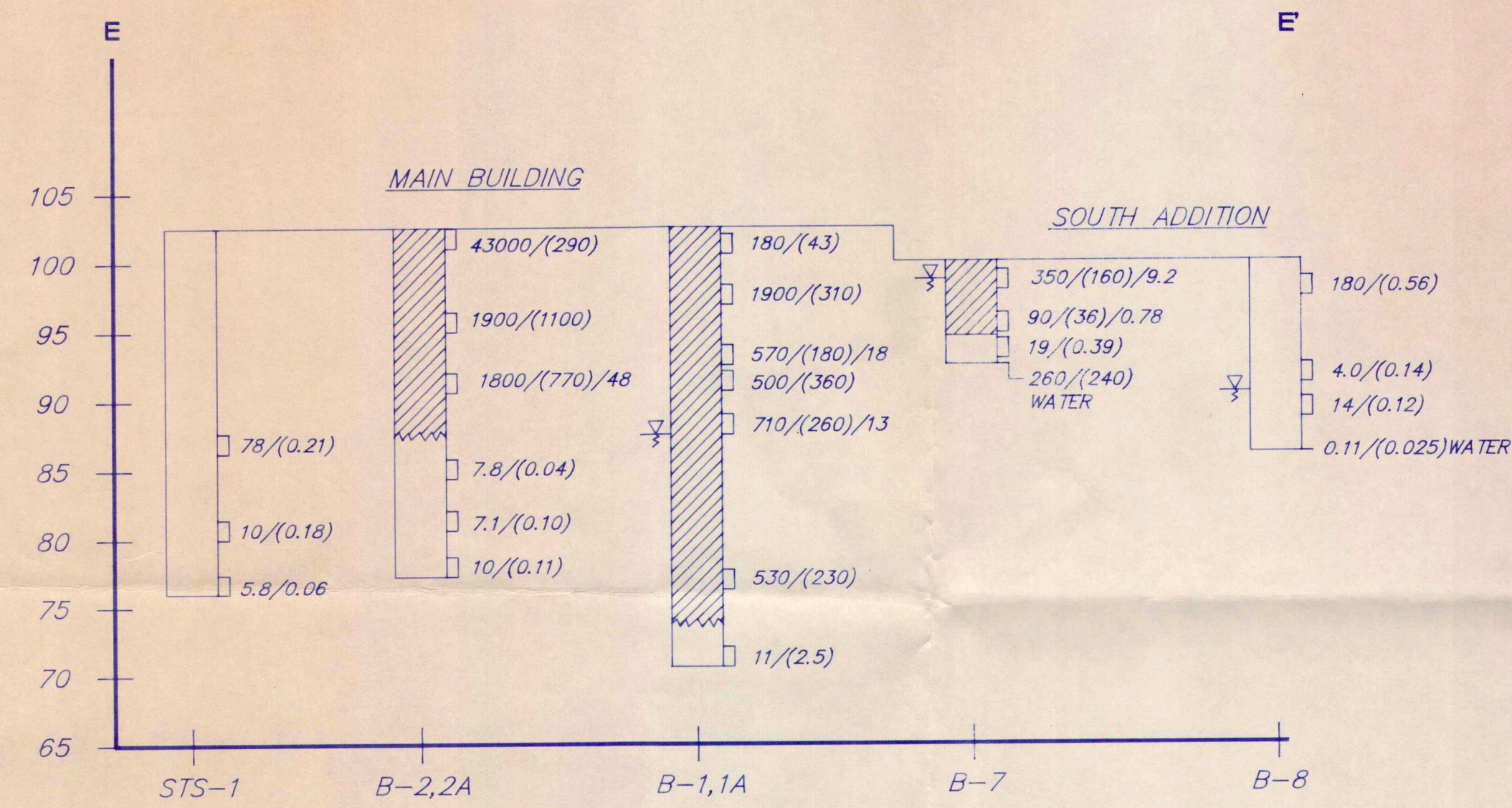

CHROMIUM CONCENTRATIONS

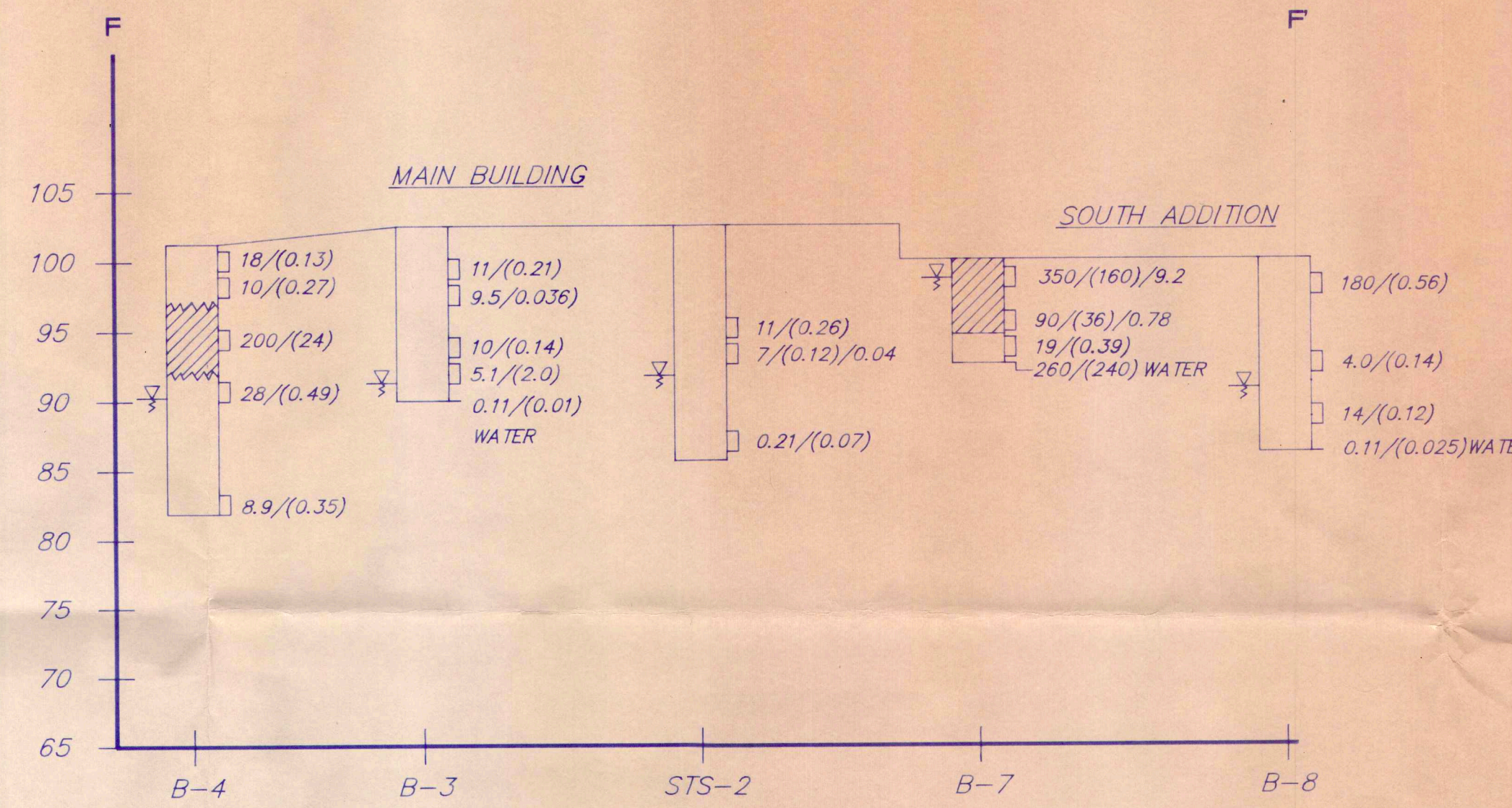

NOTES-

- 1) Total Hexavalent Chromium Concentrations Reported As ppm, EP Chromium Reported As mg/l
- 2) Elevations For STS-1 And STS-2 Are Approximate
- 3)  $110/(1.5)/0.05$  = Total/(Hexavalent)/EP Toxicity For Chromium
- 4) [Hatched] = Soil Exceeding 200 ppm Total, 20 ppm Hexavalent, Or 5 ppm EP Chromium
- 5) [Inverted Triangle] = Observed Water Level

VOLATILE ORGANIC CONCENTRATIONS

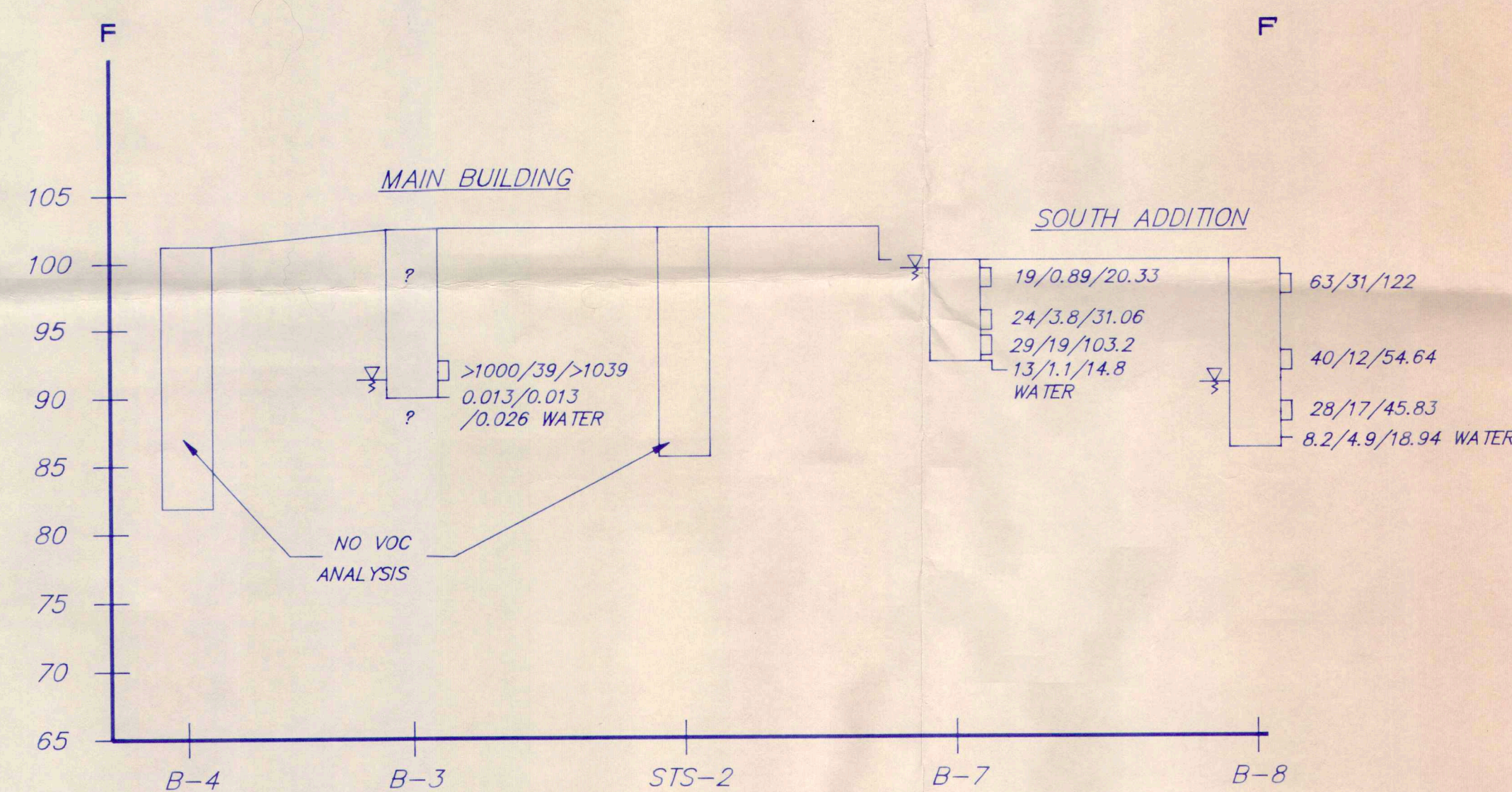

NOTES-

- 1) All Values In ppm
- 2) Elevations For STS-2 Are Approximate
- 3)  $25/15/32.59$  = Tetrachloroethylene/Trichloroethylene/Total Voc's
- 4) [Inverted Triangle] = Observed Water Level

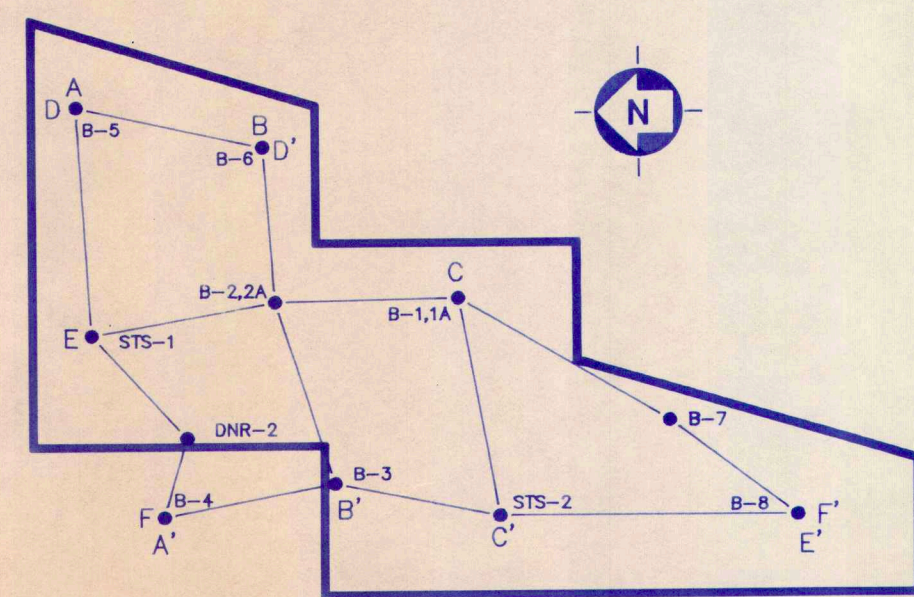

CROSS-SECTION INDEX

DEPARTMENT OF NATURAL  
 RESOURCES  
 STATE OF WISCONSIN  
 WALNUT STREET SITE  
 MILWAUKEE, WISCONSIN

eder associates consulting engineers, p.c.  
 NEW YORK  
 MICHIGAN  
 WISCONSIN



Beets # 02-41-000793-5

PROJECT  
 DEPARTMENT OF NATURAL  
 RESOURCES  
 STATE OF WISCONSIN  
 WALNUT STREET SITE  
 MILWAUKEE, WISCONSIN

TITLE  
**AREA 1  
 CHROMIUM / VOLATILE ORGANIC  
 CONCENTRATIONS  
 CROSS-SECTIONS E-E' TO F-F'**

eder associates consulting engineers, p.c.  
 LOCUST VALLEY, NEW YORK • MADISON, WISCONSIN  
 ANN ARBOR, MICHIGAN

DRAWN BY	JJK	SCALE	1" = 10'
DESIGNED BY	DJO	PROJECT No.	685-1
APPROVED BY	WJC	DWG. No.	4
DATE	MARCH, 1990		



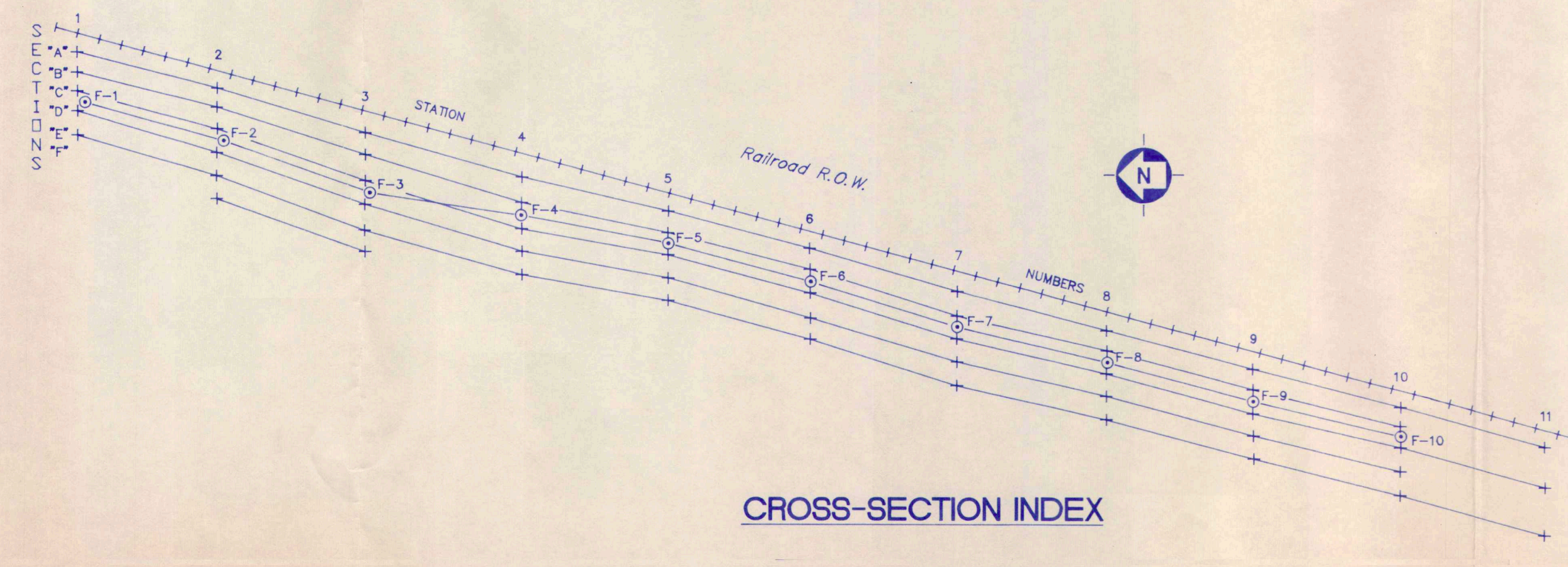
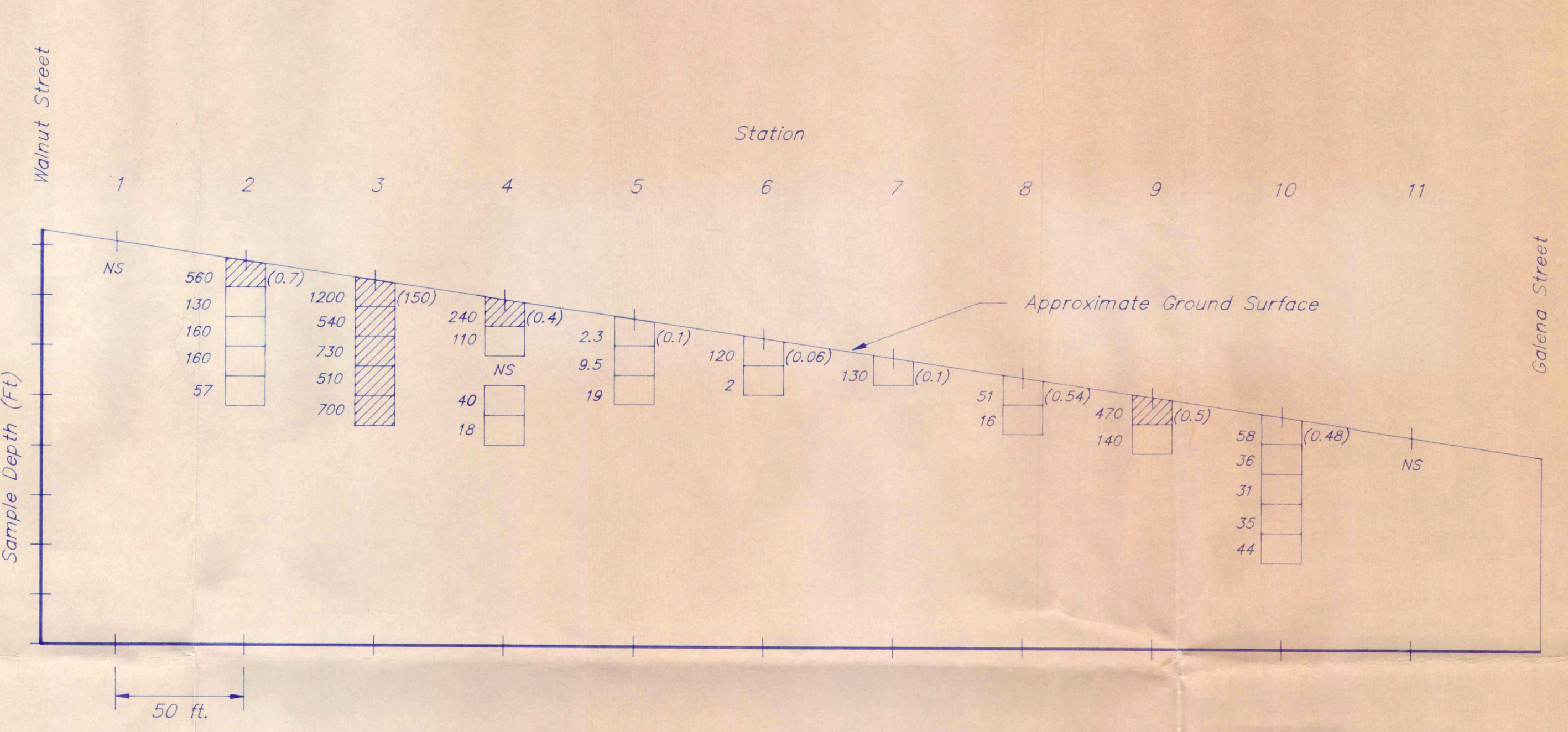
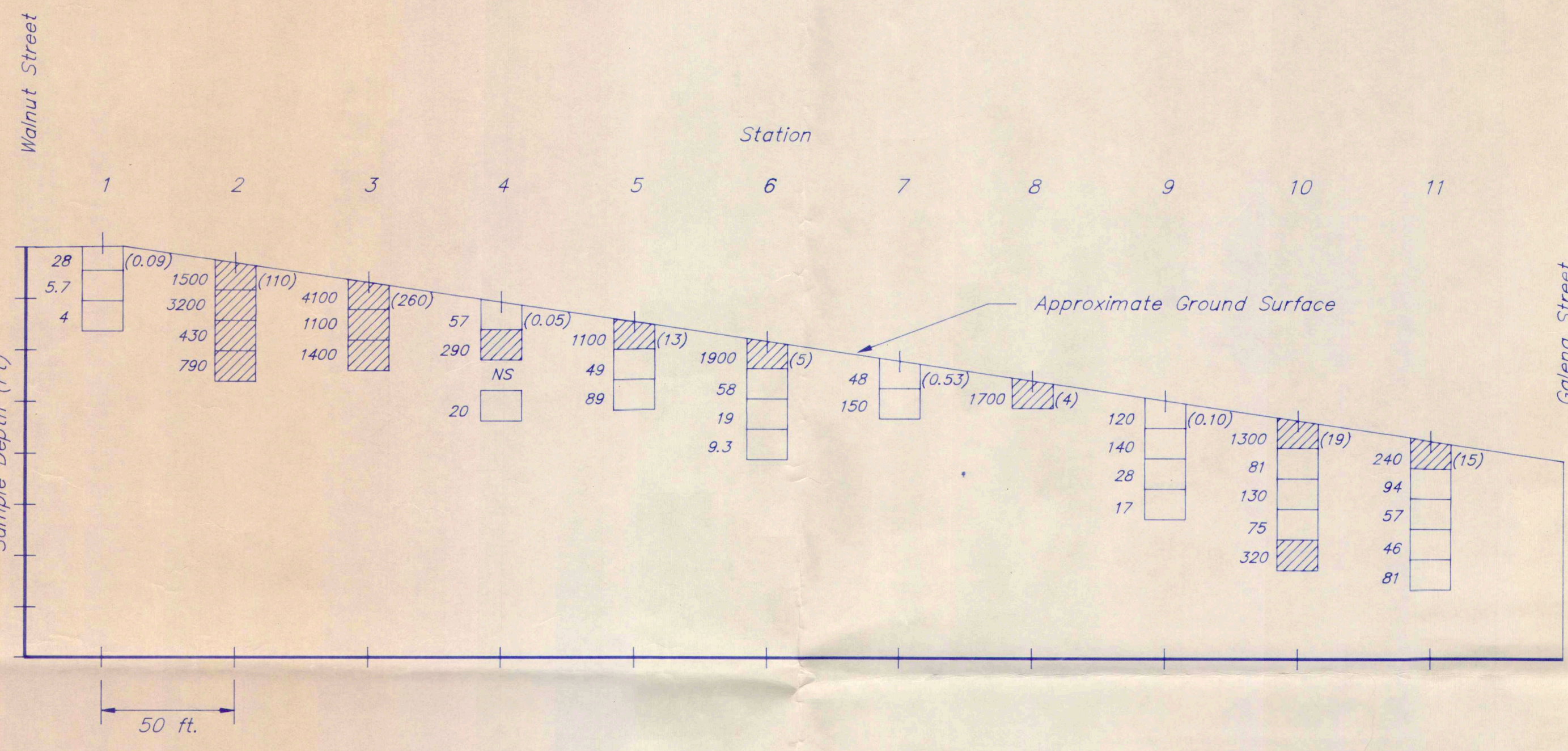
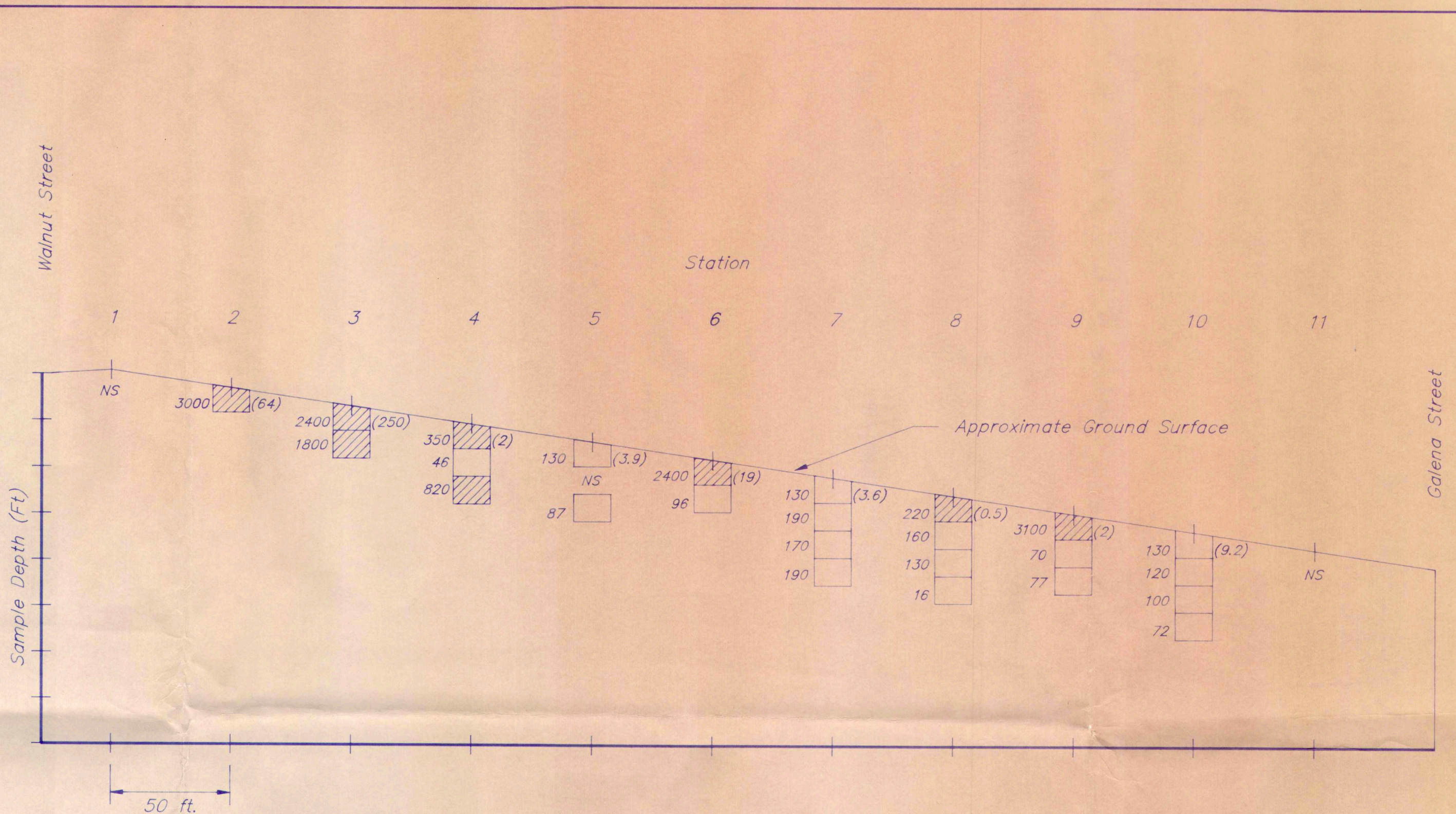
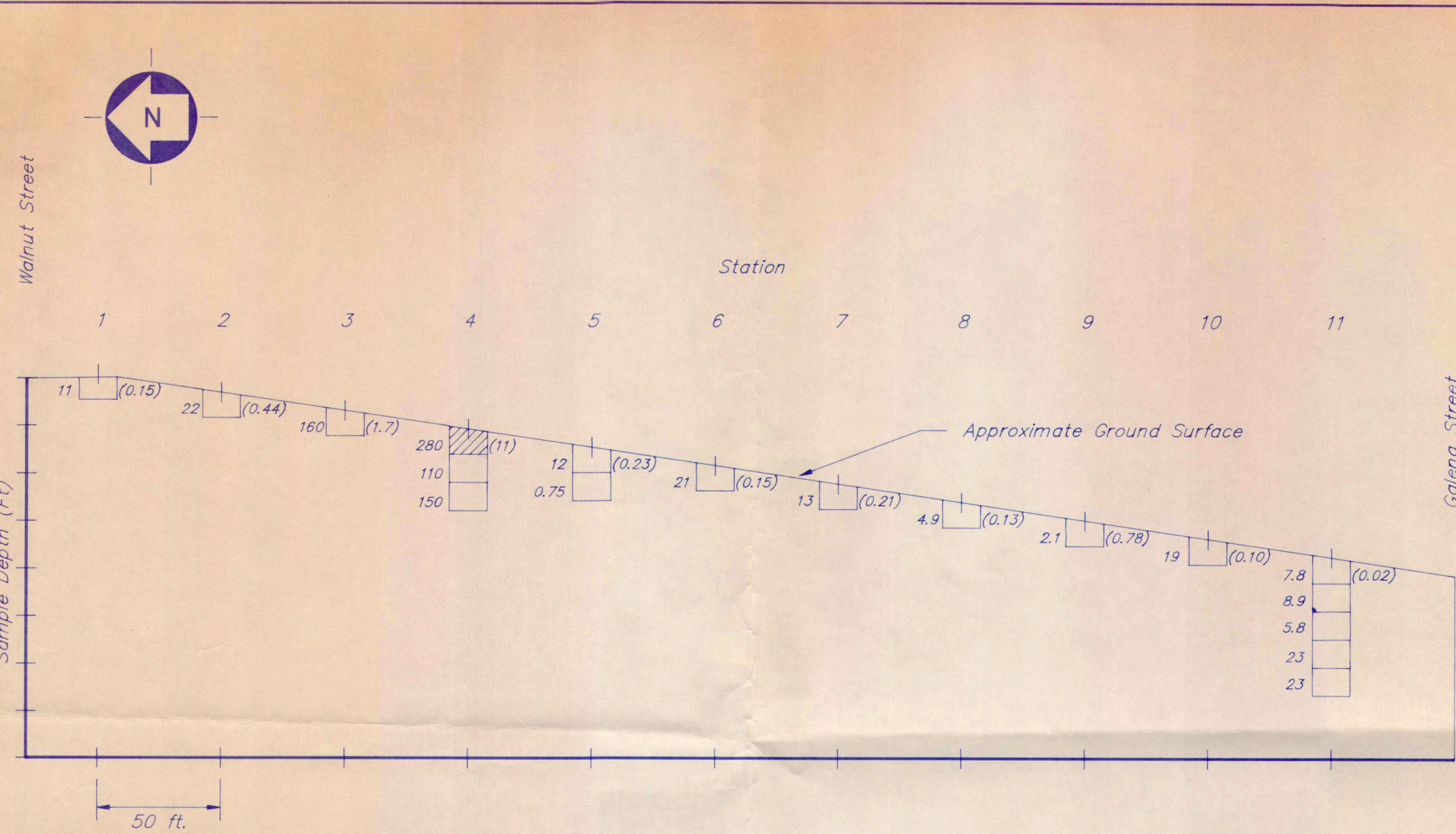

**NOTE:**

1) All Values Are In ppm

2) 10 □ (0.50) = Total □ (Hexavalent) Chromium At Six Inch Sampling Interval

3) ▨ = Soil Sample Exceeds 200 ppm Total, Or 20 ppm Hexavalent Chromium

4) NS = No Sample(s)

No.	REVISIONS	DATE	BY

**DEPARTMENT OF NATURAL RESOURCES**  
**STATE OF WISCONSIN**  
 WALNUT STREET SITE  
 MILWAUKEE, WISCONSIN

eder associates consulting engineers, p.c.  
 MICHIGAN  
 NEW YORK

BLTS # 62-41-000793-6

PROJECT  
 DEPARTMENT OF NATURAL RESOURCES  
 STATE OF WISCONSIN  
 WALNUT STREET SITE  
 MILWAUKEE, WISCONSIN

TITLE  
 AREA 2  
 CHROMIUM CONCENTRATIONS  
 CROSS-SECTIONS A-D

eder associates consulting engineers, p.c.  
 LOCUST VALLEY, NEW YORK • MADISON, WISCONSIN  
 ANN ARBOR, MICHIGAN

DRAWN BY	SCALE
JIK	As Shown
DESIGNED BY	PROJECT No.
DJO	685-1
APPROVED BY	DWG. No.
WJC	

685-1C  
 032090

MARCH, 1990



No.	REVISIONS	DATE	BY

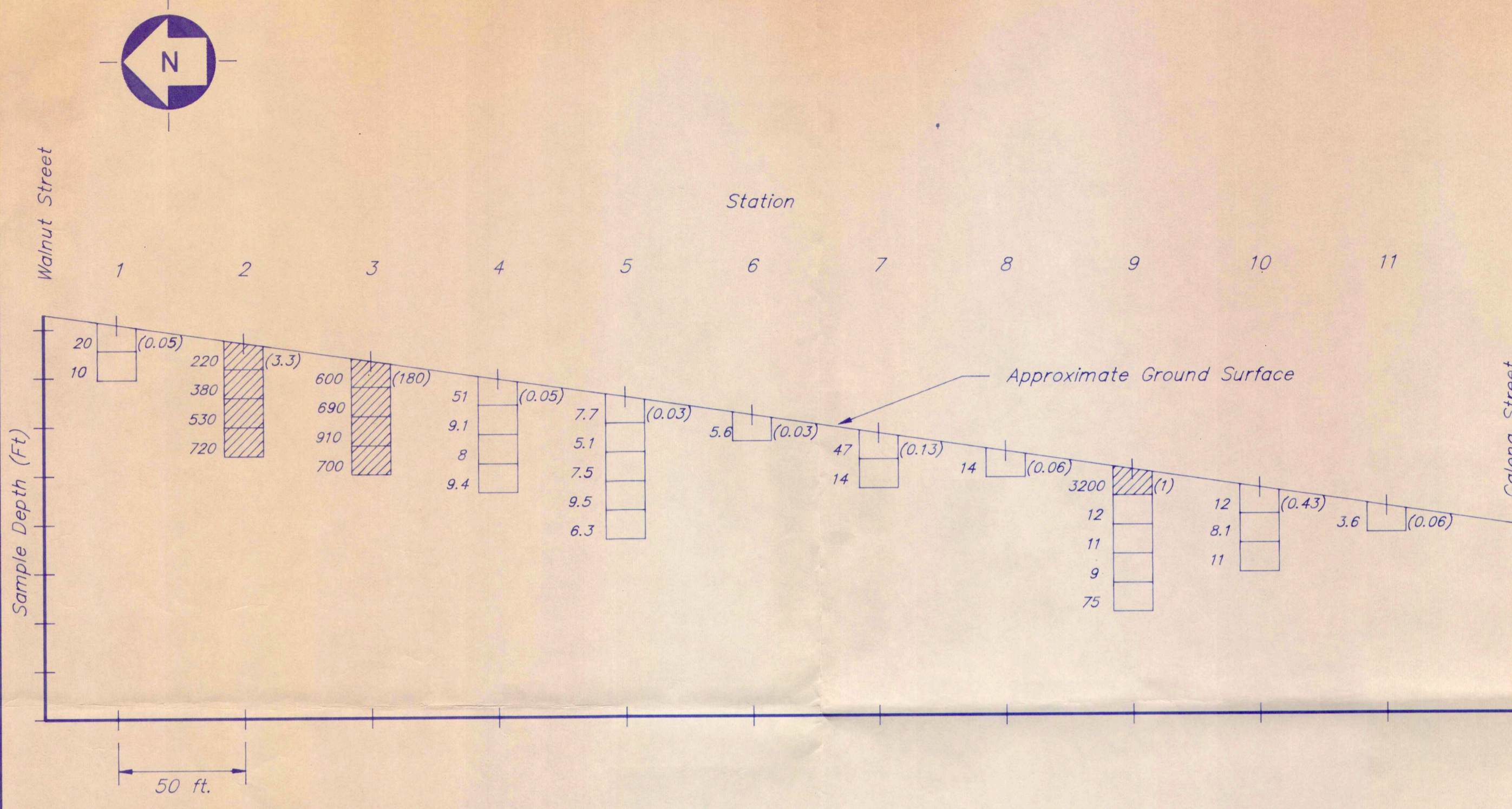

SECTION 'E'

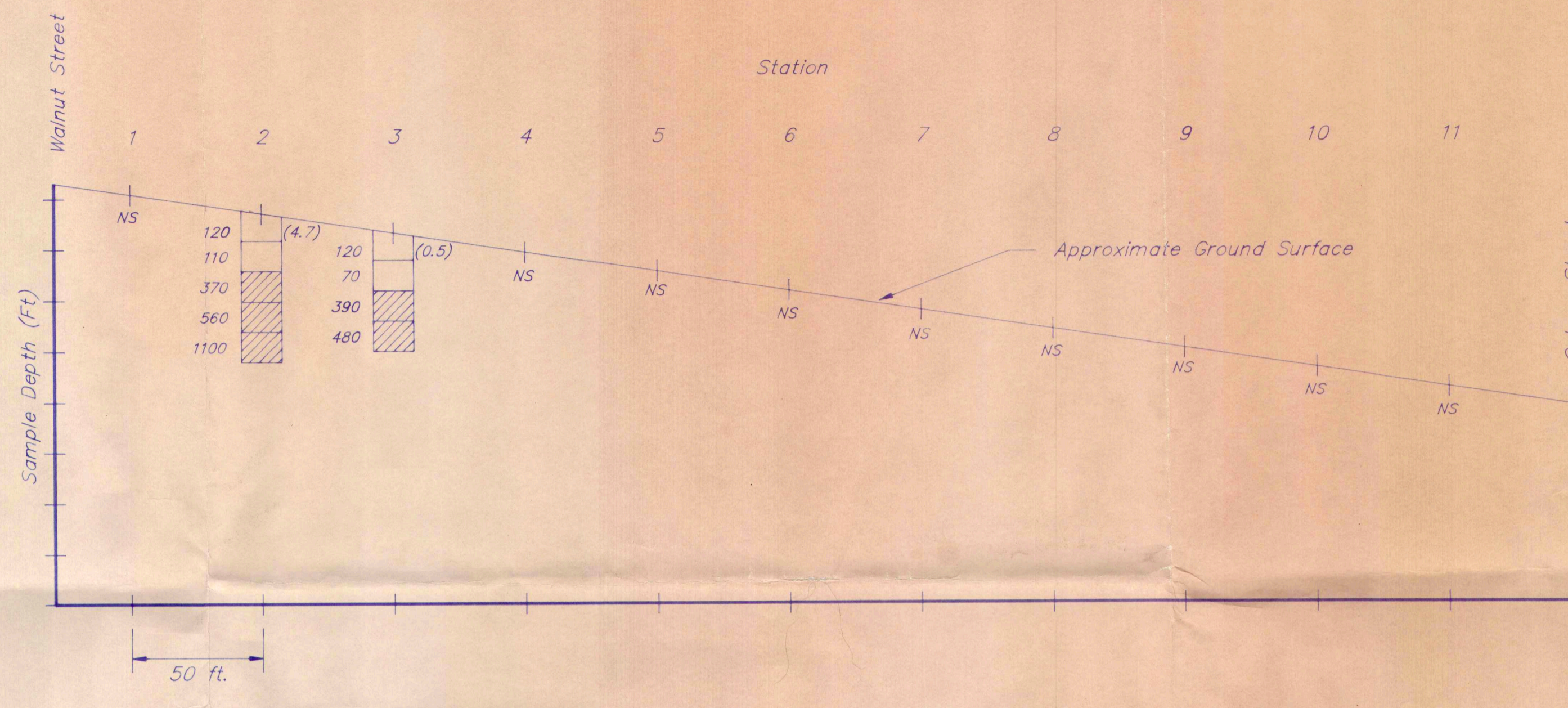

SECTION 'F'

**NOTE:**

- 1) All Values Are In ppm
- 2) 10 (0.50) = Total (Hexavalent) Chromium At Six Inch Sampling Interval
- 3) [Hatched Box] = Soil Sample Exceeds 200 ppm Total, Or 20 ppm Hexavalent Chromium
- 4) NS = No Sample(s)

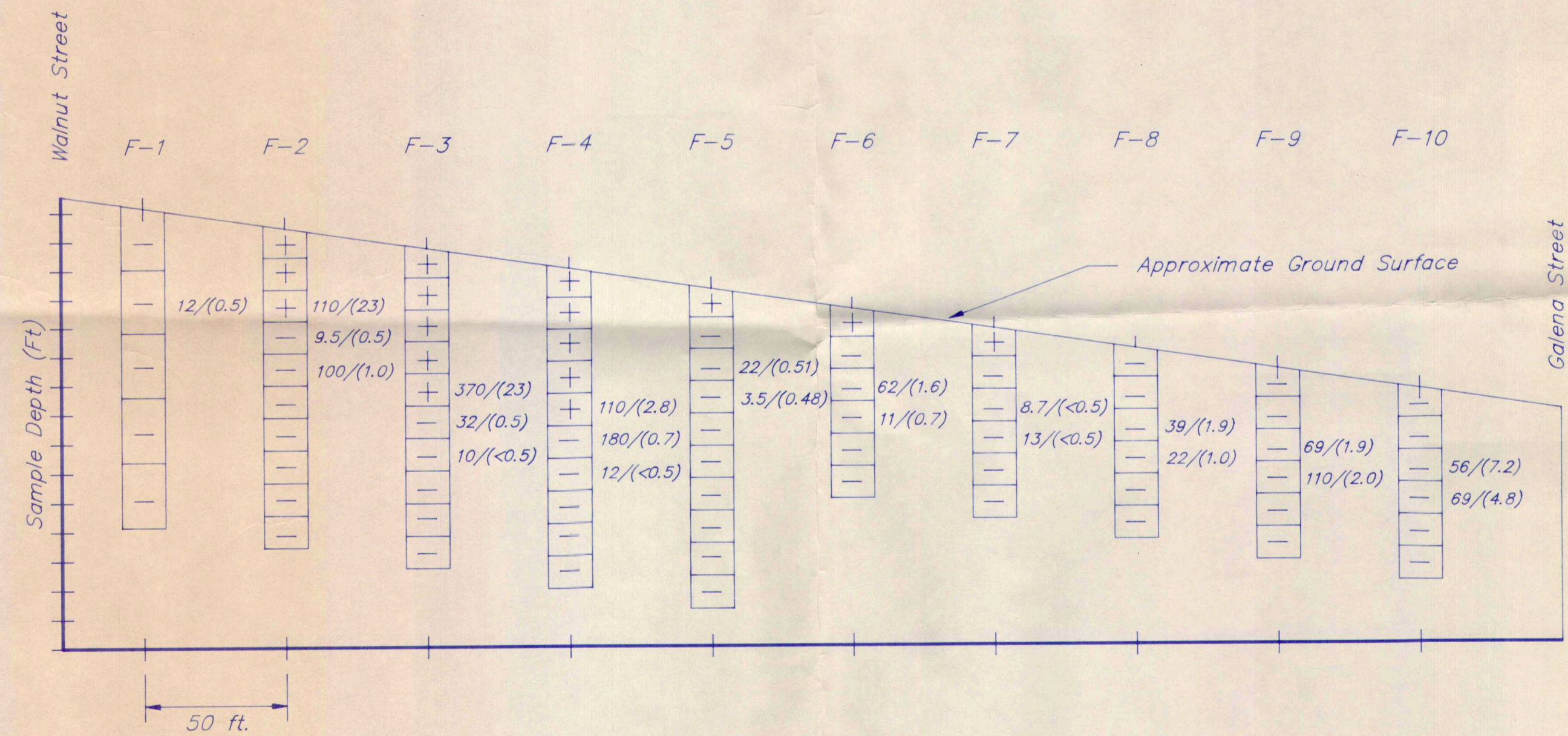

SECTION F-1 - F-10

**NOTE:**

- 1) + = Positive Field Test
- 2) - = Negative Field Test
- 3) 10/(0.5) = Total/(Hexavalent) Chromium, Laboratory Value
- 4) All Values In ppm

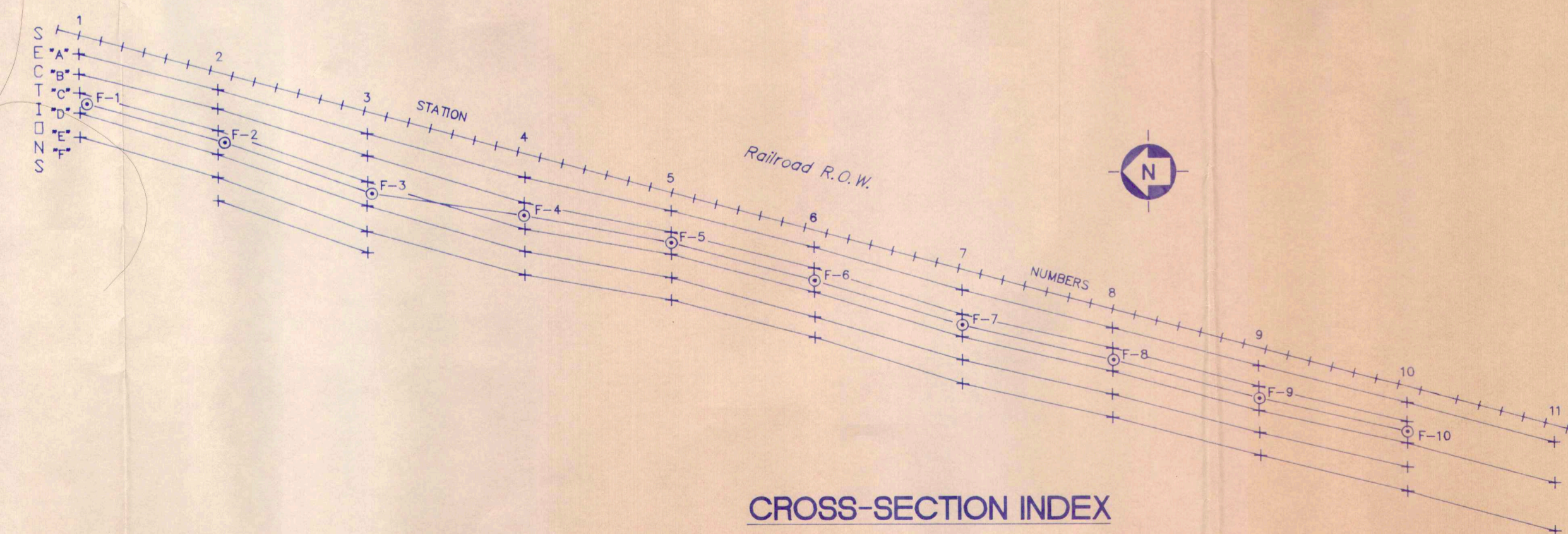

CROSS-SECTION INDEX

DEPARTMENT OF NATURAL RESOURCES  
 STATE OF WISCONSIN  
 WALNUT STREET SITE  
 MILWAUKEE, WISCONSIN

eder associates consulting engineers, p.c.  
 MILWAUKEE, WISCONSIN  
 MICHIGAN  
 NEW YORK

685-15 # 02-41-000793-7

PROJECT  
 DEPARTMENT OF NATURAL RESOURCES  
 STATE OF WISCONSIN  
 WALNUT STREET SITE  
 MILWAUKEE, WISCONSIN

TITLE  
 AREA 2  
 CHROMIUM CONCENTRATIONS  
 CROSS-SECTIONS E, F, F-1 - F-10

eder associates consulting engineers, p.c.  
 LOCUST VALLEY, NEW YORK • MADISON, WISCONSIN  
 ANN ARBOR, MICHIGAN

DRAWN BY	JIK	SCALE	AS SHOWN
DESIGNED BY	DJO	PROJECT No.	685-1
APPROVED BY	WJC	DWG. No.	6
DATE	MARCH, 1990		