

RECEIVED

JUL 19 2012

Remediation &
Redevelopment

AYRES
ASSOCIATES

July 16, 2012

Mr. Gary A. Edelstein, PE
Wisconsin Department of Natural Resources
Bureau for Remediation and Redevelopment - RR/5
PO Box 7921
Madison, WI 53707

SUBJECT: Annual Groundwater Monitoring Report and Semi-Annual Inspection Report
April 2012 Monitoring Event
Stoughton City Landfill
FID No.113005950 - License No. 00133
USEPA ID #WID980901219

Dear Mr. Edelstein:

This letter provides the Annual Groundwater Monitoring Report and the Semi-Annual Inspection Report for the April 2012 monitoring events at the Stoughton City Landfill, located in Stoughton, Wisconsin. Ayres Associates conducted the annual groundwater monitoring event on April 26, 2012, and the semi-annual facility inspection on April 30, 2012. A CD-ROM with the electronic data files of analytical results is also being submitted to the Wisconsin Department of Natural Resources (WDNR) Central Office, along with the WDNR *Environmental Monitoring Data Certification* Form 4400-231 (R1/04).

1.0 Semi-Annual Inspection Results

The semi-annual facility inspection was conducted on April 30, 2011. The following items were noted during the inspection.

Perimeter Security Fencing - No broken slats or signs of vandalism were noted for the wooden perimeter fence. Site signage was unobstructed and legible. The chain-link fencing at the site was in good condition with no damage or vandalism noted. Access gates were in satisfactory condition with both padlocks functioning properly. No further action is required for this inspection feature.

Stormwater Management System - No visible erosion was observed in the drainage channels, and the culverts appeared undamaged. Existing riprap was clogged with obstructions and sediment in the south stormwater drainage feature. Obstructions included cattails and woody vegetation. Refer to the October 2011 semi-annual inspection report for photographs of these areas.

Landfill Cover - Vegetation on the landfill cap was emerging. The ground surface was wet due to recent rains. No localized areas of ponding or bare soil were observed.

One gully, approximately 12-inches deep was observed on the northwest side of the landfill cap near gas vent 18 (GV-18). Three areas of animal burrows and established woody vegetation were also observed near GV-10, GV-11, and GV-12 during this inspection. These

Mr. Gary A. Edelstein
July 16, 2012
Page 2

items will be repaired prior to the next semi-annual inspection. Refer to the October 2011 semi-annual inspection report for photographs of these areas.

Landfill Gas Venting System - All 21 gas vents and screens were in good condition and unobstructed. No further action is required for this inspection feature.

Monitoring Wells and Wellhead Covers - Several of monitoring wells and wellhead protective covers are in poor condition and require corrective action as detailed in the October 2011 semi-annual report. Deficiencies observed at the site which will be repaired prior to the next semi-annual inspection include:

- Broken hinges on protective well casings
- Missing expandable well caps
- Artesian/flowing wells requiring plugging

In addition to the items listed above, the following deficiencies were noted during the April 2012 semi-annual inspection.

- Monitoring well MW-09B is incorrectly labeled (stenciled) as "MW-09D" on the protective casing at the site. Recommend repainting and labeling at the site. Refer to Photograph 2012-04-001 in Attachment A for a depiction of this deficiency.
- Monitoring well OW-04 has visible evidence of tampering due to graffiti on the protective casing. Recommend repainting and labeling at the site. Refer to Photograph 2012-04-002 in Attachment A for a depiction of this deficiency.

Access Road - The site access road was in good condition with no ruts or erosion noted. No further action is required for this inspection feature.

Refer to Attachment B for the field form completed during the semi-annual inspection.

2.0 Bi-Monthly Gas Monitoring Results

Bi-monthly gas monitoring of the three perimeter gas probes was conducted on December 30, 2011, February 29, 2012, and April 23, 2012. Based on the monitoring results, migration of landfill gas to the north of the landfill was not occurring during the event. The completed field forms for the Bi-Monthly Gas Monitoring Inspections are included in Attachment C.

3.0 Annual Groundwater Monitoring Event

3.1 Field Procedures

The field procedures for groundwater sample collection were conducted in accordance with provisions detailed in the WDNR-approved *Quality Assurance Project Plan (QAPP), Operation and Maintenance, Stoughton City Landfill, Stoughton, Wisconsin* (Ayres, April 2011).

CT Laboratories of Baraboo, Wisconsin, analyzed the groundwater samples for volatile organic compounds (VOCs) including dichlorodifluoromethane (DCDFM) and tetrahydrofuran (THF) by EPA Method SW 8260B.

3.2 Groundwater Monitoring Analytical Results

A summary of detections and NR 140 Wisconsin Administrative Code standard exceedances from analytical results for the groundwater monitoring event is provided in Table 1. A summary of field parameter measurements as collected during the event is provided as Table 2. A water table elevation summary is included as Table 3.

The original laboratory analytical report is enclosed as Attachment D.

3.2.1 Target Compounds at the Shallow Monitoring Wells

Three shallow monitoring wells were analyzed for either the full list of VOCs by Method 8260B. Analytical results and historical ranges for the current sampling event are summarized in Table 4.

3.2.2. Target Compounds at the Intermediate and Deep Monitoring Wells

Ten intermediate and deep monitoring wells were analyzed for the full list of volatile organic compounds (VOCs) by Method 8260B or for dichlorodifluoromethane (DCDFM) and Tetrahydrofuran (THF) only by Method 8260B. Analytical results and historical ranges for the current sampling event are summarized in Table 4.

3.3.3 Other VOCs Detected

The following VOCs, in addition to DCDFM and THF, were detected above the preventive action limit (PAL):

Compound	ES (µg/L)	PAL (µg/L)	Result (µg/L)
MW-9I			
Trichloroethene	5	0.5	0.89
MW-13I			
Tetrahydrofuran	50	10	11
MW-14I			
Tetrachloroethene	5	0.5	0.62
MW-14S			
Tetrachloroethene	5	0.5	1.7

Notes:

1. **Bolded** values indicate an exceedance of the NR 140 PAL.

Several other VOCs were detected at levels below their respective PAL and ES limits as summarized in Table 1.

3.3.4 Sampling Plan Deviations

There were no deviations from the sampling plan.

Mr. Gary A. Edelstein
July 16, 2012
Page 4

4.0 Recommendations

Due to PAL exceedances for THF, tetrachloroethene, and trichloroethene, we recommend continuing the VOC monitoring program.

If you have any questions regarding site activities or this report, feel free to contact me by phone at 608.443.1298 or by e-mail at carneyn@ayresassociates.com.

Sincerely,

Ayres Associates Inc

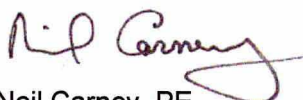
A handwritten signature in dark ink, appearing to read "Neil Carney". The signature is fluid and cursive, with a large loop at the end.

Neil Carney, PE
Project Manager

NC:sm

Attachments

cc: Ms. Nefertiti DiCosmo - USEPA Region V

5C

Notice: Personally identifiable information collected will be used for program administration and enforcement purposes. The Department may also provide this information to requesters as required under Wisconsin's Open Records law, ss. 19.31 to 19.39, Wis. Stats.

When submitting monitoring data, the owner or operator of the facility, practice or activity is required to notify the Department in writing that a groundwater standard or an explosive gas level has been attained or exceeded, as specified in ss. NR 140.24(1)(a); NR 140.26(1)(a); NR 507.30NR 635.14(9)(a); NR 635.18(20) and NR 507.30, Wis. Adm. Code. Failure to report may result in fines, forfeitures or other penalties resulting from enforcement under ss. 289.97, 291.97 or 299.95, Wis. Stats.

RECEIVED
AUG 1 2012

RECEIVED

Instructions:

- Prepare one form for each license or monitoring ID.
- Please type or print legibly.
- Attach a notification of any values that attain or exceed groundwater standards (that is, preventive action limits, enforcement standards or alternative concentration limits). The notification must include a preliminary analysis of the cause and significance of each value.
- Attach a notification of any gas values that attain or exceed explosive gas levels.
- Send the original signed form, any notification, and Electronic Data Deliverable [EDD] to: GEMS Data Submittal Contact - WA/5
Bureau of Waste Management
Wisconsin Department of Natural Resources
101 South Webster Street
Madison WI 53707-7921

Remediation & Redevelopment

JUL 18 2012

Waste & Materials Management

Monitoring Data Submittal Information

Name of entity submitting data (laboratory, consultant, facility owner):

Contact for questions about data formatting. Include data preparer's name, telephone number and E-mail address:

Name: Neil E. Carney Phone: (608) 443-1298

E-mail: carneyn@ayresassociates.com

Facility name:	License # / Monitoring ID	Facility ID [FID]	Actual sampling dates (e.g., July 2-6, 2003)
Stoughton City Landfill	License# - 00133 FID - 13005950		April 26, 2012

The enclosed results are for sampling required in the month(s) of: (e.g., June 2003)

Type of Data Submitted (Check all that apply)

- | | |
|---|--|
| <input checked="" type="checkbox"/> Groundwater monitoring data from monitoring wells | <input type="checkbox"/> Gas monitoring data |
| <input type="checkbox"/> Groundwater monitoring data from private water supply wells | <input type="checkbox"/> Air monitoring data |
| <input type="checkbox"/> Leachate monitoring data | <input type="checkbox"/> Other (specify) |

Notification attached?

- No. No groundwater standards or explosive gas limits were exceeded.
- Yes, a notification of values exceeding a groundwater standard is attached. It includes a list of monitoring points, dates, sample values, groundwater standard and preliminary analysis of the cause and significance of any concentration.
- Yes, a notification of values exceeding an explosive gas limit is attached. It includes the monitoring points, dates, sample values and explosive gas limits.

Certification

To the best of my knowledge, the information reported and statements made on this data submittal and attachments are true and correct. Furthermore, I have attached complete notification of any sampling values meeting or exceeding groundwater standards or explosive gas levels, and a preliminary analysis of the cause and significance of concentrations exceeding groundwater standards.

Neil E. Carney, PE Project Manager (608) 443-1298
Facility Representative Name (Print) Title (Area Code) Telephone No.

Neil E. Carney Signature July 16, 2012 Date

FOR DNR USE ONLY. Check action taken, and record date and your initials. Describe on back side if necessary.

Found uploading problems on _____ Initials _____

Notified contact of problems on _____ Uploaded data successfully on 7/18/12 WJS

EDD format(s): Diskette CD (initial submittal and follow-up) E-mail (follow-up only) Other

Preventive Action Limit (PAL) Exceedances
Stoughton Cty (00133)

WELL : 125 MW-9I

DATE	PARAMETER	DESCRIPTION	RESULT	PAL	LOD	UNIT
04/26/2012	39180	TRICHLOROETHYLENE	.89	.5	.5	UG/L

WELL : 131 MW-13I

DATE	PARAMETER	DESCRIPTION	RESULT	PAL	LOD	UNIT
04/26/2012	81607	TETRAHYDROFURAN	11	10	1.8	UG/L

WELL : 133 MW-14S

DATE	PARAMETER	DESCRIPTION	RESULT	PAL	LOD	UNIT
04/26/2012	34475	TETRACHLOROETHYLENE	1.7	.5	.29	UG/L

WELL : 134 MW-14I

DATE	PARAMETER	DESCRIPTION	RESULT	PAL	LOD	UNIT
04/26/2012	34475	TETRACHLOROETHYLENE	.62	.5	.29	UG/L

Tables

TABLE 1

**Summary of Detected Compounds and Exceedances
Annual Groundwater Report
Stoughton City Landfill
April 2012**

Compound	ES (µg/L)	PAL (µg/L)	Result (µg/L)
MW-3D			
Tetrahydrofuran	50	10	3.7
MW-5D			
Dichlorodifluoromethane	1000	200	2.8
MW-7I			
Tetrahydrofuran	50	10	3.6
MW-7I DUP			
Tetrahydrofuran	50	10	4.1
MW-9B			
cis-1,2-Dichloroethene	70	7	0.43
Dichlorodifluoromethane	1000	200	7.2
Trichlorofluoromethane	3490	698	5.2
MW-9I			
1,2,3-Trichloropropane	60	12	0.5
cis-1,2-Dichloroethene	70	7	1.0
Dichlorodifluoromethane	1000	200	54
Trichlorofluoromethane	3490	698	1.3
Tetrachloroethene	5	0.5	0.38
Trichloroethene	5	0.5	0.89
MW-9S			
Benzene	5	0.5	0.38
Dichlorodifluoromethane	1000	200	69
Trichlorofluoromethane	3490	698	1.8
MW-10S			
Dichlorodifluoromethane	1000	200	0.91
MW-13I			
Dichlorodifluoromethane	1000	200	5.8
Tetrahydrofuran	50	10	11
MW-14I			
Dichlorodifluoromethane	1000	200	14
Trichlorofluoromethane	3490	698	0.67
Tetrachloroethene	5	0.5	0.62
MW-14S			
Dichlorodifluoromethane	1000	200	7.8
Tetrachloroethene	5	0.5	1.7

Notes:

1. The Preventive Action Limit (PAL) and the Enforcement Standard (ES) are from the Wisconsin Department of Natural Resources NR 140.10, Table 1 (December 2010)
2. PAL - Preventive Action Limit
3. ES - Enforcement Standard
4. µg/L- micrograms per liter
5. **Bolded** values indicate and exceedance of the NR 140 PAL.

TABLE 2

**Summary of Field Parameters
Annual Groundwater Report
Stoughton City Landfill
April 2012**

Monitoring Well Number	DNR Point ID	Sampling Date	Depth to Water (ft.)	Total Depth (ft.)	Total Volume Purged (gal.)	Temperature (°C)	pH (s.u.)	Specific Conductivity (ms/cm)
MW3D	112	4/26/2012	10.25	73.0	10.3	10.42	7.50	0.823
MW4D	115	4/26/2012	7.62	74.0	11.0	10.84	7.65	0.940
MW5D	117	4/26/2012	7.50	77.0	46.0	9.49	7.33	0.843
MW7I	119	4/26/2012	0.92	60.0	38.5	10.25	7.23	0.895
MW8I	122	4/26/2012	0.35	62.4	90.5	9.22	6.73	1.051
MW9S	124	4/26/2012	2.62	13.4	7.0	10.91	7.10	0.656
MW9I	125	4/26/2012	2.91	21.5	12.3	10.34	6.97	0.730
MW9B	126	4/26/2012	2.68	83.3	52.8	10.04	7.20	0.734
MW10S	127	4/26/2012	3.78	16.9	6.0	9.21	7.08	0.575
MW10I	128	4/26/2012	-	39.8	Self Purging	10.06	6.49	0.735
MW13I	131	4/26/2012	-	51.5	Self Purging	10.13	7.61	0.613
MW14S	133	4/26/2012	5.74	26.2	13.5	12.24	7.34	0.470
MW14I	134	4/26/2012	3.03	51.2	32.0	10.27	7.45	0.701
MW7I DUP	---	4/26/2012	-	-	-	-	-	-
MW10I DUP	---	4/26/2012	-	-	-	-	-	-
Trip Blank	---	4/26/2012	-	-	-	-	-	-
Field Blank	---	4/26/2012	-	-	-	-	-	-

TABLE 3

**Water Table Elevation Summary
Annual Groundwater Report
Stoughton City Landfill
April 2012**

Well	DNR ID#	Measured Depth to Water (ft)	Total Well Depth (ft)	Screen Length (ft)	Bottom of Screen Elevation	Ground Surface Elevation (ft)	Above-Ground Riser Height (ft)	New TOC Elevation (ft)	NewGW Elevation (ft)
MW3D	112	10.25	73.0	10.0	--	857.07	1.9	855.17	844.92
MW4D	115	7.62	74.0	10.0	--	854.17	2.1	852.08	844.46
MW5D	117	7.50	77.0	10.0	--	854.15	1.8	852.35	844.85
MW7I	119	0.92	60.0	10.0	--	846.69	2.7	843.99	843.07
MW8I	122	0.35	62.4	10.0	--	--	2.1	846.32	845.97
MW9S	124	2.62	13.4	10.0	--	848.98	1.8	847.23	844.61
MW9I	125	2.91	21.5	10.0	--	849.18	2.0	847.14	844.23
MW9B	126	2.68	83.3	10.0	--	848.88	2.2	846.68	844.00
MW10S	127	3.78	16.9	10.0	829.98	--	2.4	846.88	843.10
MW10I	128	0.00	39.8	10.0	806.06	--	2.1	845.86	845.86
MW13I	131	0.00	57.5	10.0	795.52	--	2.4	853.02	853.02
MW14S	133	5.74	26.2	10.0	--	--	2.4	848.73	842.99
MW14I	134	3.03	51.2	10.0	--	--	1.5	847.38	844.35

TABLE 4

Historical Target Compound Detections
Annual Groundwater Report
Stoughton City Landfill
April 2012

Shallow Monitoring Wells				
Well	Current Event Concentration (µg/L)		Historical Range (µg/L)	
	DCDFM	THF	DCDFM	THF
MW3S	NA	NA	ND	ND
MW4S	NA	NA	ND	ND-0.84
MW5S	NA	NA	ND-5.2	ND
MW7S	NA	NA	ND	ND-0.87
MW8S	NA	NA	ND	ND
MW9S	69	ND	33-400	ND-22
MWI0S	0.91	ND	ND-20	ND-20
MW13S	NA	NA	ND	ND
MW14S	7.8	ND	7.8-710	ND-50
MW15S	NA	NA	ND	ND-0.76

Intermediate and Deep Monitoring Wells				
Well	Current Event Concentration (µg/L)		Historical Range (µg/L)	
	DCDFM	THF	DCDFM	THF
MW3D	ND	3.7	ND	3.2-310
MW3B	NA	NA	ND	ND-1.9
MW4D	ND	ND	ND	ND-2.2
MW5D	2.8	ND	0.92-10	1.2-4.0
MW7I	ND	4.1	ND	ND-4.1
MW7B	NA	NA	ND	ND-1.7
MW8I	ND	ND	ND	ND-20
MW8B	NA	NA	ND	ND
MW9I	54	ND	12-340	ND-12
MW9B	7.2	ND	2.3-25	ND-2.4
MW10I	ND	ND	ND-280	ND-21
MWI0D	NA	NA	ND	ND
MWI3I	5.8	11	ND-5.8	ND-22
MWI3D	NA	NA	ND-0.61	ND-9.3
MWI4I	14	ND	14-590	ND-2.4
MW14D	NA	NA	ND-1.5	ND-0.47
MW15I	NA	NA	ND	ND
MWI5D	NA	NA	ND	ND

Notes:

DCDFM - dichlorodifluoromethane

THF - tetrahydrofuran

ND - No detections

NA - Not analyzed

Figure

4/15/2011
 Project: Stoughton
 File: L:\LANDFILL\Stoughton\Figure 1 - Site map.dgn

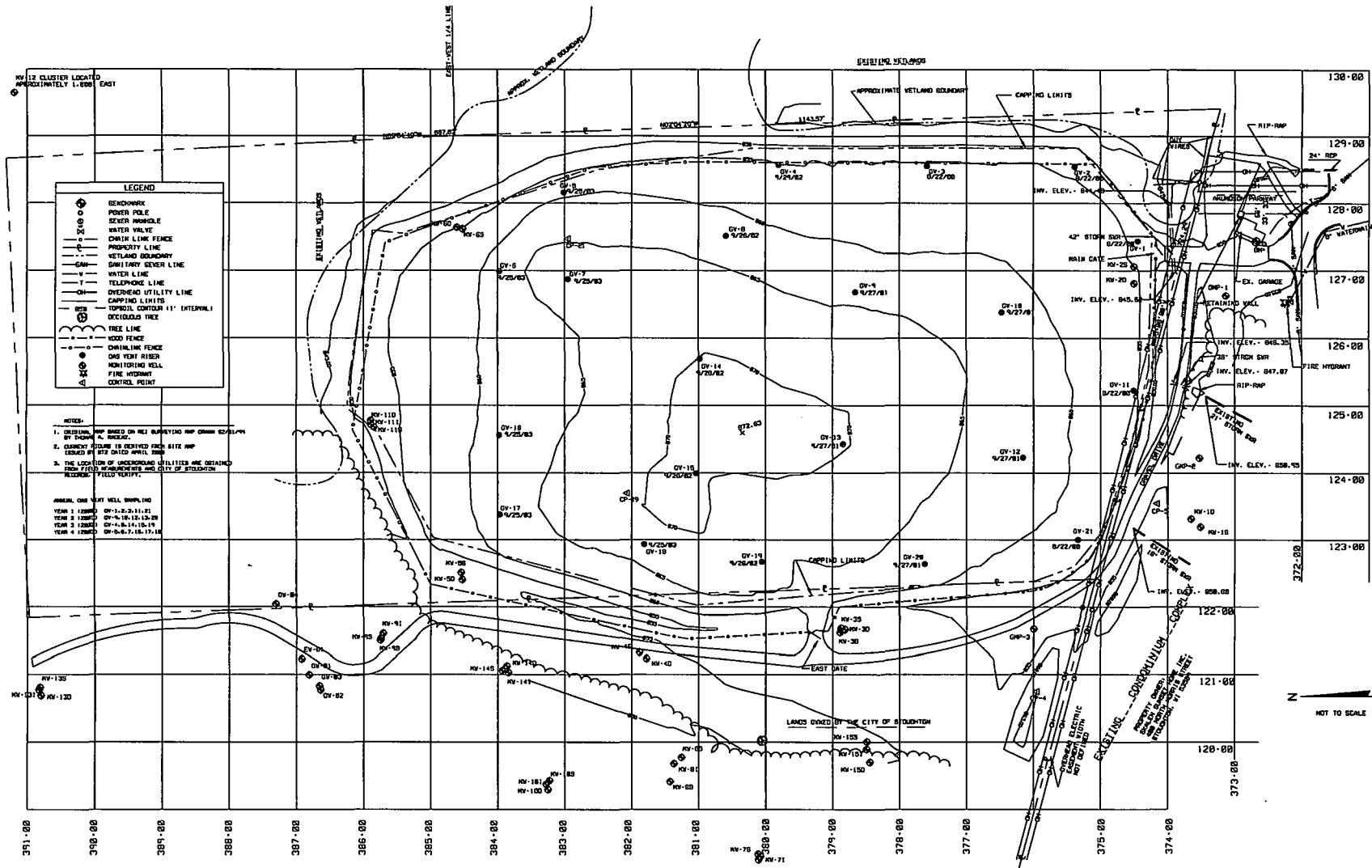

DR. BY T. SHARPE
 CH. BY H. CARRER
 DATE 04/15/11

STOUGHTON CITY LANDFILL
 STOUGHTON, WISCONSIN

AVRES
 ASSOCIATES
 800 WEST WISCONSIN

SITE MAP

FIGURE NO.
1

Attachment A
Photolog

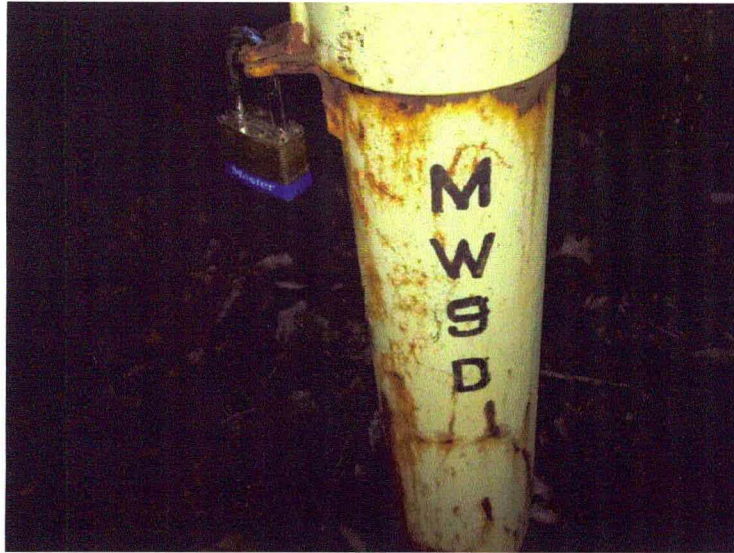

2012-04-001: MW-9B is mislabeled as "MW-9D"
Date: 30-April-2012
Time: 7:25 PM
Weather: Cloudy, 54 Degrees F.



2012-04-002: Graffiti is present on OW-04.
Date: 30-April-2012
Time: 7:30 PM
Weather: Cloudy, 54 Degrees F.

Signature of Photographer: *Rip Carney*

Attachment B
Semi-annual Inspection Report
April 2012

**Operation and Maintenance Semi Annual Inspection Report
Stoughton City Landfill
Stoughton, Wisconsin**

Inspector N. Carney
 Company Ayres Associates
 Project Stoughton City LF
 Location Stoughton, WI
 Date/Time April 30, 2012 (6:30 PM)
 Project No. 19-0270.20

Weather	Clear	P. Cloudy	<u>Cloudy</u>	Fog
Temperature	High <u>54°F</u>	<u>ⓔ</u>	---	---
Wind	Calm	<u>Medium</u> <u>6 MPH</u>	High	---
Precipitation	Rain	<u>Light</u>	Moderate	Heavy
	Snow	Light	Moderate	Heavy

- Rain/Drizzle during AM
 - Cloudy in PM

Type of Inspection Routine Special

Persons/Equipment Present: Neil Carney

General Description of Site Conditions: Overall good site conditions. Growth on landfill cap is emergent. Cattails and vegetative growth observed in south drainage swale as noted in Oct 2011 Report. Animal burrows and vegetation are present as noted in Oct 2011 report. Repairs to be conducted prior to next semi-annual inspection for cap burrows and vegetation. Date for swale repair TBD.

Specific Inspection Items	Potential Problem Areas	Status *	Notes
Perimeter Security Fencing	Broken or missing wood slats, torn chain link fabric.	I	Good condition
Entrance Gate and Locking Mechanism	Lock broken/missing, mechanism inoperative.	I	Good condition
Monitoring Wells and Wellhead Covers	<u>MW-09B mislabeled. Graffiti on OW-4</u> Signs of tampering, casing damaged, lock missing.	2	MW Hinges to be repaired prior to next inspection. <u>See 10-2011 Report.</u>
Final Cover Vegetation	Bare spots, stressed vegetation, deep rooted vegetation.	I	Excellent condition
Final Cover Slope (explain below)	Gullies, lack of vegetation, subsidence, ponding.	I	Good condition
Evidence of Burrowing Animals	Damage to final cover, evidence of waste.	2	To be repaired prior to next inspection. <u>See above.</u>
Stormwater Drainage Channels	Gullies, erosion, debris, culvert blocked.	2	Cattails & woody vegetation present. <u>see Above.</u>
Landfill Gas Venting System	Damaged or blocked vent risers, stressed vegetation.	I	Good Condition
Access Road	Ponding, rutting, erosion.	I	
Cover Mowing and Tall Vegetation	Mowing and tall vegetation removal done to specified vegetation	1	Good Condition.
Removal (October Inspection Only)	light, any missed areas		

* (1) Acceptable - No Maintenance Required. (2) Not Acceptable - Identify Required Maintenance.

Summary of Deficiencies and/or Corrective Actions: Graffiti present on OW-4. Monitoring Well "MW-09B" mislabeled as "MW-09D"

Signature of Inspector N. Carney Date 30-Apr-2012

Attachment C
Bi-monthly Gas Monitoring Reports
December 2011
February 2012
April 2012

Gas Probe Monitoring Report
Stoughton City Landfill
Stoughton, Wisconsin

Probe	%LEL (as methane)	% Oxygen	%CO2	PID (ppm)	Pressure (inches of water) Hg
GMP-1	0.0	20.1	0.0%	0.0	29.81
GMP-2	0.0	19.7	0.5%	0.0	29.81
GMP-3	0.0	19.7	0.1%	0.0	29.81

Instruments

Used: GEM2000, Thermo 5883 OVM

Operator: Neil Carney

Date: 30-Dec-2011

Weather Conditions: Light Snow

Barometric Pressure (inches of Hg): 29.62 Temperature (Degrees F): 34°

Relative Humidity (%): 90% Dewpoint (Degrees F): 29° Wind: 12 MPH

Sky Conditions: Cloudy / Snow

Ground Conditions:

Snow No Snow Frozen Ground/Frost Ice

Gas Probe Monitoring Report
Stoughton City Landfill
Stoughton, Wisconsin

Probe	%LEL (as methane)	% Oxygen	%CO2	PID (ppm)	Pressure (inches of water Hg)
GMP-1	0.00	21.1	0.01	0.00	28.54
GMP-2	0.00	21.3	0.02	0.00	28.54
GMP-3	0.00	21.2	0.03	0.00	28.54

Instruments Used: GEM-2000, Thermo 580B OUM

Operator: Nail Carney

Date: 29-Feb-2012 5PM

Weather Conditions:

Barometric Pressure (inches of Hg): 29.20 Temperature (Degrees F): 34°F

Relative Humidity (%): 89% Dewpoint (Degrees F): 32° Wind: 10-15 mph

Sky Conditions: Drizzle / Snow

Ground Conditions:

Snow No Snow Frozen Ground/Frost

Gas Probe Monitoring Report
Stoughton City Landfill
Stoughton, Wisconsin

Probe	%LEL (as methane)	% Oxygen	%CO2	PID (ppm)	Pressure (inches of water)Hg
GMP-1	0.0%	18.9%	1.4%	0.0	28.94
GMP-2	0.0%	17.8%	2.3%	0.0	28.95
GMP-3	0.0%	15.8%	2.9%	0.0%	28.94

Instruments Used: GEM-2000 , Thermo 5803 OUM

Operator: Neil Carney

Date: 23-Apr-2012

Weather Conditions:

Barometric Pressure (inches of Hg): 29.90 Temperature (Degrees F): 55°

Relative Humidity (%): 34% Dewpoint (Degrees F): 27° Wind: NW 15MPH

Sky Conditions: Partly Sunny

Ground Conditions:

Snow No Snow Frozen Ground/Frost

Attachment D
Laboratory Analytical Report



ANALYTICAL REPORT

AYRES ASSOCIATES
NEIL CARNEY
1802 PANKRATZ ST
MADISON, WI 53704-4069

Project Name: STOUGHTON LF
Project Phase:
Contract #: 2377
Project #: 19-0270.20
Folder #: 90543
Purchase Order #:

Page 1 of 32
Arrival Temperature: See COC
Report Date: 05/07/2012
Date Received: 04/27/2012
Reprint Date: 05/10/2012

CT LAB Sample#: 155888	Sample Description: TRIP BLANK	DNR License/Well #: 00133/999	Sampled: 04/26/2012
------------------------	--------------------------------	-------------------------------	---------------------

Analyte	Result	Units	LOD	LOQ	Dilution	Qualifier	Prep Date/Time	Analysis Date/Time	Analyst	Method
Organic Results										
1,1,1,2-Tetrachloroethane	<0.40	ug/L	0.40	1.4	1			04/30/2012 11:34	APG	EPA 8260B
1,1,1-Trichloroethane	<0.29	ug/L	0.29	0.96	1			04/30/2012 11:34	APG	EPA 8260B
1,1,2,2-Tetrachloroethane	<0.30	ug/L	0.30	1.1	1			04/30/2012 11:34	APG	EPA 8260B
1,1,2-Trichloroethane	<0.40	ug/L	0.40	1.2	1			04/30/2012 11:34	APG	EPA 8260B
1,1-Dichloroethane	<0.30	ug/L	0.30	1.1	1			04/30/2012 11:34	APG	EPA 8260B
1,1-Dichloroethene	<0.24	ug/L	0.24	0.79	1			04/30/2012 11:34	APG	EPA 8260B
1,1-Dichloropropene	<0.40	ug/L	0.40	1.3	1			04/30/2012 11:34	APG	EPA 8260B
1,2,3-Trichlorobenzene	<0.40	ug/L	0.40	1.4	1			04/30/2012 11:34	APG	EPA 8260B
1,2,3-Trichloropropane	<0.40	ug/L	0.40	1.2	1			04/30/2012 11:34	APG	EPA 8260B
1,2,4-Trichlorobenzene	<0.40	ug/L	0.40	1.2	1			04/30/2012 11:34	APG	EPA 8260B
1,2,4-Trimethylbenzene	<0.40	ug/L	0.40	1.2	1			04/30/2012 11:34	APG	EPA 8260B
1,2-Dibromo-3-chloropropane	<0.40	ug/L	0.40	1.3	1			04/30/2012 11:34	APG	EPA 8260B
1,2-Dibromoethane	<0.30	ug/L	0.30	1.0	1			04/30/2012 11:34	APG	EPA 8260B
1,2-Dichlorobenzene	<0.40	ug/L	0.40	1.2	1			04/30/2012 11:34	APG	EPA 8260B
1,2-Dichloroethane	<0.30	ug/L	0.30	1.0	1			04/30/2012 11:34	APG	EPA 8260B
1,2-Dichloropropane	<0.40	ug/L	0.40	1.3	1			04/30/2012 11:34	APG	EPA 8260B

Solid sample results reported on a Dry Weight Basis



CT LAB Sample#: 155888	Sample Description: TRIP BLANK	DNR License/Well #: 00133/999	Sampled: 04/26/2012
------------------------	--------------------------------	-------------------------------	---------------------

Analyte	Result	Units	LOD	LOQ	Dilution	Qualifier	Prep Date/Time	Analysis Date/Time	Analyst	Method
1,3,5-Trimethylbenzene	<0.40	ug/L	0.40	1.4	1			04/30/2012 11:34	APG	EPA 8260B
1,3-Dichlorobenzene	<0.30	ug/L	0.30	1.1	1			04/30/2012 11:34	APG	EPA 8260B
1,3-Dichloropropane	<0.29	ug/L	0.29	0.98	1			04/30/2012 11:34	APG	EPA 8260B
1,4-Dichlorobenzene	<0.30	ug/L	0.30	1.1	1			04/30/2012 11:34	APG	EPA 8260B
2,2-Dichloropropane	<0.30	ug/L	0.30	1.0	1			04/30/2012 11:34	APG	EPA 8260B
2-Butanone	<4.0	ug/L	4.0	13	1			04/30/2012 11:34	APG	EPA 8260B
2-Chlorotoluene	<0.30	ug/L	0.30	1.1	1			04/30/2012 11:34	APG	EPA 8260B
2-Hexanone	<4.0	ug/L	4.0	13	1			04/30/2012 11:34	APG	EPA 8260B
4-Chlorotoluene	<0.29	ug/L	0.29	0.95	1			04/30/2012 11:34	APG	EPA 8260B
4-Methyl-2-pentanone	<4.0	ug/L	4.0	12	1			04/30/2012 11:34	APG	EPA 8260B
Acetone	<2.9	ug/L	2.9	9.6	1			04/30/2012 11:34	APG	EPA 8260B
Benzene	<0.30	ug/L	0.30	1.0	1			04/30/2012 11:34	APG	EPA 8260B
Bromobenzene	<0.30	ug/L	0.30	1.1	1			04/30/2012 11:34	APG	EPA 8260B
Bromochloromethane	<0.50	ug/L	0.50	1.6	1			04/30/2012 11:34	APG	EPA 8260B
Bromodichloromethane	<0.30	ug/L	0.30	1.0	1			04/30/2012 11:34	APG	EPA 8260B
Bromoform	<0.30	ug/L	0.30	1.1	1			04/30/2012 11:34	APG	EPA 8260B
Bromomethane	<0.30	ug/L	0.30	1.0	1			04/30/2012 11:34	APG	EPA 8260B
Carbon disulfide	<0.50	ug/L	0.50	1.7	1			04/30/2012 11:34	APG	EPA 8260B
Carbon tetrachloride	<0.27	ug/L	0.27	0.90	1			04/30/2012 11:34	APG	EPA 8260B
Chlorobenzene	<0.28	ug/L	0.28	0.95	1			04/30/2012 11:34	APG	EPA 8260B
Chloroethane	<0.30	ug/L	0.30	1.1	1			04/30/2012 11:34	APG	EPA 8260B
Chloroform	<0.23	ug/L	0.23	0.77	1			04/30/2012 11:34	APG	EPA 8260B
Chloromethane	<0.27	ug/L	0.27	0.89	1			04/30/2012 11:34	APG	EPA 8260B
cis-1,2-Dichloroethene	<0.30	ug/L	0.30	1.1	1			04/30/2012 11:34	APG	EPA 8260B
cis-1,3-Dichloropropene	<0.26	ug/L	0.26	0.87	1			04/30/2012 11:34	APG	EPA 8260B

Solid sample results reported on a Dry Weight Basis

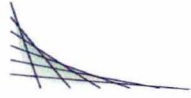

CT LAB Sample#: 155888	Sample Description: TRIP BLANK	DNR License/Well #: 00133/999	Sampled: 04/26/2012
------------------------	--------------------------------	-------------------------------	---------------------

Analyte	Result	Units	LOD	LOQ	Dilution	Qualifier	Prep Date/Time	Analysis Date/Time	Analyst	Method
Dibromochloromethane	<0.30	ug/L	0.30	1.0	1			04/30/2012 11:34	APG	EPA 8260B
Dibromomethane	<0.30	ug/L	0.30	1.0	1			04/30/2012 11:34	APG	EPA 8260B
Dichlorodifluoromethane	<0.40	ug/L	0.40	1.3	1			04/30/2012 11:34	APG	EPA 8260B
Diisopropyl ether	<0.30	ug/L	0.30	1.0	1			04/30/2012 11:34	APG	EPA 8260B
Ethylbenzene	<0.30	ug/L	0.30	1.0	1			04/30/2012 11:34	APG	EPA 8260B
Hexachlorobutadiene	<0.50	ug/L	0.50	1.6	1			04/30/2012 11:34	APG	EPA 8260B
Isopropylbenzene	<0.30	ug/L	0.30	1.1	1			04/30/2012 11:34	APG	EPA 8260B
m & p-Xylene	<0.60	ug/L	0.60	2.2	1			04/30/2012 11:34	APG	EPA 8260B
Methyl tert-butyl ether	<0.40	ug/L	0.40	1.2	1			04/30/2012 11:34	APG	EPA 8260B
Methylene chloride	<0.40	ug/L	0.40	1.3	1			04/30/2012 11:34	APG	EPA 8260B
n-Butylbenzene	<0.40	ug/L	0.40	1.4	1			04/30/2012 11:34	APG	EPA 8260B
n-Propylbenzene	<0.40	ug/L	0.40	1.3	1			04/30/2012 11:34	APG	EPA 8260B
Naphthalene	<0.30	ug/L	0.30	1.1	1			04/30/2012 11:34	APG	EPA 8260B
o-Xylene	<0.30	ug/L	0.30	1.0	1			04/30/2012 11:34	APG	EPA 8260B
p-Isopropyltoluene	<0.40	ug/L	0.40	1.2	1			04/30/2012 11:34	APG	EPA 8260B
sec-Butylbenzene	<0.30	ug/L	0.30	1.0	1			04/30/2012 11:34	APG	EPA 8260B
Styrene	<0.27	ug/L	0.27	0.89	1			04/30/2012 11:34	APG	EPA 8260B
tert-Butylbenzene	<0.40	ug/L	0.40	1.3	1			04/30/2012 11:34	APG	EPA 8260B
Tetrachloroethene	<0.29	ug/L	0.29	0.96	1			04/30/2012 11:34	APG	EPA 8260B
Tetrahydrofuran	<1.8	ug/L	1.8	5.1	1			04/30/2012 11:34	APG	EPA 8260B
Toluene	<0.30	ug/L	0.30	0.98	1			04/30/2012 11:34	APG	EPA 8260B
trans-1,2-Dichloroethene	<0.30	ug/L	0.30	1.1	1			04/30/2012 11:34	APG	EPA 8260B
trans-1,3-Dichloropropene	<0.30	ug/L	0.30	1.1	1			04/30/2012 11:34	APG	EPA 8260B
Trichloroethene	<0.50	ug/L	0.50	1.6	1			04/30/2012 11:34	APG	EPA 8260B
Trichlorofluoromethane	<0.30	ug/L	0.30	1.1	1			04/30/2012 11:34	APG	EPA 8260B

Solid sample results reported on a Dry Weight Basis



CT LAB Sample#: 155888	Sample Description: TRIP BLANK	DNR License/Well #: 00133/999	Sampled: 04/26/2012
------------------------	--------------------------------	-------------------------------	---------------------

Analyte	Result	Units	LOD	LOQ	Dilution	Qualifier	Prep Date/Time	Analysis Date/Time	Analyst	Method
Vinyl chloride	<0.18	ug/L	0.18	0.61	1			04/30/2012 11:34	APG	EPA 8260B

CT LAB Sample#: 155889	Sample Description: MW-3D	DNR License/Well #: 00133/112	Sampled: 04/26/2012 0835
------------------------	---------------------------	-------------------------------	--------------------------

Analyte	Result	Units	LOD	LOQ	Dilution	Qualifier	Prep Date/Time	Analysis Date/Time	Analyst	Method
---------	--------	-------	-----	-----	----------	-----------	----------------	--------------------	---------	--------

Organic Results

Dichlorodifluoromethane	<0.40	ug/L	0.40	1.3	1			04/30/2012 12:13	APG	EPA 8260B
Tetrahydrofuran	3.7	ug/L	1.8 *	5.1	1			04/30/2012 12:13	APG	EPA 8260B

CT LAB Sample#: 155890	Sample Description: MW-4D	DNR License/Well #: 00133/115	Sampled: 04/26/2012 0920
------------------------	---------------------------	-------------------------------	--------------------------

Analyte	Result	Units	LOD	LOQ	Dilution	Qualifier	Prep Date/Time	Analysis Date/Time	Analyst	Method
---------	--------	-------	-----	-----	----------	-----------	----------------	--------------------	---------	--------

Organic Results

Dichlorodifluoromethane	<0.40	ug/L	0.40	1.3	1			04/30/2012 12:51	APG	EPA 8260B
Tetrahydrofuran	<1.8	ug/L	1.8	5.1	1			04/30/2012 12:51	APG	EPA 8260B

CT LAB Sample#: 155891	Sample Description: MW-5D	DNR License/Well #: 00133/117	Sampled: 04/26/2012 1920
------------------------	---------------------------	-------------------------------	--------------------------

Analyte	Result	Units	LOD	LOQ	Dilution	Qualifier	Prep Date/Time	Analysis Date/Time	Analyst	Method
---------	--------	-------	-----	-----	----------	-----------	----------------	--------------------	---------	--------

Organic Results

Dichlorodifluoromethane	2.8	ug/L	0.40	1.3	1			04/30/2012 13:32	APG	EPA 8260B
Tetrahydrofuran	<1.8	ug/L	1.8	5.1	1			04/30/2012 13:32	APG	EPA 8260B



CT LAB Sample#: 155892	Sample Description: MW-71	DNR License/Well #: 00133/119	Sampled: 04/26/2012 1315
------------------------	---------------------------	-------------------------------	--------------------------

Analyte	Result	Units	LOD	LOQ	Dilution	Qualifier	Prep Date/Time	Analysis Date/Time	Analyst	Method
---------	--------	-------	-----	-----	----------	-----------	----------------	--------------------	---------	--------

Organic Results

Dichlorodifluoromethane	<0.40	ug/L	0.40	1.3	1			04/30/2012 14:12	APG	EPA 8260B
Tetrahydrofuran	3.6	ug/L	1.8 *	5.1	1			04/30/2012 14:12	APG	EPA 8260B

CT LAB Sample#: 155893	Sample Description: MW-71 DUP	DNR License/Well #: 00133/119	Sampled: 04/26/2012 1315
------------------------	-------------------------------	-------------------------------	--------------------------

Analyte	Result	Units	LOD	LOQ	Dilution	Qualifier	Prep Date/Time	Analysis Date/Time	Analyst	Method
---------	--------	-------	-----	-----	----------	-----------	----------------	--------------------	---------	--------

Organic Results

Dichlorodifluoromethane	<0.40	ug/L	0.40	1.3	1			04/30/2012 14:51	APG	EPA 8260B
Tetrahydrofuran	4.1	ug/L	1.8 *	5.1	1			04/30/2012 14:51	APG	EPA 8260B

CT LAB Sample#: 155894	Sample Description: MW-81	DNR License/Well #: 00133/122	Sampled: 04/26/2012 1420
------------------------	---------------------------	-------------------------------	--------------------------

Analyte	Result	Units	LOD	LOQ	Dilution	Qualifier	Prep Date/Time	Analysis Date/Time	Analyst	Method
---------	--------	-------	-----	-----	----------	-----------	----------------	--------------------	---------	--------

Organic Results

Dichlorodifluoromethane	<0.40	ug/L	0.40	1.3	1			04/30/2012 15:29	APG	EPA 8260B
Tetrahydrofuran	<1.8	ug/L	1.8	5.1	1			04/30/2012 15:29	APG	EPA 8260B

CT LAB Sample#: 155895	Sample Description: MW- 9S	DNR License/Well #: 00133/124	Sampled: 04/26/2012 1635
------------------------	----------------------------	-------------------------------	--------------------------

Analyte	Result	Units	LOD	LOQ	Dilution	Qualifier	Prep Date/Time	Analysis Date/Time	Analyst	Method
---------	--------	-------	-----	-----	----------	-----------	----------------	--------------------	---------	--------

Organic Results

1,1,1,2-Tetrachloroethane	<0.40	ug/L	0.40	1.4	1			04/30/2012 16:08	APG	EPA 8260B
1,1,1-Trichloroethane	<0.29	ug/L	0.29	0.96	1			04/30/2012 16:08	APG	EPA 8260B

Solid sample results reported on a Dry Weight Basis



CT LAB Sample#: 155895	Sample Description: MW- 9S	DNR License/Well #: 00133/124	Sampled: 04/26/2012 1635
------------------------	----------------------------	-------------------------------	--------------------------

Analyte	Result	Units	LOD	LOQ	Dilution	Qualifier	Prep Date/Time	Analysis Date/Time	Analyst	Method
1,1,2,2-Tetrachloroethane	<0.30	ug/L	0.30	1.1	1			04/30/2012 16:08	APG	EPA 8260B
1,1,2-Trichloroethane	<0.40	ug/L	0.40	1.2	1			04/30/2012 16:08	APG	EPA 8260B
1,1-Dichloroethane	<0.30	ug/L	0.30	1.1	1			04/30/2012 16:08	APG	EPA 8260B
1,1-Dichloroethene	<0.24	ug/L	0.24	0.79	1			04/30/2012 16:08	APG	EPA 8260B
1,1-Dichloropropene	<0.40	ug/L	0.40	1.3	1			04/30/2012 16:08	APG	EPA 8260B
1,2,3-Trichlorobenzene	<0.40	ug/L	0.40	1.4	1			04/30/2012 16:08	APG	EPA 8260B
1,2,3-Trichloropropane	<0.40	ug/L	0.40	1.2	1			04/30/2012 16:08	APG	EPA 8260B
1,2,4-Trichlorobenzene	<0.40	ug/L	0.40	1.2	1			04/30/2012 16:08	APG	EPA 8260B
1,2,4-Trimethylbenzene	<0.40	ug/L	0.40	1.2	1			04/30/2012 16:08	APG	EPA 8260B
1,2-Dibromo-3-chloropropane	<0.40	ug/L	0.40	1.3	1			04/30/2012 16:08	APG	EPA 8260B
1,2-Dibromoethane	<0.30	ug/L	0.30	1.0	1			04/30/2012 16:08	APG	EPA 8260B
1,2-Dichlorobenzene	<0.40	ug/L	0.40	1.2	1			04/30/2012 16:08	APG	EPA 8260B
1,2-Dichloroethane	<0.30	ug/L	0.30	1.0	1			04/30/2012 16:08	APG	EPA 8260B
1,2-Dichloropropane	<0.40	ug/L	0.40	1.3	1			04/30/2012 16:08	APG	EPA 8260B
1,3,5-Trimethylbenzene	<0.40	ug/L	0.40	1.4	1			04/30/2012 16:08	APG	EPA 8260B
1,3-Dichlorobenzene	<0.30	ug/L	0.30	1.1	1			04/30/2012 16:08	APG	EPA 8260B
1,3-Dichloropropane	<0.29	ug/L	0.29	0.98	1			04/30/2012 16:08	APG	EPA 8260B
1,4-Dichlorobenzene	<0.30	ug/L	0.30	1.1	1			04/30/2012 16:08	APG	EPA 8260B
2,2-Dichloropropane	<0.30	ug/L	0.30	1.0	1			04/30/2012 16:08	APG	EPA 8260B
2-Butanone	<4.0	ug/L	4.0	13	1			04/30/2012 16:08	APG	EPA 8260B
2-Chlorotoluene	<0.30	ug/L	0.30	1.1	1			04/30/2012 16:08	APG	EPA 8260B
2-Hexanone	<4.0	ug/L	4.0	13	1			04/30/2012 16:08	APG	EPA 8260B
4-Chlorotoluene	<0.29	ug/L	0.29	0.95	1			04/30/2012 16:08	APG	EPA 8260B
4-Methyl-2-pentanone	<4.0	ug/L	4.0	12	1			04/30/2012 16:08	APG	EPA 8260B
Acetone	<2.9	ug/L	2.9	9.6	1			04/30/2012 16:08	APG	EPA 8260B

Solid sample results reported on a Dry Weight Basis



CT LAB Sample#: 155895	Sample Description: MW- 9S	DNR License/Well #: 00133/124	Sampled: 04/26/2012 1635
------------------------	----------------------------	-------------------------------	--------------------------

Analyte	Result	Units	LOD	LOQ	Dilution	Qualifier	Prep Date/Time	Analysis Date/Time	Analyst	Method
Benzene	0.38	ug/L	0.30 *	1.0	1			04/30/2012 16:08	APG	EPA 8260B
Bromobenzene	<0.30	ug/L	0.30	1.1	1			04/30/2012 16:08	APG	EPA 8260B
Bromochloromethane	<0.50	ug/L	0.50	1.6	1			04/30/2012 16:08	APG	EPA 8260B
Bromodichloromethane	<0.30	ug/L	0.30	1.0	1			04/30/2012 16:08	APG	EPA 8260B
Bromoform	<0.30	ug/L	0.30	1.1	1			04/30/2012 16:08	APG	EPA 8260B
Bromomethane	<0.30	ug/L	0.30	1.0	1			04/30/2012 16:08	APG	EPA 8260B
Carbon disulfide	<0.50	ug/L	0.50	1.7	1			04/30/2012 16:08	APG	EPA 8260B
Carbon tetrachloride	<0.27	ug/L	0.27	0.90	1			04/30/2012 16:08	APG	EPA 8260B
Chlorobenzene	<0.28	ug/L	0.28	0.95	1			04/30/2012 16:08	APG	EPA 8260B
Chloroethane	<0.30	ug/L	0.30	1.1	1			04/30/2012 16:08	APG	EPA 8260B
Chloroform	<0.23	ug/L	0.23	0.77	1			04/30/2012 16:08	APG	EPA 8260B
Chloromethane	<0.27	ug/L	0.27	0.89	1			04/30/2012 16:08	APG	EPA 8260B
cis-1,2-Dichloroethene	<0.30	ug/L	0.30	1.1	1			04/30/2012 16:08	APG	EPA 8260B
cis-1,3-Dichloropropene	<0.26	ug/L	0.26	0.87	1			04/30/2012 16:08	APG	EPA 8260B
Dibromochloromethane	<0.30	ug/L	0.30	1.0	1			04/30/2012 16:08	APG	EPA 8260B
Dibromomethane	<0.30	ug/L	0.30	1.0	1			04/30/2012 16:08	APG	EPA 8260B
Dichlorodifluoromethane	69	ug/L	0.40	1.3	1			04/30/2012 16:08	APG	EPA 8260B
Diisopropyl ether	<0.30	ug/L	0.30	1.0	1			04/30/2012 16:08	APG	EPA 8260B
Ethylbenzene	<0.30	ug/L	0.30	1.0	1			04/30/2012 16:08	APG	EPA 8260B
Hexachlorobutadiene	<0.50	ug/L	0.50	1.6	1			04/30/2012 16:08	APG	EPA 8260B
Isopropylbenzene	<0.30	ug/L	0.30	1.1	1			04/30/2012 16:08	APG	EPA 8260B
m & p-Xylene	<0.60	ug/L	0.60	2.2	1			04/30/2012 16:08	APG	EPA 8260B
Methyl tert-butyl ether	<0.40	ug/L	0.40	1.2	1			04/30/2012 16:08	APG	EPA 8260B
Methylene chloride	<0.40	ug/L	0.40	1.3	1			04/30/2012 16:08	APG	EPA 8260B
n-Butylbenzene	<0.40	ug/L	0.40	1.4	1			04/30/2012 16:08	APG	EPA 8260B

Solid sample results reported on a Dry Weight Basis



CT LAB Sample#: 155895	Sample Description: MW- 9S	DNR License/Well #: 00133/124	Sampled: 04/26/2012 1635
------------------------	----------------------------	-------------------------------	--------------------------

Analyte	Result	Units	LOD	LOQ	Dilution	Qualifier	Prep Date/Time	Analysis Date/Time	Analyst	Method
n-Propylbenzene	<0.40	ug/L	0.40	1.3	1			04/30/2012 16:08	APG	EPA 8260B
Naphthalene	<0.30	ug/L	0.30	1.1	1			04/30/2012 16:08	APG	EPA 8260B
o-Xylene	<0.30	ug/L	0.30	1.0	1			04/30/2012 16:08	APG	EPA 8260B
p-Isopropyltoluene	<0.40	ug/L	0.40	1.2	1			04/30/2012 16:08	APG	EPA 8260B
sec-Butylbenzene	<0.30	ug/L	0.30	1.0	1			04/30/2012 16:08	APG	EPA 8260B
Styrene	<0.27	ug/L	0.27	0.89	1			04/30/2012 16:08	APG	EPA 8260B
tert-Butylbenzene	<0.40	ug/L	0.40	1.3	1			04/30/2012 16:08	APG	EPA 8260B
Tetrachloroethene	<0.29	ug/L	0.29	0.96	1			04/30/2012 16:08	APG	EPA 8260B
Tetrahydrofuran	<1.8	ug/L	1.8	5.1	1			04/30/2012 16:08	APG	EPA 8260B
Toluene	<0.30	ug/L	0.30	0.98	1			04/30/2012 16:08	APG	EPA 8260B
trans-1,2-Dichloroethene	<0.30	ug/L	0.30	1.1	1			04/30/2012 16:08	APG	EPA 8260B
trans-1,3-Dichloropropene	<0.30	ug/L	0.30	1.1	1			04/30/2012 16:08	APG	EPA 8260B
Trichloroethene	<0.50	ug/L	0.50	1.6	1			04/30/2012 16:08	APG	EPA 8260B
Trichlorofluoromethane	1.8	ug/L	0.30	1.1	1			04/30/2012 16:08	APG	EPA 8260B
Vinyl chloride	<0.18	ug/L	0.18	0.61	1			04/30/2012 16:08	APG	EPA 8260B

CT LAB Sample#: 155896	Sample Description: MW-9I	DNR License/Well #: 00133/125	Sampled: 04/26/2012 1710
------------------------	---------------------------	-------------------------------	--------------------------

Analyte	Result	Units	LOD	LOQ	Dilution	Qualifier	Prep Date/Time	Analysis Date/Time	Analyst	Method
Organic Results										
1,1,1,2-Tetrachloroethane	<0.40	ug/L	0.40	1.4	1			04/30/2012 16:47	APG	EPA 8260B
1,1,1-Trichloroethane	<0.29	ug/L	0.29	0.96	1			04/30/2012 16:47	APG	EPA 8260B
1,1,2,2-Tetrachloroethane	<0.30	ug/L	0.30	1.1	1			04/30/2012 16:47	APG	EPA 8260B
1,1,2-Trichloroethane	<0.40	ug/L	0.40	1.2	1			04/30/2012 16:47	APG	EPA 8260B
1,1-Dichloroethane	<0.30	ug/L	0.30	1.1	1			04/30/2012 16:47	APG	EPA 8260B

Solid sample results reported on a Dry Weight Basis



CT LAB Sample#: 155896	Sample Description: MW-9I	DNR License/Well #: 00133/125	Sampled: 04/26/2012 1710
------------------------	---------------------------	-------------------------------	--------------------------

Analyte	Result	Units	LOD	LOQ	Dilution	Qualifier	Prep Date/Time	Analysis Date/Time	Analyst	Method
1,1-Dichloroethene	<0.24	ug/L	0.24	0.79	1			04/30/2012 16:47	APG	EPA 8260B
1,1-Dichloropropene	<0.40	ug/L	0.40	1.3	1			04/30/2012 16:47	APG	EPA 8260B
1,2,3-Trichlorobenzene	<0.40	ug/L	0.40	1.4	1			04/30/2012 16:47	APG	EPA 8260B
1,2,3-Trichloropropane	0.50	ug/L	0.40 *	1.2	1			04/30/2012 16:47	APG	EPA 8260B
1,2,4-Trichlorobenzene	<0.40	ug/L	0.40	1.2	1			04/30/2012 16:47	APG	EPA 8260B
1,2,4-Trimethylbenzene	<0.40	ug/L	0.40	1.2	1			04/30/2012 16:47	APG	EPA 8260B
1,2-Dibromo-3-chloropropane	<0.40	ug/L	0.40	1.3	1			04/30/2012 16:47	APG	EPA 8260B
1,2-Dibromoethane	<0.30	ug/L	0.30	1.0	1			04/30/2012 16:47	APG	EPA 8260B
1,2-Dichlorobenzene	<0.40	ug/L	0.40	1.2	1			04/30/2012 16:47	APG	EPA 8260B
1,2-Dichloroethane	<0.30	ug/L	0.30	1.0	1			04/30/2012 16:47	APG	EPA 8260B
1,2-Dichloropropane	<0.40	ug/L	0.40	1.3	1			04/30/2012 16:47	APG	EPA 8260B
1,3,5-Trimethylbenzene	<0.40	ug/L	0.40	1.4	1			04/30/2012 16:47	APG	EPA 8260B
1,3-Dichlorobenzene	<0.30	ug/L	0.30	1.1	1			04/30/2012 16:47	APG	EPA 8260B
1,3-Dichloropropane	<0.29	ug/L	0.29	0.98	1			04/30/2012 16:47	APG	EPA 8260B
1,4-Dichlorobenzene	<0.30	ug/L	0.30	1.1	1			04/30/2012 16:47	APG	EPA 8260B
2,2-Dichloropropane	<0.30	ug/L	0.30	1.0	1			04/30/2012 16:47	APG	EPA 8260B
2-Butanone	<4.0	ug/L	4.0	13	1			04/30/2012 16:47	APG	EPA 8260B
2-Chlorotoluene	<0.30	ug/L	0.30	1.1	1			04/30/2012 16:47	APG	EPA 8260B
2-Hexanone	<4.0	ug/L	4.0	13	1			04/30/2012 16:47	APG	EPA 8260B
4-Chlorotoluene	<0.29	ug/L	0.29	0.95	1			04/30/2012 16:47	APG	EPA 8260B
4-Methyl-2-pentanone	<4.0	ug/L	4.0	12	1			04/30/2012 16:47	APG	EPA 8260B
Acetone	<2.9	ug/L	2.9	9.6	1			04/30/2012 16:47	APG	EPA 8260B
Benzene	<0.30	ug/L	0.30	1.0	1			04/30/2012 16:47	APG	EPA 8260B
Bromobenzene	<0.30	ug/L	0.30	1.1	1			04/30/2012 16:47	APG	EPA 8260B
Bromochloromethane	<0.50	ug/L	0.50	1.6	1			04/30/2012 16:47	APG	EPA 8260B

Solid sample results reported on a Dry Weight Basis



CT LAB Sample#: 155896	Sample Description: MW-9I	DNR License/Well #: 00133/125	Sampled: 04/26/2012 1710
------------------------	---------------------------	-------------------------------	--------------------------

Analyte	Result	Units	LOD	LOQ	Dilution	Qualifier	Prep Date/Time	Analysis Date/Time	Analyst	Method
Bromodichloromethane	<0.30	ug/L	0.30	1.0	1			04/30/2012 16:47	APG	EPA 8260B
Bromoform	<0.30	ug/L	0.30	1.1	1			04/30/2012 16:47	APG	EPA 8260B
Bromomethane	<0.30	ug/L	0.30	1.0	1			04/30/2012 16:47	APG	EPA 8260B
Carbon disulfide	<0.50	ug/L	0.50	1.7	1			04/30/2012 16:47	APG	EPA 8260B
Carbon tetrachloride	<0.27	ug/L	0.27	0.90	1			04/30/2012 16:47	APG	EPA 8260B
Chlorobenzene	<0.28	ug/L	0.28	0.95	1			04/30/2012 16:47	APG	EPA 8260B
Chloroethane	<0.30	ug/L	0.30	1.1	1			04/30/2012 16:47	APG	EPA 8260B
Chloroform	<0.23	ug/L	0.23	0.77	1			04/30/2012 16:47	APG	EPA 8260B
Chloromethane	<0.27	ug/L	0.27	0.89	1			04/30/2012 16:47	APG	EPA 8260B
cis-1,2-Dichloroethene	1.0	ug/L	0.30 *	1.1	1			04/30/2012 16:47	APG	EPA 8260B
cis-1,3-Dichloropropene	<0.26	ug/L	0.26	0.87	1			04/30/2012 16:47	APG	EPA 8260B
Dibromochloromethane	<0.30	ug/L	0.30	1.0	1			04/30/2012 16:47	APG	EPA 8260B
Dibromomethane	<0.30	ug/L	0.30	1.0	1			04/30/2012 16:47	APG	EPA 8260B
Dichlorodifluoromethane	54	ug/L	0.40	1.3	1			04/30/2012 16:47	APG	EPA 8260B
Diisopropyl ether	<0.30	ug/L	0.30	1.0	1			04/30/2012 16:47	APG	EPA 8260B
Ethylbenzene	<0.30	ug/L	0.30	1.0	1			04/30/2012 16:47	APG	EPA 8260B
Hexachlorobutadiene	<0.50	ug/L	0.50	1.6	1			04/30/2012 16:47	APG	EPA 8260B
Isopropylbenzene	<0.30	ug/L	0.30	1.1	1			04/30/2012 16:47	APG	EPA 8260B
m & p-Xylene	<0.60	ug/L	0.60	2.2	1			04/30/2012 16:47	APG	EPA 8260B
Methyl tert-butyl ether	<0.40	ug/L	0.40	1.2	1			04/30/2012 16:47	APG	EPA 8260B
Methylene chloride	<0.40	ug/L	0.40	1.3	1			04/30/2012 16:47	APG	EPA 8260B
n-Butylbenzene	<0.40	ug/L	0.40	1.4	1			04/30/2012 16:47	APG	EPA 8260B
n-Propylbenzene	<0.40	ug/L	0.40	1.3	1			04/30/2012 16:47	APG	EPA 8260B
Naphthalene	<0.30	ug/L	0.30	1.1	1			04/30/2012 16:47	APG	EPA 8260B
o-Xylene	<0.30	ug/L	0.30	1.0	1			04/30/2012 16:47	APG	EPA 8260B

Solid sample results reported on a Dry Weight Basis



CT LAB Sample#: 155896	Sample Description: MW-9I	DNR License/Well #: 00133/125	Sampled: 04/26/2012 1710
------------------------	---------------------------	-------------------------------	--------------------------

Analyte	Result	Units	LOD	LOQ	Dilution	Qualifier	Prep Date/Time	Analysis Date/Time	Analyst	Method
p-Isopropyltoluene	<0.40	ug/L	0.40	1.2	1			04/30/2012 16:47	APG	EPA 8260B
sec-Butylbenzene	<0.30	ug/L	0.30	1.0	1			04/30/2012 16:47	APG	EPA 8260B
Styrene	<0.27	ug/L	0.27	0.89	1			04/30/2012 16:47	APG	EPA 8260B
tert-Butylbenzene	<0.40	ug/L	0.40	1.3	1			04/30/2012 16:47	APG	EPA 8260B
Tetrachloroethene	0.38	ug/L	0.29 *	0.96	1			04/30/2012 16:47	APG	EPA 8260B
Tetrahydrofuran	<1.8	ug/L	1.8	5.1	1			04/30/2012 16:47	APG	EPA 8260B
Toluene	<0.30	ug/L	0.30	0.98	1			04/30/2012 16:47	APG	EPA 8260B
trans-1,2-Dichloroethene	<0.30	ug/L	0.30	1.1	1			04/30/2012 16:47	APG	EPA 8260B
trans-1,3-Dichloropropene	<0.30	ug/L	0.30	1.1	1			04/30/2012 16:47	APG	EPA 8260B
Trichloroethene	0.89	ug/L	0.50 *	1.6	1			04/30/2012 16:47	APG	EPA 8260B
Trichlorofluoromethane	1.3	ug/L	0.30	1.1	1			04/30/2012 16:47	APG	EPA 8260B
Vinyl chloride	<0.18	ug/L	0.18	0.61	1			04/30/2012 16:47	APG	EPA 8260B

CT LAB Sample#: 155897	Sample Description: MW-9B	DNR License/Well #: 00133/126	Sampled: 04/26/2012 1815
------------------------	---------------------------	-------------------------------	--------------------------

Analyte	Result	Units	LOD	LOQ	Dilution	Qualifier	Prep Date/Time	Analysis Date/Time	Analyst	Method
Organic Results										
1,1,1,2-Tetrachloroethane	<0.40	ug/L	0.40	1.4	1			04/30/2012 17:26	APG	EPA 8260B
1,1,1-Trichloroethane	<0.29	ug/L	0.29	0.96	1			04/30/2012 17:26	APG	EPA 8260B
1,1,2,2-Tetrachloroethane	<0.30	ug/L	0.30	1.1	1			04/30/2012 17:26	APG	EPA 8260B
1,1,2-Trichloroethane	<0.40	ug/L	0.40	1.2	1			04/30/2012 17:26	APG	EPA 8260B
1,1-Dichloroethane	<0.30	ug/L	0.30	1.1	1			04/30/2012 17:26	APG	EPA 8260B
1,1-Dichloroethene	<0.24	ug/L	0.24	0.79	1			04/30/2012 17:26	APG	EPA 8260B
1,1-Dichloropropene	<0.40	ug/L	0.40	1.3	1			04/30/2012 17:26	APG	EPA 8260B
1,2,3-Trichlorobenzene	<0.40	ug/L	0.40	1.4	1			04/30/2012 17:26	APG	EPA 8260B

Solid sample results reported on a Dry Weight Basis

CT LAB Sample#: 155897	Sample Description: MW-9B	DNR License/Well #: 00133/126	Sampled: 04/26/2012 1815
------------------------	---------------------------	-------------------------------	--------------------------

Analyte	Result	Units	LOD	LOQ	Dilution	Qualifier	Prep Date/Time	Analysis Date/Time	Analyst	Method
1,2,3-Trichloropropane	<0.40	ug/L	0.40	1.2	1			04/30/2012 17:26	APG	EPA 8260B
1,2,4-Trichlorobenzene	<0.40	ug/L	0.40	1.2	1			04/30/2012 17:26	APG	EPA 8260B
1,2,4-Trimethylbenzene	<0.40	ug/L	0.40	1.2	1			04/30/2012 17:26	APG	EPA 8260B
1,2-Dibromo-3-chloropropane	<0.40	ug/L	0.40	1.3	1			04/30/2012 17:26	APG	EPA 8260B
1,2-Dibromoethane	<0.30	ug/L	0.30	1.0	1			04/30/2012 17:26	APG	EPA 8260B
1,2-Dichlorobenzene	<0.40	ug/L	0.40	1.2	1			04/30/2012 17:26	APG	EPA 8260B
1,2-Dichloroethane	<0.30	ug/L	0.30	1.0	1			04/30/2012 17:26	APG	EPA 8260B
1,2-Dichloropropane	<0.40	ug/L	0.40	1.3	1			04/30/2012 17:26	APG	EPA 8260B
1,3,5-Trimethylbenzene	<0.40	ug/L	0.40	1.4	1			04/30/2012 17:26	APG	EPA 8260B
1,3-Dichlorobenzene	<0.30	ug/L	0.30	1.1	1			04/30/2012 17:26	APG	EPA 8260B
1,3-Dichloropropane	<0.29	ug/L	0.29	0.98	1			04/30/2012 17:26	APG	EPA 8260B
1,4-Dichlorobenzene	<0.30	ug/L	0.30	1.1	1			04/30/2012 17:26	APG	EPA 8260B
2,2-Dichloropropane	<0.30	ug/L	0.30	1.0	1			04/30/2012 17:26	APG	EPA 8260B
2-Butanone	<4.0	ug/L	4.0	13	1			04/30/2012 17:26	APG	EPA 8260B
2-Chlorotoluene	<0.30	ug/L	0.30	1.1	1			04/30/2012 17:26	APG	EPA 8260B
2-Hexanone	<4.0	ug/L	4.0	13	1			04/30/2012 17:26	APG	EPA 8260B
4-Chlorotoluene	<0.29	ug/L	0.29	0.95	1			04/30/2012 17:26	APG	EPA 8260B
4-Methyl-2-pentanone	<4.0	ug/L	4.0	12	1			04/30/2012 17:26	APG	EPA 8260B
Acetone	<2.9	ug/L	2.9	9.6	1			04/30/2012 17:26	APG	EPA 8260B
Benzene	<0.30	ug/L	0.30	1.0	1			04/30/2012 17:26	APG	EPA 8260B
Bromobenzene	<0.30	ug/L	0.30	1.1	1			04/30/2012 17:26	APG	EPA 8260B
Bromochloromethane	<0.50	ug/L	0.50	1.6	1			04/30/2012 17:26	APG	EPA 8260B
Bromodichloromethane	<0.30	ug/L	0.30	1.0	1			04/30/2012 17:26	APG	EPA 8260B
Bromoform	<0.30	ug/L	0.30	1.1	1			04/30/2012 17:26	APG	EPA 8260B
Bromomethane	<0.30	ug/L	0.30	1.0	1			04/30/2012 17:26	APG	EPA 8260B

Solid sample results reported on a Dry Weight Basis

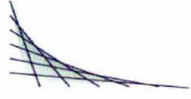

CT LAB Sample#: 155897	Sample Description: MW-9B	DNR License/Well #: 00133/126	Sampled: 04/26/2012 1815
------------------------	---------------------------	-------------------------------	--------------------------

Analyte	Result	Units	LOD	LOQ	Dilution	Qualifier	Prep Date/Time	Analysis Date/Time	Analyst	Method
Carbon disulfide	<0.50	ug/L	0.50	1.7	1			04/30/2012 17:26	APG	EPA 8260B
Carbon tetrachloride	<0.27	ug/L	0.27	0.90	1			04/30/2012 17:26	APG	EPA 8260B
Chlorobenzene	<0.28	ug/L	0.28	0.95	1			04/30/2012 17:26	APG	EPA 8260B
Chloroethane	<0.30	ug/L	0.30	1.1	1			04/30/2012 17:26	APG	EPA 8260B
Chloroform	<0.23	ug/L	0.23	0.77	1			04/30/2012 17:26	APG	EPA 8260B
Chloromethane	<0.27	ug/L	0.27	0.89	1			04/30/2012 17:26	APG	EPA 8260B
cis-1,2-Dichloroethene	0.43	ug/L	0.30 *	1.1	1			04/30/2012 17:26	APG	EPA 8260B
cis-1,3-Dichloropropene	<0.26	ug/L	0.26	0.87	1			04/30/2012 17:26	APG	EPA 8260B
Dibromochloromethane	<0.30	ug/L	0.30	1.0	1			04/30/2012 17:26	APG	EPA 8260B
Dibromomethane	<0.30	ug/L	0.30	1.0	1			04/30/2012 17:26	APG	EPA 8260B
Dichlorodifluoromethane	7.2	ug/L	0.40	1.3	1			04/30/2012 17:26	APG	EPA 8260B
Diisopropyl ether	<0.30	ug/L	0.30	1.0	1			04/30/2012 17:26	APG	EPA 8260B
Ethylbenzene	<0.30	ug/L	0.30	1.0	1			04/30/2012 17:26	APG	EPA 8260B
Hexachlorobutadiene	<0.50	ug/L	0.50	1.6	1			04/30/2012 17:26	APG	EPA 8260B
Isopropylbenzene	<0.30	ug/L	0.30	1.1	1			04/30/2012 17:26	APG	EPA 8260B
m & p-Xylene	<0.60	ug/L	0.60	2.2	1			04/30/2012 17:26	APG	EPA 8260B
Methyl tert-butyl ether	<0.40	ug/L	0.40	1.2	1			04/30/2012 17:26	APG	EPA 8260B
Methylene chloride	<0.40	ug/L	0.40	1.3	1			04/30/2012 17:26	APG	EPA 8260B
n-Butylbenzene	<0.40	ug/L	0.40	1.4	1			04/30/2012 17:26	APG	EPA 8260B
n-Propylbenzene	<0.40	ug/L	0.40	1.3	1			04/30/2012 17:26	APG	EPA 8260B
Naphthalene	<0.30	ug/L	0.30	1.1	1			04/30/2012 17:26	APG	EPA 8260B
o-Xylene	<0.30	ug/L	0.30	1.0	1			04/30/2012 17:26	APG	EPA 8260B
p-Isopropyltoluene	<0.40	ug/L	0.40	1.2	1			04/30/2012 17:26	APG	EPA 8260B
sec-Butylbenzene	<0.30	ug/L	0.30	1.0	1			04/30/2012 17:26	APG	EPA 8260B
Styrene	<0.27	ug/L	0.27	0.89	1			04/30/2012 17:26	APG	EPA 8260B

Solid sample results reported on a Dry Weight Basis



CT LAB Sample#: 155897	Sample Description: MW-9B	DNR License/Well #: 00133/126	Sampled: 04/26/2012 1815
------------------------	---------------------------	-------------------------------	--------------------------

Analyte	Result	Units	LOD	LOQ	Dilution	Qualifier	Prep Date/Time	Analysis Date/Time	Analyst	Method
tert-Butylbenzene	<0.40	ug/L	0.40	1.3	1			04/30/2012 17:26	APG	EPA 8260B
Tetrachloroethene	<0.29	ug/L	0.29	0.96	1			04/30/2012 17:26	APG	EPA 8260B
Tetrahydrofuran	<1.8	ug/L	1.8	5.1	1			04/30/2012 17:26	APG	EPA 8260B
Toluene	<0.30	ug/L	0.30	0.98	1			04/30/2012 17:26	APG	EPA 8260B
trans-1,2-Dichloroethene	<0.30	ug/L	0.30	1.1	1			04/30/2012 17:26	APG	EPA 8260B
trans-1,3-Dichloropropene	<0.30	ug/L	0.30	1.1	1			04/30/2012 17:26	APG	EPA 8260B
Trichloroethene	<0.50	ug/L	0.50	1.6	1			04/30/2012 17:26	APG	EPA 8260B
Trichlorofluoromethane	5.2	ug/L	0.30	1.1	1			04/30/2012 17:26	APG	EPA 8260B
Vinyl chloride	<0.18	ug/L	0.18	0.61	1			04/30/2012 17:26	APG	EPA 8260B

CT LAB Sample#: 155898	Sample Description: MW-10S	DNR License/Well #: 00133/127	Sampled: 04/26/2012 1545
------------------------	----------------------------	-------------------------------	--------------------------

Analyte	Result	Units	LOD	LOQ	Dilution	Qualifier	Prep Date/Time	Analysis Date/Time	Analyst	Method
Organic Results										
1,1,1,2-Tetrachloroethane	<0.40	ug/L	0.40	1.4	1			04/30/2012 18:05	APG	EPA 8260B
1,1,1-Trichloroethane	<0.29	ug/L	0.29	0.96	1			04/30/2012 18:05	APG	EPA 8260B
1,1,2,2-Tetrachloroethane	<0.30	ug/L	0.30	1.1	1			04/30/2012 18:05	APG	EPA 8260B
1,1,2-Trichloroethane	<0.40	ug/L	0.40	1.2	1			04/30/2012 18:05	APG	EPA 8260B
1,1-Dichloroethane	<0.30	ug/L	0.30	1.1	1			04/30/2012 18:05	APG	EPA 8260B
1,1-Dichloroethene	<0.24	ug/L	0.24	0.79	1			04/30/2012 18:05	APG	EPA 8260B
1,1-Dichloropropene	<0.40	ug/L	0.40	1.3	1			04/30/2012 18:05	APG	EPA 8260B
1,2,3-Trichlorobenzene	<0.40	ug/L	0.40	1.4	1			04/30/2012 18:05	APG	EPA 8260B
1,2,3-Trichloropropane	<0.40	ug/L	0.40	1.2	1			04/30/2012 18:05	APG	EPA 8260B
1,2,4-Trichlorobenzene	<0.40	ug/L	0.40	1.2	1			04/30/2012 18:05	APG	EPA 8260B
1,2,4-Trimethylbenzene	<0.40	ug/L	0.40	1.2	1			04/30/2012 18:05	APG	EPA 8260B

Solid sample results reported on a Dry Weight Basis

CT LAB Sample#: 155898	Sample Description: MW-10S	DNR License/Well #: 00133/127	Sampled: 04/26/2012 1545
------------------------	----------------------------	-------------------------------	--------------------------

Analyte	Result	Units	LOD	LOQ	Dilution	Qualifier	Prep Date/Time	Analysis Date/Time	Analyst	Method
1,2-Dibromo-3-chloropropane	<0.40	ug/L	0.40	1.3	1			04/30/2012 18:05	APG	EPA 8260B
1,2-Dibromoethane	<0.30	ug/L	0.30	1.0	1			04/30/2012 18:05	APG	EPA 8260B
1,2-Dichlorobenzene	<0.40	ug/L	0.40	1.2	1			04/30/2012 18:05	APG	EPA 8260B
1,2-Dichloroethane	<0.30	ug/L	0.30	1.0	1			04/30/2012 18:05	APG	EPA 8260B
1,2-Dichloropropane	<0.40	ug/L	0.40	1.3	1			04/30/2012 18:05	APG	EPA 8260B
1,3,5-Trimethylbenzene	<0.40	ug/L	0.40	1.4	1			04/30/2012 18:05	APG	EPA 8260B
1,3-Dichlorobenzene	<0.30	ug/L	0.30	1.1	1			04/30/2012 18:05	APG	EPA 8260B
1,3-Dichloropropane	<0.29	ug/L	0.29	0.98	1			04/30/2012 18:05	APG	EPA 8260B
1,4-Dichlorobenzene	<0.30	ug/L	0.30	1.1	1			04/30/2012 18:05	APG	EPA 8260B
2,2-Dichloropropane	<0.30	ug/L	0.30	1.0	1			04/30/2012 18:05	APG	EPA 8260B
2-Butanone	<4.0	ug/L	4.0	13	1			04/30/2012 18:05	APG	EPA 8260B
2-Chlorotoluene	<0.30	ug/L	0.30	1.1	1			04/30/2012 18:05	APG	EPA 8260B
2-Hexanone	<4.0	ug/L	4.0	13	1			04/30/2012 18:05	APG	EPA 8260B
4-Chlorotoluene	<0.29	ug/L	0.29	0.95	1			04/30/2012 18:05	APG	EPA 8260B
4-Methyl-2-pentanone	<4.0	ug/L	4.0	12	1			04/30/2012 18:05	APG	EPA 8260B
Acetone	<2.9	ug/L	2.9	9.6	1			04/30/2012 18:05	APG	EPA 8260B
Benzene	<0.30	ug/L	0.30	1.0	1			04/30/2012 18:05	APG	EPA 8260B
Bromobenzene	<0.30	ug/L	0.30	1.1	1			04/30/2012 18:05	APG	EPA 8260B
Bromochloromethane	<0.50	ug/L	0.50	1.6	1			04/30/2012 18:05	APG	EPA 8260B
Bromodichloromethane	<0.30	ug/L	0.30	1.0	1			04/30/2012 18:05	APG	EPA 8260B
Bromoform	<0.30	ug/L	0.30	1.1	1			04/30/2012 18:05	APG	EPA 8260B
Bromomethane	<0.30	ug/L	0.30	1.0	1			04/30/2012 18:05	APG	EPA 8260B
Carbon disulfide	<0.50	ug/L	0.50	1.7	1			04/30/2012 18:05	APG	EPA 8260B
Carbon tetrachloride	<0.27	ug/L	0.27	0.90	1			04/30/2012 18:05	APG	EPA 8260B
Chlorobenzene	<0.28	ug/L	0.28	0.95	1			04/30/2012 18:05	APG	EPA 8260B

Solid sample results reported on a Dry Weight Basis

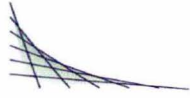

CT LAB Sample#: 155898	Sample Description: MW-10S	DNR License/Well #: 00133/127	Sampled: 04/26/2012 1545
------------------------	----------------------------	-------------------------------	--------------------------

Analyte	Result	Units	LOD	LOQ	Dilution	Qualifier	Prep Date/Time	Analysis Date/Time	Analyst	Method
Chloroethane	<0.30	ug/L	0.30	1.1	1			04/30/2012 18:05	APG	EPA 8260B
Chloroform	<0.23	ug/L	0.23	0.77	1			04/30/2012 18:05	APG	EPA 8260B
Chloromethane	<0.27	ug/L	0.27	0.89	1			04/30/2012 18:05	APG	EPA 8260B
cis-1,2-Dichloroethene	<0.30	ug/L	0.30	1.1	1			04/30/2012 18:05	APG	EPA 8260B
cis-1,3-Dichloropropene	<0.26	ug/L	0.26	0.87	1			04/30/2012 18:05	APG	EPA 8260B
Dibromochloromethane	<0.30	ug/L	0.30	1.0	1			04/30/2012 18:05	APG	EPA 8260B
Dibromomethane	<0.30	ug/L	0.30	1.0	1			04/30/2012 18:05	APG	EPA 8260B
Dichlorodifluoromethane	0.91	ug/L	0.40 *	1.3	1			04/30/2012 18:05	APG	EPA 8260B
Diisopropyl ether	<0.30	ug/L	0.30	1.0	1			04/30/2012 18:05	APG	EPA 8260B
Ethylbenzene	<0.30	ug/L	0.30	1.0	1			04/30/2012 18:05	APG	EPA 8260B
Hexachlorobutadiene	<0.50	ug/L	0.50	1.6	1			04/30/2012 18:05	APG	EPA 8260B
Isopropylbenzene	<0.30	ug/L	0.30	1.1	1			04/30/2012 18:05	APG	EPA 8260B
m & p-Xylene	<0.60	ug/L	0.60	2.2	1			04/30/2012 18:05	APG	EPA 8260B
Methyl tert-butyl ether	<0.40	ug/L	0.40	1.2	1			04/30/2012 18:05	APG	EPA 8260B
Methylene chloride	<0.40	ug/L	0.40	1.3	1			04/30/2012 18:05	APG	EPA 8260B
n-Butylbenzene	<0.40	ug/L	0.40	1.4	1			04/30/2012 18:05	APG	EPA 8260B
n-Propylbenzene	<0.40	ug/L	0.40	1.3	1			04/30/2012 18:05	APG	EPA 8260B
Naphthalene	<0.30	ug/L	0.30	1.1	1			04/30/2012 18:05	APG	EPA 8260B
o-Xylene	<0.30	ug/L	0.30	1.0	1			04/30/2012 18:05	APG	EPA 8260B
p-Isopropyltoluene	<0.40	ug/L	0.40	1.2	1			04/30/2012 18:05	APG	EPA 8260B
sec-Butylbenzene	<0.30	ug/L	0.30	1.0	1			04/30/2012 18:05	APG	EPA 8260B
Styrene	<0.27	ug/L	0.27	0.89	1			04/30/2012 18:05	APG	EPA 8260B
tert-Butylbenzene	<0.40	ug/L	0.40	1.3	1			04/30/2012 18:05	APG	EPA 8260B
Tetrachloroethene	<0.29	ug/L	0.29	0.96	1			04/30/2012 18:05	APG	EPA 8260B
Tetrahydrofuran	<1.8	ug/L	1.8	5.1	1			04/30/2012 18:05	APG	EPA 8260B

Solid sample results reported on a Dry Weight Basis

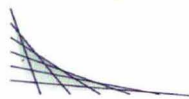

CT LAB Sample#: 155898	Sample Description: MW-10S	DNR License/Well #: 00133/127	Sampled: 04/26/2012 1545
------------------------	----------------------------	-------------------------------	--------------------------

Analyte	Result	Units	LOD	LOQ	Dilution	Qualifier	Prep Date/Time	Analysis Date/Time	Analyst	Method
Toluene	<0.30	ug/L	0.30	0.98	1			04/30/2012 18:05	APG	EPA 8260B
trans-1,2-Dichloroethene	<0.30	ug/L	0.30	1.1	1			04/30/2012 18:05	APG	EPA 8260B
trans-1,3-Dichloropropene	<0.30	ug/L	0.30	1.1	1			04/30/2012 18:05	APG	EPA 8260B
Trichloroethene	<0.50	ug/L	0.50	1.6	1			04/30/2012 18:05	APG	EPA 8260B
Trichlorofluoromethane	<0.30	ug/L	0.30	1.1	1			04/30/2012 18:05	APG	EPA 8260B
Vinyl chloride	<0.18	ug/L	0.18	0.61	1			04/30/2012 18:05	APG	EPA 8260B

CT LAB Sample#: 155899	Sample Description: MW-10I	DNR License/Well #: 00133/128	Sampled: 04/26/2012 1455
------------------------	----------------------------	-------------------------------	--------------------------

Analyte	Result	Units	LOD	LOQ	Dilution	Qualifier	Prep Date/Time	Analysis Date/Time	Analyst	Method
---------	--------	-------	-----	-----	----------	-----------	----------------	--------------------	---------	--------

Organic Results

1,1,1,2-Tetrachloroethane	<0.40	ug/L	0.40	1.4	1			04/30/2012 18:45	APG	EPA 8260B
1,1,1-Trichloroethane	<0.29	ug/L	0.29	0.96	1			04/30/2012 18:45	APG	EPA 8260B
1,1,2,2-Tetrachloroethane	<0.30	ug/L	0.30	1.1	1			04/30/2012 18:45	APG	EPA 8260B
1,1,2-Trichloroethane	<0.40	ug/L	0.40	1.2	1			04/30/2012 18:45	APG	EPA 8260B
1,1-Dichloroethane	<0.30	ug/L	0.30	1.1	1			04/30/2012 18:45	APG	EPA 8260B
1,1-Dichloroethene	<0.24	ug/L	0.24	0.79	1			04/30/2012 18:45	APG	EPA 8260B
1,1-Dichloropropene	<0.40	ug/L	0.40	1.3	1			04/30/2012 18:45	APG	EPA 8260B
1,2,3-Trichlorobenzene	<0.40	ug/L	0.40	1.4	1			04/30/2012 18:45	APG	EPA 8260B
1,2,3-Trichloropropane	<0.40	ug/L	0.40	1.2	1			04/30/2012 18:45	APG	EPA 8260B
1,2,4-Trichlorobenzene	<0.40	ug/L	0.40	1.2	1			04/30/2012 18:45	APG	EPA 8260B
1,2,4-Trimethylbenzene	<0.40	ug/L	0.40	1.2	1			04/30/2012 18:45	APG	EPA 8260B
1,2-Dibromo-3-chloropropane	<0.40	ug/L	0.40	1.3	1			04/30/2012 18:45	APG	EPA 8260B
1,2-Dibromoethane	<0.30	ug/L	0.30	1.0	1			04/30/2012 18:45	APG	EPA 8260B
1,2-Dichlorobenzene	<0.40	ug/L	0.40	1.2	1			04/30/2012 18:45	APG	EPA 8260B

Solid sample results reported on a Dry Weight Basis



CT LAB Sample#: 155899	Sample Description: MW-10I	DNR License/Well #: 00133/128	Sampled: 04/26/2012 1455
------------------------	----------------------------	-------------------------------	--------------------------

Analyte	Result	Units	LOD	LOQ	Dilution	Qualifier	Prep Date/Time	Analysis Date/Time	Analyst	Method
1,2-Dichloroethane	<0.30	ug/L	0.30	1.0	1			04/30/2012 18:45	APG	EPA 8260B
1,2-Dichloropropane	<0.40	ug/L	0.40	1.3	1			04/30/2012 18:45	APG	EPA 8260B
1,3,5-Trimethylbenzene	<0.40	ug/L	0.40	1.4	1			04/30/2012 18:45	APG	EPA 8260B
1,3-Dichlorobenzene	<0.30	ug/L	0.30	1.1	1	Y		04/30/2012 18:45	APG	EPA 8260B
1,3-Dichloropropane	<0.29	ug/L	0.29	0.98	1			04/30/2012 18:45	APG	EPA 8260B
1,4-Dichlorobenzene	<0.30	ug/L	0.30	1.1	1			04/30/2012 18:45	APG	EPA 8260B
2,2-Dichloropropane	<0.30	ug/L	0.30	1.0	1			04/30/2012 18:45	APG	EPA 8260B
2-Butanone	<4.0	ug/L	4.0	13	1			04/30/2012 18:45	APG	EPA 8260B
2-Chlorotoluene	<0.30	ug/L	0.30	1.1	1	Y		04/30/2012 18:45	APG	EPA 8260B
2-Hexanone	<4.0	ug/L	4.0	13	1			04/30/2012 18:45	APG	EPA 8260B
4-Chlorotoluene	<0.29	ug/L	0.29	0.95	1			04/30/2012 18:45	APG	EPA 8260B
4-Methyl-2-pentanone	<4.0	ug/L	4.0	12	1			04/30/2012 18:45	APG	EPA 8260B
Acetone	<2.9	ug/L	2.9	9.6	1			04/30/2012 18:45	APG	EPA 8260B
Benzene	<0.30	ug/L	0.30	1.0	1			04/30/2012 18:45	APG	EPA 8260B
Bromobenzene	<0.30	ug/L	0.30	1.1	1			04/30/2012 18:45	APG	EPA 8260B
Bromochloromethane	<0.50	ug/L	0.50	1.6	1			04/30/2012 18:45	APG	EPA 8260B
Bromodichloromethane	<0.30	ug/L	0.30	1.0	1			04/30/2012 18:45	APG	EPA 8260B
Bromoform	<0.30	ug/L	0.30	1.1	1	Y		04/30/2012 18:45	APG	EPA 8260B
Bromomethane	<0.30	ug/L	0.30	1.0	1			04/30/2012 18:45	APG	EPA 8260B
Carbon disulfide	<0.50	ug/L	0.50	1.7	1			04/30/2012 18:45	APG	EPA 8260B
Carbon tetrachloride	<0.27	ug/L	0.27	0.90	1			04/30/2012 18:45	APG	EPA 8260B
Chlorobenzene	<0.28	ug/L	0.28	0.95	1			04/30/2012 18:45	APG	EPA 8260B
Chloroethane	<0.30	ug/L	0.30	1.1	1			04/30/2012 18:45	APG	EPA 8260B
Chloroform	<0.23	ug/L	0.23	0.77	1			04/30/2012 18:45	APG	EPA 8260B
Chloromethane	<0.27	ug/L	0.27	0.89	1			04/30/2012 18:45	APG	EPA 8260B

Solid sample results reported on a Dry Weight Basis



CT LAB Sample#: 155899	Sample Description: MW-10I	DNR License/Well #: 00133/128	Sampled: 04/26/2012 1455
------------------------	----------------------------	-------------------------------	--------------------------

Analyte	Result	Units	LOD	LOQ	Dilution	Qualifier	Prep Date/Time	Analysis Date/Time	Analyst	Method
cis-1,2-Dichloroethene	<0.30	ug/L	0.30	1.1	1			04/30/2012 18:45	APG	EPA 8260B
cis-1,3-Dichloropropene	<0.26	ug/L	0.26	0.87	1			04/30/2012 18:45	APG	EPA 8260B
Dibromochloromethane	<0.30	ug/L	0.30	1.0	1			04/30/2012 18:45	APG	EPA 8260B
Dibromomethane	<0.30	ug/L	0.30	1.0	1	Y		04/30/2012 18:45	APG	EPA 8260B
Dichlorodifluoromethane	<0.40	ug/L	0.40	1.3	1			04/30/2012 18:45	APG	EPA 8260B
Diisopropyl ether	<0.30	ug/L	0.30	1.0	1			04/30/2012 18:45	APG	EPA 8260B
Ethylbenzene	<0.30	ug/L	0.30	1.0	1			04/30/2012 18:45	APG	EPA 8260B
Hexachlorobutadiene	<0.50	ug/L	0.50	1.6	1	Y		04/30/2012 18:45	APG	EPA 8260B
Isopropylbenzene	<0.30	ug/L	0.30	1.1	1			04/30/2012 18:45	APG	EPA 8260B
m & p-Xylene	<0.60	ug/L	0.60	2.2	1			04/30/2012 18:45	APG	EPA 8260B
Methyl tert-butyl ether	<0.40	ug/L	0.40	1.2	1			04/30/2012 18:45	APG	EPA 8260B
Methylene chloride	<0.40	ug/L	0.40	1.3	1			04/30/2012 18:45	APG	EPA 8260B
n-Butylbenzene	<0.40	ug/L	0.40	1.4	1	Y		04/30/2012 18:45	APG	EPA 8260B
n-Propylbenzene	<0.40	ug/L	0.40	1.3	1			04/30/2012 18:45	APG	EPA 8260B
Naphthalene	<0.30	ug/L	0.30	1.1	1			04/30/2012 18:45	APG	EPA 8260B
o-Xylene	<0.30	ug/L	0.30	1.0	1			04/30/2012 18:45	APG	EPA 8260B
p-Isopropyltoluene	<0.40	ug/L	0.40	1.2	1			04/30/2012 18:45	APG	EPA 8260B
sec-Butylbenzene	<0.30	ug/L	0.30	1.0	1			04/30/2012 18:45	APG	EPA 8260B
Styrene	<0.27	ug/L	0.27	0.89	1			04/30/2012 18:45	APG	EPA 8260B
tert-Butylbenzene	<0.40	ug/L	0.40	1.3	1	Y		04/30/2012 18:45	APG	EPA 8260B
Tetrachloroethene	<0.29	ug/L	0.29	0.96	1			04/30/2012 18:45	APG	EPA 8260B
Tetrahydrofuran	<1.8	ug/L	1.8	5.1	1			04/30/2012 18:45	APG	EPA 8260B
Toluene	<0.30	ug/L	0.30	0.98	1			04/30/2012 18:45	APG	EPA 8260B
trans-1,2-Dichloroethene	<0.30	ug/L	0.30	1.1	1			04/30/2012 18:45	APG	EPA 8260B
trans-1,3-Dichloropropene	<0.30	ug/L	0.30	1.1	1			04/30/2012 18:45	APG	EPA 8260B

Solid sample results reported on a Dry Weight Basis

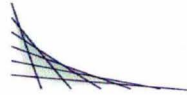

CT LAB Sample#: 155899	Sample Description: MW-10I	DNR License/Well #: 00133/128	Sampled: 04/26/2012 1455
------------------------	----------------------------	-------------------------------	--------------------------

Analyte	Result	Units	LOD	LOQ	Dilution	Qualifier	Prep Date/Time	Analysis Date/Time	Analyst	Method
Trichloroethene	<0.50	ug/L	0.50	1.6	1			04/30/2012 18:45	APG	EPA 8260B
Trichlorofluoromethane	<0.30	ug/L	0.30	1.1	1			04/30/2012 18:45	APG	EPA 8260B
Vinyl chloride	<0.18	ug/L	0.18	0.61	1			04/30/2012 18:45	APG	EPA 8260B

CT LAB Sample#: 155900	Sample Description: MW-10I DUP	DNR License/Well #: 00133/128	Sampled: 04/26/2012 1455
------------------------	--------------------------------	-------------------------------	--------------------------

Analyte	Result	Units	LOD	LOQ	Dilution	Qualifier	Prep Date/Time	Analysis Date/Time	Analyst	Method
---------	--------	-------	-----	-----	----------	-----------	----------------	--------------------	---------	--------

Organic Results

1,1,1,2-Tetrachloroethane	<0.40	ug/L	0.40	1.4	1			04/30/2012 19:25	APG	EPA 8260B
1,1,1-Trichloroethane	<0.29	ug/L	0.29	0.96	1			04/30/2012 19:25	APG	EPA 8260B
1,1,2,2-Tetrachloroethane	<0.30	ug/L	0.30	1.1	1			04/30/2012 19:25	APG	EPA 8260B
1,1,2-Trichloroethane	<0.40	ug/L	0.40	1.2	1			04/30/2012 19:25	APG	EPA 8260B
1,1-Dichloroethane	<0.30	ug/L	0.30	1.1	1			04/30/2012 19:25	APG	EPA 8260B
1,1-Dichloroethene	<0.24	ug/L	0.24	0.79	1			04/30/2012 19:25	APG	EPA 8260B
1,1-Dichloropropene	<0.40	ug/L	0.40	1.3	1			04/30/2012 19:25	APG	EPA 8260B
1,2,3-Trichlorobenzene	<0.40	ug/L	0.40	1.4	1			04/30/2012 19:25	APG	EPA 8260B
1,2,3-Trichloropropane	<0.40	ug/L	0.40	1.2	1			04/30/2012 19:25	APG	EPA 8260B
1,2,4-Trichlorobenzene	<0.40	ug/L	0.40	1.2	1			04/30/2012 19:25	APG	EPA 8260B
1,2,4-Trimethylbenzene	<0.40	ug/L	0.40	1.2	1			04/30/2012 19:25	APG	EPA 8260B
1,2-Dibromo-3-chloropropane	<0.40	ug/L	0.40	1.3	1			04/30/2012 19:25	APG	EPA 8260B
1,2-Dibromoethane	<0.30	ug/L	0.30	1.0	1			04/30/2012 19:25	APG	EPA 8260B
1,2-Dichlorobenzene	<0.40	ug/L	0.40	1.2	1			04/30/2012 19:25	APG	EPA 8260B
1,2-Dichloroethane	<0.30	ug/L	0.30	1.0	1			04/30/2012 19:25	APG	EPA 8260B
1,2-Dichloropropane	<0.40	ug/L	0.40	1.3	1			04/30/2012 19:25	APG	EPA 8260B
1,3,5-Trimethylbenzene	<0.40	ug/L	0.40	1.4	1			04/30/2012 19:25	APG	EPA 8260B

Solid sample results reported on a Dry Weight Basis

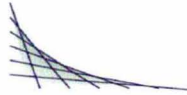

CT LAB Sample#: 155900	Sample Description: MW-10I DUP	DNR License/Well #: 00133/128	Sampled: 04/26/2012 1455
------------------------	--------------------------------	-------------------------------	--------------------------

Analyte	Result	Units	LOD	LOQ	Dilution	Qualifier	Prep Date/Time	Analysis Date/Time	Analyst	Method
1,3-Dichlorobenzene	<0.30	ug/L	0.30	1.1	1			04/30/2012 19:25	APG	EPA 8260B
1,3-Dichloropropane	<0.29	ug/L	0.29	0.98	1			04/30/2012 19:25	APG	EPA 8260B
1,4-Dichlorobenzene	<0.30	ug/L	0.30	1.1	1			04/30/2012 19:25	APG	EPA 8260B
2,2-Dichloropropane	<0.30	ug/L	0.30	1.0	1			04/30/2012 19:25	APG	EPA 8260B
2-Butanone	<4.0	ug/L	4.0	13	1			04/30/2012 19:25	APG	EPA 8260B
2-Chlorotoluene	<0.30	ug/L	0.30	1.1	1			04/30/2012 19:25	APG	EPA 8260B
2-Hexanone	<4.0	ug/L	4.0	13	1			04/30/2012 19:25	APG	EPA 8260B
4-Chlorotoluene	<0.29	ug/L	0.29	0.95	1			04/30/2012 19:25	APG	EPA 8260B
4-Methyl-2-pentanone	<4.0	ug/L	4.0	12	1			04/30/2012 19:25	APG	EPA 8260B
Acetone	<2.9	ug/L	2.9	9.6	1			04/30/2012 19:25	APG	EPA 8260B
Benzene	<0.30	ug/L	0.30	1.0	1			04/30/2012 19:25	APG	EPA 8260B
Bromobenzene	<0.30	ug/L	0.30	1.1	1			04/30/2012 19:25	APG	EPA 8260B
Bromochloromethane	<0.50	ug/L	0.50	1.6	1			04/30/2012 19:25	APG	EPA 8260B
Bromodichloromethane	<0.30	ug/L	0.30	1.0	1			04/30/2012 19:25	APG	EPA 8260B
Bromoform	<0.30	ug/L	0.30	1.1	1			04/30/2012 19:25	APG	EPA 8260B
Bromomethane	<0.30	ug/L	0.30	1.0	1			04/30/2012 19:25	APG	EPA 8260B
Carbon disulfide	<0.50	ug/L	0.50	1.7	1			04/30/2012 19:25	APG	EPA 8260B
Carbon tetrachloride	<0.27	ug/L	0.27	0.90	1			04/30/2012 19:25	APG	EPA 8260B
Chlorobenzene	<0.28	ug/L	0.28	0.95	1			04/30/2012 19:25	APG	EPA 8260B
Chloroethane	<0.30	ug/L	0.30	1.1	1			04/30/2012 19:25	APG	EPA 8260B
Chloroform	<0.23	ug/L	0.23	0.77	1			04/30/2012 19:25	APG	EPA 8260B
Chloromethane	<0.27	ug/L	0.27	0.89	1			04/30/2012 19:25	APG	EPA 8260B
cis-1,2-Dichloroethene	<0.30	ug/L	0.30	1.1	1			04/30/2012 19:25	APG	EPA 8260B
cis-1,3-Dichloropropene	<0.26	ug/L	0.26	0.87	1			04/30/2012 19:25	APG	EPA 8260B
Dibromochloromethane	<0.30	ug/L	0.30	1.0	1			04/30/2012 19:25	APG	EPA 8260B

Solid sample results reported on a Dry Weight Basis



CT LAB Sample#: 155900	Sample Description: MW-10I DUP	DNR License/Well #: 00133/128	Sampled: 04/26/2012 1455
------------------------	--------------------------------	-------------------------------	--------------------------

Analyte	Result	Units	LOD	LOQ	Dilution	Qualifier	Prep Date/Time	Analysis Date/Time	Analyst	Method
Dibromomethane	<0.30	ug/L	0.30	1.0	1			04/30/2012 19:25	APG	EPA 8260B
Dichlorodifluoromethane	<0.40	ug/L	0.40	1.3	1			04/30/2012 19:25	APG	EPA 8260B
Diisopropyl ether	<0.30	ug/L	0.30	1.0	1			04/30/2012 19:25	APG	EPA 8260B
Ethylbenzene	<0.30	ug/L	0.30	1.0	1			04/30/2012 19:25	APG	EPA 8260B
Hexachlorobutadiene	<0.50	ug/L	0.50	1.6	1			04/30/2012 19:25	APG	EPA 8260B
Isopropylbenzene	<0.30	ug/L	0.30	1.1	1			04/30/2012 19:25	APG	EPA 8260B
m & p-Xylene	<0.60	ug/L	0.60	2.2	1			04/30/2012 19:25	APG	EPA 8260B
Methyl tert-butyl ether	<0.40	ug/L	0.40	1.2	1			04/30/2012 19:25	APG	EPA 8260B
Methylene chloride	<0.40	ug/L	0.40	1.3	1			04/30/2012 19:25	APG	EPA 8260B
n-Butylbenzene	<0.40	ug/L	0.40	1.4	1			04/30/2012 19:25	APG	EPA 8260B
n-Propylbenzene	<0.40	ug/L	0.40	1.3	1			04/30/2012 19:25	APG	EPA 8260B
Naphthalene	<0.30	ug/L	0.30	1.1	1			04/30/2012 19:25	APG	EPA 8260B
o-Xylene	<0.30	ug/L	0.30	1.0	1			04/30/2012 19:25	APG	EPA 8260B
p-Isopropyltoluene	<0.40	ug/L	0.40	1.2	1			04/30/2012 19:25	APG	EPA 8260B
sec-Butylbenzene	<0.30	ug/L	0.30	1.0	1			04/30/2012 19:25	APG	EPA 8260B
Styrene	<0.27	ug/L	0.27	0.89	1			04/30/2012 19:25	APG	EPA 8260B
tert-Butylbenzene	<0.40	ug/L	0.40	1.3	1			04/30/2012 19:25	APG	EPA 8260B
Tetrachloroethene	<0.29	ug/L	0.29	0.96	1			04/30/2012 19:25	APG	EPA 8260B
Tetrahydrofuran	<1.8	ug/L	1.8	5.1	1			04/30/2012 19:25	APG	EPA 8260B
Toluene	<0.30	ug/L	0.30	0.98	1			04/30/2012 19:25	APG	EPA 8260B
trans-1,2-Dichloroethene	<0.30	ug/L	0.30	1.1	1			04/30/2012 19:25	APG	EPA 8260B
trans-1,3-Dichloropropene	<0.30	ug/L	0.30	1.1	1			04/30/2012 19:25	APG	EPA 8260B
Trichloroethene	<0.50	ug/L	0.50	1.6	1			04/30/2012 19:25	APG	EPA 8260B
Trichlorofluoromethane	<0.30	ug/L	0.30	1.1	1			04/30/2012 19:25	APG	EPA 8260B
Vinyl chloride	<0.18	ug/L	0.18	0.61	1			04/30/2012 19:25	APG	EPA 8260B

Solid sample results reported on a Dry Weight Basis

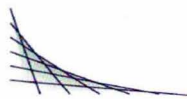

CT LAB Sample#: 155901	Sample Description: MW-13I	DNR License/Well #: 00133/131	Sampled: 04/26/2012 1205
------------------------	----------------------------	-------------------------------	--------------------------

Analyte	Result	Units	LOD	LOQ	Dilution	Qualifier	Prep Date/Time	Analysis Date/Time	Analyst	Method
Organic Results										
Dichlorodifluoromethane	5.8	ug/L	0.40	1.3	1			04/30/2012 20:05	APG	EPA 8260B
Tetrahydrofuran	11	ug/L	1.8	5.1	1			04/30/2012 20:05	APG	EPA 8260B

CT LAB Sample#: 155902	Sample Description: MW-14S	DNR License/Well #: 00133/133	Sampled: 04/26/2012 1030
------------------------	----------------------------	-------------------------------	--------------------------

Analyte	Result	Units	LOD	LOQ	Dilution	Qualifier	Prep Date/Time	Analysis Date/Time	Analyst	Method
Organic Results										
1,1,1,2-Tetrachloroethane	<0.40	ug/L	0.40	1.4	1			05/01/2012 10:31	APG	EPA 8260B
1,1,1-Trichloroethane	<0.29	ug/L	0.29	0.96	1			05/01/2012 10:31	APG	EPA 8260B
1,1,2,2-Tetrachloroethane	<0.30	ug/L	0.30	1.1	1			05/01/2012 10:31	APG	EPA 8260B
1,1,2-Trichloroethane	<0.40	ug/L	0.40	1.2	1			05/01/2012 10:31	APG	EPA 8260B
1,1-Dichloroethane	<0.30	ug/L	0.30	1.1	1			05/01/2012 10:31	APG	EPA 8260B
1,1-Dichloroethene	<0.24	ug/L	0.24	0.79	1			05/01/2012 10:31	APG	EPA 8260B
1,1-Dichloropropene	<0.40	ug/L	0.40	1.3	1			05/01/2012 10:31	APG	EPA 8260B
1,2,3-Trichlorobenzene	<0.40	ug/L	0.40	1.4	1			05/01/2012 10:31	APG	EPA 8260B
1,2,3-Trichloropropane	<0.40	ug/L	0.40	1.2	1			05/01/2012 10:31	APG	EPA 8260B
1,2,4-Trichlorobenzene	<0.40	ug/L	0.40	1.2	1			05/01/2012 10:31	APG	EPA 8260B
1,2,4-Trimethylbenzene	<0.40	ug/L	0.40	1.2	1			05/01/2012 10:31	APG	EPA 8260B
1,2-Dibromo-3-chloropropane	<0.40	ug/L	0.40	1.3	1			05/01/2012 10:31	APG	EPA 8260B
1,2-Dibromoethane	<0.30	ug/L	0.30	1.0	1			05/01/2012 10:31	APG	EPA 8260B
1,2-Dichlorobenzene	<0.40	ug/L	0.40	1.2	1			05/01/2012 10:31	APG	EPA 8260B
1,2-Dichloroethane	<0.30	ug/L	0.30	1.0	1			05/01/2012 10:31	APG	EPA 8260B
1,2-Dichloropropane	<0.40	ug/L	0.40	1.3	1			05/01/2012 10:31	APG	EPA 8260B
1,3,5-Trimethylbenzene	<0.40	ug/L	0.40	1.4	1			05/01/2012 10:31	APG	EPA 8260B

Solid sample results reported on a Dry Weight Basis



CT LAB Sample#: 155902	Sample Description: MW-14S	DNR License/Well #: 00133/133	Sampled: 04/26/2012 1030
------------------------	----------------------------	-------------------------------	--------------------------

Analyte	Result	Units	LOD	LOQ	Dilution	Qualifier	Prep Date/Time	Analysis Date/Time	Analyst	Method
1,3-Dichlorobenzene	<0.30	ug/L	0.30	1.1	1			05/01/2012 10:31	APG	EPA 8260B
1,3-Dichloropropane	<0.29	ug/L	0.29	0.98	1			05/01/2012 10:31	APG	EPA 8260B
1,4-Dichlorobenzene	<0.30	ug/L	0.30	1.1	1			05/01/2012 10:31	APG	EPA 8260B
2,2-Dichloropropane	<0.30	ug/L	0.30	1.0	1			05/01/2012 10:31	APG	EPA 8260B
2-Butanone	<4.0	ug/L	4.0	13	1			05/01/2012 10:31	APG	EPA 8260B
2-Chlorotoluene	<0.30	ug/L	0.30	1.1	1			05/01/2012 10:31	APG	EPA 8260B
2-Hexanone	<4.0	ug/L	4.0	13	1			05/01/2012 10:31	APG	EPA 8260B
4-Chlorotoluene	<0.29	ug/L	0.29	0.95	1			05/01/2012 10:31	APG	EPA 8260B
4-Methyl-2-pentanone	<4.0	ug/L	4.0	12	1			05/01/2012 10:31	APG	EPA 8260B
Acetone	<2.9	ug/L	2.9	9.6	1			05/01/2012 10:31	APG	EPA 8260B
Benzene	<0.30	ug/L	0.30	1.0	1			05/01/2012 10:31	APG	EPA 8260B
Bromobenzene	<0.30	ug/L	0.30	1.1	1			05/01/2012 10:31	APG	EPA 8260B
Bromochloromethane	<0.50	ug/L	0.50	1.6	1			05/01/2012 10:31	APG	EPA 8260B
Bromodichloromethane	<0.30	ug/L	0.30	1.0	1			05/01/2012 10:31	APG	EPA 8260B
Bromoform	<0.30	ug/L	0.30	1.1	1			05/01/2012 10:31	APG	EPA 8260B
Bromomethane	<0.30	ug/L	0.30	1.0	1	Z		05/01/2012 10:31	APG	EPA 8260B
Carbon disulfide	<0.50	ug/L	0.50	1.7	1			05/01/2012 10:31	APG	EPA 8260B
Carbon tetrachloride	<0.27	ug/L	0.27	0.90	1			05/01/2012 10:31	APG	EPA 8260B
Chlorobenzene	<0.28	ug/L	0.28	0.95	1			05/01/2012 10:31	APG	EPA 8260B
Chloroethane	<0.30	ug/L	0.30	1.1	1			05/01/2012 10:31	APG	EPA 8260B
Chloroform	<0.23	ug/L	0.23	0.77	1			05/01/2012 10:31	APG	EPA 8260B
Chloromethane	<0.27	ug/L	0.27	0.89	1			05/01/2012 10:31	APG	EPA 8260B
cis-1,2-Dichloroethene	<0.30	ug/L	0.30	1.1	1			05/01/2012 10:31	APG	EPA 8260B
cis-1,3-Dichloropropene	<0.26	ug/L	0.26	0.87	1			05/01/2012 10:31	APG	EPA 8260B
Dibromochloromethane	<0.30	ug/L	0.30	1.0	1			05/01/2012 10:31	APG	EPA 8260B

Solid sample results reported on a Dry Weight Basis

CT LAB Sample#: 155902	Sample Description: MW-14S	DNR License/Well #: 00133/133	Sampled: 04/26/2012 1030
------------------------	----------------------------	-------------------------------	--------------------------

Analyte	Result	Units	LOD	LOQ	Dilution	Qualifier	Prep Date/Time	Analysis Date/Time	Analyst	Method
Dibromomethane	<0.30	ug/L	0.30	1.0	1			05/01/2012 10:31	APG	EPA 8260B
Dichlorodifluoromethane	7.8	ug/L	0.40	1.3	1			05/01/2012 10:31	APG	EPA 8260B
Diisopropyl ether	<0.30	ug/L	0.30	1.0	1			05/01/2012 10:31	APG	EPA 8260B
Ethylbenzene	<0.30	ug/L	0.30	1.0	1			05/01/2012 10:31	APG	EPA 8260B
Hexachlorobutadiene	<0.50	ug/L	0.50	1.6	1			05/01/2012 10:31	APG	EPA 8260B
Isopropylbenzene	<0.30	ug/L	0.30	1.1	1			05/01/2012 10:31	APG	EPA 8260B
m & p-Xylene	<0.60	ug/L	0.60	2.2	1			05/01/2012 10:31	APG	EPA 8260B
Methyl tert-butyl ether	<0.40	ug/L	0.40	1.2	1			05/01/2012 10:31	APG	EPA 8260B
Methylene chloride	<0.40	ug/L	0.40	1.3	1			05/01/2012 10:31	APG	EPA 8260B
n-Butylbenzene	<0.40	ug/L	0.40	1.4	1			05/01/2012 10:31	APG	EPA 8260B
n-Propylbenzene	<0.40	ug/L	0.40	1.3	1			05/01/2012 10:31	APG	EPA 8260B
Naphthalene	<0.30	ug/L	0.30	1.1	1			05/01/2012 10:31	APG	EPA 8260B
o-Xylene	<0.30	ug/L	0.30	1.0	1			05/01/2012 10:31	APG	EPA 8260B
p-Isopropyltoluene	<0.40	ug/L	0.40	1.2	1			05/01/2012 10:31	APG	EPA 8260B
sec-Butylbenzene	<0.30	ug/L	0.30	1.0	1			05/01/2012 10:31	APG	EPA 8260B
Styrene	<0.27	ug/L	0.27	0.89	1			05/01/2012 10:31	APG	EPA 8260B
tert-Butylbenzene	<0.40	ug/L	0.40	1.3	1			05/01/2012 10:31	APG	EPA 8260B
Tetrachloroethene	1.7	ug/L	0.29	0.96	1			05/01/2012 10:31	APG	EPA 8260B
Tetrahydrofuran	<1.8	ug/L	3.0	5.1	1			05/01/2012 10:31	APG	EPA 8260B
Toluene	<0.30	ug/L	0.30	0.98	1			05/01/2012 10:31	APG	EPA 8260B
trans-1,2-Dichloroethene	<0.30	ug/L	0.30	1.1	1			05/01/2012 10:31	APG	EPA 8260B
trans-1,3-Dichloropropene	<0.30	ug/L	0.30	1.1	1			05/01/2012 10:31	APG	EPA 8260B
Trichloroethene	<0.50	ug/L	0.50	1.6	1			05/01/2012 10:31	APG	EPA 8260B
Trichlorofluoromethane	<0.30	ug/L	0.30	1.1	1			05/01/2012 10:31	APG	EPA 8260B
Vinyl chloride	<0.18	ug/L	0.18	0.61	1			05/01/2012 10:31	APG	EPA 8260B

Solid sample results reported on a Dry Weight Basis



CT LAB Sample#: 155903	Sample Description: MW-14I	DNR License/Well #: 00133/134	Sampled: 04/26/2012 1120
------------------------	----------------------------	-------------------------------	--------------------------

Analyte	Result	Units	LOD	LOQ	Dilution	Qualifier	Prep Date/Time	Analysis Date/Time	Analyst	Method
Organic Results										
1,1,1,2-Tetrachloroethane	<0.40	ug/L	0.40	1.4	1			05/01/2012 11:10	APG	EPA 8260B
1,1,1-Trichloroethane	<0.29	ug/L	0.29	0.96	1			05/01/2012 11:10	APG	EPA 8260B
1,1,2,2-Tetrachloroethane	<0.30	ug/L	0.30	1.1	1			05/01/2012 11:10	APG	EPA 8260B
1,1,2-Trichloroethane	<0.40	ug/L	0.40	1.2	1			05/01/2012 11:10	APG	EPA 8260B
1,1-Dichloroethane	<0.30	ug/L	0.30	1.1	1			05/01/2012 11:10	APG	EPA 8260B
1,1-Dichloroethene	<0.24	ug/L	0.24	0.79	1			05/01/2012 11:10	APG	EPA 8260B
1,1-Dichloropropene	<0.40	ug/L	0.40	1.3	1			05/01/2012 11:10	APG	EPA 8260B
1,2,3-Trichlorobenzene	<0.40	ug/L	0.40	1.4	1			05/01/2012 11:10	APG	EPA 8260B
1,2,3-Trichloropropane	<0.40	ug/L	0.40	1.2	1			05/01/2012 11:10	APG	EPA 8260B
1,2,4-Trichlorobenzene	<0.40	ug/L	0.40	1.2	1			05/01/2012 11:10	APG	EPA 8260B
1,2,4-Trimethylbenzene	<0.40	ug/L	0.40	1.2	1			05/01/2012 11:10	APG	EPA 8260B
1,2-Dibromo-3-chloropropane	<0.40	ug/L	0.40	1.3	1			05/01/2012 11:10	APG	EPA 8260B
1,2-Dibromoethane	<0.30	ug/L	0.30	1.0	1			05/01/2012 11:10	APG	EPA 8260B
1,2-Dichlorobenzene	<0.40	ug/L	0.40	1.2	1			05/01/2012 11:10	APG	EPA 8260B
1,2-Dichloroethane	<0.30	ug/L	0.30	1.0	1			05/01/2012 11:10	APG	EPA 8260B
1,2-Dichloropropane	<0.40	ug/L	0.40	1.3	1			05/01/2012 11:10	APG	EPA 8260B
1,3,5-Trimethylbenzene	<0.40	ug/L	0.40	1.4	1			05/01/2012 11:10	APG	EPA 8260B
1,3-Dichlorobenzene	<0.30	ug/L	0.30	1.1	1			05/01/2012 11:10	APG	EPA 8260B
1,3-Dichloropropane	<0.29	ug/L	0.29	0.98	1			05/01/2012 11:10	APG	EPA 8260B
1,4-Dichlorobenzene	<0.30	ug/L	0.30	1.1	1			05/01/2012 11:10	APG	EPA 8260B
2,2-Dichloropropane	<0.30	ug/L	0.30	1.0	1			05/01/2012 11:10	APG	EPA 8260B
2-Butanone	<4.0	ug/L	4.0	13	1			05/01/2012 11:10	APG	EPA 8260B
2-Chlorotoluene	<0.30	ug/L	0.30	1.1	1			05/01/2012 11:10	APG	EPA 8260B
2-Hexanone	<4.0	ug/L	4.0	13	1			05/01/2012 11:10	APG	EPA 8260B

Solid sample results reported on a Dry Weight Basis

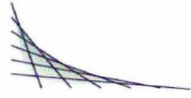

CT LAB Sample#: 155903	Sample Description: MW-14I	DNR License/Well #: 00133/134	Sampled: 04/26/2012 1120
------------------------	----------------------------	-------------------------------	--------------------------

Analyte	Result	Units	LOD	LOQ	Dilution	Qualifier	Prep Date/Time	Analysis Date/Time	Analyst	Method
4-Chlorotoluene	<0.29	ug/L	0.29	0.95	1			05/01/2012 11:10	APG	EPA 8260B
4-Methyl-2-pentanone	<4.0	ug/L	4.0	12	1			05/01/2012 11:10	APG	EPA 8260B
Acetone	<2.9	ug/L	2.9	9.6	1			05/01/2012 11:10	APG	EPA 8260B
Benzene	<0.30	ug/L	0.30	1.0	1			05/01/2012 11:10	APG	EPA 8260B
Bromobenzene	<0.30	ug/L	0.30	1.1	1			05/01/2012 11:10	APG	EPA 8260B
Bromochloromethane	<0.50	ug/L	0.50	1.6	1			05/01/2012 11:10	APG	EPA 8260B
Bromodichloromethane	<0.30	ug/L	0.30	1.0	1			05/01/2012 11:10	APG	EPA 8260B
Bromoform	<0.30	ug/L	0.30	1.1	1			05/01/2012 11:10	APG	EPA 8260B
Bromomethane	<0.30	ug/L	0.30	1.0	1	Z		05/01/2012 11:10	APG	EPA 8260B
Carbon disulfide	<0.50	ug/L	0.50	1.7	1			05/01/2012 11:10	APG	EPA 8260B
Carbon tetrachloride	<0.27	ug/L	0.27	0.90	1			05/01/2012 11:10	APG	EPA 8260B
Chlorobenzene	<0.28	ug/L	0.28	0.95	1			05/01/2012 11:10	APG	EPA 8260B
Chloroethane	<0.30	ug/L	0.30	1.1	1			05/01/2012 11:10	APG	EPA 8260B
Chloroform	<0.23	ug/L	0.23	0.77	1			05/01/2012 11:10	APG	EPA 8260B
Chloromethane	<0.27	ug/L	0.27	0.89	1			05/01/2012 11:10	APG	EPA 8260B
cis-1,2-Dichloroethene	<0.30	ug/L	0.30	1.1	1			05/01/2012 11:10	APG	EPA 8260B
cis-1,3-Dichloropropene	<0.26	ug/L	0.26	0.87	1			05/01/2012 11:10	APG	EPA 8260B
Dibromochloromethane	<0.30	ug/L	0.30	1.0	1			05/01/2012 11:10	APG	EPA 8260B
Dibromomethane	<0.30	ug/L	0.30	1.0	1			05/01/2012 11:10	APG	EPA 8260B
Dichlorodifluoromethane	14	ug/L	0.40	1.3	1			05/01/2012 11:10	APG	EPA 8260B
Diisopropyl ether	<0.30	ug/L	0.30	1.0	1			05/01/2012 11:10	APG	EPA 8260B
Ethylbenzene	<0.30	ug/L	0.30	1.0	1			05/01/2012 11:10	APG	EPA 8260B
Hexachlorobutadiene	<0.50	ug/L	0.50	1.6	1			05/01/2012 11:10	APG	EPA 8260B
Isopropylbenzene	<0.30	ug/L	0.30	1.1	1			05/01/2012 11:10	APG	EPA 8260B
m & p-Xylene	<0.60	ug/L	0.60	2.2	1			05/01/2012 11:10	APG	EPA 8260B

Solid sample results reported on a Dry Weight Basis

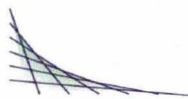

CT LAB Sample#: 155903	Sample Description: MW-14I	DNR License/Well #: 00133/134	Sampled: 04/26/2012 1120
------------------------	----------------------------	-------------------------------	--------------------------

Analyte	Result	Units	LOD	LOQ	Dilution	Qualifier	Prep Date/Time	Analysis Date/Time	Analyst	Method
Methyl tert-butyl ether	<0.40	ug/L	0.40	1.2	1			05/01/2012 11:10	APG	EPA 8260B
Methylene chloride	<0.40	ug/L	0.40	1.3	1			05/01/2012 11:10	APG	EPA 8260B
n-Butylbenzene	<0.40	ug/L	0.40	1.4	1			05/01/2012 11:10	APG	EPA 8260B
n-Propylbenzene	<0.40	ug/L	0.40	1.3	1			05/01/2012 11:10	APG	EPA 8260B
Naphthalene	<0.30	ug/L	0.30	1.1	1			05/01/2012 11:10	APG	EPA 8260B
o-Xylene	<0.30	ug/L	0.30	1.0	1			05/01/2012 11:10	APG	EPA 8260B
p-Isopropyltoluene	<0.40	ug/L	0.40	1.2	1			05/01/2012 11:10	APG	EPA 8260B
sec-Butylbenzene	<0.30	ug/L	0.30	1.0	1			05/01/2012 11:10	APG	EPA 8260B
Styrene	<0.27	ug/L	0.27	0.89	1			05/01/2012 11:10	APG	EPA 8260B
tert-Butylbenzene	<0.40	ug/L	0.40	1.3	1			05/01/2012 11:10	APG	EPA 8260B
Tetrachloroethene	0.62	ug/L	0.29 *	0.96	1			05/01/2012 11:10	APG	EPA 8260B
Tetrahydrofuran	<1.8	ug/L	1.8	5.1	1			05/01/2012 11:10	APG	EPA 8260B
Toluene	<0.30	ug/L	0.30	0.98	1			05/01/2012 11:10	APG	EPA 8260B
trans-1,2-Dichloroethene	<0.30	ug/L	0.30	1.1	1			05/01/2012 11:10	APG	EPA 8260B
trans-1,3-Dichloropropene	<0.30	ug/L	0.30	1.1	1			05/01/2012 11:10	APG	EPA 8260B
Trichloroethene	<0.50	ug/L	0.50	1.6	1			05/01/2012 11:10	APG	EPA 8260B
Trichlorofluoromethane	0.67	ug/L	0.30 *	1.1	1			05/01/2012 11:10	APG	EPA 8260B
Vinyl chloride	<0.18	ug/L	0.18	0.61	1			05/01/2012 11:10	APG	EPA 8260B

CT LAB Sample#: 155904	Sample Description: FIELD BLANK	DNR License/Well #: 00133/997	Sampled: 04/26/2012 1940
------------------------	---------------------------------	-------------------------------	--------------------------

Analyte	Result	Units	LOD	LOQ	Dilution	Qualifier	Prep Date/Time	Analysis Date/Time	Analyst	Method
Organic Results										
1,1,1,2-Tetrachloroethane	<0.40	ug/L	0.40	1.4	1			05/01/2012 11:50	APG	EPA 8260B
1,1,1-Trichloroethane	<0.29	ug/L	0.29	0.96	1			05/01/2012 11:50	APG	EPA 8260B

Solid sample results reported on a Dry Weight Basis



CT LAB Sample#: 155904	Sample Description: FIELD BLANK	DNR License/Well #: 00133/997	Sampled: 04/26/2012 1940
------------------------	---------------------------------	-------------------------------	--------------------------

Analyte	Result	Units	LOD	LOQ	Dilution	Qualifier	Prep Date/Time	Analysis Date/Time	Analyst	Method
1,1,2,2-Tetrachloroethane	<0.30	ug/L	0.30	1.1	1			05/01/2012 11:50	APG	EPA 8260B
1,1,2-Trichloroethane	<0.40	ug/L	0.40	1.2	1			05/01/2012 11:50	APG	EPA 8260B
1,1-Dichloroethane	<0.30	ug/L	0.30	1.1	1			05/01/2012 11:50	APG	EPA 8260B
1,1-Dichloroethene	<0.24	ug/L	0.24	0.79	1			05/01/2012 11:50	APG	EPA 8260B
1,1-Dichloropropene	<0.40	ug/L	0.40	1.3	1			05/01/2012 11:50	APG	EPA 8260B
1,2,3-Trichlorobenzene	<0.40	ug/L	0.40	1.4	1			05/01/2012 11:50	APG	EPA 8260B
1,2,3-Trichloropropane	<0.40	ug/L	0.40	1.2	1			05/01/2012 11:50	APG	EPA 8260B
1,2,4-Trichlorobenzene	<0.40	ug/L	0.40	1.2	1			05/01/2012 11:50	APG	EPA 8260B
1,2,4-Trimethylbenzene	<0.40	ug/L	0.40	1.2	1			05/01/2012 11:50	APG	EPA 8260B
1,2-Dibromo-3-chloropropane	<0.40	ug/L	0.40	1.3	1			05/01/2012 11:50	APG	EPA 8260B
1,2-Dibromoethane	<0.30	ug/L	0.30	1.0	1			05/01/2012 11:50	APG	EPA 8260B
1,2-Dichlorobenzene	<0.40	ug/L	0.40	1.2	1			05/01/2012 11:50	APG	EPA 8260B
1,2-Dichloroethane	<0.30	ug/L	0.30	1.0	1			05/01/2012 11:50	APG	EPA 8260B
1,2-Dichloropropane	<0.40	ug/L	0.40	1.3	1			05/01/2012 11:50	APG	EPA 8260B
1,3,5-Trimethylbenzene	<0.40	ug/L	0.40	1.4	1			05/01/2012 11:50	APG	EPA 8260B
1,3-Dichlorobenzene	<0.30	ug/L	0.30	1.1	1			05/01/2012 11:50	APG	EPA 8260B
1,3-Dichloropropane	<0.29	ug/L	0.29	0.98	1			05/01/2012 11:50	APG	EPA 8260B
1,4-Dichlorobenzene	<0.30	ug/L	0.30	1.1	1			05/01/2012 11:50	APG	EPA 8260B
2,2-Dichloropropane	<0.30	ug/L	0.30	1.0	1			05/01/2012 11:50	APG	EPA 8260B
2-Butanone	<4.0	ug/L	4.0	13	1			05/01/2012 11:50	APG	EPA 8260B
2-Chlorotoluene	<0.30	ug/L	0.30	1.1	1			05/01/2012 11:50	APG	EPA 8260B
2-Hexanone	<4.0	ug/L	4.0	13	1			05/01/2012 11:50	APG	EPA 8260B
4-Chlorotoluene	<0.29	ug/L	0.29	0.95	1			05/01/2012 11:50	APG	EPA 8260B
4-Methyl-2-pentanone	<4.0	ug/L	4.0	12	1			05/01/2012 11:50	APG	EPA 8260B
Acetone	<2.9	ug/L	2.9	9.6	1			05/01/2012 11:50	APG	EPA 8260B

Solid sample results reported on a Dry Weight Basis



CT LAB Sample#: 155904	Sample Description: FIELD BLANK	DNR License/Well #: 00133/997	Sampled: 04/26/2012 1940
------------------------	---------------------------------	-------------------------------	--------------------------

Analyte	Result	Units	LOD	LOQ	Dilution	Qualifier	Prep Date/Time	Analysis Date/Time	Analyst	Method
Benzene	<0.30	ug/L	0.30	1.0	1			05/01/2012 11:50	APG	EPA 8260B
Bromobenzene	<0.30	ug/L	0.30	1.1	1			05/01/2012 11:50	APG	EPA 8260B
Bromochloromethane	<0.50	ug/L	0.50	1.6	1			05/01/2012 11:50	APG	EPA 8260B
Bromodichloromethane	<0.30	ug/L	0.30	1.0	1			05/01/2012 11:50	APG	EPA 8260B
Bromoform	<0.30	ug/L	0.30	1.1	1			05/01/2012 11:50	APG	EPA 8260B
Bromomethane	<0.30	ug/L	0.30	1.0	1	Z		05/01/2012 11:50	APG	EPA 8260B
Carbon disulfide	<0.50	ug/L	0.50	1.7	1			05/01/2012 11:50	APG	EPA 8260B
Carbon tetrachloride	<0.27	ug/L	0.27	0.90	1			05/01/2012 11:50	APG	EPA 8260B
Chlorobenzene	<0.28	ug/L	0.28	0.95	1			05/01/2012 11:50	APG	EPA 8260B
Chloroethane	<0.30	ug/L	0.30	1.1	1			05/01/2012 11:50	APG	EPA 8260B
Chloroform	<0.23	ug/L	0.23	0.77	1			05/01/2012 11:50	APG	EPA 8260B
Chloromethane	<0.27	ug/L	0.27	0.89	1			05/01/2012 11:50	APG	EPA 8260B
cis-1,2-Dichloroethene	<0.30	ug/L	0.30	1.1	1			05/01/2012 11:50	APG	EPA 8260B
cis-1,3-Dichloropropene	<0.26	ug/L	0.26	0.87	1			05/01/2012 11:50	APG	EPA 8260B
Dibromochloromethane	<0.30	ug/L	0.30	1.0	1			05/01/2012 11:50	APG	EPA 8260B
Dibromomethane	<0.30	ug/L	0.30	1.0	1			05/01/2012 11:50	APG	EPA 8260B
Dichlorodifluoromethane	<0.40	ug/L	0.40	1.3	1			05/01/2012 11:50	APG	EPA 8260B
Diisopropyl ether	<0.30	ug/L	0.30	1.0	1			05/01/2012 11:50	APG	EPA 8260B
Ethylbenzene	<0.30	ug/L	0.30	1.0	1			05/01/2012 11:50	APG	EPA 8260B
Hexachlorobutadiene	<0.50	ug/L	0.50	1.6	1			05/01/2012 11:50	APG	EPA 8260B
Isopropylbenzene	<0.30	ug/L	0.30	1.1	1			05/01/2012 11:50	APG	EPA 8260B
m & p-Xylene	<0.60	ug/L	0.60	2.2	1			05/01/2012 11:50	APG	EPA 8260B
Methyl tert-butyl ether	<0.40	ug/L	0.40	1.2	1			05/01/2012 11:50	APG	EPA 8260B
Methylene chloride	<0.40	ug/L	0.40	1.3	1			05/01/2012 11:50	APG	EPA 8260B
n-Butylbenzene	<0.40	ug/L	0.40	1.4	1			05/01/2012 11:50	APG	EPA 8260B

Solid sample results reported on a Dry Weight Basis

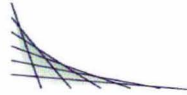

CT LAB Sample#: 155904	Sample Description: FIELD BLANK	DNR License/Well #: 00133/997	Sampled: 04/26/2012 1940
------------------------	---------------------------------	-------------------------------	--------------------------

Analyte	Result	Units	LOD	LOQ	Dilution	Qualifier	Prep Date/Time	Analysis Date/Time	Analyst	Method
n-Propylbenzene	<0.40	ug/L	0.40	1.3	1			05/01/2012 11:50	APG	EPA 8260B
Naphthalene	<0.30	ug/L	0.30	1.1	1			05/01/2012 11:50	APG	EPA 8260B
o-Xylene	<0.30	ug/L	0.30	1.0	1			05/01/2012 11:50	APG	EPA 8260B
p-Isopropyltoluene	<0.40	ug/L	0.40	1.2	1			05/01/2012 11:50	APG	EPA 8260B
sec-Butylbenzene	<0.30	ug/L	0.30	1.0	1			05/01/2012 11:50	APG	EPA 8260B
Styrene	<0.27	ug/L	0.27	0.89	1			05/01/2012 11:50	APG	EPA 8260B
tert-Butylbenzene	<0.40	ug/L	0.40	1.3	1			05/01/2012 11:50	APG	EPA 8260B
Tetrachloroethene	<0.29	ug/L	0.29	0.96	1			05/01/2012 11:50	APG	EPA 8260B
Tetrahydrofuran	<1.8	ug/L	1.8	5.1	1			05/01/2012 11:50	APG	EPA 8260B
Toluene	<0.30	ug/L	0.30	0.98	1			05/01/2012 11:50	APG	EPA 8260B
trans-1,2-Dichloroethene	<0.30	ug/L	0.30	1.1	1			05/01/2012 11:50	APG	EPA 8260B
trans-1,3-Dichloropropene	<0.30	ug/L	0.30	1.1	1			05/01/2012 11:50	APG	EPA 8260B
Trichloroethene	<0.50	ug/L	0.50	1.6	1			05/01/2012 11:50	APG	EPA 8260B
Trichlorofluoromethane	<0.30	ug/L	0.30	1.1	1			05/01/2012 11:50	APG	EPA 8260B
Vinyl chloride	<0.18	ug/L	0.18	0.61	1			05/01/2012 11:50	APG	EPA 8260B

Solid sample results reported on a Dry Weight Basis

Notes: * Indicates Value in between the LOD (limit of detection) and the LOQ (limit of quantitation).

All samples were received intact and properly preserved unless otherwise noted. The results reported relate only to the samples tested. This report shall not be reproduced, except in full, without written approval of this laboratory. The Chain of Custody is attached.

Submitted by: Eric T. Korthals
 Project Manager
 608-356-2760

QC Qualifiers

<u>Code</u>	<u>Description</u>
B	Analyte detected in the associated Method Blank.
C	Toxicity present in BOD sample.
D	Diluted Out.
E	Safe, No Total Coliform detected.
F	Unsafe, Total Coliform detected, no E. Coli detected.
G	Unsafe, Total Coliform detected and E. Coli detected.
H	Holding time exceeded.
J	Estimated value.
L	Significant peaks were detected outside the chromatographic window.
M	Matrix spike and/or Matrix Spike Duplicate recovery outside acceptance limits.
N	Insufficient BOD oxygen depletion.
O	Complete BOD oxygen depletion.
P	Concentration of analyte differs more than 40% between primary and confirmation analysis.
Q	Laboratory Control Sample outside acceptance limits.
R	See Narrative at end of report.
S	Surrogate standard recovery outside acceptance limits due to apparent matrix effects.
T	Sample received with improper preservation or temperature.
U	Analyte concentration was below detection limit.
V	Raised Quantitation or Reporting Limit due to limited sample amount or dilution for matrix background interference.
W	Sample amount received was below program minimum.
X	Analyte exceeded calibration range.
Y	Replicate/Duplicate precision outside acceptance limits.
Z	Specified calibration criteria was not met.

Current CT Laboratories Certifications

Illinois NELAP ID# 002413
 Kansas NELAP ID# E-10368
 Kentucky ID# 0023
 Pennsylvania NELAP ID# 68-04201
 New Jersey NELAP ID# WI001
 North Carolina ID# 674
 Wisconsin (WDNR) Chemistry ID# 157066030
 Wisconsin (DATCP) Bacteriology ID# 105-289
 DoD-ELAP Accreditation Cert # ADE-1453
 Alaska ID # UST-099
 Louisiana ID # 115843
 Virginia ID# 460203
 GA EPD Stipulation ID 115843, Exp 6-30-12

GA EPD Stipulation

Accreditor:	LA NELAP
Scope:	Hazardous/Solid Waste Non-potable water
Effective:	07/01/2011

CHAIN OF CUSTODY RECORD

PROJECT NO. 19-0270.20		PROJECT NAME/CLIENT Stoughton City LF. / Ayres Assoc.					NO. OF JARS DRO (WDNR) GRO (WDNR) P/OC (EPA 8020) GRO/P/OC VOC (EPA 8021) VOCs (B20 B) (incl. THF, TCE, PCE) THF + DCDFM Only										LAB: CT			
SAMPLERS: (Signature) <i>N.D. Carney</i>																	QUOTE #			
																	TURN AROUND TIME: 14-Day TAT			
LAB ID	SAMPLE NO.	COLLECTION		PRESERVE TYPE	SAMPLE MATRIX	NO. OF JARS											COMMENTS			
		DATE	TIME																	
	Trip Blank	4-26-12	-	HCl	GW	1														
	MW-3D		0835			3														155888
	MW-4D		0920			3														165889
	MW-5D		1920			3														155890
	MW-7I		1315			3														155891
	MW-7I DUP		1315			3														155892
	MW-8I		1420			3														155893
	MW-9S		1635			3														155894
	MW-9I		1710			3														155895
	MW-9B		1815			3														155896
	MW-10S		1545			3														164697 Bottle label says MW9D. MW9B script
	MW-10I		1455			3														155898
	MW-10I DUP		1455			3														155899
	MW-13I		1205			3														155900
	MW-14S		1030			3														155901
	MW-14I		1120			3														155902
	Field Blank		1940			3														155903 155902
RELINQUISHED BY: (Signature) <i>N.D. Carney</i>		DATE/TIME 4-27-12 11020		RECEIVED BY: (Signature)			RELINQUISHED BY: (Signature)			DATE/TIME 1		RECEIVED BY: (Signature)								
RELINQUISHED BY: (Signature)		DATE/TIME 1		RECEIVED FOR LABORATORY BY: (Signature)			DATE/TIME 1													
METHOD OF SHIPMENT:		DROP OFF		LAB COURIER			OTHER:													

SEND RESULTS AND C.O.C. TO: (NAME) Neil Carney



Ayres Associates, Inc.
Engineers/Photogrammetrists/Scientists/Surveyors
1802 Pankratz Street, Madison, WI 53704-4069
(608) 443-1200 Fax (608) 443-1250

3.5°
4/27/12 1025
yld

MAKE INVOICE TO *****
 NAME: J. Sar Folder #: 90543
 ADDRESS: _____ Company: AYRES ASSOCIATES
 CITY/STATE: _____ Project: STOUGHTON LF
 REMARKS: _____ Logged By: TMM PM: ET
 Please FAX executer *****

November 10, 2012

Mr. Gary A. Edelstein, PE
Wisconsin Department of Natural Resources
Bureau for Remediation and Redevelopment - RR/5
PO Box 7921
Madison, WI 53707

RECEIVED

MAY 24 2013

Remediation &
Redevelopment

SUBJECT: Semi-Annual Report
October 2012 Semi-Annual Facility Inspection
Bi-Monthly Gas Monitoring Results
Stoughton City Landfill
FID No. 113005950 - License No. 00133
USEPA ID #WID980901219

Dear Mr. Edelstein:

This letter provides the Semi-Annual Report for the October 2012 Semi-Annual Facility Inspection, and Bi-Monthly Gas Monitoring events at the Stoughton City Landfill, located in Stoughton, Wisconsin. A discussion of the results of the inspection and monitoring events are summarized in the sections below.

1.0 Semi-annual Inspection Results

The Semi-Annual Facility Inspection was conducted on October 12, 2012. Representatives from both the Wisconsin Department of Natural Resources (WDNR) and United States Environmental Protection Agency (USEPA) were present during the inspection. The following items were noted during the inspection. A photolog of the inspection event is provided as Attachment A.

Perimeter Security Fencing - Site signage was unobstructed and legible. The chain-link fencing at the site was in good condition with no damage or vandalism noted. Access gates were in satisfactory condition with both padlocks functioning properly. A broken slat and warped boards are present at the south access gate. Additionally, frost heave has caused the concrete fence supports to rise, and has created an elevated area of fence line where unauthorized access to the landfill is possible on the southwest perimeter of the landfill. Refer to [Attachment A](#), reference photos 2012-10-001 and 2012-10-002 to see these areas. **Recommend resetting the concrete support to return the fence line to original condition/elevation, and repairing the warped and broken wooden fence slats.**

Landfill Cover - Vegetation on the landfill cap was established and in late seasonal stage. No localized areas of ponding or bare soil were observed.

One gully, approximately 6-inches deep was observed on the northwest side of the landfill cap near gas vent 18 (GV-18). A pile of sandy soil was observed downgradient of the gully. Refer to [Attachment A](#), reference photo 2012-10-003. **Recommend replacement of sandy material to eliminate gully in this area.**

Multiple animal burrows and deep-rooted woody vegetation were observed during the inspection. The table below summarizes the locations and provides cross-reference to the photolog in Attachment A.

Location	Observation	Photolog Reference
GV-9	Burrow, Woody Vegetation	2012-10-004
GV-5	Burrow	2012-10-005
MW-6S	Burrow	2012-10-006
MW-6S Near Fence	Burrow	2012-10-007
MW-11S	Woody Vegetation	2012-10-008
GV-16	Woody Vegetation	2012-10-009
SE of GV-9	Burrow	2012-10-010
GV-13	Woody Vegetation	2012-10-011
GV-19	Woody Vegetation	2012-10-012
GV-12	Burrow	2012-10-013

Recommend plugging animal burrows, and removing all woody vegetation and root masses at above-listed locations.

Storm Water Management System - No visible erosion was observed in the drainage channels, and the culverts appeared undamaged. Existing riprap was clogged with obstructions in the south stormwater drainage feature. Obstructions included cattails and woody vegetation, consistent with past inspections. Based on WDNR direction during the inspection event, no further action will be taken in this area.

Landfill Gas Venting System - All 21 gas vents and screens were in good condition and unobstructed. No further action is required for this inspection feature.

Monitoring Wells and Wellhead Covers – The protective casing interferes with the well cap installation on MW4D, MW14I, and MW15D. Refer to [Attachment A](#), reference photos 2012-10-0014 through 0016. **Recommend installation of a new well cover clasp to allow sufficient clearance for expandable caps at each location.**

The stainless steel well casing has been compromised at MW-7B. Refer to [Attachment A](#), reference photos 2012-10-017. It is assumed that the installation of the existing well packer at this location allowed artesian groundwater to freeze and expand within the well casing. No action is recommend at this location as sampling does not occur at this well.

MW-13S has a broken hinge which allows access to the well. Refer to [Attachment A](#), reference photos 2012-10-018. **Recommend installation of a new hinge and clasp at this location.**

Access Road - The site access road was in good condition with no significant ruts or erosion noted. No further action is required for this inspection feature.

Refer to [Attachment B](#) for the field form completed during the semi-annual inspection.

2.0 Bi-monthly Gas Monitoring Results

Bi-Monthly Gas Monitoring of the three perimeter gas probes was conducted on June 28, August 27, and October 12, 2012. Elevated levels of carbon dioxide (10.1%) in combination with low levels of oxygen (4.3%) were detected in GMP-1 during the October 2012 gas monitoring event. These readings deviate from historical results at this well, and also deviate from readings collected from GMP-2 and GMP-3 during the same event. Recommendations for potential corrective action will be made once additional testing provides a larger data set to confirm potential landfill gas migration. The completed field forms for the Bi-Monthly Gas Monitoring Inspections is included in [Attachment C](#).

3.0 Annual Mowing for Landfill Cover

The annual landfill cap mowing event was conducted on August 15, 2012. A tractor pulled mower was utilized during the event. Vegetation was cut to a height of 12-inches or less. Vegetation and brush that were present around existing monitoring wells or gas vents were also cut. There are some well-established root systems near the landfill gas vents which remain as listed in this report. Refer to [Attachment A](#), reference photos 2012-10-019 through 2011-10-020 to see photos of the mowing event.

4.0 Conclusion

If you have any questions regarding site activities or recommendations listed in this report, feel free to contact me by phone at (608) 443-1298, or by e-mail at carneyn@ayresassociates.com.

Sincerely,

Ayres Associates Inc

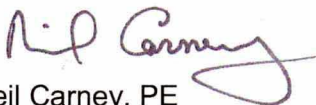
Neil Carney, PE
Project Manager

cc: Ms. Giang-Van Nguyen - USEPA Region V

ATTACHMENT A
SITE PHOTOGRAPHS



2012-10-001: Broken and warped slats on south access gate

Date: 12-Oct-2012

Time: 2:03 PM

Weather: Sunny, 50 Degrees F.



2012-10-002: Frost heave has lifted fence at SW perimeter.

Date: 12-Oct-2012

Time: 1:53 PM

Weather: Sunny, 50 Degrees F.

Signature of Photographer: _____

Rip Carney



2012-10-003: Gulley and sand pile (w/vegetation) near GV-18

Date: 12-Oct-2012

Time: 1:45 PM

Weather: Sunny, 50 Degrees F.



2012-10-004: GV-9 – Animal Burrow, Woody Vegetation

Date: 12-Oct-2012

Time: 12:50 PM

Weather: Sunny, 50 Degrees F.

Signature of Photographer: _____

Rip Carney



2012-10-005: Animal burrow at perimeter fence near GV-5
Date: 12-Oct-2012
Time: 12:55 PM
Weather: Sunny, 50 Degrees F.



2012-10-006: : Animal burrow near MW-6S
Date: 12-Oct-2012
Time: 12:58 PM
Weather: Sunny, 50 Degrees F.

Signature of Photographer: _____

Rip Corning



2012-10-007: Animal burrow near MW-6S at fenceline
Date: 12-Oct-2012
Time: 12:59 PM
Weather: Sunny, 50 Degrees F.



2012-10-008: Woody vegetation near MW-11S
Date: 12-Oct-2012
Time: 1:01 PM
Weather: Sunny, 50 Degrees F.

Signature of Photographer: _____

R. P. Corney



2012-10-009: Woody vegetation near GV-16
Date: 12-Oct-2012
Time: 1:03 PM
Weather: Sunny, 50 Degrees F.



2012-10-010: Animal burrow SE of GV-9
Date: 12-Oct-2012
Time: 1:30 PM
Weather: Sunny, 50 Degrees F.

Signature of Photographer: _____

Rip Corning

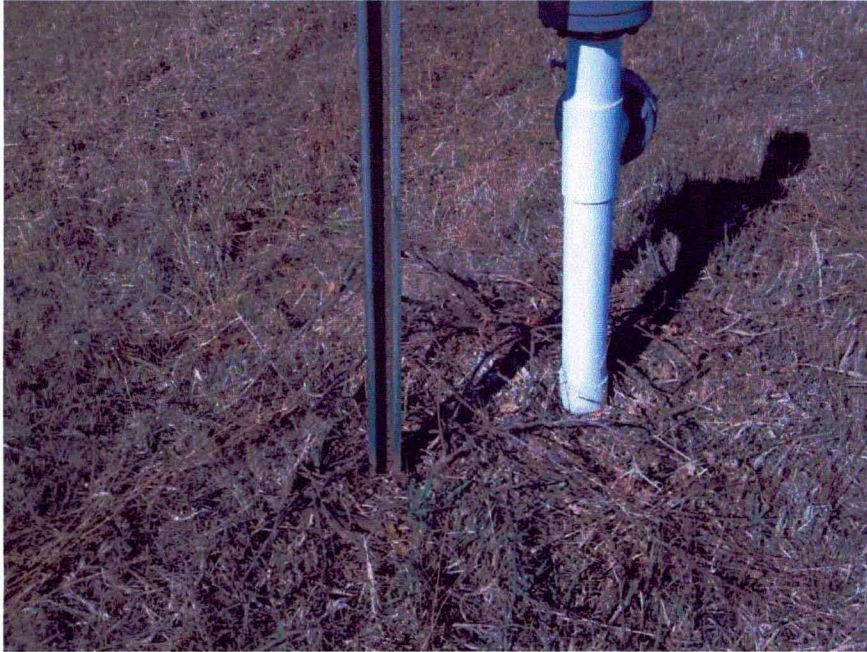

2012-10-011: Woody vegetation near GV-13
Date: 12-Oct-2012
Time: 1:36 PM
Weather: Sunny, 50 Degrees F.



2012-10-012: Woody vegetation near GV-19
Date: 12-Oct-2012
Time: 1:51 PM
Weather: Sunny, 50 Degrees F.

Signature of Photographer: *Rip Carney*



2012-10-013: Animal burrow near GV-12
Date: 12-Oct-2012
Time: 1:59 PM
Weather: Sunny, 50 Degrees F.



2012-10-014: MW4D – Well casing too high to allow installation of expandable cap
Date: 23-Mar-2012 (Historical photo)
Time: 2:49 PM
Weather: Sunny, 35 Degrees F.

Signature of Photographer: *Rip Corning*



2012-10-015: MW14I – Well casing too high to allow installation of expandable cap
Date: 23-Mar-2012 (Historical photo)
Time: 2:51 PM
Weather: Sunny, 35 Degrees F.



2012-10-016: MW15D – Well casing too high to allow installation of expandable cap
Date: 12-Oct-2012
Time: 1:53 PM
Weather: Sunny, 50 Degrees F.

Signature of Photographer: Rip Carney



2012-10-017: MW-7B – Broken Well Casing

Date: 12-Oct-2012

Time: 2:26 PM

Weather: Sunny, 50 Degrees F.



2012-10-018: MW-13S requires new hinge

Date: 12-Oct-2012

Time: 3:22 PM

Weather: Sunny, 50 Degrees F.

Signature of Photographer: _____

Rip Carney



2012-10-019: GV-1 – Landfill Cap Prior to Mowing
Date: 15-Aug-2012
Time: 8:45 PM
Weather: Sunny, 70 Degrees F.



2012-10-020: GV-1 – Landfill Cap After Mowing
Date: 15-Aug-2012
Time: 3:45 PM
Weather: Sunny, 80 Degrees F.

Signature of Photographer: _____

ATTACHMENT B
SEMI-ANNUAL INSPECTION FORM
OCTOBER 2012

**Operation and Maintenance Semi Annual Inspection Report
Stoughton City Landfill
Stoughton, Wisconsin**

Inspector N. Carney
 Company Auras Associates
 Project Stoughton LF
 Location Stoughton, WI
 Date/Time Oct 12, 2012 12:45
 Project No. 19-0270.20

Weather	Clear X	P. Cloudy	Cloudy	Fog
Temperature	High 48	F	---	---
Wind	Calm	Medium 20MPH	High	---
Precipitation	Rain	Light	Moderate	Heavy
	None	Snow	Light	Moderate

Type of Inspection Routine Special
 Persons/Equipment Present: Neil Carney, Gary Edelstein (WDNR), Giang-Van Nguyen (USEPA)

General Description of Site Conditions: Cap is in excellent condition with dense vegetation + good coverage. SW drainage swale is full of cattails + has some trees. Per WDNR No action required. Six animal burrows, and five areas of deep rooted woody vegetation present. Erosion gully (or animal dig) near NW side of cap.

Specific Inspection Items	Potential Problem Areas	Status *	Notes
Perimeter Security Fencing	Broken or missing wood slats, torn chain link fabric.	2	Frost heave on SE fence Broken slat and warp @ E gate.
Entrance Gate and Locking Mechanism	Lock broken/missing, mechanism inoperative.	1	OK
Monitoring Wells and Wellhead Covers	Signs of tampering, casing damaged, lock missing.	2	MW-7B casing broken. MW 4D, 4E, 15D need new caps MW 35 needs bridge.
Final Cover Vegetation	Bare spots, stressed vegetation, deep rooted vegetation.	2	See Below
Final Cover Slope (explain below)	Gullies, lack of vegetation, subsidence, ponding.	2	Gully on NW side of cap
Evidence of Burrowing Animals	Damage to final cover, evidence of waste.	2	See Below
Stormwater Drainage Channels	Gullies, erosion, debris, culvert blocked.	2	SW channel clogged w/cattails
Landfill Gas Venting System	Damaged or blocked vent risers, stressed vegetation.	1	OK
Access Road	Ponding, rutting, erosion.	1	OK
Cover Mowing and Tall Vegetation	Mowing and tall vegetation removal done to specified vegetation	1	OK
Removal (October Inspection Only)	height, any missed areas		

* (1) Acceptable - No Maintenance Required. (2) Not Acceptable - Identify Required Maintenance.
 Summary of Deficiencies and/or Corrective Actions: Refer to Report. Too many to list here.
 Signature of Inspector N. Carney Date 12-Oct-2012

Burrows - GV-9, GV-5, MW-65, MW 65 (Near Fence), GV-9, GV-12
Vegetation - GV-9, MW-115, GV-16, GV-13, GV-19

ATTACHMENT C
BI-MONTHLY GAS MONITORING FORMS

Gas Probe Monitoring Report
Stoughton City Landfill
Stoughton, Wisconsin

Probe	%LEL (as methane)	% Oxygen	%CO2	PID (ppm)	Pressure (inches of water)
GMP-1	0.0	20.6	0.3	0.0	29.24
GMP-2	0.0	19.1	1.8	0.0	29.24
GMP-3	0.0	17.2	3.2	0.0	29.24

Instruments Used: GEM-2000, Thermo 580B OUM

Operator: Noel Carney

Date: June 28, 2012

Weather Conditions:

Barometric Pressure (inches of Hg): 29.79 Temperature (Degrees F): 96° F

Relative Humidity (%): 31% Dewpoint (Degrees F): 70° Wind: 8 MPH

Sky Conditions: Sunny

Ground Conditions:

Snow No Snow Frozen Ground/Frost

Gas Probe Monitoring Report
Stoughton City Landfill
Stoughton, Wisconsin

Probe	%LEL (as methane)	% Oxygen	%CO2	PID (ppm)	Pressure (inches of water) Hg
GMP-1	0.0	20.1	0.0	0.0	29.11
GMP-2	0.0	17.9	2.7	0.0	29.11
GMP-3	0.0	14.9	7.2	0.0	29.11

Instruments Used: GEM 2000, Thermo 580B OUM

Operator: Neil Carney
Date: 8-27-2012

Weather Conditions:

Barometric Pressure (inches of Hg): 30.01 Temperature (Degrees F): 82° F

Relative Humidity (%): 36% Dewpoint (Degrees F): 62° Wind: NNW 7MPH

Sky Conditions: Sunny

Ground Conditions:

Snow No Snow Frozen Ground/Frost

Gas Probe Monitoring Report
Stoughton City Landfill
Stoughton, Wisconsin

Probe	%LEL (as methane)	% Oxygen	%CO2	PID (ppm)	Pressure (inches of water) H ₂ O
GMP-1	0.00%	4.3%	10.1%	0.00	29.43
GMP-2	0.00%	19.7%	1.4%	0.00	29.43
GMP-3	0.00%	18.1%	4.4%	0.00	29.43

BAL
 85.9%
 78.9%
 77.5%

Instruments Used: GEM 2000, S803 OVM Thermo

Operator: Nail Carney
 Date: Oct 12, 2012 12:00pm START

Weather Conditions: Sunny
 Barometric Pressure (inches of Hg): 30.47 Temperature (Degrees F): 47°F
 Relative Humidity (%): ^{NSL} ~~30.47~~ 42% Dewpoint (Degrees F): 25°F Wind: ESE 7MPH
 Sky Conditions: Sunny

Ground Conditions:
 Snow No Snow Frozen Ground/Frost