

GEMS Data Upload Notice

Site: W M W I - HAGEN FARM

Lic #: 2981

For report period(s): 02/01/19

Uploaded: 04/16/19 by Mike Solomon

File received: 04/11/19

Highest VC was found in the most-downgradient bedrock MW.

The following **item(s) of possible concern:** were noted in this data submittal:

- Result records for private wells (Pt. Type 13) were NOT included in this upload.
- There were no result records for parameter code 31 (Leachate, Depth of (from top to bottom in ft)) with values >20 ft in this upload.
- There were no result records for point type 24 (Leachate Head Well) and parameter code 31 (Leachate, Depth of, from top to bottom in ft) with values >1 ft included in this upload.
- There were no result records for parameter code 85547 (METHANE (CH4) IN AIR SAMPLE, VOL % OF DISS GASES) with values >1.25% in this upload.
- Result records for groundwater monitoring wells (Pt. Types 11, 12, 71 and 72) exceeding ES and PAL standards were included in this upload (any ACLs and QC flag failures are not included). ES exceedances are in green font.

Pt ID (Name)	MSI	Sample Date	*Parm Code	Parameter Code Description	Result	NR140 PAL	NR140 ES
100(P-27B)	1	02/20/19	1000	ARSENIC, DISSOLVED (UG/L AS)	13.8	1	10
100(P-27B)	1	02/20/19	1046	IRON, DISSOLVED (MG/L FE)	2.4	.15	.3
35(OB-8M)	1	02/20/19	39175	VINYL CHLORIDE IN WHOLE WATER SAMPLE (UG/L)	0.49	.02	.2
50(P-17C)	1	02/21/19	1046	IRON, DISSOLVED (MG/L FE)	2.2	.15	.3
50(P-17C)	1	02/21/19	39175	VINYL CHLORIDE IN WHOLE WATER SAMPLE (UG/L)	0.21	.02	.2
65(P-22B)	1	02/21/19	1000	ARSENIC, DISSOLVED (UG/L AS)	21.4	1	10
65(P-22B)	1	02/21/19	1046	IRON, DISSOLVED (MG/L FE)	3.1	.15	.3
85(P-26B)	1	02/21/19	39175	VINYL CHLORIDE IN WHOLE WATER SAMPLE (UG/L)	0.21	.02	.2
100(P-27B)	1	02/20/19	1056	MANGANESE, DISSOLVED (UG/L MN)	135	60	300
105(P-28B)	1	02/20/19	1056	MANGANESE, DISSOLVED (UG/L MN)	194	60	300
15(OBS-1B)	1	02/21/19	1000	ARSENIC, DISSOLVED (UG/L AS)	1.6	1	10
150(P-32B)	1	02/20/19	631	NITRITE PLUS NITRATE, DIS. 1 DET. (MG/L AS N)	3.0	2	10
155(MW-33)	1	02/21/19	1056	MANGANESE, DISSOLVED (UG/L MN)	152	60	300
17(OBS-1C)	1	02/21/19	1000	ARSENIC, DISSOLVED (UG/L AS)	7.6	1	10
22(OBS-2C)	1	02/20/19	631	NITRITE PLUS NITRATE, DIS. 1 DET. (MG/L AS N)	5.5	2	10
35(OB-8M)	1	02/20/19	1046	IRON, DISSOLVED (MG/L FE)	0.18	.15	.3
35(OB-8M)	1	02/20/19	1056	MANGANESE, DISSOLVED (UG/L MN)	139	60	300
40(OB-11M)	1	02/20/19	1056	MANGANESE, DISSOLVED (UG/L MN)	94.6	60	300
5(IG-04)	1	02/21/19	34475	TETRACHLOROETHYLENE IN WHOLE WATER SAMPLE (UG/L)	0.65	.5	5
50(P-17C)	1	02/21/19	1000	ARSENIC, DISSOLVED (UG/L AS)	3.6	1	10
50(P-17C)	1	02/21/19	1056	MANGANESE, DISSOLVED (UG/L MN)	244	60	300
55(P-17DR)	1	02/20/19	631	NITRITE PLUS NITRATE, DIS. 1 DET. (MG/L AS N)	3.6	2	10
60(MW-22)	1	02/21/19	631	NITRITE PLUS NITRATE, DIS. 1 DET. (MG/L AS N)	5.4	2	10
65(P-22B)	1	02/21/19	1056	MANGANESE, DISSOLVED (UG/L MN)	119	60	300
85(P-26B)	1	02/21/19	1056	MANGANESE, DISSOLVED (UG/L MN)	61.9	60	300
95(MW-27)	1	02/20/19	1000	ARSENIC, DISSOLVED (UG/L AS)	1.4	1	10

*Manganese is unique among GEMS parameters in that it has an ES and PAL in both NR140, Tables 1 Public Health, and 2 Public Welfare. GEMS is not designed to distinguish whether the ES or PAL for Mn originates from NR140 Table 1 or 2. The type of exceedance (ES or PAL) and table (Health or Welfare) will be evident based on the result value. Mn standards are listed below:

Public Welfare PAL (PW PAL) = 25 ppb
 Public Welfare ES (PW ES) = 50 ppb
 Public Health PAL (PH PAL) = 60 ppb
 Public Health ES (PH ES) = 300 ppb

Result = < 25 ppb.....No standards apply.
 25 - 49 ppb.....PW PAL
 50 - 59 ppb.....PW ES & PW PAL
 60 - 299 ppb.....PH PAL & PW ES & PW PAL
 >299 ppb.....PH ES & PH PAL & PW ES & PW PAL

Map from 2018 Annual Report dated 3/15/2019

OB-8M

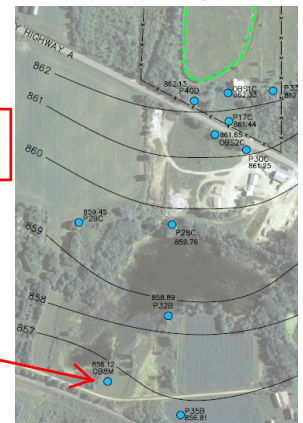

April 8, 2019
File No. 25212002.00

GEMS Data Submittal Contact – WA/5
Bureau of Waste and Materials Management
Wisconsin Department of Natural Resources
P.O. Box 7921
Madison, WI 53707-7921

Subject: Hagen Farm Landfill, Town of Dunkirk, Dane County, Wisconsin
WDNR License No. 02981 – FID #113176030
First Quarter 2019 Environmental Data Submittal

Dear GEMS Data Submittal Contact:

Enclosed is the first quarter 2019 environmental data submittal for the Hagen Farm Landfill, License No. 02981. The submittal includes results from the semi-annual (February) sampling event at the site. The data were collected in accordance with the requirements of the U.S. Environmental Protection Agency (USEPA) approval of the Hagen Farm Site Groundwater Control Operable Unit Revised Workplan dated March 1, 2005, as amended.

SAMPLING SUMMARY

The first quarter (i.e., semi-annual) sampling event, which was performed during the period of February 20-21, 2019, included measurement of water levels and/or collection of groundwater samples at 33 monitoring wells in the vicinity of the site. The samples and associated field data were collected by SCS Engineers' staff. The samples were submitted to TestAmerica Buffalo (Wisconsin Lab Certification No. 998310390) for laboratory analysis.

INFORMATION INCLUDED IN THIS SUBMITTAL

This submittal includes the following:

- A CD with the electronic data submittal file (feb19-02981.txt) from this period.
- **Attachment A**, a table that identifies the compounds that exceeded the groundwater standards identified in Chapter NR 140, Wisconsin Administrative Code (Wis. Adm. Code) (i.e., exceedances) during this sampling period.
- **Attachment B**, a table that identifies sample results between the limit of detection (LOD) and limit of quantitation (LOQ) from this sampling period.
- **Attachment C**, a completed Environmental Monitoring Data Certification Form [Form 4400 231(R 5/17)].
- **Attachment D**, a printout of the data from this sampling period.



SUBMITTAL NOTES

Please note the following:

- Results for vinyl chloride are reported from two different analytical methods, using gas chromatography/mass spectrometry (GC/MS) and selective ion methodology (SIM). The data from the two analytical methods are evaluated independently in that if both results exceeded a groundwater standard, two exceedances are reported in **Attachments A** and **D**, even though the results are from the same sample.
- Manganese results are evaluated with regard to the criteria identified in Table 1 (Public Health Groundwater Quality Standards) and Table 2 (Public Welfare Groundwater Quality Standards) of NR 140.10 and NR 140.12, respectively; thus, the data from a single sample may be reported as two exceedances in **Attachments A** and **D**.
- Results from this sampling period that exceed the values identified as the enforcement standard (ES) or preventive action limit (PAL) in Chapter NR 140, Wis. Adm. Code are denoted using an E or P, respectively, in **Attachments A** and **D** of this submittal. A "P*" indicates that the well is within the Design Management Zone (DMZ) and property boundary; therefore, the well meets the point of standards criteria identified in NR 140.22 and the ES does not apply. Consistent with prior submittals, the preliminary cause and significance of concentrations exceeding groundwater standards is not presented herein. Groundwater quality has been evaluated as part of the remedial investigation for this USEPA-lead Comprehensive Environmental Response, Compensation, and Liability Act (CERCLA) site, and is also periodically evaluated in the annual reports for the operation and maintenance of the selected remedy.

DATA QUALITY

No results from this reporting period were qualified by the laboratory as failing Wisconsin Department of Natural Resources (WDNR) Quality Control (QC) Flag 1 criteria due to identification of the compound(s) in the laboratory method, trip blank (TB), or field blank (FB) associated with the batch in which the specific samples were analyzed at a concentration above the specified criteria.

No results from this reporting period were qualified by the laboratory as failing WDNR QC Flag 2, in that all samples met preservation and holding time criteria.

Nine tetrahydrofuran (THF) results, from analysis of samples from the groundwater monitoring wells from this reporting period, were qualified by the laboratory as failing the WDNR QC Flag 3 criteria in that the results failed laboratory QC standards. Those results were qualified because the recovery of the laboratory control sample (LCS) was outside the control limits. In this case, the recovery of the LCS for THF was greater than the specified criteria; thus, potentially indicating a high bias in the data. However, each of the qualified THF results were reported as below the LOD.

In addition to laboratory QC measures, the laboratory analyzed one TB and one FB prepared in association with this sampling event to assess data quality. No volatile organic compounds (VOCs) were quantified above the LOD from analysis of the TB. One VOC, dichloromethane or methylene chloride, was identified at a concentration that exceeded the PAL, but not the ES, in analysis of the FB. Methylene chloride is a typical laboratory contaminant, thus the result is likely a laboratory

artifact. The other results from analysis of the FB are typical of deionized water and are not likely to indicate a significant data quality issue since dedicated sampling equipment is utilized at the site.

Given the explanations summarized above, the data from this period are acceptable for use.

Please contact me at (262) 518-4082 if you have any questions regarding this report.

Sincerely,



Zach Watson
Associate Scientist
SCS Engineers



Michael J. Prattke
Project Director
SCS Engineers

ZTW/jsn/MP

cc: Ms. Sheila Sullivan, USEPA, w/o disk
Mr. Aristeo Pelayo, WDNR, w/o disk (electronic copy by email only)
Mr. Michael Peterson, Waste Management of Wisconsin, Inc., w/o disk

- Encl. Attachment A – Semi-Annual Groundwater Sampling Event – February 2019
Identification of NR 140 Exceedances
- Attachment B – Semi-Annual Groundwater Sampling Event – February 2019
Identification of Sample Results Between the LOD and LOQ (“J-Flags”)
- Attachment C – Semi-Annual Groundwater Sampling Event – February 2019
Environmental Monitoring Data Certification - Form [Form 4400-231 (R
5/17)]
- Attachment D - Semi-Annual Groundwater Sampling Event – February 2019
Environmental Monitoring Data



Appendix A

Semi-Annual Groundwater Sampling Event – February 2019
Identification of NR 140 Exceedances

Hagen Farm Landfill

Attachment A
First Quarter 2019

Identification of NR 140 Exceedances

License Number: 02981
Facility ID Number: 113176030

Well	Sample		Sample Result	NR140 Standards		Units	Type of Standard	Type of Exceedance	Qualifier	RL	LOD	LOQ
	Date	Parameter		PAL	ES							
OBS1B	190221	ARSENIC-DISSOLVED AS AS	1.6	1	10	UG/L	Table 1	P		1.0	0.27	0.90
OBS1C	190221	ARSENIC-DISSOLVED AS AS	7.6	1	10	UG/L	Table 1	P		1.0	0.27	0.90
P17C	190221	ARSENIC-DISSOLVED AS AS	3.6	1	10	UG/L	Table 1	P		1.0	0.27	0.90
P22B	190221	ARSENIC-DISSOLVED AS AS	21.4	1	10	UG/L	Table 1	P*		1.0	0.27	0.90
MW27	190220	ARSENIC-DISSOLVED AS AS	1.4	1	10	UG/L	Table 1	P		1.0	0.27	0.90
P27B	190220	ARSENIC-DISSOLVED AS AS	13.8	1	10	UG/L	Table 1	E		1.0	0.27	0.90
OB8M	190220	IRON-DISSOLVED AS FE	0.18	0.15	0.3	MG/L	Table 2	P		0.030	0.019	0.064
P17C	190221	IRON-DISSOLVED AS FE	2.2	0.15	0.3	MG/L	Table 2	P*		0.030	0.019	0.064
P22B	190221	IRON-DISSOLVED AS FE	3.1	0.15	0.3	MG/L	Table 2	P*		0.030	0.019	0.064
P27B	190220	IRON-DISSOLVED AS FE	2.4	0.15	0.3	MG/L	Table 2	E		0.030	0.019	0.064
OB8M	190220	MANGANESE-DISSOLVED AS MN	139	60	300	UG/L	Table 1	P		10.0	0.40	1.3
OB8M	190220	MANGANESE-DISSOLVED AS MN	139	25	50	UG/L	Table 2	E		10.0	0.40	1.3
OB11M	190220	MANGANESE-DISSOLVED AS MN	94.6	60	300	UG/L	Table 1	P		10.0	0.40	1.3
OB11M	190220	MANGANESE-DISSOLVED AS MN	94.6	25	50	UG/L	Table 2	E		10.0	0.40	1.3
P17C	190221	MANGANESE-DISSOLVED AS MN	244	60	300	UG/L	Table 1	P		10.0	0.40	1.3
P17C	190221	MANGANESE-DISSOLVED AS MN	244	25	50	UG/L	Table 2	P*		10.0	0.40	1.3
P22B	190221	MANGANESE-DISSOLVED AS MN	119	60	300	UG/L	Table 1	P		10.0	0.40	1.3
P22B	190221	MANGANESE-DISSOLVED AS MN	119	25	50	UG/L	Table 2	P*		10.0	0.40	1.3
P26B	190221	MANGANESE-DISSOLVED AS MN	61.9	60	300	UG/L	Table 1	P		10.0	0.40	1.3
P26B	190221	MANGANESE-DISSOLVED AS MN	61.9	25	50	UG/L	Table 2	P*		10.0	0.40	1.3
P27B	190220	MANGANESE-DISSOLVED AS MN	135	60	300	UG/L	Table 1	P		10.0	0.40	1.3
P27B	190220	MANGANESE-DISSOLVED AS MN	135	25	50	UG/L	Table 2	E		10.0	0.40	1.3
P28B	190220	MANGANESE-DISSOLVED AS MN	194	60	300	UG/L	Table 1	P		10.0	0.40	1.3
P28B	190220	MANGANESE-DISSOLVED AS MN	194	25	50	UG/L	Table 2	E		10.0	0.40	1.3
MW33	190221	MANGANESE-DISSOLVED AS MN	152	60	300	UG/L	Table 1	P		10.0	0.40	1.3
MW33	190221	MANGANESE-DISSOLVED AS MN	152	25	50	UG/L	Table 2	P*		10.0	0.40	1.3
OBS2C	190220	NITRITE PLUS NITRATE-DISSOLVED AS N	5.5	2	10	MG/L	Table 1	P		0.25	0.10	0.33
P17DR	190220	NITRITE PLUS NITRATE-DISSOLVED AS N	3.6	2	10	MG/L	Table 1	P		0.10	0.040	0.13
MW22	190221	NITRITE PLUS NITRATE-DISSOLVED AS N	5.4	2	10	MG/L	Table 1	P		0.25	0.10	0.33
P32B	190220	NITRITE PLUS NITRATE-DISSOLVED AS N	3.0	2	10	MG/L	Table 1	P		0.050	0.020	0.067
IG04	190221	TETRACHLOROETHYLENE	0.65	0.5	5	UG/L	Table 1	P	J	1.0	0.36	1.2

Hagen Farm Landfill

Attachment A
First Quarter 2019

Identification of NR 140 Exceedances

License Number: 02981
Facility ID Number: 113176030

Well	Sample		Sample Result	NR140 Standards		Units	Type of Standard	Type of Exceedance	Qualifier	RL	LOD	LOQ
	Date	Parameter		PAL	ES							
OB8M	190220	VINYL CHLORIDE	0.49	0.02	0.2	UG/L	Table 1	E		0.020	0.004	0.013
P17C	190221	VINYL CHLORIDE	0.21	0.02	0.2	UG/L	Table 1	P*		0.020	0.004	0.013
P26B	190221	VINYL CHLORIDE	0.21	0.02	0.2	UG/L	Table 1	P*		0.020	0.004	0.013

P* = Well is located within the Design Management Zone (DMZ) and property boundary, thus the Enforcement Standard does not apply

P = NR 140 Preventive Action Limit or NR 500 Alternate Concentration Limit exceedance

E = NR 140 Enforcement Standard exceedance

J = Sample result is between the Limit of Detection (LOD) and the Limit of Quantitation (LOQ)

EX = NR 140.28 (NR 508.19) Exemptions granted for exceedance

Special Note:

J-Qualifier (Flag) indicates an estimated concentration of an analyte between the Limit of Detection (LOD) and the Limit of Quantitation (LOQ), thus the values are not quantifiable numbers and do not constitute exceedances. However, these values are reported in compliance with NR 507.26 (3)(b) and NR 140.16(5).

Vinyl chloride is analyzed by EPA Method 8260C and by Selective Ion Monitoring. The data from the two analytical methods is evaluated independently in that if both results exceeded a groundwater standard, two exceedances are reported even though the results are from the same sample.

Appendix B

Semi-Annual Groundwater Sampling Event – February 2019 Identification of Sample Results Between the LOD and LOQ (“J-Flags”)

Hagen Farm Landfill

Attachment B
First Quarter 2019

Identification of Sample Results Between the LOD and LOQ ("J-Flags")

License Number: 02981
Facility ID Number: 113176030

Well	Sample Date	Parameter	Sample Result	NR140 Standards		Units	Qualifier	RL	LOD	LOQ
				PAL	ES					
IG04	190221	ARSENIC-DISSOLVED AS AS	0.67	1	10	UG/L	J	1.0	0.27	0.90
IG04	190221	TETRACHLOROETHYLENE	0.65	0.5	5	UG/L	J	1.0	0.36	1.2
OBS1A	190221	ARSENIC-DISSOLVED AS AS	0.58	1	10	UG/L	J	1.0	0.27	0.90
OBS1A	190221	IRON-DISSOLVED AS FE	0.038	0.15	0.3	MG/L	J	0.030	0.019	0.064
OBS1A	190221	LEAD-DISSOLVED AS PB	0.18	1.5	15	UG/L	J	1.5	0.17	0.57
OBS1B	190221	LEAD-DISSOLVED AS PB	0.19	1.5	15	UG/L	J	1.5	0.17	0.57
OBS1C	190221	MANGANESE-DISSOLVED AS MN	0.84	60	300	UG/L	J	10.0	0.40	1.3
OBS1C	190221	NITRITE PLUS NITRATE-DISSOLVED AS N	0.056	2	10	MG/L	J	0.050	0.020	0.067
OBS2C	190220	ARSENIC-DISSOLVED AS AS	0.53	1	10	UG/L	J	1.0	0.27	0.90
MW7	190221	ARSENIC-DISSOLVED AS AS	0.41	1	10	UG/L	J	1.0	0.27	0.90
MW7	190221	IRON-DISSOLVED AS FE	0.037	0.15	0.3	MG/L	J	0.030	0.019	0.064
MW7	190221	LEAD-DISSOLVED AS PB	0.46	1.5	15	UG/L	J	1.5	0.17	0.57
OB8M	190220	ARSENIC-DISSOLVED AS AS	0.84	1	10	UG/L	J	1.0	0.27	0.90
OB11M	190220	ARSENIC-DISSOLVED AS AS	0.37	1	10	UG/L	J	1.0	0.27	0.90
P17B	190221	ARSENIC-DISSOLVED AS AS	0.59	1	10	UG/L	J	1.0	0.27	0.90
P17DR	190220	ARSENIC-DISSOLVED AS AS	0.44	1	10	UG/L	J	1.0	0.27	0.90
P17DR	190220	IRON-DISSOLVED AS FE	0.056	0.15	0.3	MG/L	J	0.030	0.019	0.064
MW22	190221	ARSENIC-DISSOLVED AS AS	0.47	1	10	UG/L	J	1.0	0.27	0.90
P22B	190221	NITRITE PLUS NITRATE-DISSOLVED AS N	0.054	2	10	MG/L	J	0.050	0.020	0.067
MW26	190221	ARSENIC-DISSOLVED AS AS	0.29	1	10	UG/L	J	1.0	0.27	0.90
MW26	190221	IRON-DISSOLVED AS FE	0.042	0.15	0.3	MG/L	J	0.030	0.019	0.064
P26B	190221	IRON-DISSOLVED AS FE	0.042	0.15	0.3	MG/L	J	0.030	0.019	0.064
MW27	190220	LEAD-DISSOLVED AS PB	0.19	1.5	15	UG/L	J	1.5	0.17	0.57
MW27	190220	NITRITE PLUS NITRATE-DISSOLVED AS N	0.055	2	10	MG/L	J	0.050	0.020	0.067
P28B	190220	ARSENIC-DISSOLVED AS AS	0.79	1	10	UG/L	J	1.0	0.27	0.90
P28B	190220	IRON-DISSOLVED AS FE	0.035	0.15	0.3	MG/L	J	0.030	0.019	0.064
P28B	190220	LEAD-DISSOLVED AS PB	0.19	1.5	15	UG/L	J	1.5	0.17	0.57
P28B	190220	NITRITE PLUS NITRATE-DISSOLVED AS N	0.024	2	10	MG/L	J	0.050	0.020	0.067
P32B	190220	LEAD-DISSOLVED AS PB	0.18	1.5	15	UG/L	J	1.5	0.17	0.57

Hagen Farm Landfill

Attachment B
First Quarter 2019

Identification of Sample Results Between the LOD and LOQ ("J-Flags")

License Number: 02981
Facility ID Number: 113176030

Well	Sample Date	Parameter	Sample Result	NR140 Standards		Units	Qualifier	RL	LOD	LOQ
				PAL	ES					
MW33	190221	ARSENIC-DISSOLVED AS AS	0.27	1	10	UG/L	J	1.0	0.27	0.90
MW33	190221	SULFATE-DISSOLVED AS SO4	0.56	125	250	MG/L	J	2.0	0.35	1.2

Notes:

J = Estimated result - sample result is between the Limit of Detection (LOD) and the Limit of Quantitation (LOQ)

Special Note:

J-Qualifier (Flag) indicates an estimated concentration of an analyte between the Limit of Detection (LOD) and the Limit of Quantitation (LOQ), thus the values are not quantifiable numbers and do not constitute exceedances. However, these values are reported in compliance with NR 507.26 (3)(b) and NR 140.16(5).

Appendix C

Semi-Annual Groundwater Sampling Event – February 2019
Environmental Monitoring Data Certification
Form [Form 4400-231 (R 5/17)]

State of Wisconsin
 Department of Natural Resources
 dnr.wi.gov

Environmental Monitoring Data Certification
 Form 4400-231 (R 5/17)

Notice: Personally identifiable information collected will be used for program administration and enforcement purposes. The Department may also provide this information to requesters as required under Wisconsin's Open Records law, ss. 19.31 to 19.39, Wis. Stats. When submitting monitoring data, the owner or operator of the facility, practice or activity is required to notify the Department in writing that a groundwater standard or an explosive gas level has been attained or exceeded, as specified in ss. NR 140.24(1)(a); NR 140.26(1)(a); NR 507.30NR 635.14(9)(a); NR 635.18(20) and NR 507.30, Wis. Adm. Code. Failure to report may result in fines, forfeitures or other penalties resulting from enforcement under ss. 289.97, 291.97 or 299.95, Wis. Stats

Instructions:

- **Prepare one form for each license or monitoring ID.**
- **Please type or print legibly.**
- Attach a notification of any values that attain or exceed groundwater standards (that is, preventive action limits, enforcement standards or alternative concentration limits). The notification must include a preliminary analysis of the cause and significance of each value.
- Attach a notification of any gas values that attain or exceed explosive gas levels.
- Send the original signed form, any notification, and Electronic Data Deliverable [EDD] to:

GEMS Data Submittal Contact - WA/5
 Wisconsin Department of Natural Resources
 P.O. Box 7921
 Madison, WI 53707-7921

Monitoring Data Submittal Information

Name of entity submitting data (laboratory, consultant, facility owner)
 SCS Engineers

Contact for questions about data formatting. Include data preparer's name, telephone number and Email address:

Name Zach Watson	Phone No. (include area code) 262-518-4082
---------------------	---

Email
 zwatson@scsengineers.com

Facility Name
 Hagen Farms Landfill

License # / Monitoring ID 02981	Facility ID (FID) 113176030
------------------------------------	--------------------------------

Actual sampling dates (e.g., July 2-6, 2003) February 20-21, 2019	The enclosed results are for sampling required in the month(s) of: (e.g., June 2003) February 2019
--	---

Type of Data Submitted (Check all that apply):

- | | |
|---|--|
| <input checked="" type="checkbox"/> Groundwater monitoring data from monitoring wells | <input type="checkbox"/> Gas monitoring data |
| <input type="checkbox"/> Groundwater monitoring data from private water supply wells | <input type="checkbox"/> Air monitoring data |
| <input type="checkbox"/> Leachate monitoring data | <input type="checkbox"/> Other (specify): |

Notification attached?

- No. No groundwater standards or explosive gas limits were exceeded.
- Yes, a notification of values exceeding a groundwater standard is attached. It includes a list of monitoring points, dates, sample values, groundwater standard and preliminary analysis of the cause and significance of any concentration.
- Yes, a notification of values exceeding an explosive gas limit is attached. It includes the monitoring points, dates, sample values and explosive gas limits.

Certification

To the best of my knowledge, the information reported and statements made on this data submittal and attachments are true and correct. Furthermore, I have attached complete notification of any sampling values meeting or exceeding groundwater standards or explosive gas levels, and a preliminary analysis of the cause and significance of concentrations exceeding groundwater standards.

Facility Representative Name (Print) Zach Watson	Title Associate Scientist	Phone No. (include area code) 262-518-4082
---	------------------------------	---



 Signature

4/5/19
 Date Signed (mm/dd/yyyy)

For DNR Use Only

Check action taken, and record date and your initials. Describe on back side if necessary.

- Found uploading problems on _____ Initials _____
- Notified contact of problems on _____ Uploaded data successfully on _____
- EDD format(s): Diskette CD (initial submittal and follow-up) E-mail (follow-up only) Other: _____



Appendix D

Semi-Annual Groundwater Sampling Event – February 2019
Environmental Monitoring Data

Hagen Farm Landfill

Stoughton, WI

License Number: 02981

Facility ID Number: 113176030

Attachment D

First Quarter 2019 Environmental Monitoring Data

Samples Collected by:

SCS Engineers
Gary Sterkel and Charlie Bills

Samples Analyzed by:

Test America, Inc., Amherst, NY (Laboratory Certification Number: 998310390)

Color, Odor, Turbidity: If the Results column shows 0 the parameter was present. If the Qualifier column shows N the parameter was not present.

Exceedance Key:

P* = Within the Design Management Zone (DMZ) and property boundary

P = NR 140 Preventive Action Limit or NR 500 Alternate Concentration Limit exceedance

E = NR 140 Enforcement Standard exceedance

EX = NR 140.28 (NR 508.19) Exemptions granted for exceedance

All exceedances take into account 40 CFR 257-258 Subtitle D standards as well as WDNR approved alternate concentration limits (ACLs)

Qualifier Flag Codes:

N = Analyte was not detected above the Limit of Detection (LOD)

J = Analyte was detected between the Limit of Detection (LOD)
and the Limit of Quantitation (LOQ) ($LOD \leq \text{result} < LOQ$)

QC Flag 2 Codes:

M = Met Preservation and Holding Time criteria

F = Failed Preservation and Holding Time criteria

QC Flag 1 Codes:

M = Analyte was not detected in Method, Trip, or Field Blanks

F = For a sample in which an analyte was detected, the analyte
was also detected in the associated Method, Trip, or Field Blanks
at concentrations which exceed the highest of the following values:

1. The limit of detection, or
2. Five percent of the lowest applicable regulatory limit, or
3. Ten percent of the measured concentration in the sample.

QC Flag 3 Codes:

M = Met Laboratory Quality Control Standards

F = Failed Laboratory Quality Control Standards

Hagen Farm Landfill
WMI Site Number: 393

License Number: 02981
Facility ID Number:

Sample Date	Parameter	Qualifier	Value	Units	PAL	ES	Type of Exceedance	Type of Standard	QC 1	QC 2	QC 3	RL	LOD	LOQ	WDNR Lab Cert
	Sample Point: IG04	WDNR Point ID:	005												
190221	1,1,1-TRICHLOROETHANE	N		UG/L	40	200		Table 1	M	M	M	1.0	0.82	2.7	98310390
190221	1,1,2,2-TETRACHLOROETHANE	N		UG/L	0.02	0.2		Table 1	M	M	M	1.0	0.21	0.70	98310390
190221	1,1,2-TRICHLOROETHANE	N		UG/L	0.5	5		Table 1	M	M	M	1.0	0.23	0.77	98310390
190221	1,1-DICHLOROETHANE	N		UG/L	85	850		Table 1	M	M	M	1.0	0.38	1.3	98310390
190221	1,1-DICHLOROETHYLENE	N		UG/L	0.7	7		Table 1	M	M	M	1.0	0.29	0.97	98310390
190221	1,2,4-TRICHLOROBENZENE	N		UG/L	14	70		Table 1	M	M	M	1.0	0.41	1.4	98310390
190221	1,2-DIBROMO-3-CHLOROPROPANE	N		UG/L	0.02	0.2		Table 1	M	M	M	1.0	0.39	1.3	98310390
190221	1,2-DIBROMOETHANE (EDB)	N		UG/L	0.005	0.05		Table 1	M	M	M	1.0	0.73	2.4	98310390
190221	1,2-DICHLOROETHANE	N		UG/L	0.5	5		Table 1	M	M	M	1.0	0.21	0.70	98310390
190221	1,2-DICHLOROPROPANE	N		UG/L	0.5	5		Table 1	M	M	M	1.0	0.72	2.4	98310390
190221	2-HEXANONE	N		UG/L					M	M	M	5.0	1.2	4.1	98310390
190221	4-METHYL-2-PENTANONE (MIBK)	N		UG/L	50	500		Table 1	M	M	M	5.0	2.1	7.0	98310390
190221	ACETONE	N		UG/L	1800	9000		Table 1	M	M	M	10	3.0	10	98310390
190221	ALKALINITY-TOTAL AS CaCO3 (FILTR)		332	MG/L					M	M	M	40.0	16.0	53.3	98310390
190221	ARSENIC-DISSOLVED AS AS	J	0.67	UG/L	1	10		Table 1	M	M	M	1.0	0.27	0.90	98310390
190221	BARIUM-DISSOLVED AS BA		41.4	UG/L	400	2000		Table 1	M	M	M	5.0	0.70	2.3	98310390
190221	BENZENE	N		UG/L	0.5	5		Table 1	M	M	M	1.0	0.41	1.4	98310390
190221	BROMODICHLOROMETHANE	N		UG/L	0.06	0.6		Table 1	M	M	M	1.0	0.39	1.3	98310390
190221	BROMOMETHANE	N		UG/L	1	10		Table 1	M	M	M	1.0	0.69	2.3	98310390
190221	CARBON DISULFIDE	N		UG/L	200	1000		Table 1	M	M	M	1.0	0.19	0.63	98310390
190221	CARBON TETRACHLORIDE	N		UG/L	0.5	5		Table 1	M	M	M	1.0	0.27	0.90	98310390
190221	CHLOROBENZENE	N		UG/L	20	100		Table 1	M	M	M	1.0	0.75	2.5	98310390
190221	CHLOROETHANE	N		UG/L	80	400		Table 1	M	M	M	1.0	0.32	1.1	98310390
190221	CHLOROFORM	N		UG/L	0.6	6		Table 1	M	M	M	1.0	0.34	1.1	98310390
190221	CHLOROMETHANE	N		UG/L	3	30		Table 1	M	M	M	1.0	0.35	1.2	98310390
190221	CIS-1,2-DICHLOROETHENE	N		UG/L	7	70		Table 1	M	M	M	1.0	0.81	2.7	98310390
190221	CIS-1,3-DICHLOROPROPENE	N		UG/L	0.04	0.4		Table 1	M	M	M	1.0	0.36	1.2	98310390
190221	DIBROMOCHLOROMETHANE	N		UG/L	6	60		Table 1	M	M	M	1.0	0.32	1.1	98310390
190221	DIBROMOMETHANE	N		UG/L					M	M	M	1.0	0.41	1.4	98310390
190221	DICHLORODIFLUOROMETHANE	N		UG/L	200	1000		Table 1	M	M	M	1.0	0.68	2.3	98310390
190221	DICHLOROMETHANE	N		UG/L	0.5	5		Table 1	M	M	M	1.0	0.44	1.5	98310390

Sample Date	Parameter	Qualifier	Value	Units	PAL	ES	Type of Exceedance	Type of Standard	QC 1	QC 2	QC 3	RL	LOD	LOQ	WDNR Lab Cert
Sample Point: IG04		WDNR Point ID: 005													
190221	DISSOLVED OXYGEN, FIELD BY PROBE		5.5	MG/L											
190221	ETHYLBENZENE	N		UG/L	140	700		Table 1	M	M	M	1.0	0.74	2.5	98310390
190221	FLUOROTRICHLOROMETHANE	N		UG/L	698	3490		Table 1	M	M	M	1.0	0.88	2.9	98310390
190221	GROUNDWATER ELEVATION		864.15	FT MSL											
190221	IRON-DISSOLVED AS FE	N		MG/L	0.15	0.3		Table 2	M	M	M	0.030	0.019	0.064	98310390
190221	LEAD-DISSOLVED AS PB	N		UG/L	1.5	15		Table 1	M	M	M	1.5	0.17	0.57	98310390
190221	MANGANESE-DISSOLVED AS MN		1.6	UG/L	60	300		Table 1	M	M	M	10.0	0.40	1.3	98310390
190221	MANGANESE-DISSOLVED AS MN		1.6	UG/L	25	50		Table 2	M	M	M	10.0	0.40	1.3	98310390
190221	M-DICHLOROBENZENE	N		UG/L	120	600		Table 1	M	M	M	1.0	0.78	2.6	98310390
190221	MERCURY-DISSOLVED	N		UG/L	0.2	2		Table 1	M	M	M	0.20	0.12	0.40	98310390
190221	METHYL ETHYL KETONE (MEK)	N		UG/L	800	4000		Table 1	M	M	M	10	1.3	4.4	98310390
190221	METHYL TERT-BUTYL ETHER (MTBE)	N		UG/L	12	60		Table 1	M	M	M	1.0	0.16	0.53	98310390
190221	NAPHTHALENE	N		UG/L	10	100		Table 1	M	M	M	1.0	0.43	1.4	98310390
190221	NITRITE PLUS NITRATE-DISSOLVED AS N		0.46	MG/L	2	10		Table 1	M	M	M	0.050	0.020	0.067	98310390
190221	O-DICHLOROBENZENE	N		UG/L	60	600		Table 1	M	M	M	1.0	0.79	2.6	98310390
190221	OXIDATION REDUCTION POTENTIAL		114.0	MILLIVOLTS											
190221	P-DICHLOROBENZENE	N		UG/L	15	75		Table 1	M	M	M	1.0	0.84	2.8	98310390
190221	PH-FIELD		7.89	SU											
190221	SAMPLE COLOR	N		NONE											
190221	SAMPLE ODOR	N		NONE											
190221	SAMPLE TEMPERATURE		11.7	DEGREES C											
190221	SAMPLE TURBIDITY		0	NONE											
190221	SPECIFIC CONDUCTANCE-FIELD		544	UMHOS/CM											
190221	STYRENE	N		UG/L	10	100		Table 1	M	M	M	1.0	0.73	2.4	98310390
190221	SULFATE-DISSOLVED AS SO4		2.8	MG/L	125	250		Table 2	M	M	M	2.0	0.35	1.2	98310390
190221	TETRACHLOROETHYLENE	J	0.65	UG/L	0.5	5	P	Table 1	M	M	M	1.0	0.36	1.2	98310390
190221	TETRAHYDROFURAN	N		UG/L	10	50		Table 1	M	M	M	5.0	1.3	4.2	98310390
190221	TOLUENE	N		UG/L	160	800		Table 1	M	M	M	1.0	0.51	1.7	98310390
190221	TRANS-1,2-DICHLOROETHENE (TOTAL)	N		UG/L	20	100		Table 1	M	M	M	1.0	0.90	3.0	98310390
190221	TRANS-1,3-DICHLOROPROPENE	N		UG/L	0.04	0.4		Table 1	M	M	M	1.0	0.37	1.2	98310390
190221	TRIBROMOMETHANE	N		UG/L	0.44	4.4		Table 1	M	M	M	1.0	0.26	0.87	98310390
190221	TRICHLOROETHYLENE	N		UG/L	0.5	5		Table 1	M	M	M	1.0	0.46	1.5	98310390

Sample Date	Parameter	Qualifier	Value	Units	PAL	ES	Type of Exceedance	Type of Standard	QC 1	QC 2	QC 3	RL	LOD	LOQ	WDNR Lab Cert
Sample Point: IG04		WDNR Point ID: 005													
190221	VINYL CHLORIDE	N		UG/L	0.02	0.2		Table 1	M	M	M	1.0	0.90	3.0	98310390
190221	VINYL CHLORIDE	N		UG/L	0.02	0.2		Table 1	M	M	M	0.020	0.004	0.013	98310390
190221	XYLENES-TOTAL	N		UG/L	400	2000		Table 1	M	M	M	2.0	0.66	2.2	98310390
Sample Point: OBS1A		WDNR Point ID: 010													
190221	1,1,1-TRICHLOROETHANE	N		UG/L	40	200		Table 1	M	M	M	1.0	0.82	2.7	98310390
190221	1,1,2,2-TETRACHLOROETHANE	N		UG/L	0.02	0.2		Table 1	M	M	M	1.0	0.21	0.70	98310390
190221	1,1,2-TRICHLOROETHANE	N		UG/L	0.5	5		Table 1	M	M	M	1.0	0.23	0.77	98310390
190221	1,1-DICHLOROETHANE	N		UG/L	85	850		Table 1	M	M	M	1.0	0.38	1.3	98310390
190221	1,1-DICHLOROETHYLENE	N		UG/L	0.7	7		Table 1	M	M	M	1.0	0.29	0.97	98310390
190221	1,2,4-TRICHLOROBENZENE	N		UG/L	14	70		Table 1	M	M	M	1.0	0.41	1.4	98310390
190221	1,2-DIBROMO-3-CHLOROPROPANE	N		UG/L	0.02	0.2		Table 1	M	M	M	1.0	0.39	1.3	98310390
190221	1,2-DIBROMOETHANE (EDB)	N		UG/L	0.005	0.05		Table 1	M	M	M	1.0	0.73	2.4	98310390
190221	1,2-DICHLOROETHANE	N		UG/L	0.5	5		Table 1	M	M	M	1.0	0.21	0.70	98310390
190221	1,2-DICHLOROPROPANE	N		UG/L	0.5	5		Table 1	M	M	M	1.0	0.72	2.4	98310390
190221	2-HEXANONE	N		UG/L					M	M	M	5.0	1.2	4.1	98310390
190221	4-METHYL-2-PENTANONE (MIBK)	N		UG/L	50	500		Table 1	M	M	M	5.0	2.1	7.0	98310390
190221	ACETONE	N		UG/L	1800	9000		Table 1	M	M	M	10	3.0	10	98310390
190221	ALKALINITY-TOTAL AS CaCO3 (FILT)		216	MG/L					M	M	M	30.0	12.0	40.0	98310390
190221	ARSENIC-DISSOLVED AS AS	J	0.58	UG/L	1	10		Table 1	M	M	M	1.0	0.27	0.90	98310390
190221	BARIUM-DISSOLVED AS BA		68.0	UG/L	400	2000		Table 1	M	M	M	5.0	0.70	2.3	98310390
190221	BENZENE	N		UG/L	0.5	5		Table 1	M	M	M	1.0	0.41	1.4	98310390
190221	BROMODICHLOROMETHANE	N		UG/L	0.06	0.6		Table 1	M	M	M	1.0	0.39	1.3	98310390
190221	BROMOMETHANE	N		UG/L	1	10		Table 1	M	M	M	1.0	0.69	2.3	98310390
190221	CARBON DISULFIDE	N		UG/L	200	1000		Table 1	M	M	M	1.0	0.19	0.63	98310390
190221	CARBON TETRACHLORIDE	N		UG/L	0.5	5		Table 1	M	M	M	1.0	0.27	0.90	98310390
190221	CHLOROBENZENE	N		UG/L	20	100		Table 1	M	M	M	1.0	0.75	2.5	98310390
190221	CHLOROETHANE	N		UG/L	80	400		Table 1	M	M	M	1.0	0.32	1.1	98310390
190221	CHLOROFORM	N		UG/L	0.6	6		Table 1	M	M	M	1.0	0.34	1.1	98310390
190221	CHLOROMETHANE	N		UG/L	3	30		Table 1	M	M	M	1.0	0.35	1.2	98310390
190221	CIS-1,2-DICHLOROETHENE	N		UG/L	7	70		Table 1	M	M	M	1.0	0.81	2.7	98310390
190221	CIS-1,3-DICHLOROPROPENE	N		UG/L	0.04	0.4		Table 1	M	M	M	1.0	0.36	1.2	98310390
190221	DIBROMOCHLOROMETHANE	N		UG/L	6	60		Table 1	M	M	M	1.0	0.32	1.1	98310390

Sample Date	Parameter	Qualifier	Value	Units	PAL	ES	Type of Exceedance	Type of Standard	QC 1	QC 2	QC 3	RL	LOD	LOQ	WDNR Lab Cert
Sample Point: OBS1A		WDNR Point ID: 010													
190221	DIBROMOMETHANE	N		UG/L					M	M	M	1.0	0.41	1.4	98310390
190221	DICHLORODIFLUOROMETHANE	N		UG/L	200	1000		Table 1	M	M	M	1.0	0.68	2.3	98310390
190221	DICHLOROMETHANE	N		UG/L	0.5	5		Table 1	M	M	M	1.0	0.44	1.5	98310390
190221	DISSOLVED OXYGEN, FIELD BY PROBE		3.9	MG/L											
190221	ETHYLBENZENE	N		UG/L	140	700		Table 1	M	M	M	1.0	0.74	2.5	98310390
190221	FLUOROTRICHLOROMETHANE	N		UG/L	698	3490		Table 1	M	M	M	1.0	0.88	2.9	98310390
190221	GROUNDWATER ELEVATION		860.82	FT MSL											
190221	IRON-DISSOLVED AS FE	J	0.038	MG/L	0.15	0.3		Table 2	M	M	M	0.030	0.019	0.064	98310390
190221	LEAD-DISSOLVED AS PB	J	0.18	UG/L	1.5	15		Table 1	M	M	M	1.5	0.17	0.57	98310390
190221	MANGANESE-DISSOLVED AS MN		4.8	UG/L	60	300		Table 1	M	M	M	10.0	0.40	1.3	98310390
190221	MANGANESE-DISSOLVED AS MN		4.8	UG/L	25	50		Table 2	M	M	M	10.0	0.40	1.3	98310390
190221	M-DICHLOROBENZENE	N		UG/L	120	600		Table 1	M	M	M	1.0	0.78	2.6	98310390
190221	MERCURY-DISSOLVED	N		UG/L	0.2	2		Table 1	M	M	M	0.20	0.12	0.40	98310390
190221	METHYL ETHYL KETONE (MEK)	N		UG/L	800	4000		Table 1	M	M	M	10	1.3	4.4	98310390
190221	METHYL TERT-BUTYL ETHER (MTBE)	N		UG/L	12	60		Table 1	M	M	M	1.0	0.16	0.53	98310390
190221	NAPHTHALENE	N		UG/L	10	100		Table 1	M	M	M	1.0	0.43	1.4	98310390
190221	NITRITE PLUS NITRATE-DISSOLVED AS N		0.38	MG/L	2	10		Table 1	M	M	M	0.050	0.020	0.067	98310390
190221	O-DICHLOROBENZENE	N		UG/L	60	600		Table 1	M	M	M	1.0	0.79	2.6	98310390
190221	OXIDATION REDUCTION POTENTIAL		123.0	MILLIVOLTS											
190221	P-DICHLOROBENZENE	N		UG/L	15	75		Table 1	M	M	M	1.0	0.84	2.8	98310390
190221	PH-FIELD		8.03	SU											
190221	SAMPLE COLOR	N		NONE											
190221	SAMPLE ODOR	N		NONE											
190221	SAMPLE TEMPERATURE		9.1	DEGREES C											
190221	SAMPLE TURBIDITY	N		NONE											
190221	SPECIFIC CONDUCTANCE-FIELD		529	UMHOS/CM											
190221	STYRENE	N		UG/L	10	100		Table 1	M	M	M	1.0	0.73	2.4	98310390
190221	SULFATE-DISSOLVED AS SO4		2.3	MG/L	125	250		Table 2	M	M	M	2.0	0.35	1.2	98310390
190221	TETRACHLOROETHYLENE	N		UG/L	0.5	5		Table 1	M	M	M	1.0	0.36	1.2	98310390
190221	TETRAHYDROFURAN	N		UG/L	10	50		Table 1	M	M	F	5.0	1.3	4.2	98310390
190221	TOLUENE	N		UG/L	160	800		Table 1	M	M	M	1.0	0.51	1.7	98310390
190221	TRANS-1,2-DICHLOROETHENE (TOTAL)	N		UG/L	20	100		Table 1	M	M	M	1.0	0.90	3.0	98310390

Hagen Farm Landfill
WMI Site Number: 393

License Number: 02981
Facility ID Number:

Sample Date	Parameter	Qualifier	Value	Units	PAL	ES	Type of Exceedance	Type of Standard	QC 1	QC 2	QC 3	RL	LOD	LOQ	WDNR Lab Cert
Sample Point: OBS1A		WDNR Point ID: 010													
190221	TRANS-1,3-DICHLOROPROPENE	N		UG/L	0.04	0.4		Table 1	M	M	M	1.0	0.37	1.2	98310390
190221	TRIBROMOMETHANE	N		UG/L	0.44	4.4		Table 1	M	M	M	1.0	0.26	0.87	98310390
190221	TRICHLOROETHYLENE	N		UG/L	0.5	5		Table 1	M	M	M	1.0	0.46	1.5	98310390
190221	VINYL CHLORIDE	N		UG/L	0.02	0.2		Table 1	M	M	M	0.020	0.004	0.013	98310390
190221	VINYL CHLORIDE	N		UG/L	0.02	0.2		Table 1	M	M	M	1.0	0.90	3.0	98310390
190221	XYLENES-TOTAL	N		UG/L	400	2000		Table 1	M	M	M	2.0	0.66	2.2	98310390
Sample Point: OBS1B		WDNR Point ID: 015													
190221	1,1,1-TRICHLOROETHANE	N		UG/L	40	200		Table 1	M	M	M	1.0	0.82	2.7	98310390
190221	1,1,2,2-TETRACHLOROETHANE	N		UG/L	0.02	0.2		Table 1	M	M	M	1.0	0.21	0.70	98310390
190221	1,1,2-TRICHLOROETHANE	N		UG/L	0.5	5		Table 1	M	M	M	1.0	0.23	0.77	98310390
190221	1,1-DICHLOROETHANE	N		UG/L	85	850		Table 1	M	M	M	1.0	0.38	1.3	98310390
190221	1,1-DICHLOROETHYLENE	N		UG/L	0.7	7		Table 1	M	M	M	1.0	0.29	0.97	98310390
190221	1,2,4-TRICHLOROBENZENE	N		UG/L	14	70		Table 1	M	M	M	1.0	0.41	1.4	98310390
190221	1,2-DIBROMO-3-CHLOROPROPANE	N		UG/L	0.02	0.2		Table 1	M	M	M	1.0	0.39	1.3	98310390
190221	1,2-DIBROMOETHANE (EDB)	N		UG/L	0.005	0.05		Table 1	M	M	M	1.0	0.73	2.4	98310390
190221	1,2-DICHLOROETHANE	N		UG/L	0.5	5		Table 1	M	M	M	1.0	0.21	0.70	98310390
190221	1,2-DICHLOROPROPANE	N		UG/L	0.5	5		Table 1	M	M	M	1.0	0.72	2.4	98310390
190221	2-HEXANONE	N		UG/L					M	M	M	5.0	1.2	4.1	98310390
190221	4-METHYL-2-PENTANONE (MIBK)	N		UG/L	50	500		Table 1	M	M	M	5.0	2.1	7.0	98310390
190221	ACETONE	N		UG/L	1800	9000		Table 1	M	M	M	10	3.0	10	98310390
190221	ALKALINITY-TOTAL AS CaCO3 (FILT)		195	MG/L					M	M	M	20.0	8.0	26.7	98310390
190221	ARSENIC-DISSOLVED AS AS		1.6	UG/L	1	10	P	Table 1	M	M	M	1.0	0.27	0.90	98310390
190221	BARIUM-DISSOLVED AS BA		55.6	UG/L	400	2000		Table 1	M	M	M	5.0	0.70	2.3	98310390
190221	BENZENE	N		UG/L	0.5	5		Table 1	M	M	M	1.0	0.41	1.4	98310390
190221	BROMODICHLOROMETHANE	N		UG/L	0.06	0.6		Table 1	M	M	M	1.0	0.39	1.3	98310390
190221	BROMOMETHANE	N		UG/L	1	10		Table 1	M	M	M	1.0	0.69	2.3	98310390
190221	CARBON DISULFIDE	N		UG/L	200	1000		Table 1	M	M	M	1.0	0.19	0.63	98310390
190221	CARBON TETRACHLORIDE	N		UG/L	0.5	5		Table 1	M	M	M	1.0	0.27	0.90	98310390
190221	CHLOROBENZENE	N		UG/L	20	100		Table 1	M	M	M	1.0	0.75	2.5	98310390
190221	CHLOROETHANE	N		UG/L	80	400		Table 1	M	M	M	1.0	0.32	1.1	98310390
190221	CHLOROFORM	N		UG/L	0.6	6		Table 1	M	M	M	1.0	0.34	1.1	98310390
190221	CHLOROMETHANE	N		UG/L	3	30		Table 1	M	M	M	1.0	0.35	1.2	98310390

Sample Date	Parameter	Qualifier	Value	Units	PAL	ES	Type of Exceedance	Type of Standard	QC 1	QC 2	QC 3	RL	LOD	LOQ	WDNR Lab Cert
	Sample Point: OBS1B		WDNR Point ID: 015												
190221	CIS-1,2-DICHLOROETHENE	N		UG/L	7	70		Table 1	M	M	M	1.0	0.81	2.7	98310390
190221	CIS-1,3-DICHLOROPROPENE	N		UG/L	0.04	0.4		Table 1	M	M	M	1.0	0.36	1.2	98310390
190221	DIBROMOCHLOROMETHANE	N		UG/L	6	60		Table 1	M	M	M	1.0	0.32	1.1	98310390
190221	DIBROMOMETHANE	N		UG/L					M	M	M	1.0	0.41	1.4	98310390
190221	DICHLORODIFLUOROMETHANE	N		UG/L	200	1000		Table 1	M	M	M	1.0	0.68	2.3	98310390
190221	DICHLOROMETHANE	N		UG/L	0.5	5		Table 1	M	M	M	1.0	0.44	1.5	98310390
190221	DISSOLVED OXYGEN, FIELD BY PROBE		9.4	MG/L											
190221	ETHYLBENZENE	N		UG/L	140	700		Table 1	M	M	M	1.0	0.74	2.5	98310390
190221	FLUOROTRICHLOROMETHANE	N		UG/L	698	3490		Table 1	M	M	M	1.0	0.88	2.9	98310390
190221	GROUNDWATER ELEVATION		861.00	FT MSL											
190221	IRON-DISSOLVED AS FE	N		MG/L	0.15	0.3		Table 2	M	M	M	0.030	0.019	0.064	98310390
190221	LEAD-DISSOLVED AS PB	J	0.19	UG/L	1.5	15		Table 1	M	M	M	1.5	0.17	0.57	98310390
190221	MANGANESE-DISSOLVED AS MN		1.5	UG/L	60	300		Table 1	M	M	M	10.0	0.40	1.3	98310390
190221	MANGANESE-DISSOLVED AS MN		1.5	UG/L	25	50		Table 2	M	M	M	10.0	0.40	1.3	98310390
190221	M-DICHLOROBENZENE	N		UG/L	120	600		Table 1	M	M	M	1.0	0.78	2.6	98310390
190221	MERCURY-DISSOLVED	N		UG/L	0.2	2		Table 1	M	M	M	0.20	0.12	0.40	98310390
190221	METHYL ETHYL KETONE (MEK)	N		UG/L	800	4000		Table 1	M	M	M	10	1.3	4.4	98310390
190221	METHYL TERT-BUTYL ETHER (MTBE)	N		UG/L	12	60		Table 1	M	M	M	1.0	0.16	0.53	98310390
190221	NAPHTHALENE	N		UG/L	10	100		Table 1	M	M	M	1.0	0.43	1.4	98310390
190221	NITRITE PLUS NITRATE-DISSOLVED AS N		0.94	MG/L	2	10		Table 1	M	M	M	0.050	0.020	0.067	98310390
190221	O-DICHLOROBENZENE	N		UG/L	60	600		Table 1	M	M	M	1.0	0.79	2.6	98310390
190221	OXIDATION REDUCTION POTENTIAL		113.0	MILLIVOLTS											
190221	P-DICHLOROBENZENE	N		UG/L	15	75		Table 1	M	M	M	1.0	0.84	2.8	98310390
190221	PH-FIELD		7.94	SU											
190221	SAMPLE COLOR	N		NONE											
190221	SAMPLE ODOR	N		NONE											
190221	SAMPLE TEMPERATURE		9.5	DEGREES C											
190221	SAMPLE TURBIDITY	N		NONE											
190221	SPECIFIC CONDUCTANCE-FIELD		925	UMHOS/CM											
190221	STYRENE	N		UG/L	10	100		Table 1	M	M	M	1.0	0.73	2.4	98310390
190221	SULFATE-DISSOLVED AS SO4		33.1	MG/L	125	250		Table 2	M	M	M	4.0	0.70	2.3	98310390
190221	TETRACHLOROETHYLENE	N		UG/L	0.5	5		Table 1	M	M	M	1.0	0.36	1.2	98310390

Hagen Farm Landfill
WMI Site Number: 393

License Number: 02981
Facility ID Number:

Sample Date	Parameter	Qualifier	Value	Units	PAL	ES	Type of Exceedance	Type of Standard	QC 1	QC 2	QC 3	RL	LOD	LOQ	WDNR Lab Cert
Sample Point: OBS1B		WDNR Point ID: 015													
190221	TETRAHYDROFURAN	N		UG/L	10	50		Table 1	M	M	F	5.0	1.3	4.2	98310390
190221	TOLUENE	N		UG/L	160	800		Table 1	M	M	M	1.0	0.51	1.7	98310390
190221	TRANS-1,2-DICHLOROETHENE (TOTAL)	N		UG/L	20	100		Table 1	M	M	M	1.0	0.90	3.0	98310390
190221	TRANS-1,3-DICHLOROPROPENE	N		UG/L	0.04	0.4		Table 1	M	M	M	1.0	0.37	1.2	98310390
190221	TRIBROMOMETHANE	N		UG/L	0.44	4.4		Table 1	M	M	M	1.0	0.26	0.87	98310390
190221	TRICHLOROETHYLENE	N		UG/L	0.5	5		Table 1	M	M	M	1.0	0.46	1.5	98310390
190221	VINYL CHLORIDE	N		UG/L	0.02	0.2		Table 1	M	M	M	1.0	0.90	3.0	98310390
190221	VINYL CHLORIDE	N		UG/L	0.02	0.2		Table 1	M	M	M	0.020	0.004	0.013	98310390
190221	XYLENES-TOTAL	N		UG/L	400	2000		Table 1	M	M	M	2.0	0.66	2.2	98310390
Sample Point: OBS1C		WDNR Point ID: 017													
190221	1,1,1-TRICHLOROETHANE	N		UG/L	40	200		Table 1	M	M	M	1.0	0.82	2.7	98310390
190221	1,1,2,2-TETRACHLOROETHANE	N		UG/L	0.02	0.2		Table 1	M	M	M	1.0	0.21	0.70	98310390
190221	1,1,2-TRICHLOROETHANE	N		UG/L	0.5	5		Table 1	M	M	M	1.0	0.23	0.77	98310390
190221	1,1-DICHLOROETHANE	N		UG/L	85	850		Table 1	M	M	M	1.0	0.38	1.3	98310390
190221	1,1-DICHLOROETHYLENE	N		UG/L	0.7	7		Table 1	M	M	M	1.0	0.29	0.97	98310390
190221	1,2,4-TRICHLOROBENZENE	N		UG/L	14	70		Table 1	M	M	M	1.0	0.41	1.4	98310390
190221	1,2-DIBROMO-3-CHLOROPROPANE	N		UG/L	0.02	0.2		Table 1	M	M	M	1.0	0.39	1.3	98310390
190221	1,2-DIBROMOETHANE (EDB)	N		UG/L	0.005	0.05		Table 1	M	M	M	1.0	0.73	2.4	98310390
190221	1,2-DICHLOROETHANE	N		UG/L	0.5	5		Table 1	M	M	M	1.0	0.21	0.70	98310390
190221	1,2-DICHLOROPROPANE	N		UG/L	0.5	5		Table 1	M	M	M	1.0	0.72	2.4	98310390
190221	2-HEXANONE	N		UG/L					M	M	M	5.0	1.2	4.1	98310390
190221	4-METHYL-2-PENTANONE (MIBK)	N		UG/L	50	500		Table 1	M	M	M	5.0	2.1	7.0	98310390
190221	ACETONE	N		UG/L	1800	9000		Table 1	M	M	M	10	3.0	10	98310390
190221	ALKALINITY-TOTAL AS CaCO3 (FILT)		442	MG/L					M	M	M	50.0	20.0	66.7	98310390
190221	ARSENIC-DISSOLVED AS AS		7.6	UG/L	1	10	P	Table 1	M	M	M	1.0	0.27	0.90	98310390
190221	BARIUM-DISSOLVED AS BA		47.5	UG/L	400	2000		Table 1	M	M	M	5.0	0.70	2.3	98310390
190221	BENZENE	N		UG/L	0.5	5		Table 1	M	M	M	1.0	0.41	1.4	98310390
190221	BROMODICHLOROMETHANE	N		UG/L	0.06	0.6		Table 1	M	M	M	1.0	0.39	1.3	98310390
190221	BROMOMETHANE	N		UG/L	1	10		Table 1	M	M	M	1.0	0.69	2.3	98310390
190221	CARBON DISULFIDE	N		UG/L	200	1000		Table 1	M	M	M	1.0	0.19	0.63	98310390
190221	CARBON TETRACHLORIDE	N		UG/L	0.5	5		Table 1	M	M	M	1.0	0.27	0.90	98310390
190221	CHLOROBENZENE	N		UG/L	20	100		Table 1	M	M	M	1.0	0.75	2.5	98310390

Sample Date	Parameter	Qualifier	Value	Units	PAL	ES	Type of Exceedance	Type of Standard	QC 1	QC 2	QC 3	RL	LOD	LOQ	WDNR Lab Cert
	Sample Point: OBS1C	WDNR Point ID:	017												
190221	CHLOROETHANE	N		UG/L	80	400		Table 1	M	M	M	1.0	0.32	1.1	98310390
190221	CHLOROFORM	N		UG/L	0.6	6		Table 1	M	M	M	1.0	0.34	1.1	98310390
190221	CHLOROMETHANE	N		UG/L	3	30		Table 1	M	M	M	1.0	0.35	1.2	98310390
190221	CIS-1,2-DICHLOROETHENE	N		UG/L	7	70		Table 1	M	M	M	1.0	0.81	2.7	98310390
190221	CIS-1,3-DICHLOROPROPENE	N		UG/L	0.04	0.4		Table 1	M	M	M	1.0	0.36	1.2	98310390
190221	DIBROMOCHLOROMETHANE	N		UG/L	6	60		Table 1	M	M	M	1.0	0.32	1.1	98310390
190221	DIBROMOMETHANE	N		UG/L					M	M	M	1.0	0.41	1.4	98310390
190221	DICHLORODIFLUOROMETHANE	N		UG/L	200	1000		Table 1	M	M	M	1.0	0.68	2.3	98310390
190221	DICHLOROMETHANE	N		UG/L	0.5	5		Table 1	M	M	M	1.0	0.44	1.5	98310390
190221	DISSOLVED OXYGEN, FIELD BY PROBE		8.0	MG/L											
190221	ETHYLBENZENE	N		UG/L	140	700		Table 1	M	M	M	1.0	0.74	2.5	98310390
190221	FLUOROTRICHLOROMETHANE	N		UG/L	698	3490		Table 1	M	M	M	1.0	0.88	2.9	98310390
190221	GROUNDWATER ELEVATION		861.01	FT MSL											
190221	IRON-DISSOLVED AS FE	N		MG/L	0.15	0.3		Table 2	M	M	M	0.030	0.019	0.064	98310390
190221	LEAD-DISSOLVED AS PB	N		UG/L	1.5	15		Table 1	M	M	M	1.5	0.17	0.57	98310390
190221	MANGANESE-DISSOLVED AS MN	J	0.84	UG/L	60	300		Table 1	M	M	M	10.0	0.40	1.3	98310390
190221	MANGANESE-DISSOLVED AS MN	J	0.84	UG/L	25	50		Table 2	M	M	M	10.0	0.40	1.3	98310390
190221	M-DICHLOROBENZENE	N		UG/L	120	600		Table 1	M	M	M	1.0	0.78	2.6	98310390
190221	MERCURY-DISSOLVED	N		UG/L	0.2	2		Table 1	M	M	M	0.20	0.12	0.40	98310390
190221	METHYL ETHYL KETONE (MEK)	N		UG/L	800	4000		Table 1	M	M	M	10	1.3	4.4	98310390
190221	METHYL TERT-BUTYL ETHER (MTBE)	N		UG/L	12	60		Table 1	M	M	M	1.0	0.16	0.53	98310390
190221	NAPHTHALENE	N		UG/L	10	100		Table 1	M	M	M	1.0	0.43	1.4	98310390
190221	NITRITE PLUS NITRATE-DISSOLVED AS N	J	0.056	MG/L	2	10		Table 1	M	M	M	0.050	0.020	0.067	98310390
190221	O-DICHLOROBENZENE	N		UG/L	60	600		Table 1	M	M	M	1.0	0.79	2.6	98310390
190221	OXIDATION REDUCTION POTENTIAL		131.0	MILLIVOLTS											
190221	P-DICHLOROBENZENE	N		UG/L	15	75		Table 1	M	M	M	1.0	0.84	2.8	98310390
190221	PH-FIELD		7.82	SU											
190221	SAMPLE COLOR	N		NONE											
190221	SAMPLE ODOR	N		NONE											
190221	SAMPLE TEMPERATURE		9.4	DEGREES C											
190221	SAMPLE TURBIDITY	N		NONE											
190221	SPECIFIC CONDUCTANCE-FIELD		753	UMHOS/CM											

Sample Date	Parameter	Qualifier	Value	Units	PAL	ES	Type of Exceedance	Type of Standard	QC 1	QC 2	QC 3	RL	LOD	LOQ	WDNR Lab Cert
Sample Point: OBS1C		WDNR Point ID: 017													
190221	STYRENE	N		UG/L	10	100		Table 1	M	M	M	1.0	0.73	2.4	98310390
190221	SULFATE-DISSOLVED AS SO4		19.3	MG/L	125	250		Table 2	M	M	M	4.0	0.70	2.3	98310390
190221	TETRACHLOROETHYLENE	N		UG/L	0.5	5		Table 1	M	M	M	1.0	0.36	1.2	98310390
190221	TETRAHYDROFURAN	N		UG/L	10	50		Table 1	M	M	F	5.0	1.3	4.2	98310390
190221	TOLUENE	N		UG/L	160	800		Table 1	M	M	M	1.0	0.51	1.7	98310390
190221	TRANS-1,2-DICHLOROETHENE (TOTAL)	N		UG/L	20	100		Table 1	M	M	M	1.0	0.90	3.0	98310390
190221	TRANS-1,3-DICHLOROPROPENE	N		UG/L	0.04	0.4		Table 1	M	M	M	1.0	0.37	1.2	98310390
190221	TRIBROMOMETHANE	N		UG/L	0.44	4.4		Table 1	M	M	M	1.0	0.26	0.87	98310390
190221	TRICHLOROETHYLENE	N		UG/L	0.5	5		Table 1	M	M	M	1.0	0.46	1.5	98310390
190221	VINYL CHLORIDE	N		UG/L	0.02	0.2		Table 1	M	M	M	1.0	0.90	3.0	98310390
190221	VINYL CHLORIDE	N		UG/L	0.02	0.2		Table 1	M	M	M	0.020	0.004	0.013	98310390
190221	XYLENES-TOTAL	N		UG/L	400	2000		Table 1	M	M	M	2.0	0.66	2.2	98310390
Sample Point: OBS2C		WDNR Point ID: 022													
190220	1,1,1-TRICHLOROETHANE	N		UG/L	40	200		Table 1	M	M	M	1.0	0.82	2.7	98310390
190220	1,1,2,2-TETRACHLOROETHANE	N		UG/L	0.02	0.2		Table 1	M	M	M	1.0	0.21	0.70	98310390
190220	1,1,2-TRICHLOROETHANE	N		UG/L	0.5	5		Table 1	M	M	M	1.0	0.23	0.77	98310390
190220	1,1-DICHLOROETHANE	N		UG/L	85	850		Table 1	M	M	M	1.0	0.38	1.3	98310390
190220	1,1-DICHLOROETHYLENE	N		UG/L	0.7	7		Table 1	M	M	M	1.0	0.29	0.97	98310390
190220	1,2,4-TRICHLOROBENZENE	N		UG/L	14	70		Table 1	M	M	M	1.0	0.41	1.4	98310390
190220	1,2-DIBROMO-3-CHLOROPROPANE	N		UG/L	0.02	0.2		Table 1	M	M	M	1.0	0.39	1.3	98310390
190220	1,2-DIBROMOETHANE (EDB)	N		UG/L	0.005	0.05		Table 1	M	M	M	1.0	0.73	2.4	98310390
190220	1,2-DICHLOROETHANE	N		UG/L	0.5	5		Table 1	M	M	M	1.0	0.21	0.70	98310390
190220	1,2-DICHLOROPROPANE	N		UG/L	0.5	5		Table 1	M	M	M	1.0	0.72	2.4	98310390
190220	2-HEXANONE	N		UG/L					M	M	M	5.0	1.2	4.1	98310390
190220	4-METHYL-2-PENTANONE (MIBK)	N		UG/L	50	500		Table 1	M	M	M	5.0	2.1	7.0	98310390
190220	ACETONE	N		UG/L	1800	9000		Table 1	M	M	M	10	3.0	10	98310390
190220	ALKALINITY-TOTAL AS CaCO3 (FILT)		338	MG/L					M	M	M	40.0	16.0	53.3	98310390
190220	ARSENIC-DISSOLVED AS AS	J	0.53	UG/L	1	10		Table 1	M	M	M	1.0	0.27	0.90	98310390
190220	BARIUM-DISSOLVED AS BA		44.2	UG/L	400	2000		Table 1	M	M	M	5.0	0.70	2.3	98310390
190220	BENZENE	N		UG/L	0.5	5		Table 1	M	M	M	1.0	0.41	1.4	98310390
190220	BROMODICHLOROMETHANE	N		UG/L	0.06	0.6		Table 1	M	M	M	1.0	0.39	1.3	98310390
190220	BROMOMETHANE	N		UG/L	1	10		Table 1	M	M	M	1.0	0.69	2.3	98310390

Sample Date	Parameter	Qualifier	Value	Units	PAL	ES	Type of Exceedance	Type of Standard	QC 1	QC 2	QC 3	RL	LOD	LOQ	WDNR Lab Cert
	Sample Point: OBS2C	WDNR Point ID:	022												
190220	CARBON DISULFIDE	N		UG/L	200	1000		Table 1	M	M	M	1.0	0.19	0.63	98310390
190220	CARBON TETRACHLORIDE	N		UG/L	0.5	5		Table 1	M	M	M	1.0	0.27	0.90	98310390
190220	CHLOROBENZENE	N		UG/L	20	100		Table 1	M	M	M	1.0	0.75	2.5	98310390
190220	CHLOROETHANE	N		UG/L	80	400		Table 1	M	M	M	1.0	0.32	1.1	98310390
190220	CHLOROFORM	N		UG/L	0.6	6		Table 1	M	M	M	1.0	0.34	1.1	98310390
190220	CHLOROMETHANE	N		UG/L	3	30		Table 1	M	M	M	1.0	0.35	1.2	98310390
190220	CIS-1,2-DICHLOROETHENE	N		UG/L	7	70		Table 1	M	M	M	1.0	0.81	2.7	98310390
190220	CIS-1,3-DICHLOROPROPENE	N		UG/L	0.04	0.4		Table 1	M	M	M	1.0	0.36	1.2	98310390
190220	DIBROMOCHLOROMETHANE	N		UG/L	6	60		Table 1	M	M	M	1.0	0.32	1.1	98310390
190220	DIBROMOMETHANE	N		UG/L					M	M	M	1.0	0.41	1.4	98310390
190220	DICHLORODIFLUOROMETHANE	N		UG/L	200	1000		Table 1	M	M	M	1.0	0.68	2.3	98310390
190220	DICHLOROMETHANE	N		UG/L	0.5	5		Table 1	M	M	M	1.0	0.44	1.5	98310390
190220	DISSOLVED OXYGEN, FIELD BY PROBE		8.8	MG/L											
190220	ETHYLBENZENE	N		UG/L	140	700		Table 1	M	M	M	1.0	0.74	2.5	98310390
190220	FLUOROTRICHLOROMETHANE	N		UG/L	698	3490		Table 1	M	M	M	1.0	0.88	2.9	98310390
190220	GROUNDWATER ELEVATION		860.85	FT MSL											
190220	IRON-DISSOLVED AS FE		0.090	MG/L	0.15	0.3		Table 2	M	M	M	0.030	0.019	0.064	98310390
190220	LEAD-DISSOLVED AS PB	N		UG/L	1.5	15		Table 1	M	M	M	1.5	0.17	0.57	98310390
190220	MANGANESE-DISSOLVED AS MN		3.4	UG/L	60	300		Table 1	M	M	M	10.0	0.40	1.3	98310390
190220	MANGANESE-DISSOLVED AS MN		3.4	UG/L	25	50		Table 2	M	M	M	10.0	0.40	1.3	98310390
190220	M-DICHLOROBENZENE	N		UG/L	120	600		Table 1	M	M	M	1.0	0.78	2.6	98310390
190220	MERCURY-DISSOLVED	N		UG/L	0.2	2		Table 1	M	M	M	0.20	0.12	0.40	98310390
190220	METHYL ETHYL KETONE (MEK)	N		UG/L	800	4000		Table 1	M	M	M	10	1.3	4.4	98310390
190220	METHYL TERT-BUTYL ETHER (MTBE)	N		UG/L	12	60		Table 1	M	M	M	1.0	0.16	0.53	98310390
190220	NAPHTHALENE	N		UG/L	10	100		Table 1	M	M	M	1.0	0.43	1.4	98310390
190220	NITRITE PLUS NITRATE-DISSOLVED AS N		5.5	MG/L	2	10	P	Table 1	M	M	M	0.25	0.10	0.33	98310390
190220	O-DICHLOROBENZENE	N		UG/L	60	600		Table 1	M	M	M	1.0	0.79	2.6	98310390
190220	OXIDATION REDUCTION POTENTIAL		120.0	MILLIVOLTS											
190220	P-DICHLOROBENZENE	N		UG/L	15	75		Table 1	M	M	M	1.0	0.84	2.8	98310390
190220	PH-FIELD		7.88	SU											
190220	SAMPLE COLOR	N		NONE											
190220	SAMPLE ODOR	N		NONE											

Sample Date	Parameter	Qualifier	Value	Units	PAL	ES	Type of Exceedance	Type of Standard	QC 1	QC 2	QC 3	RL	LOD	LOQ	WDNR Lab Cert
Sample Point: OBS2C		WDNR Point ID: 022													
190220	SAMPLE TEMPERATURE		10.0	DEGREES C											
190220	SAMPLE TURBIDITY	N		NONE											
190220	SPECIFIC CONDUCTANCE-FIELD		730	UMHOS/CM											
190220	STYRENE	N		UG/L	10	100		Table 1	M	M	M	1.0	0.73	2.4	98310390
190220	SULFATE-DISSOLVED AS SO4		21.3	MG/L	125	250		Table 2	M	M	M	4.0	0.70	2.3	98310390
190220	TETRACHLOROETHYLENE	N		UG/L	0.5	5		Table 1	M	M	M	1.0	0.36	1.2	98310390
190220	TETRAHYDROFURAN	N		UG/L	10	50		Table 1	M	M	M	5.0	1.3	4.2	98310390
190220	TOLUENE	N		UG/L	160	800		Table 1	M	M	M	1.0	0.51	1.7	98310390
190220	TRANS-1,2-DICHLOROETHENE (TOTAL)	N		UG/L	20	100		Table 1	M	M	M	1.0	0.90	3.0	98310390
190220	TRANS-1,3-DICHLOROPROPENE	N		UG/L	0.04	0.4		Table 1	M	M	M	1.0	0.37	1.2	98310390
190220	TRIBROMOMETHANE	N		UG/L	0.44	4.4		Table 1	M	M	M	1.0	0.26	0.87	98310390
190220	TRICHLOROETHYLENE	N		UG/L	0.5	5		Table 1	M	M	M	1.0	0.46	1.5	98310390
190220	VINYL CHLORIDE	N		UG/L	0.02	0.2		Table 1	M	M	M	0.020	0.004	0.013	98310390
190220	VINYL CHLORIDE	N		UG/L	0.02	0.2		Table 1	M	M	M	1.0	0.90	3.0	98310390
190220	XYLENES-TOTAL	N		UG/L	400	2000		Table 1	M	M	M	2.0	0.66	2.2	98310390
Sample Point: MW7		WDNR Point ID: 025													
190221	1,1,1-TRICHLOROETHANE	N		UG/L	40	200		Table 1	M	M	M	1.0	0.82	2.7	98310390
190221	1,1,2,2-TETRACHLOROETHANE	N		UG/L	0.02	0.2		Table 1	M	M	M	1.0	0.21	0.70	98310390
190221	1,1,2-TRICHLOROETHANE	N		UG/L	0.5	5		Table 1	M	M	M	1.0	0.23	0.77	98310390
190221	1,1-DICHLOROETHANE	N		UG/L	85	850		Table 1	M	M	M	1.0	0.38	1.3	98310390
190221	1,1-DICHLOROETHYLENE	N		UG/L	0.7	7		Table 1	M	M	M	1.0	0.29	0.97	98310390
190221	1,2,4-TRICHLOROBENZENE	N		UG/L	14	70		Table 1	M	M	M	1.0	0.41	1.4	98310390
190221	1,2-DIBROMO-3-CHLOROPROPANE	N		UG/L	0.02	0.2		Table 1	M	M	M	1.0	0.39	1.3	98310390
190221	1,2-DIBROMOETHANE (EDB)	N		UG/L	0.005	0.05		Table 1	M	M	M	1.0	0.73	2.4	98310390
190221	1,2-DICHLOROETHANE	N		UG/L	0.5	5		Table 1	M	M	M	1.0	0.21	0.70	98310390
190221	1,2-DICHLOROPROPANE	N		UG/L	0.5	5		Table 1	M	M	M	1.0	0.72	2.4	98310390
190221	2-HEXANONE	N		UG/L					M	M	M	5.0	1.2	4.1	98310390
190221	4-METHYL-2-PENTANONE (MIBK)	N		UG/L	50	500		Table 1	M	M	M	5.0	2.1	7.0	98310390
190221	ACETONE	N		UG/L	1800	9000		Table 1	M	M	M	10	3.0	10	98310390
190221	ALKALINITY-TOTAL AS CaCO3 (FILTR)		129	MG/L					M	M	M	20.0	8.0	26.7	98310390
190221	ARSENIC-DISSOLVED AS AS	J	0.41	UG/L	1	10		Table 1	M	M	M	1.0	0.27	0.90	98310390
190221	BARIUM-DISSOLVED AS BA		24.2	UG/L	400	2000		Table 1	M	M	M	5.0	0.70	2.3	98310390

Sample Date	Parameter	Qualifier	Value	Units	PAL	ES	Type of Exceedance	Type of Standard	QC 1	QC 2	QC 3	RL	LOD	LOQ	WDNR Lab Cert
	Sample Point: MW7		WDNR Point ID: 025												
190221	BENZENE	N		UG/L	0.5	5		Table 1	M	M	M	1.0	0.41	1.4	98310390
190221	BROMODICHLOROMETHANE	N		UG/L	0.06	0.6		Table 1	M	M	M	1.0	0.39	1.3	98310390
190221	BROMOMETHANE	N		UG/L	1	10		Table 1	M	M	M	1.0	0.69	2.3	98310390
190221	CARBON DISULFIDE	N		UG/L	200	1000		Table 1	M	M	M	1.0	0.19	0.63	98310390
190221	CARBON TETRACHLORIDE	N		UG/L	0.5	5		Table 1	M	M	M	1.0	0.27	0.90	98310390
190221	CHLOROBENZENE	N		UG/L	20	100		Table 1	M	M	M	1.0	0.75	2.5	98310390
190221	CHLOROETHANE	N		UG/L	80	400		Table 1	M	M	M	1.0	0.32	1.1	98310390
190221	CHLOROFORM	N		UG/L	0.6	6		Table 1	M	M	M	1.0	0.34	1.1	98310390
190221	CHLOROMETHANE	N		UG/L	3	30		Table 1	M	M	M	1.0	0.35	1.2	98310390
190221	CIS-1,2-DICHLOROETHENE	N		UG/L	7	70		Table 1	M	M	M	1.0	0.81	2.7	98310390
190221	CIS-1,3-DICHLOROPROPENE	N		UG/L	0.04	0.4		Table 1	M	M	M	1.0	0.36	1.2	98310390
190221	DIBROMOCHLOROMETHANE	N		UG/L	6	60		Table 1	M	M	M	1.0	0.32	1.1	98310390
190221	DIBROMOMETHANE	N		UG/L					M	M	M	1.0	0.41	1.4	98310390
190221	DICHLORODIFLUOROMETHANE	N		UG/L	200	1000		Table 1	M	M	M	1.0	0.68	2.3	98310390
190221	DICHLOROMETHANE	N		UG/L	0.5	5		Table 1	M	M	M	1.0	0.44	1.5	98310390
190221	DISSOLVED OXYGEN, FIELD BY PROBE		5.9	MG/L											
190221	ETHYLBENZENE	N		UG/L	140	700		Table 1	M	M	M	1.0	0.74	2.5	98310390
190221	FLUOROTRICHLOROMETHANE	N		UG/L	698	3490		Table 1	M	M	M	1.0	0.88	2.9	98310390
190221	GROUNDWATER ELEVATION		862.51	FT MSL											
190221	IRON-DISSOLVED AS FE	J	0.037	MG/L	0.15	0.3		Table 2	M	M	M	0.030	0.019	0.064	98310390
190221	LEAD-DISSOLVED AS PB	J	0.46	UG/L	1.5	15		Table 1	M	M	M	1.5	0.17	0.57	98310390
190221	MANGANESE-DISSOLVED AS MN		2.4	UG/L	60	300		Table 1	M	M	M	10.0	0.40	1.3	98310390
190221	MANGANESE-DISSOLVED AS MN		2.4	UG/L	25	50		Table 2	M	M	M	10.0	0.40	1.3	98310390
190221	M-DICHLOROBENZENE	N		UG/L	120	600		Table 1	M	M	M	1.0	0.78	2.6	98310390
190221	MERCURY-DISSOLVED	N		UG/L	0.2	2		Table 1	M	M	M	0.20	0.12	0.40	98310390
190221	METHYL ETHYL KETONE (MEK)	N		UG/L	800	4000		Table 1	M	M	M	10	1.3	4.4	98310390
190221	METHYL TERT-BUTYL ETHER (MTBE)	N		UG/L	12	60		Table 1	M	M	M	1.0	0.16	0.53	98310390
190221	NAPHTHALENE	N		UG/L	10	100		Table 1	M	M	M	1.0	0.43	1.4	98310390
190221	NITRITE PLUS NITRATE-DISSOLVED AS N		0.28	MG/L	2	10		Table 1	M	M	M	0.050	0.020	0.067	98310390
190221	O-DICHLOROBENZENE	N		UG/L	60	600		Table 1	M	M	M	1.0	0.79	2.6	98310390
190221	OXIDATION REDUCTION POTENTIAL		24.0	MILLIVOLTS											
190221	P-DICHLOROBENZENE	N		UG/L	15	75		Table 1	M	M	M	1.0	0.84	2.8	98310390

Sample Date	Parameter	Qualifier	Value	Units	PAL	ES	Type of Exceedance	Type of Standard	QC 1	QC 2	QC 3	RL	LOD	LOQ	WDNR Lab Cert
Sample Point: MW7		WDNR Point ID: 025													
190221	PH-FIELD		8.06	SU											
190221	SAMPLE COLOR	N		NONE											
190221	SAMPLE ODOR	N		NONE											
190221	SAMPLE TEMPERATURE		13.1	DEGREES C											
190221	SAMPLE TURBIDITY	N		NONE											
190221	SPECIFIC CONDUCTANCE-FIELD		460	UMHOS/CM											
190221	STYRENE	N		UG/L	10	100		Table 1	M	M	M	1.0	0.73	2.4	98310390
190221	SULFATE-DISSOLVED AS SO4		5.2	MG/L	125	250		Table 2	M	M	M	2.0	0.35	1.2	98310390
190221	TETRACHLOROETHYLENE	N		UG/L	0.5	5		Table 1	M	M	M	1.0	0.36	1.2	98310390
190221	TETRAHYDROFURAN	N		UG/L	10	50		Table 1	M	M	M	5.0	1.3	4.2	98310390
190221	TOLUENE	N		UG/L	160	800		Table 1	M	M	M	1.0	0.51	1.7	98310390
190221	TRANS-1,2-DICHLOROETHENE (TOTAL)	N		UG/L	20	100		Table 1	M	M	M	1.0	0.90	3.0	98310390
190221	TRANS-1,3-DICHLOROPROPENE	N		UG/L	0.04	0.4		Table 1	M	M	M	1.0	0.37	1.2	98310390
190221	TRIBROMOMETHANE	N		UG/L	0.44	4.4		Table 1	M	M	M	1.0	0.26	0.87	98310390
190221	TRICHLOROETHYLENE	N		UG/L	0.5	5		Table 1	M	M	M	1.0	0.46	1.5	98310390
190221	VINYL CHLORIDE	N		UG/L	0.02	0.2		Table 1	M	M	M	0.020	0.004	0.013	98310390
190221	VINYL CHLORIDE	N		UG/L	0.02	0.2		Table 1	M	M	M	1.0	0.90	3.0	98310390
190221	XYLENES-TOTAL	N		UG/L	400	2000		Table 1	M	M	M	2.0	0.66	2.2	98310390
Sample Point: OB8M		WDNR Point ID: 035													
190220	1,1,1-TRICHLOROETHANE	N		UG/L	40	200		Table 1	M	M	M	1.0	0.82	2.7	98310390
190220	1,1,2,2-TETRACHLOROETHANE	N		UG/L	0.02	0.2		Table 1	M	M	M	1.0	0.21	0.70	98310390
190220	1,1,2-TRICHLOROETHANE	N		UG/L	0.5	5		Table 1	M	M	M	1.0	0.23	0.77	98310390
190220	1,1-DICHLOROETHANE	N		UG/L	85	850		Table 1	M	M	M	1.0	0.38	1.3	98310390
190220	1,1-DICHLOROETHYLENE	N		UG/L	0.7	7		Table 1	M	M	M	1.0	0.29	0.97	98310390
190220	1,2,4-TRICHLOROBENZENE	N		UG/L	14	70		Table 1	M	M	M	1.0	0.41	1.4	98310390
190220	1,2-DIBROMO-3-CHLOROPROPANE	N		UG/L	0.02	0.2		Table 1	M	M	M	1.0	0.39	1.3	98310390
190220	1,2-DIBROMOETHANE (EDB)	N		UG/L	0.005	0.05		Table 1	M	M	M	1.0	0.73	2.4	98310390
190220	1,2-DICHLOROETHANE	N		UG/L	0.5	5		Table 1	M	M	M	1.0	0.21	0.70	98310390
190220	1,2-DICHLOROPROPANE	N		UG/L	0.5	5		Table 1	M	M	M	1.0	0.72	2.4	98310390
190220	2-HEXANONE	N		UG/L					M	M	M	5.0	1.2	4.1	98310390
190220	4-METHYL-2-PENTANONE (MIBK)	N		UG/L	50	500		Table 1	M	M	M	5.0	2.1	7.0	98310390
190220	ACETONE	N		UG/L	1800	9000		Table 1	M	M	M	10	3.0	10	98310390

Sample Date	Parameter	Qualifier	Value	Units	PAL	ES	Type of Exceedance	Type of Standard	QC 1	QC 2	QC 3	RL	LOD	LOQ	WDNR Lab Cert
Sample Point: OB8M		WDNR Point ID: 035													
190220	ALKALINITY-TOTAL AS CaCO3 (FILT)		391	MG/L					M	M	M	50.0	20.0	66.7	98310390
190220	ARSENIC-DISSOLVED AS AS	J	0.84	UG/L	1	10		Table 1	M	M	M	1.0	0.27	0.90	98310390
190220	BARIUM-DISSOLVED AS BA		98.2	UG/L	400	2000		Table 1	M	M	M	5.0	0.70	2.3	98310390
190220	BENZENE	N		UG/L	0.5	5		Table 1	M	M	M	1.0	0.41	1.4	98310390
190220	BROMODICHLOROMETHANE	N		UG/L	0.06	0.6		Table 1	M	M	M	1.0	0.39	1.3	98310390
190220	BROMOMETHANE	N		UG/L	1	10		Table 1	M	M	M	1.0	0.69	2.3	98310390
190220	CARBON DISULFIDE	N		UG/L	200	1000		Table 1	M	M	M	1.0	0.19	0.63	98310390
190220	CARBON TETRACHLORIDE	N		UG/L	0.5	5		Table 1	M	M	M	1.0	0.27	0.90	98310390
190220	CHLOROBENZENE	N		UG/L	20	100		Table 1	M	M	M	1.0	0.75	2.5	98310390
190220	CHLOROETHANE	N		UG/L	80	400		Table 1	M	M	M	1.0	0.32	1.1	98310390
190220	CHLOROFORM	N		UG/L	0.6	6		Table 1	M	M	M	1.0	0.34	1.1	98310390
190220	CHLOROMETHANE	N		UG/L	3	30		Table 1	M	M	M	1.0	0.35	1.2	98310390
190220	CIS-1,2-DICHLOROETHENE	N		UG/L	7	70		Table 1	M	M	M	1.0	0.81	2.7	98310390
190220	CIS-1,3-DICHLOROPROPENE	N		UG/L	0.04	0.4		Table 1	M	M	M	1.0	0.36	1.2	98310390
190220	DIBROMOCHLOROMETHANE	N		UG/L	6	60		Table 1	M	M	M	1.0	0.32	1.1	98310390
190220	DIBROMOMETHANE	N		UG/L					M	M	M	1.0	0.41	1.4	98310390
190220	DICHLORODIFLUOROMETHANE	N		UG/L	200	1000		Table 1	M	M	M	1.0	0.68	2.3	98310390
190220	DICHLOROMETHANE	N		UG/L	0.5	5		Table 1	M	M	M	1.0	0.44	1.5	98310390
190220	DISSOLVED OXYGEN, FIELD BY PROBE		3.8	MG/L											
190220	ETHYLBENZENE	N		UG/L	140	700		Table 1	M	M	M	1.0	0.74	2.5	98310390
190220	FLUOROTRICHLOROMETHANE	N		UG/L	698	3490		Table 1	M	M	M	1.0	0.88	2.9	98310390
190220	GROUNDWATER ELEVATION		855.71	FT MSL											
190220	IRON-DISSOLVED AS FE		0.18	MG/L	0.15	0.3	P	Table 2	M	M	M	0.030	0.019	0.064	98310390
190220	LEAD-DISSOLVED AS PB	N		UG/L	1.5	15		Table 1	M	M	M	1.5	0.17	0.57	98310390
190220	MANGANESE-DISSOLVED AS MN		139	UG/L	60	300	P	Table 1	M	M	M	10.0	0.40	1.3	98310390
190220	MANGANESE-DISSOLVED AS MN		139	UG/L	25	50	E	Table 2	M	M	M	10.0	0.40	1.3	98310390
190220	M-DICHLOROBENZENE	N		UG/L	120	600		Table 1	M	M	M	1.0	0.78	2.6	98310390
190220	MERCURY-DISSOLVED	N		UG/L	0.2	2		Table 1	M	M	M	0.20	0.12	0.40	98310390
190220	METHYL ETHYL KETONE (MEK)	N		UG/L	800	4000		Table 1	M	M	M	10	1.3	4.4	98310390
190220	METHYL TERT-BUTYL ETHER (MTBE)	N		UG/L	12	60		Table 1	M	M	M	1.0	0.16	0.53	98310390
190220	NAPHTHALENE	N		UG/L	10	100		Table 1	M	M	M	1.0	0.43	1.4	98310390
190220	NITRITE PLUS NITRATE-DISSOLVED AS N		0.49	MG/L	2	10		Table 1	M	M	M	0.050	0.020	0.067	98310390

Sample Date	Parameter	Qualifier	Value	Units	PAL	ES	Type of Exceedance	Type of Standard	QC 1	QC 2	QC 3	RL	LOD	LOQ	WDNR Lab Cert
Sample Point: OB8M		WDNR Point ID: 035													
190220	O-DICHLOROENZENE	N		UG/L	60	600		Table 1	M	M	M	1.0	0.79	2.6	98310390
190220	OXIDATION REDUCTION POTENTIAL		44.0	MILLIVOLTS											
190220	P-DICHLOROENZENE	N		UG/L	15	75		Table 1	M	M	M	1.0	0.84	2.8	98310390
190220	PH-FIELD		7.83	SU											
190220	SAMPLE COLOR	N		NONE											
190220	SAMPLE ODOR	N		NONE											
190220	SAMPLE TEMPERATURE		11.0	DEGREES C											
190220	SAMPLE TURBIDITY	N		NONE											
190220	SPECIFIC CONDUCTANCE-FIELD		885	UMHOS/CM											
190220	STYRENE	N		UG/L	10	100		Table 1	M	M	M	1.0	0.73	2.4	98310390
190220	SULFATE-DISSOLVED AS SO4		32.9	MG/L	125	250		Table 2	M	M	M	4.0	0.70	2.3	98310390
190220	TETRACHLOROETHYLENE	N		UG/L	0.5	5		Table 1	M	M	M	1.0	0.36	1.2	98310390
190220	TETRAHYDROFURAN	N		UG/L	10	50		Table 1	M	M	M	5.0	1.3	4.2	98310390
190220	TOLUENE	N		UG/L	160	800		Table 1	M	M	M	1.0	0.51	1.7	98310390
190220	TRANS-1,2-DICHLOROETHENE (TOTAL)	N		UG/L	20	100		Table 1	M	M	M	1.0	0.90	3.0	98310390
190220	TRANS-1,3-DICHLOROPROPENE	N		UG/L	0.04	0.4		Table 1	M	M	M	1.0	0.37	1.2	98310390
190220	TRIBROMOMETHANE	N		UG/L	0.44	4.4		Table 1	M	M	M	1.0	0.26	0.87	98310390
190220	TRICHLOROETHYLENE	N		UG/L	0.5	5		Table 1	M	M	M	1.0	0.46	1.5	98310390
190220	VINYL CHLORIDE	N		UG/L	0.02	0.2		Table 1	M	M	M	1.0	0.90	3.0	98310390
190220	VINYL CHLORIDE		0.49	UG/L	0.02	0.2	E	Table 1	M	M	M	0.020	0.004	0.013	98310390
190220	XYLENES-TOTAL	N		UG/L	400	2000		Table 1	M	M	M	2.0	0.66	2.2	98310390
Sample Point: OB11M		WDNR Point ID: 040													
190220	1,1,1-TRICHLOROETHANE	N		UG/L	40	200		Table 1	M	M	M	1.0	0.82	2.7	98310390
190220	1,1,2,2-TETRACHLOROETHANE	N		UG/L	0.02	0.2		Table 1	M	M	M	1.0	0.21	0.70	98310390
190220	1,1,2-TRICHLOROETHANE	N		UG/L	0.5	5		Table 1	M	M	M	1.0	0.23	0.77	98310390
190220	1,1-DICHLOROETHANE	N		UG/L	85	850		Table 1	M	M	M	1.0	0.38	1.3	98310390
190220	1,1-DICHLOROETHYLENE	N		UG/L	0.7	7		Table 1	M	M	M	1.0	0.29	0.97	98310390
190220	1,2,4-TRICHLOROBENZENE	N		UG/L	14	70		Table 1	M	M	M	1.0	0.41	1.4	98310390
190220	1,2-DIBROMO-3-CHLOROPROPANE	N		UG/L	0.02	0.2		Table 1	M	M	M	1.0	0.39	1.3	98310390
190220	1,2-DIBROMOETHANE (EDB)	N		UG/L	0.005	0.05		Table 1	M	M	M	1.0	0.73	2.4	98310390
190220	1,2-DICHLOROETHANE	N		UG/L	0.5	5		Table 1	M	M	M	1.0	0.21	0.70	98310390
190220	1,2-DICHLOROPROPANE	N		UG/L	0.5	5		Table 1	M	M	M	1.0	0.72	2.4	98310390

Sample Date	Parameter	Qualifier	Value	Units	PAL	ES	Type of Exceedance	Type of Standard	QC 1	QC 2	QC 3	RL	LOD	LOQ	WDNR Lab Cert
Sample Point: OB11M		WDNR Point ID: 040													
190220	2-HEXANONE	N		UG/L					M	M	M	5.0	1.2	4.1	98310390
190220	4-METHYL-2-PENTANONE (MIBK)	N		UG/L	50	500		Table 1	M	M	M	5.0	2.1	7.0	98310390
190220	ACETONE	N		UG/L	1800	9000		Table 1	M	M	M	10	3.0	10	98310390
190220	ALKALINITY-TOTAL AS CaCO3 (FILT)		169	MG/L					M	M	M	50.0	20.0	66.7	98310390
190220	ARSENIC-DISSOLVED AS AS	J	0.37	UG/L	1	10		Table 1	M	M	M	1.0	0.27	0.90	98310390
190220	BARIUM-DISSOLVED AS BA		75.1	UG/L	400	2000		Table 1	M	M	M	5.0	0.70	2.3	98310390
190220	BENZENE	N		UG/L	0.5	5		Table 1	M	M	M	1.0	0.41	1.4	98310390
190220	BROMODICHLOROMETHANE	N		UG/L	0.06	0.6		Table 1	M	M	M	1.0	0.39	1.3	98310390
190220	BROMOMETHANE	N		UG/L	1	10		Table 1	M	M	M	1.0	0.69	2.3	98310390
190220	CARBON DISULFIDE	N		UG/L	200	1000		Table 1	M	M	M	1.0	0.19	0.63	98310390
190220	CARBON TETRACHLORIDE	N		UG/L	0.5	5		Table 1	M	M	M	1.0	0.27	0.90	98310390
190220	CHLOROBENZENE	N		UG/L	20	100		Table 1	M	M	M	1.0	0.75	2.5	98310390
190220	CHLOROETHANE	N		UG/L	80	400		Table 1	M	M	M	1.0	0.32	1.1	98310390
190220	CHLOROFORM	N		UG/L	0.6	6		Table 1	M	M	M	1.0	0.34	1.1	98310390
190220	CHLOROMETHANE	N		UG/L	3	30		Table 1	M	M	M	1.0	0.35	1.2	98310390
190220	CIS-1,2-DICHLOROETHENE	N		UG/L	7	70		Table 1	M	M	M	1.0	0.81	2.7	98310390
190220	CIS-1,3-DICHLOROPROPENE	N		UG/L	0.04	0.4		Table 1	M	M	M	1.0	0.36	1.2	98310390
190220	DIBROMOCHLOROMETHANE	N		UG/L	6	60		Table 1	M	M	M	1.0	0.32	1.1	98310390
190220	DIBROMOMETHANE	N		UG/L					M	M	M	1.0	0.41	1.4	98310390
190220	DICHLORODIFLUOROMETHANE	N		UG/L	200	1000		Table 1	M	M	M	1.0	0.68	2.3	98310390
190220	DICHLOROMETHANE	N		UG/L	0.5	5		Table 1	M	M	M	1.0	0.44	1.5	98310390
190220	DISSOLVED OXYGEN, FIELD BY PROBE		2.0	MG/L											
190220	ETHYLBENZENE	N		UG/L	140	700		Table 1	M	M	M	1.0	0.74	2.5	98310390
190220	FLUOROTRICHLOROMETHANE	N		UG/L	698	3490		Table 1	M	M	M	1.0	0.88	2.9	98310390
190220	IRON-DISSOLVED AS FE	N		MG/L	0.15	0.3		Table 2	M	M	M	0.030	0.019	0.064	98310390
190220	LEAD-DISSOLVED AS PB	N		UG/L	1.5	15		Table 1	M	M	M	1.5	0.17	0.57	98310390
190220	MANGANESE-DISSOLVED AS MN		94.6	UG/L	60	300	P	Table 1	M	M	M	10.0	0.40	1.3	98310390
190220	MANGANESE-DISSOLVED AS MN		94.6	UG/L	25	50	E	Table 2	M	M	M	10.0	0.40	1.3	98310390
190220	M-DICHLOROBENZENE	N		UG/L	120	600		Table 1	M	M	M	1.0	0.78	2.6	98310390
190220	MERCURY-DISSOLVED	N		UG/L	0.2	2		Table 1	M	M	M	0.20	0.12	0.40	98310390
190220	METHYL ETHYL KETONE (MEK)	N		UG/L	800	4000		Table 1	M	M	M	10	1.3	4.4	98310390
190220	METHYL TERT-BUTYL ETHER (MTBE)	N		UG/L	12	60		Table 1	M	M	M	1.0	0.16	0.53	98310390

Hagen Farm Landfill
WMI Site Number: 393

License Number: 02981
Facility ID Number:

Sample Date	Parameter	Qualifier	Value	Units	PAL	ES	Type of Exceedance	Type of Standard	QC 1	QC 2	QC 3	RL	LOD	LOQ	WDNR Lab Cert
Sample Point: OB11M		WDNR Point ID: 040													
190220	NAPHTHALENE	N		UG/L	10	100		Table 1	M	M	M	1.0	0.43	1.4	98310390
190220	NITRITE PLUS NITRATE-DISSOLVED AS N		0.089	MG/L	2	10		Table 1	M	M	M	0.050	0.020	0.067	98310390
190220	O-DICHLOROENZENE	N		UG/L	60	600		Table 1	M	M	M	1.0	0.79	2.6	98310390
190220	OXIDATION REDUCTION POTENTIAL		109.0	MILLIVOLTS											
190220	P-DICHLOROENZENE	N		UG/L	15	75		Table 1	M	M	M	1.0	0.84	2.8	98310390
190220	PH-FIELD		7.65	SU											
190220	SAMPLE COLOR	N		NONE											
190220	SAMPLE ODOR	N		NONE											
190220	SAMPLE TEMPERATURE		9.9	DEGREES C											
190220	SAMPLE TURBIDITY	N		NONE											
190220	SPECIFIC CONDUCTANCE-FIELD		968	UMHOS/CM											
190220	STYRENE	N		UG/L	10	100		Table 1	M	M	M	1.0	0.73	2.4	98310390
190220	SULFATE-DISSOLVED AS SO4		41.0	MG/L	125	250		Table 2	M	M	M	4.0	0.70	2.3	98310390
190220	TETRACHLOROETHYLENE	N		UG/L	0.5	5		Table 1	M	M	M	1.0	0.36	1.2	98310390
190220	TETRAHYDROFURAN	N		UG/L	10	50		Table 1	M	M	M	5.0	1.3	4.2	98310390
190220	TOLUENE	N		UG/L	160	800		Table 1	M	M	M	1.0	0.51	1.7	98310390
190220	TRANS-1,2-DICHLOROETHENE (TOTAL)	N		UG/L	20	100		Table 1	M	M	M	1.0	0.90	3.0	98310390
190220	TRANS-1,3-DICHLOROPROPENE	N		UG/L	0.04	0.4		Table 1	M	M	M	1.0	0.37	1.2	98310390
190220	TRIBROMOMETHANE	N		UG/L	0.44	4.4		Table 1	M	M	M	1.0	0.26	0.87	98310390
190220	TRICHLOROETHYLENE	N		UG/L	0.5	5		Table 1	M	M	M	1.0	0.46	1.5	98310390
190220	VINYL CHLORIDE	N		UG/L	0.02	0.2		Table 1	M	M	M	0.020	0.004	0.013	98310390
190220	VINYL CHLORIDE	N		UG/L	0.02	0.2		Table 1	M	M	M	1.0	0.90	3.0	98310390
190220	XYLENES-TOTAL	N		UG/L	400	2000		Table 1	M	M	M	2.0	0.66	2.2	98310390
Sample Point: P17B		WDNR Point ID: 045													
190221	1,1,1-TRICHLOROETHANE	N		UG/L	40	200		Table 1	M	M	M	1.0	0.82	2.7	98310390
190221	1,1,2,2-TETRACHLOROETHANE	N		UG/L	0.02	0.2		Table 1	M	M	M	1.0	0.21	0.70	98310390
190221	1,1,2-TRICHLOROETHANE	N		UG/L	0.5	5		Table 1	M	M	M	1.0	0.23	0.77	98310390
190221	1,1-DICHLOROETHANE	N		UG/L	85	850		Table 1	M	M	M	1.0	0.38	1.3	98310390
190221	1,1-DICHLOROETHYLENE	N		UG/L	0.7	7		Table 1	M	M	M	1.0	0.29	0.97	98310390
190221	1,2,4-TRICHLOROBENZENE	N		UG/L	14	70		Table 1	M	M	M	1.0	0.41	1.4	98310390
190221	1,2-DIBROMO-3-CHLOROPROPANE	N		UG/L	0.02	0.2		Table 1	M	M	M	1.0	0.39	1.3	98310390
190221	1,2-DIBROMOETHANE (EDB)	N		UG/L	0.005	0.05		Table 1	M	M	M	1.0	0.73	2.4	98310390

Sample Date	Parameter	Qualifier	Value	Units	PAL	ES	Type of Exceedance	Type of Standard	QC 1	QC 2	QC 3	RL	LOD	LOQ	WDNR Lab Cert
	Sample Point: P17B		WDNR Point ID: 045												
190221	1,2-DICHLOROETHANE	N		UG/L	0.5	5		Table 1	M	M	M	1.0	0.21	0.70	98310390
190221	1,2-DICHLOROPROPANE	N		UG/L	0.5	5		Table 1	M	M	M	1.0	0.72	2.4	98310390
190221	2-HEXANONE	N		UG/L					M	M	M	5.0	1.2	4.1	98310390
190221	4-METHYL-2-PENTANONE (MIBK)	N		UG/L	50	500		Table 1	M	M	M	5.0	2.1	7.0	98310390
190221	ACETONE	N		UG/L	1800	9000		Table 1	M	M	M	10	3.0	10	98310390
190221	ALKALINITY-TOTAL AS CaCO3 (FILT)		371	MG/L					M	M	M	40.0	16.0	53.3	98310390
190221	ARSENIC-DISSOLVED AS AS	J	0.59	UG/L	1	10		Table 1	M	M	M	1.0	0.27	0.90	98310390
190221	BARIUM-DISSOLVED AS BA		47.3	UG/L	400	2000		Table 1	M	M	M	5.0	0.70	2.3	98310390
190221	BENZENE	N		UG/L	0.5	5		Table 1	M	M	M	1.0	0.41	1.4	98310390
190221	BROMODICHLOROMETHANE	N		UG/L	0.06	0.6		Table 1	M	M	M	1.0	0.39	1.3	98310390
190221	BROMOMETHANE	N		UG/L	1	10		Table 1	M	M	M	1.0	0.69	2.3	98310390
190221	CARBON DISULFIDE	N		UG/L	200	1000		Table 1	M	M	M	1.0	0.19	0.63	98310390
190221	CARBON TETRACHLORIDE	N		UG/L	0.5	5		Table 1	M	M	M	1.0	0.27	0.90	98310390
190221	CHLOROBENZENE	N		UG/L	20	100		Table 1	M	M	M	1.0	0.75	2.5	98310390
190221	CHLOROETHANE	N		UG/L	80	400		Table 1	M	M	M	1.0	0.32	1.1	98310390
190221	CHLOROFORM	N		UG/L	0.6	6		Table 1	M	M	M	1.0	0.34	1.1	98310390
190221	CHLOROMETHANE	N		UG/L	3	30		Table 1	M	M	M	1.0	0.35	1.2	98310390
190221	CIS-1,2-DICHLOROETHENE	N		UG/L	7	70		Table 1	M	M	M	1.0	0.81	2.7	98310390
190221	CIS-1,3-DICHLOROPROPENE	N		UG/L	0.04	0.4		Table 1	M	M	M	1.0	0.36	1.2	98310390
190221	DIBROMOCHLOROMETHANE	N		UG/L	6	60		Table 1	M	M	M	1.0	0.32	1.1	98310390
190221	DIBROMOMETHANE	N		UG/L					M	M	M	1.0	0.41	1.4	98310390
190221	DICHLORODIFLUOROMETHANE	N		UG/L	200	1000		Table 1	M	M	M	1.0	0.68	2.3	98310390
190221	DICHLOROMETHANE	N		UG/L	0.5	5		Table 1	M	M	M	1.0	0.44	1.5	98310390
190221	DISSOLVED OXYGEN, FIELD BY PROBE		3.9	MG/L											
190221	ETHYLBENZENE	N		UG/L	140	700		Table 1	M	M	M	1.0	0.74	2.5	98310390
190221	FLUOROTRICHLOROMETHANE	N		UG/L	698	3490		Table 1	M	M	M	1.0	0.88	2.9	98310390
190221	GROUNDWATER ELEVATION		860.46	FT MSL											
190221	IRON-DISSOLVED AS FE	N		MG/L	0.15	0.3		Table 2	M	M	M	0.030	0.019	0.064	98310390
190221	LEAD-DISSOLVED AS PB	N		UG/L	1.5	15		Table 1	M	M	M	1.5	0.17	0.57	98310390
190221	MANGANESE-DISSOLVED AS MN		11.7	UG/L	60	300		Table 1	M	M	M	10.0	0.40	1.3	98310390
190221	MANGANESE-DISSOLVED AS MN		11.7	UG/L	25	50		Table 2	M	M	M	10.0	0.40	1.3	98310390
190221	M-DICHLOROBENZENE	N		UG/L	120	600		Table 1	M	M	M	1.0	0.78	2.6	98310390

Sample Date	Parameter	Qualifier	Value	Units	PAL	ES	Type of Exceedance	Type of Standard	QC 1	QC 2	QC 3	RL	LOD	LOQ	WDNR Lab Cert
Sample Point: P17B		WDNR Point ID: 045													
190221	MERCURY-DISSOLVED	N		UG/L	0.2	2		Table 1	M	M	M	0.20	0.12	0.40	98310390
190221	METHYL ETHYL KETONE (MEK)	N		UG/L	800	4000		Table 1	M	M	M	10	1.3	4.4	98310390
190221	METHYL TERT-BUTYL ETHER (MTBE)	N		UG/L	12	60		Table 1	M	M	M	1.0	0.16	0.53	98310390
190221	NAPHTHALENE	N		UG/L	10	100		Table 1	M	M	M	1.0	0.43	1.4	98310390
190221	NITRITE PLUS NITRATE-DISSOLVED AS N		0.67	MG/L	2	10		Table 1	M	M	M	0.050	0.020	0.067	98310390
190221	O-DICHLOROENZENE	N		UG/L	60	600		Table 1	M	M	M	1.0	0.79	2.6	98310390
190221	OXIDATION REDUCTION POTENTIAL		14.0	MILLIVOLTS											
190221	P-DICHLOROENZENE	N		UG/L	15	75		Table 1	M	M	M	1.0	0.84	2.8	98310390
190221	PH-FIELD		7.43	SU											
190221	SAMPLE COLOR	N		NONE											
190221	SAMPLE ODOR	N		NONE											
190221	SAMPLE TEMPERATURE		13.6	DEGREES C											
190221	SAMPLE TURBIDITY	N		NONE											
190221	SPECIFIC CONDUCTANCE-FIELD		685	UMHOS/CM											
190221	STYRENE	N		UG/L	10	100		Table 1	M	M	M	1.0	0.73	2.4	98310390
190221	SULFATE-DISSOLVED AS SO4		14.9	MG/L	125	250		Table 2	M	M	M	2.0	0.35	1.2	98310390
190221	TETRACHLOROETHYLENE	N		UG/L	0.5	5		Table 1	M	M	M	1.0	0.36	1.2	98310390
190221	TETRAHYDROFURAN	N		UG/L	10	50		Table 1	M	M	M	5.0	1.3	4.2	98310390
190221	TOLUENE	N		UG/L	160	800		Table 1	M	M	M	1.0	0.51	1.7	98310390
190221	TRANS-1,2-DICHLOROETHENE (TOTAL)	N		UG/L	20	100		Table 1	M	M	M	1.0	0.90	3.0	98310390
190221	TRANS-1,3-DICHLOROPROPENE	N		UG/L	0.04	0.4		Table 1	M	M	M	1.0	0.37	1.2	98310390
190221	TRIBROMOMETHANE	N		UG/L	0.44	4.4		Table 1	M	M	M	1.0	0.26	0.87	98310390
190221	TRICHLOROETHYLENE	N		UG/L	0.5	5		Table 1	M	M	M	1.0	0.46	1.5	98310390
190221	VINYL CHLORIDE	N		UG/L	0.02	0.2		Table 1	M	M	M	0.020	0.004	0.013	98310390
190221	VINYL CHLORIDE	N		UG/L	0.02	0.2		Table 1	M	M	M	1.0	0.90	3.0	98310390
190221	XYLENES-TOTAL	N		UG/L	400	2000		Table 1	M	M	M	2.0	0.66	2.2	98310390
Sample Point: P17C		WDNR Point ID: 050													
190221	1,1,1-TRICHLOROETHANE	N		UG/L	40	200		Table 1	M	M	M	1.0	0.82	2.7	98310390
190221	1,1,2,2-TETRACHLOROETHANE	N		UG/L	0.02	0.2		Table 1	M	M	M	1.0	0.21	0.70	98310390
190221	1,1,2-TRICHLOROETHANE	N		UG/L	0.5	5		Table 1	M	M	M	1.0	0.23	0.77	98310390
190221	1,1-DICHLOROETHANE	N		UG/L	85	850		Table 1	M	M	M	1.0	0.38	1.3	98310390
190221	1,1-DICHLOROETHYLENE	N		UG/L	0.7	7		Table 1	M	M	M	1.0	0.29	0.97	98310390

Sample Date	Parameter	Qualifier	Value	Units	PAL	ES	Type of Exceedance	Type of Standard	QC 1	QC 2	QC 3	RL	LOD	LOQ	WDNR Lab Cert
	Sample Point: P17C	WDNR Point ID:	050												
190221	1,2,4-TRICHLOROBENZENE	N		UG/L	14	70		Table 1	M	M	M	1.0	0.41	1.4	98310390
190221	1,2-DIBROMO-3-CHLOROPROPANE	N		UG/L	0.02	0.2		Table 1	M	M	M	1.0	0.39	1.3	98310390
190221	1,2-DIBROMOETHANE (EDB)	N		UG/L	0.005	0.05		Table 1	M	M	M	1.0	0.73	2.4	98310390
190221	1,2-DICHLOROETHANE	N		UG/L	0.5	5		Table 1	M	M	M	1.0	0.21	0.70	98310390
190221	1,2-DICHLOROPROPANE	N		UG/L	0.5	5		Table 1	M	M	M	1.0	0.72	2.4	98310390
190221	2-HEXANONE	N		UG/L					M	M	M	5.0	1.2	4.1	98310390
190221	4-METHYL-2-PENTANONE (MIBK)	N		UG/L	50	500		Table 1	M	M	M	5.0	2.1	7.0	98310390
190221	ACETONE	N		UG/L	1800	9000		Table 1	M	M	M	10	3.0	10	98310390
190221	ALKALINITY-TOTAL AS CaCO3 (FILT)		412	MG/L					M	M	M	50.0	20.0	66.7	98310390
190221	ARSENIC-DISSOLVED AS AS		3.6	UG/L	1	10	P	Table 1	M	M	M	1.0	0.27	0.90	98310390
190221	BARIUM-DISSOLVED AS BA		23.3	UG/L	400	2000		Table 1	M	M	M	5.0	0.70	2.3	98310390
190221	BENZENE	N		UG/L	0.5	5		Table 1	M	M	M	1.0	0.41	1.4	98310390
190221	BROMODICHLOROMETHANE	N		UG/L	0.06	0.6		Table 1	M	M	M	1.0	0.39	1.3	98310390
190221	BROMOMETHANE	N		UG/L	1	10		Table 1	M	M	M	1.0	0.69	2.3	98310390
190221	CARBON DISULFIDE	N		UG/L	200	1000		Table 1	M	M	M	1.0	0.19	0.63	98310390
190221	CARBON TETRACHLORIDE	N		UG/L	0.5	5		Table 1	M	M	M	1.0	0.27	0.90	98310390
190221	CHLOROBENZENE	N		UG/L	20	100		Table 1	M	M	M	1.0	0.75	2.5	98310390
190221	CHLOROETHANE	N		UG/L	80	400		Table 1	M	M	M	1.0	0.32	1.1	98310390
190221	CHLOROFORM	N		UG/L	0.6	6		Table 1	M	M	M	1.0	0.34	1.1	98310390
190221	CHLOROMETHANE	N		UG/L	3	30		Table 1	M	M	M	1.0	0.35	1.2	98310390
190221	CIS-1,2-DICHLOROETHENE	N		UG/L	7	70		Table 1	M	M	M	1.0	0.81	2.7	98310390
190221	CIS-1,3-DICHLOROPROPENE	N		UG/L	0.04	0.4		Table 1	M	M	M	1.0	0.36	1.2	98310390
190221	DIBROMOCHLOROMETHANE	N		UG/L	6	60		Table 1	M	M	M	1.0	0.32	1.1	98310390
190221	DIBROMOMETHANE	N		UG/L					M	M	M	1.0	0.41	1.4	98310390
190221	DICHLORODIFLUOROMETHANE	N		UG/L	200	1000		Table 1	M	M	M	1.0	0.68	2.3	98310390
190221	DICHLOROMETHANE	N		UG/L	0.5	5		Table 1	M	M	M	1.0	0.44	1.5	98310390
190221	DISSOLVED OXYGEN, FIELD BY PROBE		1.3	MG/L											
190221	ETHYLBENZENE	N		UG/L	140	700		Table 1	M	M	M	1.0	0.74	2.5	98310390
190221	FLUOROTRICHLOROMETHANE	N		UG/L	698	3490		Table 1	M	M	M	1.0	0.88	2.9	98310390
190221	IRON-DISSOLVED AS FE		2.2	MG/L	0.15	0.3	P*	Table 2	M	M	M	0.030	0.019	0.064	98310390
190221	LEAD-DISSOLVED AS PB	N		UG/L	1.5	15		Table 1	M	M	M	1.5	0.17	0.57	98310390
190221	MANGANESE-DISSOLVED AS MN		244	UG/L	60	300	P	Table 1	M	M	M	10.0	0.40	1.3	98310390

Hagen Farm Landfill
WMI Site Number: 393

License Number: 02981
Facility ID Number:

Sample Date	Parameter	Qualifier	Value	Units	PAL	ES	Type of Exceedance	Type of Standard	QC 1	QC 2	QC 3	RL	LOD	LOQ	WDNR Lab Cert
Sample Point: P17C		WDNR Point ID: 050													
190221	MANGANESE-DISSOLVED AS MN		244	UG/L	25	50	P*	Table 2	M	M	M	10.0	0.40	1.3	98310390
190221	M-DICHLOROBENZENE	N		UG/L	120	600		Table 1	M	M	M	1.0	0.78	2.6	98310390
190221	MERCURY-DISSOLVED	N		UG/L	0.2	2		Table 1	M	M	M	0.20	0.12	0.40	98310390
190221	METHYL ETHYL KETONE (MEK)	N		UG/L	800	4000		Table 1	M	M	M	10	1.3	4.4	98310390
190221	METHYL TERT-BUTYL ETHER (MTBE)	N		UG/L	12	60		Table 1	M	M	M	1.0	0.16	0.53	98310390
190221	NAPHTHALENE	N		UG/L	10	100		Table 1	M	M	M	1.0	0.43	1.4	98310390
190221	NITRITE PLUS NITRATE-DISSOLVED AS N		0.20	MG/L	2	10		Table 1	M	M	M	0.050	0.020	0.067	98310390
190221	O-DICHLOROBENZENE	N		UG/L	60	600		Table 1	M	M	M	1.0	0.79	2.6	98310390
190221	OXIDATION REDUCTION POTENTIAL		-35.0	MILLIVOLTS											
190221	P-DICHLOROBENZENE	N		UG/L	15	75		Table 1	M	M	M	1.0	0.84	2.8	98310390
190221	PH-FIELD		7.49	SU											
190221	SAMPLE COLOR	N		NONE											
190221	SAMPLE ODOR		0	NONE											
190221	SAMPLE TEMPERATURE		10.2	DEGREES C											
190221	SAMPLE TURBIDITY	N		NONE											
190221	SPECIFIC CONDUCTANCE-FIELD		780	UMHOS/CM											
190221	STYRENE	N		UG/L	10	100		Table 1	M	M	M	1.0	0.73	2.4	98310390
190221	SULFATE-DISSOLVED AS SO4		12.5	MG/L	125	250		Table 2	M	M	M	2.0	0.35	1.2	98310390
190221	TETRACHLOROETHYLENE	N		UG/L	0.5	5		Table 1	M	M	M	1.0	0.36	1.2	98310390
190221	TETRAHYDROFURAN	N		UG/L	10	50		Table 1	M	M	M	5.0	1.3	4.2	98310390
190221	TOLUENE	N		UG/L	160	800		Table 1	M	M	M	1.0	0.51	1.7	98310390
190221	TRANS-1,2-DICHLOROETHENE (TOTAL)	N		UG/L	20	100		Table 1	M	M	M	1.0	0.90	3.0	98310390
190221	TRANS-1,3-DICHLOROPROPENE	N		UG/L	0.04	0.4		Table 1	M	M	M	1.0	0.37	1.2	98310390
190221	TRIBROMOMETHANE	N		UG/L	0.44	4.4		Table 1	M	M	M	1.0	0.26	0.87	98310390
190221	TRICHLOROETHYLENE	N		UG/L	0.5	5		Table 1	M	M	M	1.0	0.46	1.5	98310390
190221	VINYL CHLORIDE		0.21	UG/L	0.02	0.2	P*	Table 1	M	M	M	0.020	0.004	0.013	98310390
190221	VINYL CHLORIDE	N		UG/L	0.02	0.2		Table 1	M	M	M	1.0	0.90	3.0	98310390
190221	XYLENES-TOTAL	N		UG/L	400	2000		Table 1	M	M	M	2.0	0.66	2.2	98310390
Sample Point: P17DR		WDNR Point ID: 055													
190220	1,1,1-TRICHLOROETHANE	N		UG/L	40	200		Table 1	M	M	M	1.0	0.82	2.7	98310390
190220	1,1,2,2-TETRACHLOROETHANE	N		UG/L	0.02	0.2		Table 1	M	M	M	1.0	0.21	0.70	98310390
190220	1,1,2-TRICHLOROETHANE	N		UG/L	0.5	5		Table 1	M	M	M	1.0	0.23	0.77	98310390

Sample Date	Parameter	Qualifier	Value	Units	PAL	ES	Type of Exceedance	Type of Standard	QC 1	QC 2	QC 3	RL	LOD	LOQ	WDNR Lab Cert
	Sample Point: P17DR	WDNR Point ID:	055												
190220	1,1-DICHLOROETHANE	N		UG/L	85	850		Table 1	M	M	M	1.0	0.38	1.3	98310390
190220	1,1-DICHLOROETHYLENE	N		UG/L	0.7	7		Table 1	M	M	M	1.0	0.29	0.97	98310390
190220	1,2,4-TRICHLOROBENZENE	N		UG/L	14	70		Table 1	M	M	M	1.0	0.41	1.4	98310390
190220	1,2-DIBROMO-3-CHLOROPROPANE	N		UG/L	0.02	0.2		Table 1	M	M	M	1.0	0.39	1.3	98310390
190220	1,2-DIBROMOETHANE (EDB)	N		UG/L	0.005	0.05		Table 1	M	M	M	1.0	0.73	2.4	98310390
190220	1,2-DICHLOROETHANE	N		UG/L	0.5	5		Table 1	M	M	M	1.0	0.21	0.70	98310390
190220	1,2-DICHLOROPROPANE	N		UG/L	0.5	5		Table 1	M	M	M	1.0	0.72	2.4	98310390
190220	2-HEXANONE	N		UG/L					M	M	M	5.0	1.2	4.1	98310390
190220	4-METHYL-2-PENTANONE (MIBK)	N		UG/L	50	500		Table 1	M	M	M	5.0	2.1	7.0	98310390
190220	ACETONE	N		UG/L	1800	9000		Table 1	M	M	M	10	3.0	10	98310390
190220	ALKALINITY-TOTAL AS CaCO3 (FILT)		38.5	MG/L					M	M	M	10.0	4.0	13.3	98310390
190220	ARSENIC-DISSOLVED AS AS	J	0.44	UG/L	1	10		Table 1	M	M	M	1.0	0.27	0.90	98310390
190220	BARIUM-DISSOLVED AS BA		23.3	UG/L	400	2000		Table 1	M	M	M	5.0	0.70	2.3	98310390
190220	BENZENE	N		UG/L	0.5	5		Table 1	M	M	M	1.0	0.41	1.4	98310390
190220	BROMODICHLOROMETHANE	N		UG/L	0.06	0.6		Table 1	M	M	M	1.0	0.39	1.3	98310390
190220	BROMOMETHANE	N		UG/L	1	10		Table 1	M	M	M	1.0	0.69	2.3	98310390
190220	CARBON DISULFIDE	N		UG/L	200	1000		Table 1	M	M	M	1.0	0.19	0.63	98310390
190220	CARBON TETRACHLORIDE	N		UG/L	0.5	5		Table 1	M	M	M	1.0	0.27	0.90	98310390
190220	CHLOROBENZENE	N		UG/L	20	100		Table 1	M	M	M	1.0	0.75	2.5	98310390
190220	CHLOROETHANE	N		UG/L	80	400		Table 1	M	M	M	1.0	0.32	1.1	98310390
190220	CHLOROFORM	N		UG/L	0.6	6		Table 1	M	M	M	1.0	0.34	1.1	98310390
190220	CHLOROMETHANE	N		UG/L	3	30		Table 1	M	M	M	1.0	0.35	1.2	98310390
190220	CIS-1,2-DICHLOROETHENE	N		UG/L	7	70		Table 1	M	M	M	1.0	0.81	2.7	98310390
190220	CIS-1,3-DICHLOROPROPENE	N		UG/L	0.04	0.4		Table 1	M	M	M	1.0	0.36	1.2	98310390
190220	DIBROMOCHLOROMETHANE	N		UG/L	6	60		Table 1	M	M	M	1.0	0.32	1.1	98310390
190220	DIBROMOMETHANE	N		UG/L					M	M	M	1.0	0.41	1.4	98310390
190220	DICHLORODIFLUOROMETHANE	N		UG/L	200	1000		Table 1	M	M	M	1.0	0.68	2.3	98310390
190220	DICHLOROMETHANE	N		UG/L	0.5	5		Table 1	M	M	M	1.0	0.44	1.5	98310390
190220	DISSOLVED OXYGEN, FIELD BY PROBE		10.7	MG/L											
190220	ETHYLBENZENE	N		UG/L	140	700		Table 1	M	M	M	1.0	0.74	2.5	98310390
190220	FLUOROTRICHLOROMETHANE	N		UG/L	698	3490		Table 1	M	M	M	1.0	0.88	2.9	98310390
190220	GROUNDWATER ELEVATION		860.75	FT MSL											

Hagen Farm Landfill
WMI Site Number: 393

License Number: 02981
Facility ID Number:

Sample Date	Parameter	Qualifier	Value	Units	PAL	ES	Type of Exceedance	Type of Standard	QC 1	QC 2	QC 3	RL	LOD	LOQ	WDNR Lab Cert
Sample Point: P17DR		WDNR Point ID: 055													
190220	IRON-DISSOLVED AS FE	J	0.056	MG/L	0.15	0.3		Table 2	M	M	M	0.030	0.019	0.064	98310390
190220	LEAD-DISSOLVED AS PB	N		UG/L	1.5	15		Table 1	M	M	M	1.5	0.17	0.57	98310390
190220	MANGANESE-DISSOLVED AS MN		1.5	UG/L	60	300		Table 1	M	M	M	10.0	0.40	1.3	98310390
190220	MANGANESE-DISSOLVED AS MN		1.5	UG/L	25	50		Table 2	M	M	M	10.0	0.40	1.3	98310390
190220	M-DICHLOROBENZENE	N		UG/L	120	600		Table 1	M	M	M	1.0	0.78	2.6	98310390
190220	MERCURY-DISSOLVED	N		UG/L	0.2	2		Table 1	M	M	M	0.20	0.12	0.40	98310390
190220	METHYL ETHYL KETONE (MEK)	N		UG/L	800	4000		Table 1	M	M	M	10	1.3	4.4	98310390
190220	METHYL TERT-BUTYL ETHER (MTBE)	N		UG/L	12	60		Table 1	M	M	M	1.0	0.16	0.53	98310390
190220	NAPHTHALENE	N		UG/L	10	100		Table 1	M	M	M	1.0	0.43	1.4	98310390
190220	NITRITE PLUS NITRATE-DISSOLVED AS N		3.6	MG/L	2	10	P	Table 1	M	M	M	0.10	0.040	0.13	98310390
190220	O-DICHLOROBENZENE	N		UG/L	60	600		Table 1	M	M	M	1.0	0.79	2.6	98310390
190220	OXIDATION REDUCTION POTENTIAL		104.0	MILLIVOLTS											
190220	P-DICHLOROBENZENE	N		UG/L	15	75		Table 1	M	M	M	1.0	0.84	2.8	98310390
190220	PH-FIELD		8.27	SU											
190220	SAMPLE COLOR	N		NONE											
190220	SAMPLE ODOR	N		NONE											
190220	SAMPLE TEMPERATURE		9.6	DEGREES C											
190220	SAMPLE TURBIDITY	N		NONE											
190220	SPECIFIC CONDUCTANCE-FIELD		576	UMHOS/CM											
190220	STYRENE	N		UG/L	10	100		Table 1	M	M	M	1.0	0.73	2.4	98310390
190220	SULFATE-DISSOLVED AS SO4		13.0	MG/L	125	250		Table 2	M	M	M	2.0	0.35	1.2	98310390
190220	TETRACHLOROETHYLENE	N		UG/L	0.5	5		Table 1	M	M	M	1.0	0.36	1.2	98310390
190220	TETRAHYDROFURAN	N		UG/L	10	50		Table 1	M	M	F	5.0	1.3	4.2	98310390
190220	TOLUENE	N		UG/L	160	800		Table 1	M	M	M	1.0	0.51	1.7	98310390
190220	TRANS-1,2-DICHLOROETHENE (TOTAL)	N		UG/L	20	100		Table 1	M	M	M	1.0	0.90	3.0	98310390
190220	TRANS-1,3-DICHLOROPROPENE	N		UG/L	0.04	0.4		Table 1	M	M	M	1.0	0.37	1.2	98310390
190220	TRIBROMOMETHANE	N		UG/L	0.44	4.4		Table 1	M	M	M	1.0	0.26	0.87	98310390
190220	TRICHLOROETHYLENE	N		UG/L	0.5	5		Table 1	M	M	M	1.0	0.46	1.5	98310390
190220	VINYL CHLORIDE	N		UG/L	0.02	0.2		Table 1	M	M	M	1.0	0.90	3.0	98310390
190220	VINYL CHLORIDE	N		UG/L	0.02	0.2		Table 1	M	M	M	0.020	0.004	0.013	98310390
190220	XYLENES-TOTAL	N		UG/L	400	2000		Table 1	M	M	M	2.0	0.66	2.2	98310390

Sample Date	Parameter	Qualifier	Value	Units	PAL	ES	Type of Exceedance	Type of Standard	QC 1	QC 2	QC 3	RL	LOD	LOQ	WDNR Lab Cert
	Sample Point: MW22	WDNR Point ID:	060												
190221	1,1,1-TRICHLOROETHANE	N		UG/L	40	200		Table 1	M	M	M	1.0	0.82	2.7	98310390
190221	1,1,2,2-TETRACHLOROETHANE	N		UG/L	0.02	0.2		Table 1	M	M	M	1.0	0.21	0.70	98310390
190221	1,1,2-TRICHLOROETHANE	N		UG/L	0.5	5		Table 1	M	M	M	1.0	0.23	0.77	98310390
190221	1,1-DICHLOROETHANE	N		UG/L	85	850		Table 1	M	M	M	1.0	0.38	1.3	98310390
190221	1,1-DICHLOROETHYLENE	N		UG/L	0.7	7		Table 1	M	M	M	1.0	0.29	0.97	98310390
190221	1,2,4-TRICHLOROBENZENE	N		UG/L	14	70		Table 1	M	M	M	1.0	0.41	1.4	98310390
190221	1,2-DIBROMO-3-CHLOROPROPANE	N		UG/L	0.02	0.2		Table 1	M	M	M	1.0	0.39	1.3	98310390
190221	1,2-DIBROMOETHANE (EDB)	N		UG/L	0.005	0.05		Table 1	M	M	M	1.0	0.73	2.4	98310390
190221	1,2-DICHLOROETHANE	N		UG/L	0.5	5		Table 1	M	M	M	1.0	0.21	0.70	98310390
190221	1,2-DICHLOROPROPANE	N		UG/L	0.5	5		Table 1	M	M	M	1.0	0.72	2.4	98310390
190221	2-HEXANONE	N		UG/L					M	M	M	5.0	1.2	4.1	98310390
190221	4-METHYL-2-PENTANONE (MIBK)	N		UG/L	50	500		Table 1	M	M	M	5.0	2.1	7.0	98310390
190221	ACETONE	N		UG/L	1800	9000		Table 1	M	M	M	10	3.0	10	98310390
190221	ALKALINITY-TOTAL AS CaCO3 (FILT)		408	MG/L					M	M	M	50.0	20.0	66.7	98310390
190221	ARSENIC-DISSOLVED AS AS	J	0.47	UG/L	1	10		Table 1	M	M	M	1.0	0.27	0.90	98310390
190221	BARIUM-DISSOLVED AS BA		86.6	UG/L	400	2000		Table 1	M	M	M	5.0	0.70	2.3	98310390
190221	BENZENE	N		UG/L	0.5	5		Table 1	M	M	M	1.0	0.41	1.4	98310390
190221	BROMODICHLOROMETHANE	N		UG/L	0.06	0.6		Table 1	M	M	M	1.0	0.39	1.3	98310390
190221	BROMOMETHANE	N		UG/L	1	10		Table 1	M	M	M	1.0	0.69	2.3	98310390
190221	CARBON DISULFIDE	N		UG/L	200	1000		Table 1	M	M	M	1.0	0.19	0.63	98310390
190221	CARBON TETRACHLORIDE	N		UG/L	0.5	5		Table 1	M	M	M	1.0	0.27	0.90	98310390
190221	CHLOROBENZENE	N		UG/L	20	100		Table 1	M	M	M	1.0	0.75	2.5	98310390
190221	CHLOROETHANE	N		UG/L	80	400		Table 1	M	M	M	1.0	0.32	1.1	98310390
190221	CHLOROFORM	N		UG/L	0.6	6		Table 1	M	M	M	1.0	0.34	1.1	98310390
190221	CHLOROMETHANE	N		UG/L	3	30		Table 1	M	M	M	1.0	0.35	1.2	98310390
190221	CIS-1,2-DICHLOROETHENE	N		UG/L	7	70		Table 1	M	M	M	1.0	0.81	2.7	98310390
190221	CIS-1,3-DICHLOROPROPENE	N		UG/L	0.04	0.4		Table 1	M	M	M	1.0	0.36	1.2	98310390
190221	DIBROMOCHLOROMETHANE	N		UG/L	6	60		Table 1	M	M	M	1.0	0.32	1.1	98310390
190221	DIBROMOMETHANE	N		UG/L					M	M	M	1.0	0.41	1.4	98310390
190221	DICHLORODIFLUOROMETHANE	N		UG/L	200	1000		Table 1	M	M	M	1.0	0.68	2.3	98310390
190221	DICHLOROMETHANE	N		UG/L	0.5	5		Table 1	M	M	M	1.0	0.44	1.5	98310390
190221	DISSOLVED OXYGEN, FIELD BY PROBE		4.0	MG/L											

Sample Date	Parameter	Qualifier	Value	Units	PAL	ES	Type of Exceedance	Type of Standard	QC 1	QC 2	QC 3	RL	LOD	LOQ	WDNR Lab Cert
Sample Point: MW22		WDNR Point ID: 060													
190221	ETHYLBENZENE	N		UG/L	140	700		Table 1	M	M	M	1.0	0.74	2.5	98310390
190221	FLUOROTRICHLOROMETHANE	N		UG/L	698	3490		Table 1	M	M	M	1.0	0.88	2.9	98310390
190221	GROUNDWATER ELEVATION		861.45	FT MSL											
190221	IRON-DISSOLVED AS FE	N		MG/L	0.15	0.3		Table 2	M	M	M	0.030	0.019	0.064	98310390
190221	LEAD-DISSOLVED AS PB	N		UG/L	1.5	15		Table 1	M	M	M	1.5	0.17	0.57	98310390
190221	MANGANESE-DISSOLVED AS MN		2.5	UG/L	60	300		Table 1	M	M	M	10.0	0.40	1.3	98310390
190221	MANGANESE-DISSOLVED AS MN		2.5	UG/L	25	50		Table 2	M	M	M	10.0	0.40	1.3	98310390
190221	M-DICHLOROBENZENE	N		UG/L	120	600		Table 1	M	M	M	1.0	0.78	2.6	98310390
190221	MERCURY-DISSOLVED	N		UG/L	0.2	2		Table 1	M	M	M	0.20	0.12	0.40	98310390
190221	METHYL ETHYL KETONE (MEK)	N		UG/L	800	4000		Table 1	M	M	M	10	1.3	4.4	98310390
190221	METHYL TERT-BUTYL ETHER (MTBE)	N		UG/L	12	60		Table 1	M	M	M	1.0	0.16	0.53	98310390
190221	NAPHTHALENE	N		UG/L	10	100		Table 1	M	M	M	1.0	0.43	1.4	98310390
190221	NITRITE PLUS NITRATE-DISSOLVED AS N		5.4	MG/L	2	10	P	Table 1	M	M	M	0.25	0.10	0.33	98310390
190221	O-DICHLOROBENZENE	N		UG/L	60	600		Table 1	M	M	M	1.0	0.79	2.6	98310390
190221	OXIDATION REDUCTION POTENTIAL		136.0	MILLIVOLTS											
190221	P-DICHLOROBENZENE	N		UG/L	15	75		Table 1	M	M	M	1.0	0.84	2.8	98310390
190221	PH-FIELD		7.41	SU											
190221	SAMPLE COLOR	N		NONE											
190221	SAMPLE ODOR	N		NONE											
190221	SAMPLE TEMPERATURE		14.7	DEGREES C											
190221	SAMPLE TURBIDITY	N		NONE											
190221	SPECIFIC CONDUCTANCE-FIELD		776	UMHOS/CM											
190221	STYRENE	N		UG/L	10	100		Table 1	M	M	M	1.0	0.73	2.4	98310390
190221	SULFATE-DISSOLVED AS SO4		36.3	MG/L	125	250		Table 2	M	M	M	2.0	0.35	1.2	98310390
190221	TETRACHLOROETHYLENE	N		UG/L	0.5	5		Table 1	M	M	M	1.0	0.36	1.2	98310390
190221	TETRAHYDROFURAN	N		UG/L	10	50		Table 1	M	M	F	5.0	1.3	4.2	98310390
190221	TOLUENE	N		UG/L	160	800		Table 1	M	M	M	1.0	0.51	1.7	98310390
190221	TRANS-1,2-DICHLOROETHENE (TOTAL)	N		UG/L	20	100		Table 1	M	M	M	1.0	0.90	3.0	98310390
190221	TRANS-1,3-DICHLOROPROPENE	N		UG/L	0.04	0.4		Table 1	M	M	M	1.0	0.37	1.2	98310390
190221	TRIBROMOMETHANE	N		UG/L	0.44	4.4		Table 1	M	M	M	1.0	0.26	0.87	98310390
190221	TRICHLOROETHYLENE	N		UG/L	0.5	5		Table 1	M	M	M	1.0	0.46	1.5	98310390
190221	VINYL CHLORIDE	N		UG/L	0.02	0.2		Table 1	M	M	M	1.0	0.90	3.0	98310390

Sample Date	Parameter	Qualifier	Value	Units	PAL	ES	Type of Exceedance	Type of Standard	QC 1	QC 2	QC 3	RL	LOD	LOQ	WDNR Lab Cert
Sample Point: MW22		WDNR Point ID: 060													
190221	VINYL CHLORIDE	N		UG/L	0.02	0.2		Table 1	M	M	M	0.020	0.004	0.013	98310390
190221	XYLENES-TOTAL	N		UG/L	400	2000		Table 1	M	M	M	2.0	0.66	2.2	98310390
Sample Point: P22B		WDNR Point ID: 065													
190221	1,1,1-TRICHLOROETHANE	N		UG/L	40	200		Table 1	M	M	M	1.0	0.82	2.7	98310390
190221	1,1,2,2-TETRACHLOROETHANE	N		UG/L	0.02	0.2		Table 1	M	M	M	1.0	0.21	0.70	98310390
190221	1,1,2-TRICHLOROETHANE	N		UG/L	0.5	5		Table 1	M	M	M	1.0	0.23	0.77	98310390
190221	1,1-DICHLOROETHANE	N		UG/L	85	850		Table 1	M	M	M	1.0	0.38	1.3	98310390
190221	1,1-DICHLOROETHYLENE	N		UG/L	0.7	7		Table 1	M	M	M	1.0	0.29	0.97	98310390
190221	1,2,4-TRICHLOROBENZENE	N		UG/L	14	70		Table 1	M	M	M	1.0	0.41	1.4	98310390
190221	1,2-DIBROMO-3-CHLOROPROPANE	N		UG/L	0.02	0.2		Table 1	M	M	M	1.0	0.39	1.3	98310390
190221	1,2-DIBROMOETHANE (EDB)	N		UG/L	0.005	0.05		Table 1	M	M	M	1.0	0.73	2.4	98310390
190221	1,2-DICHLOROETHANE	N		UG/L	0.5	5		Table 1	M	M	M	1.0	0.21	0.70	98310390
190221	1,2-DICHLOROPROPANE	N		UG/L	0.5	5		Table 1	M	M	M	1.0	0.72	2.4	98310390
190221	2-HEXANONE	N		UG/L					M	M	M	5.0	1.2	4.1	98310390
190221	4-METHYL-2-PENTANONE (MIBK)	N		UG/L	50	500		Table 1	M	M	M	5.0	2.1	7.0	98310390
190221	ACETONE	N		UG/L	1800	9000		Table 1	M	M	M	10	3.0	10	98310390
190221	ALKALINITY-TOTAL AS CaCO3 (FILT)		367	MG/L					M	M	M	40.0	16.0	53.3	98310390
190221	ARSENIC-DISSOLVED AS AS		21.4	UG/L	1	10	P*	Table 1	M	M	M	1.0	0.27	0.90	98310390
190221	BARIUM-DISSOLVED AS BA		39.1	UG/L	400	2000		Table 1	M	M	M	5.0	0.70	2.3	98310390
190221	BENZENE	N		UG/L	0.5	5		Table 1	M	M	M	1.0	0.41	1.4	98310390
190221	BROMODICHLOROMETHANE	N		UG/L	0.06	0.6		Table 1	M	M	M	1.0	0.39	1.3	98310390
190221	BROMOMETHANE	N		UG/L	1	10		Table 1	M	M	M	1.0	0.69	2.3	98310390
190221	CARBON DISULFIDE	N		UG/L	200	1000		Table 1	M	M	M	1.0	0.19	0.63	98310390
190221	CARBON TETRACHLORIDE	N		UG/L	0.5	5		Table 1	M	M	M	1.0	0.27	0.90	98310390
190221	CHLOROBENZENE	N		UG/L	20	100		Table 1	M	M	M	1.0	0.75	2.5	98310390
190221	CHLOROETHANE	N		UG/L	80	400		Table 1	M	M	M	1.0	0.32	1.1	98310390
190221	CHLOROFORM	N		UG/L	0.6	6		Table 1	M	M	M	1.0	0.34	1.1	98310390
190221	CHLOROMETHANE	N		UG/L	3	30		Table 1	M	M	M	1.0	0.35	1.2	98310390
190221	CIS-1,2-DICHLOROETHENE	N		UG/L	7	70		Table 1	M	M	M	1.0	0.81	2.7	98310390
190221	CIS-1,3-DICHLOROPROPENE	N		UG/L	0.04	0.4		Table 1	M	M	M	1.0	0.36	1.2	98310390
190221	DIBROMOCHLOROMETHANE	N		UG/L	6	60		Table 1	M	M	M	1.0	0.32	1.1	98310390
190221	DIBROMOMETHANE	N		UG/L					M	M	M	1.0	0.41	1.4	98310390

Sample Date	Parameter	Qualifier	Value	Units	PAL	ES	Type of Exceedance	Type of Standard	QC 1	QC 2	QC 3	RL	LOD	LOQ	WDNR Lab Cert
Sample Point: P22B		WDNR Point ID: 065													
190221	DICHLORODIFLUOROMETHANE	N		UG/L	200	1000		Table 1	M	M	M	1.0	0.68	2.3	98310390
190221	DICHLOROMETHANE	N		UG/L	0.5	5		Table 1	M	M	M	1.0	0.44	1.5	98310390
190221	DISSOLVED OXYGEN, FIELD BY PROBE		1.6	MG/L											
190221	ETHYLBENZENE	N		UG/L	140	700		Table 1	M	M	M	1.0	0.74	2.5	98310390
190221	FLUOROTRICHLOROMETHANE	N		UG/L	698	3490		Table 1	M	M	M	1.0	0.88	2.9	98310390
190221	GROUNDWATER ELEVATION		862.21	FT MSL											
190221	IRON-DISSOLVED AS FE		3.1	MG/L	0.15	0.3	P*	Table 2	M	M	M	0.030	0.019	0.064	98310390
190221	LEAD-DISSOLVED AS PB	N		UG/L	1.5	15		Table 1	M	M	M	1.5	0.17	0.57	98310390
190221	MANGANESE-DISSOLVED AS MN		119	UG/L	60	300	P	Table 1	M	M	M	10.0	0.40	1.3	98310390
190221	MANGANESE-DISSOLVED AS MN		119	UG/L	25	50	P*	Table 2	M	M	M	10.0	0.40	1.3	98310390
190221	M-DICHLOROBENZENE	N		UG/L	120	600		Table 1	M	M	M	1.0	0.78	2.6	98310390
190221	MERCURY-DISSOLVED	N		UG/L	0.2	2		Table 1	M	M	M	0.20	0.12	0.40	98310390
190221	METHYL ETHYL KETONE (MEK)	N		UG/L	800	4000		Table 1	M	M	M	10	1.3	4.4	98310390
190221	METHYL TERT-BUTYL ETHER (MTBE)	N		UG/L	12	60		Table 1	M	M	M	1.0	0.16	0.53	98310390
190221	NAPHTHALENE	N		UG/L	10	100		Table 1	M	M	M	1.0	0.43	1.4	98310390
190221	NITRITE PLUS NITRATE-DISSOLVED AS N	J	0.054	MG/L	2	10		Table 1	M	M	M	0.050	0.020	0.067	98310390
190221	O-DICHLOROBENZENE	N		UG/L	60	600		Table 1	M	M	M	1.0	0.79	2.6	98310390
190221	OXIDATION REDUCTION POTENTIAL		-33	MILLIVOLTS											
190221	P-DICHLOROBENZENE	N		UG/L	15	75		Table 1	M	M	M	1.0	0.84	2.8	98310390
190221	PH-FIELD		7.33	SU											
190221	SAMPLE COLOR	N		NONE											
190221	SAMPLE ODOR		0	NONE											
190221	SAMPLE TEMPERATURE		15.5	DEGREES C											
190221	SAMPLE TURBIDITY	N		NONE											
190221	SPECIFIC CONDUCTANCE-FIELD		731	UMHOS/CM											
190221	STYRENE	N		UG/L	10	100		Table 1	M	M	M	1.0	0.73	2.4	98310390
190221	SULFATE-DISSOLVED AS SO4		26.4	MG/L	125	250		Table 2	M	M	M	4.0	0.70	2.3	98310390
190221	TETRACHLOROETHYLENE	N		UG/L	0.5	5		Table 1	M	M	M	1.0	0.36	1.2	98310390
190221	TETRAHYDROFURAN	N		UG/L	10	50		Table 1	M	M	F	5.0	1.3	4.2	98310390
190221	TOLUENE	N		UG/L	160	800		Table 1	M	M	M	1.0	0.51	1.7	98310390
190221	TRANS-1,2-DICHLOROETHENE (TOTAL)	N		UG/L	20	100		Table 1	M	M	M	1.0	0.90	3.0	98310390
190221	TRANS-1,3-DICHLOROPROPENE	N		UG/L	0.04	0.4		Table 1	M	M	M	1.0	0.37	1.2	98310390

Sample Date	Parameter	Qualifier	Value	Units	PAL	ES	Type of Exceedance	Type of Standard	QC 1	QC 2	QC 3	RL	LOD	LOQ	WDNR Lab Cert
Sample Point: P22B		WDNR Point ID: 065													
190221	TRIBROMOMETHANE	N		UG/L	0.44	4.4		Table 1	M	M	M	1.0	0.26	0.87	98310390
190221	TRICHLOROETHYLENE	N		UG/L	0.5	5		Table 1	M	M	M	1.0	0.46	1.5	98310390
190221	VINYL CHLORIDE	N		UG/L	0.02	0.2		Table 1	M	M	M	0.020	0.004	0.013	98310390
190221	VINYL CHLORIDE	N		UG/L	0.02	0.2		Table 1	M	M	M	1.0	0.90	3.0	98310390
190221	XYLENES-TOTAL	N		UG/L	400	2000		Table 1	M	M	M	2.0	0.66	2.2	98310390
Sample Point: MW23		WDNR Point ID: 075													
190221	GROUNDWATER ELEVATION		866.40	FT MSL											
Sample Point: MW26		WDNR Point ID: 080													
190221	1,1,1-TRICHLOROETHANE	N		UG/L	40	200		Table 1	M	M	M	1.0	0.82	2.7	98310390
190221	1,1,2,2-TETRACHLOROETHANE	N		UG/L	0.02	0.2		Table 1	M	M	M	1.0	0.21	0.70	98310390
190221	1,1,2-TRICHLOROETHANE	N		UG/L	0.5	5		Table 1	M	M	M	1.0	0.23	0.77	98310390
190221	1,1-DICHLOROETHANE	N		UG/L	85	850		Table 1	M	M	M	1.0	0.38	1.3	98310390
190221	1,1-DICHLOROETHYLENE	N		UG/L	0.7	7		Table 1	M	M	M	1.0	0.29	0.97	98310390
190221	1,2,4-TRICHLOROBENZENE	N		UG/L	14	70		Table 1	M	M	M	1.0	0.41	1.4	98310390
190221	1,2-DIBROMO-3-CHLOROPROPANE	N		UG/L	0.02	0.2		Table 1	M	M	M	1.0	0.39	1.3	98310390
190221	1,2-DIBROMOETHANE (EDB)	N		UG/L	0.005	0.05		Table 1	M	M	M	1.0	0.73	2.4	98310390
190221	1,2-DICHLOROETHANE	N		UG/L	0.5	5		Table 1	M	M	M	1.0	0.21	0.70	98310390
190221	1,2-DICHLOROPROPANE	N		UG/L	0.5	5		Table 1	M	M	M	1.0	0.72	2.4	98310390
190221	2-HEXANONE	N		UG/L					M	M	M	5.0	1.2	4.1	98310390
190221	4-METHYL-2-PENTANONE (MIBK)	N		UG/L	50	500		Table 1	M	M	M	5.0	2.1	7.0	98310390
190221	ACETONE	N		UG/L	1800	9000		Table 1	M	M	M	10	3.0	10	98310390
190221	ALKALINITY-TOTAL AS CaCO3 (FILT)		389	MG/L											
190221	ARSENIC-DISSOLVED AS AS	J	0.29	UG/L	1	10		Table 1	M	M	M	1.0	0.27	0.90	98310390
190221	BARIUM-DISSOLVED AS BA		83.0	UG/L	400	2000		Table 1	M	M	M	5.0	0.70	2.3	98310390
190221	BENZENE	N		UG/L	0.5	5		Table 1	M	M	M	1.0	0.41	1.4	98310390
190221	BROMODICHLOROMETHANE	N		UG/L	0.06	0.6		Table 1	M	M	M	1.0	0.39	1.3	98310390
190221	BROMOMETHANE	N		UG/L	1	10		Table 1	M	M	M	1.0	0.69	2.3	98310390
190221	CARBON DISULFIDE	N		UG/L	200	1000		Table 1	M	M	M	1.0	0.19	0.63	98310390
190221	CARBON TETRACHLORIDE	N		UG/L	0.5	5		Table 1	M	M	M	1.0	0.27	0.90	98310390
190221	CHLOROBENZENE	N		UG/L	20	100		Table 1	M	M	M	1.0	0.75	2.5	98310390
190221	CHLOROETHANE	N		UG/L	80	400		Table 1	M	M	M	1.0	0.32	1.1	98310390
190221	CHLOROFORM	N		UG/L	0.6	6		Table 1	M	M	M	1.0	0.34	1.1	98310390

Sample Date	Parameter	Qualifier	Value	Units	PAL	ES	Type of Exceedance	Type of Standard	QC 1	QC 2	QC 3	RL	LOD	LOQ	WDNR Lab Cert
	Sample Point: MW26		WDNR Point ID: 080												
190221	CHLOROMETHANE	N		UG/L	3	30		Table 1	M	M	M	1.0	0.35	1.2	98310390
190221	CIS-1,2-DICHLOROETHENE	N		UG/L	7	70		Table 1	M	M	M	1.0	0.81	2.7	98310390
190221	CIS-1,3-DICHLOROPROPENE	N		UG/L	0.04	0.4		Table 1	M	M	M	1.0	0.36	1.2	98310390
190221	DIBROMOCHLOROMETHANE	N		UG/L	6	60		Table 1	M	M	M	1.0	0.32	1.1	98310390
190221	DIBROMOMETHANE	N		UG/L					M	M	M	1.0	0.41	1.4	98310390
190221	DICHLORODIFLUOROMETHANE	N		UG/L	200	1000		Table 1	M	M	M	1.0	0.68	2.3	98310390
190221	DICHLOROMETHANE	N		UG/L	0.5	5		Table 1	M	M	M	1.0	0.44	1.5	98310390
190221	DISSOLVED OXYGEN, FIELD BY PROBE		3.6	MG/L											
190221	ETHYLBENZENE	N		UG/L	140	700		Table 1	M	M	M	1.0	0.74	2.5	98310390
190221	FLUOROTRICHLOROMETHANE	N		UG/L	698	3490		Table 1	M	M	M	1.0	0.88	2.9	98310390
190221	GROUNDWATER ELEVATION		862.56	FT MSL											
190221	IRON-DISSOLVED AS FE	J	0.042	MG/L	0.15	0.3		Table 2	M	M	M	0.030	0.019	0.064	98310390
190221	LEAD-DISSOLVED AS PB	N		UG/L	1.5	15		Table 1	M	M	M	1.5	0.17	0.57	98310390
190221	MANGANESE-DISSOLVED AS MN		23.5	UG/L	60	300		Table 1	M	M	M	10.0	0.40	1.3	98310390
190221	MANGANESE-DISSOLVED AS MN		23.5	UG/L	25	50		Table 2	M	M	M	10.0	0.40	1.3	98310390
190221	M-DICHLOROBENZENE	N		UG/L	120	600		Table 1	M	M	M	1.0	0.78	2.6	98310390
190221	MERCURY-DISSOLVED	N		UG/L	0.2	2		Table 1	M	M	M	0.20	0.12	0.40	98310390
190221	METHYL ETHYL KETONE (MEK)	N		UG/L	800	4000		Table 1	M	M	M	10	1.3	4.4	98310390
190221	METHYL TERT-BUTYL ETHER (MTBE)	N		UG/L	12	60		Table 1	M	M	M	1.0	0.16	0.53	98310390
190221	NAPHTHALENE	N		UG/L	10	100		Table 1	M	M	M	1.0	0.43	1.4	98310390
190221	NITRITE PLUS NITRATE-DISSOLVED AS N		0.25	MG/L	2	10		Table 1	M	M	M	0.050	0.020	0.067	98310390
190221	O-DICHLOROBENZENE	N		UG/L	60	600		Table 1	M	M	M	1.0	0.79	2.6	98310390
190221	OXIDATION REDUCTION POTENTIAL		106.0	MILLIVOLTS											
190221	P-DICHLOROBENZENE	N		UG/L	15	75		Table 1	M	M	M	1.0	0.84	2.8	98310390
190221	PH-FIELD		7.44	SU											
190221	SAMPLE COLOR	N		NONE											
190221	SAMPLE ODOR	N		NONE											
190221	SAMPLE TEMPERATURE		12.4	DEGREES C											
190221	SAMPLE TURBIDITY	N		NONE											
190221	SPECIFIC CONDUCTANCE-FIELD		764	UMHOS/CM											
190221	STYRENE	N		UG/L	10	100		Table 1	M	M	M	1.0	0.73	2.4	98310390
190221	SULFATE-DISSOLVED AS SO4		18.9	MG/L	125	250		Table 2	M	M	M	4.0	0.70	2.3	98310390

Sample Date	Parameter	Qualifier	Value	Units	PAL	ES	Type of Exceedance	Type of Standard	QC 1	QC 2	QC 3	RL	LOD	LOQ	WDNR Lab Cert
Sample Point: MW26		WDNR Point ID: 080													
190221	TETRACHLOROETHYLENE	N		UG/L	0.5	5		Table 1	M	M	M	1.0	0.36	1.2	98310390
190221	TETRAHYDROFURAN	N		UG/L	10	50		Table 1	M	M	F	5.0	1.3	4.2	98310390
190221	TOLUENE	N		UG/L	160	800		Table 1	M	M	M	1.0	0.51	1.7	98310390
190221	TRANS-1,2-DICHLOROETHENE (TOTAL)	N		UG/L	20	100		Table 1	M	M	M	1.0	0.90	3.0	98310390
190221	TRANS-1,3-DICHLOROPROPENE	N		UG/L	0.04	0.4		Table 1	M	M	M	1.0	0.37	1.2	98310390
190221	TRIBROMOMETHANE	N		UG/L	0.44	4.4		Table 1	M	M	M	1.0	0.26	0.87	98310390
190221	TRICHLOROETHYLENE	N		UG/L	0.5	5		Table 1	M	M	M	1.0	0.46	1.5	98310390
190221	VINYL CHLORIDE	N		UG/L	0.02	0.2		Table 1	M	M	M	1.0	0.90	3.0	98310390
190221	VINYL CHLORIDE	N		UG/L	0.02	0.2		Table 1	M	M	M	0.020	0.004	0.013	98310390
190221	XYLENES-TOTAL	N		UG/L	400	2000		Table 1	M	M	M	2.0	0.66	2.2	98310390
Sample Point: P26B		WDNR Point ID: 085													
190221	1,1,1-TRICHLOROETHANE	N		UG/L	40	200		Table 1	M	M	M	1.0	0.82	2.7	98310390
190221	1,1,2,2-TETRACHLOROETHANE	N		UG/L	0.02	0.2		Table 1	M	M	M	1.0	0.21	0.70	98310390
190221	1,1,2-TRICHLOROETHANE	N		UG/L	0.5	5		Table 1	M	M	M	1.0	0.23	0.77	98310390
190221	1,1-DICHLOROETHANE	N		UG/L	85	850		Table 1	M	M	M	1.0	0.38	1.3	98310390
190221	1,1-DICHLOROETHYLENE	N		UG/L	0.7	7		Table 1	M	M	M	1.0	0.29	0.97	98310390
190221	1,2,4-TRICHLOROBENZENE	N		UG/L	14	70		Table 1	M	M	M	1.0	0.41	1.4	98310390
190221	1,2-DIBROMO-3-CHLOROPROPANE	N		UG/L	0.02	0.2		Table 1	M	M	M	1.0	0.39	1.3	98310390
190221	1,2-DIBROMOETHANE (EDB)	N		UG/L	0.005	0.05		Table 1	M	M	M	1.0	0.73	2.4	98310390
190221	1,2-DICHLOROETHANE	N		UG/L	0.5	5		Table 1	M	M	M	1.0	0.21	0.70	98310390
190221	1,2-DICHLOROPROPANE	N		UG/L	0.5	5		Table 1	M	M	M	1.0	0.72	2.4	98310390
190221	2-HEXANONE	N		UG/L					M	M	M	5.0	1.2	4.1	98310390
190221	4-METHYL-2-PENTANONE (MIBK)	N		UG/L	50	500		Table 1	M	M	M	5.0	2.1	7.0	98310390
190221	ACETONE	N		UG/L	1800	9000		Table 1	M	M	M	10	3.0	10	98310390
190221	ALKALINITY-TOTAL AS CaCO3 (FILT)		308	MG/L					M	M	M	50.0	20.0	66.7	98310390
190221	ARSENIC-DISSOLVED AS AS		0.90	UG/L	1	10		Table 1	M	M	M	1.0	0.27	0.90	98310390
190221	BARIUM-DISSOLVED AS BA		63.1	UG/L	400	2000		Table 1	M	M	M	5.0	0.70	2.3	98310390
190221	BENZENE	N		UG/L	0.5	5		Table 1	M	M	M	1.0	0.41	1.4	98310390
190221	BROMODICHLOROMETHANE	N		UG/L	0.06	0.6		Table 1	M	M	M	1.0	0.39	1.3	98310390
190221	BROMOMETHANE	N		UG/L	1	10		Table 1	M	M	M	1.0	0.69	2.3	98310390
190221	CARBON DISULFIDE	N		UG/L	200	1000		Table 1	M	M	M	1.0	0.19	0.63	98310390
190221	CARBON TETRACHLORIDE	N		UG/L	0.5	5		Table 1	M	M	M	1.0	0.27	0.90	98310390

Sample Date	Parameter	Qualifier	Value	Units	PAL	ES	Type of Exceedance	Type of Standard	QC 1	QC 2	QC 3	RL	LOD	LOQ	WDNR Lab Cert
	Sample Point: P26B		WDNR Point ID: 085												
190221	CHLORO BENZENE	N		UG/L	20	100		Table 1	M	M	M	1.0	0.75	2.5	98310390
190221	CHLOROETHANE	N		UG/L	80	400		Table 1	M	M	M	1.0	0.32	1.1	98310390
190221	CHLOROFORM	N		UG/L	0.6	6		Table 1	M	M	M	1.0	0.34	1.1	98310390
190221	CHLOROMETHANE	N		UG/L	3	30		Table 1	M	M	M	1.0	0.35	1.2	98310390
190221	CIS-1,2-DICHLOROETHENE	N		UG/L	7	70		Table 1	M	M	M	1.0	0.81	2.7	98310390
190221	CIS-1,3-DICHLOROPROPENE	N		UG/L	0.04	0.4		Table 1	M	M	M	1.0	0.36	1.2	98310390
190221	DIBROMOCHLOROMETHANE	N		UG/L	6	60		Table 1	M	M	M	1.0	0.32	1.1	98310390
190221	DIBROMOMETHANE	N		UG/L					M	M	M	1.0	0.41	1.4	98310390
190221	DICHLORODIFLUOROMETHANE	N		UG/L	200	1000		Table 1	M	M	M	1.0	0.68	2.3	98310390
190221	DICHLOROMETHANE	N		UG/L	0.5	5		Table 1	M	M	M	1.0	0.44	1.5	98310390
190221	DISSOLVED OXYGEN, FIELD BY PROBE		2.7	MG/L											
190221	ETHYLBENZENE	N		UG/L	140	700		Table 1	M	M	M	1.0	0.74	2.5	98310390
190221	FLUOROTRICHLOROMETHANE	N		UG/L	698	3490		Table 1	M	M	M	1.0	0.88	2.9	98310390
190221	GROUNDWATER ELEVATION		862.31	FT MSL											
190221	IRON-DISSOLVED AS FE	J	0.042	MG/L	0.15	0.3		Table 2	M	M	M	0.030	0.019	0.064	98310390
190221	LEAD-DISSOLVED AS PB	N		UG/L	1.5	15		Table 1	M	M	M	1.5	0.17	0.57	98310390
190221	MANGANESE-DISSOLVED AS MN		61.9	UG/L	60	300	P	Table 1	M	M	M	10.0	0.40	1.3	98310390
190221	MANGANESE-DISSOLVED AS MN		61.9	UG/L	25	50	P*	Table 2	M	M	M	10.0	0.40	1.3	98310390
190221	M-DICHLORO BENZENE	N		UG/L	120	600		Table 1	M	M	M	1.0	0.78	2.6	98310390
190221	MERCURY-DISSOLVED	N		UG/L	0.2	2		Table 1	M	M	M	0.20	0.12	0.40	98310390
190221	METHYL ETHYL KETONE (MEK)	N		UG/L	800	4000		Table 1	M	M	M	10	1.3	4.4	98310390
190221	METHYL TERT-BUTYL ETHER (MTBE)	N		UG/L	12	60		Table 1	M	M	M	1.0	0.16	0.53	98310390
190221	NAPHTHALENE	N		UG/L	10	100		Table 1	M	M	M	1.0	0.43	1.4	98310390
190221	NITRITE PLUS NITRATE-DISSOLVED AS N		1.4	MG/L	2	10		Table 1	M	M	M	0.050	0.020	0.067	98310390
190221	O-DICHLORO BENZENE	N		UG/L	60	600		Table 1	M	M	M	1.0	0.79	2.6	98310390
190221	OXIDATION REDUCTION POTENTIAL		29.0	MILLIVOLTS											
190221	P-DICHLORO BENZENE	N		UG/L	15	75		Table 1	M	M	M	1.0	0.84	2.8	98310390
190221	PH-FIELD		7.43	SU											
190221	SAMPLE COLOR	N		NONE											
190221	SAMPLE ODOR	N		NONE											
190221	SAMPLE TEMPERATURE		12.5	DEGREES C											
190221	SAMPLE TURBIDITY	N		NONE											

Sample Date	Parameter	Qualifier	Value	Units	PAL	ES	Type of Exceedance	Type of Standard	QC 1	QC 2	QC 3	RL	LOD	LOQ	WDNR Lab Cert
Sample Point: P26B		WDNR Point ID: 085													
190221	SPECIFIC CONDUCTANCE-FIELD		734	UMHOS/CM											
190221	STYRENE	N		UG/L	10	100		Table 1	M	M	M	1.0	0.73	2.4	98310390
190221	SULFATE-DISSOLVED AS SO4		18.3	MG/L	125	250		Table 2	M	M	M	4.0	0.70	2.3	98310390
190221	TETRACHLOROETHYLENE	N		UG/L	0.5	5		Table 1	M	M	M	1.0	0.36	1.2	98310390
190221	TETRAHYDROFURAN	N		UG/L	10	50		Table 1	M	M	F	5.0	1.3	4.2	98310390
190221	TOLUENE	N		UG/L	160	800		Table 1	M	M	M	1.0	0.51	1.7	98310390
190221	TRANS-1,2-DICHLOROETHENE (TOTAL)	N		UG/L	20	100		Table 1	M	M	M	1.0	0.90	3.0	98310390
190221	TRANS-1,3-DICHLOROPROPENE	N		UG/L	0.04	0.4		Table 1	M	M	M	1.0	0.37	1.2	98310390
190221	TRIBROMOMETHANE	N		UG/L	0.44	4.4		Table 1	M	M	M	1.0	0.26	0.87	98310390
190221	TRICHLOROETHYLENE	N		UG/L	0.5	5		Table 1	M	M	M	1.0	0.46	1.5	98310390
190221	VINYL CHLORIDE	N		UG/L	0.02	0.2		Table 1	M	M	M	1.0	0.90	3.0	98310390
190221	VINYL CHLORIDE		0.21	UG/L	0.02	0.2	P*	Table 1	M	M	M	0.020	0.004	0.013	98310390
190221	XYLENES-TOTAL	N		UG/L	400	2000		Table 1	M	M	M	2.0	0.66	2.2	98310390
Sample Point: MW27		WDNR Point ID: 095													
190220	1,1,1-TRICHLOROETHANE	N		UG/L	40	200		Table 1	M	M	M	1.0	0.82	2.7	98310390
190220	1,1,2,2-TETRACHLOROETHANE	N		UG/L	0.02	0.2		Table 1	M	M	M	1.0	0.21	0.70	98310390
190220	1,1,2-TRICHLOROETHANE	N		UG/L	0.5	5		Table 1	M	M	M	1.0	0.23	0.77	98310390
190220	1,1-DICHLOROETHANE	N		UG/L	85	850		Table 1	M	M	M	1.0	0.38	1.3	98310390
190220	1,1-DICHLOROETHYLENE	N		UG/L	0.7	7		Table 1	M	M	M	1.0	0.29	0.97	98310390
190220	1,2,4-TRICHLOROBENZENE	N		UG/L	14	70		Table 1	M	M	M	1.0	0.41	1.4	98310390
190220	1,2-DIBROMO-3-CHLOROPROPANE	N		UG/L	0.02	0.2		Table 1	M	M	M	1.0	0.39	1.3	98310390
190220	1,2-DIBROMOETHANE (EDB)	N		UG/L	0.005	0.05		Table 1	M	M	M	1.0	0.73	2.4	98310390
190220	1,2-DICHLOROETHANE	N		UG/L	0.5	5		Table 1	M	M	M	1.0	0.21	0.70	98310390
190220	1,2-DICHLOROPROPANE	N		UG/L	0.5	5		Table 1	M	M	M	1.0	0.72	2.4	98310390
190220	2-HEXANONE	N		UG/L					M	M	M	5.0	1.2	4.1	98310390
190220	4-METHYL-2-PENTANONE (MIBK)	N		UG/L	50	500		Table 1	M	M	M	5.0	2.1	7.0	98310390
190220	ACETONE	N		UG/L	1800	9000		Table 1	M	M	M	10	3.0	10	98310390
190220	ALKALINITY-TOTAL AS CaCO3 (FILT)		72.0	MG/L					M	M	M	50.0	20.0	66.7	98310390
190220	ARSENIC-DISSOLVED AS AS		1.4	UG/L	1	10	P	Table 1	M	M	M	1.0	0.27	0.90	98310390
190220	BARIUM-DISSOLVED AS BA		29.1	UG/L	400	2000		Table 1	M	M	M	5.0	0.70	2.3	98310390
190220	BENZENE	N		UG/L	0.5	5		Table 1	M	M	M	1.0	0.41	1.4	98310390
190220	BROMODICHLOROMETHANE	N		UG/L	0.06	0.6		Table 1	M	M	M	1.0	0.39	1.3	98310390

Sample Date	Parameter	Qualifier	Value	Units	PAL	ES	Type of Exceedance	Type of Standard	QC 1	QC 2	QC 3	RL	LOD	LOQ	WDNR Lab Cert
	Sample Point: MW27	WDNR Point ID: 095													
190220	BROMOMETHANE	N		UG/L	1	10		Table 1	M	M	M	1.0	0.69	2.3	98310390
190220	CARBON DISULFIDE	N		UG/L	200	1000		Table 1	M	M	M	1.0	0.19	0.63	98310390
190220	CARBON TETRACHLORIDE	N		UG/L	0.5	5		Table 1	M	M	M	1.0	0.27	0.90	98310390
190220	CHLOROBENZENE	N		UG/L	20	100		Table 1	M	M	M	1.0	0.75	2.5	98310390
190220	CHLOROETHANE	N		UG/L	80	400		Table 1	M	M	M	1.0	0.32	1.1	98310390
190220	CHLOROFORM	N		UG/L	0.6	6		Table 1	M	M	M	1.0	0.34	1.1	98310390
190220	CHLOROMETHANE	N		UG/L	3	30		Table 1	M	M	M	1.0	0.35	1.2	98310390
190220	CIS-1,2-DICHLOROETHENE	N		UG/L	7	70		Table 1	M	M	M	1.0	0.81	2.7	98310390
190220	CIS-1,3-DICHLOROPROPENE	N		UG/L	0.04	0.4		Table 1	M	M	M	1.0	0.36	1.2	98310390
190220	DIBROMOCHLOROMETHANE	N		UG/L	6	60		Table 1	M	M	M	1.0	0.32	1.1	98310390
190220	DIBROMOMETHANE	N		UG/L					M	M	M	1.0	0.41	1.4	98310390
190220	DICHLORODIFLUOROMETHANE	N		UG/L	200	1000		Table 1	M	M	M	1.0	0.68	2.3	98310390
190220	DICHLOROMETHANE	N		UG/L	0.5	5		Table 1	M	M	M	1.0	0.44	1.5	98310390
190220	DISSOLVED OXYGEN, FIELD BY PROBE		2.3	MG/L											
190220	ETHYLBENZENE	N		UG/L	140	700		Table 1	M	M	M	1.0	0.74	2.5	98310390
190220	FLUOROTRICHLOROMETHANE	N		UG/L	698	3490		Table 1	M	M	M	1.0	0.88	2.9	98310390
190220	GROUNDWATER ELEVATION		860.28	FT MSL											
190220	IRON-DISSOLVED AS FE		0.13	MG/L	0.15	0.3		Table 2	M	M	M	0.030	0.019	0.064	98310390
190220	LEAD-DISSOLVED AS PB	J	0.19	UG/L	1.5	15		Table 1	M	M	M	1.5	0.17	0.57	98310390
190220	MANGANESE-DISSOLVED AS MN		16.4	UG/L	60	300		Table 1	M	M	M	10.0	0.40	1.3	98310390
190220	MANGANESE-DISSOLVED AS MN		16.4	UG/L	25	50		Table 2	M	M	M	10.0	0.40	1.3	98310390
190220	M-DICHLOROBENZENE	N		UG/L	120	600		Table 1	M	M	M	1.0	0.78	2.6	98310390
190220	MERCURY-DISSOLVED	N		UG/L	0.2	2		Table 1	M	M	M	0.20	0.12	0.40	98310390
190220	METHYL ETHYL KETONE (MEK)	N		UG/L	800	4000		Table 1	M	M	M	10	1.3	4.4	98310390
190220	METHYL TERT-BUTYL ETHER (MTBE)	N		UG/L	12	60		Table 1	M	M	M	1.0	0.16	0.53	98310390
190220	NAPHTHALENE	N		UG/L	10	100		Table 1	M	M	M	1.0	0.43	1.4	98310390
190220	NITRITE PLUS NITRATE-DISSOLVED AS N	J	0.055	MG/L	2	10		Table 1	M	M	M	0.050	0.020	0.067	98310390
190220	O-DICHLOROBENZENE	N		UG/L	60	600		Table 1	M	M	M	1.0	0.79	2.6	98310390
190220	OXIDATION REDUCTION POTENTIAL		-43.0	MILLIVOLTS											
190220	P-DICHLOROBENZENE	N		UG/L	15	75		Table 1	M	M	M	1.0	0.84	2.8	98310390
190220	PH-FIELD		7.86	SU											
190220	SAMPLE COLOR	N		NONE											

Sample Date	Parameter	Qualifier	Value	Units	PAL	ES	Type of Exceedance	Type of Standard	QC 1	QC 2	QC 3	RL	LOD	LOQ	WDNR Lab Cert
Sample Point: MW27		WDNR Point ID: 095													
190220	SAMPLE ODOR	N		NONE											
190220	SAMPLE TEMPERATURE		7.4	DEGREES C											
190220	SAMPLE TURBIDITY	N		NONE											
190220	SPECIFIC CONDUCTANCE-FIELD		462	UMHOS/CM											
190220	STYRENE	N		UG/L	10	100		Table 1	M	M	M	1.0	0.73	2.4	98310390
190220	SULFATE-DISSOLVED AS SO4		16.6	MG/L	125	250		Table 2	M	M	M	2.0	0.35	1.2	98310390
190220	TETRACHLOROETHYLENE	N		UG/L	0.5	5		Table 1	M	M	M	1.0	0.36	1.2	98310390
190220	TETRAHYDROFURAN	N		UG/L	10	50		Table 1	M	M	M	5.0	1.3	4.2	98310390
190220	TOLUENE	N		UG/L	160	800		Table 1	M	M	M	1.0	0.51	1.7	98310390
190220	TRANS-1,2-DICHLOROETHENE (TOTAL)	N		UG/L	20	100		Table 1	M	M	M	1.0	0.90	3.0	98310390
190220	TRANS-1,3-DICHLOROPROPENE	N		UG/L	0.04	0.4		Table 1	M	M	M	1.0	0.37	1.2	98310390
190220	TRIBROMOMETHANE	N		UG/L	0.44	4.4		Table 1	M	M	M	1.0	0.26	0.87	98310390
190220	TRICHLOROETHYLENE	N		UG/L	0.5	5		Table 1	M	M	M	1.0	0.46	1.5	98310390
190220	VINYL CHLORIDE	N		UG/L	0.02	0.2		Table 1	M	M	M	1.0	0.90	3.0	98310390
190220	VINYL CHLORIDE	N		UG/L	0.02	0.2		Table 1	M	M	M	0.020	0.004	0.013	98310390
190220	XYLENES-TOTAL	N		UG/L	400	2000		Table 1	M	M	M	2.0	0.66	2.2	98310390
Sample Point: P27B		WDNR Point ID: 100													
190220	1,1,1-TRICHLOROETHANE	N		UG/L	40	200		Table 1	M	M	M	1.0	0.82	2.7	98310390
190220	1,1,2,2-TETRACHLOROETHANE	N		UG/L	0.02	0.2		Table 1	M	M	M	1.0	0.21	0.70	98310390
190220	1,1,2-TRICHLOROETHANE	N		UG/L	0.5	5		Table 1	M	M	M	1.0	0.23	0.77	98310390
190220	1,1-DICHLOROETHANE	N		UG/L	85	850		Table 1	M	M	M	1.0	0.38	1.3	98310390
190220	1,1-DICHLOROETHYLENE	N		UG/L	0.7	7		Table 1	M	M	M	1.0	0.29	0.97	98310390
190220	1,2,4-TRICHLOROBENZENE	N		UG/L	14	70		Table 1	M	M	M	1.0	0.41	1.4	98310390
190220	1,2-DIBROMO-3-CHLOROPROPANE	N		UG/L	0.02	0.2		Table 1	M	M	M	1.0	0.39	1.3	98310390
190220	1,2-DIBROMOETHANE (EDB)	N		UG/L	0.005	0.05		Table 1	M	M	M	1.0	0.73	2.4	98310390
190220	1,2-DICHLOROETHANE	N		UG/L	0.5	5		Table 1	M	M	M	1.0	0.21	0.70	98310390
190220	1,2-DICHLOROPROPANE	N		UG/L	0.5	5		Table 1	M	M	M	1.0	0.72	2.4	98310390
190220	2-HEXANONE	N		UG/L					M	M	M	5.0	1.2	4.1	98310390
190220	4-METHYL-2-PENTANONE (MIBK)	N		UG/L	50	500		Table 1	M	M	M	5.0	2.1	7.0	98310390
190220	ACETONE	N		UG/L	1800	9000		Table 1	M	M	M	10	3.0	10	98310390
190220	ALKALINITY-TOTAL AS CaCO3 (FILT)		317	MG/L					M	M	M	40.0	16.0	53.3	98310390
190220	ARSENIC-DISSOLVED AS AS		13.8	UG/L	1	10	E	Table 1	M	M	M	1.0	0.27	0.90	98310390

Sample Date	Parameter	Qualifier	Value	Units	PAL	ES	Type of Exceedance	Type of Standard	QC 1	QC 2	QC 3	RL	LOD	LOQ	WDNR Lab Cert
	Sample Point: P27B	WDNR Point ID:	100												
190220	BARIUM-DISSOLVED AS BA		79.1	UG/L	400	2000		Table 1	M	M	M	5.0	0.70	2.3	98310390
190220	BENZENE	N		UG/L	0.5	5		Table 1	M	M	M	1.0	0.41	1.4	98310390
190220	BROMODICHLOROMETHANE	N		UG/L	0.06	0.6		Table 1	M	M	M	1.0	0.39	1.3	98310390
190220	BROMOMETHANE	N		UG/L	1	10		Table 1	M	M	M	1.0	0.69	2.3	98310390
190220	CARBON DISULFIDE	N		UG/L	200	1000		Table 1	M	M	M	1.0	0.19	0.63	98310390
190220	CARBON TETRACHLORIDE	N		UG/L	0.5	5		Table 1	M	M	M	1.0	0.27	0.90	98310390
190220	CHLOROBENZENE	N		UG/L	20	100		Table 1	M	M	M	1.0	0.75	2.5	98310390
190220	CHLOROETHANE	N		UG/L	80	400		Table 1	M	M	M	1.0	0.32	1.1	98310390
190220	CHLOROFORM	N		UG/L	0.6	6		Table 1	M	M	M	1.0	0.34	1.1	98310390
190220	CHLOROMETHANE	N		UG/L	3	30		Table 1	M	M	M	1.0	0.35	1.2	98310390
190220	CIS-1,2-DICHLOROETHENE	N		UG/L	7	70		Table 1	M	M	M	1.0	0.81	2.7	98310390
190220	CIS-1,3-DICHLOROPROPENE	N		UG/L	0.04	0.4		Table 1	M	M	M	1.0	0.36	1.2	98310390
190220	DIBROMOCHLOROMETHANE	N		UG/L	6	60		Table 1	M	M	M	1.0	0.32	1.1	98310390
190220	DIBROMOMETHANE	N		UG/L					M	M	M	1.0	0.41	1.4	98310390
190220	DICHLORODIFLUOROMETHANE	N		UG/L	200	1000		Table 1	M	M	M	1.0	0.68	2.3	98310390
190220	DICHLOROMETHANE	N		UG/L	0.5	5		Table 1	M	M	M	1.0	0.44	1.5	98310390
190220	DISSOLVED OXYGEN, FIELD BY PROBE		1.3	MG/L											
190220	ETHYLBENZENE	N		UG/L	140	700		Table 1	M	M	M	1.0	0.74	2.5	98310390
190220	FLUOROTRICHLOROMETHANE	N		UG/L	698	3490		Table 1	M	M	M	1.0	0.88	2.9	98310390
190220	GROUNDWATER ELEVATION		860.24	FT MSL											
190220	IRON-DISSOLVED AS FE		2.4	MG/L	0.15	0.3	E	Table 2	M	M	M	0.030	0.019	0.064	98310390
190220	LEAD-DISSOLVED AS PB	N		UG/L	1.5	15		Table 1	M	M	M	1.5	0.17	0.57	98310390
190220	MANGANESE-DISSOLVED AS MN		135	UG/L	60	300	P	Table 1	M	M	M	10.0	0.40	1.3	98310390
190220	MANGANESE-DISSOLVED AS MN		135	UG/L	25	50	E	Table 2	M	M	M	10.0	0.40	1.3	98310390
190220	M-DICHLOROBENZENE	N		UG/L	120	600		Table 1	M	M	M	1.0	0.78	2.6	98310390
190220	MERCURY-DISSOLVED	N		UG/L	0.2	2		Table 1	M	M	M	0.20	0.12	0.40	98310390
190220	METHYL ETHYL KETONE (MEK)	N		UG/L	800	4000		Table 1	M	M	M	10	1.3	4.4	98310390
190220	METHYL TERT-BUTYL ETHER (MTBE)	N		UG/L	12	60		Table 1	M	M	M	1.0	0.16	0.53	98310390
190220	NAPHTHALENE	N		UG/L	10	100		Table 1	M	M	M	1.0	0.43	1.4	98310390
190220	NITRITE PLUS NITRATE-DISSOLVED AS N		0.71	MG/L	2	10		Table 1	M	M	M	0.050	0.020	0.067	98310390
190220	O-DICHLOROBENZENE	N		UG/L	60	600		Table 1	M	M	M	1.0	0.79	2.6	98310390
190220	OXIDATION REDUCTION POTENTIAL		-71.0	MILLIVOLTS											

Sample Date	Parameter	Qualifier	Value	Units	PAL	ES	Type of Exceedance	Type of Standard	QC 1	QC 2	QC 3	RL	LOD	LOQ	WDNR Lab Cert
Sample Point: P27B		WDNR Point ID: 100													
190220	P-DICHLOROENZENE	N		UG/L	15	75		Table 1	M	M	M	1.0	0.84	2.8	98310390
190220	PH-FIELD		7.62	SU											
190220	SAMPLE COLOR	N		NONE											
190220	SAMPLE ODOR	N		NONE											
190220	SAMPLE TEMPERATURE		8.1	DEGREES C											
190220	SAMPLE TURBIDITY	N		NONE											
190220	SPECIFIC CONDUCTANCE-FIELD		700	UMHOS/CM											
190220	STYRENE	N		UG/L	10	100		Table 1	M	M	M	1.0	0.73	2.4	98310390
190220	SULFATE-DISSOLVED AS SO4		20.0	MG/L	125	250		Table 2	M	M	M	4.0	0.70	2.3	98310390
190220	TETRACHLOROETHYLENE	N		UG/L	0.5	5		Table 1	M	M	M	1.0	0.36	1.2	98310390
190220	TETRAHYDROFURAN	N		UG/L	10	50		Table 1	M	M	M	5.0	1.3	4.2	98310390
190220	TOLUENE	N		UG/L	160	800		Table 1	M	M	M	1.0	0.51	1.7	98310390
190220	TRANS-1,2-DICHLOROETHENE (TOTAL)	N		UG/L	20	100		Table 1	M	M	M	1.0	0.90	3.0	98310390
190220	TRANS-1,3-DICHLOROPROPENE	N		UG/L	0.04	0.4		Table 1	M	M	M	1.0	0.37	1.2	98310390
190220	TRIBROMOMETHANE	N		UG/L	0.44	4.4		Table 1	M	M	M	1.0	0.26	0.87	98310390
190220	TRICHLOROETHYLENE	N		UG/L	0.5	5		Table 1	M	M	M	1.0	0.46	1.5	98310390
190220	VINYL CHLORIDE	N		UG/L	0.02	0.2		Table 1	M	M	M	1.0	0.90	3.0	98310390
190220	VINYL CHLORIDE	N		UG/L	0.02	0.2		Table 1	M	M	M	0.020	0.004	0.013	98310390
190220	XYLENES-TOTAL	N		UG/L	400	2000		Table 1	M	M	M	2.0	0.66	2.2	98310390
Sample Point: P28B		WDNR Point ID: 105													
190220	1,1,1-TRICHLOROETHANE	N		UG/L	40	200		Table 1	M	M	M	1.0	0.82	2.7	98310390
190220	1,1,2,2-TETRACHLOROETHANE	N		UG/L	0.02	0.2		Table 1	M	M	M	1.0	0.21	0.70	98310390
190220	1,1,2-TRICHLOROETHANE	N		UG/L	0.5	5		Table 1	M	M	M	1.0	0.23	0.77	98310390
190220	1,1-DICHLOROETHANE	N		UG/L	85	850		Table 1	M	M	M	1.0	0.38	1.3	98310390
190220	1,1-DICHLOROETHYLENE	N		UG/L	0.7	7		Table 1	M	M	M	1.0	0.29	0.97	98310390
190220	1,2,4-TRICHLOROENZENE	N		UG/L	14	70		Table 1	M	M	M	1.0	0.41	1.4	98310390
190220	1,2-DIBROMO-3-CHLOROPROPANE	N		UG/L	0.02	0.2		Table 1	M	M	M	1.0	0.39	1.3	98310390
190220	1,2-DIBROMOETHANE (EDB)	N		UG/L	0.005	0.05		Table 1	M	M	M	1.0	0.73	2.4	98310390
190220	1,2-DICHLOROETHANE	N		UG/L	0.5	5		Table 1	M	M	M	1.0	0.21	0.70	98310390
190220	1,2-DICHLOROPROPANE	N		UG/L	0.5	5		Table 1	M	M	M	1.0	0.72	2.4	98310390
190220	2-HEXANONE	N		UG/L					M	M	M	5.0	1.2	4.1	98310390
190220	4-METHYL-2-PENTANONE (MIBK)	N		UG/L	50	500		Table 1	M	M	M	5.0	2.1	7.0	98310390

Sample Date	Parameter	Qualifier	Value	Units	PAL	ES	Type of Exceedance	Type of Standard	QC 1	QC 2	QC 3	RL	LOD	LOQ	WDNR Lab Cert
Sample Point: P28B		WDNR Point ID: 105													
190220	ACETONE	N		UG/L	1800	9000		Table 1	M	M	M	10	3.0	10	98310390
190220	ALKALINITY-TOTAL AS CaCO3 (FILT)		310	MG/L					M	M	M	40.0	16.0	53.3	98310390
190220	ARSENIC-DISSOLVED AS AS	J	0.79	UG/L	1	10		Table 1	M	M	M	1.0	0.27	0.90	98310390
190220	BARIUM-DISSOLVED AS BA		78.3	UG/L	400	2000		Table 1	M	M	M	5.0	0.70	2.3	98310390
190220	BENZENE	N		UG/L	0.5	5		Table 1	M	M	M	1.0	0.41	1.4	98310390
190220	BROMODICHLOROMETHANE	N		UG/L	0.06	0.6		Table 1	M	M	M	1.0	0.39	1.3	98310390
190220	BROMOMETHANE	N		UG/L	1	10		Table 1	M	M	M	1.0	0.69	2.3	98310390
190220	CARBON DISULFIDE	N		UG/L	200	1000		Table 1	M	M	M	1.0	0.19	0.63	98310390
190220	CARBON TETRACHLORIDE	N		UG/L	0.5	5		Table 1	M	M	M	1.0	0.27	0.90	98310390
190220	CHLOROBENZENE	N		UG/L	20	100		Table 1	M	M	M	1.0	0.75	2.5	98310390
190220	CHLOROETHANE	N		UG/L	80	400		Table 1	M	M	M	1.0	0.32	1.1	98310390
190220	CHLOROFORM	N		UG/L	0.6	6		Table 1	M	M	M	1.0	0.34	1.1	98310390
190220	CHLOROMETHANE	N		UG/L	3	30		Table 1	M	M	M	1.0	0.35	1.2	98310390
190220	CIS-1,2-DICHLOROETHENE	N		UG/L	7	70		Table 1	M	M	M	1.0	0.81	2.7	98310390
190220	CIS-1,3-DICHLOROPROPENE	N		UG/L	0.04	0.4		Table 1	M	M	M	1.0	0.36	1.2	98310390
190220	DIBROMOCHLOROMETHANE	N		UG/L	6	60		Table 1	M	M	M	1.0	0.32	1.1	98310390
190220	DIBROMOMETHANE	N		UG/L					M	M	M	1.0	0.41	1.4	98310390
190220	DICHLORODIFLUOROMETHANE	N		UG/L	200	1000		Table 1	M	M	M	1.0	0.68	2.3	98310390
190220	DICHLOROMETHANE	N		UG/L	0.5	5		Table 1	M	M	M	1.0	0.44	1.5	98310390
190220	DISSOLVED OXYGEN, FIELD BY PROBE		1.5	MG/L											
190220	ETHYLBENZENE	N		UG/L	140	700		Table 1	M	M	M	1.0	0.74	2.5	98310390
190220	FLUOROTRICHLOROMETHANE	N		UG/L	698	3490		Table 1	M	M	M	1.0	0.88	2.9	98310390
190220	GROUNDWATER ELEVATION		854.50	FT MSL											
190220	IRON-DISSOLVED AS FE	J	0.035	MG/L	0.15	0.3		Table 2	M	M	M	0.030	0.019	0.064	98310390
190220	LEAD-DISSOLVED AS PB	J	0.19	UG/L	1.5	15		Table 1	M	M	M	1.5	0.17	0.57	98310390
190220	MANGANESE-DISSOLVED AS MN		194	UG/L	60	300	P	Table 1	M	M	M	10.0	0.40	1.3	98310390
190220	MANGANESE-DISSOLVED AS MN		194	UG/L	25	50	E	Table 2	M	M	M	10.0	0.40	1.3	98310390
190220	M-DICHLOROBENZENE	N		UG/L	120	600		Table 1	M	M	M	1.0	0.78	2.6	98310390
190220	MERCURY-DISSOLVED	N		UG/L	0.2	2		Table 1	M	M	M	0.20	0.12	0.40	98310390
190220	METHYL ETHYL KETONE (MEK)	N		UG/L	800	4000		Table 1	M	M	M	10	1.3	4.4	98310390
190220	METHYL TERT-BUTYL ETHER (MTBE)	N		UG/L	12	60		Table 1	M	M	M	1.0	0.16	0.53	98310390
190220	NAPHTHALENE	N		UG/L	10	100		Table 1	M	M	M	1.0	0.43	1.4	98310390

Hagen Farm Landfill
WMI Site Number: 393

License Number: 02981
Facility ID Number:

Sample Date	Parameter	Qualifier	Value	Units	PAL	ES	Type of Exceedance	Type of Standard	QC 1	QC 2	QC 3	RL	LOD	LOQ	WDNR Lab Cert
Sample Point: P28B		WDNR Point ID: 105													
190220	NITRITE PLUS NITRATE-DISSOLVED AS N	J	0.024	MG/L	2	10		Table 1	M	M	M	0.050	0.020	0.067	98310390
190220	O-DICHLOROBENZENE	N		UG/L	60	600		Table 1	M	M	M	1.0	0.79	2.6	98310390
190220	OXIDATION REDUCTION POTENTIAL		-10.0	MILLIVOLTS											
190220	P-DICHLOROBENZENE	N		UG/L	15	75		Table 1	M	M	M	1.0	0.84	2.8	98310390
190220	PH-FIELD		7.03	SU											
190220	SAMPLE COLOR	N		NONE											
190220	SAMPLE ODOR	N		NONE											
190220	SAMPLE TEMPERATURE		9.0	DEGREES C											
190220	SAMPLE TURBIDITY	N		NONE											
190220	SPECIFIC CONDUCTANCE-FIELD		791	UMHOS/CM											
190220	STYRENE	N		UG/L	10	100		Table 1	M	M	M	1.0	0.73	2.4	98310390
190220	SULFATE-DISSOLVED AS SO4		47.7	MG/L	125	250		Table 2	M	M	M	4.0	0.70	2.3	98310390
190220	TETRACHLOROETHYLENE	N		UG/L	0.5	5		Table 1	M	M	M	1.0	0.36	1.2	98310390
190220	TETRAHYDROFURAN	N		UG/L	10	50		Table 1	M	M	M	5.0	1.3	4.2	98310390
190220	TOLUENE	N		UG/L	160	800		Table 1	M	M	M	1.0	0.51	1.7	98310390
190220	TRANS-1,2-DICHLOROETHENE (TOTAL)	N		UG/L	20	100		Table 1	M	M	M	1.0	0.90	3.0	98310390
190220	TRANS-1,3-DICHLOROPROPENE	N		UG/L	0.04	0.4		Table 1	M	M	M	1.0	0.37	1.2	98310390
190220	TRIBROMOMETHANE	N		UG/L	0.44	4.4		Table 1	M	M	M	1.0	0.26	0.87	98310390
190220	TRICHLOROETHYLENE	N		UG/L	0.5	5		Table 1	M	M	M	1.0	0.46	1.5	98310390
190220	VINYL CHLORIDE	N		UG/L	0.02	0.2		Table 1	M	M	M	1.0	0.90	3.0	98310390
190220	VINYL CHLORIDE	N		UG/L	0.02	0.2		Table 1	M	M	M	0.020	0.004	0.013	98310390
190220	XYLENES-TOTAL	N		UG/L	400	2000		Table 1	M	M	M	2.0	0.66	2.2	98310390
Sample Point: P28C		WDNR Point ID: 110													
190221	GROUNDWATER ELEVATION		859.33	FT MSL											
Sample Point: MW29		WDNR Point ID: 115													
190221	GROUNDWATER ELEVATION		859.13	FT MSL											
Sample Point: P29B		WDNR Point ID: 120													
190221	GROUNDWATER ELEVATION		858.90	FT MSL											
Sample Point: P29C		WDNR Point ID: 125													
190221	GROUNDWATER ELEVATION		858.90	FT MSL											
Sample Point: MW30		WDNR Point ID: 130													
190221	GROUNDWATER ELEVATION		860.52	FT MSL											

Sample Date	Parameter	Qualifier	Value	Units	PAL	ES	Type of Exceedance	Type of Standard	QC 1	QC 2	QC 3	RL	LOD	LOQ	WDNR Lab Cert
Sample Point: P30B		WDNR Point ID: 135													
190221	GROUNDWATER ELEVATION		860.54	FT MSL											
Sample Point: P30C		WDNR Point ID: 140													
190221	GROUNDWATER ELEVATION		860.56	FT MSL											
Sample Point: MW32		WDNR Point ID: 145													
190221	GROUNDWATER ELEVATION		858.83	FT MSL											
Sample Point: P32B		WDNR Point ID: 150													
190220	1,1,1-TRICHLOROETHANE	N		UG/L	40	200		Table 1	M	M	M	1.0	0.82	2.7	98310390
190220	1,1,2,2-TETRACHLOROETHANE	N		UG/L	0.02	0.2		Table 1	M	M	M	1.0	0.21	0.70	98310390
190220	1,1,2-TRICHLOROETHANE	N		UG/L	0.5	5		Table 1	M	M	M	1.0	0.23	0.77	98310390
190220	1,1-DICHLOROETHANE	N		UG/L	85	850		Table 1	M	M	M	1.0	0.38	1.3	98310390
190220	1,1-DICHLOROETHYLENE	N		UG/L	0.7	7		Table 1	M	M	M	1.0	0.29	0.97	98310390
190220	1,2,4-TRICHLOROBENZENE	N		UG/L	14	70		Table 1	M	M	M	1.0	0.41	1.4	98310390
190220	1,2-DIBROMO-3-CHLOROPROPANE	N		UG/L	0.02	0.2		Table 1	M	M	M	1.0	0.39	1.3	98310390
190220	1,2-DIBROMOETHANE (EDB)	N		UG/L	0.005	0.05		Table 1	M	M	M	1.0	0.73	2.4	98310390
190220	1,2-DICHLOROETHANE	N		UG/L	0.5	5		Table 1	M	M	M	1.0	0.21	0.70	98310390
190220	1,2-DICHLOROPROPANE	N		UG/L	0.5	5		Table 1	M	M	M	1.0	0.72	2.4	98310390
190220	2-HEXANONE	N		UG/L					M	M	M	5.0	1.2	4.1	98310390
190220	4-METHYL-2-PENTANONE (MIBK)	N		UG/L	50	500		Table 1	M	M	M	5.0	2.1	7.0	98310390
190220	ACETONE	N		UG/L	1800	9000		Table 1	M	M	M	10	3.0	10	98310390
190220	ALKALINITY-TOTAL AS CaCO3 (FILT)		372	MG/L					M	M	M	40.0	16.0	53.3	98310390
190220	ARSENIC-DISSOLVED AS AS	N		UG/L	1	10		Table 1	M	M	M	1.0	0.27	0.90	98310390
190220	BARIUM-DISSOLVED AS BA		65.8	UG/L	400	2000		Table 1	M	M	M	5.0	0.70	2.3	98310390
190220	BENZENE	N		UG/L	0.5	5		Table 1	M	M	M	1.0	0.41	1.4	98310390
190220	BROMODICHLOROMETHANE	N		UG/L	0.06	0.6		Table 1	M	M	M	1.0	0.39	1.3	98310390
190220	BROMOMETHANE	N		UG/L	1	10		Table 1	M	M	M	1.0	0.69	2.3	98310390
190220	CARBON DISULFIDE	N		UG/L	200	1000		Table 1	M	M	M	1.0	0.19	0.63	98310390
190220	CARBON TETRACHLORIDE	N		UG/L	0.5	5		Table 1	M	M	M	1.0	0.27	0.90	98310390
190220	CHLOROBENZENE	N		UG/L	20	100		Table 1	M	M	M	1.0	0.75	2.5	98310390
190220	CHLOROETHANE	N		UG/L	80	400		Table 1	M	M	M	1.0	0.32	1.1	98310390
190220	CHLOROFORM	N		UG/L	0.6	6		Table 1	M	M	M	1.0	0.34	1.1	98310390
190220	CHLOROMETHANE	N		UG/L	3	30		Table 1	M	M	M	1.0	0.35	1.2	98310390
190220	CIS-1,2-DICHLOROETHENE	N		UG/L	7	70		Table 1	M	M	M	1.0	0.81	2.7	98310390

Sample Date	Parameter	Qualifier	Value	Units	PAL	ES	Type of Exceedance	Type of Standard	QC 1	QC 2	QC 3	RL	LOD	LOQ	WDNR Lab Cert
	Sample Point: P32B	WDNR Point ID:	150												
190220	CIS-1,3-DICHLOROPROPENE	N		UG/L	0.04	0.4		Table 1	M	M	M	1.0	0.36	1.2	98310390
190220	DIBROMOCHLOROMETHANE	N		UG/L	6	60		Table 1	M	M	M	1.0	0.32	1.1	98310390
190220	DIBROMOMETHANE	N		UG/L					M	M	M	1.0	0.41	1.4	98310390
190220	DICHLORODIFLUOROMETHANE	N		UG/L	200	1000		Table 1	M	M	M	1.0	0.68	2.3	98310390
190220	DICHLOROMETHANE	N		UG/L	0.5	5		Table 1	M	M	M	1.0	0.44	1.5	98310390
190220	DISSOLVED OXYGEN, FIELD BY PROBE		1.7	MG/L											
190220	ETHYLBENZENE	N		UG/L	140	700		Table 1	M	M	M	1.0	0.74	2.5	98310390
190220	FLUOROTRICHLOROMETHANE	N		UG/L	698	3490		Table 1	M	M	M	1.0	0.88	2.9	98310390
190220	GROUNDWATER ELEVATION		858.38	FT MSL											
190220	IRON-DISSOLVED AS FE	N		MG/L	0.15	0.3		Table 2	M	M	M	0.030	0.019	0.064	98310390
190220	LEAD-DISSOLVED AS PB	J	0.18	UG/L	1.5	15		Table 1	M	M	M	1.5	0.17	0.57	98310390
190220	MANGANESE-DISSOLVED AS MN		21.0	UG/L	60	300		Table 1	M	M	M	10.0	0.40	1.3	98310390
190220	MANGANESE-DISSOLVED AS MN		21.0	UG/L	25	50		Table 2	M	M	M	10.0	0.40	1.3	98310390
190220	M-DICHLOROBENZENE	N		UG/L	120	600		Table 1	M	M	M	1.0	0.78	2.6	98310390
190220	MERCURY-DISSOLVED	N		UG/L	0.2	2		Table 1	M	M	M	0.20	0.12	0.40	98310390
190220	METHYL ETHYL KETONE (MEK)	N		UG/L	800	4000		Table 1	M	M	M	10	1.3	4.4	98310390
190220	METHYL TERT-BUTYL ETHER (MTBE)	N		UG/L	12	60		Table 1	M	M	M	1.0	0.16	0.53	98310390
190220	NAPHTHALENE	N		UG/L	10	100		Table 1	M	M	M	1.0	0.43	1.4	98310390
190220	NITRITE PLUS NITRATE-DISSOLVED AS N		3.0	MG/L	2	10	P	Table 1	M	M	M	0.050	0.020	0.067	98310390
190220	O-DICHLOROBENZENE	N		UG/L	60	600		Table 1	M	M	M	1.0	0.79	2.6	98310390
190220	OXIDATION REDUCTION POTENTIAL		-14.0	MILLIVOLTS											
190220	P-DICHLOROBENZENE	N		UG/L	15	75		Table 1	M	M	M	1.0	0.84	2.8	98310390
190220	PH-FIELD		7.57	SU											
190220	SAMPLE COLOR	N		NONE											
190220	SAMPLE ODOR	N		NONE											
190220	SAMPLE TEMPERATURE		10.4	DEGREES C											
190220	SAMPLE TURBIDITY	N		NONE											
190220	SPECIFIC CONDUCTANCE-FIELD		755	UMHOS/CM											
190220	STYRENE	N		UG/L	10	100		Table 1	M	M	M	1.0	0.73	2.4	98310390
190220	SULFATE-DISSOLVED AS SO4		21.7	MG/L	125	250		Table 2	M	M	M	4.0	0.70	2.3	98310390
190220	TETRACHLOROETHYLENE	N		UG/L	0.5	5		Table 1	M	M	M	1.0	0.36	1.2	98310390
190220	TETRAHYDROFURAN	N		UG/L	10	50		Table 1	M	M	M	5.0	1.3	4.2	98310390

Hagen Farm Landfill
WMI Site Number: 393

License Number: 02981
Facility ID Number:

Sample Date	Parameter	Qualifier	Value	Units	PAL	ES	Type of Exceedance	Type of Standard	QC 1	QC 2	QC 3	RL	LOD	LOQ	WDNR Lab Cert
Sample Point: P32B		WDNR Point ID: 150													
190220	TOLUENE	N		UG/L	160	800		Table 1	M	M	M	1.0	0.51	1.7	98310390
190220	TRANS-1,2-DICHLOROETHENE (TOTAL)	N		UG/L	20	100		Table 1	M	M	M	1.0	0.90	3.0	98310390
190220	TRANS-1,3-DICHLOROPROPENE	N		UG/L	0.04	0.4		Table 1	M	M	M	1.0	0.37	1.2	98310390
190220	TRIBROMOMETHANE	N		UG/L	0.44	4.4		Table 1	M	M	M	1.0	0.26	0.87	98310390
190220	TRICHLOROETHYLENE	N		UG/L	0.5	5		Table 1	M	M	M	1.0	0.46	1.5	98310390
190220	VINYL CHLORIDE	N		UG/L	0.02	0.2		Table 1	M	M	M	0.020	0.004	0.013	98310390
190220	VINYL CHLORIDE	N		UG/L	0.02	0.2		Table 1	M	M	M	1.0	0.90	3.0	98310390
190220	XYLENES-TOTAL	N		UG/L	400	2000		Table 1	M	M	M	2.0	0.66	2.2	98310390
Sample Point: MW33		WDNR Point ID: 155													
190221	1,1,1-TRICHLOROETHANE	N		UG/L	40	200		Table 1	M	M	M	1.0	0.82	2.7	98310390
190221	1,1,2,2-TETRACHLOROETHANE	N		UG/L	0.02	0.2		Table 1	M	M	M	1.0	0.21	0.70	98310390
190221	1,1,2-TRICHLOROETHANE	N		UG/L	0.5	5		Table 1	M	M	M	1.0	0.23	0.77	98310390
190221	1,1-DICHLOROETHANE	N		UG/L	85	850		Table 1	M	M	M	1.0	0.38	1.3	98310390
190221	1,1-DICHLOROETHYLENE	N		UG/L	0.7	7		Table 1	M	M	M	1.0	0.29	0.97	98310390
190221	1,2,4-TRICHLOROBENZENE	N		UG/L	14	70		Table 1	M	M	M	1.0	0.41	1.4	98310390
190221	1,2-DIBROMO-3-CHLOROPROPANE	N		UG/L	0.02	0.2		Table 1	M	M	M	1.0	0.39	1.3	98310390
190221	1,2-DIBROMOETHANE (EDB)	N		UG/L	0.005	0.05		Table 1	M	M	M	1.0	0.73	2.4	98310390
190221	1,2-DICHLOROETHANE	N		UG/L	0.5	5		Table 1	M	M	M	1.0	0.21	0.70	98310390
190221	1,2-DICHLOROPROPANE	N		UG/L	0.5	5		Table 1	M	M	M	1.0	0.72	2.4	98310390
190221	2-HEXANONE	N		UG/L					M	M	M	5.0	1.2	4.1	98310390
190221	4-METHYL-2-PENTANONE (MIBK)	N		UG/L	50	500		Table 1	M	M	M	5.0	2.1	7.0	98310390
190221	ACETONE	N		UG/L	1800	9000		Table 1	M	M	M	10	3.0	10	98310390
190221	ALKALINITY-TOTAL AS CaCO3 (FILT)		413	MG/L					M	M	M	50.0	20.0	66.7	98310390
190221	ARSENIC-DISSOLVED AS AS	J	0.27	UG/L	1	10		Table 1	M	M	M	1.0	0.27	0.90	98310390
190221	BARIUM-DISSOLVED AS BA		80.6	UG/L	400	2000		Table 1	M	M	M	5.0	0.70	2.3	98310390
190221	BENZENE	N		UG/L	0.5	5		Table 1	M	M	M	1.0	0.41	1.4	98310390
190221	BROMODICHLOROMETHANE	N		UG/L	0.06	0.6		Table 1	M	M	M	1.0	0.39	1.3	98310390
190221	BROMOMETHANE	N		UG/L	1	10		Table 1	M	M	M	1.0	0.69	2.3	98310390
190221	CARBON DISULFIDE	N		UG/L	200	1000		Table 1	M	M	M	1.0	0.19	0.63	98310390
190221	CARBON TETRACHLORIDE	N		UG/L	0.5	5		Table 1	M	M	M	1.0	0.27	0.90	98310390
190221	CHLOROBENZENE	N		UG/L	20	100		Table 1	M	M	M	1.0	0.75	2.5	98310390
190221	CHLOROETHANE	N		UG/L	80	400		Table 1	M	M	M	1.0	0.32	1.1	98310390

Sample Date	Parameter	Qualifier	Value	Units	PAL	ES	Type of Exceedance	Type of Standard	QC 1	QC 2	QC 3	RL	LOD	LOQ	WDNR Lab Cert
	Sample Point: MW33	WDNR Point ID:	155												
190221	CHLOROFORM	N		UG/L	0.6	6		Table 1	M	M	M	1.0	0.34	1.1	98310390
190221	CHLOROMETHANE	N		UG/L	3	30		Table 1	M	M	M	1.0	0.35	1.2	98310390
190221	CIS-1,2-DICHLOROETHENE	N		UG/L	7	70		Table 1	M	M	M	1.0	0.81	2.7	98310390
190221	CIS-1,3-DICHLOROPROPENE	N		UG/L	0.04	0.4		Table 1	M	M	M	1.0	0.36	1.2	98310390
190221	DIBROMOCHLOROMETHANE	N		UG/L	6	60		Table 1	M	M	M	1.0	0.32	1.1	98310390
190221	DIBROMOMETHANE	N		UG/L					M	M	M	1.0	0.41	1.4	98310390
190221	DICHLORODIFLUOROMETHANE	N		UG/L	200	1000		Table 1	M	M	M	1.0	0.68	2.3	98310390
190221	DICHLOROMETHANE	N		UG/L	0.5	5		Table 1	M	M	M	1.0	0.44	1.5	98310390
190221	DISSOLVED OXYGEN, FIELD BY PROBE		2.6	MG/L											
190221	ETHYLBENZENE	N		UG/L	140	700		Table 1	M	M	M	1.0	0.74	2.5	98310390
190221	FLUOROTRICHLOROMETHANE	N		UG/L	698	3490		Table 1	M	M	M	1.0	0.88	2.9	98310390
190221	GROUNDWATER ELEVATION		861.06	FT MSL											
190221	IRON-DISSOLVED AS FE		0.13	MG/L	0.15	0.3		Table 2	M	M	M	0.030	0.019	0.064	98310390
190221	LEAD-DISSOLVED AS PB	N		UG/L	1.5	15		Table 1	M	M	M	1.5	0.17	0.57	98310390
190221	MANGANESE-DISSOLVED AS MN		152	UG/L	60	300	P	Table 1	M	M	M	10.0	0.40	1.3	98310390
190221	MANGANESE-DISSOLVED AS MN		152	UG/L	25	50	P*	Table 2	M	M	M	10.0	0.40	1.3	98310390
190221	M-DICHLOROBENZENE	N		UG/L	120	600		Table 1	M	M	M	1.0	0.78	2.6	98310390
190221	MERCURY-DISSOLVED	N		UG/L	0.2	2		Table 1	M	M	M	0.20	0.12	0.40	98310390
190221	METHYL ETHYL KETONE (MEK)	N		UG/L	800	4000		Table 1	M	M	M	10	1.3	4.4	98310390
190221	METHYL TERT-BUTYL ETHER (MTBE)	N		UG/L	12	60		Table 1	M	M	M	1.0	0.16	0.53	98310390
190221	NAPHTHALENE	N		UG/L	10	100		Table 1	M	M	M	1.0	0.43	1.4	98310390
190221	NITRITE PLUS NITRATE-DISSOLVED AS N	N		MG/L	2	10		Table 1	M	M	M	0.050	0.020	0.067	98310390
190221	O-DICHLOROBENZENE	N		UG/L	60	600		Table 1	M	M	M	1.0	0.79	2.6	98310390
190221	OXIDATION REDUCTION POTENTIAL		26.0	MILLIVOLTS											
190221	P-DICHLOROBENZENE	N		UG/L	15	75		Table 1	M	M	M	1.0	0.84	2.8	98310390
190221	PH-FIELD		7.41	SU											
190221	SAMPLE COLOR	N		NONE											
190221	SAMPLE ODOR	N		NONE											
190221	SAMPLE TEMPERATURE		12.9	DEGREES C											
190221	SAMPLE TURBIDITY	N		NONE											
190221	SPECIFIC CONDUCTANCE-FIELD		706	UMHOS/CM											
190221	STYRENE	N		UG/L	10	100		Table 1	M	M	M	1.0	0.73	2.4	98310390

Sample Date	Parameter	Qualifier	Value	Units	PAL	ES	Type of Exceedance	Type of Standard	QC 1	QC 2	QC 3	RL	LOD	LOQ	WDNR Lab Cert
Sample Point: MW33		WDNR Point ID: 155													
190221	SULFATE-DISSOLVED AS SO4	J	0.56	MG/L	125	250		Table 2	M	M	M	2.0	0.35	1.2	98310390
190221	TETRACHLOROETHYLENE	N		UG/L	0.5	5		Table 1	M	M	M	1.0	0.36	1.2	98310390
190221	TETRAHYDROFURAN	N		UG/L	10	50		Table 1	M	M	F	5.0	1.3	4.2	98310390
190221	TOLUENE	N		UG/L	160	800		Table 1	M	M	M	1.0	0.51	1.7	98310390
190221	TRANS-1,2-DICHLOROETHENE (TOTAL)	N		UG/L	20	100		Table 1	M	M	M	1.0	0.90	3.0	98310390
190221	TRANS-1,3-DICHLOROPROPENE	N		UG/L	0.04	0.4		Table 1	M	M	M	1.0	0.37	1.2	98310390
190221	TRIBROMOMETHANE	N		UG/L	0.44	4.4		Table 1	M	M	M	1.0	0.26	0.87	98310390
190221	TRICHLOROETHYLENE	N		UG/L	0.5	5		Table 1	M	M	M	1.0	0.46	1.5	98310390
190221	VINYL CHLORIDE	N		UG/L	0.02	0.2		Table 1	M	M	M	0.020	0.004	0.013	98310390
190221	VINYL CHLORIDE	N		UG/L	0.02	0.2		Table 1	M	M	M	1.0	0.90	3.0	98310390
190221	XYLENES-TOTAL	N		UG/L	400	2000		Table 1	M	M	M	2.0	0.66	2.2	98310390
Sample Point: P33B		WDNR Point ID: 160													
190221	GROUNDWATER ELEVATION		860.96	FT MSL											
Sample Point: P35B		WDNR Point ID: 165													
190221	GROUNDWATER ELEVATION		856.35	FT MSL											
Sample Point: P40D		WDNR Point ID: 170													
190221	GROUNDWATER ELEVATION		861.49	FT MSL											
Sample Point: MW100		WDNR Point ID: 175													
190221	GROUNDWATER ELEVATION		865.44	FT MSL											
Sample Point: 01FB		WDNR Point ID: 997													
190220	1,1,1-TRICHLOROETHANE	N		UG/L					M	M		1.0	0.82	2.7	98310390
190220	1,1,2,2-TETRACHLOROETHANE	N		UG/L					M	M		1.0	0.21	0.70	98310390
190220	1,1,2-TRICHLOROETHANE	N		UG/L					M	M		1.0	0.23	0.77	98310390
190220	1,1-DICHLOROETHANE	N		UG/L					M	M		1.0	0.38	1.3	98310390
190220	1,1-DICHLOROETHYLENE	N		UG/L					M	M		1.0	0.29	0.97	98310390
190220	1,2,4-TRICHLOROBENZENE	N		UG/L					M	M		1.0	0.41	1.4	98310390
190220	1,2-DIBROMO-3-CHLOROPROPANE	N		UG/L					M	M		1.0	0.39	1.3	98310390
190220	1,2-DIBROMOETHANE (EDB)	N		UG/L					M	M		1.0	0.73	2.4	98310390
190220	1,2-DICHLOROETHANE	N		UG/L					M	M		1.0	0.21	0.70	98310390
190220	1,2-DICHLOROPROPANE	N		UG/L					M	M		1.0	0.72	2.4	98310390
190220	2-HEXANONE	N		UG/L					M	M		5.0	1.2	4.1	98310390
190220	4-METHYL-2-PENTANONE (MIBK)	N		UG/L					M	M		5.0	2.1	7.0	98310390

Hagen Farm Landfill
WMI Site Number: 393

License Number: 02981
Facility ID Number:

Sample Date	Parameter	Qualifier	Value	Units	PAL	ES	Type of Exceedance	Type of Standard	QC 1	QC 2	QC 3	RL	LOD	LOQ	WDNR Lab Cert
	Sample Point: 01FB	WDNR Point ID:	997												
190220	ACETONE	N		UG/L					M	M		10	3.0	10	98310390
190220	ALKALINITY-TOTAL AS CaCO3 (FILT)	N		MG/L					M	M		10.0	4.0	13.3	98310390
190220	ARSENIC-DISSOLVED AS AS	N		UG/L					M	M		1.0	0.27	0.90	98310390
190220	BARIUM-DISSOLVED AS BA	N		UG/L					M	M		5.0	0.70	2.3	98310390
190220	BENZENE	N		UG/L					M	M		1.0	0.41	1.4	98310390
190220	BROMODICHLOROMETHANE	N		UG/L					M	M		1.0	0.39	1.3	98310390
190220	BROMOMETHANE	N		UG/L					M	M		1.0	0.69	2.3	98310390
190220	CARBON DISULFIDE	N		UG/L					M	M		1.0	0.19	0.63	98310390
190220	CARBON TETRACHLORIDE	N		UG/L					M	M		1.0	0.27	0.90	98310390
190220	CHLOROBENZENE	N		UG/L					M	M		1.0	0.75	2.5	98310390
190220	CHLOROETHANE	N		UG/L					M	M		1.0	0.32	1.1	98310390
190220	CHLOROFORM	N		UG/L					M	M		1.0	0.34	1.1	98310390
190220	CHLOROMETHANE	N		UG/L					M	M		1.0	0.35	1.2	98310390
190220	CIS-1,2-DICHLOROETHENE	N		UG/L					M	M		1.0	0.81	2.7	98310390
190220	CIS-1,3-DICHLOROPROPENE	N		UG/L					M	M		1.0	0.36	1.2	98310390
190220	DIBROMOCHLOROMETHANE	N		UG/L					M	M		1.0	0.32	1.1	98310390
190220	DIBROMOMETHANE	N		UG/L					M	M		1.0	0.41	1.4	98310390
190220	DICHLORODIFLUOROMETHANE	N		UG/L					M	M		1.0	0.68	2.3	98310390
190220	DICHLOROMETHANE	J	0.85	UG/L					M	M		1.0	0.44	1.5	98310390
190220	DISSOLVED OXYGEN, FIELD BY PROBE		5.0	MG/L											
190220	ETHYLBENZENE	N		UG/L					M	M		1.0	0.74	2.5	98310390
190220	FLUOROTRICHLOROMETHANE	N		UG/L					M	M		1.0	0.88	2.9	98310390
190220	IRON-DISSOLVED AS FE	N		MG/L					M	M		0.030	0.019	0.064	98310390
190220	LEAD-DISSOLVED AS PB	N		UG/L					M	M		1.5	0.17	0.57	98310390
190220	MANGANESE-DISSOLVED AS MN	N		UG/L					M	M		10.0	0.40	1.3	98310390
190220	M-DICHLOROBENZENE	N		UG/L					M	M		1.0	0.78	2.6	98310390
190220	MERCURY-DISSOLVED	N		UG/L					M	M		0.20	0.12	0.40	98310390
190220	METHYL ETHYL KETONE (MEK)	N		UG/L					M	M		10	1.3	4.4	98310390
190220	METHYL TERT-BUTYL ETHER (MTBE)	N		UG/L					M	M		1.0	0.16	0.53	98310390
190220	NAPHTHALENE	N		UG/L					M	M		1.0	0.43	1.4	98310390
190220	NITRITE PLUS NITRATE-DISSOLVED AS N	N		MG/L					M	M		0.050	0.020	0.067	98310390
190220	O-DICHLOROBENZENE	N		UG/L					M	M		1.0	0.79	2.6	98310390

Hagen Farm Landfill
WMI Site Number: 393

License Number: 02981
Facility ID Number:

Sample Date	Parameter	Qualifier	Value	Units	PAL	ES	Type of Exceedance	Type of Standard	QC 1	QC 2	QC 3	RL	LOD	LOQ	WDNR Lab Cert
Sample Point: 01FB		WDNR Point ID: 997													
190220	OXIDATION REDUCTION POTENTIAL		-36	MILLIVOLTS											
190220	P-DICHLOROBENZENE	N		UG/L					M	M		1.0	0.84	2.8	98310390
190220	PH-FIELD		8.56	SU											
190220	SAMPLE COLOR	N		NONE											
190220	SAMPLE ODOR	N		NONE											
190220	SAMPLE TEMPERATURE		10.6	DEGREES C											
190220	SAMPLE TURBIDITY	N		NONE											
190220	SPECIFIC CONDUCTANCE-FIELD		4	UMHOS/CM											
190220	STYRENE	N		UG/L					M	M		1.0	0.73	2.4	98310390
190220	SULFATE-DISSOLVED AS SO4	N		MG/L					M	M		2.0	0.35	1.2	98310390
190220	TETRACHLOROETHYLENE	N		UG/L					M	M		1.0	0.36	1.2	98310390
190220	TETRAHYDROFURAN	N		UG/L					M	F		5.0	1.3	4.2	98310390
190220	TOLUENE	N		UG/L					M	M		1.0	0.51	1.7	98310390
190220	TRANS-1,2-DICHLOROETHENE (TOTAL)	N		UG/L					M	M		1.0	0.90	3.0	98310390
190220	TRANS-1,3-DICHLOROPROPENE	N		UG/L					M	M		1.0	0.37	1.2	98310390
190220	TRIBROMOMETHANE	N		UG/L					M	M		1.0	0.26	0.87	98310390
190220	TRICHLOROETHYLENE	N		UG/L					M	M		1.0	0.46	1.5	98310390
190220	VINYL CHLORIDE	N		UG/L					M	M		0.020	0.004	0.013	98310390
190220	VINYL CHLORIDE	N		UG/L					M	M		1.0	0.90	3.0	98310390
190220	XYLENES-TOTAL	N		UG/L					M	M		2.0	0.66	2.2	98310390
Sample Point: 01TB		WDNR Point ID: 999													
190221	1,1,1-TRICHLOROETHANE	N		UG/L					M	M		1.0	0.82	2.7	98310390
190221	1,1,2,2-TETRACHLOROETHANE	N		UG/L					M	M		1.0	0.21	0.70	98310390
190221	1,1,2-TRICHLOROETHANE	N		UG/L					M	M		1.0	0.23	0.77	98310390
190221	1,1-DICHLOROETHANE	N		UG/L					M	M		1.0	0.38	1.3	98310390
190221	1,1-DICHLOROETHYLENE	N		UG/L					M	M		1.0	0.29	0.97	98310390
190221	1,2,4-TRICHLOROBENZENE	N		UG/L					M	M		1.0	0.41	1.4	98310390
190221	1,2-DIBROMO-3-CHLOROPROPANE	N		UG/L					M	M		1.0	0.39	1.3	98310390
190221	1,2-DIBROMOETHANE (EDB)	N		UG/L					M	M		1.0	0.73	2.4	98310390
190221	1,2-DICHLOROETHANE	N		UG/L					M	M		1.0	0.21	0.70	98310390
190221	1,2-DICHLOROPROPANE	N		UG/L					M	M		1.0	0.72	2.4	98310390
190221	2-HEXANONE	N		UG/L					M	M		5.0	1.2	4.1	98310390

Hagen Farm Landfill
WMI Site Number: 393

License Number: 02981
Facility ID Number:

Sample Date	Parameter	Qualifier	Value	Units	PAL	ES	Type of Exceedance	Type of Standard	QC 1	QC 2	QC 3	RL	LOD	LOQ	WDNR Lab Cert
	Sample Point: 01TB		WDNR Point ID: 999												
190221	4-METHYL-2-PENTANONE (MIBK)	N		UG/L					M	M		5.0	2.1	7.0	98310390
190221	ACETONE	N		UG/L					M	M		10	3.0	10	98310390
190221	BENZENE	N		UG/L					M	M		1.0	0.41	1.4	98310390
190221	BROMODICHLOROMETHANE	N		UG/L					M	M		1.0	0.39	1.3	98310390
190221	BROMOMETHANE	N		UG/L					M	M		1.0	0.69	2.3	98310390
190221	CARBON DISULFIDE	N		UG/L					M	M		1.0	0.19	0.63	98310390
190221	CARBON TETRACHLORIDE	N		UG/L					M	M		1.0	0.27	0.90	98310390
190221	CHLOROBENZENE	N		UG/L					M	M		1.0	0.75	2.5	98310390
190221	CHLOROETHANE	N		UG/L					M	M		1.0	0.32	1.1	98310390
190221	CHLOROFORM	N		UG/L					M	M		1.0	0.34	1.1	98310390
190221	CHLOROMETHANE	N		UG/L					M	F		1.0	0.35	1.2	98310390
190221	CIS-1,2-DICHLOROETHENE	N		UG/L					M	M		1.0	0.81	2.7	98310390
190221	CIS-1,3-DICHLOROPROPENE	N		UG/L					M	M		1.0	0.36	1.2	98310390
190221	DIBROMOCHLOROMETHANE	N		UG/L					M	M		1.0	0.32	1.1	98310390
190221	DIBROMOMETHANE	N		UG/L					M	M		1.0	0.41	1.4	98310390
190221	DICHLORODIFLUOROMETHANE	N		UG/L					M	F		1.0	0.68	2.3	98310390
190221	DICHLOROMETHANE	N		UG/L					M	M		1.0	0.44	1.5	98310390
190221	ETHYLBENZENE	N		UG/L					M	M		1.0	0.74	2.5	98310390
190221	FLUOROTRICHLOROMETHANE	N		UG/L					M	M		1.0	0.88	2.9	98310390
190221	M-DICHLOROBENZENE	N		UG/L					M	M		1.0	0.78	2.6	98310390
190221	METHYL ETHYL KETONE (MEK)	N		UG/L					M	M		10	1.3	4.4	98310390
190221	METHYL TERT-BUTYL ETHER (MTBE)	N		UG/L					M	M		1.0	0.16	0.53	98310390
190221	NAPHTHALENE	N		UG/L					M	M		1.0	0.43	1.4	98310390
190221	O-DICHLOROBENZENE	N		UG/L					M	M		1.0	0.79	2.6	98310390
190221	P-DICHLOROBENZENE	N		UG/L					M	M		1.0	0.84	2.8	98310390
190221	STYRENE	N		UG/L					M	M		1.0	0.73	2.4	98310390
190221	TETRACHLOROETHYLENE	N		UG/L					M	M		1.0	0.36	1.2	98310390
190221	TETRAHYDROFURAN	N		UG/L					M	M		5.0	1.3	4.2	98310390
190221	TOLUENE	N		UG/L					M	M		1.0	0.51	1.7	98310390
190221	TRANS-1,2-DICHLOROETHENE (TOTAL)	N		UG/L					M	M		1.0	0.90	3.0	98310390
190221	TRANS-1,3-DICHLOROPROPENE	N		UG/L					M	M		1.0	0.37	1.2	98310390
190221	TRIBROMOMETHANE	N		UG/L					M	M		1.0	0.26	0.87	98310390

Hagen Farm Landfill
WMI Site Number: 393

License Number: 02981
Facility ID Number:

Sample Date	Parameter	Qualifier	Value	Units	PAL	ES	Type of Exceedance	Type of Standard	QC 1	QC 2	QC 3	RL	LOD	LOQ	WDNR Lab Cert
Sample Point: 01TB		WDNR Point ID: 999													
190221	TRICHLOROETHYLENE	N		UG/L					M	M		1.0	0.46	1.5	98310390
190221	VINYL CHLORIDE	N		UG/L					M	M		1.0	0.90	3.0	98310390
190221	XYLENES-TOTAL	N		UG/L					M	M		2.0	0.66	2.2	98310390