



CH2MHILL

Received

AUG 27 2009

REMEDICATION &
REDEVELOPMENT

CH2M HILL
135 S 84th Street
Suite 325
Milwaukee WI 53214
Tel 414-272-2426 X40332
Fax 414-272-4408

August 26, 2009

Ms. Wendy Weihemuller
Wisconsin Department of Natural Resources
3911 Fish Hatchery Road
Fitchburg, WI 53711

Subject: Exception Request to NR 141.25 Well Abandonment Requirements,
Wisconsin Unique Well Number Request

Dear Ms. Weihemuller:

On behalf of the United States Environmental Protection Agency (USEPA), CH2M HILL would like to request an exception to the required depth below ground surface for casing removal during well abandonment as outlined in Wisconsin Administrative Code (WAC) NR 141.25 at the former Oconomowoc Electroplating Company, Inc. facility located in Ashippun, Wisconsin (WID006100275).

CH2M HILL recently performed some site well maintenance, which included the abandonment of five 6-inch groundwater extraction wells associated with historical operation of a groundwater extraction and treatment remediation system at the facility. The WAC NR 141.25(2)(b) required abandonment depth of 30 inches below ground surface (bgs) could not be reached at two of the former site extraction wells (EW-1 and EW-4) due to the unexpected presence of large concrete slabs surrounding the well casings at depth. The concrete slabs extended to greater than 30 inches bgs and could only be partially removed using a jackhammer and an excavator. Therefore, the 6-inch steel well casing at these two extraction well locations could not be safely cut off at 30 inches bgs. The depths of abandonment for EW-1 and EW-4 were measured at 24 inches bgs and 12 inches bgs, respectively. Each well was sealed using bentonite chips and the ground surface was returned to its natural state and original grade. Well abandonment forms for the wells recently abandoned at the site, including these two extraction wells, have been enclosed for your records.

CH2M HILL would also like to request a Wisconsin Unique Well Number for a replacement well (MW-14DR) that was installed at the site on July 9, 2009. This well was installed to replace the monitoring well MW-14 (WI Unique Well # PL130), which was destroyed during local road construction completed by the Town of Ashippun.

A copy of the Monitoring Well Construction Form for MW-14DR and a site map showing the locations of the former well locations are also enclosed. Please let us know if you have concerns regarding this exception request or if you require additional information.

Sincerely,

CH2M HILL, Inc.

A handwritten signature in black ink that reads "Matt Boekenhauer". The signature is written in a cursive style with a long, sweeping underline.

Matt Boekenhauer
Site Manager

c: William J. Ryan/USEPA
Gary Edelstein/WDNR
Jon Tortomasi/CH2M HILL

Notice: Completion of this report is required by chs. 160, 281, 283, 289, 291-293, 295, and 299, Wis. Stats., and ch. NR 141, Wis. Adm. Code. In accordance with chs. 281, 289, 291-293, 295, and 299, Wis. Stats., failure to file this form may result in a forfeiture of between \$10-25,000, or imprisonment for up to one year, depending on the program and conduct involved. Personally identifiable information on this form is not intended to be used for any other purpose. Return form to the appropriate DNR office and bureau. See instructions on reverse for more information.

Route to:

Drinking Water Watershed/Wastewater Waste Management Remediation/Redevelopment Other: _____

1. General Information **2. Facility / Owner Information**

WI Unique Well No. PC926 DNR Well ID No. _____ County Dodge Facility Name Acronomowoc Electroplating Facility

Common Well Name EW1 Gov't Lot # (if applicable) _____ Facility ID _____ License/Permit/Monitoring No. _____

1/4 1/4 NW 1/4 SE Section 30 Township 9 N Range 17 E W Street Address of Well 2572 W. Oak Street

Well Location ft. / M (Local Grid) Datum _____ City, Village or Town Ashippun, WI

446132.71 N / S 2393846.06 E / W 853.74 Present Well Owner USEPA Original Well Owner USEPA

WTM- UTM- Latitude/Longitude- State Plane- S C N Zone _____ Street Address or Route of Present Owner 77 W. Jackson Blvd.

Local Grid Origin ft. / M Datum _____ City Chicago State IL ZIP Code 60604

WTM- UTM- Latitude/Longitude- State Plane- S C N Zone _____

Reason For Abandonment No longer in use WI Unique Well No. of Replacement Well _____

3. Well / Drillhole / Borehole Information **4. Pump, Liner, Screen, Casing & Sealing Material**

Monitoring Well Original Construction Date 10/4/1995
 Water Well
 Borehole / Drillhole If a Well Construction Report is available, please attach.

Construction Type:
 Drilled Driven (Sandpoint) Dug
 Other (specify): _____

Formation Type:
 Unconsolidated Formation Bedrock

Total Well Depth From Groundsurface (ft.) 41 ft Casing Diameter (in.) 6"

Lower Drillhole Diameter (in.) _____ Casing Depth (ft.) _____

Was well annular space grouted? Yes No Unknown

If yes, to what depth (feet)? _____ Depth to Water (feet) _____

5. Material Used To Fill Well / Drillhole

| From (ft.) | To (ft.) | No. Yards, Sacks Sealant or Volume (circle one) | Mix Ratio or Mud Weight |
|------------|----------|---|-------------------------|
| Surface | 41 ft | 11 bags / 550 lbs | |

6. Comments

Cut 24" bgs due to concrete slab around well casing.

7. Supervision of Work **DNR Use Only**

Name of Person or Firm Doing Sealing Work Coleman Engineering Co. Date of Abandonment 7/8/09 Date Received _____ Noted By _____

Street or Route 635 Circle Drive Telephone Number 9067743440 Comments _____

City Iron Mountain State MI ZIP Code 49801 Signature of Person Doing Work [Signature] Date Signed 7-9-09

Notice: Completion of this report is required by chs. 160, 281, 283, 289, 291-293, 295, and 299, Wis. Stats., and ch. NR 141, Wis. Adm. Code. In accordance with chs. 281, 289, 291-293, 295, and 299, Wis. Stats., failure to file this form may result in a forfeiture of between \$10-25,000, or imprisonment for up to one year, depending on the program and conduct involved. Personally identifiable information on this form is not intended to be used for any other purpose. Return form to the appropriate DNR office and bureau. See instructions on reverse for more information.

Route to: Drinking Water Watershed/Wastewater Waste Management Remediation/Redevelopment Other:

1. General Information **2. Facility / Owner Information**

| | | | |
|--|-----------------------------|--|--|
| WI Unique Well No. PC 927 | DNR Well ID No. | County Dodge | Facility Name Oconomowoc Electroplating Facility |
| Common Well Name EW-2 | Gov't Lot # (if applicable) | | Facility ID |
| 1/4 1/4 NW SE | Section 30 | Township 9 N | Range 17 E |
| Well Location <input checked="" type="checkbox"/> L / <input checked="" type="checkbox"/> M (Local Grid <input type="checkbox"/>) Datum | | Street Address of Well 2572 W. Oak Street | |
| 445928.14 N / S 2393676.41 E / W 852.41 | | City, Village or Town Ashippun, WI | |
| WTM- <input type="checkbox"/> UTM- <input type="checkbox"/> Latitude/Longitude- <input type="checkbox"/> State Plane- <input type="checkbox"/> <input checked="" type="checkbox"/> S <input checked="" type="checkbox"/> C <input checked="" type="checkbox"/> N | | Present Well Owner USEPA | |
| Local Grid Origin <input checked="" type="checkbox"/> L / <input checked="" type="checkbox"/> M Datum | | Original Well Owner USEPA | |
| _____ N, _____ E / W | | Street Address or Route of Present Owner 77 W. Jackson Blvd. | |
| WTM- <input type="checkbox"/> UTM- <input type="checkbox"/> Latitude/Longitude- <input type="checkbox"/> State Plane- <input type="checkbox"/> <input checked="" type="checkbox"/> S <input checked="" type="checkbox"/> C <input checked="" type="checkbox"/> N | | City Chicago | |
| Reason For Abandonment No longer in use | | State IL | |
| WI Unique Well No. of Replacement Well | | ZIP Code 60604 | |

3. Well / Drillhole / Borehole Information **4. Pump, Liner, Screen, Casing & Sealing Material**

| | | |
|---|---|--|
| <input checked="" type="checkbox"/> Monitoring Well | Original Construction Date 10/9/1995 | Pump and piping removed? <input checked="" type="checkbox"/> Yes <input type="checkbox"/> No <input type="checkbox"/> N/A |
| <input type="checkbox"/> Water Well | If a Well Construction Report is available, please attach. | Liner(s) removed? <input type="checkbox"/> Yes <input type="checkbox"/> No <input checked="" type="checkbox"/> N/A |
| <input type="checkbox"/> Borehole / Drillhole | | Screen removed? <input type="checkbox"/> Yes <input checked="" type="checkbox"/> No <input type="checkbox"/> N/A |
| Construction Type: | | Casing left in place? <input checked="" type="checkbox"/> Yes <input type="checkbox"/> No <input type="checkbox"/> N/A |
| <input checked="" type="checkbox"/> Drilled | <input type="checkbox"/> Driven (Sandpoint) | Was casing cut off below surface? <input checked="" type="checkbox"/> Yes <input type="checkbox"/> No <input type="checkbox"/> N/A |
| <input type="checkbox"/> Other (specify): _____ | <input type="checkbox"/> Dug | Did sealing material rise to surface? <input checked="" type="checkbox"/> Yes <input type="checkbox"/> No <input type="checkbox"/> N/A |
| Formation Type: | <input checked="" type="checkbox"/> Unconsolidated Formation <input type="checkbox"/> Bedrock | Did material settle after 24 hours? <input type="checkbox"/> Yes <input checked="" type="checkbox"/> No <input type="checkbox"/> N/A |
| Total Well Depth From Groundsurface (ft.) 41 ft | Casing Diameter (in.) 6 inches | If yes, was hole retopped? <input type="checkbox"/> Yes <input type="checkbox"/> No <input checked="" type="checkbox"/> N/A |
| Lower Drillhole Diameter (in.) | Casing Depth (ft.) | If bentonite chips were used, were they hydrated with water from a known safe source? <input type="checkbox"/> Yes <input type="checkbox"/> No <input checked="" type="checkbox"/> N/A |
| Was well annular space grouted? <input type="checkbox"/> Yes <input type="checkbox"/> No <input type="checkbox"/> Unknown | Depth to Water (feet) | Required Method of Placing Sealing Material |
| If yes, to what depth (feet)? | | <input type="checkbox"/> Conductor Pipe-Gravity <input type="checkbox"/> Conductor Pipe-Pumped |
| | | <input checked="" type="checkbox"/> Screened & Poured (Bentonite Chips) <input type="checkbox"/> Other (Explain): _____ |
| | | Sealing Materials |
| | | <input type="checkbox"/> Neat Cement Grout <input type="checkbox"/> Clay-Sand Slurry (11 lb./gal. wt.) |
| | | <input type="checkbox"/> Sand-Cement (Concrete) Grout <input type="checkbox"/> Bentonite-Sand Slurry " " |
| | | <input type="checkbox"/> Concrete <input checked="" type="checkbox"/> Bentonite Chips |
| | | For Monitoring Wells and Monitoring Well Boreholes Only: |
| | | <input checked="" type="checkbox"/> Bentonite Chips <input type="checkbox"/> Bentonite - Cement Grout |
| | | <input type="checkbox"/> Granular Bentonite <input type="checkbox"/> Bentonite - Sand Slurry |

| 5. Material Used To Fill Well / Drillhole | From (ft.) | To (ft.) | No. Yards, Sacks Sealant or Volume (circle one) | Mix Ratio or Mud Weight |
|---|------------|--------------|---|-------------------------|
| Bentonite Chips | Surface | 41 ft | 550 lb / 11 bags | |

6. Comments
Cut off well 30" bgs using a cut-off wheel and sawsall.

| | | | |
|---|---|--------------------------|--|
| 7. Supervision of Work | | DNR Use Only | |
| Name of Person or Firm Doing Sealing Work Coleman Engineering Company | Date of Abandonment 7/8/09 | Date Received | Noted By |
| Street or Route 635 Circle Drive | Telephone Number (906) 774-3440 | Comments | |
| City Mon Mountain | State MI | ZIP Code 49801 | Signature of Person Doing Work Don Patzo |
| | | | Date Signed 7-9-09 |

Notice: Completion of this report is required by chs. 160, 281, 283, 289, 291-293; 295, and 299, Wis. Stats., and ch. NR 141, Wis. Adm. Code. In accordance with chs. 281, 289, 291-293, 295, and 299, Wis. Stats., failure to file this form may result in a forfeiture of between \$10-25,000, or imprisonment for up to one year, depending on the program and conduct involved. Personally identifiable information on this form is not intended to be used for any other purpose. Return form to the appropriate DNR office and bureau. See instructions on reverse for more information.

Route to:

Drinking Water Watershed/Wastewater Waste Management Remediation/Redevelopment Other: _____

1 General Information **2 Facility / Owner Information**

| | | | | | | | | | | | | | | |
|--|------------------|----------------------|-----------------------------|--------------------|---|--|---|--|--|--|--------------------------|---------------------|--|--|
| WI Unique Well No. PC 928 | | | DNR Well ID No. | | | County Dodge | | | Facility Name Oconomowoc Electroplating Facility | | | | | |
| Common Well Name EW-3 | | | Gov't Lot # (if applicable) | | | Facility ID | | | License/Permit/Monitoring No. | | | | | |
| 1/4 1/4 NW | 1/4 SE | Section 30 | Township 9 N | Range 17 | <input checked="" type="checkbox"/> E <input type="checkbox"/> W | | Street Address of Well 2572 W. Oak Street | | | | | | | |
| Well Location <input type="checkbox"/> ft. / <input type="checkbox"/> M (Local Grid <input type="checkbox"/>) Datum 445734.99 <input checked="" type="checkbox"/> N <input type="checkbox"/> S 2393972.32 <input type="checkbox"/> E <input checked="" type="checkbox"/> W 849.79 | | | | | | City, Village or Town Ashippun, WI | | | Present Well Owner USEPA | | | Original Well Owner | | |
| WTM- <input type="checkbox"/> UTM- <input type="checkbox"/> Latitude/Longitude- <input type="checkbox"/> State Plane- <input type="checkbox"/> <input type="checkbox"/> S <input type="checkbox"/> C <input type="checkbox"/> N | | | | | | Street Address or Route of Present Owner 77 W. Jackson Blvd. | | | | | | | | |
| Local Grid Origin <input type="checkbox"/> ft. / <input type="checkbox"/> M Datum _____, N, _____ E / W _____ | | | | | | City Chicago | | | State IL | | ZIP Code 60604 | | | |
| WTM- <input type="checkbox"/> UTM- <input type="checkbox"/> Latitude/Longitude- <input type="checkbox"/> State Plane- <input type="checkbox"/> <input type="checkbox"/> S <input type="checkbox"/> C <input type="checkbox"/> N | | | | | | 4 Pump, Liner, Screen, Casing & Sealing Material | | | | | | | | |

Reason For Abandonment **No longer in use** WI Unique Well No. of Replacement Well _____

3 Well / Drillhole / Borehole Information

| | | | |
|--|--|--|--|
| <input checked="" type="checkbox"/> Monitoring Well | | Original Construction Date 10/10/1995 | |
| <input type="checkbox"/> Water Well | | If a Well Construction Report is available, please attach. | |
| <input type="checkbox"/> Borehole / Drillhole | | | |
| Construction Type: <input checked="" type="checkbox"/> Drilled <input type="checkbox"/> Driven (Sandpoint) <input type="checkbox"/> Dug <input type="checkbox"/> Other (specify): _____ | | | |
| Formation Type: <input checked="" type="checkbox"/> Unconsolidated Formation <input type="checkbox"/> Bedrock | | | |
| Total Well Depth From Groundsurface (ft.) 35 ft | | Casing Diameter (in.) 6 inch | |
| Lower Drillhole Diameter (in.) | | Casing Depth (ft.) | |
| Was well annular space grouted? <input type="checkbox"/> Yes <input type="checkbox"/> No <input type="checkbox"/> Unknown | | | |
| If yes, to what depth (feet)? | | Depth to Water (feet) | |
| Required Method of Placing Sealing Material <input type="checkbox"/> Conductor Pipe-Gravity <input type="checkbox"/> Conductor Pipe-Pumped <input checked="" type="checkbox"/> Screened & Poured (Bentonite Chips) <input type="checkbox"/> Other (Explain): _____ | | | |
| Sealing Materials <input type="checkbox"/> Neat Cement Grout <input type="checkbox"/> Clay-Sand Slurry (11 lb./gal. wt.) <input type="checkbox"/> Sand-Cement (Concrete) Grout <input type="checkbox"/> Bentonite-Sand Slurry " " <input type="checkbox"/> Concrete <input checked="" type="checkbox"/> Bentonite Chips | | | |
| For Monitoring Wells and Monitoring Well Boreholes Only: <input checked="" type="checkbox"/> Bentonite Chips <input type="checkbox"/> Bentonite - Cement Grout <input type="checkbox"/> Granular Bentonite <input type="checkbox"/> Bentonite - Sand Slurry | | | |

| 5. Material Used To Fill Well / Drillhole | From (ft.) | To (ft.) | No. Yards, Sacks Sealant or Volume (circle one) | Mix Ratio or Mud Weight |
|---|------------|--------------|---|-------------------------|
| Bentonite Chips | Surface | 35 ft | 350 500 lbs/10bags | |
| | | | | |

6. Comments

Cut off 30" bop

| | | | |
|---|--|---|--------------------------|
| 7. Supervision of Work | | DNR Use Only | |
| Name of Person or Firm Doing Sealing Work Coleman Engineering Co. | | Date of Abandonment 7/9/09 | Date Received |
| Street or Route 635 Circle Drive | | Telephone Number 906 774-3440 | Noted By |
| City Iron Mountain | | State M | ZIP Code 49801 |
| Signature of Person Doing Work Fog Faloy | | Date Signed 7-9-09 | |

Notice: Completion of this report is required by chs. 160, 281, 283, 289, 291-293, 295, and 299, Wis. Stats., and ch. NR 141, Wis. Adm. Code. In accordance with chs. 281, 289, 291-293, 295, and 299, Wis. Stats., failure to file this form may result in a forfeiture of between \$10-25,000, or imprisonment for up to one year, depending on the program and conduct involved. Personally identifiable information on this form is not intended to be used for any other purpose. Return form to the appropriate DNR office and bureau. See instructions on reverse for more information.

Route to:
 Drinking Water Watershed/Wastewater Waste Management Remediation/Redevelopment Other: _____

1 General Information **2 Facility / Owner Information**

| | | | | | | | |
|--|---|--|------------|--|---------------------------------------|--|--|
| WI Unique Well No. PC929 | | DNR Well ID No. | | County Dodge | | Facility Name Oconomowoc Electroplating Facility | |
| Common Well Name EW-4 | | Gov't Lot # (if applicable) | | Facility ID | | License/Permit/Monitoring No. | |
| 1/4 | 1/4 | Section | Township | Range | Zone | | |
| NW | SE | 30 | 9 N | 17 | <input checked="" type="checkbox"/> E | <input type="checkbox"/> W | |
| Well Location (ft./M) (Local Grid <input type="checkbox"/>) | | Datum | | Street Address of Well | | | |
| 445881.61 N/S 2393901.77 E/W 850.78 | | | | 2572 W. Oak St. | | | |
| WTM- <input type="checkbox"/> UTM- <input type="checkbox"/> Latitude/Longitude- <input type="checkbox"/> State Plane- <input type="checkbox"/> S <input type="checkbox"/> C <input type="checkbox"/> N | | Local Grid Origin (ft./M) | | Datum | | City, Village or Town | |
| | | | | | | Ashippun, WI | |
| Reason For Abandonment | | WI Unique Well No. of Replacement Well | | Present Well Owner | | Original Well Owner | |
| No longer in use | | | | USEPA | | USEPA | |
| Construction Type: | | Zone | | Street Address or Route of Present Owner | | | |
| <input checked="" type="checkbox"/> Drilled | <input type="checkbox"/> Driven (Sandpoint) | <input type="checkbox"/> Dug | | 77 W. Jackson Blvd. | | | |
| Formation Type: | | City | | State | | ZIP Code | |
| <input checked="" type="checkbox"/> Unconsolidated Formation | <input type="checkbox"/> Bedrock | Chicago | | IL | | 60604 | |

3 Well / Drillhole / Borehole Information **4 Pump, Liner, Screen, Casing & Sealing Material**

| | | | |
|---|---|---|---|
| Original Construction Date 4/7/1992 | | <input checked="" type="checkbox"/> Pump and piping removed? <input type="checkbox"/> Yes <input type="checkbox"/> No <input type="checkbox"/> N/A <input type="checkbox"/> Liner(s) removed? <input type="checkbox"/> Yes <input type="checkbox"/> No <input checked="" type="checkbox"/> N/A <input type="checkbox"/> Screen removed? <input type="checkbox"/> Yes <input checked="" type="checkbox"/> No <input type="checkbox"/> N/A <input checked="" type="checkbox"/> Casing left in place? <input type="checkbox"/> Yes <input type="checkbox"/> No <input type="checkbox"/> N/A | |
| If a Well Construction Report is available, please attach. | | <input checked="" type="checkbox"/> Was casing cut off below surface? <input type="checkbox"/> Yes <input type="checkbox"/> No <input type="checkbox"/> N/A <input checked="" type="checkbox"/> Did sealing material rise to surface? <input type="checkbox"/> Yes <input type="checkbox"/> No <input type="checkbox"/> N/A <input type="checkbox"/> Did material settle after 24 hours? <input type="checkbox"/> Yes <input checked="" type="checkbox"/> No <input type="checkbox"/> N/A If yes, was hole retopped? <input type="checkbox"/> Yes <input type="checkbox"/> No <input checked="" type="checkbox"/> N/A If bentonite chips were used, were they hydrated with water from a known safe source? <input type="checkbox"/> Yes <input type="checkbox"/> No <input type="checkbox"/> N/A | |
| Construction Type: | | Required Method of Placing Sealing Material | |
| <input checked="" type="checkbox"/> Drilled | <input type="checkbox"/> Driven (Sandpoint) | <input type="checkbox"/> Dug | <input type="checkbox"/> Conductor Pipe-Gravity <input type="checkbox"/> Conductor Pipe-Pumped <input checked="" type="checkbox"/> Screened & Poured (Bentonite Chips) <input type="checkbox"/> Other (Explain): _____ |
| Total Well Depth From Groundsurface (ft.) 20 ft | | Casing Diameter (in.) 6" | |
| Lower Drillhole Diameter (in.) | | Casing Depth (ft.) | |
| Was well annular space grouted? <input type="checkbox"/> Yes <input type="checkbox"/> No <input type="checkbox"/> Unknown | | Sealing Materials | |
| If yes, to what depth (feet)? | | <input type="checkbox"/> Neat Cement Grout <input type="checkbox"/> Clay-Sand Slurry (11 lb./gal. wt.) <input type="checkbox"/> Sand-Cement (Concrete) Grout <input type="checkbox"/> Bentonite-Sand Slurry " " <input type="checkbox"/> Concrete <input checked="" type="checkbox"/> Bentonite Chips | |
| Depth to Water (feet) | | For Monitoring Wells and Monitoring Well Boreholes Only: | |
| | | <input checked="" type="checkbox"/> Bentonite Chips <input type="checkbox"/> Bentonite - Cement Grout <input type="checkbox"/> Granular Bentonite <input type="checkbox"/> Bentonite - Sand Slurry | |

| 5: Material Used To Fill Well / Drillhole | From (ft.) | To (ft.) | No. Yards, Sacks Sealant or Volume (circle one) | Mix-Ratio or Mud Weight |
|---|------------|-------------|---|-------------------------|
| Bentonite Chip | Surface | 20ft | 300 lbs / 6 bags | |

6. Comments
 Cut casing 1' bgs due to 3'x3' concrete slab around well.

| | | | |
|---|--|---|--|
| 7. Supervision of Work | | DNR Use Only | |
| Name of Person or Firm Doing Sealing Work Coleman Engineering Co. | | Date Received | |
| Date of Abandonment 7/8/09 | | Noted By | |
| Street or Route 635 Circle Drive | | Comments | |
| Telephone Number (406) 774-3440 | | Signature of Person Doing Work Dog Peters | |
| City Iron Mountain | | Date Signed 7-9-09 | |
| State MI | | ZIP Code 49801 | |

State of Wisconsin Route to: Solid Waste Haz. Waste Wastewater MONITORING WELL CONSTRUCTION
 Department of Natural Resources Env. Response & Repair Underground Tanks Other Form 4400-113A

Rev. 4-90

| | | |
|---|--|--|
| Facility/Project Name Olanomowoc Electroplating | Local Grid Location of Well <input type="checkbox"/> N. <input type="checkbox"/> E. ft. <input type="checkbox"/> S. ft. <input type="checkbox"/> W. | Well Name MW-14DR |
| Facility License, Permit or Monitoring Number | Grid Origin Location Lat. _____ Long. _____ or St. Plane 43.2147 ft. N. 088.524 ft. W | Wis. Unique Well Number _____ DNR Well Number _____ |
| Type of Well: Water Table Observation Well <input type="checkbox"/> 11 Piezometer <input checked="" type="checkbox"/> 12 | Section Location of Waste/Source <input checked="" type="checkbox"/> E. NW $\frac{1}{4}$ of SE $\frac{1}{4}$ of Sec. 30 , T 9 N, R 17 W. | Date Well Installed 07.09.09 M M D D Y Y |
| Distance Well is From Waste/Source Boundary ft. | Location of Well Relative to Waste/Source U <input type="checkbox"/> Upgradient S <input type="checkbox"/> Sidegradient D <input type="checkbox"/> Downgradient N <input type="checkbox"/> Not Known | Well Installed By: (Persons' Name and Firm) Doug Langtagne Coleman Engineering Co. |
| Is Well A Point of Enforcement Std. Application? <input type="checkbox"/> Yes <input type="checkbox"/> No | | |

| | | |
|---|--|--|
| A. Protective pipe, top elevation 851.29 ft. MSL | | 1. Cap and lock? <input type="checkbox"/> Yes <input type="checkbox"/> No |
| B. Well casing, top elevation 851.00 ft. MSL | | 2. Protective cover pipe: a. Inside diameter: 80 in. b. Length: 1.0 ft. c. Material: Steel Steel <input checked="" type="checkbox"/> 04 Other <input type="checkbox"/> d. Additional protection? <input type="checkbox"/> Yes <input type="checkbox"/> No If yes, describe: _____ |
| C. Land surface elevation 851.23 ft. MSL | | 3. Surface seal: Bentonite <input type="checkbox"/> 30 Concrete <input checked="" type="checkbox"/> 01 Other <input type="checkbox"/> _____ |
| D. Surface seal, bottom 849.73 ft. MSL or 1.5 ft. | | 4. Material between well casing and protective pipe: Bentonite <input checked="" type="checkbox"/> 30 Annular space seal <input type="checkbox"/> _____ Other <input type="checkbox"/> _____ |
| 12. USCS classification of soil near screen: GP <input type="checkbox"/> GM <input type="checkbox"/> GC <input type="checkbox"/> GW <input type="checkbox"/> SW <input type="checkbox"/> SP <input type="checkbox"/> SM <input type="checkbox"/> SC <input type="checkbox"/> ML <input type="checkbox"/> MH <input type="checkbox"/> CL <input type="checkbox"/> CH <input type="checkbox"/> Bedrock _____ | 5. Annular space seal: a. Granular Bentonite <input checked="" type="checkbox"/> 33 b. ___ Lbs/gal mud weight... Bentonite-sand slurry <input type="checkbox"/> 35 c. ___ Lbs/gal mud weight... Bentonite slurry <input type="checkbox"/> 31 d. ___ % Bentonite... Bentonite-cement grout <input type="checkbox"/> 50 e. ___ Ft ³ volume added for any of the above f. How installed: Tremie <input type="checkbox"/> 01 Tremie pumped <input type="checkbox"/> 02 Gravity <input checked="" type="checkbox"/> 08 | |
| 13. Sieve analysis attached? <input type="checkbox"/> Yes <input type="checkbox"/> No | 6. Bentonite seal: a. Bentonite granules <input checked="" type="checkbox"/> 33 b. <input type="checkbox"/> 1/4 in. <input checked="" type="checkbox"/> 3/8 in. <input type="checkbox"/> 1/2 in. Bentonite pellets <input type="checkbox"/> 32 c. Other <input type="checkbox"/> _____ | |
| 14. Drilling method used: Rotary <input type="checkbox"/> 50 Hollow Stem Auger <input checked="" type="checkbox"/> 41 Other <input type="checkbox"/> _____ | 7. Fine sand material: Manufacturer, product name, mesh size a. U.S. Silica Silica Sand b. Volume added _____ ft ³ | |
| 15. Drilling fluid used: Water <input type="checkbox"/> 02 Air <input type="checkbox"/> 01 Drilling Mud <input type="checkbox"/> 03 None <input type="checkbox"/> 99 | 8. Filterpack material: Manufacturer, product, mesh size a. Red Flint Sand & Gravel, Filter & Industrial San b. Volume added _____ ft ³ | |
| 16. Drilling additives used? <input type="checkbox"/> Yes <input type="checkbox"/> No Describe _____ | 9. Well casing: Flush threaded PVC schedule 40 <input checked="" type="checkbox"/> 23 Flush threaded PVC schedule 80 <input type="checkbox"/> 24 Other <input type="checkbox"/> _____ | |
| 17. Source of water (attach analysis): _____ | 10. Screen Material: Stainless steel a. Screen type: Factory cut <input type="checkbox"/> 11 Continuous slot <input checked="" type="checkbox"/> 01 Other <input type="checkbox"/> _____ b. Manufacturer _____ c. Slot size: 0.01 in. d. Slotted length: _____ ft | |
| E. Bentonite seal, top 835.23 ft. MSL or 16.0 ft. | 11. Backfill material (below filter pack): None <input checked="" type="checkbox"/> 14 Other <input type="checkbox"/> _____ Collapsed in | |
| F. Fine sand, top 833.23 ft. MSL or 18.0 ft. | | |
| G. Filter pack, top 831.23 ft. MSL or 20.0 ft. | | |
| H. Screen joint, top 829.33 ft. MSL or 21.9 ft. | | |
| I. Well bottom 819.33 ft. MSL or 31.9 ft. | | |
| J. Filter pack, bottom 819.33 ft. MSL or 31.9 ft. | | |
| K. Borehole, bottom 820.33 ft. MSL or 32.9 ft. | | |
| L. Borehole, diameter 8.0 in. | | |
| M. O.D. well casing 200 in. | | |
| N. I.D. well casing 4.25 in. | | |

I hereby certify that the information on this form is true and correct to the best of my knowledge.

Signature Doug Langtagne Firm Coleman Engineering Co.

| | | |
|--|--|--|
| Facility/Project Name Oconomowoc Electroplating Company | Local Grid Location of Well ft. <input type="checkbox"/> N. <input type="checkbox"/> S. <input type="checkbox"/> E. <input type="checkbox"/> W. | Well Name TW-301D |
| Facility License, Permit or Monitoring No. | Local Grid Origin <input type="checkbox"/> (estimated: <input type="checkbox"/>) or Well Location <input checked="" type="checkbox"/> | Wis. Unique Well No. <input type="checkbox"/> DNR Well Number <input type="checkbox"/> |
| Facility ID | Lat. " ' " Long. " ' " or St. Plane 445,723 ft. N, 2,393,952 ft. E. S/C/N | Date Well Installed 04/15/2003 |
| Type of Well Well Code 12/pz | Section Location of Waste/Source SE 1/4 of SE 1/4 of Sec. 30, T. 9 N, R. 17 <input checked="" type="checkbox"/> E <input type="checkbox"/> W | Well Installed By: (Person's Name and Firm) Tony Kapugi |
| Distance from Waste/Source ft. <input type="checkbox"/> Inf. Stds. Apply <input type="checkbox"/> | Location of Well Relative to Waste/Source u <input type="checkbox"/> Upgradient s <input type="checkbox"/> Sidegradient d <input type="checkbox"/> Downgradient n <input type="checkbox"/> Not Known | Gov. Lot Number |
| | | On-Site Environmental |

| | | | |
|--|--|---|--|
| A. Protective pipe, top elevation | 848.76 ft. MSL | 1. Cap and lock? | <input checked="" type="checkbox"/> Yes <input type="checkbox"/> No |
| B. Well casing, top elevation | 848.60 ft. MSL | 2. Protective cover pipe: | |
| C. Land surface elevation | 846.8 ft. MSL | a. Inside diameter: | 2.1 in. |
| D. Surface seal, bottom | ft. MSL or ft. | b. Length: | 4.0 ft. |
| | | c. Material: | Steel <input type="checkbox"/> 04 PVC <input checked="" type="checkbox"/> Other <input type="checkbox"/> |
| | | d. Additional protection? | <input type="checkbox"/> Yes <input checked="" type="checkbox"/> No |
| | | If yes, describe: | |
| 12. USCS classification of soil near screen: GP <input type="checkbox"/> GM <input type="checkbox"/> GC <input type="checkbox"/> GW <input type="checkbox"/> SW <input type="checkbox"/> SP <input checked="" type="checkbox"/> SM <input type="checkbox"/> SC <input checked="" type="checkbox"/> ML <input type="checkbox"/> MH <input type="checkbox"/> CL <input type="checkbox"/> CH <input type="checkbox"/> Bedrock <input type="checkbox"/> | | 3. Surface seal: | Bentonite <input checked="" type="checkbox"/> 30 Concrete <input type="checkbox"/> 01 Other <input type="checkbox"/> |
| 13. Sieve analysis attached? | <input type="checkbox"/> Yes <input checked="" type="checkbox"/> No | 4. Material between well casing and protective pipe: | Bentonite <input type="checkbox"/> 30 Bentonite and sand <input checked="" type="checkbox"/> Other <input type="checkbox"/> |
| 14. Drilling method used: | Rotary <input type="checkbox"/> 50 Hollow Stem Auger <input type="checkbox"/> 41 Geoprobe <input checked="" type="checkbox"/> Other <input type="checkbox"/> | 5. Annular space seal: | a. Granular/Chipped Bentonite <input type="checkbox"/> 33 b. Lbs/gal mud weight ... Bentonite-sand slurry <input type="checkbox"/> 35 c. Lbs/gal mud weight ... Bentonite slurry <input type="checkbox"/> 31 d. % Bentonite ... Bentonite-cement grout <input type="checkbox"/> 50 e. Ft ³ volume added for any of the above f. How installed: Tremie <input type="checkbox"/> 01 Tremie pumped <input type="checkbox"/> 02 Gravity <input type="checkbox"/> 08 |
| 15. Drilling fluid used: Water <input type="checkbox"/> 02 Air <input type="checkbox"/> 01 Drilling Mud <input type="checkbox"/> 03 None <input checked="" type="checkbox"/> 99 | | 6. Bentonite seal: | a. Bentonite granules <input type="checkbox"/> 33 b. <input type="checkbox"/> 1/4 in. <input checked="" type="checkbox"/> 3/8 in. <input type="checkbox"/> 1/2 in. Bentonite chips <input checked="" type="checkbox"/> 32 c. Other <input type="checkbox"/> |
| 16. Drilling additives used? <input type="checkbox"/> Yes <input checked="" type="checkbox"/> No | | 7. Fine sand material: Manufacturer, product name & mesh size | a. Not Applicable b. Volume added ft ³ |
| Describe | | 8. Filter pack material: Manufacturer, product name & mesh size | a. Sidley, Ohio Sand #5 b. Volume added 0.13 ft ³ |
| 17. Source of water (attach analysis, if required): | | 9. Well casing: | Flush threaded PVC schedule 40 <input checked="" type="checkbox"/> 23 Flush threaded PVC schedule 80 <input type="checkbox"/> 24 Other <input type="checkbox"/> |
| E. Bentonite seal, top | 846.8 ft. MSL or 0.0 ft. | 10. Screen material: | PVC |
| F. Fine sand, top | ft. MSL or ft. | a. Screen Type: | Factory cut <input checked="" type="checkbox"/> 11 Continuous slot <input type="checkbox"/> 01 Other <input type="checkbox"/> |
| G. Filter pack, top | 825.8 ft. MSL or 21.0 ft. | b. Manufacturer | Monoflex |
| H. Screen joint, top | 824.8 ft. MSL or 22.0 ft. | c. Slot size: | 0.010 in. |
| I. Well bottom | 819.8 ft. MSL or 27.0 ft. | d. Slotted length: | 5.0 ft. |
| J. Filter pack, bottom | 819.8 ft. MSL or 27.0 ft. | 11. Backfill material (below filter pack): | None <input checked="" type="checkbox"/> 14 Other <input type="checkbox"/> |
| K. Borehole, bottom | 819.8 ft. MSL or 27.0 ft. | | |
| L. Borehole, diameter | 2.5 in. | | |
| M. O.D. well casing | 1.50 in. | | |
| N. I.D. well casing | 1.05 in. | | |

I hereby certify that the information on this form is true and correct to the best of my knowledge.

Signature  Firm RMT, Inc. 744 Heartland Trail Madison, WI 53717 Tel: (608) 831-4444 Fax: (608) 831-3334

Please complete both Forms 4400-113A and 4400-113B and return them to the appropriate DNR office and bureau. Completion of these reports is required by chs. 160, 281, 283, 289, 291, 292, 293, 295, and 299, Wis. Stats., and ch. NR 141, Wis. Adm. Code. In accordance with chs. 281, 289, 291, 292, 293, 295, and 299, Wis. Stats., failure to file these forms may result in a forfeiture of between \$10 and \$25,000, or imprisonment for up to one year, depending on the program and conduct involved. Personally identifiable information on these forms is not intended to be used for any other purpose. NOTE: See the instructions for more information, including where the completed forms should be sent.

Notice: Completion of this report is required by chs. 160, 281, 283, 289, 291-293, 295, and 299, Wis. Stats., and ch. NR 141, Wis. Adm. Code. In accordance with chs. 281, 289, 291-293, 295, and 299, Wis. Stats., failure to file this form may result in a forfeiture of between \$10-25,000, or imprisonment for up to one year, depending on the program and conduct involved. Personally identifiable information on this form is not intended to be used for any other purpose. Return form to the appropriate DNR office and bureau. See instructions on reverse for more information.

Route to:
 Drinking Water Watershed/Wastewater Waste Management Remediation/Redevelopment Other: _____

1. General Information **2. Facility / Owner Information**

WI Unique Well No. PL151 DNR Well ID No. _____ County Dodge

Common Well Name TW-301S Gov't Lot # (if applicable) _____

1/4 1/4 NW 1/4 SE Section 30 Township 9 N Range 17 E W

Well Location fl. / M (Local Grid) Datum _____

445721.13 N / S 2393952.84 E / W 848.58

WTM- UTM- Latitude/Longitude- State Plane- S C N

Local Grid Origin fl. / M Datum _____

_____ N, _____ E / W

WTM- UTM- Latitude/Longitude- State Plane- S C N

Reason For Abandonment No longer in use WI Unique Well No. of Replacement Well _____

Facility Name Oconomoc Electroplating Facility

Facility ID _____ License/Permit/Monitoring No. _____

Street Address of Well 2572 W. Oak Street

City, Village or Town Ashippun, WI

Present Well Owner USEPA Original Well Owner USEPA

Street Address or Route of Present Owner 77 W. Jackson Blvd.

City Chicago State IL ZIP Code 60604

3. Well / Drillhole / Borehole Information

Monitoring Well Original Construction Date 4/15/2003

Water Well

Borehole / Drillhole

If a Well Construction Report is available, please attach.

Construction Type:
 Drilled Driven (Sandpoint) Dug
 Other (specify): _____

Formation Type:
 Unconsolidated Formation Bedrock

Total Well Depth From Groundsurface (ft.) 15 feet Casing Diameter (in.) 1 inch

Lower Drillhole Diameter (in.) _____ Casing Depth (ft.) _____

Was well annular space grouted? Yes No Unknown

If yes, to what depth (feet)? _____ Depth to Water (feet) _____

4. Pump, Liner, Screen, Casing & Sealing Material

Pump and piping removed? Yes No N/A

Liner(s) removed? Yes No N/A

Screen removed? Yes No N/A

Casing left in place? Yes No N/A

Was casing cut off below surface? Yes No N/A

Did sealing material rise to surface? Yes No N/A

Did material settle after 24 hours? Yes No N/A

If yes, was hole retopped? Yes No N/A

If bentonite chips were used, were they hydrated with water from a known safe source? Yes No N/A

Required Method of Placing Sealing Material
 Conductor Pipe-Gravity Conductor Pipe-Pumped
 Screened & Poured (Bentonite Chips) Other (Explain): _____

Sealing Materials
 Neat Cement Grout Clay-Sand Slurry (11 lb./gal. wt.)
 Sand-Cement (Concrete) Grout Bentonite-Sand Slurry " "
 Concrete Bentonite Chips

For Monitoring Wells and Monitoring Well Boreholes Only:
 Bentonite Chips Bentonite - Cement Grout
 Granular Bentonite Bentonite - Sand Slurry

5. Material Used To Fill Well / Drillhole

| From (ft.) | To (ft.) | No. Yards, Sacks Sealant or Volume (circle one) | Mix Ratio or Mud Weight |
|------------|----------|---|-------------------------|
| Surface | 15ft | 3 lbs | |
| | | | |
| | | | |

| From (ft.) | To (ft.) | No. Yards, Sacks Sealant or Volume (circle one) | Mix Ratio or Mud Weight |
|------------|----------|---|-------------------------|
| Surface | 15ft | 3 lbs | |
| | | | |
| | | | |

6. Comments

Entire well, casing, and screen removed.

7. Supervision of Work **DNR Use Only**

Name of Person or Firm Doing Sealing Work Coleman Engineering Co. Date of Abandonment 7/6/09 Date Received _____ Noted By _____

Street or Route 635 Circle Drive Telephone Number (906) 774-3440 Comments _____

City Iron Mountain, State MI ZIP Code 49801 Signature of Person Doing Work Dog Latog Date Signed 7-8-09

Notice: Completion of this report is required by chs. 160, 281, 283, 289, 291-293, 295, and 299, Wis. Stats., and ch. NR 141, Wis. Adm. Code. In accordance with chs. 281, 289, 291-293, 295, and 299, Wis. Stats., failure to file this form may result in a forfeiture of between \$10-25,000, or imprisonment for up to one year, depending on the program and conduct involved. Personally identifiable information on this form is not intended to be used for any other purpose. Return form to the appropriate DNR office and bureau. See instructions on reverse for more information.

Route to:
 Drinking Water Watershed/Wastewater Waste Management Remediation/Redevelopment Other: _____

| 1. General Information | | | | 2. Facility / Owner Information | | | |
|---|--|--|--|---|--|--|--|
| WI Unique Well No. PL133 | | DNR Well ID No. | | County Dodge | | Facility Name Oconomowoc Electroplating Facility | |
| Common Well Name TW-201S | | Gov't Lot # (if applicable) | | Facility ID | | License/Permit/Monitoring No. | |
| 1/4 1/4 NW SE | | Section 30 | | Township 9 N | | Range 17 E | |
| Well Location <input type="checkbox"/> ft. / <input type="checkbox"/> M (Local Grid <input type="checkbox"/>) | | Datum | | Street Address of Well 2572 W. Oak Street | | | |
| 445908.42 N / S 2393690.73 E / W | | 850.30 | | City, Village or Town Ashippun, WI | | | |
| WTM- <input type="checkbox"/> UTM- <input type="checkbox"/> Latitude/Longitude- <input type="checkbox"/> State Plane- <input type="checkbox"/> <input type="checkbox"/> S <input type="checkbox"/> C <input type="checkbox"/> N | | Zone | | Present Well Owner USEPA | | Original Well Owner USEPA | |
| Local Grid Origin <input type="checkbox"/> ft. / <input type="checkbox"/> M | | Datum | | Street Address or Route of Present Owner 77 W. Jackson Blvd | | | |
| WTM- <input type="checkbox"/> UTM- <input type="checkbox"/> Latitude/Longitude- <input type="checkbox"/> State Plane- <input type="checkbox"/> <input type="checkbox"/> S <input type="checkbox"/> C <input type="checkbox"/> N | | Zone | | City Chicago | | State IL | |
| Reason For Abandonment No longer in use | | WI Unique Well No. of Replacement Well | | ZIP Code 60604 | | | |

| 3. Well / Drillhole / Borehole Information | | 4. Pump, Liner, Screen, Casing & Sealing Material | | | |
|---|--|--|--|---|--|
| <input checked="" type="checkbox"/> Monitoring Well <input type="checkbox"/> Water Well <input type="checkbox"/> Borehole / Drillhole | | Original Construction Date 4/15/2003 | | Pump and piping removed? <input type="checkbox"/> Yes <input type="checkbox"/> No <input checked="" type="checkbox"/> N/A Liner(s) removed? <input type="checkbox"/> Yes <input type="checkbox"/> No <input checked="" type="checkbox"/> N/A Screen removed? <input checked="" type="checkbox"/> Yes <input type="checkbox"/> No <input type="checkbox"/> N/A Casing left in place? <input type="checkbox"/> Yes <input checked="" type="checkbox"/> No <input type="checkbox"/> N/A | |
| Construction Type: <input type="checkbox"/> Drilled <input checked="" type="checkbox"/> Driven (Sandpoint) <input type="checkbox"/> Dug <input type="checkbox"/> Other (specify): _____ | | If a Well Construction Report is available, please attach. | | Was casing cut off below surface? <input type="checkbox"/> Yes <input checked="" type="checkbox"/> No <input type="checkbox"/> N/A Did sealing material rise to surface? <input checked="" type="checkbox"/> Yes <input type="checkbox"/> No <input type="checkbox"/> N/A Did material settle after 24 hours? <input type="checkbox"/> Yes <input checked="" type="checkbox"/> No <input type="checkbox"/> N/A If yes, was hole retopped? <input type="checkbox"/> Yes <input type="checkbox"/> No <input checked="" type="checkbox"/> N/A If bentonite chips were used, were they hydrated with water from a known safe source? <input type="checkbox"/> Yes <input type="checkbox"/> No <input checked="" type="checkbox"/> N/A | |
| Formation Type: <input checked="" type="checkbox"/> Unconsolidated Formation <input type="checkbox"/> Bedrock | | Required Method of Placing Sealing Material <input type="checkbox"/> Conductor Pipe-Gravity <input type="checkbox"/> Conductor Pipe-Pumped <input checked="" type="checkbox"/> Screened & Poured (Bentonite Chips) <input type="checkbox"/> Other (Explain): _____ | | | |
| Total Well Depth From Groundsurface (ft.) 9 feet | | Casing Diameter (in.) 1 inch | | Sealing Materials <input type="checkbox"/> Neat Cement Grout <input type="checkbox"/> Clay-Sand Slurry (11 lb./gal. wt.) <input type="checkbox"/> Sand-Cement (Concrete) Grout <input type="checkbox"/> Bentonite-Sand Slurry " " <input type="checkbox"/> Concrete <input checked="" type="checkbox"/> Bentonite Chips | |
| Lower Drillhole Diameter (in.) | | Casing Depth (ft.) | | For Monitoring Wells and Monitoring Well Boreholes Only: <input checked="" type="checkbox"/> Bentonite Chips <input type="checkbox"/> Bentonite - Cement Grout <input type="checkbox"/> Granular Bentonite <input type="checkbox"/> Bentonite - Sand Slurry | |
| Was well annular space grouted? <input type="checkbox"/> Yes <input type="checkbox"/> No <input type="checkbox"/> Unknown | | | | | |
| If yes, to what depth (feet)? | | Depth to Water (feet) | | | |

| 5. Material Used To Fill Well / Drillhole | | | |
|---|-----------------------|-------------------------|---|
| Bentonite Chips | From (ft.) Surface | To (ft.) 9 ft | No. Yards, Sacks Sealant or Volume (circle one) ~ 2 lbs |
| Mix Ratio or Mud Weight | | | |

6. Comments
Entire well, casing, and screen removed

| 7. Supervision of Work | | | DNR Use Only | |
|---|--------------------|---|--|------------------------------|
| Name of Person or Firm Doing Sealing Work Coleman Engineering Co. | | Date of Abandonment 7/6/09 | Date Received | Noted By |
| Street or Route 635 Circle Drive | | Telephone Number 906-774-3440 | Comments | |
| City Iron Mountain | State MI | ZIP Code 49801 | Signature of Person Doing Work <i>[Signature]</i> | Date Signed 7-8-09 |

| | | |
|---|--|---|
| Facility/Project Name Oconomowoc Electroplating Company | Local Grid Location of Well ft. <input type="checkbox"/> N. <input type="checkbox"/> E. <input type="checkbox"/> S. <input type="checkbox"/> W. | Well Name TW-201S |
| Facility License, Permit or Monitoring No. | Local Grid Origin (estimated: <input type="checkbox"/>) or Well Location <input checked="" type="checkbox"/> Lat. " " Long. " " or | Wis. Unique Well No. PL 133 DNR Well Number |
| Facility ID | St. Plane 445,908 ft. N, 2,393,691 ft. E. S/C/N | Date Well Installed 04/15/2003 |
| Type of Well | Section Location of Waste/Source NW 1/4 of SE 1/4 of Sec. 30, T. 9 N, R. 17 <input checked="" type="checkbox"/> E <input type="checkbox"/> W | Well Installed By: (Person's Name and Firm) Tony Kapugi |
| Distance from Waste/Source ft. | Location of Well Relative to Waste/Source u <input type="checkbox"/> Upgradient s <input type="checkbox"/> Sidegradient d <input type="checkbox"/> Downgradient n <input type="checkbox"/> Not Known | Gov. Lot Number |
| Enf. Stds. Apply <input type="checkbox"/> | | On-Site Environmental |

- A. Protective pipe, top elevation 850.55 ft. MSL
- B. Well casing, top elevation 850.30 ft. MSL
- C. Land surface elevation 849.3 ft. MSL
- D. Surface seal, bottom _____ ft. MSL or _____ ft.

12. USCS classification of soil near screen:
 GP GM GC GW SW SP
 SM SC ML MH CL CH
 Bedrock

13. Sieve analysis attached? Yes No

14. Drilling method used: Rotary 5 0
 Hollow Stem Auger 4 1
 Geoprobe _____ Other

15. Drilling fluid used: Water 0 2 Air 0 1
 Drilling Mud 0 3 None 9 9

16. Drilling additives used? Yes No
 Describe _____

17. Source of water (attach analysis, if required):

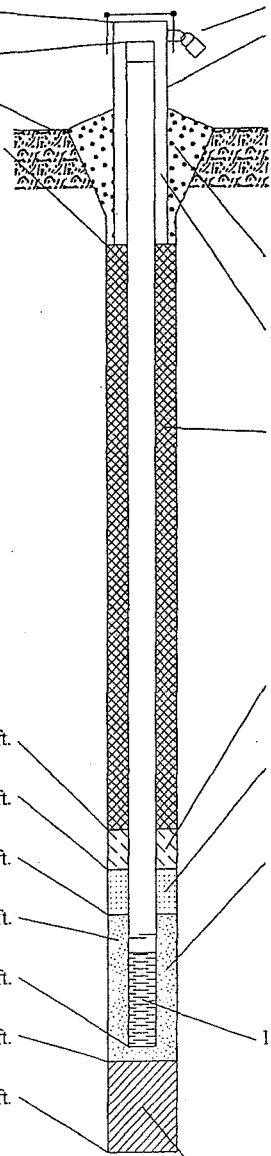

- E. Bentonite seal, top 849.3 ft. MSL or 0.0 ft.
- F. Fine sand, top _____ ft. MSL or _____ ft.
- G. Filter pack, top 846.3 ft. MSL or 3.0 ft.
- H. Screen joint, top 845.3 ft. MSL or 4.0 ft.
- I. Well bottom 840.3 ft. MSL or 9.0 ft.
- J. Filter pack, bottom 840.3 ft. MSL or 9.0 ft.
- K. Borehole, bottom 840.3 ft. MSL or 9.0 ft.
- L. Borehole, diameter 2.5 in.
- M. O.D. well casing 1.50 in.
- N. I.D. well casing 1.05 in.

- 1. Cap and lock? Yes No
- 2. Protective cover pipe:
 - a. Inside diameter: 2.1 in.
 - b. Length: 4.0 ft.
 - c. Material: Steel 0 4
PVC Other
 - d. Additional protection? Yes No
If yes, describe: _____
- 3. Surface seal: Bentonite 3 0
Concrete 0 1
Other
- 4. Material between well casing and protective pipe: Bentonite 3 0
Bentonite and sand Other
- 5. Annular space seal:
 - a. Granular/Chipped Bentonite 3 3
 - b. _____ Lbs/gal mud weight ... Bentonite-sand slurry 3 5
 - c. _____ Lbs/gal mud weight ... Bentonite slurry 3 1
 - d. _____ % Bentonite ... Bentonite-cement grout 5 0
 - e. _____ Ft³ volume added for any of the above
 - f. How installed: Tremie 0 1
Tremie pumped 0 2
Gravity 0 8
- 6. Bentonite seal:
 - a. Bentonite granules 3 3
 - b. 1/4 in. 3/8 in. 1/2 in. Bentonite chips 3 2
 - c. _____ Other
- 7. Fine sand material: Manufacturer, product name & mesh size
a. _____ Not Applicable
b. Volume added _____ ft³
- 8. Filter pack material: Manufacturer, product name & mesh size
a. _____ Sidley, Ohio Sand #5
b. Volume added 0.13 ft³
- 9. Well casing: Flush threaded PVC schedule 40 2 3
Flush threaded PVC schedule 80 2 4
Other
- 10. Screen material: PVC
a. Screen Type: Factory cut 1 1
Continuous slot 0 1
Other
- b. Manufacturer Monoflex
- c. Slot size: 0.010 in.
- d. Slotted length: 5.0 ft.
- 11. Backfill material (below filter pack): None 1 4
Other

I hereby certify that the information on this form is true and correct to the best of my knowledge.

Signature [Signature] Firm **RMT, Inc.** Tel: (608) 831-4444
 744 Heartland Trail Madison, WI 53717 Fax: (608) 831-3334

Please complete both Forms 4400-113A and 4400-113B and return them to the appropriate DNR office and bureau. Completion of these reports is required by chs. 160, 281, 283, 289, 291, 292, 293, 295, and 299, Wis. Stats., and ch. NR 141, Wis. Adm. Code. In accordance with chs. 281, 289, 291, 292, 293, 295, and 299, Wis. Stats., failure to file these forms may result in a forfeiture of between \$10 and \$25,000, or imprisonment for up to one year, depending on the program and conduct involved. Personally identifiable information on these forms is not intended to be used for any other purpose. NOTE: See the instructions for more information, including where the completed forms should be sent.

Notice: Completion of this report is required by chs. 160, 281, 283, 289, 291-293, 295, and 299, Wis. Stats., and ch. NR 141, Wis. Adm. Code. In accordance with chs. 281, 289, 291-293, 295, and 299, Wis. Stats., failure to file this form may result in a forfeiture of between \$10-25,000, or imprisonment for up to one year, depending on the program and conduct involved. Personally identifiable information on this form is not intended to be used for any other purpose. Return form to the appropriate DNR office and bureau. See instructions on reverse for more information.

Route to: Drinking Water Watershed/Wastewater Waste Management Remediation/Redevelopment Other: _____

1. General Information **2. Facility / Owner Information**

WI Unique Well No. PL134 DNR Well ID No. _____ County Dodge

Common Well Name TW-201D Gov't Lot # (if applicable) _____

1/4 NW 30 Township 9 N Range 17 E

Well Location ft./M (Local Grid) Datum
445907.64 N S 2393689.51 E W 950.97

WTM- UTM- Latitude/Longitude- State Plane- S C N

Local Grid Origin ft./M Datum
 _____ N, _____ E/W

WTM- UTM- Latitude/Longitude- State Plane- S C N

Reason For Abandonment No longer in use WI Unique Well No. of Replacement Well _____

Facility Name Oconomowoc Electroplating Facility

Facility ID _____ License/Permit/Monitoring No. _____

Street Address of Well 2572 W Oak Street

City, Village or Town Ashippun, WI

Present Well Owner USEPA Original Well Owner USEPA

Street Address or Route of Present Owner 77 W. Jackson Blvd.

City Chicago State IL ZIP Code 60604

3. Well / Drillhole / Borehole Information

Monitoring Well Water Well Borehole / Drillhole

Original Construction Date 4/15/2003

If a Well Construction Report is available, please attach. _____

Construction Type:
 Drilled Driven (Sandpoint) Dug
 Other (specify): _____

Formation Type:
 Unconsolidated Formation Bedrock

Total Well Depth From Groundsurface (ft.) 22 feet Casing Diameter (in.) 1 inch

Lower Drillhole Diameter (in.) _____ Casing Depth (ft.) _____

Was well annular space grouted? Yes No Unknown

If yes, to what depth (feet)? _____ Depth to Water (feet) _____

4. Pump, Liner, Screen, Casing & Sealing Material

Pump and piping removed? Yes No N/A

Liner(s) removed? Yes No N/A

Screen removed? Yes No N/A

Casing left in place? Yes No N/A

Was casing cut off below surface? Yes No N/A

Did sealing material rise to surface? Yes No N/A

Did material settle after 24 hours? Yes No N/A

If yes, was hole retopped? Yes No N/A

If bentonite chips were used, were they hydrated with water from a known safe source? Yes No N/A

Required Method of Placing Sealing Material
 Conductor Pipe-Gravity Conductor Pipe-Pumped
 Screened & Poured (Bentonite Chips) Other (Explain): _____

Sealing Materials
 Neat Cement Grout Clay-Sand Slurry (11 lb./gal. wt.)
 Sand-Cement (Concrete) Grout Bentonite-Sand Slurry " "
 Concrete Bentonite Chips

For Monitoring Wells and Monitoring Well Boreholes Only:
 Bentonite Chips Bentonite - Cement Grout
 Granular Bentonite Bentonite - Sand Slurry

| 5. Material Used To Fill Well / Drillhole | From (ft.) | To (ft.) | No. Yards, Sacks Sealant or Volume (circle one) | Mix Ratio or Mud Weight |
|---|----------------|--------------|---|-------------------------|
| <u>Bentonite Chips</u> | <u>Surface</u> | <u>22 ft</u> | <u>3 lbs</u> | |
| | | | | |
| | | | | |

6. Comments Entire well, casing, and screen removed

7. Supervision of Work

| | | | |
|---|---|--------------------------|--|
| Name of Person or Firm Doing Sealing Work <u>Coleman Engineering Co.</u> | Date of Abandonment <u>7/6/09</u> | Date Received | Noted By |
| Street or Route <u>635 Circle Drive</u> | Telephone Number <u>(906) 774-3440</u> | Comments | |
| City <u>Iron Mountain</u> | State <u>MI</u> | ZIP Code <u>49801</u> | Signature of Person Doing Work <u>Dog Patoz</u> |
| | | | Date Signed <u>7-8-09</u> |

| | | |
|--|--|--|
| Facility/Project Name Oconomowoc Electroplating Company | Local Grid Location of Well ft. <input type="checkbox"/> N. <input type="checkbox"/> E. <input type="checkbox"/> S. <input type="checkbox"/> W. | Well Name TW-201D |
| Facility License, Permit or Monitoring No. | Local Grid Origin <input type="checkbox"/> (estimated: <input type="checkbox"/>) or Well Location <input checked="" type="checkbox"/> | Wis. Unique Well No. PL 134 DNR Well Number |
| Facility ID | Lat. " Long. " or St. Plane 445,908 ft. N, 2,393,690 ft. E. S/C/N | Date Well Installed 04/15/2003 |
| Type of Well | Section Location of Waste/Source NW 1/4 of SE 1/4 of Sec. 30, T. 9 N, R. 17 <input checked="" type="checkbox"/> E <input type="checkbox"/> W | Well Installed By: (Person's Name and Firm) Tony Kapugi |
| Distance from Waste/Source ft. | Location of Well Relative to Waste/Source u <input type="checkbox"/> Upgradient s <input type="checkbox"/> Sidegradient d <input type="checkbox"/> Downgradient n <input type="checkbox"/> Not Known | Gov. Lot Number On-Site Environmental |

| | | |
|--|---------------------------|---|
| A. Protective pipe, top elevation | 851.00 ft. MSL | 1. Cap and lock? <input checked="" type="checkbox"/> Yes <input type="checkbox"/> No |
| B. Well casing, top elevation | 850.87 ft. MSL | 2. Protective cover pipe: a. Inside diameter: 2.1 in. b. Length: 4.0 ft. c. Material: Steel <input type="checkbox"/> 04 PVC <input checked="" type="checkbox"/> Other <input type="checkbox"/> |
| C. Land surface elevation | 849.3 ft. MSL | d. Additional protection? <input type="checkbox"/> Yes <input checked="" type="checkbox"/> No If yes, describe: _____ |
| D. Surface seal, bottom | ft. MSL or ft. | 3. Surface seal: Bentonite <input checked="" type="checkbox"/> 30 Concrete <input type="checkbox"/> 01 Other <input type="checkbox"/> |
| 12. USCS classification of soil near screen: GP <input type="checkbox"/> GM <input type="checkbox"/> GC <input type="checkbox"/> GW <input type="checkbox"/> SW <input type="checkbox"/> SP <input checked="" type="checkbox"/> SM <input checked="" type="checkbox"/> SC <input type="checkbox"/> ML <input type="checkbox"/> MH <input type="checkbox"/> CL <input type="checkbox"/> CH <input type="checkbox"/> Bedrock <input type="checkbox"/> | | 4. Material between well casing and protective pipe: Bentonite <input type="checkbox"/> 30 Bentonite and sand <input checked="" type="checkbox"/> |
| 13. Sieve analysis attached? <input type="checkbox"/> Yes <input checked="" type="checkbox"/> No 14. Drilling method used: Rotary <input type="checkbox"/> 50 Hollow Stem Auger <input type="checkbox"/> 41 Geoprobe <input type="checkbox"/> Other <input checked="" type="checkbox"/> | | 5. Annular space seal: a. Granular/Chipped Bentonite <input type="checkbox"/> 33 b. Lbs/gal mud weight ... Bentonite-sand slurry <input type="checkbox"/> 35 c. Lbs/gal mud weight ... Bentonite slurry <input type="checkbox"/> 31 d. % Bentonite ... Bentonite-cement grout <input type="checkbox"/> 50 e. Ft ³ volume added for any of the above f. How installed: Tremie <input type="checkbox"/> 01 Tremie pumped <input type="checkbox"/> 02 Gravity <input type="checkbox"/> 08 |
| 15. Drilling fluid used: Water <input type="checkbox"/> 02 Air <input type="checkbox"/> 01 Drilling Mud <input type="checkbox"/> 03 None <input checked="" type="checkbox"/> 99 16. Drilling additives used? <input type="checkbox"/> Yes <input checked="" type="checkbox"/> No Describe _____ 17. Source of water (attach analysis, if required): _____ | | 6. Bentonite seal: a. Bentonite granules <input type="checkbox"/> 33 b. <input type="checkbox"/> 1/4 in. <input checked="" type="checkbox"/> 3/8 in. <input type="checkbox"/> 1/2 in. Bentonite chips <input checked="" type="checkbox"/> 32 c. Other <input type="checkbox"/> |
| E. Bentonite seal, top | 849.3 ft. MSL or 0.0 ft. | 7. Fine sand material: Manufacturer, product name & mesh size Not Applicable |
| F. Fine sand, top | ft. MSL or ft. | a. Volume added ft ³ |
| G. Filter pack, top | 833.3 ft. MSL or 16.0 ft. | 8. Filter pack material: Manufacturer, product name & mesh size Sidley, Ohio Sand #5 |
| H. Screen joint, top | 832.3 ft. MSL or 17.0 ft. | a. Volume added 0.13 ft ³ |
| I. Well bottom | 827.3 ft. MSL or 22.0 ft. | 9. Well casing: Flush threaded PVC schedule 40 <input checked="" type="checkbox"/> 23 Flush threaded PVC schedule 80 <input type="checkbox"/> 24 Other <input type="checkbox"/> |
| J. Filter pack, bottom | 827.3 ft. MSL or 22.0 ft. | 10. Screen material: PVC |
| K. Borehole, bottom | 818.3 ft. MSL or 31.0 ft. | a. Screen Type: Factory cut <input checked="" type="checkbox"/> 11 Continuous slot <input type="checkbox"/> 01 Other <input type="checkbox"/> |
| L. Borehole, diameter | 2.5 in. | b. Manufacturer Monoflex |
| M. O.D. well casing | 1.50 in. | c. Slot size: 0.010 in. |
| N. I.D. well casing | 1.05 in. | d. Slotted length: 5.0 ft. |
| | | 11. Backfill material (below filter pack): None <input checked="" type="checkbox"/> 14 Other <input type="checkbox"/> |

I hereby certify that the information on this form is true and correct to the best of my knowledge.

Signature *[Signature]* Firm RMT, Inc. Tel: (608) 831-4444
744 Heartland Trail Madison, WI 53717 Fax: (608) 831-3334

Please complete both Forms 4400-113A and 4400-113B and return them to the appropriate DNR office and bureau. Completion of these reports is required by chs. 160, 281, 283, 289, 291, 292, 293, 295, and 299, Wis. Stats., and ch. NR 141, Wis. Adm. Code. In accordance with chs. 281, 289, 291, 292, 293, 295, and 299, Wis. Stats., failure to file these forms may result in a forfeiture of between \$10 and \$25,000, or imprisonment for up to one year, depending on the program and conduct involved. Personally identifiable information on these forms is not intended to be used for any other purpose. NOTE: See the instructions for more information, including where the completed forms should be sent.

Notice: Completion of this report is required by chs. 160, 281, 283, 289, 291-293, 295, and 299, Wis. Stats., and ch. NR 141, Wis. Adm. Code. In accordance with chs. 281, 289, 291-293, 295, and 299, Wis. Stats., failure to file this form may result in a forfeiture of between \$10-25,000, or imprisonment for up to one year, depending on the program and conduct involved. Personally identifiable information on this form is not intended to be used for any other purpose. Return form to the appropriate DNR office and bureau. See instructions on reverse for more information.

Route to:

Drinking Water Watershed/Wastewater Waste Management Remediation/Redevelopment Other: /

1. General Information **2. Facility / Owner Information**

WI Unique Well No. PC849 DNR Well ID No. _____ County Dodge Facility Name Oconomowoc Electroplating Facility

Common Well Name MW-5 Gov't Lot # (if applicable) _____ Facility ID _____ License/Permit/Monitoring No. _____

1/4 / 1/4 NW / SE Section 30 Township 9 Range 17 E W Street Address of Well 2572 W. oak Street

Well Location ft. / M (Local Grid) Datum _____ City, Village or Town Ashippun, WI

WTM- UTM- Latitude/Longitude- State Plane- S C N Zone USEPA Original Well Owner USEPA

Local Grid Origin ft. / M Datum _____ Street Address or Route of Present Owner 77 W. Jackson Blvd.

WTM- UTM- Latitude/Longitude- State Plane- S C N Zone _____ City Chicago State IL ZIP Code 60604

3. Well / Drillhole / Borehole Information **4. Pump, Liner, Screen, Casing & Sealing Material**

Reason For Abandonment Damaged WI Unique Well No. of Replacement Well _____

Monitoring Well Water Well Borehole / Drillhole Original Construction Date 11/7/1988

Construction Type: Drilled Driven (Sandpoint) Dug Other (specify): _____

Formation Type: Unconsolidated Formation Bedrock

Total Well Depth From Groundsurface (ft.) 13 ft Casing Diameter (in.) 2 inch

Lower Drillhole Diameter (in.) _____ Casing Depth (ft.) _____

Was well annular space grouted? Yes No Unknown

If yes, to what depth (feet)? _____ Depth to Water (feet) _____

5. Material Used To Fill Well / Drillhole

| From (ft.) | To (ft.) | No. Yards, Sacks Sealant or Volume (circle one) | Mix Ratio or Mud Weight |
|------------|----------|---|-------------------------|
| Surface | 13 ft | ~12 lbs | |

6. Comments

7. Supervision of Work **DNR Use Only**

Name of Person or Firm Doing Sealing Work Coleman Engineering Co. Date of Abandonment 7/7/09 Date Received _____ Noted By _____

Street or Route 635 Circle Drive Telephone Number (906) 774-3440 Comments _____

City Iron Mountain State MI ZIP Code 49801 Signature of Person Doing Work Dag Salazar Date Signed 7-8-09

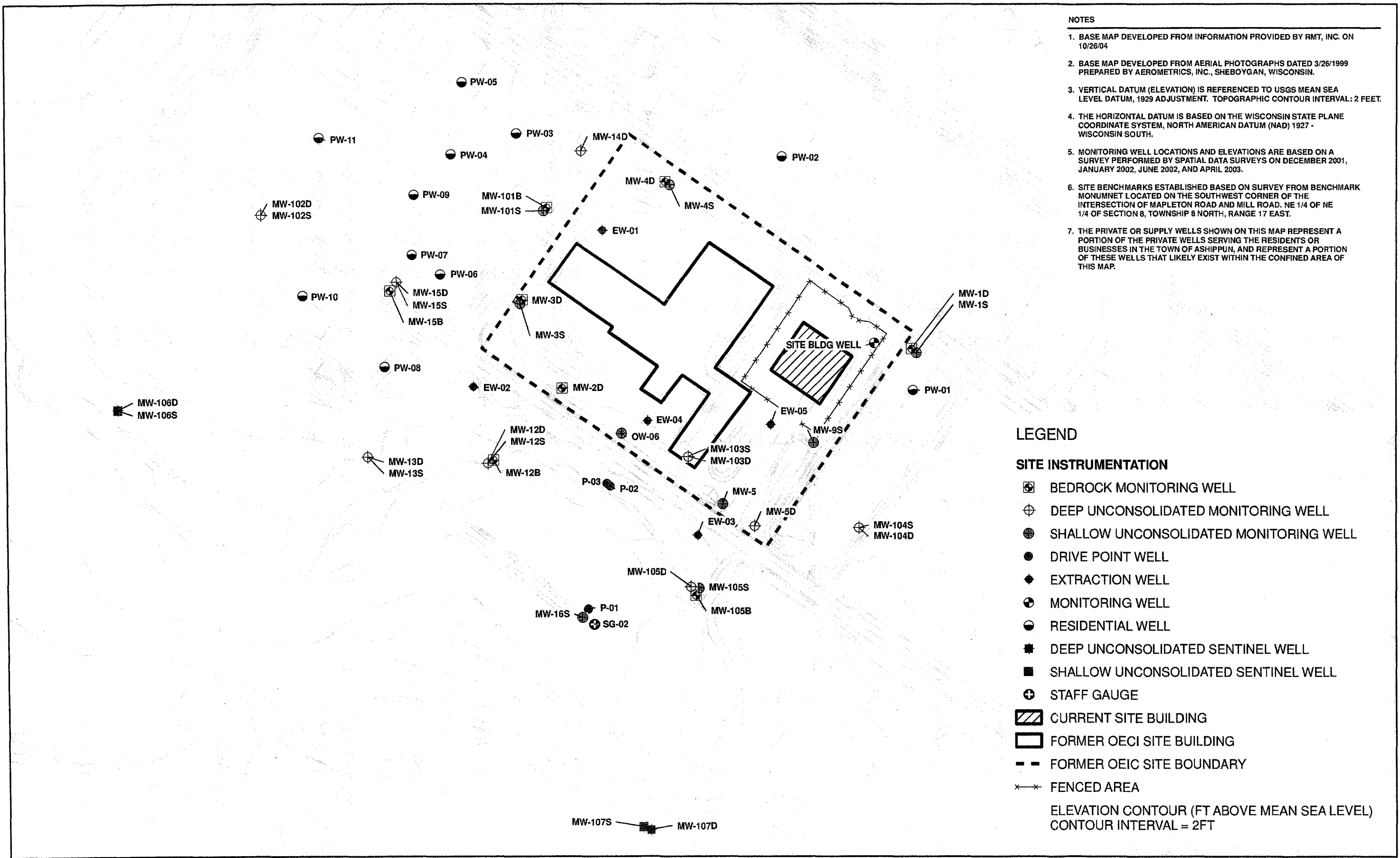

- NOTES**
1. BASE MAP DEVELOPED FROM INFORMATION PROVIDED BY RMT, INC. ON 10/26/04
 2. BASE MAP DEVELOPED FROM AERIAL PHOTOGRAPHS DATED 3/26/1999 PREPARED BY AEROMETRICS, INC., SHEBOYGAN, WISCONSIN.
 3. VERTICAL DATUM (ELEVATION) IS REFERENCED TO USGS MEAN SEA LEVEL DATUM, 1929 ADJUSTMENT. TOPOGRAPHIC CONTOUR INTERVAL: 2 FEET.
 4. THE HORIZONTAL DATUM IS BASED ON THE WISCONSIN STATE PLANE COORDINATE SYSTEM, NORTH AMERICAN DATUM (NAD) 1927 - WISCONSIN SOUTH.
 5. MONITORING WELL LOCATIONS AND ELEVATIONS ARE BASED ON A SURVEY PERFORMED BY SPATIAL DATA SURVEYS ON DECEMBER 2001, JANUARY 2002, JUNE 2002, AND APRIL 2003.
 6. SITE BENCHMARKS ESTABLISHED BASED ON SURVEY FROM BENCHMARK MONUMENT LOCATED ON THE SOUTHWEST CORNER OF THE INTERSECTION OF MAPLETON ROAD AND MILL ROAD, NE 1/4 OF NE 1/4 OF SECTION 8, TOWNSHIP 8 NORTH, RANGE 17 EAST.
 7. THE PRIVATE OR SUPPLY WELLS SHOWN ON THIS MAP REPRESENT A PORTION OF THE PRIVATE WELLS SERVING THE RESIDENTS OR BUSINESSES IN THE TOWN OF ASHIPUN, AND REPRESENT A PORTION OF THESE WELLS THAT LIKELY EXIST WITHIN THE CONFINED AREA OF THIS MAP.

- LEGEND**
- SITE INSTRUMENTATION**
- ⊕ BEDROCK MONITORING WELL
 - ⊕ DEEP UNCONSOLIDATED MONITORING WELL
 - ⊕ SHALLOW UNCONSOLIDATED MONITORING WELL
 - DRIVE POINT WELL
 - ◆ EXTRACTION WELL
 - ⊕ MONITORING WELL
 - RESIDENTIAL WELL
 - DEEP UNCONSOLIDATED SENTINEL WELL
 - SHALLOW UNCONSOLIDATED SENTINEL WELL
 - ⊕ STAFF GAUGE
 - ▨ CURRENT SITE BUILDING
 - ▭ FORMER OEIC SITE BUILDING
 - - - FORMER OEIC SITE BOUNDARY
 - ××× FENCED AREA
- ELEVATION CONTOUR (FT ABOVE MEAN SEA LEVEL)
CONTOUR INTERVAL = 2FT

FIGURE 2
Site Monitoring Well Locations - January 2009
Annual Groundwater Report - May 2009
OEIC Site

