

Notice: This form may be used to comply with the requirements of s. NR 716.14 (2), Wis. Adm. Code; however, use of this form is not required. An alternate format may be used. The rule requires that notification be provided to 1) property owners when someone else is conducting the sampling, 2) to occupants of property belonging to the responsible person, and 3) to owners and occupants of property that does not belong to the responsible person but has been affected by contamination arising on his or her property. Notification is required within 10 business days of receiving the sample results. Personal information collected will be used for program administration and may be provided to requesters to the extent required by Wisconsin's Open Records law [ss. 19.31-19.39, Wis. Stats.].

NOTE: Under s. NR 716.14, Wis. Adm. Code, the responsible party must also submit sample results and other required information to the DNR. We recommend that copies of the sample results notifications be included with that submittal, along with all attachments. Using the same format used for data presentation for a closure request may be helpful to all parties. See s. NR 716.14, Wis. Adm. Code for the full list of information to be submitted to the DNR.

Notification of Property Owners and Occupants:

This notification form has been provided to you in order to provide the results of environmental sampling that has been conducted on property that you own or occupy. Samples were collected in accordance with the methods identified in the site investigation work plan, in accordance with s. NR. 716.09 and 716.13, Wis. Adm. Code. This sampling was conducted as a result of contamination originating at the following location.

Site Information			
Site Name		DNR ID # (BRRTS #)	
Oconomowoc Electroplating Company, Inc. (OECI) Superfund Site		02-14-000905	
Address	City	State	ZIP Code
W2573 Oak Street	Ashippun	WI	53003

Responsible Party

The person(s) responsible for completing this environmental investigation is:

Property Owner

Oconomowoc Electroplating Company, Inc.			
Address	City	State	ZIP Code
W2573 Oak Street	Ashippun	WI	53003
Contact Person	Phone Number (include area code)		
Gwen Saliars (WDNR PM), William Murray (US EPA Remedial PM)	(920) 510-4343		

Person or company that collected samples

Hyde Environmental, Inc.

Sample Results (Results Attached)

Reason for Sampling: Routine Other (define) _____

The contaminants that have been identified at this time on property that you own or occupy include:

Contaminant	In Soil?		In Groundwater?	
	Yes	No	Yes	No
Gasoline	<input type="radio"/>	<input checked="" type="radio"/>	<input type="radio"/>	<input checked="" type="radio"/>
Diesel or Fuel Oil	<input type="radio"/>	<input checked="" type="radio"/>	<input type="radio"/>	<input checked="" type="radio"/>
Solvents	<input type="radio"/>	<input checked="" type="radio"/>	<input checked="" type="radio"/>	<input type="radio"/>
Heavy Metals	<input type="radio"/>	<input checked="" type="radio"/>	<input type="radio"/>	<input checked="" type="radio"/>
Pesticides	<input type="radio"/>	<input checked="" type="radio"/>	<input type="radio"/>	<input checked="" type="radio"/>
Other: _____	<input type="radio"/>	<input checked="" type="radio"/>	<input type="radio"/>	<input checked="" type="radio"/>

This sampling event included sampling of a drinking water well. <input checked="" type="radio"/> Yes <input type="radio"/> No
If yes, the sampled drinking water well had detectable contaminants. <input checked="" type="radio"/> Yes <input type="radio"/> No

	Contaminants in Vapor	
	Yes	No
Indoor Air	<input type="radio"/>	<input checked="" type="radio"/>
Sub-slab	<input type="radio"/>	<input checked="" type="radio"/>
Exterior Soil Gas	<input type="radio"/>	<input checked="" type="radio"/>

Site Investigation Sample Results Notification

Form 4400-249 (R 03/14)

Page 2 of 2

Attached are:

- A map that shows the locations from which samples were collected. (The map needs to meet the requirements of s. NR 716.15 (4), Wis. Adm. Code.)
- A data table with specific contaminant levels at each sample location and whether or not the sample results exceed state standards.
- A copy of the laboratory results.

You are not identified as the person that is responsible for this contamination. However, your cooperation is important. Property owners may become legally responsible for contamination if they do not allow access to the person that is responsible so that person may complete the environmental investigation and clean up activities.

Option for written exemption: You have the option of requesting a written liability exemption from the DNR for contamination that originated on another property, or on property that you lease. To do this, you must present an adequate environmental assessment of your property and pay a \$700 fee for review of this information. If you are interested in this option, please see DNR publication # RR 589, "When Contamination Crosses a Property Line - Rights and Responsibilities of Property Owners", available at: dnr.wi.gov/files/PDF/pubs/rr/rr589.pdf.

Contact Information

Please address questions regarding this notification, or requests for additional information to the contact person listed above, or to one of the following contacts:

Environmental Consultant

Company Name		Contact Person Last Name		First Name	
Hyde Environmental, Inc.		Pagels		Corey	
Address			City	State	ZIP Code
W175 N11163 Stonewood Drive, Suite 110			Germantown	WI	53022
Phone # (inc. area code)	Email				
(262) 250-1226	cpagels@hyde-env.com				

Select which agency: Natural Resources Agriculture, Trade and Consumer Protection

State of Wisconsin Department of Natural Resources

Contact Person Last Name		First Name		Phone # (inc. area code)	
Saliars		Gwen		(920) 510-4343	
Address			City	State	ZIP Code
625 E County Road Y, Suite 700			Oshkosh	WI	54901
Email					
gwen.saliars@wisconsin.gov					

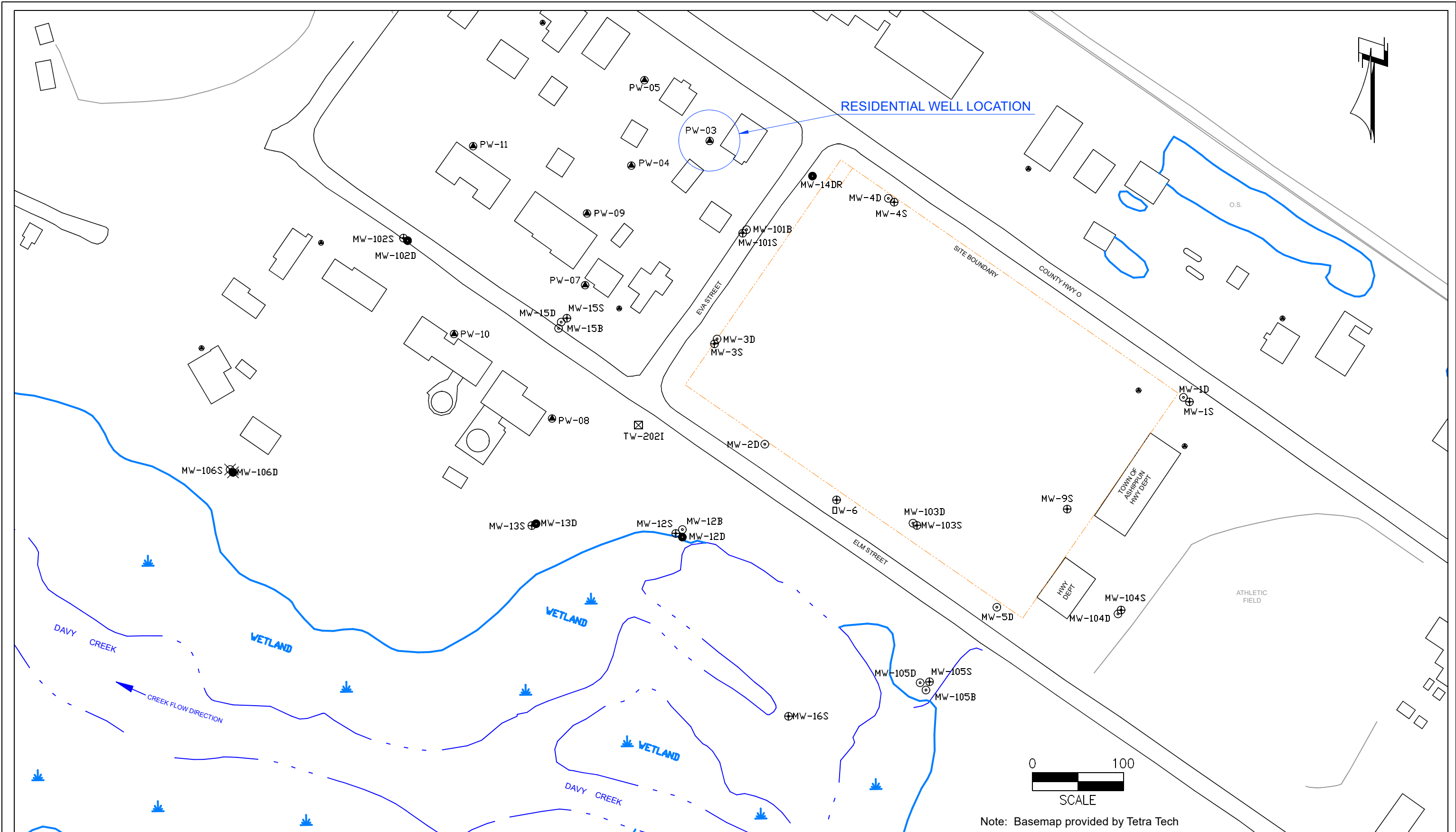

RESIDENTIAL WELL LOCATION

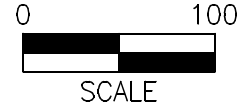

Note: Basemap provided by Tetra Tech

⊕ MW-105B	BEDROCK MONITORING WELL	● PW-11	RESIDENTIAL WELL
● MW-105D	DEEP UNCONSOLIDATED MONITORING WELL	● MW-106D	DEEP UNCONSOLIDATED SENTINEL WELL
⊕ MW-105S	SHALLOW UNCONSOLIDATED MONITORING WELL	⊗ MW-106S	SHALLOW UNCONSOLIDATED SENTINEL WELL
-----	FORMER OECI SITE BOUNDARY		



Figure 1
SITE MAP
Oconomowoc Electroplating Company, Inc.
Ashippun, WI

GROUNDWATER ANALYTICAL RESULTS SUMMARY

W2601 Oak Street, Ashippun, WI

Sampled December 1, 2021

Parameters (ug/L)	<i>NR 140 Groundwater Quality Health Standards</i>		PW-03
	<i>ES</i>	<i>PAL</i>	
VOCs			
1,2-Dichloroethane	5	0.5	0.036 J
cis-1,2-Dichloroethene	70	7	3.0
trans-1,2-Dichloroethene	100	20	0.12
Methyl tert-butyl ether (MTBE)	60	12	0.70
Trichloroethene	5	0.5	<i>0.51</i>
1,4-Dioxane	3	0.3	< 0.40

Notes:

PAL = Preventive Action Limit

ES = Enforcement Standard

Italicized values attain or exceed the NR 140 PAL

ug/L = micrograms per liter

< = less than the laboratory method detection limit (MDL)

J = Result is less than the laboratory Reporting Limit but > or = to the laboratory MDL

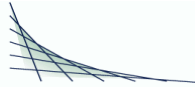

ANALYTICAL REPORT

HYDE ENVIRONMENTAL, INC.
 JIM LINDEMANN
 W175 N11163 STONEWOOD DRIVE
 SUITE 110
 GERMANTOWN, WI 53022-6501

Project Name: OCONOMOWOC ELECTROPLATING
 Project Phase: ASHIPUN, WI
 Project #:
 Folder #: 166239
 Purchase Order #:
 Contract #: 3451

Page 1 of 5
 Arrival Temperature: 4.5
 Report Date: 12/22/2021
 Date Received: 12/3/2021
 Reprint Date: 12/22/2021

CT LAB#: 1080789	Sample Description: PW-03	DNR License/Well #: 04189/051	Sampled: 12/1/2021 19:30
------------------	---------------------------	-------------------------------	--------------------------

Analyte	Result	Units	LOD	LOQ	Dilution	Qualifier	Prep Date/Time	Analysis Date/Time	Analyst	Method
Organic Results										
1,1,1,2-Tetrachloroethane	<0.013	ug/L	0.013	0.10	1	U	12/8/2021 12:15	12/8/2021 12:15	RLD	EPA 8260C
1,1,1-Trichloroethane	<0.013	ug/L	0.013	0.10	1	U	12/8/2021 12:15	12/8/2021 12:15	RLD	EPA 8260C
1,1,2,2-Tetrachloroethane	<0.015	ug/L	0.015	0.10	1	U	12/8/2021 12:15	12/8/2021 12:15	RLD	EPA 8260C
1,1,2-Trichloroethane	<0.036	ug/L	0.036	0.20	1	U	12/8/2021 12:15	12/8/2021 12:15	RLD	EPA 8260C
1,1-Dichloroethane	<0.017	ug/L	0.017	0.10	1	U	12/8/2021 12:15	12/8/2021 12:15	RLD	EPA 8260C
1,1-Dichloroethene	<0.024	ug/L	0.024	0.10	1	U	12/8/2021 12:15	12/8/2021 12:15	RLD	EPA 8260C
1,1-Dichloropropene	<0.074	ug/L	0.074	0.20	1	U	12/8/2021 12:15	12/8/2021 12:15	RLD	EPA 8260C
1,2,3-Trichlorobenzene	<0.019	ug/L	0.019	0.10	1	U	12/8/2021 12:15	12/8/2021 12:15	RLD	EPA 8260C
1,2,3-Trichloropropane	<0.031	ug/L	0.031	0.20	1	U	12/8/2021 12:15	12/8/2021 12:15	RLD	EPA 8260C
1,2,4-Trichlorobenzene	<0.022	ug/L	0.022	0.10	1	U	12/8/2021 12:15	12/8/2021 12:15	RLD	EPA 8260C
1,2,4-Trimethylbenzene	<0.011	ug/L	0.011	0.10	1	U	12/8/2021 12:15	12/8/2021 12:15	RLD	EPA 8260C
1,2-Dibromo-3-chloropropane	<0.12	ug/L	0.12	0.40	1	U	12/8/2021 12:15	12/8/2021 12:15	RLD	EPA 8260C
1,2-Dibromoethane	<0.029	ug/L	0.029	0.20	1	U	12/8/2021 12:15	12/8/2021 12:15	RLD	EPA 8260C
1,2-Dichlorobenzene	<0.016	ug/L	0.016	0.10	1	U	12/8/2021 12:15	12/8/2021 12:15	RLD	EPA 8260C
1,2-Dichloroethane	0.036	ug/L	0.017	0.10	1	J	12/8/2021 12:15	12/8/2021 12:15	RLD	EPA 8260C
1,2-Dichloropropane	<0.013	ug/L	0.013	0.10	1	U	12/8/2021 12:15	12/8/2021 12:15	RLD	EPA 8260C

Unless specifically stated to the contrary, soil/sediment/sludge sample results/LOD/LOQ/RLs were reported on a Dry Weight Basis

CT LAB#: 1080789	Sample Description:PW-03	DNR License/Well #: 04189/051	Sampled: 12/1/2021 19:30
------------------	--------------------------	-------------------------------	--------------------------

Analyte	Result	Units	LOD	LOQ	Dilution	Qualifier	Prep Date/Time	Analysis Date/Time	Analyst	Method
1,3,5-Trimethylbenzene	<0.013	ug/L	0.013	0.10	1	U		12/8/2021 12:15	RLD	EPA 8260C
1,3-Dichlorobenzene	<0.013	ug/L	0.013	0.10	1	U		12/8/2021 12:15	RLD	EPA 8260C
1,3-Dichloropropane	<0.020	ug/L	0.020	0.10	1	U		12/8/2021 12:15	RLD	EPA 8260C
1,4-Dichlorobenzene	<0.017	ug/L	0.017	0.10	1	U		12/8/2021 12:15	RLD	EPA 8260C
2,2-Dichloropropane	<0.075	ug/L	0.075	0.30	1	U		12/8/2021 12:15	RLD	EPA 8260C
2-Butanone	<0.31	ug/L	0.31	2.0	1	U		12/8/2021 12:15	RLD	EPA 8260C
2-Chlorotoluene	<0.020	ug/L	0.020	0.10	1	U		12/8/2021 12:15	RLD	EPA 8260C
2-Hexanone	<0.15	ug/L	0.15	1.0	1	U		12/8/2021 12:15	RLD	EPA 8260C
4-Chlorotoluene	<0.013	ug/L	0.013	0.10	1	U		12/8/2021 12:15	RLD	EPA 8260C
4-Methyl-2-pentanone	<0.19	ug/L	0.19	1.0	1	U		12/8/2021 12:15	RLD	EPA 8260C
Acetone	<0.84	ug/L	0.84	4.0	1	U		12/8/2021 12:15	RLD	EPA 8260C
Benzene	<0.022	ug/L	0.022	0.10	1	U		12/8/2021 12:15	RLD	EPA 8260C
Bromobenzene	<0.018	ug/L	0.018	0.10	1	U		12/8/2021 12:15	RLD	EPA 8260C
Bromochloromethane	<0.034	ug/L	0.034	0.20	1	U		12/8/2021 12:15	RLD	EPA 8260C
Bromodichloromethane	<0.019	ug/L	0.019	0.10	1	U		12/8/2021 12:15	RLD	EPA 8260C
Bromoform	<0.041	ug/L	0.041	0.20	1	U		12/8/2021 12:15	RLD	EPA 8260C
Bromomethane	<0.052	ug/L	0.052	0.20	1	U		12/8/2021 12:15	RLD	EPA 8260C
Carbon disulfide	<0.11	ug/L	0.11	0.40	1	U		12/8/2021 12:15	RLD	EPA 8260C
Carbon tetrachloride	<0.018	ug/L	0.018	0.10	1	U		12/8/2021 12:15	RLD	EPA 8260C
Chlorobenzene	<0.013	ug/L	0.013	0.10	1	U		12/8/2021 12:15	RLD	EPA 8260C
Chloroethane	<0.40	ug/L	0.40	1.5	1	U		12/8/2021 12:15	RLD	EPA 8260C
Chloroform	<0.016	ug/L	0.016	0.10	1	U		12/8/2021 12:15	RLD	EPA 8260C
Chloromethane	<0.045	ug/L	0.045	0.20	1	U		12/8/2021 12:15	RLD	EPA 8260C
cis-1,2-Dichloroethene	3.0	ug/L	0.023	0.10	1			12/8/2021 12:15	RLD	EPA 8260C
cis-1,3-Dichloropropene	<0.014	ug/L	0.014	0.10	1	U		12/8/2021 12:15	RLD	EPA 8260C
Dibromochloromethane	<0.016	ug/L	0.016	0.10	1	U		12/8/2021 12:15	RLD	EPA 8260C

Unless specifically stated to the contrary, soil/sediment/sludge sample results/LOD/LOQ/RLs were reported on a Dry Weight Basis

CT LAB#: 1080789 Sample Description:PW-03

DNR License/Well #: 04189/051

Sampled: 12/1/2021 19:30

Analyte	Result	Units	LOD	LOQ	Dilution	Qualifier	Prep Date/Time	Analysis Date/Time	Analyst	Method
Dibromomethane	<0.018	ug/L	0.018	0.10	1	U		12/8/2021 12:15	RLD	EPA 8260C
Dichlorodifluoromethane	<0.091	ug/L	0.091	0.30	1	U		12/8/2021 12:15	RLD	EPA 8260C
Diisopropyl ether	<0.02	ug/L	0.02	0.1	1	U		12/8/2021 12:15	RLD	EPA 8260C
Ethylbenzene	<0.014	ug/L	0.014	0.10	1	U		12/8/2021 12:15	RLD	EPA 8260C
Hexachlorobutadiene	<0.027	ug/L	0.027	0.20	1	U		12/8/2021 12:15	RLD	EPA 8260C
Isopropylbenzene	<0.014	ug/L	0.014	0.10	1	U		12/8/2021 12:15	RLD	EPA 8260C
m & p-Xylene	<0.022	ug/L	0.022	0.20	1	U		12/8/2021 12:15	RLD	EPA 8260C
Methyl tert-butyl ether	0.70	ug/L	0.014	0.10	1			12/8/2021 12:15	RLD	EPA 8260C
Methylene chloride	<0.090	ug/L	0.090	0.40	1	U		12/8/2021 12:15	RLD	EPA 8260C
n-Butylbenzene	<0.021	ug/L	0.021	0.10	1	U		12/8/2021 12:15	RLD	EPA 8260C
n-Propylbenzene	<0.013	ug/L	0.013	0.10	1	U		12/8/2021 12:15	RLD	EPA 8260C
Naphthalene	<0.025	ug/L	0.025	0.10	1	U		12/8/2021 12:15	RLD	EPA 8260C
o-Xylene	<0.016	ug/L	0.016	0.10	1	U		12/8/2021 12:15	RLD	EPA 8260C
p-Isopropyltoluene	<0.016	ug/L	0.016	0.10	1	U		12/8/2021 12:15	RLD	EPA 8260C
sec-Butylbenzene	<0.012	ug/L	0.012	0.10	1	U		12/8/2021 12:15	RLD	EPA 8260C
Styrene	<0.014	ug/L	0.014	0.10	1	U		12/8/2021 12:15	RLD	EPA 8260C
tert-Butylbenzene	<0.013	ug/L	0.013	0.10	1	U		12/8/2021 12:15	RLD	EPA 8260C
Tetrachloroethene	<0.028	ug/L	0.028	0.20	1	U		12/8/2021 12:15	RLD	EPA 8260C
Tetrahydrofuran	<0.38	ug/L	0.38	2.0	1	U		12/8/2021 12:15	RLD	EPA 8260C
Toluene	<0.014	ug/L	0.014	0.10	1	U		12/8/2021 12:15	RLD	EPA 8260C
trans-1,2-Dichloroethene	0.12	ug/L	0.020	0.10	1			12/8/2021 12:15	RLD	EPA 8260C
trans-1,3-Dichloropropene	<0.020	ug/L	0.020	0.10	1	U		12/8/2021 12:15	RLD	EPA 8260C
Trichloroethene	0.51	ug/L	0.022	0.10	1			12/8/2021 12:15	RLD	EPA 8260C
Trichlorofluoromethane	<0.033	ug/L	0.033	0.20	1	U		12/8/2021 12:15	RLD	EPA 8260C
Vinyl acetate	<0.14	ug/L	0.14	1.0	1	U		12/8/2021 12:15	RLD	EPA 8260C
Vinyl chloride	<0.019	ug/L	0.019	0.10	1	U		12/8/2021 12:15	RLD	EPA 8260C

Unless specifically stated to the contrary, soil/sediment/sludge sample results/LOD/LOQ/RLs were reported on a Dry Weight Basis

CT LAB#: 1080789	Sample Description:PW-03	DNR License/Well #: 04189/051	Sampled: 12/1/2021 19:30
------------------	--------------------------	-------------------------------	--------------------------

Analyte	Result	Units	LOD	LOQ	Dilution	Qualifier	Prep Date/Time	Analysis Date/Time	Analyst	Method
1,4-Dioxane	<0.40	ug/L	0.40	1.4	1	U	12/6/2021 12:00	12/9/2021 14:19	JJY	EPA 8270D-SIM

Notes: All LOD/LOQs are adjusted to reflect dilution, percent solids, and any differences in the sample weight / volume as compared to standard amounts.
"U" qualifier indicates concentration of analyte was below the detection limit. "J" qualifier indicates an estimated value between the LOD and LOQ.

All samples were received intact and properly preserved unless otherwise noted. The results reported relate only to the samples tested. This report shall not be reproduced, except in full, without written approval of this laboratory. The Chain of Custody is attached.

Brett M. Szymanski
Project Manager
Submitted by: 608-356-2760

Current CT Laboratories Certifications

Wisconsin (WDNR) Chemistry ID# 157066030

Wisconsin (DATCP) Bacteriology ID# 289

Louisiana NELAP (primary) ID# 115843

Illinois NELAP Lab ID# 200073

Kansas NELAP Lab ID# E-10368

Virginia NELAP Lab ID# 460203

ISO/IEC 17025-2005 A2LA Cert # 3806.01

DoD-ELAP A2LA 3806.01

Company: Hyde Environmental
 Project Contact: Jim Lindemann
 Telephone: (262) 250-1226
 Project Name: Ocon. Electroplating
 Project #:
 Location: Ashippun, WI
 Sampled By: Bob Thomson

CT LABORATORIES

1230 Lange Court, Baraboo, WI 53913
 608-356-2760 Fax 608-356-2766
 www.ctlaboratories.com

Report To:
 EMAIL: jc.lindemann@hyde-env.com
 Company: Hyde Environmental, INC
 Address: W175 N 11163 Stonewood Dr.
Greenmontown, WI 53022
 Invoice To:*
 EMAIL:
 Company:
 Address:

Lab Use Only
 Place Header Sticker Here:

166239

Program:
 QSM RCRA SDWA NPDES
 Solid Waste Other

PO #

*Party listed is responsible for payment of invoice as per CT Laboratories' terms and conditions

Client Special Instructions

Matrix:
 GW - groundwater SW - surface water WW - wastewater DW - drinking water
 S - soil/sediment SL - sludge A - air M - misc/waste

Filtered? Y/N

VOC (8260C) low level
1,4 Dioxane (8270D-SIM)

ANALYSES REQUESTED

Total # Containers

Designated MS/MSD

Turnaround Time
 Normal RUSH*
 Date Needed:
 Rush analysis requires prior
 CT Laboratories' approval
 Surcharges:
 24 hr 200%
 2-3 days 100%
 4-9 days 50%

Collection		Matrix	Grab/Comp	Sample #	Sample ID Description	Filtered?	ANALYSES REQUESTED										Total # Containers	Designated MS/MSD	CT Lab ID # <small>Lab use only</small>
Date	Time						Fill in Spaces with Bottles per Test												
<u>12/1/21</u>	<u>1930</u>	<u>DW</u>	<u>G</u>		<u>PW-03</u>	<u>N</u>	<u>4</u>	<u>2</u>									<u>1080789</u>		

Relinquished By: <u>[Signature]</u>	Date/Time <u>12-2-21 0946</u>	Received By: <u>EAC</u>	Date/Time <u>12/1/21 1058</u>	Lab Use Only Ice Present <input checked="" type="checkbox"/> Yes No
Received by:	Date/Time	Received for Laboratory by: <u>[Signature]</u>	Date/Time <u>12/3/21 1223</u>	Temp <u>64.8</u> IR Gun <u>27</u> Cooler # <u>6691, 6485</u>

Notice: This form may be used to comply with the requirements of s. NR 716.14 (2), Wis. Adm. Code; however, use of this form is not required. An alternate format may be used. The rule requires that notification be provided to 1) property owners when someone else is conducting the sampling, 2) to occupants of property belonging to the responsible person, and 3) to owners and occupants of property that does not belong to the responsible person but has been affected by contamination arising on his or her property. Notification is required within 10 business days of receiving the sample results. Personal information collected will be used for program administration and may be provided to requesters to the extent required by Wisconsin's Open Records law [ss. 19.31-19.39, Wis. Stats.].

NOTE: Under s. NR 716.14, Wis. Adm. Code, the responsible party must also submit sample results and other required information to the DNR. We recommend that copies of the sample results notifications be included with that submittal, along with all attachments. Using the same format used for data presentation for a closure request may be helpful to all parties. See s. NR 716.14, Wis. Adm. Code for the full list of information to be submitted to the DNR.

Notification of Property Owners and Occupants:

This notification form has been provided to you in order to provide the results of environmental sampling that has been conducted on property that you own or occupy. Samples were collected in accordance with the methods identified in the site investigation work plan, in accordance with s. NR. 716.09 and 716.13, Wis. Adm. Code. This sampling was conducted as a result of contamination originating at the following location.

Site Information			
Site Name		DNR ID # (BRRTS #)	
Oconomowoc Electroplating Company, Inc. (OECI) Superfund Site		02-14-000905	
Address	City	State	ZIP Code
W2573 Oak Street	Ashippun	WI	53003

Responsible Party

The person(s) responsible for completing this environmental investigation is:

Property Owner

Oconomowoc Electroplating Company, Inc.			
Address	City	State	ZIP Code
W2573 Oak Street	Ashippun	WI	53003
Contact Person	Phone Number (include area code)		
Gwen Saliars (WDNR PM), William Murray (US EPA Remedial PM)	(920) 510-4343		

Person or company that collected samples

Hyde Environmental, Inc.

Sample Results (Results Attached)

Reason for Sampling: Routine Other (define) _____

The contaminants that have been identified at this time on property that you own or occupy include:

Contaminant	In Soil?		In Groundwater?	
	Yes	No	Yes	No
Gasoline	<input type="radio"/>	<input checked="" type="radio"/>	<input type="radio"/>	<input checked="" type="radio"/>
Diesel or Fuel Oil	<input type="radio"/>	<input checked="" type="radio"/>	<input type="radio"/>	<input checked="" type="radio"/>
Solvents	<input type="radio"/>	<input checked="" type="radio"/>	<input checked="" type="radio"/>	<input type="radio"/>
Heavy Metals	<input type="radio"/>	<input checked="" type="radio"/>	<input type="radio"/>	<input checked="" type="radio"/>
Pesticides	<input type="radio"/>	<input checked="" type="radio"/>	<input type="radio"/>	<input checked="" type="radio"/>
Other: _____	<input type="radio"/>	<input checked="" type="radio"/>	<input type="radio"/>	<input checked="" type="radio"/>

This sampling event included sampling of a drinking water well. <input checked="" type="radio"/> Yes <input type="radio"/> No
If yes, the sampled drinking water well had detectable contaminants. <input checked="" type="radio"/> Yes <input type="radio"/> No

	Contaminants in Vapor	
	Yes	No
Indoor Air	<input type="radio"/>	<input checked="" type="radio"/>
Sub-slab	<input type="radio"/>	<input checked="" type="radio"/>
Exterior Soil Gas	<input type="radio"/>	<input checked="" type="radio"/>

Site Investigation Sample Results Notification

Form 4400-249 (R 03/14)

Page 2 of 2

Attached are:

- A map that shows the locations from which samples were collected. (The map needs to meet the requirements of s. NR 716.15 (4), Wis. Adm. Code.)
- A data table with specific contaminant levels at each sample location and whether or not the sample results exceed state standards.
- A copy of the laboratory results.

You are not identified as the person that is responsible for this contamination. However, your cooperation is important. Property owners may become legally responsible for contamination if they do not allow access to the person that is responsible so that person may complete the environmental investigation and clean up activities.

Option for written exemption: You have the option of requesting a written liability exemption from the DNR for contamination that originated on another property, or on property that you lease. To do this, you must present an adequate environmental assessment of your property and pay a \$700 fee for review of this information. If you are interested in this option, please see DNR publication # RR 589, "When Contamination Crosses a Property Line - Rights and Responsibilities of Property Owners", available at: dnr.wi.gov/files/PDF/pubs/rr/rr589.pdf.

Contact Information

Please address questions regarding this notification, or requests for additional information to the contact person listed above, or to one of the following contacts:

Environmental Consultant

Company Name		Contact Person Last Name	First Name	
Hyde Environmental, Inc.		Pagels	Corey	
Address		City	State	ZIP Code
W175 N11163 Stonewood Drive, Suite 110		Germantown	WI	53022
Phone # (inc. area code)	Email			
(262) 250-1226	cpagels@hyde-env.com			

Select which agency: Natural Resources Agriculture, Trade and Consumer Protection

State of Wisconsin Department of Natural Resources

Contact Person Last Name	First Name	Phone # (inc. area code)	
Saliars	Gwen	(920) 510-4343	
Address	City	State	ZIP Code
625 E County Road Y, Suite 700	Oshkosh	WI	54901
Email			
gwen.saliars@wisconsin.gov			

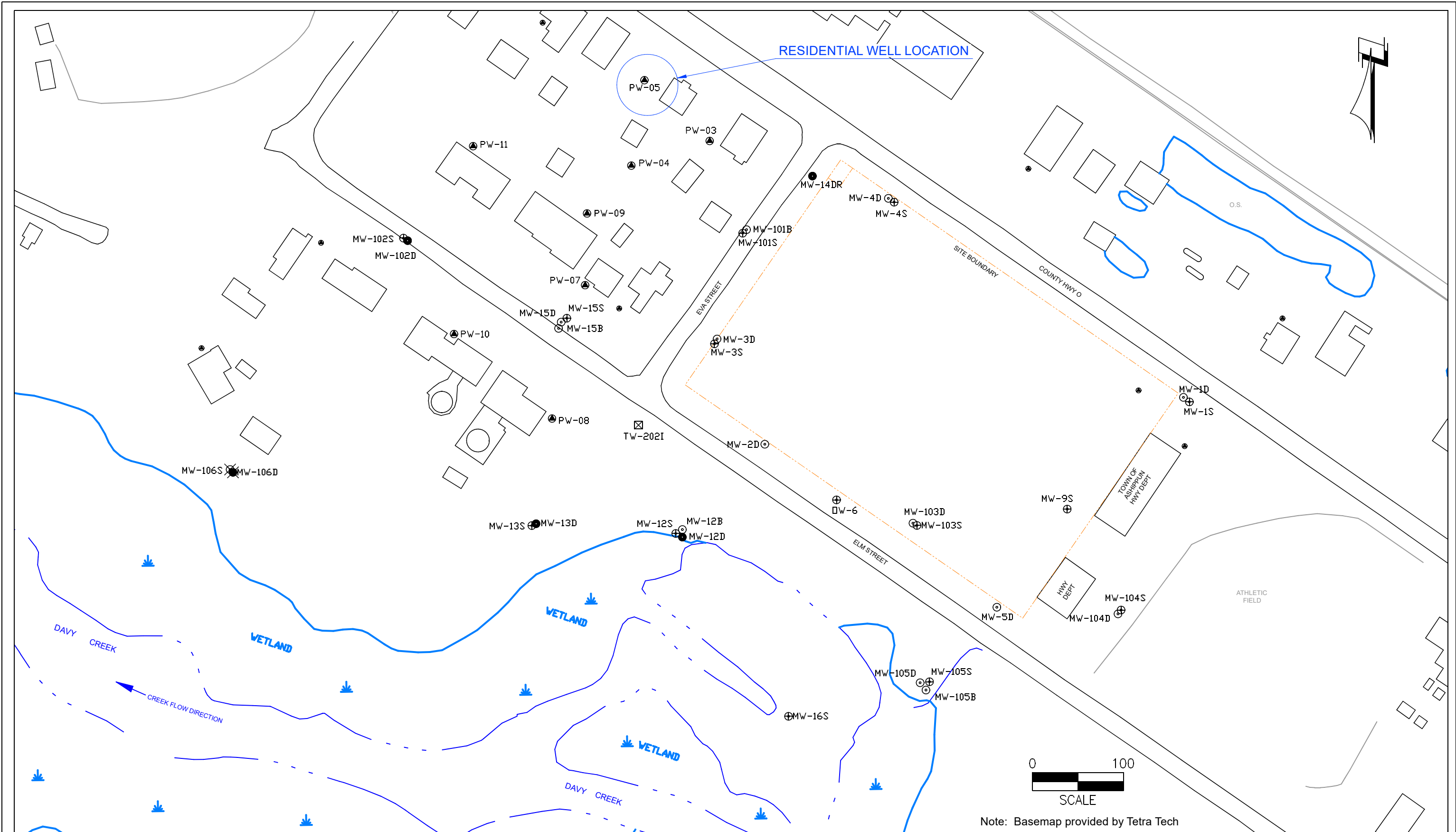

RESIDENTIAL WELL LOCATION

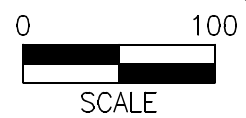

Note: Basemap provided by Tetra Tech

⊕ MW-105B	BEDROCK MONITORING WELL	● PW-11	RESIDENTIAL WELL
● MW-105D	DEEP UNCONSOLIDATED MONITORING WELL	⊗ MW-106D	DEEP UNCONSOLIDATED SENTINEL WELL
⊕ MW-105S	SHALLOW UNCONSOLIDATED MONITORING WELL	⊗ MW-106S	SHALLOW UNCONSOLIDATED SENTINEL WELL
---	FORMER OECI SITE BOUNDARY		



Figure 1
SITE MAP
Oconomowoc Electroplating Company, Inc.
Ashippun, WI

GROUNDWATER ANALYTICAL RESULTS SUMMARY

W2611 Oak Street, Ashippun, WI

Sampled December 1, 2021

Parameters (ug/L)	NR 140 Groundwater Quality Health Standards		PW-05
	ES	PAL	
VOCs			
1,2-Dichloroethane	5	0.5	0.035 J
cis-1,2-Dichloroethene	70	7	1.9
trans-1,2-Dichloroethene	100	20	0.084 J
Methyl tert-butyl ether (MTBE)	60	12	0.71
Trichloroethene	5	0.5	0.097 J
Diisopropyl ether	--	--	0.30
Vinyl acetate	--	--	0.41 J
1,4-Dioxane	3	0.3	< 0.40

Notes:

PAL = Preventive Action Limit

ES = Enforcement Standard

-- = No standard

ug/L = micrograms per liter

< = less than the laboratory method detection limit (MDL)

J = Result is less than the laboratory Reporting Limit but > or = to the laboratory MDL

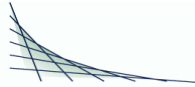

ANALYTICAL REPORT

HYDE ENVIRONMENTAL, INC.
 JIM LINDEMANN
 W175 N11163 STONEWOOD DRIVE
 SUITE 110
 GERMANTOWN, WI 53022-6501

Project Name: OCONOMOWOC ELECTROPLATING
 Project Phase: ASHIPUN, WI
 Project #:
 Folder #: 166239
 Purchase Order #:
 Contract #: 3451

Page 1 of 5
 Arrival Temperature: 4.5
 Report Date: 12/22/2021
 Date Received: 12/3/2021
 Reprint Date: 12/22/2021

CT LAB#: 1080788	Sample Description: PW-05	DNR License/Well #: 04189/053	Sampled: 12/1/2021 17:00
------------------	---------------------------	-------------------------------	--------------------------

Analyte	Result	Units	LOD	LOQ	Dilution	Qualifier	Prep Date/Time	Analysis Date/Time	Analyst	Method
Organic Results										
1,1,1,2-Tetrachloroethane	<0.013	ug/L	0.013	0.10	1	U	12/8/2021 11:47	12/8/2021 11:47	RLD	EPA 8260C
1,1,1-Trichloroethane	<0.013	ug/L	0.013	0.10	1	U	12/8/2021 11:47	12/8/2021 11:47	RLD	EPA 8260C
1,1,2,2-Tetrachloroethane	<0.015	ug/L	0.015	0.10	1	U	12/8/2021 11:47	12/8/2021 11:47	RLD	EPA 8260C
1,1,2-Trichloroethane	<0.036	ug/L	0.036	0.20	1	U	12/8/2021 11:47	12/8/2021 11:47	RLD	EPA 8260C
1,1-Dichloroethane	<0.017	ug/L	0.017	0.10	1	U	12/8/2021 11:47	12/8/2021 11:47	RLD	EPA 8260C
1,1-Dichloroethene	<0.024	ug/L	0.024	0.10	1	U	12/8/2021 11:47	12/8/2021 11:47	RLD	EPA 8260C
1,1-Dichloropropene	<0.074	ug/L	0.074	0.20	1	U	12/8/2021 11:47	12/8/2021 11:47	RLD	EPA 8260C
1,2,3-Trichlorobenzene	<0.019	ug/L	0.019	0.10	1	U	12/8/2021 11:47	12/8/2021 11:47	RLD	EPA 8260C
1,2,3-Trichloropropane	<0.031	ug/L	0.031	0.20	1	U	12/8/2021 11:47	12/8/2021 11:47	RLD	EPA 8260C
1,2,4-Trichlorobenzene	<0.022	ug/L	0.022	0.10	1	U	12/8/2021 11:47	12/8/2021 11:47	RLD	EPA 8260C
1,2,4-Trimethylbenzene	<0.011	ug/L	0.011	0.10	1	U	12/8/2021 11:47	12/8/2021 11:47	RLD	EPA 8260C
1,2-Dibromo-3-chloropropane	<0.12	ug/L	0.12	0.40	1	U	12/8/2021 11:47	12/8/2021 11:47	RLD	EPA 8260C
1,2-Dibromoethane	<0.029	ug/L	0.029	0.20	1	U	12/8/2021 11:47	12/8/2021 11:47	RLD	EPA 8260C
1,2-Dichlorobenzene	<0.016	ug/L	0.016	0.10	1	U	12/8/2021 11:47	12/8/2021 11:47	RLD	EPA 8260C
1,2-Dichloroethane	0.035	ug/L	0.017	0.10	1	J	12/8/2021 11:47	12/8/2021 11:47	RLD	EPA 8260C
1,2-Dichloropropane	<0.013	ug/L	0.013	0.10	1	U	12/8/2021 11:47	12/8/2021 11:47	RLD	EPA 8260C

Unless specifically stated to the contrary, soil/sediment/sludge sample results/LOD/LOQ/RLs were reported on a Dry Weight Basis

CT LAB#: 1080788	Sample Description:PW-05	DNR License/Well #: 04189/053	Sampled: 12/1/2021 17:00
------------------	--------------------------	-------------------------------	--------------------------

Analyte	Result	Units	LOD	LOQ	Dilution	Qualifier	Prep Date/Time	Analysis Date/Time	Analyst	Method
1,3,5-Trimethylbenzene	<0.013	ug/L	0.013	0.10	1	U		12/8/2021 11:47	RLD	EPA 8260C
1,3-Dichlorobenzene	<0.013	ug/L	0.013	0.10	1	U		12/8/2021 11:47	RLD	EPA 8260C
1,3-Dichloropropane	<0.020	ug/L	0.020	0.10	1	U		12/8/2021 11:47	RLD	EPA 8260C
1,4-Dichlorobenzene	<0.017	ug/L	0.017	0.10	1	U		12/8/2021 11:47	RLD	EPA 8260C
2,2-Dichloropropane	<0.075	ug/L	0.075	0.30	1	U		12/8/2021 11:47	RLD	EPA 8260C
2-Butanone	<0.31	ug/L	0.31	2.0	1	U		12/8/2021 11:47	RLD	EPA 8260C
2-Chlorotoluene	<0.020	ug/L	0.020	0.10	1	U		12/8/2021 11:47	RLD	EPA 8260C
2-Hexanone	<0.15	ug/L	0.15	1.0	1	U		12/8/2021 11:47	RLD	EPA 8260C
4-Chlorotoluene	<0.013	ug/L	0.013	0.10	1	U		12/8/2021 11:47	RLD	EPA 8260C
4-Methyl-2-pentanone	<0.19	ug/L	0.19	1.0	1	U		12/8/2021 11:47	RLD	EPA 8260C
Acetone	<0.84	ug/L	0.84	4.0	1	U		12/8/2021 11:47	RLD	EPA 8260C
Benzene	<0.022	ug/L	0.022	0.10	1	U		12/8/2021 11:47	RLD	EPA 8260C
Bromobenzene	<0.018	ug/L	0.018	0.10	1	U		12/8/2021 11:47	RLD	EPA 8260C
Bromochloromethane	<0.034	ug/L	0.034	0.20	1	U		12/8/2021 11:47	RLD	EPA 8260C
Bromodichloromethane	<0.019	ug/L	0.019	0.10	1	U		12/8/2021 11:47	RLD	EPA 8260C
Bromoform	<0.041	ug/L	0.041	0.20	1	U		12/8/2021 11:47	RLD	EPA 8260C
Bromomethane	<0.052	ug/L	0.052	0.20	1	U		12/8/2021 11:47	RLD	EPA 8260C
Carbon disulfide	<0.11	ug/L	0.11	0.40	1	U		12/8/2021 11:47	RLD	EPA 8260C
Carbon tetrachloride	<0.018	ug/L	0.018	0.10	1	U		12/8/2021 11:47	RLD	EPA 8260C
Chlorobenzene	<0.013	ug/L	0.013	0.10	1	U		12/8/2021 11:47	RLD	EPA 8260C
Chloroethane	<0.40	ug/L	0.40	1.5	1	U		12/8/2021 11:47	RLD	EPA 8260C
Chloroform	<0.016	ug/L	0.016	0.10	1	U		12/8/2021 11:47	RLD	EPA 8260C
Chloromethane	<0.045	ug/L	0.045	0.20	1	U		12/8/2021 11:47	RLD	EPA 8260C
cis-1,2-Dichloroethene	1.9	ug/L	0.023	0.10	1			12/8/2021 11:47	RLD	EPA 8260C
cis-1,3-Dichloropropene	<0.014	ug/L	0.014	0.10	1	U		12/8/2021 11:47	RLD	EPA 8260C
Dibromochloromethane	<0.016	ug/L	0.016	0.10	1	U		12/8/2021 11:47	RLD	EPA 8260C

Unless specifically stated to the contrary, soil/sediment/sludge sample results/LOD/LOQ/RLs were reported on a Dry Weight Basis

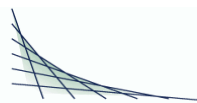

CT LAB#: 1080788 Sample Description:PW-05

DNR License/Well #: 04189/053

Sampled: 12/1/2021 17:00

Analyte	Result	Units	LOD	LOQ	Dilution	Qualifier	Prep Date/Time	Analysis Date/Time	Analyst	Method
Dibromomethane	<0.018	ug/L	0.018	0.10	1	U		12/8/2021 11:47	RLD	EPA 8260C
Dichlorodifluoromethane	<0.091	ug/L	0.091	0.30	1	U		12/8/2021 11:47	RLD	EPA 8260C
Diisopropyl ether	0.30	ug/L	0.02	0.1	1			12/8/2021 11:47	RLD	EPA 8260C
Ethylbenzene	<0.014	ug/L	0.014	0.10	1	U		12/8/2021 11:47	RLD	EPA 8260C
Hexachlorobutadiene	<0.027	ug/L	0.027	0.20	1	U		12/8/2021 11:47	RLD	EPA 8260C
Isopropylbenzene	<0.014	ug/L	0.014	0.10	1	U		12/8/2021 11:47	RLD	EPA 8260C
m & p-Xylene	<0.022	ug/L	0.022	0.20	1	U		12/8/2021 11:47	RLD	EPA 8260C
Methyl tert-butyl ether	0.71	ug/L	0.014	0.10	1			12/8/2021 11:47	RLD	EPA 8260C
Methylene chloride	<0.090	ug/L	0.090	0.40	1	U		12/8/2021 11:47	RLD	EPA 8260C
n-Butylbenzene	<0.021	ug/L	0.021	0.10	1	U		12/8/2021 11:47	RLD	EPA 8260C
n-Propylbenzene	<0.013	ug/L	0.013	0.10	1	U		12/8/2021 11:47	RLD	EPA 8260C
Naphthalene	<0.025	ug/L	0.025	0.10	1	U		12/8/2021 11:47	RLD	EPA 8260C
o-Xylene	<0.016	ug/L	0.016	0.10	1	U		12/8/2021 11:47	RLD	EPA 8260C
p-Isopropyltoluene	<0.016	ug/L	0.016	0.10	1	U		12/8/2021 11:47	RLD	EPA 8260C
sec-Butylbenzene	<0.012	ug/L	0.012	0.10	1	U		12/8/2021 11:47	RLD	EPA 8260C
Styrene	<0.014	ug/L	0.014	0.10	1	U		12/8/2021 11:47	RLD	EPA 8260C
tert-Butylbenzene	<0.013	ug/L	0.013	0.10	1	U		12/8/2021 11:47	RLD	EPA 8260C
Tetrachloroethene	<0.028	ug/L	0.028	0.20	1	U		12/8/2021 11:47	RLD	EPA 8260C
Tetrahydrofuran	<0.38	ug/L	0.38	2.0	1	U		12/8/2021 11:47	RLD	EPA 8260C
Toluene	<0.014	ug/L	0.014	0.10	1	U		12/8/2021 11:47	RLD	EPA 8260C
trans-1,2-Dichloroethene	0.084	ug/L	0.020	0.10	1	J		12/8/2021 11:47	RLD	EPA 8260C
trans-1,3-Dichloropropene	<0.020	ug/L	0.020	0.10	1	U		12/8/2021 11:47	RLD	EPA 8260C
Trichloroethene	0.097	ug/L	0.022	0.10	1	J		12/8/2021 11:47	RLD	EPA 8260C
Trichlorofluoromethane	<0.033	ug/L	0.033	0.20	1	U		12/8/2021 11:47	RLD	EPA 8260C
Vinyl acetate	0.41	ug/L	0.14	1.0	1	J		12/8/2021 11:47	RLD	EPA 8260C
Vinyl chloride	<0.019	ug/L	0.019	0.10	1	U		12/8/2021 11:47	RLD	EPA 8260C

Unless specifically stated to the contrary, soil/sediment/sludge sample results/LOD/LOQ/RLs were reported on a Dry Weight Basis

CT LAB#: 1080788	Sample Description:PW-05	DNR License/Well #: 04189/053	Sampled: 12/1/2021 17:00
------------------	--------------------------	-------------------------------	--------------------------

Analyte	Result	Units	LOD	LOQ	Dilution	Qualifier	Prep Date/Time	Analysis Date/Time	Analyst	Method
1,4-Dioxane	<0.40	ug/L	0.40	1.4	1	U	12/6/2021 12:00	12/9/2021 13:59	JJY	EPA 8270D-SIM

Notes: All LOD/LOQs are adjusted to reflect dilution, percent solids, and any differences in the sample weight / volume as compared to standard amounts.
"U" qualifier indicates concentration of analyte was below the detection limit. "J" qualifier indicates an estimated value between the LOD and LOQ.

All samples were received intact and properly preserved unless otherwise noted. The results reported relate only to the samples tested. This report shall not be reproduced, except in full, without written approval of this laboratory. The Chain of Custody is attached.

Brett M. Szymanski
Project Manager
Submitted by: 608-356-2760

Current CT Laboratories Certifications

Wisconsin (WDNR) Chemistry ID# 157066030

Wisconsin (DATCP) Bacteriology ID# 289

Louisiana NELAP (primary) ID# 115843

Illinois NELAP Lab ID# 200073

Kansas NELAP Lab ID# E-10368

Virginia NELAP Lab ID# 460203

ISO/IEC 17025-2005 A2LA Cert # 3806.01

DoD-ELAP A2LA 3806.01

CHAIN OF CUSTODY

Company: *Hyde Environmental*
 Project Contact: *Jim Lindemann*
 Telephone: *(262) 250-1226*
 Project Name: *Ocon. Electroplating*
 Project #: *—*
 Location: *Ashippun, WI*
 Sampled By: *Bob Thomson*

CT LABORATORIES

1230 Lange Court, Baraboo, WI 53913
 608-356-2760 Fax 608-356-2766
 www.ctlaboratories.com

Report To:
 EMAIL: *jlindemann@hyde-env.com*
 Company: *Hyde Environmental, INC*
 Address: *W175 N11163 Stonewood Dr.
 Fennantown, WI 53022*
 Invoice To:*
 EMAIL:
 Company:
 Address:

Lab Use Only
Place Header Sticker Here:

Program:
 QSM RCRA SDWA NPDES
 Solid Waste Other _____

PO #

186239

*Party listed is responsible for payment of invoice as per CT Laboratories' terms and conditions

Client Special Instructions

ANALYSES REQUESTED

Turnaround Time
 Normal RUSH*
 Date Needed: _____
*Rush analysis requires prior
 CT Laboratories' approval*
 Surcharges:
 24 hr 200%
 2-3 days 100%
 4-9 days 50%

Matrix:
 GW - groundwater SW - surface water WW - wastewater DW - drinking water
 S - soil/sediment SL - sludge A - air M - misc/waste

Filtered? Y/N

*VOC (8260C) low level
1,4 Dioxane (8270D-SIM)*

Total # Containers

Designated MS/MSD

Collection		Matrix	Grab/Comp	Sample #	Sample ID Description	Filtered? Y/N	ANALYSES REQUESTED												Total # Containers	Designated MS/MSD	CT Lab ID # <i>Lab use only</i>
Date	Time						Fill in Spaces with Bottles per Test														
<i>12/1/21</i>	<i>1700</i>	<i>DW</i>	<i>G</i>		<i>PW-05</i>	<i>N</i>	<i>4</i>	<i>2</i>													

Relinquished By: *Robert Thomson*

Date/Time: *12-2-21 0946*

Received By: *VRC*

Date/Time: *12/3/21 1058*

Lab Use Only
 Ice Present *Yes* No
 Temp *4.6* IR Gun *27*
 Cooler # *6693, 6289*

Received by:

Date/Time

Received for Laboratory by: *HJM*

Date/Time: *12/3/21 1223*

Notice: This form may be used to comply with the requirements of s. NR 716.14 (2), Wis. Adm. Code; however, use of this form is not required. An alternate format may be used. The rule requires that notification be provided to 1) property owners when someone else is conducting the sampling, 2) to occupants of property belonging to the responsible person, and 3) to owners and occupants of property that does not belong to the responsible person but has been affected by contamination arising on his or her property. Notification is required within 10 business days of receiving the sample results. Personal information collected will be used for program administration and may be provided to requesters to the extent required by Wisconsin's Open Records law [ss. 19.31-19.39, Wis. Stats.].

NOTE: Under s. NR 716.14, Wis. Adm. Code, the responsible party must also submit sample results and other required information to the DNR. We recommend that copies of the sample results notifications be included with that submittal, along with all attachments. Using the same format used for data presentation for a closure request may be helpful to all parties. See s. NR 716.14, Wis. Adm. Code for the full list of information to be submitted to the DNR.

Notification of Property Owners and Occupants:

This notification form has been provided to you in order to provide the results of environmental sampling that has been conducted on property that you own or occupy. Samples were collected in accordance with the methods identified in the site investigation work plan, in accordance with s. NR. 716.09 and 716.13, Wis. Adm. Code. This sampling was conducted as a result of contamination originating at the following location.

Site Information			
Site Name		DNR ID # (BRRTS #)	
Oconomowoc Electroplating Company, Inc. (OECI) Superfund Site		02-14-000905	
Address	City	State	ZIP Code
W2573 Oak Street	Ashippun	WI	53003

Responsible Party

The person(s) responsible for completing this environmental investigation is:

Property Owner

Oconomowoc Electroplating Company, Inc.			
Address	City	State	ZIP Code
W2573 Oak Street	Ashippun	WI	53003
Contact Person	Phone Number (include area code)		
Gwen Saliars (WDNR PM), William Murray (US EPA Remedial PM)	(920) 510-4343		

Person or company that collected samples

Hyde Environmental, Inc.

Sample Results (Results Attached)

Reason for Sampling: Routine Other (define) _____

The contaminants that have been identified at this time on property that you own or occupy include:

Contaminant	In Soil?		In Groundwater?	
	Yes	No	Yes	No
Gasoline	<input type="radio"/>	<input checked="" type="radio"/>	<input type="radio"/>	<input checked="" type="radio"/>
Diesel or Fuel Oil	<input type="radio"/>	<input checked="" type="radio"/>	<input type="radio"/>	<input checked="" type="radio"/>
Solvents	<input type="radio"/>	<input checked="" type="radio"/>	<input checked="" type="radio"/>	<input type="radio"/>
Heavy Metals	<input type="radio"/>	<input checked="" type="radio"/>	<input type="radio"/>	<input checked="" type="radio"/>
Pesticides	<input type="radio"/>	<input checked="" type="radio"/>	<input type="radio"/>	<input checked="" type="radio"/>
Other: _____	<input type="radio"/>	<input checked="" type="radio"/>	<input type="radio"/>	<input checked="" type="radio"/>

This sampling event included sampling of a drinking water well. <input checked="" type="radio"/> Yes <input type="radio"/> No
If yes, the sampled drinking water well had detectable contaminants. <input checked="" type="radio"/> Yes <input type="radio"/> No

	Contaminants in Vapor	
	Yes	No
Indoor Air	<input type="radio"/>	<input checked="" type="radio"/>
Sub-slab	<input type="radio"/>	<input checked="" type="radio"/>
Exterior Soil Gas	<input type="radio"/>	<input checked="" type="radio"/>

Site Investigation Sample Results Notification

Form 4400-249 (R 03/14)

Page 2 of 2

Attached are:

- A map that shows the locations from which samples were collected. (The map needs to meet the requirements of s. NR 716.15 (4), Wis. Adm. Code.)
- A data table with specific contaminant levels at each sample location and whether or not the sample results exceed state standards.
- A copy of the laboratory results.

You are not identified as the person that is responsible for this contamination. However, your cooperation is important. Property owners may become legally responsible for contamination if they do not allow access to the person that is responsible so that person may complete the environmental investigation and clean up activities.

Option for written exemption: You have the option of requesting a written liability exemption from the DNR for contamination that originated on another property, or on property that you lease. To do this, you must present an adequate environmental assessment of your property and pay a \$700 fee for review of this information. If you are interested in this option, please see DNR publication # RR 589, "When Contamination Crosses a Property Line - Rights and Responsibilities of Property Owners", available at: dnr.wi.gov/files/PDF/pubs/rr/rr589.pdf.

Contact Information

Please address questions regarding this notification, or requests for additional information to the contact person listed above, or to one of the following contacts:

Environmental Consultant

Company Name		Contact Person Last Name	First Name	
Hyde Environmental, Inc.		Pagels	Corey	
Address		City	State	ZIP Code
W175 N11163 Stonewood Drive, Suite 110		Germantown	WI	53022
Phone # (inc. area code)	Email			
(262) 250-1226	cpagels@hyde-env.com			

Select which agency: Natural Resources Agriculture, Trade and Consumer Protection

State of Wisconsin Department of Natural Resources

Contact Person Last Name	First Name	Phone # (inc. area code)	
Saliars	Gwen	(920) 510-4343	
Address	City	State	ZIP Code
625 E County Road Y, Suite 700	Oshkosh	WI	54901
Email			
gwen.saliars@wisconsin.gov			

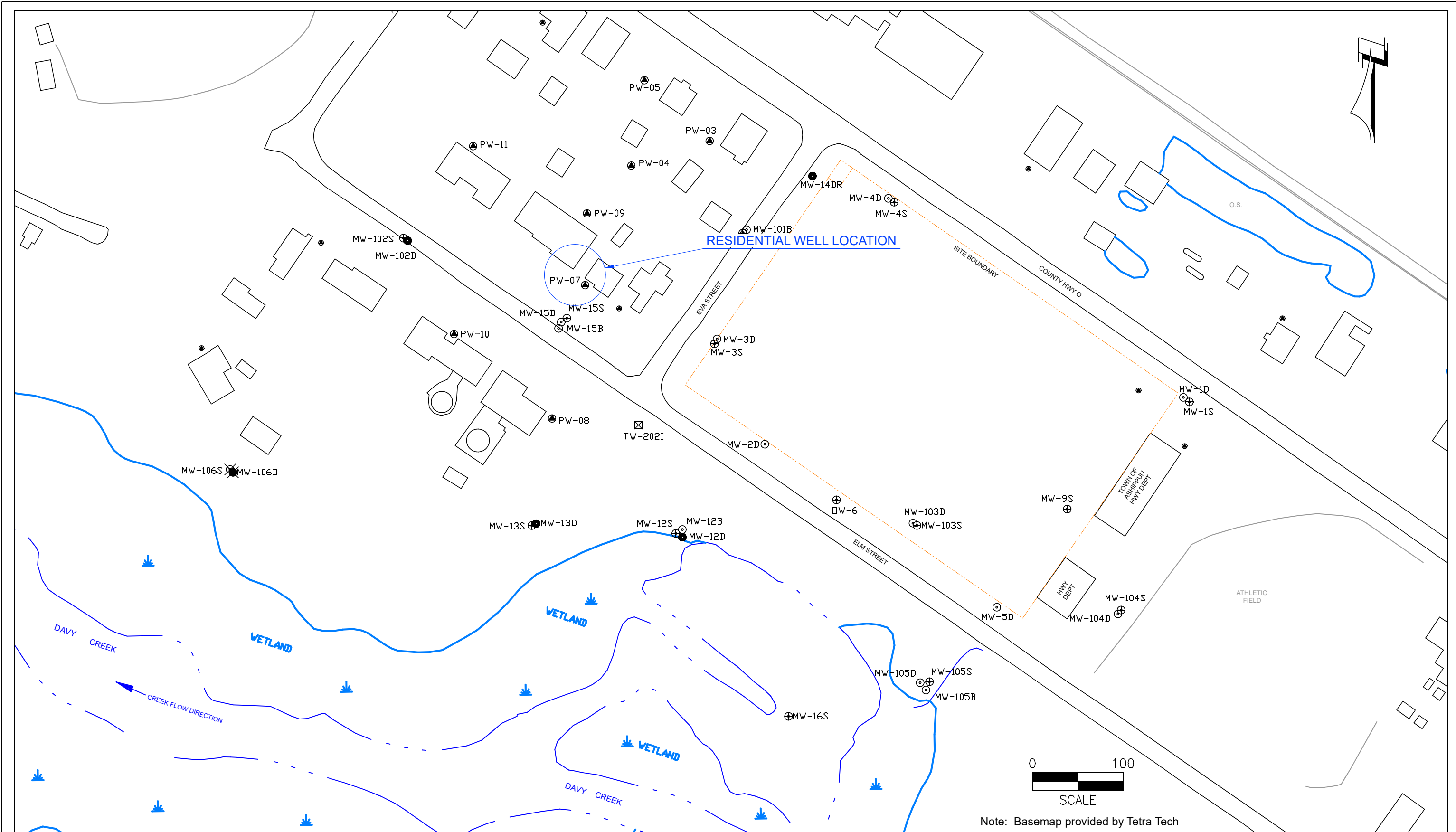

⊕ MW-105B	BEDROCK MONITORING WELL	● PW-11	RESIDENTIAL WELL
● MW-105D	DEEP UNCONSOLIDATED MONITORING WELL	⊗ MW-106D	DEEP UNCONSOLIDATED SENTINEL WELL
⊕ MW-105S	SHALLOW UNCONSOLIDATED MONITORING WELL	⊗ MW-106S	SHALLOW UNCONSOLIDATED SENTINEL WELL
---	FORMER OECI SITE BOUNDARY		

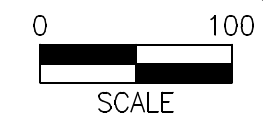

Note: Basemap provided by Tetra Tech



Figure 1
SITE MAP
Oconomowoc Electroplating Company, Inc.
Ashippun, WI

GROUNDWATER ANALYTICAL RESULTS SUMMARY

W2602 Elm Street, Ashippun, WI

Sampled December 1, 2021

Parameters (ug/L)	<i>NR 140 Groundwater Quality Health Standards</i>		
	<i>ES</i>	<i>PAL</i>	PW-07
VOCs			
1,2-Dichloroethane	5	0.5	0.035 J
cis-1,2-Dichloroethene	70	7	5.4
trans-1,2-Dichloroethene	100	20	0.21
Methyl tert-butyl ether (MTBE)	60	12	0.67
Trichloroethene	5	0.5	0.039 J
Vinyl chloride	0.2	0.02	<i>0.038 J</i>
1,4-Dioxane	3	0.3	<i>0.46 J</i>

Notes:

PAL = Preventive Action Limit

ES = Enforcement Standard

Italicized values attain or exceed the NR 140 PAL

ug/L = micrograms per liter

< = less than the laboratory method detection limit (MDL)

J = Result is less than the laboratory Reporting Limit but > or = to the laboratory MDL

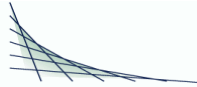

ANALYTICAL REPORT

HYDE ENVIRONMENTAL, INC.
 JIM LINDEMANN
 W175 N11163 STONEWOOD DRIVE
 SUITE 110
 GERMANTOWN, WI 53022-6501

Project Name: OCONOMOWOC ELECTROPLATING
 Project Phase: ASHIPUN, WI
 Project #:
 Folder #: 166239
 Purchase Order #:
 Contract #: 3451

Page 1 of 5
 Arrival Temperature: 4.5
 Report Date: 12/22/2021
 Date Received: 12/3/2021
 Reprint Date: 12/22/2021

CT LAB#: 1080785	Sample Description: PW-07	DNR License/Well #: 04189/054	Sampled: 12/1/2021 15:30
------------------	---------------------------	-------------------------------	--------------------------

Analyte	Result	Units	LOD	LOQ	Dilution	Qualifier	Prep Date/Time	Analysis Date/Time	Analyst	Method
Organic Results										
1,1,1,2-Tetrachloroethane	<0.013	ug/L	0.013	0.10	1	U	12/8/2021 10:21	12/8/2021 10:21	RLD	EPA 8260C
1,1,1-Trichloroethane	<0.013	ug/L	0.013	0.10	1	U	12/8/2021 10:21	12/8/2021 10:21	RLD	EPA 8260C
1,1,2,2-Tetrachloroethane	<0.015	ug/L	0.015	0.10	1	U	12/8/2021 10:21	12/8/2021 10:21	RLD	EPA 8260C
1,1,2-Trichloroethane	<0.036	ug/L	0.036	0.20	1	U	12/8/2021 10:21	12/8/2021 10:21	RLD	EPA 8260C
1,1-Dichloroethane	<0.017	ug/L	0.017	0.10	1	U	12/8/2021 10:21	12/8/2021 10:21	RLD	EPA 8260C
1,1-Dichloroethene	<0.024	ug/L	0.024	0.10	1	U	12/8/2021 10:21	12/8/2021 10:21	RLD	EPA 8260C
1,1-Dichloropropene	<0.074	ug/L	0.074	0.20	1	U	12/8/2021 10:21	12/8/2021 10:21	RLD	EPA 8260C
1,2,3-Trichlorobenzene	<0.019	ug/L	0.019	0.10	1	U	12/8/2021 10:21	12/8/2021 10:21	RLD	EPA 8260C
1,2,3-Trichloropropane	<0.031	ug/L	0.031	0.20	1	U	12/8/2021 10:21	12/8/2021 10:21	RLD	EPA 8260C
1,2,4-Trichlorobenzene	<0.022	ug/L	0.022	0.10	1	U	12/8/2021 10:21	12/8/2021 10:21	RLD	EPA 8260C
1,2,4-Trimethylbenzene	<0.011	ug/L	0.011	0.10	1	U	12/8/2021 10:21	12/8/2021 10:21	RLD	EPA 8260C
1,2-Dibromo-3-chloropropane	<0.12	ug/L	0.12	0.40	1	U	12/8/2021 10:21	12/8/2021 10:21	RLD	EPA 8260C
1,2-Dibromoethane	<0.029	ug/L	0.029	0.20	1	U	12/8/2021 10:21	12/8/2021 10:21	RLD	EPA 8260C
1,2-Dichlorobenzene	<0.016	ug/L	0.016	0.10	1	U	12/8/2021 10:21	12/8/2021 10:21	RLD	EPA 8260C
1,2-Dichloroethane	0.035	ug/L	0.017	0.10	1	J	12/8/2021 10:21	12/8/2021 10:21	RLD	EPA 8260C
1,2-Dichloropropane	<0.013	ug/L	0.013	0.10	1	U	12/8/2021 10:21	12/8/2021 10:21	RLD	EPA 8260C

Unless specifically stated to the contrary, soil/sediment/sludge sample results/LOD/LOQ/RLs were reported on a Dry Weight Basis

CT LAB#: 1080785 Sample Description:PW-07

DNR License/Well #: 04189/054

Sampled: 12/1/2021 15:30

Analyte	Result	Units	LOD	LOQ	Dilution	Qualifier	Prep Date/Time	Analysis Date/Time	Analyst	Method
1,3,5-Trimethylbenzene	<0.013	ug/L	0.013	0.10	1	U		12/8/2021 10:21	RLD	EPA 8260C
1,3-Dichlorobenzene	<0.013	ug/L	0.013	0.10	1	U		12/8/2021 10:21	RLD	EPA 8260C
1,3-Dichloropropane	<0.020	ug/L	0.020	0.10	1	U		12/8/2021 10:21	RLD	EPA 8260C
1,4-Dichlorobenzene	<0.017	ug/L	0.017	0.10	1	U		12/8/2021 10:21	RLD	EPA 8260C
2,2-Dichloropropane	<0.075	ug/L	0.075	0.30	1	U		12/8/2021 10:21	RLD	EPA 8260C
2-Butanone	<0.31	ug/L	0.31	2.0	1	U		12/8/2021 10:21	RLD	EPA 8260C
2-Chlorotoluene	<0.020	ug/L	0.020	0.10	1	U		12/8/2021 10:21	RLD	EPA 8260C
2-Hexanone	<0.15	ug/L	0.15	1.0	1	U		12/8/2021 10:21	RLD	EPA 8260C
4-Chlorotoluene	<0.013	ug/L	0.013	0.10	1	U		12/8/2021 10:21	RLD	EPA 8260C
4-Methyl-2-pentanone	<0.19	ug/L	0.19	1.0	1	U		12/8/2021 10:21	RLD	EPA 8260C
Acetone	<0.84	ug/L	0.84	4.0	1	U		12/8/2021 10:21	RLD	EPA 8260C
Benzene	<0.022	ug/L	0.022	0.10	1	U		12/8/2021 10:21	RLD	EPA 8260C
Bromobenzene	<0.018	ug/L	0.018	0.10	1	U		12/8/2021 10:21	RLD	EPA 8260C
Bromochloromethane	<0.034	ug/L	0.034	0.20	1	U		12/8/2021 10:21	RLD	EPA 8260C
Bromodichloromethane	<0.019	ug/L	0.019	0.10	1	U		12/8/2021 10:21	RLD	EPA 8260C
Bromoform	<0.041	ug/L	0.041	0.20	1	U		12/8/2021 10:21	RLD	EPA 8260C
Bromomethane	<0.052	ug/L	0.052	0.20	1	U		12/8/2021 10:21	RLD	EPA 8260C
Carbon disulfide	<0.11	ug/L	0.11	0.40	1	U		12/8/2021 10:21	RLD	EPA 8260C
Carbon tetrachloride	<0.018	ug/L	0.018	0.10	1	U		12/8/2021 10:21	RLD	EPA 8260C
Chlorobenzene	<0.013	ug/L	0.013	0.10	1	U		12/8/2021 10:21	RLD	EPA 8260C
Chloroethane	<0.40	ug/L	0.40	1.5	1	U		12/8/2021 10:21	RLD	EPA 8260C
Chloroform	<0.016	ug/L	0.016	0.10	1	U		12/8/2021 10:21	RLD	EPA 8260C
Chloromethane	<0.045	ug/L	0.045	0.20	1	U		12/8/2021 10:21	RLD	EPA 8260C
cis-1,2-Dichloroethene	5.4	ug/L	0.023	0.10	1			12/8/2021 10:21	RLD	EPA 8260C
cis-1,3-Dichloropropene	<0.014	ug/L	0.014	0.10	1	U		12/8/2021 10:21	RLD	EPA 8260C
Dibromochloromethane	<0.016	ug/L	0.016	0.10	1	U		12/8/2021 10:21	RLD	EPA 8260C

Unless specifically stated to the contrary, soil/sediment/sludge sample results/LOD/LOQ/RLs were reported on a Dry Weight Basis

CT LAB#: 1080785 Sample Description:PW-07	DNR License/Well #: 04189/054	Sampled: 12/1/2021 15:30
---	-------------------------------	--------------------------

Analyte	Result	Units	LOD	LOQ	Dilution	Qualifier	Prep Date/Time	Analysis Date/Time	Analyst	Method
Dibromomethane	<0.018	ug/L	0.018	0.10	1	U		12/8/2021 10:21	RLD	EPA 8260C
Dichlorodifluoromethane	<0.091	ug/L	0.091	0.30	1	U		12/8/2021 10:21	RLD	EPA 8260C
Diisopropyl ether	<0.02	ug/L	0.02	0.1	1	U		12/8/2021 10:21	RLD	EPA 8260C
Ethylbenzene	<0.014	ug/L	0.014	0.10	1	U		12/8/2021 10:21	RLD	EPA 8260C
Hexachlorobutadiene	<0.027	ug/L	0.027	0.20	1	U		12/8/2021 10:21	RLD	EPA 8260C
Isopropylbenzene	<0.014	ug/L	0.014	0.10	1	U		12/8/2021 10:21	RLD	EPA 8260C
m & p-Xylene	<0.022	ug/L	0.022	0.20	1	U		12/8/2021 10:21	RLD	EPA 8260C
Methyl tert-butyl ether	0.67	ug/L	0.014	0.10	1			12/8/2021 10:21	RLD	EPA 8260C
Methylene chloride	<0.090	ug/L	0.090	0.40	1	U		12/8/2021 10:21	RLD	EPA 8260C
n-Butylbenzene	<0.021	ug/L	0.021	0.10	1	U		12/8/2021 10:21	RLD	EPA 8260C
n-Propylbenzene	<0.013	ug/L	0.013	0.10	1	U		12/8/2021 10:21	RLD	EPA 8260C
Naphthalene	<0.025	ug/L	0.025	0.10	1	U		12/8/2021 10:21	RLD	EPA 8260C
o-Xylene	<0.016	ug/L	0.016	0.10	1	U		12/8/2021 10:21	RLD	EPA 8260C
p-Isopropyltoluene	<0.016	ug/L	0.016	0.10	1	U		12/8/2021 10:21	RLD	EPA 8260C
sec-Butylbenzene	<0.012	ug/L	0.012	0.10	1	U		12/8/2021 10:21	RLD	EPA 8260C
Styrene	<0.014	ug/L	0.014	0.10	1	U		12/8/2021 10:21	RLD	EPA 8260C
tert-Butylbenzene	<0.013	ug/L	0.013	0.10	1	U		12/8/2021 10:21	RLD	EPA 8260C
Tetrachloroethene	<0.028	ug/L	0.028	0.20	1	U		12/8/2021 10:21	RLD	EPA 8260C
Tetrahydrofuran	<0.38	ug/L	0.38	2.0	1	U		12/8/2021 10:21	RLD	EPA 8260C
Toluene	<0.014	ug/L	0.014	0.10	1	U		12/8/2021 10:21	RLD	EPA 8260C
trans-1,2-Dichloroethene	0.21	ug/L	0.020	0.10	1			12/8/2021 10:21	RLD	EPA 8260C
trans-1,3-Dichloropropene	<0.020	ug/L	0.020	0.10	1	U		12/8/2021 10:21	RLD	EPA 8260C
Trichloroethene	0.039	ug/L	0.022	0.10	1	J		12/8/2021 10:21	RLD	EPA 8260C
Trichlorofluoromethane	<0.033	ug/L	0.033	0.20	1	U		12/8/2021 10:21	RLD	EPA 8260C
Vinyl acetate	<0.14	ug/L	0.14	1.0	1	U		12/8/2021 10:21	RLD	EPA 8260C
Vinyl chloride	0.038	ug/L	0.019	0.10	1	J		12/8/2021 10:21	RLD	EPA 8260C

Unless specifically stated to the contrary, soil/sediment/sludge sample results/LOD/LOQ/RLs were reported on a Dry Weight Basis

CT LAB#: 1080785 Sample Description:PW-07 DNR License/Well #: 04189/054 Sampled: 12/1/2021 15:30

Analyte	Result	Units	LOD	LOQ	Dilution	Qualifier	Prep Date/Time	Analysis Date/Time	Analyst	Method
1,4-Dioxane	0.46	ug/L	0.40	1.4	1	J	12/6/2021 12:00	12/9/2021 12:58	JJY	EPA 8270D-SIM

Notes: All LOD/LOQs are adjusted to reflect dilution, percent solids, and any differences in the sample weight / volume as compared to standard amounts.
"U" qualifier indicates concentration of analyte was below the detection limit. "J" qualifier indicates an estimated value between the LOD and LOQ.

All samples were received intact and properly preserved unless otherwise noted. The results reported relate only to the samples tested. This report shall not be reproduced, except in full, without written approval of this laboratory. The Chain of Custody is attached.

Brett M. Szymanski
Project Manager
Submitted by: 608-356-2760

Current CT Laboratories Certifications

Wisconsin (WDNR) Chemistry ID# 157066030

Wisconsin (DATCP) Bacteriology ID# 289

Louisiana NELAP (primary) ID# 115843

Illinois NELAP Lab ID# 200073

Kansas NELAP Lab ID# E-10368

Virginia NELAP Lab ID# 460203

ISO/IEC 17025-2005 A2LA Cert # 3806.01

DoD-ELAP A2LA 3806.01

Company: *Hyde Environmental*
 Project Contact: *Jim Lindemann*
 Telephone: *(262) 250-1226*
 Project Name: *Ocon. Electroplating*
 Project #: *---*
 Location: *Ashippun, WI*
 Sampled By: *Bob Thomson*

Folder #: *166239*
 Company: *HYDE ENVIRONMENTAL, INC*
 Project: *OCONOMOWOC ELECTROP*
 Logged By: *erc* PM: *BMS*

1230 Lange Court, Baraboo, WI 53913
 608-356-2760 Fax 608-356-2766
 www.ctlaboratories.com

Report To:
 EMAIL: *jc.lindemann@hyde-env.com*
 Company: *Hyde Environmental, INC*
 Address: *W175 N11163 Stonewood Dr. Germantown, WI 53022*
 Invoice To:*
 EMAIL:
 Company:
 Address:

Program:
 QSM RCRA SDWA NPDES
 Solid Waste Other _____
 PO #

*Party listed is responsible for payment of invoice as per CT Laboratories' terms and conditions

Client Special Instructions

ANALYSES REQUESTED

Matrix:
 GW - groundwater SW - surface water WW - wastewater DW - drinking water
 S - soil/sediment SL - sludge A - air M - misc/waste

Filtered? Y/N

*YOC (8260C) low level
 1,4 Dioxane (8270D-SIM)*

Total # Containers
 Designated MS/MSD

Turnaround Time
 Normal RUSH*
 Date Needed: _____
 Rush analysis requires prior
 CT Laboratories' approval
 Surcharges:
 24 hr 200%
 2-3 days 100%
 4-9 days 50%

Collection		Matrix	Grab/Comp	Sample #	Sample ID Description	Filtered?	ANALYSES REQUESTED												Total # Containers	Designated MS/MSD	CT Lab ID # <i>Lab use only</i>
Date	Time						Fill in Spaces with Bottles per Test														
<i>12/1/21</i>	<i>1530</i>	<i>DW</i>	<i>G</i>		<i>PW-07</i>	<i>N</i>	<i>4</i>	<i>2</i>										<i>1080785</i>			

Relinquished By: <i>Robert S. Au</i>	Date/Time <i>12-2-21 0946</i>	Received By: <i>MC</i>	Date/Time <i>12/3/21 1050</i>	Lab Use Only Ice Present <input checked="" type="checkbox"/> No <input type="checkbox"/> Temp <i>46</i> IR Gun <i>29</i> Cooler # <i>6693, 6484</i>
Received by:	Date/Time	Received for Laboratory by: <i>MC</i>	Date/Time <i>12/3/21 (27)</i>	

Notice: This form may be used to comply with the requirements of s. NR 716.14 (2), Wis. Adm. Code; however, use of this form is not required. An alternate format may be used. The rule requires that notification be provided to 1) property owners when someone else is conducting the sampling, 2) to occupants of property belonging to the responsible person, and 3) to owners and occupants of property that does not belong to the responsible person but has been affected by contamination arising on his or her property. Notification is required within 10 business days of receiving the sample results. Personal information collected will be used for program administration and may be provided to requesters to the extent required by Wisconsin's Open Records law [ss. 19.31-19.39, Wis. Stats.].

NOTE: Under s. NR 716.14, Wis. Adm. Code, the responsible party must also submit sample results and other required information to the DNR. We recommend that copies of the sample results notifications be included with that submittal, along with all attachments. Using the same format used for data presentation for a closure request may be helpful to all parties. See s. NR 716.14, Wis. Adm. Code for the full list of information to be submitted to the DNR.

Notification of Property Owners and Occupants:

This notification form has been provided to you in order to provide the results of environmental sampling that has been conducted on property that you own or occupy. Samples were collected in accordance with the methods identified in the site investigation work plan, in accordance with s. NR. 716.09 and 716.13, Wis. Adm. Code. This sampling was conducted as a result of contamination originating at the following location.

Site Information			
Site Name		DNR ID # (BRRTS #)	
Oconomowoc Electroplating Company, Inc. (OECI) Superfund Site		02-14-000905	
Address	City	State	ZIP Code
W2573 Oak Street	Ashippun	WI	53003

Responsible Party

The person(s) responsible for completing this environmental investigation is:

Property Owner			
Oconomowoc Electroplating Company, Inc.			
Address	City	State	ZIP Code
W2573 Oak Street	Ashippun	WI	53003
Contact Person	Phone Number (include area code)		
Gwen Saliars (WDNR PM), William Murray (US EPA Remedial PM)	(920) 510-4343		

Person or company that collected samples

Hyde Environmental, Inc.

Sample Results (Results Attached)

Reason for Sampling: Routine Other (define) _____

The contaminants that have been identified at this time on property that you own or occupy include:

Contaminant	In Soil?		In Groundwater?	
	Yes	No	Yes	No
Gasoline	<input type="radio"/>	<input checked="" type="radio"/>	<input type="radio"/>	<input checked="" type="radio"/>
Diesel or Fuel Oil	<input type="radio"/>	<input checked="" type="radio"/>	<input type="radio"/>	<input checked="" type="radio"/>
Solvents	<input type="radio"/>	<input checked="" type="radio"/>	<input checked="" type="radio"/>	<input type="radio"/>
Heavy Metals	<input type="radio"/>	<input checked="" type="radio"/>	<input type="radio"/>	<input checked="" type="radio"/>
Pesticides	<input type="radio"/>	<input checked="" type="radio"/>	<input type="radio"/>	<input checked="" type="radio"/>
Other: _____	<input type="radio"/>	<input checked="" type="radio"/>	<input type="radio"/>	<input checked="" type="radio"/>

This sampling event included sampling of a drinking water well.	
<input checked="" type="radio"/> Yes	<input type="radio"/> No
If yes, the sampled drinking water well had detectable contaminants.	
<input checked="" type="radio"/> Yes	<input type="radio"/> No

	Contaminants in Vapor	
	Yes	No
Indoor Air	<input type="radio"/>	<input checked="" type="radio"/>
Sub-slab	<input type="radio"/>	<input checked="" type="radio"/>
Exterior Soil Gas	<input type="radio"/>	<input checked="" type="radio"/>

Site Investigation Sample Results Notification

Form 4400-249 (R 03/14)

Page 2 of 2

Attached are:

- A map that shows the locations from which samples were collected. (The map needs to meet the requirements of s. NR 716.15 (4), Wis. Adm. Code.)
- A data table with specific contaminant levels at each sample location and whether or not the sample results exceed state standards.
- A copy of the laboratory results.

You are not identified as the person that is responsible for this contamination. However, your cooperation is important. Property owners may become legally responsible for contamination if they do not allow access to the person that is responsible so that person may complete the environmental investigation and clean up activities.

Option for written exemption: You have the option of requesting a written liability exemption from the DNR for contamination that originated on another property, or on property that you lease. To do this, you must present an adequate environmental assessment of your property and pay a \$700 fee for review of this information. If you are interested in this option, please see DNR publication # RR 589, "When Contamination Crosses a Property Line - Rights and Responsibilities of Property Owners", available at: dnr.wi.gov/files/PDF/pubs/rr/rr589.pdf.

Contact Information

Please address questions regarding this notification, or requests for additional information to the contact person listed above, or to one of the following contacts:

Environmental Consultant

Company Name		Contact Person Last Name	First Name	
Hyde Environmental, Inc.		Pagels	Corey	
Address		City	State	ZIP Code
W175 N11163 Stonewood Drive, Suite 110		Germantown	WI	53022
Phone # (inc. area code)	Email			
(262) 250-1226	cpagels@hyde-env.com			

Select which agency: Natural Resources Agriculture, Trade and Consumer Protection

State of Wisconsin Department of Natural Resources

Contact Person Last Name	First Name	Phone # (inc. area code)	
Saliars	Gwen	(920) 510-4343	
Address	City	State	ZIP Code
625 E County Road Y, Suite 700	Oshkosh	WI	54901
Email			
gwen.saliars@wisconsin.gov			

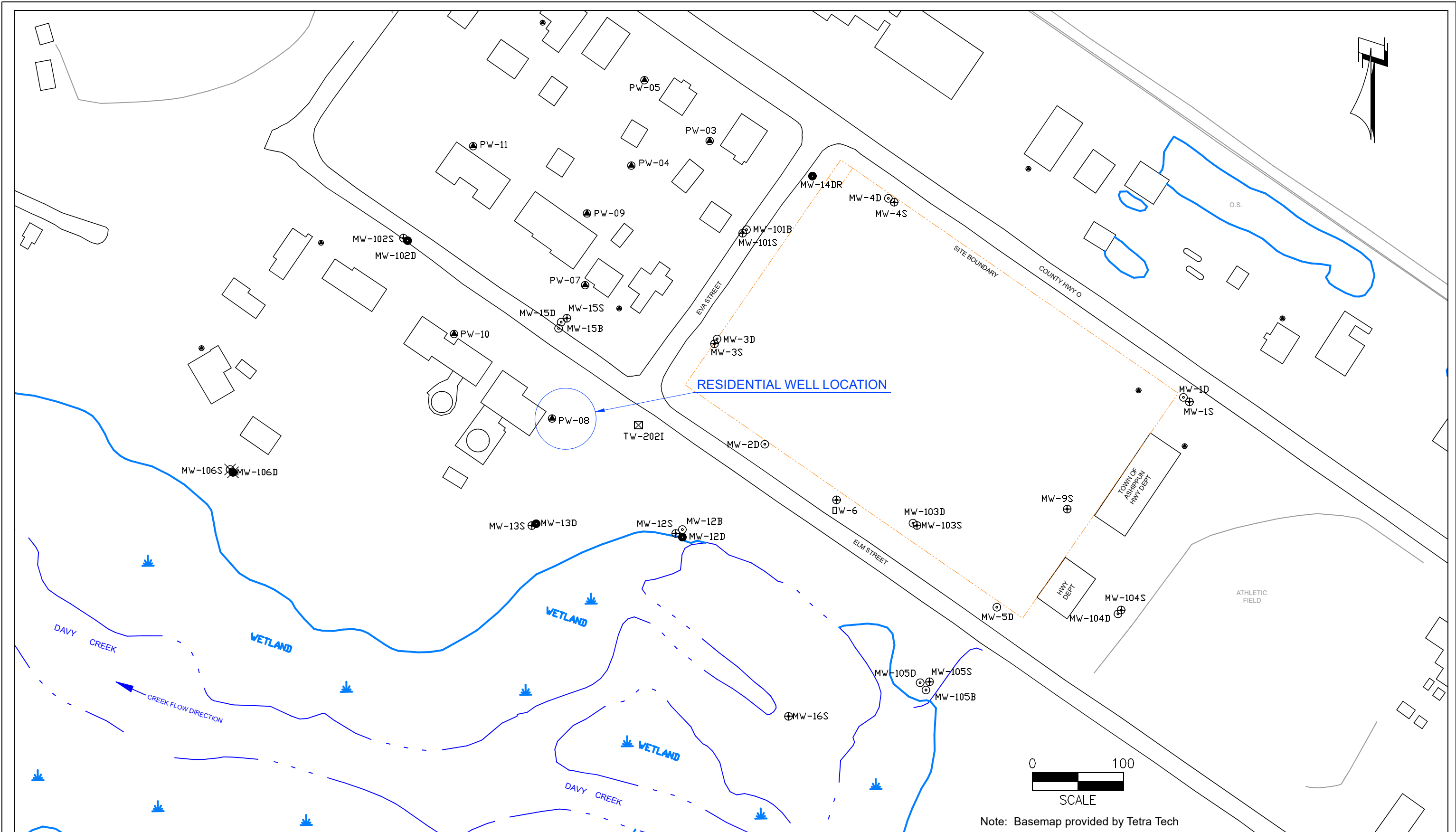

RESIDENTIAL WELL LOCATION



Note: Basemap provided by Tetra Tech

⊕ MW-105B	BEDROCK MONITORING WELL	● PW-11	RESIDENTIAL WELL
● MW-105D	DEEP UNCONSOLIDATED MONITORING WELL	● MW-106D	DEEP UNCONSOLIDATED SENTINEL WELL
⊕ MW-105S	SHALLOW UNCONSOLIDATED MONITORING WELL	⊗ MW-106S	SHALLOW UNCONSOLIDATED SENTINEL WELL
-----	FORMER OECl SITE BOUNDARY		



Figure 1
SITE MAP
Oconomowoc Electroplating Company, Inc.
Ashippun, WI

GROUNDWATER ANALYTICAL RESULTS SUMMARY

W2603 Elm Street, Ashippun, WI

Sampled December 1, 2021

Parameters (ug/L)	<i>NR 140 Groundwater Quality Health Standards</i>		PW-08
	<i>ES</i>	<i>PAL</i>	
VOCs			
cis-1,2-Dichloroethene	70	7	3.1
trans-1,2-Dichloroethene	100	20	0.12
Methyl tert-butyl ether (MTBE)	60	12	0.80
Trichloroethene	5	0.5	0.074 J
Vinyl chloride	0.2	0.02	0.041 J
Diisopropyl ether	--	--	0.052 J
1,4-Dioxane	3	0.3	0.44 J

Notes:

PAL = Preventive Action Limit

ES = Enforcement Standard

Italicized values attain or exceed the NR 140 PAL

-- = No standard

ug/L = micrograms per liter

< = less than the laboratory method detection limit (MDL)

J = Result is less than the laboratory Reporting Limit but > or = to the laboratory MDL

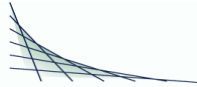

ANALYTICAL REPORT

HYDE ENVIRONMENTAL, INC.
 JIM LINDEMANN
 W175 N11163 STONEWOOD DRIVE
 SUITE 110
 GERMANTOWN, WI 53022-6501

Project Name: OCONOMOWOC ELECTROPLATING
 Project Phase: ASHIPUN, WI
 Project #:
 Folder #: 166239
 Purchase Order #:
 Contract #: 3451

Page 1 of 5
 Arrival Temperature: 4.5
 Report Date: 12/22/2021
 Date Received: 12/3/2021
 Reprint Date: 12/22/2021

CT LAB#: 1080787	Sample Description: PW-08	DNR License/Well #: 04189/055	Sampled: 12/1/2021 16:15
------------------	---------------------------	-------------------------------	--------------------------

Analyte	Result	Units	LOD	LOQ	Dilution	Qualifier	Prep Date/Time	Analysis Date/Time	Analyst	Method
Organic Results										
1,1,1,2-Tetrachloroethane	<0.013	ug/L	0.013	0.10	1	U	12/8/2021 11:19	12/8/2021 11:19	RLD	EPA 8260C
1,1,1-Trichloroethane	<0.013	ug/L	0.013	0.10	1	U	12/8/2021 11:19	12/8/2021 11:19	RLD	EPA 8260C
1,1,2,2-Tetrachloroethane	<0.015	ug/L	0.015	0.10	1	U	12/8/2021 11:19	12/8/2021 11:19	RLD	EPA 8260C
1,1,2-Trichloroethane	<0.036	ug/L	0.036	0.20	1	U	12/8/2021 11:19	12/8/2021 11:19	RLD	EPA 8260C
1,1-Dichloroethane	<0.017	ug/L	0.017	0.10	1	U	12/8/2021 11:19	12/8/2021 11:19	RLD	EPA 8260C
1,1-Dichloroethene	<0.024	ug/L	0.024	0.10	1	U	12/8/2021 11:19	12/8/2021 11:19	RLD	EPA 8260C
1,1-Dichloropropene	<0.074	ug/L	0.074	0.20	1	U	12/8/2021 11:19	12/8/2021 11:19	RLD	EPA 8260C
1,2,3-Trichlorobenzene	<0.019	ug/L	0.019	0.10	1	U	12/8/2021 11:19	12/8/2021 11:19	RLD	EPA 8260C
1,2,3-Trichloropropane	<0.031	ug/L	0.031	0.20	1	U	12/8/2021 11:19	12/8/2021 11:19	RLD	EPA 8260C
1,2,4-Trichlorobenzene	<0.022	ug/L	0.022	0.10	1	U	12/8/2021 11:19	12/8/2021 11:19	RLD	EPA 8260C
1,2,4-Trimethylbenzene	<0.011	ug/L	0.011	0.10	1	U	12/8/2021 11:19	12/8/2021 11:19	RLD	EPA 8260C
1,2-Dibromo-3-chloropropane	<0.12	ug/L	0.12	0.40	1	U	12/8/2021 11:19	12/8/2021 11:19	RLD	EPA 8260C
1,2-Dibromoethane	<0.029	ug/L	0.029	0.20	1	U	12/8/2021 11:19	12/8/2021 11:19	RLD	EPA 8260C
1,2-Dichlorobenzene	<0.016	ug/L	0.016	0.10	1	U	12/8/2021 11:19	12/8/2021 11:19	RLD	EPA 8260C
1,2-Dichloroethane	<0.017	ug/L	0.017	0.10	1	U	12/8/2021 11:19	12/8/2021 11:19	RLD	EPA 8260C
1,2-Dichloropropane	<0.013	ug/L	0.013	0.10	1	U	12/8/2021 11:19	12/8/2021 11:19	RLD	EPA 8260C

Unless specifically stated to the contrary, soil/sediment/sludge sample results/LOD/LOQ/RLs were reported on a Dry Weight Basis

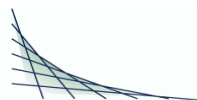

CT LAB#: 1080787 Sample Description:PW-08

DNR License/Well #: 04189/055

Sampled: 12/1/2021 16:15

Analyte	Result	Units	LOD	LOQ	Dilution	Qualifier	Prep Date/Time	Analysis Date/Time	Analyst	Method
1,3,5-Trimethylbenzene	<0.013	ug/L	0.013	0.10	1	U		12/8/2021 11:19	RLD	EPA 8260C
1,3-Dichlorobenzene	<0.013	ug/L	0.013	0.10	1	U		12/8/2021 11:19	RLD	EPA 8260C
1,3-Dichloropropane	<0.020	ug/L	0.020	0.10	1	U		12/8/2021 11:19	RLD	EPA 8260C
1,4-Dichlorobenzene	<0.017	ug/L	0.017	0.10	1	U		12/8/2021 11:19	RLD	EPA 8260C
2,2-Dichloropropane	<0.075	ug/L	0.075	0.30	1	U		12/8/2021 11:19	RLD	EPA 8260C
2-Butanone	<0.31	ug/L	0.31	2.0	1	U		12/8/2021 11:19	RLD	EPA 8260C
2-Chlorotoluene	<0.020	ug/L	0.020	0.10	1	U		12/8/2021 11:19	RLD	EPA 8260C
2-Hexanone	<0.15	ug/L	0.15	1.0	1	U		12/8/2021 11:19	RLD	EPA 8260C
4-Chlorotoluene	<0.013	ug/L	0.013	0.10	1	U		12/8/2021 11:19	RLD	EPA 8260C
4-Methyl-2-pentanone	<0.19	ug/L	0.19	1.0	1	U		12/8/2021 11:19	RLD	EPA 8260C
Acetone	<0.84	ug/L	0.84	4.0	1	U		12/8/2021 11:19	RLD	EPA 8260C
Benzene	<0.022	ug/L	0.022	0.10	1	U		12/8/2021 11:19	RLD	EPA 8260C
Bromobenzene	<0.018	ug/L	0.018	0.10	1	U		12/8/2021 11:19	RLD	EPA 8260C
Bromochloromethane	<0.034	ug/L	0.034	0.20	1	U		12/8/2021 11:19	RLD	EPA 8260C
Bromodichloromethane	<0.019	ug/L	0.019	0.10	1	U		12/8/2021 11:19	RLD	EPA 8260C
Bromoform	<0.041	ug/L	0.041	0.20	1	U		12/8/2021 11:19	RLD	EPA 8260C
Bromomethane	<0.052	ug/L	0.052	0.20	1	U		12/8/2021 11:19	RLD	EPA 8260C
Carbon disulfide	<0.11	ug/L	0.11	0.40	1	U		12/8/2021 11:19	RLD	EPA 8260C
Carbon tetrachloride	<0.018	ug/L	0.018	0.10	1	U		12/8/2021 11:19	RLD	EPA 8260C
Chlorobenzene	<0.013	ug/L	0.013	0.10	1	U		12/8/2021 11:19	RLD	EPA 8260C
Chloroethane	<0.40	ug/L	0.40	1.5	1	U		12/8/2021 11:19	RLD	EPA 8260C
Chloroform	<0.016	ug/L	0.016	0.10	1	U		12/8/2021 11:19	RLD	EPA 8260C
Chloromethane	<0.045	ug/L	0.045	0.20	1	U		12/8/2021 11:19	RLD	EPA 8260C
cis-1,2-Dichloroethene	3.1	ug/L	0.023	0.10	1			12/8/2021 11:19	RLD	EPA 8260C
cis-1,3-Dichloropropene	<0.014	ug/L	0.014	0.10	1	U		12/8/2021 11:19	RLD	EPA 8260C
Dibromochloromethane	<0.016	ug/L	0.016	0.10	1	U		12/8/2021 11:19	RLD	EPA 8260C

Unless specifically stated to the contrary, soil/sediment/sludge sample results/LOD/LOQ/RLs were reported on a Dry Weight Basis

CT LAB#: 1080787 Sample Description:PW-08

DNR License/Well #: 04189/055

Sampled: 12/1/2021 16:15

Analyte	Result	Units	LOD	LOQ	Dilution	Qualifier	Prep Date/Time	Analysis Date/Time	Analyst	Method
Dibromomethane	<0.018	ug/L	0.018	0.10	1	U		12/8/2021 11:19	RLD	EPA 8260C
Dichlorodifluoromethane	<0.091	ug/L	0.091	0.30	1	U		12/8/2021 11:19	RLD	EPA 8260C
Diisopropyl ether	0.052	ug/L	0.02	0.1	1	J		12/8/2021 11:19	RLD	EPA 8260C
Ethylbenzene	<0.014	ug/L	0.014	0.10	1	U		12/8/2021 11:19	RLD	EPA 8260C
Hexachlorobutadiene	<0.027	ug/L	0.027	0.20	1	U		12/8/2021 11:19	RLD	EPA 8260C
Isopropylbenzene	<0.014	ug/L	0.014	0.10	1	U		12/8/2021 11:19	RLD	EPA 8260C
m & p-Xylene	<0.022	ug/L	0.022	0.20	1	U		12/8/2021 11:19	RLD	EPA 8260C
Methyl tert-butyl ether	0.80	ug/L	0.014	0.10	1			12/8/2021 11:19	RLD	EPA 8260C
Methylene chloride	<0.090	ug/L	0.090	0.40	1	U		12/8/2021 11:19	RLD	EPA 8260C
n-Butylbenzene	<0.021	ug/L	0.021	0.10	1	U		12/8/2021 11:19	RLD	EPA 8260C
n-Propylbenzene	<0.013	ug/L	0.013	0.10	1	U		12/8/2021 11:19	RLD	EPA 8260C
Naphthalene	<0.025	ug/L	0.025	0.10	1	U		12/8/2021 11:19	RLD	EPA 8260C
o-Xylene	<0.016	ug/L	0.016	0.10	1	U		12/8/2021 11:19	RLD	EPA 8260C
p-Isopropyltoluene	<0.016	ug/L	0.016	0.10	1	U		12/8/2021 11:19	RLD	EPA 8260C
sec-Butylbenzene	<0.012	ug/L	0.012	0.10	1	U		12/8/2021 11:19	RLD	EPA 8260C
Styrene	<0.014	ug/L	0.014	0.10	1	U		12/8/2021 11:19	RLD	EPA 8260C
tert-Butylbenzene	<0.013	ug/L	0.013	0.10	1	U		12/8/2021 11:19	RLD	EPA 8260C
Tetrachloroethene	<0.028	ug/L	0.028	0.20	1	U		12/8/2021 11:19	RLD	EPA 8260C
Tetrahydrofuran	<0.38	ug/L	0.38	2.0	1	U		12/8/2021 11:19	RLD	EPA 8260C
Toluene	<0.014	ug/L	0.014	0.10	1	U		12/8/2021 11:19	RLD	EPA 8260C
trans-1,2-Dichloroethene	0.12	ug/L	0.020	0.10	1			12/8/2021 11:19	RLD	EPA 8260C
trans-1,3-Dichloropropene	<0.020	ug/L	0.020	0.10	1	U		12/8/2021 11:19	RLD	EPA 8260C
Trichloroethene	0.074	ug/L	0.022	0.10	1	J		12/8/2021 11:19	RLD	EPA 8260C
Trichlorofluoromethane	<0.033	ug/L	0.033	0.20	1	U		12/8/2021 11:19	RLD	EPA 8260C
Vinyl acetate	<0.14	ug/L	0.14	1.0	1	U		12/8/2021 11:19	RLD	EPA 8260C
Vinyl chloride	0.041	ug/L	0.019	0.10	1	J		12/8/2021 11:19	RLD	EPA 8260C

Unless specifically stated to the contrary, soil/sediment/sludge sample results/LOD/LOQ/RLs were reported on a Dry Weight Basis

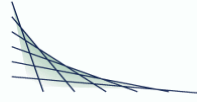

CT LAB#: 1080787	Sample Description:PW-08	DNR License/Well #: 04189/055	Sampled: 12/1/2021 16:15
------------------	--------------------------	-------------------------------	--------------------------

Analyte	Result	Units	LOD	LOQ	Dilution	Qualifier	Prep Date/Time	Analysis Date/Time	Analyst	Method
1,4-Dioxane	0.44	ug/L	0.40	1.4	1	J	12/6/2021 12:00	12/9/2021 13:39	JJY	EPA 8270D-SIM

Notes: All LOD/LOQs are adjusted to reflect dilution, percent solids, and any differences in the sample weight / volume as compared to standard amounts.
"U" qualifier indicates concentration of analyte was below the detection limit. "J" qualifier indicates an estimated value between the LOD and LOQ.

All samples were received intact and properly preserved unless otherwise noted. The results reported relate only to the samples tested. This report shall not be reproduced, except in full, without written approval of this laboratory. The Chain of Custody is attached.

Brett M. Szymanski
Project Manager
Submitted by: 608-356-2760

Current CT Laboratories Certifications

Wisconsin (WDNR) Chemistry ID# 157066030

Wisconsin (DATCP) Bacteriology ID# 289

Louisiana NELAP (primary) ID# 115843

Illinois NELAP Lab ID# 200073

Kansas NELAP Lab ID# E-10368

Virginia NELAP Lab ID# 460203

ISO/IEC 17025-2005 A2LA Cert # 3806.01

DoD-ELAP A2LA 3806.01

Company: *Hyde Environmental*
 Project Contact: *Jim Lindemann*
 Telephone: *(262) 250-1226*
 Project Name: *Ocon. Electroplating*
 Project #: *—*
 Location: *Ashippun, WI*
 Sampled By: *Bob Thomson*

CT LABORATORIES
 1230 Lange Court, Baraboo, WI 53913
 608-356-2760 Fax 608-356-2766
 www.ctlaboratories.com

Report To:
 EMAIL: *jc.lindemann@hyde-env.com*
 Company: *Hyde Environmental, INC*
 Address: *W175 N 11163 Stonewood Dr.
 Germantown, WI 53022*
 Invoice To:*
 EMAIL:
 Company:
 Address:

— Lab Use Only
 Place Header Sticker Here:
166239
 Program:
 QSM RCRA SDWA NPDES
 Solid Waste Other _____
 PO #

*Party listed is responsible for payment of invoice as per CT Laboratories' terms and conditions

Client Special Instructions

Filtered? Y/N	ANALYSES REQUESTED												Total # Containers	Designated MS/MSD
<i>N</i>	<i>4</i>	<i>2</i>												

Turnaround Time
 Normal RUSH*
 Date Needed: _____
 Rush analysis requires prior
 CT Laboratories' approval
 Surcharges:
 24 hr 200%
 2-3 days 100%
 4-9 days 50%

Matrix:
 GW - groundwater SW - surface water WW - wastewater DW - drinking water
 S - soil/sediment SL - sludge A - air M - misc/waste

Collection		Matrix	Grab/Comp	Sample #	Sample ID Description	Filtered? Y/N	Fill in Spaces with Bottles per Test												CT Lab ID # <i>Lab use only</i>
Date	Time																		
<i>12/1/21</i>	<i>1615</i>	<i>DW</i>	<i>G</i>		<i>PW-08</i>	<i>N</i>	<i>4</i>	<i>2</i>										<i>1680787</i>	

Relinquished By: <i>Robert B M</i>	Date/Time <i>12-2-21 0946</i>	Received By: <i>UC</i>	Date/Time <i>12/2/21 1050</i>	Lab Use Only Ice Present <input checked="" type="checkbox"/> No Temp <i>64.6</i> IR Gun <i>7</i> Cooler # <i>6693, 6159</i>
Received by:	Date/Time	Received for Laboratory by: <i>UC</i>	Date/Time <i>12/2/21 1127</i>	

Notice: This form may be used to comply with the requirements of s. NR 716.14 (2), Wis. Adm. Code; however, use of this form is not required. An alternate format may be used. The rule requires that notification be provided to 1) property owners when someone else is conducting the sampling, 2) to occupants of property belonging to the responsible person, and 3) to owners and occupants of property that does not belong to the responsible person but has been affected by contamination arising on his or her property. Notification is required within 10 business days of receiving the sample results. Personal information collected will be used for program administration and may be provided to requesters to the extent required by Wisconsin's Open Records law [ss. 19.31-19.39, Wis. Stats.].

NOTE: Under s. NR 716.14, Wis. Adm. Code, the responsible party must also submit sample results and other required information to the DNR. We recommend that copies of the sample results notifications be included with that submittal, along with all attachments. Using the same format used for data presentation for a closure request may be helpful to all parties. See s. NR 716.14, Wis. Adm. Code for the full list of information to be submitted to the DNR.

Notification of Property Owners and Occupants:

This notification form has been provided to you in order to provide the results of environmental sampling that has been conducted on property that you own or occupy. Samples were collected in accordance with the methods identified in the site investigation work plan, in accordance with s. NR. 716.09 and 716.13, Wis. Adm. Code. This sampling was conducted as a result of contamination originating at the following location.

Site Information			
Site Name		DNR ID # (BRRTS #)	
Oconomowoc Electroplating Company, Inc. (OECl) Superfund Site		02-14-000905	
Address	City	State	ZIP Code
W2573 Oak Street	Ashippun	WI	53003

Responsible Party

The person(s) responsible for completing this environmental investigation is:

Property Owner

Oconomowoc Electroplating Company, Inc.			
Address	City	State	ZIP Code
W2573 Oak Street	Ashippun	WI	53003
Contact Person	Phone Number (include area code)		
Gwen Saliars (WDNR PM), William Murray (US EPA Remedial PM)	(920) 510-4343		

Person or company that collected samples

Hyde Environmental, Inc.

Sample Results (Results Attached)

Reason for Sampling: Routine Other (define) _____

The contaminants that have been identified at this time on property that you own or occupy include:

Contaminant	In Soil?		In Groundwater?	
	Yes	No	Yes	No
Gasoline	<input type="radio"/>	<input checked="" type="radio"/>	<input type="radio"/>	<input checked="" type="radio"/>
Diesel or Fuel Oil	<input type="radio"/>	<input checked="" type="radio"/>	<input type="radio"/>	<input checked="" type="radio"/>
Solvents	<input type="radio"/>	<input checked="" type="radio"/>	<input checked="" type="radio"/>	<input type="radio"/>
Heavy Metals	<input type="radio"/>	<input checked="" type="radio"/>	<input type="radio"/>	<input checked="" type="radio"/>
Pesticides	<input type="radio"/>	<input checked="" type="radio"/>	<input type="radio"/>	<input checked="" type="radio"/>
Other: _____	<input type="radio"/>	<input checked="" type="radio"/>	<input type="radio"/>	<input checked="" type="radio"/>

This sampling event included sampling of a drinking water well.
 Yes No

If yes, the sampled drinking water well had detectable contaminants.
 Yes No

	Contaminants in Vapor	
	Yes	No
Indoor Air	<input type="radio"/>	<input checked="" type="radio"/>
Sub-slab	<input type="radio"/>	<input checked="" type="radio"/>
Exterior Soil Gas	<input type="radio"/>	<input checked="" type="radio"/>

Site Investigation Sample Results Notification

Form 4400-249 (R 03/14)

Page 2 of 2

Attached are:

- A map that shows the locations from which samples were collected. (The map needs to meet the requirements of s. NR 716.15 (4), Wis. Adm. Code.)
- A data table with specific contaminant levels at each sample location and whether or not the sample results exceed state standards.
- A copy of the laboratory results.

You are not identified as the person that is responsible for this contamination. However, your cooperation is important. Property owners may become legally responsible for contamination if they do not allow access to the person that is responsible so that person may complete the environmental investigation and clean up activities.

Option for written exemption: You have the option of requesting a written liability exemption from the DNR for contamination that originated on another property, or on property that you lease. To do this, you must present an adequate environmental assessment of your property and pay a \$700 fee for review of this information. If you are interested in this option, please see DNR publication # RR 589, "When Contamination Crosses a Property Line - Rights and Responsibilities of Property Owners", available at: dnr.wi.gov/files/PDF/pubs/rr/rr589.pdf.

Contact Information

Please address questions regarding this notification, or requests for additional information to the contact person listed above, or to one of the following contacts:

Environmental Consultant

Company Name		Contact Person Last Name	First Name	
Hyde Environmental, Inc.		Pagels	Corey	
Address		City	State	ZIP Code
W175 N11163 Stonewood Drive, Suite 110		Germantown	WI	53022
Phone # (inc. area code)	Email			
(262) 250-1226	cpagels@hyde-env.com			

Select which agency: Natural Resources Agriculture, Trade and Consumer Protection

State of Wisconsin Department of Natural Resources

Contact Person Last Name	First Name	Phone # (inc. area code)	
Saliars	Gwen	(920) 510-4343	
Address	City	State	ZIP Code
625 E County Road Y, Suite 700	Oshkosh	WI	54901
Email			
gwen.saliars@wisconsin.gov			

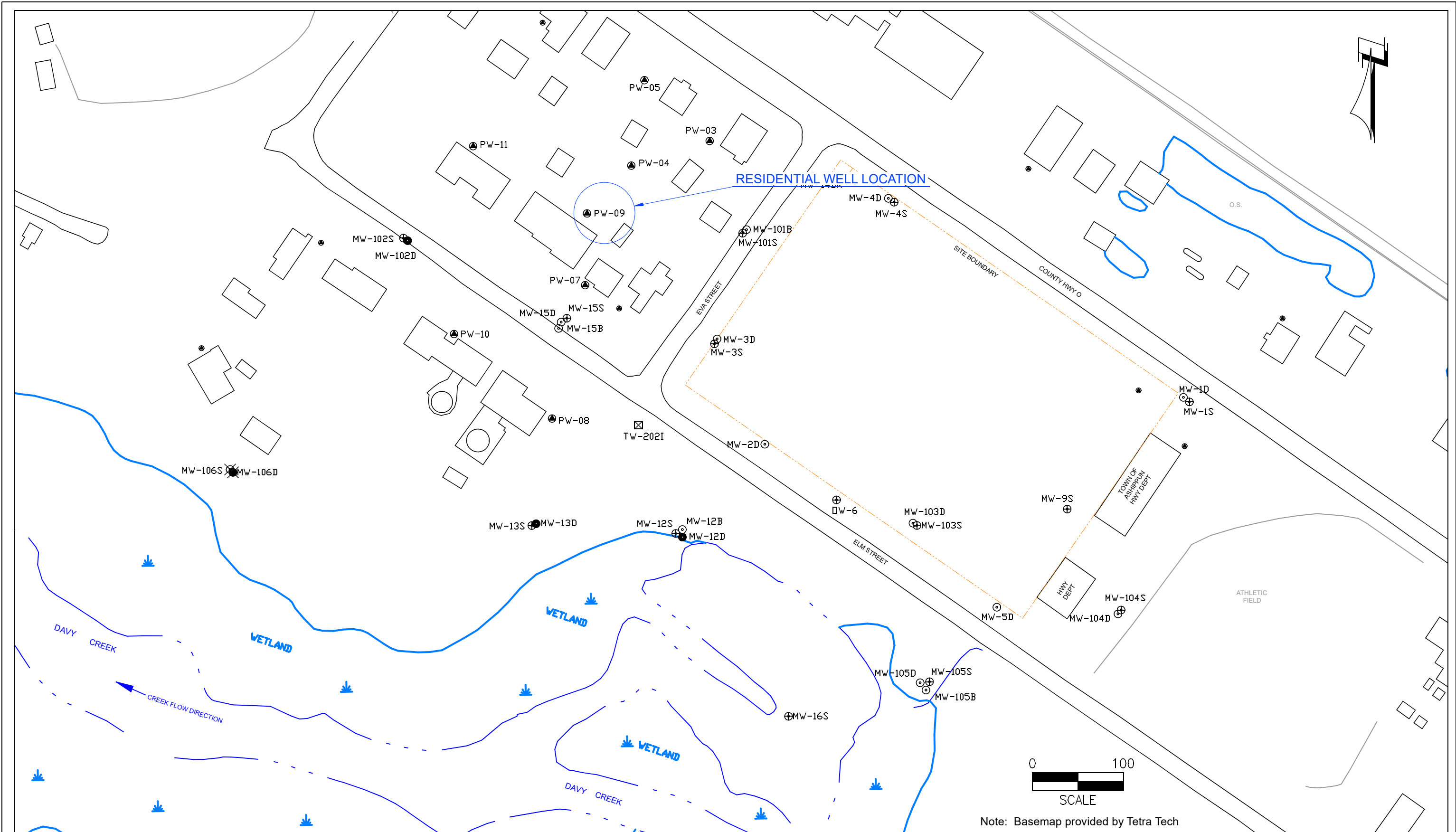

RESIDENTIAL WELL LOCATION

⊕ MW-105B	BEDROCK MONITORING WELL	● PW-11	RESIDENTIAL WELL
● MW-105D	DEEP UNCONSOLIDATED MONITORING WELL	⊗ MW-106D	DEEP UNCONSOLIDATED SENTINEL WELL
⊕ MW-105S	SHALLOW UNCONSOLIDATED MONITORING WELL	⊗ MW-106S	SHALLOW UNCONSOLIDATED SENTINEL WELL
---	FORMER OECl SITE BOUNDARY		



Figure 1
SITE MAP
 Oconomowoc Electroplating Company, Inc.
 Ashippun, WI

GROUNDWATER ANALYTICAL RESULTS SUMMARY

W2606 Elm Street, Ashippun, WI

Sampled December 1, 2021

Parameters (ug/L)	NR 140 Groundwater Quality Health Standards		PW-09
	ES	PAL	
VOCs			
1,2-Dichloroethane	5	0.5	0.040 J
cis-1,2-Dichloroethene	70	7	7.0
trans-1,2-Dichloroethene	100	20	0.27
Methyl tert-butyl ether (MTBE)	60	12	0.80
Trichloroethene	5	0.5	0.059 J
Vinyl chloride	0.2	0.02	0.037 J
Diisopropyl ether	--	--	0.028 J
1,4-Dioxane	3	0.3	< 0.40

Notes:

PAL = Preventive Action Limit

ES = Enforcement Standard

Italicized values attain or exceed the NR 140 PAL

-- = No standard

ug/L = micrograms per liter

< = less than the laboratory method detection limit (MDL)

J = Result is less than the laboratory Reporting Limit but > or = to the laboratory MDL

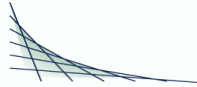

ANALYTICAL REPORT

HYDE ENVIRONMENTAL, INC.
 JIM LINDEMANN
 W175 N11163 STONEWOOD DRIVE
 SUITE 110
 GERMANTOWN, WI 53022-6501

Project Name: OCONOMOWOC ELECTROPLATING
 Project Phase: ASHIPUN, WI
 Project #:
 Folder #: 166239
 Purchase Order #:
 Contract #: 3451

Page 1 of 5
 Arrival Temperature: 4.5
 Report Date: 12/22/2021
 Date Received: 12/3/2021
 Reprint Date: 12/22/2021

CT LAB#: 1080786	Sample Description: PW-09	DNR License/Well #: 04189/056	Sampled: 12/1/2021 15:45
------------------	---------------------------	-------------------------------	--------------------------

Analyte	Result	Units	LOD	LOQ	Dilution	Qualifier	Prep Date/Time	Analysis Date/Time	Analyst	Method
Organic Results										
1,1,1,2-Tetrachloroethane	<0.013	ug/L	0.013	0.10	1	U	12/8/2021 10:50	12/8/2021 10:50	RLD	EPA 8260C
1,1,1-Trichloroethane	<0.013	ug/L	0.013	0.10	1	U	12/8/2021 10:50	12/8/2021 10:50	RLD	EPA 8260C
1,1,2,2-Tetrachloroethane	<0.015	ug/L	0.015	0.10	1	U	12/8/2021 10:50	12/8/2021 10:50	RLD	EPA 8260C
1,1,2-Trichloroethane	<0.036	ug/L	0.036	0.20	1	U	12/8/2021 10:50	12/8/2021 10:50	RLD	EPA 8260C
1,1-Dichloroethane	<0.017	ug/L	0.017	0.10	1	U	12/8/2021 10:50	12/8/2021 10:50	RLD	EPA 8260C
1,1-Dichloroethene	<0.024	ug/L	0.024	0.10	1	U	12/8/2021 10:50	12/8/2021 10:50	RLD	EPA 8260C
1,1-Dichloropropene	<0.074	ug/L	0.074	0.20	1	U	12/8/2021 10:50	12/8/2021 10:50	RLD	EPA 8260C
1,2,3-Trichlorobenzene	<0.019	ug/L	0.019	0.10	1	U	12/8/2021 10:50	12/8/2021 10:50	RLD	EPA 8260C
1,2,3-Trichloropropane	<0.031	ug/L	0.031	0.20	1	U	12/8/2021 10:50	12/8/2021 10:50	RLD	EPA 8260C
1,2,4-Trichlorobenzene	<0.022	ug/L	0.022	0.10	1	U	12/8/2021 10:50	12/8/2021 10:50	RLD	EPA 8260C
1,2,4-Trimethylbenzene	<0.011	ug/L	0.011	0.10	1	U	12/8/2021 10:50	12/8/2021 10:50	RLD	EPA 8260C
1,2-Dibromo-3-chloropropane	<0.12	ug/L	0.12	0.40	1	U	12/8/2021 10:50	12/8/2021 10:50	RLD	EPA 8260C
1,2-Dibromoethane	<0.029	ug/L	0.029	0.20	1	U	12/8/2021 10:50	12/8/2021 10:50	RLD	EPA 8260C
1,2-Dichlorobenzene	<0.016	ug/L	0.016	0.10	1	U	12/8/2021 10:50	12/8/2021 10:50	RLD	EPA 8260C
1,2-Dichloroethane	0.040	ug/L	0.017	0.10	1	J	12/8/2021 10:50	12/8/2021 10:50	RLD	EPA 8260C
1,2-Dichloropropane	<0.013	ug/L	0.013	0.10	1	U	12/8/2021 10:50	12/8/2021 10:50	RLD	EPA 8260C

Unless specifically stated to the contrary, soil/sediment/sludge sample results/LOD/LOQ/RLs were reported on a Dry Weight Basis

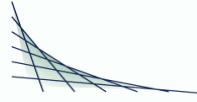

CT LAB#: 1080786 Sample Description:PW-09

DNR License/Well #: 04189/056

Sampled: 12/1/2021 15:45

Analyte	Result	Units	LOD	LOQ	Dilution	Qualifier	Prep Date/Time	Analysis Date/Time	Analyst	Method
1,3,5-Trimethylbenzene	<0.013	ug/L	0.013	0.10	1	U		12/8/2021 10:50	RLD	EPA 8260C
1,3-Dichlorobenzene	<0.013	ug/L	0.013	0.10	1	U		12/8/2021 10:50	RLD	EPA 8260C
1,3-Dichloropropane	<0.020	ug/L	0.020	0.10	1	U		12/8/2021 10:50	RLD	EPA 8260C
1,4-Dichlorobenzene	<0.017	ug/L	0.017	0.10	1	U		12/8/2021 10:50	RLD	EPA 8260C
2,2-Dichloropropane	<0.075	ug/L	0.075	0.30	1	U		12/8/2021 10:50	RLD	EPA 8260C
2-Butanone	<0.31	ug/L	0.31	2.0	1	U		12/8/2021 10:50	RLD	EPA 8260C
2-Chlorotoluene	<0.020	ug/L	0.020	0.10	1	U		12/8/2021 10:50	RLD	EPA 8260C
2-Hexanone	<0.15	ug/L	0.15	1.0	1	U		12/8/2021 10:50	RLD	EPA 8260C
4-Chlorotoluene	<0.013	ug/L	0.013	0.10	1	U		12/8/2021 10:50	RLD	EPA 8260C
4-Methyl-2-pentanone	<0.19	ug/L	0.19	1.0	1	U		12/8/2021 10:50	RLD	EPA 8260C
Acetone	<0.84	ug/L	0.84	4.0	1	U		12/8/2021 10:50	RLD	EPA 8260C
Benzene	<0.022	ug/L	0.022	0.10	1	U		12/8/2021 10:50	RLD	EPA 8260C
Bromobenzene	<0.018	ug/L	0.018	0.10	1	U		12/8/2021 10:50	RLD	EPA 8260C
Bromochloromethane	<0.034	ug/L	0.034	0.20	1	U		12/8/2021 10:50	RLD	EPA 8260C
Bromodichloromethane	<0.019	ug/L	0.019	0.10	1	U		12/8/2021 10:50	RLD	EPA 8260C
Bromoform	<0.041	ug/L	0.041	0.20	1	U		12/8/2021 10:50	RLD	EPA 8260C
Bromomethane	<0.052	ug/L	0.052	0.20	1	U		12/8/2021 10:50	RLD	EPA 8260C
Carbon disulfide	<0.11	ug/L	0.11	0.40	1	U		12/8/2021 10:50	RLD	EPA 8260C
Carbon tetrachloride	<0.018	ug/L	0.018	0.10	1	U		12/8/2021 10:50	RLD	EPA 8260C
Chlorobenzene	<0.013	ug/L	0.013	0.10	1	U		12/8/2021 10:50	RLD	EPA 8260C
Chloroethane	<0.40	ug/L	0.40	1.5	1	U		12/8/2021 10:50	RLD	EPA 8260C
Chloroform	<0.016	ug/L	0.016	0.10	1	U		12/8/2021 10:50	RLD	EPA 8260C
Chloromethane	<0.045	ug/L	0.045	0.20	1	U		12/8/2021 10:50	RLD	EPA 8260C
cis-1,2-Dichloroethene	7.0	ug/L	0.023	0.10	1			12/8/2021 10:50	RLD	EPA 8260C
cis-1,3-Dichloropropene	<0.014	ug/L	0.014	0.10	1	U		12/8/2021 10:50	RLD	EPA 8260C
Dibromochloromethane	<0.016	ug/L	0.016	0.10	1	U		12/8/2021 10:50	RLD	EPA 8260C

Unless specifically stated to the contrary, soil/sediment/sludge sample results/LOD/LOQ/RLs were reported on a Dry Weight Basis

CT LAB#: 1080786 Sample Description:PW-09

DNR License/Well #: 04189/056

Sampled: 12/1/2021 15:45

Analyte	Result	Units	LOD	LOQ	Dilution	Qualifier	Prep Date/Time	Analysis Date/Time	Analyst	Method
Dibromomethane	<0.018	ug/L	0.018	0.10	1	U		12/8/2021 10:50	RLD	EPA 8260C
Dichlorodifluoromethane	<0.091	ug/L	0.091	0.30	1	U		12/8/2021 10:50	RLD	EPA 8260C
Diisopropyl ether	0.028	ug/L	0.02	0.1	1	J		12/8/2021 10:50	RLD	EPA 8260C
Ethylbenzene	<0.014	ug/L	0.014	0.10	1	U		12/8/2021 10:50	RLD	EPA 8260C
Hexachlorobutadiene	<0.027	ug/L	0.027	0.20	1	U		12/8/2021 10:50	RLD	EPA 8260C
Isopropylbenzene	<0.014	ug/L	0.014	0.10	1	U		12/8/2021 10:50	RLD	EPA 8260C
m & p-Xylene	<0.022	ug/L	0.022	0.20	1	U		12/8/2021 10:50	RLD	EPA 8260C
Methyl tert-butyl ether	0.80	ug/L	0.014	0.10	1			12/8/2021 10:50	RLD	EPA 8260C
Methylene chloride	<0.090	ug/L	0.090	0.40	1	U		12/8/2021 10:50	RLD	EPA 8260C
n-Butylbenzene	<0.021	ug/L	0.021	0.10	1	U		12/8/2021 10:50	RLD	EPA 8260C
n-Propylbenzene	<0.013	ug/L	0.013	0.10	1	U		12/8/2021 10:50	RLD	EPA 8260C
Naphthalene	<0.025	ug/L	0.025	0.10	1	U		12/8/2021 10:50	RLD	EPA 8260C
o-Xylene	<0.016	ug/L	0.016	0.10	1	U		12/8/2021 10:50	RLD	EPA 8260C
p-Isopropyltoluene	<0.016	ug/L	0.016	0.10	1	U		12/8/2021 10:50	RLD	EPA 8260C
sec-Butylbenzene	<0.012	ug/L	0.012	0.10	1	U		12/8/2021 10:50	RLD	EPA 8260C
Styrene	<0.014	ug/L	0.014	0.10	1	U		12/8/2021 10:50	RLD	EPA 8260C
tert-Butylbenzene	<0.013	ug/L	0.013	0.10	1	U		12/8/2021 10:50	RLD	EPA 8260C
Tetrachloroethene	<0.028	ug/L	0.028	0.20	1	U		12/8/2021 10:50	RLD	EPA 8260C
Tetrahydrofuran	<0.38	ug/L	0.38	2.0	1	U		12/8/2021 10:50	RLD	EPA 8260C
Toluene	<0.014	ug/L	0.014	0.10	1	U		12/8/2021 10:50	RLD	EPA 8260C
trans-1,2-Dichloroethene	0.27	ug/L	0.020	0.10	1			12/8/2021 10:50	RLD	EPA 8260C
trans-1,3-Dichloropropene	<0.020	ug/L	0.020	0.10	1	U		12/8/2021 10:50	RLD	EPA 8260C
Trichloroethene	0.059	ug/L	0.022	0.10	1	J		12/8/2021 10:50	RLD	EPA 8260C
Trichlorofluoromethane	<0.033	ug/L	0.033	0.20	1	U		12/8/2021 10:50	RLD	EPA 8260C
Vinyl acetate	<0.14	ug/L	0.14	1.0	1	U		12/8/2021 10:50	RLD	EPA 8260C
Vinyl chloride	0.037	ug/L	0.019	0.10	1	J		12/8/2021 10:50	RLD	EPA 8260C

Unless specifically stated to the contrary, soil/sediment/sludge sample results/LOD/LOQ/RLs were reported on a Dry Weight Basis

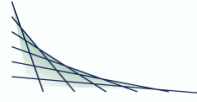

CT LAB#: 1080786 Sample Description:PW-09

DNR License/Well #: 04189/056

Sampled: 12/1/2021 15:45

Analyte	Result	Units	LOD	LOQ	Dilution	Qualifier	Prep Date/Time	Analysis Date/Time	Analyst	Method
1,4-Dioxane	<0.40	ug/L	0.40	1.4	1	U	12/6/2021 12:00	12/9/2021 13:19	JJY	EPA 8270D-SIM

Notes: All LOD/LOQs are adjusted to reflect dilution, percent solids, and any differences in the sample weight / volume as compared to standard amounts.
"U" qualifier indicates concentration of analyte was below the detection limit. "J" qualifier indicates an estimated value between the LOD and LOQ.

All samples were received intact and properly preserved unless otherwise noted. The results reported relate only to the samples tested. This report shall not be reproduced, except in full, without written approval of this laboratory. The Chain of Custody is attached.

Brett M. Szymanski
Project Manager
Submitted by: 608-356-2760

Current CT Laboratories Certifications

Wisconsin (WDNR) Chemistry ID# 157066030

Wisconsin (DATCP) Bacteriology ID# 289

Louisiana NELAP (primary) ID# 115843

Illinois NELAP Lab ID# 200073

Kansas NELAP Lab ID# E-10368

Virginia NELAP Lab ID# 460203

ISO/IEC 17025-2005 A2LA Cert # 3806.01

DoD-ELAP A2LA 3806.01

Company: Hyde Environmental
 Project Contact: Jim Lindemann
 Telephone: (262) 250-1226
 Project Name: Ocon. Electropainting
 Project #: _____
 Location: Ashippun, WI
 Sampled By: Bob Thomson

CT LABORATORIES

1230 Lange Court, Baraboo, WI 53913
 608-356-2760 Fax 608-356-2766
 www.ctlaboratories.com

Report To:
 EMAIL: jc.lindemann@hyde-env.com
 Company: Hyde Environmental, INC
 Address: W175 N 11163 Stonewood Dr.
Green Mountain, WI 53022

Lab Use Only
 Place Header Sticker Here:

Program:
 QSM RCRA SDWA NPDES
 Solid Waste Other _____

Invoice To:*
 EMAIL:
 Company:
 Address:

PO #

U66239

VOC (8260C) low level
1,4 Dioxane (8270D-SIM)

*Party listed is responsible for payment of invoice as per CT Laboratories' terms and conditions

Client Special Instructions

ANALYSES REQUESTED

Turnaround Time
 Normal RUSH*
 Date Needed: _____
 Rush analysis requires prior
 CT Laboratories' approval
 Surcharges:
 24 hr 200%
 2-3 days 100%
 4-9 days 50%

Matrix:
 GW - groundwater SW - surface water WW - wastewater DW - drinking water
 S - soil/sediment SL - sludge A - air M - misc/waste

Filtered? Y/N

Total # Containers

Designated MS/MSD

Collection		Matrix	Grab/Comp	Sample #	Sample ID Description	Filtered? Y/N	ANALYSES REQUESTED												Total # Containers	Designated MS/MSD	CT Lab ID # <i>Lab use only</i>
Date	Time						Fill in Spaces with Bottles per Test														
<u>12/1/21</u>	<u>1545</u>	<u>DW</u>	<u>G</u>		<u>PW-09</u>	<u>N</u>	<u>4</u>	<u>2</u>													

Relinquished By: [Signature] Date/Time: 12-2-21 0946 Received By: [Signature] Date/Time: 12/2/21 1:58
 Received by: _____ Date/Time: _____ Received for Laboratory by: [Signature] Date/Time: 12/2/21 12:27

Lab Use Only
 Ice Present Yes No
 Temp 64.6 IR Gun 27
 Cooler # 6692, 6189

Notice: This form may be used to comply with the requirements of s. NR 716.14 (2), Wis. Adm. Code; however, use of this form is not required. An alternate format may be used. The rule requires that notification be provided to 1) property owners when someone else is conducting the sampling, 2) to occupants of property belonging to the responsible person, and 3) to owners and occupants of property that does not belong to the responsible person but has been affected by contamination arising on his or her property. Notification is required within 10 business days of receiving the sample results. Personal information collected will be used for program administration and may be provided to requesters to the extent required by Wisconsin's Open Records law [ss. 19.31-19.39, Wis. Stats.].

NOTE: Under s. NR 716.14, Wis. Adm. Code, the responsible party must also submit sample results and other required information to the DNR. We recommend that copies of the sample results notifications be included with that submittal, along with all attachments. Using the same format used for data presentation for a closure request may be helpful to all parties. See s. NR 716.14, Wis. Adm. Code for the full list of information to be submitted to the DNR.

Notification of Property Owners and Occupants:

This notification form has been provided to you in order to provide the results of environmental sampling that has been conducted on property that you own or occupy. Samples were collected in accordance with the methods identified in the site investigation work plan, in accordance with s. NR. 716.09 and 716.13, Wis. Adm. Code. This sampling was conducted as a result of contamination originating at the following location.

Site Information			
Site Name		DNR ID # (BRRTS #)	
Oconomowoc Electroplating Company, Inc. (OECI) Superfund Site		02-14-000905	
Address	City	State	ZIP Code
W2573 Oak Street	Ashippun	WI	53003

Responsible Party

The person(s) responsible for completing this environmental investigation is:

Property Owner

Oconomowoc Electroplating Company, Inc.

Address	City	State	ZIP Code
W2573 Oak Street	Ashippun	WI	53003
Contact Person	Phone Number (include area code)		
Gwen Saliars (WDNR PM), William Murray (US EPA Remedial PM)	(920) 510-4343		

Person or company that collected samples

Hyde Environmental, Inc.

Sample Results (Results Attached)

Reason for Sampling: Routine Other (define) _____

The contaminants that have been identified at this time on property that you own or occupy include:

Contaminant	In Soil?		In Groundwater?	
	Yes	No	Yes	No
Gasoline	<input type="radio"/>	<input checked="" type="radio"/>	<input type="radio"/>	<input checked="" type="radio"/>
Diesel or Fuel Oil	<input type="radio"/>	<input checked="" type="radio"/>	<input type="radio"/>	<input checked="" type="radio"/>
Solvents	<input type="radio"/>	<input checked="" type="radio"/>	<input checked="" type="radio"/>	<input type="radio"/>
Heavy Metals	<input type="radio"/>	<input checked="" type="radio"/>	<input type="radio"/>	<input checked="" type="radio"/>
Pesticides	<input type="radio"/>	<input checked="" type="radio"/>	<input type="radio"/>	<input checked="" type="radio"/>
Other: _____	<input type="radio"/>	<input checked="" type="radio"/>	<input type="radio"/>	<input checked="" type="radio"/>

This sampling event included sampling of a drinking water well.
 Yes No

If yes, the sampled drinking water well had detectable contaminants.
 Yes No

	Contaminants in Vapor	
	Yes	No
Indoor Air	<input type="radio"/>	<input checked="" type="radio"/>
Sub-slab	<input type="radio"/>	<input checked="" type="radio"/>
Exterior Soil Gas	<input type="radio"/>	<input checked="" type="radio"/>

Site Investigation Sample Results Notification

Form 4400-249 (R 03/14)

Page 2 of 2

Attached are:

- A map that shows the locations from which samples were collected. (The map needs to meet the requirements of s. NR 716.15 (4), Wis. Adm. Code.)
- A data table with specific contaminant levels at each sample location and whether or not the sample results exceed state standards.
- A copy of the laboratory results.

You are not identified as the person that is responsible for this contamination. However, your cooperation is important. Property owners may become legally responsible for contamination if they do not allow access to the person that is responsible so that person may complete the environmental investigation and clean up activities.

Option for written exemption: You have the option of requesting a written liability exemption from the DNR for contamination that originated on another property, or on property that you lease. To do this, you must present an adequate environmental assessment of your property and pay a \$700 fee for review of this information. If you are interested in this option, please see DNR publication # RR 589, "When Contamination Crosses a Property Line - Rights and Responsibilities of Property Owners", available at: dnr.wi.gov/files/PDF/pubs/rr/rr589.pdf.

Contact Information

Please address questions regarding this notification, or requests for additional information to the contact person listed above, or to one of the following contacts:

Environmental Consultant

Company Name		Contact Person Last Name	First Name	
Hyde Environmental, Inc.		Pagels	Corey	
Address		City	State	ZIP Code
W175 N11163 Stonewood Drive, Suite 110		Germantown	WI	53022
Phone # (inc. area code)	Email			
(262) 250-1226	cpagels@hyde-env.com			

Select which agency: Natural Resources Agriculture, Trade and Consumer Protection

State of Wisconsin Department of Natural Resources

Contact Person Last Name	First Name	Phone # (inc. area code)	
Saliars	Gwen	(920) 510-4343	
Address	City	State	ZIP Code
625 E County Road Y, Suite 700	Oshkosh	WI	54901
Email			
gwen.saliars@wisconsin.gov			

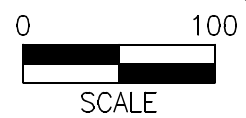
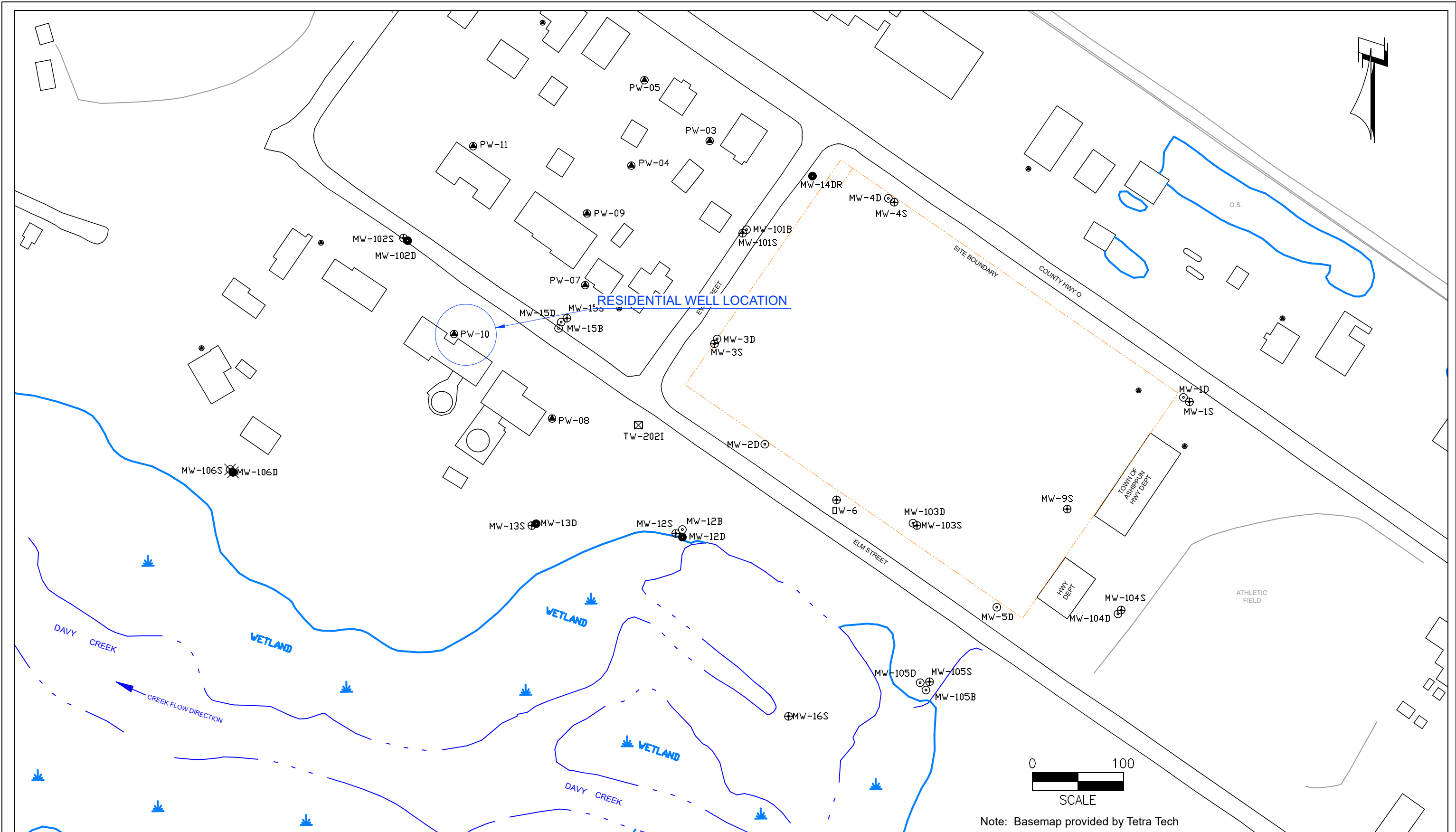

Note: Basemap provided by Tetra Tech

⊕ MW-105B	BEDROCK MONITORING WELL	● PW-11	RESIDENTIAL WELL
● MW-105D	DEEP UNCONSOLIDATED MONITORING WELL	● MW-106D	DEEP UNCONSOLIDATED SENTINEL WELL
⊕ MW-105S	SHALLOW UNCONSOLIDATED MONITORING WELL	⊗ MW-106S	SHALLOW UNCONSOLIDATED SENTINEL WELL
-----	FORMER OECl SITE BOUNDARY		



Figure 1
SITE MAP
Oconomowoc Electroplating Company, Inc.
Ashippun, WI

GROUNDWATER ANALYTICAL RESULTS SUMMARY

W2607 Elm Street, Ashippun, WI

Sampled December 1, 2021

Parameters (ug/L)	<i>NR 140 Groundwater Quality Health Standards</i>		
	<i>ES</i>	<i>PAL</i>	PW-10
VOCs			
cis-1,2-Dichloroethene	70	7	0.24
Methyl tert-butyl ether (MTBE)	60	12	0.58
Diisopropyl ether	--	--	0.032 J
1,4-Dioxane	3	0.3	<i>0.40 J</i>

Notes:

PAL = Preventive Action Limit

ES = Enforcement Standard

Italicized values attain or exceed the NR 140 PAL

-- = No standard

ug/L = micrograms per liter

< = less than the laboratory method detection limit (MDL)

J = Result is less than the laboratory Reporting Limit but > or = to the laboratory MDL

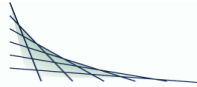

ANALYTICAL REPORT

HYDE ENVIRONMENTAL, INC.
 JIM LINDEMANN
 W175 N11163 STONEWOOD DRIVE
 SUITE 110
 GERMANTOWN, WI 53022-6501

Project Name: OCONOMOWOC ELECTROPLATING
 Project Phase: ASHIPUN, WI
 Project #:
 Folder #: 166239
 Purchase Order #:
 Contract #: 3451

Page 1 of 5
 Arrival Temperature: 4.5
 Report Date: 12/22/2021
 Date Received: 12/3/2021
 Reprint Date: 12/22/2021

CT LAB#: 1080790	Sample Description: PW-10	DNR License/Well #: 04189/057	Sampled: 12/1/2021 15:15
------------------	---------------------------	-------------------------------	--------------------------

Analyte	Result	Units	LOD	LOQ	Dilution	Qualifier	Prep Date/Time	Analysis Date/Time	Analyst	Method
Organic Results										
1,1,1,2-Tetrachloroethane	<0.013	ug/L	0.013	0.10	1	U	12/8/2021 12:45	12:45	RLD	EPA 8260C
1,1,1-Trichloroethane	<0.013	ug/L	0.013	0.10	1	U	12/8/2021 12:45	12:45	RLD	EPA 8260C
1,1,2,2-Tetrachloroethane	<0.015	ug/L	0.015	0.10	1	U	12/8/2021 12:45	12:45	RLD	EPA 8260C
1,1,2-Trichloroethane	<0.036	ug/L	0.036	0.20	1	U	12/8/2021 12:45	12:45	RLD	EPA 8260C
1,1-Dichloroethane	<0.017	ug/L	0.017	0.10	1	U	12/8/2021 12:45	12:45	RLD	EPA 8260C
1,1-Dichloroethene	<0.024	ug/L	0.024	0.10	1	U	12/8/2021 12:45	12:45	RLD	EPA 8260C
1,1-Dichloropropene	<0.074	ug/L	0.074	0.20	1	U	12/8/2021 12:45	12:45	RLD	EPA 8260C
1,2,3-Trichlorobenzene	<0.019	ug/L	0.019	0.10	1	U	12/8/2021 12:45	12:45	RLD	EPA 8260C
1,2,3-Trichloropropane	<0.031	ug/L	0.031	0.20	1	U	12/8/2021 12:45	12:45	RLD	EPA 8260C
1,2,4-Trichlorobenzene	<0.022	ug/L	0.022	0.10	1	U	12/8/2021 12:45	12:45	RLD	EPA 8260C
1,2,4-Trimethylbenzene	<0.011	ug/L	0.011	0.10	1	U	12/8/2021 12:45	12:45	RLD	EPA 8260C
1,2-Dibromo-3-chloropropane	<0.12	ug/L	0.12	0.40	1	U	12/8/2021 12:45	12:45	RLD	EPA 8260C
1,2-Dibromoethane	<0.029	ug/L	0.029	0.20	1	U	12/8/2021 12:45	12:45	RLD	EPA 8260C
1,2-Dichlorobenzene	<0.016	ug/L	0.016	0.10	1	U	12/8/2021 12:45	12:45	RLD	EPA 8260C
1,2-Dichloroethane	<0.017	ug/L	0.017	0.10	1	U	12/8/2021 12:45	12:45	RLD	EPA 8260C
1,2-Dichloropropane	<0.013	ug/L	0.013	0.10	1	U	12/8/2021 12:45	12:45	RLD	EPA 8260C

Unless specifically stated to the contrary, soil/sediment/sludge sample results/LOD/LOQ/RLs were reported on a Dry Weight Basis

CT LAB#: 1080790 Sample Description:PW-10

DNR License/Well #: 04189/057

Sampled: 12/1/2021 15:15

Analyte	Result	Units	LOD	LOQ	Dilution	Qualifier	Prep Date/Time	Analysis Date/Time	Analyst	Method
1,3,5-Trimethylbenzene	<0.013	ug/L	0.013	0.10	1	U		12/8/2021 12:45	RLD	EPA 8260C
1,3-Dichlorobenzene	<0.013	ug/L	0.013	0.10	1	U		12/8/2021 12:45	RLD	EPA 8260C
1,3-Dichloropropane	<0.020	ug/L	0.020	0.10	1	U		12/8/2021 12:45	RLD	EPA 8260C
1,4-Dichlorobenzene	<0.017	ug/L	0.017	0.10	1	U		12/8/2021 12:45	RLD	EPA 8260C
2,2-Dichloropropane	<0.075	ug/L	0.075	0.30	1	U		12/8/2021 12:45	RLD	EPA 8260C
2-Butanone	<0.31	ug/L	0.31	2.0	1	U		12/8/2021 12:45	RLD	EPA 8260C
2-Chlorotoluene	<0.020	ug/L	0.020	0.10	1	U		12/8/2021 12:45	RLD	EPA 8260C
2-Hexanone	<0.15	ug/L	0.15	1.0	1	U		12/8/2021 12:45	RLD	EPA 8260C
4-Chlorotoluene	<0.013	ug/L	0.013	0.10	1	U		12/8/2021 12:45	RLD	EPA 8260C
4-Methyl-2-pentanone	<0.19	ug/L	0.19	1.0	1	U		12/8/2021 12:45	RLD	EPA 8260C
Acetone	<0.84	ug/L	0.84	4.0	1	U		12/8/2021 12:45	RLD	EPA 8260C
Benzene	<0.022	ug/L	0.022	0.10	1	U		12/8/2021 12:45	RLD	EPA 8260C
Bromobenzene	<0.018	ug/L	0.018	0.10	1	U		12/8/2021 12:45	RLD	EPA 8260C
Bromochloromethane	<0.034	ug/L	0.034	0.20	1	U		12/8/2021 12:45	RLD	EPA 8260C
Bromodichloromethane	<0.019	ug/L	0.019	0.10	1	U		12/8/2021 12:45	RLD	EPA 8260C
Bromoform	<0.041	ug/L	0.041	0.20	1	U		12/8/2021 12:45	RLD	EPA 8260C
Bromomethane	<0.052	ug/L	0.052	0.20	1	U		12/8/2021 12:45	RLD	EPA 8260C
Carbon disulfide	<0.11	ug/L	0.11	0.40	1	U		12/8/2021 12:45	RLD	EPA 8260C
Carbon tetrachloride	<0.018	ug/L	0.018	0.10	1	U		12/8/2021 12:45	RLD	EPA 8260C
Chlorobenzene	<0.013	ug/L	0.013	0.10	1	U		12/8/2021 12:45	RLD	EPA 8260C
Chloroethane	<0.40	ug/L	0.40	1.5	1	U		12/8/2021 12:45	RLD	EPA 8260C
Chloroform	<0.016	ug/L	0.016	0.10	1	U		12/8/2021 12:45	RLD	EPA 8260C
Chloromethane	<0.045	ug/L	0.045	0.20	1	U		12/8/2021 12:45	RLD	EPA 8260C
cis-1,2-Dichloroethene	0.24	ug/L	0.023	0.10	1			12/8/2021 12:45	RLD	EPA 8260C
cis-1,3-Dichloropropene	<0.014	ug/L	0.014	0.10	1	U		12/8/2021 12:45	RLD	EPA 8260C
Dibromochloromethane	<0.016	ug/L	0.016	0.10	1	U		12/8/2021 12:45	RLD	EPA 8260C

Unless specifically stated to the contrary, soil/sediment/sludge sample results/LOD/LOQ/RLs were reported on a Dry Weight Basis

CT LAB#: 1080790 Sample Description:PW-10

DNR License/Well #: 04189/057

Sampled: 12/1/2021 15:15

Analyte	Result	Units	LOD	LOQ	Dilution	Qualifier	Prep Date/Time	Analysis Date/Time	Analyst	Method
Dibromomethane	<0.018	ug/L	0.018	0.10	1	U		12/8/2021 12:45	RLD	EPA 8260C
Dichlorodifluoromethane	<0.091	ug/L	0.091	0.30	1	U		12/8/2021 12:45	RLD	EPA 8260C
Diisopropyl ether	0.032	ug/L	0.02	0.1	1	J		12/8/2021 12:45	RLD	EPA 8260C
Ethylbenzene	<0.014	ug/L	0.014	0.10	1	U		12/8/2021 12:45	RLD	EPA 8260C
Hexachlorobutadiene	<0.027	ug/L	0.027	0.20	1	U		12/8/2021 12:45	RLD	EPA 8260C
Isopropylbenzene	<0.014	ug/L	0.014	0.10	1	U		12/8/2021 12:45	RLD	EPA 8260C
m & p-Xylene	<0.022	ug/L	0.022	0.20	1	U		12/8/2021 12:45	RLD	EPA 8260C
Methyl tert-butyl ether	0.58	ug/L	0.014	0.10	1			12/8/2021 12:45	RLD	EPA 8260C
Methylene chloride	<0.090	ug/L	0.090	0.40	1	U		12/8/2021 12:45	RLD	EPA 8260C
n-Butylbenzene	<0.021	ug/L	0.021	0.10	1	U		12/8/2021 12:45	RLD	EPA 8260C
n-Propylbenzene	<0.013	ug/L	0.013	0.10	1	U		12/8/2021 12:45	RLD	EPA 8260C
Naphthalene	<0.025	ug/L	0.025	0.10	1	U		12/8/2021 12:45	RLD	EPA 8260C
o-Xylene	<0.016	ug/L	0.016	0.10	1	U		12/8/2021 12:45	RLD	EPA 8260C
p-Isopropyltoluene	<0.016	ug/L	0.016	0.10	1	U		12/8/2021 12:45	RLD	EPA 8260C
sec-Butylbenzene	<0.012	ug/L	0.012	0.10	1	U		12/8/2021 12:45	RLD	EPA 8260C
Styrene	<0.014	ug/L	0.014	0.10	1	U		12/8/2021 12:45	RLD	EPA 8260C
tert-Butylbenzene	<0.013	ug/L	0.013	0.10	1	U		12/8/2021 12:45	RLD	EPA 8260C
Tetrachloroethene	<0.028	ug/L	0.028	0.20	1	U		12/8/2021 12:45	RLD	EPA 8260C
Tetrahydrofuran	<0.38	ug/L	0.38	2.0	1	U		12/8/2021 12:45	RLD	EPA 8260C
Toluene	<0.014	ug/L	0.014	0.10	1	U		12/8/2021 12:45	RLD	EPA 8260C
trans-1,2-Dichloroethene	<0.020	ug/L	0.020	0.10	1	U		12/8/2021 12:45	RLD	EPA 8260C
trans-1,3-Dichloropropene	<0.020	ug/L	0.020	0.10	1	U		12/8/2021 12:45	RLD	EPA 8260C
Trichloroethene	<0.022	ug/L	0.022	0.10	1	U		12/8/2021 12:45	RLD	EPA 8260C
Trichlorofluoromethane	<0.033	ug/L	0.033	0.20	1	U		12/8/2021 12:45	RLD	EPA 8260C
Vinyl acetate	<0.14	ug/L	0.14	1.0	1	U		12/8/2021 12:45	RLD	EPA 8260C
Vinyl chloride	<0.019	ug/L	0.019	0.10	1	U		12/8/2021 12:45	RLD	EPA 8260C

Unless specifically stated to the contrary, soil/sediment/sludge sample results/LOD/LOQ/RLs were reported on a Dry Weight Basis

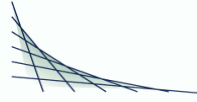

CT LAB#: 1080790 Sample Description:PW-10

DNR License/Well #: 04189/057

Sampled: 12/1/2021 15:15

Analyte	Result	Units	LOD	LOQ	Dilution	Qualifier	Prep Date/Time	Analysis Date/Time	Analyst	Method
1,4-Dioxane	0.40	ug/L	0.40	1.4	1	J	12/6/2021 12:00	12/9/2021 14:40	JJY	EPA 8270D-SIM

Notes: All LOD/LOQs are adjusted to reflect dilution, percent solids, and any differences in the sample weight / volume as compared to standard amounts.
"U" qualifier indicates concentration of analyte was below the detection limit. "J" qualifier indicates an estimated value between the LOD and LOQ.

All samples were received intact and properly preserved unless otherwise noted. The results reported relate only to the samples tested. This report shall not be reproduced, except in full, without written approval of this laboratory. The Chain of Custody is attached.

Brett M. Szymanski
Project Manager
Submitted by: 608-356-2760

Current CT Laboratories Certifications

Wisconsin (WDNR) Chemistry ID# 157066030

Wisconsin (DATCP) Bacteriology ID# 289

Louisiana NELAP (primary) ID# 115843

Illinois NELAP Lab ID# 200073

Kansas NELAP Lab ID# E-10368

Virginia NELAP Lab ID# 460203

ISO/IEC 17025-2005 A2LA Cert # 3806.01

DoD-ELAP A2LA 3806.01

Company: *Hyde Environmental*
 Project Contact: *Jim Lindemann*
 Telephone: *(262) 250-1226*
 Project Name: *Ocon. Electropainting*
 Project #: *—*
 Location: *Ashippun, WI*
 Sampled By: *Bob Thomson*

CT LABORATORIES

1230 Lange Court, Baraboo, WI 53913
 608-356-2760 Fax 608-356-2766
 www.ctlaboratories.com

Report To:
 EMAIL: *jc.lindemann@hyde-env.com*
 Company: *Hyde Environmental, INC*
 Address: *W175 N 11163 Stonewood Dr.
 Germantown, WI 53022*
 Invoice To:*
 EMAIL:
 Company:
 Address:

Lab Use Only
Place Header Sticker Here:

166239

Program:

QSM RCRA SDWA NPDES
 Solid Waste Other _____

PO #

*Party listed is responsible for payment of invoice as per CT Laboratories' terms and conditions

Client Special Instructions

ANALYSES REQUESTED

Filtered? Y/N

*VOC (8260C) low level
1,4 Dioxane (8270D-SIM)*

Total # Containers

Designated MS/MSD

Turnaround Time
 Normal RUSH*
 Date Needed: _____
 Rush analysis requires prior
 CT Laboratories' approval
 Surcharges:
 24 hr 200%
 2-3 days 100%
 4-9 days 50%

Matrix:
 GW - groundwater SW - surface water WW - wastewater DW - drinking water
 S - soil/sediment SL - sludge A - air M - misc/waste

Collection		Matrix	Grab/Comp	Sample #	Sample ID Description	Filtered? Y/N	Fill in Spaces with Bottles per Test												CT Lab ID # Lab use only
Date	Time						1	2	3	4	5	6	7	8	9	10	11	12	
<i>12/1/21</i>	<i>1515</i>	<i>DW</i>	<i>G</i>		<i>PW-10</i>	<i>N</i>	<i>4</i>	<i>2</i>										<i>1088790</i> <i>491</i>	
					<i>TRX BLANK</i>														

Relinquished By: <i>[Signature]</i>	Date/Time <i>12/2/21 0940</i>	Received By: <i>[Signature]</i>	Date/Time <i>12/2/21 1028</i>	Lab Use Only Ice Present Yes No Temp <i>64.8</i> IR Gun <i>77</i> Cooler # <i>6693, 6489</i>
Received by:	Date/Time	Received for Laboratory by:	Date/Time <i>12/3/21 1227</i>	