

From: James Lindemann <jclindemann@hyde-env.com>
Sent: Tuesday, December 20, 2022 9:22 AM
To: Saliars, Gwen N - DNR
Cc: Pamela Shudy
Subject: Private Well Notification Letters for Oconomowoc Electroplating Superfund Site, BRRTS #02-14-000905
Attachments: All 2022 PW notifs combined.pdf

Follow Up Flag: Follow up
Flag Status: Completed

CAUTION: This email originated from outside the organization. Do not click links or open attachments unless you recognize the sender and know the content is safe.

Attached is the combined pdf of all the private well sampling results notifications. The wells sampled were PW-03, PW-05, PW-07, PW-08 and PW-09.

Please let me know if you have any questions or require additional information. Thanks.

Jim Lindemann
Hyde Environmental, Inc.
www.hyde-env.com

**W175 N11163 Stonewood Drive, Suite 110
Germantown WI 53022-6501**

**(262) 250-1226 office
(262) 317-9171 fax
(262) 227-5878 cell**

Notice: This form may be used to comply with the requirements of s. NR 716.14 (2), Wis. Adm. Code; however, use of this form is not required. An alternate format may be used. The rule requires that notification be provided to 1) property owners when someone else is conducting the sampling, 2) to occupants of property belonging to the responsible person, and 3) to owners and occupants of property that does not belong to the responsible person but has been affected by contamination arising on his or her property. Notification is required within 10 business days of receiving the sample results. Personal information collected will be used for program administration and may be provided to requesters to the extent required by Wisconsin's Open Records law [ss. 19.31-19.39, Wis. Stats.].

NOTE: Under s. NR 716.14, Wis. Adm. Code, the responsible party must also submit sample results and other required information to the DNR. We recommend that copies of the sample results notifications be included with that submittal, along with all attachments. Using the same format used for data presentation for a closure request may be helpful to all parties. See s. NR 716.14, Wis. Adm. Code for the full list of information to be submitted to the DNR.

Notification of Property Owners and Occupants:

This notification form has been provided to you in order to provide the results of environmental sampling that has been conducted on property that you own or occupy. Samples were collected in accordance with the methods identified in the site investigation work plan, in accordance with s. NR. 716.09 and 716.13, Wis. Adm. Code. This sampling was conducted as a result of contamination originating at the following location.

Site Information

Site Name		DNR ID # (BRRTS #)	
Oconomowoc Electroplating Company, Inc. (OECI) Superfund Site		02-14-000905	
Address	City	State	ZIP Code
W2573 Oak Street	Ashippun	WI	53003

Responsible Party

The person(s) responsible for completing this environmental investigation is:

Property Owner

Oconomowoc Electroplating Company, Inc.

Address	City	State	ZIP Code
W2573 Oak Street	Ashippun	WI	53003

Contact Person	Phone Number (include area code)
Gwen Saliaras (WDNR PM), William Murray (US EPA Remedial PM)	(920) 510-4343

Person or company that collected samples

Hyde Environmental, Inc.

Sample Results (Results Attached)

Reason for Sampling: Routine Other (define) _____

The contaminants that have been identified at this time on property that you own or occupy include:

Contaminant	In Soil?		In Groundwater?	
	Yes	No	Yes	No
Gasoline	<input type="radio"/>	<input checked="" type="radio"/>	<input type="radio"/>	<input checked="" type="radio"/>
Diesel or Fuel Oil	<input type="radio"/>	<input checked="" type="radio"/>	<input type="radio"/>	<input checked="" type="radio"/>
Solvents	<input type="radio"/>	<input checked="" type="radio"/>	<input checked="" type="radio"/>	<input type="radio"/>
Heavy Metals	<input type="radio"/>	<input checked="" type="radio"/>	<input type="radio"/>	<input checked="" type="radio"/>
Pesticides	<input type="radio"/>	<input checked="" type="radio"/>	<input type="radio"/>	<input checked="" type="radio"/>
Other: _____	<input type="radio"/>	<input checked="" type="radio"/>	<input type="radio"/>	<input checked="" type="radio"/>

This sampling event included sampling of a drinking water well. <input checked="" type="radio"/> Yes <input type="radio"/> No
If yes, the sampled drinking water well had detectable contaminants. <input checked="" type="radio"/> Yes <input type="radio"/> No

Contaminants in Vapor

	Yes	No
	Indoor Air	<input type="radio"/>
Sub-slab	<input type="radio"/>	<input checked="" type="radio"/>
Exterior Soil Gas	<input type="radio"/>	<input checked="" type="radio"/>

Site Investigation Sample Results Notification

Form 4400-249 (R 03/14)

Page 2 of 2

Attached are:

- A map that shows the locations from which samples were collected. (The map needs to meet the requirements of s. NR 716.15 (4), Wis. Adm. Code.)
- A data table with specific contaminant levels at each sample location and whether or not the sample results exceed state standards.
- A copy of the laboratory results.

You are not identified as the person that is responsible for this contamination. However, your cooperation is important. Property owners may become legally responsible for contamination if they do not allow access to the person that is responsible so that person may complete the environmental investigation and clean up activities.

Option for written exemption: You have the option of requesting a written liability exemption from the DNR for contamination that originated on another property, or on property that you lease. To do this, you must present an adequate environmental assessment of your property and pay a \$700 fee for review of this information. If you are interested in this option, please see DNR publication # RR 589, "When Contamination Crosses a Property Line - Rights and Responsibilities of Property Owners", available at: dnr.wi.gov/files/PDF/pubs/rr/rr589.pdf.

Contact Information

Please address questions regarding this notification, or requests for additional information to the contact person listed above, or to one of the following contacts:

Environmental Consultant

Company Name	Contact Person Last Name	First Name		
Hyde Environmental, Inc.	Lindemann	James		
Address	City	State	ZIP Code	
W175 N11163 Stonewood Drive, Suite 110	Germantown	WI	53022	
Phone # (inc. area code)	Email			
(262) 250-1226	jclindemann@hyde-env.com			

Select which agency: Natural Resources Agriculture, Trade and Consumer Protection

State of Wisconsin Department of Natural Resources

Contact Person Last Name	First Name	Phone # (inc. area code)		
Saliars	Gwen	(920) 510-4343		
Address	City	State	ZIP Code	
625 E County Road Y, Suite 700	Oshkosh	WI	54901	
Email				
gwen.saliars@wisconsin.gov				

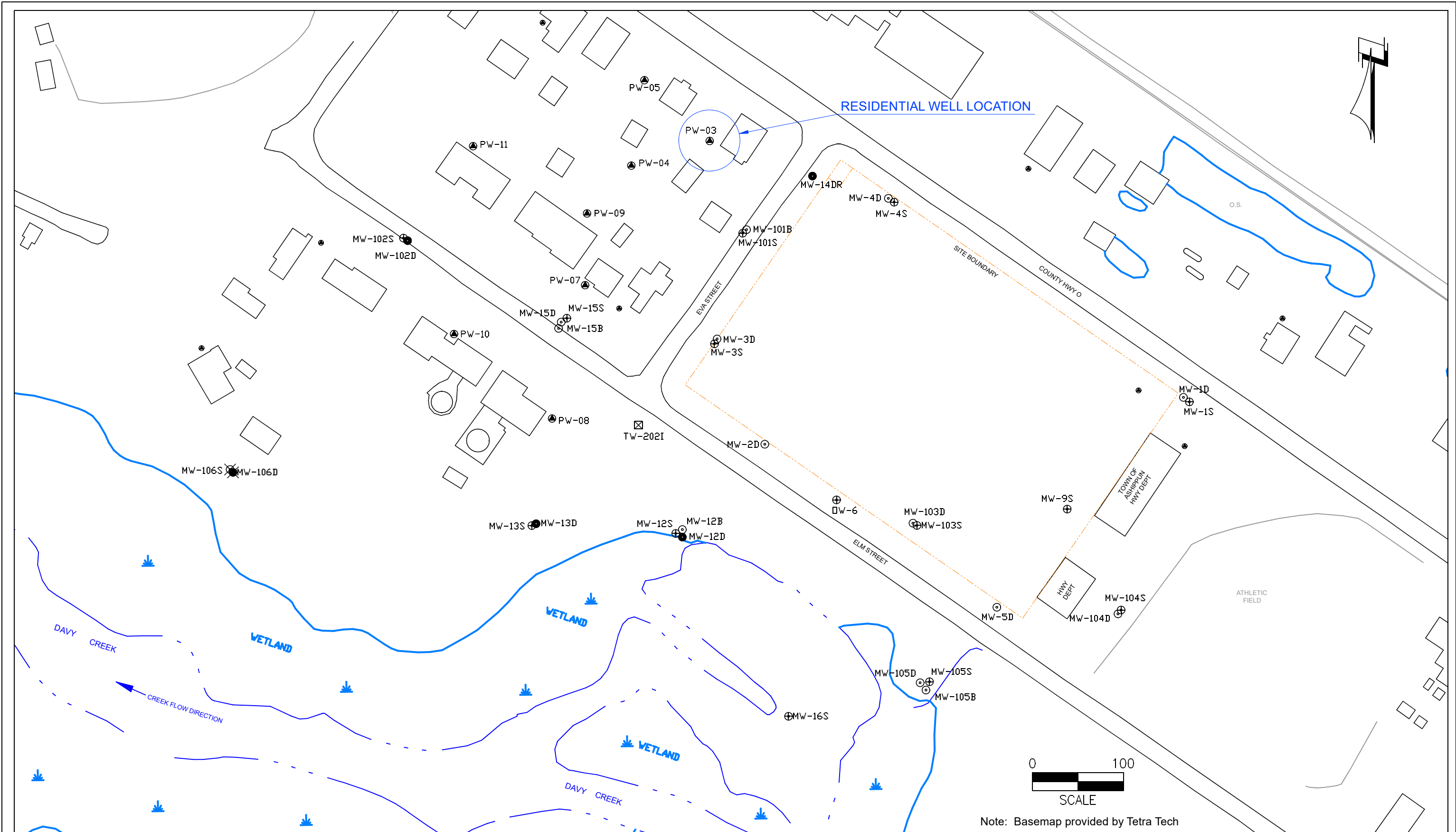

- | | | | |
|-----------|--|-----------|--------------------------------------|
| ⊕ MW-105B | BEDROCK MONITORING WELL | ● PW-11 | RESIDENTIAL WELL |
| ● MW-105D | DEEP UNCONSOLIDATED MONITORING WELL | ● MW-106D | DEEP UNCONSOLIDATED SENTINEL WELL |
| ⊕ MW-105S | SHALLOW UNCONSOLIDATED MONITORING WELL | ⊗ MW-106S | SHALLOW UNCONSOLIDATED SENTINEL WELL |
| --- | FORMER OECI SITE BOUNDARY | | |

0 100
SCALE
Note: Basemap provided by Tetra Tech



Figure 1
SITE MAP
Oconomowoc Electroplating Company, Inc.
Ashippun, WI

GROUNDWATER ANALYTICAL RESULTS SUMMARY

W2601 Oak Street, Ashippun, WI

Sampled November 18, 2022

Parameters (ug/L)	<i>NR 140 Groundwater Quality Health Standards</i>		PW-03
	<i>ES</i>	<i>PAL</i>	
VOCs			
1,2-Dichloroethane	5	0.5	0.04
Chloromethane	30	3	0.12
cis-1,2-Dichloroethene	70	7	3.0
trans-1,2-Dichloroethene	100	20	0.12
Methyl tert-butyl ether (MTBE)	60	12	0.59
Trichloroethene	5	0.5	0.63
1,4-Dioxane	3	0.3	<0.40

Notes:

PAL = Preventive Action Limit

ES = Enforcement Standard

Italicized values attain or exceed the NR 140 PAL

ug/L = micrograms per liter

< = less than the laboratory method detection limit (MDL)

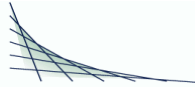

ANALYTICAL REPORT

HYDE ENVIRONMENTAL, INC.
 JIM LINDEMANN
 W175 N11163 STONEWOOD DRIVE
 SUITE 110
 GERMANTOWN, WI 53022-6501

Project Name: OEC SUPERFUND WI
 Project Phase: ASHIPPUN, WI
 Project #:
 Folder #: 173848
 Purchase Order #:
 Contract #: 3451

Page 1 of 5
 Arrival Temperature: 4.1
 Report Date: 12/1/2022
 Date Received: 11/22/2022
 Reprint Date: 12/13/2022

CT LAB#: 1266754	Sample Description: PW-03	DNR License/Well #: 04189/051	Sampled: 11/18/2022 15:45
------------------	---------------------------	-------------------------------	---------------------------

Analyte	Result	Units	LOD	LOQ	Dilution	Qualifier	Prep Date/Time	Analysis Date/Time	Analyst	Method
Organic Results										
1,1,1,2-Tetrachloroethane	<0.013	ug/L	0.013	0.10	1	U	11/24/2022 04:32	11/24/2022 04:32	RLD	EPA 8260C
1,1,1-Trichloroethane	<0.013	ug/L	0.013	0.10	1	U	11/24/2022 04:32	11/24/2022 04:32	RLD	EPA 8260C
1,1,2,2-Tetrachloroethane	<0.015	ug/L	0.015	0.10	1	U	11/24/2022 04:32	11/24/2022 04:32	RLD	EPA 8260C
1,1,2-Trichloroethane	<0.036	ug/L	0.036	0.20	1	U	11/24/2022 04:32	11/24/2022 04:32	RLD	EPA 8260C
1,1-Dichloroethane	<0.017	ug/L	0.017	0.10	1	U	11/24/2022 04:32	11/24/2022 04:32	RLD	EPA 8260C
1,1-Dichloroethene	<0.024	ug/L	0.024	0.10	1	U	11/24/2022 04:32	11/24/2022 04:32	RLD	EPA 8260C
1,1-Dichloropropene	<0.074	ug/L	0.074	0.20	1	U	11/24/2022 04:32	11/24/2022 04:32	RLD	EPA 8260C
1,2,3-Trichlorobenzene	<0.019	ug/L	0.019	0.10	1	U	11/24/2022 04:32	11/24/2022 04:32	RLD	EPA 8260C
1,2,3-Trichloropropane	<0.031	ug/L	0.031	0.20	1	U	11/24/2022 04:32	11/24/2022 04:32	RLD	EPA 8260C
1,2,4-Trichlorobenzene	<0.022	ug/L	0.022	0.10	1	U	11/24/2022 04:32	11/24/2022 04:32	RLD	EPA 8260C
1,2,4-Trimethylbenzene	<0.011	ug/L	0.011	0.10	1	U	11/24/2022 04:32	11/24/2022 04:32	RLD	EPA 8260C
1,2-Dibromo-3-chloropropane	<0.12	ug/L	0.12	0.40	1	U	11/24/2022 04:32	11/24/2022 04:32	RLD	EPA 8260C
1,2-Dibromoethane	<0.029	ug/L	0.029	0.20	1	U	11/24/2022 04:32	11/24/2022 04:32	RLD	EPA 8260C
1,2-Dichlorobenzene	<0.016	ug/L	0.016	0.10	1	U	11/24/2022 04:32	11/24/2022 04:32	RLD	EPA 8260C
1,2-Dichloroethane	0.040	ug/L	0.017	0.10	1	J	11/24/2022 04:32	11/24/2022 04:32	RLD	EPA 8260C
1,2-Dichloropropane	<0.013	ug/L	0.013	0.10	1	U	11/24/2022 04:32	11/24/2022 04:32	RLD	EPA 8260C

Unless specifically stated to the contrary, soil/sediment/sludge sample results/LOD/LOQ/RLs were reported on a Dry Weight Basis

CT LAB#: 1266754	Sample Description:PW-03	DNR License/Well #: 04189/051	Sampled: 11/18/2022 15:45
------------------	--------------------------	-------------------------------	---------------------------

Analyte	Result	Units	LOD	LOQ	Dilution	Qualifier	Prep Date/Time	Analysis Date/Time	Analyst	Method
1,3,5-Trimethylbenzene	<0.013	ug/L	0.013	0.10	1	U		11/24/2022 04:32	RLD	EPA 8260C
1,3-Dichlorobenzene	<0.013	ug/L	0.013	0.10	1	U		11/24/2022 04:32	RLD	EPA 8260C
1,3-Dichloropropane	<0.020	ug/L	0.020	0.10	1	U		11/24/2022 04:32	RLD	EPA 8260C
1,4-Dichlorobenzene	<0.017	ug/L	0.017	0.10	1	U		11/24/2022 04:32	RLD	EPA 8260C
2,2-Dichloropropane	<0.075	ug/L	0.075	0.30	1	U		11/24/2022 04:32	RLD	EPA 8260C
2-Butanone	<0.31	ug/L	0.31	2.0	1	U		11/24/2022 04:32	RLD	EPA 8260C
2-Chlorotoluene	<0.020	ug/L	0.020	0.10	1	U		11/24/2022 04:32	RLD	EPA 8260C
2-Hexanone	<0.15	ug/L	0.15	1.0	1	U		11/24/2022 04:32	RLD	EPA 8260C
4-Chlorotoluene	<0.013	ug/L	0.013	0.10	1	U		11/24/2022 04:32	RLD	EPA 8260C
4-Methyl-2-pentanone	<0.19	ug/L	0.19	1.0	1	U		11/24/2022 04:32	RLD	EPA 8260C
Acetone	<0.84	ug/L	0.84	4.0	1	U		11/24/2022 04:32	RLD	EPA 8260C
Benzene	<0.022	ug/L	0.022	0.10	1	U		11/24/2022 04:32	RLD	EPA 8260C
Bromobenzene	<0.018	ug/L	0.018	0.10	1	U		11/24/2022 04:32	RLD	EPA 8260C
Bromochloromethane	<0.034	ug/L	0.034	0.20	1	U		11/24/2022 04:32	RLD	EPA 8260C
Bromodichloromethane	<0.019	ug/L	0.019	0.10	1	U		11/24/2022 04:32	RLD	EPA 8260C
Bromoform	<0.041	ug/L	0.041	0.20	1	U		11/24/2022 04:32	RLD	EPA 8260C
Bromomethane	<0.052	ug/L	0.052	0.20	1	U Z		11/24/2022 04:32	RLD	EPA 8260C
Carbon disulfide	<0.11	ug/L	0.11	0.40	1	U		11/24/2022 04:32	RLD	EPA 8260C
Carbon tetrachloride	<0.018	ug/L	0.018	0.10	1	U		11/24/2022 04:32	RLD	EPA 8260C
Chlorobenzene	<0.013	ug/L	0.013	0.10	1	U		11/24/2022 04:32	RLD	EPA 8260C
Chloroethane	<0.40	ug/L	0.40	1.5	1	U		11/24/2022 04:32	RLD	EPA 8260C
Chloroform	<0.016	ug/L	0.016	0.10	1	U		11/24/2022 04:32	RLD	EPA 8260C
Chloromethane	0.12	ug/L	0.045	0.20	1	J B		11/24/2022 04:32	RLD	EPA 8260C
cis-1,2-Dichloroethene	3.0	ug/L	0.023	0.10	1			11/24/2022 04:32	RLD	EPA 8260C
cis-1,3-Dichloropropene	<0.014	ug/L	0.014	0.10	1	U		11/24/2022 04:32	RLD	EPA 8260C
Dibromochloromethane	<0.016	ug/L	0.016	0.10	1	U		11/24/2022 04:32	RLD	EPA 8260C

Unless specifically stated to the contrary, soil/sediment/sludge sample results/LOD/LOQ/RLs were reported on a Dry Weight Basis

CT LAB#: 1266754 Sample Description:PW-03 DNR License/Well #: 04189/051 Sampled: 11/18/2022 15:45

Analyte	Result	Units	LOD	LOQ	Dilution	Qualifier	Prep Date/Time	Analysis Date/Time	Analyst	Method
Dibromomethane	<0.018	ug/L	0.018	0.10	1	U		11/24/2022 04:32	RLD	EPA 8260C
Dichlorodifluoromethane	<0.091	ug/L	0.091	0.30	1	U		11/24/2022 04:32	RLD	EPA 8260C
Diisopropyl ether	<0.02	ug/L	0.02	0.1	1	U		11/24/2022 04:32	RLD	EPA 8260C
Ethylbenzene	<0.014	ug/L	0.014	0.10	1	U		11/24/2022 04:32	RLD	EPA 8260C
Hexachlorobutadiene	<0.027	ug/L	0.027	0.20	1	U		11/24/2022 04:32	RLD	EPA 8260C
Isopropylbenzene	<0.020	ug/L	0.020	0.10	1	U		11/24/2022 04:32	RLD	EPA 8260C
m & p-Xylene	<0.030	ug/L	0.030	0.20	1	U		11/24/2022 04:32	RLD	EPA 8260C
Methyl tert-butyl ether	0.59	ug/L	0.014	0.10	1	Q,Y		11/24/2022 04:32	RLD	EPA 8260C
Methylene chloride	<0.090	ug/L	0.090	0.40	1	U		11/24/2022 04:32	RLD	EPA 8260C
n-Butylbenzene	<0.021	ug/L	0.021	0.10	1	U		11/24/2022 04:32	RLD	EPA 8260C
n-Propylbenzene	<0.020	ug/L	0.020	0.10	1	U		11/24/2022 04:32	RLD	EPA 8260C
Naphthalene	<0.025	ug/L	0.025	0.10	1	U		11/24/2022 04:32	RLD	EPA 8260C
o-Xylene	<0.016	ug/L	0.016	0.10	1	U		11/24/2022 04:32	RLD	EPA 8260C
p-Isopropyltoluene	<0.016	ug/L	0.016	0.10	1	U		11/24/2022 04:32	RLD	EPA 8260C
sec-Butylbenzene	<0.021	ug/L	0.021	0.10	1	U		11/24/2022 04:32	RLD	EPA 8260C
Styrene	<0.014	ug/L	0.014	0.10	1	U		11/24/2022 04:32	RLD	EPA 8260C
tert-Butylbenzene	<0.020	ug/L	0.020	0.10	1	U		11/24/2022 04:32	RLD	EPA 8260C
Tetrachloroethene	<0.028	ug/L	0.028	0.20	1	U		11/24/2022 04:32	RLD	EPA 8260C
Tetrahydrofuran	<0.38	ug/L	0.38	2.0	1	U		11/24/2022 04:32	RLD	EPA 8260C
Toluene	<0.020	ug/L	0.020	0.10	1	U		11/24/2022 04:32	RLD	EPA 8260C
trans-1,2-Dichloroethene	0.12	ug/L	0.020	0.10	1			11/24/2022 04:32	RLD	EPA 8260C
trans-1,3-Dichloropropene	<0.020	ug/L	0.020	0.10	1	U		11/24/2022 04:32	RLD	EPA 8260C
Trichloroethene	0.63	ug/L	0.022	0.10	1			11/24/2022 04:32	RLD	EPA 8260C
Trichlorofluoromethane	<0.033	ug/L	0.033	0.20	1	U		11/24/2022 04:32	RLD	EPA 8260C
Vinyl acetate	<0.14	ug/L	0.14	1.0	1	U		11/24/2022 04:32	RLD	EPA 8260C
Vinyl chloride	<0.019	ug/L	0.019	0.10	1	U		11/24/2022 04:32	RLD	EPA 8260C

Unless specifically stated to the contrary, soil/sediment/sludge sample results/LOD/LOQ/RLs were reported on a Dry Weight Basis

CT LAB#: 1266754 Sample Description:PW-03 DNR License/Well #: 04189/051 Sampled: 11/18/2022 15:45

Analyte	Result	Units	LOD	LOQ	Dilution	Qualifier	Prep Date/Time	Analysis Date/Time	Analyst	Method
1,4-Dioxane	<0.40	ug/L	0.40	1.4	1	U	11/22/2022 11:00	11/28/2022 18:00	ALD	EPA 8270D-SIM

Notes: All LOD/LOQs are adjusted to reflect dilution, percent solids, and any differences in the sample weight / volume as compared to standard amounts. "U" qualifier indicates concentration of analyte was below the detection limit. "J" qualifer indicates an estimated value between the LOD and LOQ.

All samples were received intact and properly preserved unless otherwise noted . The results reported relate only to the samples tested. This report shall not be reproduced, except in full, without written approval of this laboratory. The Chain of Custody is attached.

Brett M. Szymanski
Project Manager
Submitted by: 608-356-2760

<u>Code</u>	<u>Description</u>	<u>QC Qualifiers</u>
B	Analyte detected in the associated Method Blank.	
C	Toxicity present in BOD sample.	
D	Diluted Out.	
E	Safe, No Total Coliform detected.	
F	Unsafe, Total Coliform detected, no E. Coli detected.	
G	Unsafe, Total Coliform detected and E. Coli detected.	
H	Holding time exceeded.	
I	Incubator temperature was outside acceptance limits during test period.	
J	Estimated value.	
L	Significant peaks were detected outside the chromatographic window.	
M	Matrix spike and/or Matrix Spike Duplicate recovery outside acceptance limits.	
N	Insufficient BOD oxygen depletion.	
O	Complete BOD oxygen depletion.	
P	Concentration of analyte differs more than 40% between primary and confirmation analysis.	
Q	Laboratory Control Sample outside acceptance limits.	
R	See Narrative at end of report.	
S	Surrogate standard recovery outside acceptance limits due to apparent matrix effects.	
T	Sample received with improper preservation or temperature.	
U	Analyte concentration was below detection limit.	
V	Raised Quantitation or Reporting Limit due to limited sample amount or dilution for matrix background interference.	
W	Sample amount received was below program minimum.	
X	Analyte exceeded calibration range.	
Y	Replicate/Duplicate precision outside acceptance limits.	
Z	Specified calibration criteria was not met.	

Current CT Laboratories Certifications

Wisconsin (WDNR) Chemistry ID# 157066030
 Wisconsin (DATCP) Bacteriology ID# 289
 Louisiana NELAP (primary) ID# 115843
 Illinois NELAP Lab ID# 200073
 Kansas NELAP Lab ID# E-10368
 Virginia NELAP Lab ID# 460203
 ISO/IEC 17025-2005 A2LA Cert # 3806.01
 DoD-ELAP A2LA 3806.01

CHAIN OF CUSTODY

Company: ~~Hyde Environmental~~
 Project Contact: Jim Hindemans
 Telephone: 262-250-1226
 Project Name: OEC Superfund WI
 Project #:
 Location: Ashippun WI
 Sampled By: Logan Cranley

1230 Lange Court, Baraboo, WI 53913
 608-356-2760 Fax 608-356-2766
 www.ctlaboratories.com
 Folder #: 173848
 Company: HYDE ENVIRONMENTAL, INC.
 Program:
 Project: OCONOMOWOC ELECTROPLATING
 Logged By: erc PM: BMS
 Solid Waste Other: superfund
 ID #

Report To:
 EMAIL: jclindenmann@hyde-env.com
 Company: Hyde Environmental
 Address: W175 N11163 Stone wood Av
 110, Germantown WI
 Invoice To:*
 EMAIL:
 Company: Same
 Address:

*Party listed is responsible for payment of invoice as per CT Laboratories' terms and conditions

Client Special Instructions

Filtered? Y/N	ANALYSES REQUESTED												Total # Containers	Designated MS/MSD
N	VOCs low level (82606) 14 Dioxane (0270D-SIM)													

Turnaround Time
 Normal RUSH*
 Date Needed: _____
 Rush analysis requires prior
 CT Laboratories' approval
 Surcharges:
 24 hr 200%
 2-3 days 100%
 4-9 days 50%

Matrix:
 GW - groundwater SW - surface water WW - wastewater DW - drinking water
 S - soil/sediment SL - sludge A - air M - misc/waste

Collection		Matrix	Grab/Comp	Sample #	Sample ID Description	Filtered?	Fill in Spaces with Bottles per Test												CT Lab ID # Lab use only
Date	Time																		
11-18-22	1545	DW	Grab		PW-03	N	3	2											1266754 55
					Tap Blank - EPC-11/18/22		X												

Relinquished By:
 Logan Cranley
 Received by:

Date/Time
 11-18-22 1700
 Date/Time

Received By:
 Received for Laboratory by:

Date/Time
 11/22/22

Lab Use Only
 Ice Present Yes No
 Temp 4.1 IR Gun 28
 Cooler # 5526

Jan 11/22/22 945

Notice: This form may be used to comply with the requirements of s. NR 716.14 (2), Wis. Adm. Code; however, use of this form is not required. An alternate format may be used. The rule requires that notification be provided to 1) property owners when someone else is conducting the sampling, 2) to occupants of property belonging to the responsible person, and 3) to owners and occupants of property that does not belong to the responsible person but has been affected by contamination arising on his or her property. Notification is required within 10 business days of receiving the sample results. Personal information collected will be used for program administration and may be provided to requesters to the extent required by Wisconsin's Open Records law [ss. 19.31-19.39, Wis. Stats.].

NOTE: Under s. NR 716.14, Wis. Adm. Code, the responsible party must also submit sample results and other required information to the DNR. We recommend that copies of the sample results notifications be included with that submittal, along with all attachments. Using the same format used for data presentation for a closure request may be helpful to all parties. See s. NR 716.14, Wis. Adm. Code for the full list of information to be submitted to the DNR.

Notification of Property Owners and Occupants:

This notification form has been provided to you in order to provide the results of environmental sampling that has been conducted on property that you own or occupy. Samples were collected in accordance with the methods identified in the site investigation work plan, in accordance with s. NR. 716.09 and 716.13, Wis. Adm. Code. This sampling was conducted as a result of contamination originating at the following location.

Site Information

Site Name		DNR ID # (BRRTS #)	
Oconomowoc Electroplating Company, Inc. (OECI) Superfund Site		02-14-000905	
Address	City	State	ZIP Code
W2573 Oak Street	Ashippun	WI	53003

Responsible Party

The person(s) responsible for completing this environmental investigation is:

Property Owner

Oconomowoc Electroplating Company, Inc.

Address	City	State	ZIP Code
W2573 Oak Street	Ashippun	WI	53003

Contact Person	Phone Number (include area code)
Gwen Saliaras (WDNR PM), William Murray (US EPA Remedial PM)	(920) 510-4343

Person or company that collected samples

Hyde Environmental, Inc.

Sample Results (Results Attached)

Reason for Sampling: Routine Other (define) _____

The contaminants that have been identified at this time on property that you own or occupy include:

Contaminant	In Soil?		In Groundwater?	
	Yes	No	Yes	No
Gasoline	<input type="radio"/>	<input checked="" type="radio"/>	<input type="radio"/>	<input checked="" type="radio"/>
Diesel or Fuel Oil	<input type="radio"/>	<input checked="" type="radio"/>	<input type="radio"/>	<input checked="" type="radio"/>
Solvents	<input type="radio"/>	<input checked="" type="radio"/>	<input checked="" type="radio"/>	<input type="radio"/>
Heavy Metals	<input type="radio"/>	<input checked="" type="radio"/>	<input type="radio"/>	<input checked="" type="radio"/>
Pesticides	<input type="radio"/>	<input checked="" type="radio"/>	<input type="radio"/>	<input checked="" type="radio"/>
Other: _____	<input type="radio"/>	<input checked="" type="radio"/>	<input type="radio"/>	<input checked="" type="radio"/>

This sampling event included sampling of a drinking water well. <input checked="" type="radio"/> Yes <input type="radio"/> No
If yes, the sampled drinking water well had detectable contaminants. <input checked="" type="radio"/> Yes <input type="radio"/> No

Contaminants in Vapor

	Yes	No
	Indoor Air	<input type="radio"/>
Sub-slab	<input type="radio"/>	<input checked="" type="radio"/>
Exterior Soil Gas	<input type="radio"/>	<input checked="" type="radio"/>

Site Investigation Sample Results Notification

Form 4400-249 (R 03/14)

Page 2 of 2

Attached are:

- A map that shows the locations from which samples were collected. (The map needs to meet the requirements of s. NR 716.15 (4), Wis. Adm. Code.)
- A data table with specific contaminant levels at each sample location and whether or not the sample results exceed state standards.
- A copy of the laboratory results.

You are not identified as the person that is responsible for this contamination. However, your cooperation is important. Property owners may become legally responsible for contamination if they do not allow access to the person that is responsible so that person may complete the environmental investigation and clean up activities.

Option for written exemption: You have the option of requesting a written liability exemption from the DNR for contamination that originated on another property, or on property that you lease. To do this, you must present an adequate environmental assessment of your property and pay a \$700 fee for review of this information. If you are interested in this option, please see DNR publication # RR 589, "When Contamination Crosses a Property Line - Rights and Responsibilities of Property Owners", available at: dnr.wi.gov/files/PDF/pubs/rr/rr589.pdf.

Contact Information

Please address questions regarding this notification, or requests for additional information to the contact person listed above, or to one of the following contacts:

Environmental Consultant

Company Name	Contact Person Last Name	First Name		
Hyde Environmental, Inc.	Lindemann	James		
Address	City	State	ZIP Code	
W175 N11163 Stonewood Drive, Suite 110	Germantown	WI	53022	
Phone # (inc. area code)	Email			
(262) 250-1226	jclindemann@hyde-env.com			

Select which agency: Natural Resources Agriculture, Trade and Consumer Protection

State of Wisconsin Department of Natural Resources

Contact Person Last Name	First Name	Phone # (inc. area code)		
Saliars	Gwen	(920) 510-4343		
Address	City	State	ZIP Code	
625 E County Road Y, Suite 700	Oshkosh	WI	54901	
Email				
gwen.saliars@wisconsin.gov				

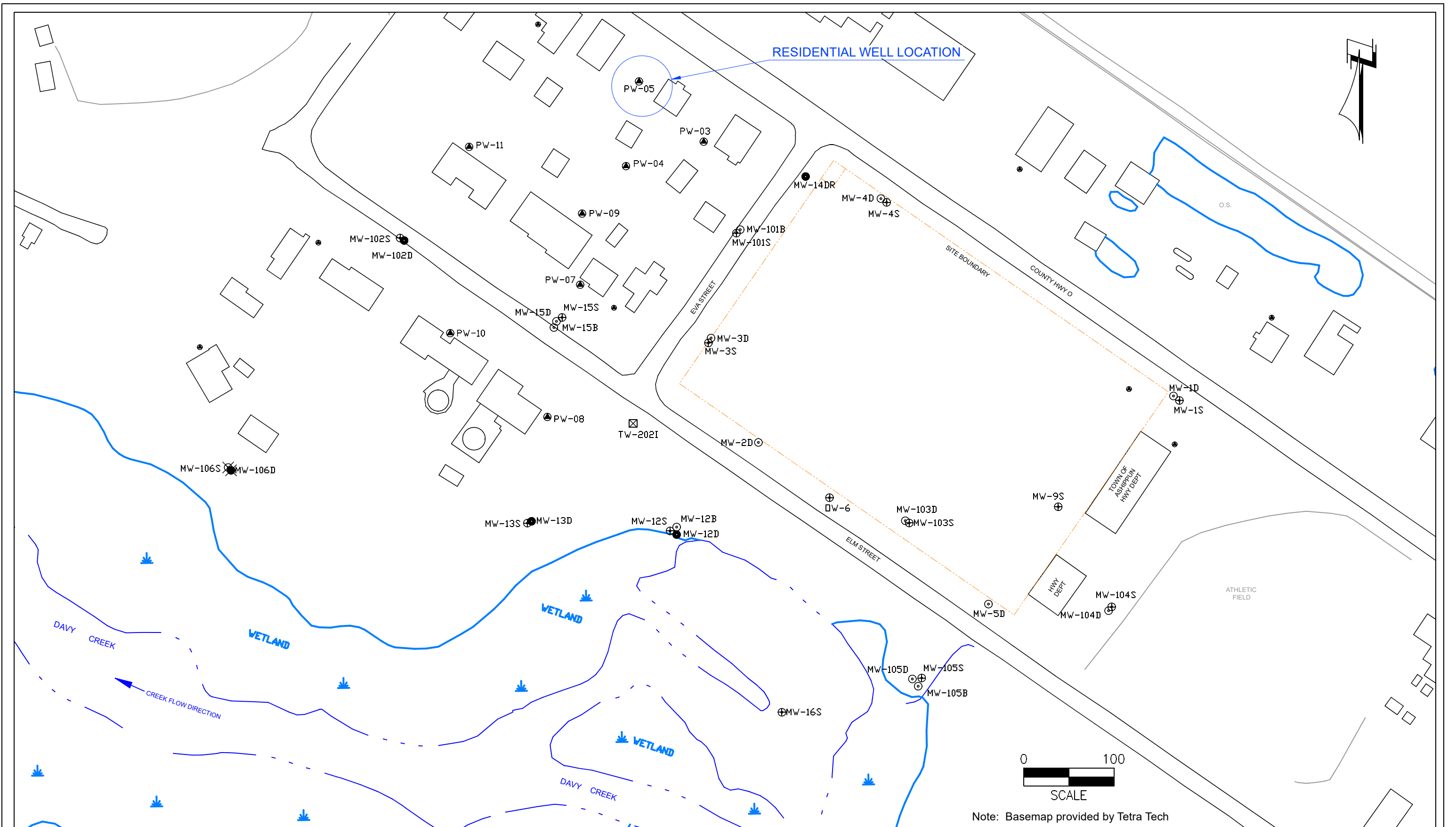

RESIDENTIAL WELL LOCATION

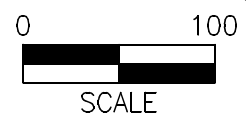

Note: Basemap provided by Tetra Tech

⊕ MW-105B	BEDROCK MONITORING WELL	● PW-11	RESIDENTIAL WELL
● MW-105D	DEEP UNCONSOLIDATED MONITORING WELL	⊗ MW-106D	DEEP UNCONSOLIDATED SENTINEL WELL
⊕ MW-105S	SHALLOW UNCONSOLIDATED MONITORING WELL	⊗ MW-106S	SHALLOW UNCONSOLIDATED SENTINEL WELL
-----	FORMER OECl SITE BOUNDARY		



Figure 1
SITE MAP
Oconomowoc Electroplating Company, Inc.
Ashippun, WI

GROUNDWATER ANALYTICAL RESULTS SUMMARY

W2611 Oak Street, Ashippun, WI

Sampled November 17, 2022

Parameters (ug/L)	<i>NR 140 Groundwater Quality Health Standards</i>		PW-05
	<i>ES</i>	<i>PAL</i>	
VOCs			
Chloromethane	30	3	0.10
1,2-Dichloroethane	5	0.5	<0.017
cis-1,2-Dichloroethene	70	7	1.2
trans-1,2-Dichloroethene	100	20	0.055
Diisopropyl ether	--	--	0.21
Methyl tert-butyl ether (MTBE)	60	12	0.52
Trichloroethene	5	0.5	0.095
Vinyl acetate	--	--	0.31
1,4-Dioxane	3	0.3	<0.40

Notes:

PAL = Preventive Action Limit

ES = Enforcement Standard

-- = No standard

Italicized values attain or exceed the NR 140 PAL

ug/L = micrograms per liter

< = less than the laboratory method detection limit (MDL)

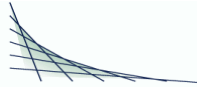

ANALYTICAL REPORT

HYDE ENVIRONMENTAL, INC.
 JIM LINDEMANN
 W175 N11163 STONEWOOD DRIVE
 SUITE 110
 GERMANTOWN, WI 53022-6501

Project Name: OEC SUPERFUND WI
 Project Phase: ASHIPPUN, WI
 Project #:
 Folder #: 173815
 Purchase Order #:
 Contract #: 3451

Page 1 of 5
 Arrival Temperature: 1.7
 Report Date: 12/13/2022
 Date Received: 11/18/2022
 Reprint Date: 12/13/2022

CT LAB#: 1265490	Sample Description: PW-05	DNR License/Well #: 04189/053	Sampled: 11/17/2022 13:30
------------------	---------------------------	-------------------------------	---------------------------

Analyte	Result	Units	LOD	LOQ	Dilution	Qualifier	Prep Date/Time	Analysis Date/Time	Analyst	Method
Organic Results										
1,1,1,2-Tetrachloroethane	<0.013	ug/L	0.013	0.10	1	U	11/24/2022	04:04	RLD	EPA 8260C
1,1,1-Trichloroethane	<0.013	ug/L	0.013	0.10	1	U	11/24/2022	04:04	RLD	EPA 8260C
1,1,2,2-Tetrachloroethane	<0.015	ug/L	0.015	0.10	1	U	11/24/2022	04:04	RLD	EPA 8260C
1,1,2-Trichloroethane	<0.036	ug/L	0.036	0.20	1	U	11/24/2022	04:04	RLD	EPA 8260C
1,1-Dichloroethane	<0.017	ug/L	0.017	0.10	1	U	11/24/2022	04:04	RLD	EPA 8260C
1,1-Dichloroethene	<0.024	ug/L	0.024	0.10	1	U	11/24/2022	04:04	RLD	EPA 8260C
1,1-Dichloropropene	<0.074	ug/L	0.074	0.20	1	U	11/24/2022	04:04	RLD	EPA 8260C
1,2,3-Trichlorobenzene	<0.019	ug/L	0.019	0.10	1	U	11/24/2022	04:04	RLD	EPA 8260C
1,2,3-Trichloropropane	<0.031	ug/L	0.031	0.20	1	U	11/24/2022	04:04	RLD	EPA 8260C
1,2,4-Trichlorobenzene	<0.022	ug/L	0.022	0.10	1	U	11/24/2022	04:04	RLD	EPA 8260C
1,2,4-Trimethylbenzene	<0.011	ug/L	0.011	0.10	1	U	11/24/2022	04:04	RLD	EPA 8260C
1,2-Dibromo-3-chloropropane	<0.12	ug/L	0.12	0.40	1	U	11/24/2022	04:04	RLD	EPA 8260C
1,2-Dibromoethane	<0.029	ug/L	0.029	0.20	1	U	11/24/2022	04:04	RLD	EPA 8260C
1,2-Dichlorobenzene	<0.016	ug/L	0.016	0.10	1	U	11/24/2022	04:04	RLD	EPA 8260C
1,2-Dichloroethane	<0.017	ug/L	0.017	0.10	1	U	11/24/2022	04:04	RLD	EPA 8260C
1,2-Dichloropropane	<0.013	ug/L	0.013	0.10	1	U	11/24/2022	04:04	RLD	EPA 8260C

Unless specifically stated to the contrary, soil/sediment/sludge sample results/LOD/LOQ/RLs were reported on a Dry Weight Basis

CT LAB#: 1265490 Sample Description:PW-05	DNR License/Well #: 04189/053	Sampled: 11/17/2022 13:30
---	-------------------------------	---------------------------

Analyte	Result	Units	LOD	LOQ	Dilution	Qualifier	Prep Date/Time	Analysis Date/Time	Analyst	Method
1,3,5-Trimethylbenzene	<0.013	ug/L	0.013	0.10	1	U		11/24/2022 04:04	RLD	EPA 8260C
1,3-Dichlorobenzene	<0.013	ug/L	0.013	0.10	1	U		11/24/2022 04:04	RLD	EPA 8260C
1,3-Dichloropropane	<0.020	ug/L	0.020	0.10	1	U		11/24/2022 04:04	RLD	EPA 8260C
1,4-Dichlorobenzene	<0.017	ug/L	0.017	0.10	1	U		11/24/2022 04:04	RLD	EPA 8260C
2,2-Dichloropropane	<0.075	ug/L	0.075	0.30	1	U		11/24/2022 04:04	RLD	EPA 8260C
2-Butanone	<0.31	ug/L	0.31	2.0	1	U		11/24/2022 04:04	RLD	EPA 8260C
2-Chlorotoluene	<0.020	ug/L	0.020	0.10	1	U		11/24/2022 04:04	RLD	EPA 8260C
2-Hexanone	<0.15	ug/L	0.15	1.0	1	U		11/24/2022 04:04	RLD	EPA 8260C
4-Chlorotoluene	<0.013	ug/L	0.013	0.10	1	U		11/24/2022 04:04	RLD	EPA 8260C
4-Methyl-2-pentanone	<0.19	ug/L	0.19	1.0	1	U		11/24/2022 04:04	RLD	EPA 8260C
Acetone	<0.84	ug/L	0.84	4.0	1	U		11/24/2022 04:04	RLD	EPA 8260C
Benzene	<0.022	ug/L	0.022	0.10	1	U		11/24/2022 04:04	RLD	EPA 8260C
Bromobenzene	<0.018	ug/L	0.018	0.10	1	U		11/24/2022 04:04	RLD	EPA 8260C
Bromochloromethane	<0.034	ug/L	0.034	0.20	1	U		11/24/2022 04:04	RLD	EPA 8260C
Bromodichloromethane	<0.019	ug/L	0.019	0.10	1	U		11/24/2022 04:04	RLD	EPA 8260C
Bromoform	<0.041	ug/L	0.041	0.20	1	U		11/24/2022 04:04	RLD	EPA 8260C
Bromomethane	<0.052	ug/L	0.052	0.20	1	U Z		11/24/2022 04:04	RLD	EPA 8260C
Carbon disulfide	<0.11	ug/L	0.11	0.40	1	U		11/24/2022 04:04	RLD	EPA 8260C
Carbon tetrachloride	<0.018	ug/L	0.018	0.10	1	U		11/24/2022 04:04	RLD	EPA 8260C
Chlorobenzene	<0.013	ug/L	0.013	0.10	1	U		11/24/2022 04:04	RLD	EPA 8260C
Chloroethane	<0.40	ug/L	0.40	1.5	1	U		11/24/2022 04:04	RLD	EPA 8260C
Chloroform	<0.016	ug/L	0.016	0.10	1	U		11/24/2022 04:04	RLD	EPA 8260C
Chloromethane	0.10	ug/L	0.045	0.20	1	J B		11/24/2022 04:04	RLD	EPA 8260C
cis-1,2-Dichloroethene	1.2	ug/L	0.023	0.10	1			11/24/2022 04:04	RLD	EPA 8260C
cis-1,3-Dichloropropene	<0.014	ug/L	0.014	0.10	1	U		11/24/2022 04:04	RLD	EPA 8260C
Dibromochloromethane	<0.016	ug/L	0.016	0.10	1	U		11/24/2022 04:04	RLD	EPA 8260C

Unless specifically stated to the contrary, soil/sediment/sludge sample results/LOD/LOQ/RLs were reported on a Dry Weight Basis

CT LAB#: 1265490	Sample Description:PW-05	DNR License/Well #: 04189/053	Sampled: 11/17/2022 13:30
------------------	--------------------------	-------------------------------	---------------------------

Analyte	Result	Units	LOD	LOQ	Dilution	Qualifier	Prep Date/Time	Analysis Date/Time	Analyst	Method
Dibromomethane	<0.018	ug/L	0.018	0.10	1	U		11/24/2022 04:04	RLD	EPA 8260C
Dichlorodifluoromethane	<0.091	ug/L	0.091	0.30	1	U		11/24/2022 04:04	RLD	EPA 8260C
Diisopropyl ether	0.21	ug/L	0.02	0.1	1			11/24/2022 04:04	RLD	EPA 8260C
Ethylbenzene	<0.014	ug/L	0.014	0.10	1	U		11/24/2022 04:04	RLD	EPA 8260C
Hexachlorobutadiene	<0.027	ug/L	0.027	0.20	1	U		11/24/2022 04:04	RLD	EPA 8260C
Isopropylbenzene	<0.020	ug/L	0.020	0.10	1	U		11/24/2022 04:04	RLD	EPA 8260C
m & p-Xylene	<0.030	ug/L	0.030	0.20	1	U		11/24/2022 04:04	RLD	EPA 8260C
Methyl tert-butyl ether	0.52	ug/L	0.014	0.10	1	Q,Y		11/24/2022 04:04	RLD	EPA 8260C
Methylene chloride	<0.090	ug/L	0.090	0.40	1	U		11/24/2022 04:04	RLD	EPA 8260C
n-Butylbenzene	<0.021	ug/L	0.021	0.10	1	U		11/24/2022 04:04	RLD	EPA 8260C
n-Propylbenzene	<0.020	ug/L	0.020	0.10	1	U		11/24/2022 04:04	RLD	EPA 8260C
Naphthalene	<0.025	ug/L	0.025	0.10	1	U		11/24/2022 04:04	RLD	EPA 8260C
o-Xylene	<0.016	ug/L	0.016	0.10	1	U		11/24/2022 04:04	RLD	EPA 8260C
p-Isopropyltoluene	<0.016	ug/L	0.016	0.10	1	U		11/24/2022 04:04	RLD	EPA 8260C
sec-Butylbenzene	<0.021	ug/L	0.021	0.10	1	U		11/24/2022 04:04	RLD	EPA 8260C
Styrene	<0.014	ug/L	0.014	0.10	1	U		11/24/2022 04:04	RLD	EPA 8260C
tert-Butylbenzene	<0.020	ug/L	0.020	0.10	1	U		11/24/2022 04:04	RLD	EPA 8260C
Tetrachloroethene	<0.028	ug/L	0.028	0.20	1	U		11/24/2022 04:04	RLD	EPA 8260C
Tetrahydrofuran	<0.38	ug/L	0.38	2.0	1	U		11/24/2022 04:04	RLD	EPA 8260C
Toluene	<0.020	ug/L	0.020	0.10	1	U		11/24/2022 04:04	RLD	EPA 8260C
trans-1,2-Dichloroethene	0.055	ug/L	0.020	0.10	1	J		11/24/2022 04:04	RLD	EPA 8260C
trans-1,3-Dichloropropene	<0.020	ug/L	0.020	0.10	1	U		11/24/2022 04:04	RLD	EPA 8260C
Trichloroethene	0.095	ug/L	0.022	0.10	1	J		11/24/2022 04:04	RLD	EPA 8260C
Trichlorofluoromethane	<0.033	ug/L	0.033	0.20	1	U		11/24/2022 04:04	RLD	EPA 8260C
Vinyl acetate	0.31	ug/L	0.14	1.0	1	J		11/24/2022 04:04	RLD	EPA 8260C
Vinyl chloride	<0.019	ug/L	0.019	0.10	1	U		11/24/2022 04:04	RLD	EPA 8260C

Unless specifically stated to the contrary, soil/sediment/sludge sample results/LOD/LOQ/RLs were reported on a Dry Weight Basis

CT LAB#: 1265490	Sample Description:PW-05	DNR License/Well #: 04189/053	Sampled: 11/17/2022 13:30
------------------	--------------------------	-------------------------------	---------------------------

Analyte	Result	Units	LOD	LOQ	Dilution	Qualifier	Prep Date/Time	Analysis Date/Time	Analyst	Method
1,4-Dioxane	<0.40	ug/L	0.40	1.4	1	U	11/22/2022 11:00	11/28/2022 17:39	ALD	EPA 8270D-SIM

Notes: All LOD/LOQs are adjusted to reflect dilution, percent solids, and any differences in the sample weight / volume as compared to standard amounts. "U" qualifier indicates concentration of analyte was below the detection limit. "J" qualifier indicates an estimated value between the LOD and LOQ.

All samples were received intact and properly preserved unless otherwise noted. The results reported relate only to the samples tested. This report shall not be reproduced, except in full, without written approval of this laboratory. The Chain of Custody is attached.

Brett M. Szymanski
Project Manager
Submitted by: 608-356-2760

<u>Code</u>	<u>Description</u>	<u>QC Qualifiers</u>
B	Analyte detected in the associated Method Blank.	
C	Toxicity present in BOD sample.	
D	Diluted Out.	
E	Safe, No Total Coliform detected.	
F	Unsafe, Total Coliform detected, no E. Coli detected.	
G	Unsafe, Total Coliform detected and E. Coli detected.	
H	Holding time exceeded.	
I	Incubator temperature was outside acceptance limits during test period.	
J	Estimated value.	
L	Significant peaks were detected outside the chromatographic window.	
M	Matrix spike and/or Matrix Spike Duplicate recovery outside acceptance limits.	
N	Insufficient BOD oxygen depletion.	
O	Complete BOD oxygen depletion.	
P	Concentration of analyte differs more than 40% between primary and confirmation analysis.	
Q	Laboratory Control Sample outside acceptance limits.	
R	See Narrative at end of report.	
S	Surrogate standard recovery outside acceptance limits due to apparent matrix effects.	
T	Sample received with improper preservation or temperature.	
U	Analyte concentration was below detection limit.	
V	Raised Quantitation or Reporting Limit due to limited sample amount or dilution for matrix background interference.	
W	Sample amount received was below program minimum.	
X	Analyte exceeded calibration range.	
Y	Replicate/Duplicate precision outside acceptance limits.	
Z	Specified calibration criteria was not met.	

Current CT Laboratories Certifications

Wisconsin (WDNR) Chemistry ID# 157066030
 Wisconsin (DATCP) Bacteriology ID# 289
 Louisiana NELAP (primary) ID# 115843
 Illinois NELAP Lab ID# 200073
 Kansas NELAP Lab ID# E-10368
 Virginia NELAP Lab ID# 460203
 ISO/IEC 17025-2005 A2LA Cert # 3806.01
 DoD-ELAP A2LA 3806.01

Company: ~~Hyde Environmental~~

Project Contact: Jim Lindemann

Telephone: 262-250-1226

Project Name: DEC Superfund WI

Project #:

Location: Ashippun WI

Sampled By: Logan Cranley

CT LABORATORIES

1230 Lange Court, Baraboo, WI 53913
608-356-2760 Fax 608-356-2766
www.ctlaboratories.com

Report To:
EMAIL: jclindemann@hyde-env.com
Company: Hyde Environmental

Address: W175 N1163 Stone Road
110, Germantown WI

Invoice To:*
EMAIL:
Company: Same
Address:

Lab Use Only
Place Header Sticker Here:

Program:
QSM RCRA SDWA NPDES
Solid Waste Other superfund

PO #

173815

*Party listed is responsible for payment of invoice as per CT Laboratories' terms and conditions

Client Special Instructions

ANALYSES REQUESTED											

Total # Containers
Designated MS/MSD

Turnaround Time
Normal RUSH*
Date Needed: _____
Rush analysis requires prior
CT Laboratories' approval
Surcharges:
24 hr 200%
2-3 days 100%
4-9 days 50%

Matrix:
GW - groundwater SW - surface water WW - wastewater DW - drinking water
S - soil/sediment SL - sludge A - air M - misc/waste

Filtered? Y/N
VOCs low level (8260C)
1/4 Dioxane
(0270D-SIM)

Collection		Matrix	Grab/Comp	Sample #	Sample ID Description	Filtered? Y/N	Fill in Spaces with Bottles per Test												CT Lab ID # Lab use only
Date	Time																		
11-17-22	1330	DW	Grab		PW-05	N	3	2											1265496

Relinquished By: Logan Cranley

Date/Time: 11-17-22 1445

Received By: [Signature]

Date/Time: 11/18/22 952

Lab Use Only
Ice Present Yes No
Temp 1.7 IR Gun 27
Cooler # 6254

Received by:

Date/Time

Received for Laboratory by:
173815 - Page 42 of 42

Date/Time: 11/18/22 1235

Notice: This form may be used to comply with the requirements of s. NR 716.14 (2), Wis. Adm. Code; however, use of this form is not required. An alternate format may be used. The rule requires that notification be provided to 1) property owners when someone else is conducting the sampling, 2) to occupants of property belonging to the responsible person, and 3) to owners and occupants of property that does not belong to the responsible person but has been affected by contamination arising on his or her property. Notification is required within 10 business days of receiving the sample results. Personal information collected will be used for program administration and may be provided to requesters to the extent required by Wisconsin's Open Records law [ss. 19.31-19.39, Wis. Stats.].

NOTE: Under s. NR 716.14, Wis. Adm. Code, the responsible party must also submit sample results and other required information to the DNR. We recommend that copies of the sample results notifications be included with that submittal, along with all attachments. Using the same format used for data presentation for a closure request may be helpful to all parties. See s. NR 716.14, Wis. Adm. Code for the full list of information to be submitted to the DNR.

Notification of Property Owners and Occupants:

This notification form has been provided to you in order to provide the results of environmental sampling that has been conducted on property that you own or occupy. Samples were collected in accordance with the methods identified in the site investigation work plan, in accordance with s. NR. 716.09 and 716.13, Wis. Adm. Code. This sampling was conducted as a result of contamination originating at the following location.

Site Information			
Site Name		DNR ID # (BRRTS #)	
Oconomowoc Electroplating Company, Inc. (OECI) Superfund Site		02-14-000905	
Address	City	State	ZIP Code
W2573 Oak Street	Ashippun	WI	53003

Responsible Party

The person(s) responsible for completing this environmental investigation is:

Property Owner			
Oconomowoc Electroplating Company, Inc.			
Address	City	State	ZIP Code
W2573 Oak Street	Ashippun	WI	53003
Contact Person	Phone Number (include area code)		
Gwen Saliars (WDNR PM), William Murray (US EPA Remedial PM)	(920) 510-4343		
Person or company that collected samples			
Hyde Environmental, Inc.			

Sample Results (Results Attached)

Reason for Sampling: Routine Other (define) _____

The contaminants that have been identified at this time on property that you own or occupy include:

Contaminant	In Soil?		In Groundwater?	
	Yes	No	Yes	No
Gasoline	<input type="radio"/>	<input checked="" type="radio"/>	<input type="radio"/>	<input checked="" type="radio"/>
Diesel or Fuel Oil	<input type="radio"/>	<input checked="" type="radio"/>	<input type="radio"/>	<input checked="" type="radio"/>
Solvents	<input type="radio"/>	<input checked="" type="radio"/>	<input checked="" type="radio"/>	<input type="radio"/>
Heavy Metals	<input type="radio"/>	<input checked="" type="radio"/>	<input type="radio"/>	<input checked="" type="radio"/>
Pesticides	<input type="radio"/>	<input checked="" type="radio"/>	<input type="radio"/>	<input checked="" type="radio"/>
Other: _____	<input type="radio"/>	<input checked="" type="radio"/>	<input type="radio"/>	<input checked="" type="radio"/>

This sampling event included sampling of a drinking water well. <input checked="" type="radio"/> Yes <input type="radio"/> No
If yes, the sampled drinking water well had detectable contaminants. <input checked="" type="radio"/> Yes <input type="radio"/> No

Contaminants in Vapor	Yes	No
	Indoor Air	<input type="radio"/>
Sub-slab	<input type="radio"/>	<input checked="" type="radio"/>
Exterior Soil Gas	<input type="radio"/>	<input checked="" type="radio"/>

Site Investigation Sample Results Notification

Form 4400-249 (R 03/14)

Page 2 of 2

Attached are:

- A map that shows the locations from which samples were collected. (The map needs to meet the requirements of s. NR 716.15 (4), Wis. Adm. Code.)
- A data table with specific contaminant levels at each sample location and whether or not the sample results exceed state standards.
- A copy of the laboratory results.

You are not identified as the person that is responsible for this contamination. However, your cooperation is important. Property owners may become legally responsible for contamination if they do not allow access to the person that is responsible so that person may complete the environmental investigation and clean up activities.

Option for written exemption: You have the option of requesting a written liability exemption from the DNR for contamination that originated on another property, or on property that you lease. To do this, you must present an adequate environmental assessment of your property and pay a \$700 fee for review of this information. If you are interested in this option, please see DNR publication # RR 589, "When Contamination Crosses a Property Line - Rights and Responsibilities of Property Owners", available at: dnr.wi.gov/files/PDF/pubs/rr/rr589.pdf.

Contact Information

Please address questions regarding this notification, or requests for additional information to the contact person listed above, or to one of the following contacts:

Environmental Consultant

Company Name	Contact Person Last Name	First Name	
Hyde Environmental, Inc.	Lindemann	James	
Address	City	State	ZIP Code
W175 N11163 Stonewood Drive, Suite 110	Germantown	WI	53022
Phone # (inc. area code)	Email		
(262) 250-1226	jclindemann@hyde-env.com		

Select which agency: Natural Resources Agriculture, Trade and Consumer Protection

State of Wisconsin Department of Natural Resources

Contact Person Last Name	First Name	Phone # (inc. area code)	
Saliars	Gwen	(920) 510-4343	
Address	City	State	ZIP Code
625 E County Road Y, Suite 700	Oshkosh	WI	54901
Email			
gwen.saliars@wisconsin.gov			

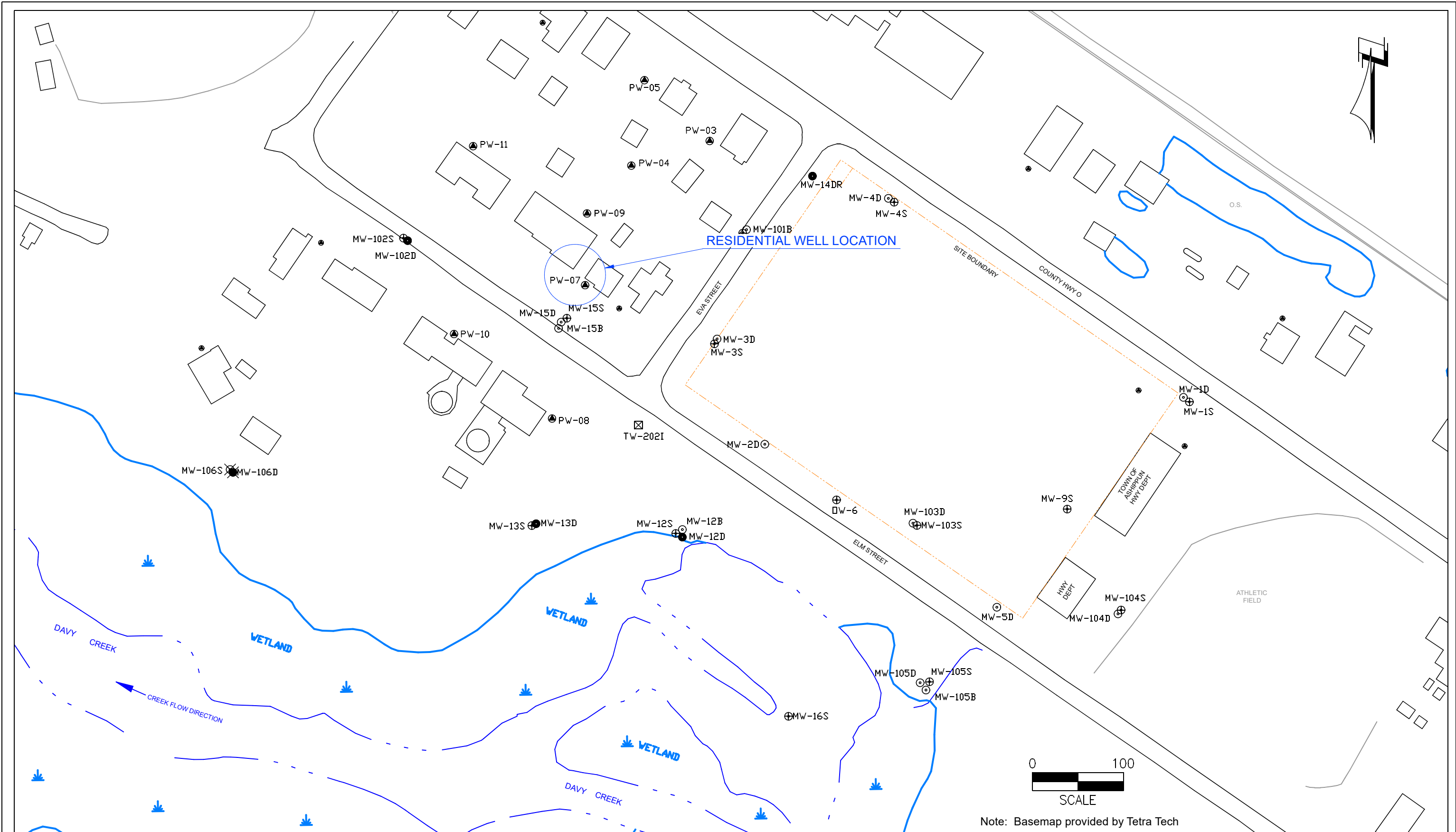

⊕ MW-105B	BEDROCK MONITORING WELL	● PW-11	RESIDENTIAL WELL
● MW-105D	DEEP UNCONSOLIDATED MONITORING WELL	⊗ MW-106D	DEEP UNCONSOLIDATED SENTINEL WELL
⊕ MW-105S	SHALLOW UNCONSOLIDATED MONITORING WELL	⊗ MW-106S	SHALLOW UNCONSOLIDATED SENTINEL WELL
-----	FORMER OECl SITE BOUNDARY		



Figure 1
SITE MAP
 Oconomowoc Electroplating Company, Inc.
 Ashippun, WI

GROUNDWATER ANALYTICAL RESULTS SUMMARY

W2602 Elm Street, Ashippun, WI

Sampled November 17, 2022

Parameters (ug/L)	NR 140 Groundwater Quality Health Standards		PW-07
	ES	PAL	
VOCs			
1,2-Dichloroethane	5	0.5	0.048
Chloromethane	30	3	0.11
cis-1,2-Dichloroethene	70	7	6.9
Diisopropyl ether	--	--	0.024
Methyl tert-butyl ether (MTBE)	60	12	0.65
trans-1,2-Dichloroethene	100	20	0.28
Trichloroethene	5	0.5	0.064
Vinyl chloride	0.2	0.02	<i>0.044</i>
1,4-Dioxane	3	0.3	<0.40

Notes:

PAL = Preventive Action Limit

ES = Enforcement Standard

-- = No standard

Italicized values attain or exceed the NR 140 PAL

ug/L = micrograms per liter

< = less than the laboratory method detection limit (MDL)

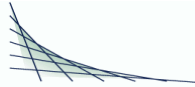

ANALYTICAL REPORT

HYDE ENVIRONMENTAL, INC.
 JIM LINDEMANN
 W175 N11163 STONEWOOD DRIVE
 SUITE 110
 GERMANTOWN, WI 53022-6501

Project Name: OEC SUPERFUND WI
 Project Phase: ASHIPPUN, WI
 Project #:
 Folder #: 173815
 Purchase Order #:
 Contract #: 3451

Page 1 of 5
 Arrival Temperature: 1.7
 Report Date: 12/13/2022
 Date Received: 11/18/2022
 Reprint Date: 12/13/2022

CT LAB#: 1265488	Sample Description: PW-07	DNR License/Well #: 04189/054	Sampled: 11/17/2022 12:30
------------------	---------------------------	-------------------------------	---------------------------

Analyte	Result	Units	LOD	LOQ	Dilution	Qualifier	Prep Date/Time	Analysis Date/Time	Analyst	Method
Organic Results										
1,1,1,2-Tetrachloroethane	<0.013	ug/L	0.013	0.10	1	U	11/24/2022	03:07	RLD	EPA 8260C
1,1,1-Trichloroethane	<0.013	ug/L	0.013	0.10	1	U	11/24/2022	03:07	RLD	EPA 8260C
1,1,2,2-Tetrachloroethane	<0.015	ug/L	0.015	0.10	1	U	11/24/2022	03:07	RLD	EPA 8260C
1,1,2-Trichloroethane	<0.036	ug/L	0.036	0.20	1	U	11/24/2022	03:07	RLD	EPA 8260C
1,1-Dichloroethane	<0.017	ug/L	0.017	0.10	1	U	11/24/2022	03:07	RLD	EPA 8260C
1,1-Dichloroethene	<0.024	ug/L	0.024	0.10	1	U	11/24/2022	03:07	RLD	EPA 8260C
1,1-Dichloropropene	<0.074	ug/L	0.074	0.20	1	U	11/24/2022	03:07	RLD	EPA 8260C
1,2,3-Trichlorobenzene	<0.019	ug/L	0.019	0.10	1	U	11/24/2022	03:07	RLD	EPA 8260C
1,2,3-Trichloropropane	<0.031	ug/L	0.031	0.20	1	U	11/24/2022	03:07	RLD	EPA 8260C
1,2,4-Trichlorobenzene	<0.022	ug/L	0.022	0.10	1	U	11/24/2022	03:07	RLD	EPA 8260C
1,2,4-Trimethylbenzene	<0.011	ug/L	0.011	0.10	1	U	11/24/2022	03:07	RLD	EPA 8260C
1,2-Dibromo-3-chloropropane	<0.12	ug/L	0.12	0.40	1	U	11/24/2022	03:07	RLD	EPA 8260C
1,2-Dibromoethane	<0.029	ug/L	0.029	0.20	1	U	11/24/2022	03:07	RLD	EPA 8260C
1,2-Dichlorobenzene	<0.016	ug/L	0.016	0.10	1	U	11/24/2022	03:07	RLD	EPA 8260C
1,2-Dichloroethane	0.048	ug/L	0.017	0.10	1	J	11/24/2022	03:07	RLD	EPA 8260C
1,2-Dichloropropane	<0.013	ug/L	0.013	0.10	1	U	11/24/2022	03:07	RLD	EPA 8260C

Unless specifically stated to the contrary, soil/sediment/sludge sample results/LOD/LOQ/RLs were reported on a Dry Weight Basis

CT LAB#: 1265488	Sample Description:PW-07	DNR License/Well #: 04189/054	Sampled: 11/17/2022 12:30
------------------	--------------------------	-------------------------------	---------------------------

Analyte	Result	Units	LOD	LOQ	Dilution	Qualifier	Prep Date/Time	Analysis Date/Time	Analyst	Method
1,3,5-Trimethylbenzene	<0.013	ug/L	0.013	0.10	1	U		11/24/2022 03:07	RLD	EPA 8260C
1,3-Dichlorobenzene	<0.013	ug/L	0.013	0.10	1	U		11/24/2022 03:07	RLD	EPA 8260C
1,3-Dichloropropane	<0.020	ug/L	0.020	0.10	1	U		11/24/2022 03:07	RLD	EPA 8260C
1,4-Dichlorobenzene	<0.017	ug/L	0.017	0.10	1	U		11/24/2022 03:07	RLD	EPA 8260C
2,2-Dichloropropane	<0.075	ug/L	0.075	0.30	1	U		11/24/2022 03:07	RLD	EPA 8260C
2-Butanone	<0.31	ug/L	0.31	2.0	1	U		11/24/2022 03:07	RLD	EPA 8260C
2-Chlorotoluene	<0.020	ug/L	0.020	0.10	1	U		11/24/2022 03:07	RLD	EPA 8260C
2-Hexanone	<0.15	ug/L	0.15	1.0	1	U		11/24/2022 03:07	RLD	EPA 8260C
4-Chlorotoluene	<0.013	ug/L	0.013	0.10	1	U		11/24/2022 03:07	RLD	EPA 8260C
4-Methyl-2-pentanone	<0.19	ug/L	0.19	1.0	1	U		11/24/2022 03:07	RLD	EPA 8260C
Acetone	<0.84	ug/L	0.84	4.0	1	U		11/24/2022 03:07	RLD	EPA 8260C
Benzene	<0.022	ug/L	0.022	0.10	1	U		11/24/2022 03:07	RLD	EPA 8260C
Bromobenzene	<0.018	ug/L	0.018	0.10	1	U		11/24/2022 03:07	RLD	EPA 8260C
Bromochloromethane	<0.034	ug/L	0.034	0.20	1	U		11/24/2022 03:07	RLD	EPA 8260C
Bromodichloromethane	<0.019	ug/L	0.019	0.10	1	U		11/24/2022 03:07	RLD	EPA 8260C
Bromoform	<0.041	ug/L	0.041	0.20	1	U		11/24/2022 03:07	RLD	EPA 8260C
Bromomethane	<0.052	ug/L	0.052	0.20	1	U Z		11/24/2022 03:07	RLD	EPA 8260C
Carbon disulfide	<0.11	ug/L	0.11	0.40	1	U		11/24/2022 03:07	RLD	EPA 8260C
Carbon tetrachloride	<0.018	ug/L	0.018	0.10	1	U		11/24/2022 03:07	RLD	EPA 8260C
Chlorobenzene	<0.013	ug/L	0.013	0.10	1	U		11/24/2022 03:07	RLD	EPA 8260C
Chloroethane	<0.40	ug/L	0.40	1.5	1	U		11/24/2022 03:07	RLD	EPA 8260C
Chloroform	<0.016	ug/L	0.016	0.10	1	U		11/24/2022 03:07	RLD	EPA 8260C
Chloromethane	0.11	ug/L	0.045	0.20	1	J B		11/24/2022 03:07	RLD	EPA 8260C
cis-1,2-Dichloroethene	6.9	ug/L	0.023	0.10	1			11/24/2022 03:07	RLD	EPA 8260C
cis-1,3-Dichloropropene	<0.014	ug/L	0.014	0.10	1	U		11/24/2022 03:07	RLD	EPA 8260C
Dibromochloromethane	<0.016	ug/L	0.016	0.10	1	U		11/24/2022 03:07	RLD	EPA 8260C

Unless specifically stated to the contrary, soil/sediment/sludge sample results/LOD/LOQ/RLs were reported on a Dry Weight Basis

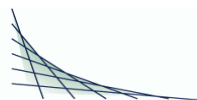

CT LAB#: 1265488 Sample Description:PW-07

DNR License/Well #: 04189/054

Sampled: 11/17/2022 12:30

Analyte	Result	Units	LOD	LOQ	Dilution	Qualifier	Prep Date/Time	Analysis Date/Time	Analyst	Method
Dibromomethane	<0.018	ug/L	0.018	0.10	1	U		11/24/2022 03:07	RLD	EPA 8260C
Dichlorodifluoromethane	<0.091	ug/L	0.091	0.30	1	U		11/24/2022 03:07	RLD	EPA 8260C
Diisopropyl ether	0.024	ug/L	0.02	0.1	1	J		11/24/2022 03:07	RLD	EPA 8260C
Ethylbenzene	<0.014	ug/L	0.014	0.10	1	U		11/24/2022 03:07	RLD	EPA 8260C
Hexachlorobutadiene	<0.027	ug/L	0.027	0.20	1	U		11/24/2022 03:07	RLD	EPA 8260C
Isopropylbenzene	<0.020	ug/L	0.020	0.10	1	U		11/24/2022 03:07	RLD	EPA 8260C
m & p-Xylene	<0.030	ug/L	0.030	0.20	1	U		11/24/2022 03:07	RLD	EPA 8260C
Methyl tert-butyl ether	0.65	ug/L	0.014	0.10	1	Q,Y		11/24/2022 03:07	RLD	EPA 8260C
Methylene chloride	<0.090	ug/L	0.090	0.40	1	U		11/24/2022 03:07	RLD	EPA 8260C
n-Butylbenzene	<0.021	ug/L	0.021	0.10	1	U		11/24/2022 03:07	RLD	EPA 8260C
n-Propylbenzene	<0.020	ug/L	0.020	0.10	1	U		11/24/2022 03:07	RLD	EPA 8260C
Naphthalene	<0.025	ug/L	0.025	0.10	1	U		11/24/2022 03:07	RLD	EPA 8260C
o-Xylene	<0.016	ug/L	0.016	0.10	1	U		11/24/2022 03:07	RLD	EPA 8260C
p-Isopropyltoluene	<0.016	ug/L	0.016	0.10	1	U		11/24/2022 03:07	RLD	EPA 8260C
sec-Butylbenzene	<0.021	ug/L	0.021	0.10	1	U		11/24/2022 03:07	RLD	EPA 8260C
Styrene	<0.014	ug/L	0.014	0.10	1	U		11/24/2022 03:07	RLD	EPA 8260C
tert-Butylbenzene	<0.020	ug/L	0.020	0.10	1	U		11/24/2022 03:07	RLD	EPA 8260C
Tetrachloroethene	<0.028	ug/L	0.028	0.20	1	U		11/24/2022 03:07	RLD	EPA 8260C
Tetrahydrofuran	<0.38	ug/L	0.38	2.0	1	U		11/24/2022 03:07	RLD	EPA 8260C
Toluene	<0.020	ug/L	0.020	0.10	1	U		11/24/2022 03:07	RLD	EPA 8260C
trans-1,2-Dichloroethene	0.28	ug/L	0.020	0.10	1			11/24/2022 03:07	RLD	EPA 8260C
trans-1,3-Dichloropropene	<0.020	ug/L	0.020	0.10	1	U		11/24/2022 03:07	RLD	EPA 8260C
Trichloroethene	0.064	ug/L	0.022	0.10	1	J		11/24/2022 03:07	RLD	EPA 8260C
Trichlorofluoromethane	<0.033	ug/L	0.033	0.20	1	U		11/24/2022 03:07	RLD	EPA 8260C
Vinyl acetate	<0.14	ug/L	0.14	1.0	1	U		11/24/2022 03:07	RLD	EPA 8260C
Vinyl chloride	0.044	ug/L	0.019	0.10	1	J		11/24/2022 03:07	RLD	EPA 8260C

Unless specifically stated to the contrary, soil/sediment/sludge sample results/LOD/LOQ/RLs were reported on a Dry Weight Basis

CT LAB#: 1265488	Sample Description:PW-07	DNR License/Well #: 04189/054	Sampled: 11/17/2022 12:30
------------------	--------------------------	-------------------------------	---------------------------

Analyte	Result	Units	LOD	LOQ	Dilution	Qualifier	Prep Date/Time	Analysis Date/Time	Analyst	Method
1,4-Dioxane	<0.40	ug/L	0.40	1.4	1	U	11/22/2022 11:00	11/28/2022 16:58	ALD	EPA 8270D-SIM

Notes: All LOD/LOQs are adjusted to reflect dilution, percent solids, and any differences in the sample weight / volume as compared to standard amounts. "U" qualifier indicates concentration of analyte was below the detection limit. "J" qualifier indicates an estimated value between the LOD and LOQ.

All samples were received intact and properly preserved unless otherwise noted. The results reported relate only to the samples tested. This report shall not be reproduced, except in full, without written approval of this laboratory. The Chain of Custody is attached.

Brett M. Szymanski
Project Manager
Submitted by: 608-356-2760

<u>Code</u>	<u>Description</u>	<u>QC Qualifiers</u>
B	Analyte detected in the associated Method Blank.	
C	Toxicity present in BOD sample.	
D	Diluted Out.	
E	Safe, No Total Coliform detected.	
F	Unsafe, Total Coliform detected, no E. Coli detected.	
G	Unsafe, Total Coliform detected and E. Coli detected.	
H	Holding time exceeded.	
I	Incubator temperature was outside acceptance limits during test period.	
J	Estimated value.	
L	Significant peaks were detected outside the chromatographic window.	
M	Matrix spike and/or Matrix Spike Duplicate recovery outside acceptance limits.	
N	Insufficient BOD oxygen depletion.	
O	Complete BOD oxygen depletion.	
P	Concentration of analyte differs more than 40% between primary and confirmation analysis.	
Q	Laboratory Control Sample outside acceptance limits.	
R	See Narrative at end of report.	
S	Surrogate standard recovery outside acceptance limits due to apparent matrix effects.	
T	Sample received with improper preservation or temperature.	
U	Analyte concentration was below detection limit.	
V	Raised Quantitation or Reporting Limit due to limited sample amount or dilution for matrix background interference.	
W	Sample amount received was below program minimum.	
X	Analyte exceeded calibration range.	
Y	Replicate/Duplicate precision outside acceptance limits.	
Z	Specified calibration criteria was not met.	

Current CT Laboratories Certifications

Wisconsin (WDNR) Chemistry ID# 157066030
 Wisconsin (DATCP) Bacteriology ID# 289
 Louisiana NELAP (primary) ID# 115843
 Illinois NELAP Lab ID# 200073
 Kansas NELAP Lab ID# E-10368
 Virginia NELAP Lab ID# 460203
 ISO/IEC 17025-2005 A2LA Cert # 3806.01
 DoD-ELAP A2LA 3806.01

Company: **Hyde Environmental**
 Project Contact: **Jim Lindeman**
 Telephone: **262-250-1226**
 Project Name: **OEC Superfund WI**
 Project #:
 Location: **Ashippun WI**
 Sampled By: **Logan Cranley**

CT LABORATORIES
 1230 Lange Court, Baraboo, WI 53913
 608-356-2760 Fax 608-356-2766
 www.ctlaboratories.com

Lab Use Only
 Place Header Sticker Here:
173815

Program:
 QSM RCRA SDWA NPDES
 Solid Waste Other superfund

PO #

Report To:
 EMAIL: **jclindenann@hyde-env.com**
 Company: **Hyde Environmental**
 Address: **W 175 N 1163 Stone wood Av
 110, Germantown WI**

Invoice To:*
 EMAIL:
 Company: **Same**
 Address:

*Party listed is responsible for payment of invoice as per CT Laboratories' terms and conditions

Client Special Instructions

ANALYSES REQUESTED											

Turnaround Time
 Normal RUSH*
 Date Needed: _____
 Rush analysis requires prior
 CT Laboratories' approval
 Surcharges:
 24 hr 200%
 2-3 days 100%
 4-9 days 50%

Matrix:
 GW - groundwater SW - surface water WW - wastewater DW - drinking water
 S - soil/sediment SL - sludge A - air M - misc/waste

Collection		Matrix	Grab/Comp	Sample #	Sample ID Description	Filtered? Y/N	ANALYSES REQUESTED												Total # Containers	Designated MS/MSD	CT Lab ID # <i>Lab use only</i>
Date	Time						Fill in Spaces with Bottles														
11-17-22	1230	DW	Grab		PW-07	N	3	2											1265488		

Relinquished By: **Logan Cranley** Date/Time: **11-17-22 1435**

Received By: **[Signature]** Date/Time: **11/18/22 952**

Received by: **[Signature]** Date/Time: **11/18/22 1035**

Received for Laboratory by: **[Signature]** Date/Time: **11/18/22 1035**

Lab Use Only
 Ice Present **Yes** No
 Temp **1.7** IR Gun **27**
 Cooler # **6384**

Notice: This form may be used to comply with the requirements of s. NR 716.14 (2), Wis. Adm. Code; however, use of this form is not required. An alternate format may be used. The rule requires that notification be provided to 1) property owners when someone else is conducting the sampling, 2) to occupants of property belonging to the responsible person, and 3) to owners and occupants of property that does not belong to the responsible person but has been affected by contamination arising on his or her property. Notification is required within 10 business days of receiving the sample results. Personal information collected will be used for program administration and may be provided to requesters to the extent required by Wisconsin's Open Records law [ss. 19.31-19.39, Wis. Stats.].

NOTE: Under s. NR 716.14, Wis. Adm. Code, the responsible party must also submit sample results and other required information to the DNR. We recommend that copies of the sample results notifications be included with that submittal, along with all attachments. Using the same format used for data presentation for a closure request may be helpful to all parties. See s. NR 716.14, Wis. Adm. Code for the full list of information to be submitted to the DNR.

Notification of Property Owners and Occupants:

This notification form has been provided to you in order to provide the results of environmental sampling that has been conducted on property that you own or occupy. Samples were collected in accordance with the methods identified in the site investigation work plan, in accordance with s. NR. 716.09 and 716.13, Wis. Adm. Code. This sampling was conducted as a result of contamination originating at the following location.

Site Information

Site Name		DNR ID # (BRRTS #)	
Oconomowoc Electroplating Company, Inc. (OECI) Superfund Site		02-14-000905	
Address	City	State	ZIP Code
W2573 Oak Street	Ashippun	WI	53003

Responsible Party

The person(s) responsible for completing this environmental investigation is:

Property Owner

Oconomowoc Electroplating Company, Inc.

Address	City	State	ZIP Code
W2573 Oak Street	Ashippun	WI	53003

Contact Person

Gwen Saliaras (WDNR PM), William Murray (US EPA Remedial PM)

Person or company that collected samples

Hyde Environmental, Inc.

Sample Results (Results Attached)

Reason for Sampling: Routine Other (define) _____

The contaminants that have been identified at this time on property that you own or occupy include:

Contaminant	In Soil?		In Groundwater?	
	Yes	No	Yes	No
Gasoline	<input type="radio"/>	<input checked="" type="radio"/>	<input type="radio"/>	<input checked="" type="radio"/>
Diesel or Fuel Oil	<input type="radio"/>	<input checked="" type="radio"/>	<input type="radio"/>	<input checked="" type="radio"/>
Solvents	<input type="radio"/>	<input checked="" type="radio"/>	<input checked="" type="radio"/>	<input type="radio"/>
Heavy Metals	<input type="radio"/>	<input checked="" type="radio"/>	<input type="radio"/>	<input checked="" type="radio"/>
Pesticides	<input type="radio"/>	<input checked="" type="radio"/>	<input type="radio"/>	<input checked="" type="radio"/>
Other: _____	<input type="radio"/>	<input checked="" type="radio"/>	<input type="radio"/>	<input checked="" type="radio"/>

This sampling event included sampling of a drinking water well. <input checked="" type="radio"/> Yes <input type="radio"/> No
If yes, the sampled drinking water well had detectable contaminants. <input checked="" type="radio"/> Yes <input type="radio"/> No

Contaminants in Vapor

	Yes	No
	Indoor Air	<input type="radio"/>
Sub-slab	<input type="radio"/>	<input checked="" type="radio"/>
Exterior Soil Gas	<input type="radio"/>	<input checked="" type="radio"/>

Site Investigation Sample Results Notification

Form 4400-249 (R 03/14)

Page 2 of 2

Attached are:

- A map that shows the locations from which samples were collected. (The map needs to meet the requirements of s. NR 716.15 (4), Wis. Adm. Code.)
- A data table with specific contaminant levels at each sample location and whether or not the sample results exceed state standards.
- A copy of the laboratory results.

You are not identified as the person that is responsible for this contamination. However, your cooperation is important. Property owners may become legally responsible for contamination if they do not allow access to the person that is responsible so that person may complete the environmental investigation and clean up activities.

Option for written exemption: You have the option of requesting a written liability exemption from the DNR for contamination that originated on another property, or on property that you lease. To do this, you must present an adequate environmental assessment of your property and pay a \$700 fee for review of this information. If you are interested in this option, please see DNR publication # RR 589, "When Contamination Crosses a Property Line - Rights and Responsibilities of Property Owners", available at: dnr.wi.gov/files/PDF/pubs/rr/rr589.pdf.

Contact Information

Please address questions regarding this notification, or requests for additional information to the contact person listed above, or to one of the following contacts:

Environmental Consultant

Company Name	Contact Person Last Name	First Name		
Hyde Environmental, Inc.	Lindemann	James		
Address	City	State	ZIP Code	
W175 N11163 Stonewood Drive, Suite 110	Germantown	WI	53022	
Phone # (inc. area code)	Email			
(262) 250-1226	jclindemann@hyde-env.com			

Select which agency: Natural Resources Agriculture, Trade and Consumer Protection

State of Wisconsin Department of Natural Resources

Contact Person Last Name	First Name	Phone # (inc. area code)		
Saliars	Gwen	(920) 510-4343		
Address	City	State	ZIP Code	
625 E County Road Y, Suite 700	Oshkosh	WI	54901	
Email				
gwen.saliars@wisconsin.gov				

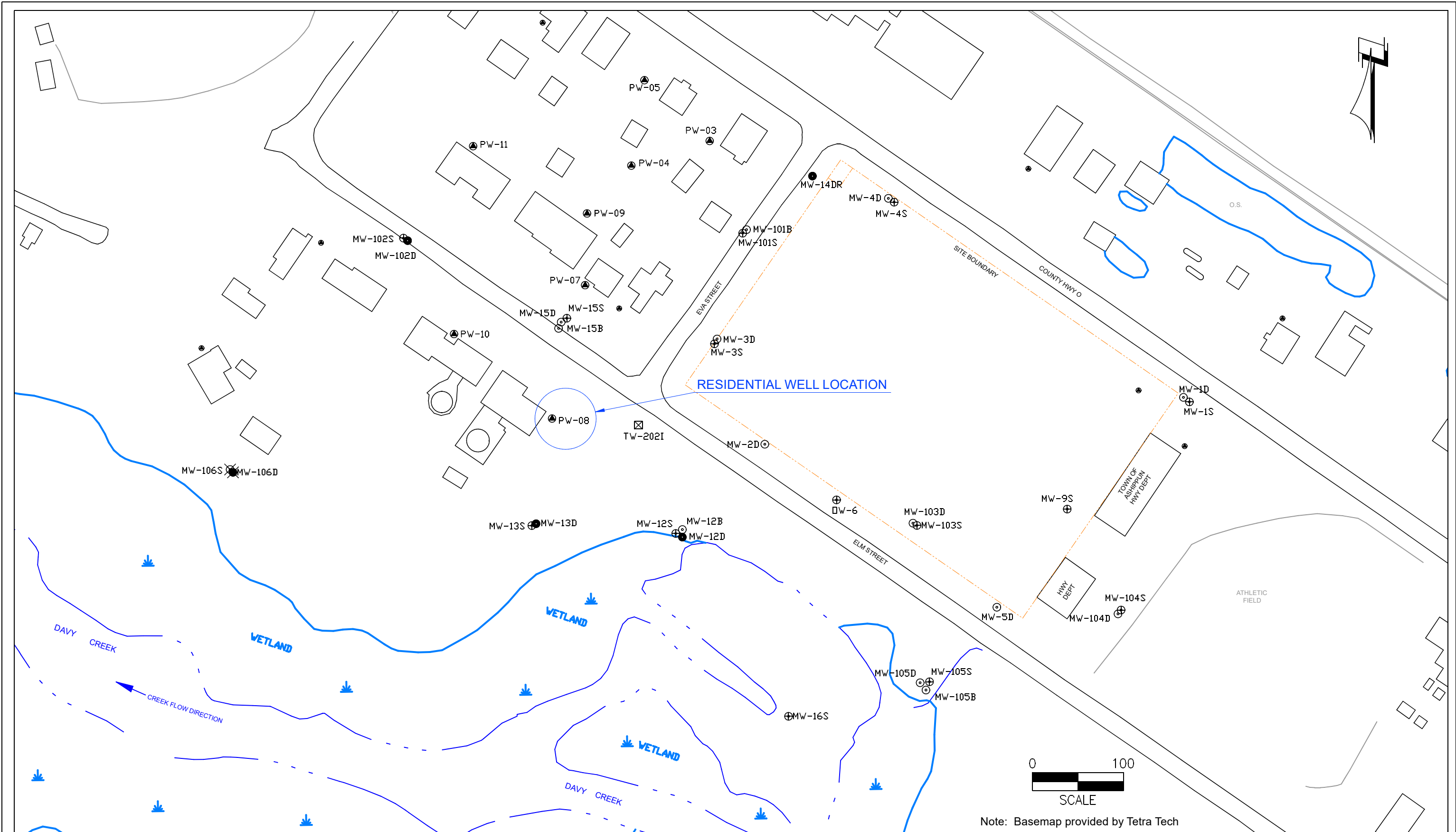

RESIDENTIAL WELL LOCATION

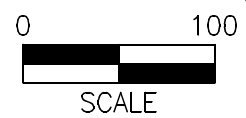

Note: Basemap provided by Tetra Tech

⊕ MW-105B	BEDROCK MONITORING WELL	● PW-11	RESIDENTIAL WELL
● MW-105D	DEEP UNCONSOLIDATED MONITORING WELL	⊗ MW-106D	DEEP UNCONSOLIDATED SENTINEL WELL
⊕ MW-105S	SHALLOW UNCONSOLIDATED MONITORING WELL	⊗ MW-106S	SHALLOW UNCONSOLIDATED SENTINEL WELL
---	FORMER OECI SITE BOUNDARY		



Figure 1
SITE MAP
Oconomowoc Electroplating Company, Inc.
Ashippun, WI

GROUNDWATER ANALYTICAL RESULTS SUMMARY

W2603 Elm Street, Ashippun, WI

Sampled November 17, 2022

Parameters (ug/L)	<i>NR 140 Groundwater Quality Health Standards</i>		PW-08
	<i>ES</i>	<i>PAL</i>	
VOCs			
Chloroform	6	0.6	0.038
2-Chlorotoluene	--	--	0.023
Chloromethane	30	3	0.13
cis-1,2-Dichloroethene	70	7	2.6
trans-1,2-Dichloroethene	100	20	0.12
Diisopropyl ether	--	--	0.059
Methyl tert-butyl ether (MTBE)	60	12	0.71
Toluene	800	160	5.80
Trichloroethene	5	0.5	0.052
Vinyl chloride	0.2	0.02	0.039
1,4-Dioxane	3	0.3	<0.40

Notes:

PAL = Preventive Action Limit

ES = Enforcement Standard

Italicized values attain or exceed the NR 140 PAL

-- = No standard

ug/L = micrograms per liter

< = less than the laboratory method detection limit (MDL)

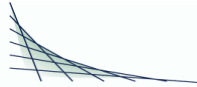

ANALYTICAL REPORT

HYDE ENVIRONMENTAL, INC.
 JIM LINDEMANN
 W175 N11163 STONEWOOD DRIVE
 SUITE 110
 GERMANTOWN, WI 53022-6501

Project Name: OEC SUPERFUND WI
 Project Phase: ASHIPPUN, WI
 Project #:
 Folder #: 173815
 Purchase Order #:
 Contract #: 3451

Page 1 of 5
 Arrival Temperature: 1.7
 Report Date: 12/13/2022
 Date Received: 11/18/2022
 Reprint Date: 12/13/2022

CT LAB#: 1265489	Sample Description: PW-08	DNR License/Well #: 04189/055	Sampled: 11/17/2022 13:00
------------------	---------------------------	-------------------------------	---------------------------

Analyte	Result	Units	LOD	LOQ	Dilution	Qualifier	Prep Date/Time	Analysis Date/Time	Analyst	Method
Organic Results										
1,1,1,2-Tetrachloroethane	<0.013	ug/L	0.013	0.10	1	U	11/24/2022 03:36	11/24/2022 03:36	RLD	EPA 8260C
1,1,1-Trichloroethane	<0.013	ug/L	0.013	0.10	1	U	11/24/2022 03:36	11/24/2022 03:36	RLD	EPA 8260C
1,1,2,2-Tetrachloroethane	<0.015	ug/L	0.015	0.10	1	U	11/24/2022 03:36	11/24/2022 03:36	RLD	EPA 8260C
1,1,2-Trichloroethane	<0.036	ug/L	0.036	0.20	1	U	11/24/2022 03:36	11/24/2022 03:36	RLD	EPA 8260C
1,1-Dichloroethane	<0.017	ug/L	0.017	0.10	1	U	11/24/2022 03:36	11/24/2022 03:36	RLD	EPA 8260C
1,1-Dichloroethene	<0.024	ug/L	0.024	0.10	1	U	11/24/2022 03:36	11/24/2022 03:36	RLD	EPA 8260C
1,1-Dichloropropene	<0.074	ug/L	0.074	0.20	1	U	11/24/2022 03:36	11/24/2022 03:36	RLD	EPA 8260C
1,2,3-Trichlorobenzene	<0.019	ug/L	0.019	0.10	1	U	11/24/2022 03:36	11/24/2022 03:36	RLD	EPA 8260C
1,2,3-Trichloropropane	<0.031	ug/L	0.031	0.20	1	U	11/24/2022 03:36	11/24/2022 03:36	RLD	EPA 8260C
1,2,4-Trichlorobenzene	<0.022	ug/L	0.022	0.10	1	U	11/24/2022 03:36	11/24/2022 03:36	RLD	EPA 8260C
1,2,4-Trimethylbenzene	<0.011	ug/L	0.011	0.10	1	U	11/24/2022 03:36	11/24/2022 03:36	RLD	EPA 8260C
1,2-Dibromo-3-chloropropane	<0.12	ug/L	0.12	0.40	1	U	11/24/2022 03:36	11/24/2022 03:36	RLD	EPA 8260C
1,2-Dibromoethane	<0.029	ug/L	0.029	0.20	1	U	11/24/2022 03:36	11/24/2022 03:36	RLD	EPA 8260C
1,2-Dichlorobenzene	<0.016	ug/L	0.016	0.10	1	U	11/24/2022 03:36	11/24/2022 03:36	RLD	EPA 8260C
1,2-Dichloroethane	<0.017	ug/L	0.017	0.10	1	U	11/24/2022 03:36	11/24/2022 03:36	RLD	EPA 8260C
1,2-Dichloropropane	<0.013	ug/L	0.013	0.10	1	U	11/24/2022 03:36	11/24/2022 03:36	RLD	EPA 8260C

Unless specifically stated to the contrary, soil/sediment/sludge sample results/LOD/LOQ/RLs were reported on a Dry Weight Basis

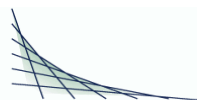

CT LAB#: 1265489 Sample Description:PW-08

DNR License/Well #: 04189/055

Sampled: 11/17/2022 13:00

Analyte	Result	Units	LOD	LOQ	Dilution	Qualifier	Prep Date/Time	Analysis Date/Time	Analyst	Method
1,3,5-Trimethylbenzene	<0.013	ug/L	0.013	0.10	1	U		11/24/2022 03:36	RLD	EPA 8260C
1,3-Dichlorobenzene	<0.013	ug/L	0.013	0.10	1	U		11/24/2022 03:36	RLD	EPA 8260C
1,3-Dichloropropane	<0.020	ug/L	0.020	0.10	1	U		11/24/2022 03:36	RLD	EPA 8260C
1,4-Dichlorobenzene	<0.017	ug/L	0.017	0.10	1	U		11/24/2022 03:36	RLD	EPA 8260C
2,2-Dichloropropane	<0.075	ug/L	0.075	0.30	1	U		11/24/2022 03:36	RLD	EPA 8260C
2-Butanone	<0.31	ug/L	0.31	2.0	1	U		11/24/2022 03:36	RLD	EPA 8260C
2-Chlorotoluene	0.023	ug/L	0.020	0.10	1	J		11/24/2022 03:36	RLD	EPA 8260C
2-Hexanone	<0.15	ug/L	0.15	1.0	1	U		11/24/2022 03:36	RLD	EPA 8260C
4-Chlorotoluene	<0.013	ug/L	0.013	0.10	1	U		11/24/2022 03:36	RLD	EPA 8260C
4-Methyl-2-pentanone	<0.19	ug/L	0.19	1.0	1	U		11/24/2022 03:36	RLD	EPA 8260C
Acetone	<0.84	ug/L	0.84	4.0	1	U		11/24/2022 03:36	RLD	EPA 8260C
Benzene	<0.022	ug/L	0.022	0.10	1	U		11/24/2022 03:36	RLD	EPA 8260C
Bromobenzene	<0.018	ug/L	0.018	0.10	1	U		11/24/2022 03:36	RLD	EPA 8260C
Bromochloromethane	<0.034	ug/L	0.034	0.20	1	U		11/24/2022 03:36	RLD	EPA 8260C
Bromodichloromethane	<0.019	ug/L	0.019	0.10	1	U		11/24/2022 03:36	RLD	EPA 8260C
Bromoform	<0.041	ug/L	0.041	0.20	1	U		11/24/2022 03:36	RLD	EPA 8260C
Bromomethane	<0.052	ug/L	0.052	0.20	1	U Z		11/24/2022 03:36	RLD	EPA 8260C
Carbon disulfide	<0.11	ug/L	0.11	0.40	1	U		11/24/2022 03:36	RLD	EPA 8260C
Carbon tetrachloride	<0.018	ug/L	0.018	0.10	1	U		11/24/2022 03:36	RLD	EPA 8260C
Chlorobenzene	<0.013	ug/L	0.013	0.10	1	U		11/24/2022 03:36	RLD	EPA 8260C
Chloroethane	<0.40	ug/L	0.40	1.5	1	U		11/24/2022 03:36	RLD	EPA 8260C
Chloroform	0.038	ug/L	0.016	0.10	1	J		11/24/2022 03:36	RLD	EPA 8260C
Chloromethane	0.13	ug/L	0.045	0.20	1	J B		11/24/2022 03:36	RLD	EPA 8260C
cis-1,2-Dichloroethene	2.6	ug/L	0.023	0.10	1			11/24/2022 03:36	RLD	EPA 8260C
cis-1,3-Dichloropropene	<0.014	ug/L	0.014	0.10	1	U		11/24/2022 03:36	RLD	EPA 8260C
Dibromochloromethane	<0.016	ug/L	0.016	0.10	1	U		11/24/2022 03:36	RLD	EPA 8260C

Unless specifically stated to the contrary, soil/sediment/sludge sample results/LOD/LOQ/RLs were reported on a Dry Weight Basis

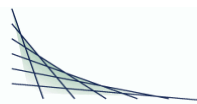

CT LAB#: 1265489 Sample Description:PW-08

DNR License/Well #: 04189/055

Sampled: 11/17/2022 13:00

Analyte	Result	Units	LOD	LOQ	Dilution	Qualifier	Prep Date/Time	Analysis Date/Time	Analyst	Method
Dibromomethane	<0.018	ug/L	0.018	0.10	1	U		11/24/2022 03:36	RLD	EPA 8260C
Dichlorodifluoromethane	<0.091	ug/L	0.091	0.30	1	U		11/24/2022 03:36	RLD	EPA 8260C
Diisopropyl ether	0.059	ug/L	0.02	0.1	1	J		11/24/2022 03:36	RLD	EPA 8260C
Ethylbenzene	<0.014	ug/L	0.014	0.10	1	U		11/24/2022 03:36	RLD	EPA 8260C
Hexachlorobutadiene	<0.027	ug/L	0.027	0.20	1	U		11/24/2022 03:36	RLD	EPA 8260C
Isopropylbenzene	<0.020	ug/L	0.020	0.10	1	U		11/24/2022 03:36	RLD	EPA 8260C
m & p-Xylene	<0.030	ug/L	0.030	0.20	1	U		11/24/2022 03:36	RLD	EPA 8260C
Methyl tert-butyl ether	0.71	ug/L	0.014	0.10	1	Q,Y		11/24/2022 03:36	RLD	EPA 8260C
Methylene chloride	<0.090	ug/L	0.090	0.40	1	U		11/24/2022 03:36	RLD	EPA 8260C
n-Butylbenzene	<0.021	ug/L	0.021	0.10	1	U		11/24/2022 03:36	RLD	EPA 8260C
n-Propylbenzene	<0.020	ug/L	0.020	0.10	1	U		11/24/2022 03:36	RLD	EPA 8260C
Naphthalene	<0.025	ug/L	0.025	0.10	1	U		11/24/2022 03:36	RLD	EPA 8260C
o-Xylene	<0.016	ug/L	0.016	0.10	1	U		11/24/2022 03:36	RLD	EPA 8260C
p-Isopropyltoluene	<0.016	ug/L	0.016	0.10	1	U		11/24/2022 03:36	RLD	EPA 8260C
sec-Butylbenzene	<0.021	ug/L	0.021	0.10	1	U		11/24/2022 03:36	RLD	EPA 8260C
Styrene	<0.014	ug/L	0.014	0.10	1	U		11/24/2022 03:36	RLD	EPA 8260C
tert-Butylbenzene	<0.020	ug/L	0.020	0.10	1	U		11/24/2022 03:36	RLD	EPA 8260C
Tetrachloroethene	<0.028	ug/L	0.028	0.20	1	U		11/24/2022 03:36	RLD	EPA 8260C
Tetrahydrofuran	<0.38	ug/L	0.38	2.0	1	U		11/24/2022 03:36	RLD	EPA 8260C
Toluene	5.8	ug/L	0.020	0.10	1			11/24/2022 03:36	RLD	EPA 8260C
trans-1,2-Dichloroethene	0.12	ug/L	0.020	0.10	1			11/24/2022 03:36	RLD	EPA 8260C
trans-1,3-Dichloropropene	<0.020	ug/L	0.020	0.10	1	U		11/24/2022 03:36	RLD	EPA 8260C
Trichloroethene	0.052	ug/L	0.022	0.10	1	J		11/24/2022 03:36	RLD	EPA 8260C
Trichlorofluoromethane	<0.033	ug/L	0.033	0.20	1	U		11/24/2022 03:36	RLD	EPA 8260C
Vinyl acetate	<0.14	ug/L	0.14	1.0	1	U		11/24/2022 03:36	RLD	EPA 8260C
Vinyl chloride	0.039	ug/L	0.019	0.10	1	J		11/24/2022 03:36	RLD	EPA 8260C

Unless specifically stated to the contrary, soil/sediment/sludge sample results/LOD/LOQ/RLs were reported on a Dry Weight Basis

CT LAB#: 1265489	Sample Description:PW-08	DNR License/Well #: 04189/055	Sampled: 11/17/2022 13:00
------------------	--------------------------	-------------------------------	---------------------------

Analyte	Result	Units	LOD	LOQ	Dilution	Qualifier	Prep Date/Time	Analysis Date/Time	Analyst	Method
1,4-Dioxane	<0.40	ug/L	0.40	1.4	1	U	11/22/2022 11:00	11/28/2022 17:19	ALD	EPA 8270D-SIM

Notes: All LOD/LOQs are adjusted to reflect dilution, percent solids, and any differences in the sample weight / volume as compared to standard amounts. "U" qualifier indicates concentration of analyte was below the detection limit. "J" qualifier indicates an estimated value between the LOD and LOQ.

All samples were received intact and properly preserved unless otherwise noted. The results reported relate only to the samples tested. This report shall not be reproduced, except in full, without written approval of this laboratory. The Chain of Custody is attached.

Brett M. Szymanski
Project Manager
Submitted by: 608-356-2760

<u>Code</u>	<u>Description</u>	<u>QC Qualifiers</u>
B	Analyte detected in the associated Method Blank.	
C	Toxicity present in BOD sample.	
D	Diluted Out.	
E	Safe, No Total Coliform detected.	
F	Unsafe, Total Coliform detected, no E. Coli detected.	
G	Unsafe, Total Coliform detected and E. Coli detected.	
H	Holding time exceeded.	
I	Incubator temperature was outside acceptance limits during test period.	
J	Estimated value.	
L	Significant peaks were detected outside the chromatographic window.	
M	Matrix spike and/or Matrix Spike Duplicate recovery outside acceptance limits.	
N	Insufficient BOD oxygen depletion.	
O	Complete BOD oxygen depletion.	
P	Concentration of analyte differs more than 40% between primary and confirmation analysis.	
Q	Laboratory Control Sample outside acceptance limits.	
R	See Narrative at end of report.	
S	Surrogate standard recovery outside acceptance limits due to apparent matrix effects.	
T	Sample received with improper preservation or temperature.	
U	Analyte concentration was below detection limit.	
V	Raised Quantitation or Reporting Limit due to limited sample amount or dilution for matrix background interference.	
W	Sample amount received was below program minimum.	
X	Analyte exceeded calibration range.	
Y	Replicate/Duplicate precision outside acceptance limits.	
Z	Specified calibration criteria was not met.	

Current CT Laboratories Certifications

Wisconsin (WDNR) Chemistry ID# 157066030
 Wisconsin (DATCP) Bacteriology ID# 289
 Louisiana NELAP (primary) ID# 115843
 Illinois NELAP Lab ID# 200073
 Kansas NELAP Lab ID# E-10368
 Virginia NELAP Lab ID# 460203
 ISO/IEC 17025-2005 A2LA Cert # 3806.01
 DoD-ELAP A2LA 3806.01

Company: ~~Hyde~~ Hyde Environmental

Project Contact: Jim Hindemann

Telephone: 262-250-1226

Project Name: OEC Superfund WI

Project #:

Location: Ashippun WI

Sampled By: Logan Cranley

CT LABORATORIES

1230 Lange Court, Baraboo, WI 53913
608-356-2760 Fax 608-356-2766
www.ctlaboratories.com

Report To:
EMAIL: jclindemann@hyde-environ.com
Company: Hyde Environmental
Address: W175 N1163 Stone Wood Dr
110, Germantown WI

Invoice To:*
EMAIL:
Company: Same
Address:

Lab Use Only
Place Header Sticker Here:

173815

Program:
QSM RCRA SDWA NPDES
Solid Waste Other: superfund
PO #

*Party listed is responsible for payment of invoice as per CT Laboratories' terms and conditions

Client Special Instructions

ANALYSES REQUESTED

Turnaround Time
Normal RUSH*
Date Needed: _____
Rush analysis requires prior
CT Laboratories' approval
Surcharges:
24 hr 200%
2-3 days 100%
4-9 days 50%

Matrix:
GW - groundwater SW - surface water WW - wastewater DW - drinking water
S - soil/sediment SL - sludge A - air M - misc/waste

Filtered? Y/N

UDCs low level (B260C)
1/4 Dioxane
(0270D-SIM)

Total # Containers

Designated MS/MSD

Collection		Matrix	Grab/Comp	Sample #	Sample ID Description
Date	Time				
11-17-22	1300	DW	Grab		PW-08

Fill in Spaces with Bottles

CT Lab ID #
Lab use only

1265789

Relinquished By: Logan Cranley

Date/Time: 11-17-22 1440

Received By: [Signature]

Date/Time: 11/18/22 9:22

Lab Use Only

Ice Present No
Temp 1.7 IR Gun
Cooler # 6384

Received by:

Date/Time

Received for Laboratory by:
173815 - Page 41 of 42

Date/Time: 11/18/22 1:55

Notice: This form may be used to comply with the requirements of s. NR 716.14 (2), Wis. Adm. Code; however, use of this form is not required. An alternate format may be used. The rule requires that notification be provided to 1) property owners when someone else is conducting the sampling, 2) to occupants of property belonging to the responsible person, and 3) to owners and occupants of property that does not belong to the responsible person but has been affected by contamination arising on his or her property. Notification is required within 10 business days of receiving the sample results. Personal information collected will be used for program administration and may be provided to requesters to the extent required by Wisconsin's Open Records law [ss. 19.31-19.39, Wis. Stats.].

NOTE: Under s. NR 716.14, Wis. Adm. Code, the responsible party must also submit sample results and other required information to the DNR. We recommend that copies of the sample results notifications be included with that submittal, along with all attachments. Using the same format used for data presentation for a closure request may be helpful to all parties. See s. NR 716.14, Wis. Adm. Code for the full list of information to be submitted to the DNR.

Notification of Property Owners and Occupants:

This notification form has been provided to you in order to provide the results of environmental sampling that has been conducted on property that you own or occupy. Samples were collected in accordance with the methods identified in the site investigation work plan, in accordance with s. NR. 716.09 and 716.13, Wis. Adm. Code. This sampling was conducted as a result of contamination originating at the following location.

Site Information			
Site Name		DNR ID # (BRRTS #)	
Oconomowoc Electroplating Company, Inc. (OECI) Superfund Site		02-14-000905	
Address	City	State	ZIP Code
W2573 Oak Street	Ashippun	WI	53003

Responsible Party
 The person(s) responsible for completing this environmental investigation is:

Property Owner

Oconomowoc Electroplating Company, Inc.

Address	City	State	ZIP Code
W2573 Oak Street	Ashippun	WI	53003
Contact Person	Phone Number (include area code)		
Gwen Saliaraes (WDNR PM), William Murray (US EPA Remedial PM)	(920) 510-4343		

Person or company that collected samples

Hyde Environmental, Inc.
 Sample Results (Results Attached)

Reason for Sampling: Routine Other (define) _____

The contaminants that have been identified at this time on property that you own or occupy include:

Contaminant	In Soil?		In Groundwater?	
	Yes	No	Yes	No
Gasoline	<input type="radio"/>	<input checked="" type="radio"/>	<input type="radio"/>	<input checked="" type="radio"/>
Diesel or Fuel Oil	<input type="radio"/>	<input checked="" type="radio"/>	<input type="radio"/>	<input checked="" type="radio"/>
Solvents	<input type="radio"/>	<input checked="" type="radio"/>	<input checked="" type="radio"/>	<input type="radio"/>
Heavy Metals	<input type="radio"/>	<input checked="" type="radio"/>	<input type="radio"/>	<input checked="" type="radio"/>
Pesticides	<input type="radio"/>	<input checked="" type="radio"/>	<input type="radio"/>	<input checked="" type="radio"/>
Other: _____	<input type="radio"/>	<input checked="" type="radio"/>	<input type="radio"/>	<input checked="" type="radio"/>

Contaminants in Vapor	Yes	No
	Indoor Air	<input type="radio"/>
Sub-slab	<input type="radio"/>	<input checked="" type="radio"/>
Exterior Soil Gas	<input type="radio"/>	<input checked="" type="radio"/>

This sampling event included sampling of a drinking water well. <input checked="" type="radio"/> Yes <input type="radio"/> No
If yes, the sampled drinking water well had detectable contaminants. <input checked="" type="radio"/> Yes <input type="radio"/> No

Site Investigation Sample Results Notification

Form 4400-249 (R 03/14)

Page 2 of 2

Attached are:

- A map that shows the locations from which samples were collected. (The map needs to meet the requirements of s. NR 716.15 (4), Wis. Adm. Code.)
- A data table with specific contaminant levels at each sample location and whether or not the sample results exceed state standards.
- A copy of the laboratory results.

You are not identified as the person that is responsible for this contamination. However, your cooperation is important. Property owners may become legally responsible for contamination if they do not allow access to the person that is responsible so that person may complete the environmental investigation and clean up activities.

Option for written exemption: You have the option of requesting a written liability exemption from the DNR for contamination that originated on another property, or on property that you lease. To do this, you must present an adequate environmental assessment of your property and pay a \$700 fee for review of this information. If you are interested in this option, please see DNR publication # RR 589, "When Contamination Crosses a Property Line - Rights and Responsibilities of Property Owners", available at: dnr.wi.gov/files/PDF/pubs/rr/rr589.pdf.

Contact Information

Please address questions regarding this notification, or requests for additional information to the contact person listed above, or to one of the following contacts:

Environmental Consultant

Company Name	Contact Person Last Name	First Name		
Hyde Environmental, Inc.	Lindemann	James		
Address	City	State	ZIP Code	
W175 N11163 Stonewood Drive, Suite 110	Germantown	WI	53022	
Phone # (inc. area code)	Email			
(262) 250-1226	jclindemann@hyde-env.com			

Select which agency: Natural Resources Agriculture, Trade and Consumer Protection

State of Wisconsin Department of Natural Resources

Contact Person Last Name	First Name	Phone # (inc. area code)		
Saliars	Gwen	(920) 510-4343		
Address	City	State	ZIP Code	
625 E County Road Y, Suite 700	Oshkosh	WI	54901	
Email				
gwen.saliars@wisconsin.gov				

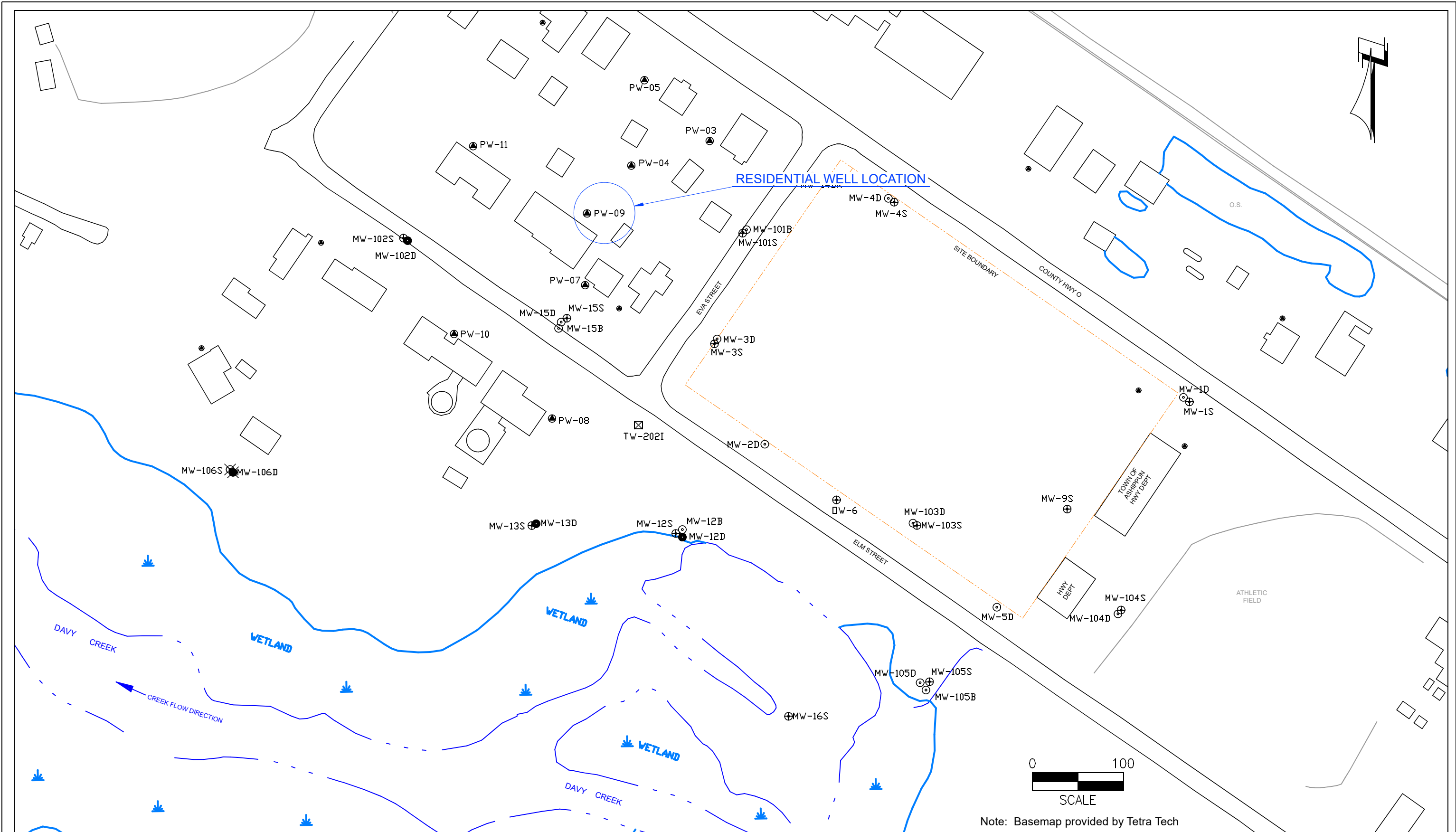

RESIDENTIAL WELL LOCATION

⊕ MW-105B	BEDROCK MONITORING WELL	● PW-11	RESIDENTIAL WELL
● MW-105D	DEEP UNCONSOLIDATED MONITORING WELL	⊗ MW-106D	DEEP UNCONSOLIDATED SENTINEL WELL
⊕ MW-105S	SHALLOW UNCONSOLIDATED MONITORING WELL	⊗ MW-106S	SHALLOW UNCONSOLIDATED SENTINEL WELL
---	FORMER OECl SITE BOUNDARY		



Figure 1
SITE MAP
 Oconomowoc Electroplating Company, Inc.
 Ashippun, WI

GROUNDWATER ANALYTICAL RESULTS SUMMARY

W2606 Elm Street, Ashippun, WI

Sampled November 17, 2022

Parameters (ug/L)	<i>NR 140 Groundwater Quality Health Standards</i>		PW-09
	<i>ES</i>	<i>PAL</i>	
VOCs			
1,2-Dichloroethane	5	0.5	<0.017
Chloromethane	30	3	0.11
cis-1,2-Dichloroethene	70	7	<i>7.4</i>
trans-1,2-Dichloroethene	100	20	0.29
Diisopropyl ether	--	--	0.023
Methyl tert-butyl ether (MTBE)	60	12	0.60
Trichloroethene	5	0.5	0.086
Vinyl chloride	0.2	0.02	<i>0.046</i>
1,4-Dioxane	3	0.3	<0.40

Notes:

PAL = Preventive Action Limit

ES = Enforcement Standard

Italicized values attain or exceed the NR 140 PAL

-- = No standard

ug/L = micrograms per liter

< = less than the laboratory method detection limit (MDL)

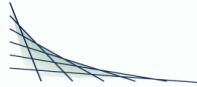

ANALYTICAL REPORT

HYDE ENVIRONMENTAL, INC.
 JIM LINDEMANN
 W175 N11163 STONEWOOD DRIVE
 SUITE 110
 GERMANTOWN, WI 53022-6501

Project Name: OEC SUPERFUND WI
 Project Phase: ASHIPPUN, WI
 Project #:
 Folder #: 173815
 Purchase Order #:
 Contract #: 3451

Page 1 of 5
 Arrival Temperature: 1.7
 Report Date: 12/13/2022
 Date Received: 11/18/2022
 Reprint Date: 12/13/2022

CT LAB#: 1265484	Sample Description: PW-09	DNR License/Well #: 04189/056	Sampled: 11/17/2022 12:15
------------------	---------------------------	-------------------------------	---------------------------

Analyte	Result	Units	LOD	LOQ	Dilution	Qualifier	Prep Date/Time	Analysis Date/Time	Analyst	Method
Organic Results										
1,1,1,2-Tetrachloroethane	<0.013	ug/L	0.013	0.10	1	U	11/24/2022 02:39	11/24/2022 02:39	RLD	EPA 8260C
1,1,1-Trichloroethane	<0.013	ug/L	0.013	0.10	1	U	11/24/2022 02:39	11/24/2022 02:39	RLD	EPA 8260C
1,1,2,2-Tetrachloroethane	<0.015	ug/L	0.015	0.10	1	U	11/24/2022 02:39	11/24/2022 02:39	RLD	EPA 8260C
1,1,2-Trichloroethane	<0.036	ug/L	0.036	0.20	1	U	11/24/2022 02:39	11/24/2022 02:39	RLD	EPA 8260C
1,1-Dichloroethane	<0.017	ug/L	0.017	0.10	1	U	11/24/2022 02:39	11/24/2022 02:39	RLD	EPA 8260C
1,1-Dichloroethene	<0.024	ug/L	0.024	0.10	1	U	11/24/2022 02:39	11/24/2022 02:39	RLD	EPA 8260C
1,1-Dichloropropene	<0.074	ug/L	0.074	0.20	1	U	11/24/2022 02:39	11/24/2022 02:39	RLD	EPA 8260C
1,2,3-Trichlorobenzene	<0.019	ug/L	0.019	0.10	1	U	11/24/2022 02:39	11/24/2022 02:39	RLD	EPA 8260C
1,2,3-Trichloropropane	<0.031	ug/L	0.031	0.20	1	U	11/24/2022 02:39	11/24/2022 02:39	RLD	EPA 8260C
1,2,4-Trichlorobenzene	<0.022	ug/L	0.022	0.10	1	U	11/24/2022 02:39	11/24/2022 02:39	RLD	EPA 8260C
1,2,4-Trimethylbenzene	<0.011	ug/L	0.011	0.10	1	U	11/24/2022 02:39	11/24/2022 02:39	RLD	EPA 8260C
1,2-Dibromo-3-chloropropane	<0.12	ug/L	0.12	0.40	1	U	11/24/2022 02:39	11/24/2022 02:39	RLD	EPA 8260C
1,2-Dibromoethane	<0.029	ug/L	0.029	0.20	1	U	11/24/2022 02:39	11/24/2022 02:39	RLD	EPA 8260C
1,2-Dichlorobenzene	<0.016	ug/L	0.016	0.10	1	U	11/24/2022 02:39	11/24/2022 02:39	RLD	EPA 8260C
1,2-Dichloroethane	<0.017	ug/L	0.017	0.10	1	U	11/24/2022 02:39	11/24/2022 02:39	RLD	EPA 8260C
1,2-Dichloropropane	<0.013	ug/L	0.013	0.10	1	U	11/24/2022 02:39	11/24/2022 02:39	RLD	EPA 8260C

Unless specifically stated to the contrary, soil/sediment/sludge sample results/LOD/LOQ/RLs were reported on a Dry Weight Basis

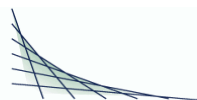

CT LAB#: 1265484 Sample Description:PW-09

DNR License/Well #: 04189/056

Sampled: 11/17/2022 12:15

Analyte	Result	Units	LOD	LOQ	Dilution	Qualifier	Prep Date/Time	Analysis Date/Time	Analyst	Method
1,3,5-Trimethylbenzene	<0.013	ug/L	0.013	0.10	1	U		11/24/2022 02:39	RLD	EPA 8260C
1,3-Dichlorobenzene	<0.013	ug/L	0.013	0.10	1	U		11/24/2022 02:39	RLD	EPA 8260C
1,3-Dichloropropane	<0.020	ug/L	0.020	0.10	1	U		11/24/2022 02:39	RLD	EPA 8260C
1,4-Dichlorobenzene	<0.017	ug/L	0.017	0.10	1	U		11/24/2022 02:39	RLD	EPA 8260C
2,2-Dichloropropane	<0.075	ug/L	0.075	0.30	1	U		11/24/2022 02:39	RLD	EPA 8260C
2-Butanone	<0.31	ug/L	0.31	2.0	1	U		11/24/2022 02:39	RLD	EPA 8260C
2-Chlorotoluene	<0.020	ug/L	0.020	0.10	1	U		11/24/2022 02:39	RLD	EPA 8260C
2-Hexanone	<0.15	ug/L	0.15	1.0	1	U		11/24/2022 02:39	RLD	EPA 8260C
4-Chlorotoluene	<0.013	ug/L	0.013	0.10	1	U		11/24/2022 02:39	RLD	EPA 8260C
4-Methyl-2-pentanone	<0.19	ug/L	0.19	1.0	1	U		11/24/2022 02:39	RLD	EPA 8260C
Acetone	<0.84	ug/L	0.84	4.0	1	U		11/24/2022 02:39	RLD	EPA 8260C
Benzene	<0.022	ug/L	0.022	0.10	1	U		11/24/2022 02:39	RLD	EPA 8260C
Bromobenzene	<0.018	ug/L	0.018	0.10	1	U		11/24/2022 02:39	RLD	EPA 8260C
Bromochloromethane	<0.034	ug/L	0.034	0.20	1	U		11/24/2022 02:39	RLD	EPA 8260C
Bromodichloromethane	<0.019	ug/L	0.019	0.10	1	U		11/24/2022 02:39	RLD	EPA 8260C
Bromoform	<0.041	ug/L	0.041	0.20	1	U		11/24/2022 02:39	RLD	EPA 8260C
Bromomethane	<0.052	ug/L	0.052	0.20	1	U Z		11/24/2022 02:39	RLD	EPA 8260C
Carbon disulfide	<0.11	ug/L	0.11	0.40	1	U		11/24/2022 02:39	RLD	EPA 8260C
Carbon tetrachloride	<0.018	ug/L	0.018	0.10	1	U		11/24/2022 02:39	RLD	EPA 8260C
Chlorobenzene	<0.013	ug/L	0.013	0.10	1	U		11/24/2022 02:39	RLD	EPA 8260C
Chloroethane	<0.40	ug/L	0.40	1.5	1	U		11/24/2022 02:39	RLD	EPA 8260C
Chloroform	<0.016	ug/L	0.016	0.10	1	U		11/24/2022 02:39	RLD	EPA 8260C
Chloromethane	0.11	ug/L	0.045	0.20	1	J B		11/24/2022 02:39	RLD	EPA 8260C
cis-1,2-Dichloroethene	7.4	ug/L	0.023	0.10	1			11/24/2022 02:39	RLD	EPA 8260C
cis-1,3-Dichloropropene	<0.014	ug/L	0.014	0.10	1	U		11/24/2022 02:39	RLD	EPA 8260C
Dibromochloromethane	<0.016	ug/L	0.016	0.10	1	U		11/24/2022 02:39	RLD	EPA 8260C

Unless specifically stated to the contrary, soil/sediment/sludge sample results/LOD/LOQ/RLs were reported on a Dry Weight Basis

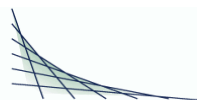

CT LAB#: 1265484 Sample Description:PW-09

DNR License/Well #: 04189/056

Sampled: 11/17/2022 12:15

Analyte	Result	Units	LOD	LOQ	Dilution	Qualifier	Prep Date/Time	Analysis Date/Time	Analyst	Method
Dibromomethane	<0.018	ug/L	0.018	0.10	1	U		11/24/2022 02:39	RLD	EPA 8260C
Dichlorodifluoromethane	<0.091	ug/L	0.091	0.30	1	U		11/24/2022 02:39	RLD	EPA 8260C
Diisopropyl ether	0.023	ug/L	0.02	0.1	1	J		11/24/2022 02:39	RLD	EPA 8260C
Ethylbenzene	<0.014	ug/L	0.014	0.10	1	U		11/24/2022 02:39	RLD	EPA 8260C
Hexachlorobutadiene	<0.027	ug/L	0.027	0.20	1	U		11/24/2022 02:39	RLD	EPA 8260C
Isopropylbenzene	<0.020	ug/L	0.020	0.10	1	U		11/24/2022 02:39	RLD	EPA 8260C
m & p-Xylene	<0.030	ug/L	0.030	0.20	1	U		11/24/2022 02:39	RLD	EPA 8260C
Methyl tert-butyl ether	0.60	ug/L	0.014	0.10	1	Q,Y		11/24/2022 02:39	RLD	EPA 8260C
Methylene chloride	<0.090	ug/L	0.090	0.40	1	U		11/24/2022 02:39	RLD	EPA 8260C
n-Butylbenzene	<0.021	ug/L	0.021	0.10	1	U		11/24/2022 02:39	RLD	EPA 8260C
n-Propylbenzene	<0.020	ug/L	0.020	0.10	1	U		11/24/2022 02:39	RLD	EPA 8260C
Naphthalene	<0.025	ug/L	0.025	0.10	1	U		11/24/2022 02:39	RLD	EPA 8260C
o-Xylene	<0.016	ug/L	0.016	0.10	1	U		11/24/2022 02:39	RLD	EPA 8260C
p-Isopropyltoluene	<0.016	ug/L	0.016	0.10	1	U		11/24/2022 02:39	RLD	EPA 8260C
sec-Butylbenzene	<0.021	ug/L	0.021	0.10	1	U		11/24/2022 02:39	RLD	EPA 8260C
Styrene	<0.014	ug/L	0.014	0.10	1	U		11/24/2022 02:39	RLD	EPA 8260C
tert-Butylbenzene	<0.020	ug/L	0.020	0.10	1	U		11/24/2022 02:39	RLD	EPA 8260C
Tetrachloroethene	<0.028	ug/L	0.028	0.20	1	U		11/24/2022 02:39	RLD	EPA 8260C
Tetrahydrofuran	<0.38	ug/L	0.38	2.0	1	U		11/24/2022 02:39	RLD	EPA 8260C
Toluene	<0.020	ug/L	0.020	0.10	1	U		11/24/2022 02:39	RLD	EPA 8260C
trans-1,2-Dichloroethene	0.29	ug/L	0.020	0.10	1			11/24/2022 02:39	RLD	EPA 8260C
trans-1,3-Dichloropropene	<0.020	ug/L	0.020	0.10	1	U		11/24/2022 02:39	RLD	EPA 8260C
Trichloroethene	0.086	ug/L	0.022	0.10	1	J		11/24/2022 02:39	RLD	EPA 8260C
Trichlorofluoromethane	<0.033	ug/L	0.033	0.20	1	U		11/24/2022 02:39	RLD	EPA 8260C
Vinyl acetate	<0.14	ug/L	0.14	1.0	1	U		11/24/2022 02:39	RLD	EPA 8260C
Vinyl chloride	0.046	ug/L	0.019	0.10	1	J		11/24/2022 02:39	RLD	EPA 8260C

Unless specifically stated to the contrary, soil/sediment/sludge sample results/LOD/LOQ/RLs were reported on a Dry Weight Basis

CT LAB#: 1265484	Sample Description:PW-09	DNR License/Well #: 04189/056	Sampled: 11/17/2022 12:15
------------------	--------------------------	-------------------------------	---------------------------

Analyte	Result	Units	LOD	LOQ	Dilution	Qualifier	Prep Date/Time	Analysis Date/Time	Analyst	Method
1,4-Dioxane	<0.40	ug/L	0.40	1.4	1	U	11/22/2022 11:00	11/28/2022 15:57	ALD	EPA 8270D-SIM

Notes: All LOD/LOQs are adjusted to reflect dilution, percent solids, and any differences in the sample weight / volume as compared to standard amounts. "U" qualifier indicates concentration of analyte was below the detection limit. "J" qualifier indicates an estimated value between the LOD and LOQ.

All samples were received intact and properly preserved unless otherwise noted. The results reported relate only to the samples tested. This report shall not be reproduced, except in full, without written approval of this laboratory. The Chain of Custody is attached.

Brett M. Szymanski
Project Manager
Submitted by: 608-356-2760

<u>Code</u>	<u>Description</u>	<u>QC Qualifiers</u>
B	Analyte detected in the associated Method Blank.	
C	Toxicity present in BOD sample.	
D	Diluted Out.	
E	Safe, No Total Coliform detected.	
F	Unsafe, Total Coliform detected, no E. Coli detected.	
G	Unsafe, Total Coliform detected and E. Coli detected.	
H	Holding time exceeded.	
I	Incubator temperature was outside acceptance limits during test period.	
J	Estimated value.	
L	Significant peaks were detected outside the chromatographic window.	
M	Matrix spike and/or Matrix Spike Duplicate recovery outside acceptance limits.	
N	Insufficient BOD oxygen depletion.	
O	Complete BOD oxygen depletion.	
P	Concentration of analyte differs more than 40% between primary and confirmation analysis.	
Q	Laboratory Control Sample outside acceptance limits.	
R	See Narrative at end of report.	
S	Surrogate standard recovery outside acceptance limits due to apparent matrix effects.	
T	Sample received with improper preservation or temperature.	
U	Analyte concentration was below detection limit.	
V	Raised Quantitation or Reporting Limit due to limited sample amount or dilution for matrix background interference.	
W	Sample amount received was below program minimum.	
X	Analyte exceeded calibration range.	
Y	Replicate/Duplicate precision outside acceptance limits.	
Z	Specified calibration criteria was not met.	

Current CT Laboratories Certifications

Wisconsin (WDNR) Chemistry ID# 157066030
 Wisconsin (DATCP) Bacteriology ID# 289
 Louisiana NELAP (primary) ID# 115843
 Illinois NELAP Lab ID# 200073
 Kansas NELAP Lab ID# E-10368
 Virginia NELAP Lab ID# 460203
 ISO/IEC 17025-2005 A2LA Cert # 3806.01
 DoD-ELAP A2LA 3806.01

Company: **Hyde Environmental**
 Project Contact: **Jim Lindemann**
 Telephone: **262-250-1226**
 Project Name: **DEC Superfund WI**
 Project #:
 Location: **Ashippun WI**
 Sampled By: **Logan Cranley**

LABORATORIES
 1230 Lange Court, Baraboo, WI 53913
 608-356-2760 Fax 608-356-2766
 www.ctlaboratories.com
 Folder #: **173815**
 Company: **HYDE ENVIRONMENTAL, INC.**
 Project: **OCONOMOWOC ELECTROPLATING**
 Logged By: **erc PM BMS**
 Program: **SM RCRA SDWA NPDES Solid Waste Other superfund**
 ID #

Report To:
 EMAIL: **jclindemann@hyde-env.com**
 Company: **Hyde Environmental**
 Address: **W175 W1163 Stone Road Dr 110, Germantown WI**
 Invoice To:*
 EMAIL:
 Company: **Same**
 Address:

*Party listed is responsible for payment of invoice as per CT Laboratories' terms and conditions

Client Special Instructions

Matrix:
 GW - groundwater SW - surface water WW - wastewater DW - drinking water
 S - soil/sediment SL - sludge A - air M - misc/waste

Filtered? Y/N	ANALYSES REQUESTED												Total # Containers	Designated MS/MSD	
N	3	2													
	3														

Turnaround Time
 Normal RUSH*
 Date Needed: _____
 Rush analysis requires prior
 CT Laboratories' approval
 Surcharges:
 24 hr 200%
 2-3 days 100%
 4-9 days 50%

Collection		Matrix	Grab/Comp	Sample #	Sample ID Description	Fill in Spaces with Bottles per Test												CT Lab ID # Lab use only
Date	Time																	
11-17-22	1215	DW	Grab		PW-09													1265484
					Trip Blank													89

Relinquished By: **Logan Cranley**
 Received by:

Date/Time: **11-17-22 1430**
 Date/Time:

Received By: **Jim**
 Received for Laboratory by: **Jim**
 173815 - Page 39 of 42

Date/Time: **11/18/22 952**
 Date/Time: **11/18/22 1035**

Lab Use Only
 Ice Present **Yes** No
 Temp **1.7** IR Gun **27**
 Cooler # **9389**