

33
3-22-2004



175 N. Corporate Drive
Suite 100
Brookfield, WI 53045

www.geotransinc.com

262-792-1282 FAX 262-792-1310

March 22, 2004
(1011.002)

Ms. Jennifer Pelczar
Wisconsin Department of Natural Resources
625 E. County Road Y, Suite 700
Oshkosh, WI 54901-9731

Re: Gas Probe Locations, FF/NN Landfill, Ripon, Wisconsin

Dear Jennie:

This letter is to indicate the locations and depths of the gas probes that the PRP Group for the FF/NN Landfill has agreed to install at the former landfill. Based upon our discussions with members of the PRP Group, followed by the conference call which we had with you and other representatives of the WDNR on March 10 and your letter dated March 16, the proposed locations of the gas probes are shown on the attached figure. The table below indicates the depths of the proposed probes, based upon the maximum known depth of wastes at 836 msl.

Proposed Gas Probe	Surface Elevation at Gas Probe	Bottom Elevation of Gas Probe	Proposed Depth of Gas Probe
GP-1	846 msl	835 msl	11 feet
GP-2	871	835	36
GP-3	870	835	35
GP-4	868	835	33

These are the locations that were acceptable to the FF/NN Landfill PRP Group, GeoTrans and the WDNR in our March 10 conference call, and the depths of the probes were revised as a result of your March 16, 2004 letter.

I trust that this information meets your needs. If you have any questions, feel free to call me.

Sincerely,

GeoTrans, Inc.

Gerald L. DeMers
Senior Engineer, Associate

Ms. Jennie Pelczar

March 22, 2004

Page 2

Cc: Raymond Roder
Nelson Olavarria
Dan Graff, WDNR (via email)
Bernard Schorle, USEPA (via email)
Leland Archiquette, WDNR (via email)
Steve Barg, City of Ripon (via email)

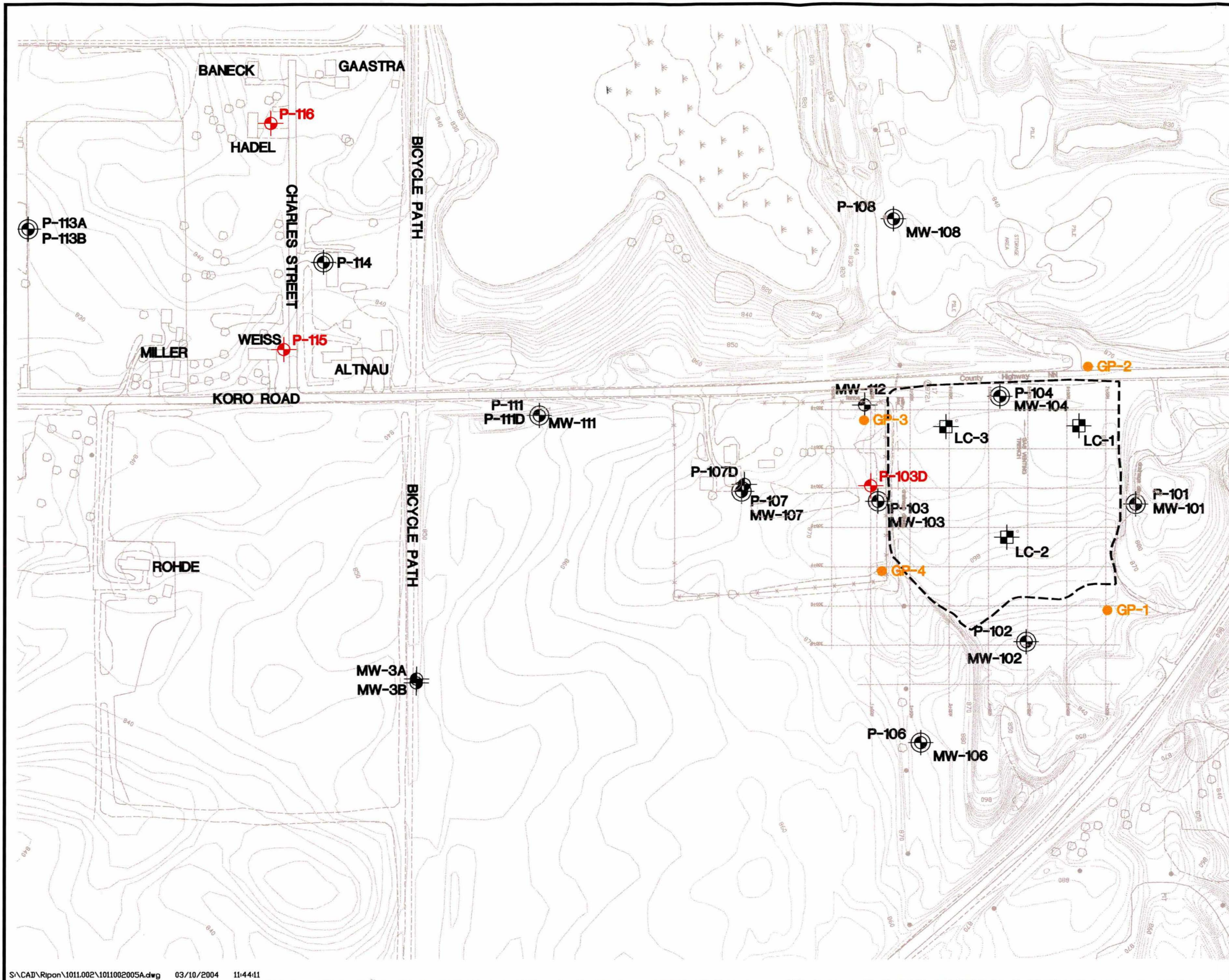

EXPLANATION

- P-104 MONITOR WELL, PIEZOMETER LOCATION, DESIGNATION
- LC-2 LEACHATE HEAD WELL LOCATION, DESIGNATION
- OUTLINE OF CLOSED LANDFILL
- P-116 PROPOSED MONITORING WELL
- GP-1 PROPOSED GAS PROBE

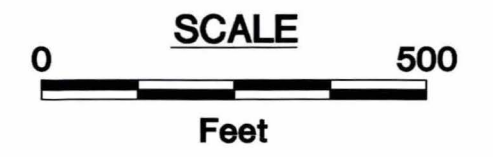

FF/NN LANDFILL RIPON, WISCONSIN PROPOSED MONITORING WELLS AND GAS PROBES	DATE: 3/10/04
	DESIGNED: HWY
	CHECKED: HWY
	APPROVED: GLD
	DRAWN: HJW
PROJ.: 1011.002	

GeoTrans, Inc.
A TETRA TECH COMPANY

Figure 1