

From: Kralick

Re: Groundwater Use Restriction  
GIS Registry Data

Site Name/Address:  
Former LaGrange / Anna Rae Recycling

City A

Doylestown, WI

BRRTS #:

07-11-363744

Date of Closure Decision:

March 26, 2003

GPS data:

589114, 329076

~~Y/N~~ Off-site Contamination

~~Y/N~~ Right-of-way Contamination

Packet Contains:

- Closure Letter
- Conditional closure letter
- All property deeds with 140 ES exceedances
- Groundwater Use Restriction
- Metes/bounds legal description (certified survey)
- Tax parcel number
- GPS data for each affected property
- General location map
- Detailed location map, showing all parcels affected by 140 ES exceedances, property boundaries, buildings, etc.
- Latest map showing gw flow direction, MW, potable wells [optional: Isoconcentration maps of compounds => ES]
- Latest map showing extent or outline of contamination plume and gw flow direction
- Latest table of analytical results
- Geologic cross section

soils



**State of Wisconsin \ DEPARTMENT OF NATURAL RESOURCES**

Jim Doyle, Governor  
Scott Hassett, Secretary  
Ruthe E. Badger, Regional Director

Horicon Service Center  
N7725 STH 28  
Horicon, Wisconsin 53032  
Telephone 920-387-7860  
FAX 920-387-7888

April 2, 2003

Ms. Deborah Raimer  
Columbia County Office of the Treasurer  
400 DeWitt Street  
Portage, WI 53901

**Subject: Final Closure of the Former Ken LaGrange/Anna Rae Recycling Property Located at  
CTH A, Doylestown, Columbia County, Wisconsin  
BRRTS ID # 07-11-363744**

Dear Ms. Raimer:

On March 26, 2003 the South Central Region Case Closure Committee reviewed your site for closure. This committee reviews environmental remediation cases for compliance with state laws and standards to maintain consistency in the closure of these cases. After careful review of the closure request, the Closure Committee has determined that the metals (lead) and polycyclic aromatic hydrocarbon (PAH) soil contamination documented on your site appears to have been investigated and remediated to Department standards and meets the screening criteria of s. NR 746.07 or s. NR 746.08, Wis. Adm. Code, and the requirements of ch. NR 726, Wis. Adm. Code.

Previously, correspondence and data had been provided indicating that your property has been remediated to Department standards in accordance with s. NR 726.05, Wis. Adm. Code. The Department considers this case closed and no further investigation, remediation or other action is required at this time. However, due to the presence of residual lead soil contamination above that compounds NR 720.11 Table 2 standard, your site will be placed on the Departments GIS Registry of Closed Remediation Sites.

Please be aware that this case may be reopened pursuant to s. NR 726.09, Wis. Adm. Code, if additional information regarding site conditions indicates that contamination on or from the site poses a threat to public health, safety or welfare, or the environment.

The Department appreciates your efforts to restore the environment at this site. If you have any questions regarding this letter, please contact me at 920-387-7867, or at the e-mail address below.

Sincerely,

James Kralick, P.G.  
Hydrogeologist, SCR Remediation & Redevelopment Program  
James.Kralick@dnr.state.wi.us

cc: Horicon – LUST case file  
Johnathan Young Eagle – DNR GEF II, RR/3  
Pat McCutcheon – DNR SCR Fitchburg (W/B)  
Dick Bookmeier, Columbia County Property Committee, 400 DeWitt Street, Portage, WI 53901  
Jim Morse, RMT, Inc., 744 Heartland Trail, PO Box 8923, Madison, WI 53708-8923



In the Matter of the Foreclosure of Tax Liens by Columbia County. List of Tax Liens of Columbia County for Tax Year 1997, Numbers: 1

664783

Case No.: 01 CV 220

FILED SEP 11 2001

JUDGMENT OF FORECLOSURE OF TAX LIENS

On October 1, 2001, a hearing was held in the above-entitled action for foreclosure of tax liens by proceeding in Rem pursuant to the provisions of Sec. 75.521, Wis. Stats. with the following appearances; the Petitioner, Deborah Raimer, County Treasurer, appeared in person and by her attorney, Joseph Ruf, III; also appearing, Attorneys Mark Lawton, Alan Strohschein, and Charles Church, duly appointed Guardians ad Litem for all persons known or unknown, who have, or may have, an interest in the lands described in the said List of Tax Liens and those persons who are, or may be minors or incompetents at the time of the filing of such tax liens, pursuant to Sec. 75.521(12), Wis. Stats.; and

It appearing that proceedings to foreclose tax liens by Columbia County were commenced by filing List of Tax Liens for Tax Year 1997, Number: 1 with the Clerk of Courts for Columbia County, pursuant to Sec. 75.521, Wis. Stats.; and

It further appearing that the necessary Petition and Affidavits were made by Deborah Raimer, County Treasurer for Columbia County, and that the necessary Affidavit of Publication was made by the authorized representative of the Daily Register, and

It further appearing that the last day for the redemption of said tax liens has been fixed for September 14, 2001, and that as of 1:30 p.m. the attached list of lands remained unredeemed and is affected by this Judgment; and

The October 5, 2001, Order for Stay of Judgment as to Number 1, Parcel 8, Tax Parcel Identification Number 9, La Grange, Kenneth H. and Joyce L., has been vacated by a separate Order of the Court.

NOW, THEREFORE, IT IS ORDERED AND ADJUDGED that Columbia County, Wisconsin, is vested with an estate in fee simple absolute in Number 1, Parcel 8, subject, however, to all unpaid taxes and charges which are subsequent to the last dated Tax Lien appearing on the List of Tax Liens and subject to recorded restrictions.

IT IS FURTHER ORDERED AND ADJUDGED that all persons, both artificial and natural, including the State of Wisconsin, infants, incompetents, absentees and nonresidents, who may have had a right, title, interest, claim, lien or equity in such lands and all persons claiming under and through them, or any of them from and after the last day fixed for redemption of said tax liens, are forever barred and foreclosed of such right, title, interest, claim, lien or equity of redemption.

STATE OF WISCONSIN } ss. 11, 2002  
COLUMBIA COUNTY }  
RECEIVED FOR RECORD

SEP 12 2002

*Richard L. Rehm*  
Judge Richard L. Rehm  
Branch III

*Denny J. Hill*  
Reg of Deeds at *DOAM* *misc files*

|   |  |                              |                                   |
|---|--|------------------------------|-----------------------------------|
| NO. 8 9 68<br>PART NE1/4 OF SE1/4 BEG AT<br>SE COR; TH W 39 FT POB; TH<br>W 208 FT; TH N 118 FT; TH N<br>87 55" E 247.4'; TH S TO<br>POB. REC IN V.262-P.397;<br>R274-627 R236-549 R242-424<br>R293-359-360 R295-522 R364-<br>357 ALSO LOT 1 CSM1539 V7-90<br>VILLAGE OF DOYLESTOWN<br>SEC 11 TOWN 011 RANGE 011<br>1.240 ACRES | LA GRANGE, KENNETH H<br>& JOYCE L<br>LaGrange, Kenneth H and Joyce L<br>Bank of Wausaukee<br>State of Wisconsin, Dept of Revenue<br>Doylestown, Village of | 1995<br>1996<br>1997<br>1998 | 965.02<br>60.59<br>55.28<br>18.80 |
|---|--|------------------------------|-----------------------------------|

116-9





**Table 2**  
**Summary of Lead Concentrations in Soil**  
**LaGrange Property**  
**Doylestown, Wisconsin**

| SAMPLE ID <sup>(1)</sup> | DEPTH (ft)  | LEAD (mg/kg) | SAMPLE ID (cont)             | DEPTH (ft)  | LEAD (mg/kg) |
|--------------------------|-------------|--------------|------------------------------|-------------|--------------|
| SA-1                     | 1/2 - 1 1/2 | 51           | C3-1                         | 0 - 1/2     | 26           |
| SA-2                     | 1/2 - 1 1/2 | 50           | C3-1                         | 1/2 - 1 1/2 | 7.8          |
| SB-1                     | 1 1/2 - 3   | 17           | C3-2                         | 0 - 1/2     | 26           |
| SD-1                     | 1 1/2 - 3   | 8.4          | C3-2                         | 1/2 - 1 1/2 | 13           |
| <b>C1*</b>               | 0 - 1/2     | <b>2,400</b> | C3-3                         | 0 - 1/2     | 7.5          |
| C1-1                     | 0 - 1/2     | 100          | C3-3                         | 1/2 - 1 1/2 | 5.4          |
| C1-1                     | 1/2 - 1 1/2 | 24           | C3-4                         | 0 - 1/2     | 35           |
| C1-1                     | 1 1/2 - 3   | 24           | C3-4                         | 1/2 - 1 1/2 | 14           |
| C1-2                     | 0 - 1/2     | 22           | C4*                          | 0 - 1/2     | 69           |
| C1-2                     | 1/2 - 1 1/2 | 0.92         | C4-1                         | 0 - 1/2     | 36           |
| C1-2                     | 1 1/2 - 3   | 0.49         | C4-1                         | 1/2 - 1 1/2 | 16           |
| C1-3                     | 0 - 1/2     | 9.3          | C4-2                         | 0 - 1/2     | 710          |
| C1-3                     | 1/2 - 1 1/2 | 2.1          | C4-2                         | 1/2 - 1 1/2 | 97           |
| C1-3                     | 1 1/2 - 3   | 2.0          | C4-3                         | 0 - 1/2     | 66           |
| C1-4                     | 0 - 1/2     | 110          | C4-3                         | 1/2 - 1 1/2 | 15           |
| C1-4                     | 1/2 - 1 1/2 | 23           | C4-4                         | 0 - 1/2     | 120          |
| C1-4                     | 1 1/2 - 3   | 3.4          | C4-4                         | 1/2 - 1 1/2 | 320          |
| C2*                      | 0 - 1/2     | 570          | D1*                          | 0 - 1/2     | 28           |
| C2-1                     | 0 - 1/2     | 69           | D2*                          | 0 - 1/2     | 27           |
| C2-1                     | 1/2 - 1 1/2 | 6.7          | D3*                          | 0 - 1/2     | 94 N         |
| C2-1                     | 1 1/2 - 3   | 7.7          | D3-1                         | 0 - 1/2     | 130          |
| C2-2                     | 0 - 1/2     | 16           | D3-1                         | 1/2 - 1 1/2 | 68           |
| C2-2                     | 1/2 - 1 1/2 | 5.2          | D3-2                         | 0 - 1/2     | 33           |
| C2-2                     | 1 1/2 - 3   | 0.31         | D3-2                         | 1/2 - 1 1/2 | 75           |
| C2-3                     | 0 - 1/2     | 30           | D3-3                         | 0 - 1/2     | 12           |
| C2-3                     | 1/2 - 1 1/2 | 4.9          | D3-3                         | 1/2 - 1 1/2 | 59           |
| C2-3                     | 1 1/2 - 3   | 1.1          | D3-4                         | 0 - 1/2     | 18           |
| C2-4                     | 0 - 1/2     | 51           | D3-4                         | 1/2 - 1 1/2 | 7.9          |
| C2-4                     | 1/2 - 1 1/2 | 8.8          |                              |             |              |
| C2-4                     | 1 1/2 - 3   | 4.7          |                              |             |              |
| C3*                      | 0 - 1/2     | 99           |                              |             |              |
|                          |             |              | NR 720<br>Nonindustrial RCLs |             | 50           |

<sup>(1)</sup> Grab samples were analyzed, unless otherwise noted.

Notes:

N = spiked sample recovery not within control limits.

\* Indicates composite sample soil sample.

Bolded values indicate NR 720 nonindustrial RCL exceedence.

**Table 1**  
**Summary of Lead Confirmation Soil Sample Analytical Results**  
**LaGrange Property - Doylestown, Wisconsin**

| Sample ID | Sample Collection Date | Sample Type | Compositional Lead (mg/kg) |
|-----------|------------------------|-------------|----------------------------|
| C1-NW     | 10/24/02               | Base        | 256                        |
| C1-NE     | 10/24/02               | Base        | 53.3                       |
| C1-SW     | 10/24/02               | Base        | 56.4                       |
| C1-SE     | 10/24/02               | Base        | 52.1                       |
| C4-NW     | 10/24/02               | Base        | 7.69                       |
| C4-NE     | 10/24/02               | Base        | 41.2                       |
| C4-SW     | 10/24/02               | Base        | 5.53                       |
| C4-SE     | 10/24/02               | Base        | 2.93                       |

Notes:

1. The depth of the excavation was approximately 2 feet.
2. The closure criterion for lead is 250 mg/kg according to the Remedial Action Plan.



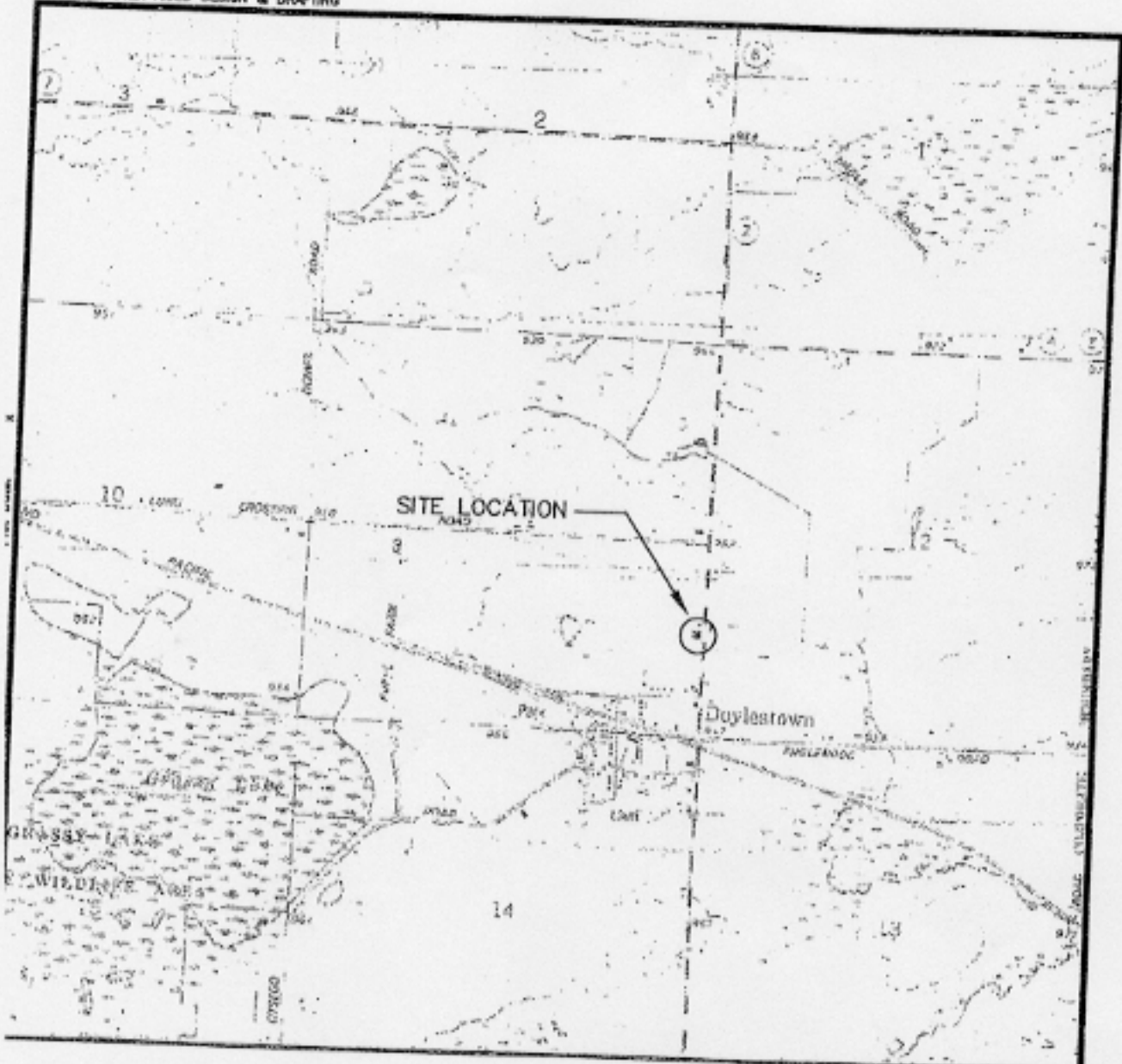

**STATE LOCATION**

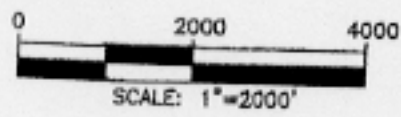

**COLUMBIA COUNTY  
LAGRANGE - HIGHWAY A  
DOYLESTOWN, WISCONSIN**

SOURCE: BASE MAP FROM RIO  
7.5 MIN. USGS QUADRANGLE  
LOCATION: NE1/4, SE1/4 SEC 11, T11N, R11E

|            |                         |
|------------|-------------------------|
| <b>RMT</b> | OWN BY: BALLIETJ        |
|            | APPROVED BY: DTH 7/9/01 |
|            | DATE: JUNE 2001         |
|            | PROJ # 5486.01          |
|            | FILE # 54860103         |

**FIGURE 1**