

24-Hour Emergency Hotline Number: 1-800-943-0003

|   |  |   |  |  |  |
|---|--|---|--|--|--|
| Date & Military Time Of Incident:<br><i>unknown</i>   |  | Date & Military Time Reported:<br><i>9/12/02 - message</i>  |  | Spill File #<br><i>04-16-403133</i>  |  |
| Person Reporting:<br><i>Barry Power</i>   |  | Representing:<br><i>NRE</i>   |  | Phone # (218) 722-9554<br>Fax # ( )  |  |
| Responsible Party (RP) / Spiller:<br><i>Enbridge Energy Company</i>   |  | RP Decision Based On:<br><i>property owner</i>  |  | Phone # (715) 394-1410<br>Fax # ( )  |  |
| RP Address:<br><i>2800 E. 21st St.</i>  |  | City<br><i>Superior</i>   |  | State<br><i>WI</i>   |  |
| RP Contact Name & Title:<br><i>Mark Sitek</i>   |  | Zip Code<br><i>54880</i>  |  | Phone # (715) 394-1410<br>Fax # ( )  |  |
| Substance Involved:<br><i>Crude Oil</i>   |  | Amount & Units Released:<br><i>unknown</i>  |  | Amount & Units Recovered:  |  |
| <input type="checkbox"/> Solid <input type="checkbox"/> Semisolid <input checked="" type="checkbox"/> Liquid  |  | <input type="checkbox"/> Gas  |  | Color: Odor:   |  |
| Exact Location Of Incident: (including street name, bldg. #, mileage, etc.)<br><i>Superior Terminal - pipeline entering from SW</i>   |  |   |  | Facility Name / Property Owner:<br><i>Enbridge Energy</i>  |  |
| <input checked="" type="checkbox"/> City <input type="checkbox"/> Village <input type="checkbox"/> Township   |  | County<br><i>Douglas</i>  |  | Latitude/Longitude<br><i>46° 41' 03.09" N 92° 04' 32.5" W</i>  |  |
| DNR Region:<br><i>NOR</i>   |  | SE 1/4 NW 1/4 Sec 36 T 49N R 14 <input type="checkbox"/> E <input checked="" type="checkbox"/> W  |  | Weather Conditions:  |  |
| Cause Of Incident:<br><i>Unknown - old release encountered during Terrace 3 Expansion Project</i>   |  |   |  |  |  |
| Spilled Substance Impact To:<br>(check X all that apply)  |  | Spill Cause/Site:   |  | Action Taken By Spiller:   |  |
| <input type="checkbox"/> Air <input type="checkbox"/> Potential<br><input type="checkbox"/> Concrete/Asphalt <input type="checkbox"/> Potential<br><input type="checkbox"/> Contained/Recovered<br><input type="checkbox"/> Groundwater <input type="checkbox"/> Potential<br><input type="checkbox"/> Private Well <input type="checkbox"/> Potential<br><input type="checkbox"/> Sanitary Sewer <input type="checkbox"/> Potential<br><input checked="" type="checkbox"/> Soil <input type="checkbox"/> Potential<br><input type="checkbox"/> Storm Sewer <input type="checkbox"/> Potential<br><input type="checkbox"/> Surface Water <input type="checkbox"/> Potential<br>Name:<br><br><input type="checkbox"/> Other: |  | <input type="checkbox"/> Ag Coop/Food Factory<br><input type="checkbox"/> Airport Facility <input type="checkbox"/> Railroad Facility<br><input type="checkbox"/> Construction, Excavation, Wrecking, Quarry, Mine<br><input type="checkbox"/> Gas/Service Station/Garage/Auto Dealer/Repair Shop<br><input type="checkbox"/> Hydraulic Line Break<br><input type="checkbox"/> Industrial Facility <input type="checkbox"/> Paper Mill <input type="checkbox"/> Chemical Co.<br><input checked="" type="checkbox"/> Pipeline/Terminal/Tank Farm/Oil Jobber/Wholesaler<br><input type="checkbox"/> Private Property (home/farm)<br><input type="checkbox"/> Public Property (city, state, church, school, etc.)<br><input type="checkbox"/> Transportation Accident, Fuel Tank Spill<br><input type="checkbox"/> Transportation Accident, Load Spill<br><input type="checkbox"/> Utility Co. Power Generating/Transfer Facility<br><input type="checkbox"/> Other: |  | <input checked="" type="checkbox"/> Cleanup Method:<br><input type="checkbox"/> Absorbent<br><input checked="" type="checkbox"/> Excavation <i>85 Tons</i><br><input type="checkbox"/><br><input type="checkbox"/> Containment<br><input checked="" type="checkbox"/> Contractor Hired <i>NRE</i><br>Name:<br><br><input type="checkbox"/> Monitor<br><input type="checkbox"/> No Action Needed<br><input type="checkbox"/> No Action Taken<br><input checked="" type="checkbox"/> Waste Destination: <i>Timberline Trail</i><br><input type="checkbox"/> Other: |  |
| Injuries? <input type="checkbox"/> Yes <input checked="" type="checkbox"/> No If yes how many?  |  | Has An Evacuation Occurred? <input type="checkbox"/> Yes <input checked="" type="checkbox"/> No   |  | Potential? <input type="checkbox"/> Yes <input checked="" type="checkbox"/> No   |  |
| Are There Any Resource Damages? <input type="checkbox"/> Yes <input checked="" type="checkbox"/> No <input type="checkbox"/> Potential What Kind?   |  |   |  |  |  |
| Other Agencies Notified: (check first column, if notified; check both columns, if on the scene)   |  |   |  | Incident Commander:  |  |
| <input type="checkbox"/> Fire Department<br><input type="checkbox"/> Local Law Enforcement<br><input type="checkbox"/> LEPC or Local Emer. Mgt.<br><input type="checkbox"/> Level A/Level B Team  |  | <input checked="" type="checkbox"/> Local DNR<br><input type="checkbox"/> Div. Emerg. Mgt.<br><input type="checkbox"/> Coast Guard<br><input type="checkbox"/> DHFS 608-258-0099  |  | <input type="checkbox"/> EPA<br><input type="checkbox"/> Nat'l Resp Ctr 800-442-8802<br><input type="checkbox"/> Chemtrec 800-424-9300<br><input type="checkbox"/> Other:  |  |
| Prepared By:<br><i>Norman Dunbar</i>  |  | Phone #<br><i>715-365-8963</i>  |  | Date:<br><i>9/20/02</i>  |  |
| Person Notified:<br><i>Norman Dunbar</i>  |  | Phone #<br><i>715-365-8963</i>  |  | Date:<br><i>9/12/02</i>  |  |
| Investigated By:<br><i>Norman Dunbar</i>  |  | Sign:<br><i>Norman Dunbar</i>   |  | Date:<br><i>11/20/02</i>   |  |
| Spill Coordinator Signoff:<br><i>Norman Dunbar</i>  |  | Date:<br><i>11/20/02</i>  |  | Rpt'd To DATCP? <input type="checkbox"/> Yes <input type="checkbox"/> No   |  |
| Transferred To: ERP <input type="checkbox"/>  |  | DATCP <input type="checkbox"/> Date:  |  | Time:<br><i>message</i>  |  |
| Case #  |  | NFA Letter Sent? <input type="checkbox"/> Yes <input checked="" type="checkbox"/> No  |  | Incident Closed? <input checked="" type="checkbox"/> Yes <input type="checkbox"/> No   |  |
|   |  | Spill Packet Sent? <input type="checkbox"/> Yes <input checked="" type="checkbox"/> No  |  | Date: <i>11/20/02</i>  |  |
|   |  | To:   |  |  |  |



**Natural Resources Engineering Company**

**Thirteen West Superior Street**

**Duluth, Minnesota 55802**

**Tel (218) 722-9554 Facsimile [218] 722-9562**

November 12, 2002

Norm Dunbar  
Wisconsin Department of Natural Resources  
107 Sutliff Avenue  
Rhineland, WI 54501

**RE: Enbridge Energy Partners  
Discovery of Impacted Soil along the Terrace III Construction Route  
September 11, 2002**

Dear Mr. Dunbar,

This letter serves to document the environmental activities conducted in response to discovery of impacted soil from a historic release near Enbridge Energy Partners' (Enbridge's) Superior Terminal in Superior, Wisconsin (hereon referred to as "Site.") The location of the Site is shown on Figure 1. GPS coordinates for the area of the release are also included on Figure 1.

**Setting:**

Near surface geology at the Site consists of over 300 feet of red, plastic, fat clay with a USCS designator of CL. Surface drainage from the Site is to the east-southeast, ultimately discharging to the Nemadji River, a low energy river that flows north to Superior Bay. The slope across the Site is generally less than 0.5%, but steepens to over 15% along the Nemadji River valley. Depth to groundwater across the Site varies from a minimum of approximately 6 feet to over 15 feet below grade in response to topographic and piezometric relief across the Site. The Nemadji River located approximately ¼-mile east of the release location, is the closest surface water and groundwater receptor. There are no known drinking water supply wells located within 1,200 feet of the Site.

**Remedial Actions:**

While excavating a trench for Enbridge's Terrace III expansion project, impacted soil from a historic release was discovered. The crude oil stained soil was encountered from nearly one foot to three feet below grade. Seven soil samples for headspace screening were collected from the base and sidewalls of the trench (See Figure 2). Headspace concentrations are summarized on Table 1. The prefix SW- indicates a sample collected from the trench sidewall while the prefix B- indicates a sample collected from the base of the trench. Approximately 55 tons of impacted soil were

11/20/02  
nd

## **Natural Resources Engineering Company**

---

Page 2  
November 12, 2002

removed from the excavation and hauled off-site for disposal at Waste Management's Timberline Trail Landfill in Weyerhaeuser, Wisconsin on September 12<sup>th</sup>.

Fifteen hand-augured boreholes were subsequently advanced on the north and south sides of the trench to define the lateral extent of impacted soil. Samples for headspace screening were collected from the impacted soil in the boring, or in cases where impacted soil was not discovered, from the bottom of the boring. Headspace screening results for the hand auger borings are summarized in Table 2.

Following placement of the new pipeline and removal of the timber mat road, impacted soil on the north side of the trench was removed and hauled off-site for disposal. Soil was excavated based on the presence of visual staining. Approximately 33 tons of impacted soil were scraped from the area beneath the timber mat road to the south of the trench on October 7<sup>th</sup> and disposed of at Waste Management's Timberline Trail Landfill in Weyerhaeuser, Wisconsin. The disposal records are attached with this letter. Due to the presence of an existing pipeline to the north of the trench, impacted soil could not be excavated from that area.

Based on the extent of the impacted soil as defined by the hand-augured borings, the remedial actions taken, and the setting of the site, we do not believe the soil left in place poses a significant risk to human health of the environment and are requesting closure of the site. Please call me if you have any comments or questions – I can be reached at (218) 722-9554.

Sincerely,

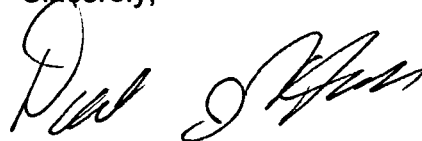

David J. Hodek, P.E.  
Environmental Engineer

c: Mark Sitek – Enbridge Energy Company  
Scott Lounsbury – Enbridge Energy Company  
Barry Power – NRE  
bc: Law

Enclosures

**Table 1: Excavation Headspace Screening Results  
Enbridge Energy Company - Terrace III Expansion**

| <b>Location</b> | <b>Date</b> | <b>Depth (feet)</b> | <b>Headspace (ppm)</b> |
|-----------------|-------------|---------------------|------------------------|
| SWN-1           | 11-Sep-02   | 2                   | 184.3                  |
| SWN-2           | 11-Sep-02   | 3                   | 139.6                  |
| SWS-1           | 11-Sep-02   | 1                   | 60.4                   |
| SWS-2           | 11-Sep-02   | 2                   | 67.0                   |
| SWS-3           | 11-Sep-02   | 3                   | 12.4                   |
| B-1             | 11-Sep-02   | 6                   | < 5.0                  |
| B-2             | 11-Sep-02   | 6                   | < 5.0                  |

**Table 2: Hand-Augured Boring Headspace Screening Results  
Enbridge Energy Company - Terrace III Expansion**

| <b>Location</b> | <b>Date</b> | <b>Depth<br/>(feet)</b> | <b>Headspace<br/>(ppm)</b> |
|-----------------|-------------|-------------------------|----------------------------|
| HA-1            | 13-Sep-02   | 2                       | < 5.0                      |
| HA-2            | 13-Sep-02   | 1                       | 60.3                       |
| HA-3            | 13-Sep-02   | 1.5                     | < 5.0                      |
| HA-4            | 13-Sep-02   | 1.5                     | 25.1                       |
| HA-5            | 13-Sep-02   | 1                       | 16.3                       |
| HA-6            | 13-Sep-02   | 1.5                     | 37.8                       |
| HA-7            | 13-Sep-02   | 2                       | < 5.0                      |
| HA-8            | 13-Sep-02   | 1.5                     | < 5.0                      |
| HA-9            | 13-Sep-02   | 1.0                     | < 5.0                      |
| HA-10           | 13-Sep-02   | 2.5                     | < 5.0                      |
| HA-11           | 18-Sep-02   | 2                       | 43.4                       |
| HA-12           | 18-Sep-02   | 2.5                     | < 5.0                      |
| HA-13           | 18-Sep-02   | 2                       | 72.1                       |
| HA-14           | 18-Sep-02   | 2.5                     | < 5.0                      |
| HA-15           | 18-Sep-02   | 2.5                     | < 5.0                      |

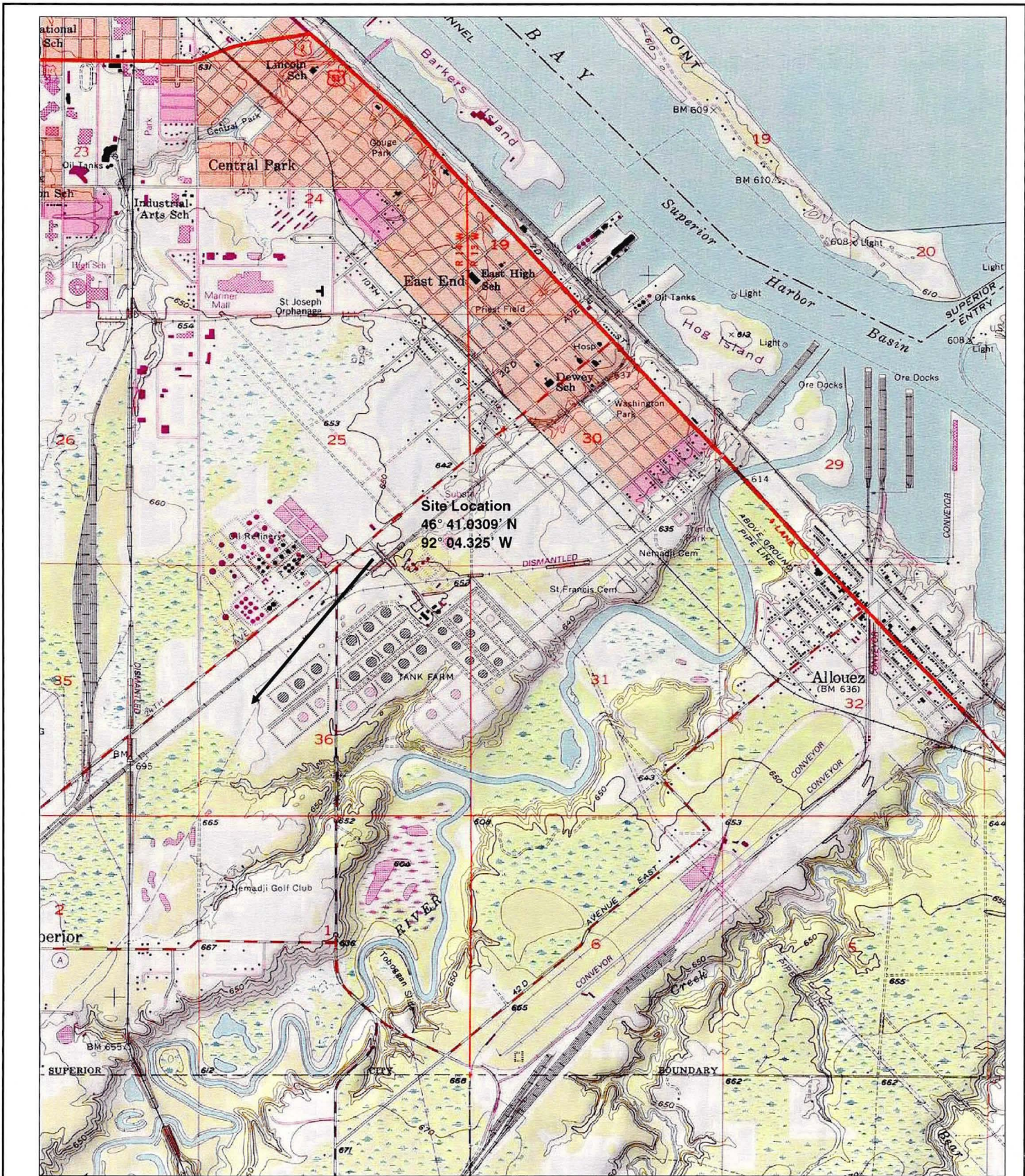

Site Location Map  
 Enbridge Energy Company - Terrace III Expansion

Natural Resources Engineering Company  
 13 West Superior Street, Duluth, MN 55802



Nov-02  
 Figure 1

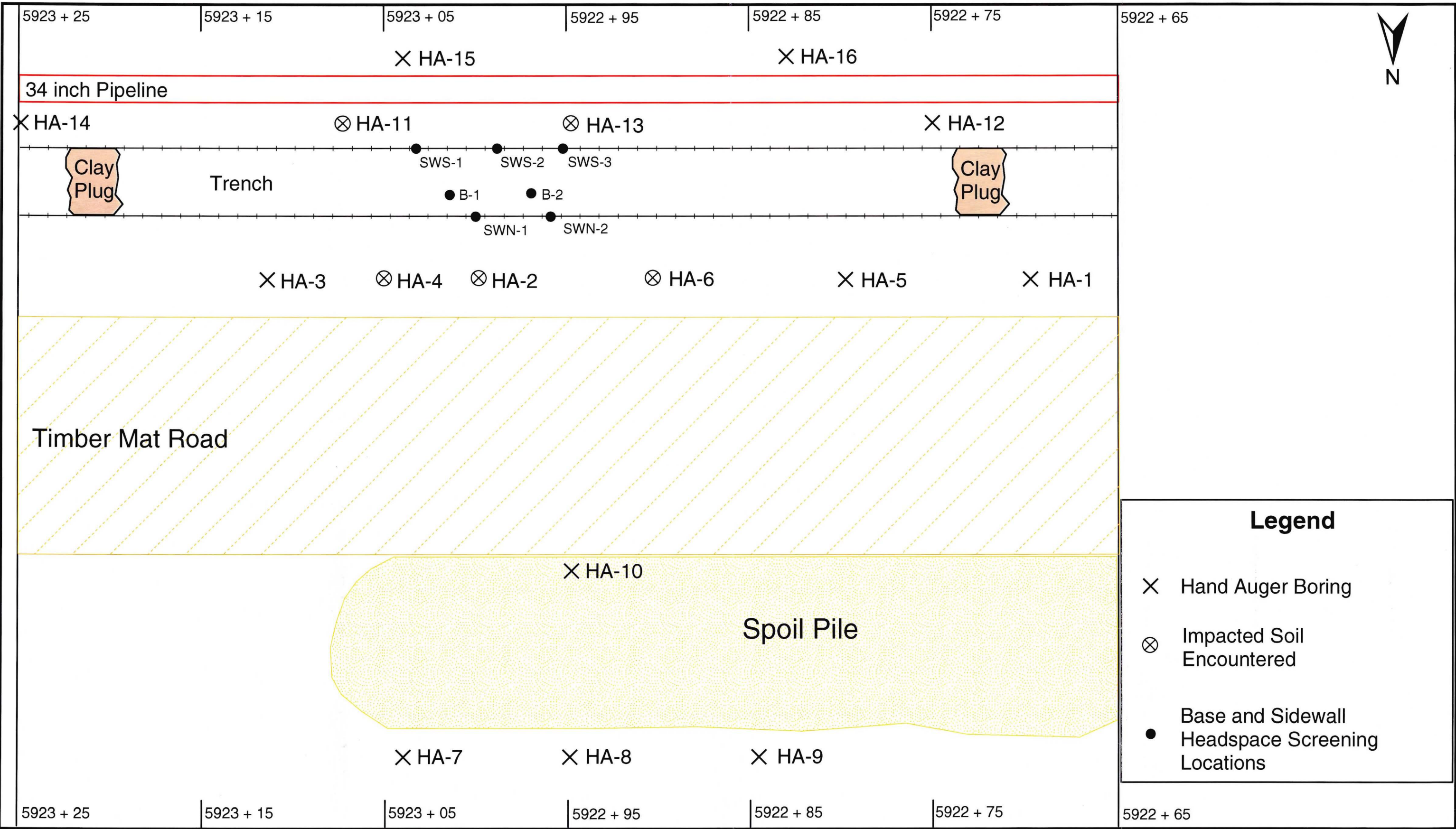

| Legend |   |
|--------|---|
| ×      | Hand Auger Boring                               |
| ⊗      | Impacted Soil Encountered                       |
| ●      | Base and Sidewall Headspace Screening Locations |



# Enbridge Energy, Limited Partnership

Figure 2: Site Map

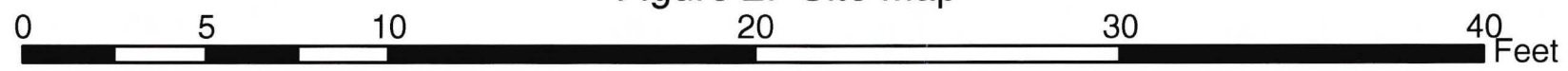

|   |  |
|---|--|
| DATE ISSUED: 11/6/2002                  |  |
| DATE REVISED: 11/06/2002                |  |
| SCALE: 1:60                             |  |
| DRAWN BY: Alina K. Mustonen, E.I.T.     |  |
| SERIES: Terrace III - Superior Terminal |  |

**INVOICE**

|                                      |
|--------------------------------------|
| ACCOUNT NUMBER<br>300-0000346-2274-6 |
| INVOICE NUMBER<br>0001729-2274-2     |
| DATE<br>11/01/2002                   |

LAKEHEAD PIPELINE-HANS

(Continued from previous page)

PAYMENT DUE UPON RECEIPT OF THIS INVOICE  
 PLEASE CONTACT WASTE MANAGEMENT WITH ANY QUESTIONS

| TICKET | DESCRIPTION  | QUANTITY               | RATE          | AMOUNT          |
|--------|--|------------------------|---------------|-----------------|
| Ticket | Description  | Quantity               | Rate          | Extended        |
| 753691 | 10/05/2002 VEH#:<br>WISCONSIN GENERATOR TAX/FEE<br>NON HAZ SOLID WASTE | 16.38 TON<br>16.38 TON | 3.75<br>15.00 | 61.43<br>245.70 |
|        | Ticket Total   |                        |               | 307.13          |
| 753799 | 10/07/2002 VEH#:<br>CONTAMINATED SOIL                                  | 12.39 TON              | 15.00         | 185.85          |
| 753800 | 10/07/2002 VEH#:<br>CONTAMINATED SOIL                                  | 8.45 TON               | 15.00         | 126.75          |
| 753801 | 10/07/2002 VEH#:<br>CONTAMINATED SOIL                                  | 11.73 TON              | 15.00         | 175.95          |
| 753829 | 10/07/2002 VEH#:<br>WISCONSIN GENERATOR TAX/FEE<br>NON HAZ SOLID WASTE | 20.26 TON<br>20.26 TON | 3.75<br>15.00 | 75.98<br>303.90 |
|        | Ticket Total   |                        |               | 379.88          |
| 753842 | 10/08/2002 VEH#:<br>WISCONSIN GENERATOR TAX/FEE<br>NON HAZ SOLID WASTE | 20.96 TON<br>20.96 TON | 3.75<br>15.00 | 78.60<br>314.40 |
|        | Ticket Total   |                        |               | 393.00          |
| 753846 | 10/08/2002 VEH#:<br>WISCONSIN GENERATOR TAX/FEE<br>NON HAZ SOLID WASTE | 11.49 TON<br>11.49 TON | 3.75<br>15.00 | 43.09<br>172.35 |
|        | Ticket Total   |                        |               | 215.44          |
| 753847 | 10/08/2002 VEH#:<br>WISCONSIN GENERATOR TAX/FEE<br>NON HAZ SOLID WASTE | 17.89 TON<br>17.89 TON | 3.75<br>15.00 | 67.09<br>268.35 |
|        | Ticket Total   |                        |               | 335.44          |
| 753848 | 10/08/2002 VEH#:<br>WISCONSIN GENERATOR TAX/FEE<br>NON HAZ SOLID WASTE | 10.33 TON<br>10.33 TON | 3.75<br>15.00 | 38.74<br>154.95 |
|        | Ticket Total   |                        |               | 193.69          |
| 753851 | 10/08/2002 VEH#:<br>WISCONSIN GENERATOR TAX/FEE<br>NON HAZ SOLID WASTE | 19.55 TON<br>19.55 TON | 3.75<br>15.00 | 73.31<br>293.25 |
|        | Ticket Total   |                        |               | 366.56          |
| 753852 | 10/08/2002 VEH#:<br>WISCONSIN GENERATOR TAX/FEE                        | 10.15 TON              | 3.75          | 38.06           |

(Continued on next page)



WEYERHAEUSER WI 5465-15  
 PHONE 708 04-1067  
 718 867-7000

LAKESHORE PIPELINE-HANS  
 13 W SUPERIOR ST  
 DULUTH MN 55802

**INVOICE**

|                                      |
|--------------------------------------|
| ACCOUNT NUMBER<br>300-0000346-2274-6 |
| INVOICE NUMBER<br>0001645-2274-0     |
| DATE<br>10/01/2002                   |

PAYMENT DUE UPON RECEIPT OF THIS INVOICE  
 PLEASE CONTACT WASTE MANAGEMENT WITH ANY QUESTIONS

| TICKET | DESCRIPTION                                  | QUANTITY  | RATE  | AMOUNT   |
|--------|--|-----------|-------|----------|
| Ticket | Description                                  | Quantity  | Rate  | Extended |
| 751982 | 09/12/2002 VEH#: CONTAMINATED SOIL           | 18.58 TON | 15.00 | 278.70   |
| 751983 | 09/12/2002 VEH#: CONTAMINATED SOIL           | 18.43 TON | 15.00 | 276.45   |
| 751984 | 09/12/2002 VEH#: CONTAMINATED SOIL           | 18.29 TON | 15.00 | 274.35   |
| 752049 | 09/13/2002 VEH#: WISCONSIN GENERATOR TAX/FEE | 17.57 TON | 3.75  | 65.89    |
|        | NON HAZ SOLID WASTE                          | 17.57 TON | 15.00 | 263.55   |
|        | Ticket Total                                 |           |       | 329.44   |
| 752051 | 09/13/2002 VEH#: WISCONSIN GENERATOR TAX/FEE | 20.18 TON | 3.75  | 75.68    |
|        | NON HAZ SOLID WASTE                          | 20.18 TON | 15.00 | 302.70   |
|        | Ticket Total                                 |           |       | 378.38   |
| 752052 | 09/13/2002 VEH#: WISCONSIN GENERATOR TAX/FEE | 17.83 TON | 3.75  | 66.86    |
|        | NON HAZ SOLID WASTE                          | 17.83 TON | 15.00 | 267.45   |
|        | Ticket Total                                 |           |       | 334.31   |
| 752056 | 09/13/2002 VEH#: WISCONSIN GENERATOR TAX/FEE | 23.00 TON | 3.75  | 86.25    |
|        | NON HAZ SOLID WASTE                          | 23.00 TON | 15.00 | 345.00   |
|        | Ticket Total                                 |           |       | 431.25   |
| 752116 | 09/13/2002 VEH#: WISCONSIN GENERATOR TAX/FEE | 22.86 TON | 3.75  | 85.73    |
|        | NON HAZ SOLID WASTE                          | 22.86 TON | 15.00 | 342.90   |
|        | Ticket Total                                 |           |       | 428.63   |
| 752197 | 09/16/2002 VEH#: WISCONSIN GENERATOR TAX/FEE | 19.11 TON | 3.75  | 71.66    |
|        | NON HAZ SOLID WASTE                          | 19.11 TON | 15.00 | 286.65   |
|        | Ticket Total                                 |           |       | 358.31   |
| 752198 | 09/16/2002 VEH#: WISCONSIN GENERATOR TAX/FEE | 19.27 TON | 3.75  | 72.26    |
|        | NON HAZ SOLID WASTE                          | 19.27 TON | 15.00 | 289.05   |
|        | Ticket Total                                 |           |       | 361.31   |
| 752201 | 09/16/2002 VEH#: WISCONSIN GENERATOR TAX/FEE | 21.54 TON | 3.75  | 80.78    |

(Continued on next page)

**SE RETURN THIS PORTION WITH PAYMENT - DO NOT ATTACH CHECK TO STUB** IF PAYING BY MASTERCARD, VISA OR AMERICAN EXPRESS, FILL OUT BELOW

CHECK CARD USING FOR PAYMENT