

23058620

State of Wisconsin  
Department of Natural Resources

**Hazardous Substance Release Fax Notification  
(Non-Emergency Only)**

03-30409352

Form 4400-225 (11/02) Page 1 of 2

**Emergency Releases / Spills must be reported via the 24-hour Hotline: 1-800-943-0003**

**Notice:** Hazardous substance discharges must be reported immediately according to the "Spills Law", s. 292.11 Wis. Stats., Section NR 706.05(1)(b), Wis. Adm. Code, requires that hazardous substance discharges are to be reported by one of three methods: telephoning the Department (toll free Spill Hotline number above), telefaxing a report to the Department or visiting a Department office in person. If you choose to notify the Department by telefax, you should use this form to be sure that all necessary information is included. However use of this form is not mandatory. Under s. 292.99, Wis. Stats., the penalty for violating ch. 292 Wis. Stats., shall be no less than \$10 nor more than \$5000 for each violation. Each day of continued violation is a separate offense. It is not the Department's intention to use any personally identifiable information from this form for any purpose other than program administration. However, information submitted on this form may also be made available to requesters under Wisconsin's Open Records Law (ss. 19.31 - 19.39, Wis. Stats.). Confirmatory laboratory data should be included with this form, to assist the DNR in processing this Hazardous Substance Release Notification.

Complete this form. **TYPE or PRINT LEGIBLY.** FAX it to the appropriate WDNR region (see next page) **IMMEDIATELY** upon discovery of a potential release from (check one):

- Underground Petroleum Storage Tank System
- Aboveground Petroleum Storage Tank System
- Dry Cleaner Facility (DERP eligibility based on:  Facility owner/operator  Property owner of licensed facility)
- Other - Describe:

TO WDNR, ATTN: R & R Program Assistant

(Area Code) FAX Number  
414-263-8483

**1. Discharge reported by:**

Name	Firm	Date FAXed to WDNR
PETE PAVALKO	PEP ENVIR. SVC. LLC	2-7-2003
Mailing Address	(Area Code) Phone Number	
7147 CEDAR SAUK RD., SAUKVILLE WI 53080	414-801-1730	

**2. Site Information**

Name of site at which discharge occurred. Include local name of site/business, not responsible party name, unless a residence / vacant property  
HEIMES GARAGE

Location: Include street address, not PO Box. If no street address, describe as precisely as possible, e.g., 1/4 mile NW of CTHs 60 & 123 on E side of CTH 60

3418 66th Street

Municipality (City, Village, Township) Specify municipality in which the site is located, not mailing address/city

KENOSHA, CITY OF

County: KENOSHA	Legal Description: _____ 1/4, NW 1/4, Section <u>1</u> , Tn <u>1N</u> , Range <u>22</u> <input checked="" type="radio"/> W (circle one)
--------------------	--

**3. Responsible Party (RP) and/or RP Representative**

Responsible Party Name: Business or owner name that is responsible for cleanup. If more than one, list all. Attach additional pages as necessary

MR. EARL HEIMES

- Reported in compliance with s. 292.11(2), Wis. Stats., by a local government exempt from liability under s.292.11(9)(e), Wis. Stats. For more information see [http://www.dnr.state.wi.us/org/aw/rr/liability/muni\\_1.html](http://www.dnr.state.wi.us/org/aw/rr/liability/muni_1.html)

Contact Person Name (if different) MR. EARL HEIMES	Phone Number
Mailing Address 7318 28th AVE.	City KENOSHA
	State WI
	ZIP Code 53143

State of Wisconsin  
Department of Natural Resources

**Hazardous Substance Release Fax Notification  
(Non-Emergency Only)**

Form 4400-225 (11/02) Page 2 of 2

**4. Hazardous Substance Impact Information**

Identify hazardous substance discharged (check all that apply):

- |   |   |  |
|---|---|--|
| <input type="checkbox"/> Ammonia                      | <input type="checkbox"/> Hydrocarbon-Unknown Type         | <input type="checkbox"/> PCB's                                 |
| <input type="checkbox"/> Arsenic                      | <input type="checkbox"/> Kerosene                         | <input type="checkbox"/> Petroleum-Unknown Type                |
| <input type="checkbox"/> Chlorinated Solvents         | <input type="checkbox"/> Leachate                         | <input type="checkbox"/> PERC                                  |
| <input type="checkbox"/> Chromium                     | <input type="checkbox"/> Lead                             | <input type="checkbox"/> Pesticides                            |
| <input type="checkbox"/> Cyanide                      | <input type="checkbox"/> MTBE-Methyl Tertiary Butyl Ether | <input type="checkbox"/> RCRA Hazardous Waste                  |
| <input checked="" type="checkbox"/> Diesel            | <input type="checkbox"/> Mercury                          | <input type="checkbox"/> SVOC (Semi-volatile Organic Compound) |
| <input type="checkbox"/> Fertilizer                   | <input type="checkbox"/> Metals (specify): _____          | <input type="checkbox"/> Stoddard Solvents                     |
| <input type="checkbox"/> Fuel Oil                     | <input type="checkbox"/> Milk                             | <input type="checkbox"/> Transformer Fluid                     |
| <input type="checkbox"/> Gasoline-Lead Unknown        | <input type="checkbox"/> Oil & Grease                     | <input type="checkbox"/> Unknown                               |
| <input type="checkbox"/> Gasoline-Leaded              | <input type="checkbox"/> Other (specify): _____           | <input type="checkbox"/> VOC's                                 |
| <input checked="" type="checkbox"/> Gasoline-Unleaded | <input type="checkbox"/> PAH's                            | <input type="checkbox"/> Waste Oil                             |
| <input type="checkbox"/> Herbicide                    | <input type="checkbox"/> Paint (oil based)                |  |
| <input type="checkbox"/> Hydraulic Oil                | <input type="checkbox"/> Paint (latex)                    |  |

Impacts to the environment (enter "K" for known/confirmed or "P" for potential for all that apply)

- |  |   |  |
|--|---|--|
| <input type="checkbox"/> Air Contamination                       | <input type="checkbox"/> Contamination in Row of Way          | <input type="checkbox"/> Sanitary Sewer Contamination  |
| <input type="checkbox"/> Co-contamination                        | <input type="checkbox"/> Direct Contact                       | <input checked="" type="checkbox"/> Soil Contamination |
| <input type="checkbox"/> Concrete/Asphalt                        | <input type="checkbox"/> Expanding Plume                      | <input type="checkbox"/> Storm Sewer Contamination     |
| <input type="checkbox"/> Contained/Recovered                     | <input type="checkbox"/> Fire Explosion Threat                | <input type="checkbox"/> Surface Water Contamination   |
| <input type="checkbox"/> Contamination Within 1 Meter of Bedrock | <input type="checkbox"/> Free Product                         | <input type="checkbox"/> Within 100 ft of Private Well |
| <input type="checkbox"/> Contaminated Private Well               | <input checked="" type="checkbox"/> Groundwater Contamination | <input type="checkbox"/> Within 1000 ft of Public Well |
| <input type="checkbox"/> Contaminated Public Well                | <input checked="" type="checkbox"/> Off-Site Contamination    |  |
| <input type="checkbox"/> Contamination in Fractured Bedrock      | <input type="checkbox"/> Other                                |  |

Contamination was discovered as a result of:

- Tank closure assessment       Site assessment      Other - Describe: \_\_\_\_\_  
Date \_\_\_\_\_      Date **12-9-02**      Date \_\_\_\_\_

Lab results:

- Lab results will be faxed upon receipt  
 Lab results are attached **WITH MAP**

Additional Comments: Include a brief description of immediate actions taken to halt the release and contain or cleanup hazardous substances that have been discharged.

**USTS have already been removed. RP will apply for PECFA + BEGIN Site Investigation. PLEASE CC: PEP on the RP letter. THANKS!**

FAX numbers to report non-emergency releases in DNR's five regions are as follows:

**Northeast Region (920-492-5859); Attention - RR Program Assistant:**

Brown, Calumet, Door, Fond du Lac (*except City of Waupun - see South Central Region*), Green Lake, Kewaunee, Manitowoc, Marinette, Marquette, Menominee, Oconto, Outagamie, Shawano, Waupaca, Waushara, Winnebago Counties

**Northern Region (715-365-8932); Attention - RR Program Assistant:**

Ashland, Barron, Bayfield, Burnett, Douglas, Forest, Florence, Iron, Langlade, Lincoln, Oneida, Polk, Price, Rusk, Sawyer, Taylor, Vilas, Washburn Counties

**South Central Region (608-275-3338); Attention - RR Program Assistant:**

Columbia, Dane, Dodge, Fond du Lac (*City of Waupun only*), Grant, Green, Iowa, Jefferson, Lafayette, Richland, Rock, Sauk Counties

**Southeast Region (414-263-8483); Attention - RR Program Assistant:**

Kenosha, Milwaukee, Ozaukee, Racine, Sheboygan, Walworth, Washington, Waukesha Counties

**West Central Region (715-839-6076); Attention - RR Program Assistant:**

Adams, Buffalo, Chippewa, Clark, Crawford, Dunn, Eau Claire, Jackson, Juneau, LaCrosse, Marathon, Monroe, Pepin, Pierce, Portage, St. Croix, Trempealeau, Vernon, Wood Counties

# Figure 2 - Site Features and Soil Boring Locations

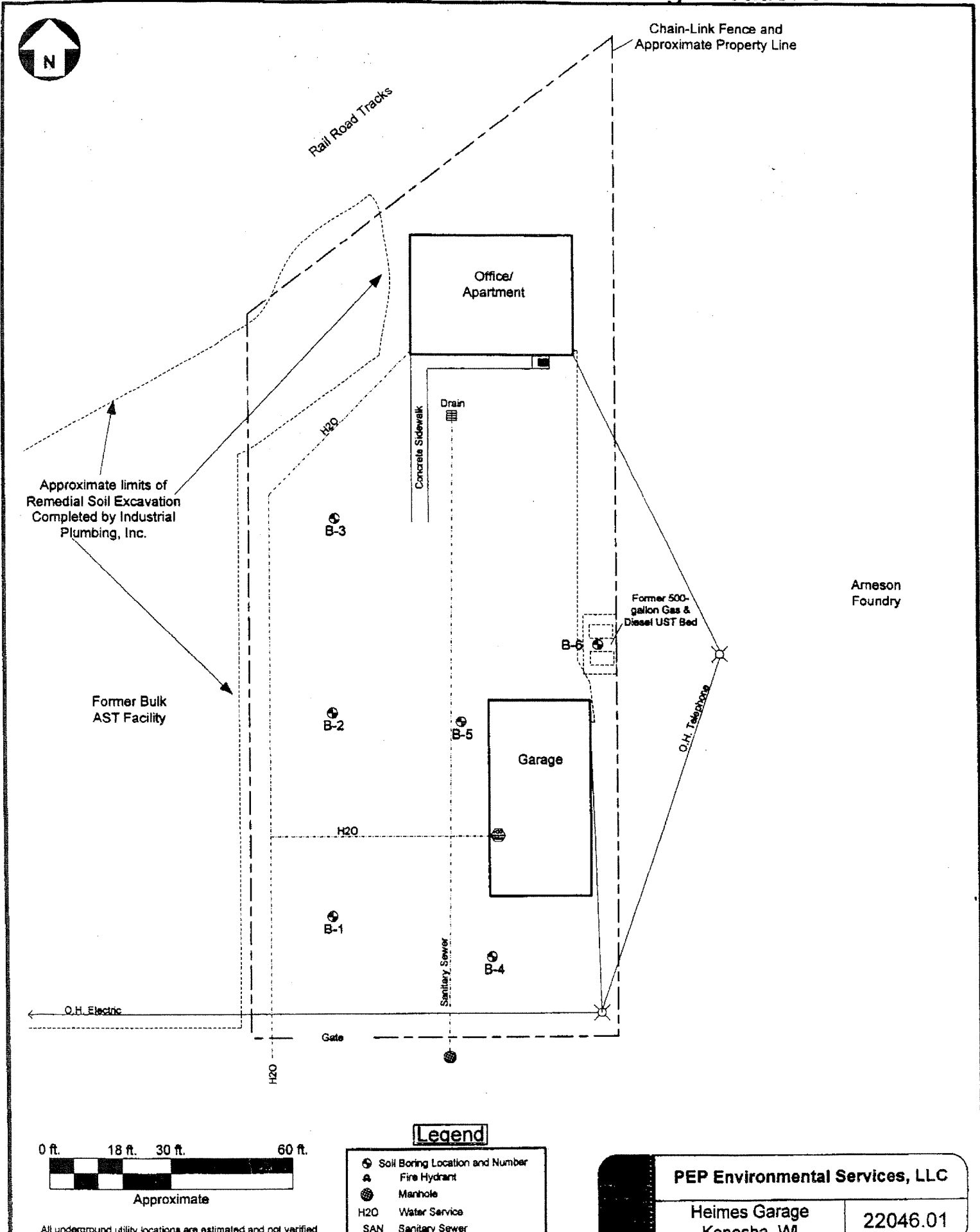

### Legend

- Soil Boring Location and Number
- ⊕ Fire Hydrant
- ⊗ Manhole
- H2O Water Service
- SAN Sanitary Sewer

PEP Environmental Services, LLC

Heimes Garage  
Kenosha, WI

22046.01

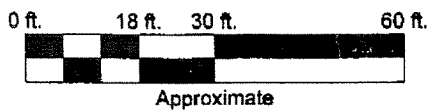

All underground utility locations are estimated and not verified

TABLE 1 ANALYTICAL RESULTS-SOIL HEIMES GARAGE SITE 3418 66TH STREET, KENOSHA, KENOSHA COUNTY, WISCONSIN									
Sample Name	NR 720 GENERIC RCLs	COMM 46 Table 1 Values (Groundwater Protection)	COMM 46 Table 2 Values (Direct Contact - Top 4 Feet)	Samples					
				SB-1A	SB-2A	SB-3A	SB-4A	SB-5A	SB-6A
Boring				B-1	B-2	B-3	B-4	B-5	B-6
Depth (feet)				4-6	4-6	4-6	4-6	4-6	6-8
Date				12/9/2002	12/9/2002	12/9/2002	12/9/2002	12/9/2002	12/9/2002
PID Reading				182	304	303	1	154	330
GROs (ppm)	100	NS	NS	<u>426</u>	<u>2,250</u>	<u>651</u>	< 6.14	<u>113</u>	<u>4,250</u>
DRO (ppm)	100	NS	NS	46.9	<u>7,060</u>	46.8	< 6.14	<u>106</u>	<u>2,660</u>
Total Lead (ppm)	50	NS	NS	NA	NA	NA	NA	NA	7.25
<b>PVOCs + N (ppb)</b>									
Benzene	5.5	8,500	1,100	< 25	<u>3,060</u>	< 25	< 25	<u>59.6</u>	<u>7,130</u>
Ethylbenzene	2,900	4,600	NS	1,020	<u>6,510</u>	<u>4,170</u>	< 25	368	<u>89,200</u>
MTBE	NS	NS	NS	< 25	< 500	< 25	< 25	< 25	< 1000
Naphthalene	400	2,700	NS	<u>3,920</u>	<u>73,600</u>	<u>6,060</u>	39.7	<u>2,280</u>	<u>57,100</u>
Toluene	1,500	38,000	NS	374	<u>2,880</u>	<u>2,330</u>	< 25	85	<u>6,730</u>
1,2,4 TMB	NS	83,000	NS	1,690	14,500	1,910	< 25	456	<u>191,000</u>
1,3,5 TMB	NS	11,000	NS	3,650	4,410	5,000	< 25	806	<u>63,700</u>
Total Xylenes	4,100	42,000	NS	2,020	<u>14,100</u>	2,460	42.3	1,780	<u>375,000</u>

NS = no standard has been established for this compound

RCLs = residual contaminant levels

Underlined values exceed the Generic RCL.

Bolding indicates concentrations above the Table 1 and/or Table 2 (direct contact, top 4 feet) values.

NA = Not analyzed

TMB = trimethylbenzene

MTBE = methyl-tert-butyl-ether

For a complete list of VOCs and detection limits, see Appendix C.

22046r1a

<b>TABLE 2</b> <b>ANALYTICAL RESULTS - GROUNDWATER</b> <b>HEIMES GARAGE SITE</b> <b>3418 66TH STREET, KENOSHA, KENOSHA COUNTY, WISCONSIN</b>						
Sample Name	WB-1	WB-5	WB-6	Water Trip Blank	NR 140 Remedial Action Limits	
Location	Temp. Well in B-1	Temp. Well in B-5	Temp. Well in B-6	QA/QC		
Date	12/9/2002	12/9/2002	12/9/2002	12/9/2002		
					ES	PAL
GROs (ppb)	< 50	1,180	27,600	< 50	NS	NS
Dissolved Lead (ppb)	NA	NA	NA	NA	15	1.5
PVOCs + N (ppb)						
Benzene	< 0.50	< 0.50	<b>184</b>	< 0.50	5	0.5
Ethylbenzene	< 0.50	4.22	<b>2,340</b>	< 0.50	700	140
MTBE	5.02	1.11	<b>325</b>	< 0.50	60	12
Naphthalene	< 2	<b>50.4</b>	<b>891</b>	< 2	40	8
Toluene	< 0.50	1.47	<b>839</b>	< 0.50	1,000	200
1,2,4-Trimethylbenzene	< 1	6.84	<b>2,620</b>	< 1	480	96
1,3,5-Trimethylbenzene	< 1	4.73	<b>901</b>	< 1		
Xylene (total)	1.02	10.50	<b>9,760</b>	< 0.50	10,000	1,000

ND = not detected

NS = no standards

MTBE = methyl-tert-butyl-ether

Bolded values indicate concentrations above ES.

Underlined values indicate concentrations above PAL.

For a complete list of VOCs and detection limits, see Appendix C.

NA = Not Analyzed

22043r1a