



**April 10, 2020**

Mr. Lee Delcore  
Wisconsin Department of Natural Resources  
1155 Pilgrim Road  
Plymouth, WI 53073

**Re: Sample Results Notification:  
Heimes Garage  
3418 – 66<sup>th</sup> St.  
Kenosha, WI 53142  
PECFA# 53142-3443-18  
BRRTS# 03-30-409382**

Dear Mr. Delcore:

Midwest Environmental Consulting (MEC) is pleased to provide the following Sample Results Notification as required by Wisconsin Administrative Code (WAC) Chapter NR 716.14(2).

On March 31, 2020, groundwater samples were collected from monitoring wells at the above-referenced site, the Kenosha Steel Castings property adjacent to the east at 3303 – 66<sup>th</sup> Street and the Nardi Properties, LLC property at 6606 – 34<sup>th</sup> Avenue, also known as the Yutka Storage site, Bureau of Remediation and Redevelopment Tracking System (BRRTS) number: 02-30-578109. The samples were analyzed for volatile organic compounds (VOCs) or petroleum VOCs (PVOCs) plus naphthalene. The sampling was conducted as part of the Heimes Garage environmental site investigation to determine the degree and extent of petroleum soil and groundwater contamination exceeding applicable standards that is associated with the past presence of petroleum underground and aboveground storage tanks at the site. The sampling locations are depicted on the attached Figure 1.

The groundwater sample laboratory results revealed contaminant concentrations exceeding groundwater quality standards (GQSs) at five of the eight wells. The laboratory results are summarized on the attached table. The laboratory report is attached.

MEC considers the extent of petroleum soil and groundwater contamination at the Heimes site to be defined. Chlorinated VOC (CVOC) groundwater contamination exceeding GQSs is present on all three of the above-referenced properties. However, the Heimes Garage site is not the source property for the CVOC groundwater contamination.



In accordance with WAC Chapter NR 714.05 (5), additional information can be made and requests for site or facility specific responses can be submitted to the WDNR in accordance with procedures that can be found here: [http://docs.legis.wisconsin.gov/code/admin\\_code/nr/700/714/05/5](http://docs.legis.wisconsin.gov/code/admin_code/nr/700/714/05/5). Contact information for the site is as follows:

Responsible Party  
Michael Zacker  
Talman Ventures, LLC  
4515 Washington Rd.  
Kenosha, WI 53144  
(262) 308-3663

Wisconsin Department of Natural Resources  
Lee Delcore  
(920) 893-8524

If you have any questions or need additional information please contact me at (262) 237-4351.

Sincerely,

  
Sean Cranley, P.G.  
Principal Hydrogeologist

Cc: Michael Zacker

Gary Lento  
3418 – 66<sup>th</sup> St.  
Kenosha, WI 53142  
(262) 349-5344

Kenosha Steel Castings  
Alan Floyd  
3303 – 66<sup>th</sup> St.  
Kenosha, WI 53142  
(262) 657-8040

Nardi Properties, LLC  
Lucas Nardi  
6606 – 34<sup>th</sup> Ave.  
Kenosha, WI 53142  
(906) 360-2543

- ☒ Groundwater Monitoring Well Location - MEC 2020 - Heimes
- Soil Boring & Groundwater Grab Sampling Location - MEC 2019 - Heimes
- Soil Boring & Groundwater Sampling Location - MEC 2016 - Yutka
- Soil Boring & Groundwater Sampling Location - MEC 2017 & 2018 - Yutka

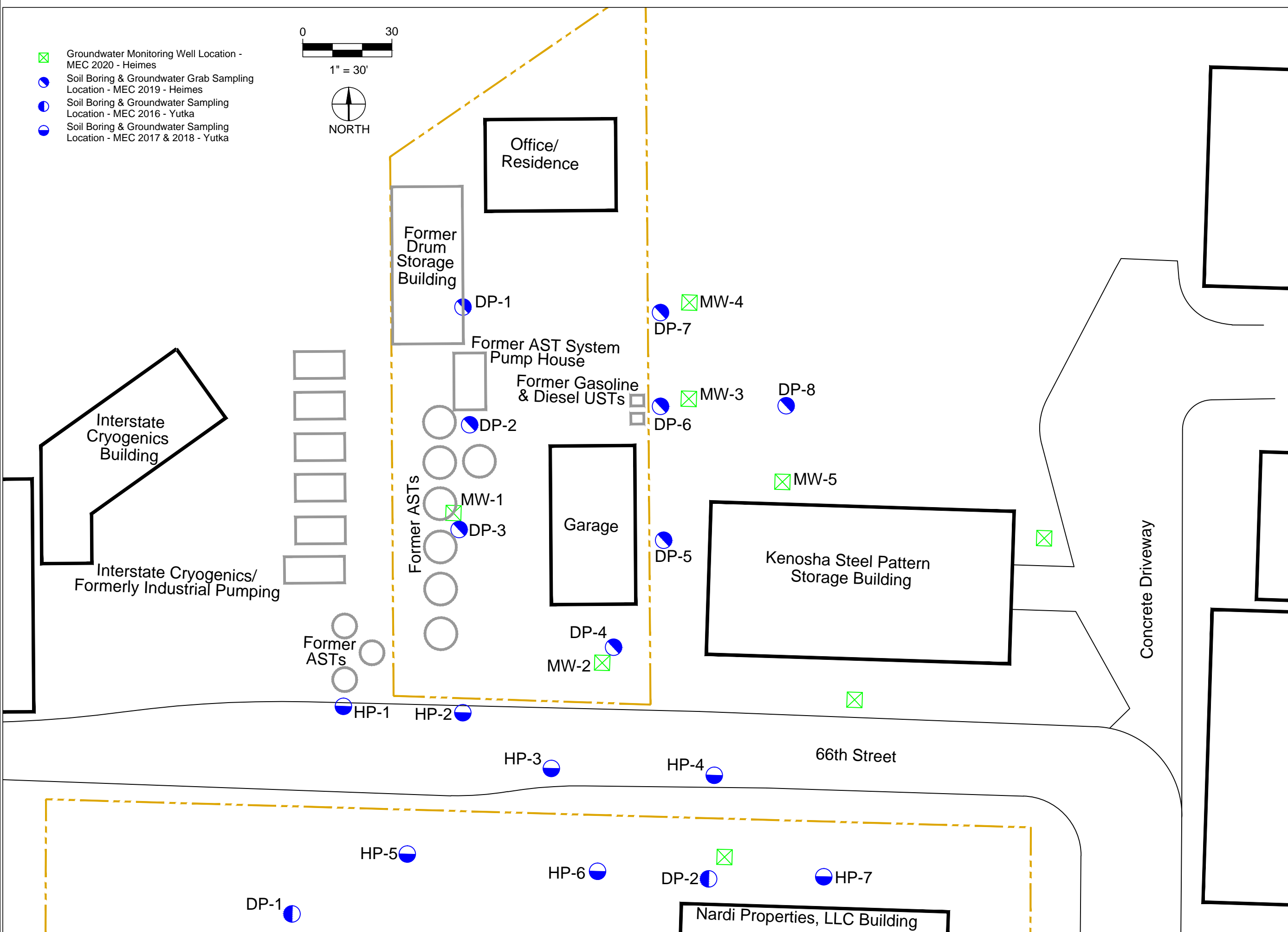
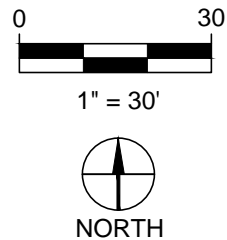

**FIGURE 1**  
**SITE CONFIGURATION**  
**MAP**

**HEIMES GARAGE**  
66TH STREET  
KENOSHA, WI

Approved By: <b>S. CRANLEY</b>	Figure <b>1</b>
Date Approved: 4/10/2020	1 of 1
Date Drawn: 4/10/2020	
Drawn by: <b>R. SCHWARTZ</b>	

**Table 1 (Page 1 of 2)**  
**Groundwater Analytical Results Table**  
**Heimes Garage**  
**3418 66th Street**  
**Kenosha, WI**

Parameters	Groundwater Quality Standards										PAL	ES	
	MW-1		MW-2		MW-3		MW-4		MW-5				
	1/29/20	3/31/20	1/29/20	3/31/20	1/29/20	3/31/20	1/29/20	3/31/20	1/29/20	3/31/20			
<b>VOCs (ug/l)</b>												ug/l	ug/l
Benzene	<b>7.6</b>	<b>27.6</b>	0.42	<0.25	<0.25	<b>4.7</b>	<0.25	<0.25	<0.25	<0.25	0.5	5	
n-Butylbenzene	0.74	NA	<0.71	NA	<0.71	NA	<0.71	NA	<0.71	NA	NS	NS	
sec-Butylbenzene	0.93	NA	<0.85	NA	<0.85	NA	<0.85	NA	<0.85	NA	NS	NS	
tert-Butylbenzene	1.2	NA	<0.30	NA	<0.30	NA	<0.30	NA	<0.30	NA	NS	NS	
1,2-Dichloroethane	<b>3.4</b>	NA	<0.28	NA	<0.28	NA	<0.28	NA	<0.28	NA	0.5	5	
cis-1,2-Dichloroethene	<0.27	NA	<b>0.90</b>	NA	<0.27	NA	<0.27	NA	<0.27	NA	7	70	
trans-1,2-Dichloroethene	<1.1	NA	<1.1	NA	<1.1	NA	<1.1	NA	<1.1	NA	20	100	
Diisopropyl ether	3.4	NA	<1.9	NA	<1.9	NA	<1.9	NA	<1.9	NA	NS	NS	
Ethylbenzene	0.29	<b>0.94</b>	<0.22	<0.32	<0.22	<b>0.38</b>	<0.22	<0.32	<0.22	<0.32	140	700	
Isopropylbenzene (Cumene)	3.0	NA	<b>0.93</b>	NA	<0.39	NA	<0.39	NA	<0.39	NA	NS	NS	
p-Isopropyltoluene	<0.80	NA	<0.80	NA	<0.80	NA	<0.80	NA	<0.80	NA	NS	NS	
Methyl-tert-butyl-ether	3.6	<b>2.2</b>	<b>95.8</b>	<b>9.3</b>	<b>33.3</b>	<b>123</b>	<1.2	<1.2	<b>167</b>	<b>94.4</b>	12	60	
Naphthalene	7.5	<b>44.2</b>	<1.2	<1.2	<1.2	<1.2	<1.2	<1.2	<1.2	<1.2	10	100	
n-Propylbenzene	3.9	NA	<0.81	NA	<0.81	NA	<0.81	NA	<0.81	NA	NS	NS	
Toluene	0.25	<b>0.72</b>	<0.17	<0.27	<0.17	<0.27	<0.17	<0.27	<0.17	<0.27	160	800	
Trichloroethene	<0.26	NA	<0.26	NA	<0.26	NA	<0.26	NA	<0.26	NA	0.5	5	
Vinyl Chloride	<0.17	NA	<b>0.38</b>	NA	<0.17	NA	<0.17	NA	<0.17	NA	0.02	0.2	
Xylenes	1.0	1.4	<0.73	<0.73	<0.73	<0.73	<0.73	<0.73	<0.73	<0.73	400	2000	

**Notes:**

Table includes detected analytes only, which are right justified in the columns.

*Italic type* indicates concentration exceeds PAL.

**Bold type** indicates concentration exceeds ES.

**VOCs** - Volatile Organic Compounds

**PAL** - NR 140 Preventive Action Limit

**ES** - NR 140 Enforcement Standard

**NS** - No Standard

**Table 1 (Page 2 of 2)**  
**Groundwater Analytical Results Table**  
**Heimes Garage**  
**3418 66th Street**  
**Kenosha, WI**

Parameters	Groundwater Quality Standards				
	MW-6 3/31/20	MW-7 3/31/20	MW-8 3/31/20	PAL	ES
<b>VOCs (ug/l)</b>				ug/l	ug/l
Benzene	<0.25	<0.25	<0.25	0.5	5
n-Butylbenzene	<0.71	<0.71	<0.71	NS	NS
sec-Butylbenzene	<0.85	<0.85	<0.85	NS	NS
tert-Butylbenzene	<0.30	<0.30	<0.30	NS	NS
1,2-Dichloroethane	<0.28	<0.28	<0.28	0.5	5
cis-1,2-Dichloroethene	<0.27	<b>5.1</b>	<0.27	7	70
trans-1,2-Dichloroethene	<0.46	<0.46	<0.46	20	100
Diisopropyl ether	<1.9	<1.9	<1.9	NS	NS
Ethylbenzene	<0.32	<0.32	<0.32	140	700
Isopropylbenzene (Cumene)	<1.7	<1.7	<1.7	NS	NS
p-Isopropyltoluene	<0.80	<0.80	<0.80	NS	NS
Methyl-tert-butyl-ether	<1.2	<1.2	<1.2	12	60
Naphthalene	<1.2	<1.2	<1.2	10	100
n-Propylbenzene	<0.81	<0.81	<0.81	NS	NS
Tetrachloroethene	<0.33	<b>1.1</b>	<b>0.58</b>	0.5	5
Toluene	<0.27	<0.27	<0.27	160	800
Trichloroethene	<0.26	<b>0.36</b>	<0.26	0.5	5
Vinyl Chloride	<0.17	<0.17	<0.17	0.02	0.2
Xylenes	<0.73	<0.73	<0.73	400	2000

**Notes:**

Table includes detected analytes only, which are right justified in the columns.

*Italic type* indicates concentration exceeds PAL.

**Bold type** indicates concentration exceeds ES.

**VOCs** - Volatile Organic Compounds

**PAL** - NR 140 Preventive Action Limit

**ES** - NR 140 Enforcement Standard

**NS** - No Standard