PREPARED BY

EnviroForensics, LLC
N16W23390 Stone Ridge Drive, Suite G
Waukesha, WI 53188



February 9, 2022

Max and Karin Hermans
Thompson Photo Imagery
114 High Avenue
Oshkosh, Wisconsin 54901

Subject: Environmental Investigation Sampling Results
BRRTS#: 02-71-467002

Dear Mr. and Mrs. Hermans:

In accordance with the executed Agreement to Provide Access for Sampling Activities, and in accordance with Wisconsin Department of Natural Resources (WDNR) regulation NR 716.14, EnviroForensics, LLC is providing the results of environmental samples collected from your property located at 114 High Avenue, Oshkosh, Wisconsin. The samples were collected on January 26, 2022. The sampling activities are part of an environmental investigation being performed for the Gunderson Cleaners facility formerly located at 118 High Avenue at the direction of the WDNR pursuant to the authority granted to it under State and Federal law. The chemicals of concern for the investigation are the dry cleaning solvent tetrachloroethene (PCE) and its associated breakdown products.

The Responsible Party is:

Gunderson Cleaners
41 Main Street
Menasha, WI 54952
920-727-4000

Sampling Results

Two (2) sub-slab vapor samples designated 200017-VP-H and 200017-VP-I were collected from the lower level and first floor of your building, respectively. The approximate sampling locations are depicted on the attached figure. Indoor air sample 200017-114-IA-1 was collected from the first floor. The results of the vapor and air samples are summarized and compared to WDNR standards on the attached table. The laboratory report that relates to the vapor and air samples are also attached.

Document: 200017-0255

N16 W23390 Stone Ridge Drive, Suite G, Waukesha, WI 53188 | P: 262-290-4001 | enviroforensics.com

As shown on the attached table, the chemicals of concern were not detected in the indoor air samples collected on January 26, 2022. Sub-slab vapor sample VP-I contained PCE at a concentration well below the vapor risk screening level established by WDNR for use in evaluating chemical concentrations at sites such as this.

At this time we do not anticipate any further sampling, unless directed by WDNR. If you have any questions or concerns, please contact me at 262-745-5054 or by email at bkappen@enviroforensics.com. The WDNR project manager, Kevin McKnight, can be reached at 920-808-0170. We greatly appreciate your help and patience with this matter.

Sincerely,
EnviroForensics, LLC

A handwritten signature in blue ink, appearing to read "Brian Kappen".

Brian Kappen, PG
Project Manager

Copy: Kevin McKnight, Wisconsin Department of Natural Resources

Attachments: Sample Location Map
Results Summary Table
Laboratory Analytical Report



Legend

	Property boundary
	Former building
	Sub-slab vapor sample port

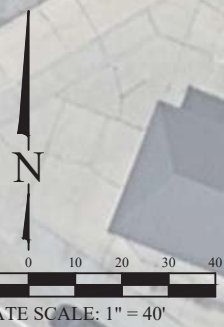

SUB-SLAB VAPOR SAMPLE LOCATIONS

Former Gunderson Cleaners
118 High Avenue
Oshkosh, Wisconsin

Date:	3/10/21
Designed:	EB
Drawn:	EB
Checked:	BK
DWG file:	200017-0126



825 North Capitol Avenue • Indianapolis, IN 46204
EnviroForensics.com

Figure	2
Project	200017

TABLE 1
VAPOR INTRUSION ASSESSMENT RESULTS SUMMARY

Former Gunderson Cleaners
 118 High Ave, Oshkosh, Wisconsin

Address	Sample Identification	Sample Location	Exposure Criteria	Sample Date	Tetrachloroethene	Trichloroethene	cis-1,2-Dichloroethene	trans-1,2-Dichloroethene	Vinyl Chloride
INDOOR/OUTDOOR AIR									
Small Commercial Vapor Action Level					180	8.8	NE	180	28
114 High Ave	114-IA-1	First Floor	Small Commercial	6/24/2021	<3.19	<1.07	<19.8	<39.6	<1.28
				1/26/2022	<3.19	<1.07	<19.8	<39.6	<1.28
SUB-SLAB VAPOR									
Small Commercial Vapor Risk Screening Level					5,800	290	NE	5,800	930
114 High Ave	VP-H	Lower Level	Small Commercial	6/23/2021	4,940	73.1	70.5	<39.6	<1.28
				1/26/2022	<31.9	10.7	<198	<396	<12.8
	VP-I	First Floor		6/23/2021	23.0	8.11	<19.8	<39.6	<1.28
				1/26/2022	34.6	<10.7	<198	<396	<12.8

Notes:

Vapor Action and Risk Screening Levels are calculated according to WDNR Publication RR-800 and subsequent vapor intrusion guidance
 Results reported in micrograms per cubic meter ($\mu\text{g}/\text{m}^3$)

Samples analyzed according to EPA Method TO-15

NE = Screening/action level not established

Bolded values are above detection limits

Bolded and shaded values exceed the applicable screening or action level



EnvisionAir
1441 Sadler Circle West Drive
Indianapolis, IN 46239
Ph: 317-351-0885
Fax: 317-351-0882
www.envision-air.com

Mr. Brian Kappen
Enviroforensics
N16 W. 23390 Stone Ridge Dr
Suite G
Waukesha, WI 53188

February 7, 2022

EnvisionAir Project Number: 2022-76
Client Project Name: 200017 – Oshkosh Gundersons

Dear Mr. Kappen,

Please find the attached analytical report for the samples received January 28, 2022. All test methods performed were fully compliant with local, state, and federal EPA methods unless otherwise noted. The project was analyzed as requested on the enclosed chain of custody record. Please review the comments section for additional information about your results or Quality Control data.

Feel free to contact me if you have any questions or comments regarding your analytical report or service.

Thank you for your business. EnvisionAir looks forward to working with you on your next project.

Yours Sincerely,

A handwritten signature in black ink that reads "David Norris". The signature is written in a cursive, flowing style.

David Norris
Project Manager
EnvisionAir, LLC



EnvisionAir
 1441 Sadlier Circle West Drive
 Indianapolis, IN 46239
 Ph: 317-351-0885
 Fax: 317-351-0882
 www.envision-air.com

Client Name: ENVIROFORENSICS
Project ID: 200017 - OSHKOSH GUNDERSONS
Client Project Manager: BRIAN KAPPEN
EnvisionAir Project Number: 2022-76

Sample Summary

Canister Pressure / Vacuum

<u>Laboratory Sample Number:</u>	<u>Sample Description:</u>	<u>Matrix:</u>	<u>START</u>	<u>START</u>	<u>End Date</u>	<u>End Time</u>	<u>Date</u>	<u>Time</u>	<u>Canister Pressure / Vacuum</u>		<u>Lab</u>
			<u>Date</u>	<u>Time</u>					<u>Initial Field</u>	<u>Final Field</u>	
			<u>Collected:</u>	<u>Collected:</u>	<u>Collected:</u>	<u>Collected:</u>	<u>Received:</u>	<u>Received:</u>	<u>(in. Hg)</u>	<u>(in. Hg)</u>	<u>(in. Hg)</u>
22-407	200017-114-IA-1	A	1/26/22	8:00	1/26/22	15:50	1/28/22	14:00	-29	-9	-9
22-408	200017-114-VP-I	A	1/26/22	16:00	1/26/22	16:05	1/28/22	14:00	-29	-3	-3
22-409	200017-114-VP-H	A	1/26/22	16:15	1/26/22	16:20	1/28/22	14:00	-27	-3	-3



EnvisionAir
1441 Sadler Circle West Drive
Indianapolis, IN 46239
Ph: 317-351-0885
Fax: 317-351-0882
www.envision-air.com

Client Name: ENVIROFORENSICS
Project ID: 200017 - OSHKOSH GUNDERSONS
Client Project Manager: BRIAN KAPPEN
EnvisionAir Project Number: 2022-76

Analytical Method: TO-15
Analytical Batch: 020122AIR(1)

Client Sample ID: 20017-114-IA-1

EnvisionAir Sample Number: 22-407
Sample Matrix: AIR

Sample Collection START Date/Time: 1/26/22 8:00
Sample Collection END Date/Time: 1/26/22 15:50
Sample Received Date/Time: 1/28/22 14:00

<u>Compounds</u>	<u>Sample Results ug/m³</u>	<u>Reporting Limit ug/m³</u>	<u>Flag</u>
cis-1,2-Dichloroethene	< 19.8	19.8	
Tetrachloroethene	< 3.19	3.19	
trans-1,2-Dichloroethene	< 39.6	39.6	
Trichloroethene	< 1.07	1.07	
Vinyl Chloride	< 1.28	1.28	
4-bromofluorobenzene (surrogate)	106%		
Analysis Date/Time:	2-1-22/20:47		
Analyst Initials	tjg		



EnvisionAir
 1441 Sadler Circle West Drive
 Indianapolis, IN 46239
 Ph: 317-351-0885
 Fax: 317-351-0882
 www.envision-air.com

Client Name: ENVIROFORENSICS
Project ID: 200017 - OSHKOSH GUNDERSONS
Client Project Manager: BRIAN KAPPEN
EnvisionAir Project Number: 2022-76

Analytical Method: TO-15
Analytical Batch: 020122AIR(2)

Client Sample ID: 20017-114-VP-I
EnvisionAir Sample Number: 22-408
Sample Matrix: AIR

Sample Collection START Date/Time: 1/26/22 16:00
Sample Collection END Date/Time: 1/26/22 16:05
Sample Received Date/Time: 1/28/22 14:00

<u>Compounds</u>	<u>Sample Results ug/m³</u>	<u>Reporting Limit ug/m³</u>	<u>Flag</u>
cis-1,2-Dichloroethene	< 198	198	
Tetrachloroethene	34.6	31.9	
trans-1,2-Dichloroethene	< 396	396	
Trichloroethene	< 10.7	10.7	
Vinyl Chloride	< 12.8	12.8	
4-bromofluorobenzene (surrogate)	103%		
Analysis Date/Time:	2-2-22/21:26		
Analyst Initials	tjg		



EnvisionAir
1441 Sadler Circle West Drive
Indianapolis, IN 46239
Ph: 317-351-0885
Fax: 317-351-0882
www.envision-air.com

Client Name: ENVIROFORENSICS
Project ID: 200017 - OSHKOSH GUNDERSONS
Client Project Manager: BRIAN KAPPEN
EnvisionAir Project Number: 2022-76

Analytical Method: TO-15
Analytical Batch: 020122AIR(2)

Client Sample ID: 20017-114-VP-H
EnvisionAir Sample Number: 22-409
Sample Matrix: AIR

Sample Collection START Date/Time: 1/26/22 16:15
Sample Collection END Date/Time: 1/26/22 16:20
Sample Received Date/Time: 1/28/22 14:00

<u>Compounds</u>	<u>Sample Results ug/m³</u>	<u>Reporting Limit ug/m³</u>	<u>Flag</u>
cis-1,2-Dichloroethene	< 198	198	
Tetrachloroethene	< 31.9	31.9	
trans-1,2-Dichloroethene	< 396	396	
Trichloroethene	< 10.7	10.7	
Vinyl Chloride	< 12.8	12.8	
4-bromofluorobenzene (surrogate)	97%		
Analysis Date/Time:	2-2-22/23:41		
Analyst Initials	tjg		

TO-15 Quality Control Data

EnvisionAir Batch Number: 020122AIR(1)

<u>Method Blank (MB):</u>	<u>MB Results (ppbv)</u>	<u>Reporting Limit (ppbv)</u>	<u>Flags</u>
cis-1,2-Dichloroethene	< 5	5	
Tetrachloroethene	< 0.47	0.47	
trans-1,2-Dichloroethene	< 10	10	
Trichloroethene	< 0.2	0.2	
Vinyl Chloride	< 0.5	0.5	
4-bromofluorobenzene (surrogate)	96%		
Analysis Date/Time:	2-1-22/13:45		
Analyst Initials	tjg		

<u>LCS/LCSD</u>	<u>LCS Results (ppbv)</u>	<u>LCSD Results (ppbv)</u>	<u>LCS/D Conc(ppbv)</u>	<u>LCS Rec.</u>	<u>LCSD Rec.</u>	<u>RPD</u>	<u>Flag</u>
Vinyl Chloride	9.9	9.69	10	99%	97%	2.1%	
trans-1,2-Dichloroethene	8.59	9.94	10	86%	99%	14.6%	
cis-1,2-Dichloroethene	11.5	10.4	10	115%	104%	10.0%	
Trichloroethene	10.3	10.5	10	103%	105%	1.9%	
Tetrachloroethene	9.7	8.62	10	97%	86%	11.8%	
4-bromofluorobenzene (surrogate)	103%	93%					
Analysis Date/Time:	2-1-22/12:17	2-1-22/13:07					
Analyst Initials	tjg	tjg					

TO-15 Quality Control Data

EnvisionAir Batch Number: 020122AIR(2)

<u>Method Blank (MB):</u>	<u>MB Results (ppbv)</u>	<u>Reporting Limit (ppbv)</u>	<u>Flags</u>
cis-1,2-Dichloroethene	< 5	5	
Tetrachloroethene	< 0.47	0.47	
trans-1,2-Dichloroethene	< 10	10	
Trichloroethene	< 0.2	0.2	
Vinyl Chloride	< 0.5	0.5	
4-bromofluorobenzene (surrogate)	100%		
Analysis Date/Time:	2-2-22/13:40		
Analyst Initials	tjg		

<u>LCS/LCSD</u>	<u>LCS Results (ppbv)</u>	<u>LCSD Results (ppbv)</u>	<u>LCS/D Conc(ppbv)</u>	<u>LCS Rec.</u>	<u>LCSD Rec.</u>	<u>RPD</u>	<u>Flag</u>
Vinyl Chloride	9.61	9.48	10	96%	95%	1.4%	
trans-1,2-Dichloroethene	9.87	10.2	10	99%	102%	3.3%	
cis-1,2-Dichloroethene	10.6	10.4	10	106%	104%	1.9%	
Trichloroethene	9.83	10.8	10	98%	108%	9.4%	
Tetrachloroethene	9.25	9.44	10	93%	94%	2.0%	
4-bromofluorobenzene (surrogate)	94%	103%					
Analysis Date/Time:	2-2-22/12:20	2-2-22/13:02					
Analyst Initials	tjg	tjg					



EnvisionAir
1441 Sadler Circle West Drive
Indianapolis, IN 46239
Ph: 317-351-0885
Fax: 317-351-0882
www.envision-air.com

Flag Number

Comments

CHAIN OF CUSTODY RECORD

EnvisionAir | 1441 Sadler Circle West Drive | Indianapolis, IN 46239 | Phone: (317) 351-0885 | Fax: (317) 351-0882

Client: <u>EnviroForensics</u>	P.O. Number: <u>2021-0808</u>
Report Address: <u>bkappene@enviroforensics.com</u>	Project Name or Number: <u>200017 Oshkosh Gundersons</u>
Report To: <u>Brian Kappen</u>	Sampled by: <u>R Brown</u>
Phone: <u>262-290-4001</u>	QA/QC Required: (circle if applicable) Level III Level IV
Invoice Address: <u>accounts payable@enviroforensics.com</u>	Reporting Units needed: (circle) <u>ug/m³</u> mg/m ³ PPBV PPMV
Desired TAT: (Please Circle One) 1 day 2 days 3 days <u>Std (5 bus. days)</u>	Media type: 1LC = 1 Liter Canister 6LC = 6 Liter Canister TB = Tedlar Bag TD = Thermal Desorption Tube

REQUESTED PARAMETERS

TO-15 Full List

TO-15 Short List (Specify in notes)



Sampling Type:
 Soil-Gas:
 Sub-Slab:
 Indoor-Air:

www.envision-air.com

Canister Pressure / Vacuum

Air Sample ID	Media Type <small>(see code above)</small>	Coll. Date <small>(Grab/Comp Start)</small>	Coll. Time <small>(Grab/Comp Start)</small>	Coll. Date <small>(Comp. End)</small>	Coll. Time <small>(Comp. End)</small>				Canister Serial #	Flow Controller Serial #	Initial Field (in. Hg)	Final Field (in. Hg)	Lab Received (in. Hg)	EnvisionAir Sample Number
200017-114-1A-1	6LC	1-26-22	800	1-26-22 1630	1550		X		112060	07752	-29	-9	-9	22-407
200017-114-VP-I	1LC	↓	1600	↓	1605		↓		83945	0046	-29	-3	-3	22-408
200017-114-VP-II	1LC	↓	1615	↓	1620		↓		20941	0080	-27	-3	-3	22-409

Comments: Short List: PCE, TCE, CDCE, EDCE, VC

Relinquished by:	Date	Time	Received by:	Date	Time
<u>[Signature]</u>	1-27-22	1630	FedEX	1-27-22	1630
			<u>Y. Daulton</u>	1-28-22	1400