

MW-3		
Sample Depth (bgs)	2'-4'	4'-6'
Date	6/29/04	6/29/04
No CVOCs above detection limits		

GP-1	
Sample Depth (bgs)	1'-3'
Date	6/25/03
No CVOCs above detection limits	

HA-1	
Sample Depth (bgs)	1'-3'
Date	6/25/03
Tetrachloroethene	1,380

HA-2	
Sample Depth (bgs)	1'-3'
Date	6/25/03
Tetrachloroethene	850

GP-2		
Sample Depth (bgs)	1'-3'	7'-9'
Date	6/25/03	6/25/03
Trichloroethene	<25	26.7

GP-102		
Sample Depth (bgs)	2'-4'	5'-6'
Date	6/10/05	6/10/05
No CVOCs above detection limits		

SB-2	
Sample Depth (bgs)	2'-4'
Date	6/28/04
No CVOCs above detection limits	

GP-101		
Sample Depth (bgs)	2'-4'	6'-6.5'
Date	6/10/05	6/10/05
No CVOCs above detection limits		

SB-106		
Sample Depth (bgs)	5'-7'	11'-13'
Date	5/17/05	5/17/05
Tetrachloroethene	6,200	1,000

SB-108		
Sample Depth (bgs)	5'-7'	9'-11'
Date	5/17/05	5/17/05
Tetrachloroethene	290	<35

SB-101		
Sample Depth (bgs)	11'-13'	17'-19'
Date	5/16/05	5/16/05
No CVOCs above detection limits		

MW-4			
Sample Depth (bgs)	2'-4'	4'-6'	10'-12'
Date	6/29/04	6/29/04	6/29/04
Tetrachloroethene	<25	97	<100

MW-5		
Sample Depth (bgs)	4'-6'	10'-12'
Date	6/29/04	6/29/04
Tetrachloroethene	230	<25

SB-102		
Sample Depth (bgs)	13'-15'	19'-21'
Date	5/16/05	5/16/05
No CVOCs above detection limits		

SB-103		
Sample Depth (bgs)	13'-15'	19'-21'
Date	5/16/05	5/16/05
No CVOCs above detection limits		

SB-104		
Sample Depth (bgs)	9'-11'	15'-17'
Date	5/16/05	5/16/05
Tetrachloroethene	590	46

SB-105		
Sample Depth (bgs)	13'-15'	19'-21'
Date	5/16/05	5/16/05
No CVOCs above detection limits		

SB-107		
Sample Depth (bgs)	9'-11'	13'-15'
Date	5/17/05	5/17/05
Tetrachloroethene	820	<29

SB-1		
Sample Depth (bgs)	4'-6'	10'-12'
Date	6/10/04	6/10/04
Tetrachloroethene	3,500	1000

SB-109		
Sample Depth (bgs)	7'-9'	11'-13'
Date	5/17/05	5/17/05
No CVOCs above detection limits		

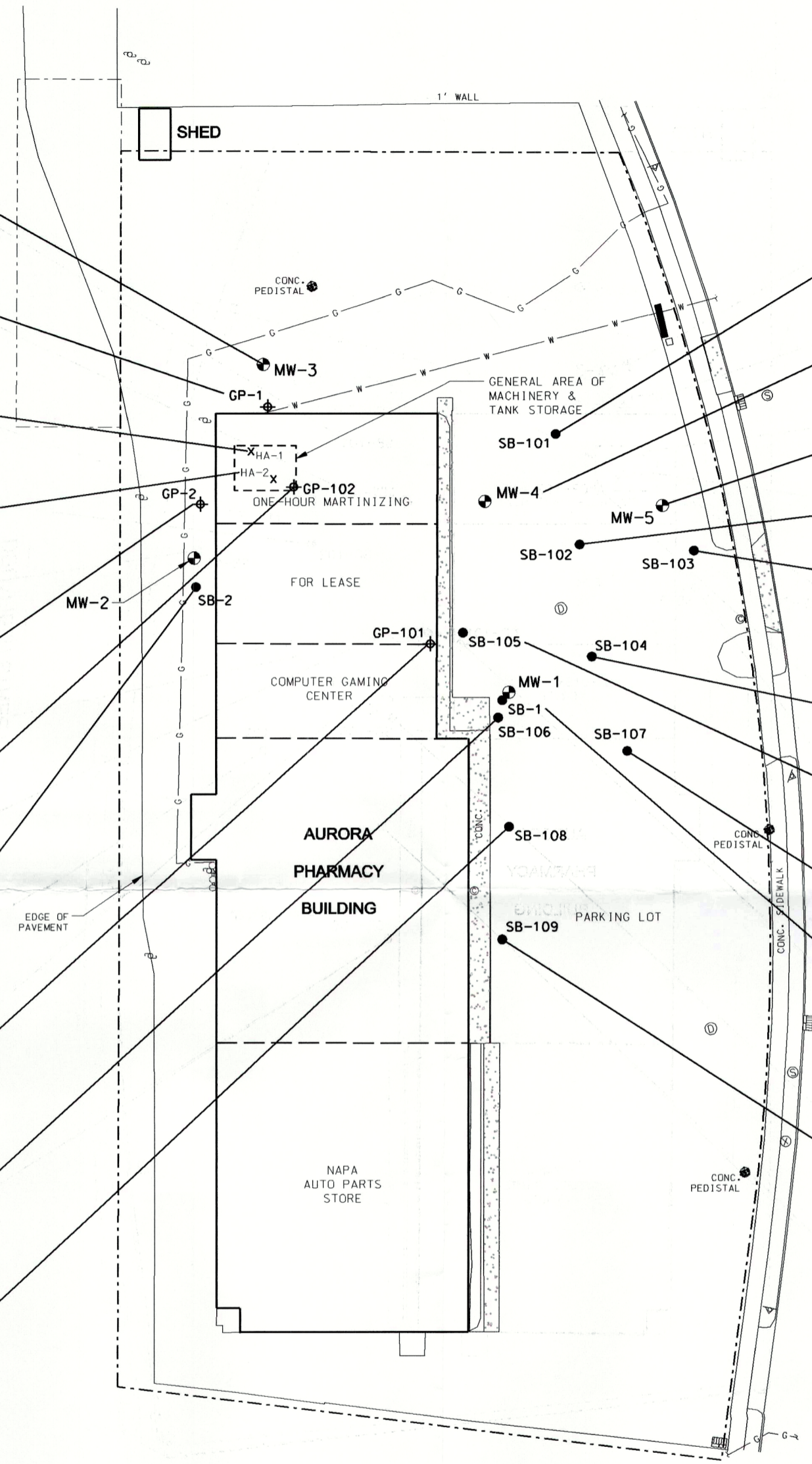

**LEGEND**

- GP-⊕ = GEOPROBE SOIL BORING
- MW-⊕ = MONITORING WELL
- SB-⊕ = SOIL BORING
- GP-⊕ = GEOPROBE
- HA X = HAND AUGER BORING
- ⊕ = MANHOLE
- ⊕ = INLET
- ∨ = SIGN
- ⊕ = POLE
- ⊕ = UTILITY BOX
- G — = UNDERGROUND GAS
- W — = UNDERGROUND WATER
- - - - - = PROPERTY LINE

NOTES:  
 1. MAP BASED ON SURVEY COMPLETED BY WELCH HANSON DATED AUGUST 18, 2004.  
 2. INTERIOR BUILDING WALLS NOT INCLUDED IN SURVEY.  
 3. BORINGS SB-101-SB-109 AND GP-101-GP-102 BASED ON FIELD MEASUREMENTS.

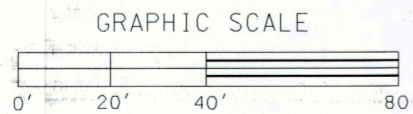

**Analytical Key**

ND = Not detected      NA = Not analyzed      CVOCs = chlorinated Volatile Organic Compounds

Concentrations = µg/kg, unless otherwise noted

Exceedances: **bold** = groundwater protection exceedance  
**bold, box** = groundwater & inhalation of volatiles exceedance

Only concentrations of chlorinated VOCs included in this figure.



NAME:	DATE:
DRAWN BY: BEB	7-11-05
DESIGNED BY:	
CHECKED BY:	
APPROVED BY:	

**GRASER TURKS**  
**310 DELAFIELD STREET, WAUKESHA, WI**  
**SOIL QUALITY MAP (CVOCs)**

0268494990A  
 1-148  
 20050718

DRAWING NUMBER  
 8771-008  
**FIGURE 6**