



October 16, 2020

Kenneth Fennewald
122 West Mullet Street
Portage, WI 53901

**Subject: Vapor Intrusion Sampling Results – 122 Mullet Street, Portage, Wisconsin
BRRTS: 02-11-512824**

Dear Mr. Fennewald:

In accordance with the executed Agreement to Provide Access for Sampling Activities, and in accordance with Wisconsin Department of Natural Resources (WDNR) regulation NR 716.14, EnviroForensics, LLC. (EnviroForensics) is providing the results of environmental samples collected from your property located at 122 Mullet Street in Portage, Wisconsin. The samples were collected on September 29-30, 2020. The sampling activities are part of an environmental investigation being performed for the Portage Cleaners facility located at 104 West Wisconsin Street in Portage at the direction of the WDNR pursuant to the authority granted to it under State and Federal law. The chemicals of concern for the investigation are the dry cleaning solvent tetrachloroethene (PCE) and its associated breakdown products.

The Responsible Party is:

Portage Cleaners
104 West Wisconsin Street
Portage, WI

Sampling Results

Two indoor air samples designated 6493-122 Mullet-IA-C and 6493-122 Mullet-IA-1 were collected from within the crawl space and first floor, respectively. A second-floor sample was not collected due a faulty cannister. For quality control purposes a sample of outdoor ambient air designated 6493-122 Mullet-OA-1 was collected. No compounds of concern were detected in any of the samples.

The sampling locations are depicted on the attached **Figure 1**. The results of the vapor samples are summarized and compared to WDNR standards on the attached **Table 1**. A copy of the laboratory report that relates to the vapor samples is also attached.

Document: 6493-0670
EnviroForensics, LLC
N16 W23390 Stone Ridge Drive, Suite G
Waukesha, WI 53188
Phone: 262-290-4001 • Fax 317.972.7875

October 16, 2020

We anticipate scheduling the second of three sampling events for December. If you have any questions or concerns, please contact me by email at rhoverman@enviroforensics.com or by telephone at 262-510-0612 or. The WDNR project manager, Larry Lester, can be reached at 608-275-3465. We greatly appreciate your help and patience with this matter.

Sincerely,
EnviroForensics, LLC

Rob Hoverman, LPG
Senior Project Manager

A handwritten signature in blue ink, appearing to read "Rob Hoverman".

Attachments: Figure 1 – Vapor Intrusion Sampling Locations
Table 1 – Vapor Intrusion Assessment Results Summary
Laboratory Analytical Report

Copy: Larry Lester, Wisconsin Department of Natural Resources

FIGURE 1
VAPOR INTRUSION SAMPLE LOCATIONS
122 Mullet Street, Portage Wisconsin

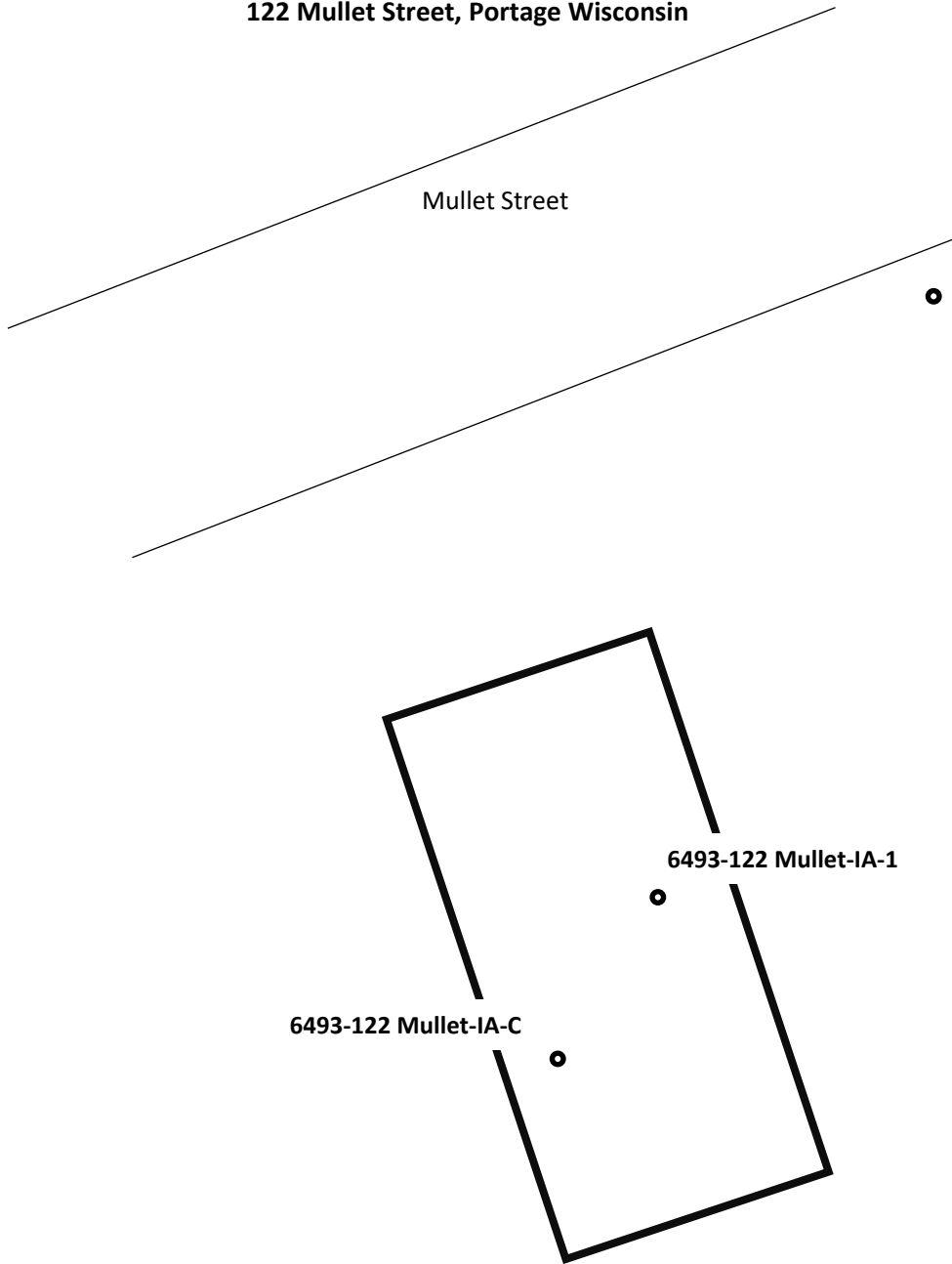

Legend

- = Indoor/Outdoor Air Sample
- IA-C = Crawl Space
- IA-1 = 1st Floor



TABLE 1
VAPOR INTRUSION ASSESSMENT ANALYTICAL RESULTS

Portage Cleaners
104 E. Wisconsin St
Portage, WI 53901

Sample Address	Sample Identification	Sample Date	Applicable Criteria	Mitigation	Tetrachloroethene	Trichloroethene	cis-1,2-Dichloroethene	trans-1,2-Dichloroethene	Vinyl chloride
INDOOR/OUTDOOR AIR									
Residential Vapor Action Limit²					42	2.1	NE	NE	1.7
Small Commercial Vapor Action Limit¹					180	8.8	NE	NE	28
122 W. Mullet St.	6493-122 Mullet-IA-C	09/30/20	Residential	No	<19.8	<1.07	<19.8	<39.6	<1.28
	6493-122 Mullet-IA-1	09/30/20		No	<19.8	<1.07	<19.8	<39.6	<1.28
	6493-OA-1	09/30/20		No	<19.8	<1.07	<19.8	<39.6	<1.28

Notes:

¹ The vapor risk screening levels for small commercial structures are calculated in accordance with the procedures described in WDNR Publication RR-800 and subsequent guidance

² The vapor risk screening levels for residential structures are calculated in accordance with the procedures described in WDNR Publication RR-800 and subsequent guidance

Samples analyzed according to EPA Method TO-15

All concentrations reported in units in micrograms per cubic meter = µg/m³

Only detected compounds are listed

Bolded values are above method detection limits

Bolded and blue shaded values exceed the residential Vapor Risk Screening Level

Bolded and orange shaded values exceed the small commercial Vapor Risk Screening Level

NE = Not Established

IA = Indoor Air

OA = Outdoor Air





EnvisionAir
1441 Sadler Circle West Drive
Indianapolis, IN 46239
Ph: 317-351-0885
Fax: 317-351-0882
www.envision-air.com

Mr. Rob Hoverman
Enviroforensics
N16 W. 23390 Stone Ridge Dr
Suite G
Waukesha, WI 53188

October 7, 2020

EnvisionAir Project Number: 2020-561
Client Project Name: 6493 - Portage

Dear Mr. Hoverman,

Please find the attached analytical report for the samples received October 2, 2020. All test methods performed were fully compliant with local, state, and federal EPA methods unless otherwise noted. The project was analyzed as requested on the enclosed chain of custody record. Please review the comments section for additional information about your results or Quality Control data.

Feel free to contact me if you have any questions or comments regarding your analytical report or service.

Thank you for your business. EnvisionAir looks forward to working with you on your next project.

Yours Sincerely,

A handwritten signature in black ink that reads "Stanley A. Hunnicutt".

Stanley A Hunnicutt

Project Manager
EnvisionAir, LLC



EnvisionAir
 1441 Sadlier Circle West Drive
 Indianapolis, IN 46239
 Ph: 317-351-0885
 Fax: 317-351-0882
 www.envision-air.com

Client Name: ENVIROFORENSICS
Project ID: PORTAGE 6493
Client Project Manager: ROB HOVERMAN
EnvisionAir Project Number: 2020-561

Sample Summary

Canister Pressure / Vacuum

<u>Laboratory Sample Number:</u>	<u>Sample Description:</u>	<u>Matrix:</u>	<u>START</u>	<u>START</u>	<u>End Date</u>	<u>End Time</u>	<u>Date</u>	<u>Time</u>	<u>Canister Pressure / Vacuum</u>		<u>Lab</u>
			<u>Date</u>	<u>Time</u>					<u>Initial Field</u>	<u>Final Field</u>	
			<u>Collected:</u>	<u>Collected:</u>	<u>Collected:</u>	<u>Collected:</u>	<u>Received:</u>	<u>Received:</u>	<u>(in. Hg)</u>	<u>(in. Hg)</u>	<u>(in. Hg)</u>
20-2613	6493-122 MULLET-IA-1	A	9/29/20	17:14	9/30/20	17:02	10/2/20	12:15	-29	-0.5	-0.5
20-2614	6493-122 MULLET-IA-C	A	9/29/20	17:16	9/30/20	17:04	10/2/20	12:15	-30	0	0
20-2615	6493-122 MULLET-OA-1	A	9/29/20	17:23	9/30/20	17:14	10/2/20	12:15	-28.5	0	0



EnvisionAir
 1441 Sadler Circle West Drive
 Indianapolis, IN 46239
 Ph: 317-351-0885
 Fax: 317-351-0882
 www.envision-air.com

Client Name: ENVIROFORENSICS

Project ID: PORTAGE 6493

Client Project Manager: ROB HOVERMAN

EnvisionAir Project Number: 2020-561

Analytical Method: TO-15
Analytical Batch: 100220AIR

Client Sample ID: 6493-122 MULLET-IA-1
EnvisionAir Sample Number: 20-2613
Sample Matrix: AIR

Sample Collection START Date/Time: 9/29/20 17:14
Sample Collection END Date/Time: 9/30/20 17:02
Sample Received Date/Time: 10/2/20 12:15

<u>Compounds</u>	<u>Sample Results ug/m³</u>	<u>Reporting Limit ug/m³</u>	<u>Flag</u>
cis-1,2-Dichloroethene	< 19.8	19.8	
Tetrachloroethene	< 3.19	3.19	
trans-1,2-Dichloroethene	< 39.6	39.6	
Trichloroethene	< 1.07	1.07	
Vinyl Chloride	< 1.28	1.28	
4-bromofluorobenzene (surrogate)	105%		
Analysis Date/Time:	10-3-20/04:54		
Analyst Initials	tjg		



EnvisionAir
 1441 Sadlier Circle West Drive
 Indianapolis, IN 46239
 Ph: 317-351-0885
 Fax: 317-351-0882
 www.envision-air.com

Client Name: ENVIROFORENSICS

Project ID: PORTAGE 6493

Client Project Manager: ROB HOVERMAN

EnvisionAir Project Number: 2020-561

Analytical Method: TO-15
Analytical Batch: 100220AIR

Client Sample ID: 6493-122 MULLET-IA-C **Sample Collection START Date/Time:** 9/29/20 17:16
Sample Collection END Date/Time: 9/30/20 17:04
EnvisionAir Sample Number: 20-2614 **Sample Received Date/Time:** 10/2/20 12:15
Sample Matrix: AIR

<u>Compounds</u>	<u>Sample Results ug/m³</u>	<u>Reporting Limit ug/m³</u>	<u>Flag</u>
cis-1,2-Dichloroethene	< 19.8	19.8	
Tetrachloroethene	< 3.19	3.19	
trans-1,2-Dichloroethene	< 39.6	39.6	
Trichloroethene	< 1.07	1.07	
Vinyl Chloride	< 1.28	1.28	
4-bromofluorobenzene (surrogate)	102%		
Analysis Date/Time:	10-3-20/06:22		
Analyst Initials	tjg		



EnvisionAir
 1441 Sadlier Circle West Drive
 Indianapolis, IN 46239
 Ph: 317-351-0885
 Fax: 317-351-0882
 www.envision-air.com

Client Name: ENVIROFORENSICS

Project ID: PORTAGE 6493

Client Project Manager: ROB HOVERMAN

EnvisionAir Project Number: 2020-561

Analytical Method: TO-15
Analytical Batch: 100220AIR

Client Sample ID: 6493-122 MULLET-OA-1
EnvisionAir Sample Number: 20-2615
Sample Matrix: AIR

Sample Collection START Date/Time: 9/29/20 17:23
Sample Collection END Date/Time: 9/30/20 17:14
Sample Received Date/Time: 10/2/20 12:15

<u>Compounds</u>	<u>Sample Results ug/m³</u>	<u>Reporting Limit ug/m³</u>	<u>Flag</u>
cis-1,2-Dichloroethene	< 19.8	19.8	
Tetrachloroethene	< 3.19	3.19	
trans-1,2-Dichloroethene	< 39.6	39.6	
Trichloroethene	< 1.07	1.07	
Vinyl Chloride	< 1.28	1.28	
4-bromofluorobenzene (surrogate)	95%		
Analysis Date/Time:	10-2-20/23:15		
Analyst Initials	tjg		

TO-15 Quality Control Data

EnvisionAir Batch Number: 100220AIR

<u>Method Blank (MB):</u>	<u>MB Results (ppbv)</u>	<u>Reporting Limit (ppbv)</u>	<u>Flags</u>
cis-1,2-Dichloroethene	< 5	5	
Tetrachloroethene	< 0.47	0.47	
trans-1,2-Dichloroethene	< 10	10	
Trichloroethene	< 0.2	0.2	
Vinyl Chloride	< 0.5	0.5	
4-bromofluorobenzene (surrogate)	102%		
Analysis Date/Time:	10-2-20/20:22		
Analyst Initials	tjg		

<u>LCS/LCSD</u>	<u>LCS Results (ppbv)</u>	<u>LCSD Results (ppbv)</u>	<u>LCS/D Conc(ppbv)</u>	<u>LCS Rec.</u>	<u>LCSD Rec.</u>	<u>RPD</u>	<u>Flag</u>
Vinyl Chloride	11.1	10.7	10	111%	107%	3.7%	
trans-1,2-Dichloroethene	8.06	9.31	10	81%	93%	14.4%	
cis-1,2-Dichloroethene	9.65	8.92	10	97%	89%	7.9%	
Trichloroethene	10.5	10.6	10	105%	106%	0.9%	
Tetrachloroethene	9.18	9.77	10	92%	98%	6.2%	
4-bromofluorobenzene (surrogate)	91%	99%					
Analysis Date/Time:	10-2-20/18:24	10-2-20/19:11					
Analyst Initials	tjg	tjg					



EnvisionAir
1441 Sadler Circle West Drive
Indianapolis, IN 46239
Ph: 317-351-0885
Fax: 317-351-0882
www.envision-air.com

Flag Number

Comments

CHAIN OF CUSTODY RECORD

EnvisionAir | 1441 Sadlier Circle West Drive | Indianapolis, IN 46239 | Phone: (317) 351-0885 | Fax: (317) 351-0882



www.envision-air.com

Client: ENVIRO FORENSICS
 Report Address: N16 W2390 STONE RIDGE WAUWATOSA, WI
 Report To: R. HOVERMAN
 Phone: 414 630 0060
 Invoice Address:
 Desired TAT: (Please Circle One) **1 day 2 days 3 days** Std (5 bus. days)

P.O. Number: 2020-1956
 Project Name or Number: PORTAGE 6493
 Sampled by: R. HOVERMAN
 QA/QC Required: (circle if applicable) Level III Level IV
 Reporting Units needed: (circle) ug/m³ mg/m³ PPBV PPMV

Media type: 1LC = 1 Liter Canister
 6LC = 6 Liter Canister
 TB = Tedlar Bag
 TD = Thermal Desorption Tube

REQUESTED PARAMETERS

TO-15 Full List
TO-15 Short List (Specify in notes)

Sampling Type:
 Soil-Gas:
 Sub-Slab:
 Indoor-Air:

Canister Pressure / Vacuum

Air Sample ID	Media Type (see code above)	Coll. Date (Grab/Comp Start)	Coll. Time (EST/Comp Start)	Coll. Date (Comp. End)	Coll. Time (Comp. End)	Canister Serial #	Flow Controller Serial #	Initial Field (in. Hg)	Final Field (in. Hg)	Lab Received (in. Hg)	EnvisionAir Sample Number
6493-122 MULLER-1K-1	6LC	9/29/20	1714	9/30/20	1702	11072	07943	-29	-0.5	-0.5	20-2613
6493-122 MULLER-1K-2	6LC		1716		1704	91444	05299	-30	0	Ø	20-2614
6493-122 MULLER-0K-1	6LC		1723		1714	19562	07438	-28.5	0	Ø	20-2615

Comments: NDC SHORT LIST PCU, TCE, cDCE, tDCE, VVC

Relinquished by: [Signature] Date: 10/1/2020 Time: 858
 Received by: [Signature] Date: 10/2/20 Time: 1215