



March 17, 2021

David Bieno
109 Mullet Street
Portage, WI 53901

**Subject: Vapor Intrusion Sampling Results – 105 Warren Street, Portage, Wisconsin
BRRTS: 02-11-512824**

Dear Mr. Bieno:

In accordance with the executed Agreement to Provide Access for Sampling Activities, and in accordance with Wisconsin Department of Natural Resources (WDNR) regulation NR 716.14, EnviroForensics, LLC. (EnviroForensics) is providing the results of environmental samples collected from your property located at 109 Mullet Street in Portage, Wisconsin. The samples were collected on March 2-3, 2021. The sampling activities are part of an environmental investigation being performed for the Portage Cleaners facility located at 104 West Wisconsin Street in Portage at the direction of the WDNR pursuant to the authority granted to it under State and Federal law. The chemicals of concern for the investigation are the dry cleaning solvent tetrachloroethene (PCE) and its associated breakdown products.

The Responsible Party is:

Portage Cleaners
104 West Wisconsin Street
Portage, WI

Sampling Results

Three indoor air samples designated 6493-109-IA-1, 6493-109-IA-2 and 6493-109-IA-3 were collected from within the building. For quality control purposes a sample of outdoor ambient air designated 6493-OA-1 was collected. Additionally, three (3) sub-slab vapor sample designated 6493-109-SSV-1, 6493-109-SSV-2 and 6493-109-SSV-3 were collected from beneath the floor of your building. The sampling locations are depicted on the attached **Figure 1**. The results of the vapor samples are summarized and compared to WDNR standards on the attached **Table 1** with the previous results. A copy of the laboratory report that relates to the vapor samples is also attached.

PCE was detected in the indoor air samples and the sub-slab vapor samples, but at a concentration below the Vapor Risk Screening Level (VRSL). No other compounds were detected in the sub-slab sample.

Mitigation of potential vapors at your property is *not* necessary and we do *not* recommend any further testing. If you have any questions or concerns, please contact us at 262-510-0612 or by email at rhoverman@enviroforensics.com. The WDNR project manager, Larry Lester, can be reached at 608-275-3465. We greatly appreciate your help and patience with this matter.

Sincerely,
EnviroForensics, LLC

A handwritten signature in blue ink, appearing to read "Rob Hoverman".

Rob Hoverman, LPG
Senior Project Manager

A handwritten signature in blue ink, appearing to read "Rebecca Brown".

Rebecca Brown
Field Professional

Attachments: Figure 1 – Vapor Intrusion Sampling Locations
Table 1 – Vapor Intrusion Assessment Results Summary
Laboratory Analytical Report

Copy: Larry Lester, Wisconsin Department of Natural Resources

FIGURE 1
VAPOR INTRUSION SAMPLE LOCATIONS
109 Mullet Street, Portage Wisconsin

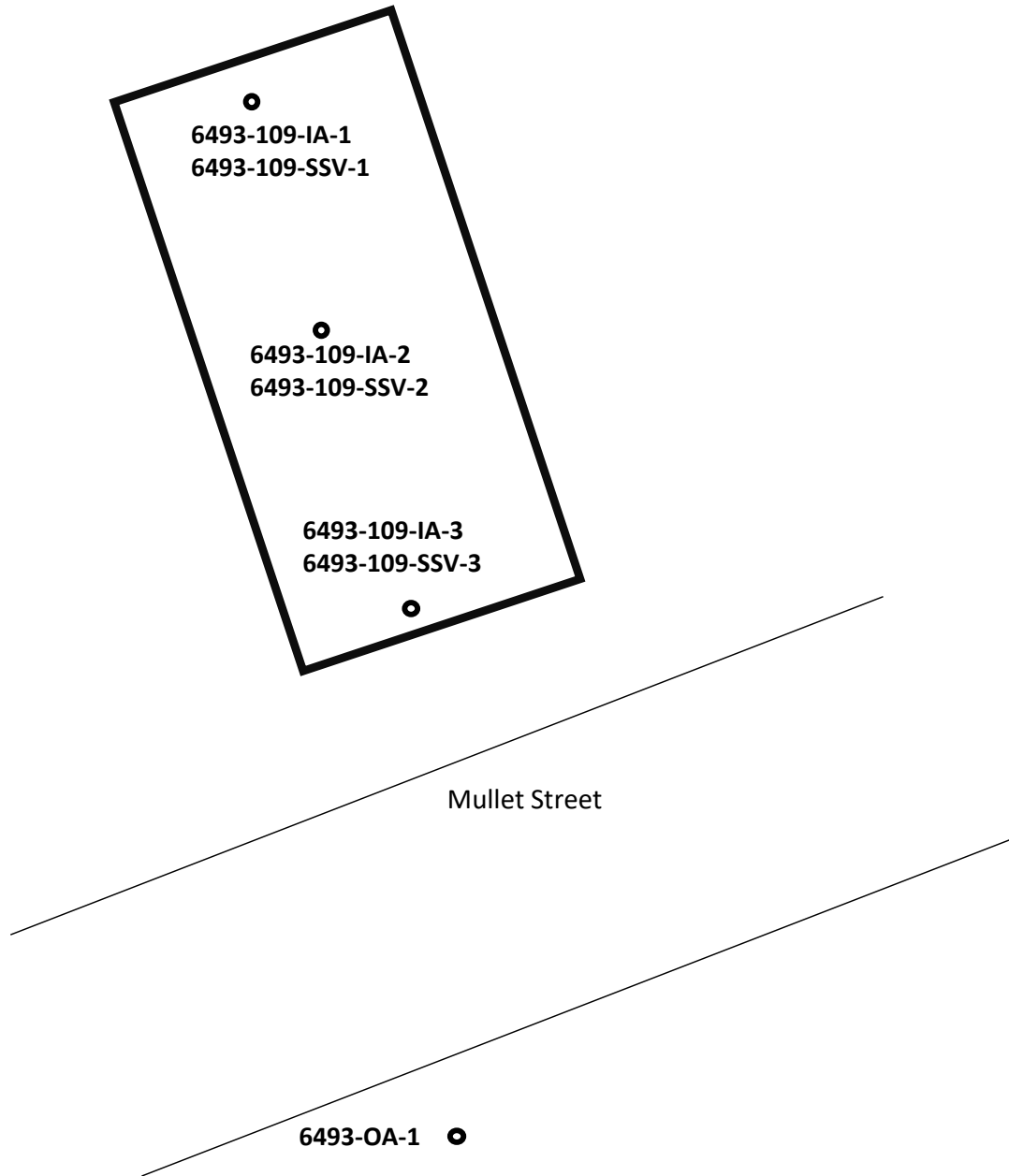

Legend

● = Indoor/Outdoor Air Sample



TABLE 1
VAPOR INTRUSION ANALYTICAL RESULTS

Portage Cleaners
104 E. Wisconsin St
Portage, WI 53901

Sample Address	Sample Identification	Sample Date	Applicable Criteria	Mitigation	Tetrachloroethene	Trichloroethene	cis-1,2-Dichloroethene	trans-1,2-Dichloroethene	Vinyl chloride	
INDOOR/OUTDOOR AIR										
Residential Vapor Action Limit					42	2.1	NE	NE	1.7	
Small Commercial Vapor Action Limit					180	8.8	NE	NE	28.0	
109 W. Mullet St.	6493-109-IA-1	03/16/18	Commercial	No	32.2	<1.07	<19.8	<39.6	<1.28	
		1/26/2021			<3.19	<1.07	<19.8	<39.6	<1.28	
		3/2/2021			8.95	<1.07	<19.8	<39.6	<1.28	
	03/16/18	18.2			<1.07	<19.8	<39.6	<1.28		
	1/26/2021	5.29			<1.07	<19.8	<39.6	<1.28		
	3/2/2021	12.9			<1.07	<19.8	<39.6	<1.28		
	6493-109-IA-2	03/16/18		No	27.8	<1.07	<19.8	<39.6	<1.28	
		1/26/2021			5.90	<1.07	<19.8	<39.6	<1.28	
		3/2/2021			13.0	<1.07	<19.8	<39.6	<1.28	
	6493-109-IA-3	03/16/18			No	<3.19	<1.07	<19.8	<39.6	<1.28
		1/26/2021				<3.19	<1.07	<19.8	<39.6	<1.28
		3/2/2021				<3.19	<1.07	<19.8	<39.6	<1.28
6493-OA-1	03/16/18	No	<3.19	<1.07		<19.8	<39.6	<1.28		
	1/26/2021		<3.19	<1.07		<19.8	<39.6	<1.28		
	3/2/2021		<3.19	<1.07		<19.8	<39.6	<1.28		
SUB-SLAB VAPOR										
Residential Vapor Risk Screening Level					1,400	70	NE	NE	57	
Small Commercial Vapor Action Limit					6,000	290	NE	NE	930	
109 W. Mullet St	6493-109-SSV-1	8/7/2017	Small Commercial	No	3,090	<10.7	<198	<396	<12.8	
		1/23/2018			12,100	<10.7	<198	<396	<12.8	
		3/16/2018			1,480	<1.07	<19.8	<39.6	<1.28	
		9/30/2020			331	<1.07	<19.8	<39.6	<1.28	
		1/26/2021			17.4	<1.07	<19.8	<39.6	<1.28	
		3/3/2021			36.1	<1.07	<19.8	<39.6	<1.28	
	6493-109-SSV-2	8/7/2017			No	3,810	<10.7	<198	<396	<12.8
		1/23/2018				18,700	<10.7	<198	<396	<12.8
		3/16/2018				3,210	19.8	<19.8	<39.6	<1.28
		9/30/2020				2,160	2.26	<19.8	<39.6	<1.28
		1/26/2021				510	<1.07	<19.8	<39.6	<1.28
		3/3/2021				191	<1.07	<19.8	<39.6	<1.28
	6493-109-SSV-3	8/7/2017		No		2,490	<10.7	<198	<396	<12.8
		1/23/2018				2,030	<10.7	<198	<396	<12.8
		3/16/2018				210	11.1	<19.8	<39.6	<1.28
		9/30/2020				2,660	<1.07	<19.8	<39.6	<1.28
		1/26/2021				3.87	<1.07	<19.8	<39.6	<1.28
		3/3/2021				106	<1.07	<19.8	<39.6	<1.28

Notes:

All concentrations reported in micrograms per cubic meter = µg/m³

Samples analyzed according to EPA Method TO-15

The vapor risk screening levels for residential structures are calculated in accordance with the procedures described in WDNR Publication RR-800 and subsequent guidance

Only detected compounds are listed

Bolded values are above method detection limits

Bolded and blue shaded values exceed the residential Vapor Risk Screening Level

Bolded and orange shaded values exceed the residential Vapor Risk Screening Level

NE = Not Established

IA = Indoor Air

OA = Outdoor Air

SSV = Sub-Slab Vapor



EnvisionAir
1441 Sadlier Circle West Drive
Indianapolis, IN 46239
Ph: 317-351-0885
Fax: 317-351-0882
www.envision-air.com

Mr. Rob Hoverman
Enviroforensics
N16 W. 23390 Stone Ridge Dr
Suite G
Waukesha, WI 53188

March 9, 2021

EnvisionAir Project Number: 2021-121
Client Project Name: 6493 – Portage Cleaners

Dear Mr. Hoverman,

Please find the attached analytical report for the samples received March 4, 2021. All test methods performed were fully compliant with local, state, and federal EPA methods unless otherwise noted. The project was analyzed as requested on the enclosed chain of custody record. Please review the comments section for additional information about your results or Quality Control data.

Feel free to contact me if you have any questions or comments regarding your analytical report or service.

Thank you for your business. EnvisionAir looks forward to working with you on your next project.

Yours Sincerely,

A handwritten signature in black ink that reads "Stanley A. Hunnicutt".

Stanley A Hunnicutt

Project Manager
EnvisionAir, LLC



EnvisionAir
 1441 Sadlier Circle West Drive
 Indianapolis, IN 46239
 Ph: 317-351-0885
 Fax: 317-351-0882
 www.envision-air.com

Client Name: ENVIROFORENSICS
Project ID: 6493 PORTAGE CLEANERS
Client Project Manager: ROB HOVERMAN
EnvisionAir Project Number: 2021-121

Sample Summary

Canister Pressure / Vacuum

<u>Laboratory Sample Number:</u>	<u>Sample Description:</u>	<u>Matrix:</u>	<u>START</u>	<u>START</u>	<u>End Date</u>	<u>End Time</u>	<u>Date</u>	<u>Time</u>	<u>Initial Field</u>	<u>Final Field</u>	<u>Lab</u>
			<u>Date</u>	<u>Time</u>							
21-635	6493-109-IA-1	A	3/2/21	7:56	3/2/21	15:59	3/4/21	15:30	-30	-3	-3
21-636	6493-109-IA-2	A	3/2/21	7:59	3/2/21	16:00	3/4/21	15:30	-30	-4	-4
21-637	6493-109-IA-3	A	3/2/21	8:02	3/2/21	16:02	3/4/21	15:30	-30	-3	-3
21-638	6493-OA-1	A	3/2/21	8:05	3/2/21	15:56	3/4/21	15:30	-28	0	0
21-639	6493-109-SSV-1	A	3/3/21	13:07	3/3/21	13:12	3/4/21	15:30	-29	-5	-5
21-640	6493-109-SSV-2	A	3/3/21	12:57	3/3/21	13:03	3/4/21	15:30	-30	-5	-5
21-641	6493-109-SSV-3	A	3/3/21	12:49	3/3/21	12:53	3/4/21	15:30	-30	-5	-5



EnvisionAir
 1441 Sadler Circle West Drive
 Indianapolis, IN 46239
 Ph: 317-351-0885
 Fax: 317-351-0882
 www.envision-air.com

Client Name: ENVIROFORENSICS
Project ID: 6493 PORTAGE CLEANERS
Client Project Manager: ROB HOVERMAN
EnvisionAir Project Number: 2021-121

Analytical Method: TO-15
Analytical Batch: 030521AIR

Client Sample ID: 6493-109-IA-1
EnvisionAir Sample Number: 21-635
Sample Matrix: AIR

Sample Collection START Date/Time: 3/2/21 7:56
Sample Collection END Date/Time: 3/2/21 15:59
Sample Received Date/Time: 3/4/21 15:30

<u>Compounds</u>	<u>Sample Results ug/m³</u>	<u>Reporting Limit ug/m³</u>	<u>Flag</u>
cis-1,2-Dichloroethene	< 19.8	19.8	
Tetrachloroethene	8.95	3.19	
trans-1,2-Dichloroethene	< 39.6	39.6	
Trichloroethene	< 1.07	1.07	
Vinyl Chloride	< 1.28	1.28	
4-bromofluorobenzene (surrogate)	105%		
Analysis Date/Time:	3-5-21/07:21		
Analyst Initials	tjg		



EnvisionAir
 1441 Sadler Circle West Drive
 Indianapolis, IN 46239
 Ph: 317-351-0885
 Fax: 317-351-0882
 www.envision-air.com

Client Name: ENVIROFORENSICS
Project ID: 6493 PORTAGE CLEANERS
Client Project Manager: ROB HOVERMAN
EnvisionAir Project Number: 2021-121

Analytical Method: TO-15
Analytical Batch: 030521AIR

Client Sample ID: 6493-109-IA-2 **Sample Collection START Date/Time:** 3/2/21 7:59
EnvisionAir Sample Number: 21-636 **Sample Collection END Date/Time:** 3/2/21 16:00
Sample Matrix: AIR **Sample Received Date/Time:** 3/4/21 15:30

<u>Compounds</u>	<u>Sample Results ug/m³</u>	<u>Reporting Limit ug/m³</u>	<u>Flag</u>
cis-1,2-Dichloroethene	< 19.8	19.8	
Tetrachloroethene	12.9	3.19	
trans-1,2-Dichloroethene	< 39.6	39.6	
Trichloroethene	< 1.07	1.07	
Vinyl Chloride	< 1.28	1.28	
4-bromofluorobenzene (surrogate)	103%		
Analysis Date/Time:	3-5-21/08:03		
Analyst Initials	tjg		



EnvisionAir
 1441 Sadler Circle West Drive
 Indianapolis, IN 46239
 Ph: 317-351-0885
 Fax: 317-351-0882
 www.envision-air.com

Client Name: ENVIROFORENSICS
Project ID: 6493 PORTAGE CLEANERS
Client Project Manager: ROB HOVERMAN
EnvisionAir Project Number: 2021-121

Analytical Method: TO-15
Analytical Batch: 030521AIR

Client Sample ID: 6493-109-IA-3
EnvisionAir Sample Number: 21-637
Sample Matrix: AIR

Sample Collection START Date/Time: 3/2/21 8:02
Sample Collection END Date/Time: 3/2/21 16:02
Sample Received Date/Time: 3/4/21 15:30

<u>Compounds</u>	<u>Sample Results ug/m³</u>	<u>Reporting Limit ug/m³</u>	<u>Flag</u>
cis-1,2-Dichloroethene	< 19.8	19.8	
Tetrachloroethene	13.0	3.19	
trans-1,2-Dichloroethene	< 39.6	39.6	
Trichloroethene	< 1.07	1.07	
Vinyl Chloride	< 1.28	1.28	
4-bromofluorobenzene (surrogate)	98%		
Analysis Date/Time:	3-5-21/08:46		
Analyst Initials	tjg		



EnvisionAir
1441 Sadlier Circle West Drive
Indianapolis, IN 46239
Ph: 317-351-0885
Fax: 317-351-0882
www.envision-air.com

Client Name: ENVIROFORENSICS
Project ID: 6493 PORTAGE CLEANERS
Client Project Manager: ROB HOVERMAN
EnvisionAir Project Number: 2021-121

Analytical Method: TO-15
Analytical Batch: 030521AIR

Client Sample ID: 6493-OA-1
EnvisionAir Sample Number: 21-638
Sample Matrix: AIR

Sample Collection START Date/Time: 3/2/21 8:05
Sample Collection END Date/Time: 3/2/21 15:56
Sample Received Date/Time: 3/4/21 15:30

<u>Compounds</u>	<u>Sample Results ug/m³</u>	<u>Reporting Limit ug/m³</u>	<u>Flag</u>
cis-1,2-Dichloroethene	< 19.8	19.8	
Tetrachloroethene	< 3.19	3.19	
trans-1,2-Dichloroethene	< 39.6	39.6	
Trichloroethene	< 1.07	1.07	
Vinyl Chloride	< 1.28	1.28	
4-bromofluorobenzene (surrogate)	95%		
Analysis Date/Time:	3-5-21/09:29		
Analyst Initials	tjg		



EnvisionAir
 1441 Sadler Circle West Drive
 Indianapolis, IN 46239
 Ph: 317-351-0885
 Fax: 317-351-0882
 www.envision-air.com

Client Name: ENVIROFORENSICS
Project ID: 6493 PORTAGE CLEANERS
Client Project Manager: ROB HOVERMAN
EnvisionAir Project Number: 2021-121

Analytical Method: TO-15
Analytical Batch: 030721AIR

Client Sample ID: 6493-109-SSV-1
EnvisionAir Sample Number: 21-639
Sample Matrix: AIR

Sample Collection START Date/Time: 3/3/21 13:07
Sample Collection END Date/Time: 3/3/21 13:12
Sample Received Date/Time: 3/4/21 15:30

<u>Compounds</u>	<u>Sample Results ug/m³</u>	<u>Reporting Limit ug/m³</u>	<u>Flag</u>
cis-1,2-Dichloroethene	< 19.8	19.8	
Tetrachloroethene	36.1	3.19	
trans-1,2-Dichloroethene	< 39.6	39.6	
Trichloroethene	< 1.07	1.07	
Vinyl Chloride	< 1.28	1.28	
4-bromofluorobenzene (surrogate)	105%		
Analysis Date/Time:	3-7-21/20:29		
Analyst Initials	tjg		



EnvisionAir
 1441 Sadler Circle West Drive
 Indianapolis, IN 46239
 Ph: 317-351-0885
 Fax: 317-351-0882
 www.envision-air.com

Client Name: ENVIROFORENSICS
Project ID: 6493 PORTAGE CLEANERS
Client Project Manager: ROB HOVERMAN
EnvisionAir Project Number: 2021-121

Analytical Method: TO-15
Analytical Batch: 030721AIR

Client Sample ID: 6493-109-SSV-2
EnvisionAir Sample Number: 21-640
Sample Matrix: AIR

Sample Collection START Date/Time: 3/3/21 12:57
Sample Collection END Date/Time: 3/3/21 13:03
Sample Received Date/Time: 3/4/21 15:30

<u>Compounds</u>	<u>Sample Results ug/m³</u>	<u>Reporting Limit ug/m³</u>	<u>Flag</u>
cis-1,2-Dichloroethene	< 19.8	19.8	
Tetrachloroethene	191	31.9	1
trans-1,2-Dichloroethene	< 39.6	39.6	
Trichloroethene	< 1.07	1.07	
Vinyl Chloride	< 1.28	1.28	
4-bromofluorobenzene (surrogate)	95%		
Analysis Date/Time:	3-7-21/21:09		
Analyst Initials	tjg		



EnvisionAir
 1441 Sadlier Circle West Drive
 Indianapolis, IN 46239
 Ph: 317-351-0885
 Fax: 317-351-0882
 www.envision-air.com

Client Name: ENVIROFORENSICS
Project ID: 6493 PORTAGE CLEANERS
Client Project Manager: ROB HOVERMAN
EnvisionAir Project Number: 2021-121

Analytical Method: TO-15
Analytical Batch: 030721AIR

Client Sample ID: 6493-109-SSV-3 **Sample Collection START Date/Time:** 3/3/21 12:49
EnvisionAir Sample Number: 21-641 **Sample Collection END Date/Time:** 3/3/21 12:53
Sample Matrix: AIR **Sample Received Date/Time:** 3/4/21 15:30

<u>Compounds</u>	<u>Sample Results ug/m³</u>	<u>Reporting Limit ug/m³</u>	<u>Flag</u>
cis-1,2-Dichloroethene	< 19.8	19.8	
Tetrachloroethene	106	3.19	
trans-1,2-Dichloroethene	< 39.6	39.6	
Trichloroethene	< 1.07	1.07	
Vinyl Chloride	< 1.28	1.28	
4-bromofluorobenzene (surrogate)	95%		
Analysis Date/Time:	3-7-21/22:29		
Analyst Initials	tjg		

TO-15 Quality Control Data

EnvisionAir Batch Number: 030521AIR

<u>Method Blank (MB):</u>	<u>MB Results (ppbv)</u>	<u>Reporting Limit (ppbv)</u>	<u>Flags</u>
cis-1,2-Dichloroethene	< 5	5	
Tetrachloroethene	< 0.47	0.47	
trans-1,2-Dichloroethene	< 10	10	
Trichloroethene	< 0.2	0.2	
Vinyl Chloride	< 0.5	0.5	
4-bromofluorobenzene (surrogate)	97%		
Analysis Date/Time:	3-4-21/16:39		
Analyst Initials	tjg		

<u>LCS/LCSD</u>	<u>LCS Results (ppbv)</u>	<u>LCSD Results (ppbv)</u>	<u>LCS/D Conc(ppbv)</u>	<u>LCS Rec.</u>	<u>LCSD Rec.</u>	<u>RPD</u>	<u>Flag</u>
Vinyl Chloride	9.55	9.03	10	96%	90%	5.6%	
trans-1,2-Dichloroethene	10	9.73	10	100%	97%	2.7%	
cis-1,2-Dichloroethene	10.3	9.22	10	103%	92%	11.1%	
Trichloroethene	10	10.2	10	100%	102%	2.0%	
Tetrachloroethene	9.86	9.56	10	99%	96%	3.1%	
4-bromofluorobenzene (surrogate)	98%	100%					
Analysis Date/Time:	3-4-21/15:16	3-4-21/16:03					
Analyst Initials	tjg	tjg					

TO-15 Quality Control Data

EnvisionAir Batch Number: 030721AIR

<u>Method Blank (MB):</u>	<u>MB Results (ppbv)</u>	<u>Reporting Limit (ppbv)</u>	<u>Flags</u>
cis-1,2-Dichloroethene	< 5	5	
Tetrachloroethene	< 0.47	0.47	
trans-1,2-Dichloroethene	< 10	10	
Trichloroethene	< 0.2	0.2	
Vinyl Chloride	< 0.5	0.5	
4-bromofluorobenzene (surrogate)	107%		
Analysis Date/Time:	3-7-21/11:09		
Analyst Initials	tjg		

<u>LCS/LCSD</u>	<u>LCS Results (ppbv)</u>	<u>LCSD Results (ppbv)</u>	<u>LCS/D Conc(ppbv)</u>	<u>LCS Rec.</u>	<u>LCSD Rec.</u>	<u>RPD</u>	<u>Flag</u>
Vinyl Chloride	10.6	10.2	10	106%	102%	3.8%	
trans-1,2-Dichloroethene	9.9	9.89	10	99%	99%	0.1%	
cis-1,2-Dichloroethene	9.75	9.27	10	98%	93%	5.0%	
Trichloroethene	9.13	9.45	10	91%	95%	3.4%	
Tetrachloroethene	9.31	9.61	10	93%	96%	3.2%	
4-bromofluorobenzene (surrogate)	97%	103%					
Analysis Date/Time:	3-7-21/09:44	3-7-21/10:31					
Analyst Initials	tjg	tjg					



EnvisionAir
1441 Sadler Circle West Drive
Indianapolis, IN 46239
Ph: 317-351-0885
Fax: 317-351-0882
www.envision-air.com

Flag Number

1

Comments

Reported value is from a 10x dilution. TJG 03-08-21

CHAIN OF CUSTODY RECORD

EnvisionAir | 1441 Sadlier Circle West Drive | Indianapolis, IN 46239 | Phone: (317) 351-0885 | Fax: (317) 351-0882



www.envision-air.com

Client: P.O. Number: 2021-0116
Report Address: R Hooverman, Portage Cleaners, 6493
Report To: R. Hooverman
Phone: 262-260-4001
Invoice Address: accounts, Payable@enviroforensics.com
Desired TAT: (Please Circle One) 1 day 2 days 3 days Std (5 bus. days)

QA/QC Required: (circle if applicable) Level III Level IV
Reporting Units needed: (circle) ug/m³ mg/m³ PPBV PPMV
Media Type: 1LC = 1 Liter Canister, 6LC = 6 Liter Canister, TB = Tedlar Bag, TD = Thermal Desorption Tube

REQUESTED PARAMETERS

TO-15 Full List
 TO-15 Short List (Specify in notes)

Sampling Type:
 Soil-Gas:
 Sub-Slab:
 Indoor-Air:

Canister Pressure / Vacuum

Air Sample ID	Media Type (see code above)	Coll. Date (Grab/Comp Start)	Coll. Time (Grab/Comp Start)	Coll. Date (Comp. End)	Coll. Time (Comp. End)	Canister Serial #	Flow Controller Serial #	Initial Field (in. Hg)	Final Field (in. Hg)	Lab Received (in. Hg)	EnvisionAir Sample Number
6493-109-IA-1	6LC	3-2-21	7:56	3-2-21	1559	91607	5002	-30	-3	-3	21-635
6493-109-IA-2	↓	↓	7:59	↓	1600	4657	5302	-30	-4	-4	21-636
6493-109-IA-3	↓	↓	8:02	↓	1602	16034	2222	-30	-3	-3	21-637
6493-0A-1	↓	↓	8:05	↓	1556	4694	5720	-28	∅	∅	21-638
6493-109-SSV-1	1LC	3-3-21	1307	3-3-21	1312	1844	0026	-79	-5	-5	21-639
6493-109-SSV-2	↓	↓	1257	↓	1303	2221	0052	-30	-5	-5	21-640
6493-109-SSV-3	↓	↓	1249	↓	1253	83831	0079	-30	-5	-5	21-641

Comments: Short List: PCE, TCE, CDCE, EDCE, VC

Relinquished by:	Date	Time	Received by:	Date	Time
RLC	3-3-21	1600	FedEx	3-3-21	1600
			Sean Humphreys	3/4/21	1530