

24-Hour Emergency Hotline Number: 1-800-943-0003

Date & Military Time Of Incident: <i>4/8/04 late am</i>		Date & Military Time Reported: <i>4/8/04 15:49</i>		Spill File # <i>04-16-527008</i>	
Person Reporting: <i>Kristen Benson</i>			Representing: <i>Enbridge Energy</i>		Phone # (715) 394-1572 Fax # (715) 394-1570
Responsible Party (RP) / Spiller: <i>Enbridge Energy</i>			RP Decision Based On:		Phone # ( ) Fax # ( )
RP Address: <i>2800 E. 21st St.</i>			City <i>Superior, WI</i>		State <i>WI</i>
RP Contact Name & Title: <i>Mark Stok</i>			Phone # (715) 394-1410 Fax # ( )		Zip Code <i>54880</i>
Substance Involved: <i>Crude oil</i>		Amount & Units Released: <i>± 1 barrel ± 32 gal.</i>		Amount & Units Recovered:	
<input type="checkbox"/> Solid <input type="checkbox"/> Semisolid <input checked="" type="checkbox"/> Liquid <input type="checkbox"/> Gas		Color:		Odor:	
Exact Location Of Incident: (including street name, bldg. #, mileage, etc.) <i>Densitometer building - near tank 15</i>				Facility Name / Property Owner: <i>Enbridge Energy</i>	
<input checked="" type="checkbox"/> City <input type="checkbox"/> Village <input type="checkbox"/> Township <i>Superior</i>		County <i>Douglas</i>		Latitude/Longitude	
DNR Region: <i>NDR</i>		NW 1/4 NW 1/4 Sec 14 T31 N R13 <input type="checkbox"/> E <input checked="" type="checkbox"/> W		Weather Conditions:	
Cause Of Incident: <i>Failed seal on a sampling pump in line to densitometer building - near tank 15</i>					
Spilled Substance Impact To: (check X all that apply)		Spill Cause/Site:		Action Taken By Spiller:	
<input type="checkbox"/> Air <input type="checkbox"/> Potential <input type="checkbox"/> Concrete/Asphalt <input type="checkbox"/> Potential <input type="checkbox"/> Contained/Recovered <input type="checkbox"/> Groundwater <input type="checkbox"/> Potential <input type="checkbox"/> Private Well <input type="checkbox"/> Potential <input type="checkbox"/> Sanitary Sewer <input type="checkbox"/> Potential <input checked="" type="checkbox"/> Soil <input checked="" type="checkbox"/> Potential <input type="checkbox"/> Storm Sewer <input type="checkbox"/> Potential <input type="checkbox"/> Surface Water <input type="checkbox"/> Potential Name:  <input type="checkbox"/> Other:		<input type="checkbox"/> Ag Coop/Food Factory <input type="checkbox"/> Airport Facility <input type="checkbox"/> Railroad Facility <input type="checkbox"/> Construction, Excavation, Wrecking, Quarry, Mine <input type="checkbox"/> Gas/Service Station/Garage/Auto Dealer/Repair Shop <input type="checkbox"/> Hydraulic Line Break <input type="checkbox"/> Industrial Facility <input type="checkbox"/> Paper Mill <input type="checkbox"/> Chemical Co. <input checked="" type="checkbox"/> Pipeline/Terminal/Tank Farm/Oil Jobber/Wholesaler <input type="checkbox"/> Private Property (home/farm) <input type="checkbox"/> Public Property (city, state, church, school, etc.) <input type="checkbox"/> Transportation Accident, Fuel Tank Spill <input type="checkbox"/> Transportation Accident, Load Spill <input type="checkbox"/> Utility Co. Power Generating/Transfer Facility <input type="checkbox"/> Other:		<input checked="" type="checkbox"/> Cleanup Method: <input type="checkbox"/> Absorbent <input checked="" type="checkbox"/> Excavation <i>29 cu. y ds</i> <input type="checkbox"/> <input type="checkbox"/> Containment <input type="checkbox"/> Contractor Hired Name:  <input type="checkbox"/> Monitor <input type="checkbox"/> No Action Needed <input type="checkbox"/> No Action Taken <input checked="" type="checkbox"/> Waste Destination: <i>Timberline Trail</i> <input type="checkbox"/> Other:	
Injuries? <input type="checkbox"/> Yes <input checked="" type="checkbox"/> No If yes how many?		Has An Evacuation Occurred? <input type="checkbox"/> Yes <input checked="" type="checkbox"/> No		Potential? <input type="checkbox"/> Yes <input checked="" type="checkbox"/> No	
Are There Any Resource Damages? <input type="checkbox"/> Yes <input checked="" type="checkbox"/> No <input type="checkbox"/> Potential What Kind?					
Other Agencies Notified: (check first column, if notified; check both columns, if on the scene)				Incident Commander:	
<input type="checkbox"/> Fire Department <input type="checkbox"/> Local Law Enforcement <input type="checkbox"/> LEPC or Local Emer. Mgt. <input type="checkbox"/> Level A/Level B Team		<input checked="" type="checkbox"/> Local DNR <input type="checkbox"/> Div. Emerg. Mgt. <input type="checkbox"/> Coast Guard <input type="checkbox"/> DHFS 608-258-0099		<input type="checkbox"/> EPA <input type="checkbox"/> Nat'l Resp Ctr 800-442-8802 <input type="checkbox"/> Chemtrec 800-424-9300 <input type="checkbox"/> Other:	
Prepared By: <i>Norman Ounbar</i>		Phone # <i>715-365-8963</i>		Date: <i>4/8/04</i>	
Person Notified: <i>Norman Ounbar</i>		Phone # <i>715-365-8963</i>		Date: <i>4/8/04</i>	
Investigated By:		Sign:		Date:	
Spill Coordinator Signoff: <i>Norman Ounbar</i>		Date: <i>6/1/04</i>		Transferred To: ERP <input type="checkbox"/> DATCP <input type="checkbox"/> Date: Case #	
				Incident Closed? <input checked="" type="checkbox"/> Yes <input type="checkbox"/> No Date: <i>6/1/04</i>	
				NFA Letter Sent? <input type="checkbox"/> Yes <input checked="" type="checkbox"/> No Spill Packet Sent? <input type="checkbox"/> Yes <input checked="" type="checkbox"/> No To:	

State of Wisconsin Substance Release Report (Cont'd)  
Form 4401-91 Rev 12-01

Date and Military Time Of Incident:	Responsible Party:
-------------------------------------	--------------------

Additional Comments :

Case Activity Report:  Yes  No CAR#: (Please, attach copy of all CAR and other documentation)

Enforcement Action:  Yes  No (Explain Below)

Enbridge Pipelines (Lakehead) L.L.C.  
119 N. 25<sup>th</sup> Street East  
Superior, WI 54880  
Tel 715 394 1400  
Fax 715 394 1570  
www.enbridgepartners.com

Scott W. Lounsbury Supervisor, Environment  
William VonSee Environmental Analyst  
Kris H. Benson Environmental Analyst II  
Paul R. Meneghini, P.E. Environmental Analyst II



May 26, 2004

Mr. Norm Dunbar  
Wisconsin Department of Natural Resources  
Northern Region  
107 Sutliff Avenue  
Rhineland, WI 54501

Re: Enbridge Superior Terminal  
April 8, 2004 Leak  
Line #6 Densitometer Building

Dear Mr. Dunbar:

As a follow-up to an earlier email from Kris Benson on April 8, 2004, I have prepared this letter to summarize Enbridge Energy Company (Enbridge) leak response activities concerning the above-referenced leak.

A release of approximately one barrel of oil occurred from the Line 6 Densitometer building on April 8, 2004. A failed seal on a sampling pump was determined to be the source of the release. Recovery of product and clean up of the area was executed immediately (within one hour of discovery). Most of the product was successfully contained within the densitometer building; the product which had migrated out of the building pooled up along the southeast and northeastern edges on the building. Cleanup was completed rather quick and impacts only affected the surface of the soil where the oil had formed a small, contained pool.

All visually stained soil was removed totaling approximately 40.87 tons (29 cubic yards) of impacted soil. The soil was stockpiled on-site and was later hauled and disposed of at Waste Management's Timberline Trail Landfill in Weyerhaeuser, Wisconsin. Manifests and weight tickets are attached as documentation.

Based on the response activities completed, we are requesting closure of this release. If you agree, please forward written closure documentation for our records. Otherwise, please contact me if you require further documentation.

Sincerely,

A handwritten signature in blue ink, appearing to read 'Paul Meneghini'.

Paul Meneghini, P.E.  
Environmental Analyst II

Attachments



TIMBERLINE TRAIL  
RECYCLING & DISPOSAL FACILITY  
BIOSITE<sup>SM</sup>



A Waste Management Company

BILL TO: Enbridge Energy

TRANSPORTER: Rock Trucking

GENERATOR: Enbridge Energy

GENERATORS SIGNATURE: [Signature] Date 4/23/04

WASTE DESCRIPTION: Metallic Impacted Soil

PROFILE # TLT484270

ACCEPTED BY: Robert Gitz Date 4/23/04

DRIVERS SIGNATURE: [Signature] Date \_\_\_\_\_

TRUCK NO. 991 2057 TONS/YARDS

Line 6 Densitometer Laks  
4/8/04

WHITE & YELLOW - TRANSPORTER COPY / PINK - DISPOSAL SITE COPY

DCE-018-96TT 7/02

REFERENCE NO.  
758061

DRIVER SIGN HERE  
LOCATION 04/23/2004  
ST PET  
RI 1006  
LOE, IDL County  
RUSK TRUCK

TIMBERLINE TRAIL PDR  
WASTE MANAGEMENT  
P.O. BOX 160  
BRUCE, WI 54819  
COMMENTS: 504-1067  
FAX: 715-848-7001  
GROSS: 36,550  
TARE: 15,280  
NET: 20,570  
TIME: 07:48 AM  
DATE: 04/23/2004  
TIME: 10:18 AM  
DATE: 04/23/2004

PROFILE NO.  
MANIFEST NO. TLT484270  
PERMIT NO.

CUSTOMER NO. TRUCK NO.  
CUSTOMER: 0000346 027  
LAKEHEAD PIPELINE

LOAD QUANTITY	LOAD DESCRIPTION	AMOUNT
15.00	Generator tax/fee	15.00
15.00	Landfill toll	15.00

CUSTOMER COPY

SPECIAL WASTE MANIFEST DISPOSAL TICKET

**TIMBERLINE TRAIL  
RECYCLING & DISPOSAL FACILITY  
BIOSITE<sup>SM</sup>**



A Waste Management Company

BILL TO: Enbridge Energy

TRANSPORTER: Foster Trucking

GENERATOR: Enbridge Energy

GENERATORS SIGNATURE: [Signature] Enbridge Energy 4/23/04  
Date

WASTE DESCRIPTION: Used Oil Impacted Soil

PROFILE # TLT 484270

ACCEPTED BY: [Signature] 110 4/23/04  
Date

DRIVERS SIGNATURE: [Signature] 4/23/04  
Date

*Line 6 Denistota Lake  
4/8/04*

TRUCK NO. 090 203 TONS/YARDS

WHITE & YELLOW - TRANSPORTER COPY / PINK - DISPOSAL SITE COPY

DCE-018-96TT 7/02

REFERENCE NO

**DRIVER SIGN HERE**

LOCATION: 04/23/2004

Loc ID: RUSK County: RUSK State: WI ZIP: 53100A

GROSS: 36.250 TARE: 15.950 NET: 20.300

In: RJD 10:23 AM 04/23/2004 Out: RJD 11:05 AM 04/23/2004

TIMBERLINE TRAIL RDF  
WASTE MANAGEMENT  
P.O. BOX 160  
BRIDGE, WI 54819  
COMMENTS: 504-1067 FAX: 715-869-7001

PROFILE NO  
MANIFEST NO TLT484270  
PERMIT NO

CUSTOMER NO. TRUCK NO. 090

CUSTOMER: 0000346 290  
LAKEHEAD PIPELINE

LOAD CODE	LOAD DESCRIPTION	LOAD QUANTITY	AMOUNT
WJ	Generator tank/tee	100.00	
LFS	landfill soil	100.00	

CUSTOMER COPY



**LEGEND**

- A-CONTROL BUILDING
- B-MANIFOLD BUILDING #1
- C-MANIFOLD BUILDING #2
- D-PUMPHOUSE (LOADING)
- E-UTILITY BUILDING
- F-SUBSTATION
- G-LINES 1,5,6, & AMOCO METER CONTROL BUILDING
- H-LINE 5 & AMOCO METERING AREA
- I-STA. #5 SWITCHGEAR BUILDING
- J-STA. #5 PUMPHOUSE
- K-STA. #5 PCV ENCLOSURE
- L-RECEIVING MANIFOLD CONTROL BUILDING
- M-MURPHY BOOSTER PUMPS
- N-STA. #6 PUMPHOUSE
- O-STA. #6 PCV ENCLOSURE

- P-STA. #6 SWITCHGEAR BUILDING
- Q-SUBSTATION
- R-BOOSTER PUMP SWITCHGEAR BUILDING
- S-BOOSTER PUMP ML61 ML62 ML63
- T-LINE #1 NGL METERING
- U-LINE #1 CRUDE METERING
- V-LINE #6 METERING
- W-LINE #1 PCV ENCLOSURE
- X-LINE #2 PCV ENCLOSURE
- Y-LINE #3 PCV ENCLOSURE
- Z-AREA 3 CONTROL BUILDING
- AA-MURPHY METERING AREA
- BB-LINE #1 PRESSURE RELIEF VESSELS
- CC-BOOSTER PUMP FB4
- DD-BOOSTER PUMP FB56 FB64 FB65 AREA
- EE-BOOSTER PUMP FB12
- FF-BOOSTER PUMP FB25 FB26 AREA
- GG-BOOSTER PUMP FB23
- HH-MURPHY BOOSTER PUMPS
- II-BOOSTER PUMP #5
- JJ-BOOSTER PUMP #1
- KK-BOOSTER PUMP #2
- LL-BOOSTER PUMP #3 AREA
- MM-FIRE PROTECTION PUMPHOUSE
- NN-DENSITOMETER BUILDING
- OO-PLM WAREHOUSE
- PP-EMERGENCY RESPONSE BUILDING
- QQ-OIL WATER SEPERATOR AREA
- RR-FIRE PROTECTION PUMPHOUSE
- SS-AREA #2 CONTROL SWITCHGEAR BUILDING

- TT-BOOSTER PUMP FB16
- UU-BOOSTER PUMP FB17
- VV-BOOSTER PUMP FB18
- WW-BOOSTER PUMP FB20
- XX-BOOSTER PUMP ML51 ML52 ML53
- YY-CRUDE OIL HEATER
- ZZ-AREA #1 CONTROL BUILDING
- AAA-AREA #3 MANIFOLD BUILDING
- BBB-STATION #14 SWITCHGEAR BUILDING
- CCC-STATION #14 PUMPHOUSE
- DDD-BOOSTER PUMP ML141 ML142
- EEE-AREA #4 CONTROL BUILDING
- FFF-BOOSTER PUMP FB30 FB31
- GGG-#3 MANIFOLD AREA

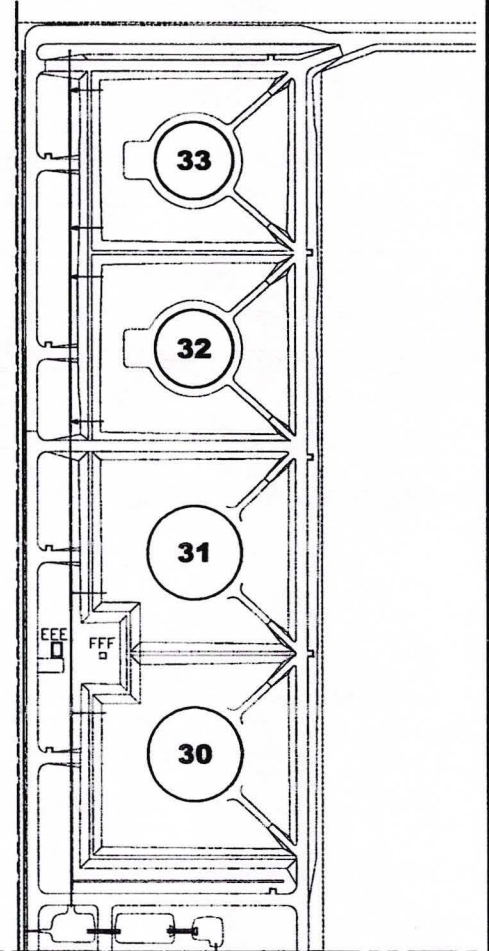
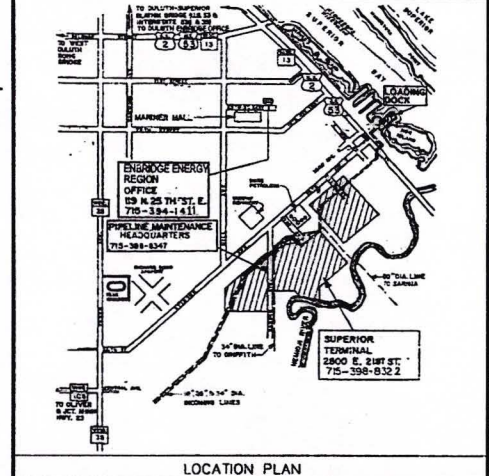
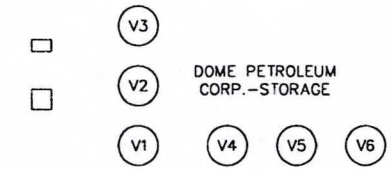
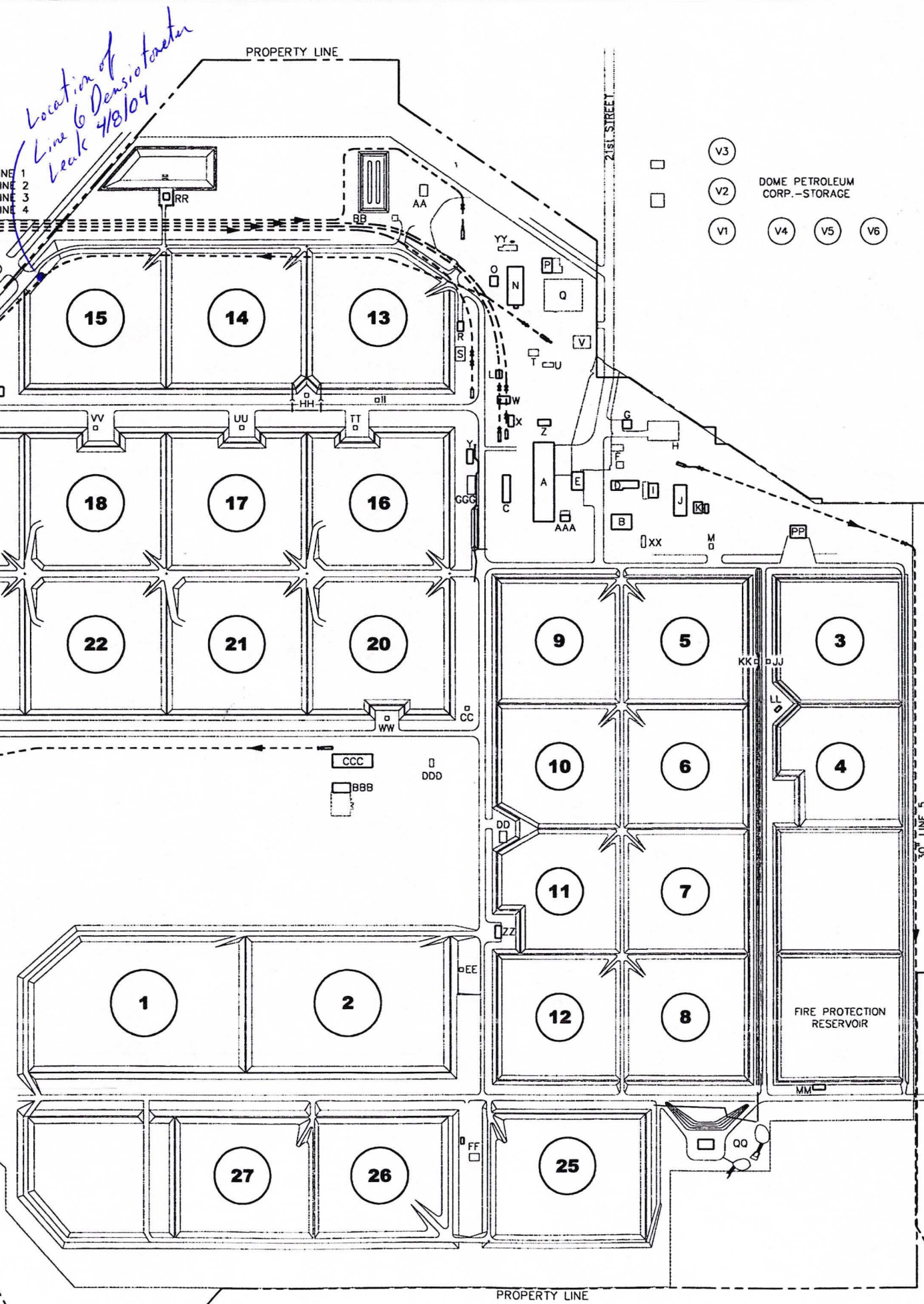

1	REVISED PER TERRACE III	JT	PJB
NO	REVISION	BY DATE	APPR

**ENBRIDGE** Enbridge Energy, Limited Partnership

**SUPERIOR (WI) TERMINAL**

ADMINISTRATIVE PLOT PLAN

PROJECT: SUPERIOR (WI) TERMINAL  
 SCALE: 1" = 200'-0" DATE: 10/23/03 DRAWN: JT  
 CHECK: PJB APPR: DAC DATE: 10/23/03  
 APPR: [Signature] DATE: [Blank]  
 APPR: [Signature] DATE: [Blank]

**D-1.2-472-1-130**

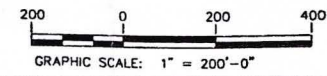



## Dunbar, Norman C

---

**From:** Kristen.Benson@enbridge.com  
**Sent:** Thursday, April 08, 2004 3:49 PM  
**To:** Dunbar, Norman C  
**Cc:** Scott.Lounsbury@enbridge.com; Al.Aleknavicius@Enbridge.com;  
Paul.Meneghini@Enbridge.com; Mark.Sitek@enbridge.com; Rick.Aunet@enbridge.com;  
Jim.McKone@enbridge.com  
**Subject:** 4/8 release: Line 6 densitometer building  
**Importance:** High



Release in Terminal  
off Bardon...



Recovery and clean  
up.jpg



More excavation at  
densitomete...



Excavation of soil  
2.jpg



Excavation of  
impacted soil.jp...

Norm,

As you are likely already aware, there was a small (estimated volume out at 1 bbl.) release which occurred within the Superior Terminal property boundary late this morning; upon discovery, the release was reported immediately to the state. Recovery of product and clean up of the area was executed immediately (within one hour of discovery) and the Environment Department was notified shortly thereafter. Evidently most of the product was successfully contained within the densitometer building; the product which had migrated out of the building pooled up along the southeast and northeastern edges of the building. When I arrived at the site (approximately 12:30 P.M.), most of the clean-up had already been completed (see attached photos); it appeared that impacts from the spill were minimal, affecting only the surface of the soil where the oil had formed a small, contained pool. The PLM Supervisor overseeing the soil removal indicated that clean-up efforts should be complete by this afternoon; contaminated soil is presently being stockpiled in a bermed area at the Terminal and will be transported off site next week to an approved landfill (Waste Management).

Bearing in mind the minimal impact of this release and the quick response and clean up of the site, coupled with the approach taken on recent leaks related to hydrotest activity (no sampling required), it is expected that sampling will not be warranted for this site, provided that all visual contamination is excavated from the site. If you feel that a different approach is justified, please advise as to what the next steps should be to obtain closure for this incident.

As I noted above, attached are pictures taken during the initial clean up effort. I plan to return to the site Monday to conduct a follow-up inspection to verify contamination has been satisfactorily removed. In the interim, please do not hesitate to contact me should you have additional questions; I will be out of the office Friday but will be returning Monday.

(See attached file: Release in Terminal off Bardon.jpg)(See attached file: Recovery and clean up.jpg)(See attached file: More excavation at densitometer.jpg)(See attached file: Excavation of soil 2.jpg)(See attached file: Excavation of impacted soil.jpg)

Kris H. Benson  
Environmental Analyst  
Enbridge Energy, Superior Office  
Phone: 715-394-1572  
Fax: 715-394-1570

~~Greg Wilson 722-6613  
10210<sup>e</sup> Stair  
quick sample  
DAD - PVOG~~

---

Christine - Enbridge Energy

April 2:00

1 barrel release

hose to denometer building

Clean up couple hours

scrapping soil  
out Friday

715-394-1572

Smaldonia



