

KPRG and Associates, Inc.

TRANSMITTAL LETTER

December 1, 2006

Mr. James Delwiche
Wisconsin Department of Natural Resources
141 NW Barstow Street, Room 180
Waukesha, WI 53188

VIA FEDERAL EXPRESS

KPRG Project No. 13905

Re: Site Investigation Status Meeting
Jill's Dry Cleaners
S74 W16834 Janesville Road, Muskego, WI
BRRTS #02-68-543070, FID #268077480

Dear Mr. Delwiche:

In preparation for our upcoming meeting on Friday December 8, 2006 at 10:00 am, enclosed are draft figures and data tables which summarize the results available to date relative to the Jill's Dry Cleaners site investigation. There is one round of quarterly groundwater data left to collect to complete a full year of monitoring. At this point in the project, and prior to formalizing the Site Investigation Report, KPRG and Associates, Inc. (KPRG), on behalf of Jill's Dry Cleaners, would like to discuss the following:

- The current data set has identified impacts to subsurface soils beneath the floor slab of the building in the immediate vicinity of the dry cleaning operations. In addition, impacts have been defined in soils immediately outside the back door to the dry cleaner operation on the north side of the building beneath an asphalt driveway/parking area.
- Groundwater impacts are limited to the vicinity of the north end of the building and do not appear to extend off site. Three quarters of sampling data document improving or stable conditions.
- Given these conditions and the observation that any of the soil impacts are beneath existing engineered barriers that preclude both direct contact and infiltration of percolation, can this site be considered for proceeding directly to closure with institutional controls (i.e., GIS Soil and Groundwater Registries) and engineered barriers with an operation and maintenance plan?

- Are there any additional extent of impact definition data needs that the WDNR may want addressed prior to review and approval of the Site Investigation Report?

It is recognized that the WDNR may not be able to provide definitive answers to these questions during the meeting, however, KPRG believes it would be beneficial to discuss these items prior to completing and submitting the Site Investigation Report. We look forward to meeting with you on December 8th. If there are any questions prior to that time, please call me at 262-781-0475.

Sincerely,
KPRG and Associates, Inc.



Richard R. Gnat, P.G.
Principal

cc: Ms. Jill Fitzgerald, Jill's Dry Cleaners
Mr. Donald P. Gallo, Reinhart Boerner Van Deuren, S.C.

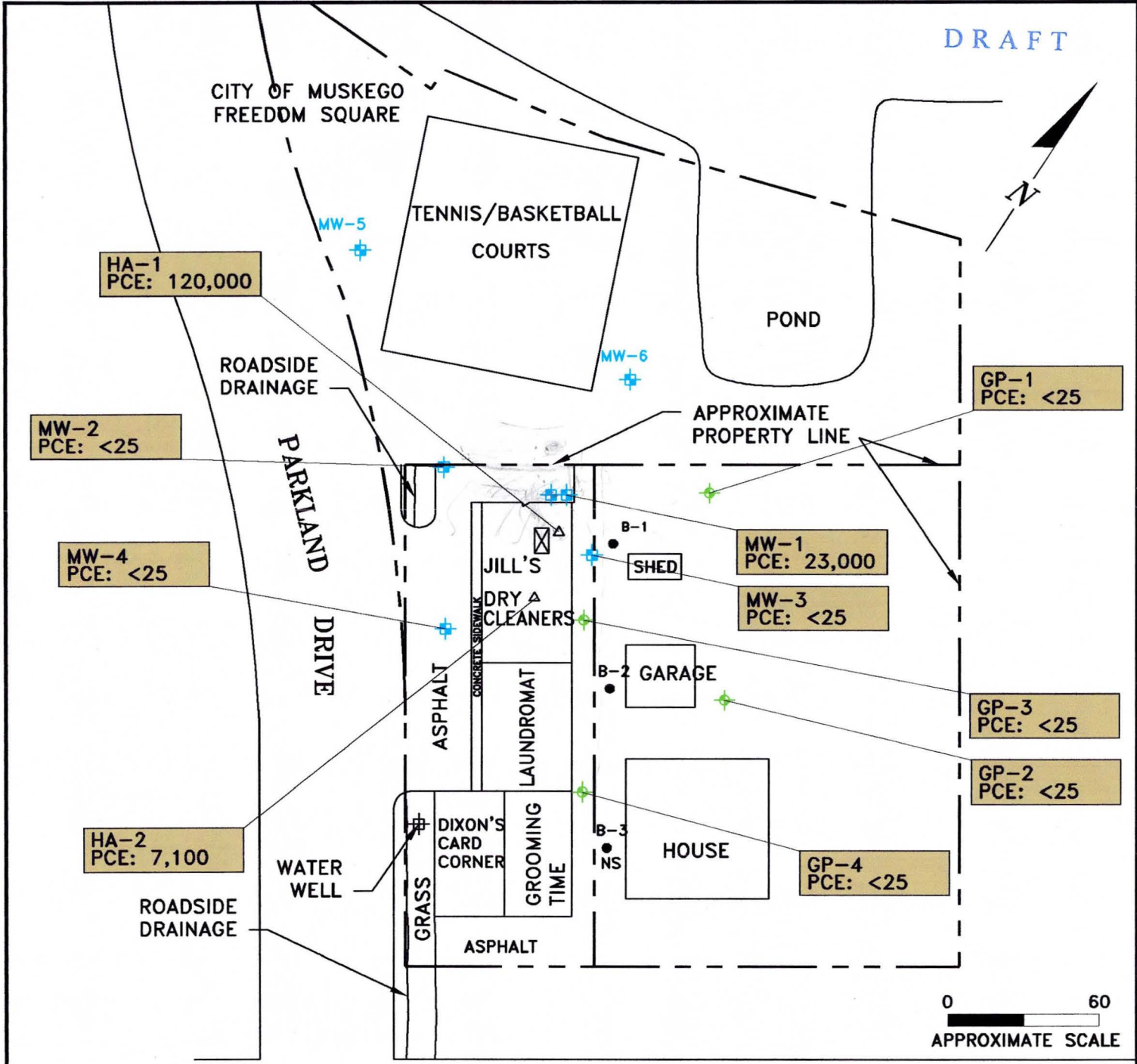

JANESVILLE ROAD

LEGEND

- ☒ LOCATION OF DRY CLEANING MACHINE
- B-1 BENCHMARK ENVIRONMENTAL BORING
- HA-1 PROPOSED HAND AUGER BORING
- GP-2 PROPOSED GEOPROBE BORING.
- MW-4 PROPOSED MONITORING WELL LOCATION

ENVIRONMENTAL CONSULTATION & REMEDIATION

K P R G

KPRG and Associates, Inc.

PCE CONCENTRATION IN SOIL

JILL'S DRY CLEANERS
MUSKEGO, WISCONSIN

Scale: 1"=60'

Date: August 15, 2006

14885 West Lisbon Road, Suite 2B Brookfield, Wisconsin 53005 Telephone 262-781-0475 Facsimile 262-781-0478
414 Plaza Drive, Suite 106 Westmont, Illinois 60559 Telephone 630-325-1300 Facsimile 630-325-1593

KPRG Proposal No. 13905

FIGURE 7

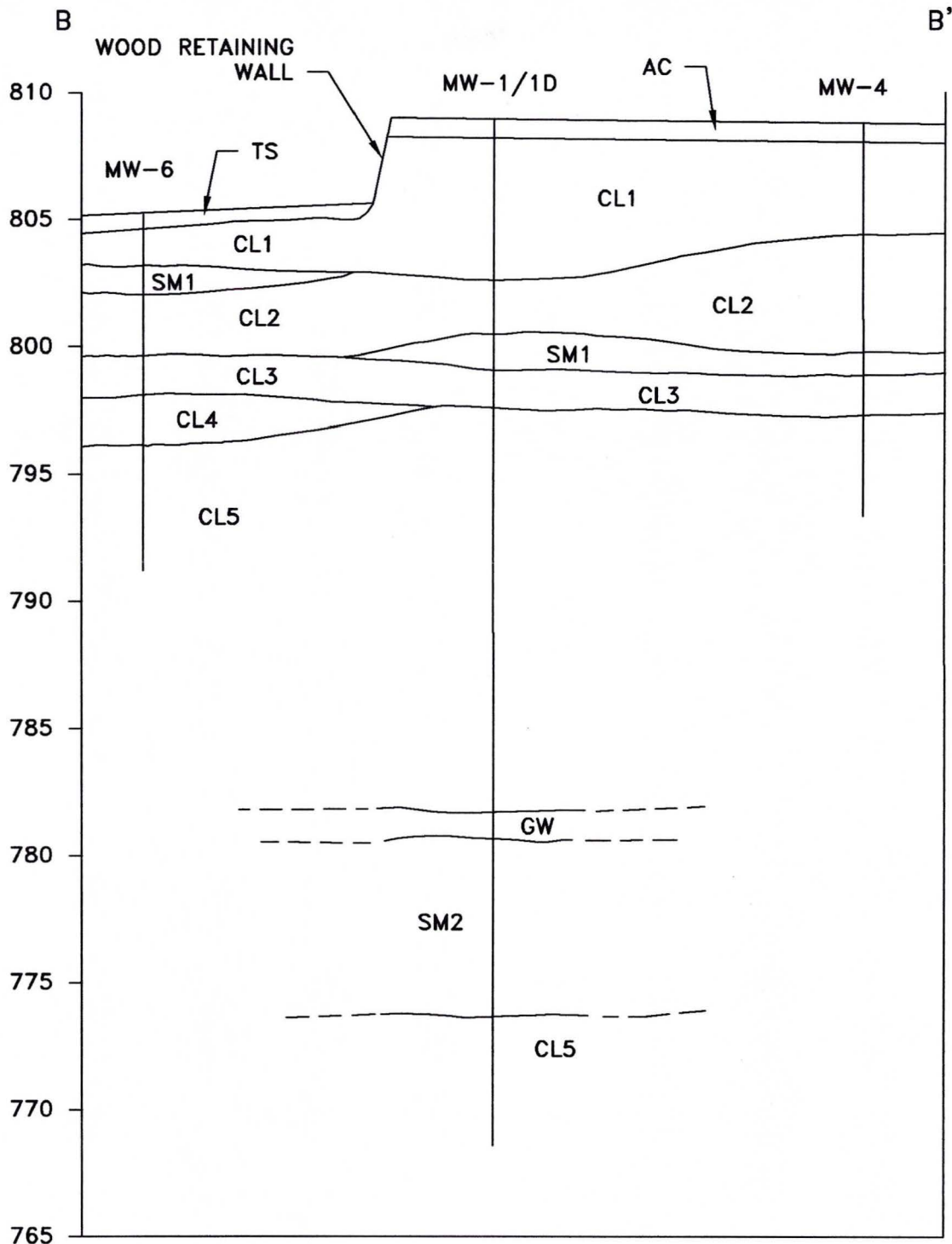

NOTE: SEE FIGURE 6 FOR LEGEND

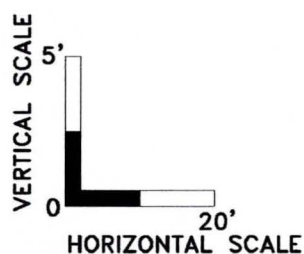

ENVIRONMENTAL CONSULTATION & REMEDIATION		GEOLOGIC CROSS-SECTION B-B'	
 KPRG and Associates, Inc.		JILL'S DRY CLEANING MUSKEGO, WISCONSIN	
		Scale: SEE BARSCALE	Date: September 5, 2006
14665 West Lisbon Road, Suite 2B Brookfield, Wisconsin 53005 Telephone 262-781-0475 Facsimile 262-781-0478 414 Plaza Drive, Suite 106 Westmont, Illinois 60559 Telephone 630-325-1300 Facsimile 630-325-1593		KPRG Project No. 13905	FIGURE 4