

GIS REGISTRY
Cover Sheet

July, 2008
(RR 5367)

Source Property Information

BRRTS #:

ACTIVITY NAME:

PROPERTY ADDRESS:

MUNICIPALITY:

PARCEL ID #:

CLOSURE DATE:

FID #:

DATCP #:

COMM #:

***WTM COORDINATES:**

X: **Y:**

** Coordinates are in
WTM83, NAD83 (1991)*

WTM COORDINATES REPRESENT:

- Approximate Center Of Contaminant Source
- Approximate Source Parcel Center

Please check as appropriate: (BRRTS Action Code)

Contaminated Media:

- | | |
|---|--|
| <input type="checkbox"/> Groundwater Contamination > ES (236) | <input checked="" type="checkbox"/> Soil Contamination > *RCL or **SSRCL (232) |
| <input type="checkbox"/> Contamination in ROW | <input type="checkbox"/> Contamination in ROW |
| <input type="checkbox"/> Off-Source Contamination | <input type="checkbox"/> Off-Source Contamination |
| <i>(note: for list of off-source properties see "Impacted Off-Source Property")</i> | <i>(note: for list of off-source properties see "Impacted Off-Source Property")</i> |

Land Use Controls:

- | | |
|--|---|
| <input type="checkbox"/> Soil: maintain industrial zoning (220) | <input checked="" type="checkbox"/> Cover or Barrier (222) |
| <i>(note: soil contamination concentrations between residential and industrial levels)</i> | <i>(note: maintenance plan for groundwater or direct contact)</i> |
| <input type="checkbox"/> Structural Impediment (224) | <input type="checkbox"/> Vapor Mitigation (226) |
| <input type="checkbox"/> Site Specific Condition (228) | <input type="checkbox"/> Maintain Liability Exemption (230) |
| | <i>(note: local government or economic development corporation)</i> |

Monitoring wells properly abandoned? (234)

- Yes No N/A

** Residual Contaminant Level
** Site Specific Residual Contaminant Level*

This Adobe Fillable form is intended to provide a list of information that is required for evaluation for case closure. It is to be used in conjunction with Form 4400-202, Case Closure Request. The closure of a case means that the Department has determined that no further response is required at that time based on the information that has been submitted to the Department.

NOTICE: Completion of this form is mandatory for applications for case closure pursuant to ch. 292, Wis. Stats. and ch. NR 726, Wis. Adm. Code, including cases closed under ch. NR 746 and ch. NR 726. The Department will not consider, or act upon your application, unless all applicable sections are completed on this form and the closure fee and any other applicable fees, required under ch. NR 749, Wis. Adm. Code, Table 1 are included. It is not the Department's intention to use any personally identifiable information from this form for any purpose other than reviewing closure requests and determining the need for additional response action. The Department may provide this information to requesters as required by Wisconsin's Open Records law [ss. 19.31 - 19.39, Wis. Stats.].

BRRTS #: PARCEL ID #:

ACTIVITY NAME: WTM COORDINATES: X: Y:

CLOSURE DOCUMENTS (the Department adds these items to the final GIS packet for posting on the Registry)

- Closure Letter**
- Maintenance Plan** (if activity is closed with a land use limitation or condition (land use control) under s. 292.12, Wis. Stats.)
- Conditional Closure Letter**
- Certificate of Completion (COC)** for VPLE sites

SOURCE LEGAL DOCUMENTS

- Deed:** The most recent deed as well as legal descriptions, for the **Source Property** (where the contamination originated). Deeds for other, off-source (off-site) properties are located in the **Notification** section.
Note: If a property has been purchased with a land contract and the purchaser has not yet received a deed, a copy of the land contract which includes the legal description shall be submitted instead of the most recent deed. If the property has been inherited, written documentation of the property transfer should be submitted along with the most recent deed.
- Certified Survey Map:** A copy of the certified survey map or the relevant section of the recorded plat map for those properties where the legal description in the most recent deed refers to a certified survey map or a recorded plat map. (lots on subdivided or platted property (e.g. lot 2 of xyz subdivision)).
Figure #: **Title: City Plat, 05343**
- Signed Statement:** A statement signed by the Responsible Party (RP), which states that he or she believes that the attached legal description accurately describes the correct contaminated property.

MAPS (meeting the visual aid requirements of s. NR 716.15(2)(h))

- Maps must be no larger than 8.5 x 14 inches unless the map is submitted electronically.
- Location Map:** A map outlining all properties within the contaminated site boundaries on a U.S.G.S. topographic map or plat map in sufficient detail to permit easy location of all parcels. If groundwater standards are exceeded, include the location of all potable wells within 1200 feet of the site.
Note: Due to security reasons municipal wells are not identified on GIS Packet maps. However, the locations of these municipal wells must be identified on Case Closure Request maps.
Figure #: 1 Title: Site Location Map
 - Detailed Site Map:** A map that shows all relevant features (buildings, roads, individual property boundaries, contaminant sources, utility lines, monitoring wells and potable wells) within the contaminated area. This map is to show the location of all contaminated public streets, and highway and railroad rights-of-way in relation to the source property and in relation to the boundaries of groundwater contamination exceeding a ch. NR 140 Enforcement Standard (ES), and/or in relation to the boundaries of soil contamination exceeding a Residual Contaminant Level (RCL) or a Site Specific Residual Contaminant Levels (SSRCL) as determined under s. NR 720.09, 720.11 and 720.19.
Figure #: 1 Title:
 - Soil Contamination Contour Map:** For sites closing with residual soil contamination, this map is to show the location of all contaminated soil and a single contour showing the horizontal extent of each area of contiguous residual soil contamination that exceeds a Residual Contaminant Level (RCL) or a Site Specific Residual Contaminant Level (SSRCL) as determined under s. NR 720.09, 720.11 and 720.19.
Figure #: 3 Title: Excavated Lift Locations

BRRTS #: 02-11-543971

ACTIVITY NAME: PORTAGE LEVEE SHOP PROPERTY

MAPS (continued)

- Geologic Cross-Section Map:** A map showing the source location and vertical extent of residual soil contamination exceeding a Residual Contaminant Level (RCL) or a Site Specific Residual Contaminant Level (SSRCL). If groundwater contamination exceeds a ch. NR 140 Enforcement Standard (ES) when closure is requested, show the source location and vertical extent, water table and piezometric elevations, and locations and elevations of geologic units, bedrock and confining units, if any.

Figure #: 2 Title: Figure 2

Figure #: Title:

- Groundwater Isoconcentration Map:** For sites closing with residual groundwater contamination, this map shows the horizontal extent of all groundwater contamination exceeding a ch. NR140 Preventive Action Limit (PAL) and an Enforcement Standard (ES). Indicate the direction and date of groundwater flow, based on the most recent sampling data.

Note: This is intended to show the total area of contaminated groundwater.

Figure #: Title:

- Groundwater Flow Direction Map:** A map that represents groundwater movement at the site. If the flow direction varies by more than 20° over the history of the site, submit 2 groundwater flow maps showing the maximum variation in flow direction.

Figure #: Title:

Figure #: Title:

TABLES (meeting the requirements of s. NR 716.15(2)(h)(3))

Tables must be no larger than 8.5 x 14 inches unless the table is submitted electronically. Tables must not contain shading and/or cross-hatching. The use of **BOLD** or *ITALICS* is acceptable.

- Soil Analytical Table:** A table showing remaining soil contamination with analytical results and collection dates.
Note: This is one table of results for the contaminants of concern. Contaminants of concern are those that were found during the site investigation, that remain after remediation. It may be necessary to create a new table to meet this requirement.

Table #: 1 Title: Summary of the chemical analyses results of soil samples

- Groundwater Analytical Table:** Table(s) that show the most recent analytical results and collection dates, for all monitoring wells and any potable wells for which samples have been collected.

Table #: 3 Title: Summary of chemical analyses results of groundwater samples

- Water Level Elevations:** Table(s) that show the previous four (at minimum) water level elevation measurements/dates from all monitoring wells. If present, free product is to be noted on the table.

Table #: Title:

IMPROPERLY ABANDONED MONITORING WELLS

For each monitoring well not properly abandoned according to requirements of s. NR 141.25 include the following documents.

Note: If the site is being listed on the GIS Registry for only an improperly abandoned monitoring well you will only need to submit the documents in this section for the GIS Registry Packet.

- Not Applicable**

- Site Location Map:** A map showing all surveyed monitoring wells with specific identification of the monitoring wells which have not been properly abandoned.

Note: If the applicable monitoring wells are distinctly identified on the Detailed Site Map this Site Location Map is not needed.

Figure #: Title:

- Well Construction Report:** Form 4440-113A for the applicable monitoring wells.

- Deed:** The most recent deed as well as legal descriptions for each property where a monitoring well was not properly abandoned.

- Notification Letter:** Copy of the notification letter to the affected property owner(s).

BRRTS #: 02-11-543971

ACTIVITY NAME: PORTAGE LEVEE SHOP PROPERTY

NOTIFICATIONS

Source Property

- Letter To Current Source Property Owner:** If the source property is owned by someone other than the person who is applying for case closure, include a copy of the letter notifying the current owner of the source property that case closure has been requested.
- Return Receipt/Signature Confirmation:** Written proof of date on which confirmation was received for notifying current source property owner.

Off-Source Property

Group the following information per individual property and label each group according to alphabetic listing on the "Impacted Off-Source Property" attachment.

- Letter To "Off-Source" Property Owners:** Copies of all letters sent by the Responsible Party (RP) to owners of properties with groundwater exceeding an Enforcement Standard (ES), and to owners of properties that will be affected by a land use control under s. 292.12, Wis. Stats.
Note: Letters sent to off-source properties regarding residual contamination must contain standard provisions in Appendix A of ch. NR 726.
Number of "Off-Source" Letters:
- Return Receipt/Signature Confirmation:** Written proof of date on which confirmation was received for notifying any off-source property owner.
- Deed of "Off-Source" Property:** The most recent deed(s) as well as legal descriptions, for all affected deeded **off-source property(ies)**. This does not apply to right-of-ways.
Note: If a property has been purchased with a land contract and the purchaser has not yet received a deed, a copy of the land contract which includes the legal description shall be submitted instead of the most recent deed. If the property has been inherited, written documentation of the property transfer should be submitted along with the most recent deed.
- Letter To "Governmental Unit/Right-Of-Way" Owners:** Copies of all letters sent by the Responsible Party (RP) to a city, village, municipality, state agency or any other entity responsible for maintenance of a public street, highway, or railroad right-of-way, within or partially within the contaminated area, for contamination exceeding a groundwater Enforcement Standard (ES) and/or soil exceeding a Residual Contaminant Level (RCL) or a Site Specific Residual Contaminant Level (SSRCL).
Number of "Governmental Unit/Right-Of-Way Owner" Letters:

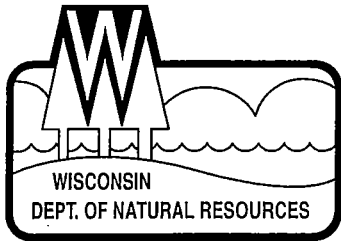

State of Wisconsin \ DEPARTMENT OF NATURAL RESOURCES

Jim Doyle, Governor
Matthew J. Frank, Secretary
Lloyd L. Eagan, Regional Director

South Central Region Headquarters
3911 Fish Hatchery Road
Fitchburg, Wisconsin 53711-5397
Telephone 608-275-3266
FAX 608-275-3338
TTY Access via relay - 711

December 11, 2008

File Ref: 02-11-543971
Columbia County

Mr. Gary Bachus
Samuels Recycling
4400 Sycamore Avenue
Madison, WI 53714

Subject: Final Site Closure: Portage Levee Shop, 700 Mullett Road, Portage, WI

Dear Mr. Bachus:

On December 10, 2008, the South Central Region Closure Committee reviewed the above referenced case for closure. This committee reviews environmental remediation cases for compliance with state laws and standards to maintain consistency in the closure of these cases. Based on the correspondence and data provided, it appears that this case meets the requirements of ch. NR 726, Wisconsin Administrative Code. The Department considers this case closed and no further investigation or remediation is required at this time.

GIS Registry

The conditions of case closure require that the site be listed on the Remediation and Redevelopment Program's GIS Registry. The specific reasons are summarized below:

- Residual soil contamination exists that must be properly managed should it be excavated or removed
- A soil barrier must be maintained over remaining solid waste and contaminated soil and the state must approve any changes to this barrier

Information that was submitted with this closure request application will be included on the GIS Registry. To review the sites on the GIS Registry web page, visit the RR Sites Map page at <http://dnr.wi.gov/org/aw/rr/gis/index.htm>.

Closure Conditions

Please be aware that pursuant to s. 292.12 Wisconsin Statutes, compliance with the requirements of this letter is a responsibility to which the current and any subsequent property owners must adhere. If these requirements are not followed or if additional information regarding site conditions indicates that contamination on or from the site poses a threat to public health, safety, welfare, or the environment, the Department may take enforcement action under s. 292.11 Wisconsin Statutes to ensure compliance with the specified requirements, limitations or other conditions related to the property or this case may be reopened pursuant to s. NR 726.09, Wis. Adm. Code. It is the Department's intent to conduct inspections in the future to ensure that the conditions included in this letter including compliance with referenced maintenance plans are met.

Cover or Barrier

Pursuant to s. 292.12(2)(a), Wis. Stats., the soil cover that currently exists across the property shall be maintained in compliance with the attached maintenance plan in order to prevent direct contact with residual solid waste or soil contamination that might otherwise pose a threat to human health. If contaminated soil is excavated in the future, the property owner at the time of excavation must sample and analyze the excavated soil to determine if residual contamination remains. If sampling confirms that contamination is present the property owner at the time of excavation will need to determine whether the material would be considered solid or hazardous waste and ensure that any storage, treatment or disposal is in compliance with applicable statutes and rules. In addition, all current and future owners and occupants of the property need to be aware that excavation of the contaminated soil may pose an inhalation or other direct contact hazard and as a result special precautions may need to be taken during excavation activities to prevent a health threat to humans.

The attached maintenance plan and inspection log are to be kept up-to-date. The inspection log need only be submitted to the Department upon request.

Prohibited Activities

The following activities are prohibited on any portion of the property where the soil cover, is required, unless prior written approval has been obtained from the Department 1) removal of the existing barrier; 2) replacement with another barrier; 3) excavating or grading of the land surface; 4) filling on capped or paved areas; 5) plowing for agricultural cultivation; or 6) construction or placement of a building or other structure.

The Department appreciates your efforts to restore the environment at this site. If you have any questions regarding this closure decision please contact Mike Schmoller at 608-275-3303.

Sincerely,



Patrick McCutcheon
South Central Region Remediation & Redevelopment Team Supervisor

Cc: CPI Environmental Services, Inc, 1123 Wheaton Oaks Court, Wheaton, IL 60187

SOIL BARRIER MAINTENANCE PLAN PORTAGE LEVEE SHOP – SITE 36

Property Located at:
700 Mullett Road
Portage, Wisconsin

Township 12 North, Range 9 East Section 5
Bureau of Remediation and Redevelopment Tracking Number: 02-11-543971

Introduction

This document is the Maintenance Plan for a soil barrier at the Portage Levee Shop property in accordance with the requirements of s. NR724.13(2), Wisconsin Administrative Code. The maintenance activities relate to the existing soil cover occupying the area over the residual contaminated soil and solid waste material. The contaminated soil is impacted by lead and residual waste from past battery disposal activities. The location of the soil barrier is shown on the attached map. (Exhibit A)

Soil Barrier Purpose

The soil barrier serves to prevent direct human contact with residual waste material and soil contamination. Based on the current and future use of the property, the barrier should function as intended unless disturbed.

Annual Inspection

The soil barrier will be inspected once per year, normally in the spring after all snow and ice is gone, for deterioration or other problems that can cause exposure to the underlying soils and/or waste. The inspections will be performed to evaluate damage due to settling, exposure to the weather, wear from traffic, increasing age and other factors. Any area where contaminated soils or waste have become or are likely to become exposed will be documented. A log of the inspections and any repairs will be maintained by the property owner and is included as Exhibit B, Cap Inspection Log. A copy of the inspection log will be sent to the Wisconsin Department of Natural Resources South Central Region Remediation and Redevelopment Program at least annually after each inspection.

Maintenance Activities

If problems are noted during the annual inspections or at any other time of the year, repairs will be scheduled as soon as possible. In the event that necessary maintenance activities expose underlying contaminated soils or waste, the owner must inform maintenance workers of the direct contact exposure risk and provide them with appropriate personal protection equipment (PPE). The owner must also sample any soil that is excavated from the site prior to disposal to determine if contamination remains. The soil and/or waste must be treated, stored and disposed of by the owner in accordance with applicable local, state and federal law.

In the event the soil barrier is removed or replaced, the replacement barrier must be equally protective. Any replacement barrier will be subject to the same maintenance and inspection guidelines as outlined in this maintenance plan unless otherwise indicated by the WDNR.

Amendment or Withdrawal of Maintenance Plan

This plan can be amended or withdrawn by the property owner and its successors with the written approval of WDNR.

Contact Information

Site Owner and Operator:

Wisconsin Department of Natural Resources





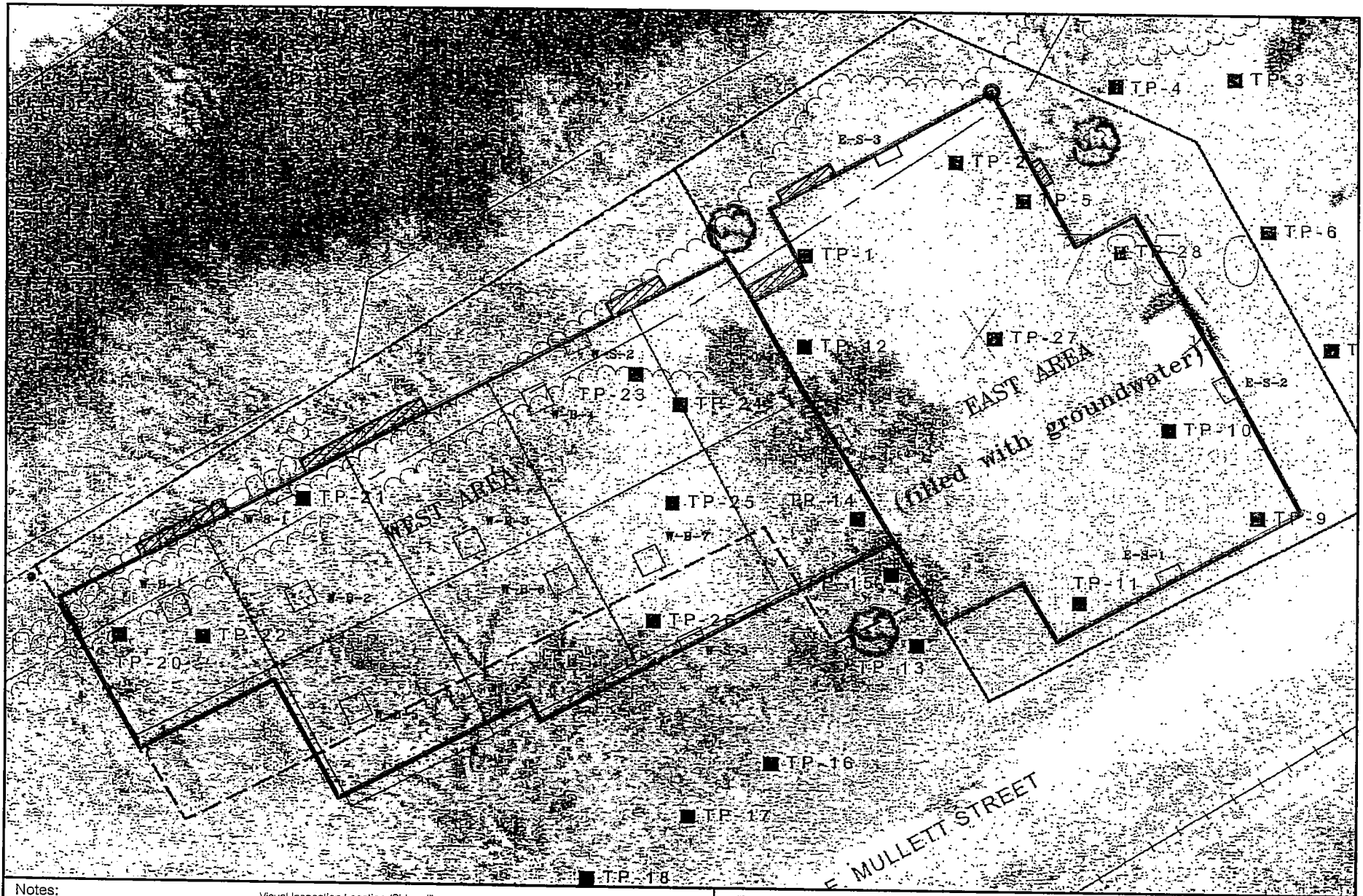

South Central Region

Remediation and Redevelopment Program

3911 Fish Hatchery Road

Fitchburg, WI

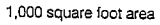

Notes:  Excavation Boundary  Tree Location (greater than 12-inches in diameter)  Visual Inspection Location (Sidewall)  Visual Inspection Location (Base)  Residual Battery Casings in Excavation Sidewall  1,000 square foot area		
	Date: November 21, 2008 Project No: E05-114-63-684	Project Manager: MBP Prepared By: DPC Drafted By: DPC Reviewed By: MBP



Continental Placer Inc.
CPI Environmental Services, Inc.
 1123 Wheaton Oaks Ct
 Wheaton, Illinois 60187
www.continentalplacer.com
 Phone: (630) 407-0800
 Fax: (630) 407-0799

Figure 4 (Revised)
Visual Inspection locations
 Site 36
 Mullet Street, Portage, Wisconsin

Exhibit B
Barrier INSPECTION LOG

Inspection Date	Inspector	Condition of Cap	Recommendations	Have Recommendations from previous inspection been implemented?

CITY PLAT

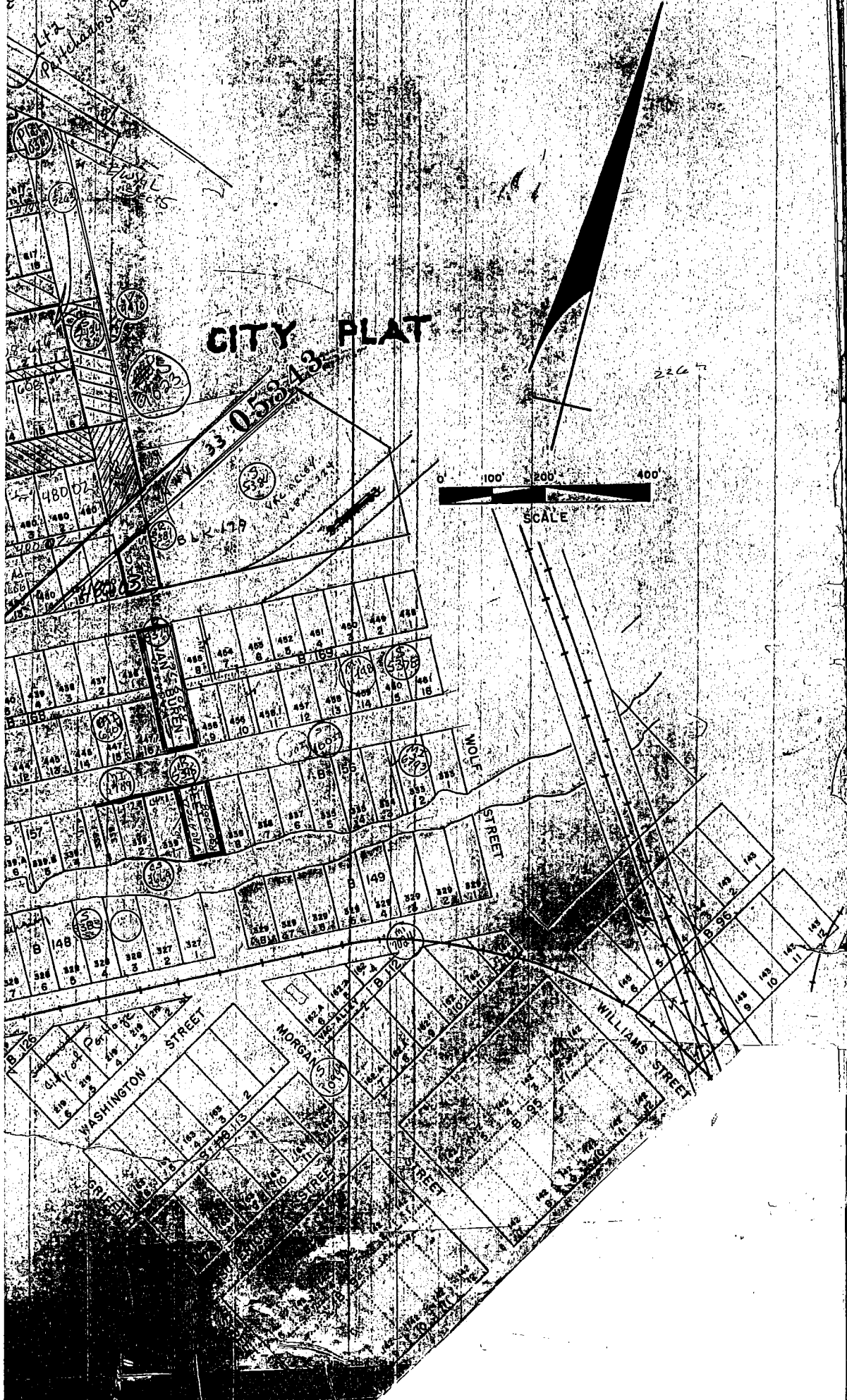

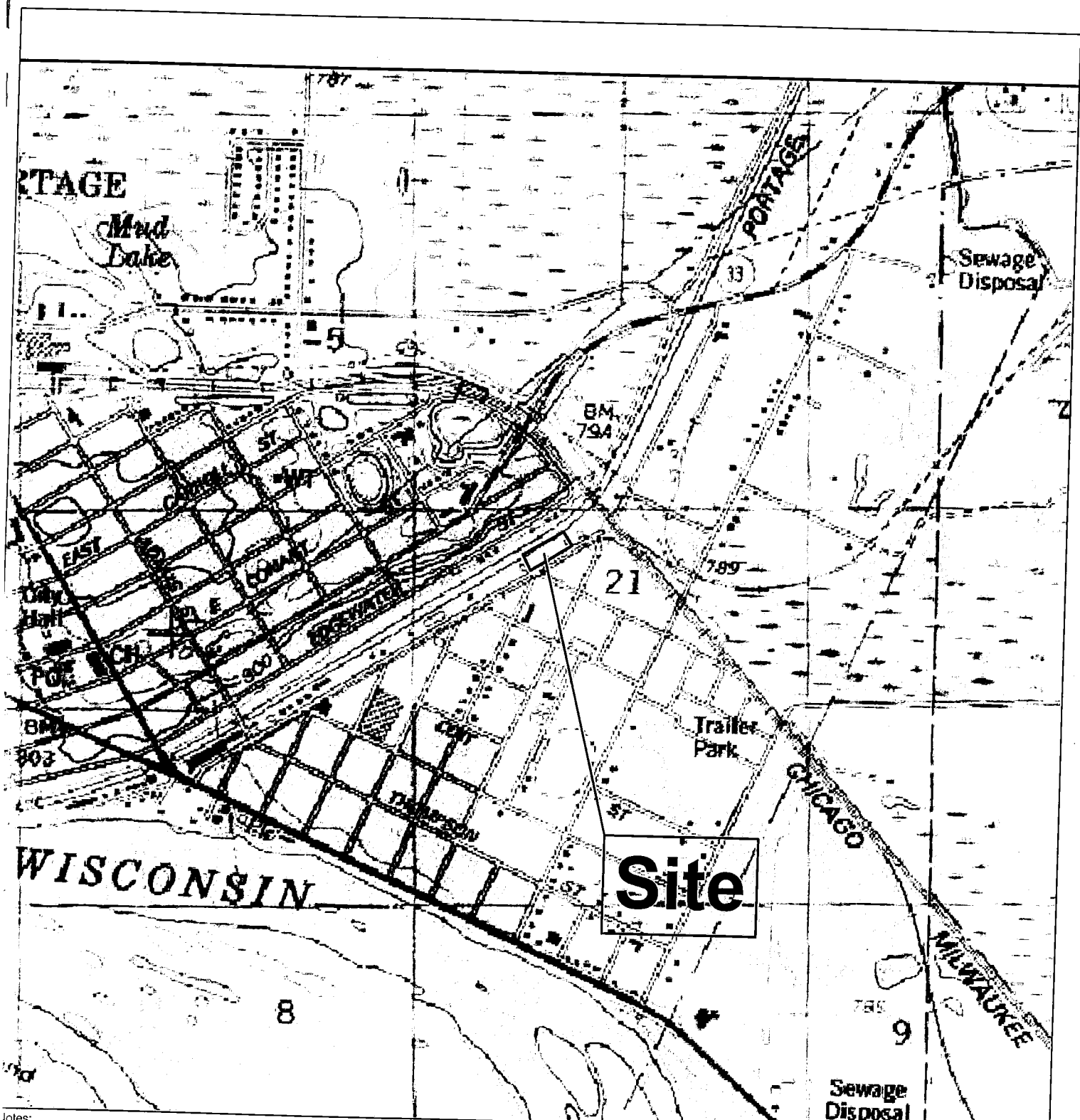

Notes:



Continental Placer Inc.
 CPI Environmental Services, Inc.

1123 Wheaton Oaks Ct
 Wheaton, Illinois 60187
 Phone: (630) 407-0800 Fax: (630) 407-0799



Date: June 6, 2008
 Project No: E05-114-63-684

Project Manager: MBP
 Prepared By: DPC
 Drafted By:
 Reviewed By:

FIGURE 1
 Site Location Map
 SRC/ Site 36
 Portage, Wisconsin

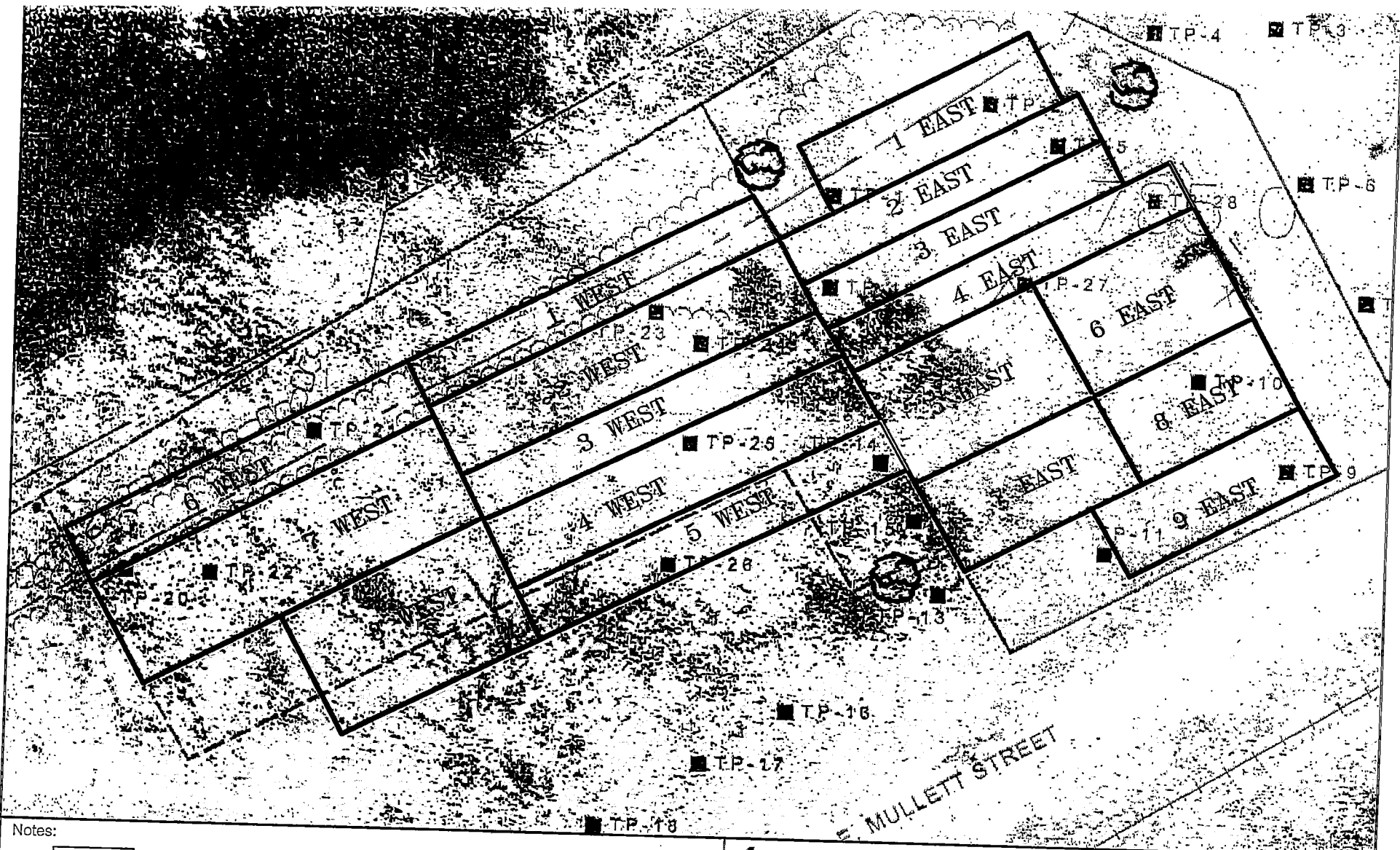

Notes:

- 1 EAST Excavation Lift Boundary and Identifier
-  Tree Location (greater than 12-inches in diameter)



Date: November 7, 2008
 Project Manager: MBP
 Prepared By: DPC
 Drafted By: DPC
 Reviewed By: MBP

Project No: E05-114-63-684







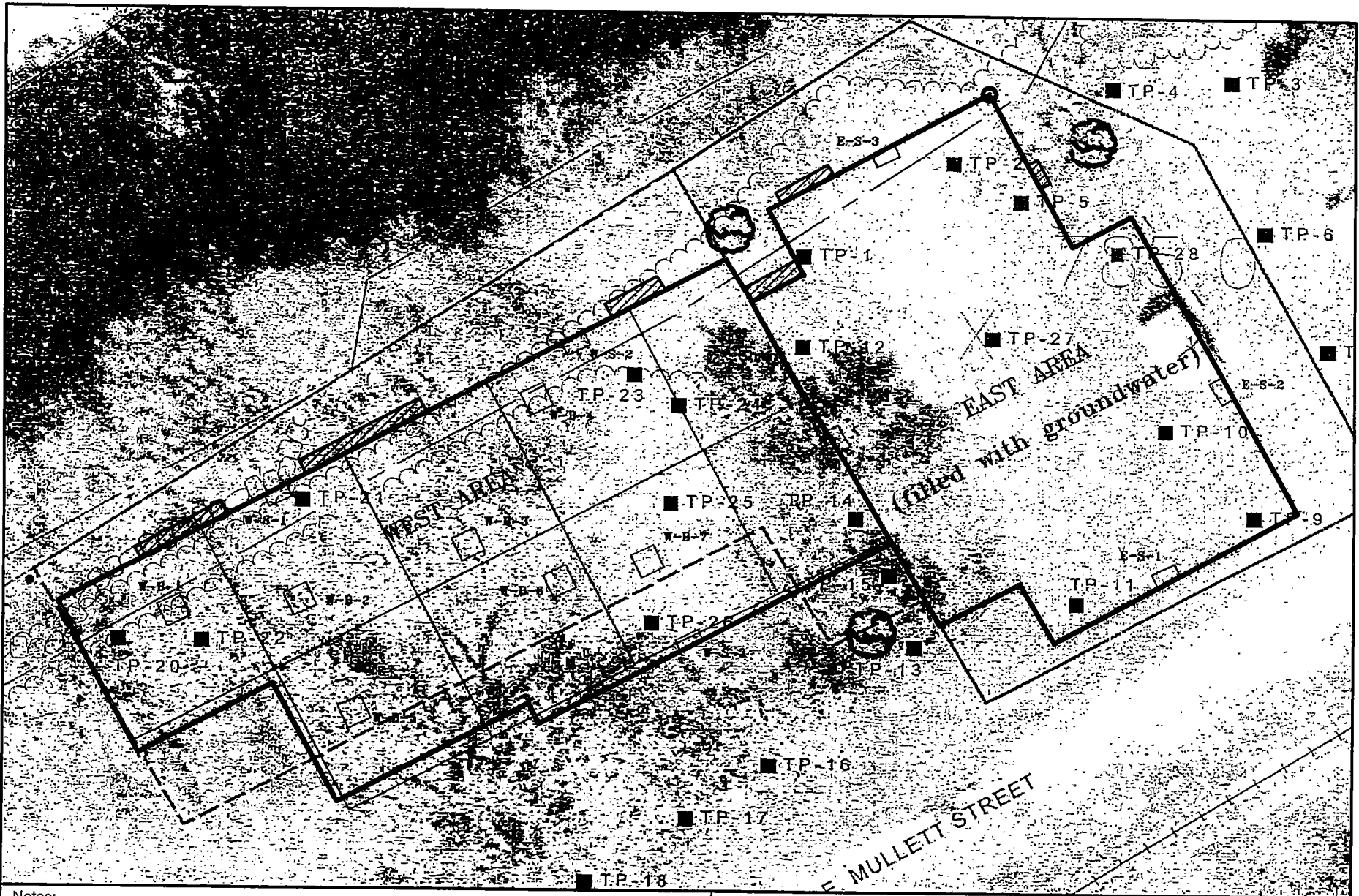

Continental Placer Inc.
CPI Environmental Services, Inc.
 1123 Wheaton Oaks Ct
 Wheaton, Illinois 60187
www.continentalplacer.com
 Phone: (630) 407-0800

Fax: (630) 407-0799

Figure 3
 Excavated Lift locations
 Site 36
 Mullet Street, Portage, Wisconsin

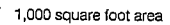

Notes:  Excavation Boundary  Tree Location (greater than 12-inches in diameter)  Visual Inspection Location (Sidewall)  Visual Inspection Location (Base)  1,000 square foot area  Residual Battery Casings in Excavation Sidewall		Date: November 21, 2008 Project No: E05-114-63-684	Project Manager: MBP Prepared By: DPC Drafted By: DPC Reviewed By: MBP
			



Continental Placer Inc.
CPI Environmental Services, Inc.
 1123 Wheaton Oaks Ct
 Wheaton, Illinois 60187
www.continentalplacer.com
 Phone: (630) 407-0800 Fax: (630) 407-0799

Figure 4 (Revised)
Visual Inspection locations
 Site 36
 Mullet Street, Portage, Wisconsin

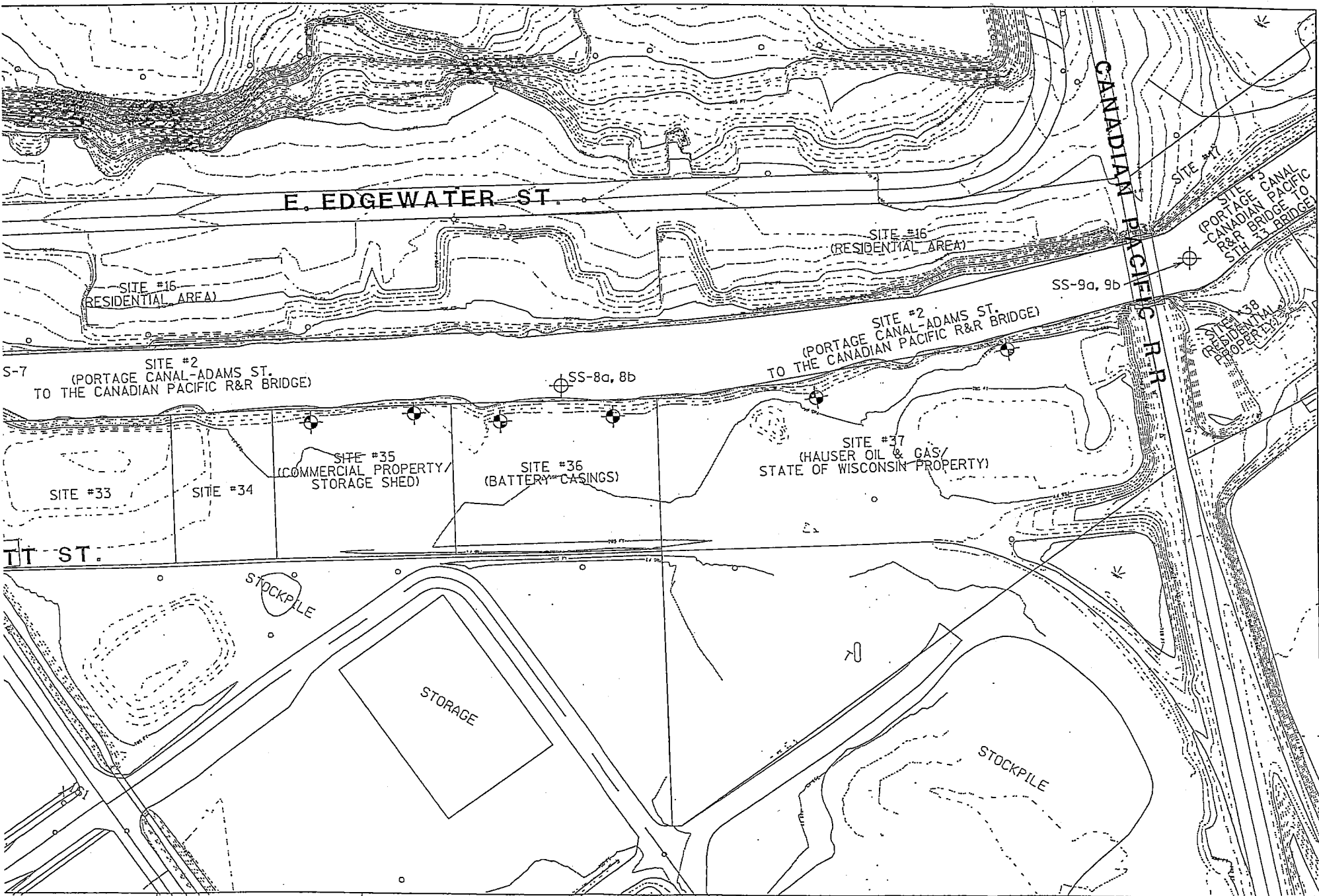

FIGURE 1

+ 785.7

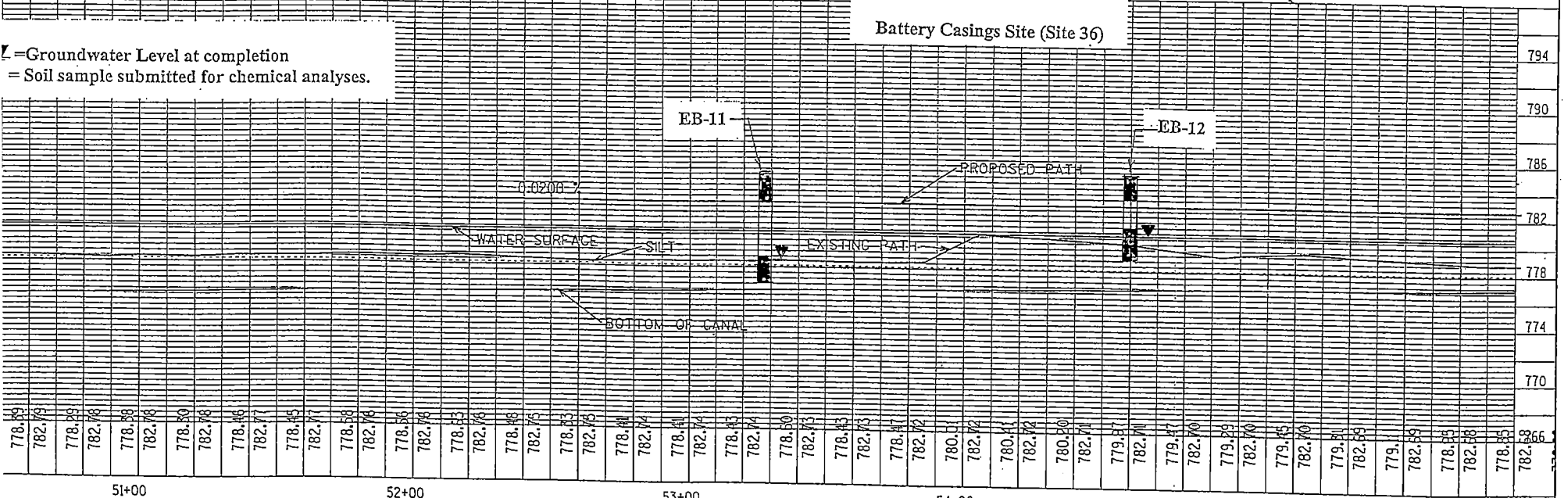
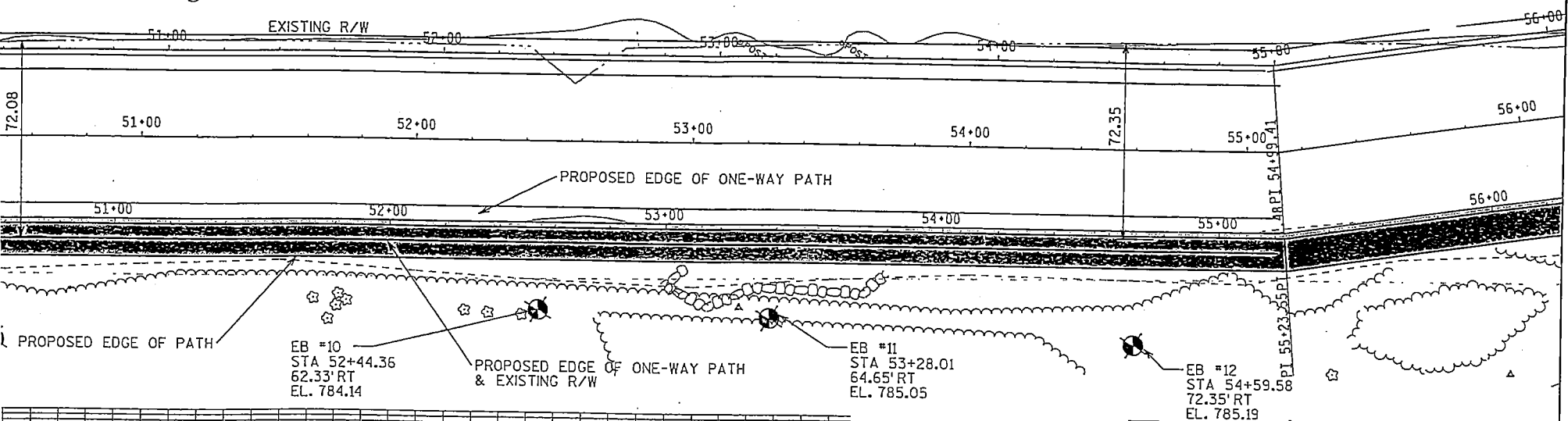

FIGURE 2

Drawing provided by Mead & Hunt, Inc.

Table 1: Summary of the chemical analyses results of soil samples.
(continued)

Chemical Compound †	SES Sample Identification Number				WDNR Limits
	EB11 S1	EB11 S4	EB12 S1	EB12 S3	
DRO and GRO analyses. Results in mg/kg.					RCL
DRO	✓ 420	✓ 8.6	✓ 430	✓ 26	100
GRO	✓ <1.8>	<1.7	<1.5>	<1.7	100
PVOC analyses. Results in mg/kg.					
Toluene	<0.025	<0.025	<0.034>	<0.025	1.5
1,2,4-Trimethylbenzene	<<0.025>>	<<0.025>>	<0.025	<0.025	—
m- & p-Xylene	<0.025	<0.025	<0.025	<0.025	4.1
o-Xylene	<0.025	<0.025	0.11	<0.025	
PAH analysis. Results in mg/kg.					
Benzo(a)anthracene	◆ 0.35	—	0.74	—	—
Benzo(a)pyrene	◆ 0.55	—	<0.030	—	—
Benzo(b)fluoranthene	◆ 0.67	—	1.6	—	—
Benzo(g,h,i)perylene	0.80	—	<0.066	—	—
Benzo(k)fluoranthene	0.20	—	<0.046	—	—
Chrysene	<0.40>	—	6.9	—	—
Fluoranthene	✓◆ 1.3	—	1.4	—	—
Indeno(1,2,3,c,d)pyrene	0.48	—	<0.072	—	—
Phenanthrene	<0.14	—	0.56	—	—
Pyrene	1.4	—	3.2	—	—

Please refer to Table 1 on page 8 for the definitions of symbols, notes, and print styles used in this table.



Table 2: Summary of the chemical analyses results of soil samples.

Chemical Compound †	SES Sample Identification Number				WDNR Limits	
	EB11 S1	EB11 S4	EB12 S1	EB12 S3		
Sample Acquisition Date	7/8/03	7/8/03	7/8/03	7/8/03		
Laboratory Received Date	7/10/03	7/10/03	7/10/03	7/10/03		
Miscellaneous analyses. Results in % dry weight.						
Total Solids	87.7	75.7	90.4	77.7	—	—
Moisture Content	12.3	24.3	9.6	22.3	—	—
Total Metals analyses. Results in ^{mg} / _{kg} .					Non-Ind	Ind
As	19.7	<1.1>	33.6	2.7	0.039	1.6
Ba	1,220	58.3	418	13.1		
Cd	33.7	0.78	13.4	0.34	8	510
Cr, total	82.6	9.5	105	3.7	* 14	* 200
Cu	1,710	139	510	17.0	† 16,000	† NA
Fe	101,000	7,000	44,100	3290		
Pb	2,980	335	5,410	4730	50	500
Mg	7,170	13,000	5,630	720		
Ni	229	7.1	77.6	3.4		
Se	<0.59 >	<0.38 >	1.0	<0.29		
Zn	16,300	255	215	194		
Hg	X 2.6	0.11	0.31	0.04 9		

Please refer to Table 1 on page 8 for the definitions of symbols, notes, and print styles used in this table.



Table 3: Summary of chemical analyses results of groundwater samples.

CHEMICAL COMPOUND†	SAMPLE IDENTIFICATION NUMBER				WDNR Groundwater Standards	
	EB11	EB12				
Sample Acquisition Date	7/8/03	7/8/03			ES PAL	
Laboratory Received Date	7/10/03	7/10/03				
TSS analysis. Results in mg/L.						
TSS	12,200	3,630			—	—
Dissolved Metals analyses. Results in µg/L.						
Ba	191	128			2,000	400
Fe	<32	<108>			—	—
Pb	<2.8	149			15	1.5
Mg	42,500	29,800			—	—
Ni	<5.3	<9.3>			100	20
Se	24.4	18.6			50	10
Zn	123	1,020			—	—
GRO and DRO analyses. Results in µg/L.						
DRO	✓ 1600	✓ 300			—	—
GRO	✓ 1700	<24			—	—
PVOC analyses. Results in µg/L.						
Ethylbenzene	31	<0.40			700	140
1,2,4-Trimethylbenzene	280	<0.30			480	96
1,3,5-Trimethylbenzene	70	<0.30				
m- & p-Xylene	530	<0.70			10,000	1,000
o-Xylene	<3.0	<0.30				

Please refer to Table 1 on page 8 for the definitions of symbols, notes, and print styles used in this table.

