

**From:** Beggs, Tauren R - DNR  
**Sent:** Wednesday, April 12, 2023 2:37 PM  
**To:** Paul Lindquist  
**Cc:** Kristin Jones (Kristin.Jones@newellco.com); Dan Koski; Witte, Edward; Jeanne Tarvin; Susan Petrofske; Adam Tegen  
**Subject:** RE: BRRTS #: 02-36-545108 (MIRRO PLT 9 [Former] - LGU) - Data Transmittal Letter: Sewer Vapor Samples

Thanks Paul, I will take a look at the results.

Regards,

**We are committed to service excellence.**

Visit our survey at <http://dnr.wi.gov/customersurvey> to evaluate how I did.

**Tauren R. Beggs**

Phone: (920) 510-3472

[Tauren.Beggs@wisconsin.gov](mailto:Tauren.Beggs@wisconsin.gov) (preferred contact method during work at home)

---

**From:** Paul Lindquist <[PLINDQUIST@ramboll.com](mailto:PLINDQUIST@ramboll.com)>  
**Sent:** Monday, April 10, 2023 1:52 PM  
**To:** Beggs, Tauren R - DNR <[Tauren.Beggs@wisconsin.gov](mailto:Tauren.Beggs@wisconsin.gov)>; Adam Tegen <[ategen@manitowoc.org](mailto:ategen@manitowoc.org)>  
**Cc:** Kristin Jones (<[Kristin.Jones@newellco.com](mailto:Kristin.Jones@newellco.com)>) <[kristin.jones@newellco.com](mailto:kristin.jones@newellco.com)>; Dan Koski <[dkoski@manitowoc.org](mailto:dkoski@manitowoc.org)>; Witte, Edward <[nwitte@gklaw.com](mailto:nwitte@gklaw.com)>; Jeanne Tarvin <[jtarvin@ramboll.com](mailto:jtarvin@ramboll.com)>; Susan Petrofske <[SPETROFSKE@ramboll.com](mailto:SPETROFSKE@ramboll.com)>  
**Subject:** BRRTS #: 02-36-545108 (MIRRO PLT 9 [Former] - LGU) - Data Transmittal Letter: Sewer Vapor Samples

Good afternoon Tauren and Adam,

Attached for your records is a copy of the data transmittal letter for the vapor samples collected from the select sanitary sewer and storm sewer locations completed as part of the site investigation of the former Mirro Plant No. 9 facility (BRRTS #02-36-545108) located at 1512 Washington Street in Manitowoc, WI. Please note, a copy of the letter and attachments has been uploaded to the WDNR RR Program Submission Portal.

Thank you.

**Paul Lindquist**

Managing Consultant  
1692722 - Great Lakes

D +1 262-901-3510  
M +1 612-209-8676  
[plindquist@ramboll.com](mailto:plindquist@ramboll.com)

---

Connect with us 

Ramboll  
234 W. Florida Street  
Fifth Floor

Milwaukee, WI 53204  
USA  
<https://ramboll.com>

Classification: Confidential

**Sent Via E-Mail**

Mr. Tauren Beggs  
Wisconsin Department of Natural Resources  
2984 Shawano Avenue  
Green Bay, WI 54313-6727

Mr. Adam Tegen  
Community Development Director  
City of Manitowoc  
900 Quay Street  
Manitowoc, WI 54220

**NR 716.14 DATA TRANSMITTAL  
SANITARY AND STORM SEWER VAPOR SAMPLING RESULTS  
FORMER MIRRO PLANT NO. 9 FACILITY  
1512 WASHINGTON STREET, MANITOWOC, WISCONSIN  
WDNR BRRTS NO. 02-36-545108**

Dear Mr. Beggs and Mr. Tegen:

Ramboll US Consulting, Inc. (Ramboll), on behalf of Newell Operating Company (NOC), is providing the Wisconsin Department of Natural Resources (WDNR) and the City of Manitowoc (the "City") with the attached analytical results for vapor samples collected from eight sanitary sewer manholes and four storm sewer manholes located near or upstream the former Mirro Plant No. 9 facility (the "facility" or "site"). All detections were below the recommended sanitary sewer gas screening level (SSGSL) recommended by WDNR guidance document RR-649. Overall, these results document that vapors within the sanitary and storm sewer networks encompassing the former Mirro 9 facility do not exceed WDNR recommended criteria or pose a risk to nearby structures. As a result, no further sewer vapor sampling is warranted at this time.

The samples were collected on March 6, 2023, in accordance with the approved *Additional Site Investigation Work Plan* submitted to WDNR on June 3, 2022, and approved on July 12, 2022. A draft figure showing the sampling locations is attached along with draft tabulated results (Attachment A) and the laboratory analytical report (Attachment B).

If you have any questions or require additional information, please feel contact us via the information below.

Yours sincerely,



**Paul D. Lindquist**  
Managing Consultant

D +1 262 901 3510  
[plindquist@ramboll.com](mailto:plindquist@ramboll.com)

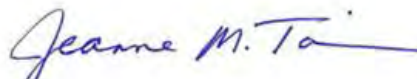

**Jeanne M. Tarvin, PG, CPG**  
E&H Americas Country Market Director

D +1 262 901 0085  
[jtarkin@ramboll.com](mailto:jtarkin@ramboll.com)

cc: Kristin Jones, NOC  
Dan Koski, City of Manitowoc  
Edward Witte, Godfrey and Kahn

April 10, 2023

Ramboll  
234 W. Florida Street  
Fifthe Floor  
Milwaukee, WI 53204  
USA

T +1 414 837 3607  
F +1 414 837 3608  
[www.ramboll.com](http://www.ramboll.com)

Ref. 1690019647

## **ATTACHMENT A**

**TABLE 1: SEWER VAPOR ANALYTICAL RESULTS**

**FIGURE 1: SEWER VAPOR SAMPLE LOCATIONS**

**Table 1. Utility Vapor Sample Analytical Results**

Former Mirro Plant No. 9  
 1512 Washington Street, Manitowoc, WI 54220  
 FID No.: 436033730 BRRTS No.: 02-36-545108

Field Sample ID		PVOC		PVOC		PVOC		PVOC		PVOC		PVOC		PVOC		CVOC		CVOC		CVOC		CVOC		CVOC		CVOC		CVOC		CVOC		CVOC											
		1,2,4-Trimethylbenzene	1,3,5-Trimethylbenzene	Benzene	Ethylbenzene	Naphthalene	Xylene, o	Xylenes, m + p	Xylenes, Total	1,1,2-Trichloroethane	1,1-Dichloroethane	1,2,4-Trichlorobenzene	1,2-Dichlorobenzene	1,3-Dichlorobenzene	1,4-Dichlorobenzene	Chlorobenzene	Chloromethane	cis-1,2-Dichloroethene	n-Propylbenzene	Tetrachloroethene	trans-1,2-Dichloroethene	Trichloroethene																					
Reporting Units:		µg/m <sup>3</sup>		µg/m <sup>3</sup>		µg/m <sup>3</sup>		µg/m <sup>3</sup>		µg/m <sup>3</sup>		µg/m <sup>3</sup>		µg/m <sup>3</sup>		µg/m <sup>3</sup>		µg/m <sup>3</sup>		µg/m <sup>3</sup>		µg/m <sup>3</sup>		µg/m <sup>3</sup>		µg/m <sup>3</sup>		µg/m <sup>3</sup>		µg/m <sup>3</sup>													
		Result	Flag	Result	Flag	Result	Flag	Result	Flag	Result	Flag	Result	Flag	Result	Flag	Result	Flag	Result	Flag	Result	Flag	Result	Flag	Result	Flag	Result	Flag	Result	Flag	Result	Flag	Result	Flag										
SSGSL AF = 0.03: <sup>1</sup>		2,100		2,100		120		370		28		3,300		3,300		3,300		7		590		70		7,000		NS		87		1,700		3,100		1,400		NS		1,400		1,400		70	
2-71B-SAN-20230306	03/06/2023	<5.0	U	<5.0	U	<3.2	U	<4.4	U	<11	U	<4.4	U	<4.4	U	<8.8	U	<5.5	U	<4.1	U	<30	U	<6.1	U	<6.1	U	<6.1	U	<4.7	U	<21	U	<4.0	U	<5.0	U	<6.9	U	<4.0	U	<5.4	U
2-71-SAN-20230306	03/06/2023	<5.0	U	<5.0	U	<3.2	U	<4.4	U	<10	U	<4.4	U	<4.4	U	<8.8	U	<5.5	U	<4.1	U	<30	U	<6.1	U	<6.1	U	<6.1	U	<4.6	U	<21	U	5.4		<5.0	U	24		<4.0	U	20	
2-72A-SAN-20230306	03/06/2023	<5.4	U	<5.4	U	5.5		<4.8	U	<11	U	<4.8	U	<4.8	U	<9.5	U	<6.0	U	<4.4	U	<32	U	<6.6	U	<6.6	U	<6.6	U	<5.0	U	<23	U	<4.3	U	<5.4	U	8.2		<4.3	U	<5.9	U
2-88-SAN-20230306	03/06/2023	<4.7	U	<4.7	U	<3.0	U	<4.1	U	<10	U	<4.1	U	<4.1	U	<8.2	U	<5.2	U	<3.8	U	<28	U	<5.7	U	<5.7	U	<5.7	U	<4.4	U	<20	U	<3.8	U	<4.7	U	<6.4	U	<3.8	U	<5.1	U
7-14A-SAN-20230306	03/06/2023	<5.2	U	<5.2	U	<3.4	U	<4.6	U	<11	U	<4.6	U	<4.6	U	<9.2	U	<5.8	U	<4.3	U	<31	U	<6.4	U	<6.4	U	<6.4	U	<4.9	U	<22	U	<4.2	U	<5.2	U	<7.2	U	<4.2	U	<5.7	U
7-1-SAN-20230306	03/06/2023	<4.7	U	<4.7	U	<3.1	U	<4.2	U	<10	U	<4.2	U	<4.2	U	<8.4	U	<5.3	U	<3.9	U	<29	U	<5.8	U	<5.8	U	<5.8	U	<4.4	U	<20	U	9.4		<4.7	U	17		<3.8	U	33	
7-220-SAN-20230306	03/06/2023	<4.9	U	<4.9	U	12		<4.4	U	<10	U	<4.4	U	<4.4	U	<8.7	U	<5.5	U	<4.1	U	<30	U	<6.0	U	<6.0	U	<6.0	U	<4.6	U	<21	U	<4.0	U	<4.9	U	<6.8	U	<4.0	U	<5.4	U
7-69-SAN-20230306	03/06/2023	<4.9	U	<4.9	U	3.7		<4.3	U	<10	U	<4.3	U	<4.3	U	<8.6	U	<5.4	U	<4.0	U	<29	U	<6.0	U	<6.0	U	<6.0	U	<4.6	U	<20	U	<3.9	U	<4.9	U	6.9		<3.9	U	13	
R16-10-STM-20230306	03/06/2023	<5.2	U	<5.2	U	<3.4	U	<4.6	U	<11	U	<4.6	U	<4.6	U	<9.2	U	<5.8	U	<4.3	U	<31	U	<6.3	U	<6.3	U	<6.3	U	<4.8	U	<22	U	<4.2	U	<5.2	U	<7.2	U	<4.2	U	<5.7	U
R16-11-STM-20230306	03/06/2023	<5.2	U	<5.2	U	<3.4	U	<4.6	U	<11	U	<4.6	U	<4.6	U	<9.2	U	<5.8	U	<4.3	U	<32	U	<6.4	U	<6.4	U	<6.4	U	<4.9	U	<22	U	<4.2	U	<5.2	U	<7.2	U	<4.2	U	<5.7	U
R16-12-STM-20230306	03/06/2023	<4.8	U	<4.8	U	<3.1	U	<4.2	U	<10	U	<4.2	U	<4.2	U	<8.4	U	<5.3	U	<3.9	U	<29	U	<5.8	U	<5.8	U	<5.8	U	<4.5	U	<20	U	<3.8	U	<4.8	U	<6.6	U	<3.8	U	<5.2	U
R16-9-STM-20230306	03/06/2023	<4.9	U	<4.9	U	<3.2	U	<4.3	U	<10	U	<4.3	U	<4.3	U	<8.6	U	<5.4	U	<4.0	U	<30	U	<6.0	U	<6.0	U	<6.0	U	<4.6	U	<20	U	5.7		<4.9	U	<6.7	U	<3.9	U	<5.3	U

[O:MGF 4/4/23]

*Italics* is greater than SSGSL AF = 0.03  
 Gray Text analyte not detected

**Screening Levels:**  
 SSGSL AF based on U.S.EPA Regional Screening Level Tables; see <http://dnr.wi.gov/topic/brownfields/vapor.html> for more details.  
 1. Sanitary sewer vapor analytical results are compared residential VRSL with an attenuation factor of 0.03 based on recommendations identified in the Department of Defense Environmental Security Technology Certification Program (ESTCP) Investigation Protocol for Sewer and Utility Tunnels as Preferential Pathways for Volatile Organic Compound Migration into Buildings: Risk Factors and Investigation Protocol (ESTCP Project ER-201505).

**Results & Flags:**  
 < = Concentration was not detected above the reported limit  
 J = Estimated concentration  
 U = Concentration was not detected above the reported limit

**Acronyms:**  
 µg/m<sup>3</sup> = micrograms per cubic meter  
 BRRTS = Bureau for Remediation and Redevelopment Tracking System (Wisconsin Department of Natural Resources (WDNR))  
 CVOC = Chlorinated Volatile Organic Compound  
 FID = facility identification number  
 PVOC = Petroleum Volatile Organic Compound  
 SSGSL = Sanitary Sewer Gas Screening Level  
 VRSL = Vapor Risk Screening Level (= VAL/Attenuation Factor) for subsurface samples

Lab comments, additional data qualifiers and definitions can be found in associated laboratory reports.

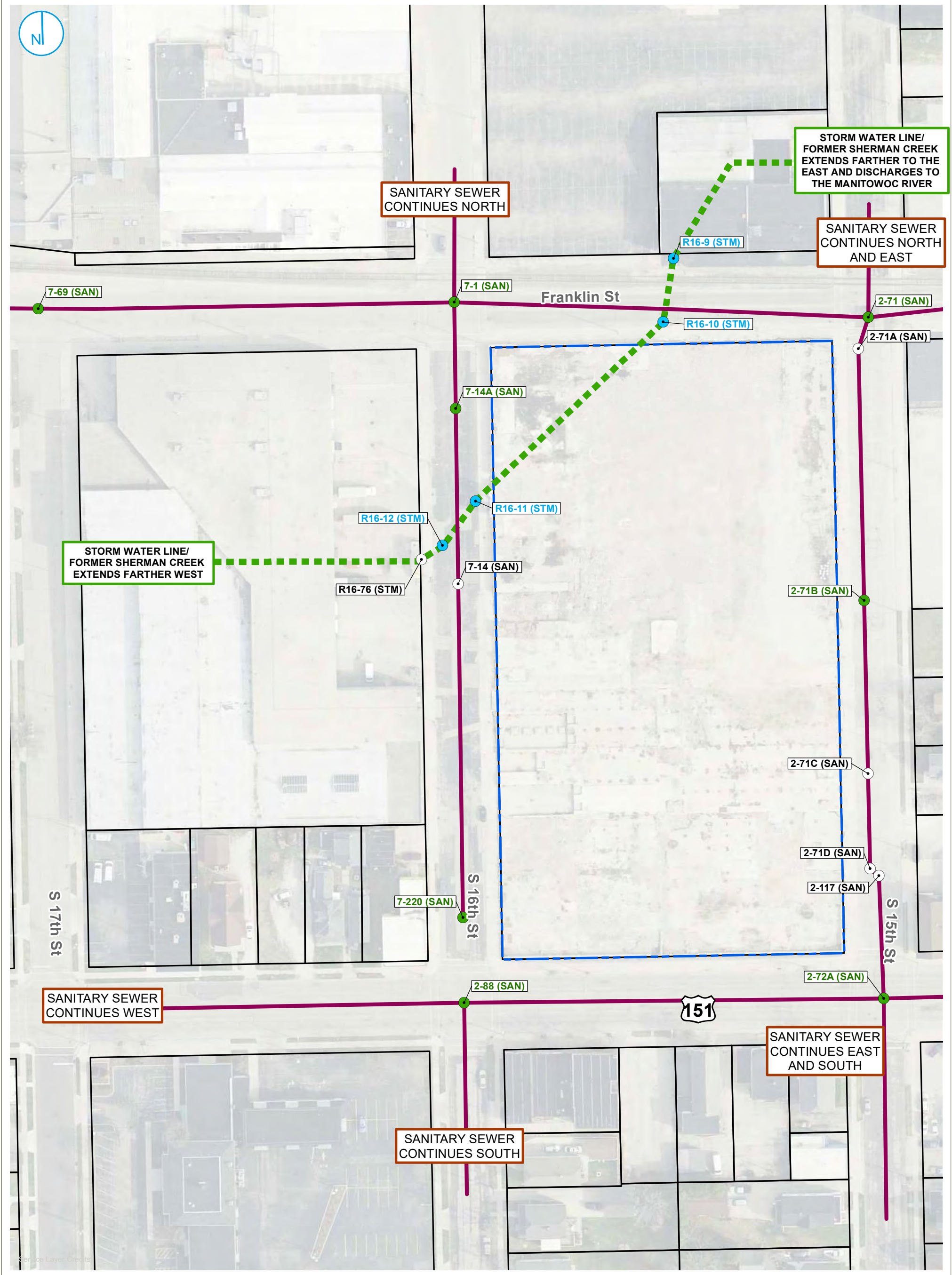

- SANITARY SEWER MANHOLE SAMPLING LOCATION
- STORM SEWER CATCH BASIN/MANHOLE SAMPLING LOCATION
- SANITARY SEWER MANHOLE LOCATION
- SANITARY SEWER MAIN
- STORM SEWER TUNNEL
- PROPERTY BOUNDARY
- PARCEL BOUNDARY



SOURCE OF SANITARY SEWERS, STORM SEWERS, AND SEWER FEATURES IS A FIGURE PROVIDED BY THE CITY OF MANITOWOC ENGINEERING DIVISION

### SEWER VAPOR SAMPLING LOCATIONS

FIGURE 1

**DRAFT**

RAMBOLL US CONSULTING, INC.



FORMER MIRRO PLANT NO. 9  
MANITOWOC, WISCONSIN



**ATTACHMENT B**  
**LABORATORY ANALYTICAL REPORT**

**Analytical Report**

3/31/2023

Mr. Paul Lindquist

Ramboll

234 W. Florida St.

5th Floor

Milwaukee WI 53204

Project Name: MIRRO 9

Project #: 1690019647

Workorder #: 2303443R1

Dear Mr. Paul Lindquist

The following report includes the data for the above referenced project for sample(s) received on 3/13/2023 at Eurofins Air Toxics LLC.

The data and associated QC analyzed by TO-15 are compliant with the project requirements or laboratory criteria with the exception of the deviations noted in the attached case narrative.

Thank you for choosing Eurofins Air Toxics LLC. for your air analysis needs. Eurofins Air Toxics Inc. is committed to providing accurate data of the highest quality. Please feel free to contact the Project Manager: Jade White at 916-985-1000 if you have any questions regarding the data in this report.

Regards,



Jade White

Project Manager



**WORK ORDER #: 2303443R1**

Work Order Summary

<b>CLIENT:</b>	Mr. Paul Lindquist Ramboll 234 W. Florida St. 5th Floor Milwaukee, WI 53204	<b>BILL TO:</b>	Accounts Payable Ramboll P.O. Box 4873 Syracuse, NY 13221-4873
<b>PHONE:</b>	414-837-3544	<b>P.O. #</b>	
<b>FAX:</b>		<b>PROJECT #</b>	1690019647 MIRRO 9
<b>DATE RECEIVED:</b>	03/13/2023	<b>CONTACT:</b>	Jade White
<b>DATE COMPLETED:</b>	03/24/2023		
<b>DATE REISSUED:</b>	03/30/2023		

<u>FRACTION #</u>	<u>NAME</u>	<u>TEST</u>	<u>RECEIPT VAC./PRES.</u>	<u>FINAL PRESSURE</u>
01A	7-220-SAN-20230306	TO-15	4.9 "Hg	10 psi
02A	2-88-SAN-20230306	TO-15	3.5 "Hg	10 psi
03A	2-72A-SAN-20230306	TO-15	6.9 "Hg	10.1 psi
04A	2-71-SAN-20230306	TO-15	5.3 "Hg	9.8 psi
05A	7-1 SAN-20230306	TO-15	3.9 "Hg	10 psi
06A	7-69-SAN-20230306	TO-15	4.7 "Hg	9.9 psi
07A	2-71B-SAN-20230306	TO-15	5.3 "Hg	9.9 psi
08A	R-16-10-STM-20230306	TO-15	6.1 "Hg	10 psi
09A	R16-9-STM-20230306	TO-15	4.9 "Hg	9.8 psi
10A	7-14A SAN 20230306	TO-15	6.1 "Hg	10.1 psi
11A	R16-11-STM-20230306	TO-15	6.5 "Hg	9.8 psi
12A	R16-12-STM-20230306	TO-15	4.3 "Hg	9.7 psi
13A	Lab Blank	TO-15	NA	NA
14A	CCV	TO-15	NA	NA
15A	LCS	TO-15	NA	NA
15AA	LCSD	TO-15	NA	NA

CERTIFIED BY:   
 \_\_\_\_\_  
 Technical Director

DATE: 03/31/23

Certification numbers: AZ Licensure AZ0775, FL NELAP – E87680, LA NELAP – 02089, NH NELAP – 209222, NJ NELAP - CA016, NY NELAP - 11291, TX NELAP – T104704434-22-18, UT NELAP – CA009332022-14, VA NELAP - 12240, WA ELAP - C935  
 Name of Accreditation Body: NELAP/ORELAP (Oregon Environmental Laboratory Accreditation Program) CA300005-017  
 Eurofins Environment Testing Northern California, LLC certifies that the test results contained in this report meet all requirements of the 2016 TNI Standard.

*This report shall not be reproduced, except in full, without the written approval of Eurofins Air Toxics, LLC.*  
 180 BLUE RAVINE ROAD, SUITE B FOLSOM, CA - 95630  
 (916) 985-1000 . (800) 985-5955 . FAX (916) 351-8279

**LABORATORY NARRATIVE**  
**EPA Method TO-15**  
**Ramboll**  
**Workorder# 2303443R1**

Twelve 1 Liter Summa Canister (100% Certified) samples were received on March 13, 2023. The laboratory performed analysis via EPA Method TO-15 using GC/MS in the full scan mode.

**Receiving Notes**

The Chain of Custody (COC) information for samples 7-220-SAN-20230306, 2-72A-SAN-20230306, 7-14A SAN 20230306 and R-16-10-STM-20230306 did not match the entries on the sample tags with regard to sample identification. Therefore the information on the COC was used to process and report the samples.

Per client request via email on 3/30/23, the identification of sample 7-1-SAN-20230306 was revised to 7-14A SAN 20230306. As a result, the sample identification no longer matches the information on the Chain of Custody.

The work order was reissued on 3/31/2023 to change identification of sample 7-14A SAN 20230306 per email provided by the client.

**Analytical Notes**

Total Xylenes concentration is calculated by summing the individual concentrations of m,p-Xylene and O-Xylene.

**Definition of Data Qualifying Flags**

Ten qualifiers may have been used on the data analysis sheets and indicates as follows:

B - Compound present in laboratory blank greater than reporting limit (background subtraction not performed).

J - Estimated value.

E - Exceeds instrument calibration range.

S - Saturated peak.

Q - Exceeds quality control limits.

U - Compound analyzed for but not detected above the reporting limit, LOD, or MDL value. See data page for project specific U-flag definition.

UJ- Non-detected compound associated with low bias in the CCV

N - The identification is based on presumptive evidence.

M - Reported value may be biased due to apparent matrix interferences.

CN - See Case Narrative.

File extensions may have been used on the data analysis sheets and indicates as follows:

a-File was requantified

b-File was quantified by a second column and detector

r1-File was requantified for the purpose of reissue



Air Toxics

### Summary of Detected Compounds EPA METHOD TO-15 GC/MS FULL SCAN

Client Sample ID: 7-220-SAN-20230306

Lab ID#: 2303443R1-01A

Compound	Rpt. Limit (ppbv)	Amount (ppbv)	Rpt. Limit (ug/m3)	Amount (ug/m3)
Benzene	1.0	3.9	3.2	12

Client Sample ID: 2-88-SAN-20230306

Lab ID#: 2303443R1-02A

No Detections Were Found.

Client Sample ID: 2-72A-SAN-20230306

Lab ID#: 2303443R1-03A

Compound	Rpt. Limit (ppbv)	Amount (ppbv)	Rpt. Limit (ug/m3)	Amount (ug/m3)
Benzene	1.1	1.7	3.5	5.5
Tetrachloroethene	1.1	1.2	7.4	8.2

Client Sample ID: 2-71-SAN-20230306

Lab ID#: 2303443R1-04A

Compound	Rpt. Limit (ppbv)	Amount (ppbv)	Rpt. Limit (ug/m3)	Amount (ug/m3)
cis-1,2-Dichloroethene	1.0	1.4	4.0	5.4
Trichloroethene	1.0	3.8	5.4	20
Tetrachloroethene	1.0	3.6	6.8	24

Client Sample ID: 7-1 SAN-20230306

Lab ID#: 2303443R1-05A

Compound	Rpt. Limit (ppbv)	Amount (ppbv)	Rpt. Limit (ug/m3)	Amount (ug/m3)
cis-1,2-Dichloroethene	0.96	2.4	3.8	9.4
Trichloroethene	0.96	6.1	5.2	33
Tetrachloroethene	0.96	2.5	6.5	17

Client Sample ID: 7-69-SAN-20230306

Lab ID#: 2303443R1-06A



Air Toxics

### Summary of Detected Compounds EPA METHOD TO-15 GC/MS FULL SCAN

**Client Sample ID: 7-69-SAN-20230306**

**Lab ID#: 2303443R1-06A**

<b>Compound</b>	<b>Rpt. Limit (ppbv)</b>	<b>Amount (ppbv)</b>	<b>Rpt. Limit (ug/m3)</b>	<b>Amount (ug/m3)</b>
Benzene	0.99	1.2	3.2	3.7
Trichloroethene	0.99	2.4	5.3	13
Tetrachloroethene	0.99	1.0	6.7	6.9

**Client Sample ID: 2-71B-SAN-20230306**

**Lab ID#: 2303443R1-07A**

No Detections Were Found.

**Client Sample ID: R-16-10-STM-20230306**

**Lab ID#: 2303443R1-08A**

No Detections Were Found.

**Client Sample ID: R16-9-STM-20230306**

**Lab ID#: 2303443R1-09A**

<b>Compound</b>	<b>Rpt. Limit (ppbv)</b>	<b>Amount (ppbv)</b>	<b>Rpt. Limit (ug/m3)</b>	<b>Amount (ug/m3)</b>
cis-1,2-Dichloroethene	1.0	1.4	3.9	5.7

**Client Sample ID: 7-14A SAN 20230306**

**Lab ID#: 2303443R1-10A**

No Detections Were Found.

**Client Sample ID: R16-11-STM-20230306**

**Lab ID#: 2303443R1-11A**

No Detections Were Found.

**Client Sample ID: R16-12-STM-20230306**

**Lab ID#: 2303443R1-12A**

No Detections Were Found.



Air Toxics

Client Sample ID: 7-220-SAN-20230306

Lab ID#: 2303443R1-01A

EPA METHOD TO-15 GC/MS FULL SCAN

File Name:	a032208	Date of Collection:	3/6/23 9:28:00 AM
Dil. Factor:	2.01	Date of Analysis:	3/22/23 03:15 PM

Compound	Rpt. Limit (ppbv)	Amount (ppbv)	Rpt. Limit (ug/m3)	Amount (ug/m3)
Chloromethane	10	Not Detected	21	Not Detected
trans-1,2-Dichloroethene	1.0	Not Detected	4.0	Not Detected
1,1-Dichloroethane	1.0	Not Detected	4.1	Not Detected
cis-1,2-Dichloroethene	1.0	Not Detected	4.0	Not Detected
Benzene	1.0	3.9	3.2	12
Trichloroethene	1.0	Not Detected	5.4	Not Detected
1,1,2-Trichloroethane	1.0	Not Detected	5.5	Not Detected
Tetrachloroethene	1.0	Not Detected	6.8	Not Detected
Chlorobenzene	1.0	Not Detected	4.6	Not Detected
Ethyl Benzene	1.0	Not Detected	4.4	Not Detected
m,p-Xylene	1.0	Not Detected	4.4	Not Detected
o-Xylene	1.0	Not Detected	4.4	Not Detected
Propylbenzene	1.0	Not Detected	4.9	Not Detected
1,3,5-Trimethylbenzene	1.0	Not Detected	4.9	Not Detected
1,2,4-Trimethylbenzene	1.0	Not Detected	4.9	Not Detected
1,3-Dichlorobenzene	1.0	Not Detected	6.0	Not Detected
1,4-Dichlorobenzene	1.0	Not Detected	6.0	Not Detected
1,2-Dichlorobenzene	1.0	Not Detected	6.0	Not Detected
1,2,4-Trichlorobenzene	4.0	Not Detected	30	Not Detected
Naphthalene	2.0	Not Detected	10	Not Detected
Total Xylenes	2.0	Not Detected	8.7	Not Detected

Container Type: 1 Liter Summa Canister (100% Certified)

Surrogates	%Recovery	Method Limits
Toluene-d8	94	70-130
1,2-Dichloroethane-d4	96	70-130
4-Bromofluorobenzene	97	70-130



Air Toxics

Client Sample ID: 2-88-SAN-20230306

Lab ID#: 2303443R1-02A

EPA METHOD TO-15 GC/MS FULL SCAN

File Name:	a032209	Date of Collection:	3/6/23 9:51:00 AM
Dil. Factor:	1.90	Date of Analysis:	3/22/23 03:42 PM

Compound	Rpt. Limit (ppbv)	Amount (ppbv)	Rpt. Limit (ug/m3)	Amount (ug/m3)
Chloromethane	9.5	Not Detected	20	Not Detected
trans-1,2-Dichloroethene	0.95	Not Detected	3.8	Not Detected
1,1-Dichloroethane	0.95	Not Detected	3.8	Not Detected
cis-1,2-Dichloroethene	0.95	Not Detected	3.8	Not Detected
Benzene	0.95	Not Detected	3.0	Not Detected
Trichloroethene	0.95	Not Detected	5.1	Not Detected
1,1,2-Trichloroethane	0.95	Not Detected	5.2	Not Detected
Tetrachloroethene	0.95	Not Detected	6.4	Not Detected
Chlorobenzene	0.95	Not Detected	4.4	Not Detected
Ethyl Benzene	0.95	Not Detected	4.1	Not Detected
m,p-Xylene	0.95	Not Detected	4.1	Not Detected
o-Xylene	0.95	Not Detected	4.1	Not Detected
Propylbenzene	0.95	Not Detected	4.7	Not Detected
1,3,5-Trimethylbenzene	0.95	Not Detected	4.7	Not Detected
1,2,4-Trimethylbenzene	0.95	Not Detected	4.7	Not Detected
1,3-Dichlorobenzene	0.95	Not Detected	5.7	Not Detected
1,4-Dichlorobenzene	0.95	Not Detected	5.7	Not Detected
1,2-Dichlorobenzene	0.95	Not Detected	5.7	Not Detected
1,2,4-Trichlorobenzene	3.8	Not Detected	28	Not Detected
Naphthalene	1.9	Not Detected	10	Not Detected
Total Xylenes	1.9	Not Detected	8.2	Not Detected

Container Type: 1 Liter Summa Canister (100% Certified)

Surrogates	%Recovery	Method Limits
Toluene-d8	95	70-130
1,2-Dichloroethane-d4	99	70-130
4-Bromofluorobenzene	96	70-130



Air Toxics

Client Sample ID: 2-72A-SAN-20230306

Lab ID#: 2303443R1-03A

EPA METHOD TO-15 GC/MS FULL SCAN

File Name:	a032210	Date of Collection:	3/6/23 10:10:00 AM
Dil. Factor:	2.19	Date of Analysis:	3/22/23 04:09 PM

Compound	Rpt. Limit (ppbv)	Amount (ppbv)	Rpt. Limit (ug/m3)	Amount (ug/m3)
Chloromethane	11	Not Detected	23	Not Detected
trans-1,2-Dichloroethene	1.1	Not Detected	4.3	Not Detected
1,1-Dichloroethane	1.1	Not Detected	4.4	Not Detected
cis-1,2-Dichloroethene	1.1	Not Detected	4.3	Not Detected
Benzene	1.1	1.7	3.5	5.5
Trichloroethene	1.1	Not Detected	5.9	Not Detected
1,1,2-Trichloroethane	1.1	Not Detected	6.0	Not Detected
Tetrachloroethene	1.1	1.2	7.4	8.2
Chlorobenzene	1.1	Not Detected	5.0	Not Detected
Ethyl Benzene	1.1	Not Detected	4.8	Not Detected
m,p-Xylene	1.1	Not Detected	4.8	Not Detected
o-Xylene	1.1	Not Detected	4.8	Not Detected
Propylbenzene	1.1	Not Detected	5.4	Not Detected
1,3,5-Trimethylbenzene	1.1	Not Detected	5.4	Not Detected
1,2,4-Trimethylbenzene	1.1	Not Detected	5.4	Not Detected
1,3-Dichlorobenzene	1.1	Not Detected	6.6	Not Detected
1,4-Dichlorobenzene	1.1	Not Detected	6.6	Not Detected
1,2-Dichlorobenzene	1.1	Not Detected	6.6	Not Detected
1,2,4-Trichlorobenzene	4.4	Not Detected	32	Not Detected
Naphthalene	2.2	Not Detected	11	Not Detected
Total Xylenes	2.2	Not Detected	9.5	Not Detected

Container Type: 1 Liter Summa Canister (100% Certified)

Surrogates	%Recovery	Method Limits
Toluene-d8	93	70-130
1,2-Dichloroethane-d4	97	70-130
4-Bromofluorobenzene	96	70-130



Air Toxics

Client Sample ID: 2-71-SAN-20230306

Lab ID#: 2303443R1-04A

EPA METHOD TO-15 GC/MS FULL SCAN

File Name:	a032211	Date of Collection:	3/6/23 10:31:00 AM
Dil. Factor:	2.02	Date of Analysis:	3/22/23 04:36 PM

Compound	Rpt. Limit (ppbv)	Amount (ppbv)	Rpt. Limit (ug/m3)	Amount (ug/m3)
Chloromethane	10	Not Detected	21	Not Detected
trans-1,2-Dichloroethene	1.0	Not Detected	4.0	Not Detected
1,1-Dichloroethane	1.0	Not Detected	4.1	Not Detected
cis-1,2-Dichloroethene	1.0	1.4	4.0	5.4
Benzene	1.0	Not Detected	3.2	Not Detected
Trichloroethene	1.0	3.8	5.4	20
1,1,2-Trichloroethane	1.0	Not Detected	5.5	Not Detected
Tetrachloroethene	1.0	3.6	6.8	24
Chlorobenzene	1.0	Not Detected	4.6	Not Detected
Ethyl Benzene	1.0	Not Detected	4.4	Not Detected
m,p-Xylene	1.0	Not Detected	4.4	Not Detected
o-Xylene	1.0	Not Detected	4.4	Not Detected
Propylbenzene	1.0	Not Detected	5.0	Not Detected
1,3,5-Trimethylbenzene	1.0	Not Detected	5.0	Not Detected
1,2,4-Trimethylbenzene	1.0	Not Detected	5.0	Not Detected
1,3-Dichlorobenzene	1.0	Not Detected	6.1	Not Detected
1,4-Dichlorobenzene	1.0	Not Detected	6.1	Not Detected
1,2-Dichlorobenzene	1.0	Not Detected	6.1	Not Detected
1,2,4-Trichlorobenzene	4.0	Not Detected	30	Not Detected
Naphthalene	2.0	Not Detected	10	Not Detected
Total Xylenes	2.0	Not Detected	8.8	Not Detected

Container Type: 1 Liter Summa Canister (100% Certified)

Surrogates	%Recovery	Method Limits
Toluene-d8	95	70-130
1,2-Dichloroethane-d4	97	70-130
4-Bromofluorobenzene	96	70-130





Air Toxics

Client Sample ID: 7-1 SAN-20230306

Lab ID#: 2303443R1-05A

EPA METHOD TO-15 GC/MS FULL SCAN

File Name:	a032212	Date of Collection:	3/6/23 10:52:00 AM
Dil. Factor:	1.93	Date of Analysis:	3/22/23 05:03 PM

Compound	Rpt. Limit (ppbv)	Amount (ppbv)	Rpt. Limit (ug/m3)	Amount (ug/m3)
Chloromethane	9.6	Not Detected	20	Not Detected
trans-1,2-Dichloroethene	0.96	Not Detected	3.8	Not Detected
1,1-Dichloroethane	0.96	Not Detected	3.9	Not Detected
cis-1,2-Dichloroethene	0.96	2.4	3.8	9.4
Benzene	0.96	Not Detected	3.1	Not Detected
Trichloroethene	0.96	6.1	5.2	33
1,1,2-Trichloroethane	0.96	Not Detected	5.3	Not Detected
Tetrachloroethene	0.96	2.5	6.5	17
Chlorobenzene	0.96	Not Detected	4.4	Not Detected
Ethyl Benzene	0.96	Not Detected	4.2	Not Detected
m,p-Xylene	0.96	Not Detected	4.2	Not Detected
o-Xylene	0.96	Not Detected	4.2	Not Detected
Propylbenzene	0.96	Not Detected	4.7	Not Detected
1,3,5-Trimethylbenzene	0.96	Not Detected	4.7	Not Detected
1,2,4-Trimethylbenzene	0.96	Not Detected	4.7	Not Detected
1,3-Dichlorobenzene	0.96	Not Detected	5.8	Not Detected
1,4-Dichlorobenzene	0.96	Not Detected	5.8	Not Detected
1,2-Dichlorobenzene	0.96	Not Detected	5.8	Not Detected
1,2,4-Trichlorobenzene	3.9	Not Detected	29	Not Detected
Naphthalene	1.9	Not Detected	10	Not Detected
Total Xylenes	1.9	Not Detected	8.4	Not Detected

Container Type: 1 Liter Summa Canister (100% Certified)

Surrogates	%Recovery	Method Limits
Toluene-d8	94	70-130
1,2-Dichloroethane-d4	96	70-130
4-Bromofluorobenzene	98	70-130



Air Toxics

Client Sample ID: 7-69-SAN-20230306

Lab ID#: 2303443R1-06A

EPA METHOD TO-15 GC/MS FULL SCAN

File Name:	a032213	Date of Collection:	3/6/23 11:15:00 AM
Dil. Factor:	1.98	Date of Analysis:	3/22/23 05:30 PM

Compound	Rpt. Limit (ppbv)	Amount (ppbv)	Rpt. Limit (ug/m3)	Amount (ug/m3)
Chloromethane	9.9	Not Detected	20	Not Detected
trans-1,2-Dichloroethene	0.99	Not Detected	3.9	Not Detected
1,1-Dichloroethane	0.99	Not Detected	4.0	Not Detected
cis-1,2-Dichloroethene	0.99	Not Detected	3.9	Not Detected
Benzene	0.99	1.2	3.2	3.7
Trichloroethene	0.99	2.4	5.3	13
1,1,2-Trichloroethane	0.99	Not Detected	5.4	Not Detected
Tetrachloroethene	0.99	1.0	6.7	6.9
Chlorobenzene	0.99	Not Detected	4.6	Not Detected
Ethyl Benzene	0.99	Not Detected	4.3	Not Detected
m,p-Xylene	0.99	Not Detected	4.3	Not Detected
o-Xylene	0.99	Not Detected	4.3	Not Detected
Propylbenzene	0.99	Not Detected	4.9	Not Detected
1,3,5-Trimethylbenzene	0.99	Not Detected	4.9	Not Detected
1,2,4-Trimethylbenzene	0.99	Not Detected	4.9	Not Detected
1,3-Dichlorobenzene	0.99	Not Detected	6.0	Not Detected
1,4-Dichlorobenzene	0.99	Not Detected	6.0	Not Detected
1,2-Dichlorobenzene	0.99	Not Detected	6.0	Not Detected
1,2,4-Trichlorobenzene	4.0	Not Detected	29	Not Detected
Naphthalene	2.0	Not Detected	10	Not Detected
Total Xylenes	2.0	Not Detected	8.6	Not Detected

Container Type: 1 Liter Summa Canister (100% Certified)

Surrogates	%Recovery	Method Limits
Toluene-d8	93	70-130
1,2-Dichloroethane-d4	98	70-130
4-Bromofluorobenzene	97	70-130



Air Toxics

Client Sample ID: 2-71B-SAN-20230306

Lab ID#: 2303443R1-07A

EPA METHOD TO-15 GC/MS FULL SCAN

File Name:	a032214	Date of Collection:	3/6/23 12:24:00 PM
Dil. Factor:	2.03	Date of Analysis:	3/22/23 05:57 PM

Compound	Rpt. Limit (ppbv)	Amount (ppbv)	Rpt. Limit (ug/m3)	Amount (ug/m3)
Chloromethane	10	Not Detected	21	Not Detected
trans-1,2-Dichloroethene	1.0	Not Detected	4.0	Not Detected
1,1-Dichloroethane	1.0	Not Detected	4.1	Not Detected
cis-1,2-Dichloroethene	1.0	Not Detected	4.0	Not Detected
Benzene	1.0	Not Detected	3.2	Not Detected
Trichloroethene	1.0	Not Detected	5.4	Not Detected
1,1,2-Trichloroethane	1.0	Not Detected	5.5	Not Detected
Tetrachloroethene	1.0	Not Detected	6.9	Not Detected
Chlorobenzene	1.0	Not Detected	4.7	Not Detected
Ethyl Benzene	1.0	Not Detected	4.4	Not Detected
m,p-Xylene	1.0	Not Detected	4.4	Not Detected
o-Xylene	1.0	Not Detected	4.4	Not Detected
Propylbenzene	1.0	Not Detected	5.0	Not Detected
1,3,5-Trimethylbenzene	1.0	Not Detected	5.0	Not Detected
1,2,4-Trimethylbenzene	1.0	Not Detected	5.0	Not Detected
1,3-Dichlorobenzene	1.0	Not Detected	6.1	Not Detected
1,4-Dichlorobenzene	1.0	Not Detected	6.1	Not Detected
1,2-Dichlorobenzene	1.0	Not Detected	6.1	Not Detected
1,2,4-Trichlorobenzene	4.1	Not Detected	30	Not Detected
Naphthalene	2.0	Not Detected	11	Not Detected
Total Xylenes	2.0	Not Detected	8.8	Not Detected

Container Type: 1 Liter Summa Canister (100% Certified)

Surrogates	%Recovery	Method Limits
Toluene-d8	95	70-130
1,2-Dichloroethane-d4	99	70-130
4-Bromofluorobenzene	96	70-130



Air Toxics

Client Sample ID: R-16-10-STM-20230306

Lab ID#: 2303443R1-08A

EPA METHOD TO-15 GC/MS FULL SCAN

File Name:	a032223	Date of Collection:	3/6/23 12:47:00 PM
Dil. Factor:	2.11	Date of Analysis:	3/23/23 12:55 AM

Compound	Rpt. Limit (ppbv)	Amount (ppbv)	Rpt. Limit (ug/m3)	Amount (ug/m3)
Chloromethane	10	Not Detected	22	Not Detected
trans-1,2-Dichloroethene	1.0	Not Detected	4.2	Not Detected
1,1-Dichloroethane	1.0	Not Detected	4.3	Not Detected
cis-1,2-Dichloroethene	1.0	Not Detected	4.2	Not Detected
Benzene	1.0	Not Detected	3.4	Not Detected
Trichloroethene	1.0	Not Detected	5.7	Not Detected
1,1,2-Trichloroethane	1.0	Not Detected	5.8	Not Detected
Tetrachloroethene	1.0	Not Detected	7.2	Not Detected
Chlorobenzene	1.0	Not Detected	4.8	Not Detected
Ethyl Benzene	1.0	Not Detected	4.6	Not Detected
m,p-Xylene	1.0	Not Detected	4.6	Not Detected
o-Xylene	1.0	Not Detected	4.6	Not Detected
Propylbenzene	1.0	Not Detected	5.2	Not Detected
1,3,5-Trimethylbenzene	1.0	Not Detected	5.2	Not Detected
1,2,4-Trimethylbenzene	1.0	Not Detected	5.2	Not Detected
1,3-Dichlorobenzene	1.0	Not Detected	6.3	Not Detected
1,4-Dichlorobenzene	1.0	Not Detected	6.3	Not Detected
1,2-Dichlorobenzene	1.0	Not Detected	6.3	Not Detected
1,2,4-Trichlorobenzene	4.2	Not Detected	31	Not Detected
Naphthalene	2.1	Not Detected	11	Not Detected
Total Xylenes	2.1	Not Detected	9.2	Not Detected

Container Type: 1 Liter Summa Canister (100% Certified)

Surrogates	%Recovery	Method Limits
Toluene-d8	94	70-130
1,2-Dichloroethane-d4	96	70-130
4-Bromofluorobenzene	98	70-130



Air Toxics

Client Sample ID: R16-9-STM-20230306

Lab ID#: 2303443R1-09A

EPA METHOD TO-15 GC/MS FULL SCAN

File Name:	a032224	Date of Collection:	3/6/23 1:10:00 PM
Dil. Factor:	1.99	Date of Analysis:	3/23/23 01:22 AM

Compound	Rpt. Limit (ppbv)	Amount (ppbv)	Rpt. Limit (ug/m3)	Amount (ug/m3)
Chloromethane	10	Not Detected	20	Not Detected
trans-1,2-Dichloroethene	1.0	Not Detected	3.9	Not Detected
1,1-Dichloroethane	1.0	Not Detected	4.0	Not Detected
cis-1,2-Dichloroethene	1.0	1.4	3.9	5.7
Benzene	1.0	Not Detected	3.2	Not Detected
Trichloroethene	1.0	Not Detected	5.3	Not Detected
1,1,2-Trichloroethane	1.0	Not Detected	5.4	Not Detected
Tetrachloroethene	1.0	Not Detected	6.7	Not Detected
Chlorobenzene	1.0	Not Detected	4.6	Not Detected
Ethyl Benzene	1.0	Not Detected	4.3	Not Detected
m,p-Xylene	1.0	Not Detected	4.3	Not Detected
o-Xylene	1.0	Not Detected	4.3	Not Detected
Propylbenzene	1.0	Not Detected	4.9	Not Detected
1,3,5-Trimethylbenzene	1.0	Not Detected	4.9	Not Detected
1,2,4-Trimethylbenzene	1.0	Not Detected	4.9	Not Detected
1,3-Dichlorobenzene	1.0	Not Detected	6.0	Not Detected
1,4-Dichlorobenzene	1.0	Not Detected	6.0	Not Detected
1,2-Dichlorobenzene	1.0	Not Detected	6.0	Not Detected
1,2,4-Trichlorobenzene	4.0	Not Detected	30	Not Detected
Naphthalene	2.0	Not Detected	10	Not Detected
Total Xylenes	2.0	Not Detected	8.6	Not Detected

Container Type: 1 Liter Summa Canister (100% Certified)

Surrogates	%Recovery	Method Limits
Toluene-d8	94	70-130
1,2-Dichloroethane-d4	96	70-130
4-Bromofluorobenzene	97	70-130



Air Toxics

Client Sample ID: 7-14A SAN 20230306

Lab ID#: 2303443R1-10A

EPA METHOD TO-15 GC/MS FULL SCAN

File Name:	a032231	Date of Collection:	3/6/23 1:39:00 PM
Dil. Factor:	2.12	Date of Analysis:	3/23/23 08:13 AM

Compound	Rpt. Limit (ppbv)	Amount (ppbv)	Rpt. Limit (ug/m3)	Amount (ug/m3)
Chloromethane	11	Not Detected	22	Not Detected
trans-1,2-Dichloroethene	1.1	Not Detected	4.2	Not Detected
1,1-Dichloroethane	1.1	Not Detected	4.3	Not Detected
cis-1,2-Dichloroethene	1.1	Not Detected	4.2	Not Detected
Benzene	1.1	Not Detected	3.4	Not Detected
Trichloroethene	1.1	Not Detected	5.7	Not Detected
1,1,2-Trichloroethane	1.1	Not Detected	5.8	Not Detected
Tetrachloroethene	1.1	Not Detected	7.2	Not Detected
Chlorobenzene	1.1	Not Detected	4.9	Not Detected
Ethyl Benzene	1.1	Not Detected	4.6	Not Detected
m,p-Xylene	1.1	Not Detected	4.6	Not Detected
o-Xylene	1.1	Not Detected	4.6	Not Detected
Propylbenzene	1.1	Not Detected	5.2	Not Detected
1,3,5-Trimethylbenzene	1.1	Not Detected	5.2	Not Detected
1,2,4-Trimethylbenzene	1.1	Not Detected	5.2	Not Detected
1,3-Dichlorobenzene	1.1	Not Detected	6.4	Not Detected
1,4-Dichlorobenzene	1.1	Not Detected	6.4	Not Detected
1,2-Dichlorobenzene	1.1	Not Detected	6.4	Not Detected
1,2,4-Trichlorobenzene	4.2	Not Detected	31	Not Detected
Naphthalene	2.1	Not Detected	11	Not Detected
Total Xylenes	2.1	Not Detected	9.2	Not Detected

Container Type: 1 Liter Summa Canister (100% Certified)

Surrogates	%Recovery	Method Limits
Toluene-d8	94	70-130
1,2-Dichloroethane-d4	98	70-130
4-Bromofluorobenzene	94	70-130



Air Toxics

Client Sample ID: R16-11-STM-20230306  
 Lab ID#: 2303443R1-11A  
 EPA METHOD TO-15 GC/MS FULL SCAN

File Name:	a032232	Date of Collection:	3/6/23 2:00:00 PM
Dil. Factor:	2.13	Date of Analysis:	3/23/23 08:40 AM

Compound	Rpt. Limit (ppbv)	Amount (ppbv)	Rpt. Limit (ug/m3)	Amount (ug/m3)
Chloromethane	11	Not Detected	22	Not Detected
trans-1,2-Dichloroethene	1.1	Not Detected	4.2	Not Detected
1,1-Dichloroethane	1.1	Not Detected	4.3	Not Detected
cis-1,2-Dichloroethene	1.1	Not Detected	4.2	Not Detected
Benzene	1.1	Not Detected	3.4	Not Detected
Trichloroethene	1.1	Not Detected	5.7	Not Detected
1,1,2-Trichloroethane	1.1	Not Detected	5.8	Not Detected
Tetrachloroethene	1.1	Not Detected	7.2	Not Detected
Chlorobenzene	1.1	Not Detected	4.9	Not Detected
Ethyl Benzene	1.1	Not Detected	4.6	Not Detected
m,p-Xylene	1.1	Not Detected	4.6	Not Detected
o-Xylene	1.1	Not Detected	4.6	Not Detected
Propylbenzene	1.1	Not Detected	5.2	Not Detected
1,3,5-Trimethylbenzene	1.1	Not Detected	5.2	Not Detected
1,2,4-Trimethylbenzene	1.1	Not Detected	5.2	Not Detected
1,3-Dichlorobenzene	1.1	Not Detected	6.4	Not Detected
1,4-Dichlorobenzene	1.1	Not Detected	6.4	Not Detected
1,2-Dichlorobenzene	1.1	Not Detected	6.4	Not Detected
1,2,4-Trichlorobenzene	4.3	Not Detected	32	Not Detected
Naphthalene	2.1	Not Detected	11	Not Detected
Total Xylenes	2.1	Not Detected	9.2	Not Detected

Container Type: 1 Liter Summa Canister (100% Certified)

Surrogates	%Recovery	Method Limits
Toluene-d8	98	70-130
1,2-Dichloroethane-d4	100	70-130
4-Bromofluorobenzene	95	70-130



Air Toxics

Client Sample ID: R16-12-STM-20230306  
 Lab ID#: 2303443R1-12A  
 EPA METHOD TO-15 GC/MS FULL SCAN

File Name:	a032233	Date of Collection:	3/6/23 2:19:00 PM
Dil. Factor:	1.94	Date of Analysis:	3/23/23 09:07 AM

Compound	Rpt. Limit (ppbv)	Amount (ppbv)	Rpt. Limit (ug/m3)	Amount (ug/m3)
Chloromethane	9.7	Not Detected	20	Not Detected
trans-1,2-Dichloroethene	0.97	Not Detected	3.8	Not Detected
1,1-Dichloroethane	0.97	Not Detected	3.9	Not Detected
cis-1,2-Dichloroethene	0.97	Not Detected	3.8	Not Detected
Benzene	0.97	Not Detected	3.1	Not Detected
Trichloroethene	0.97	Not Detected	5.2	Not Detected
1,1,2-Trichloroethane	0.97	Not Detected	5.3	Not Detected
Tetrachloroethene	0.97	Not Detected	6.6	Not Detected
Chlorobenzene	0.97	Not Detected	4.5	Not Detected
Ethyl Benzene	0.97	Not Detected	4.2	Not Detected
m,p-Xylene	0.97	Not Detected	4.2	Not Detected
o-Xylene	0.97	Not Detected	4.2	Not Detected
Propylbenzene	0.97	Not Detected	4.8	Not Detected
1,3,5-Trimethylbenzene	0.97	Not Detected	4.8	Not Detected
1,2,4-Trimethylbenzene	0.97	Not Detected	4.8	Not Detected
1,3-Dichlorobenzene	0.97	Not Detected	5.8	Not Detected
1,4-Dichlorobenzene	0.97	Not Detected	5.8	Not Detected
1,2-Dichlorobenzene	0.97	Not Detected	5.8	Not Detected
1,2,4-Trichlorobenzene	3.9	Not Detected	29	Not Detected
Naphthalene	1.9	Not Detected	10	Not Detected
Total Xylenes	1.9	Not Detected	8.4	Not Detected

Container Type: 1 Liter Summa Canister (100% Certified)

Surrogates	%Recovery	Method Limits
Toluene-d8	93	70-130
1,2-Dichloroethane-d4	96	70-130
4-Bromofluorobenzene	96	70-130





Air Toxics

Client Sample ID: Lab Blank

Lab ID#: 2303443R1-13A

EPA METHOD TO-15 GC/MS FULL SCAN

File Name:	a032207c	Date of Collection:	NA
Dil. Factor:	1.00	Date of Analysis:	3/22/23 02:02 PM

Compound	Rpt. Limit (ppbv)	Amount (ppbv)	Rpt. Limit (ug/m3)	Amount (ug/m3)
Chloromethane	5.0	Not Detected	10	Not Detected
trans-1,2-Dichloroethene	0.50	Not Detected	2.0	Not Detected
1,1-Dichloroethane	0.50	Not Detected	2.0	Not Detected
cis-1,2-Dichloroethene	0.50	Not Detected	2.0	Not Detected
Benzene	0.50	Not Detected	1.6	Not Detected
Trichloroethene	0.50	Not Detected	2.7	Not Detected
1,1,2-Trichloroethane	0.50	Not Detected	2.7	Not Detected
Tetrachloroethene	0.50	Not Detected	3.4	Not Detected
Chlorobenzene	0.50	Not Detected	2.3	Not Detected
Ethyl Benzene	0.50	Not Detected	2.2	Not Detected
m,p-Xylene	0.50	Not Detected	2.2	Not Detected
o-Xylene	0.50	Not Detected	2.2	Not Detected
Propylbenzene	0.50	Not Detected	2.4	Not Detected
1,3,5-Trimethylbenzene	0.50	Not Detected	2.4	Not Detected
1,2,4-Trimethylbenzene	0.50	Not Detected	2.4	Not Detected
1,3-Dichlorobenzene	0.50	Not Detected	3.0	Not Detected
1,4-Dichlorobenzene	0.50	Not Detected	3.0	Not Detected
1,2-Dichlorobenzene	0.50	Not Detected	3.0	Not Detected
1,2,4-Trichlorobenzene	2.0	Not Detected	15	Not Detected
Naphthalene	1.0	Not Detected	5.2	Not Detected
Total Xylenes	1.0	Not Detected	4.3	Not Detected

Container Type: NA - Not Applicable

Surrogates	%Recovery	Method Limits
Toluene-d8	94	70-130
1,2-Dichloroethane-d4	96	70-130
4-Bromofluorobenzene	96	70-130



Air Toxics

Client Sample ID: CCV

Lab ID#: 2303443R1-14A

EPA METHOD TO-15 GC/MS FULL SCAN

File Name:	a032202	Date of Collection: NA
Dil. Factor:	1.00	Date of Analysis: 3/22/23 10:54 AM

Compound	%Recovery
Chloromethane	101
trans-1,2-Dichloroethene	104
1,1-Dichloroethane	103
cis-1,2-Dichloroethene	99
Benzene	97
Trichloroethene	101
1,1,2-Trichloroethane	101
Tetrachloroethene	107
Chlorobenzene	101
Ethyl Benzene	101
m,p-Xylene	98
o-Xylene	98
Propylbenzene	101
1,3,5-Trimethylbenzene	98
1,2,4-Trimethylbenzene	99
1,3-Dichlorobenzene	103
1,4-Dichlorobenzene	103
1,2-Dichlorobenzene	102
1,2,4-Trichlorobenzene	96
Naphthalene	93
Total Xylenes	98

Container Type: NA - Not Applicable

Surrogates	%Recovery	Method Limits
Toluene-d8	95	70-130
1,2-Dichloroethane-d4	98	70-130
4-Bromofluorobenzene	101	70-130



Air Toxics

Client Sample ID: LCS

Lab ID#: 2303443R1-15A

EPA METHOD TO-15 GC/MS FULL SCAN

File Name:	a032203	Date of Collection: NA
Dil. Factor:	1.00	Date of Analysis: 3/22/23 11:19 AM

Compound	%Recovery	Method Limits
Chloromethane	102	70-130
trans-1,2-Dichloroethene	101	70-130
1,1-Dichloroethane	98	70-130
cis-1,2-Dichloroethene	97	70-130
Benzene	99	70-130
Trichloroethene	102	70-130
1,1,2-Trichloroethane	105	70-130
Tetrachloroethene	107	70-130
Chlorobenzene	100	70-130
Ethyl Benzene	101	70-130
m,p-Xylene	98	70-130
o-Xylene	98	70-130
Propylbenzene	100	70-130
1,3,5-Trimethylbenzene	97	70-130
1,2,4-Trimethylbenzene	97	70-130
1,3-Dichlorobenzene	100	70-130
1,4-Dichlorobenzene	99	70-130
1,2-Dichlorobenzene	100	70-130
1,2,4-Trichlorobenzene	101	70-130
Naphthalene	89	60-140
Total Xylenes	98	70-130

Container Type: NA - Not Applicable

Surrogates	%Recovery	Method Limits
Toluene-d8	97	70-130
1,2-Dichloroethane-d4	93	70-130
4-Bromofluorobenzene	100	70-130



Air Toxics

Client Sample ID: LCSD

Lab ID#: 2303443R1-15AA

EPA METHOD TO-15 GC/MS FULL SCAN

File Name:	a032204	Date of Collection: NA
Dil. Factor:	1.00	Date of Analysis: 3/22/23 11:44 AM

Compound	%Recovery	Method Limits
Chloromethane	106	70-130
trans-1,2-Dichloroethene	101	70-130
1,1-Dichloroethane	99	70-130
cis-1,2-Dichloroethene	95	70-130
Benzene	97	70-130
Trichloroethene	100	70-130
1,1,2-Trichloroethane	104	70-130
Tetrachloroethene	107	70-130
Chlorobenzene	100	70-130
Ethyl Benzene	101	70-130
m,p-Xylene	98	70-130
o-Xylene	97	70-130
Propylbenzene	100	70-130
1,3,5-Trimethylbenzene	99	70-130
1,2,4-Trimethylbenzene	96	70-130
1,3-Dichlorobenzene	101	70-130
1,4-Dichlorobenzene	99	70-130
1,2-Dichlorobenzene	100	70-130
1,2,4-Trichlorobenzene	103	70-130
Naphthalene	92	60-140
Total Xylenes	98	70-130

Container Type: NA - Not Applicable

Surrogates	%Recovery	Method Limits
Toluene-d8	95	70-130
1,2-Dichloroethane-d4	92	70-130
4-Bromofluorobenzene	101	70-130