



Engineers • Land Surveyors • Environmental Scientists

April 1, 2010

Mr. William P. Scott  
Gonzales Saggio & Harlan, LLP  
225 East Michigan St.  
Fourth Floor  
Milwaukee, WI 53202

RE: Addendum to RSV's July 24, 2009 Proposal for Site Remediation and Well Installation  
Express Cleaners  
3941 North Main St.  
Racine, WI  
BRRTS# 02-52-547631

Dear Mr. Scott:

Per your request, RSV Engineering, Inc. ("RSV") has prepared this addendum to the proposal submitted on July 24, 2009 for remediation of soil and groundwater impacts at the Express Cleaners site in Racine, Wisconsin (Figure 1) on behalf of the Ehrlich Family Limited Partnership ("Ehrlich"). As part of the remedial action for the property owned by S.C. Johnson & Son ("SCJ") adjacent to the site, RSV proposed periodic tilling of an isolated area of potential shallow soil impacts in the vicinity of Monitoring Well MW-13. At the request of SCJ and the Ehrlich Family Limited Partnership, RSV is amending the proposal to include excavation of soil of the area around MW-13, in lieu of tilling, to appropriately protect human health and welfare. The attached Figure 2 shows the revised proposed excavation areas. An anticipated 97 tons of soil will be removed from the additional (easternmost) excavation area, at a cost of approximately \$6,700, as detailed on the attached Table 1. Following completion of excavation work at the SCJ property, RSV will re-seed disturbed areas with a native seed mix at a cost of approximately \$200.

The additional excavation will address a soil tetrachloroethene (PCE) concentration of 1200 µg/kg detected in the soil sample collected from Soil Boring BA9 at a depth of 2 feet below ground surface (bgs). Estimated disposal costs are based on the expectation that composite samples collected from the removed soil will not exceed this concentration, such that it would change the classification of the waste for disposal purposes (currently classified as special waste).

Mr. William P. Scott  
April 1, 2010  
Page 2 of 2

Please contact the undersigned with any questions regarding the revised scope of work.

Sincerely,  
RSV ENGINEERING, INC.



Paula A. Richardson, P.G  
Hydrogeologist

Enclosures:

Figures 1 and 2  
Table 1

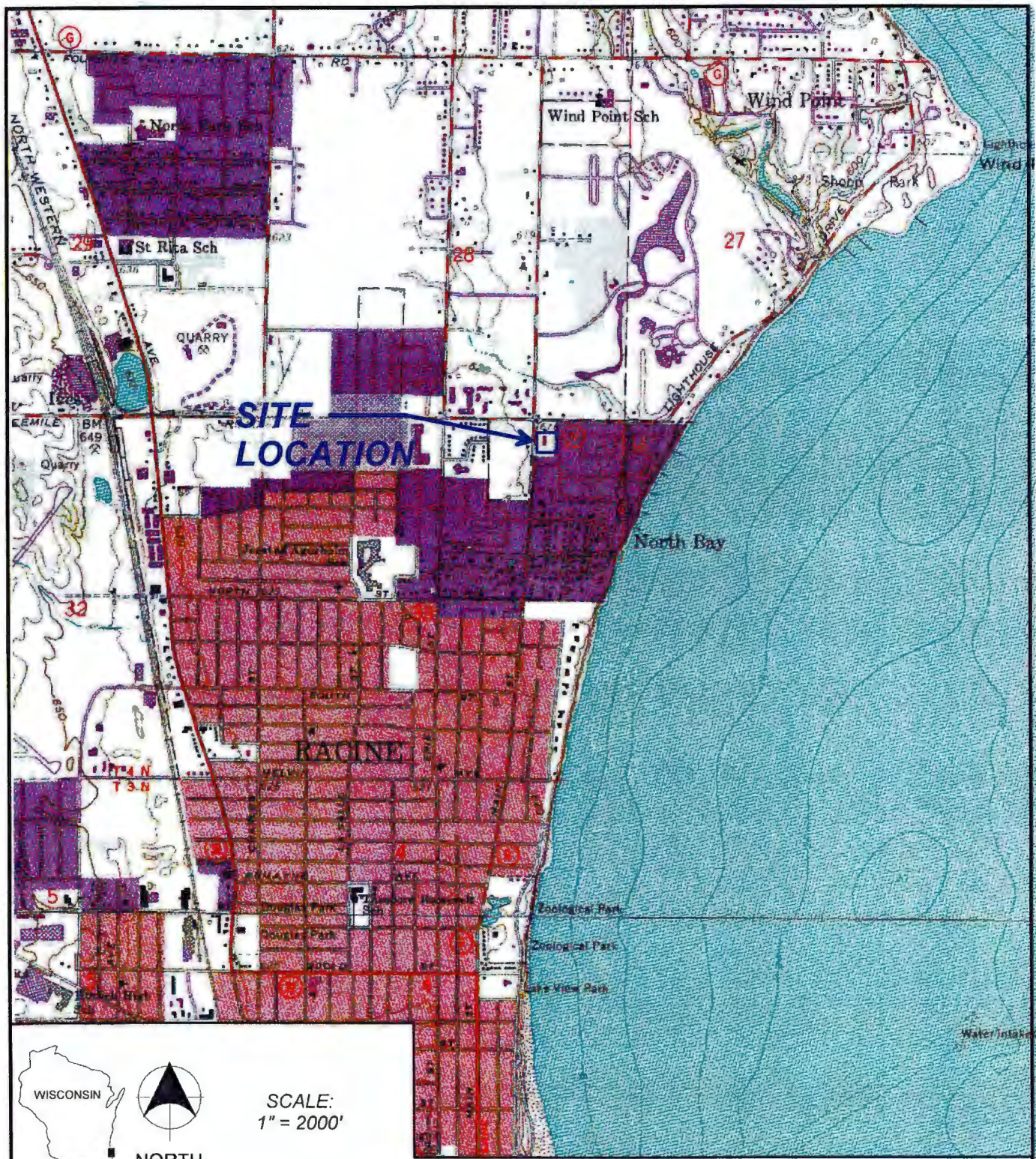

SCALE:  
1" = 2000'

BASE MAP: 7.5 MINUTE USGS TOPOGRAPHIC QUADRANGLE,  
RACINE NORTH, WISCONSIN.

**RSV**  
ENGINEERING, INC.

Engineers - Land Surveyors - Environmental Scientists

146 E. MILWAUKEE STREET JEFFERSON, WISCONSIN 53549 (920) 674-3411

EXPRESS CLEANERS  
RACINE, WISCONSIN  
SITE LOCATION MAP

FIGURE  
1

DRAWN BY

RN

PROJ. No.

09-5008

DATE

24 JUL 09

FILE NAME

SITE LOC

PROJECT NO. 09-5008  
 SHEET NO. 1 OF 1  
 DATE: 08/20/08  
 DRAWN BY: [unintelligible]  
 CHECKED BY: [unintelligible]  
 PROJECT NO. 09-5008  
 SHEET NO. 1 OF 1

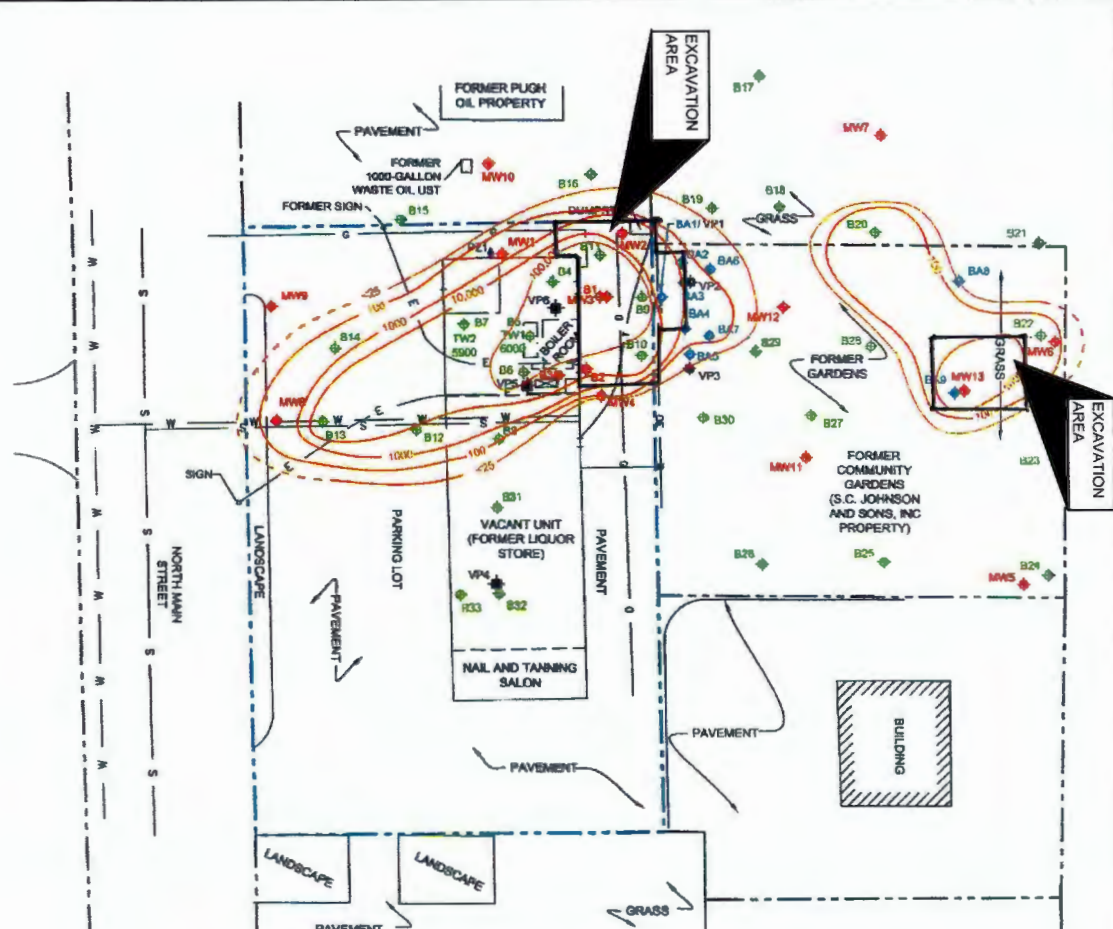

**LEGEND**

- SUBJECT PROPERTY BOUNDARY
- ADJACENT PROPERTY BOUNDARIES
- OVERHEAD ELECTRIC LINE
- FENCE
- UNDERGROUND GAS LINE
- WATERMAIN
- BURIED ELECTRIC LINE
- BURIED SANITARY SEWER
- BURIED TELEPHONE LINE
- UTILITY POLE
- FORMER DRY CLEANING MACHINE LOCATION
- EXISTING DRY CLEANING MACHINE
- VP1 SOIL VAPOR SAMPLING POINT LOCATION AND IDENTIFICATION
- BA1 1" HAND AUGER NEAR SURFACE SAMPLE LOCATION AND IDENTIFICATION
- B5 BOREHOLE LOCATION AND IDENTIFICATION
- B3 GABRIEL ENVIRONMENTAL BOREHOLE LOCATION AND IDENTIFICATION
- MW1 2" MONITORING WELL LOCATION AND IDENTIFICATION
- PZ1 PIEZOMETER LOCATION AND IDENTIFICATION
- TW2 1" TEMPORARY MONITORING WELL LOCATION
- 1000 SOIL PCE BIOCONCENTRATION LINE IN MICROGRAMS PER KILOGRAM

Sample Location	Sample Depth (feet)	Soil PCE Concentration (ug/kg)	Sample Location	Sample Depth (feet)	Soil PCE Concentration (ug/kg)
PZ1	1-3	370	B17	3-4	<25
MW1	3.5-5.5	430	B18	2-4	<25
MW2	1-3	1740	B19	2-4	<25
MW3	1-3	8400	B20	2-4	104
MW4	1-3	<25	B21	2-4	<25
MW6	2-4	48	B22	2-4	670
MW8	1-3	330	B23	2-4	<25
MW12	1-3	<18	B24	2-4	<25
B1	4	121,000	B25	2-4	<25
B2	2	9900	B26	2-4	<25
B2	12	465	B27	2-4	<25
B3	4	21,100	B28	2-4	<25
B4	2-4	270,000	B29	2-4	<25
B4	4-6	1,380	B30	2-4	<25
B4	14-16	270	B31	2-4	<25
B5	2-4	66,000	B32	2-4	<25
B5	10-12	305	B33	2-4	<25
B6	2-4	136,000	MW6	2-4	48
B6	12-14	174	MW8	1-3	330
B7	2-4	10,200	BA1	2	130
B7	0-8	77,000	BA2	0.5	650
B8	2-4	67	BA2	2	700
B9	0-2	92,000	BA3	0.5	1200
B9	8-10	770,000	BA3	2	1300
B10	2-4	14,000	BA4	0.5	690
B10	8-10	28	BA4	2	100
B11	2-4	63,000	BA5	3.0	43
B11	6-8	990,000	BA6	0.5	56
B12	2-4	1370	BA6	2	74
B13	2-4	112	BA7	0.5	84
B13	6-8	68,000	BA7	2	380
B14	2-4	131	UAR	1.5	<25
B15	2-4	<25	BA9	0.5	33
B15	4-6	<25	BA9	2	1200
B16	2-4	<25			

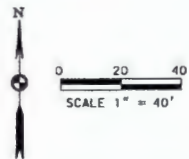

INITIALS DATE  
 DESIGNED BY: [unintelligible]  
 DRAWN BY: [unintelligible]  
 CHECKED BY: [unintelligible]  
 PROJECT NO. 09-5008  
 SHEET NO. 1 OF 1

**EXPRESS CLEANERS, INCORPORATED**  
**EXCAVATION LOCATIONS**  
 3941 N. MAIN STREET  
 RACINE, WISCONSIN

NO.	REVISIONS	BY	DATE

**RSV**  
**ENGINEERING, INC.**  
 146 E. MILWAUKEE ST.  
 JEFFERSON, WI 53549  
 (920) 674-3411

**TABLE 1**  
**EXPRESS CLEANERS**  
**RACINE, WISCONSIN**  
**ADDITIONAL SCJ PROPERTY EXCAVATION**  
**ESTIMATED COSTS**

TASK	UNITS	QTY.	RATE	COST
Oversight labor	Hours	5	\$95	\$475
Excavation and backfill	ton	97	\$9	\$873
Transportation and offsite disposal	ton	97	\$41	\$3,996
Backfill material	ton	97	\$12	\$1,188
Seeding with native plant seed	estimate	1	\$200	\$200
<b>Total cost:</b>				<b>\$6,733</b>