

McKnight, Kevin - DNR

From: Hilse, Matt J. [hilse@stsconsultants.com]
Sent: Friday, January 12, 2007 3:07 PM
To: McKnight, Kevin - DNR
Subject: File transfer
Attachments: diagram.pdf; soil-table.pdf

City of Princeton Property, 417 West Main Street, BRRTS# 03-24-547974

On August 18, 2006, two USTs were abandoned by removal from the above mentioned site. It was initially thought the property contained a standard 250 gallon tank. The removal of overburden revealed two 55-gallon drums which formerly supplied a furnace. One contained some product and the other had leaked. The product was removed by Chief Liquid Waste. A total of 7.12 tons of impacted soil was removed and disposed of at Valley Trail Landfill. Material could only be removed to the elevation of the footings. Two soil samples at the base of the excavation had elevated PAH and DRO results. I have included a summary of lab data and a location diagram. On September 5, 2006 release notification was sent to the WDNR. A site investigation is planned to determine extent and degree of the release.

The source of impacts was removed. Base on the results of the material remaining in place it does not appear likely that free product would be present in the groundwater or in the bedrock located approximately 100 feet below the site. Based on the available information it is the opinion of STS that this site falls under the definition of "low or medium risk" as indicated in Wisconsin Administrative Code, Chapter NR 746.04 Site Authority. As such, STS requests that the site be transferred to the Department of Commerce. If you have any questions regarding this request, please contact me at 1-920-236-6712.

This e-mail and any attachments may contain confidential and privileged material for the sole use of the intended recipient(s). Any review or distribution by anyone other than the intended recipient(s) is strictly prohibited. If you are not the intended recipient(s), please contact the sender and delete all copies of this e-mail immediately.

Table 2
PAH Soil Analytical Results
417 West Main Street
Princeton, Wisconsin

| Sample No. Sample Depth (ft) | | North 5 | South 5 | Suggested Generic WDNR Interim Guidance Values Direct Contact Non-Industrial RCLs (mg/kg) | Suggested Generic WDNR Interim Guidance Values Direct Contact Industrial RCLs (mg/kg) | Suggested Generic WDNR Interim Guidance Values Groundwater Pathway RCLs (mg/kg) |
|---------------------------------|---------|------------------|------------------|--|--|--|
| <i>PAHs</i> | | | | | | |
| Acenaphthene | (mg/kg) | 0.437 | 0.544 | <u>900</u> | <u>60,000</u> | <u>38</u> |
| Acenaphthylene | (mg/kg) | 0.273 | 0.280 | <u>18</u> | <u>360</u> | 0.7 |
| Anthracene | (mg/kg) | 0.134 | 0.265 | <u>5,000</u> | <u>300,000</u> | 3,000 |
| Benzo(a)anthracene | (mg/kg) | 0.049 "J" | 0.061 "J" | <u>0.088</u> | <u>39</u> | 17 |
| Benzo(a)pyrene | (mg/kg) | <u>0.018 "J"</u> | <u>0.027 "J"</u> | <u>0.0088</u> | <u>0.39</u> | 48 |
| Benzo(b)fluoranthene | (mg/kg) | 0.033 "J" | 0.043 "J" | <u>0.088</u> | <u>3.9</u> | 360 |
| Benzo(g,h,i)perylene | (mg/kg) | <0.017 | 0.023 "J" | <u>1.8</u> | <u>39</u> | 6,800 |
| Benzo(k)fluoranthene | (mg/kg) | <0.028 | <0.028 | <u>0.88</u> | <u>39</u> | 870 |
| Chrysene | (mg/kg) | 0.072 "J" | 0.097 "J" | <u>8.8</u> | <u>390</u> | 37 |
| Dibenzo(a,h)anthracene | (mg/kg) | <0.022 | <u>0.183</u> | <u>0.0088</u> | <u>0.39</u> | 38 |
| Fluoranthene | (mg/kg) | 0.150 | <0.022 | <u>600</u> | <u>40,000</u> | 500 |
| Fluorene | (mg/kg) | 1.190 | 0.183 | <u>600</u> | <u>40,000</u> | 100 |
| Indeno(1,2,3-cd)pyrene | (mg/kg) | <0.019 | 0.022 "J" | <u>0.088</u> | <u>3.9</u> | 680 |
| 1-Methylnaphthalene | (mg/kg) | 3.740 | 4.400 | <u>1,100</u> | <u>70,000</u> | 23 |
| 2-Methylnaphthalene | (mg/kg) | 5.560 | 6.460 | <u>600</u> | <u>40,000</u> | 20 |
| Naphthalene | (mg/kg) | <u>1.040</u> | <u>1.010</u> | <u>20</u> | <u>110</u> | 0.4 |
| Phenanthrene | (mg/kg) | 1.580 | 1.720 | <u>18</u> | <u>390</u> | 1.8 |
| Pyrene | (mg/kg) | 0.787 | 1.120 | <u>500</u> | <u>30,000</u> | 8,700 |
| DRO | (mg/kg) | 5150 | 7630 | | | 100 |

Notes:

mg/kg - Milligrams per kilograms

8

Exceeds Suggested Generic WDNR Interim Guidance Values for Direct Contact Non-Industrial RCLs.

25

Exceeds Suggested Generic WDNR Interim Guidance Values for Direct Contact Industrial RCLs.

38

Exceeds Suggested Generic WDNR Interim Guidance Values for Groundwater Pathway RCLs.

"J" - Result between limit of detection and limit of quantification.

X:\Projects\200603189\dwg\site location diagram.dwg; 8/23/2006 9:07:20 AM; CAD TEMP ACCOUNT

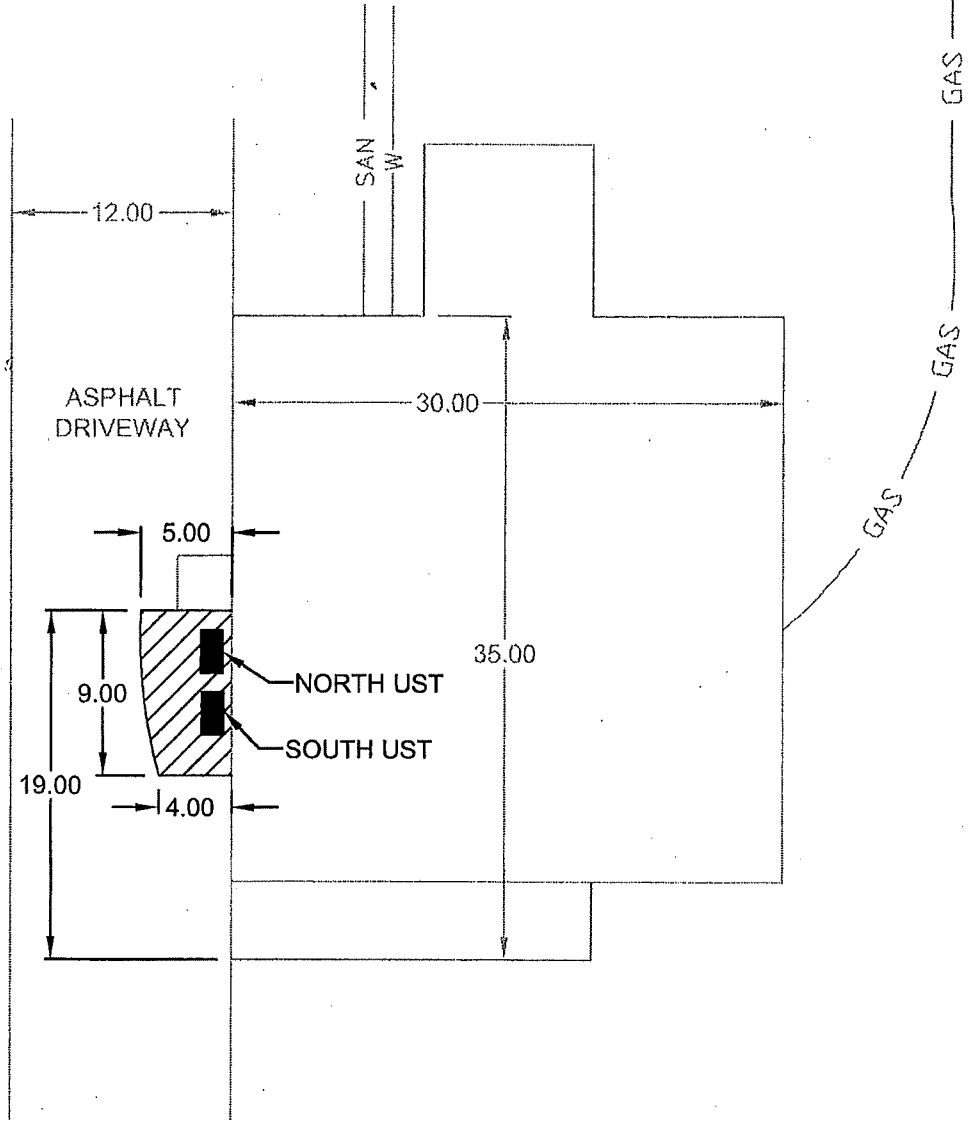

| LEGEND | |
|--------|------------------------------|
| | EXTENT OF EXCAVATION |
| | UNDERGROUND STORAGE TANK |
| | EXISTING NATURAL GAS LINE |
| | EXISTING SANITARY SEWER LINE |
| | EXISTING WATER LINE |

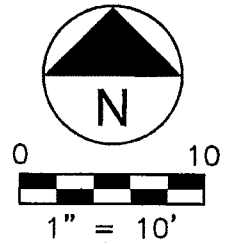

STS CONSULTANTS
 558 North Main Street
 Oshkosh, WI 54901
 920-235-0270
 www.stsconsultants.com
 Copyright ©2006, By: STS Consultants, Ltd.

SITE LOCATION DIAGRAM
 417 WEST MAIN STREET
 PRINCETON, WI

| | |
|----------------|----------------|
| Drawn : | CSW 08/23/2006 |
| Checked: | MJH 08/23/2006 |
| Approved: | |
| PROJECT NUMBER | 200603189 |
| FIGURE NUMBER | 2 |