



GILES

ENGINEERING ASSOCIATES, INC.

GEOTECHNICAL, ENVIRONMENTAL & CONSTRUCTION MATERIALS CONSULTANTS

- Atlanta, GA
- Baltimore/Wash. DC
- Dallas, TX
- Los Angeles, CA
- Milwaukee, WI
- Orlando, FL

June 17, 2014

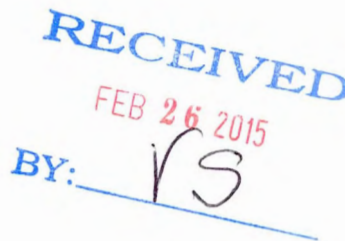

Wisconsin Department of Natural Resources
2300 North Dr. Martin Luther King Drive
Milwaukee, WI 53212

Attention: Ms. Shanna Laube-Anderson

Subject: Change Order #3 - Proposed Additional Site Investigation and Cost Estimate
Martinizing Dry Cleaning Site
1730 State Street
Racine, Wisconsin
Project No. 1E-0909013
BRRS No. 02-52-549890/FID No. 252251010

Dear Ms. Laube-Anderson:

Giles Engineering Associates, Inc. (Giles) has prepared this Change Order #3 which includes a scope of services and cost estimate on behalf of BMP Realty LLC, owner of the Martinizing Racine property (the "Site"), located at 1730 State Street, in Racine, Wisconsin (Figure 1). Based on our previous correspondence and dialog, it is our understanding that the Wisconsin Department of Natural Resources (WDNR) has requested that additional site investigation be completed to determine the vertical extent of contamination near soil boring GP-1/MW-2. In addition, Mr. Berry has indicated that he had discussed the site investigation results with you and you indicated that additional groundwater sampling is required to establish the groundwater contaminant trends.

Background

The Site began operations in the early 1930's as a gasoline filling station in the early 1930s to 1970. In 1970, the Site became a self-service coin laundry mat and a dry cleaning facility, and is currently operated as a self-service coin laundry mat and a dry cleaner drop-off; dry cleaning operations were performed at the Site until approximately 2004. A Site Plan illustrating the current dry cleaner building layout and the configuration of the former gasoline station is included as Figure 2.

The results of the initial site scoping investigation (2007) and the site investigation (2010 to present) have shown that low level petroleum volatile organic compounds (petroleum VOCs) and elevated concentrations of chlorinated VOCs were detected in the soil and groundwater and are associated with the historic uses of the Site as a gasoline station and a dry cleaner. The

Teysen



detected petroleum VOCs in soil are generally present on the western region of the site at concentrations below the WDNR Publication RR-890 residual contaminant levels (RCLs) and are illustrated on Figure 3A. Chlorinated VOCs were detected in soil at levels exceeding the RR-890 RCLs for protection of groundwater. The distribution of the generally appears to be beneath the building, and in the paved area immediately northwest of the building. The highest soil concentrations exceed the WDNR landfill standard for Contaminated-Out, Non-Hazardous Material and are located immediately north and west of the service door on the north side of the building. Figure 3B shows the general distribution of chlorinated VOCs.

The direction of groundwater flow has been generally to the south or southwest across the Site. However, a "mounded" groundwater condition was noted during groundwater sampling event performed in August, 2010 at the location of MW-2, situated north of the western portion of the structure, and December 2010 associated with monitoring wells.

The distribution of select petroleum VOCs in groundwater are also present on the western region of the site at concentrations below their respective WDNR Wisconsin Administrative Code (WAC) Ch. NR 140 Enforcement Standards (ES), but exceed their NR-140 preventative action limits (PALs); the distribution of petroleum VOCs in groundwater is illustrated on Figure 4A.

The detected chlorinated VOCs in groundwater are also present beneath the building, and in the paved areas immediately northwest, southwest, and southeast of the building at concentrations exceeding their respective Ch. NR 140 ES; the distribution of chlorinated VOCs in groundwater is illustrated on Figure 4B.

At this time, it is our understanding that additional site investigation activities are required to be completed to determine the vertical extent of contamination near soil boring GP-1/MW-2. In addition, additional groundwater sampling is required to establish the current groundwater contaminant trends, prior to bidding the remediation phase of this project.

Proposed Scope of Services

- Prepare this Change Order #3 to provide a detailed description of the proposed soil and groundwater sampling services and associated costs for WDNR review and approval;
- Complete one soil boring to delineate the vertical extent of soil contamination near soil boring GP-1/MW-2 to 30 feet below ground surface (bgs). Soil samples will be collected using a 4-foot dual tube (closed) sampling system to minimize vertical cross-contamination between the shallow PCE impacted groundwater (perched in fill soil), and the deeper saturated soil sample intervals.
- Collect 3 soil samples including one sample soil from the interval 0 to 4 feet bgs in the unsaturated zone, and soil samples from the interval 14 to 16 feet bgs the interval 28 to 30 feet bgs, to provide the vertical profile of contamination and establish the vertical extent.
- Install a NR-141 variance 1-inch inside diameter piezometer (PZ-1) in the soil boring. The





piezometer screen will be established from 25 feet to 30 feet with approximately 10 feet of separation from the bottom of the screen for MW-2 to determine the vertical gradient and groundwater quality.

- Perform two groundwater sampling events. An initial groundwater sampling event will be performed in conjunction with the direct-push soil sampling activities to assess the current groundwater conditions. Nine groundwater samples (and one duplicate sample) will be collected (per event) from the existing monitoring wells using low-flow sampling techniques. The groundwater samples will be submitted to a Wisconsin Licensed Analytical Laboratory for analysis of VOCs by U.S. EPA Method 8260.
- Install up to two sub-slab depressurization systems within the existing building. Giles will assist with the identification of up to three State of Wisconsin certified radon mitigation specialists for the installation of the systems. Two systems are currently specified due to the potential presence of a structural wall down the center of the building structure. Giles will work with Mr. Berry to determine if two systems are truly needed.
- Coordinate the transport and disposal of one drum of purge water from the groundwater sampling events.
- Prepare a Supplemental Investigation Summary. Giles will prepare a brief letter report, upon receipt of the results from the second groundwater sampling event. The letter report will summarize the tasks performed, results of soil and groundwater chemical analyses, results of the potential receptor survey, and provide recommendations for additional delineation, site characterization, monitoring, or remediation.

Cost

The estimated cost to complete referenced scope of services is \$19,245. A detailed cost summary is attached as Table 1 and also presented in the attached DERF Investigation Bid Sheet (WDNR Form 4400-233). The estimated costs have been prepared based on good-faith estimates submitted from select qualified commodity service providers based on the proposed scope of services. Due to the potential for WDNR revisions/additional to the scope of services, final compensation will be determined based on the actual lineal footage of borings drilled, waste disposal tipping and transportation fees, number of types of laboratory tests performed, and the actual costs for professional services. Also, it should be noted that the fees presented in the attached bid sheets do not include costs for expedited analytical turnaround time

If project costs are envisioned to exceed the estimated amount due to circumstances listed in NR169.21(2)(e), Giles will not incur additional costs in excess of \$3,000.00 or 5 percent of the total project amount (whichever is lower) without prior authorization from you and the WDNR. Additional communication, correspondence, or supplemental reporting is not included in the scope of services or cost estimate.





GILES
ENGINEERING ASSOCIATES, INC.

Martinizing Racine Change Order #3
Racine, Wisconsin
Project No. 1E-0909013
Page 4

SCHEDULE

Giles anticipates four to five months from the anticipated date of authorization to proceed to complete through the completion of the proposed scope of services.

CLOSURE

Thank you for the opportunity to offer our engineering services. Should you have any questions relating to the proposed services or if we can be of additional assistance, please do not hesitate to call.

Respectfully submitted,
GILES ENGINEERING ASSOCIATES, INC.

Kevin T. Bugel, P.G., C.P.G.
Environmental Division Manager

ACCEPTED: BMP REALTY

BY: 
(signature)

LAURIE J. BERRY
(printed name)

TITLE: Seep Tread

DATE: 1-21-2015

- Figures: Figure 1; Site location Map
- Figure 2; Site Plan
- Figure 3A; Soil Analytical Results (Petroleum VOCs)
- Figure 3B; Soil Analytical Results (Chlorinated VOCs)
- Figure 4A; Groundwater Analytical Results (Petroleum VOCs)
- Figure 4B; Groundwater Analytical Results (Chlorinated VOCs)

Attachments: Table 1; Proposed Schedule of Fees
DERF Site Investigation Bid Sheet Form 4400-233 (R4/04)

Distribution: Wisconsin Department of Natural Resources
Attr: Ms. Shanna Laube-Anderson

BMP Realty
Attr: Mr. Jason Berry



GILES ENGINEERING ASSOCIATES, INC.



GILES
ENGINEERING ASSOCIATES, INC.

Martinizing Racine Change Order #3
Racine, Wisconsin
Project No. 1E-0909013
Page 5

© Giles Engineering Associates, Inc. 2014
Martinizing Racine Change Order #3, Env-13/ktb/



GILES ENGINEERING ASSOCIATES, INC.

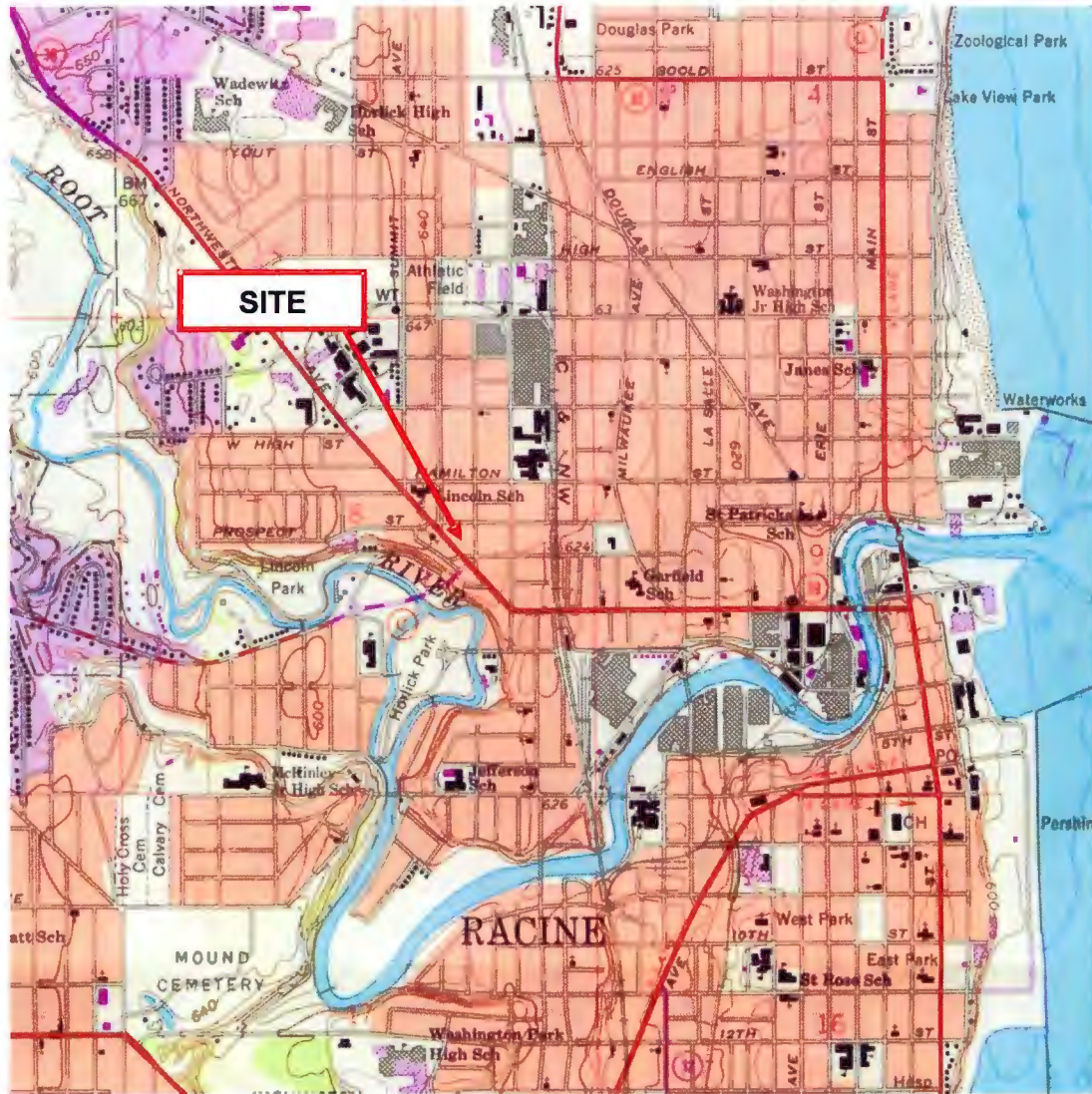

Source: USGS Racine South, Wisconsin 7.5-Minute Series (topographic) Quadrangle Map (1958; photorevised in 1971 and 1976)

Scale: 1:24,000
 Contour Interval: 10 Feet

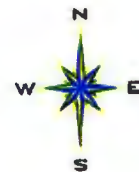
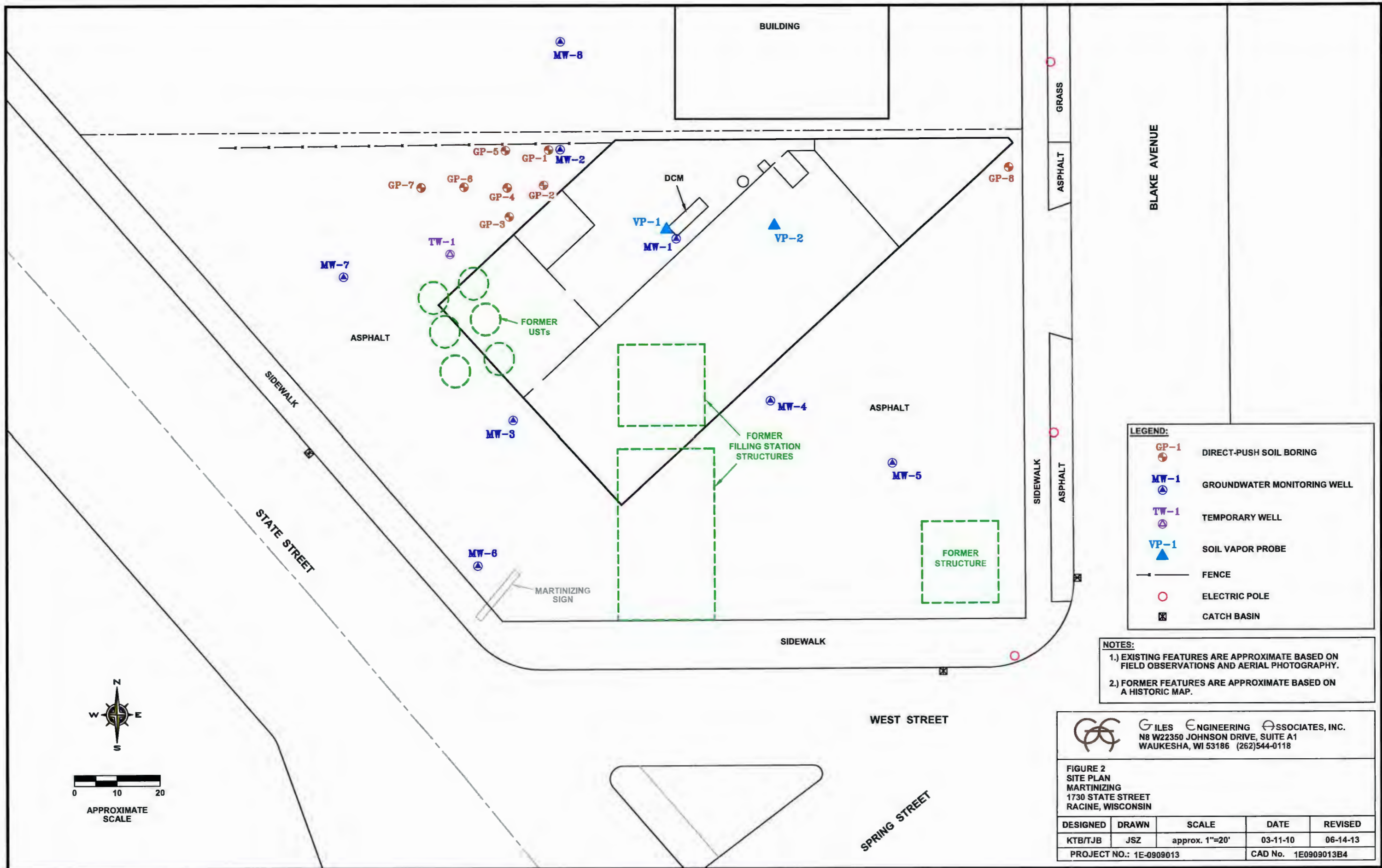

**FIGURE 1
 SITE LOCATION MAP**

**Martinizing Racine
 1730 State Street
 Racine, Wisconsin
 Project No. 1E-0909013**



GILES
 ENGINEERING ASSOCIATES, INC.



LEGEND:

- GP-1 DIRECT-PUSH SOIL BORING
- MW-1 GROUNDWATER MONITORING WELL
- TW-1 TEMPORARY WELL
- VP-1 SOIL VAPOR PROBE
- FENCE
- ELECTRIC POLE
- ⊠ CATCH BASIN

NOTES:

- 1.) EXISTING FEATURES ARE APPROXIMATE BASED ON FIELD OBSERVATIONS AND AERIAL PHOTOGRAPHY.
- 2.) FORMER FEATURES ARE APPROXIMATE BASED ON A HISTORIC MAP.

GILES ENGINEERING ASSOCIATES, INC.
 N8 W22350 JOHNSON DRIVE, SUITE A1
 WAUKESHA, WI 53186 (262)544-0118

FIGURE 2
SITE PLAN
MARTINIZING
1730 STATE STREET
RACINE, WISCONSIN

DESIGNED	DRAWN	SCALE	DATE	REVISED
KTB/TJB	JSZ	approx. 1"=20'	03-11-10	06-14-13
PROJECT NO.: 1E-0909013			CAD No. 1E0909013B4	

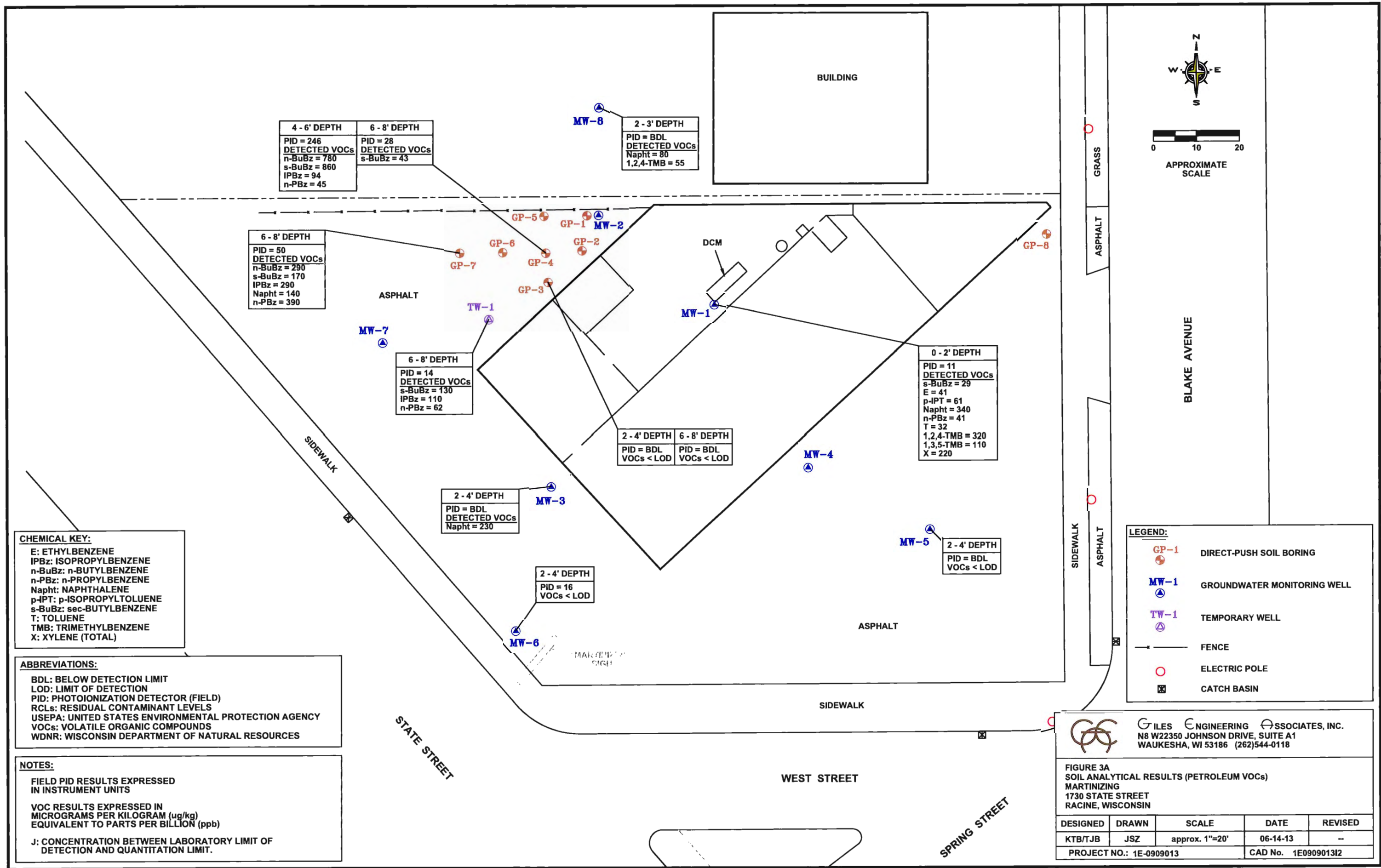

4 - 6' DEPTH	6 - 8' DEPTH
PID = 246 DETECTED VOCs n-BuBz = 780 s-BuBz = 860 IPBz = 94 n-PBz = 45	PID = 28 DETECTED VOCs s-BuBz = 43

2 - 3' DEPTH
PID = BDL DETECTED VOCs Napht = 80 1,2,4-TMB = 55

6 - 8' DEPTH
PID = 50 DETECTED VOCs n-BuBz = 290 s-BuBz = 170 IPBz = 290 Napht = 140 n-PBz = 390

6 - 8' DEPTH
PID = 14 DETECTED VOCs s-BuBz = 130 IPBz = 110 n-PBz = 62

2 - 4' DEPTH	6 - 8' DEPTH
PID = BDL VOCs < LOD	PID = BDL VOCs < LOD

0 - 2' DEPTH
PID = 11 DETECTED VOCs s-BuBz = 29 E = 41 p-IPT = 61 Napht = 340 n-PBz = 41 T = 32 1,2,4-TMB = 320 1,3,5-TMB = 110 X = 220

2 - 4' DEPTH
PID = BDL DETECTED VOCs Napht = 230

2 - 4' DEPTH
PID = 16 VOCs < LOD

2 - 4' DEPTH
PID = BDL VOCs < LOD

CHEMICAL KEY:
 E: ETHYLBENZENE
 IPBz: ISOPROPYLBENZENE
 n-BuBz: n-BUTYLBENZENE
 n-PBz: n-PROPYLBENZENE
 Napht: NAPHTHALENE
 p-IPT: p-ISOPROPYLTOLUENE
 s-BuBz: sec-BUTYLBENZENE
 T: TOLUENE
 TMB: TRIMETHYLBENZENE
 X: XYLENE (TOTAL)

ABBREVIATIONS:
 BDL: BELOW DETECTION LIMIT
 LOD: LIMIT OF DETECTION
 PID: PHOTOIONIZATION DETECTOR (FIELD)
 RCLs: RESIDUAL CONTAMINANT LEVELS
 USEPA: UNITED STATES ENVIRONMENTAL PROTECTION AGENCY
 VOCs: VOLATILE ORGANIC COMPOUNDS
 WDNR: WISCONSIN DEPARTMENT OF NATURAL RESOURCES

NOTES:
 FIELD PID RESULTS EXPRESSED IN INSTRUMENT UNITS
 VOC RESULTS EXPRESSED IN MICROGRAMS PER KILOGRAM (ug/kg) EQUIVALENT TO PARTS PER BILLION (ppb)
 J: CONCENTRATION BETWEEN LABORATORY LIMIT OF DETECTION AND QUANTITATION LIMIT.

LEGEND:

- GP-1 DIRECT-PUSH SOIL BORING
- MW-1 GROUNDWATER MONITORING WELL
- TW-1 TEMPORARY WELL
- FENCE
- ELECTRIC POLE
- ☒ CATCH BASIN

GILES ENGINEERING ASSOCIATES, INC.
 N8 W22350 JOHNSON DRIVE, SUITE A1
 WAUKESHA, WI 53186 (262)544-0118

FIGURE 3A
 SOIL ANALYTICAL RESULTS (PETROLEUM VOCs)
 MARTINIZING
 1730 STATE STREET
 RACINE, WISCONSIN

DESIGNED	DRAWN	SCALE	DATE	REVISED
KTB/TJB	JSZ	approx. 1"=20'	06-14-13	--
PROJECT NO.: 1E-0909013			CAD No. 1E0909013I2	

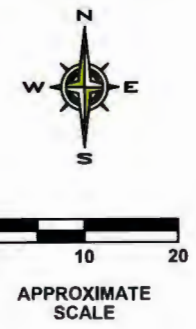
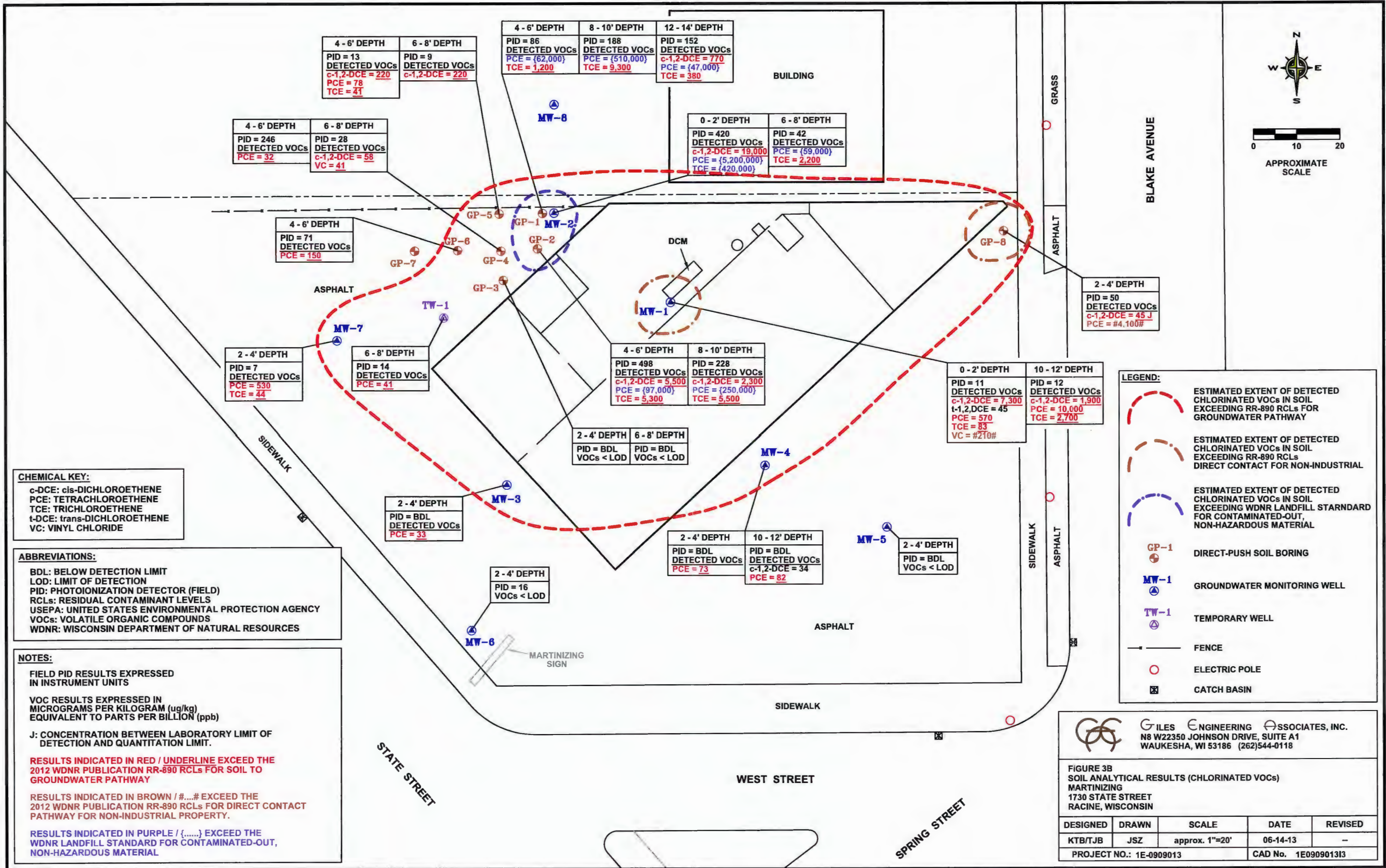

CHEMICAL KEY:
 c-DCE: cis-DICHLOROETHENE
 PCE: TETRACHLOROETHENE
 TCE: TRICHLOROETHENE
 t-DCE: trans-DICHLOROETHENE
 VC: VINYL CHLORIDE

ABBREVIATIONS:
 BDL: BELOW DETECTION LIMIT
 LOD: LIMIT OF DETECTION
 PID: PHOTOIONIZATION DETECTOR (FIELD)
 RCLs: RESIDUAL CONTAMINANT LEVELS
 USEPA: UNITED STATES ENVIRONMENTAL PROTECTION AGENCY
 VOCs: VOLATILE ORGANIC COMPOUNDS
 WDNr: WISCONSIN DEPARTMENT OF NATURAL RESOURCES

NOTES:
 FIELD PID RESULTS EXPRESSED IN INSTRUMENT UNITS
 VOC RESULTS EXPRESSED IN MICROGRAMS PER KILOGRAM (ug/kg) EQUIVALENT TO PARTS PER BILLION (ppb)
 J: CONCENTRATION BETWEEN LABORATORY LIMIT OF DETECTION AND QUANTITATION LIMIT.
 RESULTS INDICATED IN RED / UNDERLINE EXCEED THE 2012 WDNr PUBLICATION RR-890 RCLs FOR SOIL TO GROUNDWATER PATHWAY
 RESULTS INDICATED IN BROWN / #.....# EXCEED THE 2012 WDNr PUBLICATION RR-890 RCLs FOR DIRECT CONTACT PATHWAY FOR NON-INDUSTRIAL PROPERTY.
 RESULTS INDICATED IN PURPLE / {.....} EXCEED THE WDNr LANDFILL STANDARD FOR CONTAMINATED-OUT, NON-HAZARDOUS MATERIAL

LEGEND:

- - - ESTIMATED EXTENT OF DETECTED CHLORINATED VOCs IN SOIL EXCEEDING RR-890 RCLs FOR GROUNDWATER PATHWAY
- - - ESTIMATED EXTENT OF DETECTED CHLORINATED VOCs IN SOIL EXCEEDING RR-890 RCLs DIRECT CONTACT FOR NON-INDUSTRIAL
- - - ESTIMATED EXTENT OF DETECTED CHLORINATED VOCs IN SOIL EXCEEDING WDNr LANDFILL STANDARD FOR CONTAMINATED-OUT, NON-HAZARDOUS MATERIAL
- GP-1 DIRECT-PUSH SOIL BORING
- MW-1 GROUNDWATER MONITORING WELL
- TW-1 TEMPORARY WELL
- FENCE
- ELECTRIC POLE
- ☒ CATCH BASIN

GILES ENGINEERING ASSOCIATES, INC.
 N8 W22350 JOHNSON DRIVE, SUITE A1
 WAUKESHA, WI 53186 (262)544-0118

FIGURE 3B
 SOIL ANALYTICAL RESULTS (CHLORINATED VOCs)
 MARTINIZING
 1730 STATE STREET
 RACINE, WISCONSIN

DESIGNED	DRAWN	SCALE	DATE	REVISED
KTB/TJB	JSZ	approx. 1"=20'	06-14-13	-
PROJECT NO.: 1E-0909013			CAD No. 1E0909013I3	

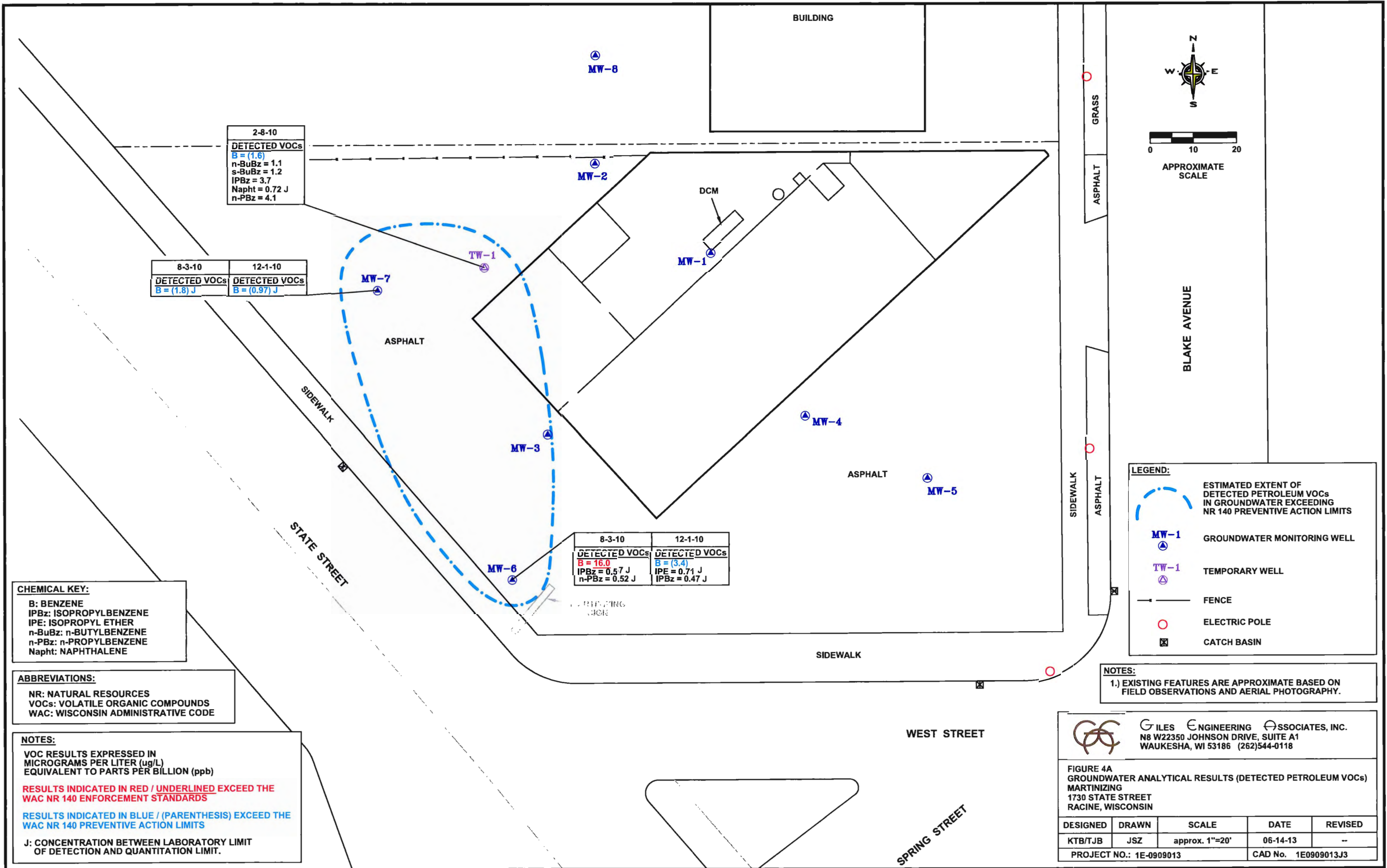

2-8-10
DETECTED VOCs
B = (1.6)
n-BuBz = 1.1
s-BuBz = 1.2
IPBz = 3.7
Napht = 0.72 J
n-PBz = 4.1

8-3-10	12-1-10
DETECTED VOCs	DETECTED VOCs
B = (1.8) J	B = (0.97) J

8-3-10	12-1-10
DETECTED VOCs	DETECTED VOCs
B = <u>16.0</u>	B = (3.4)
IPBz = 0.57 J	IPE = 0.71 J
n-PBz = 0.52 J	IPBz = 0.47 J

CHEMICAL KEY:
 B: BENZENE
 IPBz: ISOPROPYL BENZENE
 IPE: ISOPROPYL ETHER
 n-BuBz: n-BUTYLBENZENE
 n-PBz: n-PROPYLBENZENE
 Napht: NAPHTHALENE

ABBREVIATIONS:
 NR: NATURAL RESOURCES
 VOCs: VOLATILE ORGANIC COMPOUNDS
 WAC: WISCONSIN ADMINISTRATIVE CODE

NOTES:
 VOC RESULTS EXPRESSED IN MICROGRAMS PER LITER (ug/L) EQUIVALENT TO PARTS PER BILLION (ppb)
RESULTS INDICATED IN RED / UNDERLINED EXCEED THE WAC NR 140 ENFORCEMENT STANDARDS
RESULTS INDICATED IN BLUE / (PARENTHESIS) EXCEED THE WAC NR 140 PREVENTIVE ACTION LIMITS
 J: CONCENTRATION BETWEEN LABORATORY LIMIT OF DETECTION AND QUANTITATION LIMIT.

LEGEND:

- ESTIMATED EXTENT OF DETECTED PETROLEUM VOCs IN GROUNDWATER EXCEEDING NR 140 PREVENTIVE ACTION LIMITS
- MW-1 GROUNDWATER MONITORING WELL
- TW-1 TEMPORARY WELL
- FENCE
- ELECTRIC POLE
- CATCH BASIN

NOTES:
 1.) EXISTING FEATURES ARE APPROXIMATE BASED ON FIELD OBSERVATIONS AND AERIAL PHOTOGRAPHY.

GILES ENGINEERING ASSOCIATES, INC.
 N8 W22350 JOHNSON DRIVE, SUITE A1
 WAUKESHA, WI 53186 (262)544-0118

FIGURE 4A
 GROUNDWATER ANALYTICAL RESULTS (DETECTED PETROLEUM VOCs)
 MARTINIZING
 1730 STATE STREET
 RACINE, WISCONSIN

DESIGNED	DRAWN	SCALE	DATE	REVISED
KTB/TJB	JSZ	approx. 1"=20'	06-14-13	--
PROJECT NO.: 1E-0909013			CAD No. 1E0909013J3	

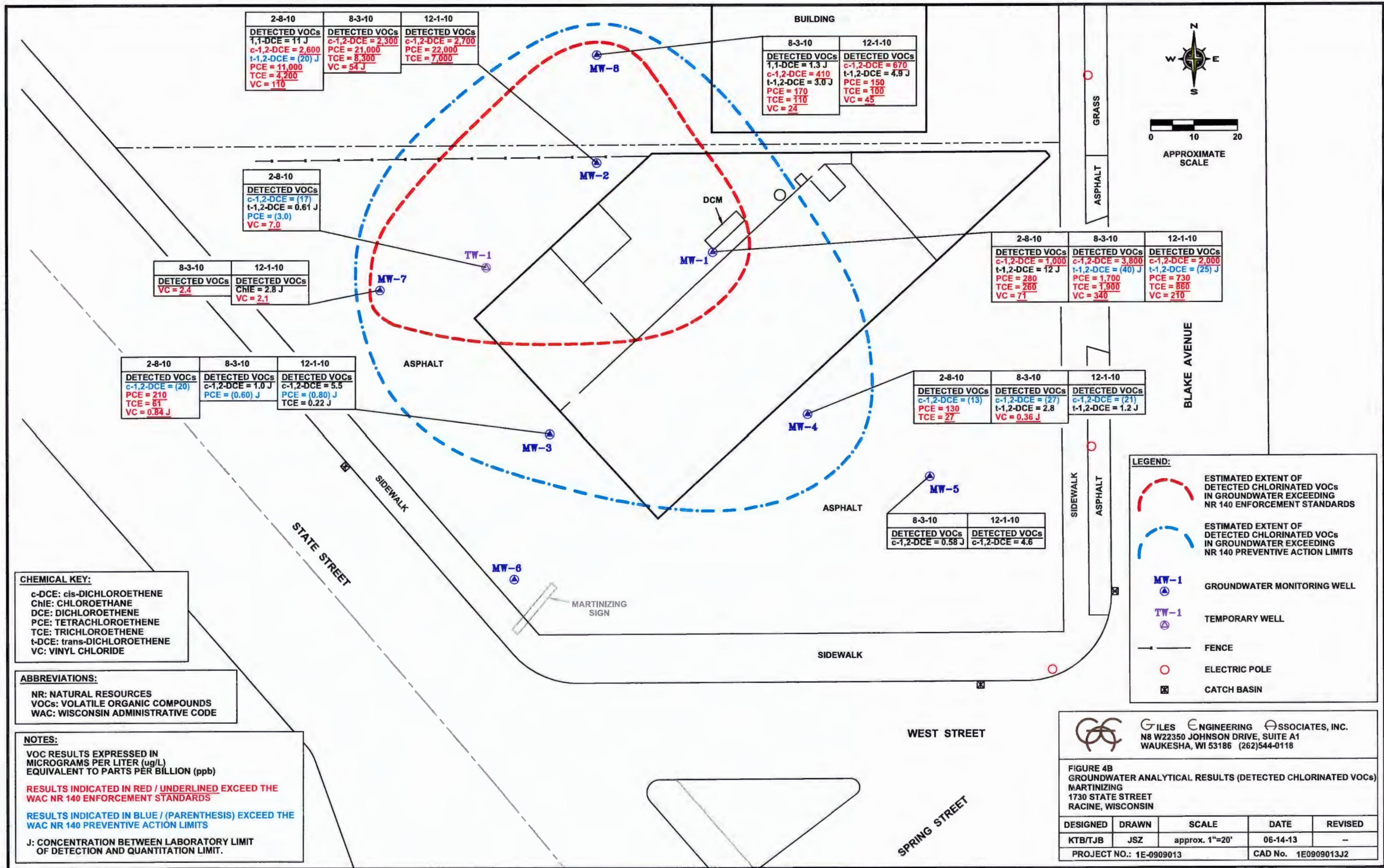

2-8-10	8-3-10	12-1-10
DETECTED VOCs 1,1-DCE = 11 J c-1,2-DCE = 2,600 t-1,2-DCE = (20) J PCE = 11,000 TCE = 4,200 VC = 110	DETECTED VOCs c-1,2-DCE = 2,300 PCE = 21,000 TCE = 8,300 VC = 54 J	DETECTED VOCs c-1,2-DCE = 2,700 PCE = 22,000 TCE = 7,000

BUILDING	
8-3-10	12-1-10
DETECTED VOCs 1,1-DCE = 1.3 J c-1,2-DCE = 410 t-1,2-DCE = 3.0 J PCE = 170 TCE = 110 VC = 24	DETECTED VOCs c-1,2-DCE = 670 t-1,2-DCE = 4.9 J PCE = 150 TCE = 100 VC = 45

2-8-10
DETECTED VOCs c-1,2-DCE = (17) t-1,2-DCE = 0.61 J PCE = (3.0) VC = 7.0

8-3-10	12-1-10
DETECTED VOCs VC = 2.4	DETECTED VOCs ChIE = 2.8 J VC = 2.1

2-8-10	8-3-10	12-1-10
DETECTED VOCs c-1,2-DCE = (20) PCE = 210 TCE = 61 VC = 0.84 J	DETECTED VOCs c-1,2-DCE = 1.0 J PCE = (0.60) J	DETECTED VOCs c-1,2-DCE = 5.5 PCE = (0.80) J TCE = 0.22 J

2-8-10	8-3-10	12-1-10
DETECTED VOCs c-1,2-DCE = 1,000 t-1,2-DCE = 12 J PCE = 280 TCE = 260 VC = 71	DETECTED VOCs c-1,2-DCE = 3,800 t-1,2-DCE = (40) J PCE = 1,700 TCE = 1,900 VC = 340	DETECTED VOCs c-1,2-DCE = 2,000 t-1,2-DCE = (25) J PCE = 730 TCE = 860 VC = 210

2-8-10	8-3-10	12-1-10
DETECTED VOCs c-1,2-DCE = (13) PCE = 130 TCE = 27	DETECTED VOCs c-1,2-DCE = (27) t-1,2-DCE = 2.8 VC = 0.36 J	DETECTED VOCs c-1,2-DCE = (21) t-1,2-DCE = 1.2 J

8-3-10	12-1-10
DETECTED VOCs c-1,2-DCE = 0.58 J	DETECTED VOCs c-1,2-DCE = 4.6

LEGEND:

- ESTIMATED EXTENT OF DETECTED CHLORINATED VOCs IN GROUNDWATER EXCEEDING NR 140 ENFORCEMENT STANDARDS
- ESTIMATED EXTENT OF DETECTED CHLORINATED VOCs IN GROUNDWATER EXCEEDING NR 140 PREVENTIVE ACTION LIMITS
- MW-1 GROUNDWATER MONITORING WELL
- TW-1 TEMPORARY WELL
- FENCE
- ELECTRIC POLE
- CATCH BASIN

CHEMICAL KEY:
 c-DCE: cis-DICHLOROETHENE
 ChIE: CHLOROETHANE
 DCE: DICHLOROETHENE
 PCE: TETRACHLOROETHENE
 TCE: TRICHLOROETHENE
 t-DCE: trans-DICHLOROETHENE
 VC: VINYL CHLORIDE

ABBREVIATIONS:
 NR: NATURAL RESOURCES
 VOCs: VOLATILE ORGANIC COMPOUNDS
 WAC: WISCONSIN ADMINISTRATIVE CODE

NOTES:
 VOC RESULTS EXPRESSED IN MICROGRAMS PER LITER (ug/L) EQUIVALENT TO PARTS PER BILLION (ppb)
 RESULTS INDICATED IN RED / UNDERLINED EXCEED THE WAC NR 140 ENFORCEMENT STANDARDS
 RESULTS INDICATED IN BLUE / (PARENTHESIS) EXCEED THE WAC NR 140 PREVENTIVE ACTION LIMITS
 J: CONCENTRATION BETWEEN LABORATORY LIMIT OF DETECTION AND QUANTITATION LIMIT.

GILES ENGINEERING ASSOCIATES, INC.
 N8 W22350 JOHNSON DRIVE, SUITE A1
 WAUKESHA, WI 53186 (262)544-0118

FIGURE 4B
 GROUNDWATER ANALYTICAL RESULTS (DETECTED CHLORINATED VOCs)
 MARTINIZING
 1730 STATE STREET
 RACINE, WISCONSIN

DESIGNED	DRAWN	SCALE	DATE	REVISED
KTB/TJB	JSZ	approx. 1"=20'	06-14-13	-
PROJECT NO.: 1E-0909013			CAD No. 1E0909013J2	

**TABLE 1
PROPOSED SCHEDULE OF FEES**

**SITE INVESTIGATION CHANGE ORDER NO. 3- STATE STREET MARTINIZING RACINE, WI
RACINE, WISCONSIN**

Phase No.	Description	CONSULTANT FEES			SUBCONTRACTOR FEES	Budget
		Labor	Expenses	Equipment		
TASK 01:	SAMPLING PLAN PREPARATION	\$1,330	\$40	\$0	\$0	\$1,370
TASK 02:	SHSP PREPARATION & UTILITY LOCATE	\$420	\$0	\$0	\$0	\$420
TASK 03:	DIRECT-PUSH SOIL SAMPLING	\$1,360	\$60	\$160	\$1,695	\$3,275
TASK 04:	GW SAMPLING (2 QTRLY EVENTS)	\$2,380	\$120	\$450	\$1,850	\$4,800
TASK 05:	SUB-SLAB DEPRESSURIZATION SYSTEM INSTALL	\$1,230	\$60	\$0	\$5,000	\$6,290
TASK 06:	SI REPORT PREPARATION	\$3,090	\$0	\$0	\$0	\$3,090
Fee Estimate		\$9,810	\$280	\$610	\$8,545	\$19,245

**TABLE 1
PROPOSED SCHEDULE OF FEES
SITE INVESTIGATION CHANGE ORDER NO. 3- STATE STREET MARTINIZING RACINE, WI
RACINE, WISCONSIN**

SUBCONTRACTOR FEES DETAIL		SUBCONTRACTOR FEES	Budget
TASK 01:	SAMPLING PLAN PREPARATION	\$0	\$0
TASK 02:	SHSP PREPARATION & UTILITY LOCATE	\$0	\$0
TASK 03:	DIRECT-PUSH SOIL SAMPLING	\$1,695	\$1,695
	Laboratory Subcontractor Costs	\$195	
	Direct-push Subcontractor Costs	\$1,500	
TASK 04:	GW SAMPLING (2 QTRLY EVENTS)	\$1,850	\$1,850
	Laboratory Subcontractor Costs	\$1,300	
	Purge/ Dev. Water Soil Waste Disposal Subcontractor Costs	\$550	
TASK 05:	SUB-SLAB DEPRESSURIZATION SYSTEM INSTALL	\$5,000	\$5,000
	Certified Radon Mitigation Contractor	\$5,000	
TASK 06:	SI REPORT PREPARATION	\$0	\$0
TOTALS:			\$8,545

BUDGET WORKSHEET

PROJECT NAME: SITE INVESTIGATION CHANGE ORDER NO. 3- STATE STREET MARTINIZING RACINE, WI
 CITY, STATE: RACINE, WISCONSIN
 PROJECT NO: 1E-0909013

TASK 01: SAMPLING PLAN PREPARATION		\$1,370.00		
GILES LABOR	Units	Unit Rate	Quantity	Price
REGIONAL MANAGER	hr.	\$120.00		\$0.00
DIVISION MANAGER	hr.	\$120.00	4	\$480.00
SENIOR PM	hr.	\$110.00		\$0.00
PROJECT PM II	hr.	\$100.00		\$0.00
PROJECT PM I	hr.	\$95.00		\$0.00
STAFF ENV SCIENTIST I / II	hr.	\$85.00	10	\$850.00
STAFF GEOLOGIST II / I	hr.	\$75.00		\$0.00
ENV SPECIALIST I / II	hr.	\$65.00		\$0.00
CAD OPERATOR	hr.	\$55.00		\$0.00
WORD-PROCESSING	hr.	\$45.00		\$0.00
GILES LABOR COST TOTAL				\$1,330.00
GILES EMPLOYEE EXPENSES	Units	Unit Rate	Quantity	Price
Mileage-Personal Vehicle	mi.	\$0.40	100	\$40.00
GILES EMPLOYEE EXPENSES COST TOTAL				\$40.00

BUDGET WORKSHEET

PROJECT NAME: SITE INVESTIGATION CHANGE ORDER NO. 3- STATE STREET MARTINIZING RACINE, WI
CITY, STATE: RACINE, WISCONSIN
PROJECT NO: 1E-0909013

TASK 02: SHSP PREPARATION & UTILITY LOCATE		\$420.00		
GILES LABOR	Units	Unit Rate	Quantity	Price
REGIONAL MANAGER	hr.	\$120.00		\$0.00
DIVISION MANAGER	hr.	\$120.00	1	\$120.00
SENIOR PM	hr.	\$110.00		\$0.00
PROJECT PM II	hr.	\$100.00		\$0.00
PROJECT PM I	hr.	\$95.00		\$0.00
STAFF ENV SCIENTIST I / II	hr.	\$85.00	2	\$170.00
STAFF GEOLOGIST II / I	hr.	\$75.00		\$0.00
ENV SPECIALIST I / II	hr.	\$65.00	2	\$130.00
CAD OPERATOR	hr.	\$55.00		\$0.00
WORD-PROCESSING	hr.	\$45.00		\$0.00
GILES LABOR COST TOTAL				\$420.00

BUDGET WORKSHEET

PROJECT NAME: SITE INVESTIGATION CHANGE ORDER NO. 3- STATE STREET MARTINIZING RACINE, WI
 CITY, STATE: RACINE, WISCONSIN
 PROJECT NO: 1E-0909013

TASK 03: DIRECT-PUSH SOIL SAMPLING		\$3,275.00		
GILES LABOR	Units	Unit Rate	Quantity	Price
REGIONAL MANAGER	hr.	\$120.00		\$0.00
DIVISION MANAGER	hr.	\$120.00	2	\$240.00
SENIOR PM	hr.	\$110.00		\$0.00
PROJECT PM II	hr.	\$100.00		\$0.00
PROJECT PM I	hr.	\$95.00		\$0.00
STAFF ENV SCIENTIST I / II	hr.	\$85.00	4	\$340.00
STAFF GEOLOGIST II / I	hr.	\$75.00		\$0.00
ENV SPECIALIST I / II	hr.	\$65.00	12	\$780.00
CAD OPERATOR	hr.	\$55.00		\$0.00
WORD-PROCESSING	hr.	\$45.00		\$0.00
GILES LABOR COST TOTAL				\$1,360.00

GILES EMPLOYEE EXPENSES	Units	Unit Rate	Quantity	Price
Mileage-Giles Vehicle	mi.	\$0.60	100	\$60.00
GILES EMPLOYEE EXPENSES COST TOTAL				\$60.00

GILES EQUIPMENT	Units	Unit Rate	Quantity	Price
Survey Equipment	day	\$40	1	\$40.00
PID	day	\$75	1	\$75.00
Electronic Scale	day	\$25	1	\$25.00
Water Level Indicator	day	\$20	1	\$20.00
GILES EQUIPMENT COST TOTAL				\$160.00

LABORATORY SUBCONTRACTOR COSTS	Units	Unit Rate	Quantity	Price
TestAmerica				
Soil Laboratory Analytical Methods				
VOCs 8260		\$65.00	3	\$195.00
LABORATORY SUBCONTRACTOR COST TOTAL				\$195.00

GEOPROBE SUBCONTRACTOR COSTS	Units	Unit Rate	Quantity	Price
Giles Drilling Division				
Mobilization/Demobilization	LS	\$275.00		\$0.00
0 to 20 feet	ft	\$8.50		\$0.00
20 to 40 feet	ft	\$9.50		\$0.00
Decon	ea	\$150.00		\$0.00
Temp Wells	ft	\$6.50		\$0.00
Expendables	LS			\$0.00
Borehole Abandonment	ft	\$2.50		\$0.00
Per diem	LS	\$150.00		\$0.00
OPTIONAL LUMP SUM DAILY Geoprobe Services	LS	\$1,500.00	1	\$1,500.00
GEOPROBE SUBCONTRACTOR COST TOTAL				\$1,500.00

BUDGET WORKSHEET

PROJECT NAME: SITE INVESTIGATION CHANGE ORDER NO. 3- STATE STREET MARTINIZING RACINE, WI
 CITY, STATE: RACINE, WISCONSIN
 PROJECT NO: 1E-0909013

TASK 04: GW SAMPLING (2 QTRLY EVENTS)		\$4,800.00		
GILES LABOR				
	Units	Unit Rate	Quantity	Price
REGIONAL MANAGER	hr.	\$120.00		\$0.00
DIVISION MANAGER	hr.	\$120.00	4	\$480.00
SENIOR PM	hr.	\$110.00		\$0.00
PROJECT PM II	hr.	\$100.00		\$0.00
PROJECT PM I	hr.	\$95.00		\$0.00
STAFF ENV SCIENTIST I / II	hr.	\$85.00	4	\$340.00
STAFF GEOLOGIST II / I	hr.	\$75.00		\$0.00
ENV SPECIALIST I / II	hr.	\$65.00	24	\$1,560.00
CAD OPERATOR	hr.	\$55.00		\$0.00
WORD-PROCESSING	hr.	\$45.00		\$0.00
GILES LABOR COST TOTAL				\$2,380.00

GILES EMPLOYEE EXPENSES				
	Units	Unit Rate	Quantity	Price
Mileage-Giles Vehicle	mi.	\$0.60	200	\$120.00
GILES EMPLOYEE EXPENSES COST TOTAL				\$120.00

GILES EQUIPMENT				
	Units	Unit Rate	Quantity	Price
Water Level Indicator	day	\$20	2	\$40.00
Peristaltic Sampling Pump	day	\$40	2	\$80.00
Water Quality Meter	day	\$100	2	\$200.00
Drums	ea	\$65	2	\$130.00
GILES EQUIPMENT COST TOTAL				\$450.00

LABORATORY SUBCONTRACTOR COSTS				
	Units	Unit Rate	Quantity	Price
GW Lab Analysis				
VOCs 8260		\$65.00	20	\$1,300.00
Subtotal GW Analytical Cost				\$1,300.00
LABORATORY SUBCONTRACTOR COST TOTAL				\$1,300.00

WASTE DISPOSAL SUBCONTRACTOR COSTS				
	Units	Unit Rate	Quantity	Price
Development/Purge Water Disposal				
Transportation	LS	\$250.00	1	\$250.00
Disposal	drum	\$150.00	2	\$300.00
Waste Disposal Subcontractor Cost Markup		0.00%	\$550.00	\$0.00
MISCELLANEOUS SUBCONTRACTOR 01 COST TOTAL				\$550.00

BUDGET WORKSHEET

PROJECT NAME: SITE INVESTIGATION CHANGE ORDER NO. 3- STATE STREET MARTINIZING RACINE, WI
 CITY, STATE: RACINE, WISCONSIN
 PROJECT NO: 1E-0909013

TASK 05: SUB-SLAB DEPRESSURIZATION SYSTEM INSTALL		\$6,290.00		
GILES LABOR	Units	Unit Rate	Quantity	Price
REGIONAL MANAGER	hr.	\$120.00		\$0.00
DIVISION MANAGER	hr.	\$120.00	2	\$240.00
SENIOR PM	hr.	\$110.00		\$0.00
PROJECT PM II	hr.	\$100.00		\$0.00
PROJECT PM I	hr.	\$95.00		\$0.00
STAFF ENV SCIENTIST I / II	hr.	\$85.00	4	\$340.00
STAFF GEOLOGIST II / I	hr.	\$75.00		\$0.00
ENV SPECIALIST I / II	hr.	\$65.00	10	\$650.00
CAD OPERATOR	hr.	\$55.00		\$0.00
WORD-PROCESSING	hr.	\$45.00		\$0.00
GILES LABOR COST TOTAL				\$1,230.00

GILES EMPLOYEE EXPENSES	Units	Unit Rate	Quantity	Price
Mileage-Giles Vehicle	mi.	\$0.60	100	\$60.00
GILES EMPLOYEE EXPENSES COST TOTAL				\$60.00

SUBSLAB VAPOR MITIGATION SYS SUBCONTRACTOR COSTS	Units	Unit Rate	Quantity	Price
System Installation				
Transportation	LS	\$2,500.00	2	\$5,000.00
Disposal	drum	\$125.00		\$0.00
WASTE DISPOSAL SUBCONTRACTOR COST TOTAL				\$5,000.00

BUDGET WORKSHEET

PROJECT NAME: SITE INVESTIGATION CHANGE ORDER NO. 3- STATE STREET MARTINIZING RACINE, WI
CITY, STATE: RACINE, WISCONSIN
PROJECT NO: 1E-0909013

TASK 06: SI REPORT PREPARATION		\$3,090.00		
GILES LABOR	Units	Unit Rate	Quantity	Price
REGIONAL MANAGER	hr.	\$120.00		\$0.00
DIVISION MANAGER	hr.	\$120.00	6	\$720.00
SENIOR PM	hr.	\$110.00		\$0.00
PROJECT PM II	hr.	\$100.00		\$0.00
PROJECT PM I	hr.	\$95.00		\$0.00
STAFF ENV SCIENTIST I / II	hr.	\$85.00	24	\$2,040.00
STAFF GEOLOGIST II / I	hr.	\$75.00		\$0.00
ENV SPECIALIST I / II	hr.	\$65.00	2	\$130.00
CAD OPERATOR	hr.	\$55.00	2	\$110.00
WORD-PROCESSING	hr.	\$45.00	2	\$90.00
GILES LABOR COST TOTAL				\$3,090.00

**DERF Site Investigation Bid Summary
 Consultant Selection Cover Sheet**

Notice: Use this form to notify the Department of Natural Resources of the consultant you are selecting to conduct a site investigation and to submit and summarize the bids required in the Dry Cleaner Environmental Response Fund (DERF) Program. This form is authorized under s. 292.65, Wis. Stats. and s. NR 169.23, Wis. Adm. Code. Completion of this form is mandatory for any person applying for DERF reimbursement. Persons who do not submit a completed form will not be eligible for reimbursement under DERF. Personal information will be used to manage the DERF program, and be made available to requesters under Wisconsin's Open Records laws (ss. 19.32-19.39, Wis. Stats.) and requirements.

Complete the following information and submit it to your DNR regional project manager. Copy this form as necessary.

Site Information		
Site name: Martinizing Cleaners	Facility Name: 1730 State Street, Racine WI	BRRTS # 02-52-549890
Site Investigation		

Consultant Selected	
Consultant Name: Giles Engineering Associates, Inc.	Consultant Address: Waukesha WI

Summary of Costs:			
Consultant Name: Giles Engineering Associates, Inc.			
Consulting costs:	\$	9,810	
Drilling costs:	\$	1,500	
Analytical costs:	\$	1,495	
Miscellaneous costs:	\$	6,440	
Total Costs:	\$	19,245	

Consultant Name:	
Consulting costs:	
Drilling costs:	
Analytical costs:	
Miscellaneous costs:	
Total Costs:	

Consultant Name:	
Consulting costs:	
Drilling costs:	
Analytical costs:	
Miscellaneous costs:	
Total Costs:	

Optional 4th bid information:	
Consultant Name:	
Consulting costs:	
Drilling costs:	
Analytical costs:	
Miscellaneous costs:	
Total Costs:	

Justification for Selection:
Martinizing Cleaners has Selected Giles Engineering to perform the requested services of the RFP because their proposal provides a thorough and complete approach to accomplish the requested work.

Applicant Information and Certification

I certify that the information contained above is true and correct to the best of my knowledge.

Applicant Name Douglas Berry	Date		
Street Address 3319 Nobb Hill Drive	City Racine	State WI	Zip Code 53406

Signature

Department Use Only		
Project Manager Approval Signature	Phone Number	Date

If not approved, reason for non-approval:

Consultant Name: Giles Eng
Site Name: Martinizing Cleaners; State Street Racine, WI
BRRTS #:02-52-549890
Date:6/11/13

DERF Site Investigation Bid Sheet
Consultant Bid Summary
Form 4400-233 (R 4/04) Page 1 of 1

Site Information

Site Name Martinizing Cleaners State Street, Racine WI

Consultant Name:
Giles Engineering Associates, Inc.

Applicant Name:
Kevin T. Bugel, P.G., C.P.G.

Bid Summary

Drilling Costs Total =	\$	1,500
Analytical Costs Total =	\$	1,495
Consulting Costs Total =	\$	9,810
Misc Costs Total =	\$	6,440
Grand Total =	\$	19,245

I certify that the costs are an accurate estimate of my total projected costs for the site investigation and I understand and will adhere to s.292.65 Stats. and ch NR 169, Wis. Adm. Code.

Consultant Signature

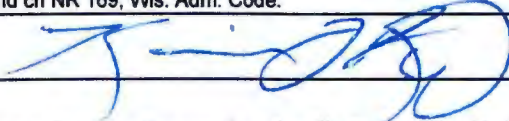

Date

06/17/2014

Please attach to these forms a written narrative specifying how the tasks outlined in these sheets will be performed.

Consultant Name: Giles Eng
 Site Name: Martinizing Cleaners; State Street Racine, WI
 BRRTS #: 02-52-549890
 Date: 6/11/13

DERF Site Investigation Bid Sheet
Analytical Costs

Form 4400-233 (R 4/04) Page 4 of 6

Parameter	WI Certified Lab			Field Test/Field Kit			Mobile Lab			Total Costs
	\$/sample	# samples	Method Used	\$/sample	# samples	Method Used	\$/Sample \$/Day	# Samples # Days	Method Used	
Solids Analysis										
VOCs	\$65	3	8260							\$195.00
TCLP										\$0.00
RCRA Metals										\$0.00
Duplicate Analyses										\$0.00
Blank Analyses	\$0									\$0.00
Other: (Specify)										\$0.00
TOC*										\$0.00
Water Analysis (low flow sampling assumed unless otherwise indicated at bottom of this sheet)										
VOCs	\$65	20	8260							\$1,300.00
Nitrate*	\$15									\$0.00
Dissolved Oxygen*										\$0.00
Temperature*										\$0.00
Ferrous Iron*	\$8									\$0.00
Sulfate*	\$8									\$0.00
Sulfide*	\$15									\$0.00
ORP*										\$0.00
pH*										\$0.00
TOC*	\$15									\$0.00
Alkalinity*	\$8									\$0.00
Chloride*	\$8									\$0.00
Spec. Conductance*										\$0.00
Ethene/Ethane/Methane*	\$125									\$0.00
Hydrogen*	\$125									\$0.00
Carbon Dioxide*	\$125									\$0.00
RCRA Metals										\$0.00
Duplicate Analyses	\$65		8260							\$0.00
Blank Analyses	\$0									\$0.00
Other: (Specify)										\$0.00
Nitrogen (total kjeldahl)	\$15									\$0.00
Phosphorous (total)	\$15									\$0.00
Manganese	\$8									\$0.00
Air Analysis										
VOCs										\$0.00
TCE										\$0.00
PCE (minimum detection limit is <10 ppbv)										\$0.00
Other: (Specify)										\$0.00
Waste Analyses (soil/water)										
Protocol B										\$0.00
Miscellaneous (specify)										
										\$0.00
										\$0.00
Charge for Mobile Lab (indicate # days and daily fee)										
Total Analytical Costs										\$1,495.00

* Natural Attenuation parameters required for consideration of NA as remedy.

Consultant Name: Giles Eng
 Site Name: Martinizing Cleaners, State Street, Racine, WI
 BRRTS #: 02-520549890
 Date: 6/11/13

DERF Site Investigation Bid Sheet

Consultant Costs

Form 4400-233 (R 4/04) Page 5 of 6

Position (specify)	Hourly Rate	Hours/Task															Total Costs		
		Workplan Development	Access (Off-site)	Receptor Survey	Waste Determination	Drilling Oversight	Soil Sampling	Drilling sampling	Well Development	Hydraulic Conductivity Test	Groundwater sampling	Soil gas/vapor intrusion survey	SSRCL calculations (contained out or remedial actions)	SI Report preparation	RAOR Report preparation	Project Management		Other (specify)	
																		Data Reduction	
Professional Staff																			\$0.00
Sr. Project Manager	120	4				3					4	2		6					\$2,280.00
Project Manager	85	10				6					4	4		24					\$4,080.00
Staff Hydrogeologist	75																		\$0.00
																			\$0.00
Field Staff																			\$0.00
Field Technician	65					2	6	6			24	10		2					\$3,250.00
																			\$0.00
																			\$0.00
																			\$0.00
																			\$0.00
Office Support Staff																			\$0.00
CAD Operator	55													2					\$110.00
Clerical	45													2					\$90.00
																			\$0.00
																			\$0.00
																			\$0.00
Total Consulting Costs																			\$9,810.00

Consultant Name: Giles Eng
 Site Name: Martinizing Cleaners; State Street, Racine, WI
 BRRTS #: 02-52-549890
 Date: 6/11/13

DERF Site Investigation Bid Sheet
Miscellaneous Costs

Form 4400-233 (R 4/04) Page 6 of 6

Major Activity	Specifications	Commodity Unit (specify)	Unit Rate	Number of Units	Total Cost
IDW Disposal					
Soil Disposal - Special Waste	Non-Hazardous	per drum	\$80		\$0
Soil Disposal - Assume Direct Subtile C	Hazardous	per drum			
Soil Drum Transportation		trip	\$75		\$0
Groundwater Disposal					
Groundwater Disposal	Non-Hazardous	per drum	\$150	2	\$300
Groundwater Disposal	Hazardous	per drum			
Groundwater Transportation		trip	\$250	1	\$250
Equipment Rental (list and include shipping costs if applicable)					
					0
					0
Field Supplies (list)					
Peristaltic Pump			\$40	2	\$80
Hand Auger			\$10		\$0
Water Level Indicator			\$20	3	\$60
Water Quality Meter			\$100	2	\$200
Hermit Data Logger			\$125		\$0
Photoionization detector			\$75	1	\$75
electronic scale			\$25	1	\$25
Whale Pump & Tubing			\$35		\$0
Drums			\$65	2	\$130
Survey Equipment			\$40	1	\$40
Caps and Locks			\$13		\$0
Surveying					
					0
					0
Personal Protection Equipment (list)					
				850	0
					0
Sample Shipping Costs					
					0
					0
					0
Other (specify)					
Sub-Slab Depressorization Sys (2)			\$2,500.00	2	\$5,000
Mileage (Not Eligible)		100 Miles\roundtrip	\$0.40	100	\$40
Mileage (Not Eligible)		100 Miles\roundtrip	\$0.60	400	\$240
Per Diem					\$0
Total Miscellaneous Costs					\$6,440

Reminders: DERF does not reimburse for attorney, closure or GIS fees. Mileage and meals are also non-reimbursable. Also, costs to prepare a reimbursement application and discuss the application with the department are not reimbursable. No expedited shipping w/o prior PM approval.