



Rec'd 10-13-15
D.W.

October 9, 2015

Terry Schuetz
Napa Auto Parts
1603 Manhattan Drive
Waukesha, WI 53186

Subject: Environmental sampling results
36863 East Wisconsin Avenue
Oconomowoc, Wisconsin

Dear Mr. Schuetz:

In accordance with the executed Agreement to Provide Access for Sampling Activities dated February 10, 2015, and in accordance with Wisconsin Department of Natural Resources (WDNR) regulation NR 716.14, Environmental Forensic Investigations, Inc. (EnviroForensics) is providing the results of the soil gas sample collected from your property located at 36863 East Wisconsin Avenue, Oconomowoc, Wisconsin. The soil gas sample was collected on September 15, 2015 from a groundwater monitoring well (MW-15) located on your property. The sampling activities are part of an environmental investigation being performed at the Former One Hour Martinizing (OHM) of Oconomowoc, located at 36929 Plank Road, Oconomowoc, Wisconsin at the direction of the Wisconsin Department of Natural Resources (WDNR) pursuant to the authority granted to it under State and Federal law. The WDNR has assigned the following identification to this on-going investigation: BRRTS# 02-68-551911. The chemicals of concern for the investigation are the dry cleaning solvent tetrachloroethene (PCE) and its associated breakdown products.

The Responsible Party is:

Mr. Brian Cass
OHM Holdings, Inc.
W229 N2494 County Road F
Waukesha, WI 53186-1104
262-521-9710

Groundwater Sampling Results

One (1) soil gas sample (6143-SG-5 (MW-15)) was collected from monitoring well MW-15. The sample was analyzed for chlorinated volatile organic compounds (CVOCs). The location of MW-15 is depicted on the attached **Figure 1**. The sample result is summarized in **Table 1**. An

Document: 6143-0426
Environmental Forensic Investigations, Inc.
N16 W23390 Stone Ridge Drive, Suite G, Waukesha, WI 53188
Phone: 262-290-4001 • Fax 317-972-7875

excerpt of the laboratory report that relates to the 6143-SG-5 (MW-15) soil gas sample is also attached.

As listed on **Table 1**, sample 6143-SG-5 (MW-15) contained PCE at a concentration of 661 micrograms per cubic meter ($\mu\text{g}/\text{m}^3$). The concentration of PCE in 6143-SG-5 (MW-15) does not exceed the the WDNR Vapor Risk Screening Level of 180,000 $\mu\text{g}/\text{m}^3$. No other compounds were detected in the soil gas sample.

At this time, there does not appear to be vapor intrusion issue on your property. We will contact you to discuss additional investigation work, if any. If you have any questions or concerns, please contact me at 414-982-3988 or by email at wfassbender@enviroforensics.com. The WDNR project manager, Dave Volkert, can be reached at 262-547-2166. We greatly appreciate your help and patience with this matter.

Sincerely,

Environmental Forensic Investigations, Inc.

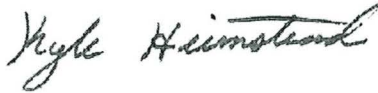
A handwritten signature in cursive script that reads "Kyle Heimstead".

Kyle Heimstead
Staff Geologist

A handwritten signature in cursive script that reads "Wayne P. Fassbender".

Wayne Fassbender, PG, PMP
Senior Project Manager

Attachments: Figure 1 - Monitoring Well Location Map
Table 1 – Summary of Groundwater Analytical Results
Laboratory Analytical Report Excerpt

Copy: Dave Volkert, Wisconsin Department of Natural Resources
Ted Warpinski, Friebert, Finerty & St. John, S.C.

WISCONSIN AVENUE

Grass

Grass

Parking
(Concrete)

Grass

MW-15

Legend

--- Property boundary

MW-15 Monitoring well sample location

NAPA

Parking
(Concrete)

Former Dry
Cleaner

Pick-N-Save
Grocery Store

Ewald Kia

PLANK ROAD

Retention Pond



100 0 25 50 75 100

APPROXIMATE SCALE: 1" = 100'

MONITORING WELL LOCATION MAP

Martinizing Dry Cleaning
36929 Plank Road
Oconomowoc, WI

Date:	5/1/15
Designed:	EB
Drawn:	EB
Checked:	KH
DWG file:	6143-0135



ENVIRONMENTAL FORENSIC INVESTIGATIONS, INC.
602 N. Capitol Ave., Ste. 210 • Indianapolis, IN 46204
EnviroForensics.com

Figure

1

Project

6143

Table 1
Summary of Soil Gas Analytical Results
 NAPA Auto Parts Store Soil Gas
 Oconomowoc, Wisconsin

Soil Gas Well ID	Sample Date	Tetrachloroethene	Trichloroethene	cis-1,2-Dichloroethene	trans-1,2-Dichloroethene	Vinyl chloride
Deep Vapor Risk Screening Level ¹		180,000	8,800	NE	260,000	28,000
6143-SG-5 (MW-15)	9/15/2015	661	<10.7	<198	<396	<12.8

ug/m³

Notes:

¹ The Vapor Risk Screening Levels are based on U.S. E.P.A.'s Regional Screening Levels (RSL's) for non-residential indoor air with an attenuation factor of 0.001 for soil gas deeper than 5 feet below the foundation of a large commercial buildings and a 0.1 adjustment for 1 x 10⁻⁵ lifetime cancer risk for carcinogens.

² The Vapor Risk Screening Levels are based on U.S. E.P.A.'s Regional Screening Levels (RSL's) for non-residential indoor
Bolded values are above detection limits

NE = Not Established



EnvisionAir
1441 Sadler Circle West Drive
Indianapolis, IN 46239
Ph: 317-351-0885
Fax: 317-351-0882
www.envision-air.com

Mr. Wayne Fassbender
Enviroforensics
N16 W. 23390 Stone Ridge Dr
Suite G
Waukesha, WI 53188

September 29, 2015

ENVision Project Number: 2015-538
Client Project Name: 6143 – OHM-Oconomowoc

Dear Mr. Fassbender,

Please find the attached analytical report for the samples received September 17, 2015. All test methods performed were fully compliant with local, state, and federal EPA methods unless otherwise noted. The project was analyzed as requested on the enclosed chain of custody record. Please review the comments section for additional information about your results or Quality Control data.

Feel free to contact me if you have any questions or comments regarding your analytical report or service.

Thank you for your business. EnvisionAir looks forward to working with you on your next project.

Yours Sincerely,

A handwritten signature in black ink that reads "David Norris".

David Norris

Client Services Manager
EnvisionAir



EnvisionAir
1441 Sadler Circle West Drive
Indianapolis, IN 46239
Ph: 317-351-0885
Fax: 317-351-0882
www.envision-air.com

Client Name: ENVIROFORENSICS
Project ID: 6143 - OHM-OCONOMOWOC
Client Project Manager: W. FASSBENDER
EnvisionAir Project Number: 2015-538

Sample Summary

Canister Pressure / Vacuum

<u>Laboratory Sample Number:</u>	<u>Sample Description:</u>	<u>START</u> <u>Date</u>	<u>START</u> <u>Time</u>	<u>End Date</u>	<u>End Time</u>	<u>Date</u>	<u>Time</u>	<u>Initial Field</u>	<u>Final Field</u>	<u>Lab</u> <u>Received</u>	
		<u>Collected:</u>	<u>Collected:</u>	<u>Collected:</u>	<u>Collected:</u>	<u>Received:</u>	<u>Received</u>	<u>(in. Hg)</u>	<u>(in. Hg)</u>	<u>(in. Hg)</u>	
15-1972	6143-SG-5 (MW-15)	A	9/15/15	13:10	9/15/15	13:17	9/17/15	9:15	-29	-2	-2



EnvisionAir
1441 Sadlier Circle West Drive
Indianapolis, IN 46239
Ph: 317-351-0885
Fax: 317-351-0882
www.envision-air.com

Client Name: ENVIROFORENSICS
Project ID: 6143 - OHM-OCONOMOWOC
Client Project Manager: W. FASSBENDER
EnvisionAir Project Number: 2015-538

Analytical Method: TO-15
Analytical Batch: 092515AIR

Client Sample ID: 6143-SG-5 (MW-15)

Sample Collection START Date/Time: 9/15/15 13:10
Sample Collection END Date/Time: 9/15/15 13:17
Sample Received Date/Time: 9/17/15 9:15

Envision Sample Number: 15-1972
Sample Matrix: AIR

<u>Compounds</u>	<u>Sample Results ug/m³</u>	<u>Reporting Limit ug/m³</u>	<u>Flag</u>
cis-1,2-Dichloroethene	< 198	198	1
Tetrachloroethene	661	31.9	1
trans-1,2-Dichloroethene	< 396	396	1
Trichlorethene	< 10.7	10.7	1
Vinyl Chloride	< 12.8	12.8	1
4-bromofluorobenzene (surrogate)	108%		
Analysis Date/Time:	09-25-15/12:47		
Analyst Initials	tjg		



EnvisionAir
 1441 Sadlier Circle West Drive
 Indianapolis, IN 46239
 Ph: 317-351-0885
 Fax: 317-351-0882
 www.envision-air.com

Analytical Report

TO-15 Quality Control Data

EnvisionAir Batch Number: 092515AIR

<u>Method Blank (MB):</u>	<u>MB Results (ppbv)</u>	<u>Reporting Limit (ppbv)</u>	<u>Flags</u>
cis-1,2-Dichloroethene	< 5	5	
Tetrachloroethene	< 0.47	0.47	
trans-1,2-Dichloroethene	< 10	10	
Trichloroethene	< 0.2	0.2	
Vinyl Chloride	< 0.5	0.5	
4-bromofluorobenzene (surrogate)	111%		
Analysis Date/Time:	09-24-15/20:19		
Analyst Initials	tjg		

<u>LCS/LCSD</u>	<u>LCS Results (ppbv)</u>	<u>LCSD Results (ppbv)</u>	<u>LCS/D Conc(ppbv)</u>	<u>LCS Rec.</u>	<u>LCSD Rec.</u>	<u>RPD</u>	<u>Flag</u>
cis-1,2-Dichloroethene	9.71	8.52	10	97%	85%	13.1%	
Tetrachloroethene	8.91	8.14	10	89%	81%	9.0%	
trans-1,2-Dichloroethene	9.35	8.05	10	94%	81%	14.9%	
Trichloroethene	8.91	8.85	10	89%	89%	0.7%	
Vinyl Chloride	9.36	9.32	10	94%	93%	0.4%	
4-bromofluorobenzene (surrogate)	116%	109%					
Analysis Date/Time:	09-24-15/19:09	09-24-15/19:45					
Analyst Initials	tjg	tjg					



EnvisionAir
1441 Sadlier Circle West Drive
Indianapolis, IN 46239
Ph: 317-351-0885
Fax: 317-351-0882
www.envision-air.com

Flag Number

1

Comments

Reported value is from a 10x dilution. TJG 09-29-15



FID 268087380

Rec'd 10-13-15
DSV

October 9, 2015

Brian Ewald
Ewald KIA
36883 East Wisconsin Avenue
Oconomowoc, WI 53066

Subject: Environmental sampling results
36883 East Wisconsin Avenue
Oconomowoc, Wisconsin

Dear Mr. Ewald:

In accordance with the executed Agreement to Provide Access for Sampling Activities dated April 2, 2015, and in accordance with Wisconsin Department of Natural Resources (WDNR) regulation NR 716.14, Environmental Forensic Investigations, Inc. (EnviroForensics) is providing the results of the soil gas sample collected from your property located at 36883 East Wisconsin Avenue, Oconomowoc, Wisconsin. The soil gas sample was collected on September 15, 2015 from the groundwater monitoring well located on your property. The sampling activities are part of an environmental investigation being performed at the Former One Hour Martinizing (OHM) of Oconomowoc, located at 36929 Plank Road, Oconomowoc, Wisconsin at the direction of the WDNR pursuant to the authority granted to it under State and Federal law. The WDNR has assigned the following identification to this on-going investigation: BRRTS# 02-68-551911. The chemicals of concern for the investigation are the dry cleaning solvent tetrachloroethene (PCE) and its associated breakdown products.

The Responsible Party is:

Mr. Brian Cass
OHM Holdings, Inc.
W229 N2494 County Road F
Waukesha, WI 53186-1104
262-521-9710

Soil Gas Sampling Results

One (1) soil gas sample (6143-SG-4 (MW-17)) was collected from monitoring well MW-17. The sample was analyzed for chlorinated volatile organic compounds (CVOCs). The location of MW-17 is depicted on the attached **Figure 1**. The sample result is summarized in **Table 1**. An excerpt of the laboratory report that relates to the 6143-SG-4 (MW-17) soil gas sample is also attached.

Document: 6143-0435
Environmental Forensic Investigations, Inc.
N16 W23390 Stone Ridge Drive, Suite G, Waukesha, WI 53188
Phone: 262-290-4001 • Fax 317-972-7875

As listed on **Table 1**, sample 6143-SG-4 (MW-17) contained PCE at a concentration of 54.9 micrograms per cubic meter ($\mu\text{g}/\text{m}^3$). The concentration of PCE in 6143-SG-4 (MW-17) does not exceed the the WDNR Vapor Risk Screening Level of 180,000 $\mu\text{g}/\text{m}^3$ established for deep soil gas. No other compounds were detected in the soil gas sample.

At this time, there does not appear to be a risk of vapor intrusion to your building. We will contact you to discuss additional investigation work, if any. If you have any questions or concerns, please contact me at 414-982-3988 or by email at wfassbender@enviroforensics.com. The WDNR project manager, Dave Volkert, can be reached at 262-547-2166. We greatly appreciate your help and patience with this matter.

Sincerely,
Environmental Forensic Investigations, Inc.

Handwritten signature of Kyle Heimstead in cursive.

Kyle Heimstead
Staff Geologist

Handwritten signature of Wayne Fassbender in cursive.

Wayne Fassbender, PG, PMP
Senior Project Manager

Attachments: Figure 1 - Monitoring Well Location Map
Table 1 – Summary of Groundwater Analytical Results
Laboratory Analytical Report Excerpt

Copy: Dave Volkert, Wisconsin Department of Natural Resources
Ted Warpinski, Friebert, Finerty & St. John, S.C.



October 9, 2015

Brian Ewald
Ewald KIA
36883 East Wisconsin Avenue
Oconomowoc, WI 53066

Subject: Environmental sampling results
36883 East Wisconsin Avenue
Oconomowoc, Wisconsin

Dear Mr. Ewald:

In accordance with the executed Agreement to Provide Access for Sampling Activities dated April 2, 2015, and in accordance with Wisconsin Department of Natural Resources (WDNR) regulation NR 716.14, Environmental Forensic Investigations, Inc. (EnviroForensics) is providing the results of the soil gas sample collected from your property located at 36883 East Wisconsin Avenue, Oconomowoc, Wisconsin. The soil gas sample was collected on September 15, 2015 from the groundwater monitoring well located on your property. The sampling activities are part of an environmental investigation being performed at the Former One Hour Martinizing (OHM) of Oconomowoc, located at 36929 Plank Road, Oconomowoc, Wisconsin at the direction of the WDNR pursuant to the authority granted to it under State and Federal law. The WDNR has assigned the following identification to this on-going investigation: BRRTS# 02-68-551911. The chemicals of concern for the investigation are the dry cleaning solvent tetrachloroethene (PCE) and its associated breakdown products.

The Responsible Party is:

Mr. Brian Cass
OHM Holdings, Inc.
W229 N2494 County Road F
Waukesha, WI 53186-1104
262-521-9710

Soil Gas Sampling Results

One (1) soil gas sample (6143-SG-4 (MW-17)) was collected from monitoring well MW-17. The sample was analyzed for chlorinated volatile organic compounds (CVOCs). The location of MW-17 is depicted on the attached **Figure 1**. The sample result is summarized in **Table 1**. An excerpt of the laboratory report that relates to the 6143-SG-4 (MW-17) soil gas sample is also attached.

Document: 6143-0435
Environmental Forensic Investigations, Inc.
N16 W23390 Stone Ridge Drive, Suite G, Waukesha, WI 53188
Phone: 262-290-4001 • Fax 317-972-7875

As listed on **Table 1**, sample 6143-SG-4 (MW-17) contained PCE at a concentration of 54.9 micrograms per cubic meter ($\mu\text{g}/\text{m}^3$). The concentration of PCE in 6143-SG-4 (MW-17) does not exceed the the WDNR Vapor Risk Screening Level of 180,000 $\mu\text{g}/\text{m}^3$ established for deep soil gas. No other compounds were detected in the soil gas sample.

At this time, there does not appear to be a risk of vapor intrusion to your building. We will contact you to discuss additional investigation work, if any. If you have any questions or concerns, please contact me at 414-982-3988 or by email at wfassbender@enviroforensics.com. The WDNR project manager, Dave Volkert, can be reached at 262-547-2166. We greatly appreciate your help and patience with this matter.

Sincerely,
Environmental Forensic Investigations, Inc.

Handwritten signature of Kyle Heimstead in cursive.

Kyle Heimstead
Staff Geologist

Handwritten signature of Wayne Fassbender in cursive.

Wayne Fassbender, PG, PMP
Senior Project Manager

Attachments: Figure 1 - Monitoring Well Location Map
Table 1 – Summary of Groundwater Analytical Results
Laboratory Analytical Report Excerpt

Copy: Dave Volkert, Wisconsin Department of Natural Resources
Ted Warpinski, Friebert, Finerty & St. John, S.C.

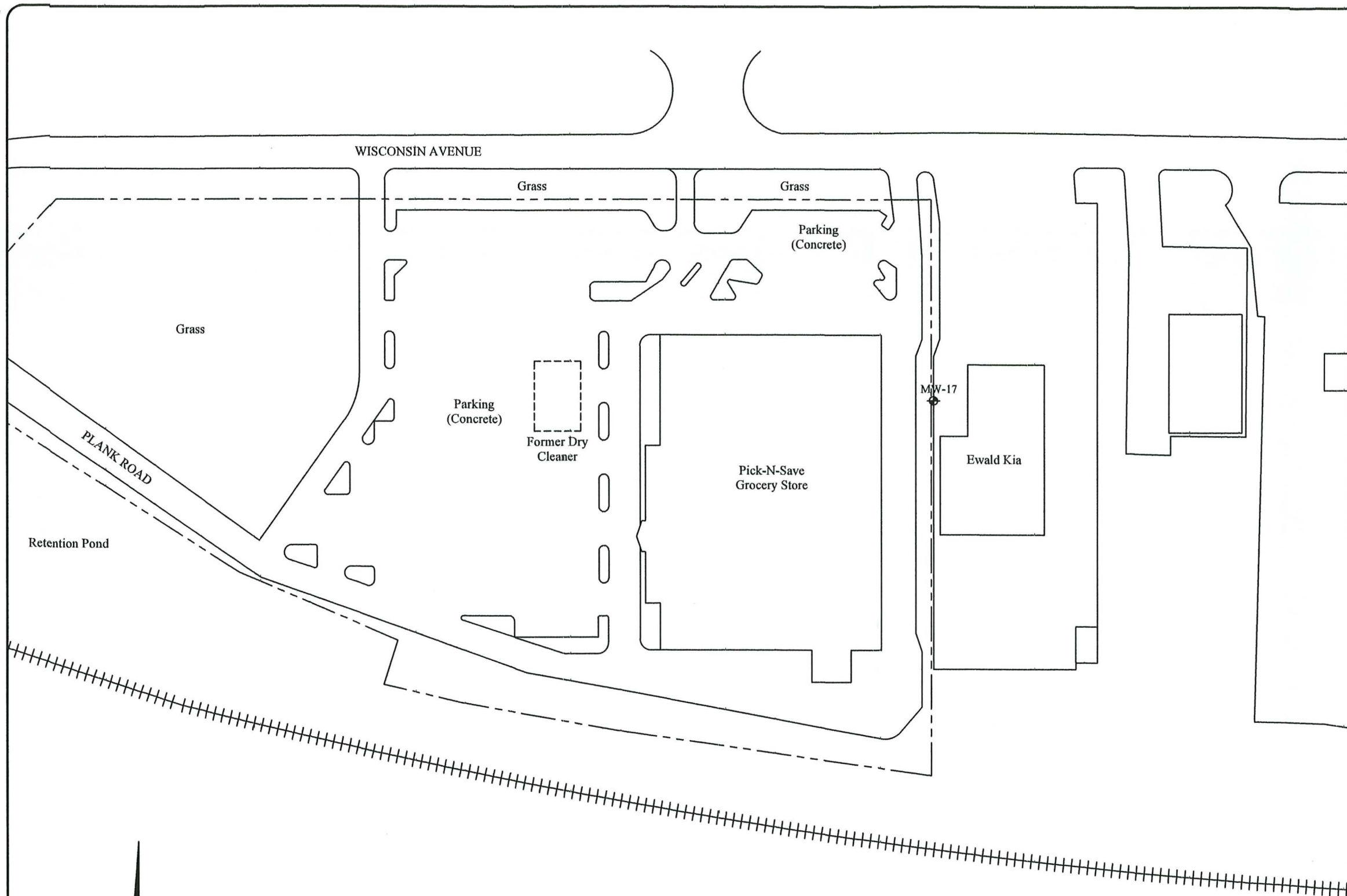

Legend

- Property boundary
- MW-17 ⊕ Monitoring well sample location

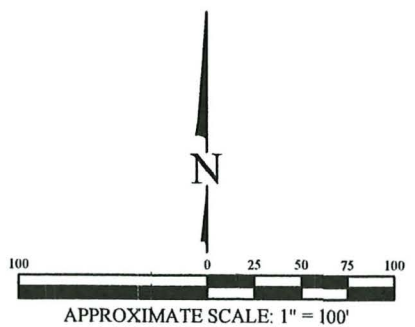

MONITORING WELL LOCATION MAP

Martinzing Dry Cleaning
36929 Plank Road
Oconomowoc, WI

Date: 5/1/15	Figure
Designed: EB	1
Drawn: EB	Project
Checked: KH	6143
DWG file: 6143-0135	

ENVIRONMENTAL FORENSIC INVESTIGATIONS, INC.
602 N. Capitol Ave., Ste. 210 • Indianapolis, IN 46204
EnviroForensics.com

Table 1
Summary of Soil Gas Analytical Results
 Ewald KIA Soil Gas
 Oconomowoc, Wisconsin

Soil Gas Well ID	Sample Date	Tetrachloroethene	Trichloroethene	cis-1,2-Dichloroethene	trans-1,2-Dichloroethene	Vinyl chloride
Deep Vapor Risk Screening Level ¹		180,000	8,800	NE	260,000	28,000
6143-SG-4 (MW-17)	9/15/2015	54.9	<10.7	<198	<396	<12.8

ug/m³

Notes:

¹ The Vapor Risk Screening Levels are based on U.S. E.P.A.'s Regional Screening Levels (RSL's) for non-residential indoor air with an attenuation factor of 0.001 for soil gas deeper than 5 feet below the foundation of a large commercial buildings and a 0.1 adjustment for 1 x 10⁻⁵ lifetime cancer risk for carcinogens.

All concentrations reported in units of micrograms per cubic meter (µg/m³)

Bolded values are above detection limits

NE = Not Established



EnvisionAir
1441 Sadlier Circle West Drive
Indianapolis, IN 46239
Ph: 317-351-0885
Fax: 317-351-0882
www.envision-air.com

Mr. Wayne Fassbender
Enviroforensics
N16 W. 23390 Stone Ridge Dr
Suite G
Waukesha, WI 53188

September 29, 2015

ENVision Project Number: 2015-537
Client Project Name: 6143 – OHM-Oconomowoc

Dear Mr. Fassbender,

Please find the attached analytical report for the samples received September 17, 2015. All test methods performed were fully compliant with local, state, and federal EPA methods unless otherwise noted. The project was analyzed as requested on the enclosed chain of custody record. Please review the comments section for additional information about your results or Quality Control data.

Feel free to contact me if you have any questions or comments regarding your analytical report or service.

Thank you for your business. EnvisionAir looks forward to working with you on your next project.

Yours Sincerely,

A handwritten signature in cursive script that reads "David Norris".

David Norris

Client Services Manager
EnvisionAir



EnvisionAir
1441 Sadler Circle West Drive
Indianapolis, IN 46239
Ph: 317-351-0885
Fax: 317-351-0882
www.envision-air.com

Client Name: ENVIROFORENSICS
Project ID: 6143 - OHM-OCONOMOWOC
Client Project Manager: W. FASSBENDER
EnvisionAir Project Number: 2015-537

Sample Summary

Canister Pressure / Vacuum

<u>Laboratory Sample Number:</u>	<u>Sample Description:</u>	<u>START</u> <u>Date</u>	<u>START</u> <u>Time</u>	<u>End Date</u>	<u>End Time</u>	<u>Date</u>	<u>Time</u>	<u>Initial Field</u>	<u>Final Field</u>	<u>Lab</u> <u>Received</u>	
		<u>Collected:</u>	<u>Collected:</u>	<u>Collected:</u>	<u>Collected:</u>	<u>Received:</u>	<u>Received</u>	<u>(in. Hg)</u>	<u>(in. Hg)</u>	<u>(in. Hg)</u>	
15-1971	6143-SG-4 (MW-17)	A	9/15/15	13:55	9/15/15	14:01	9/17/15	9:15	-29	-2	-2



EnvisionAir
1441 Sadlier Circle West Drive
Indianapolis, IN 46239
Ph: 317-351-0885
Fax: 317-351-0882
www.envision-air.com

Client Name: ENVIROFORENSICS
Project ID: 6143 - OHM-OCONOMOWOC
Client Project Manager: W. FASSBENDER
EnvisionAir Project Number: 2015-537

Analytical Method: TO-15
Analytical Batch: 092515AIR

Client Sample ID: 6143-SG-4 (MW-17)

Sample Collection START Date/Time: 9/15/15 15:55
Sample Collection END Date/Time: 9/15/15 14:01
Sample Received Date/Time: 9/17/15 9:15

Envision Sample Number: 15-1971
Sample Matrix: AIR

<u>Compounds</u>	<u>Sample Results ug/m³</u>	<u>Reporting Limit ug/m³</u>	<u>Flag</u>
cis-1,2-Dichloroethene	< 198	198	1
Tetrachloroethene	54.9	31.9	1
trans-1,2-Dichloroethene	< 396	396	1
Trichlorethene	< 10.7	10.7	1
Vinyl Chloride	< 12.8	12.8	1
4-bromofluorobenzene (surrogate)	107%		
Analysis Date/Time:	09-25-15/08:48		
Analyst Initials	tjg		



EnvisionAir
 1441 Sadlier Circle West Drive
 Indianapolis, IN 46239
 Ph: 317-351-0885
 Fax: 317-351-0882
 www.envision-air.com

Analytical Report

TO-15 Quality Control Data

EnvisionAir Batch Number: 092515AIR

<u>Method Blank (MB):</u>	<u>MB Results (ppbv)</u>	<u>Reporting Limit (ppbv)</u>	<u>Flags</u>
cis-1,2-Dichloroethene	< 5	5	
Tetrachloroethene	< 0.47	0.47	
trans-1,2-Dichloroethene	< 10	10	
Trichlorethene	< 0.2	0.2	
Vinyl Chloride	< 0.5	0.5	
4-bromofluorobenzene (surrogate)	111%		
Analysis Date/Time:	09-24-15/20:19		
Analyst Initials	tjg		

<u>LCS/LCSD</u>	<u>LCS Results (ppbv)</u>	<u>LCSD Results (ppbv)</u>	<u>LCS/D Conc(ppbv)</u>	<u>LCS Rec.</u>	<u>LCSD Rec.</u>	<u>RPD</u>	<u>Flag</u>
cis-1,2-Dichloroethene	9.71	8.52	10	97%	85%	13.1%	
Tetrachloroethene	8.91	8.14	10	89%	81%	9.0%	
trans-1,2-Dichloroethene	9.35	8.05	10	94%	81%	14.9%	
Trichlorethene	8.91	8.85	10	89%	89%	0.7%	
Vinyl Chloride	9.36	9.32	10	94%	93%	0.4%	
4-bromofluorobenzene (surrogate)	116%	109%					
Analysis Date/Time:	09-24-15/19:09	09-24-15/19:45					
Analyst Initials	tjg	tjg					



EnvisionAir
1441 Sadler Circle West Drive
Indianapolis, IN 46239
Ph: 317-351-0885
Fax: 317-351-0882
www.envision-air.com

Flag Number

1

Comments

Reported value is from a 10x dilution. TJG 09-29-15

CHAIN OF CUSTODY RECORD

NOTE

EnvisionAir | 1441 Sadler Circle West Drive | Indianapolis, IN 46239 | Phone: (317) 351-0885 | Fax: (317) 351-0882

Client: <u>Enviro Forensics</u>	P.O. Number: <u>2015835</u>
Report Address: <u>116 W23390 Star Ridge Dr Waukesha WI 53188</u>	Project Name or Number: <u>643</u> <u>OWM - Oronomance</u>
Report To: <u>V. Fassbender / K. Hunsstead</u>	Sampled by: <u>K. Hunsstead</u>
Phone: <u>317-972-7870</u>	QA/QC Required: (circle if applicable) Level III Level IV
Invoice Address:	Reporting Units needed: (circle) <u>ug/m³</u> mg/m ³ PPBV PPMV
Desired TAT: (Please Circle One) 1 day 2 days 3 days Std (5 bus. days)	Media type: 1LC = 1 Liter Canister 6LC = 6 Liter Canister TB = Tedlar Bag TD = Thermal Desorption Tube

REQUESTED PARAMETERS

TO-15 Full List

TO-15 Short List



Sampling Type:
Soil-Gas:
Sub-Slab:
Indoor-Air:

www.envision-air.com

Canister Pressure / Vacuum

Air Sample ID	Media Type <small>(see code above)</small>	Coll. Date <small>(Grab/Comp Start)</small>	Coll. Time <small>(Grab/Comp Start)</small>	Coll. Date <small>(Comp. End)</small>	Coll. Time <small>(Comp. End)</small>					Canister Serial #	Flow Controller Serial #	Initial Field (in. Hg)	Final Field (in. Hg)	Lab Received (in. Hg)	EnvisionAir Sample Number
643-SG-4 (15-17)	1LC	9-15-15	1355	9-15-15	1401					2255	-	-29	-2	-2	15-1971

Comments:

Relinquished by:	Date	Time	Received by:	Date	Time
<u>[Signature]</u>	9-16-15		<u>FEDEX</u> <u>Stanley A. Hunsstead</u>	9-16-15	
				9/17/15	0915