

268087380



Rec'd
11-30-15
DBV

November 24, 2015

Mr. Patrick McAdams
McAdams Realty Oconomowoc, LLP
110 South Regency Circle
Oconomowoc, WI 53066

Subject: Environmental sampling results
BRTTS #: 20-68-551911

Dear Mr. McAdams:

In accordance with the executed Agreement to Provide Access for Sampling Activities, and in accordance with Wisconsin Department of Natural Resources (WDNR) regulation NR 716.14, Environmental Forensic Investigations, Inc. (EnviroForensics) is providing the results of environmental samples collected from your property located at 36929 Plank Road, Oconomowoc, Wisconsin on November 4, 5 and 6, 2015. The sampling activities are part of an environmental investigation being performed for the former One Hour Martinizing facility previously located on your property at the direction of the WDNR pursuant to the authority granted to it under State and Federal law. The chemicals of concern for the investigation are the chlorinated dry cleaning solvent tetrachloroethene (PCE) and associated chlorinated compounds resulting from the natural breakdown in the subsurface of PCE including trichloroethene (TCE), dichloroethene (DCE), and vinyl chloride.

The Responsible Party is:

Mr. Brian Cass
OHM Holdings, Inc.
W229 N2494 Hwy F
Waukesha, WI 53186
Telephone: 262-521-9710

Sampling Results

Groundwater samples were collected from all monitoring wells depicted on the attached **Figure 1**. The sampling results are summarized and compared to public health standards on the attached **Table 1**, and the laboratory report that relates to the groundwater samples is also attached. As can be seen on the enclosed documentation, various chlorinated compounds were detected in several wells at concentrations exceeding either the

WDNR's Groundwater Preventative Action Limits (PALs) or Groundwater Enforcement Standards (ESs).

At this time, we do not have any further groundwater sampling activities scheduled. We will contact you to discuss additional investigation or remediation work, if any. If you have any questions or concerns, please contact me at 414-982-3988 or by email at wfassbender@enviroforensics.com. The WDNR project manager, Dave Volkert, can be reached at 262-574-2166. We greatly appreciate your help and patience with this matter.

Sincerely,

Environmental Forensic Investigations, Inc.

A handwritten signature in cursive script that reads "Kyle Heimstead".

Kyle Heimstead
Staff Geologist

A handwritten signature in cursive script that reads "Wayne P. Fassbender".

Wayne Fassbender, PG, PMP
Senior Project Manager

Attachments: Monitoring Well Location Map
Analytical Results Summary Table
Analytical Report for Groundwater Samples

Copy: Brian Cass, OHM Holdings, Inc.
Ted Warpinski, Friebert, Finerty, and St. John, S.C.
Dave Volkert, Wisconsin Department of Natural Resources

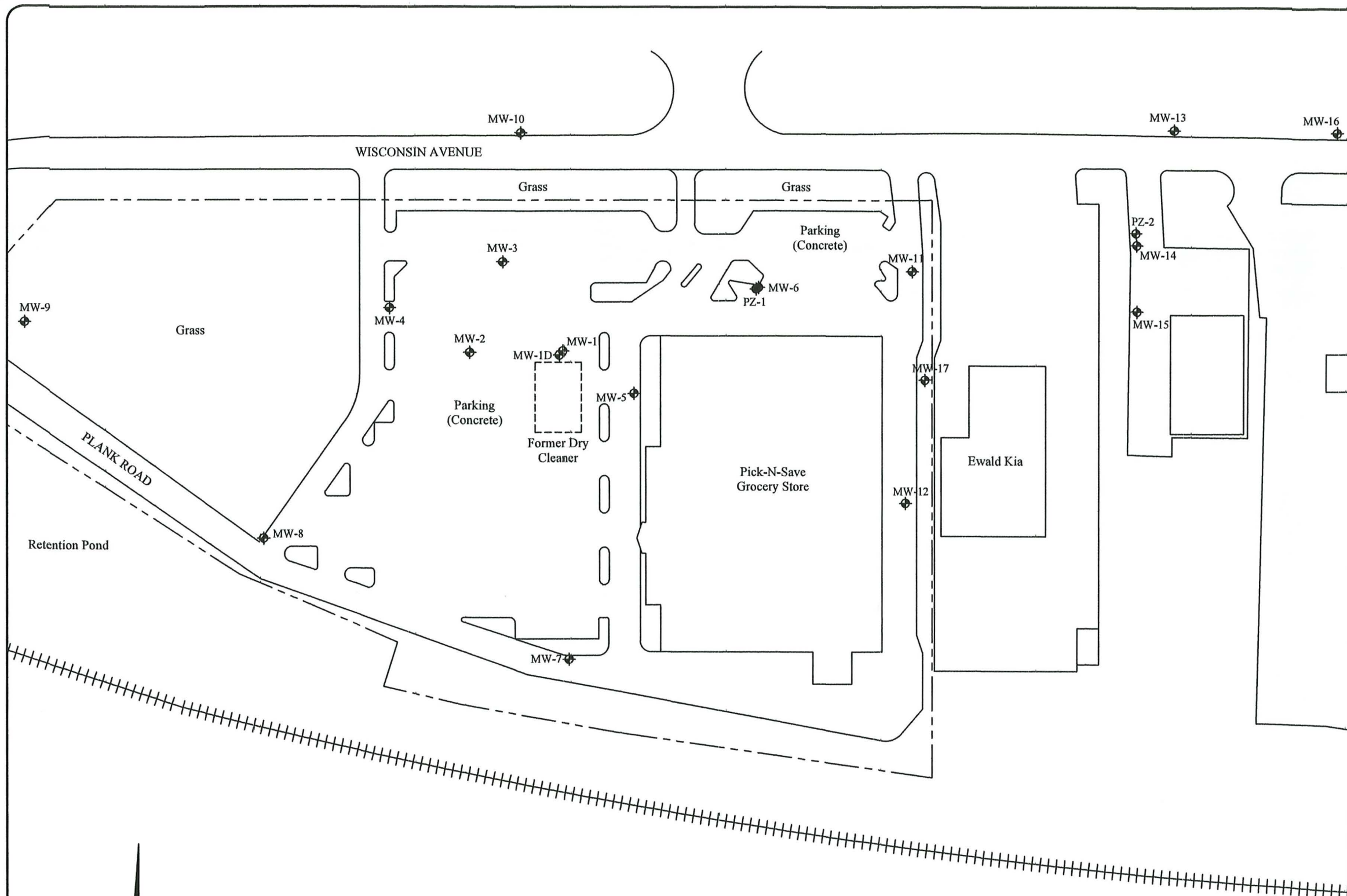

Legend

- Property boundary
- MW-1 Monitoring well sample location

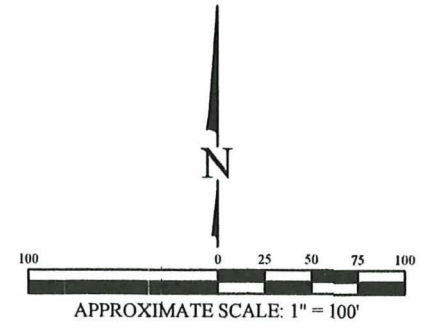

MONITORING WELL LOCATION MAP											
Martinizing Dry Cleaning 36929 Plank Road Oconomowoc, WI											
	Figure										
ENVIRONMENTAL FORENSIC INVESTIGATIONS, INC. <small>602 N. Capitol Ave., Ste. 210 • Indianapolis, IN 46204 EnviroForensics.com</small>	1										
<table border="1" style="width: 100%; border-collapse: collapse;"> <tr><td>Date:</td><td>5/1/15</td></tr> <tr><td>Designed:</td><td>EB</td></tr> <tr><td>Drawn:</td><td>EB</td></tr> <tr><td>Checked:</td><td>KH</td></tr> <tr><td>DWG file:</td><td>6143-0135</td></tr> </table>	Date:	5/1/15	Designed:	EB	Drawn:	EB	Checked:	KH	DWG file:	6143-0135	Project
Date:	5/1/15										
Designed:	EB										
Drawn:	EB										
Checked:	KH										
DWG file:	6143-0135										
	6143										

Table 4
Summary of Groundwater Analytical Results
Former One Hour Martinizing Cleaners
Oconomowoc, Wisconsin

Monitoring Well ID	Sample Date	Tetrachloroethene	Trichloroethene	cis-1,2-Dichloroethene	trans-1,2-Dichloroethene	Vinyl chloride	Naphthalene	Chloroform
Preventive Action Limit		0.5	0.5	7	20	0.02	10	0.6
Enforcement Standard		5	5	70	100	0.2	100	6
MW-1	05/08/09	210	0.66 J	< 0.96	< 0.96	< 0.26	< 0.26	<0.20
	08/28/09	357	1.9 J	< 4.2	< 4.4	< 0.90	< 0.90	<0.20
	12/03/09	154	< 0.96	< 0.96	< 0.96	< 0.26	< 0.26	<0.20
	03/10/10	229	1.0 J	< 0.96	< 0.96	< 0.26	< 0.26	<0.20
	06/02/10	140	< 0.96	< 0.96	< 0.96	< 0.26	< 0.26	<0.20
	09/17/10	442	< 2.4	< 4.2	< 4.4	< 0.90	< 0.90	<0.20
	01/07/11	420	2.4	<0.50	< .50	< 0.20	< 0.20	<0.20
	04/27/11	167	0.58 J	<0.83	<0.89	<0.18	<0.18	<0.18
	09/08/11	335	<1.9	<3.3	<3.6	<0.72	<0.72	<5.2
	12/19/11	170	0.78 J	<1.0	<1.0	<0.40	<1.3	<0.40
	02/28/12	120	0.46 J	<0.50	< .50	< 0.20	< 0.20	<0.20
	05/24/12	140	0.81	<0.12	<0.25	<0.10	<0.16	<0.20
	6/12/2013	120	0.69	<0.12	<0.25	<0.10	<0.16	<0.20
	10/2/2013	169	<3.3	<3.8	<3.5	<1.8	<17	<2.8
	1/3/2014	254	<3.3	<3.8	<3.5	<1.8	<17	<2.8
	3/6/2014	267	2.2 J	<1.9	<1.75	<0.9	<8.5	<1.4
	5/29/2014	109	<1.65	<1.9	<1.75	<0.9	<8.5	<1.4
	10/9/2014	280	2.63	<0.38	<0.35	<0.18	<1.7	<0.28
6/23/2015	78	<2.35	<2.25	<2.7	<0.85	NA	NA	
11/5/2015	82	0.53 J	<0.45	<0.54	<0.17	NA	NA	
MW-1D	08/28/09	7.9	< 0.48	< 0.83	< 0.89	< 0.18	< 0.18	<0.20
	12/03/09	14	< 0.48	< 0.83	< 0.89	< 0.18	< 0.18	<0.20
	03/10/10	3.2	< 0.48	< 0.83	< 0.89	< 0.18	< 0.18	<0.20
	06/02/10	4.2	< 0.48	< 0.83	< 0.89	< 0.18	< 0.18	<0.20
	09/17/10	8.9	< 0.48	< 0.83	< 0.89	< 0.18	< 0.18	<0.20
	01/07/11	2.7	< 0.20	< 0.50	< 0.50	< 0.20	< 0.20	<0.20
	04/27/11	2.9	<0.48	<0.83	<0.89	<0.18	<0.18	<0.18
	09/08/11	3.4	<0.48	<0.83	<0.89	<0.18	<0.18	<1.3
	12/19/11	2.0	2.0	<0.50	<0.50	<0.20	0.90 J	<0.20
	02/27/12	1.8 J	< 0.96	<0.50	<0.50	<0.20	< 0.20	<0.20
	05/22/12	2.5	<0.19	<0.12	<0.25	<0.10	<0.16	<0.20
	6/12/2013	4.4	<0.19	8.5	<0.25	<0.10	<0.16	<0.20
	10/2/2013	0.91 J	0.37 J	2.08	<0.35	<0.18	<1.7	<0.28
	1/3/2014	0.42 J	<0.33	3.8	<0.35	<0.18	<1.7	<0.28
	3/6/2014	6.0	1.87	11.3	<0.35	<0.18	<1.7	<0.28
	5/29/2014	1.37	0.46 J	0.66 J	<0.35	<0.18	<1.7	<0.28
	10/9/2014	0.77 J	<0.33	<0.38	<0.35	<0.18	<1.7	<0.28
	6/23/2015	2.33 J	<0.47	<0.45	<0.54	<0.17	NA	NA
11/5/2015	2.08	0.53 J	1.01 J	<0.54	<0.17	NA	NA	

Table 4
Summary of Groundwater Analytical Results
Former One Hour Martinizing Cleaners
Oconomowoc, Wisconsin

Monitoring Well ID	Sample Date	Tetrachloroethene	Trichloroethene	cis-1,2-Dichloroethene	trans-1,2-Dichloroethene	Vinyl chloride	Naphthalene	Chloroform
Preventive Action Limit		0.5	0.5	7	20	0.02	10	0.6
Enforcement Standard		5	5	70	100	0.2	100	6
MW-2	08/28/09	14.4	< 0.48	< 0.83	< 0.89	< 0.18	< 0.18	< 0.18
	12/03/09	31.1	< 0.48	< 0.83	< 0.89	< 0.18	< 0.18	< 0.18
	03/10/10	36.7	< 0.48	< 0.83	< 0.89	< 0.18	< 0.18	< 0.18
	06/02/10	24.2	< 0.48	< 0.83	< 0.89	< 0.18	< 0.18	< 0.18
	09/17/10	47.8	< 0.48	< 0.83	< 0.89	< 0.18	< 0.18	< 0.18
	01/07/11	41	< 0.20	< 0.50	< 0.50	< 0.20	< 0.20	< 0.20
	04/27/11	44.1	< 0.48	< 0.83	< 0.89	< 0.18	< 0.18	< 0.18
	09/08/11	41.7	< 0.48	< 0.83	< 0.89	< 0.18	< 0.18	< 1.3
	12/19/11	51	< 0.20	< 0.20	< 0.20	< 0.20	< 0.25	< 0.20
	02/27/12	45	< 0.20	< 0.20	< 0.20	< 0.20	< 0.25	< 0.20
	05/23/12	37	< 0.19	< 0.12	< 0.25	< 0.10	< 0.16	< 0.20
	6/12/2013	27	< 0.19	< 0.12	< 0.25	< 0.10	< 0.16	< 0.20
	10/2/2013	34	< 0.33	< 0.38	< 0.35	< 0.18	< 1.7	< 0.28
	1/3/2014	29.8	< 0.33	< 0.38	< 0.35	< 0.18	< 1.7	< 0.28
	3/6/2014	37.0	< 0.33	< 0.38	< 0.35	< 0.18	< 1.7	< 0.28
	5/29/2014	27.8	< 0.33	< 0.38	< 0.35	< 0.18	< 1.7	< 0.28
	10/9/2014	18.5	< 0.33	< 0.38	< 0.35	< 0.18	< 1.7	< 0.28
6/23/2015	16.9	< 0.47	< 0.45	< 0.54	< 0.17	NA	NA	
11/5/2015	23	< 0.47	< 0.45	< 0.54	< 0.17	NA	NA	
MW-3	08/28/09	49.5	0.68 J	< 0.83	< 0.89	< 0.18	< 0.18	< 0.18
	12/03/09	63.3	1.0	< 0.83	< 0.89	< 0.18	< 0.18	< 0.18
	03/10/10	51.6	0.93 J	< 0.83	< 0.89	< 0.18	< 0.18	< 0.18
	06/02/10	34.2	0.64 J	< 0.83	< 0.89	< 0.18	< 0.18	< 0.18
	09/17/10	96.3	3.6	< 0.83	< 0.89	< 0.18	< 0.18	< 0.18
	01/07/11	83	3.3	< 0.64	< 0.50	< 0.20	< 0.20	< 0.20
	04/27/11	72.9	2.7	< 0.83	< 0.89	< 0.18	< 0.18	< 0.20
	09/08/11	74.4	2.7	< 0.83	< 0.89	< 0.18	< 0.18	< 1.3
	12/19/11	66	1.2 J	< 0.50	< 0.50	< 0.20	< 0.25	< 0.20
	02/28/12	70	1.2 J	< 0.20	< 0.20	< 0.20	< 0.25	< 0.20
	05/23/12	57	1.3	< 0.12	< 0.25	< 0.10	< 0.16	< 0.20
	6/12/2013	52	2.2	< 0.12	< 0.25	< 0.10	< 0.16	< 0.20
	10/2/2013	65	3.5	< 0.38	< 0.35	< 0.18	< 1.7	< 0.28
	1/2/2014	55	1.88	< 0.38	< 0.35	< 0.18	< 1.7	< 0.28
	3/6/2014	68	2.07	< 0.38	< 0.35	< 0.18	< 1.7	< 0.28
	5/29/2014	56	2.22	< 0.38	< 0.35	< 0.18	< 1.7	< 0.28
	10/8/2014	58	1.78	< 0.38	< 0.35	< 0.18	< 1.7	< 0.28
6/23/2015	64	1.55	< 0.45	< 0.54	< 0.17	NA	NA	
11/4/2015	54	2.06	< 0.45	< 0.54	< 0.17	NA	NA	

Table 4
Summary of Groundwater Analytical Results
Former One Hour Martinizing Cleaners
Oconomowoc, Wisconsin

Monitoring Well ID	Sample Date	Tetrachloroethene	Trichloroethene	cis-1,2-Dichloroethene	trans-1,2-Dichloroethene	Vinyl chloride	Naphthalene	Chloroform
Preventive Action Limit		0.5	0.5	7	20	0.02	10	0.6
Enforcement Standard		5	5	70	100	0.2	100	6
MW-4	01/07/11	46	<0.20	< 0.50	< 0.50	< 0.20	< 0.20	<0.20
	04/27/11	69	<0.48	<0.83	<0.89	<0.18	<0.18	<0.20
	09/08/11	29	<0.48	<0.83	<0.89	<0.18	<0.18	<1.3
	12/19/11	23	<0.20	<0.50	<0.50	<0.20	<0.25	<0.20
	02/27/12	19	<0.20	<0.50	<0.50	<0.20	<0.25	<0.20
	05/23/12	35	<0.19	<0.12	<0.25	<0.10	<0.16	<0.20
	6/12/2013	30	<0.19	<0.12	<0.25	<0.10	<0.16	<0.20
	10/2/2013	53	<0.33	<0.38	<0.35	<0.18	<1.7	<0.28
	1/2/2014	19.5	<0.33	<0.38	<0.35	<0.18	<1.7	<0.28
	3/5/2014	32.0	<0.33	<0.38	<0.35	<0.18	<1.7	<0.28
	5/28/2014	13.3	<0.33	<0.38	<0.35	<0.18	<1.7	<0.28
	10/8/2014	12.7	<0.33	<0.38	<0.35	<0.18	<1.7	<0.28
MW-5	6/23/2015	14.8	<0.47	<0.45	<0.54	<0.17	NA	NA
	11/4/2015	11.8	<0.47	<0.54	<0.45	<0.54	NA	NA
	01/07/11	140	0.86	< 0.50	< 0.50	< 0.20	< 0.20	< 0.20
	04/27/11	133	0.77 J	<0.83	<0.89	<0.18	<0.18	<0.20
	09/08/11	121	<0.48	<0.83	<0.89	<0.18	<0.18	<1.3
	12/19/11	110	0.41 J	<0.50	<0.50	<0.20	<0.50	<0.20
	02/28/12	140	0.62 J	<0.50	<0.50	<0.20	<0.50	<0.20
	05/23/12	89	0.49 J	<0.12	<0.25	<0.10	<0.16	<0.20
	6/12/2013	98	0.58	<0.12	<0.25	<0.10	<0.16	<0.20
	10/2/2013	105	0.75 J	<0.38	<0.35	<0.18	<1.7	<0.28
	1/3/2014	160	1.34	<0.38	<0.35	<0.18	<1.7	<0.28
	3/6/2014	180	1.93	<0.38	<0.35	<0.18	<1.7	<0.28
5/29/2014	162	0.96 J	<0.38	<0.35	<0.18	<1.7	<0.28	
10/9/2014	116	1.23	<0.38	<0.35	<0.18	<1.7	<0.28	
6/23/2015	152	0.89 J	<0.45	<0.54	<0.17	NA	NA	
11/5/2015	158	<4.7	<4.5	<5.4	<1.7	NA	NA	

Table 4
Summary of Groundwater Analytical Results
Former One Hour Martinizing Cleaners
Oconomowoc, Wisconsin

Monitoring Well ID	Sample Date	Tetrachloroethene	Trichloroethene	cis-1,2-Dichloroethene	trans-1,2-Dichloroethene	Vinyl chloride	Naphthalene	Chloroform
Preventive Action Limit		0.5	0.5	7	20	0.02	10	0.6
Enforcement Standard		5	5	70	100	0.2	100	6
MW-6	01/07/11	41	0.38	< 0.50	< 0.50	< 0.20	< 0.20	< 0.20
	04/27/11	47.3	<0.48	<0.83	<0.89	<0.18	<0.18	<0.20
	09/08/11	39.2	<0.48	<0.83	<0.89	<0.18	<0.18	<1.3
	12/19/11	43	0.27 J	<0.50	<0.50	<0.20	<0.25	<0.20
	02/28/12	36	0.21 J	<0.50	<0.50	<0.20	<0.25	<0.20
	05/23/12	27	<0.19	<0.12	<0.25	<0.10	<0.16	<0.20
	6/11/2013	19	<0.19	<0.12	<0.25	<0.10	<0.16	<0.20
	10/1/2013	28.8	0.34 J	<0.38	<0.35	<0.18	<1.7	<0.28
	1/3/2014	36	0.71 J	<0.38	<0.35	0.21 J	<1.7	<0.28
	3/6/2014	33	<0.33	<0.38	<0.35	<0.18	<1.7	<0.28
	5/29/2014	40	0.51 J	<0.38	<0.35	<0.18	<1.7	<0.28
10/9/2014	34	0.37 J	<0.38	<0.35	<0.18	<1.7	<0.28	
6/23/2015	45	<0.47	<0.45	<0.54	<0.17	NA	NA	
11/5/2015	36	<0.47	<0.45	<0.54	<0.17	NA	NA	
MW-7	01/07/11	<0.50	<0.20	< 0.50	< 0.50	< 0.20	< 0.20	< 0.20
	04/27/11	<0.45	<0.48	<0.83	<0.89	<0.18	<0.18	<0.20
	09/08/11	<0.45	<0.48	<0.83	<0.89	<0.18	<0.18	<1.3
	12/19/11	<0.45	<0.48	<0.83	<0.89	<0.18	<0.18	0.47 J
	02/27/12	<0.45	<0.48	<0.83	<0.89	<0.18	<0.18	0.49 J
	05/22/12	<0.17	<0.19	<0.12	<0.25	<0.10	<0.16	<0.20
	6/11/2013	<0.17	<0.19	<0.12	<0.25	<0.10	<0.16	<0.20
	10/2/2013	<0.33	<0.33	<0.38	<0.35	<0.18	<1.7	<0.28
	1/3/2014	<0.33	<0.33	<0.38	<0.35	<0.18	<1.7	<0.28
	3/5/2014	<0.33	<0.33	<0.38	<0.35	<0.18	<1.7	<0.28
	5/28/2014	<0.33	<0.33	<0.38	<0.35	<0.18	<1.7	<0.28
	10/9/2014	<0.33	<0.33	<0.38	<0.35	<0.18	<1.7	<0.28
6/23/2015	<0.74	<0.47	<0.45	<0.54	<0.17	NA	NA	
11/5/2015	<0.49	<0.47	<0.45	<0.54	<0.17	NA	NA	
MW-8	6/11/2013	1.3	<0.19	<0.12	<0.25	<0.10	<0.16	<0.20
	10/1/2013	1.52	<0.33	<0.38	<0.35	<0.18	<1.7	<0.28
	1/2/2014	1.11	<0.33	<0.38	<0.35	<0.18	<1.7	<0.28
	3/5/2014	1.67	<0.33	<0.38	<0.35	<0.18	<1.7	<0.28
	5/28/2014	0.33 J	<0.33	<0.38	<0.35	<0.18	<1.7	<0.28
	10/9/2014	1.4	<0.33	<0.38	<0.35	<0.18	<1.7	<0.28
	6/23/2015	2.12 J	<0.47	<0.45	<0.54	<0.17	NA	NA
11/4/2015	2.5	<0.47	<0.45	<0.54	<0.17	NA	NA	

Table 4
Summary of Groundwater Analytical Results
Former One Hour Martinizing Cleaners
Oconomowoc, Wisconsin

Monitoring Well ID	Sample Date	Tetrachloroethene	Trichloroethene	cis-1,2-Dichloroethene	trans-1,2-Dichloroethene	Vinyl chloride	Naphthalene	Chloroform
Preventive Action Limit		0.5	0.5	7	20	0.02	10	0.6
Enforcement Standard		5	5	70	100	0.2	100	6
MW-9	6/11/2013	<0.17	<0.19	<0.12	<0.25	<0.10	<0.16	<0.20
	10/1/2013	<0.33	<0.33	<0.38	<0.35	<0.18	<1.7	<0.28
	1/2/2014	<0.33	<0.33	<0.38	<0.35	<0.18	<1.7	<0.28
	3/5/2014	<0.33	<0.33	<0.38	<0.35	<0.18	<1.7	<0.28
	5/28/2014	<0.33	<0.33	<0.38	<0.35	<0.18	<1.7	<0.28
	10/8/2014	<0.33	<0.33	<0.38	<0.35	<0.18	<1.7	<0.28
	6/22/2015	<0.74	<0.47	<0.45	<0.54	<0.17	NA	NA
11/4/2015	<0.49	<0.47	<0.45	<0.54	<0.17	NA	NA	
MW-10	6/11/2013	<0.17	<0.19	<0.12	<0.25	<0.10	<0.16	<0.20
	10/1/2013	<0.33	<0.33	<0.38	<0.35	<0.18	<1.7	<0.28
	1/2/2014	<0.33	<0.33	<0.38	<0.35	<0.18	<1.7	<0.28
	3/5/2014	<0.33	<0.33	<0.38	<0.35	<0.18	<1.7	<0.28
	5/28/2014	<0.33	<0.33	<0.38	<0.35	<0.18	<1.7	<0.28
	10/9/2014	<0.33	<0.33	<0.38	<0.35	<0.18	<1.7	<0.28
	6/23/2015	<0.74	<0.47	<0.45	<0.54	<0.17	NA	NA
11/4/2015	<0.49	<0.47	<0.45	<0.54	<0.17	NA	NA	
MW-11	6/11/2013	12	<0.19	<0.12	<0.25	<0.10	<0.16	<0.20
	10/1/2013	30.4	<0.33	<0.38	<0.35	<0.18	<1.7	<0.28
	1/3/2014	38	<0.33	<0.38	<0.35	<0.18	<1.7	<0.28
	3/5/2014	34	<0.33	<0.38	<0.35	<0.18	<1.7	<0.28
	5/29/2014	34	<0.33	<0.38	<0.35	<0.18	<1.7	<0.28
	10/8/2014	25	<0.33	<0.38	<0.35	<0.18	<1.7	<0.28
	6/22/2015	24	<0.47	<0.45	<0.54	<0.17	NA	NA
11/6/2015	12.6	<0.47	<0.45	<0.54	<0.17	NA	NA	

Table 4
Summary of Groundwater Analytical Results
 Former One Hour Martinizing Cleaners
 Oconomowoc, Wisconsin

Monitoring Well ID	Sample Date	Tetrachloroethene	Trichloroethene	cis-1,2-Dichloroethene	trans-1,2-Dichloroethene	Vinyl chloride	Naphthalene	Chloroform
Preventive Action Limit		0.5	0.5	7	20	0.02	10	0.6
Enforcement Standard		5	5	70	100	0.2	100	6
MW-12	6/11/2013	<0.17	<0.19	<0.12	<0.25	<0.10	<0.16	<0.20
	10/1/2013	<0.33	<0.33	<0.38	<0.35	<0.18	<1.7	<0.28
	1/3/2014	<0.33	<0.33	<0.38	<0.35	<0.18	<1.7	<0.28
	3/6/2014	<0.33	<0.33	<0.38	<0.35	<0.18	<1.7	<0.28
	5/28/2014	<0.33	<0.33	<0.38	<0.35	<0.18	<1.7	<0.28
	10/8/2014	<0.33	<0.33	<0.38	<0.35	<0.18	<1.7	<0.28
	6/22/2015	<0.74	<0.47	<0.45	<0.54	<0.17	NA	NA
11/5/2015	<0.49	<0.47	<0.45	<0.54	<0.17	NA	NA	
PZ-1	1/3/2014	8.9	<0.33	<0.38	<0.35	0.26 J	<1.7	<0.28
	3/6/2014	8.5	<0.33	<0.38	<0.35	<0.18	<1.7	<0.28
	5/29/2014	6.3	<0.33	<0.38	<0.35	<0.18	<1.7	<0.28
	10/9/2014	7.1	<0.33	<0.38	<0.35	<0.18	<1.7	<0.28
	4/15/2015	<0.74	<0.33	<0.38	<0.35	<0.18	<1.7	<0.28
	6/23/2015	10.6	<0.47	<0.45	<0.54	<0.17	NA	NA
	11/5/2015	9.8	<0.47	<0.45	<0.54	<0.17	NA	NA

Notes:

Samples analyzed using EPA SW-846 Method 8260

All concentrations reported in µg/L

Bolded and orange shaded values are above Public Health Enforcement Standards

Bolded and blue shaded values are above Public Health Preventive Action Limits

J=Analyte concentration detected between the laboratory Reporting Limit and the laboratory Method Detection Limit

NA = Not Analyzed

Table 1
Summary of Groundwater Analytical Results
Former One Hour Martinizing Cleaners
Oconomowoc, Wisconsin

Monitoring Well ID	Sample Date	Tetrachloroethene	Trichloroethene	cis-1,2-Dichloroethene	trans-1,2-Dichloroethene	Vinyl chloride
Preventive Action Limit		0.5	0.5	7	20	0.02
Enforcement Standard		5	5	70	100	0.2
MW-14	4/15/2015	10.50	<0.47	<0.45	<0.54	<0.17
	6/22/2015	12.6	<0.47	<0.45	<0.54	<0.17
	8/3/2015	6.7	<0.47	<0.45	<0.54	<0.17
	11/6/2015	12.2	<0.47	<0.45	<0.54	<0.17
MW-15	4/15/2015	2.97	<0.47	<0.45	<0.54	<0.17
	6/22/2015	10.7	<0.47	<0.45	<0.54	<0.17
	8/3/2015	3.2	<0.47	<0.45	<0.54	<0.17
	11/6/2015	8.2	<0.47	<0.45	<0.54	<0.17
MW-16	8/3/2015	2.99	<0.47	<0.45	<0.54	<0.17
	11/6/2015	4.6	<0.47	<0.45	<0.54	<0.17
MW-17	8/3/2015	8.4	<0.47	<0.45	<0.54	<0.17
	11/5/2015	11.1	<0.47	<0.45	<0.54	<0.17
PZ-2	4/15/2015	<0.74	<0.47	<0.45	<0.54	<0.17
	6/23/2015	<0.74	<0.47	<0.45	<0.54	<0.17
	8/3/2015	<0.74	<0.47	<0.45	<0.54	<0.17
	11/6/2015	<0.49	<0.47	<0.45	<0.54	<0.17

Notes:

Samples analyzed using EPA SW-846 Method 8260

All concentrations reported in µg/L

Bolded and orange shaded values are above Public Health Enforcement Standards

Bolded and blue shaded values are above Public Health Preventive Action Limits

Synergy Environmental Lab, INC.

1990 Prospect Ct., Appleton, WI 54914 *P 920-830-2455 * F 920-733-0631

WAYNE FASSBENDER
ENVIROFORENSICS
N16 W23390 STONE RIDGE DRIVE
WAUKESHA, WI 53188

Report Date 17-Nov-15

Project Name OHM-OCONOMOWOC
Project # 6143 PO#2015991

Invoice # E30024

Lab Code 5030024A
Sample ID 6143-MW-1
Sample Matrix Water
Sample Date 11/5/2015

	Result	Unit	LOD	LOQ	Dil	Method	Ext Date	Run Date	Analyst	Code
Organic										
VOC's										
cis-1,2-Dichloroethene	< 0.45	ug/l	0.45	1.4	1	8260B	11/12/2015	11/12/2015	CJR	1
trans-1,2-Dichloroethene	< 0.54	ug/l	0.54	1.7	1	8260B	11/12/2015	11/12/2015	CJR	1
Tetrachloroethene	82	ug/l	0.49	1.5	1	8260B	11/12/2015	11/12/2015	CJR	1
Trichloroethene (TCE)	0.53 "J"	ug/l	0.47	1.5	1	8260B	11/12/2015	11/12/2015	CJR	1
Vinyl Chloride	< 0.17	ug/l	0.17	0.54	1	8260B	11/12/2015	11/12/2015	CJR	1
SUR - Dibromofluoromethane	102	REC %			1	8260B	11/12/2015	11/12/2015	CJR	1
SUR - Toluene-d8	118	REC %			1	8260B	11/12/2015	11/12/2015	CJR	1
SUR - 4-Bromofluorobenzene	131	REC %			1	8260B	11/12/2015	11/12/2015	CJR	1
SUR - 1,2-Dichloroethane-d4	90	REC %			1	8260B	11/12/2015	11/12/2015	CJR	1

Lab Code 5030024B
Sample ID 6143-MW-1D
Sample Matrix Water
Sample Date 11/5/2015

	Result	Unit	LOD	LOQ	Dil	Method	Ext Date	Run Date	Analyst	Code
Organic										
VOC's										
cis-1,2-Dichloroethene	1.01 "J"	ug/l	0.45	1.4	1	8260B	11/12/2015	11/12/2015	CJR	1
trans-1,2-Dichloroethene	< 0.54	ug/l	0.54	1.7	1	8260B	11/12/2015	11/12/2015	CJR	1
Tetrachloroethene	2.08	ug/l	0.49	1.5	1	8260B	11/12/2015	11/12/2015	CJR	1
Trichloroethene (TCE)	0.53 "J"	ug/l	0.47	1.5	1	8260B	11/12/2015	11/12/2015	CJR	1
Vinyl Chloride	< 0.17	ug/l	0.17	0.54	1	8260B	11/12/2015	11/12/2015	CJR	1
SUR - Toluene-d8	117	REC %			1	8260B	11/12/2015	11/12/2015	CJR	1
SUR - Dibromofluoromethane	99	REC %			1	8260B	11/12/2015	11/12/2015	CJR	1
SUR - 1,2-Dichloroethane-d4	95	REC %			1	8260B	11/12/2015	11/12/2015	CJR	1
SUR - 4-Bromofluorobenzene	131	REC %			1	8260B	11/12/2015	11/12/2015	CJR	1

Project Name OHM-OCONOMOWOC
Project # 6143 PO#2015991

Invoice # E30024

Lab Code 5030024C
Sample ID 6143-MW-2
Sample Matrix Water
Sample Date 11/5/2015

	Result	Unit	LOD	LOQ	Dil	Method	Ext Date	Run Date	Analyst	Code
Organic										
VOC's										
cis-1,2-Dichloroethene	< 0.45	ug/l	0.45	1.4	1	8260B		11/12/2015	CJR	1
trans-1,2-Dichloroethene	< 0.54	ug/l	0.54	1.7	1	8260B		11/12/2015	CJR	1
Tetrachloroethene	23	ug/l	0.49	1.5	1	8260B		11/12/2015	CJR	1
Trichloroethene (TCE)	< 0.47	ug/l	0.47	1.5	1	8260B		11/12/2015	CJR	1
Vinyl Chloride	< 0.17	ug/l	0.17	0.54	1	8260B		11/12/2015	CJR	1
SUR - 1,2-Dichloroethane-d4	94	REC %			1	8260B		11/12/2015	CJR	1
SUR - 4-Bromofluorobenzene	127	REC %			1	8260B		11/12/2015	CJR	1
SUR - Dibromofluoromethane	100	REC %			1	8260B		11/12/2015	CJR	1
SUR - Toluene-d8	113	REC %			1	8260B		11/12/2015	CJR	1

Lab Code 5030024D
Sample ID 6143-MW-3
Sample Matrix Water
Sample Date 11/4/2015

	Result	Unit	LOD	LOQ	Dil	Method	Ext Date	Run Date	Analyst	Code
Organic										
VOC's										
cis-1,2-Dichloroethene	< 0.45	ug/l	0.45	1.4	1	8260B		11/12/2015	CJR	1
trans-1,2-Dichloroethene	< 0.54	ug/l	0.54	1.7	1	8260B		11/12/2015	CJR	1
Tetrachloroethene	54	ug/l	0.49	1.5	1	8260B		11/12/2015	CJR	1
Trichloroethene (TCE)	2.06	ug/l	0.47	1.5	1	8260B		11/12/2015	CJR	1
Vinyl Chloride	< 0.17	ug/l	0.17	0.54	1	8260B		11/12/2015	CJR	1
SUR - 1,2-Dichloroethane-d4	88	REC %			1	8260B		11/12/2015	CJR	1
SUR - 4-Bromofluorobenzene	139	REC %			1	8260B		11/12/2015	CJR	1
SUR - Dibromofluoromethane	100	REC %			1	8260B		11/12/2015	CJR	1
SUR - Toluene-d8	117	REC %			1	8260B		11/12/2015	CJR	1

Lab Code 5030024E
Sample ID 6143-MW-4
Sample Matrix Water
Sample Date 11/4/2015

	Result	Unit	LOD	LOQ	Dil	Method	Ext Date	Run Date	Analyst	Code
Organic										
VOC's										
cis-1,2-Dichloroethene	< 0.45	ug/l	0.45	1.4	1	8260B		11/12/2015	CJR	1
trans-1,2-Dichloroethene	< 0.54	ug/l	0.54	1.7	1	8260B		11/12/2015	CJR	1
Tetrachloroethene	11.8	ug/l	0.49	1.5	1	8260B		11/12/2015	CJR	1
Trichloroethene (TCE)	< 0.47	ug/l	0.47	1.5	1	8260B		11/12/2015	CJR	1
Vinyl Chloride	< 0.17	ug/l	0.17	0.54	1	8260B		11/12/2015	CJR	1
SUR - 1,2-Dichloroethane-d4	90	REC %			1	8260B		11/12/2015	CJR	1
SUR - Toluene-d8	118	REC %			1	8260B		11/12/2015	CJR	1
SUR - 4-Bromofluorobenzene	130	REC %			1	8260B		11/12/2015	CJR	1
SUR - Dibromofluoromethane	96	REC %			1	8260B		11/12/2015	CJR	1

Project Name OHM-OCONOMOWOC
Project # 6143 PO#2015991

Invoice # E30024

Lab Code 5030024F
Sample ID 6143-MW-5
Sample Matrix Water
Sample Date 11/5/2015

	Result	Unit	LOD	LOQ	Dil	Method	Ext Date	Run Date	Analyst	Code
Organic										
VOC's										
cis-1,2-Dichloroethene	< 4.5	ug/l	4.5	14	10	8260B		11/13/2015	CJR	1
trans-1,2-Dichloroethene	< 5.4	ug/l	5.4	17	10	8260B		11/13/2015	CJR	1
Tetrachloroethene	158	ug/l	4.9	15	10	8260B		11/13/2015	CJR	1
Trichloroethene (TCE)	< 4.7	ug/l	4.7	15	10	8260B		11/13/2015	CJR	1
Vinyl Chloride	< 1.7	ug/l	1.7	5.4	10	8260B		11/13/2015	CJR	1
SUR - 1,2-Dichloroethane-d4	95	REC %			10	8260B		11/13/2015	CJR	1
SUR - 4-Bromofluorobenzene	128	REC %			10	8260B		11/13/2015	CJR	1
SUR - Dibromofluoromethane	103	REC %			10	8260B		11/13/2015	CJR	1
SUR - Toluene-d8	121	REC %			10	8260B		11/13/2015	CJR	1

Lab Code 5030024G
Sample ID 6143-MW-6
Sample Matrix Water
Sample Date 11/5/2015

	Result	Unit	LOD	LOQ	Dil	Method	Ext Date	Run Date	Analyst	Code
Organic										
VOC's										
cis-1,2-Dichloroethene	< 0.45	ug/l	0.45	1.4	1	8260B		11/13/2015	CJR	1
trans-1,2-Dichloroethene	< 0.54	ug/l	0.54	1.7	1	8260B		11/13/2015	CJR	1
Tetrachloroethene	36	ug/l	0.49	1.5	1	8260B		11/13/2015	CJR	1
Trichloroethene (TCE)	< 0.47	ug/l	0.47	1.5	1	8260B		11/13/2015	CJR	1
Vinyl Chloride	< 0.17	ug/l	0.17	0.54	1	8260B		11/13/2015	CJR	1
SUR - 1,2-Dichloroethane-d4	93	REC %			1	8260B		11/13/2015	CJR	1
SUR - 4-Bromofluorobenzene	133	REC %			1	8260B		11/13/2015	CJR	1
SUR - Dibromofluoromethane	101	REC %			1	8260B		11/13/2015	CJR	1
SUR - Toluene-d8	117	REC %			1	8260B		11/13/2015	CJR	1

Lab Code 5030024H
Sample ID 6143-MW-7
Sample Matrix Water
Sample Date 11/5/2015

	Result	Unit	LOD	LOQ	Dil	Method	Ext Date	Run Date	Analyst	Code
Organic										
VOC's										
cis-1,2-Dichloroethene	< 0.45	ug/l	0.45	1.4	1	8260B		11/12/2015	CJR	1
trans-1,2-Dichloroethene	< 0.54	ug/l	0.54	1.7	1	8260B		11/12/2015	CJR	1
Tetrachloroethene	< 0.49	ug/l	0.49	1.5	1	8260B		11/12/2015	CJR	1
Trichloroethene (TCE)	< 0.47	ug/l	0.47	1.5	1	8260B		11/12/2015	CJR	1
Vinyl Chloride	< 0.17	ug/l	0.17	0.54	1	8260B		11/12/2015	CJR	1
SUR - 4-Bromofluorobenzene	126	REC %			1	8260B		11/12/2015	CJR	1
SUR - Dibromofluoromethane	102	REC %			1	8260B		11/12/2015	CJR	1
SUR - 1,2-Dichloroethane-d4	102	REC %			1	8260B		11/12/2015	CJR	1
SUR - Toluene-d8	115	REC %			1	8260B		11/12/2015	CJR	1

Project Name OHM-OCONOMOWOC
Project # 6143 PO#2015991

Invoice # E30024

Lab Code 5030024I
Sample ID 6143-MW-8
Sample Matrix Water
Sample Date 11/4/2015

	Result	Unit	LOD	LOQ	Dil	Method	Ext Date	Run Date	Analyst	Code
Organic										
VOC's										
cis-1,2-Dichloroethene	< 0.45	ug/l	0.45	1.4	1	8260B		11/12/2015	CJR	1
trans-1,2-Dichloroethene	< 0.54	ug/l	0.54	1.7	1	8260B		11/12/2015	CJR	1
Tetrachloroethene	2.47	ug/l	0.49	1.5	1	8260B		11/12/2015	CJR	1
Trichloroethene (TCE)	< 0.47	ug/l	0.47	1.5	1	8260B		11/12/2015	CJR	1
Vinyl Chloride	< 0.17	ug/l	0.17	0.54	1	8260B		11/12/2015	CJR	1
SUR - 1,2-Dichloroethane-d4	96	REC %			1	8260B		11/12/2015	CJR	1
SUR - 4-Bromofluorobenzene	131	REC %			1	8260B		11/12/2015	CJR	1
SUR - Dibromofluoromethane	98	REC %			1	8260B		11/12/2015	CJR	1
SUR - Toluene-d8	118	REC %			1	8260B		11/12/2015	CJR	1

Lab Code 5030024J
Sample ID 6143-MW-9
Sample Matrix Water
Sample Date 11/4/2015

	Result	Unit	LOD	LOQ	Dil	Method	Ext Date	Run Date	Analyst	Code
Organic										
VOC's										
cis-1,2-Dichloroethene	< 0.45	ug/l	0.45	1.4	1	8260B		11/12/2015	CJR	1
trans-1,2-Dichloroethene	< 0.54	ug/l	0.54	1.7	1	8260B		11/12/2015	CJR	1
Tetrachloroethene	< 0.49	ug/l	0.49	1.5	1	8260B		11/12/2015	CJR	1
Trichloroethene (TCE)	< 0.47	ug/l	0.47	1.5	1	8260B		11/12/2015	CJR	1
Vinyl Chloride	< 0.17	ug/l	0.17	0.54	1	8260B		11/12/2015	CJR	1
SUR - 1,2-Dichloroethane-d4	96	REC %			1	8260B		11/12/2015	CJR	1
SUR - 4-Bromofluorobenzene	129	REC %			1	8260B		11/12/2015	CJR	1
SUR - Dibromofluoromethane	103	REC %			1	8260B		11/12/2015	CJR	1
SUR - Toluene-d8	121	REC %			1	8260B		11/12/2015	CJR	1

Lab Code 5030024K
Sample ID 6143-MW-10
Sample Matrix Water
Sample Date 11/4/2015

	Result	Unit	LOD	LOQ	Dil	Method	Ext Date	Run Date	Analyst	Code
Organic										
VOC's										
cis-1,2-Dichloroethene	< 0.45	ug/l	0.45	1.4	1	8260B		11/12/2015	CJR	1
trans-1,2-Dichloroethene	< 0.54	ug/l	0.54	1.7	1	8260B		11/12/2015	CJR	1
Tetrachloroethene	< 0.49	ug/l	0.49	1.5	1	8260B		11/12/2015	CJR	1
Trichloroethene (TCE)	< 0.47	ug/l	0.47	1.5	1	8260B		11/12/2015	CJR	1
Vinyl Chloride	< 0.17	ug/l	0.17	0.54	1	8260B		11/12/2015	CJR	1
SUR - Dibromofluoromethane	97	REC %			1	8260B		11/12/2015	CJR	1
SUR - Toluene-d8	120	REC %			1	8260B		11/12/2015	CJR	1
SUR - 4-Bromofluorobenzene	129	REC %			1	8260B		11/12/2015	CJR	1
SUR - 1,2-Dichloroethane-d4	93	REC %			1	8260B		11/12/2015	CJR	1

Project Name OHM-OCONOMOWOC
Project # 6143 PO#2015991

Invoice # E30024

Lab Code 5030024R
Sample ID 6143-MW-17
Sample Matrix Water
Sample Date 11/5/2015

	Result	Unit	LOD	LOQ	Dil	Method	Ext Date	Run Date	Analyst	Code
Organic										
VOC's										
cis-1,2-Dichloroethene	< 0.45	ug/l	0.45	1.4	1	8260B		11/13/2015	CJR	1
trans-1,2-Dichloroethene	< 0.54	ug/l	0.54	1.7	1	8260B		11/13/2015	CJR	1
Tetrachloroethene	11.1	ug/l	0.49	1.5	1	8260B		11/13/2015	CJR	1
Trichloroethene (TCE)	< 0.47	ug/l	0.47	1.5	1	8260B		11/13/2015	CJR	1
Vinyl Chloride	< 0.17	ug/l	0.17	0.54	1	8260B		11/13/2015	CJR	1
SUR - 1,2-Dichloroethane-d4	95	REC %			1	8260B		11/13/2015	CJR	1
SUR - 4-Bromofluorobenzene	119	REC %			1	8260B		11/13/2015	CJR	1
SUR - Dibromofluoromethane	100	REC %			1	8260B		11/13/2015	CJR	1
SUR - Toluene-d8	116	REC %			1	8260B		11/13/2015	CJR	1

Lab Code 5030024S
Sample ID 6143-PZ-1
Sample Matrix Water
Sample Date 11/5/2015

	Result	Unit	LOD	LOQ	Dil	Method	Ext Date	Run Date	Analyst	Code
Organic										
VOC's										
cis-1,2-Dichloroethene	< 0.45	ug/l	0.45	1.4	1	8260B		11/13/2015	CJR	1
trans-1,2-Dichloroethene	< 0.54	ug/l	0.54	1.7	1	8260B		11/13/2015	CJR	1
Tetrachloroethene	9.8	ug/l	0.49	1.5	1	8260B		11/13/2015	CJR	1
Trichloroethene (TCE)	< 0.47	ug/l	0.47	1.5	1	8260B		11/13/2015	CJR	1
Vinyl Chloride	< 0.17	ug/l	0.17	0.54	1	8260B		11/13/2015	CJR	1
SUR - 1,2-Dichloroethane-d4	97	REC %			1	8260B		11/13/2015	CJR	1
SUR - Toluene-d8	119	REC %			1	8260B		11/13/2015	CJR	1
SUR - Dibromofluoromethane	102	REC %			1	8260B		11/13/2015	CJR	1
SUR - 4-Bromofluorobenzene	126	REC %			1	8260B		11/13/2015	CJR	1

Lab Code 5030024T
Sample ID 6143-PZ-2
Sample Matrix Water
Sample Date 11/6/2015

	Result	Unit	LOD	LOQ	Dil	Method	Ext Date	Run Date	Analyst	Code
Organic										
VOC's										
cis-1,2-Dichloroethene	< 0.45	ug/l	0.45	1.4	1	8260B		11/13/2015	CJR	1
trans-1,2-Dichloroethene	< 0.54	ug/l	0.54	1.7	1	8260B		11/13/2015	CJR	1
Tetrachloroethene	< 0.49	ug/l	0.49	1.5	1	8260B		11/13/2015	CJR	1
Trichloroethene (TCE)	< 0.47	ug/l	0.47	1.5	1	8260B		11/13/2015	CJR	1
Vinyl Chloride	< 0.17	ug/l	0.17	0.54	1	8260B		11/13/2015	CJR	1
SUR - 1,2-Dichloroethane-d4	103	REC %			1	8260B		11/13/2015	CJR	1
SUR - 4-Bromofluorobenzene	118	REC %			1	8260B		11/13/2015	CJR	1
SUR - Dibromofluoromethane	101	REC %			1	8260B		11/13/2015	CJR	1
SUR - Toluene-d8	118	REC %			1	8260B		11/13/2015	CJR	1



November 24, 2015

Terry Schuetz
Napa Auto Parts
1603 Manhattan Drive
Waukesha, WI 53186

Subject: Environmental sampling results
36863 East Wisconsin Avenue
Oconomowoc, Wisconsin

Dear Mr. Schuetz:

In accordance with the executed Access Agreement dated February 10, 2015, Environmental Forensic Investigations, Inc. (EnviroForensics) is providing the results of groundwater samples collected from your property located at 36863 East Wisconsin Avenue, Oconomowoc, Wisconsin. The groundwater samples were collected on November 6, 2015 from the three (3) groundwater monitoring wells located on your property. The sampling activities are part of an environmental investigation being performed at the Former One Hour Martinizing (OHM) of Oconomowoc, located at 36929 Plank Road, Oconomowoc, Wisconsin at the direction of the Wisconsin Department of Natural Resources (WDNR) pursuant to the authority granted to it under State and Federal law. The WDNR has assigned the following identification to this ongoing investigation: BRRTS# 02-68-551911. The chemicals of concern for the investigation are the dry cleaning solvent tetrachloroethene (PCE) and its associated breakdown products.

The Responsible Party is:

Mr. Brian Cass
OHM Holdings, Inc.
W229 N2494 County Road F
Waukesha, WI 53186-1104
262-521-9710

Groundwater Sampling Results

Three (3) groundwater samples (6143-MW-14, 6143-MW-15, 6143-PZ-2) were collected from monitoring wells MW-14, MW-15 and PZ-2, respectively. The samples were analyzed for chlorinated volatile organic compounds (CVOCs). The location of MW-14, MW-15 and PZ-2 are depicted on the attached **Figure 1**. The sample results are summarized in **Table 1**. An excerpt of the laboratory report that relates to the MW-14, MW-15 and PZ-2 groundwater samples is also attached.

Document: 6143-0445
Environmental Forensic Investigations, Inc.
N16 W23390 Stone Ridge Drive, Suite G, Waukesha, WI 53188
Phone: 262-290-4001 • Fax 317-972-7875

As listed on **Table 1**, samples MW-14 and MW-15 contained PCE at concentration of 12.2 micrograms per liter ($\mu\text{g/L}$) and 8.2 $\mu\text{g/L}$, respectively. The concentrations of PCE in MW-14 and MW-15 exceed the WDNR Groundwater Enforcement Standard (ES) of 5 $\mu\text{g/L}$. All chemicals of concern were below detection limits in PZ-2. No other compounds were detected in the groundwater samples.

We will contact you to discuss additional investigation work, if any. If you have any questions or concerns, please contact me at 414-982-3988 or by email at wfassbender@enviroforensics.com. The WDNR project manager, Dave Volkert, can be reached at 262-547-2166. We greatly appreciate your help and patience with this matter.

Sincerely,

Environmental Forensic Investigations, Inc.

Handwritten signature of Kyle Heimstead in cursive.

Kyle Heimstead
Staff Geologist

Handwritten signature of Wayne Fassbender in cursive.

Wayne Fassbender, PG, PMP
Senior Project Manager

Attachments: Figure 1 - Monitoring Well Location Map
Table 1 – Summary of Groundwater Analytical Results
Laboratory Analytical Report Excerpt

Copy: Dave Volkert, Wisconsin Department of Natural Resources
Ted Warpinski, Friebert, Finerty & St. John, S.C.

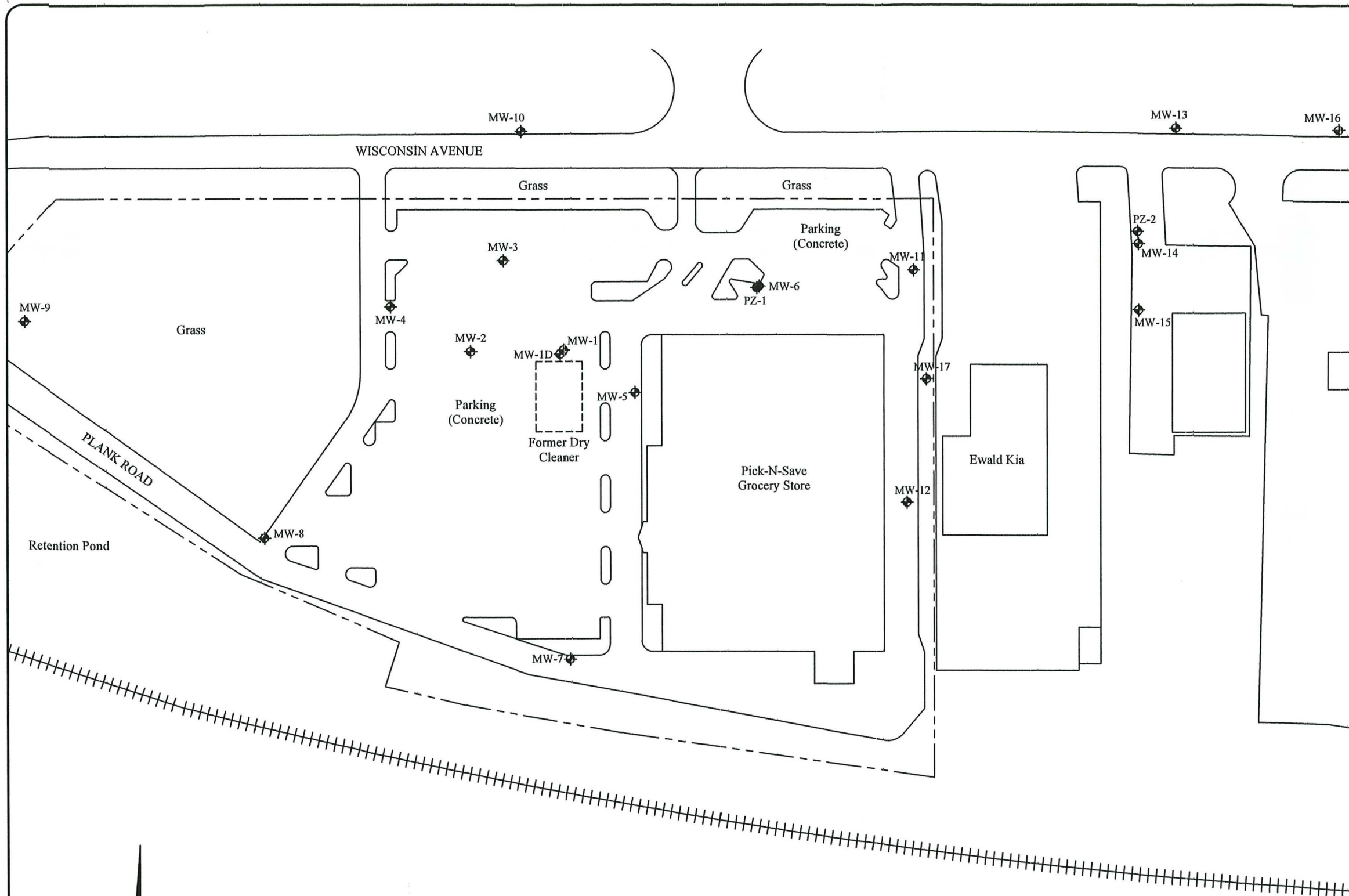

Legend

- Property boundary
- MW-1 ◆ Monitoring well sample location

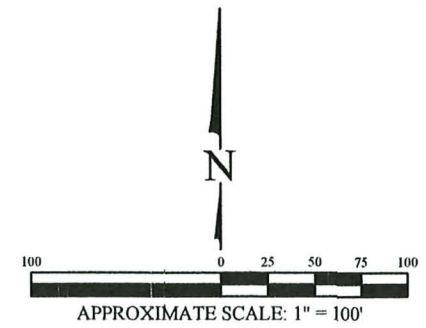

MONITORING WELL LOCATION MAP											
Martinizing Dry Cleaning 36929 Plank Road Oconomowoc, WI											
	Figure										
ENVIRONMENTAL FORENSIC INVESTIGATIONS, INC. 602 N. Capitol Ave., Ste. 210 • Indianapolis, IN 46204 EnviroForensics.com	1										
<table border="1" style="width: 100%; border-collapse: collapse;"> <tr><td>Date:</td><td>5/1/15</td></tr> <tr><td>Designed:</td><td>EB</td></tr> <tr><td>Drawn:</td><td>EB</td></tr> <tr><td>Checked:</td><td>KH</td></tr> <tr><td>DWG file:</td><td>6143-0135</td></tr> </table>	Date:	5/1/15	Designed:	EB	Drawn:	EB	Checked:	KH	DWG file:	6143-0135	Project
Date:	5/1/15										
Designed:	EB										
Drawn:	EB										
Checked:	KH										
DWG file:	6143-0135										
	6143										

Table 1
Summary of Groundwater Analytical Results
 NAPA Auto Parts Store Monitoring Wells
 Oconomowoc, Wisconsin

Monitoring Well ID	Sample Date	Tetrachloroethene	Trichloroethene	cis-1,2-Dichloroethene	trans-1,2-Dichloroethene	Vinyl chloride
Preventive Action Limit		0.5	0.5	7	20	0.02
Enforcement Standard		5	5	70	100	0.2
MW-14	4/15/2015	10.50	<0.47	<0.45	<0.54	<0.17
	6/22/2015	12.6	<0.47	<0.45	<0.54	<0.17
	8/3/2015	6.7	<0.47	<0.45	<0.54	<0.17
	11/6/2015	12.2	<0.47	<0.45	<0.54	<0.17
MW-15	4/15/2015	2.97	<0.47	<0.45	<0.54	<0.17
	6/22/2015	10.7	<0.47	<0.45	<0.54	<0.17
	8/3/2015	3.2	<0.47	<0.45	<0.54	<0.17
	11/6/2015	8.2	<0.47	<0.45	<0.54	<0.17
PZ-2	4/15/2015	<0.74	<0.47	<0.45	<0.54	<0.17
	6/23/2015	<0.74	<0.47	<0.45	<0.54	<0.17
	8/3/2015	<0.74	<0.47	<0.45	<0.54	<0.17
	11/6/2015	<0.49	<0.47	<0.45	<0.54	<0.17

Notes:

Samples analyzed using EPA SW-846 Method 8260

All concentrations reported in µg/L

Bolded and orange shaded values are above Public Health Enforcement Standards

Bolded and blue shaded values are above Public Health Preventive Action Limits

Project Name OHM-OCONOMOWOC
Project # 6143 PO#2015991

Invoice # E30024

Lab Code 5030024O
Sample ID 6143-MW-14
Sample Matrix Water
Sample Date 11/6/2015

	Result	Unit	LOD	LOQ	Dil	Method	Ext Date	Run Date	Analyst	Code
Organic										
VOC's										
cis-1,2-Dichloroethene	< 0.45	ug/l	0.45	1.4	1	8260B		11/13/2015	CJR	1
trans-1,2-Dichloroethene	< 0.54	ug/l	0.54	1.7	1	8260B		11/13/2015	CJR	1
Tetrachloroethene	12.2	ug/l	0.49	1.5	1	8260B		11/13/2015	CJR	1
Trichloroethene (TCE)	< 0.47	ug/l	0.47	1.5	1	8260B		11/13/2015	CJR	1
Vinyl Chloride	< 0.17	ug/l	0.17	0.54	1	8260B		11/13/2015	CJR	1
SUR - 1,2-Dichloroethane-d4	101	REC %			1	8260B		11/13/2015	CJR	1
SUR - 4-Bromofluorobenzene	123	REC %			1	8260B		11/13/2015	CJR	1
SUR - Dibromofluoromethane	100	REC %			1	8260B		11/13/2015	CJR	1
SUR - Toluene-d8	115	REC %			1	8260B		11/13/2015	CJR	1

Lab Code 5030024P
Sample ID 6143-MW-15
Sample Matrix Water
Sample Date 11/6/2015

	Result	Unit	LOD	LOQ	Dil	Method	Ext Date	Run Date	Analyst	Code
Organic										
VOC's										
cis-1,2-Dichloroethene	< 0.45	ug/l	0.45	1.4	1	8260B		11/13/2015	CJR	1
trans-1,2-Dichloroethene	< 0.54	ug/l	0.54	1.7	1	8260B		11/13/2015	CJR	1
Tetrachloroethene	8.2	ug/l	0.49	1.5	1	8260B		11/13/2015	CJR	1
Trichloroethene (TCE)	< 0.47	ug/l	0.47	1.5	1	8260B		11/13/2015	CJR	1
Vinyl Chloride	< 0.17	ug/l	0.17	0.54	1	8260B		11/13/2015	CJR	1
SUR - Toluene-d8	114	REC %			1	8260B		11/13/2015	CJR	1
SUR - Dibromofluoromethane	101	REC %			1	8260B		11/13/2015	CJR	1
SUR - 4-Bromofluorobenzene	118	REC %			1	8260B		11/13/2015	CJR	1
SUR - 1,2-Dichloroethane-d4	98	REC %			1	8260B		11/13/2015	CJR	1

Lab Code 5030024Q
Sample ID 6143-MW-16
Sample Matrix Water
Sample Date 11/6/2015

	Result	Unit	LOD	LOQ	Dil	Method	Ext Date	Run Date	Analyst	Code
Organic										
VOC's										
cis-1,2-Dichloroethene	< 0.45	ug/l	0.45	1.4	1	8260B		11/13/2015	CJR	1
trans-1,2-Dichloroethene	< 0.54	ug/l	0.54	1.7	1	8260B		11/13/2015	CJR	1
Tetrachloroethene	4.6	ug/l	0.49	1.5	1	8260B		11/13/2015	CJR	1
Trichloroethene (TCE)	< 0.47	ug/l	0.47	1.5	1	8260B		11/13/2015	CJR	1
Vinyl Chloride	< 0.17	ug/l	0.17	0.54	1	8260B		11/13/2015	CJR	1
SUR - 1,2-Dichloroethane-d4	93	REC %			1	8260B		11/13/2015	CJR	1
SUR - 4-Bromofluorobenzene	120	REC %			1	8260B		11/13/2015	CJR	1
SUR - Dibromofluoromethane	99	REC %			1	8260B		11/13/2015	CJR	1
SUR - Toluene-d8	114	REC %			1	8260B		11/13/2015	CJR	1

Project Name OHM-OCONOMOWOC
Project # 6143 PO#2015991

Invoice # E30024

Lab Code 5030024R
Sample ID 6143-MW-17
Sample Matrix Water
Sample Date 11/5/2015

	Result	Unit	LOD	LOQ	Dil	Method	Ext Date	Run Date	Analyst	Code
Organic										
VOC's										
cis-1,2-Dichloroethene	< 0.45	ug/l	0.45	1.4	1	8260B		11/13/2015	CJR	1
trans-1,2-Dichloroethene	< 0.54	ug/l	0.54	1.7	1	8260B		11/13/2015	CJR	1
Tetrachloroethene	11.1	ug/l	0.49	1.5	1	8260B		11/13/2015	CJR	1
Trichloroethene (TCE)	< 0.47	ug/l	0.47	1.5	1	8260B		11/13/2015	CJR	1
Vinyl Chloride	< 0.17	ug/l	0.17	0.54	1	8260B		11/13/2015	CJR	1
SUR - 1,2-Dichloroethane-d4	95	REC %			1	8260B		11/13/2015	CJR	1
SUR - 4-Bromofluorobenzene	119	REC %			1	8260B		11/13/2015	CJR	1
SUR - Dibromofluoromethane	100	REC %			1	8260B		11/13/2015	CJR	1
SUR - Toluene-d8	116	REC %			1	8260B		11/13/2015	CJR	1

Lab Code 5030024S
Sample ID 6143-PZ-1
Sample Matrix Water
Sample Date 11/5/2015

	Result	Unit	LOD	LOQ	Dil	Method	Ext Date	Run Date	Analyst	Code
Organic										
VOC's										
cis-1,2-Dichloroethene	< 0.45	ug/l	0.45	1.4	1	8260B		11/13/2015	CJR	1
trans-1,2-Dichloroethene	< 0.54	ug/l	0.54	1.7	1	8260B		11/13/2015	CJR	1
Tetrachloroethene	9.8	ug/l	0.49	1.5	1	8260B		11/13/2015	CJR	1
Trichloroethene (TCE)	< 0.47	ug/l	0.47	1.5	1	8260B		11/13/2015	CJR	1
Vinyl Chloride	< 0.17	ug/l	0.17	0.54	1	8260B		11/13/2015	CJR	1
SUR - 1,2-Dichloroethane-d4	97	REC %			1	8260B		11/13/2015	CJR	1
SUR - Toluene-d8	119	REC %			1	8260B		11/13/2015	CJR	1
SUR - Dibromofluoromethane	102	REC %			1	8260B		11/13/2015	CJR	1
SUR - 4-Bromofluorobenzene	126	REC %			1	8260B		11/13/2015	CJR	1

Lab Code 5030024T
Sample ID 6143-PZ-2
Sample Matrix Water
Sample Date 11/6/2015

	Result	Unit	LOD	LOQ	Dil	Method	Ext Date	Run Date	Analyst	Code
Organic										
VOC's										
cis-1,2-Dichloroethene	< 0.45	ug/l	0.45	1.4	1	8260B		11/13/2015	CJR	1
trans-1,2-Dichloroethene	< 0.54	ug/l	0.54	1.7	1	8260B		11/13/2015	CJR	1
Tetrachloroethene	< 0.49	ug/l	0.49	1.5	1	8260B		11/13/2015	CJR	1
Trichloroethene (TCE)	< 0.47	ug/l	0.47	1.5	1	8260B		11/13/2015	CJR	1
Vinyl Chloride	< 0.17	ug/l	0.17	0.54	1	8260B		11/13/2015	CJR	1
SUR - 1,2-Dichloroethane-d4	103	REC %			1	8260B		11/13/2015	CJR	1
SUR - 4-Bromofluorobenzene	118	REC %			1	8260B		11/13/2015	CJR	1
SUR - Dibromofluoromethane	101	REC %			1	8260B		11/13/2015	CJR	1
SUR - Toluene-d8	118	REC %			1	8260B		11/13/2015	CJR	1

Project Name OHM-OCONOMOWOC
 Project # 6143 PO#2015991

Invoice # E30024

Lab Code 5030024X
 Sample ID 6143-EB-2
 Sample Matrix Water
 Sample Date

	Result	Unit	LOD	LOQ	Dil	Method	Ext Date	Run Date	Analyst	Code
Organic										
VOC's										
cis-1,2-Dichloroethene	< 0.45	ug/l	0.45	1.4	1	8260B		11/13/2015	CJR	1
trans-1,2-Dichloroethene	< 0.54	ug/l	0.54	1.7	1	8260B		11/13/2015	CJR	1
Tetrachloroethene	< 0.49	ug/l	0.49	1.5	1	8260B		11/13/2015	CJR	1
Trichloroethene (TCE)	< 0.47	ug/l	0.47	1.5	1	8260B		11/13/2015	CJR	1
Vinyl Chloride	< 0.17	ug/l	0.17	0.54	1	8260B		11/13/2015	CJR	1
SUR - 1,2-Dichloroethane-d4	91	REC %				8260B		11/13/2015	CJR	1
SUR - 4-Bromofluorobenzene	121	REC %				8260B		11/13/2015	CJR	1
SUR - Dibromofluoromethane	101	REC %				8260B		11/13/2015	CJR	1
SUR - Toluene-d8	114	REC %				8260B		11/13/2015	CJR	1

Lab Code 5030024Y
 Sample ID TRIP BLANK
 Sample Matrix Water
 Sample Date

	Result	Unit	LOD	LOQ	Dil	Method	Ext Date	Run Date	Analyst	Code
Organic										
VOC's										
cis-1,2-Dichloroethene	< 0.45	ug/l	0.45	1.4	1	8260B		11/13/2015	CJR	1
trans-1,2-Dichloroethene	< 0.54	ug/l	0.54	1.7	1	8260B		11/13/2015	CJR	1
Tetrachloroethene	< 0.49	ug/l	0.49	1.5	1	8260B		11/13/2015	CJR	1
Trichloroethene (TCE)	< 0.47	ug/l	0.47	1.5	1	8260B		11/13/2015	CJR	1
Vinyl Chloride	< 0.17	ug/l	0.17	0.54	1	8260B		11/13/2015	CJR	1
SUR - Toluene-d8	114	REC %				8260B		11/13/2015	CJR	1
SUR - 1,2-Dichloroethane-d4	98	REC %				8260B		11/13/2015	CJR	1
SUR - 4-Bromofluorobenzene	124	REC %				8260B		11/13/2015	CJR	1
SUR - Dibromofluoromethane	102	REC %				8260B		11/13/2015	CJR	1

"J" Flag: Analyte detected between LOD and LOQ

LOD Limit of Detection

LOQ Limit of Quantitation

Code **Comment**

1 Laboratory QC within limits.

All solid sample results reported on a dry weight basis unless otherwise indicated. All LOD's and LOQ's are adjusted for dilutions but not dry weight. Subcontracted results are denoted by SUB in the analyst field.

Authorized Signature

Project Name OHM-OCONOMOWOC
Project # 6143 PO#2015991

Invoice # E30024

Lab Code 5030024U
Sample ID 6143-DUP-1
Sample Matrix Water
Sample Date 11/5/2015

	Result	Unit	LOD	LOQ	Dil	Method	Ext Date	Run Date	Analyst	Code
Organic										
VOC's										
cis-1,2-Dichloroethene	< 0.45	ug/l	0.45	1.4	1	8260B		11/13/2015	CJR	1
trans-1,2-Dichloroethene	< 0.54	ug/l	0.54	1.7	1	8260B		11/13/2015	CJR	1
Tetrachloroethene	12.4	ug/l	0.49	1.5	1	8260B		11/13/2015	CJR	1
Trichloroethene (TCE)	< 0.47	ug/l	0.47	1.5	1	8260B		11/13/2015	CJR	1
Vinyl Chloride	< 0.17	ug/l	0.17	0.54	1	8260B		11/13/2015	CJR	1
SUR - 1,2-Dichloroethane-d4	94	REC %			1	8260B		11/13/2015	CJR	1
SUR - 4-Bromofluorobenzene	122	REC %			1	8260B		11/13/2015	CJR	1
SUR - Dibromofluoromethane	103	REC %			1	8260B		11/13/2015	CJR	1
SUR - Toluene-d8	113	REC %			1	8260B		11/13/2015	CJR	1

Lab Code 5030024V
Sample ID 6143-DUP-2
Sample Matrix Water
Sample Date 11/6/2015

	Result	Unit	LOD	LOQ	Dil	Method	Ext Date	Run Date	Analyst	Code
Organic										
VOC's										
cis-1,2-Dichloroethene	< 0.45	ug/l	0.45	1.4	1	8260B		11/13/2015	CJR	1
trans-1,2-Dichloroethene	< 0.54	ug/l	0.54	1.7	1	8260B		11/13/2015	CJR	1
Tetrachloroethene	12.1	ug/l	0.49	1.5	1	8260B		11/13/2015	CJR	1
Trichloroethene (TCE)	< 0.47	ug/l	0.47	1.5	1	8260B		11/13/2015	CJR	1
Vinyl Chloride	< 0.17	ug/l	0.17	0.54	1	8260B		11/13/2015	CJR	1
SUR - Dibromofluoromethane	102	REC %			1	8260B		11/13/2015	CJR	1
SUR - Toluene-d8	116	REC %			1	8260B		11/13/2015	CJR	1
SUR - 1,2-Dichloroethane-d4	99	REC %			1	8260B		11/13/2015	CJR	1
SUR - 4-Bromofluorobenzene	120	REC %			1	8260B		11/13/2015	CJR	1

Lab Code 5030024W
Sample ID 6143-EB-1
Sample Matrix Water
Sample Date

	Result	Unit	LOD	LOQ	Dil	Method	Ext Date	Run Date	Analyst	Code
Organic										
VOC's										
cis-1,2-Dichloroethene	< 0.45	ug/l	0.45	1.4	1	8260B		11/13/2015	CJR	1
trans-1,2-Dichloroethene	< 0.54	ug/l	0.54	1.7	1	8260B		11/13/2015	CJR	1
Tetrachloroethene	< 0.49	ug/l	0.49	1.5	1	8260B		11/13/2015	CJR	1
Trichloroethene (TCE)	< 0.47	ug/l	0.47	1.5	1	8260B		11/13/2015	CJR	1
Vinyl Chloride	< 0.17	ug/l	0.17	0.54	1	8260B		11/13/2015	CJR	1
SUR - 1,2-Dichloroethane-d4	96	REC %			1	8260B		11/13/2015	CJR	1
SUR - 4-Bromofluorobenzene	118	REC %			1	8260B		11/13/2015	CJR	1
SUR - Dibromofluoromethane	100	REC %			1	8260B		11/13/2015	CJR	1
SUR - Toluene-d8	114	REC %			1	8260B		11/13/2015	CJR	1



November 24, 2015

Brian Ewald
Ewald KIA
36883 East Wisconsin Avenue
Oconomowoc, WI 53066

Subject: Environmental sampling results
36883 East Wisconsin Avenue
Oconomowoc, Wisconsin

Dear Mr. Ewald:

In accordance with the executed Access Agreement dated April 2, 2015, Environmental Forensic Investigations, Inc. (EnviroForensics) is providing the result of the groundwater sample collected from your property located at 36883 East Wisconsin Avenue, Oconomowoc, Wisconsin. The groundwater sample was collected on November 5, 2015 from the groundwater monitoring well located on your property. The sampling activities are part of an environmental investigation being performed at the Former One Hour Martinizing (OHM) of Oconomowoc, located at 36929 Plank Road, Oconomowoc, Wisconsin at the direction of the Wisconsin Department of Natural Resources (WDNR) pursuant to the authority granted to it under State and Federal law. The WDNR has assigned the following identification to this on-going investigation: BRRTS# 02-68-551911. The chemicals of concern for the investigation are the dry cleaning solvent tetrachloroethene (PCE) and its associated breakdown products.

The Responsible Party is:

Mr. Brian Cass
OHM Holdings, Inc.
W229 N2494 County Road F
Waukesha, WI 53186-1104
262-521-9710

Groundwater Sampling Results

One (1) groundwater sample (6143-MW-17) was collected from monitoring well MW-17. The sample was analyzed for chlorinated volatile organic compounds (CVOCs). The location of MW-17 is depicted on the attached **Figure 1**. The sample result is summarized in **Table 1**. An excerpt of the laboratory report that relates to the MW-17 groundwater sample is also attached.

Document: 6143-0450
Environmental Forensic Investigations, Inc.
N16 W23390 Stone Ridge Drive, Suite G, Waukesha, WI 53188
Phone: 262-290-4001 • Fax 317-972-7875

As listed on **Table 1**, sample MW-17 contained PCE at a concentration of 11.1 micrograms per liter ($\mu\text{g/L}$). The concentration of PCE in MW-17 exceeds the the WDNR Groundwater Enforcement Standard (ES) of 5 $\mu\text{g/L}$. No other compounds were detected in the groundwater sample.

We will contact you to discuss additional investigation work, if any. If you have any questions or concerns, please contact me at 414-982-3988 or by email at wfassbender@enviroforensics.com. The WDNR project manager, Dave Volkert, can be reached at 262-547-2166. We greatly appreciate your help and patience with this matter.

Sincerely,
Environmental Forensic Investigations, Inc.

Handwritten signature of Kyle Heimstead in cursive.

Kyle Heimstead
Staff Geologist

Handwritten signature of Wayne Fassbender in cursive.

Wayne Fassbender, PG, PMP
Senior Project Manager

Attachments: Figure 1 - Monitoring Well Location Map
Table 1 – Summary of Groundwater Analytical Results
Laboratory Analytical Report Excerpt

Copy: Dave Volkert, Wisconsin Department of Natural Resources
Ted Warpinski, Friebert, Finerty & St. John, S.C.

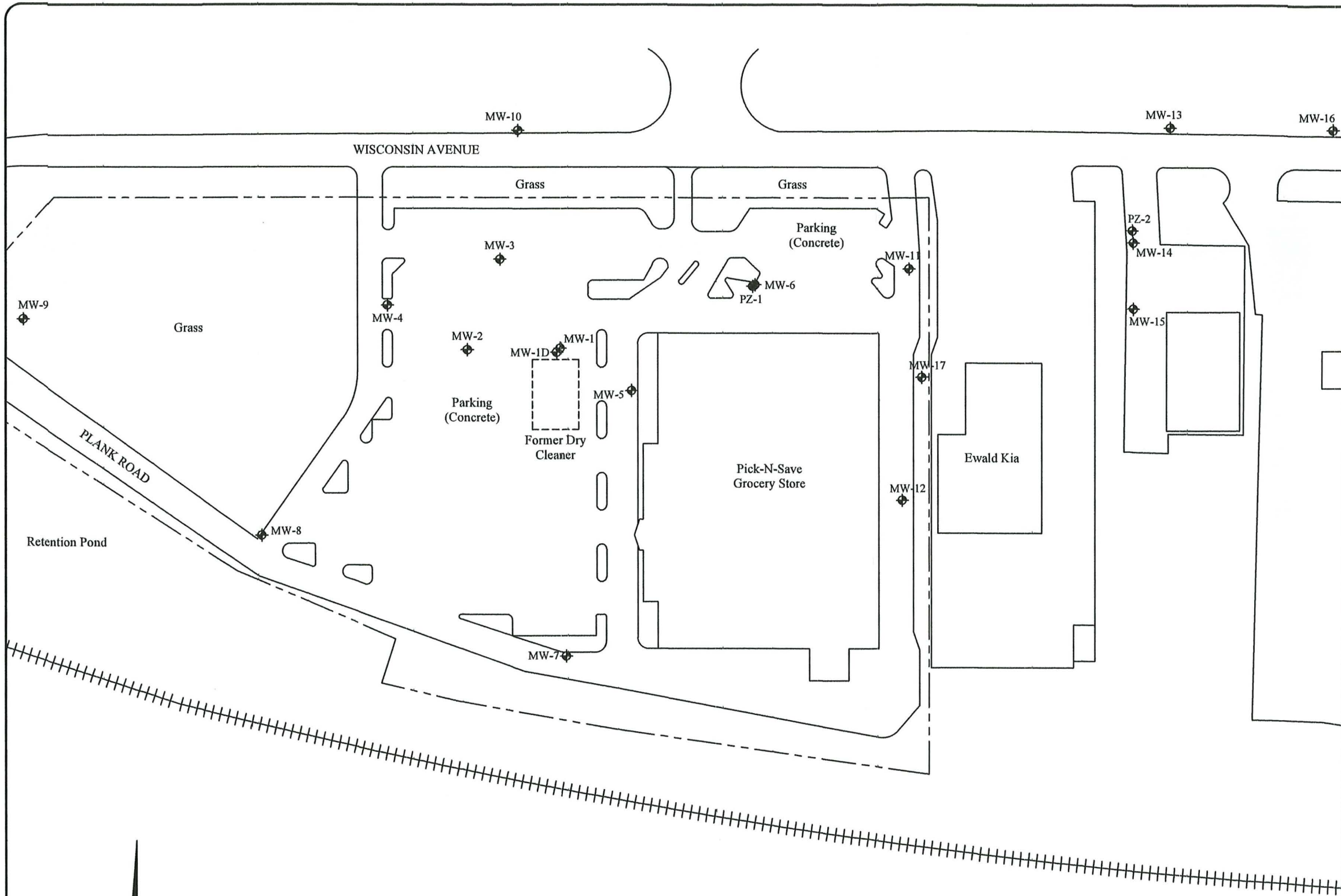

Legend

- Property boundary
- MW-1 Monitoring well sample location

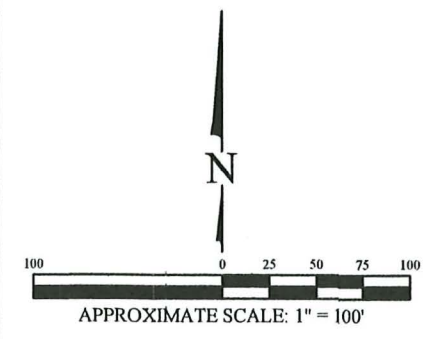

MONITORING WELL LOCATION MAP															
Martinizing Dry Cleaning 36929 Plank Road Oconomowoc, WI															
<table border="1" style="width: 100%; border-collapse: collapse;"> <tr><td>Date:</td><td>5/1/15</td></tr> <tr><td>Designed:</td><td>EB</td></tr> <tr><td>Drawn:</td><td>EB</td></tr> <tr><td>Checked:</td><td>KH</td></tr> <tr><td>DWG file:</td><td>6143-0135</td></tr> </table>	Date:	5/1/15	Designed:	EB	Drawn:	EB	Checked:	KH	DWG file:	6143-0135	<table border="1" style="width: 100%; border-collapse: collapse;"> <tr> <td style="text-align: center;"></td> <td style="text-align: center;">Figure 1</td> </tr> <tr> <td style="text-align: center;"> ENVIRONMENTAL FORENSIC INVESTIGATIONS, INC. 602 N. Capitol Ave., Ste. 210 • Indianapolis, IN 46204 EnviroForensics.com </td> <td style="text-align: center;">Project 6143</td> </tr> </table>		Figure 1	ENVIRONMENTAL FORENSIC INVESTIGATIONS, INC. 602 N. Capitol Ave., Ste. 210 • Indianapolis, IN 46204 EnviroForensics.com	Project 6143
Date:	5/1/15														
Designed:	EB														
Drawn:	EB														
Checked:	KH														
DWG file:	6143-0135														
	Figure 1														
ENVIRONMENTAL FORENSIC INVESTIGATIONS, INC. 602 N. Capitol Ave., Ste. 210 • Indianapolis, IN 46204 EnviroForensics.com	Project 6143														

Table 1
Summary of Groundwater Analytical Results
 Ewald KIA Monitoring Wells
 Oconomowoc, Wisconsin

Monitoring Well ID	Sample Date	Tetrachloroethene	Trichloroethene	cis-1,2-Dichloroethene	trans-1,2-Dichloroethene	Vinyl chloride
Preventive Action Limit		0.5	0.5	7	20	0.02
Enforcement Standard		5	5	70	100	0.2
MW-17	8/3/2015	8.4	<0.47	<0.45	<0.54	<0.17
	11/5/2015	11.1	<0.47	<0.45	<0.54	<0.17

Notes:

Samples analyzed using EPA SW-846 Method 8260

All concentrations reported in µg/L

Bolded and orange shaded values are above Public Health Enforcement Standards

Bolded and blue shaded values are above Public Health Preventive Action Limits

Project Name OHM-OCONOMOWOC
Project # 6143 PO#2015991

Invoice # E30024

Lab Code 5030024R
Sample ID 6143-MW-17
Sample Matrix Water
Sample Date 11/5/2015

	Result	Unit	LOD	LOQ	Dil	Method	Ext Date	Run Date	Analyst	Code
Organic										
VOC's										
cis-1,2-Dichloroethene	< 0.45	ug/l	0.45	1.4	1	8260B		11/13/2015	CJR	1
trans-1,2-Dichloroethene	< 0.54	ug/l	0.54	1.7	1	8260B		11/13/2015	CJR	1
Tetrachloroethene	11.1	ug/l	0.49	1.5	1	8260B		11/13/2015	CJR	1
Trichloroethene (TCE)	< 0.47	ug/l	0.47	1.5	1	8260B		11/13/2015	CJR	1
Vinyl Chloride	< 0.17	ug/l	0.17	0.54	1	8260B		11/13/2015	CJR	1
SUR - 1,2-Dichloroethane-d4	95	REC %			1	8260B		11/13/2015	CJR	1
SUR - 4-Bromofluorobenzene	119	REC %			1	8260B		11/13/2015	CJR	1
SUR - Dibromofluoromethane	100	REC %			1	8260B		11/13/2015	CJR	1
SUR - Toluene-d8	116	REC %			1	8260B		11/13/2015	CJR	1

Lab Code 5030024S
Sample ID 6143-PZ-1
Sample Matrix Water
Sample Date 11/5/2015

	Result	Unit	LOD	LOQ	Dil	Method	Ext Date	Run Date	Analyst	Code
Organic										
VOC's										
cis-1,2-Dichloroethene	< 0.45	ug/l	0.45	1.4	1	8260B		11/13/2015	CJR	1
trans-1,2-Dichloroethene	< 0.54	ug/l	0.54	1.7	1	8260B		11/13/2015	CJR	1
Tetrachloroethene	9.8	ug/l	0.49	1.5	1	8260B		11/13/2015	CJR	1
Trichloroethene (TCE)	< 0.47	ug/l	0.47	1.5	1	8260B		11/13/2015	CJR	1
Vinyl Chloride	< 0.17	ug/l	0.17	0.54	1	8260B		11/13/2015	CJR	1
SUR - 1,2-Dichloroethane-d4	97	REC %			1	8260B		11/13/2015	CJR	1
SUR - Toluene-d8	119	REC %			1	8260B		11/13/2015	CJR	1
SUR - Dibromofluoromethane	102	REC %			1	8260B		11/13/2015	CJR	1
SUR - 4-Bromofluorobenzene	126	REC %			1	8260B		11/13/2015	CJR	1

Lab Code 5030024T
Sample ID 6143-PZ-2
Sample Matrix Water
Sample Date 11/6/2015

	Result	Unit	LOD	LOQ	Dil	Method	Ext Date	Run Date	Analyst	Code
Organic										
VOC's										
cis-1,2-Dichloroethene	< 0.45	ug/l	0.45	1.4	1	8260B		11/13/2015	CJR	1
trans-1,2-Dichloroethene	< 0.54	ug/l	0.54	1.7	1	8260B		11/13/2015	CJR	1
Tetrachloroethene	< 0.49	ug/l	0.49	1.5	1	8260B		11/13/2015	CJR	1
Trichloroethene (TCE)	< 0.47	ug/l	0.47	1.5	1	8260B		11/13/2015	CJR	1
Vinyl Chloride	< 0.17	ug/l	0.17	0.54	1	8260B		11/13/2015	CJR	1
SUR - 1,2-Dichloroethane-d4	103	REC %			1	8260B		11/13/2015	CJR	1
SUR - 4-Bromofluorobenzene	118	REC %			1	8260B		11/13/2015	CJR	1
SUR - Dibromofluoromethane	101	REC %			1	8260B		11/13/2015	CJR	1
SUR - Toluene-d8	118	REC %			1	8260B		11/13/2015	CJR	1

Project Name OHM-OCONOMOWOC
Project # 6143 PO#2015991

Invoice # E30024

Lab Code 5030024U
Sample ID 6143-DUP-1
Sample Matrix Water
Sample Date 11/5/2015

	Result	Unit	LOD	LOQ	Dil	Method	Ext Date	Run Date	Analyst	Code
Organic										
VOC's										
cis-1,2-Dichloroethene	< 0.45	ug/l	0.45	1.4	1	8260B		11/13/2015	CJR	1
trans-1,2-Dichloroethene	< 0.54	ug/l	0.54	1.7	1	8260B		11/13/2015	CJR	1
Tetrachloroethene	12.4	ug/l	0.49	1.5	1	8260B		11/13/2015	CJR	1
Trichloroethene (TCE)	< 0.47	ug/l	0.47	1.5	1	8260B		11/13/2015	CJR	1
Vinyl Chloride	< 0.17	ug/l	0.17	0.54	1	8260B		11/13/2015	CJR	1
SUR - 1,2-Dichloroethane-d4	94	REC %			1	8260B		11/13/2015	CJR	1
SUR - 4-Bromofluorobenzene	122	REC %			1	8260B		11/13/2015	CJR	1
SUR - Dibromofluoromethane	103	REC %			1	8260B		11/13/2015	CJR	1
SUR - Toluene-d8	113	REC %			1	8260B		11/13/2015	CJR	1

Lab Code 5030024V
Sample ID 6143-DUP-2
Sample Matrix Water
Sample Date 11/6/2015

	Result	Unit	LOD	LOQ	Dil	Method	Ext Date	Run Date	Analyst	Code
Organic										
VOC's										
cis-1,2-Dichloroethene	< 0.45	ug/l	0.45	1.4	1	8260B		11/13/2015	CJR	1
trans-1,2-Dichloroethene	< 0.54	ug/l	0.54	1.7	1	8260B		11/13/2015	CJR	1
Tetrachloroethene	12.1	ug/l	0.49	1.5	1	8260B		11/13/2015	CJR	1
Trichloroethene (TCE)	< 0.47	ug/l	0.47	1.5	1	8260B		11/13/2015	CJR	1
Vinyl Chloride	< 0.17	ug/l	0.17	0.54	1	8260B		11/13/2015	CJR	1
SUR - Dibromofluoromethane	102	REC %			1	8260B		11/13/2015	CJR	1
SUR - Toluene-d8	116	REC %			1	8260B		11/13/2015	CJR	1
SUR - 1,2-Dichloroethane-d4	99	REC %			1	8260B		11/13/2015	CJR	1
SUR - 4-Bromofluorobenzene	120	REC %			1	8260B		11/13/2015	CJR	1

Lab Code 5030024W
Sample ID 6143-EB-1
Sample Matrix Water
Sample Date

	Result	Unit	LOD	LOQ	Dil	Method	Ext Date	Run Date	Analyst	Code
Organic										
VOC's										
cis-1,2-Dichloroethene	< 0.45	ug/l	0.45	1.4	1	8260B		11/13/2015	CJR	1
trans-1,2-Dichloroethene	< 0.54	ug/l	0.54	1.7	1	8260B		11/13/2015	CJR	1
Tetrachloroethene	< 0.49	ug/l	0.49	1.5	1	8260B		11/13/2015	CJR	1
Trichloroethene (TCE)	< 0.47	ug/l	0.47	1.5	1	8260B		11/13/2015	CJR	1
Vinyl Chloride	< 0.17	ug/l	0.17	0.54	1	8260B		11/13/2015	CJR	1
SUR - 1,2-Dichloroethane-d4	96	REC %			1	8260B		11/13/2015	CJR	1
SUR - 4-Bromofluorobenzene	118	REC %			1	8260B		11/13/2015	CJR	1
SUR - Dibromofluoromethane	100	REC %			1	8260B		11/13/2015	CJR	1
SUR - Toluene-d8	114	REC %			1	8260B		11/13/2015	CJR	1

Project Name OHM-OCONOMOWOC
Project # 6143 PO#2015991

Invoice # E30024

Lab Code 5030024X
Sample ID 6143-EB-2
Sample Matrix Water
Sample Date

	Result	Unit	LOD	LOQ	Dil	Method	Ext Date	Run Date	Analyst	Code
Organic										
VOC's										
cis-1,2-Dichloroethene	< 0.45	ug/l	0.45	1.4	1	8260B		11/13/2015	CJR	1
trans-1,2-Dichloroethene	< 0.54	ug/l	0.54	1.7	1	8260B		11/13/2015	CJR	1
Tetrachloroethene	< 0.49	ug/l	0.49	1.5	1	8260B		11/13/2015	CJR	1
Trichloroethene (TCE)	< 0.47	ug/l	0.47	1.5	1	8260B		11/13/2015	CJR	1
Vinyl Chloride	< 0.17	ug/l	0.17	0.54	1	8260B		11/13/2015	CJR	1
SUR - 1,2-Dichloroethane-d4	91	REC %				1 8260B		11/13/2015	CJR	1
SUR - 4-Bromofluorobenzene	121	REC %				1 8260B		11/13/2015	CJR	1
SUR - Dibromofluoromethane	101	REC %				1 8260B		11/13/2015	CJR	1
SUR - Toluene-d8	114	REC %				1 8260B		11/13/2015	CJR	1

Lab Code 5030024Y
Sample ID TRIP BLANK
Sample Matrix Water
Sample Date

	Result	Unit	LOD	LOQ	Dil	Method	Ext Date	Run Date	Analyst	Code
Organic										
VOC's										
cis-1,2-Dichloroethene	< 0.45	ug/l	0.45	1.4	1	8260B		11/13/2015	CJR	1
trans-1,2-Dichloroethene	< 0.54	ug/l	0.54	1.7	1	8260B		11/13/2015	CJR	1
Tetrachloroethene	< 0.49	ug/l	0.49	1.5	1	8260B		11/13/2015	CJR	1
Trichloroethene (TCE)	< 0.47	ug/l	0.47	1.5	1	8260B		11/13/2015	CJR	1
Vinyl Chloride	< 0.17	ug/l	0.17	0.54	1	8260B		11/13/2015	CJR	1
SUR - Toluene-d8	114	REC %				1 8260B		11/13/2015	CJR	1
SUR - 1,2-Dichloroethane-d4	98	REC %				1 8260B		11/13/2015	CJR	1
SUR - 4-Bromofluorobenzene	124	REC %				1 8260B		11/13/2015	CJR	1
SUR - Dibromofluoromethane	102	REC %				1 8260B		11/13/2015	CJR	1

"J" Flag: Analyte detected between LOD and LOQ

LOD Limit of Detection

LOQ Limit of Quantitation

Code *Comment*

1 Laboratory QC within limits.

All solid sample results reported on a dry weight basis unless otherwise indicated. All LOD's and LOQ's are adjusted for dilutions but not dry weight. Subcontracted results are denoted by SUB in the analyst field.

Authorized Signature



Environmental Lab, Inc.

1990 Prospect Ct. • Appleton, WI 54914
920-830-2455 • FAX 920-733-0631

Sample Handling Request
Rush Analysis Date Required _____
(Rushes accepted only with prior authorization)
 Normal Turn Around

Lab I.D. # _____
Account No.: _____ Quote No.: _____
Project #: **6143**
Sampler: (signature) *[Signature]*

Project (Name / Location): **OHM-Occurrence / Occurrence WI**
Reports To: *w. f. s. bender / K. Heinsstead*
Company: **EnviroForensics**
Address: **N16 W23390 Stem Ridge Dr.**
City State Zip: **Waukesha WI 53188**
Phone: **317-972-7870**
FAX: _____

Analysis Requested										Other Analysis				
DRO (Mod DRO Sep 95)	GRO (Mod GRO Sep 95)	LEAD	NITRATE/NITRITE	OIL & GREASE	PAH (EPA 8270)	PCB	PVOC (EPA 8021)	PVOC + NAPHTHALENE	SULFATE	TOTAL SUSPENDED SOLIDS	VOC DW (EPA 542.2)	VOC (EPA 8260) <i>Pyrene only</i>	8-PCRA METALS	PID/ FID
												X		
												X		
												X		
												X		
												X		
												X		
												X		
												X		
												X		
												X		
												X		
												X		

Lab I.D.	Sample I.D.	Collection Date	Time	Comp	Grab	Filtered Y/N	No. of Containers	Sample Type (Matrix)*	Preservation
S030024A	6143-PW-1	11-5	1055		X	N	3	GW	HCl
B	6143-PW-1D	11-5	1200		X	N	3	GW	HCl
C	6143-PW-2	11-5	825		X	N	3	GW	HCl
D	6143-PW-3	11-4	1455		X	N	3	GW	HCl
E	6143-PW-4	11-4	1345		X	N	3	GW	HCl
F	6143-PW-5	11-5	910		X	N	3	GW	HCl
G	6143-PW-6	11-5	1255		X	N	3	GW	HCl
H	6143-PW-7	11-5	1000		X	N	3	GW	HCl
I	6143-PW-8	11-4	1245		X	N	3	GW	HCl
J	6143-PW-9	11-4	1125		X	N	3	GW	HCl

Comments/Special Instructions (*Specify groundwater "GW", Drinking Water "DW", Waste Water "WW", Soil "S", Air "A", Oil, Sludge etc.)

PO# 2015991

Only Analyze for PCB, PCE, CIS 1,2 DCE, TMS 1,2 DCE & Vinyl chloride

Sample Integrity - To be completed by receiving lab.
Method of Shipment: **Dry Ice**
Temp. of Temp. Blank _____ °C On Ice: **X**
Cooler seal intact upon receipt: **X** Yes ___ No

Relinquished By: (sign) *[Signature]* Time: **11:11** Date: **11/10/15**
Received By: (sign) *[Signature]* Time: **11:11** Date: **11/10/15**
Received in Laboratory By: *[Signature]* Time: **8:00** Date: **11/11/15**

WAF

Environmental Lab, Inc.

1990 Prospect Ct. • Appleton, WI 54914
920-830-2455 • FAX 920-733-0631

Sample Handling Request

Rush Analysis Date Required
(Rushes accepted only with prior authorization)

Normal Turn Around

Lab I.D. # _____
Account No. : _____ Quote No.: _____
Project #: 6143
Sampler: (signature) [Signature]

Project (Name / Location): OHM-Oconomowoc / Oconomowoc WI
Reports To: w Fassbender / H. Heinstead Invoice To: _____
Company: EnviroForensics Company: _____
Address: N16 W23370 Stone Ridge Dr. Address: _____
City State Zip: Waukesha WI 53188 City State Zip: _____
Phone: 317-972-7870 Phone: _____
FAX: _____ FAX: _____

Analysis Requested										Other Analysis											
DRO (Mod DRO Sep 95)	GRO (Mod GRO Sep 95)	LEAD	NITRATE/NITRITE	OIL & GREASE	PAH (EPA 8270)	PCB	PVOC (EPA 8021)	PVOC + NAPHTHALENE	SULFATE	TOTAL SUSPENDED SOLIDS	VOC DW (EPA 512.2)	VOC (EPA 8260) <i>Phys. Cleaner only</i>	8-PCRA METALS							PID/ FID	

Lab I.D.	Sample I.D.	Collection Date	Time	Comp	Grab	Filtered Y/N	No. of Containers	Sample Type (Matrix)*	Preservation
<u>5030024k</u>	<u>6143-MW-10</u>	<u>11-4</u>	<u>1550</u>		<u>X</u>	<u>N</u>	<u>3</u>	<u>GW</u>	<u>HCL</u>
<u>L</u>	<u>6143-MW-11</u>	<u>11-6</u>	<u>930</u>		<u>X</u>	<u>N</u>	<u>3</u>	<u>GW</u>	<u>HCL</u>
<u>M</u>	<u>6143-MW-12</u>	<u>11-5</u>	<u>1430</u>		<u>X</u>	<u>N</u>	<u>3</u>	<u>GW</u>	<u>HCL</u>
<u>N</u>	<u>6143-MW-13</u>	<u>11-6</u>	<u>1330</u>		<u>X</u>	<u>N</u>	<u>3</u>	<u>GW</u>	<u>HCL</u>
<u>O</u>	<u>6143-MW-14</u>	<u>11-6</u>	<u>1220</u>		<u>X</u>	<u>N</u>	<u>3</u>	<u>GW</u>	<u>HCL</u>
<u>P</u>	<u>6143-MW-15</u>	<u>11-6</u>	<u>1535</u>		<u>X</u>	<u>N</u>	<u>3</u>	<u>GW</u>	<u>HCL</u>
<u>Q</u>	<u>6143-MW-16</u>	<u>11-6</u>	<u>1430</u>		<u>X</u>	<u>N</u>	<u>3</u>	<u>GW</u>	<u>HCL</u>
<u>R</u>	<u>6143-MW-17</u>	<u>11-5</u>	<u>1520</u>		<u>X</u>	<u>N</u>	<u>3</u>	<u>GW</u>	<u>HCL</u>
<u>S</u>	<u>6143-PZ-1</u>	<u>11-5</u>	<u>1335</u>		<u>X</u>	<u>N</u>	<u>3</u>	<u>GW</u>	<u>HCL</u>
<u>T</u>	<u>6143-PZ-2</u>	<u>11-6</u>	<u>1120</u>		<u>X</u>	<u>N</u>	<u>3</u>	<u>GW</u>	<u>HCL</u>

Comments/Special Instructions (*Specify groundwater "GW", Drinking Water "DW", Waste Water "WW", Soil "S", Air "A", Oil, Sludge etc.)

PO# 2015 991

Only Analyze for PCE, TCE, cis 1-2 DCE, Trans 1,2 DCE & Vinyl Chloride

Sample Integrity - To be completed by receiving lab.

Method of Shipment: Air

Temp. of Temp. Blank _____ °C On Ice:

Cooler seal intact upon receipt: Yes _____ No

Relinquished By: (sign) [Signature] Time 11:12 Date 11/10/15
Received By: (sign) [Signature] Time 11:11 Date 11/10/15

Received in Laboratory By: [Signature] Time: 8:00 Date: 11/10/15