



March 8, 2016

Brian Ewald
Ewald KIA
36883 East Wisconsin Avenue
Oconomowoc, WI 53066

Subject: Environmental sampling results
36883 East Wisconsin Avenue
Oconomowoc, Wisconsin

Dear Mr. Ewald:

In accordance with the executed Agreement to Provide Access for Sampling Activities dated April 2, 2015, and in accordance with Wisconsin Department of Natural Resources (WDNR) regulation NR 716.14, Environmental Forensic Investigations, Inc. (EnviroForensics) is providing the results of the soil gas sample collected from your property located at 36883 East Wisconsin Avenue, Oconomowoc, Wisconsin. The soil gas sample was collected on February 25, 2016 from the groundwater monitoring well (MW-17) located on your property. The sampling activities are part of an environmental investigation being performed at the Former One Hour Martinizing (OHM) of Oconomowoc, located at 36929 Plank Road, Oconomowoc, Wisconsin at the direction of the WDNR pursuant to the authority granted to it under State and Federal law. The WDNR has assigned the following identification to this on-going investigation: BRRTS# 02-68-551911. The chemicals of concern for the investigation are the dry cleaning solvent tetrachloroethene (PCE) and its associated breakdown products.

The Responsible Party is:

Mr. Brian Cass
OHM Holdings, Inc.
W229 N2494 County Road F
Waukesha, WI 53186-1104
262-521-9710

Soil Gas Sampling Results

One (1) soil gas sample (6143-SG-4 (MW-17)) was collected from monitoring well MW-17. The sample was analyzed for chlorinated volatile organic compounds (CVOCs). The location of MW-17 is depicted on the attached **Figure 1**. The sample result is summarized in **Table 1**. An excerpt of the laboratory report that relates to the 6143-SG-4 (MW-17) soil gas sample is also attached.

Document: 6143-0477
Environmental Forensic Investigations, Inc.
N16 W23390 Stone Ridge Drive, Suite G, Waukesha, WI 53188
Phone: 262-290-4001 • Fax 317-972-7875



As listed on **Table 1**, sample 6143-SG-4 (MW-17) did not contain PCE or associated compounds above laboratory detection limits.

At this time, there does not appear to be a risk of vapor intrusion to your building. We will contact you to discuss additional investigation work, if any. If you have any questions or concerns, please contact me at 414-982-3988 or by email at wfassbender@enviroforensics.com. The WDNR project manager, Dave Volkert, can be reached at 262-547-2166. We greatly appreciate your help and patience with this matter.

Sincerely,

Environmental Forensic Investigations, Inc.

Handwritten signature of Kyle Heimstead in black ink.

Kyle Heimstead
Staff Geologist

Handwritten signature of Wayne Fassbender in black ink.

Wayne Fassbender, PG, PMP
Senior Project Manager

Attachments: Figure 1 - Monitoring Well Location Map
Table 1 – Summary of Groundwater Analytical Results
Laboratory Analytical Report Excerpt

Copy: Dave Volkert, Wisconsin Department of Natural Resources
Ted Warpinski, Friebert, Finerty & St. John, S.C.

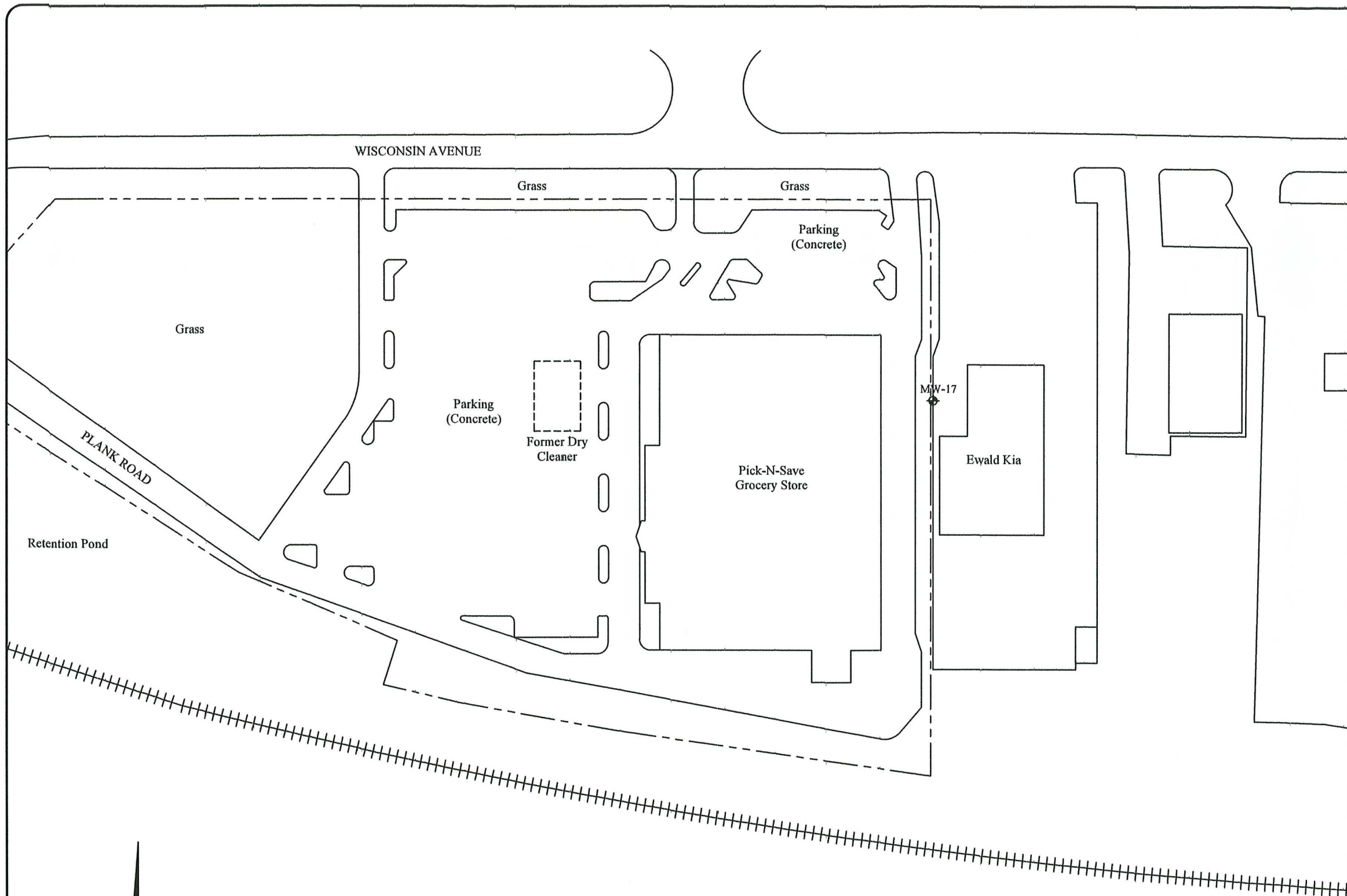

Legend

- Property boundary
- MW-17 ◆ Monitoring well sample location

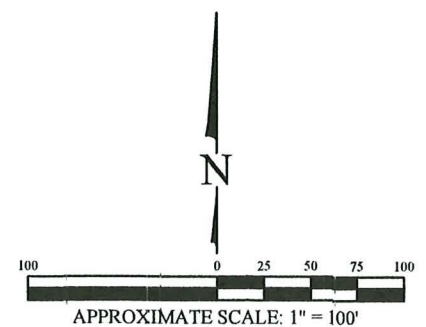

MONITORING WELL LOCATION MAP

Martinzing Dry Cleaning
36929 Plank Road
Oconomowoc, WI

Date: 5/1/15	Figure
Designed: EB	1
Drawn: EB	Project
Checked: KH	6143
DWG file: 6143-0135	



ENVIRONMENTAL FORENSIC INVESTIGATIONS, INC.
602 N. Capitol Ave., Ste. 210 • Indianapolis, IN 46204
EnviroForensics.com

Table 1
Summary of Soil Gas Analytical Results
 Ewald KIA Soil Gas
 Oconomowoc, Wisconsin

Soil Gas Well ID	Sample Date	Tetrachloroethene	Trichloroethene	cis-1,2-Dichloroethene	trans-1,2-Dichloroethene	Vinyl chloride
Deep Vapor Risk Screening Level ¹		18,000	880	NE	NE	2,800
6143-SG-4 (MW-17)	9/15/2015	54.9	<10.7	<198	<396	<12.8
	2/25/2016	<3.19	<1.07	<3.96	<3.96	<0.64

Notes:

¹ The Vapor Risk Screening Levels are based on U.S. E.P.A.'s Regional Screening Levels (RSL's) for non-residential indoor air with an attenuation factor of 0.01 for soil gas deeper than 5 feet below the foundation of a large commercial buildings and a 0.1 adjustment for 1 x 10⁻⁵ lifetime cancer risk for carcinogens.

All concentrations reported in units of micrograms per cubic meter (µg/m³)

Bolded and Orange Shaded values exceed the Deep Vapor Risk Screening Level

Bolded values are above detection limits

NE = Not Established



EnvisionAir
1441 Sadlier Circle West Drive
Indianapolis, IN 46239
Ph: 317-351-0885
Fax: 317-351-0882
www.envision-air.com

Mr. W. Fassbender
Enviroforensics
N16 W. 23390 Stone Ridge Dr
Suite G
Waukesha, WI 53188

March 8, 2016

EnvisionAir Project Number: 2016-153
Client Project Name: 6143 – OHM Oconomowoc

Dear Mr. Fassbender,

Please find the attached analytical report for the samples received March 1, 2016. All test methods performed were fully compliant with local, state, and federal EPA methods unless otherwise noted. The project was analyzed as requested on the enclosed chain of custody record. Please review the comments section for additional information about your results or Quality Control data.

Feel free to contact me if you have any questions or comments regarding your analytical report or service.

Thank you for your business. EnvisionAir looks forward to working with you on your next project.

Yours Sincerely,

A handwritten signature in cursive script that reads "Stanley A. Hunnicutt".

Stanley A Hunnicutt

Project Manager
EnvisionAir, LLC



EnvisionAir
1441 Sadlier Circle West Drive
Indianapolis, IN 46239
Ph: 317-351-0885
Fax: 317-351-0882
www.envision-air.com

Client Name: ENVIROFORENSICS
Project ID: 6404
Client Project Manager: W. FASSBENDER
EnvisionAir Project Number: 2016-153

Sample Summary

Canister Pressure / Vacuum

<u>Laboratory Sample Number:</u>	<u>Sample Description:</u>	<u>START</u> <u>Date</u>	<u>START</u> <u>Time</u>	<u>End Date</u>	<u>End Time</u>	<u>Date</u>	<u>Time</u>	<u>Initial Field</u> <u>(in. Hg)</u>	<u>Final Field</u> <u>(in. Hg)</u>	<u>Lab</u> <u>Received</u> <u>(in. Hg)</u>	
16-540	6143-SG-4(MW-17)	A	2/25/16	11:53	2/25/16	12:23	3/1/16	10:35	-27	-3	-3



EnvisionAir
1441 Sadlier Circle West Drive
Indianapolis, IN 46239
Ph: 317-351-0885
Fax: 317-351-0882
www.envision-air.com

Client Name: ENVIROFORENSICS
Project ID: 6143 / OHM OCONOMOWOC
Client Project Manager: W. FASSBENDER
EnvisionAir Project Number: 2016-153

Analytical Method: TO-15
Analytical Batch: 030116AIR

Client Sample ID: 6143-SG-4(MW-17) **Sample Collection START Date/Time:** 2/25/16 11:53
Envision Sample Number: 16-540 **Sample Collection END Date/Time:** 2/25/16 12:23
Sample Matrix: AIR **Sample Received Date/Time:** 3/1/16 10:35

<u>Compounds</u>	<u>Sample Results ug/m³</u>	<u>Reporting Limit ug/m³</u>	<u>Flag</u>
cis-1,2-Dichloroethene	< 3.96	3.96	
Tetrachloroethene	< 3.19	3.19	
trans-1,2-Dichloroethene	< 3.96	3.96	
Trichloroethene	< 1.07	1.07	
Vinyl Chloride	< 0.64	0.64	
4-bromofluorobenzene (surrogate)	104%		
Analysis Date/Time:	3-1-16/20:45		
Analyst Initials	tjg		



EnvisionAir
 1441 Sadlier Circle West Drive
 Indianapolis, IN 46239
 Ph: 317-351-0885
 Fax: 317-351-0882
 www.envision-air.com

Analytical Report

TO-15 Quality Control Data

EnvisionAir Batch Number: 030116AIR

<u>Method Blank (MB):</u>	<u>MB Results (ppbv)</u>	<u>Reporting Limit (ppbv)</u>	<u>Flags</u>
cis-1,2-Dichloroethene	< 5	5	
Tetrachloroethene	< 0.47	0.47	
trans-1,2-Dichloroethene	< 10	10	
Trichlorethene	< 0.2	0.2	
Vinyl Chloride	< 0.5	0.5	
4-bromofluorobenzene (surrogate)	114%		
Analysis Date/Time:	3-1-16/18:46		
Analyst Initials	tjg		

<u>LCS/LCSD</u>	<u>LCS Results (ppbv)</u>	<u>LCSD Results (ppbv)</u>	<u>LCS/D Conc(ppbv)</u>	<u>LCS Rec.</u>	<u>LCSD Rec.</u>	<u>RPD</u>	<u>Flag</u>
cis-1,2-Dichloroethene	9.78	9.89	10	98%	99%	1.1%	
Tetrachloroethene	10.7	11.1	10	107%	111%	3.7%	
trans-1,2-Dichloroethene	10.6	10.8	10	106%	108%	1.9%	
Trichlorethene	10.2	10.5	10	102%	105%	2.9%	
Vinyl Chloride	9.26	9.57	10	93%	96%	3.3%	
4-bromofluorobenzene (surrogate)	108%	109%					
Analysis Date/Time:	3-1-16/17:26	3-1-16/18:07					
Analyst Initials	tjg	tjg					



EnvisionAir
1441 Sadlier Circle West Drive
Indianapolis, IN 46239
Ph: 317-351-0885
Fax: 317-351-0882
www.envision-air.com

Flag Number

Comments

10/1 3/1 AH

CHAIN OF CUSTODY RECORD

WDF

EnvisionAir | 1441 Sadlier Circle West Drive | Indianapolis, IN 46239 | Phone: (317) 351-0885 | Fax: (317) 351-0882

Client: <i>EnviroForensics</i>	P.O. Number: <i>2016135</i>
Report Address: <i>N16 W2380 Stone Ridge Dr Suite 6 Waukegan, WI 53188</i>	Project Name or Number: <i>6143 / OHM OSHA 2008</i>
Report To: <i>W. Fassbender</i>	Sampled by: <i>K. VanderHeide</i>
Phone: <i>317 972 2870</i>	QA/QC Required: (circle if applicable) Level III Level IV
Invoice Address: <i>same</i>	Reporting Units needed: (circle) <u>ug/m³</u> mg/m ³ PPBV PPMV
Desired TAT: (Please Circle One) 1 day 2 days 3 days Std (5 bus. days)	Media type: 1LC = 1 Liter Canister 6LC = 6 Liter Canister TB = Tedlar Bag TD = Thermal Desorption Tube

REQUESTED PARAMETERS

TO-15 Full List

TO-15 Short List



Sampling Type:

- Soil-Gas:
- Sub-Slab:
- Indoor-Air:

www.envision-air.com

Canister Pressure / Vacuum

Air Sample ID	Media Type <small>(see code above)</small>	Coll. Date <small>(Grab/Comp Start)</small>	Coll. Time <small>(Grab/Comp Start)</small>	Coll. Date <small>(Comp. End)</small>	Coll. Time <small>(Comp. End)</small>					Canister Serial #	Flow Controller Serial #	Initial Field (in. Hg)	Final Field (in. Hg)	Lab Received (in. Hg)	EnvisionAir Sample Number
6143-SG-4 (MW-17)	6LC	2/25	1153	2/25	1223					19625	NA	-27	-3	-3	16-540

Comments: *Do Not Dilute - No need to dilute. Past concentrations below 460 ug/m³ (ACE detected, only)*

Relinquished by:	Date	Time	Received by:	Date	Time
<i>[Signature]</i>	2/25/16	1503	<i>Stanley A. Minicucci</i>	3/1/16	1035



March 8, 2016

Terry Schuetz
Napa Auto Parts
1603 Manhattan Drive
Waukesha, WI 53186

Subject: Environmental sampling results
36863 East Wisconsin Avenue
Oconomowoc, Wisconsin

Dear Mr. Schuetz:

In accordance with the executed Agreement to Provide Access for Sampling Activities dated February 10, 2015, and in accordance with Wisconsin Department of Natural Resources (WDNR) regulation NR 716.14, Environmental Forensic Investigations, Inc. (EnviroForensics) is providing the results of the soil gas sample collected from your property located at 36863 East Wisconsin Avenue, Oconomowoc, Wisconsin. The soil gas sample was collected on February 25, 2016 from a groundwater monitoring well (MW-15) located on your property. The sampling activities are part of an environmental investigation being performed at the Former One Hour Martinizing (OHM) of Oconomowoc, located at 36929 Plank Road, Oconomowoc, Wisconsin at the direction of the Wisconsin Department of Natural Resources (WDNR) pursuant to the authority granted to it under State and Federal law. The WDNR has assigned the following identification to this on-going investigation: BRRTS# 02-68-551911. The chemicals of concern for the investigation are the dry cleaning solvent tetrachloroethene (PCE) and its associated breakdown products.

The Responsible Party is:

Mr. Brian Cass
OHM Holdings, Inc.
W229 N2494 County Road F
Waukesha, WI 53186-1104
262-521-9710

Groundwater Sampling Results

One (1) soil gas sample (6143-SG-5 (MW-15)) was collected from monitoring well MW-15. The sample was analyzed for chlorinated volatile organic compounds (CVOCs). The location of MW-15 is depicted on the attached **Figure 1**. The sample result is summarized in **Table 1**. An

Document: 6143-0481
Environmental Forensic Investigations, Inc.
N16 W23390 Stone Ridge Drive, Suite G, Waukesha, WI 53188
Phone: 262-290-4001 • Fax 317-972-7875

excerpt of the laboratory report that relates to the 6143-SG-5 (MW-15) soil gas sample is also attached.

As listed on **Table 1**, sample 6143-SG-5 (MW-15) did not contain PCE or associated compounds above laboratory detection limits.

At this time, there does not appear to be vapor intrusion issue on your property. We will contact you to discuss additional investigation work, if any. If you have any questions or concerns, please contact me at 414-982-3988 or by email at wfassbender@enviroforensics.com. The WDNR project manager, Dave Volkert, can be reached at 262-547-2166. We greatly appreciate your help and patience with this matter.

Sincerely,
Environmental Forensic Investigations, Inc.

Handwritten signature of Kyle Heimstead in black ink.

Kyle Heimstead
Staff Geologist

Handwritten signature of Wayne Fassbender in black ink.

Wayne Fassbender, PG, PMP
Senior Project Manager

Attachments: Figure 1 - Monitoring Well Location Map
Table 1 – Summary of Groundwater Analytical Results
Laboratory Analytical Report Excerpt

Copy: Dave Volkert, Wisconsin Department of Natural Resources
Ted Warpinski, Friebert, Finerty & St. John, S.C.

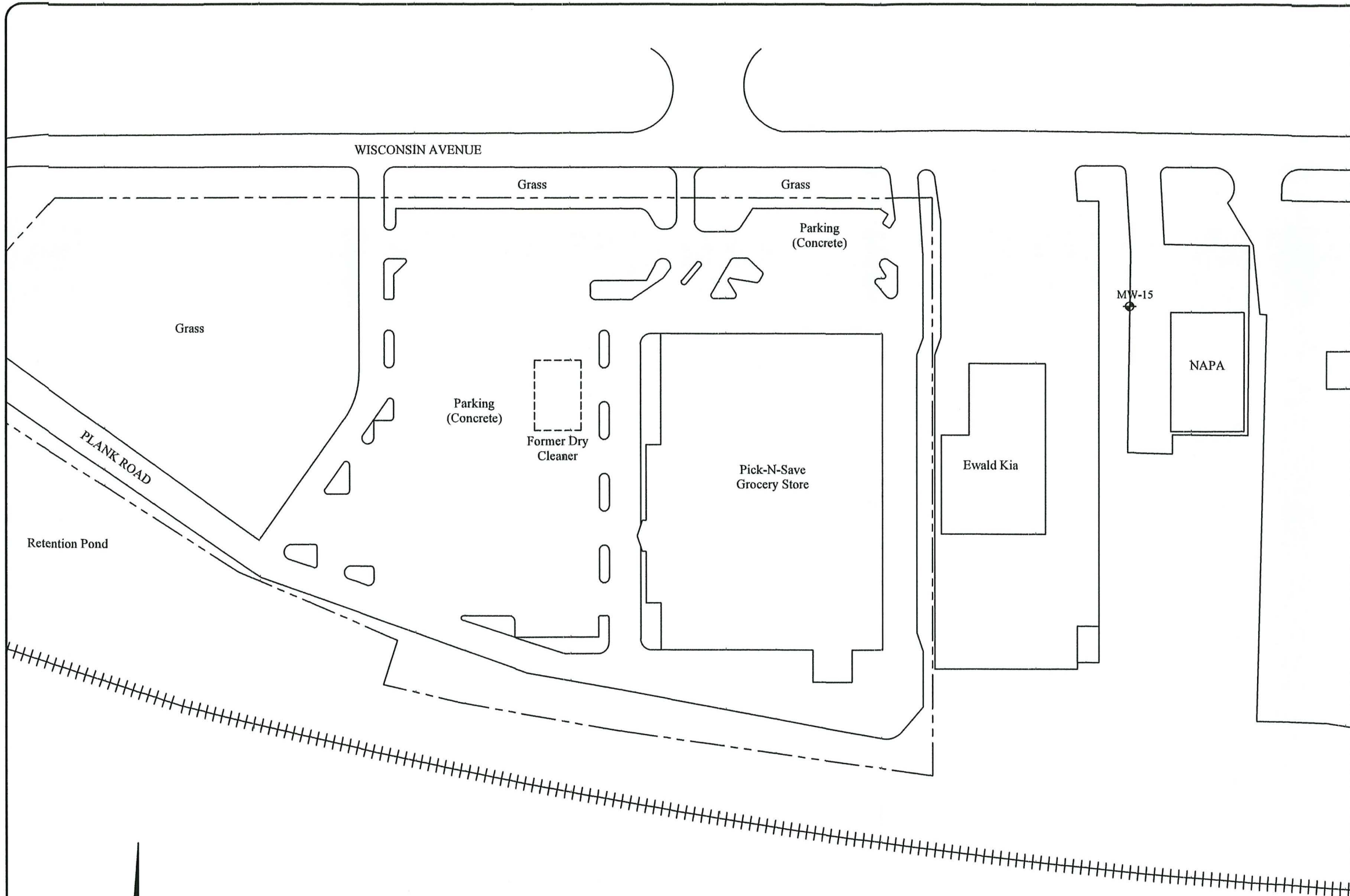

Legend
 - - - - - Property boundary
 MW-15 ⊕ Monitoring well sample location

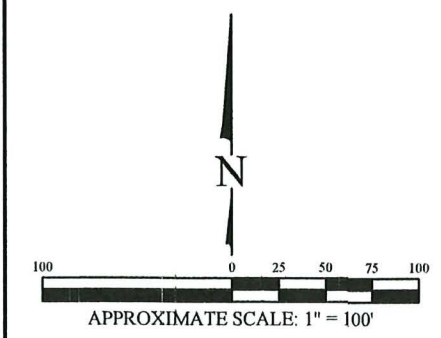

MONITORING WELL LOCATION MAP

Martinizing Dry Cleaning
 36929 Plank Road
 Oconomowoc, WI

Date:	5/1/15
Designed:	EB
Drawn:	EB
Checked:	KH
DWG file:	6143-0135

ENVIROforensics
 ENVIRONMENTAL FORENSIC INVESTIGATIONS, INC.
 602 N. Capitol Ave., Ste. 210 • Indianapolis, IN 46204
 EnviroForensics.com

Figure	1
Project	6143

Table 1
Summary of Soil Gas Analytical Results
 NAPA Auto Parts Store Soil Gas
 Oconomowoc, Wisconsin

Soil Gas Well ID	Sample Date	Tetrachloroethene	Trichloroethene	cis-1,2-Dichloroethene	trans-1,2-Dichloroethene	Vinyl chloride
Deep Vapor Risk Screening Level ¹		18,000	880	NE	NE	2,800
6143-SG-5 (MW-15)	9/15/2015	661	<10.7	<198	<396	<12.8
	2/25/2016	<3.19	<1.07	<3.96	<3.96	<0.64

Notes:

¹ The Vapor Risk Screening Levels are based on U.S. E.P.A.'s Regional Screening Levels (RSL's) for non-residential indoor air with an attenuation factor of 0.01 for soil gas deeper than 5 feet below the foundation of a large commercial buildings and a 0.1 adjustment for 1 x 10⁻⁵ lifetime cancer risk for carcinogens.

² The Vapor Risk Screening Levels are based on U.S. E.P.A.'s Regional Screening Levels (RSL's) for non-residential indoor

Bolded values are above detection limits

NE = Not Established



EnvisionAir
1441 Sadlier Circle West Drive
Indianapolis, IN 46239
Ph: 317-351-0885
Fax: 317-351-0882
www.envision-air.com

Mr. W. Fassbender
Enviroforensics
N16 W. 23390 Stone Ridge Dr
Suite G
Waukesha, WI 53188

March 8, 2016

EnvisionAir Project Number: 2016-154
Client Project Name: 6143 – OHM Oconomowoc

Dear Mr. Fassbender,

Please find the attached analytical report for the samples received March 1, 2016. All test methods performed were fully compliant with local, state, and federal EPA methods unless otherwise noted. The project was analyzed as requested on the enclosed chain of custody record. Please review the comments section for additional information about your results or Quality Control data.

Feel free to contact me if you have any questions or comments regarding your analytical report or service.

Thank you for your business. EnvisionAir looks forward to working with you on your next project.

Yours Sincerely,

A handwritten signature in cursive script that reads 'Stanley A. Hunnicutt'.

Stanley A Hunnicutt

Project Manager
EnvisionAir, LLC



EnvisionAir
 1441 Sadlier Circle West Drive
 Indianapolis, IN 46239
 Ph: 317-351-0885
 Fax: 317-351-0882
 www.envision-air.com

Client Name: ENVIROFORENSICS
Project ID: 6143 / OHM OCONOMOWOC
Client Project Manager: W. FASSBENDER
EnvisionAir Project Number: 2016-154

Sample Summary

Canister Pressure / Vacuum

<u>Laboratory Sample Number:</u>	<u>Sample Description:</u>	<u>START</u>	<u>START</u>	<u>End Date</u>	<u>End Time</u>	<u>Date</u>	<u>Time</u>	<u>Initial Field</u>	<u>Final Field</u>	<u>Lab</u>	
		<u>Date</u>	<u>Time</u>	<u>Collected:</u>	<u>Collected:</u>	<u>Received:</u>	<u>Received</u>	<u>(in. Hg)</u>	<u>(in. Hg)</u>	<u>(in. Hg)</u>	
16-539	6143-SG-5(MW-15)	A	2/25/16	12:56	2/25/16	13:19	3/1/16	10:35	-27	-3	-3



EnvisionAir
1441 Sadlier Circle West Drive
Indianapolis, IN 46239
Ph: 317-351-0885
Fax: 317-351-0882
www.envision-air.com

Client Name: ENVIROFORENSICS
Project ID: 6143 / OHM OCONOMOWOC
Client Project Manager: W. FASSBENDER
EnvisionAir Project Number: 2016-153

Analytical Method: TO-15
Analytical Batch: 030116AIR

Client Sample ID: 6143-SG-5(MW-15) **Sample Collection START Date/Time:** 2/25/16 12:56
Envision Sample Number: 16-539 **Sample Collection END Date/Time:** 2/25/16 13:19
Sample Matrix: AIR **Sample Received Date/Time:** 3/1/16 10:35

<u>Compounds</u>	<u>Sample Results ug/m³</u>	<u>Reporting Limit ug/m³</u>	<u>Flag</u>
cis-1,2-Dichloroethene	< 3.96	3.96	
Tetrachloroethene	< 3.19	3.19	
trans-1,2-Dichloroethene	< 3.96	3.96	
Trichloroethene	< 1.07	1.07	
Vinyl Chloride	< 0.64	0.64	
4-bromofluorobenzene (surrogate)	110%		
Analysis Date/Time:	3-1-16/20:05		
Analyst Initials	tjg		



EnvisionAir
 1441 Sadlier Circle West Drive
 Indianapolis, IN 46239
 Ph: 317-351-0885
 Fax: 317-351-0882
 www.envision-air.com

Analytical Report

TO-15 Quality Control Data

EnvisionAir Batch Number: 030116AIR

<u>Method Blank (MB):</u>	<u>MB Results (ppbv)</u>	<u>Reporting Limit (ppbv)</u>	<u>Flags</u>
cis-1,2-Dichloroethene	< 5	5	
Tetrachloroethene	< 0.47	0.47	
trans-1,2-Dichloroethene	< 10	10	
Trichlorethene	< 0.2	0.2	
Vinyl Chloride	< 0.5	0.5	
4-bromofluorobenzene (surrogate)	114%		
Analysis Date/Time:	3-1-16/18:46		
Analyst Initials	tjg		

<u>LCS/LCSD</u>	<u>LCS Results (ppbv)</u>	<u>LCSD Results (ppbv)</u>	<u>LCS/D Conc(ppbv)</u>	<u>LCS Rec.</u>	<u>LCSD Rec.</u>	<u>RPD</u>	<u>Flag</u>
cis-1,2-Dichloroethene	9.78	9.89	10	98%	99%	1.1%	
Tetrachloroethene	10.7	11.1	10	107%	111%	3.7%	
trans-1,2-Dichloroethene	10.6	10.8	10	106%	108%	1.9%	
Trichlorethene	10.2	10.5	10	102%	105%	2.9%	
Vinyl Chloride	9.26	9.57	10	93%	96%	3.3%	
4-bromofluorobenzene (surrogate)	108%	109%					
Analysis Date/Time:	3-1-16/17:26	3-1-16/18:07					
Analyst Initials	tjg	tjg					



EnvisionAir
1441 Sadlier Circle West Drive
Indianapolis, IN 46239
Ph: 317-351-0885
Fax: 317-351-0882
www.envision-air.com

Flag Number

Comments

154 ^{4th} 3/1
1 of 1 ^{4th} 3/1

CHAIN OF CUSTODY RECORD *WAT*

EnvisionAir | 1441 Sadlier Circle West Drive | Indianapolis, IN 46239 | Phone: (317) 351-0885 | Fax: (317) 351-0882

Client: <i>EnviroForensics</i>	P.O. Number: <i>2016135</i>
Report <i>N16 W23390</i>	Project Name or Number:
Address: <i>51706 Stone Ridge Dr Waukesha, WI 53188</i>	<i>6143/04M 04M Geonoma</i>
Report To: <i>W. Fassbender</i>	Sampled by: <i>K. Vander Heide</i>
Phone: <i>317 932 2820</i>	QA/QC Required: (circle if applicable) Level III Level IV
Invoice Address: <i>same</i>	Reporting Units needed: (circle) <u>ug/m³</u> mg/m ³ PPBV PPMV
Desired TAT: (Please Circle One) 1 day 2 days 3 days Std (5 bus. days)	Media type: 1LC = 1 Liter Canister 6LC = 6 Liter Canister TB = Tedlar Bag TD = Thermal Desorption Tube

REQUESTED PARAMETERS

TO-15 Full List

TO-15 Short List



Sampling Type:
Soil-Gas:
Sub-Slab:
Indoor-Air:

www.envision-air.com

Canister Pressure / Vacuum

Air Sample ID	Media Type <small>(see code above)</small>	Coll. Date <small>(Grab/Comp Start)</small>	Coll. Time <small>(Grab/Comp Start)</small>	Coll. Date <small>(Comp. End)</small>	Coll. Time <small>(Comp. End)</small>				Canister Serial #	Flow Controller Serial #	Initial Field (in. Hg)	Final Field (in. Hg)	Lab Received (in. Hg)	EnvisionAir Sample Number
<i>6143-56-5(MW-15)</i>	<i>6LC</i>	<i>2/25</i>	<i>1256</i>	<i>2/25</i>	<i>1319</i>	<i>X</i>			<i>NA</i>	<i>4663</i>	<i>-27</i>	<i>-3</i>	<i>-3</i>	<i>16-539</i>

Comments: *Do Not Dilute. Past concentration of PCE below 700ug/m³.*

Relinquished by:	Date	Time	Received by:	Date	Time
<i>[Signature]</i>	<i>2/25/15</i>	<i>1500</i>	<i>Stanley A. Hunsicker</i>	<i>3/1/16</i>	<i>1035</i>