



June 28, 2019

Mr. Patrick McAdams
McAdams Realty Oconomowoc, LLP
110 South Regency Circle
Oconomowoc, WI 53066

Subject: Environmental sampling results
BRTTS #: 02-68-551911

Dear Mr. McAdams:

In accordance with the executed Agreement to Provide Access for Sampling Activities, and in accordance with Wisconsin Department of Natural Resources (WDNR) regulation NR 716.14, EnviroForensics, LLC (EnviroForensics) is providing the results of groundwater samples collected from your property located at 36929 Plank Road in Oconomowoc, Wisconsin.

The groundwater samples were collected from eight (8) monitoring wells (MW-1, MW-1D MW-2, MW-3, MW-4, MW-5, MW-6, and MW-11) on June 6-7, 2019. The locations of the monitoring wells are shown on attached **Figure 1**. The sampling activities are part of an environmental investigation being performed at the former One Hour Martinizing (OHM) of Oconomowoc, formerly located at 36929 Plank Road, Oconomowoc, Wisconsin at the direction of the WDNR pursuant to the authority granted to it under State and Federal law. The chemicals of concern are the dry cleaning solvent tetrachloroethene (PCE) and its associated breakdown products collectively known as chlorinated volatile organic compounds (CVOCs).

The Responsible Party is:

Mr. Brian Cass
OHM Holdings, Inc.
W229 N2494 Hwy F
Waukesha, WI 53186
Telephone: 262-521-9710

Sampling Results

The laboratory results of groundwater samples collected in June 2019 are summarized and compared to public health criteria in attached **Table 1**. An excerpt from the laboratory report that relates to the groundwater samples collected from the monitoring wells is also attached.

As can be seen in **Table 1**, significant degradation of PCE has occurred in source area treatment zone wells MW-1, MW-1d, MW-2, and MW-5. Reductions have also been realized in down-

Document: 6143-1489



gradient well MW-11. The combination of soil venting and groundwater remedial injections continue to reduce the mass of PCE in the area where releases of dry cleaning solvent have occurred. We intend to discuss site cleanup progress with the WDNR sometime this fall.

In our last results letter said we were going to sample all of the wells during June 2019; however, due to scheduling conflicts we will sample all of the site wells during the next quarterly groundwater monitoring event scheduled for September 2019.

If you have any questions or concerns, please contact me at 414-982-3988 or by email at wfassbender@enviroforensics.com.

The WDNR project manager, Jim Delwiche, can be reached at 262-574-2145. We greatly appreciate your help and patience with this matter.

Sincerely,
EnviroForensics, LLC

A handwritten signature in black ink that reads "Wayne P. Fassbender".

Wayne Fassbender, PG, PMP
Senior Project Manager

Attachments: Figure 1: Monitoring Well Location Map
Table 1: Monitoring Well Analytical Results
Analytical Report for Groundwater Samples

Copy: Brian Cass, OHM Holdings, Inc.
James Delwiche, Wisconsin Department of Natural Resources

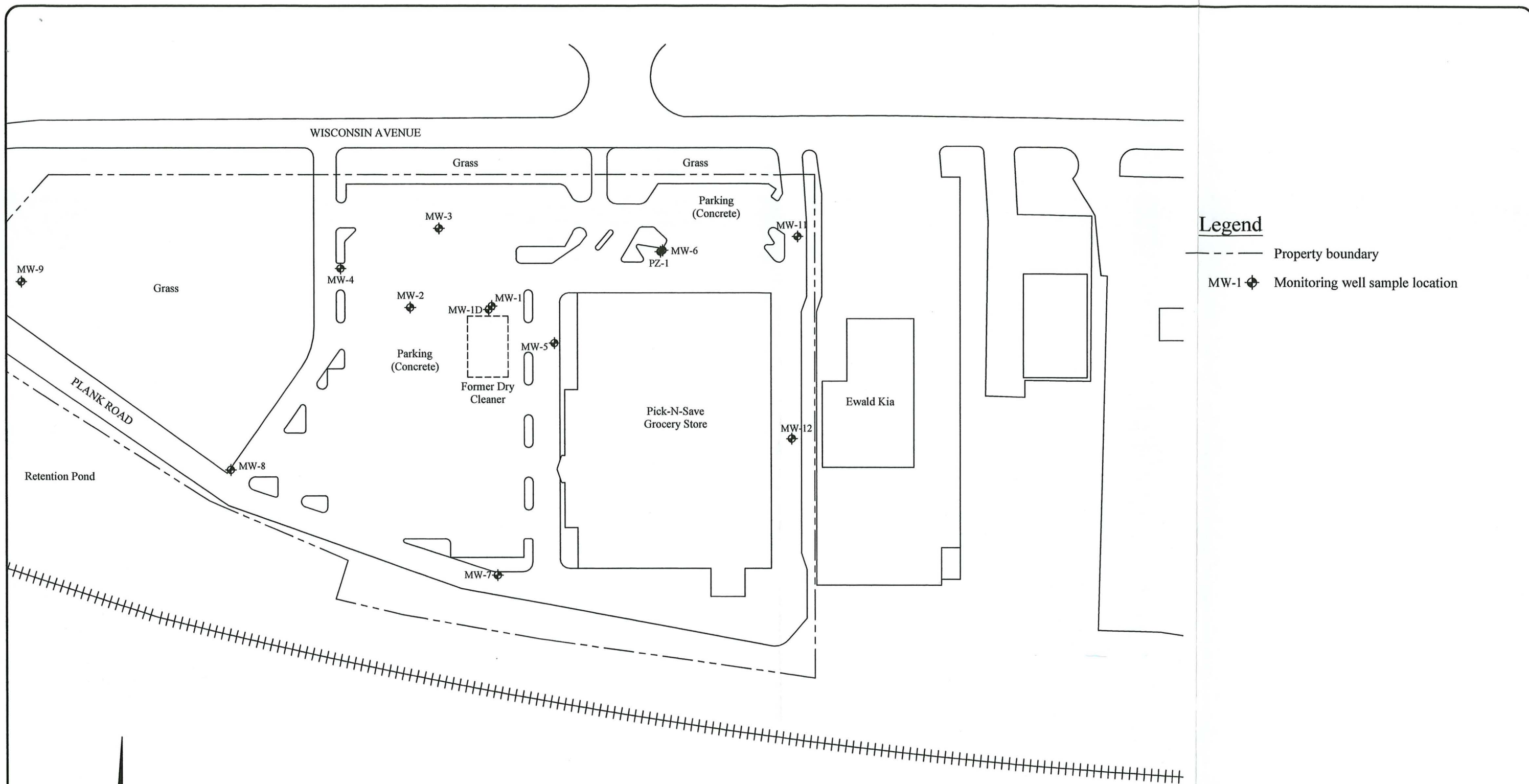

Legend

- Property boundary
- MW-1 Monitoring well sample location

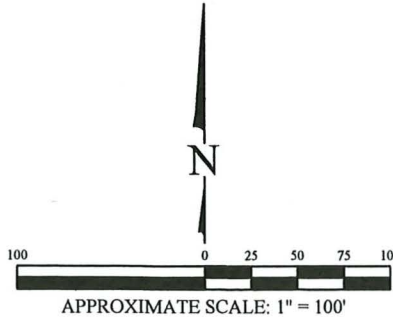

MONITORING WELL LOCATION MAP

Martinizing Dry Cleaning
 36929 Plank Road
 Oconomowoc, WI

Date:	5/1/15
Designed:	EB
Drawn:	EB
Checked:	KH
DWG file:	6143-0135

ENVIROforensics
 ENVIRONMENTAL FORENSIC INVESTIGATIONS, INC.
 602 N. Capitol Ave., Ste. 210 • Indianapolis, IN 46204
 EnviroForensics.com

Figure	1
Project	6143

TABLE 1
MONITORING WELL ANALYTICAL RESULTS
Former One Hour Martinizing Cleaners
Oconomowoc, Wisconsin

Monitoring Well ID	Sample Date	Tetrachloroethene	Trichloroethene	cis-1,2-Dichloroethene	trans-1,2-Dichloroethene	Vinyl chloride	Naphthalene	Chloroform
Preventive Action Limit		0.5	0.5	7	20	0.02	10	0.6
Enforcement Standard		5	5	70	100	0.2	100	6
MW-1	05/08/09	210	0.66 J	<0.96	<0.96	<0.26	<0.26	<0.20
	08/28/09	357	1.9 J	<4.2	<4.4	<0.90	<0.90	<0.20
	12/03/09	154	<0.96	<0.96	<0.96	<0.26	<0.26	<0.20
	03/10/10	229	1.0 J	<0.96	<0.96	<0.26	<0.26	<0.20
	06/02/10	140	<0.96	<0.96	<0.96	<0.26	<0.26	<0.20
	09/17/10	442	<2.4	<4.2	<4.4	<0.90	<0.90	<0.20
	01/07/11	420	2.4	<0.50	<0.50	<0.20	<0.20	<0.20
	04/27/11	167	0.58 J	<0.83	<0.89	<0.18	<0.18	<0.18
	09/08/11	335	<1.9	<3.3	<3.6	<0.72	<0.72	<5.2
	12/19/11	170	0.78 J	<1.0	<1.0	<0.40	<1.3	<0.40
	02/28/12	120	0.46 J	<0.50	<0.50	<0.20	<0.20	<0.20
	05/24/12	140	0.81	<0.12	<0.25	<0.10	<0.16	<0.20
	6/12/2013	120	0.69	<0.12	<0.25	<0.10	<0.16	<0.20
	10/2/2013	169	<3.3	<3.8	<3.5	<1.8	<1.7	<2.8
	1/3/2014	254	<3.3	<3.8	<3.5	<1.8	<1.7	<2.8
	3/6/2014	267	2.2 J	<1.9	<1.75	<0.9	<8.5	<1.4
	5/29/2014	109	<1.65	<1.9	<1.75	<0.9	<8.5	<1.4
	10/9/2014	280	2.63	<0.38	<0.35	<0.18	<1.7	<0.28
	6/23/2015	78	<2.35	<2.25	<2.7	<0.85	NA	NA
	11/5/2015	82	0.53 J	<0.45	<0.54	<0.17	NA	NA
	10/13/2016	237	1.50	<0.45	<0.54	<0.17	<1.6	<0.43
	4/3/2017	205	<2.25	<2.05	<1.75	<0.95	NA	NA
	9/1/2017	340	1.95	<0.41	<0.35	<0.19	NA	NA
5/18/2018	44	1.38	<0.37	<0.34	<0.2	<2.1	<0.26	
8/29/2018	3.2	0.59 J	0.50 J	<0.34	<0.2	<2.1	<0.26	
11/28/2018	9.7	7.0	19.5	<0.34	0.76	<2.1	<0.26	
3/18/2019	2.7	0.49 J	20.5	<0.34	7.3	<2.1	<0.26	
6/6/2019 ^a	2.03	0.44 J	11.1	<0.34	3.9	<2.1	1.31	
MW-1D	08/28/09	7.9	<0.48	<0.83	<0.89	<0.18	<0.18	<0.20
	12/03/09	14	<0.48	<0.83	<0.89	<0.18	<0.18	<0.20
	03/10/10	3.2	<0.48	<0.83	<0.89	<0.18	<0.18	<0.20
	06/02/10	4.2	<0.48	<0.83	<0.89	<0.18	<0.18	<0.20
	09/17/10	8.9	<0.48	<0.83	<0.89	<0.18	<0.18	<0.20
	01/07/11	2.7	<0.20	<0.50	<0.50	<0.20	<0.20	<0.20
	04/27/11	2.9	<0.48	<0.83	<0.89	<0.18	<0.18	<0.18
	09/08/11	3.4	<0.48	<0.83	<0.89	<0.18	<0.18	<1.3
	12/19/11	2.0	2.0	<0.50	<0.50	<0.20	0.90 J	<0.20
	02/27/12	1.8 J	<0.96	<0.50	<0.50	<0.20	<0.20	<0.20
	05/22/12	2.5	<0.19	<0.12	<0.25	<0.10	<0.16	<0.20
	6/12/2013	4.4	<0.19	8.5	<0.25	<0.10	<0.16	<0.20
	10/2/2013	0.91 J	0.37 J	2.08	<0.35	<0.18	<1.7	<0.28
	1/3/2014	0.42 J	<0.33	3.8	<0.35	<0.18	<1.7	<0.28
	3/6/2014	6.0	1.87	11.3	<0.35	<0.18	<1.7	<0.28
	5/29/2014	1.37	0.46 J	0.66 J	<0.35	<0.18	<1.7	<0.28
	10/9/2014	0.77 J	<0.33	<0.38	<0.35	<0.18	<1.7	<0.28
	6/23/2015	2.33 J	<0.47	<0.45	<0.54	<0.17	NA	NA
	11/5/2015	2.08	0.53 J	1.01 J	<0.54	<0.17	NA	NA
	10/11/2016	0.57 J	<0.47	<0.45	<0.54	<0.17	<1.6	<0.43
	3/31/2017	<0.48	<0.45	0.85 J	<0.35	<0.19	NA	NA
	9/1/2017	<0.48	<0.45	<0.41	<0.35	<0.19	NA	NA
	5/18/2018	0.66 J	<0.3	<0.37	<0.34	<0.2	<2.1	<0.26
11/28/2018	<0.48	<0.3	0.61 J	<0.34	<0.2	<2.1	<0.26	
6/6/2019	0.51 J	<0.3	<0.37	<0.34	<0.2	<2.1	<0.26	

TABLE 1
MONITORING WELL ANALYTICAL RESULTS
Former One Hour Martinizing Cleaners
Oconomowoc, Wisconsin

Monitoring Well ID	Sample Date	Tetrachloroethene	Trichloroethene	cis-1,2-Dichloroethene	trans-1,2-Dichloroethene	Vinyl chloride	Naphthalene	Chloroform
Preventive Action Limit		0.5	0.5	7	20	0.02	10	0.6
Enforcement Standard		5	5	70	100	0.2	100	6
MW-2	08/28/09	14.4	<0.48	<0.83	<0.89	<0.18	<0.18	<0.18
	12/03/09	31.1	<0.48	<0.83	<0.89	<0.18	<0.18	<0.18
	03/10/10	36.7	<0.48	<0.83	<0.89	<0.18	<0.18	<0.18
	06/02/10	24.2	<0.48	<0.83	<0.89	<0.18	<0.18	<0.18
	09/17/10	47.8	<0.48	<0.83	<0.89	<0.18	<0.18	<0.18
	01/07/11	41	<0.20	<0.50	<0.50	<0.20	<0.20	<0.20
	04/27/11	44.1	<0.48	<0.83	<0.89	<0.18	<0.18	<0.18
	09/08/11	41.7	<0.48	<0.83	<0.89	<0.18	<0.18	<1.3
	12/19/11	51	<0.20	<0.20	<0.20	<0.20	<0.25	<0.20
	02/27/12	45	<0.20	<0.20	<0.20	<0.20	<0.25	<0.20
	05/23/12	37	<0.19	<0.12	<0.25	<0.10	<0.16	<0.20
	6/12/2013	27	<0.19	<0.12	<0.25	<0.10	<0.16	<0.20
	10/2/2013	34	<0.33	<0.38	<0.35	<0.18	<1.7	<0.28
	1/3/2014	29.8	<0.33	<0.38	<0.35	<0.18	<1.7	<0.28
	3/6/2014	37.0	<0.33	<0.38	<0.35	<0.18	<1.7	<0.28
	5/29/2014	27.8	<0.33	<0.38	<0.35	<0.18	<1.7	<0.28
	10/9/2014	18.5	<0.33	<0.38	<0.35	<0.18	<1.7	<0.28
	6/23/2015	16.9	<0.47	<0.45	<0.54	<0.17	NA	NA
	11/5/2015	23	<0.47	<0.45	<0.54	<0.17	NA	NA
	10/13/2016	1.25 J	<0.47	<0.45	<0.54	<0.17	<1.6	<0.43
	3/31/2017	<0.48	<0.45	<0.41	<0.35	<0.19	NA	NA
	9/1/2017	1.82	<0.45	<0.41	<0.35	<0.19	NA	NA
	5/18/2018	4.7	<0.3	<0.37	<0.34	<0.2	<2.1	<0.26
8/29/2018	<0.38	<0.3	<0.37	<0.34	<0.2	<2.1	<0.26	
11/28/2018	<0.38	<0.3	<0.37	<0.34	<0.2	<2.1	<0.26	
3/18/2019	<0.38	<0.3	<0.37	<0.34	<0.2	<2.1	<0.26	
6/6/2019	<0.38	<0.3	<0.37	<0.34	<0.2	<2.1	<0.26	
MW-3	08/28/09	49.5	0.68 J	<0.83	<0.89	<0.18	<0.18	<0.18
	12/03/09	63.3	1.0	<0.83	<0.89	<0.18	<0.18	<0.18
	03/10/10	51.6	0.93 J	<0.83	<0.89	<0.18	<0.18	<0.18
	06/02/10	34.2	0.64 J	<0.83	<0.89	<0.18	<0.18	<0.18
	09/17/10	96.3	3.6	<0.83	<0.89	<0.18	<0.18	<0.18
	01/07/11	83	3.3	<0.64	<0.50	<0.20	<0.20	<0.20
	04/27/11	72.9	2.7	<0.83	<0.89	<0.18	<0.18	<0.20
	09/08/11	74.4	2.7	<0.83	<0.89	<0.18	<0.18	<1.3
	12/19/11	66	1.2 J	<0.50	<0.50	<0.20	<0.25	<0.20
	02/28/12	70	1.2 J	<0.20	<0.20	<0.20	<0.25	<0.20
	05/23/12	57	1.3	<0.12	<0.25	<0.10	<0.16	<0.20
	6/12/2013	52	2.2	<0.12	<0.25	<0.10	<0.16	<0.20
	10/2/2013	65	3.5	<0.38	<0.35	<0.18	<1.7	<0.28
	1/2/2014	55	1.88	<0.38	<0.35	<0.18	<1.7	<0.28
	3/6/2014	68	2.07	<0.38	<0.35	<0.18	<1.7	<0.28
	5/29/2014	56	2.22	<0.38	<0.35	<0.18	<1.7	<0.28
	10/8/2014	58	1.78	<0.38	<0.35	<0.18	<1.7	<0.28
	6/23/2015	64	1.55	<0.45	<0.54	<0.17	NA	NA
	11/4/2015	54	2.06	<0.45	<0.54	<0.17	NA	NA
	10/13/2016	63	1.91	<0.45	<0.54	<0.17	<1.6	<0.43
	3/30/2017	62	1.38 J	<0.41	<0.35	<0.19	NA	NA
	9/1/2017	51	1.28 J	<0.41	<0.35	<0.19	NA	NA
	5/18/2018	52	1.23	<0.37	<0.34	<0.2	<2.1	<0.26
8/29/2018	41	0.79 J	<0.37	<0.34	<0.2	<2.1	<0.26	
11/27/2018	54	0.89 J	<0.37	<0.34	<0.2	<2.1	<0.26	
3/18/2019	44	0.72 J	<0.37	<0.34	<0.2	<2.1	<0.26	
6/6/2019	47	0.54 J	<0.37	<0.34	<0.2	<2.1	<0.26	
MW-4	01/07/11	46	<0.20	<0.50	<0.50	<0.20	<0.20	<0.20
	04/27/11	69	<0.48	<0.83	<0.89	<0.18	<0.18	<0.20
	09/08/11	29	<0.48	<0.83	<0.89	<0.18	<0.18	<1.3
	12/19/11	23	<0.20	<0.50	<0.50	<0.20	<0.25	<0.20
	02/27/12	19	<0.20	<0.50	<0.50	<0.20	<0.25	<0.20
	05/23/12	35	<0.19	<0.12	<0.25	<0.10	<0.16	<0.20
	6/12/2013	30	<0.19	<0.12	<0.25	<0.10	<0.16	<0.20
	10/2/2013	53	<0.33	<0.38	<0.35	<0.18	<1.7	<0.28
	1/2/2014	19.5	<0.33	<0.38	<0.35	<0.18	<1.7	<0.28
	3/5/2014	32.0	<0.33	<0.38	<0.35	<0.18	<1.7	<0.28
	5/28/2014	13.3	<0.33	<0.38	<0.35	<0.18	<1.7	<0.28
	10/8/2014	12.7	<0.33	<0.38	<0.35	<0.18	<1.7	<0.28
	6/23/2015	14.8	<0.47	<0.45	<0.54	<0.17	NA	NA
	11/4/2015	11.8	<0.47	<0.54	<0.45	<0.54	NA	NA
	10/13/2016	17.2	<0.47	<0.54	<0.45	<0.54	<1.6	<0.43
	4/3/2017	27.1	<0.45	<0.41	<0.35	<0.19	NA	NA
	9/1/2017	31.4	<0.45	<0.41	<0.35	<0.19	NA	NA
	5/18/2018	30.1	<0.3	<0.37	<0.34	<0.2	<2.1	<0.26
	8/29/2018	35	<0.3	<0.37	<0.34	<0.2	<2.1	<0.26
	11/27/2018	52	<0.3	<0.37	<0.34	<0.2	<2.1	<0.26
	3/18/2019	33	<0.3	<0.37	<0.34	<0.2	<2.1	<0.26
	6/6/2019	11.3	<0.3	<0.37	<0.34	<0.2	<2.1	<0.26

TABLE 1
MONITORING WELL ANALYTICAL RESULTS
Former One Hour Martinizing Cleaners
Oconomowoc, Wisconsin

Monitoring Well ID	Sample Date	Tetrachloroethene	Trichloroethene	cis-1,2-Dichloroethene	trans-1,2-Dichloroethene	Vinyl chloride	Naphthalene	Chloroform
Preventive Action Limit		0.5	0.5	7	20	0.02	10	0.6
Enforcement Standard		5	5	70	100	0.2	100	6
MW-5	01/07/11	140	0.86	<0.50	<0.50	<0.20	<0.20	<0.20
	04/27/11	133	0.77 J	<0.83	<0.89	<0.18	<0.18	<0.20
	09/08/11	121	<0.48	<0.83	<0.89	<0.18	<0.18	<1.3
	12/19/11	110	0.41 J	<0.50	<0.50	<0.20	<0.50	<0.20
	02/28/12	140	0.62 J	<0.50	<0.50	<0.20	<0.50	<0.20
	05/23/12	89	0.49 J	<0.12	<0.25	<0.10	<0.16	<0.20
	6/12/2013	98	0.58	<0.12	<0.25	<0.10	<0.16	<0.20
	10/2/2013	105	0.75 J	<0.38	<0.35	<0.18	<1.7	<0.28
	1/3/2014	160	1.34	<0.38	<0.35	<0.18	<1.7	<0.28
	3/6/2014	180	1.93	<0.38	<0.35	<0.18	<1.7	<0.28
	5/29/2014	162	0.96 J	<0.38	<0.35	<0.18	<1.7	<0.28
	10/9/2014	116	1.23	<0.38	<0.35	<0.18	<1.7	<0.28
	6/23/2015	152	0.89 J	<0.45	<0.54	<0.17	NA	NA
	11/5/2015	158	<4.7	<4.5	<5.4	<1.7	NA	NA
	10/13/2016	132	0.68	<0.45	<0.54	<0.17	<1.6	<0.43
	4/3/2017	67	<0.45	<0.41	<0.35	<0.19	NA	NA
	8/31/2017	68	<0.45	0.43 J	<0.35	<0.19	NA	NA
	5/18/2018	99	<0.3	<0.37	<0.34	<0.2	<2.1	<0.26
8/29/2018	43	<0.3	0.47 J	<0.34	<0.2	<2.1	<0.26	
11/28/2018	39	0.58 J	0.61 J	<0.34	<0.2	<2.1	<0.26	
3/18/2019	27.2	0.83 J	<0.37	<0.34	<0.2	<2.1	<0.26	
6/7/2019	19.5	1.41	<0.37	<0.34	<0.2	<2.1	<0.26	
MW-6	01/07/11	41	0.38	<0.50	<0.50	<0.20	<0.20	<0.20
	04/27/11	47.3	<0.48	<0.83	<0.89	<0.18	<0.18	<0.20
	09/08/11	39.2	<0.48	<0.83	<0.89	<0.18	<0.18	<1.3
	12/19/11	43	0.27 J	<0.50	<0.50	<0.20	<0.25	<0.20
	02/28/12	36	0.21 J	<0.50	<0.50	<0.20	<0.25	<0.20
	05/23/12	27	<0.19	<0.12	<0.25	<0.10	<0.16	<0.20
	6/11/2013	19	<0.19	<0.12	<0.25	<0.10	<0.16	<0.20
	10/1/2013	28.8	0.34 J	<0.38	<0.35	<0.18	<1.7	<0.28
	1/3/2014	36	0.71 J	<0.38	<0.35	0.21 J	<1.7	<0.28
	3/6/2014	33	<0.33	<0.38	<0.35	<0.18	<1.7	<0.28
	5/29/2014	40	0.51 J	<0.38	<0.35	<0.18	<1.7	<0.28
	10/9/2014	34	0.37 J	<0.38	<0.35	<0.18	<1.7	<0.28
	6/23/2015	45	<0.47	<0.45	<0.54	<0.17	NA	NA
	11/5/2015	36	<0.47	<0.45	<0.54	<0.17	NA	NA
	10/13/2016	26.3	<0.47	<0.45	<0.54	<0.17	<1.6	<0.43
	4/3/2017	29.8	<0.45	<0.41	<0.35	<0.19	NA	NA
	9/1/2017	22.2	<0.45	<0.41	<0.35	<0.19	NA	NA
	5/18/2018	55	0.62 J	<0.37	<0.34	<0.2	<2.1	<0.26
8/29/2018	27	<0.3	<0.37	<0.34	<0.2	<2.1	<0.26	
11/27/2018	36	<0.3	<0.37	<0.34	<0.2	<2.1	<0.26	
3/18/2019	35	<0.3	<0.37	<0.34	<0.2	<2.1	<0.26	
6/6/2019	29.5	<0.3	<0.37	<0.34	<0.2	<2.1	<0.26	
MW-11	6/11/2013	12	<0.19	<0.12	<0.25	<0.10	<0.16	<0.20
	10/1/2013	30.4	<0.33	<0.38	<0.35	<0.18	<1.7	<0.28
	1/3/2014	38	<0.33	<0.38	<0.35	<0.18	<1.7	<0.28
	3/5/2014	34	<0.33	<0.38	<0.35	<0.18	<1.7	<0.28
	5/29/2014	34	<0.33	<0.38	<0.35	<0.18	<1.7	<0.28
	10/8/2014	25	<0.33	<0.38	<0.35	<0.18	<1.7	<0.28
	6/22/2015	24	<0.47	<0.45	<0.54	<0.17	NA	NA
	11/6/2015	12.6	<0.47	<0.45	<0.54	<0.17	NA	NA
	10/13/2016	23.5	<0.47	<0.45	<0.54	<0.17	<1.6	<0.43
	4/3/2017	23.8	<0.45	<0.41	<0.35	<0.19	NA	NA
	9/1/2017	14.5	0.48 J	<0.41	<0.35	<0.19	NA	NA
	5/18/2018	20.6	0.35 J	0.76 J	<0.34	<0.2	<2.1	<0.26
	8/29/2018	26.9	<0.3	<0.37	<0.34	<0.2	<2.1	<0.26
	11/27/2018	<0.38	<0.3	<0.37	<0.34	<0.2	<2.1	<0.26
3/18/2019	1.37	<0.3	0.46 J	<0.34	<0.2	<2.1	<0.26	
6/6/2019	4.1	<0.3	<0.37	<0.34	<0.2	<2.1	<0.26	

Notes:

Samples analyzed using EPA SW-846 Method 8260

All concentrations reported in µg/L

Bolded and orange shaded values are above Public Health Enforcement Standards

Bolded and blue shaded values are above Public Health Preventive Action Limits

J=Analyte concentration detected between the laboratory Reporting Limit and the laboratory Method Detection Limit

NA = Not Analyzed

³ = Methyl Chloride detected at a concentration above the preventive action limit

Synergy Environmental Lab, INC

1990 Prospect Ct., Appleton, WI 54914 *P 920-830-2455 * F 920-733-0631

WAYNE FASSBENDER
 ENVIROFORENSICS
 N16 W 23390 STONERIDGE DR
 WAUKESHA WI 53188

Report Date 25-Jun-19

Project Name OHM-OCONOMOWOC
 Project # 6143 PO#2019-0523

Invoice # E36303

Lab Code 5036303A
 Sample ID 6143 MW-1
 Sample Matrix Water
 Sample Date 6/7/2019

	Result	Unit	LOD	LOQ	Dil	Method	Ext Date	Run Date	Analyst	Code
Inorganic										
Metals										
Iron, Dissolved	0.04	mg/l	0.03	0.1	1	200.7		6/10/2019	CWT	1
Iron, Total	0.78	mg/l	0.03	0.1	1	200.7		6/10/2019	CWT	1
Organic										
GASES										
Ethane	0.894 "J"	ug/l	0.5	1.5	1	8015		6/20/2019	MJR	1
Ethene	< 0.5	ug/l	0.5	1.5	1	8015		6/20/2019	MJR	1
Methane	7460	ug/l	20	60	20	8015		6/20/2019	MJR	1
VOC's										
Benzene	< 0.22	ug/l	0.22	0.71	1	8260B		6/11/2019	CJR	1
Bromobenzene	< 0.44	ug/l	0.44	1.38	1	8260B		6/11/2019	CJR	1
Bromodichloromethane	< 0.33	ug/l	0.33	1.06	1	8260B		6/11/2019	CJR	1
Bromoform	< 0.45	ug/l	0.45	1.44	1	8260B		6/11/2019	CJR	1
tert-Butylbenzene	< 0.25	ug/l	0.25	0.8	1	8260B		6/11/2019	CJR	1
sec-Butylbenzene	< 0.79	ug/l	0.79	2.53	1	8260B		6/11/2019	CJR	1
n-Butylbenzene	< 0.71	ug/l	0.71	2.25	1	8260B		6/11/2019	CJR	1
Carbon Tetrachloride	< 0.31	ug/l	0.31	0.98	1	8260B		6/11/2019	CJR	1
Chlorobenzene	< 0.26	ug/l	0.26	0.83	1	8260B		6/11/2019	CJR	1
Chloroethane	< 0.61	ug/l	0.61	1.95	1	8260B		6/11/2019	CJR	1
Chloroform	1.31	ug/l	0.26	0.82	1	8260B		6/11/2019	CJR	1
Chloromethane	< 0.54	ug/l	0.54	1.72	1	8260B		6/11/2019	CJR	1
2-Chlorotoluene	< 0.31	ug/l	0.31	0.98	1	8260B		6/11/2019	CJR	1
4-Chlorotoluene	< 0.26	ug/l	0.26	0.83	1	8260B		6/11/2019	CJR	1
1,2-Dibromo-3-chloropropane	< 2.96	ug/l	2.96	9.43	1	8260B		6/11/2019	CJR	1
Dibromochloromethane	< 0.22	ug/l	0.22	0.69	1	8260B		6/11/2019	CJR	1
1,4-Dichlorobenzene	< 0.7	ug/l	0.7	2.22	1	8260B		6/11/2019	CJR	1

Project Name OHM-OCONOMOWOC
 Project # 6143 PO#2019-0523

Invoice # E36303

Lab Code 5036303A
 Sample ID 6143 MW-1
 Sample Matrix Water
 Sample Date 6/7/2019

	Result	Unit	LOD	LOQ	Dil	Method	Ext Date	Run Date	Analyst	Code
1,3-Dichlorobenzene	< 0.85	ug/l	0.85	2.7	1	8260B		6/11/2019	CJR	1
1,2-Dichlorobenzene	< 0.86	ug/l	0.86	2.74	1	8260B		6/11/2019	CJR	1
Dichlorodifluoromethane	< 0.32	ug/l	0.32	1.02	1	8260B		6/11/2019	CJR	1
1,2-Dichloroethane	< 0.25	ug/l	0.25	0.78	1	8260B		6/11/2019	CJR	1
1,1-Dichloroethane	< 0.36	ug/l	0.36	1.14	1	8260B		6/11/2019	CJR	1
1,1-Dichloroethene	< 0.42	ug/l	0.42	1.34	1	8260B		6/11/2019	CJR	1
cis-1,2-Dichloroethene	11.1	ug/l	0.37	1.16	1	8260B		6/11/2019	CJR	1
trans-1,2-Dichloroethene	< 0.34	ug/l	0.34	1.07	1	8260B		6/11/2019	CJR	1
1,2-Dichloropropane	< 0.44	ug/l	0.44	1.39	1	8260B		6/11/2019	CJR	1
1,3-Dichloropropane	< 0.3	ug/l	0.3	0.94	1	8260B		6/11/2019	CJR	1
trans-1,3-Dichloropropene	< 0.32	ug/l	0.32	1.01	1	8260B		6/11/2019	CJR	1
cis-1,3-Dichloropropene	< 0.26	ug/l	0.26	0.81	1	8260B		6/11/2019	CJR	1
Di-isopropyl ether	< 0.21	ug/l	0.21	0.66	1	8260B		6/11/2019	CJR	1
EDB (1,2-Dibromoethane)	< 0.34	ug/l	0.34	1.09	1	8260B		6/11/2019	CJR	1
Ethylbenzene	< 0.26	ug/l	0.26	0.83	1	8260B		6/11/2019	CJR	1
Hexachlorobutadiene	< 1.34	ug/l	1.34	4.28	1	8260B		6/11/2019	CJR	1
Isopropylbenzene	< 0.78	ug/l	0.78	2.47	1	8260B		6/11/2019	CJR	1
p-Isopropyltoluene	< 0.24	ug/l	0.24	0.76	1	8260B		6/11/2019	CJR	1
Methylene chloride	1.73 "J"	ug/l	1.32	4.21	1	8260B		6/11/2019	CJR	1
Methyl tert-butyl ether (MTBE)	< 0.28	ug/l	0.28	0.89	1	8260B		6/11/2019	CJR	1
Naphthalene	< 2.1	ug/l	2.1	6.65	1	8260B		6/11/2019	CJR	1
n-Propylbenzene	< 0.61	ug/l	0.61	1.95	1	8260B		6/11/2019	CJR	1
1,1,2,2-Tetrachloroethane	< 0.3	ug/l	0.3	0.97	1	8260B		6/11/2019	CJR	1
1,1,1,2-Tetrachloroethane	< 0.35	ug/l	0.35	1.13	1	8260B		6/11/2019	CJR	1
Tetrachloroethene	2.03	ug/l	0.38	1.21	1	8260B		6/11/2019	CJR	1
Toluene	< 0.19	ug/l	0.19	0.6	1	8260B		6/11/2019	CJR	1
1,2,4-Trichlorobenzene	< 1.15	ug/l	1.15	3.67	1	8260B		6/11/2019	CJR	1
1,2,3-Trichlorobenzene	< 1.71	ug/l	1.71	5.43	1	8260B		6/11/2019	CJR	1
1,1,1-Trichloroethane	< 0.33	ug/l	0.33	1.05	1	8260B		6/11/2019	CJR	1
1,1,2-Trichloroethane	< 0.42	ug/l	0.42	1.32	1	8260B		6/11/2019	CJR	1
Trichloroethene (TCE)	0.44 "J"	ug/l	0.3	0.94	1	8260B		6/11/2019	CJR	1
Trichlorofluoromethane	< 0.35	ug/l	0.35	1.1	1	8260B		6/11/2019	CJR	1
1,2,4-Trimethylbenzene	< 0.8	ug/l	0.8	2.55	1	8260B		6/11/2019	CJR	1
1,3,5-Trimethylbenzene	< 0.63	ug/l	0.63	2	1	8260B		6/11/2019	CJR	1
Vinyl Chloride	3.9	ug/l	0.2	0.65	1	8260B		6/11/2019	CJR	1
m&p-Xylene	< 0.43	ug/l	0.43	1.38	1	8260B		6/11/2019	CJR	1
o-Xylene	< 0.29	ug/l	0.29	0.93	1	8260B		6/11/2019	CJR	1
SUR - 1,2-Dichloroethane-d4	98	REC %			1	8260B		6/11/2019	CJR	1
SUR - Toluene-d8	97	REC %			1	8260B		6/11/2019	CJR	1
SUR - 4-Bromofluorobenzene	96	REC %			1	8260B		6/11/2019	CJR	1
SUR - Dibromofluoromethane	102	REC %			1	8260B		6/11/2019	CJR	1
Wet Chemistry										
General										
Nitrate Nitrogen, Total	< 0.47	mg/l	0.47	1.56	1	353.2		6/12/2019	NJC	1
Nitrite Nitrogen, Total	0.017 "J"	mg/l	0.014	0.048	1	353.2		6/10/2019	NJC	1
Sulfate, Unfiltered	17.3	mg/l	3.37	11.23	1	ASTM D516-5		6/14/2019	NJC	1

Project Name OHM-OCONOMOWOC
 Project # 6143 PO#2019-0523

Invoice # E36303

Lab Code 5036303B
 Sample ID 6143 MW-1D
 Sample Matrix Water
 Sample Date 6/6/2019

	Result	Unit	LOD	LOQ	Dil	Method	Ext Date	Run Date	Analyst	Code
Organic										
VOC's										
Benzene	< 0.22	ug/l	0.22	0.71	1	8260B		6/11/2019	CJR	1
Bromobenzene	< 0.44	ug/l	0.44	1.38	1	8260B		6/11/2019	CJR	1
Bromodichloromethane	< 0.33	ug/l	0.33	1.06	1	8260B		6/11/2019	CJR	1
Bromoförm	< 0.45	ug/l	0.45	1.44	1	8260B		6/11/2019	CJR	1
tert-Butylbenzene	< 0.25	ug/l	0.25	0.8	1	8260B		6/11/2019	CJR	1
sec-Butylbenzene	< 0.79	ug/l	0.79	2.53	1	8260B		6/11/2019	CJR	1
n-Butylbenzene	< 0.71	ug/l	0.71	2.25	1	8260B		6/11/2019	CJR	1
Carbon Tetrachloride	< 0.31	ug/l	0.31	0.98	1	8260B		6/11/2019	CJR	1
Chlorobenzene	< 0.26	ug/l	0.26	0.83	1	8260B		6/11/2019	CJR	1
Chloroethane	< 0.61	ug/l	0.61	1.95	1	8260B		6/11/2019	CJR	1
Chloroförm	< 0.26	ug/l	0.26	0.82	1	8260B		6/11/2019	CJR	1
Chloromethane	< 0.54	ug/l	0.54	1.72	1	8260B		6/11/2019	CJR	1
2-Chlorotoluene	< 0.31	ug/l	0.31	0.98	1	8260B		6/11/2019	CJR	1
4-Chlorotoluene	< 0.26	ug/l	0.26	0.83	1	8260B		6/11/2019	CJR	1
1,2-Dibromo-3-chloropropane	< 2.96	ug/l	2.96	9.43	1	8260B		6/11/2019	CJR	1
Dibromochloromethane	< 0.22	ug/l	0.22	0.69	1	8260B		6/11/2019	CJR	1
1,4-Dichlorobenzene	< 0.7	ug/l	0.7	2.22	1	8260B		6/11/2019	CJR	1
1,3-Dichlorobenzene	< 0.85	ug/l	0.85	2.7	1	8260B		6/11/2019	CJR	1
1,2-Dichlorobenzene	< 0.86	ug/l	0.86	2.74	1	8260B		6/11/2019	CJR	1
Dichlorodifluoromethane	< 0.32	ug/l	0.32	1.02	1	8260B		6/11/2019	CJR	1
1,2-Dichloroethane	< 0.25	ug/l	0.25	0.78	1	8260B		6/11/2019	CJR	1
1,1-Dichloroethane	< 0.36	ug/l	0.36	1.14	1	8260B		6/11/2019	CJR	1
1,1-Dichloroethene	< 0.42	ug/l	0.42	1.34	1	8260B		6/11/2019	CJR	1
cis-1,2-Dichloroethene	< 0.37	ug/l	0.37	1.16	1	8260B		6/11/2019	CJR	1
trans-1,2-Dichloroethene	< 0.34	ug/l	0.34	1.07	1	8260B		6/11/2019	CJR	1
1,2-Dichloropropane	< 0.44	ug/l	0.44	1.39	1	8260B		6/11/2019	CJR	1
1,3-Dichloropropane	< 0.3	ug/l	0.3	0.94	1	8260B		6/11/2019	CJR	1
trans-1,3-Dichloropropene	< 0.32	ug/l	0.32	1.01	1	8260B		6/11/2019	CJR	1
cis-1,3-Dichloropropene	< 0.26	ug/l	0.26	0.81	1	8260B		6/11/2019	CJR	1
Di-isopropyl ether	< 0.21	ug/l	0.21	0.66	1	8260B		6/11/2019	CJR	1
EDB (1,2-Dibromoethane)	< 0.34	ug/l	0.34	1.09	1	8260B		6/11/2019	CJR	1
Ethylbenzene	< 0.26	ug/l	0.26	0.83	1	8260B		6/11/2019	CJR	1
Hexachlorobutadiene	< 1.34	ug/l	1.34	4.28	1	8260B		6/11/2019	CJR	1
Isopropylbenzene	< 0.78	ug/l	0.78	2.47	1	8260B		6/11/2019	CJR	1
p-Isopropyltoluene	< 0.24	ug/l	0.24	0.76	1	8260B		6/11/2019	CJR	1
Methylene chloride	< 1.32	ug/l	1.32	4.21	1	8260B		6/11/2019	CJR	1
Methyl tert-butyl ether (MTBE)	< 0.28	ug/l	0.28	0.89	1	8260B		6/11/2019	CJR	1
Naphthalene	< 2.1	ug/l	2.1	6.65	1	8260B		6/11/2019	CJR	1
n-Propylbenzene	< 0.61	ug/l	0.61	1.95	1	8260B		6/11/2019	CJR	1
1,1,2,2-Tetrachloroethane	< 0.3	ug/l	0.3	0.97	1	8260B		6/11/2019	CJR	1
1,1,1,2-Tetrachloroethane	< 0.35	ug/l	0.35	1.13	1	8260B		6/11/2019	CJR	1
Tetrachloroethene	0.51 "J"	ug/l	0.38	1.21	1	8260B		6/11/2019	CJR	1
Toluene	< 0.19	ug/l	0.19	0.6	1	8260B		6/11/2019	CJR	1
1,2,4-Trichlorobenzene	< 1.15	ug/l	1.15	3.67	1	8260B		6/11/2019	CJR	1

Project Name OHM-OCONOMOWOC
Project # 6143 PO#2019-0523

Invoice # E36303

Lab Code 5036303B
Sample ID 6143 MW-1D
Sample Matrix Water
Sample Date 6/6/2019

	Result	Unit	LOD	LOQ	Dil	Method	Ext Date	Run Date	Analyst	Code
1,2,3-Trichlorobenzene	< 1.71	ug/l	1.71	5.43	1	8260B		6/11/2019	CJR	1
1,1,1-Trichloroethane	< 0.33	ug/l	0.33	1.05	1	8260B		6/11/2019	CJR	1
1,1,2-Trichloroethane	< 0.42	ug/l	0.42	1.32	1	8260B		6/11/2019	CJR	1
Trichloroethene (TCE)	< 0.3	ug/l	0.3	0.94	1	8260B		6/11/2019	CJR	1
Trichlorofluoromethane	< 0.35	ug/l	0.35	1.1	1	8260B		6/11/2019	CJR	1
1,2,4-Trimethylbenzene	< 0.8	ug/l	0.8	2.55	1	8260B		6/11/2019	CJR	1
1,3,5-Trimethylbenzene	< 0.63	ug/l	0.63	2	1	8260B		6/11/2019	CJR	1
Vinyl Chloride	< 0.2	ug/l	0.2	0.65	1	8260B		6/11/2019	CJR	1
m&p-Xylene	< 0.43	ug/l	0.43	1.38	1	8260B		6/11/2019	CJR	1
o-Xylene	< 0.29	ug/l	0.29	0.93	1	8260B		6/11/2019	CJR	1
SUR - Toluene-d8	96	REC %			1	8260B		6/11/2019	CJR	1
SUR - Dibromofluoromethane	99	REC %			1	8260B		6/11/2019	CJR	1
SUR - 1,2-Dichloroethane-d4	101	REC %			1	8260B		6/11/2019	CJR	1
SUR - 4-Bromofluorobenzene	90	REC %			1	8260B		6/11/2019	CJR	1

Project Name OHM-OCONOMOWOC
 Project # 6143 PO#2019-0523

Invoice # E36303

Lab Code 5036303C
 Sample ID 6143 MW-2
 Sample Matrix Water
 Sample Date 6/6/2019

	Result	Unit	LOD	LOQ	Dil	Method	Ext Date	Run Date	Analyst	Code
Organic										
VOC's										
Benzene	< 0.22	ug/l	0.22	0.71	1	8260B		6/12/2019	CJR	1
Bromobenzene	< 0.44	ug/l	0.44	1.38	1	8260B		6/12/2019	CJR	1
Bromodichloromethane	< 0.33	ug/l	0.33	1.06	1	8260B		6/12/2019	CJR	1
Bromoform	< 0.45	ug/l	0.45	1.44	1	8260B		6/12/2019	CJR	1
tert-Butylbenzene	< 0.25	ug/l	0.25	0.8	1	8260B		6/12/2019	CJR	1
sec-Butylbenzene	< 0.79	ug/l	0.79	2.53	1	8260B		6/12/2019	CJR	1
n-Butylbenzene	< 0.71	ug/l	0.71	2.25	1	8260B		6/12/2019	CJR	1
Carbon Tetrachloride	< 0.31	ug/l	0.31	0.98	1	8260B		6/12/2019	CJR	1
Chlorobenzene	< 0.26	ug/l	0.26	0.83	1	8260B		6/12/2019	CJR	1
Chloroethane	< 0.61	ug/l	0.61	1.95	1	8260B		6/12/2019	CJR	1
Chloroform	< 0.26	ug/l	0.26	0.82	1	8260B		6/12/2019	CJR	1
Chloromethane	< 0.54	ug/l	0.54	1.72	1	8260B		6/12/2019	CJR	1
2-Chlorotoluene	< 0.31	ug/l	0.31	0.98	1	8260B		6/12/2019	CJR	1
4-Chlorotoluene	< 0.26	ug/l	0.26	0.83	1	8260B		6/12/2019	CJR	1
1,2-Dibromo-3-chloropropane	< 2.96	ug/l	2.96	9.43	1	8260B		6/12/2019	CJR	1
Dibromochloromethane	< 0.22	ug/l	0.22	0.69	1	8260B		6/12/2019	CJR	1
1,4-Dichlorobenzene	< 0.7	ug/l	0.7	2.22	1	8260B		6/12/2019	CJR	1
1,3-Dichlorobenzene	< 0.85	ug/l	0.85	2.7	1	8260B		6/12/2019	CJR	1
1,2-Dichlorobenzene	< 0.86	ug/l	0.86	2.74	1	8260B		6/12/2019	CJR	1
Dichlorodifluoromethane	< 0.32	ug/l	0.32	1.02	1	8260B		6/12/2019	CJR	1
1,2-Dichloroethane	< 0.25	ug/l	0.25	0.78	1	8260B		6/12/2019	CJR	1
1,1-Dichloroethane	< 0.36	ug/l	0.36	1.14	1	8260B		6/12/2019	CJR	1
1,1-Dichloroethene	< 0.42	ug/l	0.42	1.34	1	8260B		6/12/2019	CJR	1
cis-1,2-Dichloroethene	< 0.37	ug/l	0.37	1.16	1	8260B		6/12/2019	CJR	1
trans-1,2-Dichloroethene	< 0.34	ug/l	0.34	1.07	1	8260B		6/12/2019	CJR	1
1,2-Dichloropropane	< 0.44	ug/l	0.44	1.39	1	8260B		6/12/2019	CJR	1
1,3-Dichloropropane	< 0.3	ug/l	0.3	0.94	1	8260B		6/12/2019	CJR	1
trans-1,3-Dichloropropene	< 0.32	ug/l	0.32	1.01	1	8260B		6/12/2019	CJR	1
cis-1,3-Dichloropropene	< 0.26	ug/l	0.26	0.81	1	8260B		6/12/2019	CJR	1
Di-isopropyl ether	< 0.21	ug/l	0.21	0.66	1	8260B		6/12/2019	CJR	1
EDB (1,2-Dibromoethane)	< 0.34	ug/l	0.34	1.09	1	8260B		6/12/2019	CJR	1
Ethylbenzene	< 0.26	ug/l	0.26	0.83	1	8260B		6/12/2019	CJR	1
Hexachlorobutadiene	< 1.34	ug/l	1.34	4.28	1	8260B		6/12/2019	CJR	1
Isopropylbenzene	< 0.78	ug/l	0.78	2.47	1	8260B		6/12/2019	CJR	1
p-Isopropyltoluene	< 0.24	ug/l	0.24	0.76	1	8260B		6/12/2019	CJR	1
Methylene chloride	< 1.32	ug/l	1.32	4.21	1	8260B		6/12/2019	CJR	1
Methyl tert-butyl ether (MTBE)	< 0.28	ug/l	0.28	0.89	1	8260B		6/12/2019	CJR	1
Naphthalene	< 2.1	ug/l	2.1	6.65	1	8260B		6/12/2019	CJR	1
n-Propylbenzene	< 0.61	ug/l	0.61	1.95	1	8260B		6/12/2019	CJR	1
1,1,2,2-Tetrachloroethane	< 0.3	ug/l	0.3	0.97	1	8260B		6/12/2019	CJR	1
1,1,1,2-Tetrachloroethane	< 0.35	ug/l	0.35	1.13	1	8260B		6/12/2019	CJR	1
Tetrachloroethene	< 0.38	ug/l	0.38	1.21	1	8260B		6/12/2019	CJR	1
Toluene	< 0.19	ug/l	0.19	0.6	1	8260B		6/12/2019	CJR	1
1,2,4-Trichlorobenzene	< 1.15	ug/l	1.15	3.67	1	8260B		6/12/2019	CJR	1

Project Name OHM-OCONOMOWOC
Project # 6143 PO#2019-0523

Invoice # E36303

Lab Code 5036303C
Sample ID 6143 MW-2
Sample Matrix Water
Sample Date 6/6/2019

	Result	Unit	LOD	LOQ	Dil	Method	Ext Date	Run Date	Analyst	Code
1,2,3-Trichlorobenzene	< 1.71	ug/l	1.71	5.43	1	8260B		6/12/2019	CJR	1
1,1,1-Trichloroethane	< 0.33	ug/l	0.33	1.05	1	8260B		6/12/2019	CJR	1
1,1,2-Trichloroethane	< 0.42	ug/l	0.42	1.32	1	8260B		6/12/2019	CJR	1
Trichloroethene (TCE)	< 0.3	ug/l	0.3	0.94	1	8260B		6/12/2019	CJR	1
Trichlorofluoromethane	< 0.35	ug/l	0.35	1.1	1	8260B		6/12/2019	CJR	1
1,2,4-Trimethylbenzene	< 0.8	ug/l	0.8	2.55	1	8260B		6/12/2019	CJR	1
1,3,5-Trimethylbenzene	< 0.63	ug/l	0.63	2	1	8260B		6/12/2019	CJR	1
Vinyl Chloride	< 0.2	ug/l	0.2	0.65	1	8260B		6/12/2019	CJR	1
m&p-Xylene	< 0.43	ug/l	0.43	1.38	1	8260B		6/12/2019	CJR	1
o-Xylene	< 0.29	ug/l	0.29	0.93	1	8260B		6/12/2019	CJR	1
SUR - 1,2-Dichloroethane-d4	110	REC %			1	8260B		6/12/2019	CJR	1
SUR - 4-Bromofluorobenzene	94	REC %			1	8260B		6/12/2019	CJR	1
SUR - Dibromofluoromethane	103	REC %			1	8260B		6/12/2019	CJR	1
SUR - Toluene-d8	95	REC %			1	8260B		6/12/2019	CJR	1

Project Name OHM-OCONOMOWOC
 Project # 6143 PO#2019-0523

Invoice # E36303

Lab Code 5036303D
 Sample ID 6143 MW-3
 Sample Matrix Water
 Sample Date 6/6/2019

	Result	Unit	LOD	LOQ	Dil	Method	Ext Date	Run Date	Analyst	Code
Organic										
VOC's										
Benzene	< 0.22	ug/l	0.22	0.71	1	8260B		6/12/2019	CJR	1
Bromobenzene	< 0.44	ug/l	0.44	1.38	1	8260B		6/12/2019	CJR	1
Bromodichloromethane	< 0.33	ug/l	0.33	1.06	1	8260B		6/12/2019	CJR	1
Bromoform	< 0.45	ug/l	0.45	1.44	1	8260B		6/12/2019	CJR	1
tert-Butylbenzene	< 0.25	ug/l	0.25	0.8	1	8260B		6/12/2019	CJR	1
sec-Butylbenzene	< 0.79	ug/l	0.79	2.53	1	8260B		6/12/2019	CJR	1
n-Butylbenzene	< 0.71	ug/l	0.71	2.25	1	8260B		6/12/2019	CJR	1
Carbon Tetrachloride	< 0.31	ug/l	0.31	0.98	1	8260B		6/12/2019	CJR	1
Chlorobenzene	< 0.26	ug/l	0.26	0.83	1	8260B		6/12/2019	CJR	1
Chloroethane	< 0.61	ug/l	0.61	1.95	1	8260B		6/12/2019	CJR	1
Chloroform	< 0.26	ug/l	0.26	0.82	1	8260B		6/12/2019	CJR	1
Chloromethane	< 0.54	ug/l	0.54	1.72	1	8260B		6/12/2019	CJR	1
2-Chlorotoluene	< 0.31	ug/l	0.31	0.98	1	8260B		6/12/2019	CJR	1
4-Chlorotoluene	< 0.26	ug/l	0.26	0.83	1	8260B		6/12/2019	CJR	1
1,2-Dibromo-3-chloropropane	< 2.96	ug/l	2.96	9.43	1	8260B		6/12/2019	CJR	1
Dibromochloromethane	< 0.22	ug/l	0.22	0.69	1	8260B		6/12/2019	CJR	1
1,4-Dichlorobenzene	< 0.7	ug/l	0.7	2.22	1	8260B		6/12/2019	CJR	1
1,3-Dichlorobenzene	< 0.85	ug/l	0.85	2.7	1	8260B		6/12/2019	CJR	1
1,2-Dichlorobenzene	< 0.86	ug/l	0.86	2.74	1	8260B		6/12/2019	CJR	1
Dichlorodifluoromethane	< 0.32	ug/l	0.32	1.02	1	8260B		6/12/2019	CJR	1
1,2-Dichloroethane	< 0.25	ug/l	0.25	0.78	1	8260B		6/12/2019	CJR	1
1,1-Dichloroethane	< 0.36	ug/l	0.36	1.14	1	8260B		6/12/2019	CJR	1
1,1-Dichloroethene	< 0.42	ug/l	0.42	1.34	1	8260B		6/12/2019	CJR	1
cis-1,2-Dichloroethene	< 0.37	ug/l	0.37	1.16	1	8260B		6/12/2019	CJR	1
trans-1,2-Dichloroethene	< 0.34	ug/l	0.34	1.07	1	8260B		6/12/2019	CJR	1
1,2-Dichloropropane	< 0.44	ug/l	0.44	1.39	1	8260B		6/12/2019	CJR	1
1,3-Dichloropropane	< 0.3	ug/l	0.3	0.94	1	8260B		6/12/2019	CJR	1
trans-1,3-Dichloropropene	< 0.32	ug/l	0.32	1.01	1	8260B		6/12/2019	CJR	1
cis-1,3-Dichloropropene	< 0.26	ug/l	0.26	0.81	1	8260B		6/12/2019	CJR	1
Di-isopropyl ether	< 0.21	ug/l	0.21	0.66	1	8260B		6/12/2019	CJR	1
EDB (1,2-Dibromoethane)	< 0.34	ug/l	0.34	1.09	1	8260B		6/12/2019	CJR	1
Ethylbenzene	< 0.26	ug/l	0.26	0.83	1	8260B		6/12/2019	CJR	1
Hexachlorobutadiene	< 1.34	ug/l	1.34	4.28	1	8260B		6/12/2019	CJR	1
Isopropylbenzene	< 0.78	ug/l	0.78	2.47	1	8260B		6/12/2019	CJR	1
p-Isopropyltoluene	< 0.24	ug/l	0.24	0.76	1	8260B		6/12/2019	CJR	1
Methylene chloride	< 1.32	ug/l	1.32	4.21	1	8260B		6/12/2019	CJR	1
Methyl tert-butyl ether (MTBE)	< 0.28	ug/l	0.28	0.89	1	8260B		6/12/2019	CJR	1
Naphthalene	< 2.1	ug/l	2.1	6.65	1	8260B		6/12/2019	CJR	1
n-Propylbenzene	< 0.61	ug/l	0.61	1.95	1	8260B		6/12/2019	CJR	1
1,1,2,2-Tetrachloroethane	< 0.3	ug/l	0.3	0.97	1	8260B		6/12/2019	CJR	1
1,1,1,2-Tetrachloroethane	< 0.35	ug/l	0.35	1.13	1	8260B		6/12/2019	CJR	1
Tetrachloroethene	47	ug/l	0.38	1.21	1	8260B		6/12/2019	CJR	1
Toluene	< 0.19	ug/l	0.19	0.6	1	8260B		6/12/2019	CJR	1
1,2,4-Trichlorobenzene	< 1.15	ug/l	1.15	3.67	1	8260B		6/12/2019	CJR	1

Project Name OHM-OCONOMOWOC
Project # 6143 PO#2019-0523

Invoice # E36303

Lab Code 5036303D
Sample ID 6143 MW-3
Sample Matrix Water
Sample Date 6/6/2019

	Result	Unit	LOD	LOQ	Dil	Method	Ext Date	Run Date	Analyst	Code
1,2,3-Trichlorobenzene	< 1.71	ug/l	1.71	5.43	1	8260B		6/12/2019	CJR	1
1,1,1-Trichloroethane	< 0.33	ug/l	0.33	1.05	1	8260B		6/12/2019	CJR	1
1,1,2-Trichloroethane	< 0.42	ug/l	0.42	1.32	1	8260B		6/12/2019	CJR	1
Trichloroethene (TCE)	0.54 "J"	ug/l	0.3	0.94	1	8260B		6/12/2019	CJR	1
Trichlorofluoromethane	< 0.35	ug/l	0.35	1.1	1	8260B		6/12/2019	CJR	1
1,2,4-Trimethylbenzene	< 0.8	ug/l	0.8	2.55	1	8260B		6/12/2019	CJR	1
1,3,5-Trimethylbenzene	< 0.63	ug/l	0.63	2	1	8260B		6/12/2019	CJR	1
Vinyl Chloride	< 0.2	ug/l	0.2	0.65	1	8260B		6/12/2019	CJR	1
m&p-Xylene	< 0.43	ug/l	0.43	1.38	1	8260B		6/12/2019	CJR	1
o-Xylene	< 0.29	ug/l	0.29	0.93	1	8260B		6/12/2019	CJR	1
SUR - 1,2-Dichloroethane-d4	104	REC %			1	8260B		6/12/2019	CJR	1
SUR - 4-Bromofluorobenzene	96	REC %			1	8260B		6/12/2019	CJR	1
SUR - Dibromofluoromethane	106	REC %			1	8260B		6/12/2019	CJR	1
SUR - Toluene-d8	97	REC %			1	8260B		6/12/2019	CJR	1

Project Name OHM-OCONOMOWOC
 Project # 6143 PO#2019-0523

Invoice # E36303

Lab Code 5036303E
 Sample ID 6143 MW-4
 Sample Matrix Water
 Sample Date 6/6/2019

	Result	Unit	LOD	LOQ	Dil	Method	Ext Date	Run Date	Analyst	Code
Organic										
VOC's										
Benzene	< 0.22	ug/l	0.22	0.71	1	8260B		6/12/2019	CJR	1
Bromobenzene	< 0.44	ug/l	0.44	1.38	1	8260B		6/12/2019	CJR	1
Bromodichloromethane	< 0.33	ug/l	0.33	1.06	1	8260B		6/12/2019	CJR	1
Bromoform	< 0.45	ug/l	0.45	1.44	1	8260B		6/12/2019	CJR	1
tert-Butylbenzene	< 0.25	ug/l	0.25	0.8	1	8260B		6/12/2019	CJR	1
sec-Butylbenzene	< 0.79	ug/l	0.79	2.53	1	8260B		6/12/2019	CJR	1
n-Butylbenzene	< 0.71	ug/l	0.71	2.25	1	8260B		6/12/2019	CJR	1
Carbon Tetrachloride	< 0.31	ug/l	0.31	0.98	1	8260B		6/12/2019	CJR	1
Chlorobenzene	< 0.26	ug/l	0.26	0.83	1	8260B		6/12/2019	CJR	1
Chloroethane	< 0.61	ug/l	0.61	1.95	1	8260B		6/12/2019	CJR	1
Chloroform	< 0.26	ug/l	0.26	0.82	1	8260B		6/12/2019	CJR	1
Chloromethane	< 0.54	ug/l	0.54	1.72	1	8260B		6/12/2019	CJR	1
2-Chlorotoluene	< 0.31	ug/l	0.31	0.98	1	8260B		6/12/2019	CJR	1
4-Chlorotoluene	< 0.26	ug/l	0.26	0.83	1	8260B		6/12/2019	CJR	1
1,2-Dibromo-3-chloropropane	< 2.96	ug/l	2.96	9.43	1	8260B		6/12/2019	CJR	1
Dibromochloromethane	< 0.22	ug/l	0.22	0.69	1	8260B		6/12/2019	CJR	1
1,4-Dichlorobenzene	< 0.7	ug/l	0.7	2.22	1	8260B		6/12/2019	CJR	1
1,3-Dichlorobenzene	< 0.85	ug/l	0.85	2.7	1	8260B		6/12/2019	CJR	1
1,2-Dichlorobenzene	< 0.86	ug/l	0.86	2.74	1	8260B		6/12/2019	CJR	1
Dichlorodifluoromethane	< 0.32	ug/l	0.32	1.02	1	8260B		6/12/2019	CJR	1
1,2-Dichloroethane	< 0.25	ug/l	0.25	0.78	1	8260B		6/12/2019	CJR	1
1,1-Dichloroethane	< 0.36	ug/l	0.36	1.14	1	8260B		6/12/2019	CJR	1
1,1-Dichloroethene	< 0.42	ug/l	0.42	1.34	1	8260B		6/12/2019	CJR	1
cis-1,2-Dichloroethene	< 0.37	ug/l	0.37	1.16	1	8260B		6/12/2019	CJR	1
trans-1,2-Dichloroethene	< 0.34	ug/l	0.34	1.07	1	8260B		6/12/2019	CJR	1
1,2-Dichloropropane	< 0.44	ug/l	0.44	1.39	1	8260B		6/12/2019	CJR	1
1,3-Dichloropropane	< 0.3	ug/l	0.3	0.94	1	8260B		6/12/2019	CJR	1
trans-1,3-Dichloropropene	< 0.32	ug/l	0.32	1.01	1	8260B		6/12/2019	CJR	1
cis-1,3-Dichloropropene	< 0.26	ug/l	0.26	0.81	1	8260B		6/12/2019	CJR	1
Di-isopropyl ether	< 0.21	ug/l	0.21	0.66	1	8260B		6/12/2019	CJR	1
EDB (1,2-Dibromoethane)	< 0.34	ug/l	0.34	1.09	1	8260B		6/12/2019	CJR	1
Ethylbenzene	< 0.26	ug/l	0.26	0.83	1	8260B		6/12/2019	CJR	1
Hexachlorobutadiene	< 1.34	ug/l	1.34	4.28	1	8260B		6/12/2019	CJR	1
Isopropylbenzene	< 0.78	ug/l	0.78	2.47	1	8260B		6/12/2019	CJR	1
p-Isopropyltoluene	< 0.24	ug/l	0.24	0.76	1	8260B		6/12/2019	CJR	1
Methylene chloride	< 1.32	ug/l	1.32	4.21	1	8260B		6/12/2019	CJR	1
Methyl tert-butyl ether (MTBE)	< 0.28	ug/l	0.28	0.89	1	8260B		6/12/2019	CJR	1
Naphthalene	< 2.1	ug/l	2.1	6.65	1	8260B		6/12/2019	CJR	1
n-Propylbenzene	< 0.61	ug/l	0.61	1.95	1	8260B		6/12/2019	CJR	1
1,1,2,2-Tetrachloroethane	< 0.3	ug/l	0.3	0.97	1	8260B		6/12/2019	CJR	1
1,1,1,2-Tetrachloroethane	< 0.35	ug/l	0.35	1.13	1	8260B		6/12/2019	CJR	1
Tetrachloroethene	11.3	ug/l	0.38	1.21	1	8260B		6/12/2019	CJR	1
Toluene	< 0.19	ug/l	0.19	0.6	1	8260B		6/12/2019	CJR	1
1,2,4-Trichlorobenzene	< 1.15	ug/l	1.15	3.67	1	8260B		6/12/2019	CJR	1

Project Name OHM-OCONOMOWOC
Project # 6143 PO#2019-0523

Invoice # E36303

Lab Code 5036303E
Sample ID 6143 MW-4
Sample Matrix Water
Sample Date 6/6/2019

	Result	Unit	LOD	LOQ	Dil	Method	Ext Date	Run Date	Analyst	Code
1,2,3-Trichlorobenzene	< 1.71	ug/l	1.71	5.43	1	8260B		6/12/2019	CJR	1
1,1,1-Trichloroethane	< 0.33	ug/l	0.33	1.05	1	8260B		6/12/2019	CJR	1
1,1,2-Trichloroethane	< 0.42	ug/l	0.42	1.32	1	8260B		6/12/2019	CJR	1
Trichloroethene (TCE)	< 0.3	ug/l	0.3	0.94	1	8260B		6/12/2019	CJR	1
Trichlorofluoromethane	< 0.35	ug/l	0.35	1.1	1	8260B		6/12/2019	CJR	1
1,2,4-Trimethylbenzene	< 0.8	ug/l	0.8	2.55	1	8260B		6/12/2019	CJR	1
1,3,5-Trimethylbenzene	< 0.63	ug/l	0.63	2	1	8260B		6/12/2019	CJR	1
Vinyl Chloride	< 0.2	ug/l	0.2	0.65	1	8260B		6/12/2019	CJR	1
m&p-Xylene	< 0.43	ug/l	0.43	1.38	1	8260B		6/12/2019	CJR	1
o-Xylene	< 0.29	ug/l	0.29	0.93	1	8260B		6/12/2019	CJR	1
SUR - Dibromofluoromethane	105	REC %			1	8260B		6/12/2019	CJR	1
SUR - 1,2-Dichloroethane-d4	101	REC %			1	8260B		6/12/2019	CJR	1
SUR - 4-Bromofluorobenzene	94	REC %			1	8260B		6/12/2019	CJR	1
SUR - Toluene-d8	97	REC %			1	8260B		6/12/2019	CJR	1

Project Name OHM-OCONOMOWOC
 Project # 6143 PO#2019-0523

Invoice # E36303

Lab Code 5036303F
 Sample ID 6143 MW-5
 Sample Matrix Water
 Sample Date 6/7/2019

	Result	Unit	LOD	LOQ	Dil	Method	Ext Date	Run Date	Analyst	Code
Inorganic										
Metals										
Iron, Dissolved	0.76	mg/l	0.03	0.1	1	200.7		6/10/2019	CWT	1
Iron, Total	1.99	mg/l	0.03	0.1	1	200.7		6/10/2019	CWT	1
Organic										
GASES										
Ethane	< 0.5	ug/l	0.5	1.5	1	8015		6/20/2019	MJR	1
Ethene	< 0.5	ug/l	0.5	1.5	1	8015		6/20/2019	MJR	1
Methane	33.9	ug/l	1	3	1	8015		6/20/2019	MJR	1
VOC's										
Benzene	< 0.22	ug/l	0.22	0.71	1	8260B		6/12/2019	CJR	1
Bromobenzene	< 0.44	ug/l	0.44	1.38	1	8260B		6/12/2019	CJR	1
Bromodichloromethane	< 0.33	ug/l	0.33	1.06	1	8260B		6/12/2019	CJR	1
Bromoform	< 0.45	ug/l	0.45	1.44	1	8260B		6/12/2019	CJR	1
tert-Butylbenzene	< 0.25	ug/l	0.25	0.8	1	8260B		6/12/2019	CJR	1
sec-Butylbenzene	< 0.79	ug/l	0.79	2.53	1	8260B		6/12/2019	CJR	1
n-Butylbenzene	< 0.71	ug/l	0.71	2.25	1	8260B		6/12/2019	CJR	1
Carbon Tetrachloride	< 0.31	ug/l	0.31	0.98	1	8260B		6/12/2019	CJR	1
Chlorobenzene	< 0.26	ug/l	0.26	0.83	1	8260B		6/12/2019	CJR	1
Chloroethane	< 0.61	ug/l	0.61	1.95	1	8260B		6/12/2019	CJR	1
Chloroform	< 0.26	ug/l	0.26	0.82	1	8260B		6/12/2019	CJR	1
Chloromethane	< 0.54	ug/l	0.54	1.72	1	8260B		6/12/2019	CJR	1
2-Chlorotoluene	< 0.31	ug/l	0.31	0.98	1	8260B		6/12/2019	CJR	1
4-Chlorotoluene	< 0.26	ug/l	0.26	0.83	1	8260B		6/12/2019	CJR	1
1,2-Dibromo-3-chloropropane	< 2.96	ug/l	2.96	9.43	1	8260B		6/12/2019	CJR	1
Dibromochloromethane	< 0.22	ug/l	0.22	0.69	1	8260B		6/12/2019	CJR	1
1,4-Dichlorobenzene	< 0.7	ug/l	0.7	2.22	1	8260B		6/12/2019	CJR	1
1,3-Dichlorobenzene	< 0.85	ug/l	0.85	2.7	1	8260B		6/12/2019	CJR	1
1,2-Dichlorobenzene	< 0.86	ug/l	0.86	2.74	1	8260B		6/12/2019	CJR	1
Dichlorodifluoromethane	< 0.32	ug/l	0.32	1.02	1	8260B		6/12/2019	CJR	1
1,2-Dichloroethane	< 0.25	ug/l	0.25	0.78	1	8260B		6/12/2019	CJR	1
1,1-Dichloroethane	< 0.36	ug/l	0.36	1.14	1	8260B		6/12/2019	CJR	1
1,1-Dichloroethene	< 0.42	ug/l	0.42	1.34	1	8260B		6/12/2019	CJR	1
cis-1,2-Dichloroethene	< 0.37	ug/l	0.37	1.16	1	8260B		6/12/2019	CJR	1
trans-1,2-Dichloroethene	< 0.34	ug/l	0.34	1.07	1	8260B		6/12/2019	CJR	1
1,2-Dichloropropane	< 0.44	ug/l	0.44	1.39	1	8260B		6/12/2019	CJR	1
1,3-Dichloropropane	< 0.3	ug/l	0.3	0.94	1	8260B		6/12/2019	CJR	1
trans-1,3-Dichloropropene	< 0.32	ug/l	0.32	1.01	1	8260B		6/12/2019	CJR	1
cis-1,3-Dichloropropene	< 0.26	ug/l	0.26	0.81	1	8260B		6/12/2019	CJR	1
Di-isopropyl ether	< 0.21	ug/l	0.21	0.66	1	8260B		6/12/2019	CJR	1
EDB (1,2-Dibromoethane)	< 0.34	ug/l	0.34	1.09	1	8260B		6/12/2019	CJR	1
Ethylbenzene	< 0.26	ug/l	0.26	0.83	1	8260B		6/12/2019	CJR	1
Hexachlorobutadiene	< 1.34	ug/l	1.34	4.28	1	8260B		6/12/2019	CJR	1
Isopropylbenzene	< 0.78	ug/l	0.78	2.47	1	8260B		6/12/2019	CJR	1
p-Isopropyltoluene	< 0.24	ug/l	0.24	0.76	1	8260B		6/12/2019	CJR	1
Methylene chloride	< 1.32	ug/l	1.32	4.21	1	8260B		6/12/2019	CJR	1

Project Name OHM-OCONOMOWOC
 Project # 6143 PO#2019-0523

Invoice # E36303

Lab Code 5036303F
 Sample ID 6143 MW-5
 Sample Matrix Water
 Sample Date 6/7/2019

	Result	Unit	LOD	LOQ	Dil	Method	Ext Date	Run Date	Analyst	Code
Methyl tert-butyl ether (MTBE)	< 0.28	ug/l	0.28	0.89	1	8260B		6/12/2019	CJR	1
Naphthalene	< 2.1	ug/l	2.1	6.65	1	8260B		6/12/2019	CJR	1
n-Propylbenzene	< 0.61	ug/l	0.61	1.95	1	8260B		6/12/2019	CJR	1
1,1,2,2-Tetrachloroethane	< 0.3	ug/l	0.3	0.97	1	8260B		6/12/2019	CJR	1
1,1,1,2-Tetrachloroethane	< 0.35	ug/l	0.35	1.13	1	8260B		6/12/2019	CJR	1
Tetrachloroethene	19.5	ug/l	0.38	1.21	1	8260B		6/12/2019	CJR	1
Toluene	< 0.19	ug/l	0.19	0.6	1	8260B		6/12/2019	CJR	1
1,2,4-Trichlorobenzene	< 1.15	ug/l	1.15	3.67	1	8260B		6/12/2019	CJR	1
1,2,3-Trichlorobenzene	< 1.71	ug/l	1.71	5.43	1	8260B		6/12/2019	CJR	1
1,1,1-Trichloroethane	< 0.33	ug/l	0.33	1.05	1	8260B		6/12/2019	CJR	1
1,1,2-Trichloroethane	< 0.42	ug/l	0.42	1.32	1	8260B		6/12/2019	CJR	1
Trichloroethene (TCE)	1.41	ug/l	0.3	0.94	1	8260B		6/12/2019	CJR	1
Trichlorofluoromethane	< 0.35	ug/l	0.35	1.1	1	8260B		6/12/2019	CJR	1
1,2,4-Trimethylbenzene	< 0.8	ug/l	0.8	2.55	1	8260B		6/12/2019	CJR	1
1,3,5-Trimethylbenzene	< 0.63	ug/l	0.63	2	1	8260B		6/12/2019	CJR	1
Vinyl Chloride	< 0.2	ug/l	0.2	0.65	1	8260B		6/12/2019	CJR	1
m&p-Xylene	< 0.43	ug/l	0.43	1.38	1	8260B		6/12/2019	CJR	1
o-Xylene	< 0.29	ug/l	0.29	0.93	1	8260B		6/12/2019	CJR	1
SUR - 1,2-Dichloroethane-d4	98	REC %			1	8260B		6/12/2019	CJR	1
SUR - Toluene-d8	96	REC %			1	8260B		6/12/2019	CJR	1
SUR - 4-Bromofluorobenzene	89	REC %			1	8260B		6/12/2019	CJR	1
SUR - Dibromofluoromethane	102	REC %			1	8260B		6/12/2019	CJR	1
Wet Chemistry										
General										
Nitrate Nitrogen, Total	< 0.47	mg/l	0.47	1.56	1	353.2		6/12/2019	NJC	1
Nitrite Nitrogen, Total	0.067	mg/l	0.014	0.048	1	353.2		6/10/2019	NJC	1
Sulfate, Unfiltered	77.1 "J"	mg/l	33.7	112.3	10	ASTM D516-5		6/14/2019	NJC	1

Project Name OHM-OCONOMOWOC
 Project # 6143 PO#2019-0523

Invoice # E36303

Lab Code 5036303G
 Sample ID 6143 MW-6
 Sample Matrix Water
 Sample Date 6/6/2019

	Result	Unit	LOD	LOQ	Dil	Method	Ext Date	Run Date	Analyst	Code
Organic										
VOC's										
Benzene	< 0.22	ug/l	0.22	0.71	1	8260B		6/12/2019	CJR	1
Bromobenzene	< 0.44	ug/l	0.44	1.38	1	8260B		6/12/2019	CJR	1
Bromodichloromethane	< 0.33	ug/l	0.33	1.06	1	8260B		6/12/2019	CJR	1
Bromoform	< 0.45	ug/l	0.45	1.44	1	8260B		6/12/2019	CJR	1
tert-Butylbenzene	< 0.25	ug/l	0.25	0.8	1	8260B		6/12/2019	CJR	1
sec-Butylbenzene	< 0.79	ug/l	0.79	2.53	1	8260B		6/12/2019	CJR	1
n-Butylbenzene	< 0.71	ug/l	0.71	2.25	1	8260B		6/12/2019	CJR	1
Carbon Tetrachloride	< 0.31	ug/l	0.31	0.98	1	8260B		6/12/2019	CJR	1
Chlorobenzene	< 0.26	ug/l	0.26	0.83	1	8260B		6/12/2019	CJR	1
Chloroethane	< 0.61	ug/l	0.61	1.95	1	8260B		6/12/2019	CJR	1
Chloroform	< 0.26	ug/l	0.26	0.82	1	8260B		6/12/2019	CJR	1
Chloromethane	< 0.54	ug/l	0.54	1.72	1	8260B		6/12/2019	CJR	1
2-Chlorotoluene	< 0.31	ug/l	0.31	0.98	1	8260B		6/12/2019	CJR	1
4-Chlorotoluene	< 0.26	ug/l	0.26	0.83	1	8260B		6/12/2019	CJR	1
1,2-Dibromo-3-chloropropane	< 2.96	ug/l	2.96	9.43	1	8260B		6/12/2019	CJR	1
Dibromochloromethane	< 0.22	ug/l	0.22	0.69	1	8260B		6/12/2019	CJR	1
1,4-Dichlorobenzene	< 0.7	ug/l	0.7	2.22	1	8260B		6/12/2019	CJR	1
1,3-Dichlorobenzene	< 0.85	ug/l	0.85	2.7	1	8260B		6/12/2019	CJR	1
1,2-Dichlorobenzene	< 0.86	ug/l	0.86	2.74	1	8260B		6/12/2019	CJR	1
Dichlorodifluoromethane	< 0.32	ug/l	0.32	1.02	1	8260B		6/12/2019	CJR	1
1,2-Dichloroethane	< 0.25	ug/l	0.25	0.78	1	8260B		6/12/2019	CJR	1
1,1-Dichloroethane	< 0.36	ug/l	0.36	1.14	1	8260B		6/12/2019	CJR	1
1,1-Dichloroethene	< 0.42	ug/l	0.42	1.34	1	8260B		6/12/2019	CJR	1
cis-1,2-Dichloroethene	< 0.37	ug/l	0.37	1.16	1	8260B		6/12/2019	CJR	1
trans-1,2-Dichloroethene	< 0.34	ug/l	0.34	1.07	1	8260B		6/12/2019	CJR	1
1,2-Dichloropropane	< 0.44	ug/l	0.44	1.39	1	8260B		6/12/2019	CJR	1
1,3-Dichloropropane	< 0.3	ug/l	0.3	0.94	1	8260B		6/12/2019	CJR	1
trans-1,3-Dichloropropene	< 0.32	ug/l	0.32	1.01	1	8260B		6/12/2019	CJR	1
cis-1,3-Dichloropropene	< 0.26	ug/l	0.26	0.81	1	8260B		6/12/2019	CJR	1
Di-isopropyl ether	< 0.21	ug/l	0.21	0.66	1	8260B		6/12/2019	CJR	1
EDB (1,2-Dibromoethane)	< 0.34	ug/l	0.34	1.09	1	8260B		6/12/2019	CJR	1
Ethylbenzene	< 0.26	ug/l	0.26	0.83	1	8260B		6/12/2019	CJR	1
Hexachlorobutadiene	< 1.34	ug/l	1.34	4.28	1	8260B		6/12/2019	CJR	1
Isopropylbenzene	< 0.78	ug/l	0.78	2.47	1	8260B		6/12/2019	CJR	1
p-Isopropyltoluene	< 0.24	ug/l	0.24	0.76	1	8260B		6/12/2019	CJR	1
Methylene chloride	< 1.32	ug/l	1.32	4.21	1	8260B		6/12/2019	CJR	1
Methyl tert-butyl ether (MTBE)	< 0.28	ug/l	0.28	0.89	1	8260B		6/12/2019	CJR	1
Naphthalene	< 2.1	ug/l	2.1	6.65	1	8260B		6/12/2019	CJR	1
n-Propylbenzene	< 0.61	ug/l	0.61	1.95	1	8260B		6/12/2019	CJR	1
1,1,2,2-Tetrachloroethane	< 0.3	ug/l	0.3	0.97	1	8260B		6/12/2019	CJR	1
1,1,1,2-Tetrachloroethane	< 0.35	ug/l	0.35	1.13	1	8260B		6/12/2019	CJR	1
Tetrachloroethene	29.5	ug/l	0.38	1.21	1	8260B		6/12/2019	CJR	1
Toluene	< 0.19	ug/l	0.19	0.6	1	8260B		6/12/2019	CJR	1
1,2,4-Trichlorobenzene	< 1.15	ug/l	1.15	3.67	1	8260B		6/12/2019	CJR	1

Project Name OHM-OCONOMOWOC
 Project # 6143 PO#2019-0523

Invoice # E36303

Lab Code 5036303G
 Sample ID 6143 MW-6
 Sample Matrix Water
 Sample Date 6/6/2019

	Result	Unit	LOD	LOQ	Dil	Method	Ext Date	Run Date	Analyst	Code
1,2,3-Trichlorobenzene	< 1.71	ug/l	1.71	5.43	1	8260B		6/12/2019	CJR	1
1,1,1-Trichloroethane	< 0.33	ug/l	0.33	1.05	1	8260B		6/12/2019	CJR	1
1,1,2-Trichloroethane	< 0.42	ug/l	0.42	1.32	1	8260B		6/12/2019	CJR	1
Trichloroethene (TCE)	< 0.3	ug/l	0.3	0.94	1	8260B		6/12/2019	CJR	1
Trichlorofluoromethane	< 0.35	ug/l	0.35	1.1	1	8260B		6/12/2019	CJR	1
1,2,4-Trimethylbenzene	< 0.8	ug/l	0.8	2.55	1	8260B		6/12/2019	CJR	1
1,3,5-Trimethylbenzene	< 0.63	ug/l	0.63	2	1	8260B		6/12/2019	CJR	1
Vinyl Chloride	< 0.2	ug/l	0.2	0.65	1	8260B		6/12/2019	CJR	1
m&p-Xylene	< 0.43	ug/l	0.43	1.38	1	8260B		6/12/2019	CJR	1
o-Xylene	< 0.29	ug/l	0.29	0.93	1	8260B		6/12/2019	CJR	1
SUR - Toluene-d8	97	REC %				8260B		6/12/2019	CJR	1
SUR - Dibromofluoromethane	106	REC %				8260B		6/12/2019	CJR	1
SUR - 1,2-Dichloroethane-d4	98	REC %				8260B		6/12/2019	CJR	1
SUR - 4-Bromofluorobenzene	92	REC %				8260B		6/12/2019	CJR	1

Project Name OHM-OCONOMOWOC
 Project # 6143 PO#2019-0523

Invoice # E36303

Lab Code 5036303H
 Sample ID 6143 MW-11
 Sample Matrix Water
 Sample Date 6/6/2019

	Result	Unit	LOD	LOQ	Dil	Method	Ext Date	Run Date	Analyst	Code
Organic										
VOC's										
Benzene	< 0.22	ug/l	0.22	0.71	1	8260B		6/12/2019	CJR	1
Bromobenzene	< 0.44	ug/l	0.44	1.38	1	8260B		6/12/2019	CJR	1
Bromodichloromethane	< 0.33	ug/l	0.33	1.06	1	8260B		6/12/2019	CJR	1
Bromoform	< 0.45	ug/l	0.45	1.44	1	8260B		6/12/2019	CJR	1
tert-Butylbenzene	< 0.25	ug/l	0.25	0.8	1	8260B		6/12/2019	CJR	1
sec-Butylbenzene	< 0.79	ug/l	0.79	2.53	1	8260B		6/12/2019	CJR	1
n-Butylbenzene	< 0.71	ug/l	0.71	2.25	1	8260B		6/12/2019	CJR	1
Carbon Tetrachloride	< 0.31	ug/l	0.31	0.98	1	8260B		6/12/2019	CJR	1
Chlorobenzene	< 0.26	ug/l	0.26	0.83	1	8260B		6/12/2019	CJR	1
Chloroethane	< 0.61	ug/l	0.61	1.95	1	8260B		6/12/2019	CJR	1
Chloroform	< 0.26	ug/l	0.26	0.82	1	8260B		6/12/2019	CJR	1
Chloromethane	< 0.54	ug/l	0.54	1.72	1	8260B		6/12/2019	CJR	1
2-Chlorotoluene	< 0.31	ug/l	0.31	0.98	1	8260B		6/12/2019	CJR	1
4-Chlorotoluene	< 0.26	ug/l	0.26	0.83	1	8260B		6/12/2019	CJR	1
1,2-Dibromo-3-chloropropane	< 2.96	ug/l	2.96	9.43	1	8260B		6/12/2019	CJR	1
Dibromochloromethane	< 0.22	ug/l	0.22	0.69	1	8260B		6/12/2019	CJR	1
1,4-Dichlorobenzene	< 0.7	ug/l	0.7	2.22	1	8260B		6/12/2019	CJR	1
1,3-Dichlorobenzene	< 0.85	ug/l	0.85	2.7	1	8260B		6/12/2019	CJR	1
1,2-Dichlorobenzene	< 0.86	ug/l	0.86	2.74	1	8260B		6/12/2019	CJR	1
Dichlorodifluoromethane	< 0.32	ug/l	0.32	1.02	1	8260B		6/12/2019	CJR	1
1,2-Dichloroethane	< 0.25	ug/l	0.25	0.78	1	8260B		6/12/2019	CJR	1
1,1-Dichloroethane	< 0.36	ug/l	0.36	1.14	1	8260B		6/12/2019	CJR	1
1,1-Dichloroethene	< 0.42	ug/l	0.42	1.34	1	8260B		6/12/2019	CJR	1
cis-1,2-Dichloroethene	< 0.37	ug/l	0.37	1.16	1	8260B		6/12/2019	CJR	1
trans-1,2-Dichloroethene	< 0.34	ug/l	0.34	1.07	1	8260B		6/12/2019	CJR	1
1,2-Dichloropropane	< 0.44	ug/l	0.44	1.39	1	8260B		6/12/2019	CJR	1
1,3-Dichloropropane	< 0.3	ug/l	0.3	0.94	1	8260B		6/12/2019	CJR	1
trans-1,3-Dichloropropene	< 0.32	ug/l	0.32	1.01	1	8260B		6/12/2019	CJR	1
cis-1,3-Dichloropropene	< 0.26	ug/l	0.26	0.81	1	8260B		6/12/2019	CJR	1
Di-isopropyl ether	< 0.21	ug/l	0.21	0.66	1	8260B		6/12/2019	CJR	1
EDB (1,2-Dibromoethane)	< 0.34	ug/l	0.34	1.09	1	8260B		6/12/2019	CJR	1
Ethylbenzene	< 0.26	ug/l	0.26	0.83	1	8260B		6/12/2019	CJR	1
Hexachlorobutadiene	< 1.34	ug/l	1.34	4.28	1	8260B		6/12/2019	CJR	1
Isopropylbenzene	< 0.78	ug/l	0.78	2.47	1	8260B		6/12/2019	CJR	1
p-Isopropyltoluene	< 0.24	ug/l	0.24	0.76	1	8260B		6/12/2019	CJR	1
Methylene chloride	< 1.32	ug/l	1.32	4.21	1	8260B		6/12/2019	CJR	1
Methyl tert-butyl ether (MTBE)	< 0.28	ug/l	0.28	0.89	1	8260B		6/12/2019	CJR	1
Naphthalene	< 2.1	ug/l	2.1	6.65	1	8260B		6/12/2019	CJR	1
n-Propylbenzene	< 0.61	ug/l	0.61	1.95	1	8260B		6/12/2019	CJR	1
1,1,2,2-Tetrachloroethane	< 0.3	ug/l	0.3	0.97	1	8260B		6/12/2019	CJR	1
1,1,1,2-Tetrachloroethane	< 0.35	ug/l	0.35	1.13	1	8260B		6/12/2019	CJR	1
Tetrachloroethene	4.1	ug/l	0.38	1.21	1	8260B		6/12/2019	CJR	1
Toluene	< 0.19	ug/l	0.19	0.6	1	8260B		6/12/2019	CJR	1
1,2,4-Trichlorobenzene	< 1.15	ug/l	1.15	3.67	1	8260B		6/12/2019	CJR	1

Project Name OHM-OCONOMOWOC
Project # 6143 PO#2019-0523

Invoice # E36303

Lab Code 5036303H
Sample ID 6143 MW-11
Sample Matrix Water
Sample Date 6/6/2019

	Result	Unit	LOD	LOQ	Dil	Method	Ext Date	Run Date	Analyst	Code
1,2,3-Trichlorobenzene	< 1.71	ug/l	1.71	5.43	1	8260B		6/12/2019	CJR	1
1,1,1-Trichloroethane	< 0.33	ug/l	0.33	1.05	1	8260B		6/12/2019	CJR	1
1,1,2-Trichloroethane	< 0.42	ug/l	0.42	1.32	1	8260B		6/12/2019	CJR	1
Trichloroethene (TCE)	< 0.3	ug/l	0.3	0.94	1	8260B		6/12/2019	CJR	1
Trichlorofluoromethane	< 0.35	ug/l	0.35	1.1	1	8260B		6/12/2019	CJR	1
1,2,4-Trimethylbenzene	< 0.8	ug/l	0.8	2.55	1	8260B		6/12/2019	CJR	1
1,3,5-Trimethylbenzene	< 0.63	ug/l	0.63	2	1	8260B		6/12/2019	CJR	1
Vinyl Chloride	< 0.2	ug/l	0.2	0.65	1	8260B		6/12/2019	CJR	1
m&p-Xylene	< 0.43	ug/l	0.43	1.38	1	8260B		6/12/2019	CJR	1
o-Xylene	< 0.29	ug/l	0.29	0.93	1	8260B		6/12/2019	CJR	1
SUR - 1,2-Dichloroethane-d4	102	REC %			1	8260B		6/12/2019	CJR	1
SUR - 4-Bromofluorobenzene	93	REC %			1	8260B		6/12/2019	CJR	1
SUR - Dibromofluoromethane	106	REC %			1	8260B		6/12/2019	CJR	1
SUR - Toluene-d8	96	REC %			1	8260B		6/12/2019	CJR	1

Project Name OHM-OCONOMOWOC
 Project # 6143 PO#2019-0523

Invoice # E36303

Lab Code 5036303I
 Sample ID 6143 EB-1
 Sample Matrix Water
 Sample Date 6/6/2019

	Result	Unit	LOD	LOQ	Dil	Method	Ext Date	Run Date	Analyst	Code
Organic										
VOC's										
Benzene	< 0.22	ug/l	0.22	0.71	1	8260B		6/12/2019	CJR	1
Bromobenzene	< 0.44	ug/l	0.44	1.38	1	8260B		6/12/2019	CJR	1
Bromodichloromethane	< 0.33	ug/l	0.33	1.06	1	8260B		6/12/2019	CJR	1
Bromoform	< 0.45	ug/l	0.45	1.44	1	8260B		6/12/2019	CJR	1
tert-Butylbenzene	< 0.25	ug/l	0.25	0.8	1	8260B		6/12/2019	CJR	1
sec-Butylbenzene	< 0.79	ug/l	0.79	2.53	1	8260B		6/12/2019	CJR	1
n-Butylbenzene	< 0.71	ug/l	0.71	2.25	1	8260B		6/12/2019	CJR	1
Carbon Tetrachloride	< 0.31	ug/l	0.31	0.98	1	8260B		6/12/2019	CJR	1
Chlorobenzene	< 0.26	ug/l	0.26	0.83	1	8260B		6/12/2019	CJR	1
Chloroethane	< 0.61	ug/l	0.61	1.95	1	8260B		6/12/2019	CJR	1
Chloroform	0.44 "J"	ug/l	0.26	0.82	1	8260B		6/12/2019	CJR	1
Chloromethane	< 0.54	ug/l	0.54	1.72	1	8260B		6/12/2019	CJR	1
2-Chlorotoluene	< 0.31	ug/l	0.31	0.98	1	8260B		6/12/2019	CJR	1
4-Chlorotoluene	< 0.26	ug/l	0.26	0.83	1	8260B		6/12/2019	CJR	1
1,2-Dibromo-3-chloropropane	< 2.96	ug/l	2.96	9.43	1	8260B		6/12/2019	CJR	1
Dibromochloromethane	< 0.22	ug/l	0.22	0.69	1	8260B		6/12/2019	CJR	1
1,4-Dichlorobenzene	< 0.7	ug/l	0.7	2.22	1	8260B		6/12/2019	CJR	1
1,3-Dichlorobenzene	< 0.85	ug/l	0.85	2.7	1	8260B		6/12/2019	CJR	1
1,2-Dichlorobenzene	< 0.86	ug/l	0.86	2.74	1	8260B		6/12/2019	CJR	1
Dichlorodifluoromethane	< 0.32	ug/l	0.32	1.02	1	8260B		6/12/2019	CJR	1
1,2-Dichloroethane	< 0.25	ug/l	0.25	0.78	1	8260B		6/12/2019	CJR	1
1,1-Dichloroethane	< 0.36	ug/l	0.36	1.14	1	8260B		6/12/2019	CJR	1
1,1-Dichloroethene	< 0.42	ug/l	0.42	1.34	1	8260B		6/12/2019	CJR	1
cis-1,2-Dichloroethene	< 0.37	ug/l	0.37	1.16	1	8260B		6/12/2019	CJR	1
trans-1,2-Dichloroethene	< 0.34	ug/l	0.34	1.07	1	8260B		6/12/2019	CJR	1
1,2-Dichloropropane	< 0.44	ug/l	0.44	1.39	1	8260B		6/12/2019	CJR	1
1,3-Dichloropropane	< 0.3	ug/l	0.3	0.94	1	8260B		6/12/2019	CJR	1
trans-1,3-Dichloropropene	< 0.32	ug/l	0.32	1.01	1	8260B		6/12/2019	CJR	1
cis-1,3-Dichloropropene	< 0.26	ug/l	0.26	0.81	1	8260B		6/12/2019	CJR	1
Di-isopropyl ether	< 0.21	ug/l	0.21	0.66	1	8260B		6/12/2019	CJR	1
EDB (1,2-Dibromoethane)	< 0.34	ug/l	0.34	1.09	1	8260B		6/12/2019	CJR	1
Ethylbenzene	< 0.26	ug/l	0.26	0.83	1	8260B		6/12/2019	CJR	1
Hexachlorobutadiene	< 1.34	ug/l	1.34	4.28	1	8260B		6/12/2019	CJR	1
Isopropylbenzene	< 0.78	ug/l	0.78	2.47	1	8260B		6/12/2019	CJR	1
p-Isopropyltoluene	< 0.24	ug/l	0.24	0.76	1	8260B		6/12/2019	CJR	1
Methylene chloride	< 1.32	ug/l	1.32	4.21	1	8260B		6/12/2019	CJR	1
Methyl tert-butyl ether (MTBE)	< 0.28	ug/l	0.28	0.89	1	8260B		6/12/2019	CJR	1
Naphthalene	< 2.1	ug/l	2.1	6.65	1	8260B		6/12/2019	CJR	1
n-Propylbenzene	< 0.61	ug/l	0.61	1.95	1	8260B		6/12/2019	CJR	1
1,1,2,2-Tetrachloroethane	< 0.3	ug/l	0.3	0.97	1	8260B		6/12/2019	CJR	1
1,1,1,2-Tetrachloroethane	< 0.35	ug/l	0.35	1.13	1	8260B		6/12/2019	CJR	1
Tetrachloroethene	< 0.38	ug/l	0.38	1.21	1	8260B		6/12/2019	CJR	1
Toluene	< 0.19	ug/l	0.19	0.6	1	8260B		6/12/2019	CJR	1
1,2,4-Trichlorobenzene	< 1.15	ug/l	1.15	3.67	1	8260B		6/12/2019	CJR	1

Project Name OHM-OCONOMOWOC
Project # 6143 PO#2019-0523

Invoice # E36303

Lab Code 5036303I
Sample ID 6143 EB-1
Sample Matrix Water
Sample Date 6/6/2019

	Result	Unit	LOD	LOQ	Dil	Method	Ext Date	Run Date	Analyst	Code
1,2,3-Trichlorobenzene	< 1.71	ug/l	1.71	5.43	1	8260B		6/12/2019	CJR	1
1,1,1-Trichloroethane	< 0.33	ug/l	0.33	1.05	1	8260B		6/12/2019	CJR	1
1,1,2-Trichloroethane	< 0.42	ug/l	0.42	1.32	1	8260B		6/12/2019	CJR	1
Trichloroethene (TCE)	< 0.3	ug/l	0.3	0.94	1	8260B		6/12/2019	CJR	1
Trichlorofluoromethane	< 0.35	ug/l	0.35	1.1	1	8260B		6/12/2019	CJR	1
1,2,4-Trimethylbenzene	< 0.8	ug/l	0.8	2.55	1	8260B		6/12/2019	CJR	1
1,3,5-Trimethylbenzene	< 0.63	ug/l	0.63	2	1	8260B		6/12/2019	CJR	1
Vinyl Chloride	< 0.2	ug/l	0.2	0.65	1	8260B		6/12/2019	CJR	1
m&p-Xylene	< 0.43	ug/l	0.43	1.38	1	8260B		6/12/2019	CJR	1
o-Xylene	< 0.29	ug/l	0.29	0.93	1	8260B		6/12/2019	CJR	1
SUR - 1,2-Dichloroethane-d4	105	REC %			1	8260B		6/12/2019	CJR	1
SUR - 4-Bromofluorobenzene	94	REC %			1	8260B		6/12/2019	CJR	1
SUR - Dibromofluoromethane	105	REC %			1	8260B		6/12/2019	CJR	1
SUR - Toluene-d8	98	REC %			1	8260B		6/12/2019	CJR	1

Project Name OHM-OCONOMOWOC
 Project # 6143 PO#2019-0523

Invoice # E36303

Lab Code 5036303J
 Sample ID 6143 DUP-1
 Sample Matrix Water
 Sample Date 6/6/2019

	Result	Unit	LOD	LOQ	Dil	Method	Ext Date	Run Date	Analyst	Code
Organic										
VOC's										
Benzene	< 0.22	ug/l	0.22	0.71	1	8260B		6/12/2019	CJR	1
Bromobenzene	< 0.44	ug/l	0.44	1.38	1	8260B		6/12/2019	CJR	1
Bromodichloromethane	< 0.33	ug/l	0.33	1.06	1	8260B		6/12/2019	CJR	1
Bromoform	< 0.45	ug/l	0.45	1.44	1	8260B		6/12/2019	CJR	1
tert-Butylbenzene	< 0.25	ug/l	0.25	0.8	1	8260B		6/12/2019	CJR	1
sec-Butylbenzene	< 0.79	ug/l	0.79	2.53	1	8260B		6/12/2019	CJR	1
n-Butylbenzene	< 0.71	ug/l	0.71	2.25	1	8260B		6/12/2019	CJR	1
Carbon Tetrachloride	< 0.31	ug/l	0.31	0.98	1	8260B		6/12/2019	CJR	1
Chlorobenzene	< 0.26	ug/l	0.26	0.83	1	8260B		6/12/2019	CJR	1
Chloroethane	< 0.61	ug/l	0.61	1.95	1	8260B		6/12/2019	CJR	1
Chloroform	1.47	ug/l	0.26	0.82	1	8260B		6/12/2019	CJR	1
Chloromethane	< 0.54	ug/l	0.54	1.72	1	8260B		6/12/2019	CJR	1
2-Chlorotoluene	< 0.31	ug/l	0.31	0.98	1	8260B		6/12/2019	CJR	1
4-Chlorotoluene	< 0.26	ug/l	0.26	0.83	1	8260B		6/12/2019	CJR	1
1,2-Dibromo-3-chloropropane	< 2.96	ug/l	2.96	9.43	1	8260B		6/12/2019	CJR	1
Dibromochloromethane	< 0.22	ug/l	0.22	0.69	1	8260B		6/12/2019	CJR	1
1,4-Dichlorobenzene	< 0.7	ug/l	0.7	2.22	1	8260B		6/12/2019	CJR	1
1,3-Dichlorobenzene	< 0.85	ug/l	0.85	2.7	1	8260B		6/12/2019	CJR	1
1,2-Dichlorobenzene	< 0.86	ug/l	0.86	2.74	1	8260B		6/12/2019	CJR	1
Dichlorodifluoromethane	< 0.32	ug/l	0.32	1.02	1	8260B		6/12/2019	CJR	1
1,2-Dichloroethane	< 0.25	ug/l	0.25	0.78	1	8260B		6/12/2019	CJR	1
1,1-Dichloroethane	< 0.36	ug/l	0.36	1.14	1	8260B		6/12/2019	CJR	1
1,1-Dichloroethene	< 0.42	ug/l	0.42	1.34	1	8260B		6/12/2019	CJR	1
cis-1,2-Dichloroethene	11.4	ug/l	0.37	1.16	1	8260B		6/12/2019	CJR	1
trans-1,2-Dichloroethene	< 0.34	ug/l	0.34	1.07	1	8260B		6/12/2019	CJR	1
1,2-Dichloropropane	< 0.44	ug/l	0.44	1.39	1	8260B		6/12/2019	CJR	1
1,3-Dichloropropane	< 0.3	ug/l	0.3	0.94	1	8260B		6/12/2019	CJR	1
trans-1,3-Dichloropropene	< 0.32	ug/l	0.32	1.01	1	8260B		6/12/2019	CJR	1
cis-1,3-Dichloropropene	< 0.26	ug/l	0.26	0.81	1	8260B		6/12/2019	CJR	1
Di-isopropyl ether	< 0.21	ug/l	0.21	0.66	1	8260B		6/12/2019	CJR	1
EDB (1,2-Dibromoethane)	< 0.34	ug/l	0.34	1.09	1	8260B		6/12/2019	CJR	1
Ethylbenzene	< 0.26	ug/l	0.26	0.83	1	8260B		6/12/2019	CJR	1
Hexachlorobutadiene	< 1.34	ug/l	1.34	4.28	1	8260B		6/12/2019	CJR	1
Isopropylbenzene	< 0.78	ug/l	0.78	2.47	1	8260B		6/12/2019	CJR	1
p-Isopropyltoluene	< 0.24	ug/l	0.24	0.76	1	8260B		6/12/2019	CJR	1
Methylene chloride	1.91 "J"	ug/l	1.32	4.21	1	8260B		6/12/2019	CJR	1
Methyl tert-butyl ether (MTBE)	< 0.28	ug/l	0.28	0.89	1	8260B		6/12/2019	CJR	1
Naphthalene	< 2.1	ug/l	2.1	6.65	1	8260B		6/12/2019	CJR	1
n-Propylbenzene	< 0.61	ug/l	0.61	1.95	1	8260B		6/12/2019	CJR	1
1,1,2,2-Tetrachloroethane	< 0.3	ug/l	0.3	0.97	1	8260B		6/12/2019	CJR	1
1,1,1,2-Tetrachloroethane	< 0.35	ug/l	0.35	1.13	1	8260B		6/12/2019	CJR	1
Tetrachloroethene	2.11	ug/l	0.38	1.21	1	8260B		6/12/2019	CJR	1
Toluene	0.23 "J"	ug/l	0.19	0.6	1	8260B		6/12/2019	CJR	1
1,2,4-Trichlorobenzene	< 1.15	ug/l	1.15	3.67	1	8260B		6/12/2019	CJR	1

Project Name OHM-OCONOMOWOC
 Project # 6143 PO#2019-0523

Invoice # E36303

Lab Code 5036303J
 Sample ID 6143 DUP-1
 Sample Matrix Water
 Sample Date 6/6/2019

	Result	Unit	LOD	LOQ	Dil	Method	Ext Date	Run Date	Analyst	Code
1,2,3-Trichlorobenzene	< 1.71	ug/l	1.71	5.43	1	8260B		6/12/2019	CJR	1
1,1,1-Trichloroethane	< 0.33	ug/l	0.33	1.05	1	8260B		6/12/2019	CJR	1
1,1,2-Trichloroethane	< 0.42	ug/l	0.42	1.32	1	8260B		6/12/2019	CJR	1
Trichloroethene (TCE)	0.32 "J"	ug/l	0.3	0.94	1	8260B		6/12/2019	CJR	1
Trichlorofluoromethane	< 0.35	ug/l	0.35	1.1	1	8260B		6/12/2019	CJR	1
1,2,4-Trimethylbenzene	< 0.8	ug/l	0.8	2.55	1	8260B		6/12/2019	CJR	1
1,3,5-Trimethylbenzene	< 0.63	ug/l	0.63	2	1	8260B		6/12/2019	CJR	1
Vinyl Chloride	3.8	ug/l	0.2	0.65	1	8260B		6/12/2019	CJR	1
m&p-Xylene	< 0.43	ug/l	0.43	1.38	1	8260B		6/12/2019	CJR	1
o-Xylene	< 0.29	ug/l	0.29	0.93	1	8260B		6/12/2019	CJR	1
SUR - Toluene-d8	97	REC %			1	8260B		6/12/2019	CJR	1
SUR - 1,2-Dichloroethane-d4	99	REC %			1	8260B		6/12/2019	CJR	1
SUR - 4-Bromofluorobenzene	92	REC %			1	8260B		6/12/2019	CJR	1
SUR - Dibromofluoromethane	104	REC %			1	8260B		6/12/2019	CJR	1

"J" Flag: Analyte detected between LOD and LOQ

LOD Limit of Detection

LOQ Limit of Quantitation

Code *Comment*

1 Laboratory QC within limits.

CWT denotes sub contract lab - Certification #445126660

All solid sample results reported on a dry weight basis unless otherwise indicated. All LOD's and LOQ's are adjusted for dilutions but not dry weight. Subcontracted results are denoted by SUB in the analyst field.

Authorized Signature



134

Environmental Lab, Inc.

1990 Prospect Ct. • Appleton, WI 54914
920-830-2455 • FAX 920-733-0631

Sample Handling Request

Rush Analysis Date Required _____
(Rushes accepted only with prior authorization)
 Normal Turn Around

Lab I.D. # _____
Account No.: _____ Quote No.: _____
Project #: 6142
Sampler: (signature) [Signature]

Project (Name / Location): OTHM - Oconomowoc / Oconomowoc LE
Reports To: W. Fassbender / K. Heinstad Invoice To: _____
Company: Enviroforensics Company: _____
Address: N16W 23390 Stone Ridge Dr. Address: _____
City State Zip: Waukesha, WI 53188 City State Zip: _____
Phone: 209-390-9814 Phone: _____
FAX: _____ FAX: _____

Analysis Requested										Other Analysis									
DRO (Mod DRO Sep 95)	GRO (Mod GRO Sep 95)	LEAD	NITRATE/NITRITE	OIL & GREASE	PAH (EPA 8270)	PCB	PVOC (EPA 8021)	PVOC + NAPHTHALENE	SULFATE	TOTAL SUSPENDED SOLIDS	VOC DW (EPA 524.2)	VOC (EPA 8260)	8-PCRA METALS	ethene/ethane/propane	Total IRON	Dissolved IRON	Nitrate	Nitrite	PID/ FID
									X		X			X	X	X	X	X	
											X								
											X								
											X								
											X								
											X								
											X								
											X								
											X								
											X								
											X								
											X								

Lab I.D.	Sample I.D.	Collection Date	Time	Comp	Grab	Filtered Y/N	No. of Containers	Sample Type (Matrix)*	Preservation
5056303A	6142-MW-1	6-7	1233		X	*	8	GW	multiple
B	6142-MW-2D	6-6	958				3		HCL
C	6142-MW-2	6-6	1048				3		HCL
D	6142-MW-3	6-6	1327				3		HCL
E	6142-MW-4	6-6	1230				3		HCL
F	6142-MW-5	6-7	1327			*	8		multiple
G	6142-MW-6	6-6	1412				3		HCL
H	6142-MW-11	6-6	1133				3		HCL
I	6142-EB-1	6-6	1425				3		HCL
J	6142-DJP-1	6-7	-				3		HCL

Comments/Special Instructions (*Specify groundwater "GW", Drinking Water "DW", Waste Water "WW", Soil "S", Air "A", Oil, Sludge etc.) VOC - HCL
PO# 2019-0523 * only Dissolved IRON was filtered Preservation: ethene/ethane/propane - HCL
TB not recd - ep 6/10/19
Total Fe - HNO₃
Dissolved Fe - HNO₃
nitrite - H₂SO₄
nitrate/sulfate - none

Sample Integrity - To be completed by receiving lab.
 Method of Shipment: GC
 Temp. of Temp. Blank _____ °C On Ice:
 Cooler seal intact upon receipt: Yes _____ No

Relinquished By: (sign) [Signature] Time 1615 Date 6-7-19
 Received By: (sign) [Signature] Time 10:00 Date 6/8/19

CHAIN OF CUSTODY RECORD

Synergy

Environmental Lab, Inc.

1990 Prospect Ct. • Appleton, WI 54914
920-830-2455 • FAX 920-733-0631

Chain # No 303

Page 2 of 2

Sample Handling Request

Rush Analysis Date Required _____
(Rushes accepted only with prior authorization)

Normal Turn Around

Lab I.D. # _____
Account No. : _____ Quote No.: _____
Project #: 6143
Sampler: (signature) *Z Du*

Project (Name / Location): OHM-ocmonowoc, WI
Reports To: W. Fasbender, K. Heinstead
Company: Enviroforensics
Address: N16 W 23390 Stone Ridge Dr.
City State Zip: Waukesha, WI 53186
Phone: 209-340-9814
FAX: _____

Analysis Requested										Other Analysis										
DRO (Mod DRO Sep 95)	GRO (Mod GRO Sep 95)	LEAD	NITRATE/NITRITE	OIL & GREASE	PAH (EPA 8270)	PCH	PVOC (EPA 8021)	PVOC + NAPHTHALENE	SULFATE	TOTAL SUSPENDED SOLIDS	VOC DW (EPA 542.2)	VOC (EPA 8260)	8-PCRA METALS	PID/FID						

Lab I.D.	Sample I.D.	Collection Date	Time	Comp	Grab	Filtered Y/N	No. of Containers	Sample Type (Matrix)*	Preservation
S036303k	6143-TB	-	-		X	N	1	GW	HCC

Comments/Special Instructions (*Specify groundwater "GW", Drinking Water "DW", Waste Water "WW", Soil "S", Air "A", Oil, Sludge etc.)
PO# 2019-0523

Sample Integrity - To be completed by receiving lab.
Method of Shipment: GA
Temp. of Temp. Blank _____ °C On Ice:
Cooler seal intact upon receipt: Yes _____ No

Relinquished By: (sign) *Z Du* Time 1615 Date 6-7-19
Received By: (sign) *Gold Cross* Time 1615 Date 6-7-19
Received in Laboratory By: *Ch...* Time 10:00 Date 6/8/19