



November 5, 2020

EXCHANGERIGHT

Attn: Asset Management Group
1055 E. Colorado Blvd., Suite 310
Pasadena, CA 91106

**Subject: Environmental sampling results
BRTTS #: 02-68-551911**

To Whom it May Concern:

EnviroForensics, LLC (EnviroForensics) is providing the results of recent groundwater and soil vapor samples collected from your property located at 36929 Plank Road in Oconomowoc, Wisconsin in accordance with the Wisconsin Department of Natural Resources (WDNR) regulation NR 716.14.

The Responsible Party is:

Mr. Brian Cass
OHM Holdings, Inc.
W229 N2494 Hwy F
Waukesha, WI 53186
Telephone: 262-521-9710

Groundwater samples were collected from eleven (11) monitoring wells (MW-1, MW-1D, MW-2, MW-3, MW-4, MW-5, MW-6, MW-8, MW-11, and PZ-1) during September 21-24, 2020. The locations of the monitoring wells are shown on attached **Figure 1**. The groundwater samples were analyzed for the “dry cleaner list” of chlorinated volatile organic compounds (CVOCs).

In addition, soil vapor samples were collected from the locations of MW-1, nested vapor sampling points SG-1 through SG-3, and vapor sampling points VP-1s, VP-1d, and VP-3s. The locations of these sampling points are shown on attached **Figure 2**.

Sampling Results

The laboratory results of groundwater sampling are summarized and compared to public health criteria in attached **Table 1**. Excerpts from the analytical laboratory reports are also attached.

As can be seen in **Table 1**, tetrachloroethene (PCE) concentrations in wells MW-3 through MW-

Document: 6143-1489

6, MW-11, and PZ-1 exceeded the groundwater enforcement standard (ES) of 5 micrograms per liter ($\mu\text{g/L}$) for that compound. In addition, the ES was exceeded for trichloroethene (TCE) in well MW-5 and the ES for vinyl chloride exceeded in MW-1. The groundwater preventative action limit (PAL) was exceeded for PCE in well MW-8, for TCE in well MW-6, and for cis-1,2 dichloroethene in well MW-5.

The results of soil vapor samples are shown on **Figure 2** and in **Table 2**. The laboratory analytical report is also attached. The concentrations of CVOCs in soil vapor continue to be well below the Vapor Risk Levels (VRSLs) established for large commercial buildings.

We anticipate submitting to the WDNR a request for site closure in late 2020 or early 2021. We are unsure whether additional sampling of the wells will be required in the future. If not, the wells will be properly abandoned.

If you have any questions or concerns, please contact me at 414-982-3988 or by email at wfassbender@enviroforensics.com.

The WDNR project manager, Greg Michael, can be reached at 262-574-2176. We greatly appreciate your help and patience with this matter.

Sincerely,
EnviroForensics, LLC

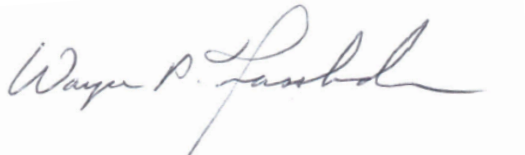
A handwritten signature in black ink that reads "Wayne P. Fassbender".

Wayne Fassbender, PG, PMP
Senior Project Manager

Attachments: Figure 1: Monitoring Well Location Map
Figure 2: Soil Vapor Analytical Results Map
Table 1: Monitoring Well Sample Analytical Results
Table 2: Soil Gas Analytical Results Summary
Laboratory Analytical Results Sheets

Copy: Brian Cass, OHM Holdings, Inc.
Greg Michael, Wisconsin Department of Natural Resources

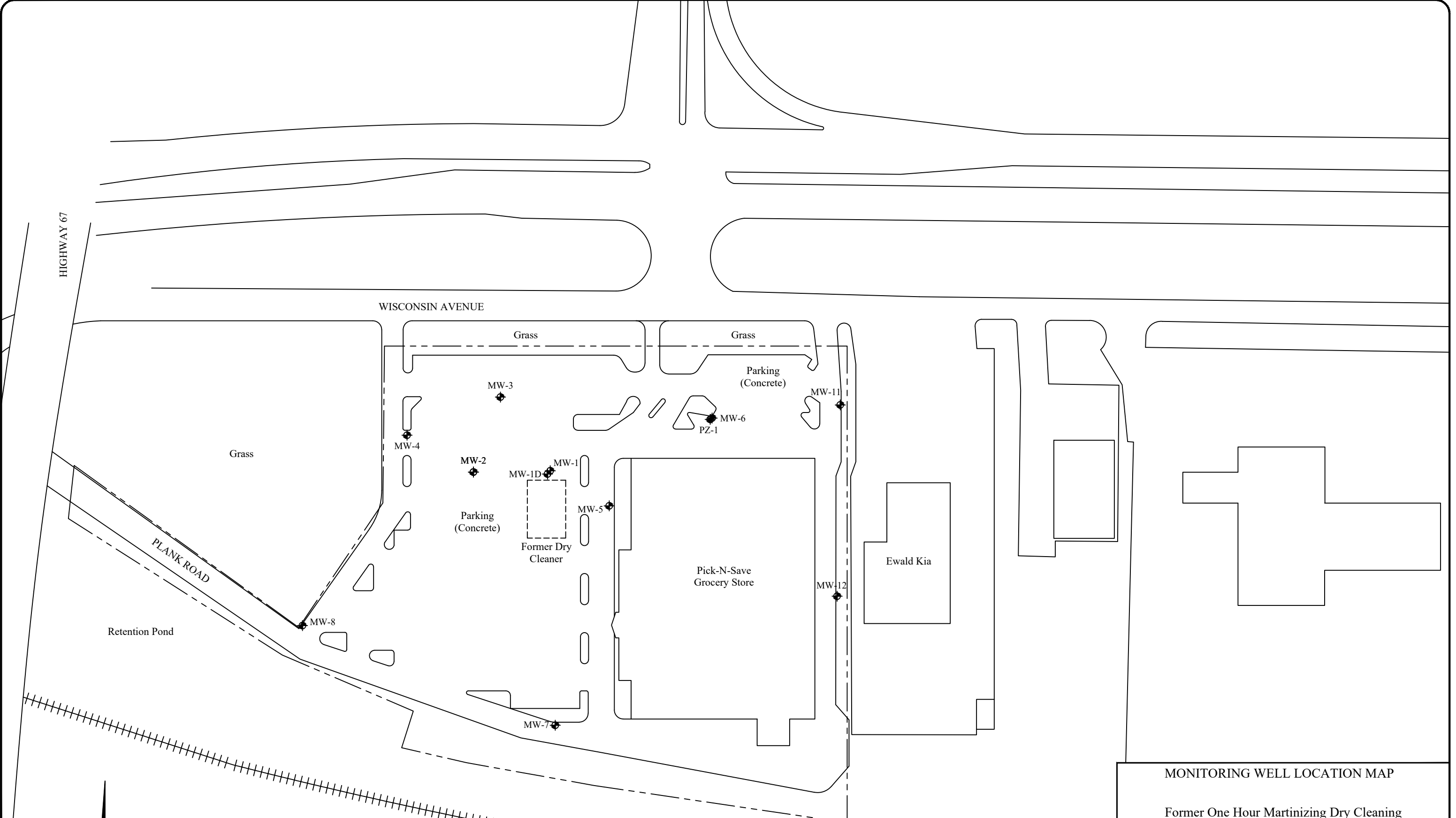

MONITORING WELL LOCATION MAP
 Former One Hour Martinizing Dry Cleaning
 36929 Plank Road
 Oconomowoc, WI

Date:	1/15/20
Designed:	EB
Drawn:	EB
Checked:	KH
DWG file:	6143-1608

 825 North Capitol Avenue • Indianapolis, IN 46204
 EnviroForensics.com

Figure	1
Project	6143

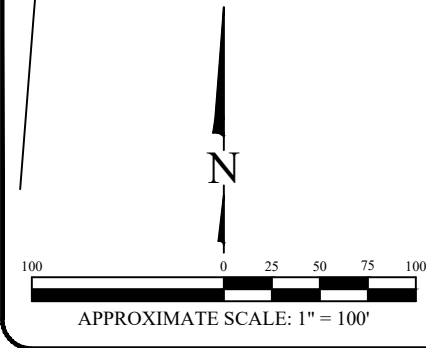

HIGHWAY 67

VP-3s	12/20/19	9/23/20
PCE	372	8,220
TCE	4.94	<10.7
VP-3d	12/20/19	9/23/20
PCE	948	NS
TCE	13.3	

SG-1s	6/21/13	1/17/18	12/20/19	9/23/20
PCE	20,000	1,260	86.8	276
SG-1d	6/21/13	1/17/18	12/20/19	9/23/20
PCE	80,000	2,440	248	489

Legend

- Property boundary
- MW-1 Monitoring well sample location
- SG-1s/d Nested soil gas sampling point
- SVE-1s/d SVE wells
- VP-1s/d Nested vacuum monitoring point

Analyte	Soil Vapor Risk Screening Level		
	Large Commercial/Industrial ¹	Small Commercial ²	Residential ³
PCE	18,000	6,000	1,400
TCE	880	290	70
Vinyl Chloride	2,800	930	57

- Notes:
- Bolded and orange shaded values exceed the Large Commercial/Industrial Vapor Risk Screening Level
 - Bolded and blue shaded values exceed the Small Commercial Vapor Risk Screening Level
 - Bolded and green shaded values exceed the Residential Vapor Risk Screening Level
 - Bolded values exceed laboratory reporting limits
 - All concentrations reported in reported in micrograms per cubic meter (ug/m³)
 - PCE = Tetrachloroethene
 - TCE = Trichloroethene
 - s = Shallow Soil Gas
 - d = Deep Soil Gas
 - NS = Not sampled
 - ¹ = The Vapor Risk Screening Levels (VRSL's) are based on US EPA's Regional Screening Levels (RSL's) for Large Commercial indoor air with an attenuation factor of 0.01 for soil gas below large commercial/industrial
 - ² = The Vapor Risk Screening Levels (VRSL's) are based on US EPA's Regional Screening Levels (RSL's) for Small Commercial indoor air with an attenuation factor of 0.03 for soil gas below small commercial
 - ³ = The Vapor Risk Screening Levels (VRSL's) are based on US EPA's Regional Screening Levels (RSL's) for Residential indoor air with an attenuation factor of 0.03 for soil gas below residential

MW-1	1/17/18	9/23/20
PCE	14,700	404
TCE	83.8	23.1
Vinyl Chloride	<12.8	343

MW-2	1/17/18
PCE	14.8

VP-1s	12/20/19	9/23/20
PCE	28.6	1,000
VP-1d	12/20/19	9/23/20
PCE	<3.19	3,130
TCE	<10.7	23.1

SG-2s	6/21/13	1/17/18	12/20/19	9/23/20
PCE	3,600	NS	231	1,320
TCE	120		<10.7	<10.7
SG-2d	6/21/13	1/17/18	12/20/19	9/23/20
PCE	22,000	6,470	1,610	2,360
TCE	<330	<10.7	<10.7	103

SG-3s	6/21/13	1/17/18	12/20/19	9/23/20
PCE	570	NS	<3.19	1,510
TCE	31		<1.07	<1.07
SG-3d	6/21/13	1/17/18	12/20/19	9/23/20
PCE	15,000	1,610	758	2,330
TCE	<170	<10.7	16.7	29.6

WISCONSIN AVENUE

PLANK ROAD

Retention Pond

Grass

Grass

Parking (Concrete)

Parking (Concrete)

Former Dry Cleaner

Pick-N-Save Grocery Store

Ewald Kia

Napa

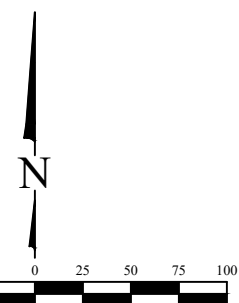

APPROXIMATE SCALE: 1" = 100'

SOIL VAPOR ANALYTICAL RESULTS MAP

Martinizing Dry Cleaning
36929 Plank Road
Oconomowoc, WI

Date:	11/3/20
Designed:	EB
Drawn:	EB
Checked:	WF
DWG file:	6143-1751



825 North Capitol Avenue • Indianapolis, IN 46204
EnviroForensics.com

Figure	2
Project	6143

TABLE 1
MONITORING WELL SAMPLE ANALYTICAL RESULTS

Former One Hour Martinizing Cleaners
Oconomowoc, Wisconsin

Monitoring Well ID	Sample Date	Tetrachloroethene	Trichloroethene	cis-1,2-Dichloroethene	trans-1,2-Dichloroethene	Vinyl chloride
Preventive Action Limit		0.5	0.5	7	20	0.02
Enforcement Standard		5	5	70	100	0.2
MW-1	5/18/2018	44	1.38	<0.37	<0.34	<0.2
	8/29/2018	3.2	0.59 J	0.50 J	<0.34	<0.2
	11/28/2018	9.7	7.0	19.5	<0.34	0.76
	3/18/2019	2.7	0.49 J	20.5	<0.34	7.3
	6/6/2019 ³	2.03	0.44 J	11.1	<0.34	3.9
	9/4/2019 ³	1.35	0.37 J	6.6	<0.34	2.5
	12/12/2019	0.78 J	0.44 J	1.19	<0.34	1.41
	6/16/2020	0.4 J	0.82 J	5.7	<0.37	<0.2
	9/22/2020	<0.33	<0.47	6.6	<0.37	5.4
MW-1D	5/18/2018	0.66 J	<0.3	<0.37	<0.34	<0.2
	11/28/2018	<0.48	<0.3	0.61 J	<0.34	<0.2
	6/6/2019	0.51 J	<0.3	<0.37	<0.34	<0.2
	12/10/2019	1.1 J	<0.3	<0.37	<0.34	<0.2
	6/16/2020	<0.33	<0.47	<0.39	<0.37	<0.2
	9/22/2020	<0.33	<0.47	<0.39	<0.37	<0.2
DUP-1	9/22/2020	<0.33	<0.47	<0.39	<0.37	<0.2
MW-2	5/18/2018	4.7	<0.3	<0.37	<0.34	<0.2
	8/29/2018	<0.38	<0.3	<0.37	<0.34	<0.2
	11/28/2018	<0.38	<0.3	<0.37	<0.34	<0.2
	3/18/2019	<0.38	<0.3	<0.37	<0.34	<0.2
	6/6/2019	<0.38	<0.3	<0.37	<0.34	<0.2
	9/4/2019	<0.38	<0.3	<0.37	<0.34	<0.2
	12/10/2019	0.67 J	<0.3	<0.37	<0.34	<0.2
	6/16/2020	0.62 J	<0.47	0.39 J	<0.37	<0.2
	9/21/2020	<0.33	<0.47	<0.39	<0.37	<0.2
MW-3	5/18/2018	52	1.23	<0.37	<0.34	<0.2
	8/29/2018	41	0.79 J	<0.37	<0.34	<0.2
	11/27/2018	54	0.89 J	<0.37	<0.34	<0.2
	3/18/2019	44	0.72 J	<0.37	<0.34	<0.2
	6/6/2019	47	0.54 J	<0.37	<0.34	<0.2
	9/5/2019	33	0.40 J	<0.37	<0.34	<0.2
	12/10/2019	43	0.57 J	<0.37	<0.34	<0.2
	6/16/2020	37	<0.47	<0.39	<0.37	<0.2
	9/23/2020	21.1	<0.47	<0.39	<0.37	<0.2
DUP-2	9/23/2020	21.2	<0.47	<0.39	<0.37	<0.2
MW-4	5/18/2018	30.1	<0.3	<0.37	<0.34	<0.2
	8/29/2018	35	<0.3	<0.37	<0.34	<0.2
	11/27/2018	52	<0.3	<0.37	<0.34	<0.2
	3/18/2019	33	<0.3	<0.37	<0.34	<0.2
	6/6/2019	11.3	<0.3	<0.37	<0.34	<0.2
	9/5/2019	11.4	<0.3	<0.37	<0.34	<0.2
	12/10/2019	38	<0.3	<0.37	<0.34	<0.2
	6/16/2020	26.4	<0.47	<0.39	<0.37	<0.2
	9/21/2020	12	<0.47	<0.39	<0.37	<0.2

TABLE 1
MONITORING WELL SAMPLE ANALYTICAL RESULTS

Former One Hour Martinizing Cleaners
Oconomowoc, Wisconsin

Monitoring Well ID	Sample Date	Tetrachloroethene	Trichloroethene	cis-1,2-Dichloroethene	trans-1,2-Dichloroethene	Vinyl chloride
Preventive Action Limit		0.5	0.5	7	20	0.02
Enforcement Standard		5	5	70	100	0.2
MW-5	5/18/2018	99	<0.3	<0.37	<0.34	<0.2
	8/29/2018	43	<0.3	0.47 J	<0.34	<0.2
	11/28/2018	39	0.58 J	0.61 J	<0.34	<0.2
	3/18/2019	27.2	0.83 J	<0.37	<0.34	<0.2
	6/7/2019	19.5	1.41	<0.37	<0.34	<0.2
	9/5/2019	21.6	4.9	0.54 J	<0.34	<0.2
	12/12/2019	17.9	19.5	4.0	<0.34	<0.2
	6/16/2020	6.9	15.3	7.5	<0.37	<0.2
	9/24/2020	6.5	7.4	12.3	<0.37	<0.2
MW-6	5/18/2018	55	0.62 J	<0.37	<0.34	<0.2
	8/29/2018	27	<0.3	<0.37	<0.34	<0.2
	11/27/2018	36	<0.3	<0.37	<0.34	<0.2
	3/18/2019	35	<0.3	<0.37	<0.34	<0.2
	6/6/2019	29.5	<0.3	<0.37	<0.34	<0.2
	9/5/2019	22.8	<0.3	<0.37	<0.34	<0.2
	12/12/2019	25.1	<0.3	<0.37	<0.34	<0.2
	6/16/2020	24.4	1.57	<0.39	<0.37	<0.2
	9/22/2020	21.4	1.07 J	<0.39	<0.37	<0.2
MW-8	12/9/2019	3.20	<0.3	<0.37	<0.34	<0.2
	6/17/2020	3.15	<0.47	<0.39	<0.37	<0.2
	9/22/2020	2.66	<0.47	<0.39	<0.37	<0.2
MW-11	5/18/2018	20.6	0.35 J	0.76 J	<0.34	<0.2
	8/29/2018	26.9	<0.3	<0.37	<0.34	<0.2
	11/27/2018	<0.38	<0.3	<0.37	<0.34	<0.2
	3/18/2019	1.37	<0.3	0.46 J	<0.34	<0.2
	6/6/2019	4.1	<0.3	<0.37	<0.34	<0.2
	9/4/2019	8.7	<0.3	<0.37	<0.34	<0.2
	12/11/2019	47	0.45 J	<0.37	<0.34	<0.2
	6/17/2020	18.8	<0.47	<0.39	<0.37	<0.2
	9/22/2020	22.3	<0.47	<0.39	<0.37	<0.2
PZ-1	12/12/2019	6.6	<0.3	<0.37	<0.34	<0.2
	6/16/2020	7.9	<0.47	<0.39	<0.37	<0.2
	9/22/2020	9.1	<0.47	<0.39	<0.37	<0.2

Notes:

Samples analyzed using EPA SW-846 Method 8260

All concentrations reported in units of micrograms per liter (µg/L)

Bolded and orange shaded values are above Public Health Enforcement Standards

Bolded and blue shaded values are above Public Health Preventive Action Limits

J = Estimated concentration between the laboratory Method Detection Limit and Reporting Limit

NA = Not Analyzed

³ = Methylene Chloride detected at a concentration above the preventive action limit

TABLE 2
SOIL GAS ANALYTICAL RESULTS SUMMARY

Former One Hour Martinizing Cleaners
Oconomowoc, Wisconsin

Sample Identification	Sample Depth (feet)	Sample Date	Tetrachloroethene	Trichloroethene	cis-1,2-Dichloroethene	trans-1,2-Dichloroethene	Vinyl Chloride
Vapor Risk Screening Level Large Commercial/Industrial			18,000	880	NE	NE	2,800
Vapor Risk Screening Level Small Commercial			6,000	290	NE	NE	930
Vapor Risk Screening Level Residential			1,400	70	NE	NE	57
6143-SG-1s	6	6/21/2013	20,000	<170	<130	<130	<82
		1/17/2018	1,260	<10.7	<198	<396	<12.8
		12/20/2019	86.8	<10.7	<198	<396	<12.8
		9/23/2020	276	<10.7	<198	<396	<12.8
6143-SG-1d	25	6/21/2013	80,000	<1000	<770	<770	<500
		1/17/2018	2,440	<10.7	<198	<396	<12.8
		12/20/2019	248	<10.7	<198	<396	<12.8
		9/23/2020	489	<10.7	<198	<396	<12.8
6143-SG-2s	6	6/21/2013	3,600	120	<37	<37	<24
		12/20/2019	231	<10.7	<198	<396	<12.8
		9/23/2020	1,320	<10.7	<198	<396	<12.8
6143-SG-2d	25	6/21/2013	22,000	<330	<250	<250	<160
		1/17/2018	6,470	<10.7	<198	<396	<12.8
		12/20/2019	1,610	<10.7	<198	<396	<12.8
		9/23/2020	2,360	103	<198	<396	<12.8
6143-SG-3s	6	6/21/2013	570	31	<7.9	<7.9	<5.1
		12/20/2019	<3.19	<1.07	<19.8	<39.6	<1.28
		9/23/2020	1,510	<10.7	<198	<396	<12.8
6143-SG-3d	25	6/21/2013	15,000	<170	<130	<130	<82
		1/17/2018	1,610	<10.7	<198	<396	<12.8
		12/20/2019	758	16.7	<198	<396	<12.8
		9/23/2020	2,330	29.6	<198	<396	<12.8
6143-MW-1	27	1/17/2018	14,700	83.8	<198	<396	<12.8
		9/23/2020	404	23.1	<198	<396	343
6143-MW-2	25.5	1/17/2018	14.8	<1.07	<19.8	<39.6	<1.28
6143-VP-1s	10	12/20/2019	28.6	<1.07	<19.8	<39.6	<1.28
		9/23/2020	1,000	<10.7	<198	<396	<12.8
6143-VP-1d	25	12/20/2019	<3.19	<1.07	<19.8	<39.6	<1.28
		9/23/2020	3,130	23.1	<198	<396	<12.8
6143-VP-3s	10	12/20/2019	372	4.94	<19.8	<39.6	<1.28
		9/23/2020	8,220	<10.7	<198	<396	<12.8
6143-VP-3d	25	12/20/2019	948	13.3	<19.8	<39.6	<1.28

Notes:

Vapor Risk Screening Levels are calculated in accordance with the procedures listed in WDNR Publication RR-800 and subsequent guidance

All concentrations reported in units of micrograms per cubic meter ($\mu\text{g}/\text{m}^3$)

Bolded values are above detection limits

Bolded and Orange Shaded values exceed the Large Commercial/Industrial Vapor Risk Screening Level

Bolded and Blue Shaded values exceed the Small Commercial Vapor Risk Screening Level

Bolded and Green Shaded values exceed the Residential Vapor Risk Screening Level

"s" designation is for shallow soil gas samples

"d" designation is for deep soil gas samples

NE = Not Established

Synergy Environmental Lab, INC

1990 Prospect Ct., Appleton, WI 54914 *P 920-830-2455 * F 920-733-0631

BRIAN KAPPEN
ENVIROFORENSICS
N16 W 23390 STONERIDGE DR
WAUKESHA WI 53188

Report Date 14-Oct-20

Project Name OHM-OCONOMOWOC
Project # 6143

Invoice # E38538

Lab Code 5038538A
Sample ID 6143-MW-1
Sample Matrix Water
Sample Date 9/22/2020

	Result	Unit	LOD	LOQ	Dil	Method	Ext Date	Run Date	Analyst	Code
Organic										
GASES										
Ethane	< 0.5	ug/l	0.5	1.5	1	8015		10/13/2020	MJR	1
Ethene	< 0.5	ug/l	0.5	1.5	1	8015		10/13/2020	MJR	1
Methane	12800	ug/l	20	60	20	8015		10/13/2020	MJR	1
VOC's										
cis-1,2-Dichloroethene	6.6	ug/l	0.39	1.2	1	8260B	9/29/2020	9/29/2020	MJR	1
trans-1,2-Dichloroethene	< 0.37	ug/l	0.37	1.2	1	8260B	9/29/2020	9/29/2020	MJR	1
Tetrachloroethene	< 0.33	ug/l	0.33	1	1	8260B	9/29/2020	9/29/2020	MJR	1
Trichloroethene (TCE)	< 0.47	ug/l	0.47	1.5	1	8260B	9/29/2020	9/29/2020	MJR	1
Vinyl Chloride	5.4	ug/l	0.2	0.65	1	8260B	9/29/2020	9/29/2020	MJR	1
SUR - 1,2-Dichloroethane-d4	110	REC %			1	8260B	9/29/2020	9/29/2020	MJR	1
SUR - 4-Bromofluorobenzene	102	REC %			1	8260B	9/29/2020	9/29/2020	MJR	1
SUR - Dibromofluoromethane	112	REC %			1	8260B	9/29/2020	9/29/2020	MJR	1
SUR - Toluene-d8	97	REC %			1	8260B	9/29/2020	9/29/2020	MJR	1

Project Name OHM-OCONOMOWOC
Project # 6143

Invoice # E38538

Lab Code 5038538B
Sample ID 6143-MW-1D
Sample Matrix Water
Sample Date 9/22/2020

	Result	Unit	LOD	LOQ	Dil	Method	Ext Date	Run Date	Analyst	Code
Organic										
VOC's										
cis-1,2-Dichloroethene	< 0.39	ug/l	0.39	1.2	1	8260B	9/29/2020	9/29/2020	MJR	1
trans-1,2-Dichloroethene	< 0.37	ug/l	0.37	1.2	1	8260B	9/29/2020	9/29/2020	MJR	1
Tetrachloroethene	< 0.33	ug/l	0.33	1	1	8260B	9/29/2020	9/29/2020	MJR	1
Trichloroethene (TCE)	< 0.47	ug/l	0.47	1.5	1	8260B	9/29/2020	9/29/2020	MJR	1
Vinyl Chloride	< 0.2	ug/l	0.2	0.65	1	8260B	9/29/2020	9/29/2020	MJR	1
SUR - 1,2-Dichloroethane-d4	103	REC %			1	8260B	9/29/2020	9/29/2020	MJR	1
SUR - 4-Bromofluorobenzene	99	REC %			1	8260B	9/29/2020	9/29/2020	MJR	1
SUR - Dibromofluoromethane	112	REC %			1	8260B	9/29/2020	9/29/2020	MJR	1
SUR - Toluene-d8	96	REC %			1	8260B	9/29/2020	9/29/2020	MJR	1

Lab Code 5038538C
Sample ID 6143-MW-2
Sample Matrix Water
Sample Date 9/21/2020

	Result	Unit	LOD	LOQ	Dil	Method	Ext Date	Run Date	Analyst	Code
Organic										
VOC's										
cis-1,2-Dichloroethene	< 0.39	ug/l	0.39	1.2	1	8260B	9/29/2020	9/29/2020	MJR	1
trans-1,2-Dichloroethene	< 0.37	ug/l	0.37	1.2	1	8260B	9/29/2020	9/29/2020	MJR	1
Tetrachloroethene	< 0.33	ug/l	0.33	1	1	8260B	9/29/2020	9/29/2020	MJR	1
Trichloroethene (TCE)	< 0.47	ug/l	0.47	1.5	1	8260B	9/29/2020	9/29/2020	MJR	1
Vinyl Chloride	< 0.2	ug/l	0.2	0.65	1	8260B	9/29/2020	9/29/2020	MJR	1
SUR - Toluene-d8	95	REC %			1	8260B	9/29/2020	9/29/2020	MJR	1
SUR - Dibromofluoromethane	108	REC %			1	8260B	9/29/2020	9/29/2020	MJR	1
SUR - 4-Bromofluorobenzene	100	REC %			1	8260B	9/29/2020	9/29/2020	MJR	1
SUR - 1,2-Dichloroethane-d4	101	REC %			1	8260B	9/29/2020	9/29/2020	MJR	1

Lab Code 5038538D
Sample ID 6143-MW-3
Sample Matrix Water
Sample Date 9/23/2020

	Result	Unit	LOD	LOQ	Dil	Method	Ext Date	Run Date	Analyst	Code
Organic										
VOC's										
cis-1,2-Dichloroethene	< 0.39	ug/l	0.39	1.2	1	8260B	9/29/2020	9/29/2020	MJR	1
trans-1,2-Dichloroethene	< 0.37	ug/l	0.37	1.2	1	8260B	9/29/2020	9/29/2020	MJR	1
Tetrachloroethene	21.1	ug/l	0.33	1	1	8260B	9/29/2020	9/29/2020	MJR	1
Trichloroethene (TCE)	< 0.47	ug/l	0.47	1.5	1	8260B	9/29/2020	9/29/2020	MJR	1
Vinyl Chloride	< 0.2	ug/l	0.2	0.65	1	8260B	9/29/2020	9/29/2020	MJR	1
SUR - 1,2-Dichloroethane-d4	103	REC %			1	8260B	9/29/2020	9/29/2020	MJR	1
SUR - 4-Bromofluorobenzene	98	REC %			1	8260B	9/29/2020	9/29/2020	MJR	1
SUR - Dibromofluoromethane	110	REC %			1	8260B	9/29/2020	9/29/2020	MJR	1
SUR - Toluene-d8	97	REC %			1	8260B	9/29/2020	9/29/2020	MJR	1

Project Name OHM-OCONOMOWOC
Project # 6143

Invoice # E38538

Lab Code 5038538E
Sample ID 6143-MW-4
Sample Matrix Water
Sample Date 9/21/2020

	Result	Unit	LOD	LOQ	Dil	Method	Ext Date	Run Date	Analyst	Code
Organic										
VOC's										
cis-1,2-Dichloroethene	< 0.39	ug/l	0.39	1.2	1	8260B	9/29/2020	9/29/2020	MJR	1
trans-1,2-Dichloroethene	< 0.37	ug/l	0.37	1.2	1	8260B	9/29/2020	9/29/2020	MJR	1
Tetrachloroethene	12	ug/l	0.33	1	1	8260B	9/29/2020	9/29/2020	MJR	1
Trichloroethene (TCE)	< 0.47	ug/l	0.47	1.5	1	8260B	9/29/2020	9/29/2020	MJR	1
Vinyl Chloride	< 0.2	ug/l	0.2	0.65	1	8260B	9/29/2020	9/29/2020	MJR	1
SUR - 1,2-Dichloroethane-d4	106	REC %			1	8260B	9/29/2020	9/29/2020	MJR	1
SUR - 4-Bromofluorobenzene	102	REC %			1	8260B	9/29/2020	9/29/2020	MJR	1
SUR - Dibromofluoromethane	116	REC %			1	8260B	9/29/2020	9/29/2020	MJR	1
SUR - Toluene-d8	96	REC %			1	8260B	9/29/2020	9/29/2020	MJR	1

Lab Code 5038538F
Sample ID 6143-MW-5
Sample Matrix Water
Sample Date 9/24/2020

	Result	Unit	LOD	LOQ	Dil	Method	Ext Date	Run Date	Analyst	Code
Organic										
GASES										
Ethane	< 0.5	ug/l	0.5	1.5	1	8015		10/13/2020	MJR	1
Ethene	< 0.5	ug/l	0.5	1.5	1	8015		10/13/2020	MJR	1
Methane	155	ug/l	1	3	1	8015		10/13/2020	MJR	1
VOC's										
cis-1,2-Dichloroethene	12.3	ug/l	0.39	1.2	1	8260B	9/29/2020	9/29/2020	MJR	1
trans-1,2-Dichloroethene	< 0.37	ug/l	0.37	1.2	1	8260B	9/29/2020	9/29/2020	MJR	1
Tetrachloroethene	6.5	ug/l	0.33	1	1	8260B	9/29/2020	9/29/2020	MJR	1
Trichloroethene (TCE)	7.4	ug/l	0.47	1.5	1	8260B	9/29/2020	9/29/2020	MJR	1
Vinyl Chloride	< 0.2	ug/l	0.2	0.65	1	8260B	9/29/2020	9/29/2020	MJR	1
SUR - 1,2-Dichloroethane-d4	98	REC %			1	8260B	9/29/2020	9/29/2020	MJR	1
SUR - 4-Bromofluorobenzene	101	REC %			1	8260B	9/29/2020	9/29/2020	MJR	1
SUR - Dibromofluoromethane	106	REC %			1	8260B	9/29/2020	9/29/2020	MJR	1
SUR - Toluene-d8	95	REC %			1	8260B	9/29/2020	9/29/2020	MJR	1

Project Name OHM-OCONOMOWOC
Project # 6143

Invoice # E38538

Lab Code 5038538G
Sample ID 6143-MW-6
Sample Matrix Water
Sample Date 9/22/2020

	Result	Unit	LOD	LOQ	Dil	Method	Ext Date	Run Date	Analyst	Code
Organic										
VOC's										
cis-1,2-Dichloroethene	< 0.39	ug/l	0.39	1.2	1	8260B	9/29/2020	9/29/2020	MJR	1
trans-1,2-Dichloroethene	< 0.37	ug/l	0.37	1.2	1	8260B	9/29/2020	9/29/2020	MJR	1
Tetrachloroethene	21.4	ug/l	0.33	1	1	8260B	9/29/2020	9/29/2020	MJR	1
Trichloroethene (TCE)	1.07 "J"	ug/l	0.47	1.5	1	8260B	9/29/2020	9/29/2020	MJR	1
Vinyl Chloride	< 0.2	ug/l	0.2	0.65	1	8260B	9/29/2020	9/29/2020	MJR	1
SUR - 1,2-Dichloroethane-d4	93	REC %			1	8260B	9/29/2020	9/29/2020	MJR	1
SUR - Toluene-d8	97	REC %			1	8260B	9/29/2020	9/29/2020	MJR	1
SUR - 4-Bromofluorobenzene	100	REC %			1	8260B	9/29/2020	9/29/2020	MJR	1
SUR - Dibromofluoromethane	105	REC %			1	8260B	9/29/2020	9/29/2020	MJR	1

Lab Code 5038538H
Sample ID 6143-MW-8
Sample Matrix Water
Sample Date 9/22/2020

	Result	Unit	LOD	LOQ	Dil	Method	Ext Date	Run Date	Analyst	Code
Organic										
VOC's										
cis-1,2-Dichloroethene	< 0.39	ug/l	0.39	1.2	1	8260B	9/29/2020	9/29/2020	MJR	1
trans-1,2-Dichloroethene	< 0.37	ug/l	0.37	1.2	1	8260B	9/29/2020	9/29/2020	MJR	1
Tetrachloroethene	2.66	ug/l	0.33	1	1	8260B	9/29/2020	9/29/2020	MJR	1
Trichloroethene (TCE)	< 0.47	ug/l	0.47	1.5	1	8260B	9/29/2020	9/29/2020	MJR	1
Vinyl Chloride	< 0.2	ug/l	0.2	0.65	1	8260B	9/29/2020	9/29/2020	MJR	1
SUR - 1,2-Dichloroethane-d4	107	REC %			1	8260B	9/29/2020	9/29/2020	MJR	1
SUR - 4-Bromofluorobenzene	106	REC %			1	8260B	9/29/2020	9/29/2020	MJR	1
SUR - Dibromofluoromethane	114	REC %			1	8260B	9/29/2020	9/29/2020	MJR	1
SUR - Toluene-d8	97	REC %			1	8260B	9/29/2020	9/29/2020	MJR	1

Lab Code 5038538I
Sample ID 6143-MW-11
Sample Matrix Water
Sample Date 9/22/2020

	Result	Unit	LOD	LOQ	Dil	Method	Ext Date	Run Date	Analyst	Code
Organic										
VOC's										
cis-1,2-Dichloroethene	< 0.39	ug/l	0.39	1.2	1	8260B	9/29/2020	9/29/2020	MJR	1
trans-1,2-Dichloroethene	< 0.37	ug/l	0.37	1.2	1	8260B	9/29/2020	9/29/2020	MJR	1
Tetrachloroethene	22.3	ug/l	0.33	1	1	8260B	9/29/2020	9/29/2020	MJR	1
Trichloroethene (TCE)	< 0.47	ug/l	0.47	1.5	1	8260B	9/29/2020	9/29/2020	MJR	1
Vinyl Chloride	< 0.2	ug/l	0.2	0.65	1	8260B	9/29/2020	9/29/2020	MJR	1
SUR - 1,2-Dichloroethane-d4	105	REC %			1	8260B	9/29/2020	9/29/2020	MJR	1
SUR - 4-Bromofluorobenzene	100	REC %			1	8260B	9/29/2020	9/29/2020	MJR	1
SUR - Dibromofluoromethane	112	REC %			1	8260B	9/29/2020	9/29/2020	MJR	1
SUR - Toluene-d8	98	REC %			1	8260B	9/29/2020	9/29/2020	MJR	1

Project Name OHM-OCONOMOWOC
Project # 6143

Invoice # E38538

Lab Code 5038538P
Sample ID 6143-MW-19
Sample Matrix Water
Sample Date 9/24/2020

	Result	Unit	LOD	LOQ	Dil	Method	Ext Date	Run Date	Analyst	Code
Organic										
VOC's										
cis-1,2-Dichloroethene	< 0.39	ug/l	0.39	1.2	1	8260B	9/29/2020	9/29/2020	MJR	1
trans-1,2-Dichloroethene	< 0.37	ug/l	0.37	1.2	1	8260B	9/29/2020	9/29/2020	MJR	1
Tetrachloroethene	3.2	ug/l	0.33	1	1	8260B	9/29/2020	9/29/2020	MJR	1
Trichloroethene (TCE)	< 0.47	ug/l	0.47	1.5	1	8260B	9/29/2020	9/29/2020	MJR	1
Vinyl Chloride	< 0.2	ug/l	0.2	0.65	1	8260B	9/29/2020	9/29/2020	MJR	1
SUR - 4-Bromofluorobenzene	99	REC %			1	8260B	9/29/2020	9/29/2020	MJR	1
SUR - Dibromofluoromethane	107	REC %			1	8260B	9/29/2020	9/29/2020	MJR	1
SUR - Toluene-d8	96	REC %			1	8260B	9/29/2020	9/29/2020	MJR	1
SUR - 1,2-Dichloroethane-d4	102	REC %			1	8260B	9/29/2020	9/29/2020	MJR	1

Lab Code 5038538Q
Sample ID 6143-MW-20
Sample Matrix Water
Sample Date 9/24/2020

	Result	Unit	LOD	LOQ	Dil	Method	Ext Date	Run Date	Analyst	Code
Organic										
VOC's										
cis-1,2-Dichloroethene	< 0.39	ug/l	0.39	1.2	1	8260B	9/29/2020	9/29/2020	MJR	1
trans-1,2-Dichloroethene	< 0.37	ug/l	0.37	1.2	1	8260B	9/29/2020	9/29/2020	MJR	1
Tetrachloroethene	1.86	ug/l	0.33	1	1	8260B	9/29/2020	9/29/2020	MJR	1
Trichloroethene (TCE)	< 0.47	ug/l	0.47	1.5	1	8260B	9/29/2020	9/29/2020	MJR	1
Vinyl Chloride	< 0.2	ug/l	0.2	0.65	1	8260B	9/29/2020	9/29/2020	MJR	1
SUR - Toluene-d8	96	REC %			1	8260B	9/29/2020	9/29/2020	MJR	1
SUR - 1,2-Dichloroethane-d4	103	REC %			1	8260B	9/29/2020	9/29/2020	MJR	1
SUR - 4-Bromofluorobenzene	100	REC %			1	8260B	9/29/2020	9/29/2020	MJR	1
SUR - Dibromofluoromethane	110	REC %			1	8260B	9/29/2020	9/29/2020	MJR	1

Lab Code 5038538R
Sample ID 6143-PZ-1
Sample Matrix Water
Sample Date 9/22/2020

	Result	Unit	LOD	LOQ	Dil	Method	Ext Date	Run Date	Analyst	Code
Organic										
VOC's										
cis-1,2-Dichloroethene	< 0.39	ug/l	0.39	1.2	1	8260B	9/29/2020	9/30/2020	MJR	1
trans-1,2-Dichloroethene	< 0.37	ug/l	0.37	1.2	1	8260B	9/29/2020	9/30/2020	MJR	1
Tetrachloroethene	9.1	ug/l	0.33	1	1	8260B	9/29/2020	9/30/2020	MJR	1
Trichloroethene (TCE)	< 0.47	ug/l	0.47	1.5	1	8260B	9/29/2020	9/30/2020	MJR	1
Vinyl Chloride	< 0.2	ug/l	0.2	0.65	1	8260B	9/29/2020	9/30/2020	MJR	1
SUR - 1,2-Dichloroethane-d4	111	REC %			1	8260B	9/29/2020	9/30/2020	MJR	1
SUR - 4-Bromofluorobenzene	102	REC %			1	8260B	9/29/2020	9/30/2020	MJR	1
SUR - Dibromofluoromethane	113	REC %			1	8260B	9/29/2020	9/30/2020	MJR	1
SUR - Toluene-d8	95	REC %			1	8260B	9/29/2020	9/30/2020	MJR	1



EnvisionAir
1441 Sadler Circle West Drive
Indianapolis, IN 46239
Ph: 317-351-0885
Fax: 317-351-0882
www.envision-air.com

Mr. Brian Kappen
Enviroforensics
N16 W. 23390 Stone Ridge Dr
Suite G
Waukesha, WI 53188

October 2, 2020

EnvisionAir Project Number: 2020-552
Client Project Name: OHM - Oconomocow

Dear Mr. Kappen,

Please find the attached analytical report for the samples received August 28, 2020. All test methods performed were fully compliant with local, state, and federal EPA methods unless otherwise noted. The project was analyzed as requested on the enclosed chain of custody record. Please review the comments section for additional information about your results or Quality Control data.

Feel free to contact me if you have any questions or comments regarding your analytical report or service.

Thank you for your business. EnvisionAir looks forward to working with you on your next project.

Yours Sincerely,

A handwritten signature in black ink that reads "Stanley A. Hunnicutt".

Stanley A Hunnicutt

Project Manager
EnvisionAir, LLC



EnvisionAir
 1441 Sadler Circle West Drive
 Indianapolis, IN 46239
 Ph: 317-351-0885
 Fax: 317-351-0882
 www.envision-air.com

Client Name: ENVIROFORENSICS
Project ID: OHM - OCONOMOCOW
Client Project Manager: BRIAN KAPPEN
EnvisionAir Project Number: 2020-552

Sample Summary

Canister Pressure / Vacuum

<u>Laboratory Sample Number:</u>	<u>Sample Description:</u>	<u>Matrix:</u>	<u>START</u>	<u>START</u>	<u>End Date</u>	<u>End Time</u>	<u>Date</u>	<u>Time</u>	<u>Initial Field</u>	<u>Final Field</u>	<u>Lab</u>
			<u>Collected:</u>	<u>Collected:</u>							<u>Collected:</u>
20-2574	6143-MW-1	A	9/23/20	9:37	9/23/20	9:41	9/28/20	16:30	-30	-4	-4
20-2575	6143-SG-1S	A	9/23/20	8:46	9/23/20	8:51	9/28/20	16:30	-29	-4	-4
20-2576	6143-SG-1D	A	9/23/20	9:03	9/23/20	9:15	9/28/20	16:30	-30	-4	-4
20-2577	6143-SG-2S	A	9/23/20	12:35	9/23/20	12:40	9/28/20	16:30	-30	-4	-4
20-2578	6143-SG-2D	A	9/23/20	12:46	9/23/20	12:51	9/28/20	16:30	-30	-4	-4
20-2579	6143-SG-3S	A	9/23/20	14:08	9/23/20	14:18	9/28/20	16:30	-28	-3.5	-3.5
20-2580	6143-SG-3D	A	9/23/20	13:39	9/23/20	13:57	9/28/20	16:30	-30	-5	-5
20-2581	6143-VP-1S	A	9/23/20	10:11	9/23/20	10:14	9/28/20	16:30	-26	-3.5	-3.5
20-2582	6143-VP-1D	A	9/23/20	10:40	9/23/20	10:45	9/28/20	16:30	-30	-4	-4
20-2583	6143-VP-3S	A	9/23/20	11:25	9/23/20	11:30	9/28/20	16:30	-27	-3.5	-3.5



EnvisionAir
 1441 Sadler Circle West Drive
 Indianapolis, IN 46239
 Ph: 317-351-0885
 Fax: 317-351-0882
 www.envision-air.com

Client Name: ENVIROFORENSICS
Project ID: OHM - OCONOMOWOC
Client Project Manager: BRIAN KAPPEN
EnvisionAir Project Number: 2020-552

Analytical Method: TO-15
Analytical Batch: 093020AIR

Client Sample ID: 6143-MW-1
EnvisionAir Sample Number: 20-2574
Sample Matrix: AIR

Sample Collection START Date/Time: 9/23/20 9:37
Sample Collection END Date/Time: 9/23/20 9:41
Sample Received Date/Time: 9/28/20 16:30

<u>Compounds</u>	<u>Sample Results ug/m³</u>	<u>Reporting Limit ug/m³</u>	<u>Flag</u>
cis-1,2-Dichloroethene	< 198	198	
Tetrachloroethene	404	31.9	
trans-1,2-Dichloroethene	< 396	396	
Trichloroethene	23.1	10.7	
Vinyl Chloride	343	12.8	
4-bromofluorobenzene (surrogate)	98%		
Analysis Date/Time:	9-30-20/13:34		
Analyst Initials	tjg		



EnvisionAir
 1441 Sadler Circle West Drive
 Indianapolis, IN 46239
 Ph: 317-351-0885
 Fax: 317-351-0882
 www.envision-air.com

Client Name: ENVIROFORENSICS
Project ID: OHM - OCONOMOWOC
Client Project Manager: BRIAN KAPPEN
EnvisionAir Project Number: 2020-552

Analytical Method: TO-15
Analytical Batch: 093020AIR

Client Sample ID: 6143-SG-1S
EnvisionAir Sample Number: 20-2575
Sample Matrix: AIR

Sample Collection START Date/Time: 9/23/20 8:46
Sample Collection END Date/Time: 9/23/20 8:51
Sample Received Date/Time: 9/28/20 16:30

<u>Compounds</u>	<u>Sample Results ug/m³</u>	<u>Reporting Limit ug/m³</u>	<u>Flag</u>
cis-1,2-Dichloroethene	< 198	198	
Tetrachloroethene	276	31.9	
trans-1,2-Dichloroethene	< 396	396	
Trichloroethene	< 10.7	10.7	
Vinyl Chloride	< 12.8	12.8	
4-bromofluorobenzene (surrogate)	90%		
Analysis Date/Time:	9-30-20/14:13		
Analyst Initials	tjg		



EnvisionAir
 1441 Sadler Circle West Drive
 Indianapolis, IN 46239
 Ph: 317-351-0885
 Fax: 317-351-0882
 www.envision-air.com

Client Name: ENVIROFORENSICS
Project ID: OHM - OCONOMOWOC
Client Project Manager: BRIAN KAPPEN
EnvisionAir Project Number: 2020-552

Analytical Method: TO-15
Analytical Batch: 093020AIR

Client Sample ID: 6143-SG-1D
EnvisionAir Sample Number: 20-2576
Sample Matrix: AIR

Sample Collection START Date/Time: 9/23/20 9:03
Sample Collection END Date/Time: 9/23/20 9:15
Sample Received Date/Time: 9/28/20 16:30

<u>Compounds</u>	<u>Sample Results ug/m³</u>	<u>Reporting Limit ug/m³</u>	<u>Flag</u>
cis-1,2-Dichloroethene	< 198	198	
Tetrachloroethene	489	31.9	
trans-1,2-Dichloroethene	< 396	396	
Trichloroethene	< 10.7	10.7	
Vinyl Chloride	< 12.8	12.8	
4-bromofluorobenzene (surrogate)	91%		
Analysis Date/Time:	9-30-20/14:48		
Analyst Initials	tjg		



EnvisionAir
 1441 Sadler Circle West Drive
 Indianapolis, IN 46239
 Ph: 317-351-0885
 Fax: 317-351-0882
 www.envision-air.com

Client Name: ENVIROFORENSICS
Project ID: OHM - OCONOMOWOC
Client Project Manager: BRIAN KAPPEN
EnvisionAir Project Number: 2020-552

Analytical Method: TO-15
Analytical Batch: 093020AIR

Client Sample ID: 6143-SG-2S
EnvisionAir Sample Number: 20-2577
Sample Matrix: AIR

Sample Collection START Date/Time: 9/23/20 12:35
Sample Collection END Date/Time: 9/23/20 12:40
Sample Received Date/Time: 9/28/20 16:30

<u>Compounds</u>	<u>Sample Results ug/m³</u>	<u>Reporting Limit ug/m³</u>	<u>Flag</u>
cis-1,2-Dichloroethene	< 198	198	
Tetrachloroethene	1,320	31.9	
trans-1,2-Dichloroethene	< 396	396	
Trichloroethene	< 10.7	10.7	
Vinyl Chloride	< 12.8	12.8	
4-bromofluorobenzene (surrogate)	89%		
Analysis Date/Time:	9-30-20/15:56		
Analyst Initials	tjg		



EnvisionAir
 1441 Sadlier Circle West Drive
 Indianapolis, IN 46239
 Ph: 317-351-0885
 Fax: 317-351-0882
 www.envision-air.com

Client Name: ENVIROFORENSICS
Project ID: OHM - OCONOMOWOC
Client Project Manager: BRIAN KAPPEN
EnvisionAir Project Number: 2020-552

Analytical Method: TO-15
Analytical Batch: 093020AIR

Client Sample ID: 6143-SG-2D
EnvisionAir Sample Number: 20-2578
Sample Matrix: AIR

Sample Collection START Date/Time: 9/23/20 12:46
Sample Collection END Date/Time: 9/23/20 12:51
Sample Received Date/Time: 9/28/20 16:30

<u>Compounds</u>	<u>Sample Results ug/m³</u>	<u>Reporting Limit ug/m³</u>	<u>Flag</u>
cis-1,2-Dichloroethene	< 198	198	
Tetrachloroethene	2,360	128	1
trans-1,2-Dichloroethene	< 396	396	
Trichloroethene	103	10.7	
Vinyl Chloride	< 12.8	12.8	
4-bromofluorobenzene (surrogate)	98%		
Analysis Date/Time:	9-30-20/16:29		
Analyst Initials	tjg		



EnvisionAir
 1441 Sadler Circle West Drive
 Indianapolis, IN 46239
 Ph: 317-351-0885
 Fax: 317-351-0882
 www.envision-air.com

Client Name: ENVIROFORENSICS
Project ID: OHM - OCONOMOWOC
Client Project Manager: BRIAN KAPPEN
EnvisionAir Project Number: 2020-552

Analytical Method: TO-15
Analytical Batch: 093020AIR

Client Sample ID: 6143-SG-3S
EnvisionAir Sample Number: 20-2579
Sample Matrix: AIR

Sample Collection START Date/Time: 9/23/20 14:08
Sample Collection END Date/Time: 9/23/20 14:18
Sample Received Date/Time: 9/28/20 16:30

<u>Compounds</u>	<u>Sample Results ug/m³</u>	<u>Reporting Limit ug/m³</u>	<u>Flag</u>
cis-1,2-Dichloroethene	< 198	198	
Tetrachloroethene	1,510	128	1
trans-1,2-Dichloroethene	< 396	396	
Trichloroethene	< 10.7	10.7	
Vinyl Chloride	< 12.8	12.8	
4-bromofluorobenzene (surrogate)	100%		
Analysis Date/Time:	9-30-20/17:03		
Analyst Initials	tjg		



EnvisionAir
 1441 Sadler Circle West Drive
 Indianapolis, IN 46239
 Ph: 317-351-0885
 Fax: 317-351-0882
 www.envision-air.com

Client Name: ENVIROFORENSICS
Project ID: OHM - OCONOMOWOC
Client Project Manager: BRIAN KAPPEN
EnvisionAir Project Number: 2020-552

Analytical Method: TO-15
Analytical Batch: 093020AIR

Client Sample ID: 6143-SG-3D
EnvisionAir Sample Number: 20-2580
Sample Matrix: AIR

Sample Collection START Date/Time: 9/23/20 13:39
Sample Collection END Date/Time: 9/23/20 13:57
Sample Received Date/Time: 9/28/20 16:30

<u>Compounds</u>	<u>Sample Results ug/m³</u>	<u>Reporting Limit ug/m³</u>	<u>Flag</u>
cis-1,2-Dichloroethene	< 198	198	
Tetrachloroethene	2,330	128	1
trans-1,2-Dichloroethene	< 396	396	
Trichloroethene	29.6	10.7	
Vinyl Chloride	< 12.8	12.8	
4-bromofluorobenzene (surrogate)	99%		
Analysis Date/Time:	9-30-20/17:36		
Analyst Initials	tjg		



EnvisionAir
 1441 Sadlier Circle West Drive
 Indianapolis, IN 46239
 Ph: 317-351-0885
 Fax: 317-351-0882
 www.envision-air.com

Client Name: ENVIROFORENSICS
Project ID: OHM - OCONOMOWOC
Client Project Manager: BRIAN KAPPEN
EnvisionAir Project Number: 2020-552

Analytical Method: TO-15
Analytical Batch: 093020AIR

Client Sample ID: 6143-VP-1S
EnvisionAir Sample Number: 20-2581
Sample Matrix: AIR

Sample Collection START Date/Time: 9/23/20 10:11
Sample Collection END Date/Time: 9/23/20 10:14
Sample Received Date/Time: 9/28/20 16:30

<u>Compounds</u>	<u>Sample Results ug/m³</u>	<u>Reporting Limit ug/m³</u>	<u>Flag</u>
cis-1,2-Dichloroethene	< 198	198	
Tetrachloroethene	1,000	31.9	
trans-1,2-Dichloroethene	< 396	396	
Trichloroethene	< 10.7	10.7	
Vinyl Chloride	< 12.8	12.8	
4-bromofluorobenzene (surrogate)	99%		
Analysis Date/Time:	9-30-20/18:09		
Analyst Initials	tjg		



EnvisionAir
 1441 Sadler Circle West Drive
 Indianapolis, IN 46239
 Ph: 317-351-0885
 Fax: 317-351-0882
 www.envision-air.com

Client Name: ENVIROFORENSICS
Project ID: OHM - OCONOMOWOC
Client Project Manager: BRIAN KAPPEN
EnvisionAir Project Number: 2020-552

Analytical Method: TO-15
Analytical Batch: 093020AIR

Client Sample ID: 6143-VP-1D
EnvisionAir Sample Number: 20-2582
Sample Matrix: AIR

Sample Collection START Date/Time: 9/23/20 10:40
Sample Collection END Date/Time: 9/23/20 10:45
Sample Received Date/Time: 9/28/20 16:30

<u>Compounds</u>	<u>Sample Results ug/m³</u>	<u>Reporting Limit ug/m³</u>	<u>Flag</u>
cis-1,2-Dichloroethene	< 198	198	
Tetrachloroethene	3,130	638	2
trans-1,2-Dichloroethene	< 396	396	
Trichloroethene	23.1	10.7	
Vinyl Chloride	< 12.8	12.8	
4-bromofluorobenzene (surrogate)	103%		
Analysis Date/Time:	9-30-20/18:51		
Analyst Initials	tjg		



EnvisionAir
 1441 Sadlier Circle West Drive
 Indianapolis, IN 46239
 Ph: 317-351-0885
 Fax: 317-351-0882
 www.envision-air.com

Client Name: ENVIROFORENSICS
Project ID: OHM - OCONOMOWOC
Client Project Manager: BRIAN KAPPEN
EnvisionAir Project Number: 2020-552

Analytical Method: TO-15
Analytical Batch: 093020AIR

Client Sample ID: 6143-VP-3S
EnvisionAir Sample Number: 20-2583
Sample Matrix: AIR

Sample Collection START Date/Time: 9/23/20 11:25
Sample Collection END Date/Time: 9/23/20 11:30
Sample Received Date/Time: 9/28/20 16:30

<u>Compounds</u>	<u>Sample Results ug/m³</u>	<u>Reporting Limit ug/m³</u>	<u>Flag</u>
cis-1,2-Dichloroethene	< 198	198	
Tetrachloroethene	8,220	1280	3
trans-1,2-Dichloroethene	< 396	396	
Trichloroethene	< 10.7	10.7	
Vinyl Chloride	< 12.8	12.8	
4-bromofluorobenzene (surrogate)	99%		
Analysis Date/Time:	9-30-20/19:32		
Analyst Initials	tjg		

TO-15 Quality Control Data

EnvisionAir Batch Number: 093020AIR

<u>Method Blank (MB):</u>	<u>MB Results (ppbv)</u>	<u>Reporting Limit (ppbv)</u>	<u>Flags</u>
cis-1,2-Dichloroethene	< 5	5	
Tetrachloroethene	< 0.47	0.47	
trans-1,2-Dichloroethene	< 10	10	
Trichloroethene	< 0.2	0.2	
Vinyl Chloride	< 0.5	0.5	
4-bromofluorobenzene (surrogate)	105%		
Analysis Date/Time:	9-30-20/12:11		
Analyst Initials	tjg		

<u>LCS/LCSD</u>	<u>LCS Results (ppbv)</u>	<u>LCSD Results (ppbv)</u>	<u>LCS/D Conc(ppbv)</u>	<u>LCS Rec.</u>	<u>LCSD Rec.</u>	<u>RPD</u>	<u>Flag</u>
Vinyl Chloride	10.7	11.6	10	107%	116%	8.1%	
trans-1,2-Dichloroethene	9.21	10.1	10	92%	101%	9.2%	
cis-1,2-Dichloroethene	10.4	10.4	10	104%	104%	0.0%	
Trichloroethene	11.1	10.6	10	111%	106%	4.6%	
Tetrachloroethene	8.24	8.47	10	82%	85%	2.8%	
4-bromofluorobenzene (surrogate)	91%	92%					
Analysis Date/Time:	9-30-20/10:20	9-30-20/10:58					
Analyst Initials	tjg	tjg					



EnvisionAir
1441 Sadlier Circle West Drive
Indianapolis, IN 46239
Ph: 317-351-0885
Fax: 317-351-0882
www.envision-air.com

<u>Flag Number</u>	<u>Comments</u>
1	Reported value is from a 40x dilution. TJG 10/1/20
2	Reported value is from a 200x dilution. TJG 10/1/20
3	Reported value is from a 400x dilution. TJG 10/1/20

CHAIN OF CUSTODY RECORD

EnvisionAir | 1441 Sadlier Circle West Drive | Indianapolis, IN 46239 | Phone: (317) 351-0885 | Fax: (317) 351-0882

Client: NFO	P.O. Number: 2020-1942
Report Address: 625 N. Cal State Ridge Dr, Waukesha WI	Project Name or Number: OHM - Oconomowoc
Report To: B Kappen	Sampled by: M-che
Phone:	QA/QC Required: (circle if applicable) Level III Level IV
Invoice Address: Same	Reporting Units needed: (circle) ug/m³ mg/m ³ PPBV PPMV
Desired TAT: (Please Circle One) 1 day 2 days 3 days Std (5 bus. days)	Media type: 1LC = 1 Liter Canister 6LC = 6 Liter Canister TB = Tedlar Bag TD = Thermal Desorption Tube

REQUESTED PARAMETERS

TO-15 Full List

TO-15 Short List (Specify in notes)



Sampling Type:
 Soil-Gas:
 Sub-Slab:
 Indoor-Air:

www.envision-air.com

Canister Pressure / Vacuum

Air Sample ID	Media Type (see code above)	Coll. Date (Grab/Comp Start)	Coll. Time (Grab/Comp Start)	Coll. Date (Comp. End)	Coll. Time (Comp. End)					Canister Serial #	Flow Controller Serial #	Initial Field (in. Hg)	Final Field (in. Hg)	Lab Received (in. Hg)	EnvisionAir Sample Number
6143-MW-1	1LC	9/23/20	0937	9/23/20	0941	✓				84136	0108	-30	-4	-4	20-2574
6143-SG-1S	1LC	9/23/20	0846	9/23/20	0851	✓				2097	0125	-29	-4	-4	20-2575
6143-SG-1D	1LC	9/23/20	0903	9/23/20	0915	✓				84050	0133	-30	-4	-4	20-2576
6143-SG-2S	1LC	9/23/20	1235	9/23/20	1240	✓				83978	0063	-30	-4	-4	20-2577
6143-SG-2D	1LC	9/23/20	1246	9/23/20	1251	✓				2100	0058	-30	-4	-4	20-2578
6143-SG-3S	1LC	9/23/20	1408	9/23/20	1418	✓				83925	0052	-28	-3.5	-3.5	20-2579
6143-SG-3D	1LC	9/23/20	1339	9/23/20	1357	✓				83679	0099	-30	-5	-5	20-2580
6143-VP-1S	1LC	9/23/20	1011	9/23/20	1014	✓				2090	0132	-26	-3.5	-3.5	20-2581
6143-VP-1D	1LC	9/23/20	1040	9/23/20	1045	✓				83813	0072	-30	-4	-4	20-2582
6143-VP-3S	1LC	9/23/20	1125	9/23/20	1130	✓				83721	0166	-27	-3.5	-3.5	20-2583

Comments:

Relinquished by:	Date	Time	Received by:	Date	Time
<i>Melody Che</i>	9/25/20	1100	<i>FedEx</i>	9/25/20	1100
			<i>Adam Munnich</i>	9/28/20	1630



November 5, 2020

Mr. Patrick McAdams
McAdams Realty Oconomowoc, LLP
110 South Regency Circle
Oconomowoc, WI 53066

Subject: Environmental sampling results
BRTTS #: 02-68-551911

Dear Mr. McAdams:

In accordance with the executed Agreement to Provide Access for Sampling Activities, and in accordance with Wisconsin Department of Natural Resources (WDNR) regulation NR 716.14, EnviroForensics, LLC (EnviroForensics) is providing the results of soil vapor samples collected from your property located at 36929 Plank Road in Oconomowoc, Wisconsin.

The soil vapor samples were collected on October 14, 2020 at the locations labeled SG-6, SG-7, and SG-8 on attached **Figure 1**. The purpose for collecting the soil vapor samples was to determine if there is a vapor risk concern associated with the plume of contaminated groundwater that is present along the northeast portion of your property. The chemicals of concern are the dry cleaning solvent tetrachloroethene (PCE) and its associated breakdown products.

Samples of soil vapor were collected using the post-run tubing (PRT) method of sample collection. Simply put, a geoprobe™ was used to advance sampling rod to a depth of 11 feet. Plastic tubing is set inside the sampling rod to isolate a one-foot section of subsurface soil from the overall soil column, and a vapor sample is collected from this soil section through the plastic tubing. The depth interval for the vapor sample was selected to be indicative of the depth of a building with a 9-foot deep basement.

The Responsible Party is:

Mr. Brian Cass
OHM Holdings, Inc.
W229 N2494 Hwy F
Waukesha, WI 53186
Telephone: 262-521-9710

Sampling Results

The soil vapor results are summarized and compared to vapor risk screening levels (VRSLs) in attached **Table 1**. The laboratory analytical report is also attached. As can be seen in these results documents, PCE was detected in the vapor samples from SG-6 and SG-7 at

Document: 6143-1603

concentrations above the residential VRSL, indicating a potential vapor intrusion risk to residential structures in this area. The PCE concentrations were below the VRSL that applies to commercial structures. These sample locations coincide with the approximate location of the groundwater plume shown on **Figure 1**.

It is not conclusive that there would be a vapor intrusion risk to future buildings constructed on your property, however, the concentrations detected demonstrate the potential for this risk. As such, the WDNR will likely require that future buildings proposed for construction in the northeastern part of your property be evaluated for the risk of vapor intrusion, or have engineered methods for the mitigation of vapor intrusion incorporated into the building design. These design elements can include, but are not limited to, designed below slab vapor barriers, and passive or active sub-slab depressurization systems similar to those utilized to mitigate radon gas.

If you have any questions or concerns, please contact me at 414-982-3988 or by email at wfassbender@enviroforensics.com. The WDNR project manager, Greg Michael, can be reached at 262-574-2176. We greatly appreciate your help and patience with this matter.

Sincerely,
EnviroForensics, LLC

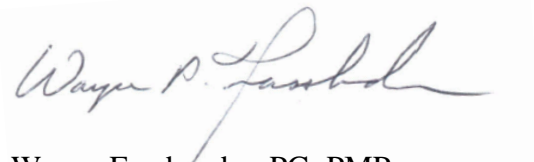
A handwritten signature in black ink that reads "Wayne P. Fassbender".

Wayne Fassbender, PG, PMP
Senior Project Manager

Attachments: Figure 1: Soil Gas Analytical Results in Relation to the Groundwater Plume, October, 2020
Table 1: Soil Gas Analytical Results Summary
Analytical Report for the Soil Vapor Samples

Copy: Greg Michael, Wisconsin Department of Natural Resources

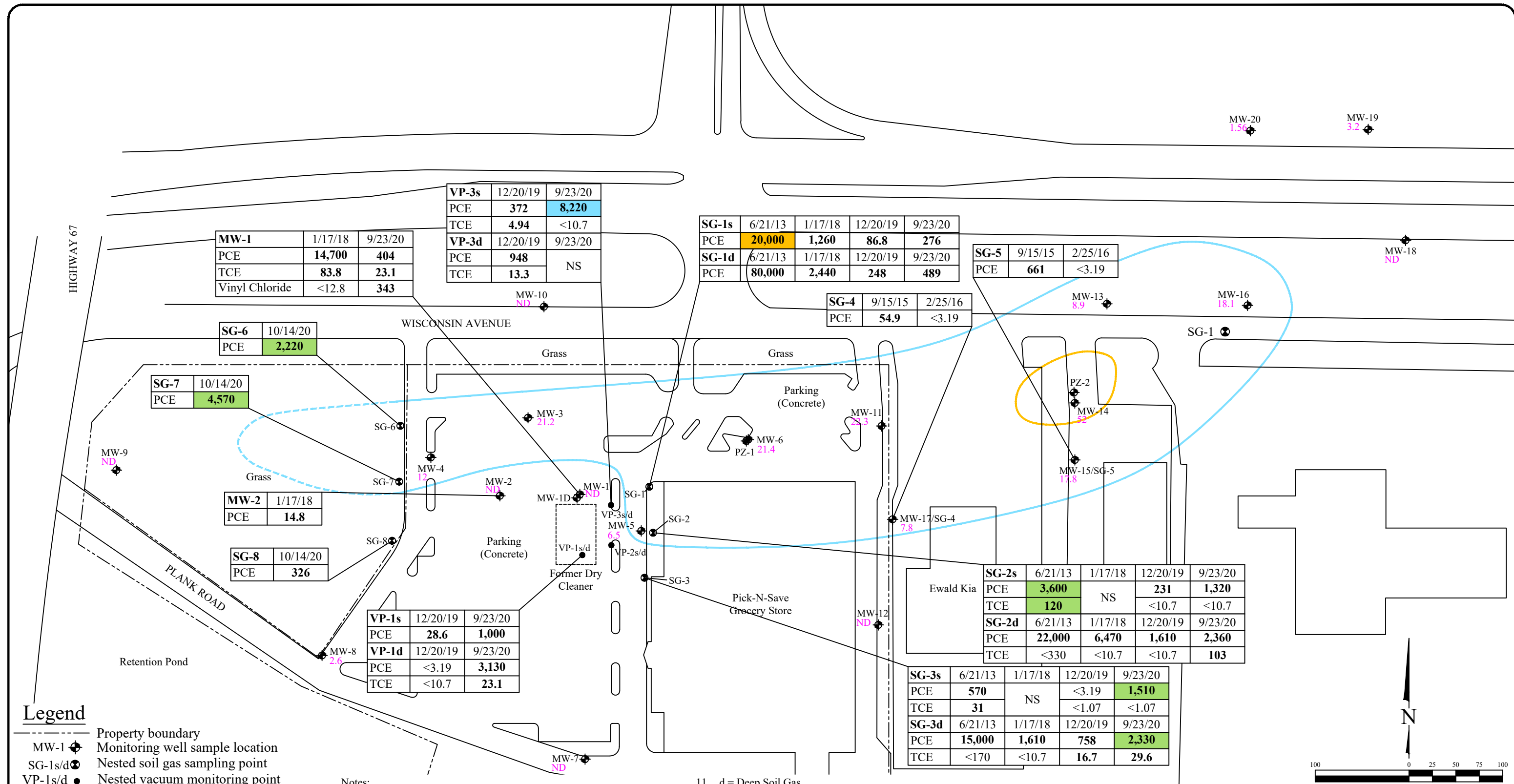

MW-1	1/17/18	9/23/20
PCE	14,700	404
TCE	83.8	23.1
Vinyl Chloride	<12.8	343

VP-3s	12/20/19	9/23/20
PCE	372	8,220
TCE	4.94	<10.7
VP-3d	12/20/19	9/23/20
PCE	948	NS
TCE	13.3	NS

SG-1s	6/21/13	1/17/18	12/20/19	9/23/20
PCE	20,000	1,260	86.8	276
SG-1d	6/21/13	1/17/18	12/20/19	9/23/20
PCE	80,000	2,440	248	489

SG-5	9/15/15	2/25/16
PCE	661	<3.19

SG-4	9/15/15	2/25/16
PCE	54.9	<3.19

SG-6	10/14/20
PCE	2,220

SG-7	10/14/20
PCE	4,570

MW-2	1/17/18
PCE	14.8

SG-8	10/14/20
PCE	326

VP-1s	12/20/19	9/23/20
PCE	28.6	1,000
VP-1d	12/20/19	9/23/20
PCE	<3.19	3,130
TCE	<10.7	23.1

SG-2s	6/21/13	1/17/18	12/20/19	9/23/20
PCE	3,600	NS	231	1,320
TCE	120	NS	<10.7	<10.7
SG-2d	6/21/13	1/17/18	12/20/19	9/23/20
PCE	22,000	6,470	1,610	2,360
TCE	<330	<10.7	<10.7	103

SG-3s	6/21/13	1/17/18	12/20/19	9/23/20
PCE	570	NS	<3.19	1,510
TCE	31	NS	<1.07	<1.07
SG-3d	6/21/13	1/17/18	12/20/19	9/23/20
PCE	15,000	1,610	758	2,330
TCE	<170	<10.7	16.7	29.6

Legend

- MW-1 Property boundary
- SG-1s/d Monitoring well sample location
- VP-1s/d Nested soil gas sampling point
- 5.0** PCE concentration in groundwater (ug/L)
- >5 ug/L PCE concentration in groundwater
- >50 ug/L PCE concentration in groundwater
- Dashed where inferred

Soil Vapor Risk Screening Level			
Analyte	Large Commercial/Industrial ¹	Small Commercial ²	Residential ³
PCE	18,000	6,000	1,400
TCE	880	290	70

Notes:

1. Bolded and orange shaded values exceed the Large Commercial/Industrial Vapor Risk Screening Level
2. Bolded and blue shaded values exceed the Small Commercial Vapor Risk Screening Level
3. Bolded and green shaded values exceed the Residential Vapor Risk Screening Level
4. Bolded values exceed laboratory reporting limits
5. Soil Gas concentrations reported in reported in micrograms per cubic meter (ug/m³)
6. Groundwater units in micrograms per liter (ug/L)
7. Groundwater samples analyzed for VOCs using US EPA SW-846 Method 8260
8. PCE = Tetrachloroethene
9. TCE = Trichloroethene
10. s = Shallow Soil Gas

11. d = Deep Soil Gas
12. NS = Not sampled
13. ¹ = The Vapor Risk Screening Levels (VRSL's) are based on US EPA's Regional Screening Levels (RSL's) for Large Commercial indoor air with an attenuation factor of 0.01 for soil gas below large commercial/industrial
14. ² = The Vapor Risk Screening Levels (VRSL's) are based on US EPA's Regional Screening Levels (RSL's) for Small Commercial indoor air with an attenuation factor of 0.03 for soil gas below small commercial
15. ³ = The Vapor Risk Screening Levels (VRSL's) are based on US EPA's Regional Screening Levels (RSL's) for Residential indoor air with an attenuation factor of 0.03 for soil gas below residential

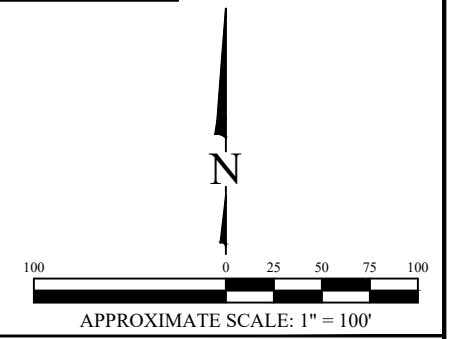

SOIL GAS ANALYTICAL RESULTS IN RELATION TO THE GROUNDWATER PLUME, OCTOBER 2020

Martinizing Dry Cleaning
36929 Plank Road
Oconomowoc, WI

Date:	11/3/20
Designed:	EB
Drawn:	EB
Checked:	WF
DWG file:	6143-1750



825 North Capitol Avenue • Indianapolis, IN 46204
EnviroForensics.com

Figure	1
Project	6143

TABLE 1
SOIL GAS ANALYTICAL RESULTS SUMMARY
Former One Hour Martinizing Cleaners
Oconomowoc, Wisconsin

Sample Identification	Sample Depth (feet)	Sample Date	Tetrachloroethene	Trichloroethene	cis-1,2-Dichloroethene	trans-1,2-Dichloroethene	Vinyl Chloride
Vapor Risk Screening Level Large Commercial/Industrial			18,000	880	NE	NE	2,800
Vapor Risk Screening Level Small Commercial			6,000	290	NE	NE	930
Vapor Risk Screening Level Residential			1,400	70	NE	NE	57
6143-SG-6	11	10/14/2020	2,220	<10.7	<198	<396	<12.8
6143-SG-7	11	10/14/2020	4,570	<10.7	<198	<396	<12.8
6143-SG-8	11	10/14/2020	326	<10.7	<198	<396	<12.8

Notes:

Vapor Risk Screening Levels are calculated in accordance with the procedures listed in WDNR Publication RR-800 and subsequent guidance

All concentrations reported in units of micrograms per cubic meter ($\mu\text{g}/\text{m}^3$)

Bolded values are above detection limits

Bolded and Orange Shaded values exceed the Large Commercial/Industrial Vapor Risk Screening Level

Bolded and Blue Shaded values exceed the Small Commercial Vapor Risk Screening Level

Bolded and Green Shaded values exceed the Residential Vapor Risk Screening Level

"s" designation is for shallow soil gas samples

"d" designation is for deep soil gas samples

NE = Not Established



EnvisionAir
1441 Sadler Circle West Drive
Indianapolis, IN 46239
Ph: 317-351-0885
Fax: 317-351-0882
www.envision-air.com

Mr. Brian Kappen
Enviroforensics
N16 W. 23390 Stone Ridge Dr
Suite G
Waukesha, WI 53188

October 21, 2020

EnvisionAir Project Number: 2020-581
Client Project Name: 6143

Dear Mr. Kappen,

Please find the attached analytical report for the samples received October 16, 2020. All test methods performed were fully compliant with local, state, and federal EPA methods unless otherwise noted. The project was analyzed as requested on the enclosed chain of custody record. Please review the comments section for additional information about your results or Quality Control data.

Feel free to contact me if you have any questions or comments regarding your analytical report or service.

Thank you for your business. EnvisionAir looks forward to working with you on your next project.

Yours Sincerely,

A handwritten signature in black ink that reads "Stanley A. Hunnicutt".

Stanley A Hunnicutt

Project Manager
EnvisionAir, LLC



EnvisionAir
 1441 Sadlier Circle West Drive
 Indianapolis, IN 46239
 Ph: 317-351-0885
 Fax: 317-351-0882
 www.envision-air.com

Client Name: ENVIROFORENSICS
Project ID: 6143
Client Project Manager: BRIAN KAPPEN
EnvisionAir Project Number: 2020-581

Sample Summary

Canister Pressure / Vacuum

<u>Laboratory Sample Number:</u>	<u>Sample Description:</u>	<u>Matrix:</u>	<u>START</u>	<u>START</u>	<u>End Date</u>	<u>End Time</u>	<u>Date</u>	<u>Time</u>	<u>Canister Pressure / Vacuum</u>		<u>Lab</u>
			<u>Date</u>	<u>Time</u>					<u>Initial Field</u>	<u>Final Field</u>	
			<u>Collected:</u>	<u>Collected:</u>	<u>Collected:</u>	<u>Collected:</u>	<u>Received:</u>	<u>Received:</u>	<u>(in. Hg)</u>	<u>(in. Hg)</u>	<u>(in. Hg)</u>
20-2707	6143-SG-6	A	10/14/20	11:19			10/16/20	9:50	-29	-3	-3
20-2708	6143-SG-7	A	10/14/20	11:58			10/16/20	9:50	-28	-3	-3
20-2709	6143-SG-8	A	10/14/20	12:43			10/16/20	9:50	-30	-3	-3



EnvisionAir
1441 Sadlier Circle West Drive
Indianapolis, IN 46239
Ph: 317-351-0885
Fax: 317-351-0882
www.envision-air.com

Client Name: ENVIROFORENSICS

Project ID: 6143

Client Project Manager: BRIAN KAPPEN

EnvisionAir Project Number: 2020-581

Analytical Method: TO-15
Analytical Batch: 101520CAIR

Client Sample ID: 6143-SG-6

Sample Collection START Date/Time: 10/14/20 11:19

Sample Collection END Date/Time:

EnvisionAir Sample Number: 20-2707

Sample Received Date/Time: 10/16/20 9:50

Sample Matrix: AIR

<u>Compounds</u>	<u>Sample Results ug/m³</u>	<u>Reporting Limit ug/m³</u>	<u>Flag</u>
cis-1,2-Dichloroethene	< 198	198	
Tetrachloroethene	2,220	638	1
trans-1,2-Dichloroethene	< 396	396	
Trichloroethene	< 10.7	10.7	
Vinyl Chloride	< 12.8	12.8	
4-bromofluorobenzene (surrogate)	98%		
Analysis Date/Time:	10-17-20/01:49		
Analyst Initials	tjg		



EnvisionAir
1441 Sadlier Circle West Drive
Indianapolis, IN 46239
Ph: 317-351-0885
Fax: 317-351-0882
www.envision-air.com

Client Name: ENVIROFORENSICS

Project ID: 6143

Client Project Manager: BRIAN KAPPEN

EnvisionAir Project Number: 2020-581

Analytical Method: TO-15
Analytical Batch: 101520CAIR

Client Sample ID: 6143-SG-7

Sample Collection START Date/Time: 10/14/20 11:58

Sample Collection END Date/Time:

EnvisionAir Sample Number: 20-2708

Sample Received Date/Time: 10/16/20 9:50

Sample Matrix: AIR

<u>Compounds</u>	<u>Sample Results ug/m³</u>	<u>Reporting Limit ug/m³</u>	<u>Flag</u>
cis-1,2-Dichloroethene	< 198	198	
Tetrachloroethene	4,570	638	1
trans-1,2-Dichloroethene	< 396	396	
Trichloroethene	< 10.7	10.7	
Vinyl Chloride	< 12.8	12.8	
4-bromofluorobenzene (surrogate)	87%		
Analysis Date/Time:	10-17-20/03:42		
Analyst Initials	tjg		



EnvisionAir
1441 Sadlier Circle West Drive
Indianapolis, IN 46239
Ph: 317-351-0885
Fax: 317-351-0882
www.envision-air.com

Client Name: ENVIROFORENSICS

Project ID: 6143

Client Project Manager: BRIAN KAPPEN

EnvisionAir Project Number: 2020-581

Analytical Method: TO-15
Analytical Batch: 101520CAIR

Client Sample ID: 6143-SG-8

Sample Collection START Date/Time: 10/14/20 12:43

Sample Collection END Date/Time:

EnvisionAir Sample Number: 20-2709

Sample Received Date/Time: 10/16/20 9:50

Sample Matrix: AIR

<u>Compounds</u>	<u>Sample Results ug/m³</u>	<u>Reporting Limit ug/m³</u>	<u>Flag</u>
cis-1,2-Dichloroethene	< 198	198	
Tetrachloroethene	326	31.9	
trans-1,2-Dichloroethene	< 396	396	
Trichloroethene	< 10.7	10.7	
Vinyl Chloride	< 12.8	12.8	
4-bromofluorobenzene (surrogate)	94%		
Analysis Date/Time:	10-17-20/05:06		
Analyst Initials	tjg		

TO-15 Quality Control Data

EnvisionAir Batch Number: 101520CAIR

<u>Method Blank (MB):</u>	<u>MB Results (ppbv)</u>	<u>Reporting Limit (ppbv)</u>	<u>Flags</u>
cis-1,2-Dichloroethene	< 5	5	
Tetrachloroethene	< 0.47	0.47	
trans-1,2-Dichloroethene	< 10	10	
Trichloroethene	< 0.2	0.2	
Vinyl Chloride	< 0.5	0.5	
4-bromofluorobenzene (surrogate)	98%		
Analysis Date/Time:	10-16-20/23:11		
Analyst Initials	tjg		

<u>LCS/LCSD</u>	<u>LCS Results (ppbv)</u>	<u>LCSD Results (ppbv)</u>	<u>LCS/D Conc(ppbv)</u>	<u>LCS Rec.</u>	<u>LCSD Rec.</u>	<u>RPD</u>	<u>Flag</u>
Vinyl Chloride	10.9	11.3	10	109%	113%	3.6%	
trans-1,2-Dichloroethene	8.79	9.71	10	88%	97%	9.9%	
cis-1,2-Dichloroethene	9.14	10.4	10	91%	104%	12.9%	
Trichloroethene	11.1	11.1	10	111%	111%	0.0%	
Tetrachloroethene	10.7	10.3	10	107%	103%	3.8%	
4-bromofluorobenzene (surrogate)	118%	116%					
Analysis Date/Time:	10-16-20/21:23	10-16-20/22:00					
Analyst Initials	tjg	tjg					



EnvisionAir
1441 Sadler Circle West Drive
Indianapolis, IN 46239
Ph: 317-351-0885
Fax: 317-351-0882
www.envision-air.com

Flag Number

1

Comments

Reported value is from a 200x dilution. TJG 10-21-20

CHAIN OF CUSTODY RECORD

EnvisionAir | 1441 Sadlier Circle West Drive | Indianapolis, IN 46239 | Phone: (317) 351-0885 | Fax: (317) 351-0882

Client: <u>EnviroForensics</u>	P.O. Number: <u>2020-1998</u>
Report Address: <u>bkappen@enviroforensics.com</u>	Project Name or Number: <u>6143</u>
Report To: <u>B. Kappen</u>	Sampled by: <u>B. Kappen</u>
Phone: <u>262-745-5054</u>	QA/QC Required: (circle if applicable) Level III Level IV
Invoice Address: <u>accounts payable @enviroforensics.com</u>	Reporting Units needed: (circle) <u>ug/m³</u> mg/m ³ PPBV PPMV
Desired TAT: (Please Circle One) 1 day 2 days 3 days <u>Std (5 bus. days)</u>	Media type: 1LC = 1 Liter Canister 6LC = 6 Liter Canister TB = Tedlar Bag TD = Thermal Desorption Tube

REQUESTED PARAMETERS

TO-15 Full List

TO-15 Short List (Specify in notes)



Sampling Type:
 Soil-Gas:
 Sub-Slab:
 Indoor-Air:

www.envision-air.com

Canister Pressure / Vacuum

Air Sample ID	Media Type <small>(see code above)</small>	Coll. Date <small>(Grab/Comp Start)</small>	Coll. Time <small>(Grab/Comp Start)</small>	Coll. Date <small>(Comp. End)</small>	Coll. Time <small>(Comp. End)</small>				Canister Serial #	Flow Controller Serial #	Initial Field (in. Hg)	Final Field (in. Hg)	Lab Received (in. Hg)	EnvisionAir Sample Number
6143-SG-6	1LC	10/14/20	1119						84051	0055	-29	-3	-3	20-2707
6143-SG-7	1LC	↓	1158						2231	0062	-28	-3	-3	20-2708
6143-SG-8	1LC	↓	1243						2230	0058	-30	-3	-3	20-2709

Comments: PCE, TCE, cis-1,2-DCE, trans-1,2-DCE, vinyl chloride

Relinquished by:	Date	Time	Received by:	Date	Time
<u>[Signature]</u>	<u>10/15/20</u>	<u>930</u>	<u>FedEx</u>	<u>10/15/20</u>	<u>930</u>
			<u>[Signature]</u>	<u>10/16/20</u>	<u>0950</u>