



January 15, 2020

Jeff Carr
Facilities Supervisor
Monona Grove School District
5301 Monona Drive
Monona, WI 53716-3126

**Subject: Environmental Sampling Results
BRRTS# 02-13-551928**

Dear Mr. Carr:

In accordance with the Access Agreement between the Monona Grove School District and Klinke Clothing Care, Corp. (Klinke) dated August 7, 2012 and related amendments, EnviroForensics LLC (EnviroForensics) is providing the attached sampling results associated with indoor air and sub-slab vapor samples collected from Monona Grove School District property located at 4400 Monona Drive, Monona, Wisconsin (the "Property"). The sampling activities were conducted at the direction of the Wisconsin Department of Natural Resources (WDNR) as part of an environmental investigation and remediation being performed for Klinke Cleaners located at 4518 Monona Drive Madison, Wisconsin. The WDNR has assigned the following identification number to the Klinke Cleaners site: BRRTS# 02-13-551928. The chemicals of concern for the investigation are the solvent tetrachloroethene (PCE) and its associated breakdown products.

The purpose of this sampling event was to continue monitoring sub-slab vapor conditions in the orchestra pit area of Monona Grove High School, which is the only area of the school with an ongoing vapor intrusion risk. The vapor mitigation sub-system 3 and 4 fans which mitigate that part of the school were shut down approximately three (3) week prior to sample collection as recommended in WDNR guidance.

Sampling Results

One (1) indoor air sample and one (1) sub-slab vapor sample were collected from the orchestra pit area on December 27, 2019. The approximate sample locations are shown on **Figure 1** (attached). The analytical results of the samples are summarized on **Tables 1 and 2**, and the laboratory report is also attached.

The chemicals of concern were not detected in the indoor air sample. In the sub-slab vapor sample, PCE was detected at a concentration well below the screening level established by WDNR. No other chemicals of concern were detected in sub-slab vapor.

We will work with the WDNR to determine what additional steps, if any, will be required to rule out vapor intrusion risk. In accordance with the Access Agreement, we will contact you prior to any subsequent work on the Property. If you have any questions or concerns, please contact me at 414-326-4412 or by email at bkappen@enviroforensics.com. The WDNR project manager, Mike Schmoller, can be reached at 608-275-3303. We greatly appreciate your assistance with this matter.

Sincerely,
EnviroForensics, LLC

A handwritten signature in blue ink, appearing to read "Brian Kappen".

Brian Kappen, PG
Project Manager

Copy: Steve Klinke, Klinke Cleaners
Mike Schmoller, Wisconsin Department of Natural Resources

Attachments:

- Figure 1 – Vapor Intrusion Sampling Locations
- Table 1 – Indoor Air Sample Analytical Results Summary
- Table 2 – Sub-Slab Vapor Sample Analytical Results Summary
- Laboratory Analytical Report

FIGURE 1

Monona Grove High School
Vapor Intrusion Sampling Locations

Legend

- Indoor Air Sample Location
- Sub-Slab Vapor Sample Location

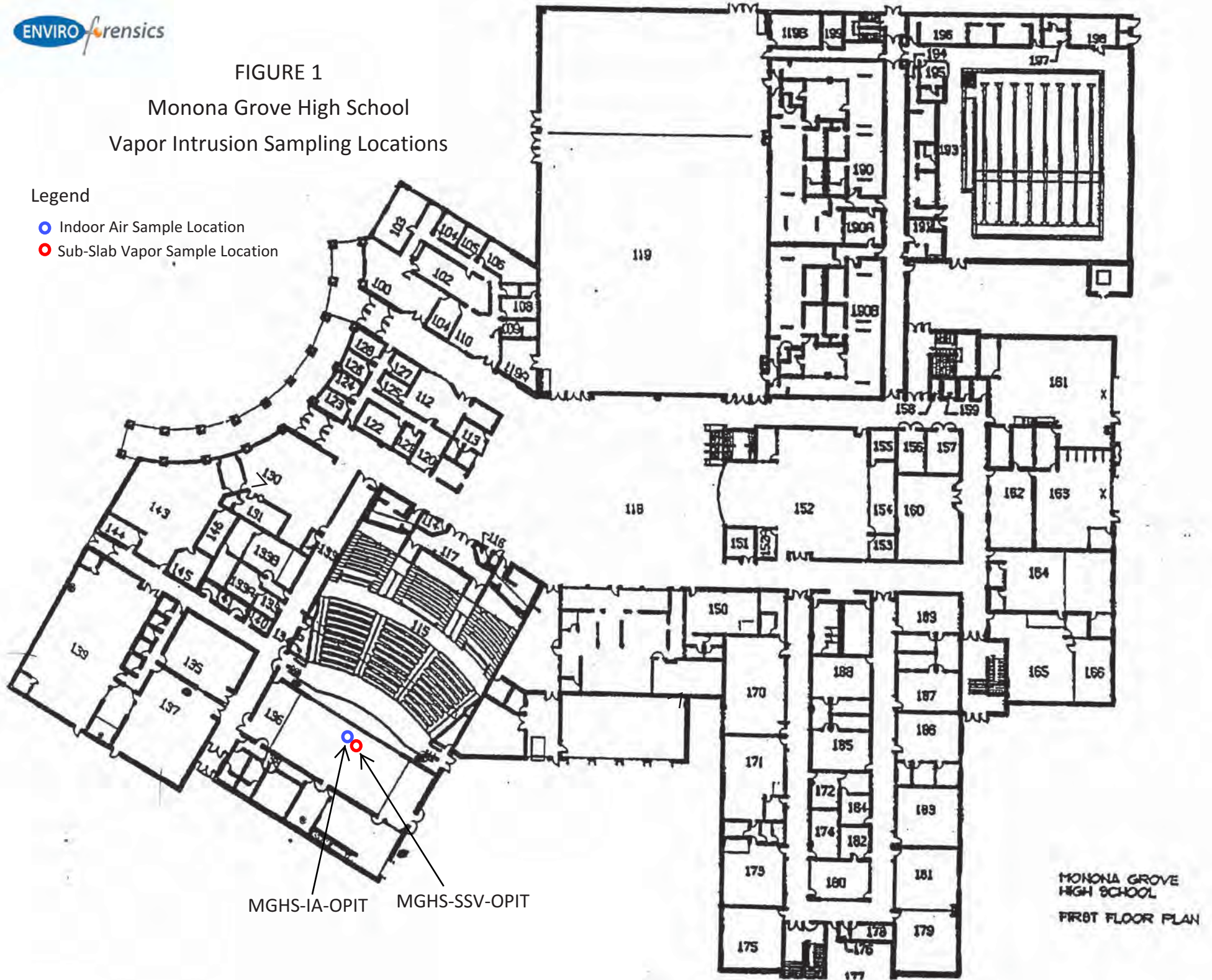

TABLE 1
INDOOR AIR SAMPLE ANALYTICAL RESULTS SUMMARY
MONONA GROVE HIGH SCHOOL

Klinke Cleaners
4518 Monona Drive, Madison, Wisconsin

Sample Identification	Sampling Location	Mitigation (pre/post)	Date Sampled	Tetrachloroethene	Trichloroethene
Residential Indoor Air Vapor Action Level				6.2	0.39
6243-MGHS-IA-OP	Orchestra Pit	pre	5/18/2012	10	0.0
6243-MGHS-IA-OP			5/31/2012	13	ND
6243-MGHS-IA-OP		post	8/28/2012	4.6	ND
6243-MGHS-IA-OP			9/26/2012	0.67	ND
6243-MGHS-IA-OPIT			1/3/2013	1.6	ND
6243-MGHS-DUP			1/3/2013	1.2	ND
6243-MGHS-IA-OP			4/3/2013	1.5	ND
6243-MGHS-IA-DUP			4/3/2013	0.62	ND
6243-MGHS-IA-OPIT			8/7/2013	0.21	ND
6243-MGHS-DUP			8/7/2013	0.51	ND
6243-MGHS-IA-OPIT			11/25/2013	0.20	ND
6243-MGHS-IA-OPIT			7/1/2014	2.0	ND
6243-MGHS-IA-OPIT			12/23/2014	0.44	ND
6243-MGHS-IA-OPIT			12/29/2015	ND	ND
6404-MGHS-IA-OPIT			7/26/2018	ND	ND
6404-MGHS-IA-OPIT			12/28/2018	ND	ND
6404-MGHS-IA-OPIT		12/27/2019	ND	ND	

Notes:

Concentrations reported in units in ppbv = parts per billion by volume

Indoor air vapor action levels calculated in accordance with WDNR Publication RR-800.

Bolded values are above detection limits

Bolded and shaded values exceed the residential vapor action level

Mitigation system installation completed August 21, 2012

ND = Compound not detected

TABLE 2
SUB-SLAB VAPOR SAMPLE ANALYTICAL RESULTS SUMMARY
MONONA GROVE HIGH SCHOOL

Klinke Cleaners
4518 Monona Drive, Madison, Wisconsin

Sample Identification	Sampling Location	Date Sampled	Tetrachloroethene	Trichloroethene
Residential Vapor Risk Screening Level			210	13
6243-MGHS-SSV-OPIT	Orchestra Pit	5/4/2012	3,700	<47
6243-SSV-DUP (OPIT)		5/4/2012	4,600	<56
6404-MGHS-SSV-OPIT		7/26/2018	16.3	1.47
6404-MGHS-SSV-OPIT		12/28/2018	28.8	66.1
6404-MGHS-SSV-OPIT		12/27/2019	27.9	<2

Notes:

Concentrations reported in units in ppbv = parts per billion by volume

Vapor risk screening levels calculated according to the procedures described in

WDNR Publication RR-800 and subsequent guidance

Bolded values are above detection limits

Bolded and shaded values exceed land use-specific screening levels



EnvisionAir
1441 Sadlier Circle West Drive
Indianapolis, IN 46239
Ph: 317-351-0885
Fax: 317-351-0882
www.envision-air.com

Mr. Brian Kappen
Enviroforensics
N16 W. 23390 Stone Ridge Dr
Suite G
Waukesha, WI 53188

January 8, 2020

EnvisionAir Project Number: 2019-819
Client Project Name: 6404

Dear Mr. Kappen,

Please find the attached analytical report for the samples received December 30, 2019. All test methods performed were fully compliant with local, state, and federal EPA methods unless otherwise noted. The project was analyzed as requested on the enclosed chain of custody record. Please review the comments section for additional information about your results or Quality Control data.

Feel free to contact me if you have any questions or comments regarding your analytical report or service.

Thank you for your business. EnvisionAir looks forward to working with you on your next project.

Yours Sincerely,

A handwritten signature in black ink that reads "Stanley A. Hunnicutt".

Stanley A Hunnicutt

Project Manager
EnvisionAir, LLC



EnvisionAir
 1441 Sadlier Circle West Drive
 Indianapolis, IN 46239
 Ph: 317-351-0885
 Fax: 317-351-0882
 www.envision-air.com

Client Name: ENVIROFORENSICS
Project ID: 6404
Client Project Manager: BRIAN KAPPEN
EnvisionAir Project Number: 2019-819

Sample Summary

Canister Pressure / Vacuum

<u>Laboratory Sample Number:</u>	<u>Sample Description:</u>	<u>Matrix:</u>	<u>START</u>	<u>START</u>	<u>End Date</u>	<u>End Time</u>	<u>Date</u>	<u>Time</u>	<u>Initial Field</u>	<u>Final Field</u>	<u>Lab</u>
			<u>Date</u>	<u>Time</u>							
19-3572	6404-MGHS-IA-OPIT	A	12/26/19	9:50	12/27/19	9:36	12/30/19	10:00	-29	-5	-5
19-3573	6404-MGHS-SSV-OPIT	A	12/27/19	9:48	12/27/19	9:53	12/30/19	10:00	-27	-3	-3



EnvisionAir
1441 Sadler Circle West Drive
Indianapolis, IN 46239
Ph: 317-351-0885
Fax: 317-351-0882
www.envision-air.com

Client Name: ENVIROFORENSICS

Project ID: 6404

Client Project Manager: BRIAN KAPPEN

EnvisionAir Project Number: 2019-819

Analytical Method: TO-15
Analytical Batch: 010220AIR

Client Sample ID: 6404-MGHS-IA-OPIT **Sample Collection START Date/Time:** 12/26/19 9:50
Sample Collection END Date/Time: 12/27/19 9:36
Envision Sample Number: 19-3572 **Sample Received Date/Time:** 12/30/19 10:00
Sample Matrix: AIR

<u>Compounds</u>	<u>Sample Results ppbv</u>	<u>Reporting Limit ppbv</u>	<u>Flag</u>
cis-1,2-Dichloroethene	< 5	5	
Tetrachloroethene	< 0.47	0.47	
trans-1,2-Dichloroethene	< 10	10	
Trichloroethene	< 0.2	0.2	
Vinyl Chloride	< 0.5	0.5	
4-bromofluorobenzene (surrogate)	118%		
Analysis Date/Time:	1-2-20/17:40		
Analyst Initials	tjg		



EnvisionAir
1441 Sadlier Circle West Drive
Indianapolis, IN 46239
Ph: 317-351-0885
Fax: 317-351-0882
www.envision-air.com

Client Name: ENVIROFORENSICS

Project ID: 6404

Client Project Manager: BRIAN KAPPEN

EnvisionAir Project Number: 2019-819

Analytical Method: TO-15
Analytical Batch: 010220AIR

Client Sample ID: 6404-MGHS-SSV-OPIT **Sample Collection START Date/Time:** 12/27/19
Sample Collection END Date/Time: 12/27/19
Envision Sample Number: 19-3573 **Sample Received Date/Time:** 12/30/19
Sample Matrix: AIR

<u>Compounds</u>	<u>Sample Results ppbv</u>	<u>Reporting Limit ppbv</u>	<u>Flag</u>
cis-1,2-Dichloroethene	< 50	50	
Tetrachloroethene	27.9	4.7	
trans-1,2-Dichloroethene	< 100	100	
Trichloroethene	< 2	2	
Vinyl Chloride	< 5	5	
4-bromofluorobenzene (surrogate)	98%		
Analysis Date/Time:	1-2-20/19:22		
Analyst Initials	tjg		

TO-15 Quality Control Data

EnvisionAir Batch Number: 010220AIR

<u>Method Blank (MB):</u>	<u>MB Results (ppbv)</u>	<u>Reporting Limit (ppbv)</u>	<u>Flags</u>
cis-1,2-Dichloroethene	< 5	5	
Tetrachloroethene	< 0.47	0.47	
trans-1,2-Dichloroethene	< 10	10	
Trichloroethene	< 0.2	0.2	
Vinyl Chloride	< 0.5	0.5	
4-bromofluorobenzene (surrogate)	107%		
Analysis Date/Time:	1-2-20/15:16		
Analyst Initials	tjg		

<u>LCS/LCSD</u>	<u>LCS Results (ppbv)</u>	<u>LCSD Results (ppbv)</u>	<u>LCS/D Conc(ppbv)</u>	<u>LCS Rec.</u>	<u>LCSD Rec.</u>	<u>RPD</u>	<u>Flag</u>
Vinyl Chloride	10.1	11.1	10	101%	111%	9.4%	
trans-1,2-Dichloroethene	10.4	11.3	10	104%	113%	8.3%	
cis-1,2-Dichloroethene	11	10.4	10	110%	104%	5.6%	
Trichloroethene	9.97	9.44	10	100%	94%	5.5%	
Tetrachloroethene	8.77	9.56	10	88%	96%	8.6%	
4-bromofluorobenzene (surrogate)	101%	93%					
Analysis Date/Time:	1-2-20/13:17	1-2-20/14:02					
Analyst Initials	tjg	tjg					



EnvisionAir
1441 Sadlier Circle West Drive
Indianapolis, IN 46239
Ph: 317-351-0885
Fax: 317-351-0882
www.envision-air.com

Flag Number

Comments

