



INTERIM REMEDIAL ACTION COMPLETION REPORT

**KLINKE CLEANERS
1295 N. SHERMAN AVENUE
MADISON, WI 53704
BRRTS# 02-13-551965**

September 27, 2019

Prepared For:

Klinke Cleaners
4518 Monona Drive
Madison, WI 53716

Prepared By:

EnviroForensics, LLC
N16W23390 Stone Ridge Drive, Suite G
Waukesha, WI 53188
Phone: (262) 290-4001
www.enviroforensics.com

A handwritten signature in blue ink, appearing to read "Brian Kappen".

Brian Kappen, PG
Project Manager

Andrew Horwath, PE
Senior Engineer

TABLE OF CONTENTS

1.0	INTRODUCTION.....	1
1.1	Site Description.....	1
1.2	Remedial Objectives	1
2.0	REMEDIAL ACTIVITIES	2
2.1	Soil Excavation and Utility Replacement.....	2
2.2	Post-Excavation Soil Sampling.....	3
3.0	CONCLUSIONS	5

TABLES

- 1 Summary of Excavation Floor and Sidewall Sample Analytical Results

FIGURES

- 1 Site Layout Map
- 2 Excavation Limits with Floor and Sidewall Soil Sample Results
- 3 Underground Utility Layout

APPENDICES

- A Waste Manifests and Weight Tickets
- B Photographs
- C Soil Laboratory Analytical Report

CERTIFICATIONS

I, Andrew Horwath, hereby certify that I am a registered professional engineer in the State of Wisconsin, registered in accordance with the requirements of ch. A-E 4, Wis. Adm. Code; that this document has been prepared in accordance with the Rules of Professional Conduct in ch. A-E 8, Wis. Adm. Code; and that, to the best of my knowledge, all information contained in this document is correct and the document was prepared in compliance with all applicable requirements in chs. NR 700 to 726, Wis. Adm. Code.

Senior Engineer, PE Lic. No. E-43831-6

Signature, title and P.E. number

P.E. stamp

I, Brian Kappen, hereby certify that I am a hydrogeologist as that term is defined in s. NR 712.03 (1), Wis. Adm. Code, am registered in accordance with the requirements of ch. GHSS 2, Wis. Adm. Code, or licensed in accordance with the requirements of ch. GHSS 3, Wis. Adm. Code, and that, to the best of my knowledge, all of the information contained in this document is correct and the document was prepared in compliance with all applicable requirements in chs. NR 700 to 726, Wis. Adm. Code.



Signature and title Project Manager

9/27/2019
Date

1.0 INTRODUCTION

EnviroForensics, LLC (EnviroForensics) has prepared this *Interim Remedial Action Completion Report* (Report) to document remedial activities performed at the Klinke Cleaners facility located at 1295 N. Sherman Avenue in Madison, Wisconsin (Site). This Report has been prepared in accordance with the requirements of Wisconsin Administrative Code Chapter NR 724.15.

1.1 Site Description

The Site is occupied by a dry cleaning facility that currently uses a non-toxic silicon-based solution in the cleaning process. The use of the dry cleaning solvent tetrachloroethene (PCE) was discontinued in 2008. The Site is located within an area of mixed residential and commercial land use. The features of the Site and surrounding area are depicted on **Figure 1**. The Site consists of a slab-on-grade, one-story, commercial building and asphalt paved parking area with drive through service. The Site is bound by Aberg Avenue to the north, a multi-tenant commercial property to the east and south, and Sherman Avenue to the west. The nearest surface water body is Lake Mendota located approximately 2,300 feet to the west of the site.

PCE is the primary contaminant of concern in the subsurface. The distribution of PCE concentrations suggested that the likely source of impacts was historic releases to the sanitary sewer lateral, possibly through floor drains inside the building. The highest PCE concentrations in soil were detected along the sanitary sewer lateral, focused at some point along that lateral within 20-30 feet of the Site building. A camera inspection of the sewer lateral revealed a cast iron pipe buried shallow (2-3 feet below ground surface (bgs)) and in generally poor condition, with a significant downward bow in the line west of the building. In general, the highest impacts detected during site investigation and source area characterization activities were present in the 4-6 foot depth interval, immediately below the sewer pipe.

1.2 Remedial Objectives

The interim remedial action plan consisted of excavation and off-site disposal of contaminated soil, and replacement of the damaged sanitary sewer lateral. The objectives of remediation were to:

- Remove the source of contamination, defined as soil containing PCE at concentrations above 1 milligram per kilogram (mg/kg); and
- Reduce the potential for further contaminant migration to groundwater by eliminating leakage from the sanitary sewer lateral.

2.0 REMEDIAL ACTIVITIES

The interim remedial action consisted of contaminated soil excavation and off-site disposal, and replacement of the damaged sanitary utility lateral. In addition, sections of the water service and a private underground electrical line required replacement to facilitate remediation because they transected the excavation area. Following backfilling, the excavation area was covered at the surface with new asphalt.

The remedial activities were conducted as described in the *Interim Remedial Action Design Report* dated May 3, 2019, approved by a May 23, 2019 letter from the Wisconsin Department of Natural Resources.

2.1 Soil Excavation and Utility Replacement

The remedial activities were performed July 22-25 of 2019 under the direction of EnviroForensics. The excavation and sewer replacement tasks were completed by Horizon Construction and Exploration, LLC and H. J. Pertzborn Plumbing & Fire Protection Corp., respectively. Soil was excavated from a pre-defined area based on the results of source area soil characterization sampling completed in 2015. Soil was removed using an excavator and loaded directly into dump trucks. Debris associated with prior Site use as a gasoline service station, including pieces of concrete foundation and steel piping, was encountered and removed. The majority of the excavated material was sandy fill, likely emplaced during redevelopment of the Site in the late 1970's or early 1980's. Native silty sand soil was exposed in the bottom and sidewalls of the excavation.

Field screening of soil samples was performed using a portable gas chromatograph (GC) as excavation activities proceeded. The screening samples were generally collected from the floor of the excavation at a depth of 6 feet bgs. In the field, the GC was connected to a computer that displayed the real-time analysis of each soil sample in the form of a graph with peaks corresponding to individual VOCs. The concentration of a given compound was estimated by selecting the area under the peak per manufacturer instructions. The concentrations are considered estimates because the areas are selected manually by the user, and beginning and ending points if each peak are subject to interpretation. If the field screening analysis indicated a PCE concentration above 1 mg/kg, an additional 1 to 2 feet of soil was removed from the surrounding area. The final depth of excavation ranged from 6 to 8 feet bgs, as planned.

The southeast extent of the excavation was limited by a large piece of concrete that was encountered below the curb that extends north from the drive-through canopy. The excavator

attempted to lift the concrete, but it appeared to be a significant piece so it was left in place to maintain structural integrity in that area. The excavation extent is depicted on **Figure 2**.

A total of 376.85 tons of contaminated soil were excavated, loaded and transported for disposal to Madison Prairie Landfill in Sun Prairie, Wisconsin. Copies of the waste manifests and weight tickets are provided in **Appendix A**. The excavation was backfilled with gravel and capped with 4 inches of hot-mix asphalt pavement. Photographs of the excavation are presented in **Appendix B**.

The sanitary sewer lateral was replaced within the excavation area with 4-inch diameter PVC pipe. The PVC pipe was connected to the original cast iron sewer pipe at the east wall of the excavation. The subsurface utility layout at the Site is depicted on **Figure 3**, indicating the sections of sewer and water service laterals that were replaced. All plumbing work was approved by a City of Madison inspector.

2.2 Post-Excavation Soil Sampling

Soil samples were collected from the floor and sidewalls of the excavation area to document residual volatile organic compound (VOC) concentrations. Six (6) floor samples were collected from depths ranging from 6 to 8 feet bgs, and six (6) sidewall samples were collected from approximately 4 feet bgs using new, disposable core sampling devices. Soil cores were transferred into vials containing methanol, and the samples were immediately placed in a cooler on ice under chain of custody control and submitted to Synergy Environmental Lab for analysis of VOCs by the Environmental Protection Agency Method 8260.

The soil sample analytical results are summarized and compared to Residual Contaminant Levels on **Table 1**. The soil sample locations and PCE concentrations are depicted on **Figure 2**. Laboratory analytical reports are provided in **Appendix C**. The PCE concentrations in floor samples FS-1 (1.01 mg/kg) and FS-2 (1.14 mg/kg) were very close to the target residual concentration of 1 mg/kg. All other floor sample results were below 1 mg/kg. These results indicate that the excavation depth was adequate to remove the most contaminated soil around the sewer lateral.

PCE concentrations in the sidewall samples were below 1 mg/kg with the exception of WS-1, which contained PCE at a concentration of 2.24 mg/kg. This concentration was unexpected given the low PCE concentrations detected in nearby characterization samples from borings GP-1 and PZ-1 collected during the Site investigation (see **Figure 1**). The PCE concentration was just above the detection limit at GP-1 (4-6 feet bgs), and PCE was not detected at PZ-1

(2.5 – 5 feet bgs). The planned lateral extent of the excavation toward the northwest was based on these data points, which indicate that PCE concentrations in soil decrease quickly to the north and west of sidewall sample WS-1. Field screening with the portable GC during the excavation was focused on confirming sufficient excavation depth only. Screening of sidewall soil was limited to a few samples near the sewer pipe.

The PCE concentrations in sidewall samples collected from the southeast part of the excavation, including WS-3 (0.128 mg/kg) and WS-4 (<0.032 mg/kg), indicate that soil left in place due to encountering the large piece of concrete does not contain significant PCE mass.

3.0 CONCLUSIONS

Excavation activities resulted in the removal of 376.85 tons of contaminated soil. The PCE mass removed was estimated by assigning PCE concentrations (using the investigation, source area characterization, and post-excavation sampling data) to 22 individual “volumes” that added up to the total tons of soil excavated. According to this estimation, approximately 0.78 pounds of PCE was removed. However, this estimate is likely biased low because PCE concentrations near point source(s) of leakage from sewer lateral could be orders of magnitude higher than those detected in the soil samples.

The post-excavation sampling indicates that the soil removed comprised the majority of the source material, however, some contaminant mass resides along the excavation boundaries. Direct contact with residual soil contamination is prevented by the asphalt surface. The concentrations of VOCs remaining in soil are well below direct contact RCLs and would not pose a risk to workers in the event of future excavation. Additionally, the new, impervious pavement will inhibit infiltration of precipitation, thereby minimizing the potential for continued mass loading to groundwater.

Periodic groundwater monitoring should be conducted to evaluate the effects of the completed remedial actions on groundwater conditions. A groundwater monitoring plan will be submitted separately for review and approval.

TABLES

TABLE 1
SUMMARY OF EXCAVATION FLOOR AND SIDEWALL SAMPLE ANALYTICAL RESULTS

Klinke Cleaners - Sherman Ave
 Madison, Wisconsin

Sample Identification	Sample Date	Sample Depth (feet)	Tetrachloroethene	1,2,4-Trimethylbenzene	1,3,5-Trimethylbenzene
Industrial RCL ¹			145	219	182
Non-Industrial RCL ¹			33	219	182
Soil to Goundwater RCL ¹			0.0045	1.3787	
FS-1	7/22/2019	6	1.01	0.101	0.07 J
FS-2	7/22/2019	6	1.14	<0.025	<0.032
FS-3	7/23/2019	6	0.264	<0.025	<0.032
FS-4	7/23/2019	6	0.88	<0.025	<0.032
FS-5	7/23/2019	6	0.088 J	<0.025	<0.032
FS-6	7/23/2019	6	0.268	<0.025	<0.032
WS-1	7/23/2019	4	2.24	<0.025	<0.032
WS-2	7/23/2019	4	0.87	<0.025	<0.032
WS-3	7/23/2019	4	0.128	<0.025	<0.032
WS-4	7/23/2019	4	<0.032	<0.025	<0.032
WS-5	7/23/2019	4	<0.032	<0.025	<0.032
WS-6	7/23/2019	4	0.91	<0.025	<0.032

Notes:

¹ Residual Contaminant Levels are determined using the EPA Residual Screening Levels (RSL) calculator according to the procedures described in WDNR Publication RR-890

All concentrations reported in milligrams per kilogram (mg/kg)

Samples analyzed using EPA SW-846 Method 8260

Bolded values exceed method detection limits

Bolded and blue shaded values exceed the Soil to Groundwater Residual Contaminant Level

FS = Floor Sample

WS = Wall Sample

J = Analyte concentration between the laboratory Method Detection Limit and Reporting Limit

RCL = Residual Contaminant Level

FIGURES

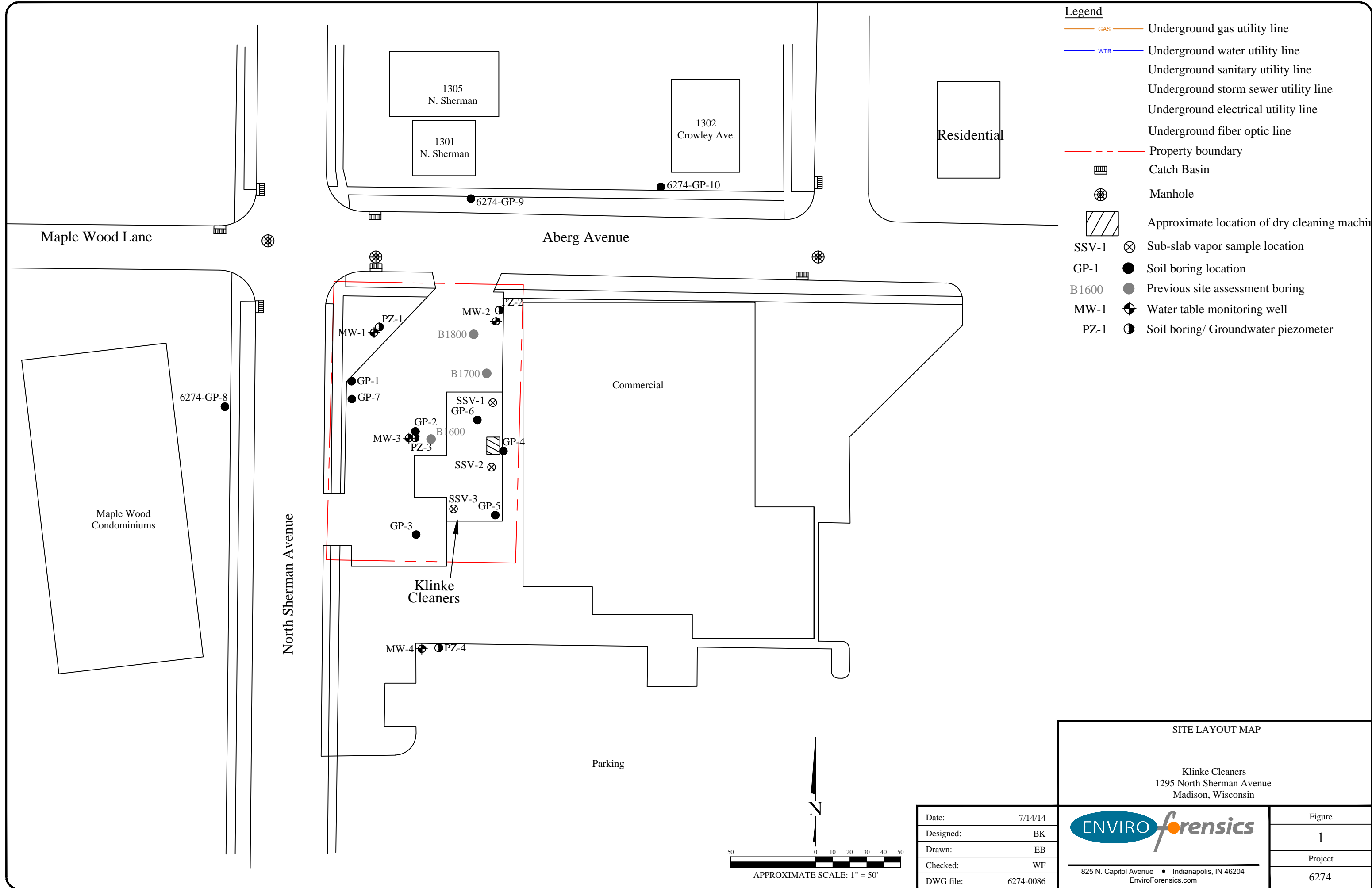

- Legend**
- GAS — Underground gas utility line
 - WTR — Underground water utility line
 - Underground sanitary utility line
 - Underground storm sewer utility line
 - Underground electrical utility line
 - Underground fiber optic line
 - - - Property boundary
 - Catch Basin
 - Manhole
 - Approximate location of dry cleaning machine
 - SSV-1 Sub-slab vapor sample location
 - GP-1 Soil boring location
 - B1600 Previous site assessment boring
 - MW-1 Water table monitoring well
 - PZ-1 Soil boring/ Groundwater piezometer

SITE LAYOUT MAP	
Klinke Cleaners 1295 North Sherman Avenue Madison, Wisconsin	
	Figure 1
825 N. Capitol Avenue • Indianapolis, IN 46204 EnviroForensics.com	Project 6274

Date:	7/14/14
Designed:	BK
Drawn:	EB
Checked:	WF
DWG file:	6274-0086

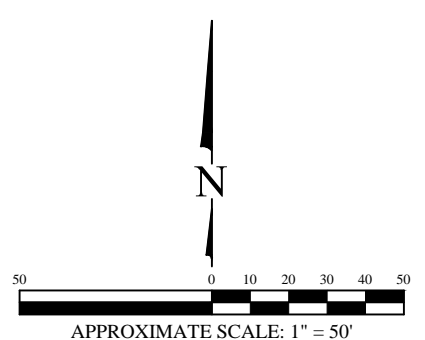

North Sherman Avenue

Aberg Avenue

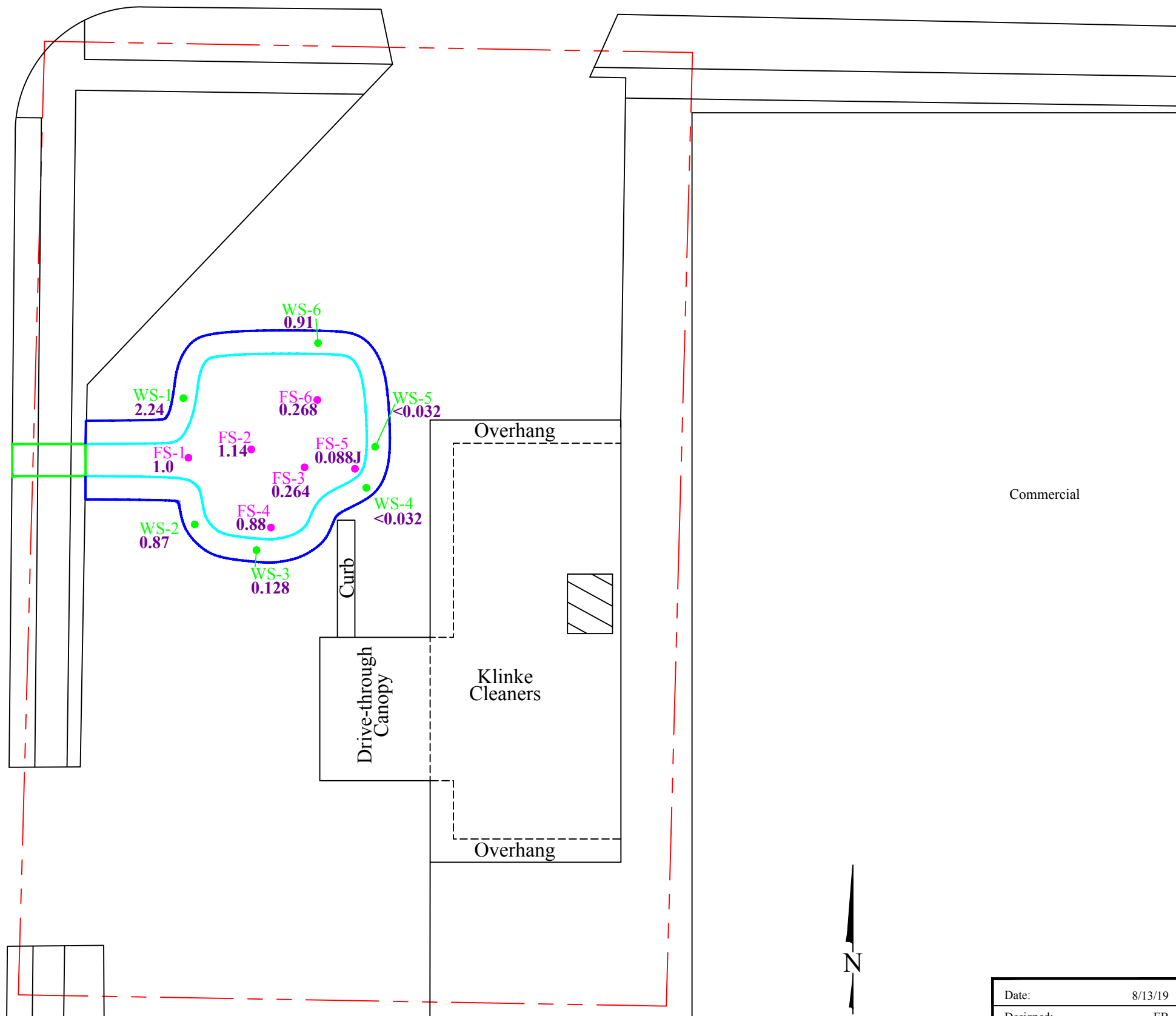

Legend

- Property boundary
- Approximate location of dry cleaning machine

Note:

- Tetrachloroethene (PCE) concentrations at standard depth intervals
- Samples collected July 22-23, 2019
- Depth is in feet below ground surface

- Excavation to 6-8 feet
- Excavation to depth of sewer connection 3-4 feet
- Excavation extent for sloping
- Excavation sidewall sample
- Excavation floor sample
- PCE concentration in soil sample in milligrams per kilogram (mg/kg)

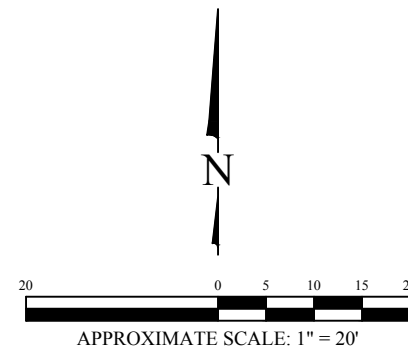

EXCAVATION LIMITS WITH FLOOR AND SIDEWALL SOIL SAMPLE RESULTS

Klinke Cleaners
1295 North Sherman Avenue
Madison, Wisconsin

Date:	8/13/19
Designed:	EB
Drawn:	EB
Checked:	BK
DWG file:	6274-0384

825 North Capitol Avenue • Indianapolis, IN 46204
EnviroForensics.com

Figure	2
Project	6274

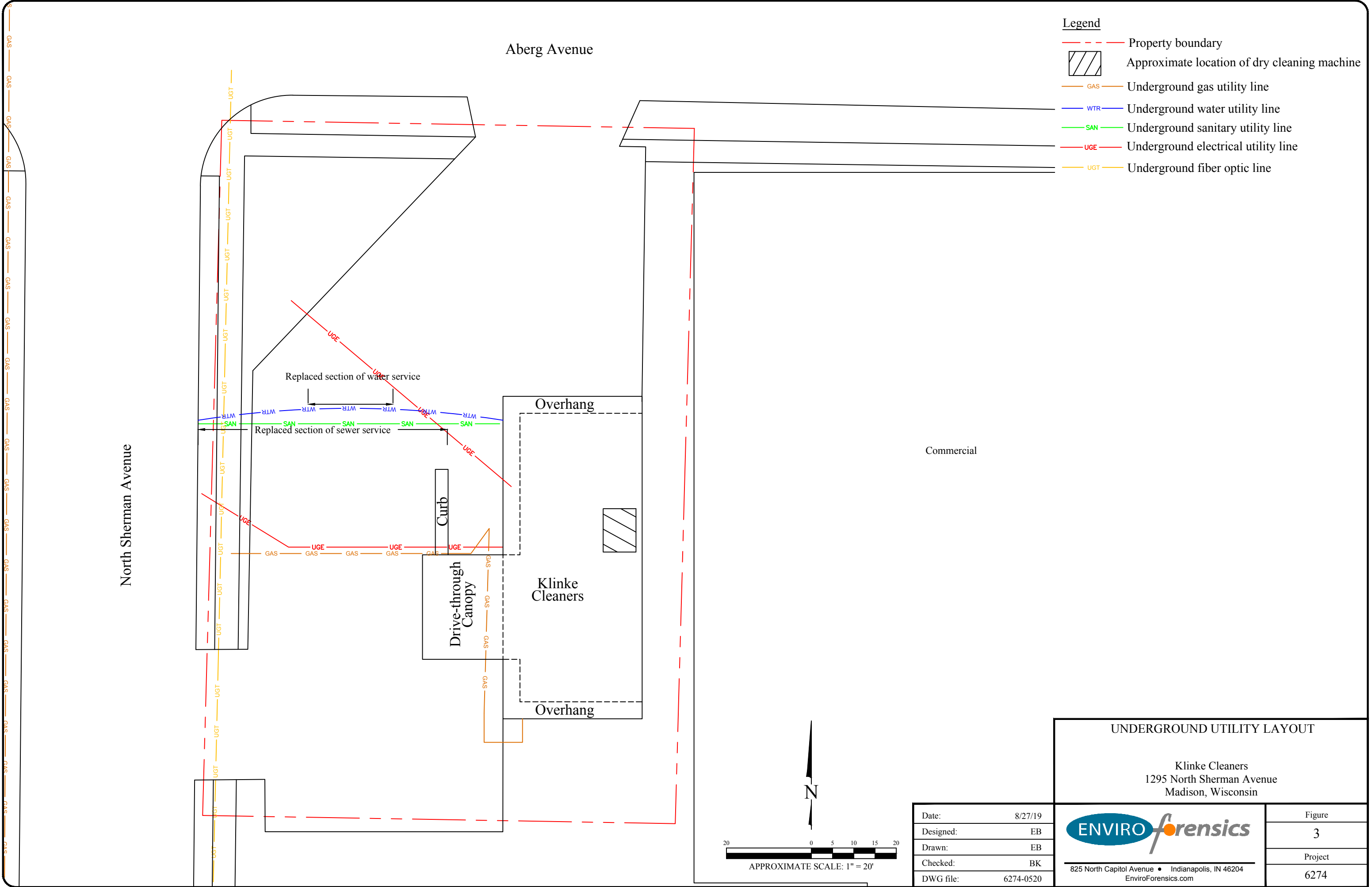

North Sherman Avenue

Aberg Avenue

Commercial







Curb

Drive-through
Canopy

Overhang

Klinke
Cleaners

Overhang

- Legend**
-  Property boundary
 -  Approximate location of dry cleaning machine
 -  GAS - Underground gas utility line
 -  WTR - Underground water utility line
 -  SAN - Underground sanitary utility line
 -  UGE - Underground electrical utility line
 -  UGT - Underground fiber optic line

UNDERGROUND UTILITY LAYOUT															
Klinke Cleaners 1295 North Sherman Avenue Madison, Wisconsin															
<table border="1" style="width: 100%; border-collapse: collapse;"> <tr><td>Date:</td><td>8/27/19</td></tr> <tr><td>Designed:</td><td>EB</td></tr> <tr><td>Drawn:</td><td>EB</td></tr> <tr><td>Checked:</td><td>BK</td></tr> <tr><td>DWG file:</td><td>6274-0520</td></tr> </table>	Date:	8/27/19	Designed:	EB	Drawn:	EB	Checked:	BK	DWG file:	6274-0520	<table border="1" style="width: 100%; border-collapse: collapse;"> <tr><td style="text-align: center;">Figure</td></tr> <tr><td style="text-align: center;">3</td></tr> <tr><td style="text-align: center;">Project</td></tr> <tr><td style="text-align: center;">6274</td></tr> </table>	Figure	3	Project	6274
Date:	8/27/19														
Designed:	EB														
Drawn:	EB														
Checked:	BK														
DWG file:	6274-0520														
Figure															
3															
Project															
6274															
															
825 North Capitol Avenue • Indianapolis, IN 46204 EnviroForensics.com															

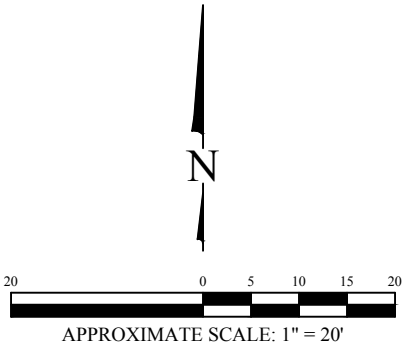

APPENDIX A

Waste Manifests and Weight Tickets



NON-HAZARDOUS MANIFEST

NON-HAZARDOUS MANIFEST		1. Generator's US EPA ID No.		Manifest Doc No.		2. Page 1 of			
3. Generator's Mailing Address: EnviroForensics, LLC N16 W23390 Stone Ridge Dr, Suite G Waukesha WI 53188			Generator's Site Address (if different than mailing): Klinke Clothing Care, Inc. 1295 N. Sherman Ave Madison, WI 53704			A. Manifest Number WMNA 8207024			
4. Generator's Phone (608) 620-7659			B. State Generator's ID						
5. Transporter 1 Company Name <i>Fredenberg</i>			6. US EPA ID Number		C. State Transporter's ID				
7. Transporter 2 Company Name			8. US EPA ID Number		D. Transporter's Phone				
9. Designated Facility Name and Site Address Madison Prairie Landfill 6002 Nelson Rd. Sun Prairie, WI 53590			10. US EPA ID Number		E. State Transporter's ID				
					F. Transporter's Phone				
					G. State Facility ID				
					H. State Facility Phone 608-837-9031				
GENERATOR	11. Description of Waste Materials		12. Containers		13. Total	14. Unit	I. Misc. Comments		
	a. PCE Impacted Soil		No.	Type	Quantity	Wt./Vol.			
	WM Profile # V131499WI				24.3	gal			
	b.								
	WM Profile #								
	c.								
d.									
WM Profile #									
J. Additional Descriptions for Materials Listed Above			K. Disposal Location						
BILL TO:			Cell	Level					
			Grid						
15. Special Handling Instructions and Additional Information									
Purchase Order # 2019-0491		EMERGENCY CONTACT / PHONE NO.:			(608) 620-7659				
16. GENERATOR'S CERTIFICATE: I hereby certify that the above-described materials are not hazardous wastes as defined by CFR Part 261 or any applicable state law, have been fully and accurately described, classified and packaged and are in proper condition for transportation according to applicable regulations.									
Printed Name <i>A. agent of generator</i> <i>Nathan Degan</i>			Signature "On behalf of"			Month	Day	Year	
						7	22	19	
TRANSPORTER	17. Transporter 1 Acknowledgement of Receipt of Materials								
	Printed Name <i>Xavier M...</i>			Signature			Month	Day	Year
							7	22	19
OPERATOR	18. Transporter 2 Acknowledgement of Receipt of Materials								
	Printed Name			Signature			Month	Day	Year
FACILITY	19. Certificate of Final Treatment/Disposal I certify, on behalf of the above listed treatment facility, that to the best of my knowledge, the above-described waste was managed in compliance with all applicable laws, regulations, permits and licenses on the dates listed above.								
	20. Facility Owner or Operator: Certification of receipt of non-hazardous materials covered by this manifest.								
Printed Name <i>Nathan Degan</i>			Signature			Month	Day	Year	
						7	22	19	

White- TREATMENT, STORAGE, DISPOSAL FACILITY COPY

Blue- GENERATOR #2 COPY

Yellow- GENERATOR #1 COPY

Pink- FACILITY USE ONLY

Gold- TRANSPORTER #1 COPY



NON-HAZARDOUS MANIFEST

NON-HAZARDOUS MANIFEST		1. Generator's US EPA ID No.		Manifest Doc No.		2. Page 1 of		
3. Generator's Mailing Address: EnviroForensics, LLC N16 W23390 Stone Ridge Dr, Suite G Waukesha WI 53188			Generator's Site Address (if different than mailing): Klinke Clothing Care, Inc. 1295 N. Sherman Ave Madison, WI 53704			A. Manifest Number WMNA 8207022		
4. Generator's Phone (608) 620-7659			B. State Generator's ID					
5. Transporter 1 Company Name <i>Fredenberg 32</i>			6. US EPA ID Number		C. State Transporter's ID			
7. Transporter 2 Company Name			8. US EPA ID Number		D. Transporter's Phone			
9. Designated Facility Name and Site Address Madison Prairie Landfill 6002 Nelson Rd. Sun Prairie, WI 53590			10. US EPA ID Number		E. State Transporter's ID			
					F. Transporter's Phone			
					G. State Facility ID			
					H. State Facility Phone 608-837-9031			
GENERATOR	11. Description of Waste Materials			12. Containers		13. Total	14. Unit	I. Misc. Comments
	a. PCE Impacted Soil			No.	Type	Quantity	Wt./Vol.	
	WM Profile # V131499WI					21.99	ton	
	b.							
	WM Profile #							
c.								
WM Profile #								
d.								
WM Profile #								
J. Additional Descriptions for Materials Listed Above			K. Disposal Location					
BILL TO:			Cell		Level			
			Grid					
15. Special Handling Instructions and Additional Information								
Purchase Order # 2019-0491		EMERGENCY CONTACT / PHONE NO.:				(608) 620-7659		
16. GENERATOR'S CERTIFICATE: I hereby certify that the above-described materials are not hazardous wastes as defined by CFR Part 261 or any applicable state law, have been fully and accurately described, classified and packaged and are in proper condition for transportation according to applicable regulations.								
Printed Name <i>As agent of generator</i> <i>Nathan Dade</i>			Signature "On behalf of" <i>As agent of generator</i> <i>N. Dade</i>			Month	Day	Year
						7	22	19
TRANSPORTER	17. Transporter 1 Acknowledgement of Receipt of Materials			Signature		Month	Day	Year
	Printed Name <i>Deren Humphrey</i>			<i>A. L. Humphrey</i>		7	22	19
	18. Transporter 2 Acknowledgement of Receipt of Materials			Signature		Month	Day	Year
Printed Name								
FACILITY	19. Certificate of Final Treatment/Disposal I certify, on behalf of the above listed treatment facility, that to the best of my knowledge, the above-described waste was managed in compliance with all applicable laws, regulations, permits and licenses on the dates listed above.							
	20. Facility Owner or Operator: Certification of receipt of non-hazardous materials covered by this manifest.							
Printed Name <i>K. Olson</i>			Signature <i>K. Olson</i>			Month	Day	Year
						7	22	19

White- TREATMENT, STORAGE, DISPOSAL FACILITY COPY

Blue- GENERATOR #2 COPY

Yellow- GENERATOR #1 COPY

Pink- FACILITY USE ONLY

Gold- TRANSPORTER #1 COPY



NON-HAZARDOUS MANIFEST

NON-HAZARDOUS MANIFEST	1. Generator's US EPA ID No.	Manifest Doc No.	2. Page 1 of
3. Generator's Mailing Address: EnviroForensics, LLC N16 W23390 Stone Ridge Dr, Suite G Waukesha WI 53188		Generator's Site Address (if different than mailing): Klinke Clothing Care, Inc. 1295 N. Sherman Ave Madison, WI 53704	
4. Generator's Phone (608) 620-7659		A. Manifest Number WMNA 8207023	
5. Transporter 1 Company Name <i>Med 54</i>		B. State Generator's ID	
6. US EPA ID Number		C. State Transporter's ID	
7. Transporter 2 Company Name		D. Transporter's Phone	
8. US EPA ID Number		E. State Transporter's ID	
9. Designated Facility Name and Site Address Madison Prairie Landfill 6002 Nelson Rd. Sun Prairie, WI 53590		F. Transporter's Phone	
10. US EPA ID Number		G. State Facility ID	
		H. State Facility Phone 608-837-9031	
GENERATOR	11. Description of Waste Materials		12. Containers
	a. PCE Impacted Soil		No. Type
	WM Profile # V131499WI		13. Total Quantity
	b.		14. Unit Wt./Vol.
	WM Profile #		I. Misc. Comments
	c.		
WM Profile #			
d.			
WM Profile #			
J. Additional Descriptions for Materials Listed Above		K. Disposal Location	
BILL TO:		Cell	Level
		Grid	
15. Special Handling Instructions and Additional Information			
Purchase Order # 2019-0491		EMERGENCY CONTACT / PHONE NO.: (608) 620-7659	
16. GENERATOR'S CERTIFICATE: I hereby certify that the above-described materials are not hazardous wastes as defined by CFR Part 261 or any applicable state law, have been fully and accurately described, classified and packaged and are in proper condition for transportation according to applicable regulations.			
Printed Name <i>As agent of generator Nathan Duda</i>		Signature "On behalf of" <i>[Signature]</i>	
		Month	Day Year
		<i>7</i>	<i>22 19</i>
TRANSPORTER	17. Transporter 1 Acknowledgement of Receipt of Materials		
	Printed Name <i>XAVIER MOIRAD</i>		Signature <i>[Signature]</i>
	Month	Day	Year
		<i>7</i>	<i>22 19</i>
18. Transporter 2 Acknowledgement of Receipt of Materials			
Printed Name		Signature	
Month	Day	Year	
FACILITY	19. Certificate of Final Treatment/Disposal I certify, on behalf of the above listed treatment facility, that to the best of my knowledge, the above-described waste was managed in compliance with all applicable laws, regulations, permits and licenses on the dates listed above.		
	20. Facility Owner or Operator: Certification of receipt of non-hazardous materials covered by this manifest.		
	Printed Name <i>HOISA</i>		Signature <i>[Signature]</i>
		Month	Day Year
		<i>7</i>	<i>22 19</i>

White- TREATMENT, STORAGE, DISPOSAL FACILITY COPY

Blue- GENERATOR #2 COPY

Yellow- GENERATOR #1 COPY

Pink- FACILITY USE ONLY

Gold- TRANSPORTER #1 COPY



NON-HAZARDOUS MANIFEST

NON-HAZARDOUS MANIFEST		1. Generator's US EPA ID No.		Manifest Doc No.		2. Page 1 of				
3. Generator's Mailing Address: EnviroForensics, LLC N16 W23390 Stone Ridge Dr, Suite G Waukesha WI 53188			Generator's Site Address (if different than mailing): Klinke Clothing Care, Inc. 1295 N. Sherman Ave Madison, WI 53704			A. Manifest Number WMNA 8207025				
4. Generator's Phone (608) 620-7659			B. State Generator's ID							
5. Transporter 1 Company Name			6. US EPA ID Number		C. State Transporter's ID					
7. Transporter 2 Company Name			8. US EPA ID Number		D. Transporter's Phone					
9. Designated Facility Name and Site Address Madison Prairie Landfill 6002 Nelson Rd. Sun Prairie, WI 53590			10. US EPA ID Number		E. State Transporter's ID					
					F. Transporter's Phone					
					G. State Facility ID					
					H. State Facility Phone 608-837-9031					
GENERATOR	11. Description of Waste Materials				12. Containers		13. Total	14. Units	I. Misc. Comments	
	a. PCE Impacted Soil				No.	Type	Quantity	Wt./Vol.		
	WM Profile # V131499WI						24.97	tn		
	b.									
	WM Profile #									
	c.									
WM Profile #										
d.										
WM Profile #										
J. Additional Descriptions for Materials Listed Above				K. Disposal Location						
BILL TO:				Cell				Level		
				Grid						
15. Special Handling Instructions and Additional Information										
Purchase Order # 2019-0491		EMERGENCY CONTACT / PHONE NO.: (608) 620-7659								
16. GENERATOR'S CERTIFICATE:										
I hereby certify that the above-described materials are not hazardous wastes as defined by CFR Part 261 or any applicable state law, have been fully and accurately described, classified and packaged and are in proper condition for transportation according to applicable regulations.										
Printed Name <i>As agents of generator</i> <i>Nathan Duda</i>				Signature "On behalf of" <i>[Signature]</i>				Month	Day	Year
								7	22	19
TRANSPORTER	17. Transporter 1 Acknowledgement of Receipt of Materials									
	Printed Name <i>Xavier Moreno</i>			Signature <i>[Signature]</i>				Month	Day	Year
								7	22	19
18. Transporter 2 Acknowledgement of Receipt of Materials										
Printed Name			Signature				Month	Day	Year	
FACILITY	19. Certificate of Final Treatment/Disposal									
	I certify, on behalf of the above listed treatment facility, that to the best of my knowledge, the above-described waste was managed in compliance with all applicable laws, regulations, permits and licenses on the dates listed above.									
20. Facility Owner or Operator: Certification of receipt of non-hazardous materials covered by this manifest.										
Printed Name <i>LSWA</i>				Signature <i>[Signature]</i>				Month	Day	Year
								7	22	19

White- TREATMENT, STORAGE, DISPOSAL FACILITY COPY

Blue- GENERATOR #2 COPY

Yellow- GENERATOR #1 COPY

Pink- FACILITY USE ONLY

Gold- TRANSPORTER #1 COPY



NON-HAZARDOUS MANIFEST

NON-HAZARDOUS MANIFEST		1. Generator's US EPA ID No. _____ Manifest Doc No. _____		2. Page 1 of _____					
3. Generator's Mailing Address: EnviroForensics, LLC N16 W23390 Stone Ridge Dr, Suite G Waukesha WI 53188		Generator's Site Address (if different than mailing): Klinke Clothing Care, Inc. 1295 N. Sherman Ave Madison, WI 53704		A. Manifest Number WMNA 8207026					
4. Generator's Phone (608) 620-7659		B. State Generator's ID							
5. Transporter 1 Company Name <i>Trid 32</i>		6. US EPA ID Number		C. State Transporter's ID					
7. Transporter 2 Company Name		8. US EPA ID Number		D. Transporter's Phone					
9. Designated Facility Name and Site Address Madison Prairie Landfill 6002 Nelson Rd. Sun Prairie, WI 53590		10. US EPA ID Number		E. State Transporter's ID					
				F. Transporter's Phone					
				G. State Facility ID					
				H. State Facility Phone 608-837-9031					
GENERATOR	11. Description of Waste Materials		12. Containers		13. Total Quantity				
	a. PCE Impacted Soil		No.	Type		14. Unit Wt./Vol.			
	WM Profile # V131499WI						I. Misc. Comments		
	b.							<i>24.61</i>	
	WM Profile #								<i>h</i>
	c.								
WM Profile #									
d.									
WM Profile #									
J. Additional Descriptions for Materials Listed Above		K. Disposal Location							
BILL TO:		Cell		Level					
		Grid							
15. Special Handling Instructions and Additional Information									
Purchase Order # 2019-0491		EMERGENCY CONTACT / PHONE NO.: (608) 620-7659							
16. GENERATOR'S CERTIFICATE: I hereby certify that the above-described materials are not hazardous wastes as defined by CFR Part 261 or any applicable state law, have been fully and accurately described, classified and packaged and are in proper condition for transportation according to applicable regulations.									
Printed Name <i>As agent of generator</i> <i>Nathan Puda</i>		Signature "On behalf of" <i>[Signature]</i>		Month	Day				
				<i>7</i>	<i>22</i>				
				Year	<i>17</i>				
TRANSPORTER	17. Transporter 1 Acknowledgement of Receipt of Materials								
	Printed Name <i>Deron Humphreys</i>	Signature <i>[Signature]</i>			Month	Day			
EXPORTER	18. Transporter 2 Acknowledgement of Receipt of Materials								
	Printed Name	Signature			Month	Day			
FACILITY	19. Certificate of Final Treatment/Disposal. I certify, on behalf of the above listed treatment facility, that to the best of my knowledge, the above-described waste was managed in compliance with all applicable laws, regulations, permits and licenses on the dates listed above.								
	20. Facility Owner or Operator: Certification of receipt of non-hazardous materials covered by this manifest.								
	Printed Name <i>[Signature]</i>	Signature <i>[Signature]</i>			Month	Day			
				<i>7</i>	<i>22</i>				
				Year	<i>19</i>				

White- TREATMENT, STORAGE, DISPOSAL FACILITY COPY

Blue- GENERATOR #2 COPY

Yellow- GENERATOR #1 COPY

Pink- FACILITY USE ONLY

Gold- TRANSPORTER #1 COPY



NON-HAZARDOUS MANIFEST

NON-HAZARDOUS MANIFEST	1. Generator's US EPA ID No.	Manifest Doc No.	2. Page 1 of					
3. Generator's Mailing Address: EnviroForensics, LLC N16 W23390 Stone Ridge Dr, Suite G Waukesha WI 53188		Generator's Site Address (if different than mailing): Klinke Clothing Care, Inc. 1295 N. Sherman Ave Madison, WI 53704		A. Manifest Number WMNA	8207027			
4. Generator's Phone (608) 620-7659		B. State Generator's ID						
5. Transporter 1 Company Name <i>Handwritten signature</i>		6. US EPA ID Number	C. State Transporter's ID					
7. Transporter 2 Company Name		8. US EPA ID Number	D. Transporter's Phone					
9. Designated Facility Name and Site Address Madison Prairie Landfill 6002 Nelson Rd. Sun Prairie, WI 53590		10. US EPA ID Number	E. State Transporter's ID					
			F. Transporter's Phone					
			G. State Facility ID					
			H. State Facility Phone 608-837-9031					
GENERATOR	11. Description of Waste Materials		12. Containers		13. Total Quantity			
	a. PCE Impacted Soil		No.	Type		14. Unit Wt./Vol.		
	WM Profile # V131499WI						I. Misc. Comments	
	b.							<i>25.37 h</i>
	WM Profile #							
	c.							
WM Profile #								
d.								
WM Profile #								
J. Additional Descriptions for Materials Listed Above		K. Disposal Location						
BILL TO:		Cell	Level					
		Grid						
15. Special Handling Instructions and Additional Information								
Purchase Order # 2019-0491		EMERGENCY CONTACT / PHONE NO.: (608) 620-7659						
16. GENERATOR'S CERTIFICATE: I hereby certify that the above-described materials are not hazardous wastes as defined by CFR Part 261 or any applicable state law, have been fully and accurately described, classified and packaged and are in proper condition for transportation according to applicable regulations.								
Printed Name <i>As agent of generator</i> <i>Nathan D. ...</i>		Signature "On behalf of"		Month	Day			
				<i>7</i>	<i>26</i>			
				<i>15</i>				
TRANSPORTER	17. Transporter 1 Acknowledgement of Receipt of Materials							
	Printed Name <i>Xavier Moreno</i>		Signature <i>[Signature]</i>		Month			
					<i>7</i>			
				<i>22</i>	<i>15</i>			
18. Transporter 2 Acknowledgement of Receipt of Materials								
Printed Name		Signature		Month	Day			
FACILITY	19. Certificate of Final Treatment/Disposal I certify, on behalf of the above listed treatment facility, that to the best of my knowledge, the above-described waste was managed in compliance with all applicable laws, regulations, permits and licenses on the dates listed above.							
	20. Facility Owner or Operator: Certification of receipt of non-hazardous materials covered by this manifest.							
	Printed Name <i>[Signature]</i>		Signature <i>[Signature]</i>		Month	Day		
				<i>7</i>	<i>21</i>			
				<i>19</i>				

White- TREATMENT, STORAGE, DISPOSAL FACILITY COPY

Blue- GENERATOR #2 COPY

Yellow- GENERATOR #1 COPY

Pink- FACILITY USE ONLY

Gold- TRANSPORTER #1 COPY



NON-HAZARDOUS MANIFEST

NON-HAZARDOUS MANIFEST		1. Generator's US EPA ID No.	Manifest Doc No.	2. Page 1 of	
3. Generator's Mailing Address: EnviroForensics, LLC N16 W23390 Stone Ridge Dr, Suite G Waukesha WI 53188		Generator's Site Address (if different than mailing): Klinke Clothing Care, Inc. 1295 N. Sherman Ave Madison, WI 53704		A. Manifest Number WMNA	8207028
4. Generator's Phone (608) 620-7659		B. State Generator's ID			
5. Transporter 1 Company Name <i>Fred 32</i>		6. US EPA ID Number		C. State Transporter's ID	
7. Transporter 2 Company Name		8. US EPA ID Number		D. Transporter's Phone	
9. Designated Facility Name and Site Address Madison Prairie Landfill 6002 Nelson Rd. Sun Prairie, WI 53590		10. US EPA ID Number		E. State Transporter's ID	
				F. Transporter's Phone	
				G. State Facility ID	
				H. State Facility Phone 608-837-9031	
GENERATOR	11. Description of Waste Materials		12. Containers		13. Total Quantity
	a. PCE Impacted Soil		No.	Type	24.89
	WM Profile # V131499WI				14. Unit Wt./Vol.
	b.				<i>th</i>
	WM Profile #				i. Misc. Comments
	c.				
WM Profile #					
d.					
J. Additional Descriptions for Materials Listed Above		K. Disposal Location			
BILL TO:		Cell			Level
		Grid			
15. Special Handling Instructions and Additional Information					
Purchase Order # 2019-0491		EMERGENCY CONTACT / PHONE NO.: (608) 620-7659			
16. GENERATOR'S CERTIFICATE: I hereby certify that the above-described materials are not hazardous wastes as defined by CFR Part 261 or any applicable state law, have been fully and accurately described, classified and packaged and are in proper condition for transportation according to applicable regulations.					
Printed Name <i>As Agent of generator</i>		Signature "On behalf of" <i>[Signature]</i>		Month 7	Day 22
				Year 19	
TRANSPORTER	17. Transporter 1 Acknowledgement of Receipt of Materials				
	Printed Name <i>Deron Humphrey</i>		Signature <i>[Signature]</i>		Month
					Day
FACILITY	18. Transporter 2 Acknowledgement of Receipt of Materials				
	Printed Name		Signature		Month
					Day
19. Certificate of Final Treatment/Disposal I certify, on behalf of the above listed treatment facility, that to the best of my knowledge, the above-described waste was managed in compliance with all applicable laws, regulations, permits and licenses on the dates listed above.					
20. Facility Owner or Operator: Certification of receipt of non-hazardous materials covered by this manifest.					
Printed Name <i>WSA Olson</i>		Signature <i>[Signature]</i>		Month 7	Day 22
				Year 19	

White- TREATMENT, STORAGE, DISPOSAL FACILITY COPY

Blue- GENERATOR #2 COPY

Yellow- GENERATOR #1 COPY

Pink- FACILITY USE ONLY

Gold- TRANSPORTER #1 COPY



NON-HAZARDOUS MANIFEST

NON-HAZARDOUS MANIFEST		1. Generator's US EPA ID No.		Manifest Doc No.		2. Page 1 of			
3. Generator's Mailing Address: EnviroForensics, LLC N16 W23390 Stone Ridge Dr, Suite G Waukesha WI 53188			Generator's Site Address (if different than mailing): Klinke Clothing Care, Inc. 1295 N. Sherman Ave Madison, WI 53704			A. Manifest Number WMNA 8207029			
4. Generator's Phone (608) 620-7659			B. State Generator's ID						
5. Transporter 1 Company Name <i>Med 54</i>			6. US EPA ID Number		C. State Transporter's ID				
7. Transporter 2 Company Name			8. US EPA ID Number		D. Transporter's Phone				
9. Designated Facility Name and Site Address Madison Prairie Landfill 6002 Nelson Rd. Sun Prairie, WI 53590			10. US EPA ID Number		E. State Transporter's ID				
					F. Transporter's Phone				
					G. State Facility ID				
					H. State Facility Phone 608-837-9031				
GENERATOR	11. Description of Waste Materials			12. Containers		13. Total Quantity	14. Unit Wt./Vol.	I. Misc. Comments	
	a. PCE Impacted Soil			No.	Type	22.43	ton		
	WM Profile # V131499WI								
	b.								
	WM Profile #								
	c.								
TRANSPORTER	d.								
	WM Profile #								
	J. Additional Descriptions for Materials Listed Above			K. Disposal Location					
	BILL TO:			Cell		Level			
				Grid					
	15. Special Handling Instructions and Additional Information								
Purchase Order # 2019-0491			EMERGENCY CONTACT / PHONE NO.: (608) 620-7659						
16. GENERATOR'S CERTIFICATE: I hereby certify that the above-described materials are not hazardous wastes as defined by CFR Part 261 or any applicable state law, have been fully and accurately described, classified and packaged and are in proper condition for transportation according to applicable regulations.									
Printed Name AS AGENT OF GENERATOR <i>Nathan Dush</i>				Signature "On behalf of"			Month	Day	Year
				<i>[Signature]</i>			7	33	1999
TRANSPORTER	17. Transporter 1 Acknowledgement of Receipt of Materials			Signature			Month	Day	Year
	Printed Name <i>Xavier M...</i>			<i>[Signature]</i>			7	23	19
	18. Transporter 2 Acknowledgement of Receipt of Materials			Signature			Month	Day	Year
FACILITY	19. Certificate of Final Treatment/Disposal I certify, on behalf of the above listed treatment facility, that to the best of my knowledge, the above-described waste was managed in compliance with all applicable laws, regulations, permits and licenses on the dates listed above.								
	20. Facility Owner or Operator: Certification of receipt of non-hazardous materials covered by this manifest.								
	Printed Name <i>Laura</i>				Signature <i>[Signature]</i>			Month	Day
							7	23	19

White- TREATMENT, STORAGE, DISPOSAL FACILITY COPY

Blue- GENERATOR #2 COPY

Yellow- GENERATOR #1 COPY

Pink- FACILITY USE ONLY

Gold- TRANSPORTER #1 COPY



NON-HAZARDOUS MANIFEST

NON-HAZARDOUS MANIFEST		1. Generator's US EPA ID No.		Manifest Doc No.		2. Page 1 of				
3. Generator's Mailing Address: EnviroForensics, LLC N16 W23390 Stone Ridge Dr, Suite G Waukesha WI 53188			Generator's Site Address (if different than mailing): Klinke Clothing Care, Inc. 1295 N. Sherman Ave Madison, WI 53704			A. Manifest Number WMNA 8207030				
4. Generator's Phone (608) 620-7659			B. State Generator's ID							
5. Transporter 1 Company Name <i>Fred 32</i>			6. US EPA ID Number		C. State Transporter's ID					
7. Transporter 2 Company Name			8. US EPA ID Number		D. Transporter's Phone					
9. Designated Facility Name and Site Address Madison Prairie Landfill 6002 Nelson Rd. Sun Prairie, WI 53590			10. US EPA ID Number		E. State Transporter's ID					
					F. Transporter's Phone					
					G. State Facility ID					
					H. State Facility Phone 608-837-9031					
GENERATOR	11. Description of Waste Materials			12. Containers		13. Total	14. Unit	1. Misc. Comments		
	a. PCE Impacted Soil			No. Type		Quantity	Wt./Vol.			
	WM Profile # V131499WI					2.37	tn			
	b.									
	WM Profile #									
	c.									
	WM Profile #									
d.										
WM Profile #										
J. Additional Descriptions for Materials Listed Above			K. Disposal Location							
BILL TO:			Cell		Level					
			Grid							
15. Special Handling Instructions and Additional Information										
Purchase Order # 2019-0491			EMERGENCY CONTACT / PHONE NO.: (608) 620-7659							
16. GENERATOR'S CERTIFICATE: I hereby certify that the above-described materials are not hazardous wastes as defined by CFR Part 261 or any applicable state law, have been fully and accurately described, classified and packaged and are in proper condition for transportation according to applicable regulations.										
Printed Name <i>Agent of generator</i> <i>Nathan Datta</i>			Signature "On behalf of"			Month	Day	Year		
						7	23	19		
TRANSPORTER	17. Transporter 1 Acknowledgement of Receipt of Materials			Printed Name		Signature		Month	Day	Year
				<i>Deron Humphrey</i>		<i>[Signature]</i>		7	22	19
FACILITY	19. Certificate of Final Treatment/Disposal			I certify, on behalf of the above listed treatment facility, that to the best of my knowledge, the above-described waste was managed in compliance with all applicable laws, regulations, permits and licenses on the dates listed above.						
	20. Facility Owner or Operator: Certification of receipt of non-hazardous materials covered by this manifest.			Printed Name		Signature		Month	Day	Year
				<i>[Signature]</i>		<i>[Signature]</i>		7	22	19

White- TREATMENT, STORAGE, DISPOSAL FACILITY COPY

Blue- GENERATOR #2 COPY

Yellow- GENERATOR #1 COPY

Pink- FACILITY USE ONLY

Gold- TRANSPORTER #1 COPY



NON-HAZARDOUS MANIFEST

NON-HAZARDOUS MANIFEST		1. Generator's US EPA ID No. _____ Manifest Doc No. _____		2. Page 1 of _____	
3. Generator's Mailing Address: EnviroForensics, LLC N16 W23390 Stone Ridge Dr, Suite G Waukesha WI 53188			Generator's Site Address (if different than mailing): Klinke Clothing Care, Inc. 1295 N. Sherman Ave Madison, WI 53704		A. Manifest Number WMNA 8207031
4. Generator's Phone (608) 620-7659			B. State Generator's ID _____		
5. Transporter 1 Company Name <i>Fred 54</i>		6. US EPA ID Number _____		C. State Transporter's ID _____	
7. Transporter 2 Company Name _____		8. US EPA ID Number _____		D. Transporter's Phone _____	
9. Designated Facility Name and Site Address Madison Prairie Landfill 6002 Nelson Rd. Sun Prairie, WI 53590		10. US EPA ID Number _____		E. State Transporter's ID _____	
				F. Transporter's Phone _____	
				G. State Facility ID _____	
				H. State Facility Phone 608-837-9031	
GENERATOR	11. Description of Waste Materials		12. Containers		13. Total
			No.	Type	Quantity
	a. PCE Impacted Soil				24.09
	WM Profile # V131499WI				ha
	b.				
WM Profile # _____					
c.					
WM Profile # _____					
d.					
WM Profile # _____					
J. Additional Descriptions for Materials Listed Above			K. Disposal Location		
BILL TO:			Cell _____	Level _____	
			Grid _____		
15. Special Handling Instructions and Additional Information					
Purchase Order # 2019-0491		EMERGENCY CONTACT / PHONE NO.: (608) 620-7659			
16. GENERATOR'S CERTIFICATE: I hereby certify that the above-described materials are not hazardous wastes as defined by CFR Part 261 or any applicable state law, have been fully and accurately described, classified and packaged and are in proper condition for transportation according to applicable regulations.					
Printed Name <i>As agent of generator</i> <i>Nathan Duran</i>			Signature "On behalf of" <i>[Signature]</i>		Month Day Year <i>7 23 19</i>
TRANSPORTER	17. Transporter 1 Acknowledgement of Receipt of Materials				
	Printed Name <i>Xavier Moreno</i>		Signature <i>[Signature]</i>		Month Day Year <i>7 23 19</i>
	18. Transporter 2 Acknowledgement of Receipt of Materials				
Printed Name _____		Signature _____		Month Day Year _____	
FACILITY	19. Certificate of Final Treatment/Disposal I certify, on behalf of the above listed treatment facility, that to the best of my knowledge, the above-described waste was managed in compliance with all applicable laws, regulations, permits and licenses on the dates listed above.				
	20. Facility Owner or Operator: Certification of receipt of non-hazardous materials covered by this manifest.				
	Printed Name <i>LOSA</i>		Signature <i>[Signature]</i>		Month Day Year <i>7 23 19</i>

White- TREATMENT, STORAGE, DISPOSAL FACILITY COPY

Blue- GENERATOR #2 COPY

Yellow- GENERATOR #1 COPY

Pink- FACILITY USE ONLY

Gold- TRANSPORTER #1 COPY



NON-HAZARDOUS MANIFEST

NON-HAZARDOUS MANIFEST		1. Generator's US EPA ID No.		Manifest Doc No.		2. Page 1 of					
3. Generator's Mailing Address: EnviroForensics, LLC N16 W23390 Stone Ridge Dr, Suite G Waukesha WI 53188			Generator's Site Address (if different than mailing): Klinke Clothing Care, Inc. 1295 N. Sherman Ave Madison, WI 53704			A. Manifest Number WMNA 8207032					
4. Generator's Phone (608) 620-7659			B. State Generator's ID								
5. Transporter 1 Company Name <i>Tred 32</i>			6. US EPA ID Number		C. State Transporter's ID						
7. Transporter 2 Company Name			8. US EPA ID Number		D. Transporter's Phone						
9. Designated Facility Name and Site Address Madison Prairie Landfill 6002 Nelson Rd. Sun Prairie, WI 53590			10. US EPA ID Number		E. State Transporter's ID						
					F. Transporter's Phone						
					G. State Facility ID						
					H. State Facility Phone 608-837-9031						
GENERATOR	11. Description of Waste Materials				12. Containers		13. Total	14. Unit	I. Misc. Comments		
	a. PCE Impacted Soil				No.		Quantity	Wt./Vol.			
	WM Profile # V131499WI						24.55	tn			
	b.										
	WM Profile #										
	c.										
WM Profile #											
d.											
WM Profile #											
J. Additional Descriptions for Materials Listed Above				K. Disposal Location							
BILL TO:				Cell		Level					
				Grid							
15. Special Handling Instructions and Additional Information											
Purchase Order # 2019-0491				EMERGENCY CONTACT / PHONE NO.: (608) 620-7659							
16. GENERATOR'S CERTIFICATE: I hereby certify that the above-described materials are not hazardous wastes as defined by CFR Part 261 or any applicable state law, have been fully and accurately described, classified and packaged and are in proper condition for transportation according to applicable regulations.											
Printed Name <i>As agent of generator</i> <i>Nathan Puro</i>				Signature "On behalf of" <i>Nathan Puro</i>				Month	Day	Year	
								7	23	19	
TRANSPORTER	17. Transporter 1 Acknowledgement of Receipt of Materials										
	Printed Name <i>Deron Humphrey</i>				Signature <i>Deron Humphrey</i>				Month	Day	Year
									7	23	19
18. Transporter 2 Acknowledgement of Receipt of Materials											
Printed Name				Signature				Month	Day	Year	
FACILITY	19. Certificate of Final Treatment/Disposal I certify, on behalf of the above listed treatment facility, that to the best of my knowledge, the above-described waste was managed in compliance with all applicable laws, regulations, permits and licenses on the dates listed above.										
	20. Facility Owner or Operator: Certification of receipt of non-hazardous materials covered by this manifest.										
	Printed Name <i>Wise Olden</i>				Signature <i>Wise Olden</i>				Month	Day	Year
								7	23	19	

White- TREATMENT, STORAGE, DISPOSAL FACILITY COPY

Blue- GENERATOR #2 COPY

Yellow- GENERATOR #1 COPY

Pink- FACILITY USE ONLY

Gold- TRANSPORTER #1 COPY



NON-HAZARDOUS MANIFEST

NON-HAZARDOUS MANIFEST	1. Generator's US EPA ID No.	Manifest Doc No.	2. Page 1 of	
3. Generator's Mailing Address: EnviroForensics, LLC N16 W23390 Stone Ridge Dr, Suite G Waukesha WI 53188		Generator's Site Address (if different than mailing): Klinke Clothing Care, Inc. 1295 N. Sherman Ave Madison, WI 53704		
4. Generator's Phone (608) 620-7659		A. Manifest Number WMNA	8207033	
5. Transporter 1 Company Name <i>Fred 54</i>		B. State Generator's ID		
6. US EPA ID Number		C. State Transporter's ID		
7. Transporter 2 Company Name		D. Transporter's Phone		
8. US EPA ID Number		E. State Transporter's ID		
9. Designated Facility Name and Site Address Madison Prairie Landfill 6002 Nelson Rd. Sun Prairie, WI 53590		F. Transporter's Phone		
10. US EPA ID Number		G. State Facility ID		
		H. State Facility Phone	608-837-9031	
GENERATOR	11. Description of Waste Materials		12. Containers	
	a. PCE Impacted Soil		No. Type	
	WM Profile # V131499WI		13. Total Quantity	14. Unit Wt./Vol.
	b.			
	WM Profile #			
	c.			
WM Profile #				
d.				
WM Profile #				
J. Additional Descriptions for Materials Listed Above		K. Disposal Location		
BILL TO:		Cell	Level	
15. Special Handling Instructions and Additional Information		Grid		
Purchase Order # 2019-0491		EMERGENCY CONTACT / PHONE NO.: (608) 620-7659		
16. GENERATOR'S CERTIFICATE: I hereby certify that the above-described materials are not hazardous wastes as defined by CFR Part 261 or any applicable state law, have been fully and accurately described, classified and packaged and are in proper condition for transportation according to applicable regulations.				
Printed Name <i>As Agent of generator</i> <i>Nathan Duda</i>		Signature "On behalf of"	Month Day Year	
17. Transporter 1 Acknowledgement of Receipt of Materials				
Printed Name <i>Xavier Moreno</i>		Signature	Month Day Year	
18. Transporter 2 Acknowledgement of Receipt of Materials				
Printed Name		Signature	Month Day Year	
19. Certificate of Final Treatment/Disposal I certify, on behalf of the above listed treatment facility, that to the best of my knowledge, the above-described waste was managed in compliance with all applicable laws, regulations, permits and licenses on the dates listed above.				
20. Facility Owner or Operator: Certification of receipt of non-hazardous materials covered by this manifest.				
Printed Name <i>Wolsh</i>		Signature	Month Day Year	

White- TREATMENT, STORAGE, DISPOSAL FACILITY COPY

Blue- GENERATOR #2 COPY

Yellow- GENERATOR #1 COPY

Pink- FACILITY USE ONLY

Gold- TRANSPORTER #1 COPY



NON-HAZARDOUS MANIFEST

NON-HAZARDOUS MANIFEST		1. Generator's US EPA ID No.		Manifest Doc No.		2. Page 1 of						
3. Generator's Mailing Address: EnviroForensics, LLC N16 W23390 Stone Ridge Dr, Suite G Waukesha WI 53188			Generator's Site Address (if different than mailing): Klinke Clothing Care, Inc. 1295 N. Sherman Ave Madison, WI 53704			A. Manifest Number WMNA 8207034						
4. Generator's Phone (608) 620-7659			B. State Generator's ID									
5. Transporter 1 Company Name <i>Med 32</i>			6. US EPA ID Number		C. State Transporter's ID							
7. Transporter 2 Company Name			8. US EPA ID Number		D. Transporter's Phone							
9. Designated Facility Name and Site Address Madison Prairie Landfill 6002 Nelson Rd. Sun Prairie, WI 53590			10. US EPA ID Number		E. State Transporter's ID							
					F. Transporter's Phone							
					G. State Facility ID							
					H. State Facility Phone 608-837-9031							
GENERATOR	11. Description of Waste Materials				12. Containers		13. Total	14. Unit	1. Misc. Comments			
	a. PCE Impacted Soil				No. Type		Quantity	Wt./Vol.				
	WM Profile # V131499WI						20.26	TR	J			
	b.											
	WM Profile #											
	c.											
WM Profile #												
d.												
WM Profile #												
J. Additional Descriptions for Materials Listed Above				K. Disposal Location								
BILL TO:				Cell		Level						
				Grid								
15. Special Handling Instructions and Additional Information												
Purchase Order # 2019-0491			EMERGENCY CONTACT / PHONE NO.:			(608) 620-7659						
16. GENERATOR'S CERTIFICATE: I hereby certify that the above-described materials are not hazardous wastes as defined by CFR Part 261 or any applicable state law, have been fully and accurately described, classified and packaged and are in proper condition for transportation according to applicable regulations.												
Printed Name <i>AS AGENT OF GENERATOR</i> <i>Nathan Duda</i>				Signature "On behalf of"			Month	Day	Year			
							7	23	19			
TRANSPORTER	17. Transporter 1 Acknowledgement of Receipt of Materials				Printed Name			Signature		Month	Day	Year
					<i>Deven Humphrey</i>			<i>A [Signature]</i>		7	23	19
18. Transporter 2 Acknowledgement of Receipt of Materials				Printed Name			Signature		Month	Day	Year	
19. Certificate of Final Treatment/Disposal I certify, on behalf of the above listed treatment facility, that to the best of my knowledge, the above-described waste was managed in compliance with all applicable laws, regulations, permits and licenses on the dates listed above.												
20. Facility Owner or Operator: Certification of receipt of non-hazardous materials covered by this manifest.												
Printed Name <i>Holish</i>				Signature <i>[Signature]</i>			Month	Day	Year			
							7	23	19			

White- TREATMENT, STORAGE, DISPOSAL FACILITY COPY

Blue- GENERATOR #2 COPY

Yellow- GENERATOR #1 COPY

Pink- FACILITY USE ONLY

Gold- TRANSPORTER #1 COPY

27
27

0
TN



NON-HAZARDOUS MANIFEST

NON-HAZARDOUS MANIFEST	1. Generator's US EPA ID No.	Manifest Doc No.	2. Page 1 of	
3. Generator's Mailing Address: EnviroForensics, LLC N16 W23390 Stone Ridge Dr, Suite G Waukesha WI 53188	Generator's Site Address (if different than mailing): Klinke Clothing Care, Inc. 1295 N. Sherman Ave Madison, WI 53704		A. Manifest Number WMNA	8207035
			B. State Generator's ID	
4. Generator's Phone (608) 620-7659	5. Transporter 1 Company Name <i>Fred SA</i>	6. US EPA ID Number	C. State Transporter's ID	
7. Transporter 2 Company Name	8. US EPA ID Number	D. Transporter's Phone		
9. Designated Facility Name and Site Address Madison Prairie Landfill 6002 Nelson Rd. Sun Prairie, WI 53590	10. US EPA ID Number	E. State Transporter's ID		
		F. Transporter's Phone		
11. Description of Waste Materials	12. Containers No. Type	13. Total Quantity	14. Unit Wt./Vol.	15. Misc. Comments
b. WM Profile #				
c. WM Profile #				
d. WM Profile #				
J. Additional Descriptions for Materials Listed Above		K. Disposal Location		
BILL TO:		Cell	Level	
15. Special Handling Instructions and Additional Information		Grid		
Purchase Order # 2019-0491		EMERGENCY CONTACT / PHONE NO.: (608) 620-7659		
16. GENERATOR'S CERTIFICATE: I hereby certify that the above-described materials are not hazardous wastes as defined by CFR Part 261 or any applicable state law, have been fully and accurately described, classified and packaged and are in proper condition for transportation according to applicable regulations.				
Printed Name <i>As Agent of generator</i> <i>Nathan Duda</i>		Signature "On behalf of" <i>Nathan Duda</i>		Month <i>7</i>
				Day <i>23</i>
				Year <i>19</i>
T R A N S P O R T E R	17. Transporter 1 Acknowledgement of Receipt of Materials			
	Printed Name <i>Xavier Moreno</i>	Signature <i>Xavier Moreno</i>	Month <i>7</i>	Day <i>23</i>
P O R T E R	18. Transporter 2 Acknowledgement of Receipt of Materials			
	Printed Name	Signature	Month	Day
F A C I L I T Y	19. Certificate of Final Treatment/Disposal I certify, on behalf of the above listed treatment facility, that to the best of my knowledge, the above-described waste was managed in compliance with all applicable laws, regulations, permits and licenses on the dates listed above.			
	20. Facility Owner or Operator: Certification of receipt of non-hazardous materials covered by this manifest.			
Printed Name <i>NS Wilson</i>	Signature <i>NS Wilson</i>		Month <i>7</i>	Day <i>23</i>
			Year <i>19</i>	

White- TREATMENT, STORAGE, DISPOSAL FACILITY COPY Blue- GENERATOR #2 COPY Yellow- GENERATOR #1 COPY
 Pink- FACILITY USE ONLY Gold- TRANSPORTER #1 COPY



NON-HAZARDOUS MANIFEST

NON-HAZARDOUS MANIFEST		1. Generator's US EPA ID No. _____ Manifest Doc No. _____		2. Page 1 of _____				
3. Generator's Mailing Address: EnviroForensics, LLC N16 W23390 Stone Ridge Dr, Suite G Waukesha WI 53188			Generator's Site Address (if different than mailing): Klinke Clothing Care, Inc. 1295 N. Sherman Ave Madison, WI 53704		A. Manifest Number WMNA 8207036			
4. Generator's Phone (608) 620-7659			B. State Generator's ID					
5. Transporter 1 Company Name <i>Fred 32</i>		6. US EPA ID Number		C. State Transporter's ID				
7. Transporter 2 Company Name		8. US EPA ID Number		D. Transporter's Phone				
9. Designated Facility Name and Site Address Madison Prairie Landfill 6002 Nelson Rd. Sun Prairie, WI 53590		10. US EPA ID Number		E. State Transporter's ID				
				F. Transporter's Phone				
				G. State Facility ID				
				H. State Facility Phone 608-837-9031				
GENERATOR	11. Description of Waste Materials		12. Containers		13. Total Quantity			
	a. PCE Impacted Soil		No.	Type		14. Unit Wt./Vol.		
	WM Profile # V131499WI						I. Misc. Comments	
	b.							<i>23.01</i> <i>HA</i>
	WM Profile #							
c.								
WM Profile #								
d.								
WM Profile #								
J. Additional Descriptions for Materials Listed Above			K. Disposal Location					
BILL TO:			Cell	Level				
			Grid					
15. Special Handling Instructions and Additional Information								
Purchase Order # 2019-0491		EMERGENCY CONTACT / PHONE NO.: (608) 620-7659						
16. GENERATOR'S CERTIFICATE: I hereby certify that the above-described materials are not hazardous wastes as defined by CFR Part 261 or any applicable state law, have been fully and accurately described, classified and packaged and are in proper condition for transportation according to applicable regulations.								
Printed Name <i>Nathan Duda</i>			Signature "On behalf of" <i>[Signature]</i>		Month Day Year <i>7 23 19</i>			
TRANSPORTER	17. Transporter 1 Acknowledgement of Receipt of Materials							
	Printed Name <i>Derek Humphrey</i>		Signature <i>[Signature]</i>		Month Day Year			
	18. Transporter 2 Acknowledgement of Receipt of Materials							
Printed Name		Signature		Month Day Year				
FACILITY	19. Certificate of Final Treatment/Disposal I certify, on behalf of the above listed treatment facility, that to the best of my knowledge, the above-described waste was managed in compliance with all applicable laws, regulations, permits and licenses on the dates listed above.							
	20. Facility Owner or Operator: Certification of receipt of non-hazardous materials covered by this manifest.							
	Printed Name <i>Nisa Olson</i>			Signature <i>[Signature]</i>		Month Day Year <i>7 23 19</i>		

White- TREATMENT, STORAGE, DISPOSAL FACILITY COPY

Blue- GENERATOR #2 COPY

Yellow- GENERATOR #1 COPY

Pink- FACILITY USE ONLY

Gold- TRANSPORTER #1 COPY



NON-HAZARDOUS MANIFEST

NON-HAZARDOUS MANIFEST		1. Generator's US EPA ID No.		Manifest Doc No.		2. Page 1 of				
3. Generator's Mailing Address: EnviroForensics, LLC N16 W23390 Stone Ridge Dr, Suite G Waukesha WI 53188			Generator's Site Address (if different than mailing): Klinke Clothing Care, Inc. 1295 N. Sherman Ave Madison, WI 53704			A. Manifest Number WMNA 8207037				
4. Generator's Phone (608) 620-7659			B. State Generator's ID							
5. Transporter 1 Company Name <i>Fred 54</i>			6. US EPA ID Number			C. State Transporter's ID				
7. Transporter 2 Company Name			8. US EPA ID Number			D. Transporter's Phone				
9. Designated Facility Name and Site Address Madison Prairie Landfill 6002 Nelson Rd. Sun Prairie, WI 53590			10. US EPA ID Number			E. State Transporter's ID				
						F. Transporter's Phone				
						G. State Facility ID				
						H. State Facility Phone 608-837-9031				
GENERATOR	11. Description of Waste Materials				12. Containers		13. Total Quantity	14. Unit Wt./Vol.	I. Misc. Comments	
	a. PCE Impacted Soil				No.	Type	20.89	tn		
	WM Profile # V131499WI									
	b.									
	WM Profile #									
	c.									
WM Profile #										
d.										
WM Profile #										
J. Additional Descriptions for Materials Listed Above				K. Disposal Location						
BILL TO:				Cell		Level				
				Grid						
15. Special Handling Instructions and Additional Information										
Purchase Order # 2019-0491				EMERGENCY CONTACT / PHONE NO.: (608) 620-7659						
16. GENERATOR'S CERTIFICATE: I hereby certify that the above-described materials are not hazardous wastes as defined by CFR Part 261 or any applicable state law, have been fully and accurately described, classified and packaged and are in proper condition for transportation according to applicable regulations.										
Printed Name <i>As Agent of Generator</i> <i>Nathan Onda</i>				Signature "On behalf of" <i>[Signature]</i>				Month	Day	Year
								7	23	19
TRANSPORTER	17. Transporter 1 Acknowledgement of Receipt of Materials									
	Printed Name <i>Xavier Moreno</i>				Signature <i>[Signature]</i>				Month	Day
								7	23	19
OPERATOR	18. Transporter 2 Acknowledgement of Receipt of Materials									
	Printed Name				Signature				Month	Day
FACILITY	19. Certificate of Final Treatment/Disposal I certify, on behalf of the above listed treatment facility, that to the best of my knowledge, the above-described waste was managed in compliance with all applicable laws, regulations, permits and licenses on the dates listed above.									
	20. Facility Owner or Operator: Certification of receipt of non-hazardous materials covered by this manifest.									
Printed Name <i>[Signature]</i>				Signature <i>[Signature]</i>				Month	Day	Year
								7	23	19

White- TREATMENT, STORAGE, DISPOSAL FACILITY COPY

Blue- GENERATOR #2 COPY

Yellow- GENERATOR #1 COPY

Pink- FACILITY USE ONLY

Gold- TRANSPORTER #1 COPY



Madison Prairie Landfill
 6002 NELSON ROAD
 SUN PRAIRIE, WI, 53590
 Ph: 608-837-9031

17122487
 Original
 Ticket# 372584

Customer Name ENVIROFORENICS ENVIRO FORENSI Carrier fredenberg
 Ticket Date 07/22/2019 Vehicle# 54 Volume
 Payment Type Credit Account Container
 Manual Ticket# Driver
 Hauling Ticket# Check#
 Route Billing # 0001710
 State Waste Code A-24-06 Gen EPA ID
 Manifest 8207024
 Destination Grid
 PO 2019 0491
 Profile V131499WI (PCE IMPACTED SOIL WM012A)
 Generator 136-KLINKECLOTHING KLINKE CLOTHING CARE LLC

	Time	Scale	Operator	Inbound	Gross	79480 lb
In	07/22/2019 09:37:33	scale	lolson		Tare	30760 lb
Out	07/22/2019 09:50:51	scale	lolson		Net	48720 lb
					Tons	24.36

Comments

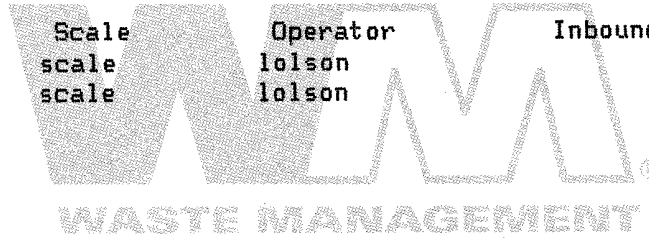

Product	LD%	Qty	UOM	Rate	Tax	Amount	Origin
1 Spwaste VOC-Tons-S	100	24.36	Tons				
2 ENVT-ENVIRONMENTAL	100	24.36	Tons				
3 FUELT-FUEL SURCHAR	100	24.36	Tons				

Total Tax
 Total Ticket

Driver's Signature
403W/M-N





Madison Prairie Landfill
 6002 NELSON ROAD
 SUN PRAIRIE, WI, 53590
 Ph: 608-837-9031

17122492
 Original
 Ticket# 372591

Customer Name	ENVIROFORENICS ENVIRO FORENSI	Carrier	fredenberg	Volume
Ticket Date	07/22/2019	Vehicle#	32	
Payment Type	Credit Account	Container		
Manual Ticket#		Driver		
Hauling Ticket#		Check#		
Route		Billing #	0001710	
State Waste Code	A-24-06	Gen EPA ID		
Manifest	8207022			
Destination		Grid		
PO	2019 0491			
Profile	V131499WI (PCE IMPACTED SOIL WM012A)			
Generator	136-KLINKECLOTHING KLINKE CLOTHING CARE LLC			

	Time	Scale	Operator	Inbound	Gross	73020 lb
In	07/22/2019 10:30:01	scale	lolson		Tare	29040 lb
Out	07/22/2019 10:36:12	scale	lolson		Net	43980 lb
					Tons	21.99

Comments

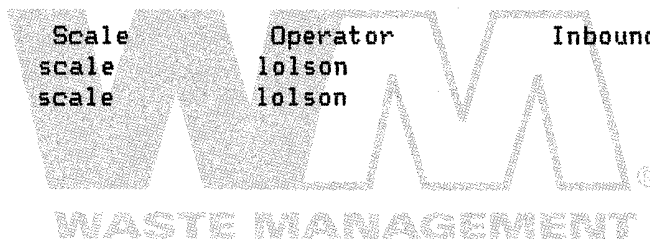

Product	LD%	Qty	UOM	Rate	Tax	Amount	Origin
1 Spwaste VOC-Tons-S	100	21.99	Tons				
2 ENVT-ENVIRONMENTAL	100	21.99	Tons				
3 FUELT-FUEL SURCHAR	100	21.99	Tons				

Total Tax
 Total Ticket

Driver's Signature
 403WM-N





Madison Prairie Landfill
 6002 NELSON ROAD
 SUN PRAIRIE, WI, 53590
 Ph: 608-837-9031

17122497
 Original
 Ticket# 372595

Customer Name	ENVIROFORENICS ENVIRO FORENSI	Carrier	fredenberg	Volume
Ticket Date	07/22/2019	Vehicle#	54	
Payment Type	Credit Account	Container		
Manual Ticket#		Driver		
Hauling Ticket#		Check#		
Route		Billing #	0001710	
State Waste Code	A-24-06	Gen EPA ID		
Manifest	8207023			
Destination		Grid		
PO	2019 0491			
Profile	V131499WI (PCE IMPACTED SOIL WM012A)			
Generator	136-KLINKECLOTHING KLINKE CLOTHING CARE LLC			

	Time	Scale	Operator	Inbound	Gross	79940 lb
In	07/22/2019 11:11:05	scale	lolson		Tare	30760 lb
Out	07/22/2019 11:11:05		lolson		Net	49180 lb
					Tons	24.59

Comments



Product	LD%	Qty	UOM	Rate	Tax	Amount	Origin
1 Spwaste VOC-Tons-S	100	24.59	Tons				
2 ENVT-ENVIRONMENTAL	100	24.59	Tons				
3 FUELT-FUEL SURCHAR	100	24.59	Tons				

Total Tax
 Total Ticket

Driver's Signature
 403WM-N





Madison Prairie Landfill
 6002 NELSON ROAD
 SUN PRAIRIE, WI, 53590
 Ph: 608-837-9031

Original 17122506
 Ticket# 372601

Customer Name ENVIROFORENICS ENVIRO FORENSI Carrier fredenberg
 Ticket Date 07/22/2019 Vehicle# 54 Volume
 Payment Type Credit Account Container
 Manual Ticket# Driver
 Hauling Ticket# Check#
 Route Billing # 0001710
 State Waste Code A-24-06 Gen EPA ID
 Manifest 8207025
 Destination Grid
 PO 2019 0491
 Profile V131499WI (PCE IMPACTED SOIL WM012A)
 Generator 136-KLINKECLOTHING KLINKE CLOTHING CARE LLC

	Time	Scale	Operator	Inbound	Gross	80700 lb
In	07/22/2019 12:39:24	scale	lolson		Tare	30760 lb
Out	07/22/2019 12:39:24		lolson		Net	49940 lb
					Tons	24.97

Comments

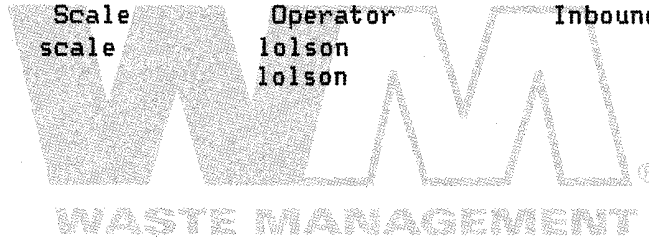

Product	LD%	Qty	UOM	Rate	Tax	Amount	Origin
1 Spwaste VOC-Tons-S	100	24.97	Tons				
2 ENVT-ENVIRONMENTAL	100	24.97	Tons				
3 FUELT-FUEL SURCHAR	100	24.97	Tons				

Total Tax
 Total Ticket

Driver's Signature

403WM-N





Madison Prairie Landfill
 6002 NELSON ROAD
 SUN PRAIRIE, WI, 53590
 Ph: 608-837-9031

Original 17122509
 Ticket# 372604

Customer Name	ENVIROFORENICS ENVIRO FORENSI	Carrier	fredenberg	Volume
Ticket Date	07/22/2019	Vehicle#	32	
Payment Type	Credit Account	Container		
Manual Ticket#		Driver		
Hauling Ticket#		Check#		
Route		Billing #	0001710	
State Waste Code	A-24-06	Gen EPA ID		
Manifest	0207026			
Destination		Grid		
PO	2019 0491			
Profile	V131499WI (PCE IMPACTED SOIL WM012A)			
Generator	136-KLINKECLOTHING KLINKE CLOTHING CARE LLC			

	Time	Scale	Operator	Inbound	Gross	78260 lb
In	07/22/2019 13:14:29	scale	lolson		Tare	29040 lb
Out	07/22/2019 13:14:29		lolson		Net	49220 lb
					Tons	24.61

Comments

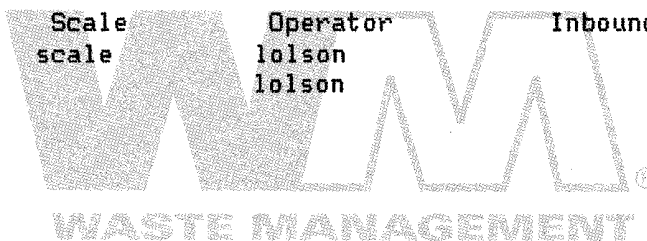

Product	LD%	Qty	UOM	Rate	Tax	Amount	Origin
1 Spwaste VOC-Tons-S	100	24.61	Tons				
2 ENVY-ENVIRONMENTAL	100	24.61	Tons				
3 FUELT-FUEL SURCHAR	100	24.61	Tons				

Total Tax
 Total Ticket

Driver's Signature

403WM-N





Madison Prairie Landfill
 6002 NELSON ROAD
 SUN PRAIRIE, WI, 53590
 Ph: 608-837-9031

Original 17122515
 Ticket# 372611

Customer Name ENVIROFORENICS ENVIRO FORENSI Carrier fredenberg
 Ticket Date 07/22/2019 Vehicle# 54 Volume
 Payment Type Credit Account Container
 Manual Ticket# Driver
 Hauling Ticket# Check#
 Route Billing # 0001710
 State Waste Code A-24-06 Gen EPA ID
 Manifest 8207027
 Destination Grid
 PO 2019 0491
 Profile V131499WI (PCE IMPACTED SOIL WM012A)
 Generator 136-KLINKECLOTHING KLINKE CLOTHING CARE LLC

	Time	Scale	Operator	Inbound	Gross	
In	07/22/2019 14:02:15	scale	lolson		81500	1b
Out	07/22/2019 14:02:15		lolson		30760	1b
					50740	1b
					Tons	25.37

Comments

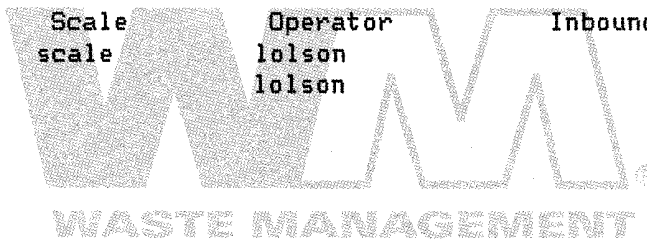

Product	LD%	Qty	UOM	Rate	Tax	Amount	Origin
1 Spwaste VOC-Tons-S	100	25.37	Tons				
2 ENVT-ENVIRONMENTAL	100	25.37	Tons				
3 FUELT-FUEL SURCHAR	100	25.37	Tons				

Total Tax
 Total Ticket

Driver's Signature
 403WM-N





Madison Prairie Landfill
 6002 NELSON ROAD
 SUN PRAIRIE, WI, 53590
 Ph: 608-837-9031

Original 17122519
 Ticket# 372613

Customer Name ENVIROFORENICS ENVIRO FORENSI Carrier fredenberg
 Ticket Date 07/22/2019 Vehicle# 32 Volume
 Payment Type Credit Account Container
 Manual Ticket# Driver
 Hauling Ticket# Check#
 Route Billing # 0001710
 State Waste Code A-24-06 Gen EPA ID
 Manifest 8207028
 Destination Grid
 PO 2019 0491
 Profile V131499WI (PCE IMPACTED SOIL WM012A)
 Generator 136-KLINKECLOTHING KLINKE CLOTHING CARE LLC

Time	Scale	Operator	Inbound	Gross	
In 07/22/2019 14:30:23	scale	lolson		78820	1b
Out 07/22/2019 14:30:23		lolson		29040	1b
				49780	1b
				Tons	24.89

Comments

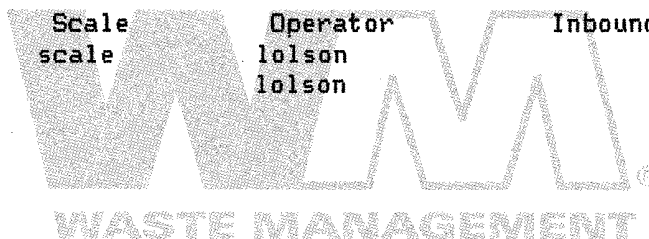

Product	LD%	Qty	UOM	Rate	Tax	Amount	Origin
1 Spwaste VOC-Tons-S	100	24.89	Tons				
2 ENVY-ENVIRONMENTAL	100	24.89	Tons				
3 FUELT-FUEL SURCHAR	100	24.89	Tons				

Total Tax
 Total Ticket

Driver's Signature

403WM-N





Madison Prairie Landfill
 6002 NELSON ROAD
 SUN PRAIRIE, WI, 53590
 Ph: 608-837-9031

Original 17122528
 Ticket# 372624

Customer Name	ENVIROFORENICS ENVIRO FORENSI	Carrier	fredenberg	Volume
Ticket Date	07/23/2019	Vehicle#	54	
Payment Type	Credit Account	Container		
Manual Ticket#		Driver		
Hauling Ticket#		Check#		
Route		Billing #	0001710	
State Waste Code	A-24-06	Gen EPA ID		
Manifest	8207029			
Destination		Grid		
PO	2019 0491			
Profile	V131499WI (PCE IMPACTED SOIL WM012A)			
Generator	136-KLINKECLOTHING KLINKE CLOTHING CARE LLC			

	Time	Scale	Operator	Inbound	Gross	75620 lb
In	07/23/2019 08:11:10	scale	lolson		Tare	30760 lb
Out	07/23/2019 08:11:10		lolson		Net	44860 lb
					Tons	22.43

Comments

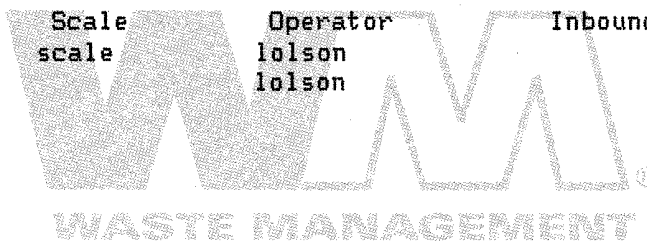

Product	LD%	Qty	UOM	Rate	Tax	Amount	Origin
1 Spwaste VOC-Tons-S	100	22.43	Tons				
2 ENVY-ENVIRONMENTAL	100	22.43	Tons				
3 FUELT-FUEL SURCHAR	100	22.43	Tons				

Total Tax
 Total Ticket

Driver's Signature
 403WM-N





Madison Prairie Landfill
 6002 NELSON ROAD
 SUN PRAIRIE, WI, 53590
 Ph: 608-837-9031

Original 17122531
 Ticket# 372628

Customer Name ENVIROFORENICS ENVIRO FORENSI Carrier fredenberg
 Ticket Date 07/23/2019 Vehicle# 32 Volume
 Payment Type Credit Account Container
 Manual Ticket# Driver
 Hauling Ticket# Check#
 Route Billing # 0001710
 State Waste Code A-24-06 Gen EPA ID
 Manifest 8207030
 Destination Grid
 PO 2019 0491
 Profile V131499WI (PCE IMPACTED SOIL WM012A)
 Generator 136-KLINKECLOTHING KLINKE CLOTHING CARE LLC

Time	Scale	Operator	Inbound	Gross	
In 07/23/2019 08:26:52	scale	lolson		71780 lb	
Out 07/23/2019 08:26:52		lolson		29040 lb	
				Net	42740 lb
				Tons	21.37

Comments

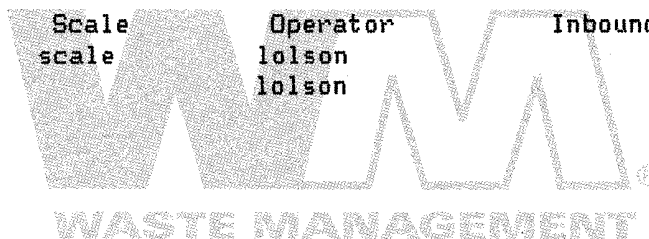

Product	LD%	Qty	UOM	Rate	Tax	Amount	Origin
1 Spwaste VOC-Tons-S	100	21.37	Tons				
2 ENVT-ENVIRONMENTAL	100	21.37	Tons				
3 FUELT-FUEL SURCHAR	100	21.37	Tons				

Total Tax
 Total Ticket

Driver's Signature
 403WM-N





Madison Prairie Landfill
 6002 NELSON ROAD
 SUN PRAIRIE, WI, 53590
 Ph: 608-837-9031

Original 17122538
 Ticket# 372634

Customer Name ENVIROFORENICS ENVIRO FORENSI Carrier fredenberg
 Ticket Date 07/23/2019 Vehicle# 54 Volume
 Payment Type Credit Account Container
 Manual Ticket# Driver
 Hauling Ticket# Check#
 Route Billing # 0001710
 State Waste Code A-24-06 Gen EPA ID
 Manifest 8207031
 Destination Grid
 PO 2019 0491
 Profile V131499WI (PCE IMPACTED SOIL WM012A)
 Generator 136-KLINKECLOTHING KLINKE CLOTHING CARE LLC

	Time	Scale	Operator	Inbound	Gross	78940 lb
In	07/23/2019 09:40:26	scale	lolson		Tare	30760 lb
Out	07/23/2019 09:40:26		lolson		Net	48180 lb
					Tons	24.09

Comments



Product	LD%	Qty	UOM	Rate	Tax	Amount	Origin
1 Spwaste VOC-Tons-S	100	24.09	Tons				
2 ENVT-ENVIRONMENTAL	100	24.09	Tons				
3 FUELT-FUEL SURCHAR	100	24.09	Tons				

Total Tax
 Total Ticket

Driver's Signature

403WM-N





Madison Prairie Landfill
 6002 NELSON ROAD
 SUN PRAIRIE, WI, 53590
 Ph: 608-837-9031

Original 17122541
 Ticket# 372637

Customer Name ENVIROFORENICS ENVIRD FORENSI Carrier fredenberg
 Ticket Date 07/23/2019 Vehicle# 32 Volume
 Payment Type Credit Account Container
 Manual Ticket# Driver
 Hauling Ticket# Check#
 Route Billing # 0001710
 State Waste Code A-24-06 Gen EPA ID
 Manifest 8207032
 Destination Grid
 PO 2019 0491
 Profile V131499WI (PCE IMPACTED SOIL WM012A)
 Generator 136-KLINKECLOTHING KLINKE CLOTHING CARE LLC

Time	Scale	Operator	Inbound	Gross	
In 07/23/2019 10:00:55	scale	lolson		78140	1b
Out 07/23/2019 10:00:55		lolson		29040	1b
				49100	1b
				Tons	24.55

Comments

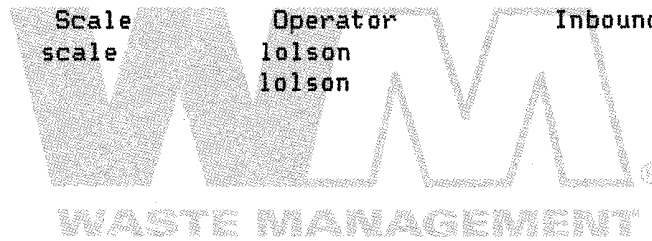

Product	LD%	Qty	UOM	Rate	Tax	Amount	Origin
1 Spwaste VOC-Tons-S	100	24.55	Tons				
2 ENVT-ENVIRONMENTAL	100	24.55	Tons				
3 FUELT-FUEL SURCHAR	100	24.55	Tons				

Total Tax
 Total Ticket

Driver's Signature

403WM-N





Madison Prairie Landfill
 6002 NELSON ROAD
 SUN PRAIRIE, WI, 53590
 Ph: 608-837-9031

Original 17122549
 Ticket# 372646

Customer Name ENVIROFORENICS ENVIRO FORENSI Carrier fredenberg
 Ticket Date 07/23/2019 Vehicle# 54 Volume
 Payment Type Credit Account Container
 Manual Ticket# Driver
 Hauling Ticket# Check#
 Route Billing # 0001710
 State Waste Code A-24-06 Gen EPA ID
 Manifest 8207023
 Destination Grid
 PO 2019 0491
 Profile V131499WI (PCE IMPACTED SOIL WM012A)
 Generator 136-KLINKECLOTHING KLINKE CLOTHING CARE LLC

Time	Scale	Operator	Inbound	Gross
In 07/23/2019 11:08:08	scale	lolson		79640 lb
Out 07/23/2019 11:08:08		lolson		30760 lb
				Net 48880 lb
				Tons 24.44

Comments

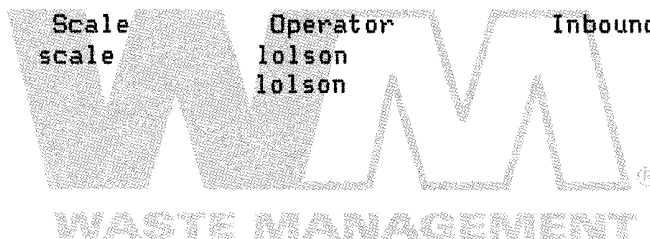

Product	LD%	Qty	UOM	Rate	Tax	Amount	Origin
1 Spwaste VOC-Tons-S	100	24.44	Tons				
2 ENVY-ENVIRONMENTAL	100	24.44	Tons				
3 FUELT-FUEL SURCHAR	100	24.44	Tons				

Total Tax
 Total Ticket

Driver's Signature

403WM-N





Madison Prairie Landfill
 6002 NELSON ROAD
 SUN PRAIRIE, WI, 53590
 Ph: 608-837-9031

Original 17122555
 Ticket# 372649

Customer Name ENVIROFORENICS ENVIRO FORENSI Carrier fredenberg
 Ticket Date 07/23/2019 Vehicle# 32 Volume
 Payment Type Credit Account Container
 Manual Ticket# Driver
 Hauling Ticket# Check#
 Route Billing # 0001710
 State Waste Code A-24-06 Gen EPA ID
 Manifest 8207034
 Destination Grid
 PO 2019 0491
 Profile V131499WI (PCE IMPACTED SOIL WM012A)
 Generator 136-KLINKECLOTHING KLINKE CLOTHING CARE LLC

Time	Scale	Operator	Inbound	Gross
In 07/23/2019 11:40:09	scale	lolson		69560 lb
Out 07/23/2019 11:40:09		lolson		29040 lb
				Net 40520 lb
				Tons 20.26

Comments

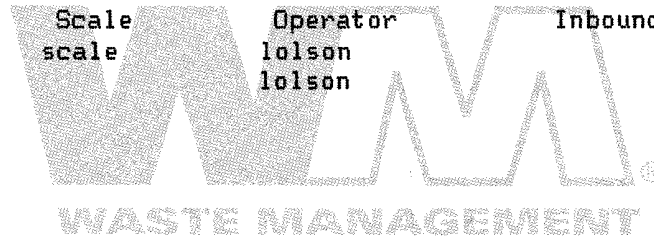

Product	LD%	Qty	UOM	Rate	Tax	Amount	Origin
1 Spwaste VOC-Tons-S	100	20.26	Tons				
2 ENVT-ENVIRONMENTAL	100	20.26	Tons				
3 FUELT-FUEL SURCHAR	100	20.26	Tons				

Total Tax
 Total Ticket

Driver's Signature

403WM-N





Madison Prairie Landfill
 6002 NELSON ROAD
 SUN PRAIRIE, WI, 53590
 Ph: 608-837-9031

Original 17122558
 Ticket# 372655

Customer Name ENVIROFORENICS ENVIRO FORENSI Carrier fredenberg
 Ticket Date 07/23/2019 Vehicle# 54 Volume
 Payment Type Credit Account Container
 Manual Ticket# Driver
 Hauling Ticket# Check#
 Route Billing # 0001710
 State Waste Code A-24-06 Gen EPA ID
 Manifest 8207035
 Destination Grid
 PD 2019 0491
 Profile V131499WI (PCE IMPACTED SOIL WM012A)
 Generator 136-KLINKECLOTHING KLINKE CLOTHING CARE LLC

Time	Scale	Operator	Inbound	Gross	80820 lb
In 07/23/2019 12:42:30	scale	lolson		Tare	30760 lb
Out 07/23/2019 12:42:30		lolson		Net	50060 lb
				Tons	25.03

Comments

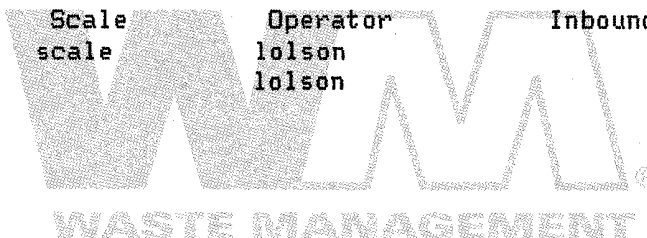

Product	LD%	Qty	UOM	Rate	Tax	Amount	Origin
1 Spwaste VOC-Tons-S	100	25.03	Tons				
2 ENVY-ENVIRONMENTAL	100	25.03	Tons				
3 FUELT-FUEL SURCHAR	100	25.03	Tons				

Total Tax
 Total Ticket

Driver's Signature

403WM-N





Madison Prairie Landfill
 6002 NELSON ROAD
 SUN PRAIRIE, WI, 53590
 Ph: 608-837-9031

Original 17122562
 Ticket# 372657

Customer Name	ENVIROFORENICS ENVIRO FORENSI	Carrier	fredenberg	Volume
Ticket Date	07/23/2019	Vehicle#	32	
Payment Type	Credit Account	Container		
Manual Ticket#		Driver		
Hauling Ticket#		Check#		
Route		Billing #	0001710	
State Waste Code	A-24-06	Gen EPA ID		
Manifest	8207036			
Destination		Grid		
PO	2019 0491			
Profile	V131499WI (PCE IMPACTED SOIL WM012A)			
Generator	136-KLINKECLOTHING KLINKE CLOTHING CARE LLC			

	Time	Scale	Operator	Inbound	Gross	75060 lb
In	07/23/2019 13:11:39	scale	lolson		Tare	29040 lb
Out	07/23/2019 13:11:39		lolson		Net	46020 lb
					Tons	23.01

Comments

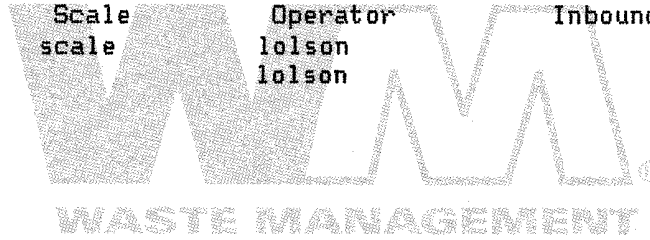

Product	LD%	Qty	UOM	Rate	Tax	Amount	Origin
1 Spwaste VOC-Tons-S	100	23.01	Tons				
2 ENVT-ENVIRONMENTAL	100	23.01	Tons				
3 FUELT-FUEL SURCHAR	100	23.01	Tons				

Total Tax
 Total Ticket

Driver's Signature

403WM-N





Madison Prairie Landfill
 6002 NELSON ROAD
 SUN PRAIRIE, WI, 53590
 Ph: 608-837-9031

Original 17122568
 Ticket# 372663

Customer Name ENVIROFORENICS ENVIRO FORENSI Carrier fredenberg
 Ticket Date 07/23/2019 Vehicle# 54 Volume
 Payment Type Credit Account Container
 Manual Ticket# Driver
 Hauling Ticket# Check#
 Route Billing # 0001710
 State Waste Code A-24-06 Gen EPA ID
 Manifest 8207037
 Destination Grid
 PO 2019 0491
 Profile V131499WI (PCE IMPACTED SOIL WM012A)
 Generator 136-KLINKECLOTHING KLINKE CLOTHING CARE LLC

Time	Scale	Operator	Inbound	Gross
In 07/23/2019 14:17:53	scale	lolson		72540 lb
Out 07/23/2019 14:17:53		lolson		30760 lb
				41780 lb
				Tons 20.89

Comments

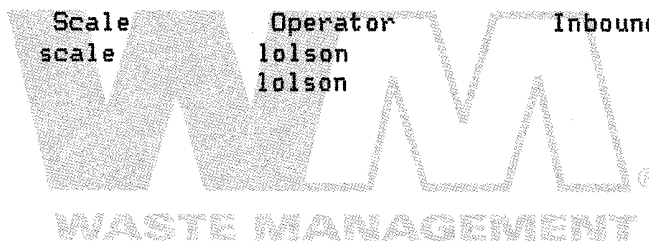

Product	LD%	Qty	UOM	Rate	Tax	Amount	Origin
1 Spwaste VOC-Tons-S	100	20.89	Tons				
2 ENVT-ENVIRONMENTAL	100	20.89	Tons				
3 FUELT-FUEL SURCHAR	100	20.89	Tons				

Total Tax
 Total Ticket

Driver's Signature
 403WM-N



APPENDIX B

Photographs



Excavation overview, facing southeast. The concrete slabs in the foreground were removed from the west side of the excavation.



Excavation in progress, facing west.



East side of excavation showing the sanitary lateral stub to which new PVC pipe was connected.



Excavator removing piping associated with former gas station infrastructure.



Orientation of existing water service, facing west.



Backfilling in progress, facing south.



Replacement sewer lateral beneath sidewalk and terrace.



Compaction of gravel backfill.



Backfilling completed, facing south.



Overview of completed asphalt replacement, facing east.

APPENDIX C

Soil Laboratory Analytical Report

Synergy Environmental Lab, INC

1990 Prospect Ct., Appleton, WI 54914 *P 920-830-2455 * F 920-733-0631

R. HOVERMAN / B. KAPPEN
ENVIROFORENSICS
N16 W 23390 STONERIDGE DR
WAUKESHA WI 53188

Report Date 31-Jul-19

Project Name KLINKE CLEANERS
Project # 6274

Invoice # E36534

Lab Code 5036534A
Sample ID 6274-FS-1 (6')
Sample Matrix Soil
Sample Date 7/22/2019

	Result	Unit	LOD	LOQ	Dil	Method	Ext Date	Run Date	Analyst	Code
General										
General										
Solids Percent	88.7	%			1	5021		7/26/2019	NJC	1
Organic										
VOC's										
Benzene	< 0.03	mg/kg	0.03	0.096	1	8260B		7/30/2019	CJR	1
Bromobenzene	< 0.025	mg/kg	0.025	0.081	1	8260B		7/30/2019	CJR	1
Bromodichloromethane	< 0.074	mg/kg	0.074	0.24	1	8260B		7/30/2019	CJR	1
Bromoform	< 0.029	mg/kg	0.029	0.092	1	8260B		7/30/2019	CJR	1
tert-Butylbenzene	< 0.026	mg/kg	0.026	0.084	1	8260B		7/30/2019	CJR	1
sec-Butylbenzene	< 0.033	mg/kg	0.033	0.1	1	8260B		7/30/2019	CJR	1
n-Butylbenzene	< 0.04	mg/kg	0.04	0.13	1	8260B		7/30/2019	CJR	1
Carbon Tetrachloride	< 0.016	mg/kg	0.016	0.053	1	8260B		7/30/2019	CJR	1
Chlorobenzene	< 0.013	mg/kg	0.013	0.04	1	8260B		7/30/2019	CJR	1
Chloroethane	< 0.091	mg/kg	0.091	0.29	1	8260B		7/30/2019	CJR	1
Chloroform	< 0.035	mg/kg	0.035	0.11	1	8260B		7/30/2019	CJR	1
Chloromethane	< 0.076	mg/kg	0.076	0.24	1	8260B		7/30/2019	CJR	1
2-Chlorotoluene	< 0.015	mg/kg	0.015	0.047	1	8260B		7/30/2019	CJR	1
4-Chlorotoluene	< 0.018	mg/kg	0.018	0.057	1	8260B		7/30/2019	CJR	1
1,2-Dibromo-3-chloropropane	< 0.058	mg/kg	0.058	0.18	1	8260B		7/30/2019	CJR	1
Dibromochloromethane	< 0.025	mg/kg	0.025	0.079	1	8260B		7/30/2019	CJR	1
1,4-Dichlorobenzene	< 0.037	mg/kg	0.037	0.12	1	8260B		7/30/2019	CJR	1
1,3-Dichlorobenzene	< 0.037	mg/kg	0.037	0.12	1	8260B		7/30/2019	CJR	1
1,2-Dichlorobenzene	< 0.028	mg/kg	0.028	0.088	1	8260B		7/30/2019	CJR	1
Dichlorodifluoromethane	< 0.048	mg/kg	0.048	0.15	1	8260B		7/30/2019	CJR	1
1,2-Dichloroethane	< 0.038	mg/kg	0.038	0.12	1	8260B		7/30/2019	CJR	1
1,1-Dichloroethane	< 0.034	mg/kg	0.034	0.11	1	8260B		7/30/2019	CJR	1

Project Name KLINKE CLEANERS
Project # 6274

Invoice # E36534

Lab Code 5036534A
Sample ID 6274-FS-1 (6')
Sample Matrix Soil
Sample Date 7/22/2019

	Result	Unit	LOD	LOQ	Dil	Method	Ext Date	Run Date	Analyst	Code
1,1-Dichloroethene	< 0.022	mg/kg	0.022	0.069	1	8260B		7/30/2019	CJR	1
cis-1,2-Dichloroethene	< 0.032	mg/kg	0.032	0.1	1	8260B		7/30/2019	CJR	1
trans-1,2-Dichloroethene	< 0.028	mg/kg	0.028	0.09	1	8260B		7/30/2019	CJR	1
1,2-Dichloropropane	< 0.035	mg/kg	0.035	0.11	1	8260B		7/30/2019	CJR	1
1,3-Dichloropropane	< 0.025	mg/kg	0.025	0.079	1	8260B		7/30/2019	CJR	1
trans-1,3-Dichloropropene	< 0.022	mg/kg	0.022	0.068	1	8260B		7/30/2019	CJR	1
cis-1,3-Dichloropropene	< 0.039	mg/kg	0.039	0.12	1	8260B		7/30/2019	CJR	1
Di-isopropyl ether	< 0.01	mg/kg	0.01	0.032	1	8260B		7/30/2019	CJR	1
EDB (1,2-Dibromoethane)	< 0.023	mg/kg	0.023	0.072	1	8260B		7/30/2019	CJR	1
Ethylbenzene	< 0.035	mg/kg	0.035	0.11	1	8260B		7/30/2019	CJR	1
Hexachlorobutadiene	< 0.085	mg/kg	0.085	0.27	1	8260B		7/30/2019	CJR	1
Isopropylbenzene	< 0.034	mg/kg	0.034	0.11	1	8260B		7/30/2019	CJR	1
p-Isopropyltoluene	< 0.029	mg/kg	0.029	0.093	1	8260B		7/30/2019	CJR	1
Methylene chloride	< 0.15	mg/kg	0.15	0.46	1	8260B		7/30/2019	CJR	1
Methyl tert-butyl ether (MTBE)	< 0.05	mg/kg	0.05	0.16	1	8260B		7/30/2019	CJR	1
Naphthalene	< 0.094	mg/kg	0.094	0.3	1	8260B		7/30/2019	CJR	1
n-Propylbenzene	< 0.033	mg/kg	0.033	0.1	1	8260B		7/30/2019	CJR	1
1,1,2,2-Tetrachloroethane	< 0.028	mg/kg	0.028	0.88	1	8260B		7/30/2019	CJR	1
1,1,1,2-Tetrachloroethane	< 0.028	mg/kg	0.028	0.09	1	8260B		7/30/2019	CJR	1
Tetrachloroethene	1.01	mg/kg	0.032	0.1	1	8260B		7/30/2019	CJR	1
Toluene	< 0.032	mg/kg	0.032	0.1	1	8260B		7/30/2019	CJR	1
1,2,4-Trichlorobenzene	< 0.064	mg/kg	0.064	0.2	1	8260B		7/30/2019	CJR	1
1,2,3-Trichlorobenzene	< 0.066	mg/kg	0.066	0.21	1	8260B		7/30/2019	CJR	1
1,1,1-Trichloroethane	< 0.03	mg/kg	0.03	0.96	1	8260B		7/30/2019	CJR	1
1,1,2-Trichloroethane	< 0.033	mg/kg	0.033	0.11	1	8260B		7/30/2019	CJR	1
Trichloroethene (TCE)	< 0.041	mg/kg	0.041	0.13	1	8260B		7/30/2019	CJR	1
Trichlorofluoromethane	< 0.041	mg/kg	0.041	0.13	1	8260B		7/30/2019	CJR	1
1,2,4-Trimethylbenzene	0.101	mg/kg	0.025	0.08	1	8260B		7/30/2019	CJR	1
1,3,5-Trimethylbenzene	0.07 "J"	mg/kg	0.032	0.1	1	8260B		7/30/2019	CJR	1
Vinyl Chloride	< 0.019	mg/kg	0.019	0.062	1	8260B		7/30/2019	CJR	1
m&p-Xylene	< 0.072	mg/kg	0.072	0.23	1	8260B		7/30/2019	CJR	1
o-Xylene	< 0.044	mg/kg	0.044	0.14	1	8260B		7/30/2019	CJR	1
SUR - Toluene-d8	99	Rec %			1	8260B		7/30/2019	CJR	1
SUR - 1,2-Dichloroethane-d4	104	Rec %			1	8260B		7/30/2019	CJR	1
SUR - 4-Bromofluorobenzene	106	Rec %			1	8260B		7/30/2019	CJR	1
SUR - Dibromofluoromethane	104	Rec %			1	8260B		7/30/2019	CJR	1

Project Name KLINKE CLEANERS
Project # 6274

Invoice # E36534

Lab Code 5036534B
Sample ID 6274-FS-2 (6')
Sample Matrix Soil
Sample Date 7/22/2019

	Result	Unit	LOD	LOQ	Dil	Method	Ext Date	Run Date	Analyst	Code
General										
General										
Solids Percent	84.7	%			1	5021		7/26/2019	NJC	1
Organic										
VOC's										
Benzene	< 0.03	mg/kg	0.03	0.096	1	8260B		7/30/2019	CJR	1
Bromobenzene	< 0.025	mg/kg	0.025	0.081	1	8260B		7/30/2019	CJR	1
Bromodichloromethane	< 0.074	mg/kg	0.074	0.24	1	8260B		7/30/2019	CJR	1
Bromoform	< 0.029	mg/kg	0.029	0.092	1	8260B		7/30/2019	CJR	1
tert-Butylbenzene	< 0.026	mg/kg	0.026	0.084	1	8260B		7/30/2019	CJR	1
sec-Butylbenzene	< 0.033	mg/kg	0.033	0.1	1	8260B		7/30/2019	CJR	1
n-Butylbenzene	< 0.04	mg/kg	0.04	0.13	1	8260B		7/30/2019	CJR	1
Carbon Tetrachloride	< 0.016	mg/kg	0.016	0.053	1	8260B		7/30/2019	CJR	1
Chlorobenzene	< 0.013	mg/kg	0.013	0.04	1	8260B		7/30/2019	CJR	1
Chloroethane	< 0.091	mg/kg	0.091	0.29	1	8260B		7/30/2019	CJR	1
Chloroform	< 0.035	mg/kg	0.035	0.11	1	8260B		7/30/2019	CJR	1
Chloromethane	< 0.076	mg/kg	0.076	0.24	1	8260B		7/30/2019	CJR	1
2-Chlorotoluene	< 0.015	mg/kg	0.015	0.047	1	8260B		7/30/2019	CJR	1
4-Chlorotoluene	< 0.018	mg/kg	0.018	0.057	1	8260B		7/30/2019	CJR	1
1,2-Dibromo-3-chloropropane	< 0.058	mg/kg	0.058	0.18	1	8260B		7/30/2019	CJR	1
Dibromochloromethane	< 0.025	mg/kg	0.025	0.079	1	8260B		7/30/2019	CJR	1
1,4-Dichlorobenzene	< 0.037	mg/kg	0.037	0.12	1	8260B		7/30/2019	CJR	1
1,3-Dichlorobenzene	< 0.037	mg/kg	0.037	0.12	1	8260B		7/30/2019	CJR	1
1,2-Dichlorobenzene	< 0.028	mg/kg	0.028	0.088	1	8260B		7/30/2019	CJR	1
Dichlorodifluoromethane	< 0.048	mg/kg	0.048	0.15	1	8260B		7/30/2019	CJR	1
1,2-Dichloroethane	< 0.038	mg/kg	0.038	0.12	1	8260B		7/30/2019	CJR	1
1,1-Dichloroethane	< 0.034	mg/kg	0.034	0.11	1	8260B		7/30/2019	CJR	1
1,1-Dichloroethene	< 0.022	mg/kg	0.022	0.069	1	8260B		7/30/2019	CJR	1
cis-1,2-Dichloroethene	< 0.032	mg/kg	0.032	0.1	1	8260B		7/30/2019	CJR	1
trans-1,2-Dichloroethene	< 0.028	mg/kg	0.028	0.09	1	8260B		7/30/2019	CJR	1
1,2-Dichloropropane	< 0.035	mg/kg	0.035	0.11	1	8260B		7/30/2019	CJR	1
1,3-Dichloropropane	< 0.025	mg/kg	0.025	0.079	1	8260B		7/30/2019	CJR	1
trans-1,3-Dichloropropene	< 0.022	mg/kg	0.022	0.068	1	8260B		7/30/2019	CJR	1
cis-1,3-Dichloropropene	< 0.039	mg/kg	0.039	0.12	1	8260B		7/30/2019	CJR	1
Di-isopropyl ether	< 0.01	mg/kg	0.01	0.032	1	8260B		7/30/2019	CJR	1
EDB (1,2-Dibromoethane)	< 0.023	mg/kg	0.023	0.072	1	8260B		7/30/2019	CJR	1
Ethylbenzene	< 0.035	mg/kg	0.035	0.11	1	8260B		7/30/2019	CJR	1
Hexachlorobutadiene	< 0.085	mg/kg	0.085	0.27	1	8260B		7/30/2019	CJR	1
Isopropylbenzene	< 0.034	mg/kg	0.034	0.11	1	8260B		7/30/2019	CJR	1
p-Isopropyltoluene	< 0.029	mg/kg	0.029	0.093	1	8260B		7/30/2019	CJR	1
Methylene chloride	< 0.15	mg/kg	0.15	0.46	1	8260B		7/30/2019	CJR	1
Methyl tert-butyl ether (MTBE)	< 0.05	mg/kg	0.05	0.16	1	8260B		7/30/2019	CJR	1
Naphthalene	< 0.094	mg/kg	0.094	0.3	1	8260B		7/30/2019	CJR	1
n-Propylbenzene	< 0.033	mg/kg	0.033	0.1	1	8260B		7/30/2019	CJR	1
1,1,2,2-Tetrachloroethane	< 0.028	mg/kg	0.028	0.88	1	8260B		7/30/2019	CJR	1
1,1,1,2-Tetrachloroethane	< 0.028	mg/kg	0.028	0.09	1	8260B		7/30/2019	CJR	1

Project Name KLINKE CLEANERS
Project # 6274

Invoice # E36534

Lab Code 5036534B
Sample ID 6274-FS-2 (6')
Sample Matrix Soil
Sample Date 7/22/2019

	Result	Unit	LOD	LOQ	Dil	Method	Ext Date	Run Date	Analyst	Code
Tetrachloroethene	1.14	mg/kg	0.032	0.1	1	8260B		7/30/2019	CJR	1
Toluene	< 0.032	mg/kg	0.032	0.1	1	8260B		7/30/2019	CJR	1
1,2,4-Trichlorobenzene	< 0.064	mg/kg	0.064	0.2	1	8260B		7/30/2019	CJR	1
1,2,3-Trichlorobenzene	< 0.066	mg/kg	0.066	0.21	1	8260B		7/30/2019	CJR	1
1,1,1-Trichloroethane	< 0.03	mg/kg	0.03	0.96	1	8260B		7/30/2019	CJR	1
1,1,2-Trichloroethane	< 0.033	mg/kg	0.033	0.11	1	8260B		7/30/2019	CJR	1
Trichloroethene (TCE)	< 0.041	mg/kg	0.041	0.13	1	8260B		7/30/2019	CJR	1
Trichlorofluoromethane	< 0.041	mg/kg	0.041	0.13	1	8260B		7/30/2019	CJR	1
1,2,4-Trimethylbenzene	< 0.025	mg/kg	0.025	0.08	1	8260B		7/30/2019	CJR	1
1,3,5-Trimethylbenzene	< 0.032	mg/kg	0.032	0.1	1	8260B		7/30/2019	CJR	1
Vinyl Chloride	< 0.019	mg/kg	0.019	0.062	1	8260B		7/30/2019	CJR	1
m&p-Xylene	< 0.072	mg/kg	0.072	0.23	1	8260B		7/30/2019	CJR	1
o-Xylene	< 0.044	mg/kg	0.044	0.14	1	8260B		7/30/2019	CJR	1
SUR - 1,2-Dichloroethane-d4	105	Rec %			1	8260B		7/30/2019	CJR	1
SUR - 4-Bromofluorobenzene	100	Rec %			1	8260B		7/30/2019	CJR	1
SUR - Dibromofluoromethane	99	Rec %			1	8260B		7/30/2019	CJR	1
SUR - Toluene-d8	101	Rec %			1	8260B		7/30/2019	CJR	1

Project Name KLINKE CLEANERS
Project # 6274

Invoice # E36534

Lab Code 5036534C
Sample ID 6274-FS-3 (6')
Sample Matrix Soil
Sample Date 7/23/2019

	Result	Unit	LOD	LOQ	Dil	Method	Ext Date	Run Date	Analyst	Code
General										
General										
Solids Percent	96.9	%			1	5021		7/26/2019	NJC	1
Organic										
VOC's										
Benzene	< 0.03	mg/kg	0.03	0.096	1	8260B		7/30/2019	CJR	1
Bromobenzene	< 0.025	mg/kg	0.025	0.081	1	8260B		7/30/2019	CJR	1
Bromodichloromethane	< 0.074	mg/kg	0.074	0.24	1	8260B		7/30/2019	CJR	1
Bromoform	< 0.029	mg/kg	0.029	0.092	1	8260B		7/30/2019	CJR	1
tert-Butylbenzene	< 0.026	mg/kg	0.026	0.084	1	8260B		7/30/2019	CJR	1
sec-Butylbenzene	< 0.033	mg/kg	0.033	0.1	1	8260B		7/30/2019	CJR	1
n-Butylbenzene	< 0.04	mg/kg	0.04	0.13	1	8260B		7/30/2019	CJR	1
Carbon Tetrachloride	< 0.016	mg/kg	0.016	0.053	1	8260B		7/30/2019	CJR	1
Chlorobenzene	< 0.013	mg/kg	0.013	0.04	1	8260B		7/30/2019	CJR	1
Chloroethane	< 0.091	mg/kg	0.091	0.29	1	8260B		7/30/2019	CJR	1
Chloroform	< 0.035	mg/kg	0.035	0.11	1	8260B		7/30/2019	CJR	1
Chloromethane	< 0.076	mg/kg	0.076	0.24	1	8260B		7/30/2019	CJR	1
2-Chlorotoluene	< 0.015	mg/kg	0.015	0.047	1	8260B		7/30/2019	CJR	1
4-Chlorotoluene	< 0.018	mg/kg	0.018	0.057	1	8260B		7/30/2019	CJR	1
1,2-Dibromo-3-chloropropane	< 0.058	mg/kg	0.058	0.18	1	8260B		7/30/2019	CJR	1
Dibromochloromethane	< 0.025	mg/kg	0.025	0.079	1	8260B		7/30/2019	CJR	1
1,4-Dichlorobenzene	< 0.037	mg/kg	0.037	0.12	1	8260B		7/30/2019	CJR	1
1,3-Dichlorobenzene	< 0.037	mg/kg	0.037	0.12	1	8260B		7/30/2019	CJR	1
1,2-Dichlorobenzene	< 0.028	mg/kg	0.028	0.088	1	8260B		7/30/2019	CJR	1
Dichlorodifluoromethane	< 0.048	mg/kg	0.048	0.15	1	8260B		7/30/2019	CJR	1
1,2-Dichloroethane	< 0.038	mg/kg	0.038	0.12	1	8260B		7/30/2019	CJR	1
1,1-Dichloroethane	< 0.034	mg/kg	0.034	0.11	1	8260B		7/30/2019	CJR	1
1,1-Dichloroethene	< 0.022	mg/kg	0.022	0.069	1	8260B		7/30/2019	CJR	1
cis-1,2-Dichloroethene	< 0.032	mg/kg	0.032	0.1	1	8260B		7/30/2019	CJR	1
trans-1,2-Dichloroethene	< 0.028	mg/kg	0.028	0.09	1	8260B		7/30/2019	CJR	1
1,2-Dichloropropane	< 0.035	mg/kg	0.035	0.11	1	8260B		7/30/2019	CJR	1
1,3-Dichloropropane	< 0.025	mg/kg	0.025	0.079	1	8260B		7/30/2019	CJR	1
trans-1,3-Dichloropropene	< 0.022	mg/kg	0.022	0.068	1	8260B		7/30/2019	CJR	1
cis-1,3-Dichloropropene	< 0.039	mg/kg	0.039	0.12	1	8260B		7/30/2019	CJR	1
Di-isopropyl ether	< 0.01	mg/kg	0.01	0.032	1	8260B		7/30/2019	CJR	1
EDB (1,2-Dibromoethane)	< 0.023	mg/kg	0.023	0.072	1	8260B		7/30/2019	CJR	1
Ethylbenzene	< 0.035	mg/kg	0.035	0.11	1	8260B		7/30/2019	CJR	1
Hexachlorobutadiene	< 0.085	mg/kg	0.085	0.27	1	8260B		7/30/2019	CJR	1
Isopropylbenzene	< 0.034	mg/kg	0.034	0.11	1	8260B		7/30/2019	CJR	1
p-Isopropyltoluene	< 0.029	mg/kg	0.029	0.093	1	8260B		7/30/2019	CJR	1
Methylene chloride	< 0.15	mg/kg	0.15	0.46	1	8260B		7/30/2019	CJR	1
Methyl tert-butyl ether (MTBE)	< 0.05	mg/kg	0.05	0.16	1	8260B		7/30/2019	CJR	1
Naphthalene	< 0.094	mg/kg	0.094	0.3	1	8260B		7/30/2019	CJR	1
n-Propylbenzene	< 0.033	mg/kg	0.033	0.1	1	8260B		7/30/2019	CJR	1
1,1,2,2-Tetrachloroethane	< 0.028	mg/kg	0.028	0.88	1	8260B		7/30/2019	CJR	1
1,1,1,2-Tetrachloroethane	< 0.028	mg/kg	0.028	0.09	1	8260B		7/30/2019	CJR	1

Project Name KLINKE CLEANERS
Project # 6274

Invoice # E36534

Lab Code 5036534C
Sample ID 6274-FS-3 (6')
Sample Matrix Soil
Sample Date 7/23/2019

	Result	Unit	LOD	LOQ	Dil	Method	Ext Date	Run Date	Analyst	Code
Tetrachloroethene	0.264	mg/kg	0.032	0.1	1	8260B		7/30/2019	CJR	1
Toluene	< 0.032	mg/kg	0.032	0.1	1	8260B		7/30/2019	CJR	1
1,2,4-Trichlorobenzene	< 0.064	mg/kg	0.064	0.2	1	8260B		7/30/2019	CJR	1
1,2,3-Trichlorobenzene	< 0.066	mg/kg	0.066	0.21	1	8260B		7/30/2019	CJR	1
1,1,1-Trichloroethane	< 0.03	mg/kg	0.03	0.96	1	8260B		7/30/2019	CJR	1
1,1,2-Trichloroethane	< 0.033	mg/kg	0.033	0.11	1	8260B		7/30/2019	CJR	1
Trichloroethene (TCE)	< 0.041	mg/kg	0.041	0.13	1	8260B		7/30/2019	CJR	1
Trichlorofluoromethane	< 0.041	mg/kg	0.041	0.13	1	8260B		7/30/2019	CJR	1
1,2,4-Trimethylbenzene	< 0.025	mg/kg	0.025	0.08	1	8260B		7/30/2019	CJR	1
1,3,5-Trimethylbenzene	< 0.032	mg/kg	0.032	0.1	1	8260B		7/30/2019	CJR	1
Vinyl Chloride	< 0.019	mg/kg	0.019	0.062	1	8260B		7/30/2019	CJR	1
m&p-Xylene	< 0.072	mg/kg	0.072	0.23	1	8260B		7/30/2019	CJR	1
o-Xylene	< 0.044	mg/kg	0.044	0.14	1	8260B		7/30/2019	CJR	1
SUR - 1,2-Dichloroethane-d4	99	Rec %			1	8260B		7/30/2019	CJR	1
SUR - 4-Bromofluorobenzene	103	Rec %			1	8260B		7/30/2019	CJR	1
SUR - Dibromofluoromethane	97	Rec %			1	8260B		7/30/2019	CJR	1
SUR - Toluene-d8	101	Rec %			1	8260B		7/30/2019	CJR	1

Project Name KLINKE CLEANERS
Project # 6274

Invoice # E36534

Lab Code 5036534D
Sample ID 6274-FS-4 (6')
Sample Matrix Soil
Sample Date 7/23/2019

	Result	Unit	LOD	LOQ	Dil	Method	Ext Date	Run Date	Analyst	Code
General										
General										
Solids Percent	85.9	%			1	5021		7/26/2019	NJC	1
Organic										
VOC's										
Benzene	< 0.03	mg/kg	0.03	0.096	1	8260B		7/30/2019	CJR	1
Bromobenzene	< 0.025	mg/kg	0.025	0.081	1	8260B		7/30/2019	CJR	1
Bromodichloromethane	< 0.074	mg/kg	0.074	0.24	1	8260B		7/30/2019	CJR	1
Bromoform	< 0.029	mg/kg	0.029	0.092	1	8260B		7/30/2019	CJR	1
tert-Butylbenzene	< 0.026	mg/kg	0.026	0.084	1	8260B		7/30/2019	CJR	1
sec-Butylbenzene	< 0.033	mg/kg	0.033	0.1	1	8260B		7/30/2019	CJR	1
n-Butylbenzene	< 0.04	mg/kg	0.04	0.13	1	8260B		7/30/2019	CJR	1
Carbon Tetrachloride	< 0.016	mg/kg	0.016	0.053	1	8260B		7/30/2019	CJR	1
Chlorobenzene	< 0.013	mg/kg	0.013	0.04	1	8260B		7/30/2019	CJR	1
Chloroethane	< 0.091	mg/kg	0.091	0.29	1	8260B		7/30/2019	CJR	1
Chloroform	< 0.035	mg/kg	0.035	0.11	1	8260B		7/30/2019	CJR	1
Chloromethane	< 0.076	mg/kg	0.076	0.24	1	8260B		7/30/2019	CJR	1
2-Chlorotoluene	< 0.015	mg/kg	0.015	0.047	1	8260B		7/30/2019	CJR	1
4-Chlorotoluene	< 0.018	mg/kg	0.018	0.057	1	8260B		7/30/2019	CJR	1
1,2-Dibromo-3-chloropropane	< 0.058	mg/kg	0.058	0.18	1	8260B		7/30/2019	CJR	1
Dibromochloromethane	< 0.025	mg/kg	0.025	0.079	1	8260B		7/30/2019	CJR	1
1,4-Dichlorobenzene	< 0.037	mg/kg	0.037	0.12	1	8260B		7/30/2019	CJR	1
1,3-Dichlorobenzene	< 0.037	mg/kg	0.037	0.12	1	8260B		7/30/2019	CJR	1
1,2-Dichlorobenzene	< 0.028	mg/kg	0.028	0.088	1	8260B		7/30/2019	CJR	1
Dichlorodifluoromethane	< 0.048	mg/kg	0.048	0.15	1	8260B		7/30/2019	CJR	1
1,2-Dichloroethane	< 0.038	mg/kg	0.038	0.12	1	8260B		7/30/2019	CJR	1
1,1-Dichloroethane	< 0.034	mg/kg	0.034	0.11	1	8260B		7/30/2019	CJR	1
1,1-Dichloroethene	< 0.022	mg/kg	0.022	0.069	1	8260B		7/30/2019	CJR	1
cis-1,2-Dichloroethene	< 0.032	mg/kg	0.032	0.1	1	8260B		7/30/2019	CJR	1
trans-1,2-Dichloroethene	< 0.028	mg/kg	0.028	0.09	1	8260B		7/30/2019	CJR	1
1,2-Dichloropropane	< 0.035	mg/kg	0.035	0.11	1	8260B		7/30/2019	CJR	1
1,3-Dichloropropane	< 0.025	mg/kg	0.025	0.079	1	8260B		7/30/2019	CJR	1
trans-1,3-Dichloropropene	< 0.022	mg/kg	0.022	0.068	1	8260B		7/30/2019	CJR	1
cis-1,3-Dichloropropene	< 0.039	mg/kg	0.039	0.12	1	8260B		7/30/2019	CJR	1
Di-isopropyl ether	< 0.01	mg/kg	0.01	0.032	1	8260B		7/30/2019	CJR	1
EDB (1,2-Dibromoethane)	< 0.023	mg/kg	0.023	0.072	1	8260B		7/30/2019	CJR	1
Ethylbenzene	< 0.035	mg/kg	0.035	0.11	1	8260B		7/30/2019	CJR	1
Hexachlorobutadiene	< 0.085	mg/kg	0.085	0.27	1	8260B		7/30/2019	CJR	1
Isopropylbenzene	< 0.034	mg/kg	0.034	0.11	1	8260B		7/30/2019	CJR	1
p-Isopropyltoluene	< 0.029	mg/kg	0.029	0.093	1	8260B		7/30/2019	CJR	1
Methylene chloride	< 0.15	mg/kg	0.15	0.46	1	8260B		7/30/2019	CJR	1
Methyl tert-butyl ether (MTBE)	< 0.05	mg/kg	0.05	0.16	1	8260B		7/30/2019	CJR	1
Naphthalene	< 0.094	mg/kg	0.094	0.3	1	8260B		7/30/2019	CJR	1
n-Propylbenzene	< 0.033	mg/kg	0.033	0.1	1	8260B		7/30/2019	CJR	1
1,1,2,2-Tetrachloroethane	< 0.028	mg/kg	0.028	0.88	1	8260B		7/30/2019	CJR	1
1,1,1,2-Tetrachloroethane	< 0.028	mg/kg	0.028	0.09	1	8260B		7/30/2019	CJR	1

Project Name KLINKE CLEANERS
Project # 6274

Invoice # E36534

Lab Code 5036534D
Sample ID 6274-FS-4 (6')
Sample Matrix Soil
Sample Date 7/23/2019

	Result	Unit	LOD	LOQ	Dil	Method	Ext Date	Run Date	Analyst	Code
Tetrachloroethene	0.88	mg/kg	0.032	0.1	1	8260B		7/30/2019	CJR	1
Toluene	< 0.032	mg/kg	0.032	0.1	1	8260B		7/30/2019	CJR	1
1,2,4-Trichlorobenzene	< 0.064	mg/kg	0.064	0.2	1	8260B		7/30/2019	CJR	1
1,2,3-Trichlorobenzene	< 0.066	mg/kg	0.066	0.21	1	8260B		7/30/2019	CJR	1
1,1,1-Trichloroethane	< 0.03	mg/kg	0.03	0.96	1	8260B		7/30/2019	CJR	1
1,1,2-Trichloroethane	< 0.033	mg/kg	0.033	0.11	1	8260B		7/30/2019	CJR	1
Trichloroethene (TCE)	< 0.041	mg/kg	0.041	0.13	1	8260B		7/30/2019	CJR	1
Trichlorofluoromethane	< 0.041	mg/kg	0.041	0.13	1	8260B		7/30/2019	CJR	1
1,2,4-Trimethylbenzene	< 0.025	mg/kg	0.025	0.08	1	8260B		7/30/2019	CJR	1
1,3,5-Trimethylbenzene	< 0.032	mg/kg	0.032	0.1	1	8260B		7/30/2019	CJR	1
Vinyl Chloride	< 0.019	mg/kg	0.019	0.062	1	8260B		7/30/2019	CJR	1
m&p-Xylene	< 0.072	mg/kg	0.072	0.23	1	8260B		7/30/2019	CJR	1
o-Xylene	< 0.044	mg/kg	0.044	0.14	1	8260B		7/30/2019	CJR	1
SUR - 1,2-Dichloroethane-d4	102	Rec %			1	8260B		7/30/2019	CJR	1
SUR - 4-Bromofluorobenzene	101	Rec %			1	8260B		7/30/2019	CJR	1
SUR - Dibromofluoromethane	96	Rec %			1	8260B		7/30/2019	CJR	1
SUR - Toluene-d8	103	Rec %			1	8260B		7/30/2019	CJR	1

Project Name KLINKE CLEANERS
Project # 6274

Invoice # E36534

Lab Code 5036534E
Sample ID 6274-FS-5 (6')
Sample Matrix Soil
Sample Date 7/23/2019

	Result	Unit	LOD	LOQ	Dil	Method	Ext Date	Run Date	Analyst	Code
General										
General										
Solids Percent	96.6	%			1	5021		7/26/2019	NJC	1
Organic										
VOC's										
Benzene	< 0.03	mg/kg	0.03	0.096	1	8260B		7/30/2019	CJR	1
Bromobenzene	< 0.025	mg/kg	0.025	0.081	1	8260B		7/30/2019	CJR	1
Bromodichloromethane	< 0.074	mg/kg	0.074	0.24	1	8260B		7/30/2019	CJR	1
Bromoform	< 0.029	mg/kg	0.029	0.092	1	8260B		7/30/2019	CJR	1
tert-Butylbenzene	< 0.026	mg/kg	0.026	0.084	1	8260B		7/30/2019	CJR	1
sec-Butylbenzene	< 0.033	mg/kg	0.033	0.1	1	8260B		7/30/2019	CJR	1
n-Butylbenzene	< 0.04	mg/kg	0.04	0.13	1	8260B		7/30/2019	CJR	1
Carbon Tetrachloride	< 0.016	mg/kg	0.016	0.053	1	8260B		7/30/2019	CJR	1
Chlorobenzene	< 0.013	mg/kg	0.013	0.04	1	8260B		7/30/2019	CJR	1
Chloroethane	< 0.091	mg/kg	0.091	0.29	1	8260B		7/30/2019	CJR	1
Chloroform	< 0.035	mg/kg	0.035	0.11	1	8260B		7/30/2019	CJR	1
Chloromethane	< 0.076	mg/kg	0.076	0.24	1	8260B		7/30/2019	CJR	1
2-Chlorotoluene	< 0.015	mg/kg	0.015	0.047	1	8260B		7/30/2019	CJR	1
4-Chlorotoluene	< 0.018	mg/kg	0.018	0.057	1	8260B		7/30/2019	CJR	1
1,2-Dibromo-3-chloropropane	< 0.058	mg/kg	0.058	0.18	1	8260B		7/30/2019	CJR	1
Dibromochloromethane	< 0.025	mg/kg	0.025	0.079	1	8260B		7/30/2019	CJR	1
1,4-Dichlorobenzene	< 0.037	mg/kg	0.037	0.12	1	8260B		7/30/2019	CJR	1
1,3-Dichlorobenzene	< 0.037	mg/kg	0.037	0.12	1	8260B		7/30/2019	CJR	1
1,2-Dichlorobenzene	< 0.028	mg/kg	0.028	0.088	1	8260B		7/30/2019	CJR	1
Dichlorodifluoromethane	< 0.048	mg/kg	0.048	0.15	1	8260B		7/30/2019	CJR	1
1,2-Dichloroethane	< 0.038	mg/kg	0.038	0.12	1	8260B		7/30/2019	CJR	1
1,1-Dichloroethane	< 0.034	mg/kg	0.034	0.11	1	8260B		7/30/2019	CJR	1
1,1-Dichloroethene	< 0.022	mg/kg	0.022	0.069	1	8260B		7/30/2019	CJR	1
cis-1,2-Dichloroethene	< 0.032	mg/kg	0.032	0.1	1	8260B		7/30/2019	CJR	1
trans-1,2-Dichloroethene	< 0.028	mg/kg	0.028	0.09	1	8260B		7/30/2019	CJR	1
1,2-Dichloropropane	< 0.035	mg/kg	0.035	0.11	1	8260B		7/30/2019	CJR	1
1,3-Dichloropropane	< 0.025	mg/kg	0.025	0.079	1	8260B		7/30/2019	CJR	1
trans-1,3-Dichloropropene	< 0.022	mg/kg	0.022	0.068	1	8260B		7/30/2019	CJR	1
cis-1,3-Dichloropropene	< 0.039	mg/kg	0.039	0.12	1	8260B		7/30/2019	CJR	1
Di-isopropyl ether	< 0.01	mg/kg	0.01	0.032	1	8260B		7/30/2019	CJR	1
EDB (1,2-Dibromoethane)	< 0.023	mg/kg	0.023	0.072	1	8260B		7/30/2019	CJR	1
Ethylbenzene	< 0.035	mg/kg	0.035	0.11	1	8260B		7/30/2019	CJR	1
Hexachlorobutadiene	< 0.085	mg/kg	0.085	0.27	1	8260B		7/30/2019	CJR	1
Isopropylbenzene	< 0.034	mg/kg	0.034	0.11	1	8260B		7/30/2019	CJR	1
p-Isopropyltoluene	< 0.029	mg/kg	0.029	0.093	1	8260B		7/30/2019	CJR	1
Methylene chloride	< 0.15	mg/kg	0.15	0.46	1	8260B		7/30/2019	CJR	1
Methyl tert-butyl ether (MTBE)	< 0.05	mg/kg	0.05	0.16	1	8260B		7/30/2019	CJR	1
Naphthalene	< 0.094	mg/kg	0.094	0.3	1	8260B		7/30/2019	CJR	1
n-Propylbenzene	< 0.033	mg/kg	0.033	0.1	1	8260B		7/30/2019	CJR	1
1,1,2,2-Tetrachloroethane	< 0.028	mg/kg	0.028	0.88	1	8260B		7/30/2019	CJR	1
1,1,1,2-Tetrachloroethane	< 0.028	mg/kg	0.028	0.09	1	8260B		7/30/2019	CJR	1

Project Name KLINKE CLEANERS
Project # 6274

Invoice # E36534

Lab Code 5036534E
Sample ID 6274-FS-5 (6')
Sample Matrix Soil
Sample Date 7/23/2019

	Result	Unit	LOD	LOQ	Dil	Method	Ext Date	Run Date	Analyst	Code
Tetrachloroethene	0.088 "J"	mg/kg	0.032	0.1	1	8260B		7/30/2019	CJR	1
Toluene	< 0.032	mg/kg	0.032	0.1	1	8260B		7/30/2019	CJR	1
1,2,4-Trichlorobenzene	< 0.064	mg/kg	0.064	0.2	1	8260B		7/30/2019	CJR	1
1,2,3-Trichlorobenzene	< 0.066	mg/kg	0.066	0.21	1	8260B		7/30/2019	CJR	1
1,1,1-Trichloroethane	< 0.03	mg/kg	0.03	0.96	1	8260B		7/30/2019	CJR	1
1,1,2-Trichloroethane	< 0.033	mg/kg	0.033	0.11	1	8260B		7/30/2019	CJR	1
Trichloroethene (TCE)	< 0.041	mg/kg	0.041	0.13	1	8260B		7/30/2019	CJR	1
Trichlorofluoromethane	< 0.041	mg/kg	0.041	0.13	1	8260B		7/30/2019	CJR	1
1,2,4-Trimethylbenzene	< 0.025	mg/kg	0.025	0.08	1	8260B		7/30/2019	CJR	1
1,3,5-Trimethylbenzene	< 0.032	mg/kg	0.032	0.1	1	8260B		7/30/2019	CJR	1
Vinyl Chloride	< 0.019	mg/kg	0.019	0.062	1	8260B		7/30/2019	CJR	1
m&p-Xylene	< 0.072	mg/kg	0.072	0.23	1	8260B		7/30/2019	CJR	1
o-Xylene	< 0.044	mg/kg	0.044	0.14	1	8260B		7/30/2019	CJR	1
SUR - 1,2-Dichloroethane-d4	106	Rec %			1	8260B		7/30/2019	CJR	1
SUR - 4-Bromofluorobenzene	103	Rec %			1	8260B		7/30/2019	CJR	1
SUR - Dibromofluoromethane	101	Rec %			1	8260B		7/30/2019	CJR	1
SUR - Toluene-d8	101	Rec %			1	8260B		7/30/2019	CJR	1

Project Name KLINKE CLEANERS
Project # 6274

Invoice # E36534

Lab Code 5036534F
Sample ID 6274-FS-6 (6')
Sample Matrix Soil
Sample Date 7/23/2019

	Result	Unit	LOD	LOQ	Dil	Method	Ext Date	Run Date	Analyst	Code
General										
General										
Solids Percent	81.7	%			1	5021		7/26/2019	NJC	1
Organic										
VOC's										
Benzene	< 0.03	mg/kg	0.03	0.096	1	8260B		7/30/2019	CJR	1
Bromobenzene	< 0.025	mg/kg	0.025	0.081	1	8260B		7/30/2019	CJR	1
Bromodichloromethane	< 0.074	mg/kg	0.074	0.24	1	8260B		7/30/2019	CJR	1
Bromoform	< 0.029	mg/kg	0.029	0.092	1	8260B		7/30/2019	CJR	1
tert-Butylbenzene	< 0.026	mg/kg	0.026	0.084	1	8260B		7/30/2019	CJR	1
sec-Butylbenzene	< 0.033	mg/kg	0.033	0.1	1	8260B		7/30/2019	CJR	1
n-Butylbenzene	< 0.04	mg/kg	0.04	0.13	1	8260B		7/30/2019	CJR	1
Carbon Tetrachloride	< 0.016	mg/kg	0.016	0.053	1	8260B		7/30/2019	CJR	1
Chlorobenzene	< 0.013	mg/kg	0.013	0.04	1	8260B		7/30/2019	CJR	1
Chloroethane	< 0.091	mg/kg	0.091	0.29	1	8260B		7/30/2019	CJR	1
Chloroform	< 0.035	mg/kg	0.035	0.11	1	8260B		7/30/2019	CJR	1
Chloromethane	< 0.076	mg/kg	0.076	0.24	1	8260B		7/30/2019	CJR	1
2-Chlorotoluene	< 0.015	mg/kg	0.015	0.047	1	8260B		7/30/2019	CJR	1
4-Chlorotoluene	< 0.018	mg/kg	0.018	0.057	1	8260B		7/30/2019	CJR	1
1,2-Dibromo-3-chloropropane	< 0.058	mg/kg	0.058	0.18	1	8260B		7/30/2019	CJR	1
Dibromochloromethane	< 0.025	mg/kg	0.025	0.079	1	8260B		7/30/2019	CJR	1
1,4-Dichlorobenzene	< 0.037	mg/kg	0.037	0.12	1	8260B		7/30/2019	CJR	1
1,3-Dichlorobenzene	< 0.037	mg/kg	0.037	0.12	1	8260B		7/30/2019	CJR	1
1,2-Dichlorobenzene	< 0.028	mg/kg	0.028	0.088	1	8260B		7/30/2019	CJR	1
Dichlorodifluoromethane	< 0.048	mg/kg	0.048	0.15	1	8260B		7/30/2019	CJR	1
1,2-Dichloroethane	< 0.038	mg/kg	0.038	0.12	1	8260B		7/30/2019	CJR	1
1,1-Dichloroethane	< 0.034	mg/kg	0.034	0.11	1	8260B		7/30/2019	CJR	1
1,1-Dichloroethene	< 0.022	mg/kg	0.022	0.069	1	8260B		7/30/2019	CJR	1
cis-1,2-Dichloroethene	< 0.032	mg/kg	0.032	0.1	1	8260B		7/30/2019	CJR	1
trans-1,2-Dichloroethene	< 0.028	mg/kg	0.028	0.09	1	8260B		7/30/2019	CJR	1
1,2-Dichloropropane	< 0.035	mg/kg	0.035	0.11	1	8260B		7/30/2019	CJR	1
1,3-Dichloropropane	< 0.025	mg/kg	0.025	0.079	1	8260B		7/30/2019	CJR	1
trans-1,3-Dichloropropene	< 0.022	mg/kg	0.022	0.068	1	8260B		7/30/2019	CJR	1
cis-1,3-Dichloropropene	< 0.039	mg/kg	0.039	0.12	1	8260B		7/30/2019	CJR	1
Di-isopropyl ether	< 0.01	mg/kg	0.01	0.032	1	8260B		7/30/2019	CJR	1
EDB (1,2-Dibromoethane)	< 0.023	mg/kg	0.023	0.072	1	8260B		7/30/2019	CJR	1
Ethylbenzene	< 0.035	mg/kg	0.035	0.11	1	8260B		7/30/2019	CJR	1
Hexachlorobutadiene	< 0.085	mg/kg	0.085	0.27	1	8260B		7/30/2019	CJR	1
Isopropylbenzene	< 0.034	mg/kg	0.034	0.11	1	8260B		7/30/2019	CJR	1
p-Isopropyltoluene	< 0.029	mg/kg	0.029	0.093	1	8260B		7/30/2019	CJR	1
Methylene chloride	< 0.15	mg/kg	0.15	0.46	1	8260B		7/30/2019	CJR	1
Methyl tert-butyl ether (MTBE)	< 0.05	mg/kg	0.05	0.16	1	8260B		7/30/2019	CJR	1
Naphthalene	< 0.094	mg/kg	0.094	0.3	1	8260B		7/30/2019	CJR	1
n-Propylbenzene	< 0.033	mg/kg	0.033	0.1	1	8260B		7/30/2019	CJR	1
1,1,2,2-Tetrachloroethane	< 0.028	mg/kg	0.028	0.88	1	8260B		7/30/2019	CJR	1
1,1,1,2-Tetrachloroethane	< 0.028	mg/kg	0.028	0.09	1	8260B		7/30/2019	CJR	1

Project Name KLINKE CLEANERS
Project # 6274

Invoice # E36534

Lab Code 5036534F
Sample ID 6274-FS-6 (6')
Sample Matrix Soil
Sample Date 7/23/2019

	Result	Unit	LOD	LOQ	Dil	Method	Ext Date	Run Date	Analyst	Code
Tetrachloroethene	0.268	mg/kg	0.032	0.1	1	8260B		7/30/2019	CJR	1
Toluene	< 0.032	mg/kg	0.032	0.1	1	8260B		7/30/2019	CJR	1
1,2,4-Trichlorobenzene	< 0.064	mg/kg	0.064	0.2	1	8260B		7/30/2019	CJR	1
1,2,3-Trichlorobenzene	< 0.066	mg/kg	0.066	0.21	1	8260B		7/30/2019	CJR	1
1,1,1-Trichloroethane	< 0.03	mg/kg	0.03	0.96	1	8260B		7/30/2019	CJR	1
1,1,2-Trichloroethane	< 0.033	mg/kg	0.033	0.11	1	8260B		7/30/2019	CJR	1
Trichloroethene (TCE)	< 0.041	mg/kg	0.041	0.13	1	8260B		7/30/2019	CJR	1
Trichlorofluoromethane	< 0.041	mg/kg	0.041	0.13	1	8260B		7/30/2019	CJR	1
1,2,4-Trimethylbenzene	< 0.025	mg/kg	0.025	0.08	1	8260B		7/30/2019	CJR	1
1,3,5-Trimethylbenzene	< 0.032	mg/kg	0.032	0.1	1	8260B		7/30/2019	CJR	1
Vinyl Chloride	< 0.019	mg/kg	0.019	0.062	1	8260B		7/30/2019	CJR	1
m&p-Xylene	< 0.072	mg/kg	0.072	0.23	1	8260B		7/30/2019	CJR	1
o-Xylene	< 0.044	mg/kg	0.044	0.14	1	8260B		7/30/2019	CJR	1
SUR - 1,2-Dichloroethane-d4	96	Rec %			1	8260B		7/30/2019	CJR	1
SUR - 4-Bromofluorobenzene	99	Rec %			1	8260B		7/30/2019	CJR	1
SUR - Dibromofluoromethane	98	Rec %			1	8260B		7/30/2019	CJR	1
SUR - Toluene-d8	98	Rec %			1	8260B		7/30/2019	CJR	1

Project Name KLINKE CLEANERS
Project # 6274

Invoice # E36534

Lab Code 5036534G
Sample ID 6274-WS-1 (4')
Sample Matrix Soil
Sample Date 7/23/2019

	Result	Unit	LOD	LOQ	Dil	Method	Ext Date	Run Date	Analyst	Code
General										
General										
Solids Percent	84.2	%			1	5021		7/26/2019	NJC	1
Organic										
VOC's										
Benzene	< 0.03	mg/kg	0.03	0.096	1	8260B		7/30/2019	CJR	1
Bromobenzene	< 0.025	mg/kg	0.025	0.081	1	8260B		7/30/2019	CJR	1
Bromodichloromethane	< 0.074	mg/kg	0.074	0.24	1	8260B		7/30/2019	CJR	1
Bromoform	< 0.029	mg/kg	0.029	0.092	1	8260B		7/30/2019	CJR	1
tert-Butylbenzene	< 0.026	mg/kg	0.026	0.084	1	8260B		7/30/2019	CJR	1
sec-Butylbenzene	< 0.033	mg/kg	0.033	0.1	1	8260B		7/30/2019	CJR	1
n-Butylbenzene	< 0.04	mg/kg	0.04	0.13	1	8260B		7/30/2019	CJR	1
Carbon Tetrachloride	< 0.016	mg/kg	0.016	0.053	1	8260B		7/30/2019	CJR	1
Chlorobenzene	< 0.013	mg/kg	0.013	0.04	1	8260B		7/30/2019	CJR	1
Chloroethane	< 0.091	mg/kg	0.091	0.29	1	8260B		7/30/2019	CJR	1
Chloroform	< 0.035	mg/kg	0.035	0.11	1	8260B		7/30/2019	CJR	1
Chloromethane	< 0.076	mg/kg	0.076	0.24	1	8260B		7/30/2019	CJR	1
2-Chlorotoluene	< 0.015	mg/kg	0.015	0.047	1	8260B		7/30/2019	CJR	1
4-Chlorotoluene	< 0.018	mg/kg	0.018	0.057	1	8260B		7/30/2019	CJR	1
1,2-Dibromo-3-chloropropane	< 0.058	mg/kg	0.058	0.18	1	8260B		7/30/2019	CJR	1
Dibromochloromethane	< 0.025	mg/kg	0.025	0.079	1	8260B		7/30/2019	CJR	1
1,4-Dichlorobenzene	< 0.037	mg/kg	0.037	0.12	1	8260B		7/30/2019	CJR	1
1,3-Dichlorobenzene	< 0.037	mg/kg	0.037	0.12	1	8260B		7/30/2019	CJR	1
1,2-Dichlorobenzene	< 0.028	mg/kg	0.028	0.088	1	8260B		7/30/2019	CJR	1
Dichlorodifluoromethane	< 0.048	mg/kg	0.048	0.15	1	8260B		7/30/2019	CJR	1
1,2-Dichloroethane	< 0.038	mg/kg	0.038	0.12	1	8260B		7/30/2019	CJR	1
1,1-Dichloroethane	< 0.034	mg/kg	0.034	0.11	1	8260B		7/30/2019	CJR	1
1,1-Dichloroethene	< 0.022	mg/kg	0.022	0.069	1	8260B		7/30/2019	CJR	1
cis-1,2-Dichloroethene	< 0.032	mg/kg	0.032	0.1	1	8260B		7/30/2019	CJR	1
trans-1,2-Dichloroethene	< 0.028	mg/kg	0.028	0.09	1	8260B		7/30/2019	CJR	1
1,2-Dichloropropane	< 0.035	mg/kg	0.035	0.11	1	8260B		7/30/2019	CJR	1
1,3-Dichloropropane	< 0.025	mg/kg	0.025	0.079	1	8260B		7/30/2019	CJR	1
trans-1,3-Dichloropropene	< 0.022	mg/kg	0.022	0.068	1	8260B		7/30/2019	CJR	1
cis-1,3-Dichloropropene	< 0.039	mg/kg	0.039	0.12	1	8260B		7/30/2019	CJR	1
Di-isopropyl ether	< 0.01	mg/kg	0.01	0.032	1	8260B		7/30/2019	CJR	1
EDB (1,2-Dibromoethane)	< 0.023	mg/kg	0.023	0.072	1	8260B		7/30/2019	CJR	1
Ethylbenzene	< 0.035	mg/kg	0.035	0.11	1	8260B		7/30/2019	CJR	1
Hexachlorobutadiene	< 0.085	mg/kg	0.085	0.27	1	8260B		7/30/2019	CJR	1
Isopropylbenzene	< 0.034	mg/kg	0.034	0.11	1	8260B		7/30/2019	CJR	1
p-Isopropyltoluene	< 0.029	mg/kg	0.029	0.093	1	8260B		7/30/2019	CJR	1
Methylene chloride	< 0.15	mg/kg	0.15	0.46	1	8260B		7/30/2019	CJR	1
Methyl tert-butyl ether (MTBE)	< 0.05	mg/kg	0.05	0.16	1	8260B		7/30/2019	CJR	1
Naphthalene	< 0.094	mg/kg	0.094	0.3	1	8260B		7/30/2019	CJR	1
n-Propylbenzene	< 0.033	mg/kg	0.033	0.1	1	8260B		7/30/2019	CJR	1
1,1,2,2-Tetrachloroethane	< 0.028	mg/kg	0.028	0.88	1	8260B		7/30/2019	CJR	1
1,1,1,2-Tetrachloroethane	< 0.028	mg/kg	0.028	0.09	1	8260B		7/30/2019	CJR	1

Project Name KLINKE CLEANERS
Project # 6274

Invoice # E36534

Lab Code 5036534G
Sample ID 6274-WS-1 (4')
Sample Matrix Soil
Sample Date 7/23/2019

	Result	Unit	LOD	LOQ	Dil	Method	Ext Date	Run Date	Analyst	Code
Tetrachloroethene	2.24	mg/kg	0.032	0.1	1	8260B		7/30/2019	CJR	1
Toluene	< 0.032	mg/kg	0.032	0.1	1	8260B		7/30/2019	CJR	1
1,2,4-Trichlorobenzene	< 0.064	mg/kg	0.064	0.2	1	8260B		7/30/2019	CJR	1
1,2,3-Trichlorobenzene	< 0.066	mg/kg	0.066	0.21	1	8260B		7/30/2019	CJR	1
1,1,1-Trichloroethane	< 0.03	mg/kg	0.03	0.96	1	8260B		7/30/2019	CJR	1
1,1,2-Trichloroethane	< 0.033	mg/kg	0.033	0.11	1	8260B		7/30/2019	CJR	1
Trichloroethene (TCE)	< 0.041	mg/kg	0.041	0.13	1	8260B		7/30/2019	CJR	1
Trichlorofluoromethane	< 0.041	mg/kg	0.041	0.13	1	8260B		7/30/2019	CJR	1
1,2,4-Trimethylbenzene	< 0.025	mg/kg	0.025	0.08	1	8260B		7/30/2019	CJR	1
1,3,5-Trimethylbenzene	< 0.032	mg/kg	0.032	0.1	1	8260B		7/30/2019	CJR	1
Vinyl Chloride	< 0.019	mg/kg	0.019	0.062	1	8260B		7/30/2019	CJR	1
m&p-Xylene	< 0.072	mg/kg	0.072	0.23	1	8260B		7/30/2019	CJR	1
o-Xylene	< 0.044	mg/kg	0.044	0.14	1	8260B		7/30/2019	CJR	1
SUR - 1,2-Dichloroethane-d4	101	Rec %			1	8260B		7/30/2019	CJR	1
SUR - 4-Bromofluorobenzene	98	Rec %			1	8260B		7/30/2019	CJR	1
SUR - Dibromofluoromethane	102	Rec %			1	8260B		7/30/2019	CJR	1
SUR - Toluene-d8	98	Rec %			1	8260B		7/30/2019	CJR	1

Project Name KLINKE CLEANERS
Project # 6274

Invoice # E36534

Lab Code 5036534H
Sample ID 6274-WS-2 (4')
Sample Matrix Soil
Sample Date 7/23/2019

	Result	Unit	LOD	LOQ	Dil	Method	Ext Date	Run Date	Analyst	Code
General										
General										
Solids Percent	87.8	%			1	5021		7/26/2019	NJC	1
Organic										
VOC's										
Benzene	< 0.03	mg/kg	0.03	0.096	1	8260B		7/31/2019	CJR	1
Bromobenzene	< 0.025	mg/kg	0.025	0.081	1	8260B		7/31/2019	CJR	1
Bromodichloromethane	< 0.074	mg/kg	0.074	0.24	1	8260B		7/31/2019	CJR	1
Bromoform	< 0.029	mg/kg	0.029	0.092	1	8260B		7/31/2019	CJR	1
tert-Butylbenzene	< 0.026	mg/kg	0.026	0.084	1	8260B		7/31/2019	CJR	1
sec-Butylbenzene	< 0.033	mg/kg	0.033	0.1	1	8260B		7/31/2019	CJR	1
n-Butylbenzene	< 0.04	mg/kg	0.04	0.13	1	8260B		7/31/2019	CJR	1
Carbon Tetrachloride	< 0.016	mg/kg	0.016	0.053	1	8260B		7/31/2019	CJR	1
Chlorobenzene	< 0.013	mg/kg	0.013	0.04	1	8260B		7/31/2019	CJR	1
Chloroethane	< 0.091	mg/kg	0.091	0.29	1	8260B		7/31/2019	CJR	1
Chloroform	< 0.035	mg/kg	0.035	0.11	1	8260B		7/31/2019	CJR	1
Chloromethane	< 0.076	mg/kg	0.076	0.24	1	8260B		7/31/2019	CJR	1
2-Chlorotoluene	< 0.015	mg/kg	0.015	0.047	1	8260B		7/31/2019	CJR	1
4-Chlorotoluene	< 0.018	mg/kg	0.018	0.057	1	8260B		7/31/2019	CJR	1
1,2-Dibromo-3-chloropropane	< 0.058	mg/kg	0.058	0.18	1	8260B		7/31/2019	CJR	1
Dibromochloromethane	< 0.025	mg/kg	0.025	0.079	1	8260B		7/31/2019	CJR	1
1,4-Dichlorobenzene	< 0.037	mg/kg	0.037	0.12	1	8260B		7/31/2019	CJR	1
1,3-Dichlorobenzene	< 0.037	mg/kg	0.037	0.12	1	8260B		7/31/2019	CJR	1
1,2-Dichlorobenzene	< 0.028	mg/kg	0.028	0.088	1	8260B		7/31/2019	CJR	1
Dichlorodifluoromethane	< 0.048	mg/kg	0.048	0.15	1	8260B		7/31/2019	CJR	1
1,2-Dichloroethane	< 0.038	mg/kg	0.038	0.12	1	8260B		7/31/2019	CJR	1
1,1-Dichloroethane	< 0.034	mg/kg	0.034	0.11	1	8260B		7/31/2019	CJR	1
1,1-Dichloroethene	< 0.022	mg/kg	0.022	0.069	1	8260B		7/31/2019	CJR	1
cis-1,2-Dichloroethene	< 0.032	mg/kg	0.032	0.1	1	8260B		7/31/2019	CJR	1
trans-1,2-Dichloroethene	< 0.028	mg/kg	0.028	0.09	1	8260B		7/31/2019	CJR	1
1,2-Dichloropropane	< 0.035	mg/kg	0.035	0.11	1	8260B		7/31/2019	CJR	1
1,3-Dichloropropane	< 0.025	mg/kg	0.025	0.079	1	8260B		7/31/2019	CJR	1
trans-1,3-Dichloropropene	< 0.022	mg/kg	0.022	0.068	1	8260B		7/31/2019	CJR	1
cis-1,3-Dichloropropene	< 0.039	mg/kg	0.039	0.12	1	8260B		7/31/2019	CJR	1
Di-isopropyl ether	< 0.01	mg/kg	0.01	0.032	1	8260B		7/31/2019	CJR	1
EDB (1,2-Dibromoethane)	< 0.023	mg/kg	0.023	0.072	1	8260B		7/31/2019	CJR	1
Ethylbenzene	< 0.035	mg/kg	0.035	0.11	1	8260B		7/31/2019	CJR	1
Hexachlorobutadiene	< 0.085	mg/kg	0.085	0.27	1	8260B		7/31/2019	CJR	1
Isopropylbenzene	< 0.034	mg/kg	0.034	0.11	1	8260B		7/31/2019	CJR	1
p-Isopropyltoluene	< 0.029	mg/kg	0.029	0.093	1	8260B		7/31/2019	CJR	1
Methylene chloride	< 0.15	mg/kg	0.15	0.46	1	8260B		7/31/2019	CJR	1
Methyl tert-butyl ether (MTBE)	< 0.05	mg/kg	0.05	0.16	1	8260B		7/31/2019	CJR	1
Naphthalene	< 0.094	mg/kg	0.094	0.3	1	8260B		7/31/2019	CJR	1
n-Propylbenzene	< 0.033	mg/kg	0.033	0.1	1	8260B		7/31/2019	CJR	1
1,1,2,2-Tetrachloroethane	< 0.028	mg/kg	0.028	0.88	1	8260B		7/31/2019	CJR	1
1,1,1,2-Tetrachloroethane	< 0.028	mg/kg	0.028	0.09	1	8260B		7/31/2019	CJR	1

Project Name KLINKE CLEANERS
Project # 6274

Invoice # E36534

Lab Code 5036534H
Sample ID 6274-WS-2 (4')
Sample Matrix Soil
Sample Date 7/23/2019

	Result	Unit	LOD	LOQ	Dil	Method	Ext Date	Run Date	Analyst	Code
Tetrachloroethene	0.87	mg/kg	0.032	0.1	1	8260B		7/31/2019	CJR	1
Toluene	< 0.032	mg/kg	0.032	0.1	1	8260B		7/31/2019	CJR	1
1,2,4-Trichlorobenzene	< 0.064	mg/kg	0.064	0.2	1	8260B		7/31/2019	CJR	1
1,2,3-Trichlorobenzene	< 0.066	mg/kg	0.066	0.21	1	8260B		7/31/2019	CJR	1
1,1,1-Trichloroethane	< 0.03	mg/kg	0.03	0.96	1	8260B		7/31/2019	CJR	1
1,1,2-Trichloroethane	< 0.033	mg/kg	0.033	0.11	1	8260B		7/31/2019	CJR	1
Trichloroethene (TCE)	< 0.041	mg/kg	0.041	0.13	1	8260B		7/31/2019	CJR	1
Trichlorofluoromethane	< 0.041	mg/kg	0.041	0.13	1	8260B		7/31/2019	CJR	1
1,2,4-Trimethylbenzene	< 0.025	mg/kg	0.025	0.08	1	8260B		7/31/2019	CJR	1
1,3,5-Trimethylbenzene	< 0.032	mg/kg	0.032	0.1	1	8260B		7/31/2019	CJR	1
Vinyl Chloride	< 0.019	mg/kg	0.019	0.062	1	8260B		7/31/2019	CJR	1
m&p-Xylene	< 0.072	mg/kg	0.072	0.23	1	8260B		7/31/2019	CJR	1
o-Xylene	< 0.044	mg/kg	0.044	0.14	1	8260B		7/31/2019	CJR	1
SUR - 1,2-Dichloroethane-d4	102	Rec %			1	8260B		7/31/2019	CJR	1
SUR - 4-Bromofluorobenzene	97	Rec %			1	8260B		7/31/2019	CJR	1
SUR - Dibromofluoromethane	101	Rec %			1	8260B		7/31/2019	CJR	1
SUR - Toluene-d8	98	Rec %			1	8260B		7/31/2019	CJR	1

Project Name KLINKE CLEANERS
Project # 6274

Invoice # E36534

Lab Code 5036534I
Sample ID 6274-WS-3 (4')
Sample Matrix Soil
Sample Date 7/23/2019

	Result	Unit	LOD	LOQ	Dil	Method	Ext Date	Run Date	Analyst	Code
General										
General										
Solids Percent	98.8	%			1	5021		7/26/2019	NJC	1
Organic										
VOC's										
Benzene	< 0.03	mg/kg	0.03	0.096	1	8260B		7/31/2019	CJR	1
Bromobenzene	< 0.025	mg/kg	0.025	0.081	1	8260B		7/31/2019	CJR	1
Bromodichloromethane	< 0.074	mg/kg	0.074	0.24	1	8260B		7/31/2019	CJR	1
Bromoform	< 0.029	mg/kg	0.029	0.092	1	8260B		7/31/2019	CJR	1
tert-Butylbenzene	< 0.026	mg/kg	0.026	0.084	1	8260B		7/31/2019	CJR	1
sec-Butylbenzene	< 0.033	mg/kg	0.033	0.1	1	8260B		7/31/2019	CJR	1
n-Butylbenzene	< 0.04	mg/kg	0.04	0.13	1	8260B		7/31/2019	CJR	1
Carbon Tetrachloride	< 0.016	mg/kg	0.016	0.053	1	8260B		7/31/2019	CJR	1
Chlorobenzene	< 0.013	mg/kg	0.013	0.04	1	8260B		7/31/2019	CJR	1
Chloroethane	< 0.091	mg/kg	0.091	0.29	1	8260B		7/31/2019	CJR	1
Chloroform	< 0.035	mg/kg	0.035	0.11	1	8260B		7/31/2019	CJR	1
Chloromethane	< 0.076	mg/kg	0.076	0.24	1	8260B		7/31/2019	CJR	1
2-Chlorotoluene	< 0.015	mg/kg	0.015	0.047	1	8260B		7/31/2019	CJR	1
4-Chlorotoluene	< 0.018	mg/kg	0.018	0.057	1	8260B		7/31/2019	CJR	1
1,2-Dibromo-3-chloropropane	< 0.058	mg/kg	0.058	0.18	1	8260B		7/31/2019	CJR	1
Dibromochloromethane	< 0.025	mg/kg	0.025	0.079	1	8260B		7/31/2019	CJR	1
1,4-Dichlorobenzene	< 0.037	mg/kg	0.037	0.12	1	8260B		7/31/2019	CJR	1
1,3-Dichlorobenzene	< 0.037	mg/kg	0.037	0.12	1	8260B		7/31/2019	CJR	1
1,2-Dichlorobenzene	< 0.028	mg/kg	0.028	0.088	1	8260B		7/31/2019	CJR	1
Dichlorodifluoromethane	< 0.048	mg/kg	0.048	0.15	1	8260B		7/31/2019	CJR	1
1,2-Dichloroethane	< 0.038	mg/kg	0.038	0.12	1	8260B		7/31/2019	CJR	1
1,1-Dichloroethane	< 0.034	mg/kg	0.034	0.11	1	8260B		7/31/2019	CJR	1
1,1-Dichloroethene	< 0.022	mg/kg	0.022	0.069	1	8260B		7/31/2019	CJR	1
cis-1,2-Dichloroethene	< 0.032	mg/kg	0.032	0.1	1	8260B		7/31/2019	CJR	1
trans-1,2-Dichloroethene	< 0.028	mg/kg	0.028	0.09	1	8260B		7/31/2019	CJR	1
1,2-Dichloropropane	< 0.035	mg/kg	0.035	0.11	1	8260B		7/31/2019	CJR	1
1,3-Dichloropropane	< 0.025	mg/kg	0.025	0.079	1	8260B		7/31/2019	CJR	1
trans-1,3-Dichloropropene	< 0.022	mg/kg	0.022	0.068	1	8260B		7/31/2019	CJR	1
cis-1,3-Dichloropropene	< 0.039	mg/kg	0.039	0.12	1	8260B		7/31/2019	CJR	1
Di-isopropyl ether	< 0.01	mg/kg	0.01	0.032	1	8260B		7/31/2019	CJR	1
EDB (1,2-Dibromoethane)	< 0.023	mg/kg	0.023	0.072	1	8260B		7/31/2019	CJR	1
Ethylbenzene	< 0.035	mg/kg	0.035	0.11	1	8260B		7/31/2019	CJR	1
Hexachlorobutadiene	< 0.085	mg/kg	0.085	0.27	1	8260B		7/31/2019	CJR	1
Isopropylbenzene	< 0.034	mg/kg	0.034	0.11	1	8260B		7/31/2019	CJR	1
p-Isopropyltoluene	< 0.029	mg/kg	0.029	0.093	1	8260B		7/31/2019	CJR	1
Methylene chloride	< 0.15	mg/kg	0.15	0.46	1	8260B		7/31/2019	CJR	1
Methyl tert-butyl ether (MTBE)	< 0.05	mg/kg	0.05	0.16	1	8260B		7/31/2019	CJR	1
Naphthalene	< 0.094	mg/kg	0.094	0.3	1	8260B		7/31/2019	CJR	1
n-Propylbenzene	< 0.033	mg/kg	0.033	0.1	1	8260B		7/31/2019	CJR	1
1,1,2,2-Tetrachloroethane	< 0.028	mg/kg	0.028	0.88	1	8260B		7/31/2019	CJR	1
1,1,1,2-Tetrachloroethane	< 0.028	mg/kg	0.028	0.09	1	8260B		7/31/2019	CJR	1

Project Name KLINKE CLEANERS
Project # 6274

Invoice # E36534

Lab Code 5036534I
Sample ID 6274-WS-3 (4')
Sample Matrix Soil
Sample Date 7/23/2019

	Result	Unit	LOD	LOQ	Dil	Method	Ext Date	Run Date	Analyst	Code
Tetrachloroethene	0.128	mg/kg	0.032	0.1	1	8260B		7/31/2019	CJR	1
Toluene	< 0.032	mg/kg	0.032	0.1	1	8260B		7/31/2019	CJR	1
1,2,4-Trichlorobenzene	< 0.064	mg/kg	0.064	0.2	1	8260B		7/31/2019	CJR	1
1,2,3-Trichlorobenzene	< 0.066	mg/kg	0.066	0.21	1	8260B		7/31/2019	CJR	1
1,1,1-Trichloroethane	< 0.03	mg/kg	0.03	0.96	1	8260B		7/31/2019	CJR	1
1,1,2-Trichloroethane	< 0.033	mg/kg	0.033	0.11	1	8260B		7/31/2019	CJR	1
Trichloroethene (TCE)	< 0.041	mg/kg	0.041	0.13	1	8260B		7/31/2019	CJR	1
Trichlorofluoromethane	< 0.041	mg/kg	0.041	0.13	1	8260B		7/31/2019	CJR	1
1,2,4-Trimethylbenzene	< 0.025	mg/kg	0.025	0.08	1	8260B		7/31/2019	CJR	1
1,3,5-Trimethylbenzene	< 0.032	mg/kg	0.032	0.1	1	8260B		7/31/2019	CJR	1
Vinyl Chloride	< 0.019	mg/kg	0.019	0.062	1	8260B		7/31/2019	CJR	1
m&p-Xylene	< 0.072	mg/kg	0.072	0.23	1	8260B		7/31/2019	CJR	1
o-Xylene	< 0.044	mg/kg	0.044	0.14	1	8260B		7/31/2019	CJR	1
SUR - 1,2-Dichloroethane-d4	112	Rec %			1	8260B		7/31/2019	CJR	1
SUR - 4-Bromofluorobenzene	96	Rec %			1	8260B		7/31/2019	CJR	1
SUR - Dibromofluoromethane	98	Rec %			1	8260B		7/31/2019	CJR	1
SUR - Toluene-d8	98	Rec %			1	8260B		7/31/2019	CJR	1

Project Name KLINKE CLEANERS
Project # 6274

Invoice # E36534

Lab Code 5036534J
Sample ID 6274-WS-4 (4')
Sample Matrix Soil
Sample Date 7/23/2019

	Result	Unit	LOD	LOQ	Dil	Method	Ext Date	Run Date	Analyst	Code
General										
General										
Solids Percent	98.0	%			1	5021		7/26/2019	NJC	1
Organic										
VOC's										
Benzene	< 0.03	mg/kg	0.03	0.096	1	8260B		7/31/2019	CJR	1
Bromobenzene	< 0.025	mg/kg	0.025	0.081	1	8260B		7/31/2019	CJR	1
Bromodichloromethane	< 0.074	mg/kg	0.074	0.24	1	8260B		7/31/2019	CJR	1
Bromoform	< 0.029	mg/kg	0.029	0.092	1	8260B		7/31/2019	CJR	1
tert-Butylbenzene	< 0.026	mg/kg	0.026	0.084	1	8260B		7/31/2019	CJR	1
sec-Butylbenzene	< 0.033	mg/kg	0.033	0.1	1	8260B		7/31/2019	CJR	1
n-Butylbenzene	< 0.04	mg/kg	0.04	0.13	1	8260B		7/31/2019	CJR	1
Carbon Tetrachloride	< 0.016	mg/kg	0.016	0.053	1	8260B		7/31/2019	CJR	1
Chlorobenzene	< 0.013	mg/kg	0.013	0.04	1	8260B		7/31/2019	CJR	1
Chloroethane	< 0.091	mg/kg	0.091	0.29	1	8260B		7/31/2019	CJR	1
Chloroform	< 0.035	mg/kg	0.035	0.11	1	8260B		7/31/2019	CJR	1
Chloromethane	< 0.076	mg/kg	0.076	0.24	1	8260B		7/31/2019	CJR	1
2-Chlorotoluene	< 0.015	mg/kg	0.015	0.047	1	8260B		7/31/2019	CJR	1
4-Chlorotoluene	< 0.018	mg/kg	0.018	0.057	1	8260B		7/31/2019	CJR	1
1,2-Dibromo-3-chloropropane	< 0.058	mg/kg	0.058	0.18	1	8260B		7/31/2019	CJR	1
Dibromochloromethane	< 0.025	mg/kg	0.025	0.079	1	8260B		7/31/2019	CJR	1
1,4-Dichlorobenzene	< 0.037	mg/kg	0.037	0.12	1	8260B		7/31/2019	CJR	1
1,3-Dichlorobenzene	< 0.037	mg/kg	0.037	0.12	1	8260B		7/31/2019	CJR	1
1,2-Dichlorobenzene	< 0.028	mg/kg	0.028	0.088	1	8260B		7/31/2019	CJR	1
Dichlorodifluoromethane	< 0.048	mg/kg	0.048	0.15	1	8260B		7/31/2019	CJR	1
1,2-Dichloroethane	< 0.038	mg/kg	0.038	0.12	1	8260B		7/31/2019	CJR	1
1,1-Dichloroethane	< 0.034	mg/kg	0.034	0.11	1	8260B		7/31/2019	CJR	1
1,1-Dichloroethene	< 0.022	mg/kg	0.022	0.069	1	8260B		7/31/2019	CJR	1
cis-1,2-Dichloroethene	< 0.032	mg/kg	0.032	0.1	1	8260B		7/31/2019	CJR	1
trans-1,2-Dichloroethene	< 0.028	mg/kg	0.028	0.09	1	8260B		7/31/2019	CJR	1
1,2-Dichloropropane	< 0.035	mg/kg	0.035	0.11	1	8260B		7/31/2019	CJR	1
1,3-Dichloropropane	< 0.025	mg/kg	0.025	0.079	1	8260B		7/31/2019	CJR	1
trans-1,3-Dichloropropene	< 0.022	mg/kg	0.022	0.068	1	8260B		7/31/2019	CJR	1
cis-1,3-Dichloropropene	< 0.039	mg/kg	0.039	0.12	1	8260B		7/31/2019	CJR	1
Di-isopropyl ether	< 0.01	mg/kg	0.01	0.032	1	8260B		7/31/2019	CJR	1
EDB (1,2-Dibromoethane)	< 0.023	mg/kg	0.023	0.072	1	8260B		7/31/2019	CJR	1
Ethylbenzene	< 0.035	mg/kg	0.035	0.11	1	8260B		7/31/2019	CJR	1
Hexachlorobutadiene	< 0.085	mg/kg	0.085	0.27	1	8260B		7/31/2019	CJR	1
Isopropylbenzene	< 0.034	mg/kg	0.034	0.11	1	8260B		7/31/2019	CJR	1
p-Isopropyltoluene	< 0.029	mg/kg	0.029	0.093	1	8260B		7/31/2019	CJR	1
Methylene chloride	< 0.15	mg/kg	0.15	0.46	1	8260B		7/31/2019	CJR	1
Methyl tert-butyl ether (MTBE)	< 0.05	mg/kg	0.05	0.16	1	8260B		7/31/2019	CJR	1
Naphthalene	< 0.094	mg/kg	0.094	0.3	1	8260B		7/31/2019	CJR	1
n-Propylbenzene	< 0.033	mg/kg	0.033	0.1	1	8260B		7/31/2019	CJR	1
1,1,2,2-Tetrachloroethane	< 0.028	mg/kg	0.028	0.88	1	8260B		7/31/2019	CJR	1
1,1,1,2-Tetrachloroethane	< 0.028	mg/kg	0.028	0.09	1	8260B		7/31/2019	CJR	1

Project Name KLINKE CLEANERS
Project # 6274

Invoice # E36534

Lab Code 5036534J
Sample ID 6274-WS-4 (4')
Sample Matrix Soil
Sample Date 7/23/2019

	Result	Unit	LOD	LOQ	Dil	Method	Ext Date	Run Date	Analyst	Code
Tetrachloroethene	< 0.032	mg/kg	0.032	0.1	1	8260B		7/31/2019	CJR	1
Toluene	< 0.032	mg/kg	0.032	0.1	1	8260B		7/31/2019	CJR	1
1,2,4-Trichlorobenzene	< 0.064	mg/kg	0.064	0.2	1	8260B		7/31/2019	CJR	1
1,2,3-Trichlorobenzene	< 0.066	mg/kg	0.066	0.21	1	8260B		7/31/2019	CJR	1
1,1,1-Trichloroethane	< 0.03	mg/kg	0.03	0.96	1	8260B		7/31/2019	CJR	1
1,1,2-Trichloroethane	< 0.033	mg/kg	0.033	0.11	1	8260B		7/31/2019	CJR	1
Trichloroethene (TCE)	< 0.041	mg/kg	0.041	0.13	1	8260B		7/31/2019	CJR	1
Trichlorofluoromethane	< 0.041	mg/kg	0.041	0.13	1	8260B		7/31/2019	CJR	1
1,2,4-Trimethylbenzene	< 0.025	mg/kg	0.025	0.08	1	8260B		7/31/2019	CJR	1
1,3,5-Trimethylbenzene	< 0.032	mg/kg	0.032	0.1	1	8260B		7/31/2019	CJR	1
Vinyl Chloride	< 0.019	mg/kg	0.019	0.062	1	8260B		7/31/2019	CJR	1
m&p-Xylene	< 0.072	mg/kg	0.072	0.23	1	8260B		7/31/2019	CJR	1
o-Xylene	< 0.044	mg/kg	0.044	0.14	1	8260B		7/31/2019	CJR	1
SUR - Toluene-d8	99	Rec %			1	8260B		7/31/2019	CJR	1
SUR - Dibromofluoromethane	100	Rec %			1	8260B		7/31/2019	CJR	1
SUR - 1,2-Dichloroethane-d4	104	Rec %			1	8260B		7/31/2019	CJR	1
SUR - 4-Bromofluorobenzene	96	Rec %			1	8260B		7/31/2019	CJR	1

Project Name KLINKE CLEANERS
Project # 6274

Invoice # E36534

Lab Code 5036534K
Sample ID 6274-WS-5 (4')
Sample Matrix Soil
Sample Date 7/23/2019

	Result	Unit	LOD	LOQ	Dil	Method	Ext Date	Run Date	Analyst	Code
General										
General										
Solids Percent	97.8	%			1	5021		7/26/2019	NJC	1
Organic										
VOC's										
Benzene	< 0.03	mg/kg	0.03	0.096	1	8260B		7/31/2019	CJR	1
Bromobenzene	< 0.025	mg/kg	0.025	0.081	1	8260B		7/31/2019	CJR	1
Bromodichloromethane	< 0.074	mg/kg	0.074	0.24	1	8260B		7/31/2019	CJR	1
Bromoform	< 0.029	mg/kg	0.029	0.092	1	8260B		7/31/2019	CJR	1
tert-Butylbenzene	< 0.026	mg/kg	0.026	0.084	1	8260B		7/31/2019	CJR	1
sec-Butylbenzene	< 0.033	mg/kg	0.033	0.1	1	8260B		7/31/2019	CJR	1
n-Butylbenzene	< 0.04	mg/kg	0.04	0.13	1	8260B		7/31/2019	CJR	1
Carbon Tetrachloride	< 0.016	mg/kg	0.016	0.053	1	8260B		7/31/2019	CJR	1
Chlorobenzene	< 0.013	mg/kg	0.013	0.04	1	8260B		7/31/2019	CJR	1
Chloroethane	< 0.091	mg/kg	0.091	0.29	1	8260B		7/31/2019	CJR	1
Chloroform	< 0.035	mg/kg	0.035	0.11	1	8260B		7/31/2019	CJR	1
Chloromethane	< 0.076	mg/kg	0.076	0.24	1	8260B		7/31/2019	CJR	1
2-Chlorotoluene	< 0.015	mg/kg	0.015	0.047	1	8260B		7/31/2019	CJR	1
4-Chlorotoluene	< 0.018	mg/kg	0.018	0.057	1	8260B		7/31/2019	CJR	1
1,2-Dibromo-3-chloropropane	< 0.058	mg/kg	0.058	0.18	1	8260B		7/31/2019	CJR	1
Dibromochloromethane	< 0.025	mg/kg	0.025	0.079	1	8260B		7/31/2019	CJR	1
1,4-Dichlorobenzene	< 0.037	mg/kg	0.037	0.12	1	8260B		7/31/2019	CJR	1
1,3-Dichlorobenzene	< 0.037	mg/kg	0.037	0.12	1	8260B		7/31/2019	CJR	1
1,2-Dichlorobenzene	< 0.028	mg/kg	0.028	0.088	1	8260B		7/31/2019	CJR	1
Dichlorodifluoromethane	< 0.048	mg/kg	0.048	0.15	1	8260B		7/31/2019	CJR	1
1,2-Dichloroethane	< 0.038	mg/kg	0.038	0.12	1	8260B		7/31/2019	CJR	1
1,1-Dichloroethane	< 0.034	mg/kg	0.034	0.11	1	8260B		7/31/2019	CJR	1
1,1-Dichloroethene	< 0.022	mg/kg	0.022	0.069	1	8260B		7/31/2019	CJR	1
cis-1,2-Dichloroethene	< 0.032	mg/kg	0.032	0.1	1	8260B		7/31/2019	CJR	1
trans-1,2-Dichloroethene	< 0.028	mg/kg	0.028	0.09	1	8260B		7/31/2019	CJR	1
1,2-Dichloropropane	< 0.035	mg/kg	0.035	0.11	1	8260B		7/31/2019	CJR	1
1,3-Dichloropropane	< 0.025	mg/kg	0.025	0.079	1	8260B		7/31/2019	CJR	1
trans-1,3-Dichloropropene	< 0.022	mg/kg	0.022	0.068	1	8260B		7/31/2019	CJR	1
cis-1,3-Dichloropropene	< 0.039	mg/kg	0.039	0.12	1	8260B		7/31/2019	CJR	1
Di-isopropyl ether	< 0.01	mg/kg	0.01	0.032	1	8260B		7/31/2019	CJR	1
EDB (1,2-Dibromoethane)	< 0.023	mg/kg	0.023	0.072	1	8260B		7/31/2019	CJR	1
Ethylbenzene	< 0.035	mg/kg	0.035	0.11	1	8260B		7/31/2019	CJR	1
Hexachlorobutadiene	< 0.085	mg/kg	0.085	0.27	1	8260B		7/31/2019	CJR	1
Isopropylbenzene	< 0.034	mg/kg	0.034	0.11	1	8260B		7/31/2019	CJR	1
p-Isopropyltoluene	< 0.029	mg/kg	0.029	0.093	1	8260B		7/31/2019	CJR	1
Methylene chloride	< 0.15	mg/kg	0.15	0.46	1	8260B		7/31/2019	CJR	1
Methyl tert-butyl ether (MTBE)	< 0.05	mg/kg	0.05	0.16	1	8260B		7/31/2019	CJR	1
Naphthalene	< 0.094	mg/kg	0.094	0.3	1	8260B		7/31/2019	CJR	1
n-Propylbenzene	< 0.033	mg/kg	0.033	0.1	1	8260B		7/31/2019	CJR	1
1,1,2,2-Tetrachloroethane	< 0.028	mg/kg	0.028	0.88	1	8260B		7/31/2019	CJR	1
1,1,1,2-Tetrachloroethane	< 0.028	mg/kg	0.028	0.09	1	8260B		7/31/2019	CJR	1

Project Name KLINKE CLEANERS
Project # 6274

Invoice # E36534

Lab Code 5036534K
Sample ID 6274-WS-5 (4')
Sample Matrix Soil
Sample Date 7/23/2019

	Result	Unit	LOD	LOQ	Dil	Method	Ext Date	Run Date	Analyst	Code
Tetrachloroethene	< 0.032	mg/kg	0.032	0.1	1	8260B		7/31/2019	CJR	1
Toluene	< 0.032	mg/kg	0.032	0.1	1	8260B		7/31/2019	CJR	1
1,2,4-Trichlorobenzene	< 0.064	mg/kg	0.064	0.2	1	8260B		7/31/2019	CJR	1
1,2,3-Trichlorobenzene	< 0.066	mg/kg	0.066	0.21	1	8260B		7/31/2019	CJR	1
1,1,1-Trichloroethane	< 0.03	mg/kg	0.03	0.96	1	8260B		7/31/2019	CJR	1
1,1,2-Trichloroethane	< 0.033	mg/kg	0.033	0.11	1	8260B		7/31/2019	CJR	1
Trichloroethene (TCE)	< 0.041	mg/kg	0.041	0.13	1	8260B		7/31/2019	CJR	1
Trichlorofluoromethane	< 0.041	mg/kg	0.041	0.13	1	8260B		7/31/2019	CJR	1
1,2,4-Trimethylbenzene	< 0.025	mg/kg	0.025	0.08	1	8260B		7/31/2019	CJR	1
1,3,5-Trimethylbenzene	< 0.032	mg/kg	0.032	0.1	1	8260B		7/31/2019	CJR	1
Vinyl Chloride	< 0.019	mg/kg	0.019	0.062	1	8260B		7/31/2019	CJR	1
m&p-Xylene	< 0.072	mg/kg	0.072	0.23	1	8260B		7/31/2019	CJR	1
o-Xylene	< 0.044	mg/kg	0.044	0.14	1	8260B		7/31/2019	CJR	1
SUR - 1,2-Dichloroethane-d4	100	Rec %			1	8260B		7/31/2019	CJR	1
SUR - Toluene-d8	96	Rec %			1	8260B		7/31/2019	CJR	1
SUR - Dibromofluoromethane	98	Rec %			1	8260B		7/31/2019	CJR	1
SUR - 4-Bromofluorobenzene	94	Rec %			1	8260B		7/31/2019	CJR	1

Project Name KLINKE CLEANERS
Project # 6274

Invoice # E36534

Lab Code 5036534L
Sample ID 6274-WS-6 (4')
Sample Matrix Soil
Sample Date 7/23/2019

	Result	Unit	LOD	LOQ	Dil	Method	Ext Date	Run Date	Analyst	Code
General										
General										
Solids Percent	83.9	%			1	5021		7/26/2019	NJC	1
Organic										
VOC's										
Benzene	< 0.03	mg/kg	0.03	0.096	1	8260B		7/31/2019	CJR	1
Bromobenzene	< 0.025	mg/kg	0.025	0.081	1	8260B		7/31/2019	CJR	1
Bromodichloromethane	< 0.074	mg/kg	0.074	0.24	1	8260B		7/31/2019	CJR	1
Bromoform	< 0.029	mg/kg	0.029	0.092	1	8260B		7/31/2019	CJR	1
tert-Butylbenzene	< 0.026	mg/kg	0.026	0.084	1	8260B		7/31/2019	CJR	1
sec-Butylbenzene	< 0.033	mg/kg	0.033	0.1	1	8260B		7/31/2019	CJR	1
n-Butylbenzene	< 0.04	mg/kg	0.04	0.13	1	8260B		7/31/2019	CJR	1
Carbon Tetrachloride	< 0.016	mg/kg	0.016	0.053	1	8260B		7/31/2019	CJR	1
Chlorobenzene	< 0.013	mg/kg	0.013	0.04	1	8260B		7/31/2019	CJR	1
Chloroethane	< 0.091	mg/kg	0.091	0.29	1	8260B		7/31/2019	CJR	1
Chloroform	< 0.035	mg/kg	0.035	0.11	1	8260B		7/31/2019	CJR	1
Chloromethane	< 0.076	mg/kg	0.076	0.24	1	8260B		7/31/2019	CJR	1
2-Chlorotoluene	< 0.015	mg/kg	0.015	0.047	1	8260B		7/31/2019	CJR	1
4-Chlorotoluene	< 0.018	mg/kg	0.018	0.057	1	8260B		7/31/2019	CJR	1
1,2-Dibromo-3-chloropropane	< 0.058	mg/kg	0.058	0.18	1	8260B		7/31/2019	CJR	1
Dibromochloromethane	< 0.025	mg/kg	0.025	0.079	1	8260B		7/31/2019	CJR	1
1,4-Dichlorobenzene	< 0.037	mg/kg	0.037	0.12	1	8260B		7/31/2019	CJR	1
1,3-Dichlorobenzene	< 0.037	mg/kg	0.037	0.12	1	8260B		7/31/2019	CJR	1
1,2-Dichlorobenzene	< 0.028	mg/kg	0.028	0.088	1	8260B		7/31/2019	CJR	1
Dichlorodifluoromethane	< 0.048	mg/kg	0.048	0.15	1	8260B		7/31/2019	CJR	1
1,2-Dichloroethane	< 0.038	mg/kg	0.038	0.12	1	8260B		7/31/2019	CJR	1
1,1-Dichloroethane	< 0.034	mg/kg	0.034	0.11	1	8260B		7/31/2019	CJR	1
1,1-Dichloroethene	< 0.022	mg/kg	0.022	0.069	1	8260B		7/31/2019	CJR	1
cis-1,2-Dichloroethene	< 0.032	mg/kg	0.032	0.1	1	8260B		7/31/2019	CJR	1
trans-1,2-Dichloroethene	< 0.028	mg/kg	0.028	0.09	1	8260B		7/31/2019	CJR	1
1,2-Dichloropropane	< 0.035	mg/kg	0.035	0.11	1	8260B		7/31/2019	CJR	1
1,3-Dichloropropane	< 0.025	mg/kg	0.025	0.079	1	8260B		7/31/2019	CJR	1
trans-1,3-Dichloropropene	< 0.022	mg/kg	0.022	0.068	1	8260B		7/31/2019	CJR	1
cis-1,3-Dichloropropene	< 0.039	mg/kg	0.039	0.12	1	8260B		7/31/2019	CJR	1
Di-isopropyl ether	< 0.01	mg/kg	0.01	0.032	1	8260B		7/31/2019	CJR	1
EDB (1,2-Dibromoethane)	< 0.023	mg/kg	0.023	0.072	1	8260B		7/31/2019	CJR	1
Ethylbenzene	< 0.035	mg/kg	0.035	0.11	1	8260B		7/31/2019	CJR	1
Hexachlorobutadiene	< 0.085	mg/kg	0.085	0.27	1	8260B		7/31/2019	CJR	1
Isopropylbenzene	< 0.034	mg/kg	0.034	0.11	1	8260B		7/31/2019	CJR	1
p-Isopropyltoluene	< 0.029	mg/kg	0.029	0.093	1	8260B		7/31/2019	CJR	1
Methylene chloride	< 0.15	mg/kg	0.15	0.46	1	8260B		7/31/2019	CJR	1
Methyl tert-butyl ether (MTBE)	< 0.05	mg/kg	0.05	0.16	1	8260B		7/31/2019	CJR	1
Naphthalene	< 0.094	mg/kg	0.094	0.3	1	8260B		7/31/2019	CJR	1
n-Propylbenzene	< 0.033	mg/kg	0.033	0.1	1	8260B		7/31/2019	CJR	1
1,1,2,2-Tetrachloroethane	< 0.028	mg/kg	0.028	0.88	1	8260B		7/31/2019	CJR	1
1,1,1,2-Tetrachloroethane	< 0.028	mg/kg	0.028	0.09	1	8260B		7/31/2019	CJR	1

Project Name KLINKE CLEANERS
Project # 6274

Invoice # E36534

Lab Code 5036534L
Sample ID 6274-WS-6 (4')
Sample Matrix Soil
Sample Date 7/23/2019

	Result	Unit	LOD	LOQ	Dil	Method	Ext Date	Run Date	Analyst	Code
Tetrachloroethene	0.91	mg/kg	0.032	0.1	1	8260B		7/31/2019	CJR	1
Toluene	< 0.032	mg/kg	0.032	0.1	1	8260B		7/31/2019	CJR	1
1,2,4-Trichlorobenzene	< 0.064	mg/kg	0.064	0.2	1	8260B		7/31/2019	CJR	1
1,2,3-Trichlorobenzene	< 0.066	mg/kg	0.066	0.21	1	8260B		7/31/2019	CJR	1
1,1,1-Trichloroethane	< 0.03	mg/kg	0.03	0.96	1	8260B		7/31/2019	CJR	1
1,1,2-Trichloroethane	< 0.033	mg/kg	0.033	0.11	1	8260B		7/31/2019	CJR	1
Trichloroethene (TCE)	< 0.041	mg/kg	0.041	0.13	1	8260B		7/31/2019	CJR	1
Trichlorofluoromethane	< 0.041	mg/kg	0.041	0.13	1	8260B		7/31/2019	CJR	1
1,2,4-Trimethylbenzene	< 0.025	mg/kg	0.025	0.08	1	8260B		7/31/2019	CJR	1
1,3,5-Trimethylbenzene	< 0.032	mg/kg	0.032	0.1	1	8260B		7/31/2019	CJR	1
Vinyl Chloride	< 0.019	mg/kg	0.019	0.062	1	8260B		7/31/2019	CJR	1
m&p-Xylene	< 0.072	mg/kg	0.072	0.23	1	8260B		7/31/2019	CJR	1
o-Xylene	< 0.044	mg/kg	0.044	0.14	1	8260B		7/31/2019	CJR	1
SUR - 4-Bromofluorobenzene	94	Rec %			1	8260B		7/31/2019	CJR	1
SUR - Dibromofluoromethane	100	Rec %			1	8260B		7/31/2019	CJR	1
SUR - 1,2-Dichloroethane-d4	103	Rec %			1	8260B		7/31/2019	CJR	1
SUR - Toluene-d8	97	Rec %			1	8260B		7/31/2019	CJR	1

Project Name KLINKE CLEANERS
Project # 6274

Invoice # E36534

Lab Code 5036534M
Sample ID 6274-TB
Sample Matrix Soil
Sample Date 7/23/2019

	Result	Unit	LOD	LOQ	Dil	Method	Ext Date	Run Date	Analyst	Code
Organic										
VOC's										
Benzene	< 0.03	mg/kg	0.03	0.096	1	8260B		7/30/2019	CJR	1
Bromobenzene	< 0.025	mg/kg	0.025	0.081	1	8260B		7/30/2019	CJR	1
Bromodichloromethane	< 0.074	mg/kg	0.074	0.24	1	8260B		7/30/2019	CJR	1
Bromoform	< 0.029	mg/kg	0.029	0.092	1	8260B		7/30/2019	CJR	1
tert-Butylbenzene	< 0.026	mg/kg	0.026	0.084	1	8260B		7/30/2019	CJR	1
sec-Butylbenzene	< 0.033	mg/kg	0.033	0.1	1	8260B		7/30/2019	CJR	1
n-Butylbenzene	< 0.04	mg/kg	0.04	0.13	1	8260B		7/30/2019	CJR	1
Carbon Tetrachloride	< 0.016	mg/kg	0.016	0.053	1	8260B		7/30/2019	CJR	1
Chlorobenzene	< 0.013	mg/kg	0.013	0.04	1	8260B		7/30/2019	CJR	1
Chloroethane	< 0.091	mg/kg	0.091	0.29	1	8260B		7/30/2019	CJR	1
Chloroform	< 0.035	mg/kg	0.035	0.11	1	8260B		7/30/2019	CJR	1
Chloromethane	< 0.076	mg/kg	0.076	0.24	1	8260B		7/30/2019	CJR	1
2-Chlorotoluene	< 0.015	mg/kg	0.015	0.047	1	8260B		7/30/2019	CJR	1
4-Chlorotoluene	< 0.018	mg/kg	0.018	0.057	1	8260B		7/30/2019	CJR	1
1,2-Dibromo-3-chloropropane	< 0.058	mg/kg	0.058	0.18	1	8260B		7/30/2019	CJR	1
Dibromochloromethane	< 0.025	mg/kg	0.025	0.079	1	8260B		7/30/2019	CJR	1
1,4-Dichlorobenzene	< 0.037	mg/kg	0.037	0.12	1	8260B		7/30/2019	CJR	1
1,3-Dichlorobenzene	< 0.037	mg/kg	0.037	0.12	1	8260B		7/30/2019	CJR	1
1,2-Dichlorobenzene	< 0.028	mg/kg	0.028	0.088	1	8260B		7/30/2019	CJR	1
Dichlorodifluoromethane	< 0.048	mg/kg	0.048	0.15	1	8260B		7/30/2019	CJR	1
1,2-Dichloroethane	< 0.038	mg/kg	0.038	0.12	1	8260B		7/30/2019	CJR	1
1,1-Dichloroethane	< 0.034	mg/kg	0.034	0.11	1	8260B		7/30/2019	CJR	1
1,1-Dichloroethene	< 0.022	mg/kg	0.022	0.069	1	8260B		7/30/2019	CJR	1
cis-1,2-Dichloroethene	< 0.032	mg/kg	0.032	0.1	1	8260B		7/30/2019	CJR	1
trans-1,2-Dichloroethene	< 0.028	mg/kg	0.028	0.09	1	8260B		7/30/2019	CJR	1
1,2-Dichloropropane	< 0.035	mg/kg	0.035	0.11	1	8260B		7/30/2019	CJR	1
1,3-Dichloropropane	< 0.025	mg/kg	0.025	0.079	1	8260B		7/30/2019	CJR	1
trans-1,3-Dichloropropene	< 0.022	mg/kg	0.022	0.068	1	8260B		7/30/2019	CJR	1
cis-1,3-Dichloropropene	< 0.039	mg/kg	0.039	0.12	1	8260B		7/30/2019	CJR	1
Di-isopropyl ether	< 0.01	mg/kg	0.01	0.032	1	8260B		7/30/2019	CJR	1
EDB (1,2-Dibromoethane)	< 0.023	mg/kg	0.023	0.072	1	8260B		7/30/2019	CJR	1
Ethylbenzene	< 0.035	mg/kg	0.035	0.11	1	8260B		7/30/2019	CJR	1
Hexachlorobutadiene	< 0.085	mg/kg	0.085	0.27	1	8260B		7/30/2019	CJR	1
Isopropylbenzene	< 0.034	mg/kg	0.034	0.11	1	8260B		7/30/2019	CJR	1
p-Isopropyltoluene	< 0.029	mg/kg	0.029	0.093	1	8260B		7/30/2019	CJR	1
Methylene chloride	< 0.15	mg/kg	0.15	0.46	1	8260B		7/30/2019	CJR	1
Methyl tert-butyl ether (MTBE)	< 0.05	mg/kg	0.05	0.16	1	8260B		7/30/2019	CJR	1
Naphthalene	< 0.094	mg/kg	0.094	0.3	1	8260B		7/30/2019	CJR	1
n-Propylbenzene	< 0.033	mg/kg	0.033	0.1	1	8260B		7/30/2019	CJR	1
1,1,2,2-Tetrachloroethane	< 0.028	mg/kg	0.028	0.88	1	8260B		7/30/2019	CJR	1
1,1,1,2-Tetrachloroethane	< 0.028	mg/kg	0.028	0.09	1	8260B		7/30/2019	CJR	1
Tetrachloroethene	< 0.032	mg/kg	0.032	0.1	1	8260B		7/30/2019	CJR	1
Toluene	< 0.032	mg/kg	0.032	0.1	1	8260B		7/30/2019	CJR	1
1,2,4-Trichlorobenzene	< 0.064	mg/kg	0.064	0.2	1	8260B		7/30/2019	CJR	1

Project Name KLINKE CLEANERS
Project # 6274

Invoice # E36534

Lab Code 5036534M
Sample ID 6274-TB
Sample Matrix Soil
Sample Date 7/23/2019

	Result	Unit	LOD	LOQ	Dil	Method	Ext Date	Run Date	Analyst	Code
1,2,3-Trichlorobenzene	< 0.066	mg/kg	0.066	0.21	1	8260B		7/30/2019	CJR	1
1,1,1-Trichloroethane	< 0.03	mg/kg	0.03	0.96	1	8260B		7/30/2019	CJR	1
1,1,2-Trichloroethane	< 0.033	mg/kg	0.033	0.11	1	8260B		7/30/2019	CJR	1
Trichloroethene (TCE)	< 0.041	mg/kg	0.041	0.13	1	8260B		7/30/2019	CJR	1
Trichlorofluoromethane	< 0.041	mg/kg	0.041	0.13	1	8260B		7/30/2019	CJR	1
1,2,4-Trimethylbenzene	< 0.025	mg/kg	0.025	0.08	1	8260B		7/30/2019	CJR	1
1,3,5-Trimethylbenzene	< 0.032	mg/kg	0.032	0.1	1	8260B		7/30/2019	CJR	1
Vinyl Chloride	< 0.019	mg/kg	0.019	0.062	1	8260B		7/30/2019	CJR	1
m&p-Xylene	< 0.072	mg/kg	0.072	0.23	1	8260B		7/30/2019	CJR	1
o-Xylene	< 0.044	mg/kg	0.044	0.14	1	8260B		7/30/2019	CJR	1
SUR - Toluene-d8	100	Rec %			1	8260B		7/30/2019	CJR	1
SUR - 1,2-Dichloroethane-d4	101	Rec %			1	8260B		7/30/2019	CJR	1
SUR - 4-Bromofluorobenzene	94	Rec %			1	8260B		7/30/2019	CJR	1
SUR - Dibromofluoromethane	101	Rec %			1	8260B		7/30/2019	CJR	1

"J" Flag: Analyte detected between LOD and LOQ

LOD Limit of Detection

LOQ Limit of Quantitation

<i>Code</i>	<i>Comment</i>
1	Laboratory QC within limits.

All solid sample results reported on a dry weight basis unless otherwise indicated. All LOD's and LOQ's are adjusted for dilutions but not dry weight. Subcontracted results are denoted by SUB in the analyst field.

Authorized Signature

Environmental Lab, Inc.

1990 Prospect Ct. • Appleton, WI 54914
920-830-2455 • FAX 920-733-0631

Sample Handling Request
 Rush Analysis Date Required _____
 (Rushes accepted only with prior authorization)
 Normal Turn Around

Lab I.D. # _____
 Account No.: _____ Quote No.: _____
 Project #: 6274
 Sampler: (signature) [Signature]

Project (Name / Location): Klinke Cleaners / 1295 N. Sherman Ave., Madison WI

Reports To: R. Hoyerman / B. Kappen Invoice To: _____
 Company: Enviroforensics Company: _____
 Address: W16W23390 Stone Ridge Dr. Address: _____
 City State Zip: Waukesha, WI City State Zip: _____
 Phone: 262-745-5054 Phone: _____
 FAX: _____ FAX: _____

Analysis Requested										Other Analysis															
Lab I.D.	Sample I.D.	Collection Date	Time	Comp	Grab	Filtered Y/N	No. of Containers	Sample Type (Matrix)*	Preservation	DRO (Mod DRO Sep 95)	GRO (Mod GRO Sep 95)	LEAD	NITRATE/NITRITE	OIL & GREASE	PAH (EPA 8270)	PCB	PVOC (EPA 8021)	PVOC + NAPHTHALENE	SULFATE	TOTAL SUSPENDED SOLIDS	VOC DW (EPA 524-2)	VOC (EPA 8260)	8-PCRA METALS	PID/FID	
S-36524K	6274-W5-5(4)	7-23	1007		X	N	2	S	MeOH																
	L 6274-W5-6(4)	7-23	1230		X	N	2	S	MeOH																
	M 6274-TB	-	-		X	N	1	S	MeOH																

Comments/Special Instructions (*Specify groundwater "GW", Drinking Water "DW", Waste Water "WW", Soil "S", Air "A", Oil, Sludge etc.)

Standard rate project. PO # 2019-0698

Sample Integrity - To be completed by receiving lab.
 Method of Shipment: Cold
 Temp. of Temp. Blank _____ °C On Ice: 6
 Cooler seal intact upon receipt: Yes _____ No

Relinquished By: (sign) [Signature] Time 1125 Date 7/24/19
 Received By: (sign) Gold Cross Time 1125 Date 7/24/19
 Received in Laboratory By: [Signature] Time: 8:00 AM Date: 7-25-19