

Legend

- Property boundary
- Former dry cleaning machine location (approximate)
- MW-1 Water table monitoring well
- 851.40 Water table elevation contour
- 851.89 Groundwater elevation in feet AMSL

Note:
 AMSL = Above Mean Sea Level

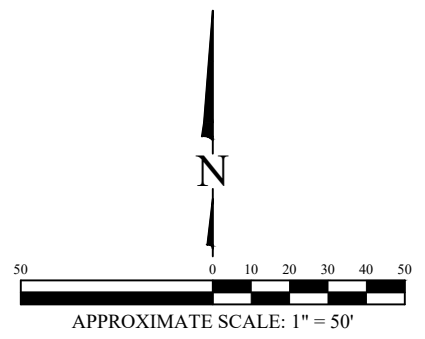

WATER TABLE CONTOUR MAP
FEBRUARY 4, 2020

Klinke Cleaners
 1295 North Sherman Avenue
 Madison, Wisconsin

Date:	2/27/20
Designed:	EB
Drawn:	EB
Checked:	BK
DWG file:	6274-0576

825 North Capitol Avenue • Indianapolis, IN 46204
 EnviroForensics.com

Figure	1
Project	6274

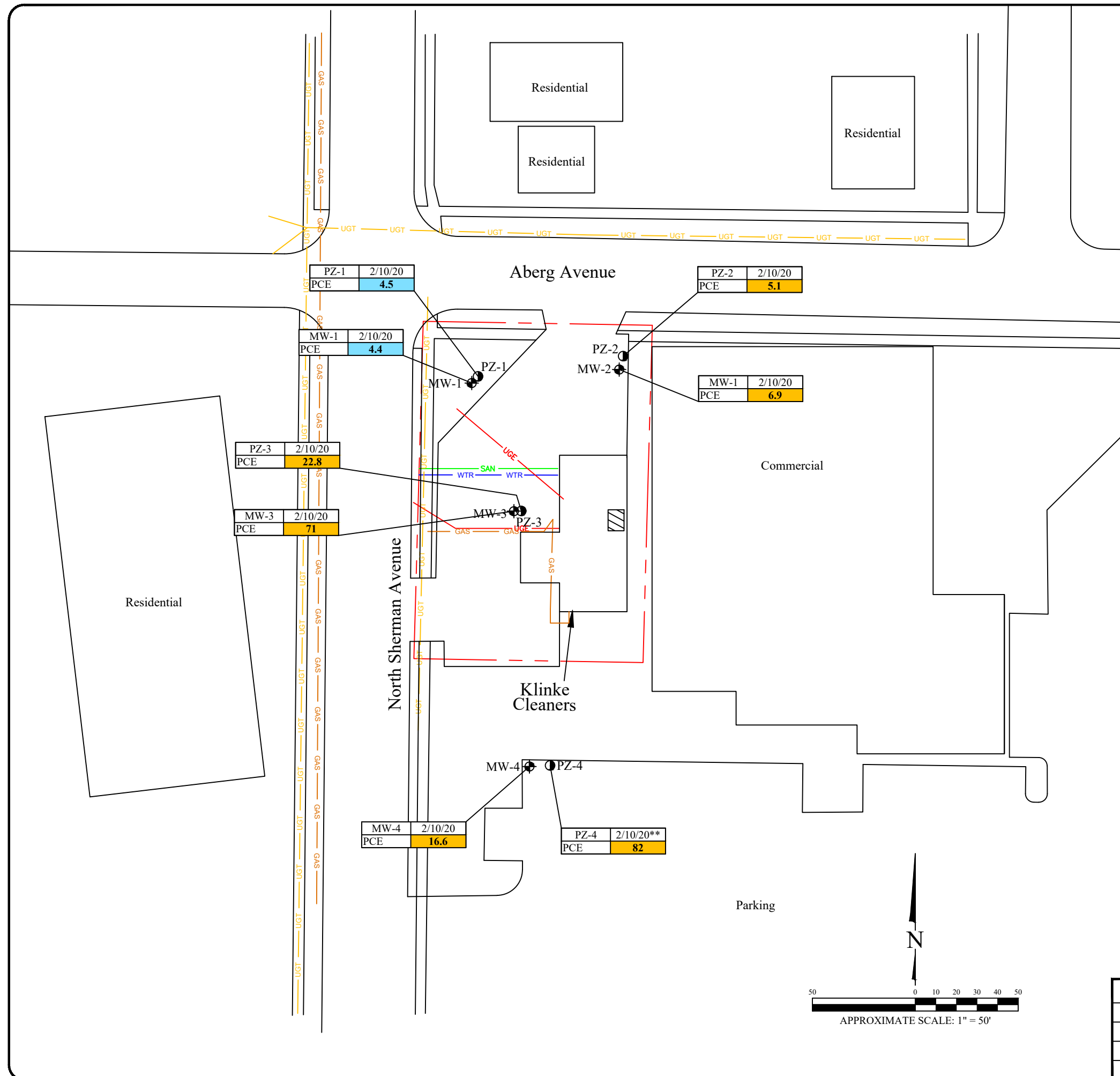

Legend

- GAS — Underground gas utility line
- WTR — Underground water utility line
- SAN — Underground sanitary utility line
- UGE — Underground electrical utility line
- UGT — Underground fiber optic line
- - - Property boundary
- Former dry cleaning machine location (approximate)

PZ-1 Soil boring/groundwater piezometer
 MW-1 Water table monitoring well

Analyte (ug/L)	Public Health Preventive Action Limit	Public Health Enforcement Standard
PCE	0.5	5

- Note:
1. Bolded and orange shaded values exceed the Public Health Enforcement Standard
 2. Bolded and blue shaded values exceed the Public Health Preventive Action Limit
 3. Bolded values are above detection limits
 4. All results reported in units of micrograms per liter (ug/L)
 5. PCE = Tetrachloroethene
 6. TCE = Trichloroethene
 7. ** = Reported concentrations are highest detected in duplicate samples

GROUNDWATER ANALYTICAL RESULTS SUMMARY

Klinke Cleaners
 1295 North Sherman Avenue
 Madison, Wisconsin

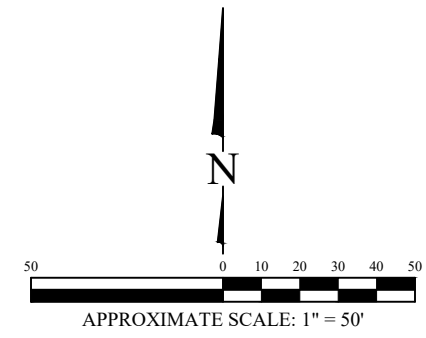

Date:	2/27/20
Designed:	EB
Drawn:	EB
Checked:	BK
DWG file:	6274-0575

825 North Capitol Avenue • Indianapolis, IN 46204
 EnviroForensics.com

Figure	2
Project	6274

MW-3 PCE Concentration Trend

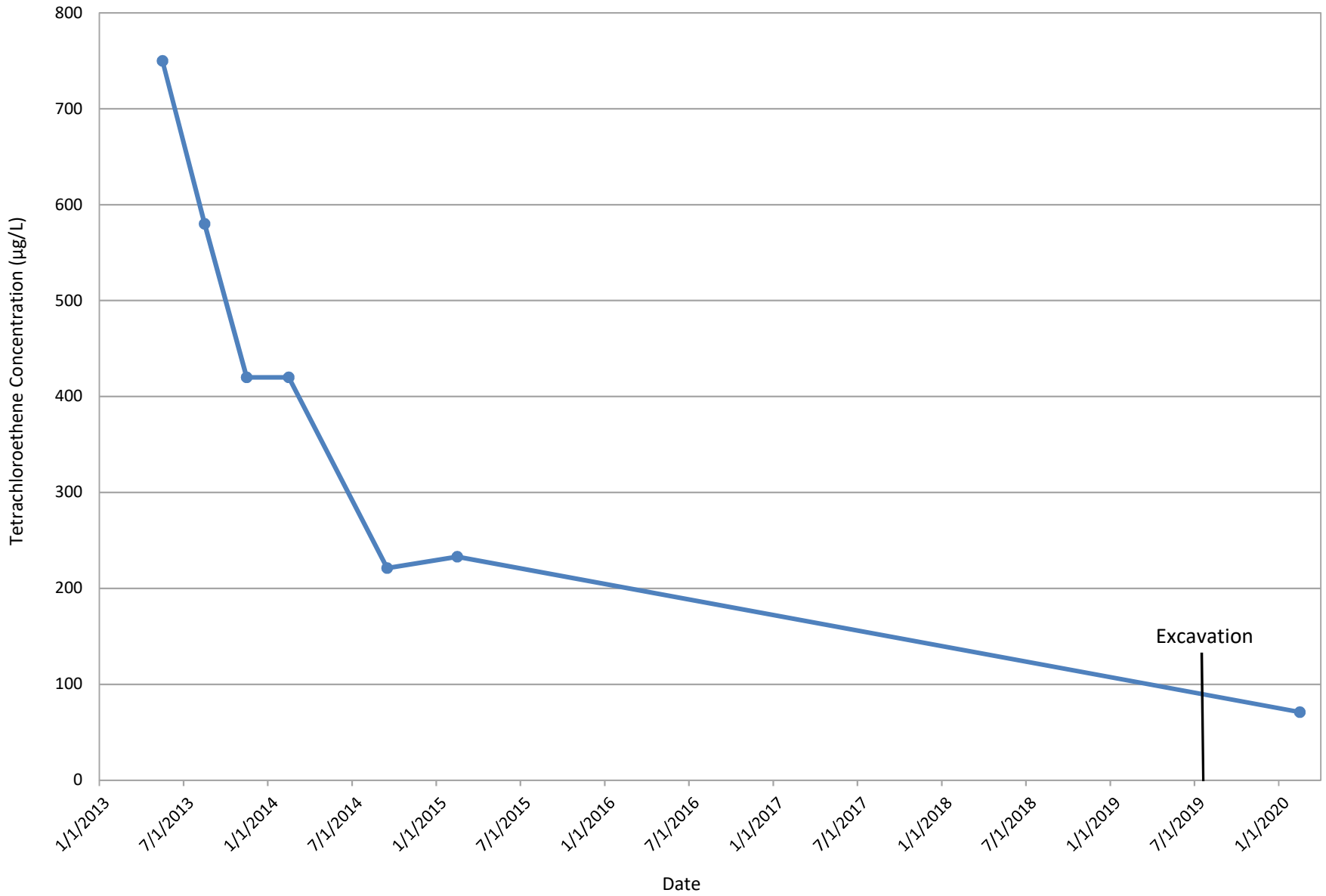

TABLE 1
SUMMARY OF GROUNDWATER SAMPLE ANALYTICAL RESULTS

Klinke Cleaners - Sherman Ave.
 Madison, Wisconsin

Well Identification	Sample Date	Tetrachloroethene	Trichloroethene	cis-1,2-Dichloroethene	Trichlorofluoromethane
Enforcement Standard		5	5	70	3,490
Preventive Action Limit		0.5	0.5	7	698
MW-1	5/21/2013	11	<0.19	<0.12	0.95 J
	8/21/2013	7.9	<0.19	<0.12	<0.19
	11/20/2013	11.6	<0.33	<0.38	0.83 J
	2/21/2014	9.8	0.42 J	<0.38	<0.35
	9/23/2014	8.9	<0.33	<0.38	<0.71
	2/4/2015	11.5	0.53 J	<0.45	<0.87
	2/10/2020	4.4	<0.3	<0.37	<0.35
MW-2	5/21/2013	3.6	<0.19	<0.12	<0.19
	8/21/2013 **	13	1.2	<0.12	<0.19
	11/20/2013	12.9	1.19	<0.38	<0.71
	2/27/2014	10.8	1.26	<0.38	<0.35
	9/23/2014	13.2	0.85 J	<0.38	<0.71
	2/3/2015	12.4	1.38 J	<0.45	<0.87
	2/10/2020	6.9	<0.3	<0.37	<0.35
MW-3	5/23/2013 **	750	2.0	2.1	4.9
	8/21/2013	580	2.2	5.7	5.6
	11/20/2013	420	<16.5	<19	<35.5
	2/21/2014 **	420	1.33	0.69 J	2.55
	9/24/2014	221	0.76 J	<0.38	<0.71
	2/4/2015	233	<4.7	<4.5	<8.7
	2/10/2020	71	<0.3	<0.37	2.38
MW-4	5/21/2013	38	0.26 J	<0.12	<0.19
	8/22/2013	81	<0.19	<0.12	<0.19
	11/20/2013	99	<0.33	<0.38	<0.71
	2/21/2014	103	0.76 J	<0.38	<0.35
	9/23/2014	183	<0.33	<0.38	<0.71
	2/4/2015	101	<0.47	<0.45	<0.87
	2/10/2020	16.6	<0.3	<0.37	<0.35
PZ-1	5/21/2013	20	0.40 J	<0.12	<0.19
	8/21/2013	15	0.27 J	<0.12	<0.19
	11/20/2013	13.6	<0.33	<0.38	<0.71
	2/21/2014	15.2	0.37 J	<0.38	<0.35
	9/23/2014	12.8	<0.33	<0.38	<0.71
	2/4/2015	11.8	<0.47	<0.45	<0.87
	2/10/2020	4.5	<0.3	<0.37	<0.35

TABLE 1
SUMMARY OF GROUNDWATER SAMPLE ANALYTICAL RESULTS

Klinke Cleaners - Sherman Ave.
 Madison, Wisconsin

Well Identification	Sample Date	Tetrachloroethene	Trichloroethene	cis-1,2-Dichloroethene	Trichlorofluoromethane
Enforcement Standard		5	5	70	3,490
Preventive Action Limit		0.5	0.5	7	698
PZ-2	5/21/2013	38	4.7	<0.12	<0.19
	8/21/2013	35	4.1	<0.12	<0.19
	11/20/2013	28.8	3.07	<0.38	<0.71
	2/27/2014	32	3.02	<0.38	<0.35
	9/24/2014	36	3.20	<0.38	<0.71
	2/3/2015	26.4	2.63	<0.45	<0.87
	2/10/2020	5.1	<0.3	<0.37	<0.35
PZ-3	5/23/2013	98	1.5	<0.12	2.5
	8/21/2013	82	1.1	<0.12	<0.19
	11/20/2013 **	64	1.03	<3.8	<7.1
	2/21/2014	21.3	0.37 J	<0.38	<0.35
	9/24/2014	65	0.70 J	<0.38	<0.71
	2/4/2015	62	0.75 J	<0.45	<0.87
	2/10/2020	22.8	<0.3	<0.37	<0.35
PZ-4	5/21/2013	180	1.9	<0.12	<0.19
	8/21/2013	210	1.9	<0.12	<0.19
	11/20/2013	173	3.8 J	<3.8	<7.1
	2/21/2014	200	2.84	<0.38	<0.35
	9/23/2014	184	2.15 J	<1.9	<3.55
	2/3/2015	280	1.67	<0.45	<0.87
	2/10/2020 **	82	<0.3	<0.37	0.70 J

Notes:

All concentrations reported in micrograms per liter (µg/l)

Samples analyzed using EPA SW-846 Method 8260

Bolded values are above the laboratory detection limit

Bolded and blue shaded values exceed the Public Health Preventive Action Limit

Bolded and orange shaded values exceed the Public Health Enforcement Standard

Public Health standards are listed in Wisconsin Administrative Code (WAC) Chapter NR 140

** = Reported concentrations are the highest detected in duplicate samples

J = Analyte concentration between the laboratory Method Detection Limit and Reporting Limit

NE = Not Established