

**From:** [Ken Ebbott](#)  
**To:** [Hnat, John J - DNR](#)  
**Cc:** [Ken Ebbott](#); [tschafer@wi.rr.com](mailto:tschafer@wi.rr.com)  
**Subject:** Proposed Well Locations, Shorewood Queensway Cleaners 4300 N Oakland BRRTS 02-41-552089  
**Date:** Friday, August 7, 2020 12:03:13 PM  
**Attachments:** [Proposed Monitoring Wells August 2020.pdf](#)

---

John,

We're all done with the digging at Shorewood Queensway Cleaners, and are going to install the replacement wells and piezometers next Friday – Aug 14.

Attached is a crude map of the existing wells in Blue, and the proposed new wells in Yellow Text Boxes, with the rough excavation boundaries shown. I have a better figure in prep, but it isn't available yet, but this figure generally shows where we dug and depths.

For the new five wells- there are two well nests – shallow well at 13' with a 10' screen, deeper piezo at 30' with a 5' screen. The nests are about where we removed prior wells – the shallow wells will be mostly in fill, as we dug to 14' and 18' at the proposed well locations for MW-5R and 3R, respectively.

I've also added another well to go into the former tank area on the southwest part of the site. We dug out the smelly soils, but I'm still waiting on the perimeter lab results from there to see what may be left behind. That water table well will be 13' deep with a 10' screen.

Depth to water historically at the site has been about 2 to 7 feet or so – depending on the well, and flow has been to the north / northwest, except on the far southeast part of the site, there seemed to be a component of flow to the southeast. I will resurvey all the well elevations once we get the new wells in.

I also installed a 4" diameter sump in the backfill – I'll sample it for VOCs, at least in this initial round. I like to have a 4" access to the backfilled area in case we need to try something creative to treat the groundwater post-excavation, if groundwater concentrations aren't as clean as expected.

Let me know your thoughts about the well locations before I drill on Friday.

Thanks –

Ken

Regards,

**Ken Ebbott, PG, CGWP**

**Senior Project Manager/Senior Geologist**

**Sand Creek Consultants, Inc.** | W5877 Pheasant Lane | Plymouth, WI 53073

main 920.918.9024 | fax 866.608.6473

[www.sand-creek.com](http://www.sand-creek.com) | [ken.ebbott@sand-creek.com](mailto:ken.ebbott@sand-creek.com)

**Sand Creek Consultants, Inc.** | Environmental and Geological Scientists and Engineers  
*Solutions in Green Site Remediation, Sustainability, and Phytoremediation since 1995*



**PROPOSED  
2020  
EXCAVATION  
AND SAMPLE  
LOCATIONS**

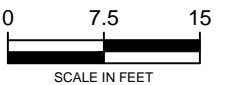

**SHOREWOOD  
QUEENSWAY CLEANERS  
4300 N. OAKLAND AVE.  
SHOREWOOD, WI**

DATE: JULY 2020  
SCALE: 1"=15'  
DRAWN BY: KAP  
APPROVED: KE

**FIGURE 6**

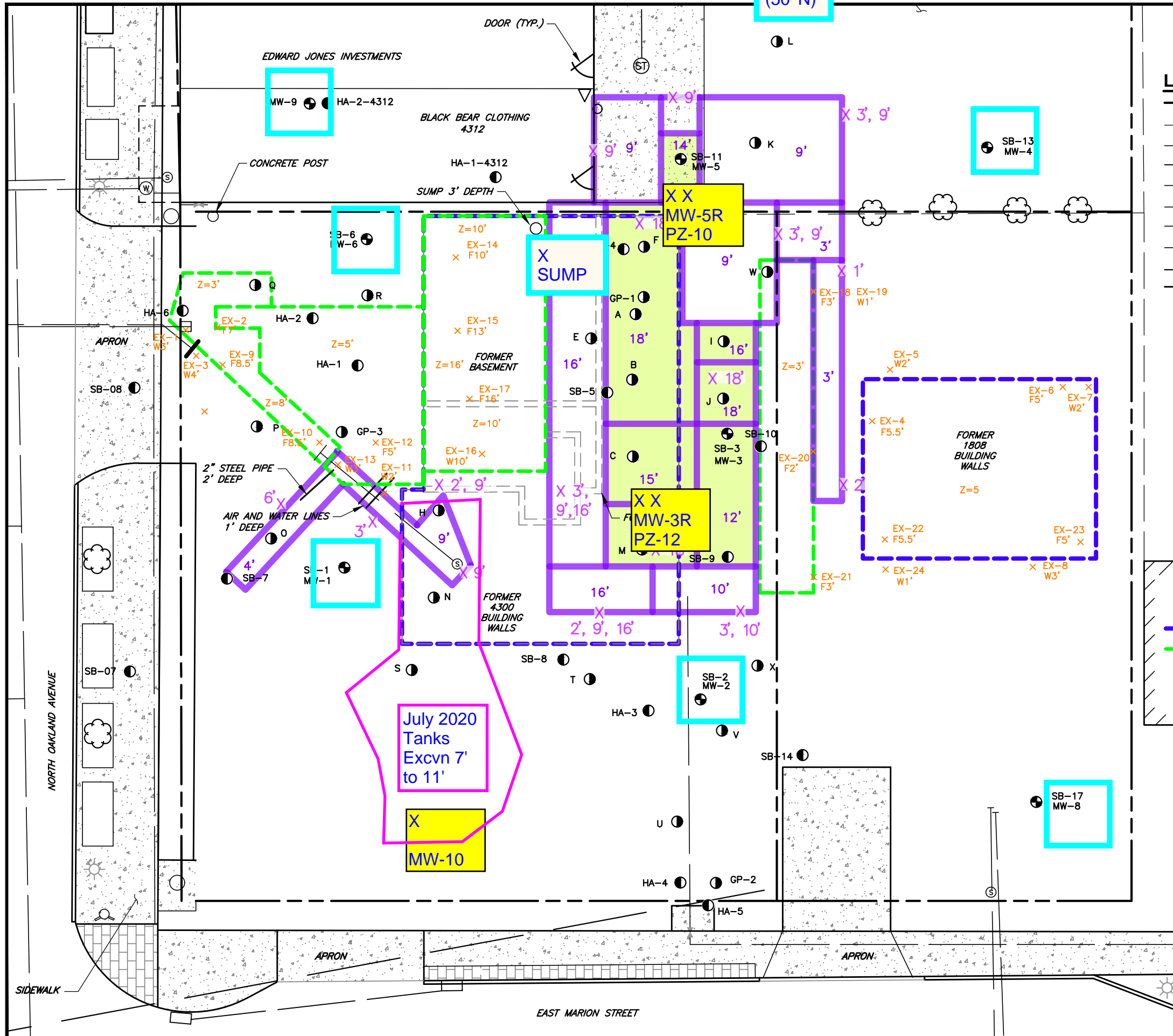

**LEGEND**

- PROPERTY LINE (APPROXIMATE)
- FENCE LINE
- SANITARY SEWER LINE
- STORM SEWER LINE
- WATERLINE
- OVERHEAD WIRE
- UNDERGROUND ELECTRIC
- GAS LINE
- UNDERGROUND FIBER OPTIC
- EDGE OF PAVEMENT/CURB
- CONCRETE
- BUILDING
- FORMER BUILDING/BASEMENT
- BRICK PAVERS
- UTILITY POLE
- LIGHT POLE
- FIRE HYDRANT
- GAS UTILITY VALVE
- STORM SEWER MANHOLE
- SANITARY SEWER MANHOLE
- CATCH BASIN
- SIGN
- CEMENT PLANTER
- SOIL BORING
- MONITORING WELL/SOIL BORING
- FORMER BUILDING LOCATION
- EXCAVATION BOUNDARY
- DEPTH OF EXCAVATION
- W3' x
- F5' x
- 10'
- AREAS WHERE CHEMICAL TREATMENT REQUIRED
- SEE TABLE FOR DIMENSIONS

Existing Wells	XX Proposed Wells
----------------	-------------------

- SITE LAYOUT AND SAMPLE LOCATIONS DIGITIZED FROM FIGURE TITLED "SITE LAYOUT" BY FEHR GRAHAM, ENGINEERING & ENVIRONMENTAL DATED MARCH 2017. SAMPLE LOCATIONS FIELD VERIFIED AUGUST 2019. SITE LAYOUT IS SUPPLEMENTED BY DIGITIZING GOOGLE EARTH PRO IMAGE DATED JULY 2018.
- PROPERTY LINE AND BUILDING DIMENSIONS FOR 4300 N. SHOREWOOD AVENUE IS DEVELOPED FROM SHOREWOOD, WISCONSIN GIS WEBSITE AND A SURVEY BY SURVEYING ASSOCIATES, WAUWATOSA, WISCONSIN DATED APRIL 2009.
- VERIFY UTILITY LOCATIONS BEFORE DIGGING.