



April 18, 2018

Richard Paul, Jr., Public Works Director
Village of Elm Grove
13600 Juneau Boulevard
Elm Grove, Wisconsin 53122-1679

Subject: Environmental Investigation Sampling Results
BRRTS#: 02-68-552102

Dear Mr. Paul:

In accordance with the executed Agreement to Provide Access for Sampling Activities, and in accordance with Wisconsin Department of Natural Resources (WDNR) regulation NR 716.14, EnviroForensics, LLC (EnviroForensics) is providing the results of the groundwater sample collected from Village of Elm Grove property (monitoring well, MW-8), on April 3, 2018.

The sampling activities were conducted at the direction of the WDNR as part of an environmental investigation being performed for the One Hour Martinizing facility located at 13405 Watertown Plank Road, Elm Grove, Wisconsin. The chemicals of concern for the investigation are the chlorinated dry cleaning solvent tetrachloroethene (PCE) and associated chlorinated compounds resulting from the natural breakdown in the subsurface of PCE including trichloroethene (TCE), cis/trans-1,2,-dichloroethene (DCE), and vinyl chloride.

The Responsible Party is:

Mr. Brian Cass
OHM Holdings, Inc.
W229 N2494 Hwy F
Waukesha, WI 53186
Telephone: 262-521-9710

Sampling Results

The analytical results of groundwater samples collected from MW-8 to date are summarized and compared to public health criteria on **Table 1**. The sample location is depicted on the attached **Figure 1**. An excerpt from the laboratory report that relates to the groundwater sample collected from the monitoring well is also attached. During the April 2018 sampling event, the

groundwater sample collected from monitoring well MW-8 did not contain concentrations of chlorinated compounds above laboratory detection limits.

We will contact you to discuss additional investigation work, if any. If you have any questions or concerns, please contact me at 414-982-3988 or by email at wfassbender@enviroforensics.com. The WDNR project manager, Mr. Jim Delwiche, can be reached at 262-574-2145. We greatly appreciate your help and patience with this matter.

Sincerely,
EnviroForensics, LLC

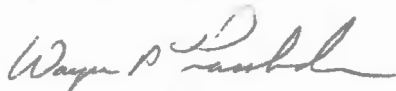













A handwritten signature in black ink, appearing to read "Wayne P. Fassbender".

Wayne P. Fassbender, PG, PMP
Sr. Project Manager

Attachments: Figure 1: Site Layout Map
Table 1: Groundwater Results Summary
Laboratory Analytical Report

Copy: Ted Warpinski, Davis & Kuelthau, S.C. (via email)
Jim Delwiche, Wisconsin Department of Natural Resources
Brian Cass, OHM Holdings, LLC (via email)

Legend

- MW-2  Monitoring well location
-  Property boundary
-  GAS  GAS Underground gas utility line
-  WTR  WTR Underground water utility line
-  SAN  SAN Underground sanitary utility line (Arrow shows direction of flow)
-  CATV  CATV Underground cable television utility line
-  OVHD  OVHD Over head electrical utility line
-  UGE  UGE Underground electrical utility line
-  Sanitary Sewer Manhole

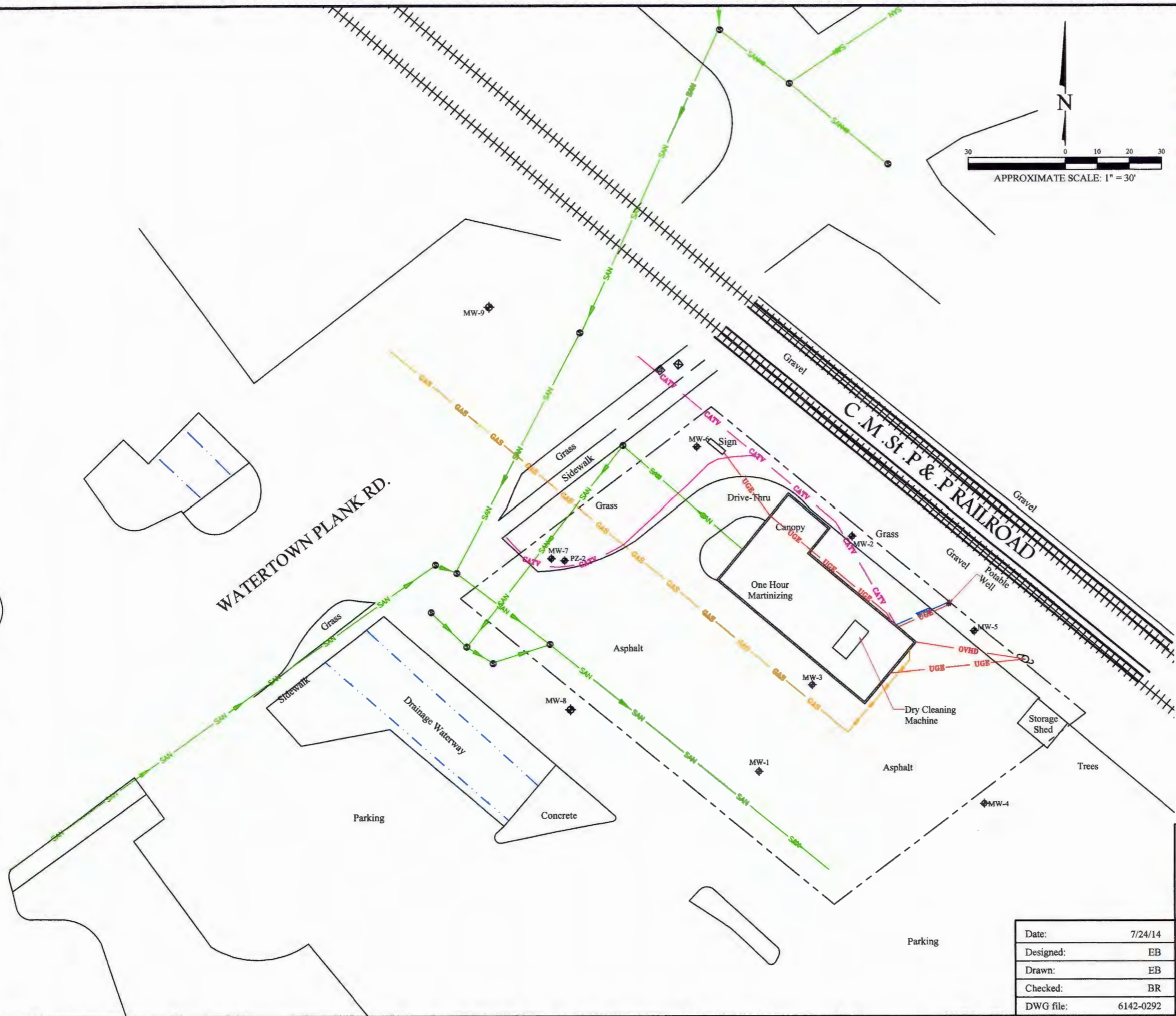
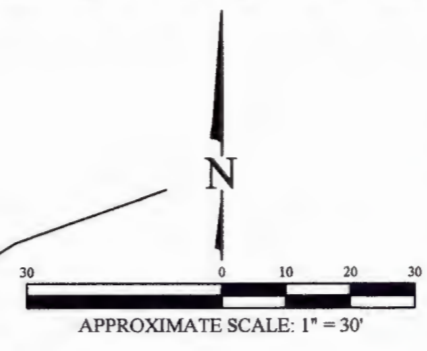

SITE LAYOUT MAP

Date:	7/24/14
Designed:	EB
Drawn:	EB
Checked:	BR
DWG file:	6142-0292

ENVIRONMENTAL FORENSIC INVESTIGATIONS, INC.
 825 North Capitol Avenue • Indianapolis, IN 46204
 EnviroForensics.com

Figure	2
Project	6142

TABLE 1
MONITORING WELL SAMPLE ANALYTICAL RESULTS
 One Hour Martinizing
 Elm Grove, Wisconsin

Boring Identification	Date Sampled	Tetrachloroethene	Trichloroethene	cis-1,2-Dichloroethene	trans-1,2-Dichloroethene	Vinyl Chloride	Benzene	Naphthalene	1,2,4-Trimethylbenzene
Enforcement Standard		5	5	70	100	0.2	5	100	480
Preventive Action Limit		0.5	0.5	7	20	0.02	0.5	10	96
MW-8	12/6/2013	<0.33	<0.33	<0.38	<0.35	<0.18	<0.24	<1.7	<2.2
	2/28/2014	<0.33	<0.33	<0.38	<0.35	<0.18	<0.24	<1.7	<2.2
	5/8/2014	<0.33	<0.33	<0.38	<0.35	<0.18	<0.24	<1.7	<2.2
	8/5/2014	<0.33	<0.33	<0.38	<0.35	<0.18	<0.24	<1.7	<2.2
	10/31/2014	<0.33	<0.33	<0.38	<0.35	<0.18	<0.24	<1.7	<2.2
	3/31/2015	<0.74	<0.47	<0.45	<0.54	<0.17	NA	NA	NA
	6/18/2015	<0.74	<0.54	<0.45	<0.54	<0.17	NA	NA	NA
	9/4/2015	<0.49	<0.47	<0.45	<0.54	<0.17	<0.44	<1.6	<1.6
	12/3/2015	<0.49	<0.47	<0.45	<0.54	<0.17	<0.44	<1.6	<1.6
	5/24/2016	<0.49	<0.47	<0.45	<0.54	<0.17	<0.44	<1.6	<1.6
	11/15/2016	<0.49	<0.47	<0.45	<0.54	<0.17	<0.44	<1.6	<1.6
	3/20/2017	<0.48	<0.45	<0.41	<0.35	<0.19	<0.17	<2.17	<1.14
8/1/2017	<0.48	<0.45	<0.41	<0.35	<0.19	<0.17	<2.17	<1.14	
4/3/2018	<0.38	<0.3	<0.37	<0.34	<0.2	<0.22	<0.21	<0.8	

Notes:

All concentrations reported in units of micrograms per liter (µg/l)
 Samples analyzed using EPA SW-846 Method 8260
 NA = Not Analyzed

Project Name OHM-ELM GROVE
Project # 6142

Invoice # E34451

Lab Code 5034451C
Sample ID 6142 MW-8
Sample Matrix Water
Sample Date 4/3/2018

	Result	Unit	LOD	LOQ	Dil	Method	Ext Date	Run Date	Analyst	Code
Organic										
VOC's										
Benzene	< 0.22	ug/l	0.22	0.71	1	8260B		4/10/2018	CJR	1
Bromobenzene	< 0.44	ug/l	0.44	1.38	1	8260B		4/10/2018	CJR	1
Bromodichloromethane	< 0.33	ug/l	0.33	1.06	1	8260B		4/10/2018	CJR	1
Bromoform	< 0.45	ug/l	0.45	1.44	1	8260B		4/10/2018	CJR	1
tert-Butylbenzene	< 0.25	ug/l	0.25	0.8	1	8260B		4/10/2018	CJR	1
sec-Butylbenzene	< 0.79	ug/l	0.79	2.53	1	8260B		4/10/2018	CJR	1
n-Butylbenzene	< 0.71	ug/l	0.71	2.25	1	8260B		4/10/2018	CJR	1
Carbon Tetrachloride	< 0.31	ug/l	0.31	0.98	1	8260B		4/10/2018	CJR	1
Chlorobenzene	< 0.26	ug/l	0.26	0.83	1	8260B		4/10/2018	CJR	1
Chloroethane	< 0.61	ug/l	0.61	1.95	1	8260B		4/10/2018	CJR	1
Chloroform	< 0.26	ug/l	0.26	0.82	1	8260B		4/10/2018	CJR	1
Chloromethane	< 0.54	ug/l	0.54	1.72	1	8260B		4/10/2018	CJR	1
2-Chlorotoluene	< 0.31	ug/l	0.31	0.98	1	8260B		4/10/2018	CJR	1
4-Chlorotoluene	< 0.26	ug/l	0.26	0.83	1	8260B		4/10/2018	CJR	1
1,2-Dibromo-3-chloropropane	< 2.96	ug/l	2.96	9.43	1	8260B		4/10/2018	CJR	1
Dibromochloromethane	< 0.22	ug/l	0.22	0.69	1	8260B		4/10/2018	CJR	1
1,4-Dichlorobenzene	< 0.7	ug/l	0.7	2.22	1	8260B		4/10/2018	CJR	1
1,3-Dichlorobenzene	< 0.85	ug/l	0.85	2.7	1	8260B		4/10/2018	CJR	1
1,2-Dichlorobenzene	< 0.86	ug/l	0.86	2.74	1	8260B		4/10/2018	CJR	1
Dichlorodifluoromethane	< 0.32	ug/l	0.32	1.02	1	8260B		4/10/2018	CJR	1
1,2-Dichloroethane	< 0.25	ug/l	0.25	0.78	1	8260B		4/10/2018	CJR	1
1,1-Dichloroethane	< 0.36	ug/l	0.36	1.14	1	8260B		4/10/2018	CJR	1
1,1-Dichloroethene	< 0.42	ug/l	0.42	1.34	1	8260B		4/10/2018	CJR	1
cis-1,2-Dichloroethene	< 0.37	ug/l	0.37	1.16	1	8260B		4/10/2018	CJR	1
trans-1,2-Dichloroethene	< 0.34	ug/l	0.34	1.07	1	8260B		4/10/2018	CJR	1
1,2-Dichloropropane	< 0.44	ug/l	0.44	1.39	1	8260B		4/10/2018	CJR	1
1,3-Dichloropropane	< 0.3	ug/l	0.3	0.94	1	8260B		4/10/2018	CJR	1
trans-1,3-Dichloropropene	< 0.32	ug/l	0.32	1.01	1	8260B		4/10/2018	CJR	1
cis-1,3-Dichloropropene	< 0.26	ug/l	0.26	0.81	1	8260B		4/10/2018	CJR	1
Di-isopropyl ether	< 0.21	ug/l	0.21	0.66	1	8260B		4/10/2018	CJR	1
EDB (1,2-Dibromoethane)	< 0.34	ug/l	0.34	1.09	1	8260B		4/10/2018	CJR	1
Ethylbenzene	< 0.26	ug/l	0.26	0.83	1	8260B		4/10/2018	CJR	1
Hexachlorobutadiene	< 1.34	ug/l	1.34	4.28	1	8260B		4/10/2018	CJR	1
Isopropylbenzene	< 0.78	ug/l	0.78	2.47	1	8260B		4/10/2018	CJR	1
p-Isopropyltoluene	< 0.24	ug/l	0.24	0.76	1	8260B		4/10/2018	CJR	1
Methylene chloride	< 1.32	ug/l	1.32	4.21	1	8260B		4/10/2018	CJR	1
Methyl tert-butyl ether (MTBE)	< 0.28	ug/l	0.28	0.89	1	8260B		4/10/2018	CJR	1
Naphthalene	< 2.1	ug/l	2.1	6.65	1	8260B		4/10/2018	CJR	1
n-Propylbenzene	< 0.61	ug/l	0.61	1.95	1	8260B		4/10/2018	CJR	1
1,1,2,2-Tetrachloroethane	< 0.3	ug/l	0.3	0.97	1	8260B		4/10/2018	CJR	1
1,1,1,2-Tetrachloroethane	< 0.35	ug/l	0.35	1.13	1	8260B		4/10/2018	CJR	1
Tetrachloroethene	< 0.38	ug/l	0.38	1.21	1	8260B		4/10/2018	CJR	1
Toluene	< 0.19	ug/l	0.19	0.6	1	8260B		4/10/2018	CJR	1
1,2,4-Trichlorobenzene	< 1.15	ug/l	1.15	3.67	1	8260B		4/10/2018	CJR	1
1,2,3-Trichlorobenzene	< 1.71	ug/l	1.71	5.43	1	8260B		4/10/2018	CJR	1
1,1,1-Trichloroethane	< 0.33	ug/l	0.33	1.05	1	8260B		4/10/2018	CJR	1
1,1,2-Trichloroethane	< 0.42	ug/l	0.42	1.32	1	8260B		4/10/2018	CJR	1
Trichloroethene (TCE)	< 0.3	ug/l	0.3	0.94	1	8260B		4/10/2018	CJR	1
Trichlorofluoromethane	< 0.35	ug/l	0.35	1.1	1	8260B		4/10/2018	CJR	1
1,2,4-Trimethylbenzene	< 0.8	ug/l	0.8	2.55	1	8260B		4/10/2018	CJR	1

Project Name OHM-ELM GROVE
Project # 6142

Invoice # E34451

Lab Code 5034451C
Sample ID 6142 MW-8
Sample Matrix Water
Sample Date 4/3/2018

	Result	Unit	LOD	LOQ	Dil	Method	Ext Date	Run Date	Analyst	Code
1,3,5-Trimethylbenzene	< 0.63	ug/l	0.63		2 1	8260B		4/10/2018	CJR	1
Vinyl Chloride	< 0.2	ug/l	0.2	0.65	1	8260B		4/10/2018	CJR	1
m&p-Xylene	< 0.43	ug/l	0.43	1.38	1	8260B		4/10/2018	CJR	1
o-Xylene	< 0.29	ug/l	0.29	0.93	1	8260B		4/10/2018	CJR	1
SUR - 4-Bromofluorobenzene	107	REC %			1	8260B		4/10/2018	CJR	1
SUR - Dibromofluoromethane	108	REC %			1	8260B		4/10/2018	CJR	1
SUR - 1,2-Dichloroethane-d4	106	REC %			1	8260B		4/10/2018	CJR	1
SUR - Toluene-d8	97	REC %			1	8260B		4/10/2018	CJR	1

