



February 14, 2024

Greg Moll, Hydrogeologist
Wisconsin Department of Natural Resources
2300 N. Dr. Martin Luther King Jr. Drive
Milwaukee, WI 53212

**Re: Groundwater Sampling Results Report
Former One Hour Martinizing
13405 Watertown Plank Road, Elm Grove, Wisconsin
BRRTS# 02-68-552102**

Dear Mr. Moll:

EnviroForensics, LLC (EnviroForensics) is providing the results of recent groundwater sampling. Samples of groundwater were collected from all site groundwater monitoring wells during December 7-8, 2023. The locations of all site groundwater monitoring wells are shown on attached **Figure 1**. The direction of groundwater flow has been historically consistent to the southeast as seen on **Figure 1**.

The groundwater samples were analyzed for total volatile organic compound (VOCs) using EPA Method 8260. In addition, the samples were analyzed for total organic carbon (TOC), methane, ethane, and ethene and field parameters were collected to help determine the continued degree of microbial degradation following remedial injections performed in 2018.

As can be seen in **Table 1** and the attached laboratory results report, concentrations of tetrachloroethene (PCE) and trichloroethene (TCE) have been reduced over time to below groundwater enforcement standards (ES). TCE was detected at a concentration exceeding the groundwater preventative action limit (PAL) in well MW-5, only. The concentrations of cis-1,2 dichloroethene (DCE) have decreased in source area wells MW-5, MW-6, and MW-7 with the concentration of DCE in well MW-5 above the PAL and the concentration of DCE in wells MW-6 and MW-7 remaining above the ES. The concentration of vinyl chloride in source area wells MW-5 and MW-6 continue to decrease while the concentration of vinyl chloride in well MW-7 has increased due to continued reductive de-chlorination of DCE at that location.

Continued reduction of TCE and DCE is anticipated due to the existing favorable conditions for reductive de-chlorination as exhibited by negative oxidation reduction potential values, low oxygen measurements, and high methane concentrations presented in **Table 1**. The plume is stable and has not migrated to the southeastern property boundary over the course of sub-surface

investigations dating back to 2009 as exhibited by unaffected down-gradient property boundary well MW-4.

If you have questions regarding the content of this report, please feel free to contact me at 262-490-6472 or wfassbender@enviroforensics.com.

Sincerely,

EnviroForensics LLC

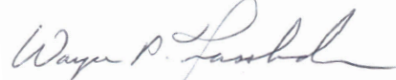
A handwritten signature in black ink that reads "Wayne P. Fassbender".

Wayne Fassbender, P.G.

Senior Project Manager

Enclosure: Figure 1: Potentiometric Surface Contour Map, December 7, 2023
 Table 1: Groundwater Geochemical Data Summary
 Synergy Environmental Lab Report

Copy: Collin Martin, Ash Union, LLC
 Thomas Harrigan, Village of Elm Grove Manager



- Legend**
- Property boundary
 - Underground gas utility line
 - Underground water utility line
 - Underground sanitary utility line (Arrow shows direction of flow)
 - Underground cable television utility line
 - Over head electrical utility line
 - Underground electrical utility line
 - MW-1 Monitoring well location
 - Sanitary Sewer Manhole
 - Manhole
 - 726.95 Groundwater elevation contour
 - 726.94 Groundwater elevation (feet above mean sea level)

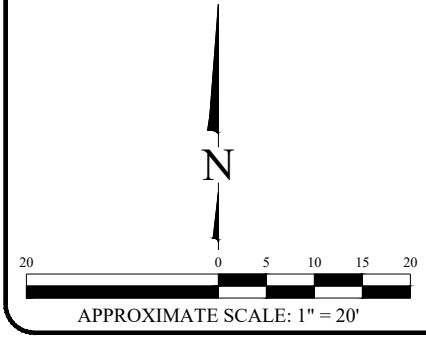

POTENTIOMETRIC SURFACE CONTOUR MAP DECEMBER 7, 2023																			
One Hour Martinizing 13405 Watertown Plank Road Elm Grove, WI																			
<table border="1" style="width: 100%; border-collapse: collapse;"> <tr><td>Date:</td><td>1/19/24</td></tr> <tr><td>Designed:</td><td>EB</td></tr> <tr><td>Drawn:</td><td>AL</td></tr> <tr><td>Checked:</td><td>BK</td></tr> <tr><td>DWG file:</td><td>6142-1600</td></tr> </table>	Date:	1/19/24	Designed:	EB	Drawn:	AL	Checked:	BK	DWG file:	6142-1600	<table border="1" style="width: 100%; border-collapse: collapse;"> <tr> <td style="text-align: center;"></td> <td style="text-align: center;">Figure</td> </tr> <tr> <td style="text-align: center;">825 North Capitol Avenue • Indianapolis, IN 46204 EnviroForensics.com</td> <td style="text-align: center;">1</td> </tr> <tr> <td></td> <td style="text-align: center;">Project</td> </tr> <tr> <td></td> <td style="text-align: center;">6142</td> </tr> </table>		Figure	825 North Capitol Avenue • Indianapolis, IN 46204 EnviroForensics.com	1		Project		6142
Date:	1/19/24																		
Designed:	EB																		
Drawn:	AL																		
Checked:	BK																		
DWG file:	6142-1600																		
	Figure																		
825 North Capitol Avenue • Indianapolis, IN 46204 EnviroForensics.com	1																		
	Project																		
	6142																		

TABLE 1
GROUNDWATER GEOCHEMICAL DATA SUMMARY

Former One Hour Martinizing
Elm Grove, Wisconsin

Monitoring Well Identification	Sample Date	Injection Pre/Post	Tetrachloroethene	Trichloroethene	cis-1,2-Dichloroethene	trans-1,2-Dichloroethene	Vinyl chloride	1,1-Dichloroethene	Dissolved Gases			Inorganic/ Physical Parameters						Dehalococoides (DHC)				Field Parameters							
									Ethane	Ethene	Methane	Dissolved Iron	Total Iron	Nitrite plus Nitrate	Nitrate	Nitrite	Sulfate	Total Organic Carbon	DHC	tceA Reductase	BAV1 Vinyl Chloride Reductase	Vinyl Chloride Reductase	Temperature	pH	Specific Conductance	Oxidation Reduction Potential	Turbidity	Dissolved Oxygen	
Units			µg/L	µg/L	µg/L	µg/L	µg/L	µg/L	µg/L	µg/L	µg/L	µg/L	mg/L	mg/L	mg/L	mg/L	mg/L	mg/L	mg/L	cells/mL	cells/mL	cells/mL	cells/mL	°C	S.U.	mS/cm	mV	NTU	mg/L
Enforcement Standard			5	5	70	100	0.2	7																					
Preventive Action Limit			0.5	0.5	7	20	0.02	0.7																					
MW-1	12/7/2023	Post	<0.47	<0.38	2.44	<0.5	<0.15	<0.43	<0.5	<0.5	28.1	--	--	--	--	--	--	--	3.91					15.18	7.12	2.19	-16.1	10.19	0.14
MW-2	12/7/2023	Post	<0.47	<0.38	<0.32	<0.5	<0.15	<0.43	<0.5	<0.5	31.3	--	--	--	--	--	--	--	1.44 J					12.65	7.06	1.83	155.2	0.63	0.30
MW-3	12/7/2023	Post	<0.47	<0.38	<0.32	<0.5	<0.15	<0.43	<0.5	<0.5	343	--	--	--	--	--	--	--	2.73					14.90	6.89	2.52	-62.2	0.74	0.14
MW-4	3/18/2020	Post	<0.74	<0.54	<0.45	<0.54	<0.17	NA	<0.5	<0.5	4.45	--	--	--	--	--	--	--					11.1	6.64	11.41	77.2	0.04	0.22	
	12/7/2023		<0.47	<0.38	0.61 J	<0.5	<0.15	<0.43	<0.5	<0.5	41.4	--	--	--	--	--	--	--	2.90					15.88	6.80	3.13	-103.1	1.88	0.22
MW-5	12/3/2015	Pre	37	<0.47	<0.45	<0.54	<0.17	<0.65	--	--	--	--	--	--	--	--	--	--					12.56	7.02	2.35	126	17.6	0.00	
	8/30/2018	Post	108	1.68	1.08	<0.34	<0.2	<0.42	<0.5	<0.5	1.94	22.7	25.6	<0.36	--	--	123 J						17.30	6.90	1.71	-163	0.1	1.56	
	11/19/2018		0.49	<0.3	205	1.23	1.77	<0.42	0.57 J	<0.5	295	22	22.8	--	<0.15	0.003 J	2.97 J						12.7	7.00	1.58	-122	2.6	0.29	
	6/5/2019		2.58	0.8	193	6.1	1.03	<0.42	<0.5	<0.5	11,500	3.85	30.6	--	<0.47	0.016 J	560						17.30	6.79	2.02	-356	14.4	5.16	
	10/14/2019		3.1	0.59	168	4.3	1.02	0.54 J	<0.5	<0.5	10,200	4.44	5.22	--	<0.47	0.074	308						14.35	6.55	2.22	-339	31	0.07	
	12/26/2019		0.94	<0.3	90	2.94	<0.2	<0.42	--	--	--	--	--	--	--	--	--	--	--					12.22	6.32	1.43	-238	29	0.18
	3/18/2020		2.1	0.63	131	3.6	1.43	<0.42	<10	<10	16,900	--	--	--	--	--	--	--	--					10.52	6.60	1.53	-210	14	0.05
	8/5/2020		3.3	1.48	106	4.5	3.2	NA	<0.5	<0.5	15,500	1.38	1.53	--	<0.47	<0.11	69.9						13.71	6.62	1.28	-123	17.4	0.08	
	12/10/2020		5.5	1.87	142	5.1	6.3	<0.5	3.49	<0.5	17,600	--	--	--	--	--	--	--	--					13.37	6.66	1.23	-68.3	1.68	0.43
	5/21/2021		8.0	2.48	92	5.3	7.4	<0.55	18.1	<0.5	6,830	--	--	--	--	--	--	--	--					16.61	6.78	1.37	-105.7	1.97	1.15
	12/8/2021		18.6	2.5	6.2	1.21	3.03	<0.55	<0.5	<0.5	6,610	--	--	--	--	--	--	--	--					12.23	7.23	1.57	-247.8	28.23	2.67
	6/9/2022		16.7	7.5	89	5.6	8.1	<0.43	<0.5	2.52	8,260	--	--	--	--	--	--	--	--					15.08	6.73	1.6	-96.1	51.11	0.29
	12/8/2023		1.03 J	3.4	36	3.8	3.2	<0.43	<5	<5	3,417	--	--	--	--	--	--	--	--	4.93				14.04	6.84	1.24	-257.0	18.62	0.12
MW-6	12/4/2015		Pre	195	40	18.8	<2.7	<0.85	<3.25	--	--	--	--	--	--	--	--	--	--					13.85	6.99	5.18	-15	22.4	0.00
	8/30/2018	Post	150	17.2	61	0.5	<0.2	<0.42	<0.5	<0.5	50.4	3.67	3.79	<0.36	--	--	169 J						13.34	7.15	4.12	-87	6.4	0.00	
	11/19/2018		89	31.5	88	0.57	<0.2	<0.42	<0.5	<0.5	11.9	4.23	2.92	--	<0.15	<0.0023	307						11.55	7.53	4.31	-69	0.6	0.00	
	3/29/2019		40	10.7	285	1.73	1.04	<0.42	--	--	--	--	--	--	--	--	--	--						12.25	7.13	4.61	-338	11.4	0.21
	6/5/2019		1.7	0.96	370	2.78	0.76	1.48	10.5	<0.5	4,760	2.57	4.06	--	<0.47	<0.014	264						15.51	7.19	4.22	-230	2.2	8.53	
	10/14/2019		3.8	2.2	380	3.4	6.1	<2.1	3.33	<0.5	2,540	3.51	4.45	--	<0.47	<0.014	469						13.28	7.12	4.37	-186	2.3	0.09	
	12/26/2019		<3.8	<3	330	<3.4	<2	<4.2	--	--	--	--	--	--	--	--	--	--	--					12.62	6.77	4.41	-125	18	0.54
	3/18/2020		8.9	4.6	350	2.85	<1	NA	<5	<5	4,230	--	--	--	--	--	--	--	--					11.19	7.01	3.93	-167	5.5	0.04
	8/5/2020		<0.33	<0.47	860	3.2	10.2	1.37	17.6	<0.5	5,490	4.56	5.26	--	<0.47	<0.11	502						12.61	6.79	5.09	-160	14.8	0.01	
	12/10/2020		<0.33	<0.47	410	4.2	5.2	<5	<0.5	4.98	10,800	--	--	--	--	--	--	--	--					13.08	7.07	3.29	-77.1	1.17	0.18
	5/21/2021		<5.4	<4.7	450	6.5	35	<5.5	27.2	<0.5	4,640	--	--	--	--	--	--	--	--					13.81	7.06	3.4	-80.2	30.12	1.36
	12/8/2021		<2.7	<2.35	222	4	41	<2.75	47.6	<0.5	3,300	--	--	--	--	--	--	--	--					12	7.41	3.33	-153.9	6.61	1.28
	6/9/2022		5.2	3.2	780	18.7	75	1.37	30.6	<0.5	3,600	--	--	--	--	--	--	--	--					12.65	7.09	2.89	-69	81.9	0.17
12/8/2023	1.06 J		<0.76	116	9.9	22.3	<0.86	<5	<5	2,011	--	--	--	--	--	--	--	--	3.42				14.45	7.19	3.06	-130.4	4.48	0.14	
MW-7	12/4/2015	Pre	214	68	77	<5.4	<1.7	<6.5	--	--	--	--	--	--	--	--	--	--					14.93	6.88	8.92	-37	24.6	0.00	
	5/24/2016	Post	620	106	166	11	<1.7	<6.5	--	--	--	--	--	--	--	--	--	--					20.98	6.64	5.75	182	105	0.00	
	11/15/2016		850	122	125	8.2	<1.7	<6.5	--	--	--	--	--	--	--	--	--	--					16.78	6.9	--	54	52.5	0.47	
	3/20/2017		810	105	126	8.1	<1.9	<4.6	--	--	--	--	--	--	--	--	--	--					--	--	--	--	--	--	
	8/1/2017		930	118	130	7.8	<1.9	<4.6	--	--	--	--	--	--	--	--	--	--	--					24.87	6.83	5.38	63	2.5	0.00
	4/3/2018		670	94	100	5.8	<2	<4.2	--	--	--	--	--	--	--	--	--	--	--					9.11	6.87	2.72	7	7.9	0.00
	8/30/2018		203	590	350	6.9	3.5	<4.2	1.25 J	<0.5	257	47.2	47.6	<0.36	--	--	46.1						14.55	6.76	4.08	-142	30	0.00	
	11/19/2018		<3.8	<3	1,300	9.7	10	<4.2	<2.5	<2.5	4,480	4.96	6.83	--	<0.15	0.005 J	38.2							11.62	7.42	3.60	-281	0.5	25.86*
	3/29/2019		4.4	<3	1,390	15.6	7.6	<0.42	--	--	--	--	--	--	--	--	--	--	--					11.74	7.03	4.75	-357	19.2	1.81
	6/5/2019		<3.8	<3	1,470	22.9	6.9	<4.2	0.737 J	<0.5	8,690	0.04	2.91	--	<0.47	<0.014	405						16.18	7.00	3.93	-356	8.1	5.44	
	10/14/2019		27.2	5.8	1,110	16.6	2.6	<4.2	<0.5	<0.5	8,750	1.28	3.39	--	0.026 J	<0.47	521						15.64	6.82	5.16	-319	21	0.07	
	12/26/2019		12.3	6.1	530	10.7	<2	<4.2	--	--	--	--	--	--	--	--	--	--	--					13.37	6.75	5.77	-265	16	0.54
	3/18/2020		102	22	790	11	<1	NA	<5	<5	9,290	--	--	--	--	--	--	--	--					10.77	6.99	4.67	-315	18	0.07
8/5/2020	35		6.8	1,040	9.6	0.65	1.72	<0.5	<0.5	7,080	0.46	1.76	--	0.71 J	<0.47	1560						14.08							

Synergy Environmental Lab, LLC.

1990 Prospect Ct., Appleton, WI 54914 *P 920-830-2455 * F 920-733-0631

WAYNE FASSBENDER
ENVIROFORENSICS
825 N. CAPITOL AVENUE
INDIANAPOLIS, IN 46204

Report Date 21-Dec-23

Project Name OHM-ELM GROVE 6142
Project # 6142

Invoice # E43312

Lab Code 5043312A
Sample ID 6142-MW-1
Sample Matrix Water
Sample Date 12/7/2023

	Result	Unit	LOD	LOQ	Dil	Method	Ext Date	Run Date	Analyst	Code
Organic										
GASES										
Ethane	< 0.5	ug/l	0.5	1.5	1	8015		12/12/2023	ZJW	1
Ethene	< 0.5	ug/l	0.5	1.5	1	8015		12/12/2023	ZJW	1
Methane	28.1	ug/l	1	3	1	8015		12/12/2023	ZJW	1
VOC's										
Benzene	< 0.3	ug/l	0.3	1.25	1	8260B		12/11/2023	CJR	1
Bromobenzene	< 0.34	ug/l	0.34	1.4	1	8260B		12/11/2023	CJR	1
Bromodichloromethane	< 0.36	ug/l	0.36	1.47	1	8260B		12/11/2023	CJR	1
Bromoform	< 0.42	ug/l	0.42	1.72	1	8260B		12/11/2023	CJR	1
tert-Butylbenzene	< 0.37	ug/l	0.37	1.49	1	8260B		12/11/2023	CJR	1
sec-Butylbenzene	< 0.33	ug/l	0.33	1.34	1	8260B		12/11/2023	CJR	1
n-Butylbenzene	< 0.71	ug/l	0.71	2.9	1	8260B		12/11/2023	CJR	1
Carbon Tetrachloride	< 0.34	ug/l	0.34	1.39	1	8260B		12/11/2023	CJR	1
Chlorobenzene	< 0.29	ug/l	0.29	1.19	1	8260B		12/11/2023	CJR	1
Chloroethane	< 0.62	ug/l	0.62	2.54	1	8260B		12/11/2023	CJR	1
Chloroform	< 0.33	ug/l	0.33	1.33	1	8260B		12/11/2023	CJR	1
Chloromethane	< 0.74	ug/l	0.74	3.03	1	8260B		12/11/2023	CJR	1
2-Chlorotoluene	< 0.34	ug/l	0.34	1.37	1	8260B		12/11/2023	CJR	1
4-Chlorotoluene	< 0.4	ug/l	0.4	1.63	1	8260B		12/11/2023	CJR	1
1,2-Dibromo-3-chloropropane	< 0.74	ug/l	0.74	3.01	1	8260B		12/11/2023	CJR	1
Dibromochloromethane	< 0.36	ug/l	0.36	1.46	1	8260B		12/11/2023	CJR	1
1,4-Dichlorobenzene	< 0.49	ug/l	0.49	2.01	1	8260B		12/11/2023	CJR	1
1,3-Dichlorobenzene	< 0.35	ug/l	0.35	1.44	1	8260B		12/11/2023	CJR	1
1,2-Dichlorobenzene	< 0.4	ug/l	0.4	1.65	1	8260B		12/11/2023	CJR	1
Dichlorodifluoromethane	< 0.3	ug/l	0.3	1.23	1	8260B		12/11/2023	CJR	1
1,2-Dichloroethane	< 0.43	ug/l	0.43	1.75	1	8260B		12/11/2023	CJR	1

Project Name OHM-ELM GROVE 6142
Project # 6142

Invoice # E43312

Lab Code 5043312A
Sample ID 6142-MW-1
Sample Matrix Water
Sample Date 12/7/2023

	Result	Unit	LOD	LOQ	Dil	Method	Ext Date	Run Date	Analyst	Code
1,1-Dichloroethane	< 0.43	ug/l	0.43	1.74	1	8260B		12/11/2023	CJR	1
1,1-Dichloroethene	< 0.43	ug/l	0.43	1.76	1	8260B		12/11/2023	CJR	1
cis-1,2-Dichloroethene	2.44	ug/l	0.32	1.29	1	8260B		12/11/2023	CJR	1
trans-1,2-Dichloroethene	< 0.5	ug/l	0.5	2.02	1	8260B		12/11/2023	CJR	1
1,2-Dichloropropane	< 0.39	ug/l	0.39	1.58	1	8260B		12/11/2023	CJR	1
1,3-Dichloropropane	< 0.38	ug/l	0.38	1.55	1	8260B		12/11/2023	CJR	1
trans-1,3-Dichloropropene	< 0.41	ug/l	0.41	1.67	1	8260B		12/11/2023	CJR	1
cis-1,3-Dichloropropene	< 0.41	ug/l	0.41	1.67	1	8260B		12/11/2023	CJR	1
Di-isopropyl ether	< 0.48	ug/l	0.48	1.96	1	8260B		12/11/2023	CJR	1
EDB (1,2-Dibromoethane)	< 0.39	ug/l	0.39	1.59	1	8260B		12/11/2023	CJR	1
Ethylbenzene	< 0.33	ug/l	0.33	1.37	1	8260B		12/11/2023	CJR	1
Hexachlorobutadiene	< 0.81	ug/l	0.81	3.44	1	8260B		12/11/2023	CJR	1
Isopropylbenzene	< 0.34	ug/l	0.34	1.38	1	8260B		12/11/2023	CJR	1
p-Isopropyltoluene	< 0.47	ug/l	0.47	1.91	1	8260B		12/11/2023	CJR	1
Methylene chloride	< 0.79	ug/l	0.79	3.23	1	8260B		12/11/2023	CJR	1
Methyl tert-butyl ether (MTBE)	< 0.47	ug/l	0.47	1.91	1	8260B		12/11/2023	CJR	1
Naphthalene	< 1.4	ug/l	1.4	5.56	1	8260B		12/11/2023	CJR	1
n-Propylbenzene	< 0.39	ug/l	0.39	1.6	1	8260B		12/11/2023	CJR	1
1,1,2,2-Tetrachloroethane	< 0.43	ug/l	0.43	1.77	1	8260B		12/11/2023	CJR	1
1,1,1,2-Tetrachloroethane	< 0.55	ug/l	0.55	2.25	1	8260B		12/11/2023	CJR	1
Tetrachloroethene	< 0.47	ug/l	0.47	1.91	1	8260B		12/11/2023	CJR	1
Toluene	< 0.33	ug/l	0.33	1.35	1	8260B		12/11/2023	CJR	1
1,2,4-Trichlorobenzene	< 0.63	ug/l	0.63	2.57	1	8260B		12/11/2023	CJR	1
1,2,3-Trichlorobenzene	< 1.4	ug/l	1.4	5.94	1	8260B		12/11/2023	CJR	1
1,1,1-Trichloroethane	< 0.33	ug/l	0.33	1.34	1	8260B		12/11/2023	CJR	1
1,1,2-Trichloroethane	< 0.42	ug/l	0.42	1.72	1	8260B		12/11/2023	CJR	1
Trichloroethene (TCE)	< 0.38	ug/l	0.38	1.55	1	8260B		12/11/2023	CJR	1
Trichlorofluoromethane	< 0.33	ug/l	0.33	1.35	1	8260B		12/11/2023	CJR	1
1,2,4-Trimethylbenzene	< 0.35	ug/l	0.35	1.44	1	8260B		12/11/2023	CJR	1
1,3,5-Trimethylbenzene	< 0.41	ug/l	0.41	1.66	1	8260B		12/11/2023	CJR	1
Vinyl Chloride	< 0.15	ug/l	0.15	0.61	1	8260B		12/11/2023	CJR	1
m&p-Xylene	< 0.64	ug/l	0.64	2.63	1	8260B		12/11/2023	CJR	1
o-Xylene	< 0.37	ug/l	0.37	1.51	1	8260B		12/11/2023	CJR	1
SUR - 4-Bromofluorobenzene	92	REC %			1	8260B		12/11/2023	CJR	1
SUR - Dibromofluoromethane	91	REC %			1	8260B		12/11/2023	CJR	1
SUR - 1,2-Dichloroethane-d4	102	REC %			1	8260B		12/11/2023	CJR	1
SUR - Toluene-d8	113	REC %			1	8260B		12/11/2023	CJR	1

Wet Chemistry

General

Total Organic Carbon	3.91	mg/l	0.7	2	1	SM 5310B		12/19/2023	SLA	1
----------------------	------	------	-----	---	---	----------	--	------------	-----	---

Project Name OHM-ELM GROVE 6142
Project # 6142

Invoice # E43312

Lab Code 5043312B
Sample ID 6142-MW-2
Sample Matrix Water
Sample Date 12/7/2023

	Result	Unit	LOD	LOQ	Dil	Method	Ext Date	Run Date	Analyst	Code
Organic										
GASES										
Ethane	< 0.5	ug/l	0.5	1.5	1	8015		12/12/2023	ZJW	1
Ethene	< 0.5	ug/l	0.5	1.5	1	8015		12/12/2023	ZJW	1
Methane	31.3	ug/l	1	3	1	8015		12/12/2023	ZJW	1
VOC's										
Benzene	< 0.3	ug/l	0.3	1.25	1	8260B		12/11/2023	CJR	1
Bromobenzene	< 0.34	ug/l	0.34	1.4	1	8260B		12/11/2023	CJR	1
Bromodichloromethane	< 0.36	ug/l	0.36	1.47	1	8260B		12/11/2023	CJR	1
Bromoform	< 0.42	ug/l	0.42	1.72	1	8260B		12/11/2023	CJR	1
tert-Butylbenzene	< 0.37	ug/l	0.37	1.49	1	8260B		12/11/2023	CJR	1
sec-Butylbenzene	< 0.33	ug/l	0.33	1.34	1	8260B		12/11/2023	CJR	1
n-Butylbenzene	< 0.71	ug/l	0.71	2.9	1	8260B		12/11/2023	CJR	1
Carbon Tetrachloride	< 0.34	ug/l	0.34	1.39	1	8260B		12/11/2023	CJR	1
Chlorobenzene	< 0.29	ug/l	0.29	1.19	1	8260B		12/11/2023	CJR	1
Chloroethane	< 0.62	ug/l	0.62	2.54	1	8260B		12/11/2023	CJR	1
Chloroform	< 0.33	ug/l	0.33	1.33	1	8260B		12/11/2023	CJR	1
Chloromethane	< 0.74	ug/l	0.74	3.03	1	8260B		12/11/2023	CJR	1
2-Chlorotoluene	< 0.34	ug/l	0.34	1.37	1	8260B		12/11/2023	CJR	1
4-Chlorotoluene	< 0.4	ug/l	0.4	1.63	1	8260B		12/11/2023	CJR	1
1,2-Dibromo-3-chloropropane	< 0.74	ug/l	0.74	3.01	1	8260B		12/11/2023	CJR	1
Dibromochloromethane	< 0.36	ug/l	0.36	1.46	1	8260B		12/11/2023	CJR	1
1,4-Dichlorobenzene	< 0.49	ug/l	0.49	2.01	1	8260B		12/11/2023	CJR	1
1,3-Dichlorobenzene	< 0.35	ug/l	0.35	1.44	1	8260B		12/11/2023	CJR	1
1,2-Dichlorobenzene	< 0.4	ug/l	0.4	1.65	1	8260B		12/11/2023	CJR	1
Dichlorodifluoromethane	< 0.3	ug/l	0.3	1.23	1	8260B		12/11/2023	CJR	1
1,2-Dichloroethane	< 0.43	ug/l	0.43	1.75	1	8260B		12/11/2023	CJR	1
1,1-Dichloroethane	< 0.43	ug/l	0.43	1.74	1	8260B		12/11/2023	CJR	1
1,1-Dichloroethene	< 0.43	ug/l	0.43	1.76	1	8260B		12/11/2023	CJR	1
cis-1,2-Dichloroethene	< 0.32	ug/l	0.32	1.29	1	8260B		12/11/2023	CJR	1
trans-1,2-Dichloroethene	< 0.5	ug/l	0.5	2.02	1	8260B		12/11/2023	CJR	1
1,2-Dichloropropane	< 0.39	ug/l	0.39	1.58	1	8260B		12/11/2023	CJR	1
1,3-Dichloropropane	< 0.38	ug/l	0.38	1.55	1	8260B		12/11/2023	CJR	1
trans-1,3-Dichloropropene	< 0.41	ug/l	0.41	1.67	1	8260B		12/11/2023	CJR	1
cis-1,3-Dichloropropene	< 0.41	ug/l	0.41	1.67	1	8260B		12/11/2023	CJR	1
Di-isopropyl ether	< 0.48	ug/l	0.48	1.96	1	8260B		12/11/2023	CJR	1
EDB (1,2-Dibromoethane)	< 0.39	ug/l	0.39	1.59	1	8260B		12/11/2023	CJR	1
Ethylbenzene	< 0.33	ug/l	0.33	1.37	1	8260B		12/11/2023	CJR	1
Hexachlorobutadiene	< 0.81	ug/l	0.81	3.44	1	8260B		12/11/2023	CJR	1
Isopropylbenzene	< 0.34	ug/l	0.34	1.38	1	8260B		12/11/2023	CJR	1
p-Isopropyltoluene	< 0.47	ug/l	0.47	1.91	1	8260B		12/11/2023	CJR	1
Methylene chloride	< 0.79	ug/l	0.79	3.23	1	8260B		12/11/2023	CJR	1
Methyl tert-butyl ether (MTBE)	< 0.47	ug/l	0.47	1.91	1	8260B		12/11/2023	CJR	1
Naphthalene	< 1.4	ug/l	1.4	5.56	1	8260B		12/11/2023	CJR	1
n-Propylbenzene	< 0.39	ug/l	0.39	1.6	1	8260B		12/11/2023	CJR	1
1,1,2,2-Tetrachloroethane	< 0.43	ug/l	0.43	1.77	1	8260B		12/11/2023	CJR	1

Project Name OHM-ELM GROVE 6142
Project # 6142

Invoice # E43312

Lab Code 5043312B
Sample ID 6142-MW-2
Sample Matrix Water
Sample Date 12/7/2023

	Result	Unit	LOD	LOQ	Dil	Method	Ext Date	Run Date	Analyst	Code
1,1,1,2-Tetrachloroethane	< 0.55	ug/l	0.55	2.25	1	8260B		12/11/2023	CJR	1
Tetrachloroethene	< 0.47	ug/l	0.47	1.91	1	8260B		12/11/2023	CJR	1
Toluene	< 0.33	ug/l	0.33	1.35	1	8260B		12/11/2023	CJR	1
1,2,4-Trichlorobenzene	< 0.63	ug/l	0.63	2.57	1	8260B		12/11/2023	CJR	1
1,2,3-Trichlorobenzene	< 1.4	ug/l	1.4	5.94	1	8260B		12/11/2023	CJR	1
1,1,1-Trichloroethane	< 0.33	ug/l	0.33	1.34	1	8260B		12/11/2023	CJR	1
1,1,2-Trichloroethane	< 0.42	ug/l	0.42	1.72	1	8260B		12/11/2023	CJR	1
Trichloroethene (TCE)	< 0.38	ug/l	0.38	1.55	1	8260B		12/11/2023	CJR	1
Trichlorofluoromethane	< 0.33	ug/l	0.33	1.35	1	8260B		12/11/2023	CJR	1
1,2,4-Trimethylbenzene	< 0.35	ug/l	0.35	1.44	1	8260B		12/11/2023	CJR	1
1,3,5-Trimethylbenzene	< 0.41	ug/l	0.41	1.66	1	8260B		12/11/2023	CJR	1
Vinyl Chloride	< 0.15	ug/l	0.15	0.61	1	8260B		12/11/2023	CJR	1
m&p-Xylene	< 0.64	ug/l	0.64	2.63	1	8260B		12/11/2023	CJR	1
o-Xylene	< 0.37	ug/l	0.37	1.51	1	8260B		12/11/2023	CJR	1
SUR - 1,2-Dichloroethane-d4	99	REC %			1	8260B		12/11/2023	CJR	1
SUR - Toluene-d8	111	REC %			1	8260B		12/11/2023	CJR	1
SUR - Dibromofluoromethane	89	REC %			1	8260B		12/11/2023	CJR	1
SUR - 4-Bromofluorobenzene	96	REC %			1	8260B		12/11/2023	CJR	1

Wet Chemistry

General

Total Organic Carbon	1.44 "J"	mg/l	0.7	2	1	SM 5310B		12/19/2023	SLA	1
----------------------	----------	------	-----	---	---	----------	--	------------	-----	---

Project Name OHM-ELM GROVE 6142
Project # 6142

Invoice # E43312

Lab Code 5043312C
Sample ID 6142-MW-3
Sample Matrix Water
Sample Date 12/7/2023

	Result	Unit	LOD	LOQ	Dil	Method	Ext Date	Run Date	Analyst	Code
Organic										
GASES										
Ethane	< 0.5	ug/l	0.5	1.5	1	8015		12/12/2023	ZJW	1
Ethene	< 0.5	ug/l	0.5	1.5	1	8015		12/12/2023	ZJW	1
Methane	343	ug/l	1	3	1	8015		12/12/2023	ZJW	1
VOC's										
Benzene	< 0.3	ug/l	0.3	1.25	1	8260B		12/11/2023	CJR	1
Bromobenzene	< 0.34	ug/l	0.34	1.4	1	8260B		12/11/2023	CJR	1
Bromodichloromethane	< 0.36	ug/l	0.36	1.47	1	8260B		12/11/2023	CJR	1
Bromoform	< 0.42	ug/l	0.42	1.72	1	8260B		12/11/2023	CJR	1
tert-Butylbenzene	< 0.37	ug/l	0.37	1.49	1	8260B		12/11/2023	CJR	1
sec-Butylbenzene	< 0.33	ug/l	0.33	1.34	1	8260B		12/11/2023	CJR	1
n-Butylbenzene	< 0.71	ug/l	0.71	2.9	1	8260B		12/11/2023	CJR	1
Carbon Tetrachloride	< 0.34	ug/l	0.34	1.39	1	8260B		12/11/2023	CJR	1
Chlorobenzene	< 0.29	ug/l	0.29	1.19	1	8260B		12/11/2023	CJR	1
Chloroethane	< 0.62	ug/l	0.62	2.54	1	8260B		12/11/2023	CJR	1
Chloroform	< 0.33	ug/l	0.33	1.33	1	8260B		12/11/2023	CJR	1
Chloromethane	< 0.74	ug/l	0.74	3.03	1	8260B		12/11/2023	CJR	1
2-Chlorotoluene	< 0.34	ug/l	0.34	1.37	1	8260B		12/11/2023	CJR	1
4-Chlorotoluene	< 0.4	ug/l	0.4	1.63	1	8260B		12/11/2023	CJR	1
1,2-Dibromo-3-chloropropane	< 0.74	ug/l	0.74	3.01	1	8260B		12/11/2023	CJR	1
Dibromochloromethane	< 0.36	ug/l	0.36	1.46	1	8260B		12/11/2023	CJR	1
1,4-Dichlorobenzene	< 0.49	ug/l	0.49	2.01	1	8260B		12/11/2023	CJR	1
1,3-Dichlorobenzene	< 0.35	ug/l	0.35	1.44	1	8260B		12/11/2023	CJR	1
1,2-Dichlorobenzene	< 0.4	ug/l	0.4	1.65	1	8260B		12/11/2023	CJR	1
Dichlorodifluoromethane	< 0.3	ug/l	0.3	1.23	1	8260B		12/11/2023	CJR	1
1,2-Dichloroethane	< 0.43	ug/l	0.43	1.75	1	8260B		12/11/2023	CJR	1
1,1-Dichloroethane	< 0.43	ug/l	0.43	1.74	1	8260B		12/11/2023	CJR	1
1,1-Dichloroethene	< 0.43	ug/l	0.43	1.76	1	8260B		12/11/2023	CJR	1
cis-1,2-Dichloroethene	< 0.32	ug/l	0.32	1.29	1	8260B		12/11/2023	CJR	1
trans-1,2-Dichloroethene	< 0.5	ug/l	0.5	2.02	1	8260B		12/11/2023	CJR	1
1,2-Dichloropropane	< 0.39	ug/l	0.39	1.58	1	8260B		12/11/2023	CJR	1
1,3-Dichloropropane	< 0.38	ug/l	0.38	1.55	1	8260B		12/11/2023	CJR	1
trans-1,3-Dichloropropene	< 0.41	ug/l	0.41	1.67	1	8260B		12/11/2023	CJR	1
cis-1,3-Dichloropropene	< 0.41	ug/l	0.41	1.67	1	8260B		12/11/2023	CJR	1
Di-isopropyl ether	< 0.48	ug/l	0.48	1.96	1	8260B		12/11/2023	CJR	1
EDB (1,2-Dibromoethane)	< 0.39	ug/l	0.39	1.59	1	8260B		12/11/2023	CJR	1
Ethylbenzene	< 0.33	ug/l	0.33	1.37	1	8260B		12/11/2023	CJR	1
Hexachlorobutadiene	< 0.81	ug/l	0.81	3.44	1	8260B		12/11/2023	CJR	1
Isopropylbenzene	< 0.34	ug/l	0.34	1.38	1	8260B		12/11/2023	CJR	1
p-Isopropyltoluene	< 0.47	ug/l	0.47	1.91	1	8260B		12/11/2023	CJR	1
Methylene chloride	< 0.79	ug/l	0.79	3.23	1	8260B		12/11/2023	CJR	1
Methyl tert-butyl ether (MTBE)	< 0.47	ug/l	0.47	1.91	1	8260B		12/11/2023	CJR	1
Naphthalene	< 1.4	ug/l	1.4	5.56	1	8260B		12/11/2023	CJR	1
n-Propylbenzene	< 0.39	ug/l	0.39	1.6	1	8260B		12/11/2023	CJR	1
1,1,2,2-Tetrachloroethane	< 0.43	ug/l	0.43	1.77	1	8260B		12/11/2023	CJR	1

Project Name OHM-ELM GROVE 6142
Project # 6142

Invoice # E43312

Lab Code 5043312C
Sample ID 6142-MW-3
Sample Matrix Water
Sample Date 12/7/2023

	Result	Unit	LOD	LOQ	Dil	Method	Ext Date	Run Date	Analyst	Code
1,1,1,2-Tetrachloroethane	< 0.55	ug/l	0.55	2.25	1	8260B		12/11/2023	CJR	1
Tetrachloroethene	< 0.47	ug/l	0.47	1.91	1	8260B		12/11/2023	CJR	1
Toluene	< 0.33	ug/l	0.33	1.35	1	8260B		12/11/2023	CJR	1
1,2,4-Trichlorobenzene	< 0.63	ug/l	0.63	2.57	1	8260B		12/11/2023	CJR	1
1,2,3-Trichlorobenzene	< 1.4	ug/l	1.4	5.94	1	8260B		12/11/2023	CJR	1
1,1,1-Trichloroethane	< 0.33	ug/l	0.33	1.34	1	8260B		12/11/2023	CJR	1
1,1,2-Trichloroethane	< 0.42	ug/l	0.42	1.72	1	8260B		12/11/2023	CJR	1
Trichloroethene (TCE)	< 0.38	ug/l	0.38	1.55	1	8260B		12/11/2023	CJR	1
Trichlorofluoromethane	< 0.33	ug/l	0.33	1.35	1	8260B		12/11/2023	CJR	1
1,2,4-Trimethylbenzene	< 0.35	ug/l	0.35	1.44	1	8260B		12/11/2023	CJR	1
1,3,5-Trimethylbenzene	< 0.41	ug/l	0.41	1.66	1	8260B		12/11/2023	CJR	1
Vinyl Chloride	< 0.15	ug/l	0.15	0.61	1	8260B		12/11/2023	CJR	1
m&p-Xylene	< 0.64	ug/l	0.64	2.63	1	8260B		12/11/2023	CJR	1
o-Xylene	< 0.37	ug/l	0.37	1.51	1	8260B		12/11/2023	CJR	1
SUR - 1,2-Dichloroethane-d4	100	REC %			1	8260B		12/11/2023	CJR	1
SUR - 4-Bromofluorobenzene	92	REC %			1	8260B		12/11/2023	CJR	1
SUR - Dibromofluoromethane	93	REC %			1	8260B		12/11/2023	CJR	1
SUR - Toluene-d8	113	REC %			1	8260B		12/11/2023	CJR	1

Wet Chemistry

General

Total Organic Carbon	2.73	mg/l	0.7	2	1	SM 5310B		12/19/2023	SLA	1
----------------------	------	------	-----	---	---	----------	--	------------	-----	---

Project Name OHM-ELM GROVE 6142
Project # 6142

Invoice # E43312

Lab Code 5043312D
Sample ID 6142-MW-4
Sample Matrix Water
Sample Date 12/7/2023

	Result	Unit	LOD	LOQ	Dil	Method	Ext Date	Run Date	Analyst	Code
Organic										
GASES										
Ethane	< 0.5	ug/l	0.5	1.5	1	8015		12/12/2023	ZJW	1
Ethene	< 0.5	ug/l	0.5	1.5	1	8015		12/12/2023	ZJW	1
Methane	41.4	ug/l	1	3	1	8015		12/12/2023	ZJW	1
VOC's										
Benzene	< 0.3	ug/l	0.3	1.25	1	8260B		12/11/2023	CJR	1
Bromobenzene	< 0.34	ug/l	0.34	1.4	1	8260B		12/11/2023	CJR	1
Bromodichloromethane	< 0.36	ug/l	0.36	1.47	1	8260B		12/11/2023	CJR	1
Bromoform	< 0.42	ug/l	0.42	1.72	1	8260B		12/11/2023	CJR	1
tert-Butylbenzene	< 0.37	ug/l	0.37	1.49	1	8260B		12/11/2023	CJR	1
sec-Butylbenzene	< 0.33	ug/l	0.33	1.34	1	8260B		12/11/2023	CJR	1
n-Butylbenzene	< 0.71	ug/l	0.71	2.9	1	8260B		12/11/2023	CJR	1
Carbon Tetrachloride	< 0.34	ug/l	0.34	1.39	1	8260B		12/11/2023	CJR	1
Chlorobenzene	< 0.29	ug/l	0.29	1.19	1	8260B		12/11/2023	CJR	1
Chloroethane	< 0.62	ug/l	0.62	2.54	1	8260B		12/11/2023	CJR	1
Chloroform	< 0.33	ug/l	0.33	1.33	1	8260B		12/11/2023	CJR	1
Chloromethane	< 0.74	ug/l	0.74	3.03	1	8260B		12/11/2023	CJR	1
2-Chlorotoluene	< 0.34	ug/l	0.34	1.37	1	8260B		12/11/2023	CJR	1
4-Chlorotoluene	< 0.4	ug/l	0.4	1.63	1	8260B		12/11/2023	CJR	1
1,2-Dibromo-3-chloropropane	< 0.74	ug/l	0.74	3.01	1	8260B		12/11/2023	CJR	1
Dibromochloromethane	< 0.36	ug/l	0.36	1.46	1	8260B		12/11/2023	CJR	1
1,4-Dichlorobenzene	< 0.49	ug/l	0.49	2.01	1	8260B		12/11/2023	CJR	1
1,3-Dichlorobenzene	< 0.35	ug/l	0.35	1.44	1	8260B		12/11/2023	CJR	1
1,2-Dichlorobenzene	< 0.4	ug/l	0.4	1.65	1	8260B		12/11/2023	CJR	1
Dichlorodifluoromethane	< 0.3	ug/l	0.3	1.23	1	8260B		12/11/2023	CJR	1
1,2-Dichloroethane	< 0.43	ug/l	0.43	1.75	1	8260B		12/11/2023	CJR	1
1,1-Dichloroethane	< 0.43	ug/l	0.43	1.74	1	8260B		12/11/2023	CJR	1
1,1-Dichloroethene	< 0.43	ug/l	0.43	1.76	1	8260B		12/11/2023	CJR	1
cis-1,2-Dichloroethene	0.61 "J"	ug/l	0.32	1.29	1	8260B		12/11/2023	CJR	1
trans-1,2-Dichloroethene	< 0.5	ug/l	0.5	2.02	1	8260B		12/11/2023	CJR	1
1,2-Dichloropropane	< 0.39	ug/l	0.39	1.58	1	8260B		12/11/2023	CJR	1
1,3-Dichloropropane	< 0.38	ug/l	0.38	1.55	1	8260B		12/11/2023	CJR	1
trans-1,3-Dichloropropene	< 0.41	ug/l	0.41	1.67	1	8260B		12/11/2023	CJR	1
cis-1,3-Dichloropropene	< 0.41	ug/l	0.41	1.67	1	8260B		12/11/2023	CJR	1
Di-isopropyl ether	< 0.48	ug/l	0.48	1.96	1	8260B		12/11/2023	CJR	1
EDB (1,2-Dibromoethane)	< 0.39	ug/l	0.39	1.59	1	8260B		12/11/2023	CJR	1
Ethylbenzene	< 0.33	ug/l	0.33	1.37	1	8260B		12/11/2023	CJR	1
Hexachlorobutadiene	< 0.81	ug/l	0.81	3.44	1	8260B		12/11/2023	CJR	1
Isopropylbenzene	< 0.34	ug/l	0.34	1.38	1	8260B		12/11/2023	CJR	1
p-Isopropyltoluene	< 0.47	ug/l	0.47	1.91	1	8260B		12/11/2023	CJR	1
Methylene chloride	< 0.79	ug/l	0.79	3.23	1	8260B		12/11/2023	CJR	1
Methyl tert-butyl ether (MTBE)	< 0.47	ug/l	0.47	1.91	1	8260B		12/11/2023	CJR	1
Naphthalene	< 1.4	ug/l	1.4	5.56	1	8260B		12/11/2023	CJR	1
n-Propylbenzene	< 0.39	ug/l	0.39	1.6	1	8260B		12/11/2023	CJR	1
1,1,2,2-Tetrachloroethane	< 0.43	ug/l	0.43	1.77	1	8260B		12/11/2023	CJR	1

Project Name OHM-ELM GROVE 6142
Project # 6142

Invoice # E43312

Lab Code 5043312D
Sample ID 6142-MW-4
Sample Matrix Water
Sample Date 12/7/2023

	Result	Unit	LOD	LOQ	Dil	Method	Ext Date	Run Date	Analyst	Code
1,1,1,2-Tetrachloroethane	< 0.55	ug/l	0.55	2.25	1	8260B		12/11/2023	CJR	1
Tetrachloroethane	< 0.47	ug/l	0.47	1.91	1	8260B		12/11/2023	CJR	1
Toluene	< 0.33	ug/l	0.33	1.35	1	8260B		12/11/2023	CJR	1
1,2,4-Trichlorobenzene	< 0.63	ug/l	0.63	2.57	1	8260B		12/11/2023	CJR	1
1,2,3-Trichlorobenzene	< 1.4	ug/l	1.4	5.94	1	8260B		12/11/2023	CJR	1
1,1,1-Trichloroethane	< 0.33	ug/l	0.33	1.34	1	8260B		12/11/2023	CJR	1
1,1,2-Trichloroethane	< 0.42	ug/l	0.42	1.72	1	8260B		12/11/2023	CJR	1
Trichloroethene (TCE)	< 0.38	ug/l	0.38	1.55	1	8260B		12/11/2023	CJR	1
Trichlorofluoromethane	< 0.33	ug/l	0.33	1.35	1	8260B		12/11/2023	CJR	1
1,2,4-Trimethylbenzene	< 0.35	ug/l	0.35	1.44	1	8260B		12/11/2023	CJR	1
1,3,5-Trimethylbenzene	< 0.41	ug/l	0.41	1.66	1	8260B		12/11/2023	CJR	1
Vinyl Chloride	< 0.15	ug/l	0.15	0.61	1	8260B		12/11/2023	CJR	1
m&p-Xylene	< 0.64	ug/l	0.64	2.63	1	8260B		12/11/2023	CJR	1
o-Xylene	< 0.37	ug/l	0.37	1.51	1	8260B		12/11/2023	CJR	1
SUR - 1,2-Dichloroethane-d4	102	REC %			1	8260B		12/11/2023	CJR	1
SUR - 4-Bromofluorobenzene	90	REC %			1	8260B		12/11/2023	CJR	1
SUR - Dibromofluoromethane	91	REC %			1	8260B		12/11/2023	CJR	1
SUR - Toluene-d8	114	REC %			1	8260B		12/11/2023	CJR	1

Wet Chemistry

General

Total Organic Carbon	2.90	mg/l	0.7	2	1	SM 5310B		12/19/2023	SLA	1
----------------------	------	------	-----	---	---	----------	--	------------	-----	---

Project Name OHM-ELM GROVE 6142
Project # 6142

Invoice # E43312

Lab Code 5043312E
Sample ID 6142-MW-5
Sample Matrix Water
Sample Date 12/8/2023

	Result	Unit	LOD	LOQ	Dil	Method	Ext Date	Run Date	Analyst	Code
Organic										
GASES										
Ethane	< 5	ug/l	5	15	10	8015		12/12/2023	ZJW	1
Ethene	< 5	ug/l	5	15	10	8015		12/12/2023	ZJW	1
Methane	3417	ug/l	10	30	10	8015		12/12/2023	ZJW	1
VOC's										
Benzene	< 0.3	ug/l	0.3	1.25	1	8260B		12/14/2023	CJR	1
Bromobenzene	< 0.34	ug/l	0.34	1.4	1	8260B		12/14/2023	CJR	1
Bromodichloromethane	< 0.36	ug/l	0.36	1.47	1	8260B		12/14/2023	CJR	1
Bromoform	< 0.42	ug/l	0.42	1.72	1	8260B		12/14/2023	CJR	1
tert-Butylbenzene	< 0.37	ug/l	0.37	1.49	1	8260B		12/14/2023	CJR	1
sec-Butylbenzene	< 0.33	ug/l	0.33	1.34	1	8260B		12/14/2023	CJR	1
n-Butylbenzene	< 0.71	ug/l	0.71	2.9	1	8260B		12/14/2023	CJR	1
Carbon Tetrachloride	< 0.34	ug/l	0.34	1.39	1	8260B		12/14/2023	CJR	1
Chlorobenzene	< 0.29	ug/l	0.29	1.19	1	8260B		12/14/2023	CJR	1
Chloroethane	< 0.62	ug/l	0.62	2.54	1	8260B		12/14/2023	CJR	1
Chloroform	< 0.33	ug/l	0.33	1.33	1	8260B		12/14/2023	CJR	1
Chloromethane	< 0.74	ug/l	0.74	3.03	1	8260B		12/14/2023	CJR	1
2-Chlorotoluene	< 0.34	ug/l	0.34	1.37	1	8260B		12/14/2023	CJR	1
4-Chlorotoluene	< 0.4	ug/l	0.4	1.63	1	8260B		12/14/2023	CJR	1
1,2-Dibromo-3-chloropropane	< 0.74	ug/l	0.74	3.01	1	8260B		12/14/2023	CJR	1
Dibromochloromethane	< 0.36	ug/l	0.36	1.46	1	8260B		12/14/2023	CJR	1
1,4-Dichlorobenzene	< 0.49	ug/l	0.49	2.01	1	8260B		12/14/2023	CJR	1
1,3-Dichlorobenzene	< 0.35	ug/l	0.35	1.44	1	8260B		12/14/2023	CJR	1
1,2-Dichlorobenzene	< 0.4	ug/l	0.4	1.65	1	8260B		12/14/2023	CJR	1
Dichlorodifluoromethane	< 0.3	ug/l	0.3	1.23	1	8260B		12/14/2023	CJR	1
1,2-Dichloroethane	< 0.43	ug/l	0.43	1.75	1	8260B		12/14/2023	CJR	1
1,1-Dichloroethane	< 0.43	ug/l	0.43	1.74	1	8260B		12/14/2023	CJR	1
1,1-Dichloroethene	< 0.43	ug/l	0.43	1.76	1	8260B		12/14/2023	CJR	1
cis-1,2-Dichloroethene	36	ug/l	0.32	1.29	1	8260B		12/14/2023	CJR	1
trans-1,2-Dichloroethene	3.8	ug/l	0.5	2.02	1	8260B		12/14/2023	CJR	1
1,2-Dichloropropane	< 0.39	ug/l	0.39	1.58	1	8260B		12/14/2023	CJR	1
1,3-Dichloropropane	< 0.38	ug/l	0.38	1.55	1	8260B		12/14/2023	CJR	1
trans-1,3-Dichloropropene	< 0.41	ug/l	0.41	1.67	1	8260B		12/14/2023	CJR	1
cis-1,3-Dichloropropene	< 0.41	ug/l	0.41	1.67	1	8260B		12/14/2023	CJR	1
Di-isopropyl ether	< 0.48	ug/l	0.48	1.96	1	8260B		12/14/2023	CJR	1
EDB (1,2-Dibromoethane)	< 0.39	ug/l	0.39	1.59	1	8260B		12/14/2023	CJR	1
Ethylbenzene	< 0.33	ug/l	0.33	1.37	1	8260B		12/14/2023	CJR	1
Hexachlorobutadiene	< 0.81	ug/l	0.81	3.44	1	8260B		12/14/2023	CJR	1
Isopropylbenzene	< 0.34	ug/l	0.34	1.38	1	8260B		12/14/2023	CJR	1
p-Isopropyltoluene	< 0.47	ug/l	0.47	1.91	1	8260B		12/14/2023	CJR	1
Methylene chloride	< 0.79	ug/l	0.79	3.23	1	8260B		12/14/2023	CJR	1
Methyl tert-butyl ether (MTBE)	< 0.47	ug/l	0.47	1.91	1	8260B		12/14/2023	CJR	1
Naphthalene	< 1.4	ug/l	1.4	5.56	1	8260B		12/14/2023	CJR	1
n-Propylbenzene	< 0.39	ug/l	0.39	1.6	1	8260B		12/14/2023	CJR	1
1,1,2,2-Tetrachloroethane	< 0.43	ug/l	0.43	1.77	1	8260B		12/14/2023	CJR	1

Project Name OHM-ELM GROVE 6142
Project # 6142

Invoice # E43312

Lab Code 5043312E
Sample ID 6142-MW-5
Sample Matrix Water
Sample Date 12/8/2023

	Result	Unit	LOD	LOQ	Dil	Method	Ext Date	Run Date	Analyst	Code
1,1,1,2-Tetrachloroethane	< 0.55	ug/l	0.55	2.25	1	8260B		12/14/2023	CJR	1
Tetrachloroethene	1.03 "J"	ug/l	0.47	1.91	1	8260B		12/14/2023	CJR	1
Toluene	< 0.33	ug/l	0.33	1.35	1	8260B		12/14/2023	CJR	1
1,2,4-Trichlorobenzene	< 0.63	ug/l	0.63	2.57	1	8260B		12/14/2023	CJR	1
1,2,3-Trichlorobenzene	< 1.4	ug/l	1.4	5.94	1	8260B		12/14/2023	CJR	1
1,1,1-Trichloroethane	< 0.33	ug/l	0.33	1.34	1	8260B		12/14/2023	CJR	1
1,1,2-Trichloroethane	< 0.42	ug/l	0.42	1.72	1	8260B		12/14/2023	CJR	1
Trichloroethene (TCE)	3.4	ug/l	0.38	1.55	1	8260B		12/14/2023	CJR	1
Trichlorofluoromethane	< 0.33	ug/l	0.33	1.35	1	8260B		12/14/2023	CJR	1
1,2,4-Trimethylbenzene	< 0.35	ug/l	0.35	1.44	1	8260B		12/14/2023	CJR	1
1,3,5-Trimethylbenzene	< 0.41	ug/l	0.41	1.66	1	8260B		12/14/2023	CJR	1
Vinyl Chloride	3.2	ug/l	0.15	0.61	1	8260B		12/14/2023	CJR	1
m&p-Xylene	< 0.64	ug/l	0.64	2.63	1	8260B		12/14/2023	CJR	1
o-Xylene	< 0.37	ug/l	0.37	1.51	1	8260B		12/14/2023	CJR	1
SUR - 1,2-Dichloroethane-d4	107	REC %			1	8260B		12/14/2023	CJR	1
SUR - 4-Bromofluorobenzene	94	REC %			1	8260B		12/14/2023	CJR	1
SUR - Dibromofluoromethane	102	REC %			1	8260B		12/14/2023	CJR	1
SUR - Toluene-d8	112	REC %			1	8260B		12/14/2023	CJR	1
Wet Chemistry										
General										
Total Organic Carbon	4.93	mg/l	0.7	2	1	SM 5310B		12/19/2023	SLA	1

Project Name OHM-ELM GROVE 6142
Project # 6142

Invoice # E43312

Lab Code 5043312F
Sample ID 6142-MW-6
Sample Matrix Water
Sample Date 12/8/2023

	Result	Unit	LOD	LOQ	Dil	Method	Ext Date	Run Date	Analyst	Code
Organic										
GASES										
Ethane	< 5	ug/l	5	15	10	8015		12/12/2023	ZJW	1
Ethene	< 5	ug/l	5	15	10	8015		12/12/2023	ZJW	1
Methane	2011	ug/l	10	30	10	8015		12/12/2023	ZJW	1
VOC's										
Benzene	< 0.6	ug/l	0.6	2.5	2	8260B		12/15/2023	CJR	1
Bromobenzene	< 0.68	ug/l	0.68	2.8	2	8260B		12/15/2023	CJR	1
Bromodichloromethane	< 0.72	ug/l	0.72	2.94	2	8260B		12/15/2023	CJR	1
Bromoform	< 0.84	ug/l	0.84	3.44	2	8260B		12/15/2023	CJR	1
tert-Butylbenzene	< 0.74	ug/l	0.74	2.98	2	8260B		12/15/2023	CJR	1
sec-Butylbenzene	< 0.66	ug/l	0.66	2.68	2	8260B		12/15/2023	CJR	1
n-Butylbenzene	< 1.42	ug/l	1.42	5.8	2	8260B		12/15/2023	CJR	1
Carbon Tetrachloride	< 0.68	ug/l	0.68	2.78	2	8260B		12/15/2023	CJR	1
Chlorobenzene	< 0.58	ug/l	0.58	2.38	2	8260B		12/15/2023	CJR	1
Chloroethane	< 1.24	ug/l	1.24	5.08	2	8260B		12/15/2023	CJR	1
Chloroform	< 0.66	ug/l	0.66	2.66	2	8260B		12/15/2023	CJR	1
Chloromethane	< 1.48	ug/l	1.48	6.06	2	8260B		12/15/2023	CJR	1
2-Chlorotoluene	< 0.68	ug/l	0.68	2.74	2	8260B		12/15/2023	CJR	1
4-Chlorotoluene	< 0.8	ug/l	0.8	3.26	2	8260B		12/15/2023	CJR	1
1,2-Dibromo-3-chloropropane	< 1.48	ug/l	1.48	6.02	2	8260B		12/15/2023	CJR	1
Dibromochloromethane	< 0.72	ug/l	0.72	2.92	2	8260B		12/15/2023	CJR	1
1,4-Dichlorobenzene	< 0.98	ug/l	0.98	4.02	2	8260B		12/15/2023	CJR	1
1,3-Dichlorobenzene	< 0.7	ug/l	0.7	2.88	2	8260B		12/15/2023	CJR	1
1,2-Dichlorobenzene	< 0.8	ug/l	0.8	3.3	2	8260B		12/15/2023	CJR	1
Dichlorodifluoromethane	< 0.6	ug/l	0.6	2.46	2	8260B		12/15/2023	CJR	1
1,2-Dichloroethane	< 0.86	ug/l	0.86	3.5	2	8260B		12/15/2023	CJR	1
1,1-Dichloroethane	< 0.86	ug/l	0.86	3.48	2	8260B		12/15/2023	CJR	1
1,1-Dichloroethene	< 0.86	ug/l	0.86	3.52	2	8260B		12/15/2023	CJR	1
cis-1,2-Dichloroethene	116	ug/l	0.64	2.58	2	8260B		12/15/2023	CJR	1
trans-1,2-Dichloroethene	9.9	ug/l	1	4.04	2	8260B		12/15/2023	CJR	1
1,2-Dichloropropane	< 0.78	ug/l	0.78	3.16	2	8260B		12/15/2023	CJR	1
1,3-Dichloropropane	< 0.76	ug/l	0.76	3.1	2	8260B		12/15/2023	CJR	1
trans-1,3-Dichloropropene	< 0.82	ug/l	0.82	3.34	2	8260B		12/15/2023	CJR	1
cis-1,3-Dichloropropene	< 0.82	ug/l	0.82	3.34	2	8260B		12/15/2023	CJR	1
Di-isopropyl ether	< 0.96	ug/l	0.96	3.92	2	8260B		12/15/2023	CJR	1
EDB (1,2-Dibromoethane)	< 0.78	ug/l	0.78	3.18	2	8260B		12/15/2023	CJR	1
Ethylbenzene	< 0.66	ug/l	0.66	2.74	2	8260B		12/15/2023	CJR	1
Hexachlorobutadiene	< 1.62	ug/l	1.62	6.88	2	8260B		12/15/2023	CJR	1
Isopropylbenzene	< 0.68	ug/l	0.68	2.76	2	8260B		12/15/2023	CJR	1
p-Isopropyltoluene	< 0.94	ug/l	0.94	3.82	2	8260B		12/15/2023	CJR	1
Methylene chloride	< 1.58	ug/l	1.58	6.46	2	8260B		12/15/2023	CJR	1
Methyl tert-butyl ether (MTBE)	< 0.94	ug/l	0.94	3.82	2	8260B		12/15/2023	CJR	1
Naphthalene	< 2.8	ug/l	2.8	11.12	2	8260B		12/15/2023	CJR	1
n-Propylbenzene	< 0.78	ug/l	0.78	3.2	2	8260B		12/15/2023	CJR	1
1,1,2,2-Tetrachloroethane	< 0.86	ug/l	0.86	3.54	2	8260B		12/15/2023	CJR	1

Project Name OHM-ELM GROVE 6142
Project # 6142

Invoice # E43312

Lab Code 5043312F
Sample ID 6142-MW-6
Sample Matrix Water
Sample Date 12/8/2023

	Result	Unit	LOD	LOQ	Dil	Method	Ext Date	Run Date	Analyst	Code
1,1,1,2-Tetrachloroethane	< 1.1	ug/l	1.1	4.5	2	8260B		12/15/2023	CJR	1
Tetrachloroethene	1.06 "J"	ug/l	0.94	3.82	2	8260B		12/15/2023	CJR	1
Toluene	< 0.66	ug/l	0.66	2.7	2	8260B		12/15/2023	CJR	1
1,2,4-Trichlorobenzene	< 1.26	ug/l	1.26	5.14	2	8260B		12/15/2023	CJR	1
1,2,3-Trichlorobenzene	< 2.8	ug/l	2.8	11.88	2	8260B		12/15/2023	CJR	1
1,1,1-Trichloroethane	< 0.66	ug/l	0.66	2.68	2	8260B		12/15/2023	CJR	1
1,1,2-Trichloroethane	< 0.84	ug/l	0.84	3.44	2	8260B		12/15/2023	CJR	1
Trichloroethene (TCE)	< 0.76	ug/l	0.76	3.1	2	8260B		12/15/2023	CJR	1
Trichlorofluoromethane	< 0.66	ug/l	0.66	2.7	2	8260B		12/15/2023	CJR	1
1,2,4-Trimethylbenzene	< 0.7	ug/l	0.7	2.88	2	8260B		12/15/2023	CJR	1
1,3,5-Trimethylbenzene	< 0.82	ug/l	0.82	3.32	2	8260B		12/15/2023	CJR	1
Vinyl Chloride	22.3	ug/l	0.3	1.22	2	8260B		12/15/2023	CJR	1
m&p-Xylene	< 1.28	ug/l	1.28	5.26	2	8260B		12/15/2023	CJR	1
o-Xylene	< 0.74	ug/l	0.74	3.02	2	8260B		12/15/2023	CJR	1
SUR - 1,2-Dichloroethane-d4	120	REC %			2	8260B		12/15/2023	CJR	1
SUR - 4-Bromofluorobenzene	92	REC %			2	8260B		12/15/2023	CJR	1
SUR - Dibromofluoromethane	102	REC %			2	8260B		12/15/2023	CJR	1
SUR - Toluene-d8	111	REC %			2	8260B		12/15/2023	CJR	1
Wet Chemistry										
General										
Total Organic Carbon	3.42	mg/l	0.7	2	1	SM 5310B		12/19/2023	SLA	1

Project Name OHM-ELM GROVE 6142
Project # 6142

Invoice # E43312

Lab Code 5043312G
Sample ID 6142-MW-7
Sample Matrix Water
Sample Date 12/8/2023

	Result	Unit	LOD	LOQ	Dil	Method	Ext Date	Run Date	Analyst	Code
Organic										
GASES										
Ethane	< 5	ug/l	5	15	10	8015		12/12/2023	ZJW	1
Ethene	< 5	ug/l	5	15	10	8015		12/12/2023	ZJW	1
Methane	1825	ug/l	10	30	10	8015		12/12/2023	ZJW	1
VOC's										
Benzene	< 1.5	ug/l	1.5	6.25	5	8260B		12/15/2023	CJR	1
Bromobenzene	< 1.7	ug/l	1.7	7	5	8260B		12/15/2023	CJR	1
Bromodichloromethane	< 1.8	ug/l	1.8	7.35	5	8260B		12/15/2023	CJR	1
Bromoform	< 2.1	ug/l	2.1	8.6	5	8260B		12/15/2023	CJR	1
tert-Butylbenzene	< 1.85	ug/l	1.85	7.45	5	8260B		12/15/2023	CJR	1
sec-Butylbenzene	< 1.65	ug/l	1.65	6.7	5	8260B		12/15/2023	CJR	1
n-Butylbenzene	< 3.55	ug/l	3.55	14.5	5	8260B		12/15/2023	CJR	1
Carbon Tetrachloride	< 1.7	ug/l	1.7	6.95	5	8260B		12/15/2023	CJR	1
Chlorobenzene	< 1.45	ug/l	1.45	5.95	5	8260B		12/15/2023	CJR	1
Chloroethane	< 3.1	ug/l	3.1	12.7	5	8260B		12/15/2023	CJR	1
Chloroform	< 1.65	ug/l	1.65	6.65	5	8260B		12/15/2023	CJR	1
Chloromethane	< 3.7	ug/l	3.7	15.15	5	8260B		12/15/2023	CJR	1
2-Chlorotoluene	< 1.7	ug/l	1.7	6.85	5	8260B		12/15/2023	CJR	1
4-Chlorotoluene	< 2	ug/l	2	8.15	5	8260B		12/15/2023	CJR	1
1,2-Dibromo-3-chloropropane	< 3.7	ug/l	3.7	15.05	5	8260B		12/15/2023	CJR	1
Dibromochloromethane	< 1.8	ug/l	1.8	7.3	5	8260B		12/15/2023	CJR	1
1,4-Dichlorobenzene	< 2.45	ug/l	2.45	10.05	5	8260B		12/15/2023	CJR	1
1,3-Dichlorobenzene	< 1.75	ug/l	1.75	7.2	5	8260B		12/15/2023	CJR	1
1,2-Dichlorobenzene	< 2	ug/l	2	8.25	5	8260B		12/15/2023	CJR	1
Dichlorodifluoromethane	< 1.5	ug/l	1.5	6.15	5	8260B		12/15/2023	CJR	1
1,2-Dichloroethane	< 2.15	ug/l	2.15	8.75	5	8260B		12/15/2023	CJR	1
1,1-Dichloroethane	< 2.15	ug/l	2.15	8.7	5	8260B		12/15/2023	CJR	1
1,1-Dichloroethene	< 2.15	ug/l	2.15	8.8	5	8260B		12/15/2023	CJR	1
cis-1,2-Dichloroethene	320	ug/l	1.6	6.45	5	8260B		12/15/2023	CJR	1
trans-1,2-Dichloroethene	14.9	ug/l	2.5	10.1	5	8260B		12/15/2023	CJR	1
1,2-Dichloropropane	< 1.95	ug/l	1.95	7.9	5	8260B		12/15/2023	CJR	1
1,3-Dichloropropane	< 1.9	ug/l	1.9	7.75	5	8260B		12/15/2023	CJR	1
trans-1,3-Dichloropropene	< 2.05	ug/l	2.05	8.35	5	8260B		12/15/2023	CJR	1
cis-1,3-Dichloropropene	< 2.05	ug/l	2.05	8.35	5	8260B		12/15/2023	CJR	1
Di-isopropyl ether	< 2.4	ug/l	2.4	9.8	5	8260B		12/15/2023	CJR	1
EDB (1,2-Dibromoethane)	< 1.95	ug/l	1.95	7.95	5	8260B		12/15/2023	CJR	1
Ethylbenzene	< 1.65	ug/l	1.65	6.85	5	8260B		12/15/2023	CJR	1
Hexachlorobutadiene	< 4.05	ug/l	4.05	17.2	5	8260B		12/15/2023	CJR	1
Isopropylbenzene	< 1.7	ug/l	1.7	6.9	5	8260B		12/15/2023	CJR	1
p-Isopropyltoluene	< 2.35	ug/l	2.35	9.55	5	8260B		12/15/2023	CJR	1
Methylene chloride	< 3.95	ug/l	3.95	16.15	5	8260B		12/15/2023	CJR	1
Methyl tert-butyl ether (MTBE)	< 2.35	ug/l	2.35	9.55	5	8260B		12/15/2023	CJR	1
Naphthalene	< 7	ug/l	7	27.8	5	8260B		12/15/2023	CJR	1
n-Propylbenzene	< 1.95	ug/l	1.95	8	5	8260B		12/15/2023	CJR	1
1,1,2,2-Tetrachloroethane	< 2.15	ug/l	2.15	8.85	5	8260B		12/15/2023	CJR	1

Project Name OHM-ELM GROVE 6142
Project # 6142

Invoice # E43312

Lab Code 5043312G
Sample ID 6142-MW-7
Sample Matrix Water
Sample Date 12/8/2023

	Result	Unit	LOD	LOQ	Dil	Method	Ext Date	Run Date	Analyst	Code
1,1,1,2-Tetrachloroethane	< 2.75	ug/l	2.75	11.25	5	8260B		12/15/2023	CJR	1
Tetrachloroethene	< 2.35	ug/l	2.35	9.55	5	8260B		12/15/2023	CJR	1
Toluene	< 1.65	ug/l	1.65	6.75	5	8260B		12/15/2023	CJR	1
1,2,4-Trichlorobenzene	< 3.15	ug/l	3.15	12.85	5	8260B		12/15/2023	CJR	1
1,2,3-Trichlorobenzene	< 7	ug/l	7	29.7	5	8260B		12/15/2023	CJR	1
1,1,1-Trichloroethane	< 1.65	ug/l	1.65	6.7	5	8260B		12/15/2023	CJR	1
1,1,2-Trichloroethane	< 2.1	ug/l	2.1	8.6	5	8260B		12/15/2023	CJR	1
Trichloroethene (TCE)	< 1.9	ug/l	1.9	7.75	5	8260B		12/15/2023	CJR	1
Trichlorofluoromethane	< 1.65	ug/l	1.65	6.75	5	8260B		12/15/2023	CJR	1
1,2,4-Trimethylbenzene	< 1.75	ug/l	1.75	7.2	5	8260B		12/15/2023	CJR	1
1,3,5-Trimethylbenzene	< 2.05	ug/l	2.05	8.3	5	8260B		12/15/2023	CJR	1
Vinyl Chloride	81	ug/l	0.75	3.05	5	8260B		12/15/2023	CJR	1
m&p-Xylene	< 3.2	ug/l	3.2	13.15	5	8260B		12/15/2023	CJR	1
o-Xylene	< 1.85	ug/l	1.85	7.55	5	8260B		12/15/2023	CJR	1
SUR - 1,2-Dichloroethane-d4	113	REC %			5	8260B		12/15/2023	CJR	1
SUR - 4-Bromofluorobenzene	94	REC %			5	8260B		12/15/2023	CJR	1
SUR - Dibromofluoromethane	103	REC %			5	8260B		12/15/2023	CJR	1
SUR - Toluene-d8	113	REC %			5	8260B		12/15/2023	CJR	1

Wet Chemistry

General

Total Organic Carbon	5.06	mg/l	0.7	2	1	SM 5310B		12/19/2023	SLA	1
----------------------	------	------	-----	---	---	----------	--	------------	-----	---

Project Name OHM-ELM GROVE 6142
Project # 6142

Invoice # E43312

Lab Code 5043312H
Sample ID 6142-MW-8
Sample Matrix Water
Sample Date 12/7/2023

	Result	Unit	LOD	LOQ	Dil	Method	Ext Date	Run Date	Analyst	Code
Organic										
GASES										
Ethane	< 0.5	ug/l	0.5	1.5	1	8015		12/12/2023	ZJW	1
Ethene	< 0.5	ug/l	0.5	1.5	1	8015		12/12/2023	ZJW	1
Methane	43.2	ug/l	1	3	1	8015		12/12/2023	ZJW	1
VOC's										
Benzene	< 0.3	ug/l	0.3	1.25	1	8260B		12/11/2023	CJR	1
Bromobenzene	< 0.34	ug/l	0.34	1.4	1	8260B		12/11/2023	CJR	1
Bromodichloromethane	< 0.36	ug/l	0.36	1.47	1	8260B		12/11/2023	CJR	1
Bromoform	< 0.42	ug/l	0.42	1.72	1	8260B		12/11/2023	CJR	1
tert-Butylbenzene	< 0.37	ug/l	0.37	1.49	1	8260B		12/11/2023	CJR	1
sec-Butylbenzene	< 0.33	ug/l	0.33	1.34	1	8260B		12/11/2023	CJR	1
n-Butylbenzene	< 0.71	ug/l	0.71	2.9	1	8260B		12/11/2023	CJR	1
Carbon Tetrachloride	< 0.34	ug/l	0.34	1.39	1	8260B		12/11/2023	CJR	1
Chlorobenzene	< 0.29	ug/l	0.29	1.19	1	8260B		12/11/2023	CJR	1
Chloroethane	< 0.62	ug/l	0.62	2.54	1	8260B		12/11/2023	CJR	1
Chloroform	< 0.33	ug/l	0.33	1.33	1	8260B		12/11/2023	CJR	1
Chloromethane	< 0.74	ug/l	0.74	3.03	1	8260B		12/11/2023	CJR	1
2-Chlorotoluene	< 0.34	ug/l	0.34	1.37	1	8260B		12/11/2023	CJR	1
4-Chlorotoluene	< 0.4	ug/l	0.4	1.63	1	8260B		12/11/2023	CJR	1
1,2-Dibromo-3-chloropropane	< 0.74	ug/l	0.74	3.01	1	8260B		12/11/2023	CJR	1
Dibromochloromethane	< 0.36	ug/l	0.36	1.46	1	8260B		12/11/2023	CJR	1
1,4-Dichlorobenzene	< 0.49	ug/l	0.49	2.01	1	8260B		12/11/2023	CJR	1
1,3-Dichlorobenzene	< 0.35	ug/l	0.35	1.44	1	8260B		12/11/2023	CJR	1
1,2-Dichlorobenzene	< 0.4	ug/l	0.4	1.65	1	8260B		12/11/2023	CJR	1
Dichlorodifluoromethane	< 0.3	ug/l	0.3	1.23	1	8260B		12/11/2023	CJR	1
1,2-Dichloroethane	< 0.43	ug/l	0.43	1.75	1	8260B		12/11/2023	CJR	1
1,1-Dichloroethane	< 0.43	ug/l	0.43	1.74	1	8260B		12/11/2023	CJR	1
1,1-Dichloroethene	< 0.43	ug/l	0.43	1.76	1	8260B		12/11/2023	CJR	1
cis-1,2-Dichloroethene	< 0.32	ug/l	0.32	1.29	1	8260B		12/11/2023	CJR	1
trans-1,2-Dichloroethene	< 0.5	ug/l	0.5	2.02	1	8260B		12/11/2023	CJR	1
1,2-Dichloropropane	< 0.39	ug/l	0.39	1.58	1	8260B		12/11/2023	CJR	1
1,3-Dichloropropane	< 0.38	ug/l	0.38	1.55	1	8260B		12/11/2023	CJR	1
trans-1,3-Dichloropropene	< 0.41	ug/l	0.41	1.67	1	8260B		12/11/2023	CJR	1
cis-1,3-Dichloropropene	< 0.41	ug/l	0.41	1.67	1	8260B		12/11/2023	CJR	1
Di-isopropyl ether	< 0.48	ug/l	0.48	1.96	1	8260B		12/11/2023	CJR	1
EDB (1,2-Dibromoethane)	< 0.39	ug/l	0.39	1.59	1	8260B		12/11/2023	CJR	1
Ethylbenzene	< 0.33	ug/l	0.33	1.37	1	8260B		12/11/2023	CJR	1
Hexachlorobutadiene	< 0.81	ug/l	0.81	3.44	1	8260B		12/11/2023	CJR	1
Isopropylbenzene	< 0.34	ug/l	0.34	1.38	1	8260B		12/11/2023	CJR	1
p-Isopropyltoluene	< 0.47	ug/l	0.47	1.91	1	8260B		12/11/2023	CJR	1
Methylene chloride	< 0.79	ug/l	0.79	3.23	1	8260B		12/11/2023	CJR	1
Methyl tert-butyl ether (MTBE)	< 0.47	ug/l	0.47	1.91	1	8260B		12/11/2023	CJR	1
Naphthalene	< 1.4	ug/l	1.4	5.56	1	8260B		12/11/2023	CJR	1
n-Propylbenzene	< 0.39	ug/l	0.39	1.6	1	8260B		12/11/2023	CJR	1
1,1,2,2-Tetrachloroethane	< 0.43	ug/l	0.43	1.77	1	8260B		12/11/2023	CJR	1

Project Name OHM-ELM GROVE 6142
Project # 6142

Invoice # E43312

Lab Code 5043312H
Sample ID 6142-MW-8
Sample Matrix Water
Sample Date 12/7/2023

	Result	Unit	LOD	LOQ	Dil	Method	Ext Date	Run Date	Analyst	Code
1,1,1,2-Tetrachloroethane	< 0.55	ug/l	0.55	2.25	1	8260B		12/11/2023	CJR	1
Tetrachloroethane	< 0.47	ug/l	0.47	1.91	1	8260B		12/11/2023	CJR	1
Toluene	< 0.33	ug/l	0.33	1.35	1	8260B		12/11/2023	CJR	1
1,2,4-Trichlorobenzene	< 0.63	ug/l	0.63	2.57	1	8260B		12/11/2023	CJR	1
1,2,3-Trichlorobenzene	< 1.4	ug/l	1.4	5.94	1	8260B		12/11/2023	CJR	1
1,1,1-Trichloroethane	< 0.33	ug/l	0.33	1.34	1	8260B		12/11/2023	CJR	1
1,1,2-Trichloroethane	< 0.42	ug/l	0.42	1.72	1	8260B		12/11/2023	CJR	1
Trichloroethene (TCE)	< 0.38	ug/l	0.38	1.55	1	8260B		12/11/2023	CJR	1
Trichlorofluoromethane	< 0.33	ug/l	0.33	1.35	1	8260B		12/11/2023	CJR	1
1,2,4-Trimethylbenzene	< 0.35	ug/l	0.35	1.44	1	8260B		12/11/2023	CJR	1
1,3,5-Trimethylbenzene	< 0.41	ug/l	0.41	1.66	1	8260B		12/11/2023	CJR	1
Vinyl Chloride	< 0.15	ug/l	0.15	0.61	1	8260B		12/11/2023	CJR	1
m&p-Xylene	< 0.64	ug/l	0.64	2.63	1	8260B		12/11/2023	CJR	1
o-Xylene	< 0.37	ug/l	0.37	1.51	1	8260B		12/11/2023	CJR	1
SUR - 1,2-Dichloroethane-d4	102	REC %			1	8260B		12/11/2023	CJR	1
SUR - 4-Bromofluorobenzene	89	REC %			1	8260B		12/11/2023	CJR	1
SUR - Dibromofluoromethane	90	REC %			1	8260B		12/11/2023	CJR	1
SUR - Toluene-d8	110	REC %			1	8260B		12/11/2023	CJR	1
Wet Chemistry										
General										
Total Organic Carbon	5.59	mg/l	0.7	2	1	SM 5310B		12/19/2023	SLA	1

Project Name OHM-ELM GROVE 6142
Project # 6142

Invoice # E43312

Lab Code 5043312I
Sample ID 6142-MW-9
Sample Matrix Water
Sample Date 12/8/2023

	Result	Unit	LOD	LOQ	Dil	Method	Ext Date	Run Date	Analyst	Code
Organic										
GASES										
Ethane	< 0.5	ug/l	0.5	1.5	1	8015		12/12/2023	ZJW	1
Ethene	< 0.5	ug/l	0.5	1.5	1	8015		12/12/2023	ZJW	1
Methane	18.1	ug/l	1	3	1	8015		12/12/2023	ZJW	1
VOC's										
Benzene	< 0.3	ug/l	0.3	1.25	1	8260B		12/11/2023	CJR	1
Bromobenzene	< 0.34	ug/l	0.34	1.4	1	8260B		12/11/2023	CJR	1
Bromodichloromethane	< 0.36	ug/l	0.36	1.47	1	8260B		12/11/2023	CJR	1
Bromoform	< 0.42	ug/l	0.42	1.72	1	8260B		12/11/2023	CJR	1
tert-Butylbenzene	< 0.37	ug/l	0.37	1.49	1	8260B		12/11/2023	CJR	1
sec-Butylbenzene	< 0.33	ug/l	0.33	1.34	1	8260B		12/11/2023	CJR	1
n-Butylbenzene	< 0.71	ug/l	0.71	2.9	1	8260B		12/11/2023	CJR	1
Carbon Tetrachloride	< 0.34	ug/l	0.34	1.39	1	8260B		12/11/2023	CJR	1
Chlorobenzene	< 0.29	ug/l	0.29	1.19	1	8260B		12/11/2023	CJR	1
Chloroethane	< 0.62	ug/l	0.62	2.54	1	8260B		12/11/2023	CJR	1
Chloroform	< 0.33	ug/l	0.33	1.33	1	8260B		12/11/2023	CJR	1
Chloromethane	< 0.74	ug/l	0.74	3.03	1	8260B		12/11/2023	CJR	1
2-Chlorotoluene	< 0.34	ug/l	0.34	1.37	1	8260B		12/11/2023	CJR	1
4-Chlorotoluene	< 0.4	ug/l	0.4	1.63	1	8260B		12/11/2023	CJR	1
1,2-Dibromo-3-chloropropane	< 0.74	ug/l	0.74	3.01	1	8260B		12/11/2023	CJR	1
Dibromochloromethane	< 0.36	ug/l	0.36	1.46	1	8260B		12/11/2023	CJR	1
1,4-Dichlorobenzene	< 0.49	ug/l	0.49	2.01	1	8260B		12/11/2023	CJR	1
1,3-Dichlorobenzene	< 0.35	ug/l	0.35	1.44	1	8260B		12/11/2023	CJR	1
1,2-Dichlorobenzene	< 0.4	ug/l	0.4	1.65	1	8260B		12/11/2023	CJR	1
Dichlorodifluoromethane	< 0.3	ug/l	0.3	1.23	1	8260B		12/11/2023	CJR	1
1,2-Dichloroethane	< 0.43	ug/l	0.43	1.75	1	8260B		12/11/2023	CJR	1
1,1-Dichloroethane	< 0.43	ug/l	0.43	1.74	1	8260B		12/11/2023	CJR	1
1,1-Dichloroethene	< 0.43	ug/l	0.43	1.76	1	8260B		12/11/2023	CJR	1
cis-1,2-Dichloroethene	< 0.32	ug/l	0.32	1.29	1	8260B		12/11/2023	CJR	1
trans-1,2-Dichloroethene	< 0.5	ug/l	0.5	2.02	1	8260B		12/11/2023	CJR	1
1,2-Dichloropropane	< 0.39	ug/l	0.39	1.58	1	8260B		12/11/2023	CJR	1
1,3-Dichloropropane	< 0.38	ug/l	0.38	1.55	1	8260B		12/11/2023	CJR	1
trans-1,3-Dichloropropene	< 0.41	ug/l	0.41	1.67	1	8260B		12/11/2023	CJR	1
cis-1,3-Dichloropropene	< 0.41	ug/l	0.41	1.67	1	8260B		12/11/2023	CJR	1
Di-isopropyl ether	< 0.48	ug/l	0.48	1.96	1	8260B		12/11/2023	CJR	1
EDB (1,2-Dibromoethane)	< 0.39	ug/l	0.39	1.59	1	8260B		12/11/2023	CJR	1
Ethylbenzene	< 0.33	ug/l	0.33	1.37	1	8260B		12/11/2023	CJR	1
Hexachlorobutadiene	< 0.81	ug/l	0.81	3.44	1	8260B		12/11/2023	CJR	1
Isopropylbenzene	< 0.34	ug/l	0.34	1.38	1	8260B		12/11/2023	CJR	1
p-Isopropyltoluene	< 0.47	ug/l	0.47	1.91	1	8260B		12/11/2023	CJR	1
Methylene chloride	< 0.79	ug/l	0.79	3.23	1	8260B		12/11/2023	CJR	1
Methyl tert-butyl ether (MTBE)	< 0.47	ug/l	0.47	1.91	1	8260B		12/11/2023	CJR	1
Naphthalene	< 1.4	ug/l	1.4	5.56	1	8260B		12/11/2023	CJR	1
n-Propylbenzene	< 0.39	ug/l	0.39	1.6	1	8260B		12/11/2023	CJR	1
1,1,2,2-Tetrachloroethane	< 0.43	ug/l	0.43	1.77	1	8260B		12/11/2023	CJR	1

Project Name OHM-ELM GROVE 6142
Project # 6142

Invoice # E43312

Lab Code 5043312I
Sample ID 6142-MW-9
Sample Matrix Water
Sample Date 12/8/2023

	Result	Unit	LOD	LOQ	Dil	Method	Ext Date	Run Date	Analyst	Code
1,1,1,2-Tetrachloroethane	< 0.55	ug/l	0.55	2.25	1	8260B		12/11/2023	CJR	1
Tetrachloroethene	< 0.47	ug/l	0.47	1.91	1	8260B		12/11/2023	CJR	1
Toluene	< 0.33	ug/l	0.33	1.35	1	8260B		12/11/2023	CJR	1
1,2,4-Trichlorobenzene	< 0.63	ug/l	0.63	2.57	1	8260B		12/11/2023	CJR	1
1,2,3-Trichlorobenzene	< 1.4	ug/l	1.4	5.94	1	8260B		12/11/2023	CJR	1
1,1,1-Trichloroethane	< 0.33	ug/l	0.33	1.34	1	8260B		12/11/2023	CJR	1
1,1,2-Trichloroethane	< 0.42	ug/l	0.42	1.72	1	8260B		12/11/2023	CJR	1
Trichloroethene (TCE)	< 0.38	ug/l	0.38	1.55	1	8260B		12/11/2023	CJR	1
Trichlorofluoromethane	< 0.33	ug/l	0.33	1.35	1	8260B		12/11/2023	CJR	1
1,2,4-Trimethylbenzene	< 0.35	ug/l	0.35	1.44	1	8260B		12/11/2023	CJR	1
1,3,5-Trimethylbenzene	< 0.41	ug/l	0.41	1.66	1	8260B		12/11/2023	CJR	1
Vinyl Chloride	< 0.15	ug/l	0.15	0.61	1	8260B		12/11/2023	CJR	1
m&p-Xylene	< 0.64	ug/l	0.64	2.63	1	8260B		12/11/2023	CJR	1
o-Xylene	< 0.37	ug/l	0.37	1.51	1	8260B		12/11/2023	CJR	1
SUR - 1,2-Dichloroethane-d4	102	REC %			1	8260B		12/11/2023	CJR	1
SUR - 4-Bromofluorobenzene	89	REC %			1	8260B		12/11/2023	CJR	1
SUR - Dibromofluoromethane	92	REC %			1	8260B		12/11/2023	CJR	1
SUR - Toluene-d8	112	REC %			1	8260B		12/11/2023	CJR	1

Wet Chemistry

General

Total Organic Carbon	2.44	mg/l	0.7	2	1	SM 5310B		12/19/2023	SLA	1
----------------------	------	------	-----	---	---	----------	--	------------	-----	---

Project Name OHM-ELM GROVE 6142
Project # 6142

Invoice # E43312

Lab Code 5043312J
Sample ID 6142-PZ-1
Sample Matrix Water
Sample Date 12/7/2023

	Result	Unit	LOD	LOQ	Dil	Method	Ext Date	Run Date	Analyst	Code
Organic										
GASES										
Ethane	< 0.5	ug/l	0.5	1.5	1	8015		12/12/2023	ZJW	1
Ethene	< 0.5	ug/l	0.5	1.5	1	8015		12/12/2023	ZJW	1
Methane	18.4	ug/l	1	3	1	8015		12/12/2023	ZJW	1
VOC's										
Benzene	< 0.3	ug/l	0.3	1.25	1	8260B		12/11/2023	CJR	1
Bromobenzene	< 0.34	ug/l	0.34	1.4	1	8260B		12/11/2023	CJR	1
Bromodichloromethane	< 0.36	ug/l	0.36	1.47	1	8260B		12/11/2023	CJR	1
Bromoform	< 0.42	ug/l	0.42	1.72	1	8260B		12/11/2023	CJR	1
tert-Butylbenzene	< 0.37	ug/l	0.37	1.49	1	8260B		12/11/2023	CJR	1
sec-Butylbenzene	< 0.33	ug/l	0.33	1.34	1	8260B		12/11/2023	CJR	1
n-Butylbenzene	< 0.71	ug/l	0.71	2.9	1	8260B		12/11/2023	CJR	1
Carbon Tetrachloride	< 0.34	ug/l	0.34	1.39	1	8260B		12/11/2023	CJR	1
Chlorobenzene	< 0.29	ug/l	0.29	1.19	1	8260B		12/11/2023	CJR	1
Chloroethane	< 0.62	ug/l	0.62	2.54	1	8260B		12/11/2023	CJR	1
Chloroform	< 0.33	ug/l	0.33	1.33	1	8260B		12/11/2023	CJR	1
Chloromethane	< 0.74	ug/l	0.74	3.03	1	8260B		12/11/2023	CJR	1
2-Chlorotoluene	< 0.34	ug/l	0.34	1.37	1	8260B		12/11/2023	CJR	1
4-Chlorotoluene	< 0.4	ug/l	0.4	1.63	1	8260B		12/11/2023	CJR	1
1,2-Dibromo-3-chloropropane	< 0.74	ug/l	0.74	3.01	1	8260B		12/11/2023	CJR	1
Dibromochloromethane	< 0.36	ug/l	0.36	1.46	1	8260B		12/11/2023	CJR	1
1,4-Dichlorobenzene	< 0.49	ug/l	0.49	2.01	1	8260B		12/11/2023	CJR	1
1,3-Dichlorobenzene	< 0.35	ug/l	0.35	1.44	1	8260B		12/11/2023	CJR	1
1,2-Dichlorobenzene	< 0.4	ug/l	0.4	1.65	1	8260B		12/11/2023	CJR	1
Dichlorodifluoromethane	< 0.3	ug/l	0.3	1.23	1	8260B		12/11/2023	CJR	1
1,2-Dichloroethane	< 0.43	ug/l	0.43	1.75	1	8260B		12/11/2023	CJR	1
1,1-Dichloroethane	< 0.43	ug/l	0.43	1.74	1	8260B		12/11/2023	CJR	1
1,1-Dichloroethene	< 0.43	ug/l	0.43	1.76	1	8260B		12/11/2023	CJR	1
cis-1,2-Dichloroethene	< 0.32	ug/l	0.32	1.29	1	8260B		12/11/2023	CJR	1
trans-1,2-Dichloroethene	< 0.5	ug/l	0.5	2.02	1	8260B		12/11/2023	CJR	1
1,2-Dichloropropane	< 0.39	ug/l	0.39	1.58	1	8260B		12/11/2023	CJR	1
1,3-Dichloropropane	< 0.38	ug/l	0.38	1.55	1	8260B		12/11/2023	CJR	1
trans-1,3-Dichloropropene	< 0.41	ug/l	0.41	1.67	1	8260B		12/11/2023	CJR	1
cis-1,3-Dichloropropene	< 0.41	ug/l	0.41	1.67	1	8260B		12/11/2023	CJR	1
Di-isopropyl ether	< 0.48	ug/l	0.48	1.96	1	8260B		12/11/2023	CJR	1
EDB (1,2-Dibromoethane)	< 0.39	ug/l	0.39	1.59	1	8260B		12/11/2023	CJR	1
Ethylbenzene	< 0.33	ug/l	0.33	1.37	1	8260B		12/11/2023	CJR	1
Hexachlorobutadiene	< 0.81	ug/l	0.81	3.44	1	8260B		12/11/2023	CJR	1
Isopropylbenzene	< 0.34	ug/l	0.34	1.38	1	8260B		12/11/2023	CJR	1
p-Isopropyltoluene	< 0.47	ug/l	0.47	1.91	1	8260B		12/11/2023	CJR	1
Methylene chloride	< 0.79	ug/l	0.79	3.23	1	8260B		12/11/2023	CJR	1
Methyl tert-butyl ether (MTBE)	< 0.47	ug/l	0.47	1.91	1	8260B		12/11/2023	CJR	1
Naphthalene	< 1.4	ug/l	1.4	5.56	1	8260B		12/11/2023	CJR	1
n-Propylbenzene	< 0.39	ug/l	0.39	1.6	1	8260B		12/11/2023	CJR	1
1,1,2,2-Tetrachloroethane	< 0.43	ug/l	0.43	1.77	1	8260B		12/11/2023	CJR	1

Project Name OHM-ELM GROVE 6142
Project # 6142

Invoice # E43312

Lab Code 5043312J
Sample ID 6142-PZ-1
Sample Matrix Water
Sample Date 12/7/2023

	Result	Unit	LOD	LOQ	Dil	Method	Ext Date	Run Date	Analyst	Code
1,1,1,2-Tetrachloroethane	< 0.55	ug/l	0.55	2.25	1	8260B		12/11/2023	CJR	1
Tetrachloroethane	< 0.47	ug/l	0.47	1.91	1	8260B		12/11/2023	CJR	1
Toluene	< 0.33	ug/l	0.33	1.35	1	8260B		12/11/2023	CJR	1
1,2,4-Trichlorobenzene	< 0.63	ug/l	0.63	2.57	1	8260B		12/11/2023	CJR	1
1,2,3-Trichlorobenzene	< 1.4	ug/l	1.4	5.94	1	8260B		12/11/2023	CJR	1
1,1,1-Trichloroethane	< 0.33	ug/l	0.33	1.34	1	8260B		12/11/2023	CJR	1
1,1,2-Trichloroethane	< 0.42	ug/l	0.42	1.72	1	8260B		12/11/2023	CJR	1
Trichloroethene (TCE)	< 0.38	ug/l	0.38	1.55	1	8260B		12/11/2023	CJR	1
Trichlorofluoromethane	< 0.33	ug/l	0.33	1.35	1	8260B		12/11/2023	CJR	1
1,2,4-Trimethylbenzene	< 0.35	ug/l	0.35	1.44	1	8260B		12/11/2023	CJR	1
1,3,5-Trimethylbenzene	< 0.41	ug/l	0.41	1.66	1	8260B		12/11/2023	CJR	1
Vinyl Chloride	< 0.15	ug/l	0.15	0.61	1	8260B		12/11/2023	CJR	1
m&p-Xylene	< 0.64	ug/l	0.64	2.63	1	8260B		12/11/2023	CJR	1
o-Xylene	< 0.37	ug/l	0.37	1.51	1	8260B		12/11/2023	CJR	1
SUR - 1,2-Dichloroethane-d4	96	REC %			1	8260B		12/11/2023	CJR	1
SUR - 4-Bromofluorobenzene	92	REC %			1	8260B		12/11/2023	CJR	1
SUR - Dibromofluoromethane	92	REC %			1	8260B		12/11/2023	CJR	1
SUR - Toluene-d8	112	REC %			1	8260B		12/11/2023	CJR	1

Wet Chemistry

General

Total Organic Carbon	1.66 "J"	mg/l	0.7	2	1	SM 5310B		12/19/2023	SLA	1
----------------------	----------	------	-----	---	---	----------	--	------------	-----	---

Project Name OHM-ELM GROVE 6142
Project # 6142

Invoice # E43312

Lab Code 5043312K
Sample ID 6142-PZ-2
Sample Matrix Water
Sample Date 12/8/2023

	Result	Unit	LOD	LOQ	Dil	Method	Ext Date	Run Date	Analyst	Code
Organic										
GASES										
Ethane	< 0.5	ug/l	0.5	1.5	1	8015		12/12/2023	ZJW	1
Ethene	< 0.5	ug/l	0.5	1.5	1	8015		12/12/2023	ZJW	1
Methane	25.9	ug/l	1	3	1	8015		12/12/2023	ZJW	1
VOC's										
Benzene	< 0.3	ug/l	0.3	1.25	1	8260B		12/11/2023	CJR	1
Bromobenzene	< 0.34	ug/l	0.34	1.4	1	8260B		12/11/2023	CJR	1
Bromodichloromethane	< 0.36	ug/l	0.36	1.47	1	8260B		12/11/2023	CJR	1
Bromoform	< 0.42	ug/l	0.42	1.72	1	8260B		12/11/2023	CJR	1
tert-Butylbenzene	< 0.37	ug/l	0.37	1.49	1	8260B		12/11/2023	CJR	1
sec-Butylbenzene	< 0.33	ug/l	0.33	1.34	1	8260B		12/11/2023	CJR	1
n-Butylbenzene	< 0.71	ug/l	0.71	2.9	1	8260B		12/11/2023	CJR	1
Carbon Tetrachloride	< 0.34	ug/l	0.34	1.39	1	8260B		12/11/2023	CJR	1
Chlorobenzene	< 0.29	ug/l	0.29	1.19	1	8260B		12/11/2023	CJR	1
Chloroethane	< 0.62	ug/l	0.62	2.54	1	8260B		12/11/2023	CJR	1
Chloroform	< 0.33	ug/l	0.33	1.33	1	8260B		12/11/2023	CJR	1
Chloromethane	< 0.74	ug/l	0.74	3.03	1	8260B		12/11/2023	CJR	1
2-Chlorotoluene	< 0.34	ug/l	0.34	1.37	1	8260B		12/11/2023	CJR	1
4-Chlorotoluene	< 0.4	ug/l	0.4	1.63	1	8260B		12/11/2023	CJR	1
1,2-Dibromo-3-chloropropane	< 0.74	ug/l	0.74	3.01	1	8260B		12/11/2023	CJR	1
Dibromochloromethane	< 0.36	ug/l	0.36	1.46	1	8260B		12/11/2023	CJR	1
1,4-Dichlorobenzene	< 0.49	ug/l	0.49	2.01	1	8260B		12/11/2023	CJR	1
1,3-Dichlorobenzene	< 0.35	ug/l	0.35	1.44	1	8260B		12/11/2023	CJR	1
1,2-Dichlorobenzene	< 0.4	ug/l	0.4	1.65	1	8260B		12/11/2023	CJR	1
Dichlorodifluoromethane	< 0.3	ug/l	0.3	1.23	1	8260B		12/11/2023	CJR	1
1,2-Dichloroethane	< 0.43	ug/l	0.43	1.75	1	8260B		12/11/2023	CJR	1
1,1-Dichloroethane	< 0.43	ug/l	0.43	1.74	1	8260B		12/11/2023	CJR	1
1,1-Dichloroethene	< 0.43	ug/l	0.43	1.76	1	8260B		12/11/2023	CJR	1
cis-1,2-Dichloroethene	0.9 "J"	ug/l	0.32	1.29	1	8260B		12/11/2023	CJR	1
trans-1,2-Dichloroethene	< 0.5	ug/l	0.5	2.02	1	8260B		12/11/2023	CJR	1
1,2-Dichloropropane	< 0.39	ug/l	0.39	1.58	1	8260B		12/11/2023	CJR	1
1,3-Dichloropropane	< 0.38	ug/l	0.38	1.55	1	8260B		12/11/2023	CJR	1
trans-1,3-Dichloropropene	< 0.41	ug/l	0.41	1.67	1	8260B		12/11/2023	CJR	1
cis-1,3-Dichloropropene	< 0.41	ug/l	0.41	1.67	1	8260B		12/11/2023	CJR	1
Di-isopropyl ether	< 0.48	ug/l	0.48	1.96	1	8260B		12/11/2023	CJR	1
EDB (1,2-Dibromoethane)	< 0.39	ug/l	0.39	1.59	1	8260B		12/11/2023	CJR	1
Ethylbenzene	< 0.33	ug/l	0.33	1.37	1	8260B		12/11/2023	CJR	1
Hexachlorobutadiene	< 0.81	ug/l	0.81	3.44	1	8260B		12/11/2023	CJR	1
Isopropylbenzene	< 0.34	ug/l	0.34	1.38	1	8260B		12/11/2023	CJR	1
p-Isopropyltoluene	< 0.47	ug/l	0.47	1.91	1	8260B		12/11/2023	CJR	1
Methylene chloride	< 0.79	ug/l	0.79	3.23	1	8260B		12/11/2023	CJR	1
Methyl tert-butyl ether (MTBE)	< 0.47	ug/l	0.47	1.91	1	8260B		12/11/2023	CJR	1
Naphthalene	< 1.4	ug/l	1.4	5.56	1	8260B		12/11/2023	CJR	1
n-Propylbenzene	< 0.39	ug/l	0.39	1.6	1	8260B		12/11/2023	CJR	1
1,1,2,2-Tetrachloroethane	< 0.43	ug/l	0.43	1.77	1	8260B		12/11/2023	CJR	1

Project Name OHM-ELM GROVE 6142
Project # 6142

Invoice # E43312

Lab Code 5043312K
Sample ID 6142-PZ-2
Sample Matrix Water
Sample Date 12/8/2023

	Result	Unit	LOD	LOQ	Dil	Method	Ext Date	Run Date	Analyst	Code
1,1,1,2-Tetrachloroethane	< 0.55	ug/l	0.55	2.25	1	8260B		12/11/2023	CJR	1
Tetrachloroethene	< 0.47	ug/l	0.47	1.91	1	8260B		12/11/2023	CJR	1
Toluene	< 0.33	ug/l	0.33	1.35	1	8260B		12/11/2023	CJR	1
1,2,4-Trichlorobenzene	< 0.63	ug/l	0.63	2.57	1	8260B		12/11/2023	CJR	1
1,2,3-Trichlorobenzene	< 1.4	ug/l	1.4	5.94	1	8260B		12/11/2023	CJR	1
1,1,1-Trichloroethane	< 0.33	ug/l	0.33	1.34	1	8260B		12/11/2023	CJR	1
1,1,2-Trichloroethane	< 0.42	ug/l	0.42	1.72	1	8260B		12/11/2023	CJR	1
Trichloroethene (TCE)	< 0.38	ug/l	0.38	1.55	1	8260B		12/11/2023	CJR	1
Trichlorofluoromethane	< 0.33	ug/l	0.33	1.35	1	8260B		12/11/2023	CJR	1
1,2,4-Trimethylbenzene	< 0.35	ug/l	0.35	1.44	1	8260B		12/11/2023	CJR	1
1,3,5-Trimethylbenzene	< 0.41	ug/l	0.41	1.66	1	8260B		12/11/2023	CJR	1
Vinyl Chloride	< 0.15	ug/l	0.15	0.61	1	8260B		12/11/2023	CJR	1
m&p-Xylene	< 0.64	ug/l	0.64	2.63	1	8260B		12/11/2023	CJR	1
o-Xylene	< 0.37	ug/l	0.37	1.51	1	8260B		12/11/2023	CJR	1
SUR - Toluene-d8	112	REC %			1	8260B		12/11/2023	CJR	1
SUR - 1,2-Dichloroethane-d4	103	REC %			1	8260B		12/11/2023	CJR	1
SUR - 4-Bromofluorobenzene	88	REC %			1	8260B		12/11/2023	CJR	1
SUR - Dibromofluoromethane	94	REC %			1	8260B		12/11/2023	CJR	1

Wet Chemistry

General

Total Organic Carbon	1.80 "J"	mg/l	0.7	2	1	SM 5310B		12/19/2023	SLA	1
----------------------	----------	------	-----	---	---	----------	--	------------	-----	---

Project Name OHM-ELM GROVE 6142
Project # 6142

Invoice # E43312

Lab Code 5043312L
Sample ID 6142-DUP-1
Sample Matrix Water
Sample Date 12/8/2023

	Result	Unit	LOD	LOQ	Dil	Method	Ext Date	Run Date	Analyst	Code
Organic										
VOC's										
Benzene	< 0.3	ug/l	0.3	1.25	1	8260B		12/12/2023	CJR	1
Bromobenzene	< 0.34	ug/l	0.34	1.4	1	8260B		12/12/2023	CJR	1
Bromodichloromethane	< 0.36	ug/l	0.36	1.47	1	8260B		12/12/2023	CJR	1
Bromoform	< 0.42	ug/l	0.42	1.72	1	8260B		12/12/2023	CJR	1
tert-Butylbenzene	< 0.37	ug/l	0.37	1.49	1	8260B		12/12/2023	CJR	1
sec-Butylbenzene	< 0.33	ug/l	0.33	1.34	1	8260B		12/12/2023	CJR	1
n-Butylbenzene	< 0.71	ug/l	0.71	2.9	1	8260B		12/12/2023	CJR	1
Carbon Tetrachloride	< 0.34	ug/l	0.34	1.39	1	8260B		12/12/2023	CJR	1
Chlorobenzene	< 0.29	ug/l	0.29	1.19	1	8260B		12/12/2023	CJR	1
Chloroethane	< 0.62	ug/l	0.62	2.54	1	8260B		12/12/2023	CJR	1
Chloroform	< 0.33	ug/l	0.33	1.33	1	8260B		12/12/2023	CJR	1
Chloromethane	< 0.74	ug/l	0.74	3.03	1	8260B		12/12/2023	CJR	1
2-Chlorotoluene	< 0.34	ug/l	0.34	1.37	1	8260B		12/12/2023	CJR	1
4-Chlorotoluene	< 0.4	ug/l	0.4	1.63	1	8260B		12/12/2023	CJR	1
1,2-Dibromo-3-chloropropane	< 0.74	ug/l	0.74	3.01	1	8260B		12/12/2023	CJR	1
Dibromochloromethane	< 0.36	ug/l	0.36	1.46	1	8260B		12/12/2023	CJR	1
1,4-Dichlorobenzene	< 0.49	ug/l	0.49	2.01	1	8260B		12/12/2023	CJR	1
1,3-Dichlorobenzene	< 0.35	ug/l	0.35	1.44	1	8260B		12/12/2023	CJR	1
1,2-Dichlorobenzene	< 0.4	ug/l	0.4	1.65	1	8260B		12/12/2023	CJR	1
Dichlorodifluoromethane	< 0.3	ug/l	0.3	1.23	1	8260B		12/12/2023	CJR	1
1,2-Dichloroethane	< 0.43	ug/l	0.43	1.75	1	8260B		12/12/2023	CJR	1
1,1-Dichloroethane	< 0.43	ug/l	0.43	1.74	1	8260B		12/12/2023	CJR	1
1,1-Dichloroethene	< 0.43	ug/l	0.43	1.76	1	8260B		12/12/2023	CJR	1
cis-1,2-Dichloroethene	32	ug/l	0.32	1.29	1	8260B		12/12/2023	CJR	1
trans-1,2-Dichloroethene	3.3	ug/l	0.5	2.02	1	8260B		12/12/2023	CJR	1
1,2-Dichloropropane	< 0.39	ug/l	0.39	1.58	1	8260B		12/12/2023	CJR	1
1,3-Dichloropropane	< 0.38	ug/l	0.38	1.55	1	8260B		12/12/2023	CJR	1
trans-1,3-Dichloropropene	< 0.41	ug/l	0.41	1.67	1	8260B		12/12/2023	CJR	1
cis-1,3-Dichloropropene	< 0.41	ug/l	0.41	1.67	1	8260B		12/12/2023	CJR	1
Di-isopropyl ether	< 0.48	ug/l	0.48	1.96	1	8260B		12/12/2023	CJR	1
EDB (1,2-Dibromoethane)	< 0.39	ug/l	0.39	1.59	1	8260B		12/12/2023	CJR	1
Ethylbenzene	< 0.33	ug/l	0.33	1.37	1	8260B		12/12/2023	CJR	1
Hexachlorobutadiene	< 0.81	ug/l	0.81	3.44	1	8260B		12/12/2023	CJR	1
Isopropylbenzene	< 0.34	ug/l	0.34	1.38	1	8260B		12/12/2023	CJR	1
p-Isopropyltoluene	< 0.47	ug/l	0.47	1.91	1	8260B		12/12/2023	CJR	1
Methylene chloride	< 0.79	ug/l	0.79	3.23	1	8260B		12/12/2023	CJR	1
Methyl tert-butyl ether (MTBE)	< 0.47	ug/l	0.47	1.91	1	8260B		12/12/2023	CJR	1
Naphthalene	< 1.4	ug/l	1.4	5.56	1	8260B		12/12/2023	CJR	1
n-Propylbenzene	< 0.39	ug/l	0.39	1.6	1	8260B		12/12/2023	CJR	1
1,1,2,2-Tetrachloroethane	< 0.43	ug/l	0.43	1.77	1	8260B		12/12/2023	CJR	1
1,1,1,2-Tetrachloroethane	< 0.55	ug/l	0.55	2.25	1	8260B		12/12/2023	CJR	1
Tetrachloroethene	1.03 "J"	ug/l	0.47	1.91	1	8260B		12/12/2023	CJR	1
Toluene	< 0.33	ug/l	0.33	1.35	1	8260B		12/12/2023	CJR	1
1,2,4-Trichlorobenzene	< 0.63	ug/l	0.63	2.57	1	8260B		12/12/2023	CJR	1

Project Name OHM-ELM GROVE 6142
Project # 6142

Invoice # E43312

Lab Code 5043312L
Sample ID 6142-DUP-1
Sample Matrix Water
Sample Date 12/8/2023

	Result	Unit	LOD	LOQ	Dil	Method	Ext Date	Run Date	Analyst	Code
1,2,3-Trichlorobenzene	< 1.4	ug/l	1.4	5.94	1	8260B		12/12/2023	CJR	1
1,1,1-Trichloroethane	< 0.33	ug/l	0.33	1.34	1	8260B		12/12/2023	CJR	1
1,1,2-Trichloroethane	< 0.42	ug/l	0.42	1.72	1	8260B		12/12/2023	CJR	1
Trichloroethene (TCE)	3.3	ug/l	0.38	1.55	1	8260B		12/12/2023	CJR	1
Trichlorofluoromethane	< 0.33	ug/l	0.33	1.35	1	8260B		12/12/2023	CJR	1
1,2,4-Trimethylbenzene	< 0.35	ug/l	0.35	1.44	1	8260B		12/12/2023	CJR	1
1,3,5-Trimethylbenzene	< 0.41	ug/l	0.41	1.66	1	8260B		12/12/2023	CJR	1
Vinyl Chloride	3.2	ug/l	0.15	0.61	1	8260B		12/12/2023	CJR	1
m&p-Xylene	< 0.64	ug/l	0.64	2.63	1	8260B		12/12/2023	CJR	1
o-Xylene	< 0.37	ug/l	0.37	1.51	1	8260B		12/12/2023	CJR	1
SUR - 1,2-Dichloroethane-d4	97	REC %			1	8260B		12/12/2023	CJR	1
SUR - 4-Bromofluorobenzene	91	REC %			1	8260B		12/12/2023	CJR	1
SUR - Dibromofluoromethane	93	REC %			1	8260B		12/12/2023	CJR	1
SUR - Toluene-d8	115	REC %			1	8260B		12/12/2023	CJR	1

Project Name OHM-ELM GROVE 6142
Project # 6142

Invoice # E43312

Lab Code 5043312M
Sample ID 6142-DUP-2
Sample Matrix Water
Sample Date 12/8/2023

	Result	Unit	LOD	LOQ	Dil	Method	Ext Date	Run Date	Analyst	Code
Organic										
VOC's										
Benzene	< 0.3	ug/l	0.3	1.25	1	8260B		12/12/2023	CJR	1
Bromobenzene	< 0.34	ug/l	0.34	1.4	1	8260B		12/12/2023	CJR	1
Bromodichloromethane	< 0.36	ug/l	0.36	1.47	1	8260B		12/12/2023	CJR	1
Bromoform	< 0.42	ug/l	0.42	1.72	1	8260B		12/12/2023	CJR	1
tert-Butylbenzene	< 0.37	ug/l	0.37	1.49	1	8260B		12/12/2023	CJR	1
sec-Butylbenzene	< 0.33	ug/l	0.33	1.34	1	8260B		12/12/2023	CJR	1
n-Butylbenzene	< 0.71	ug/l	0.71	2.9	1	8260B		12/12/2023	CJR	1
Carbon Tetrachloride	< 0.34	ug/l	0.34	1.39	1	8260B		12/12/2023	CJR	1
Chlorobenzene	< 0.29	ug/l	0.29	1.19	1	8260B		12/12/2023	CJR	1
Chloroethane	< 0.62	ug/l	0.62	2.54	1	8260B		12/12/2023	CJR	1
Chloroform	< 0.33	ug/l	0.33	1.33	1	8260B		12/12/2023	CJR	1
Chloromethane	< 0.74	ug/l	0.74	3.03	1	8260B		12/12/2023	CJR	1
2-Chlorotoluene	< 0.34	ug/l	0.34	1.37	1	8260B		12/12/2023	CJR	1
4-Chlorotoluene	< 0.4	ug/l	0.4	1.63	1	8260B		12/12/2023	CJR	1
1,2-Dibromo-3-chloropropane	< 0.74	ug/l	0.74	3.01	1	8260B		12/12/2023	CJR	1
Dibromochloromethane	< 0.36	ug/l	0.36	1.46	1	8260B		12/12/2023	CJR	1
1,4-Dichlorobenzene	< 0.49	ug/l	0.49	2.01	1	8260B		12/12/2023	CJR	1
1,3-Dichlorobenzene	< 0.35	ug/l	0.35	1.44	1	8260B		12/12/2023	CJR	1
1,2-Dichlorobenzene	< 0.4	ug/l	0.4	1.65	1	8260B		12/12/2023	CJR	1
Dichlorodifluoromethane	< 0.3	ug/l	0.3	1.23	1	8260B		12/12/2023	CJR	1
1,2-Dichloroethane	< 0.43	ug/l	0.43	1.75	1	8260B		12/12/2023	CJR	1
1,1-Dichloroethane	< 0.43	ug/l	0.43	1.74	1	8260B		12/12/2023	CJR	1
1,1-Dichloroethene	< 0.43	ug/l	0.43	1.76	1	8260B		12/12/2023	CJR	1
cis-1,2-Dichloroethene	320	ug/l	3.2	12.9	10	8260B		12/15/2023	CJR	1
trans-1,2-Dichloroethene	12.7	ug/l	0.5	2.02	1	8260B		12/12/2023	CJR	1
1,2-Dichloropropane	< 0.39	ug/l	0.39	1.58	1	8260B		12/12/2023	CJR	1
1,3-Dichloropropane	< 0.38	ug/l	0.38	1.55	1	8260B		12/12/2023	CJR	1
trans-1,3-Dichloropropene	< 0.41	ug/l	0.41	1.67	1	8260B		12/12/2023	CJR	1
cis-1,3-Dichloropropene	< 0.41	ug/l	0.41	1.67	1	8260B		12/12/2023	CJR	1
Di-isopropyl ether	< 0.48	ug/l	0.48	1.96	1	8260B		12/12/2023	CJR	1
EDB (1,2-Dibromoethane)	< 0.39	ug/l	0.39	1.59	1	8260B		12/12/2023	CJR	1
Ethylbenzene	< 0.33	ug/l	0.33	1.37	1	8260B		12/12/2023	CJR	1
Hexachlorobutadiene	< 0.81	ug/l	0.81	3.44	1	8260B		12/12/2023	CJR	1
Isopropylbenzene	< 0.34	ug/l	0.34	1.38	1	8260B		12/12/2023	CJR	1
p-Isopropyltoluene	< 0.47	ug/l	0.47	1.91	1	8260B		12/12/2023	CJR	1
Methylene chloride	< 0.79	ug/l	0.79	3.23	1	8260B		12/12/2023	CJR	1
Methyl tert-butyl ether (MTBE)	< 0.47	ug/l	0.47	1.91	1	8260B		12/12/2023	CJR	1
Naphthalene	< 1.4	ug/l	1.4	5.56	1	8260B		12/12/2023	CJR	1
n-Propylbenzene	< 0.39	ug/l	0.39	1.6	1	8260B		12/12/2023	CJR	1
1,1,2,2-Tetrachloroethane	< 0.43	ug/l	0.43	1.77	1	8260B		12/12/2023	CJR	1
1,1,1,2-Tetrachloroethane	< 0.55	ug/l	0.55	2.25	1	8260B		12/12/2023	CJR	1
Tetrachloroethene	< 0.47	ug/l	0.47	1.91	1	8260B		12/12/2023	CJR	1
Toluene	< 0.33	ug/l	0.33	1.35	1	8260B		12/12/2023	CJR	1
1,2,4-Trichlorobenzene	< 0.63	ug/l	0.63	2.57	1	8260B		12/12/2023	CJR	1

Project Name OHM-ELM GROVE 6142
Project # 6142

Invoice # E43312

Lab Code 5043312M
Sample ID 6142-DUP-2
Sample Matrix Water
Sample Date 12/8/2023

	Result	Unit	LOD	LOQ	Dil	Method	Ext Date	Run Date	Analyst	Code
1,2,3-Trichlorobenzene	< 1.4	ug/l	1.4	5.94	1	8260B		12/12/2023	CJR	1
1,1,1-Trichloroethane	< 0.33	ug/l	0.33	1.34	1	8260B		12/12/2023	CJR	1
1,1,2-Trichloroethane	< 0.42	ug/l	0.42	1.72	1	8260B		12/12/2023	CJR	1
Trichloroethene (TCE)	< 0.38	ug/l	0.38	1.55	1	8260B		12/12/2023	CJR	1
Trichlorofluoromethane	< 0.33	ug/l	0.33	1.35	1	8260B		12/12/2023	CJR	1
1,2,4-Trimethylbenzene	< 0.35	ug/l	0.35	1.44	1	8260B		12/12/2023	CJR	1
1,3,5-Trimethylbenzene	< 0.41	ug/l	0.41	1.66	1	8260B		12/12/2023	CJR	1
Vinyl Chloride	81	ug/l	0.15	0.61	1	8260B		12/12/2023	CJR	1
m&p-Xylene	< 0.64	ug/l	0.64	2.63	1	8260B		12/12/2023	CJR	1
o-Xylene	< 0.37	ug/l	0.37	1.51	1	8260B		12/12/2023	CJR	1
SUR - 1,2-Dichloroethane-d4	99	REC %			1	8260B		12/12/2023	CJR	1
SUR - 4-Bromofluorobenzene	90	REC %			1	8260B		12/12/2023	CJR	1
SUR - Dibromofluoromethane	94	REC %			1	8260B		12/12/2023	CJR	1
SUR - Toluene-d8	112	REC %			1	8260B		12/12/2023	CJR	1

Project Name OHM-ELM GROVE 6142
Project # 6142

Invoice # E43312

Lab Code 5043312N
Sample ID 6142-EB-1
Sample Matrix Water
Sample Date 12/7/2023

	Result	Unit	LOD	LOQ	Dil	Method	Ext Date	Run Date	Analyst	Code
Organic										
VOC's										
Benzene	< 0.3	ug/l	0.3	1.25	1	8260B		12/11/2023	CJR	1
Bromobenzene	< 0.34	ug/l	0.34	1.4	1	8260B		12/11/2023	CJR	1
Bromodichloromethane	< 0.36	ug/l	0.36	1.47	1	8260B		12/11/2023	CJR	1
Bromoform	< 0.42	ug/l	0.42	1.72	1	8260B		12/11/2023	CJR	1
tert-Butylbenzene	< 0.37	ug/l	0.37	1.49	1	8260B		12/11/2023	CJR	1
sec-Butylbenzene	< 0.33	ug/l	0.33	1.34	1	8260B		12/11/2023	CJR	1
n-Butylbenzene	< 0.71	ug/l	0.71	2.9	1	8260B		12/11/2023	CJR	1
Carbon Tetrachloride	< 0.34	ug/l	0.34	1.39	1	8260B		12/11/2023	CJR	1
Chlorobenzene	< 0.29	ug/l	0.29	1.19	1	8260B		12/11/2023	CJR	1
Chloroethane	< 0.62	ug/l	0.62	2.54	1	8260B		12/11/2023	CJR	1
Chloroform	< 0.33	ug/l	0.33	1.33	1	8260B		12/11/2023	CJR	1
Chloromethane	< 0.74	ug/l	0.74	3.03	1	8260B		12/11/2023	CJR	1
2-Chlorotoluene	< 0.34	ug/l	0.34	1.37	1	8260B		12/11/2023	CJR	1
4-Chlorotoluene	< 0.4	ug/l	0.4	1.63	1	8260B		12/11/2023	CJR	1
1,2-Dibromo-3-chloropropane	< 0.74	ug/l	0.74	3.01	1	8260B		12/11/2023	CJR	1
Dibromochloromethane	< 0.36	ug/l	0.36	1.46	1	8260B		12/11/2023	CJR	1
1,4-Dichlorobenzene	< 0.49	ug/l	0.49	2.01	1	8260B		12/11/2023	CJR	1
1,3-Dichlorobenzene	< 0.35	ug/l	0.35	1.44	1	8260B		12/11/2023	CJR	1
1,2-Dichlorobenzene	< 0.4	ug/l	0.4	1.65	1	8260B		12/11/2023	CJR	1
Dichlorodifluoromethane	< 0.3	ug/l	0.3	1.23	1	8260B		12/11/2023	CJR	1
1,2-Dichloroethane	< 0.43	ug/l	0.43	1.75	1	8260B		12/11/2023	CJR	1
1,1-Dichloroethane	< 0.43	ug/l	0.43	1.74	1	8260B		12/11/2023	CJR	1
1,1-Dichloroethene	< 0.43	ug/l	0.43	1.76	1	8260B		12/11/2023	CJR	1
cis-1,2-Dichloroethene	< 0.32	ug/l	0.32	1.29	1	8260B		12/11/2023	CJR	1
trans-1,2-Dichloroethene	< 0.5	ug/l	0.5	2.02	1	8260B		12/11/2023	CJR	1
1,2-Dichloropropane	< 0.39	ug/l	0.39	1.58	1	8260B		12/11/2023	CJR	1
1,3-Dichloropropane	< 0.38	ug/l	0.38	1.55	1	8260B		12/11/2023	CJR	1
trans-1,3-Dichloropropene	< 0.41	ug/l	0.41	1.67	1	8260B		12/11/2023	CJR	1
cis-1,3-Dichloropropene	< 0.41	ug/l	0.41	1.67	1	8260B		12/11/2023	CJR	1
Di-isopropyl ether	< 0.48	ug/l	0.48	1.96	1	8260B		12/11/2023	CJR	1
EDB (1,2-Dibromoethane)	< 0.39	ug/l	0.39	1.59	1	8260B		12/11/2023	CJR	1
Ethylbenzene	< 0.33	ug/l	0.33	1.37	1	8260B		12/11/2023	CJR	1
Hexachlorobutadiene	< 0.81	ug/l	0.81	3.44	1	8260B		12/11/2023	CJR	1
Isopropylbenzene	< 0.34	ug/l	0.34	1.38	1	8260B		12/11/2023	CJR	1
p-Isopropyltoluene	< 0.47	ug/l	0.47	1.91	1	8260B		12/11/2023	CJR	1
Methylene chloride	< 0.79	ug/l	0.79	3.23	1	8260B		12/11/2023	CJR	1
Methyl tert-butyl ether (MTBE)	< 0.47	ug/l	0.47	1.91	1	8260B		12/11/2023	CJR	1
Naphthalene	< 1.4	ug/l	1.4	5.56	1	8260B		12/11/2023	CJR	1
n-Propylbenzene	< 0.39	ug/l	0.39	1.6	1	8260B		12/11/2023	CJR	1
1,1,2,2-Tetrachloroethane	< 0.43	ug/l	0.43	1.77	1	8260B		12/11/2023	CJR	1
1,1,1,2-Tetrachloroethane	< 0.55	ug/l	0.55	2.25	1	8260B		12/11/2023	CJR	1
Tetrachloroethene	< 0.47	ug/l	0.47	1.91	1	8260B		12/11/2023	CJR	1
Toluene	< 0.33	ug/l	0.33	1.35	1	8260B		12/11/2023	CJR	1
1,2,4-Trichlorobenzene	< 0.63	ug/l	0.63	2.57	1	8260B		12/11/2023	CJR	1

Project Name OHM-ELM GROVE 6142
Project # 6142

Invoice # E43312

Lab Code 5043312N
Sample ID 6142-EB-1
Sample Matrix Water
Sample Date 12/7/2023

	Result	Unit	LOD	LOQ	Dil	Method	Ext Date	Run Date	Analyst	Code
1,2,3-Trichlorobenzene	< 1.4	ug/l	1.4	5.94	1	8260B		12/11/2023	CJR	1
1,1,1-Trichloroethane	< 0.33	ug/l	0.33	1.34	1	8260B		12/11/2023	CJR	1
1,1,2-Trichloroethane	< 0.42	ug/l	0.42	1.72	1	8260B		12/11/2023	CJR	1
Trichloroethene (TCE)	< 0.38	ug/l	0.38	1.55	1	8260B		12/11/2023	CJR	1
Trichlorofluoromethane	< 0.33	ug/l	0.33	1.35	1	8260B		12/11/2023	CJR	1
1,2,4-Trimethylbenzene	< 0.35	ug/l	0.35	1.44	1	8260B		12/11/2023	CJR	1
1,3,5-Trimethylbenzene	< 0.41	ug/l	0.41	1.66	1	8260B		12/11/2023	CJR	1
Vinyl Chloride	< 0.15	ug/l	0.15	0.61	1	8260B		12/11/2023	CJR	1
m&p-Xylene	< 0.64	ug/l	0.64	2.63	1	8260B		12/11/2023	CJR	1
o-Xylene	< 0.37	ug/l	0.37	1.51	1	8260B		12/11/2023	CJR	1
SUR - 1,2-Dichloroethane-d4	102	REC %			1	8260B		12/11/2023	CJR	1
SUR - 4-Bromofluorobenzene	90	REC %			1	8260B		12/11/2023	CJR	1
SUR - Dibromofluoromethane	95	REC %			1	8260B		12/11/2023	CJR	1
SUR - Toluene-d8	111	REC %			1	8260B		12/11/2023	CJR	1

Project Name OHM-ELM GROVE 6142
Project # 6142

Invoice # E43312

Lab Code 50433120
Sample ID 6142-EB-2
Sample Matrix Water
Sample Date 12/8/2023

	Result	Unit	LOD	LOQ	Dil	Method	Ext Date	Run Date	Analyst	Code
Organic										
VOC's										
Benzene	< 0.3	ug/l	0.3	1.25	1	8260B		12/11/2023	CJR	1
Bromobenzene	< 0.34	ug/l	0.34	1.4	1	8260B		12/11/2023	CJR	1
Bromodichloromethane	< 0.36	ug/l	0.36	1.47	1	8260B		12/11/2023	CJR	1
Bromoform	< 0.42	ug/l	0.42	1.72	1	8260B		12/11/2023	CJR	1
tert-Butylbenzene	< 0.37	ug/l	0.37	1.49	1	8260B		12/11/2023	CJR	1
sec-Butylbenzene	< 0.33	ug/l	0.33	1.34	1	8260B		12/11/2023	CJR	1
n-Butylbenzene	< 0.71	ug/l	0.71	2.9	1	8260B		12/11/2023	CJR	1
Carbon Tetrachloride	< 0.34	ug/l	0.34	1.39	1	8260B		12/11/2023	CJR	1
Chlorobenzene	< 0.29	ug/l	0.29	1.19	1	8260B		12/11/2023	CJR	1
Chloroethane	< 0.62	ug/l	0.62	2.54	1	8260B		12/11/2023	CJR	1
Chloroform	< 0.33	ug/l	0.33	1.33	1	8260B		12/11/2023	CJR	1
Chloromethane	< 0.74	ug/l	0.74	3.03	1	8260B		12/11/2023	CJR	1
2-Chlorotoluene	< 0.34	ug/l	0.34	1.37	1	8260B		12/11/2023	CJR	1
4-Chlorotoluene	< 0.4	ug/l	0.4	1.63	1	8260B		12/11/2023	CJR	1
1,2-Dibromo-3-chloropropane	< 0.74	ug/l	0.74	3.01	1	8260B		12/11/2023	CJR	1
Dibromochloromethane	< 0.36	ug/l	0.36	1.46	1	8260B		12/11/2023	CJR	1
1,4-Dichlorobenzene	< 0.49	ug/l	0.49	2.01	1	8260B		12/11/2023	CJR	1
1,3-Dichlorobenzene	< 0.35	ug/l	0.35	1.44	1	8260B		12/11/2023	CJR	1
1,2-Dichlorobenzene	< 0.4	ug/l	0.4	1.65	1	8260B		12/11/2023	CJR	1
Dichlorodifluoromethane	< 0.3	ug/l	0.3	1.23	1	8260B		12/11/2023	CJR	1
1,2-Dichloroethane	< 0.43	ug/l	0.43	1.75	1	8260B		12/11/2023	CJR	1
1,1-Dichloroethane	< 0.43	ug/l	0.43	1.74	1	8260B		12/11/2023	CJR	1
1,1-Dichloroethene	< 0.43	ug/l	0.43	1.76	1	8260B		12/11/2023	CJR	1
cis-1,2-Dichloroethene	< 0.32	ug/l	0.32	1.29	1	8260B		12/11/2023	CJR	1
trans-1,2-Dichloroethene	< 0.5	ug/l	0.5	2.02	1	8260B		12/11/2023	CJR	1
1,2-Dichloropropane	< 0.39	ug/l	0.39	1.58	1	8260B		12/11/2023	CJR	1
1,3-Dichloropropane	< 0.38	ug/l	0.38	1.55	1	8260B		12/11/2023	CJR	1
trans-1,3-Dichloropropene	< 0.41	ug/l	0.41	1.67	1	8260B		12/11/2023	CJR	1
cis-1,3-Dichloropropene	< 0.41	ug/l	0.41	1.67	1	8260B		12/11/2023	CJR	1
Di-isopropyl ether	< 0.48	ug/l	0.48	1.96	1	8260B		12/11/2023	CJR	1
EDB (1,2-Dibromoethane)	< 0.39	ug/l	0.39	1.59	1	8260B		12/11/2023	CJR	1
Ethylbenzene	< 0.33	ug/l	0.33	1.37	1	8260B		12/11/2023	CJR	1
Hexachlorobutadiene	< 0.81	ug/l	0.81	3.44	1	8260B		12/11/2023	CJR	1
Isopropylbenzene	< 0.34	ug/l	0.34	1.38	1	8260B		12/11/2023	CJR	1
p-Isopropyltoluene	< 0.47	ug/l	0.47	1.91	1	8260B		12/11/2023	CJR	1
Methylene chloride	< 0.79	ug/l	0.79	3.23	1	8260B		12/11/2023	CJR	1
Methyl tert-butyl ether (MTBE)	< 0.47	ug/l	0.47	1.91	1	8260B		12/11/2023	CJR	1
Naphthalene	< 1.4	ug/l	1.4	5.56	1	8260B		12/11/2023	CJR	1
n-Propylbenzene	< 0.39	ug/l	0.39	1.6	1	8260B		12/11/2023	CJR	1
1,1,2,2-Tetrachloroethane	< 0.43	ug/l	0.43	1.77	1	8260B		12/11/2023	CJR	1
1,1,1,2-Tetrachloroethane	< 0.55	ug/l	0.55	2.25	1	8260B		12/11/2023	CJR	1
Tetrachloroethene	< 0.47	ug/l	0.47	1.91	1	8260B		12/11/2023	CJR	1
Toluene	< 0.33	ug/l	0.33	1.35	1	8260B		12/11/2023	CJR	1
1,2,4-Trichlorobenzene	< 0.63	ug/l	0.63	2.57	1	8260B		12/11/2023	CJR	1

Project Name OHM-ELM GROVE 6142
Project # 6142

Invoice # E43312

Lab Code 50433120
Sample ID 6142-EB-2
Sample Matrix Water
Sample Date 12/8/2023

	Result	Unit	LOD	LOQ	Dil	Method	Ext Date	Run Date	Analyst	Code
1,2,3-Trichlorobenzene	< 1.4	ug/l	1.4	5.94	1	8260B		12/11/2023	CJR	1
1,1,1-Trichloroethane	< 0.33	ug/l	0.33	1.34	1	8260B		12/11/2023	CJR	1
1,1,2-Trichloroethane	< 0.42	ug/l	0.42	1.72	1	8260B		12/11/2023	CJR	1
Trichloroethene (TCE)	< 0.38	ug/l	0.38	1.55	1	8260B		12/11/2023	CJR	1
Trichlorofluoromethane	< 0.33	ug/l	0.33	1.35	1	8260B		12/11/2023	CJR	1
1,2,4-Trimethylbenzene	< 0.35	ug/l	0.35	1.44	1	8260B		12/11/2023	CJR	1
1,3,5-Trimethylbenzene	< 0.41	ug/l	0.41	1.66	1	8260B		12/11/2023	CJR	1
Vinyl Chloride	< 0.15	ug/l	0.15	0.61	1	8260B		12/11/2023	CJR	1
m&p-Xylene	< 0.64	ug/l	0.64	2.63	1	8260B		12/11/2023	CJR	1
o-Xylene	< 0.37	ug/l	0.37	1.51	1	8260B		12/11/2023	CJR	1
SUR - 1,2-Dichloroethane-d4	100	REC %			1	8260B		12/11/2023	CJR	1
SUR - Toluene-d8	109	REC %			1	8260B		12/11/2023	CJR	1
SUR - Dibromofluoromethane	90	REC %			1	8260B		12/11/2023	CJR	1
SUR - 4-Bromofluorobenzene	92	REC %			1	8260B		12/11/2023	CJR	1

Project Name OHM-ELM GROVE 6142
Project # 6142

Invoice # E43312

Lab Code 5043312P
Sample ID TRIP BLANK
Sample Matrix Water
Sample Date 12/8/2023

	Result	Unit	LOD	LOQ	Dil	Method	Ext Date	Run Date	Analyst	Code
Organic										
VOC's										
Benzene	< 0.3	ug/l	0.3	1.25	1	8260B		12/11/2023	CJR	1
Bromobenzene	< 0.34	ug/l	0.34	1.4	1	8260B		12/11/2023	CJR	1
Bromodichloromethane	< 0.36	ug/l	0.36	1.47	1	8260B		12/11/2023	CJR	1
Bromoform	< 0.42	ug/l	0.42	1.72	1	8260B		12/11/2023	CJR	1
tert-Butylbenzene	< 0.37	ug/l	0.37	1.49	1	8260B		12/11/2023	CJR	1
sec-Butylbenzene	< 0.33	ug/l	0.33	1.34	1	8260B		12/11/2023	CJR	1
n-Butylbenzene	< 0.71	ug/l	0.71	2.9	1	8260B		12/11/2023	CJR	1
Carbon Tetrachloride	< 0.34	ug/l	0.34	1.39	1	8260B		12/11/2023	CJR	1
Chlorobenzene	< 0.29	ug/l	0.29	1.19	1	8260B		12/11/2023	CJR	1
Chloroethane	< 0.62	ug/l	0.62	2.54	1	8260B		12/11/2023	CJR	1
Chloroform	< 0.33	ug/l	0.33	1.33	1	8260B		12/11/2023	CJR	1
Chloromethane	< 0.74	ug/l	0.74	3.03	1	8260B		12/11/2023	CJR	1
2-Chlorotoluene	< 0.34	ug/l	0.34	1.37	1	8260B		12/11/2023	CJR	1
4-Chlorotoluene	< 0.4	ug/l	0.4	1.63	1	8260B		12/11/2023	CJR	1
1,2-Dibromo-3-chloropropane	< 0.74	ug/l	0.74	3.01	1	8260B		12/11/2023	CJR	1
Dibromochloromethane	< 0.36	ug/l	0.36	1.46	1	8260B		12/11/2023	CJR	1
1,4-Dichlorobenzene	< 0.49	ug/l	0.49	2.01	1	8260B		12/11/2023	CJR	1
1,3-Dichlorobenzene	< 0.35	ug/l	0.35	1.44	1	8260B		12/11/2023	CJR	1
1,2-Dichlorobenzene	< 0.4	ug/l	0.4	1.65	1	8260B		12/11/2023	CJR	1
Dichlorodifluoromethane	< 0.3	ug/l	0.3	1.23	1	8260B		12/11/2023	CJR	1
1,2-Dichloroethane	< 0.43	ug/l	0.43	1.75	1	8260B		12/11/2023	CJR	1
1,1-Dichloroethane	< 0.43	ug/l	0.43	1.74	1	8260B		12/11/2023	CJR	1
1,1-Dichloroethene	< 0.43	ug/l	0.43	1.76	1	8260B		12/11/2023	CJR	1
cis-1,2-Dichloroethene	< 0.32	ug/l	0.32	1.29	1	8260B		12/11/2023	CJR	1
trans-1,2-Dichloroethene	< 0.5	ug/l	0.5	2.02	1	8260B		12/11/2023	CJR	1
1,2-Dichloropropane	< 0.39	ug/l	0.39	1.58	1	8260B		12/11/2023	CJR	1
1,3-Dichloropropane	< 0.38	ug/l	0.38	1.55	1	8260B		12/11/2023	CJR	1
trans-1,3-Dichloropropene	< 0.41	ug/l	0.41	1.67	1	8260B		12/11/2023	CJR	1
cis-1,3-Dichloropropene	< 0.41	ug/l	0.41	1.67	1	8260B		12/11/2023	CJR	1
Di-isopropyl ether	< 0.48	ug/l	0.48	1.96	1	8260B		12/11/2023	CJR	1
EDB (1,2-Dibromoethane)	< 0.39	ug/l	0.39	1.59	1	8260B		12/11/2023	CJR	1
Ethylbenzene	< 0.33	ug/l	0.33	1.37	1	8260B		12/11/2023	CJR	1
Hexachlorobutadiene	< 0.81	ug/l	0.81	3.44	1	8260B		12/11/2023	CJR	1
Isopropylbenzene	< 0.34	ug/l	0.34	1.38	1	8260B		12/11/2023	CJR	1
p-Isopropyltoluene	< 0.47	ug/l	0.47	1.91	1	8260B		12/11/2023	CJR	1
Methylene chloride	< 0.79	ug/l	0.79	3.23	1	8260B		12/11/2023	CJR	1
Methyl tert-butyl ether (MTBE)	< 0.47	ug/l	0.47	1.91	1	8260B		12/11/2023	CJR	1
Naphthalene	< 1.4	ug/l	1.4	5.56	1	8260B		12/11/2023	CJR	1
n-Propylbenzene	< 0.39	ug/l	0.39	1.6	1	8260B		12/11/2023	CJR	1
1,1,2,2-Tetrachloroethane	< 0.43	ug/l	0.43	1.77	1	8260B		12/11/2023	CJR	1
1,1,1,2-Tetrachloroethane	< 0.55	ug/l	0.55	2.25	1	8260B		12/11/2023	CJR	1
Tetrachloroethene	< 0.47	ug/l	0.47	1.91	1	8260B		12/11/2023	CJR	1
Toluene	< 0.33	ug/l	0.33	1.35	1	8260B		12/11/2023	CJR	1
1,2,4-Trichlorobenzene	< 0.63	ug/l	0.63	2.57	1	8260B		12/11/2023	CJR	1

Project Name OHM-ELM GROVE 6142
Project # 6142

Invoice # E43312

Lab Code 5043312P
Sample ID TRIP BLANK
Sample Matrix Water
Sample Date 12/8/2023

	Result	Unit	LOD	LOQ	Dil	Method	Ext Date	Run Date	Analyst	Code
1,2,3-Trichlorobenzene	< 1.4	ug/l	1.4	5.94	1	8260B		12/11/2023	CJR	1
1,1,1-Trichloroethane	< 0.33	ug/l	0.33	1.34	1	8260B		12/11/2023	CJR	1
1,1,2-Trichloroethane	< 0.42	ug/l	0.42	1.72	1	8260B		12/11/2023	CJR	1
Trichloroethene (TCE)	< 0.38	ug/l	0.38	1.55	1	8260B		12/11/2023	CJR	1
Trichlorofluoromethane	< 0.33	ug/l	0.33	1.35	1	8260B		12/11/2023	CJR	1
1,2,4-Trimethylbenzene	< 0.35	ug/l	0.35	1.44	1	8260B		12/11/2023	CJR	1
1,3,5-Trimethylbenzene	< 0.41	ug/l	0.41	1.66	1	8260B		12/11/2023	CJR	1
Vinyl Chloride	< 0.15	ug/l	0.15	0.61	1	8260B		12/11/2023	CJR	1
m&p-Xylene	< 0.64	ug/l	0.64	2.63	1	8260B		12/11/2023	CJR	1
o-Xylene	< 0.37	ug/l	0.37	1.51	1	8260B		12/11/2023	CJR	1
SUR - Toluene-d8	111	REC %				8260B		12/11/2023	CJR	1
SUR - 1,2-Dichloroethane-d4	98	REC %				8260B		12/11/2023	CJR	1
SUR - 4-Bromofluorobenzene	90	REC %				8260B		12/11/2023	CJR	1
SUR - Dibromofluoromethane	92	REC %				8260B		12/11/2023	CJR	1

"J" Flag: Analyte detected between LOD and LOQ

LOD Limit of Detection

LOQ Limit of Quantitation

Code ***Comment***

1 Laboratory QC within limits.

SLA denotes sub contract lab - Certification #999888890

All solid sample results reported on a dry weight basis unless otherwise indicated. All LOD's and LOQ's are adjusted for dilutions but not dry weight. Subcontracted results are denoted by SUB in the analyst field.

Authorized Signature





Environmental Lab, LLC

www.synergy-lab.net
1990 Prospect Ct. • Appleton, WI 54914
920-830-2455 • mrsynergy@wi.twcbc.com

Sample Handling Request

Rush Analysis Date Required: _____
(Flushes accepted only with prior authorization)
 Normal Turn Around

Lab I.D. # _____
QUOTE #: 2023-0360

Project #: 6142

Sampler: (signature) *M. L...*

Project (Name / Location): OHM-Elm Grove 6142 / Elm Grove, WI

Analysis Requested

Other Analysis

Reports To: W. Fassbender / N. Morris

Invoice To: _____
Company: _____

Company: EnviroForensics

Address: _____
City State Zip: _____

Address: 825 N. Capitol Ave

Address: _____
City State Zip: _____

City State Zip: Indianapolis, IN 46204

City State Zip: _____

Phone: _____

Phone: _____

Email: _____

Email: Accounts payable@enviroforensics.com

PID/
FID

Lab I.D.	Sample I.D.	Collection Date	Time	Filtered Y/N	No. of Containers	Sample Type (Matrix)*	Preservation	DRO (Mod DRO Sep 95)	GRO (Mod GRO Sep 95)	LEAD	NITRATE/NITRITE	OIL & GREASE	PAH (EPA 8270)	PCB	PVOC (EPA 8021)	PVOC + NAPHTHALENE	SULFATE	TOTAL SUSPENDED SOLIDS	VOC DW (EPA 524.2)	VOC (EPA 8260)	VOC AIR (TO - 15)	8-RCRA METALS	MEE	TOC	
5043312A	6142-MW-1	12/17/23	14:55	N	5	WT	HCl																		
B	6142-MW-2	12/17/23	10:55																						
C	6142-MW-3	12/17/23	11:56																						
D	6142-MW-4	12/17/23	12:51																						
E	6142-MW-5	12/18/23	10:17																						
F	6142-MW-6	12/18/23	11:10																						
G	6142-MW-7	12/18/23	12:18																						
H	6142-MW-8	12/17/23	15:53																						
I	6142-MW-9	12/18/23	1:38																						
J	6142-PZ-1	12/17/23	13:44																						
K	6142-PZ-2	12/18/23	8:48																						
L	6142-DUP-1	12/18/23			3																				

Comments/Special Instructions (*Specify groundwater "GW", Drinking Water "DW", Waste Water "WW", Soil "S", Air "A", Oil, Sludge, etc.)
All times in local time zone CST

Sample Integrity - To be completed by receiving lab.
Method of Shipment: CS

Temp. of Temp. Blank: _____ °C On Ice: _____
Cooler seal intact upon receipt: Yes No

Relinquished By: (sign) *M. L...*

Time: 14:10

Date: 12/18/2023

Received By: (sign) *K. L...*

Time: 14:10

Date: 12/18

Received in Laboratory By: *M. L...*

Time: 11:00

Date: 12/19/23

CHAIN OF STUDY RECORD



Chain # 45389
Page 2 of 2

Environmental Lab, LLC

www.synergy-lab.net
1990 Prospect Ct. • Appleton, WI 54914
920-830-2455 • mrsynergy@wi.twcbc.com

Sample Handling Request
 Rush Analysis Date Required: _____
 (Flushes accepted only with prior authorization)
 Normal Turn Around

Lab I.D. # _____
 QUOTE #: 2023-0360
 Project #: 6142
 Sampler: (signature) *Melissa Dunne*

Project (Name / Location): DTM-Elm Grove 6142
 Reports To: W. Fassbender / N. Morris
 Company: Enviroforensics
 Address: 825 N. Capitol Ave
 City State Zip: Indianapolis, IN 46204
 Phone: _____
 Email: _____

Invoice To: _____
 Company: _____
 Address: Same
 City State Zip: _____
 Phone: _____
 Email: Accounts payable@enviroforensics.com

Lab I.D.	Sample I.D.	Collection Date	Filtered Y/N	No. of Containers	Sample Type (Matrix)*	Preservation	DRO (Mod DRO Sep 95)	GRO (Mod GRO Sep 95)	LEAD	NITRATE/NITRITE	OIL & GREASE	PAH (EPA 8270)	PCB	PVOC (EPA 8021)	PVOC + NAPHTHALENE	SULFATE	TOTAL SUSPENDED SOLIDS	VOC DW (EPA 524.2)	VOC (EPA 8260)	VOC AIR (TO - 15)	8-RCRA METALS	PID/ FID
243312	M	6142-DUP-2		3	WT	HCl																
	N	6142-EB-1		1	I	I													X	X	X	
	O	6142-EB-2		1	WT	HCl													X	X	X	
	P	Trip Blank		1	WT	HCl																

Comments/Special Instructions (*Specify groundwater "GW", Drinking Water "DW", Waste Water "WW", Soil "S", Air "A", Oil, Sludge, etc.):
 All times in local time zone CST

Sample Integrity - To be completed by receiving lab.
 Method of Shipment: CS
 Temp. of Temp. Blank: _____ °C On Ice:
 Cooler seal intact upon receipt: Yes No

Relinquished By: (sign) *Melissa Dunne* Time: 14:10 Date: 12/18/2023
 Received in Laboratory By: *[Signature]* Time: 1:00 Date: 12/19/23

Received By: (sign) *Kyle Davis* Time: 14:10 Date: 12/18