



April 15, 2015

June M. Evans, RPA
Vice President CRE U.S. Facilities Management
BMO Harris Bank
111 W Monroe, CRE 21W
Chicago, IL 60603

**Subject: Environmental sampling results
7535 Pershing Blvd
Kenosha, Wisconsin**

Dear Ms. Evans:

In accordance with the executed Access Agreement dated March 12, 2013, Environmental Forensic Investigations, Inc. (EnviroForensics) is providing the results of a groundwater sample collected from 7535 Pershing Blvd in Kenosha, Wisconsin. The groundwater sample was collected on November 12, 2014. The sampling activities are part of an environmental investigation being performed at the Martino's Master Dry Cleaners (Martino's) facility located at 7513 41st Avenue in Kenosha, Wisconsin at the direction of the Wisconsin Department of Natural Resources (WDNR) pursuant to the authority granted to it under State and Federal law. The WDNR has assigned the following identification to the Martino's facility: BRRTS# 02-30-552188. The chemicals of concern for the investigation are the dry cleaning solvent tetrachloroethene (PCE) and its associated breakdown products.

The Responsible Party is:

Martino's Master Drycleaners
7513 41st Avenue
Kenosha, WI
262-694-7545

Groundwater Sampling Results

One (1) groundwater sample (6165-MW-9) was collected from monitoring well MW-9 and analyzed for volatile organic compounds (VOCs). The location of MW-9 is depicted on the attached **Figure 1**. The sample results are summarized on **Table 1**. An excerpt of the laboratory report that relates to the MW-9 groundwater sample is also attached.

Document: 6165-0742
Environmental Forensic Investigations, Inc.
N16 W23390 Stone Ridge Drive, Suite G, Waukesha, WI 53188
Phone: 262-290-4001 • Fax 317-972-7875

As listed on **Table 1**, sample MW-9 contained cis-1,2-dichloroethene at an estimated concentration of 0.58 micrograms per liter (ug/L) and vinyl chloride at a concentration of 0.95 ug/L. The concentration of cis-1,2-dichloroethene is less than the WDNR Preventive Action Limit of 7 ug/L and the vinyl chloride concentration is above the WDNR Enforcement Standard of 0.2 ug/L. No other compounds were detected in the groundwater sample.

Additional samples may be collected from monitoring well MW-9 during 2015. The results of any samples will be provided to you. We will contact you to discuss additional investigation work, if any. If you have any questions or concerns, please contact me at 414-326-4412 or by email at bkappen@enviroforensics.com. The WDNR project manager, Doug Cieslak, can be reached at 262-884-2344. We greatly appreciate your help and patience with this matter.

Sincerely,
Environmental Forensic Investigations, Inc.

A handwritten signature in blue ink, appearing to read "Brian Kappen".

Brian Kappen, PG
Project Manager

A handwritten signature in blue ink, appearing to read "Wayne Fassbender".

Wayne Fassbender, PG, PMP
Senior Project Manager

Attachments: Figure 1 - Monitoring Well Location Map
Table 1 – Summary of Groundwater Analytical Results
Laboratory Analytical Report Excerpt

Copy: Doug Cieslak, Wisconsin Department of Natural Resources

Table 1
Summary of Groundwater Analytical Results - 7535 Pershing Blvd
 Martino's 41st Street
 Kenosha, Wisconsin

Monitoring Well Identification	Sample Date	Tetrachloroethene	Trichloroethene	cis-1,2-Dichloroethene	trans-1,2-Dichloroethene	Vinyl Chloride
Public Health Enforcement Standard		5	5	70	100	0.2
Public Health Preventive Action Limit		0.5	0.5	7	20	0.02
MW-9	12/17/2013	<0.33	<0.33	0.42 J	<0.35	<0.18
	3/12/2014	<0.33	<0.33	<0.38	<0.35	<0.18
	5/29/2014	<0.33	<0.33	0.60 J	<0.35	0.59
	9/22/2014	<0.33	<0.33	0.71 J	<0.35	0.34 J
	11/12/2014	<0.33	<0.33	0.69 J	<0.35	0.51 J
	03/18/15	<0.74	<0.47	0.58 J	<0.54	0.95

Notes:

All concentrations reported in micrograms per liter µg/l

Samples analyzed using EPA SW-846 Method 8260

Bolded values are above detection limits

Bolded and Orange Shaded values indicates an exceedance of the Public Health Enforcement Standard

Bolded and Blue Shaded values indicates an exceedance the Public Health Preventive Action Limit

J = Estimated concentration between the laboratory Reporting Limit and the laboratory Method Detection Limit

Project Name MARTINOS 41ST
 Project # 6165 PO#2015183

Invoice # E28660

Lab Code 5028660J
 Sample ID 6165-MW-9
 Sample Matrix Water
 Sample Date 3/18/2015

	Result	Unit	LOD	LOQ	Dil	Method	Ext Date	Run Date	Analyst	Code
Organic										
VOC's										
Benzene	< 0.44	ug/l	0.44	1.4	1	8260B		3/24/2015	CJR	1
Bromobenzene	< 0.48	ug/l	0.48	1.5	1	8260B		3/24/2015	CJR	1
Bromodichloromethane	< 0.46	ug/l	0.46	1.5	1	8260B		3/24/2015	CJR	1
Bromoform	< 0.46	ug/l	0.46	1.5	1	8260B		3/24/2015	CJR	1
tert-Butylbenzene	< 1.1	ug/l	1.1	3.4	1	8260B		3/24/2015	CJR	1
sec-Butylbenzene	< 1.2	ug/l	1.2	3.8	1	8260B		3/24/2015	CJR	1
n-Butylbenzene	< 1	ug/l	1	3.3	1	8260B		3/24/2015	CJR	1
Carbon Tetrachloride	< 0.65	ug/l	0.65	2.1	1	8260B		3/24/2015	CJR	1
Chlorobenzene	< 0.46	ug/l	0.46	1.4	1	8260B		3/24/2015	CJR	1
Chloroethane	< 0.65	ug/l	0.65	2.1	1	8260B		3/24/2015	CJR	1
Chloroform	< 0.43	ug/l	0.43	1.4	1	8260B		3/24/2015	CJR	1
Chloromethane	< 1.9	ug/l	1.9	6	1	8260B		3/24/2015	CJR	1
2-Chlorotoluene	< 0.4	ug/l	0.4	1.3	1	8260B		3/24/2015	CJR	1
4-Chlorotoluene	< 0.63	ug/l	0.63	2	1	8260B		3/24/2015	CJR	1
1,2-Dibromo-3-chloropropane	< 1.4	ug/l	1.4	4.5	1	8260B		3/24/2015	CJR	1
Dibromochloromethane	< 0.45	ug/l	0.45	1.4	1	8260B		3/24/2015	CJR	1
1,4-Dichlorobenzene	< 0.49	ug/l	0.49	1.6	1	8260B		3/24/2015	CJR	1
1,3-Dichlorobenzene	< 0.52	ug/l	0.52	1.6	1	8260B		3/24/2015	CJR	1
1,2-Dichlorobenzene	< 0.46	ug/l	0.46	1.5	1	8260B		3/24/2015	CJR	1
Dichlorodifluoromethane	< 0.87	ug/l	0.87	2.8	1	8260B		3/24/2015	CJR	1
1,2-Dichloroethane	< 0.54	ug/l	0.54	1.7	1	8260B		3/24/2015	CJR	1
1,1-Dichloroethane	< 1.1	ug/l	1.1	3.6	1	8260B		3/24/2015	CJR	1
1,1-Dichloroethene	< 0.65	ug/l	0.65	2.1	1	8260B		3/24/2015	CJR	1
cis-1,2-Dichloroethene	0.58 "J"	ug/l	0.45	1.4	1	8260B		3/24/2015	CJR	1
trans-1,2-Dichloroethene	< 0.54	ug/l	0.54	1.7	1	8260B		3/24/2015	CJR	1
1,2-Dichloropropane	< 0.43	ug/l	0.43	1.37	1	8260B		3/24/2015	CJR	1
2,2-Dichloropropane	< 3.1	ug/l	3.1	9.8	1	8260B		3/24/2015	CJR	4 8
1,3-Dichloropropane	< 0.42	ug/l	0.42	1.3	1	8260B		3/24/2015	CJR	1
Di-isopropyl ether	< 0.44	ug/l	0.44	1.4	1	8260B		3/24/2015	CJR	1
EDB (1,2-Dibromoethane)	< 0.63	ug/l	0.63	2	1	8260B		3/24/2015	CJR	1
Ethylbenzene	< 0.71	ug/l	0.71	2.3	1	8260B		3/24/2015	CJR	1
Hexachlorobutadiene	< 2.2	ug/l	2.2	7.1	1	8260B		3/24/2015	CJR	1
Isopropylbenzene	< 0.82	ug/l	0.82	2.6	1	8260B		3/24/2015	CJR	1
p-Isopropyltoluene	< 1.1	ug/l	1.1	3.5	1	8260B		3/24/2015	CJR	1
Methylene chloride	< 1.3	ug/l	1.3	4.2	1	8260B		3/24/2015	CJR	1
Methyl tert-butyl ether (MTBE)	< 1.1	ug/l	1.1	3.7	1	8260B		3/24/2015	CJR	1
Naphthalene	< 1.6	ug/l	1.6	5.2	1	8260B		3/24/2015	CJR	1
n-Propylbenzene	< 0.77	ug/l	0.77	2.4	1	8260B		3/24/2015	CJR	1
1,1,2,2-Tetrachloroethane	< 0.52	ug/l	0.52	1.7	1	8260B		3/24/2015	CJR	1
1,1,1,2-Tetrachloroethane	< 0.48	ug/l	0.48	1.5	1	8260B		3/24/2015	CJR	1
Tetrachloroethene	< 0.74	ug/l	0.74	2.4	1	8260B		3/24/2015	CJR	1
Toluene	< 0.44	ug/l	0.44	1.4	1	8260B		3/24/2015	CJR	1
1,2,4-Trichlorobenzene	< 1.7	ug/l	1.7	5.6	1	8260B		3/24/2015	CJR	1
1,2,3-Trichlorobenzene	< 2.7	ug/l	2.7	8.6	1	8260B		3/24/2015	CJR	1
1,1,1-Trichloroethane	< 0.84	ug/l	0.84	2.7	1	8260B		3/24/2015	CJR	1
1,1,2-Trichloroethane	< 0.48	ug/l	0.48	1.52	1	8260B		3/24/2015	CJR	1
Trichloroethene (TCE)	< 0.47	ug/l	0.47	1.5	1	8260B		3/24/2015	CJR	1
Trichlorofluoromethane	< 0.87	ug/l	0.87	2.8	1	8260B		3/24/2015	CJR	1
1,2,4-Trimethylbenzene	< 1.6	ug/l	1.6	5	1	8260B		3/24/2015	CJR	1
1,3,5-Trimethylbenzene	< 1.5	ug/l	1.5	4.8	1	8260B		3/24/2015	CJR	1
Vinyl Chloride	0.95	ug/l	0.17	0.54	1	8260B		3/24/2015	CJR	1
m&p-Xylene	< 2.2	ug/l	2.2	6.9	1	8260B		3/24/2015	CJR	1
o-Xylene	< 0.9	ug/l	0.9	2.9	1	8260B		3/24/2015	CJR	1
SUR - Toluene-d8	102	REC %			1	8260B		3/24/2015	CJR	1
SUR - 1,2-Dichloroethane-d4	101	REC %			1	8260B		3/24/2015	CJR	1
SUR - 4-Bromofluorobenzene	104	REC %			1	8260B		3/24/2015	CJR	1
SUR - Dibromofluoromethane	94	REC %			1	8260B		3/24/2015	CJR	1

Legend

- Property boundary
- Fence line
- GAS— Underground gas utility line
- WTR— Underground water utility line
- SAN— Underground sanitary utility line
- - - - - Underground storm utility line
- OVHD— Over head electrical utility line
- UGE— Underground electrical utility line
- UCT— Underground cable television utility line
- MW-5 ◆ Monitoring well location

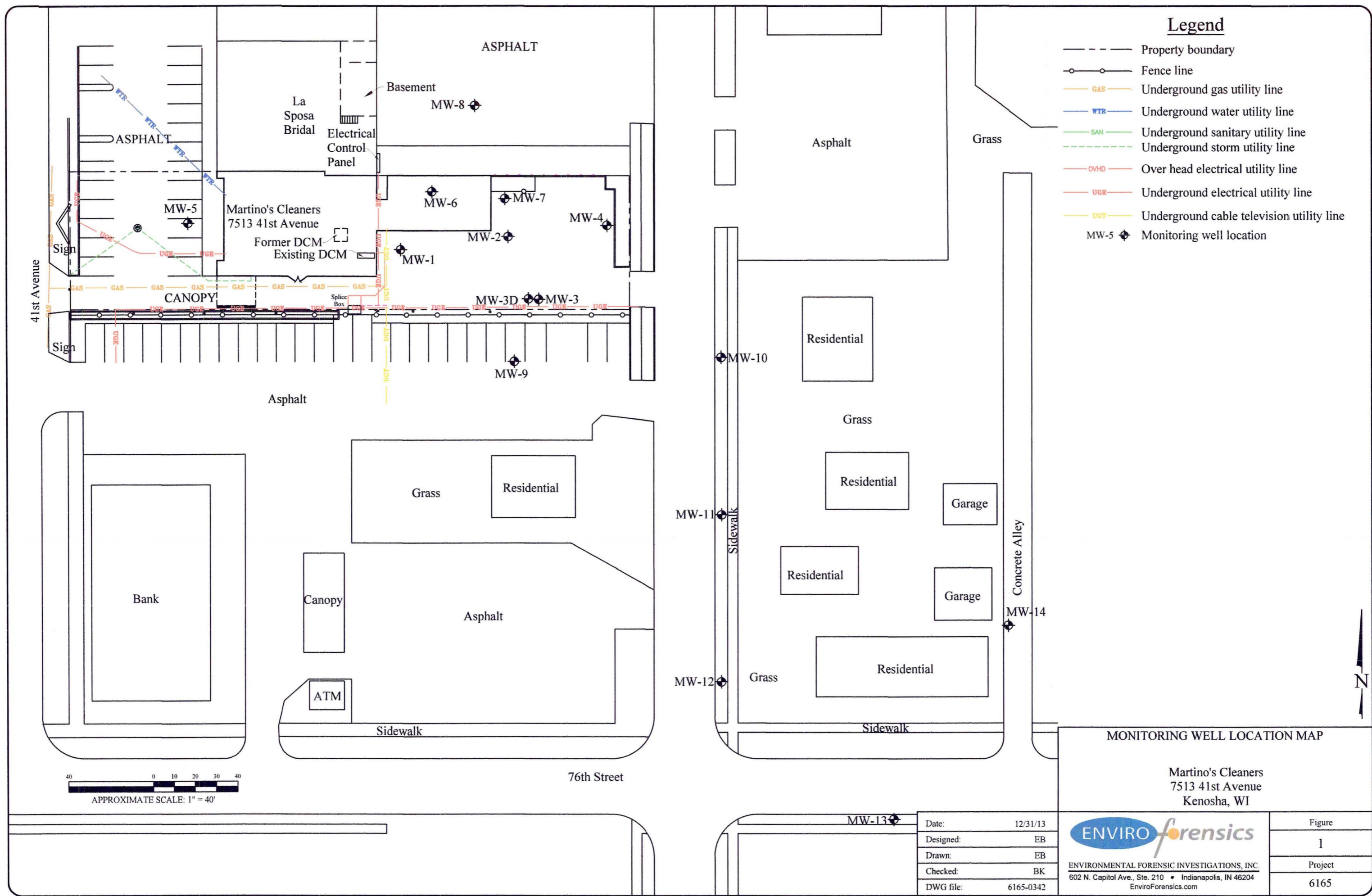

MONITORING WELL LOCATION MAP

Martino's Cleaners
7513 41st Avenue
Kenosha, WI

Date:	12/31/13
Designed:	EB
Drawn:	EB
Checked:	BK
DWG file:	6165-0342

ENVIROforensics
ENVIRONMENTAL FORENSIC INVESTIGATIONS, INC.
602 N. Capitol Ave., Ste. 210 • Indianapolis, IN 46204
EnviroForensics.com

Figure	1
Project	6165

