



July 24, 2015

RECEIVED  
JUL 29 2015

BY: *P.C.*

June M. Evans, RPA  
Vice President CRE U.S. Facilities Management  
BMO Harris Bank  
111 W Monroe, CRE 21W  
Chicago, IL 60603

**Subject: Environmental sampling results - 7535 Pershing Blvd, Kenosha, Wisconsin  
BRRTS# 02-30-552188**

Dear Ms. Evans:

In accordance with the executed Access Agreement dated March 12, 2013, Environmental Forensic Investigations, Inc. (EnviroForensics) is providing the results of a groundwater sample collected from 7535 Pershing Blvd in Kenosha, Wisconsin. The groundwater sample was collected on June 22, 2015. The sampling activities are part of an environmental investigation being performed at the Martino's Master Dry Cleaners (Martino's) facility located at 7513 41st Avenue in Kenosha, Wisconsin at the direction of the Wisconsin Department of Natural Resources (WDNR) pursuant to the authority granted to it under State and Federal law. The WDNR has assigned the following identification to the Martino's facility: BRRTS# 02-30-552188. The chemicals of concern for the investigation are the dry cleaning solvent tetrachloroethene (PCE) and its associated breakdown products.

The Responsible Party is:

Martino's Master Drycleaners  
7513 41<sup>st</sup> Avenue  
Kenosha, WI  
262-694-7545

### **Groundwater Sampling Results**

One (1) groundwater sample (6165-MW-9) was collected from monitoring well MW-9 and analyzed for volatile organic compounds (VOCs). The location of MW-9 is depicted on the attached **Figure 1**. The sample results are summarized on **Table 1**. An excerpt of the laboratory report that relates to the MW-9 groundwater sample is also attached.

As listed on **Table 1**, sample MW-9 contained cis-1,2-dichloroethene at an estimated concentration of 0.65 micrograms per liter ( $\mu\text{g/L}$ ) and vinyl chloride at a concentration of 1.35

*Document: 6165-0877*  
Environmental Forensic Investigations, Inc.  
N16 W23390 Stone Ridge Drive, Suite G, Waukesha, WI 53188  
Phone: 262-290-4001 • Fax 317-972-7875



µg/L. The concentration of cis-1,2-dichloroethene is less than the preventive action limit of 7 µg/L, and the vinyl chloride concentration is above the enforcement standard of 0.2 µg/L. No other compounds were detected in the groundwater sample.

Additional samples may be collected from monitoring well MW-9 during 2015. The results of any samples will be provided to you. We will contact you to discuss additional investigation work, if any. If you have any questions or concerns, please contact me at 414-326-4412 or by email at [bkappen@enviroforensics.com](mailto:bkappen@enviroforensics.com). The WDNR project manager, Doug Cieslak, can be reached at 262-884-2344. We greatly appreciate your help and patience with this matter.

Sincerely,  
**Environmental Forensic Investigations, Inc.**

A handwritten signature in black ink, appearing to read "Brian Kappen".

Brian Kappen, PG  
*Project Manager*

A handwritten signature in black ink, appearing to read "Wayne Fassbender".

Wayne Fassbender, PG, PMP  
*Senior Project Manager*

Attachments: Figure 1 - Monitoring Well Location Map  
Table 1 - Summary of Groundwater Analytical Results  
Laboratory Analytical Report Excerpt

Copy: Doug Cieslak, Wisconsin Department of Natural Resources

Project Name MARTINO'S 41ST AVE  
 Project # 6165.17a PO#2015579

Invoice # E29159

Lab Code 50291590  
 Sample ID 6165-MW-9  
 Sample Matrix Water  
 Sample Date 6/22/2015

	Result	Unit	LOD	LOQ	Dil	Method	Ext Date	Run Date	Analyst	Code
Organic										
VOC's										
Benzene	< 0.44	ug/l	0.44	1.4	1	8260B		6/29/2015	CJR	1
Bromobenzene	< 0.48	ug/l	0.48	1.5	1	8260B		6/29/2015	CJR	1
Bromodichloromethane	< 0.46	ug/l	0.46	1.5	1	8260B		6/29/2015	CJR	1
Bromoform	< 0.46	ug/l	0.46	1.5	1	8260B		6/29/2015	CJR	1
tert-Butylbenzene	< 1.1	ug/l	1.1	3.4	1	8260B		6/29/2015	CJR	1
sec-Butylbenzene	< 1.2	ug/l	1.2	3.8	1	8260B		6/29/2015	CJR	1
n-Butylbenzene	< 1	ug/l	1	3.3	1	8260B		6/29/2015	CJR	1
Carbon Tetrachloride	< 0.65	ug/l	0.65	2.1	1	8260B		6/29/2015	CJR	1
Chlorobenzene	< 0.46	ug/l	0.46	1.4	1	8260B		6/29/2015	CJR	1
Chloroethane	< 0.65	ug/l	0.65	2.1	1	8260B		6/29/2015	CJR	1
Chloroform	< 0.43	ug/l	0.43	1.4	1	8260B		6/29/2015	CJR	1
Chloromethane	< 1.9	ug/l	1.9	6	1	8260B		6/29/2015	CJR	1
2-Chlorotoluene	< 0.4	ug/l	0.4	1.3	1	8260B		6/29/2015	CJR	1
4-Chlorotoluene	< 0.63	ug/l	0.63	2	1	8260B		6/29/2015	CJR	1
1,2-Dibromo-3-chloropropane	< 1.4	ug/l	1.4	4.5	1	8260B		6/29/2015	CJR	1
Dibromochloromethane	< 0.45	ug/l	0.45	1.4	1	8260B		6/29/2015	CJR	1
1,4-Dichlorobenzene	< 0.49	ug/l	0.49	1.6	1	8260B		6/29/2015	CJR	1
1,3-Dichlorobenzene	< 0.52	ug/l	0.52	1.6	1	8260B		6/29/2015	CJR	1
1,2-Dichlorobenzene	< 0.46	ug/l	0.46	1.5	1	8260B		6/29/2015	CJR	1
Dichlorodifluoromethane	< 0.87	ug/l	0.87	2.8	1	8260B		6/29/2015	CJR	1
1,2-Dichloroethane	< 0.54	ug/l	0.54	1.7	1	8260B		6/29/2015	CJR	1
1,1-Dichloroethane	< 1.1	ug/l	1.1	3.6	1	8260B		6/29/2015	CJR	1
1,1-Dichloroethene	< 0.65	ug/l	0.65	2.1	1	8260B		6/29/2015	CJR	1
cis-1,2-Dichloroethene	0.65 "J"	ug/l	0.45	1.4	1	8260B		6/29/2015	CJR	1
trans-1,2-Dichloroethene	< 0.54	ug/l	0.54	1.7	1	8260B		6/29/2015	CJR	1
1,2-Dichloropropane	< 0.43	ug/l	0.43	1.37	1	8260B		6/29/2015	CJR	1
2,2-Dichloropropane	< 3.1	ug/l	3.1	9.8	1	8260B		6/29/2015	CJR	1
1,3-Dichloropropane	< 0.42	ug/l	0.42	1.3	1	8260B		6/29/2015	CJR	1
Di-isopropyl ether	< 0.44	ug/l	0.44	1.4	1	8260B		6/29/2015	CJR	1
EDB (1,2-Dibromoethane)	< 0.63	ug/l	0.63	2	1	8260B		6/29/2015	CJR	1
Ethylbenzene	< 0.71	ug/l	0.71	2.3	1	8260B		6/29/2015	CJR	1
Hexachlorobutadiene	< 2.2	ug/l	2.2	7.1	1	8260B		6/29/2015	CJR	1
Isopropylbenzene	< 0.82	ug/l	0.82	2.6	1	8260B		6/29/2015	CJR	1
p-Isopropyltoluene	< 1.1	ug/l	1.1	3.5	1	8260B		6/29/2015	CJR	1
Methylene chloride	< 1.3	ug/l	1.3	4.2	1	8260B		6/29/2015	CJR	1
Methyl tert-butyl ether (MTBE)	< 1.1	ug/l	1.1	3.7	1	8260B		6/29/2015	CJR	1
Naphthalene	< 1.6	ug/l	1.6	5.2	1	8260B		6/29/2015	CJR	1
n-Propylbenzene	< 0.77	ug/l	0.77	2.4	1	8260B		6/29/2015	CJR	1
1,1,2,2-Tetrachloroethane	< 0.52	ug/l	0.52	1.7	1	8260B		6/29/2015	CJR	1
1,1,1,2-Tetrachloroethane	< 0.48	ug/l	0.48	1.5	1	8260B		6/29/2015	CJR	1
Tetrachloroethene	< 0.74	ug/l	0.74	2.4	1	8260B		6/29/2015	CJR	1
Toluene	< 0.44	ug/l	0.44	1.4	1	8260B		6/29/2015	CJR	1
1,2,4-Trichlorobenzene	< 1.7	ug/l	1.7	5.6	1	8260B		6/29/2015	CJR	1
1,2,3-Trichlorobenzene	< 2.7	ug/l	2.7	8.6	1	8260B		6/29/2015	CJR	1
1,1,1-Trichloroethane	< 0.84	ug/l	0.84	2.7	1	8260B		6/29/2015	CJR	1
1,1,2-Trichloroethane	< 0.48	ug/l	0.48	1.52	1	8260B		6/29/2015	CJR	1
Trichloroethene (TCE)	< 0.47	ug/l	0.47	1.5	1	8260B		6/29/2015	CJR	1
Trichlorofluoromethane	< 0.87	ug/l	0.87	2.8	1	8260B		6/29/2015	CJR	1
1,2,4-Trimethylbenzene	< 1.6	ug/l	1.6	5	1	8260B		6/29/2015	CJR	1
1,3,5-Trimethylbenzene	< 1.5	ug/l	1.5	4.8	1	8260B		6/29/2015	CJR	1
Vinyl Chloride	1.35	ug/l	0.17	0.54	1	8260B		6/29/2015	CJR	1
m&p-Xylene	< 2.2	ug/l	2.2	6.9	1	8260B		6/29/2015	CJR	1
o-Xylene	< 0.9	ug/l	0.9	2.9	1	8260B		6/29/2015	CJR	1
SUR - 1,2-Dichloroethane-d4	102	REC %			1	8260B		6/29/2015	CJR	1
SUR - Toluene-d8	95	REC %			1	8260B		6/29/2015	CJR	1
SUR - 4-Bromofluorobenzene	101	REC %			1	8260B		6/29/2015	CJR	1
SUR - Dibromofluoromethane	104	REC %			1	8260B		6/29/2015	CJR	1

"J" Flag: Analyte detected between LOD and LOQ                      LOD Limit of Detection                      LOQ Limit of Quantitation

<i>Code</i>	<i>Comment</i>
1	Laboratory QC within limits.
3	The matrix spike not within established limits.
4	The continuing calibration standard not within established limits.
8	Closing calibration standard not within established limits.

CWT denotes sub contract lab - Certification #445126660

ESC denotes sub contract lab - Certification #998093910

All solid sample results reported on a dry weight basis unless otherwise indicated. All LOD's and LOQ's are adjusted for dilutions but not dry weight. Subcontracted results are denoted by SUB in the analyst field.

Authorized Signature

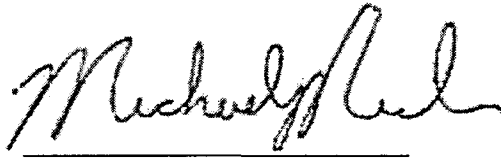

CHAIN OF CUSTODY RECORD

PORT2015579

Synergy

Environmental Lab, Inc.

Chain # N<sup>o</sup> 246

B37

Page 2 of 2

Lab I.D. #  
 Account No.: Quote No.:  
 Project #: 6165.17a  
 Sampler: (signature) \_\_\_\_\_

1990 Prospect Ct. • Appleton, WI 54914  
920-830-2455 • FAX 920-733-0631

**Sample Handling Request**  
 Rush Analysis Date Required \_\_\_\_\_  
 (Rushes accepted only with prior authorization)  
 Normal Turn Around

Project (Name / Location): Martino's 41st Ave  
 Reports To: B. Krappen / K. VanderHeide  
 Invoice To:  
 Company: EnviroForensics  
 Address: N16 W2390 Stone Bridge Dr. Suite G  
 City State Zip: Waukesha, WI 53188  
 Phone: 317-972-7870  
 FAX:

Analysis Requested		Other Analysis											
DRO (Mod DRO Sep 95)	GRO (Mod GRO Sep 95)	LEAD	NITRATE/NITRITE	OIL & GREASE	PAH (EPA 8270)	PVOC (EPA 8021)	PVOC + NAPHTHALENE	SULFATE	TOTAL SUSPENDED SOLIDS	VOC DW (EPA 542.2)	VOC (EPA 8260)	8-PCRA METALS	PID/ FID

Lab I.D.	Sample I.D.	Collection Date	Time	Comp	Grab	Filtered Y/N	No. of Containers	Sample Type (Matrix)*	Preservation
5029159 E	6165-MW-3D	6/23	1330		<	N	3	GW	HCL
L	6165-MW-4	6/23	1040		x	N	3	GW	HCL
M	6165-MW-7	6/23	1118		x	N	3	GW	HCL
N	6165-MW-8	6/22	1650		<	N	3	GW	HCL
O	6165-MW-9	6/22	1240		x	N	3	GW	HCL
P	6165-MW-10	6/22	1535		x	N	3	GW	HCL
Q	6165-MW-12	6/22	1455		x	N	3	GW	HCL
R	6165-MW-14	6/22	1325		<	N	3	GW	HCL
S	6165-DUP-2	6/22			x	N	3	GW	HCL
T	6165-TRIP-1				<	N	1	GW	HCL

Comments/Special Instructions (\*Specify groundwater "GW", Drinking Water "DW", Waste Water "WW", Soil "S", Air "A", Oil, Sludge etc.)

Sample Integrity - To be completed by receiving lab.  
 Method of Shipment: Duplicate  
 Temp. of Temp. Blank:      °C On Ice:   
 Cooler seal intact upon receipt:  Yes  No

Relinquished By: (sign) \_\_\_\_\_ Time: 11:01 Date: 6/24  
 Received By: (sign) \_\_\_\_\_ Time: 11:02 Date: 6/24/15

Received in Laboratory By: Christine Rose Time: 8:00 Date: 6/25/15

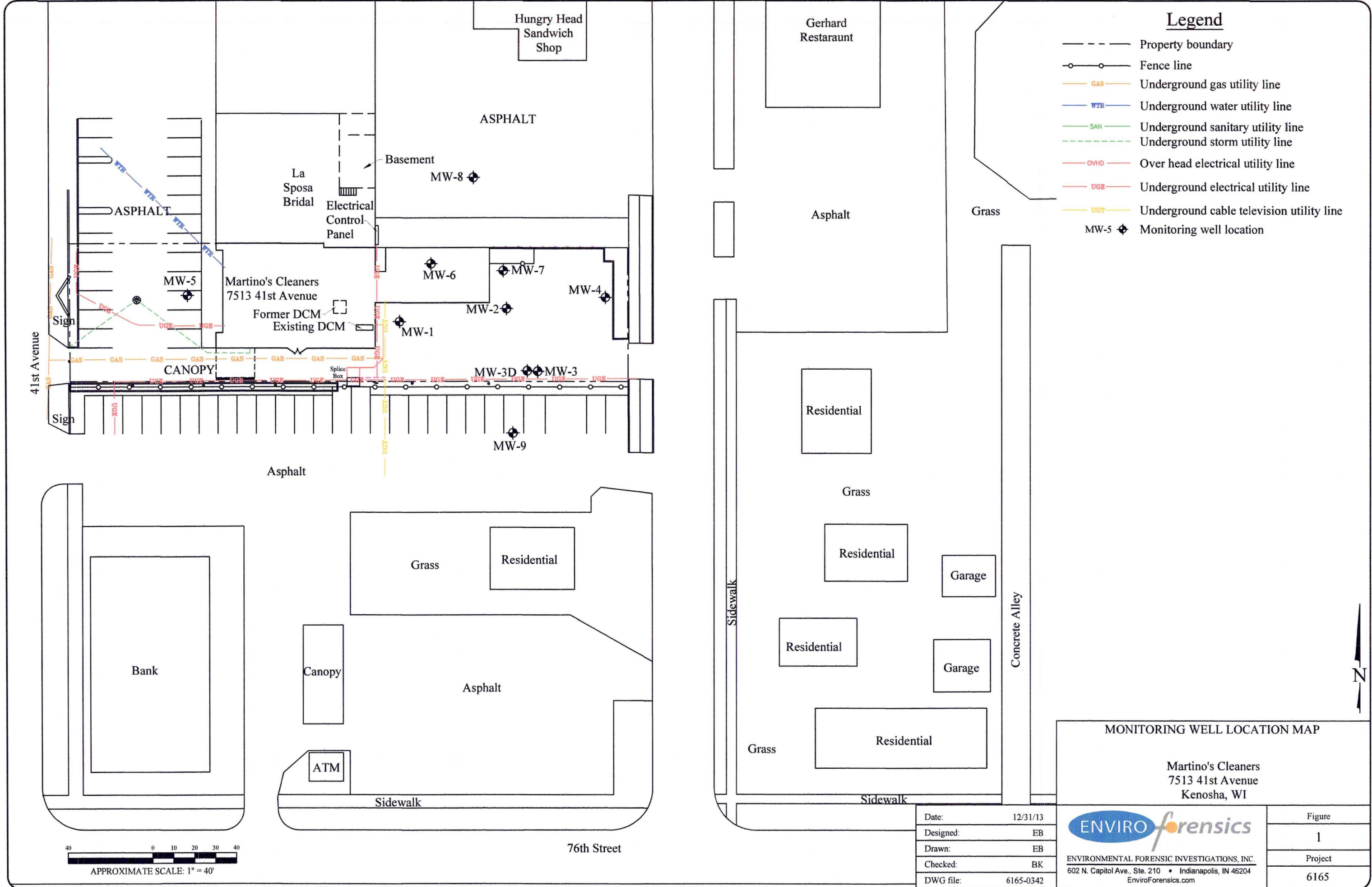

**Legend**

- Property boundary
- Fence line
- GAS— Underground gas utility line
- WTR— Underground water utility line
- SAN— Underground sanitary utility line
- - - - - Underground storm utility line
- OVHD— Over head electrical utility line
- UGE— Underground electrical utility line
- UGT— Underground cable television utility line
- MW-5 ◆ Monitoring well location

41st Avenue

76th Street

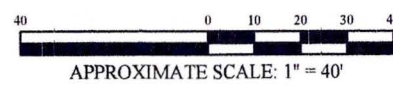

**MONITORING WELL LOCATION MAP**

Martino's Cleaners  
7513 41st Avenue  
Kenosha, WI

Date:	12/31/13
Designed:	EB
Drawn:	EB
Checked:	BK
DWG file:	6165-0342

ENVIRONMENTAL FORENSIC INVESTIGATIONS, INC.  
602 N. Capitol Ave., Ste. 210 • Indianapolis, IN 46204  
EnviroForensics.com

Figure	1
Project	6165



**Table 1**  
**Summary of Groundwater Analytical Results - 7535 Pershing Blvd**  
 Martino's 41st Street  
 Kenosha, Wisconsin

Monitoring Well Identification	Sample Date	Tetrachloroethene	Trichloroethene	cis-1,2-Dichloroethene	trans-1,2-Dichloroethene	Vinyl Chloride
<b>Public Health Enforcement Standard</b>		<b>5</b>	<b>5</b>	<b>70</b>	<b>100</b>	<b>0.2</b>
<b>Public Health Preventive Action Limit</b>		<b>0.5</b>	<b>0.5</b>	<b>7</b>	<b>20</b>	<b>0.02</b>
MW-9	12/17/2013	<0.33	<0.33	<b>0.42 J</b>	<0.35	<0.18
	3/12/2014	<0.33	<0.33	<0.38	<0.35	<0.18
	5/29/2014	<0.33	<0.33	<b>0.60 J</b>	<0.35	<b>0.59</b>
	9/22/2014	<0.33	<0.33	<b>0.71 J</b>	<0.35	<b>0.34 J</b>
	11/12/2014	<0.33	<0.33	<b>0.69 J</b>	<0.35	<b>0.51 J</b>
	03/18/15	<0.74	<0.47	<b>0.58 J</b>	<0.54	<b>0.95</b>
	06/22/15	<0.74	<0.47	<b>0.65 J</b>	<0.54	<b>1.35</b>

**Notes:**

All concentrations reported in micrograms per liter µg/l

Samples analyzed using EPA SW-846 Method 8260

**Bolded** values are above detection limits

**Bolded** and Orange Shaded values indicates an exceedance of the Public Health Enforcement Standard

**Bolded** and Blue Shaded values indicates an exceedance the Public Health Preventive Action Limit

J = Estimated concentration between the laboratory Reporting Limit and the laboratory Method Detection Limit