



December 28, 2020

June Evans
Vice-President
BMO Harris Bank
111 W Monroe, 4W
Chicago, IL 60603

**Subject: Environmental sampling results - 7535 Pershing Blvd, Kenosha, Wisconsin
BRRTS# 02-30-552188**

Dear Ms. Evans:

In accordance with the executed Agreement to Provide Access for Sampling Activities, EnviroForensics, LLC is providing the attached sampling results. A groundwater sample was collected from one (1) monitoring well located at 7535 Pershing Blvd in Kenosha, Wisconsin on December 8, 2020. The sampling activities are part of an environmental investigation being performed at the Martino's Master Dry Cleaners (Martino's) facility located at 7513 41st Avenue in Kenosha, Wisconsin at the direction of the Wisconsin Department of Natural Resources (WDNR) pursuant to the authority granted to it under State and Federal law. The WDNR has assigned the following identification to the Martino's facility: BRRTS# 02-30-552188. The chemicals of concern for the investigation are the dry cleaning solvent tetrachloroethene (PCE) and its associated breakdown products.

The Responsible Party is:

Martino's Master Drycleaners
7513 41st Avenue
Kenosha, WI

Sampling Results

One (1) groundwater sample designated 6165 MW-9 was collected from monitoring well MW-9 and analyzed for volatile organic compounds (VOCs). The location of MW-9 is shown on the attached **Figure 1**. The results of the groundwater sample are summarized and compared to WDNR standards on **Table 1**. An excerpt of the laboratory report that relates to the MW-9 groundwater sample is also attached. As shown on **Table 1**, the chemicals of concern were not detected in the MW-9 sample.

Additional groundwater samples may be collected from monitoring well MW-9 in the future. We will schedule the work with you prior to accessing the property, and the results of any samples will be provided to you. If you have any questions or concerns, please contact me at 262-745-5054 or by email at bkappen@enviroforensics.com. The WDNR project manager, Jane Pfeiffer, can be reached at 414-435-8021. We greatly appreciate your help and patience with this matter.

Sincerely,
EnviroForensics, LLC

A handwritten signature in blue ink, appearing to read "Brian Kappen".

Brian Kappen, PG
Project Manager

Attachments: Figure 1 - Monitoring Well Location Map
Table 1 – Summary of Groundwater Analytical Results
Laboratory Analytical Report Excerpt

Copy: Jane Pfeiffer, Wisconsin Department of Natural Resources

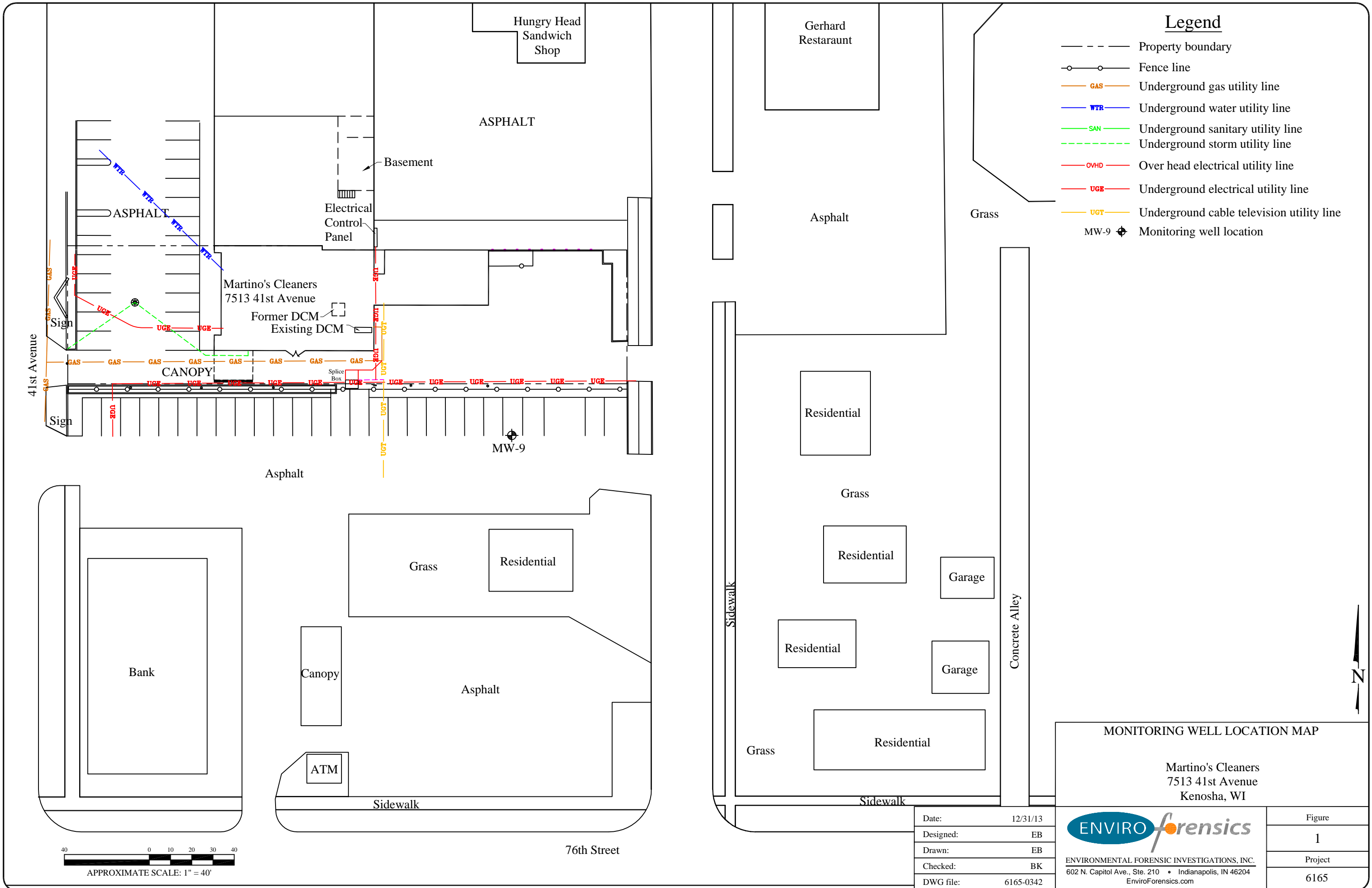

Legend

- Property boundary
- Fence line
- GAS— Underground gas utility line
- WTR— Underground water utility line
- SAN— Underground sanitary utility line
- - - - - Underground storm utility line
- OVHD— Over head electrical utility line
- UGE— Underground electrical utility line
- UGT— Underground cable television utility line
- MW-9 ⊕ Monitoring well location



APPROXIMATE SCALE: 1" = 40'

MONITORING WELL LOCATION MAP

Martino's Cleaners
7513 41st Avenue
Kenosha, WI

Date:	12/31/13
Designed:	EB
Drawn:	EB
Checked:	BK
DWG file:	6165-0342



ENVIRONMENTAL FORENSIC INVESTIGATIONS, INC.
602 N. Capitol Ave., Ste. 210 • Indianapolis, IN 46204
EnviroForensics.com

Figure	1
Project	6165



Table 1
Summary of Groundwater Analytical Results - 7535 Pershing Blvd
 Martino's Master Dry Cleaners
 7513 41st Avenue, Kenosha, Wisconsin

Monitoring Well Identification	Sample Date	Tetrachloroethene	Trichloroethene	cis-1,2-Dichloroethene	trans-1,2-Dichloroethene	Vinyl Chloride
Public Health Enforcement Standard		5	5	70	100	0.2
Public Health Preventive Action Limit		0.5	0.5	7	20	0.02
MW-9	12/17/13	<0.33	<0.33	0.42 J	<0.35	<0.18
	03/12/14	<0.33	<0.33	<0.38	<0.35	<0.18
	05/29/14	<0.33	<0.33	0.60 J	<0.35	0.59
	09/22/14	<0.33	<0.33	0.71 J	<0.35	0.34 J
	11/12/14	<0.33	<0.33	0.69 J	<0.35	0.51 J
	03/18/15	<0.74	<0.47	0.58 J	<0.54	0.95
	06/22/15	<0.74	<0.47	0.65 J	<0.54	1.35
	09/18/15	<0.49	<0.47	0.73 J	<0.54	0.70
	12/02/15	<0.49	<0.47	0.80 J	<0.54	3.01
	09/15/20	<0.33	<0.47	<0.39	<0.37	<0.2
12/08/20	<0.33	<0.47	<0.39	<0.37	<0.2	

Notes:

All concentrations reported in micrograms per liter µg/l

Samples analyzed using EPA SW-846 Method 8260

Bolded values are above detection limits

Bolded and Orange Shaded values indicates an exceedance of the Public Health Enforcement Standard

Bolded and Blue Shaded values indicates an exceedance the Public Health Preventive Action Limit

J = Estimated concentration between the laboratory Reporting Limit and Method Detection Limit

Project Name MARTINO'S 41ST-KENOSHA
Project # 6165 PO#2020-2131

Invoice # E38892

Lab Code 5038892D
Sample ID 6165 MW-9
Sample Matrix Water
Sample Date 12/8/2020

	Result	Unit	LOD	LOQ	Dil	Method	Ext Date	Run Date	Analyst	Code
Organic										
VOC's										
Benzene	< 0.33	ug/l	0.33		1	624		12/15/2020	CJR	1
Bromobenzene	< 0.26	ug/l	0.26	0.84	1	624		12/15/2020	CJR	1
Bromodichloromethane	< 0.33	ug/l	0.33		1	624		12/15/2020	CJR	1
Bromoform	< 0.65	ug/l	0.65	2.1	1	624		12/15/2020	CJR	1
tert-Butylbenzene	< 0.61	ug/l	0.61	1.9	1	624		12/15/2020	CJR	1
sec-Butylbenzene	< 0.32	ug/l	0.32		1	624		12/15/2020	CJR	1
n-Butylbenzene	< 0.28	ug/l	0.28	0.89	1	624		12/15/2020	CJR	1
Carbon Tetrachloride	< 0.31	ug/l	0.31	0.98	1	624		12/15/2020	CJR	1
Chlorobenzene	< 0.39	ug/l	0.39	1.2	1	624		12/15/2020	CJR	1
Chloroethane	< 1.1	ug/l	1.1	3.6	1	624		12/15/2020	CJR	1
Chloroform	< 0.44	ug/l	0.44	1.4	1	624		12/15/2020	CJR	1
Chloromethane	< 0.8	ug/l	0.8	2.5	1	624		12/15/2020	CJR	1
2-Chlorotoluene	< 0.32	ug/l	0.32		1	624		12/15/2020	CJR	1
4-Chlorotoluene	< 0.3	ug/l	0.3	0.96	1	624		12/15/2020	CJR	1
1,2-Dibromo-3-chloropropane	< 0.82	ug/l	0.82	2.6	1	624		12/15/2020	CJR	1
Dibromochloromethane	< 0.23	ug/l	0.23	0.74	1	624		12/15/2020	CJR	1
1,4-Dichlorobenzene	< 0.36	ug/l	0.36	1.1	1	624		12/15/2020	CJR	1
1,3-Dichlorobenzene	< 0.31	ug/l	0.31	0.98	1	624		12/15/2020	CJR	1
1,2-Dichlorobenzene	< 0.32	ug/l	0.32		1	624		12/15/2020	CJR	1
Dichlorodifluoromethane	< 0.45	ug/l	0.45	1.4	1	624		12/15/2020	CJR	1
1,2-Dichloroethane	< 0.39	ug/l	0.39	1.3	1	624		12/15/2020	CJR	1
1,1-Dichloroethane	< 0.46	ug/l	0.46	1.5	1	624		12/15/2020	CJR	1
1,1-Dichloroethene	< 0.5	ug/l	0.5	1.6	1	624		12/15/2020	CJR	1
cis-1,2-Dichloroethene	< 0.39	ug/l	0.39	1.2	1	624		12/15/2020	CJR	1
trans-1,2-Dichloroethene	< 0.37	ug/l	0.37	1.2	1	624		12/15/2020	CJR	1
1,2-Dichloropropane	< 0.38	ug/l	0.38	1.2	1	624		12/15/2020	CJR	1
1,3-Dichloropropane	< 0.35	ug/l	0.35	1.1	1	624		12/15/2020	CJR	1
trans-1,3-Dichloropropene	< 0.3	ug/l	0.3	0.94	1	624		12/15/2020	CJR	1
cis-1,3-Dichloropropene	< 0.36	ug/l	0.36	1.1	1	624		12/15/2020	CJR	1
Di-isopropyl ether	< 0.34	ug/l	0.34	1.1	1	624		12/15/2020	CJR	1
EDB (1,2-Dibromoethane)	< 0.24	ug/l	0.24	0.75	1	624		12/15/2020	CJR	1
Ethylbenzene	< 0.32	ug/l	0.32		1	624		12/15/2020	CJR	1
Hexachlorobutadiene	< 0.72	ug/l	0.72	2.3	1	624		12/15/2020	CJR	1
Isopropylbenzene	< 0.32	ug/l	0.32		1	624		12/15/2020	CJR	1
p-Isopropyltoluene	< 0.47	ug/l	0.47	1.5	1	624		12/15/2020	CJR	1
Methylene chloride	< 1.32	ug/l	1.32	4.21	1	624		12/15/2020	CJR	1
Methyl tert-butyl ether (MTBE)	< 0.47	ug/l	0.47	1.5	1	624		12/15/2020	CJR	1
Naphthalene	< 1.1	ug/l	1.1	3.6	1	624		12/15/2020	CJR	1
n-Propylbenzene	< 0.33	ug/l	0.33	1.1	1	624		12/15/2020	CJR	1
1,1,2,2-Tetrachloroethane	< 0.37	ug/l	0.37	1.2	1	624		12/15/2020	CJR	1
1,1,1,2-Tetrachloroethane	< 0.88	ug/l	0.88	3.3	1	624		12/15/2020	CJR	1
Tetrachloroethene	< 0.33	ug/l	0.33		1	624		12/15/2020	CJR	1
Toluene	< 0.26	ug/l	0.26	0.83	1	624		12/15/2020	CJR	1
1,2,4-Trichlorobenzene	< 0.44	ug/l	0.44	1.4	1	624		12/15/2020	CJR	1

Project Name MARTINO'S 41ST-KENOSHA
Project # 6165 PO#2020-2131

Invoice # E38892

Lab Code 5038892D
Sample ID 6165 MW-9
Sample Matrix Water
Sample Date 12/8/2020

	Result	Unit	LOD	LOQ	Dil	Method	Ext Date	Run Date	Analyst	Code
1,2,3-Trichlorobenzene	< 1	ug/l	1	3.2	1	624		12/15/2020	CJR	1
1,1,1-Trichloroethane	< 0.3	ug/l	0.3	0.95	1	624		12/15/2020	CJR	1
1,1,2-Trichloroethane	< 0.36	ug/l	0.36	1.1	1	624		12/15/2020	CJR	1
Trichloroethene (TCE)	< 0.47	ug/l	0.47	1.5	1	624		12/15/2020	CJR	1
Trichlorofluoromethane	< 0.42	ug/l	0.42	1.3	1	624		12/15/2020	CJR	1
1,2,4-Trimethylbenzene	< 0.3	ug/l	0.3	0.96	1	624		12/15/2020	CJR	1
1,3,5-Trimethylbenzene	< 0.32	ug/l	0.32	1	1	624		12/15/2020	CJR	1
Vinyl Chloride	< 0.2	ug/l	0.2	0.65	1	624		12/15/2020	CJR	1
m&p-Xylene	< 1.1	ug/l	1.1	3.3	1	624		12/15/2020	CJR	1
o-Xylene	< 0.38	ug/l	0.38	1.2	1	624		12/15/2020	CJR	1
SUR - 1,2-Dichloroethane-d4	106	REC %			1	624		12/15/2020	CJR	1
SUR - 4-Bromofluorobenzene	98	REC %			1	624		12/15/2020	CJR	1
SUR - Dibromofluoromethane	110	REC %			1	624		12/15/2020	CJR	1
SUR - Toluene-d8	94	REC %			1	624		12/15/2020	CJR	1

Environmental Lab, Inc.

www.synergy-lab.net
 1990 Prospect Ct. • Appleton, WI 54914
 920-830-2455 • mrsynergy@wi.twcbc.com

Sample Handling Request	
Rush Analysis	Date Required: _____
(Rushes accepted only with prior authorization)	
<input checked="" type="checkbox"/> Normal Turn Around	

Lab I.D. # _____
 QUOTE #: 8242
 Project #: 6165
 Sampler: (signature) *TLR*

Project (Name / Location): *Martino's 41st - Kenosha, WI*

Reports To: <i>B. Kappen</i>	Invoice To: <i>Accounts Payable</i>
Company: <i>Enviroforensics, LLC</i>	Company: <i>Enviroforensics, LLC</i>
Address: _____	Address: _____
City State Zip: _____	City State Zip: _____
Phone: <i>262-745-5054</i>	Phone: <i>317-972-7870</i>
Email: <i>bkappen@enviroforensics.com</i>	Email: <i>accountspayable@enviroforensics.com</i>

Analysis Requested												Other Analysis			
DRO (Mod DRO Sep 95)	GRO (Mod GRO Sep 95)	LEAD	NITRATE/NITRITE	OIL & GREASE	PAH (EPA 8270)	PCB	PVOC (EPA 8021)	PVOC + NAPHTHALENE	SULFATE	TOTAL SUSPENDED SOLIDS	VOC DW (EPA 524.2)	VOC (EPA 8260)	VOC AIR (TO - 15)	8-PCRA METALS	PID/ FID
														<i>Ethene, ethane, methane</i>	

Lab I.D.	Sample I.D.	Collection Date	Time	Filtered Y/N	No. of Containers	Sample Type (Matrix)*	Preservation
<i>5038892A</i>	<i>6165-MW-1</i>	<i>12/8/20</i>	<i>1412</i>	<i>N</i>	<i>4</i>	<i>GW</i>	<i>HCl</i>
<i>B</i>	<i>6165-MW-2</i>	<i>12/8/20</i>	<i>1332</i>	<i> </i>	<i>4</i>	<i> </i>	<i> </i>
<i>C</i>	<i>6165-MW-3</i>	<i>12/8/20</i>	<i>1151</i>	<i> </i>	<i>4</i>	<i> </i>	<i> </i>
<i>D</i>	<i>6165-MW-9</i>	<i>12/8/20</i>	<i>1105</i>	<i> </i>	<i>3</i>	<i> </i>	<i> </i>
<i>E</i>	<i>6165-MW-10</i>	<i>12/8/20</i>	<i>1012</i>	<i> </i>	<i>4</i>	<i> </i>	<i> </i>
<i>F</i>	<i>6165-MW-11</i>	<i>12/7/20</i>	<i>1517</i>	<i> </i>	<i>4</i>	<i> </i>	<i> </i>
<i>G</i>	<i>6165-MW-12</i>	<i>12/7/20</i>	<i>1441</i>	<i> </i>	<i>4</i>	<i> </i>	<i> </i>
<i>H</i>	<i>6165-MW-15</i>	<i>12/7/20</i>	<i>1150</i>	<i> </i>	<i>3</i>	<i> </i>	<i> </i>
<i>I</i>	<i>6165-MW-16</i>	<i>12/7/20</i>	<i>1256</i>	<i> </i>	<i>3</i>	<i> </i>	<i> </i>
<i>J</i>	<i>6165-MW-17</i>	<i>12/8/20</i>	<i>931</i>	<i> </i>	<i>3</i>	<i> </i>	<i> </i>
<i>K</i>	<i>6165-MW-18</i>	<i>12/7/20</i>	<i>1345</i>	<i> </i>	<i>3</i>	<i> </i>	<i> </i>
<i>L</i>	<i>6165-DUP-1</i>	<i>12/7/20</i>	<i>-</i>	<i> </i>	<i>3</i>	<i> </i>	<i> </i>

Comments/Special Instructions (*Specify groundwater "GW", Drinking Water "DW", Waste Water "WW", Soil "S", Air "A", Oil, Sludge, etc.)

PO# 2020-2131

Sample Integrity - To be completed by receiving lab.

Method of Shipment: *GC*

Temp. of Temp. Blank: _____ °C On Ice:

Cooler seal intact upon receipt: Yes _____ No

Relinquished By: (sign) <i>TLR</i>	Time <i>1600</i>	Date <i>12-10-20</i>	Received By: (sign) <i>CS Logistics</i>	Time <i>1600</i>	Date <i>12-10-20</i>
Received in Laboratory By: <i>[Signature]</i>			Time: <i>8:00</i>	Date: <i>12/11/20</i>	