

KPRG and Associates, Inc.

REVISED ADDITIONAL BUDGET REQUEST

July 5, 2011

Mr. Andrew F Boettcher
Wisconsin Department of Natural Resources
2300 N. Dr. Martin Luther King, Jr. Drive
Milwaukee, WI 53212

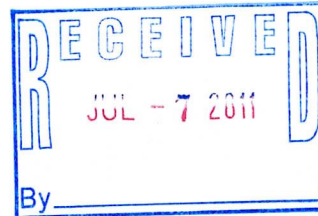

VIA FEDERAL EXPRESS

Re: Revised Additional Budget Request
3707 West Loomis Road, Greenfield, Wisconsin
FID# 241487180, BRRTS# 02-41-552212

KPRG Project No. 19008

Action Codes
35 & 112

Dear Mr. Boettcher:

On March 21, 2001, KPRG and Associates, Inc. (KPRG) submitted a Site Investigation (SI) Report and Additional Budget Request. Based on our conversation on May 11, 2011, only additional soil and vapor sampling and associated reporting costs would be approved in order to complete definition of impacts prior to proceeding with any additional work, if necessary. Therefore this transmittal is an additional budget request for the revised proposed additional work.

Based on the above mentioned discussion, the following tasks have been identified:

- Task 1 – Complete Definition of Soil Impacts
- Task 2 - Complete Definition of Sub-slab Vapor Impacts
- Task 3 – SI Report Addendum

The scope of each task is described below followed by an overall budget.

SCOPE OF WORK

Task 1 - Definition of Soil Impacts

KPRG will complete the definition of the extent of soil impacts by collecting additional soil samples. Eight additional soil borings are proposed at locations shown of Figure 1. Up to two soil samples will be collected from each boring and analyzed for volatile organic compounds (VOCs). The borings will be advanced using a Geoprobe to a depth of approximately 15 feet below ground surface. It is noted that B-9 and B-10 will be

located in the basement of the building. Actual depths of these borings may be influenced by drilling equipment (hand-auger or power hand tools) and sub-surface conditions. All borings will be continuously logged and field screened with a photoionization detector (PID) for total organic vapors. Upon completion, all borings will be abandoned with bentonite and hydrated. A surface seal will be placed matching the surrounding material.

Task 2 – Additional Sub-slab Vapor Sampling

Impacts were noted in a sub-slab vapor sample collected at B-8/V in the basement of the north central portion of the building. The sub-slab soils on the west side of the building are likely partially separated from the west side via a footing along the north-south wall. As a result, a vapor point in the west side has been requested. An Entech vapor probe will be installed at location V-1 in this west side shown on Figure 1. Upon completion, soil vapor samples will be collected from both vapor points, B-8/V and V-1, using the Summa canister collection method and analyzed for chlorinated organics using method TO15M.

Task 3 – SI Report Addendum

Upon receipt of all analytical data, an addendum to the site investigation report will be developed and submitted to the WDNR. The addendum will include, but not be limited to:

- Objective of additional site investigations.
- Documentation of field activities.
- Updated evaluation of the extent of soil impacts.
- Updated evaluation of sub-slab vapor impacts.
- Summary/Conclusions.

Summary data tables will include all soil and vapor data from the initial phase of site investigation work along with the new data generated as part of this additional site investigation.

ADDITIONAL BUDGET REQUEST

To complete the above defined scope of remedial action, an additional budget of \$7,105 is requested. Adding to the total approved budget of \$22,120, a revised total requested budget to date is \$29,225. Detailed costing sheets for each task are provided in Attachment 1. The budget is based on the following assumptions:

- KPRG recommended and completed site investigation work will be sufficient to the WDNR satisfaction.
- A total of sixteen (16) soil samples to be analyzed for VOCs.
- A total of two (2) vapor samples to be analyzed for CVOCs

Only those costs incurred will be billed. All billing will be performed on a monthly basis and will be broken down by task and unit rates. A total budget of \$29,225 is requested to complete this work.

No additional work will be performed until formal WDNR approval of the proposed budget is received. KPRG and Carriage Cleaners look forward to working with the WDNR towards the successful completion of the additional site investigation and case closure. If there are any questions, please contact me at 262-781-0475.

Sincerely,
KPRG and Associates, Inc.



Patrick Allenstein, P.G.
Senior Geologist

cc: Mr. James Butz, Carriage Cleaners
Mr. Donald P. Gallo, Reinhart, Boerner, Van Deuren, S.C.

FIGURE

WEST LOOMIS ROAD

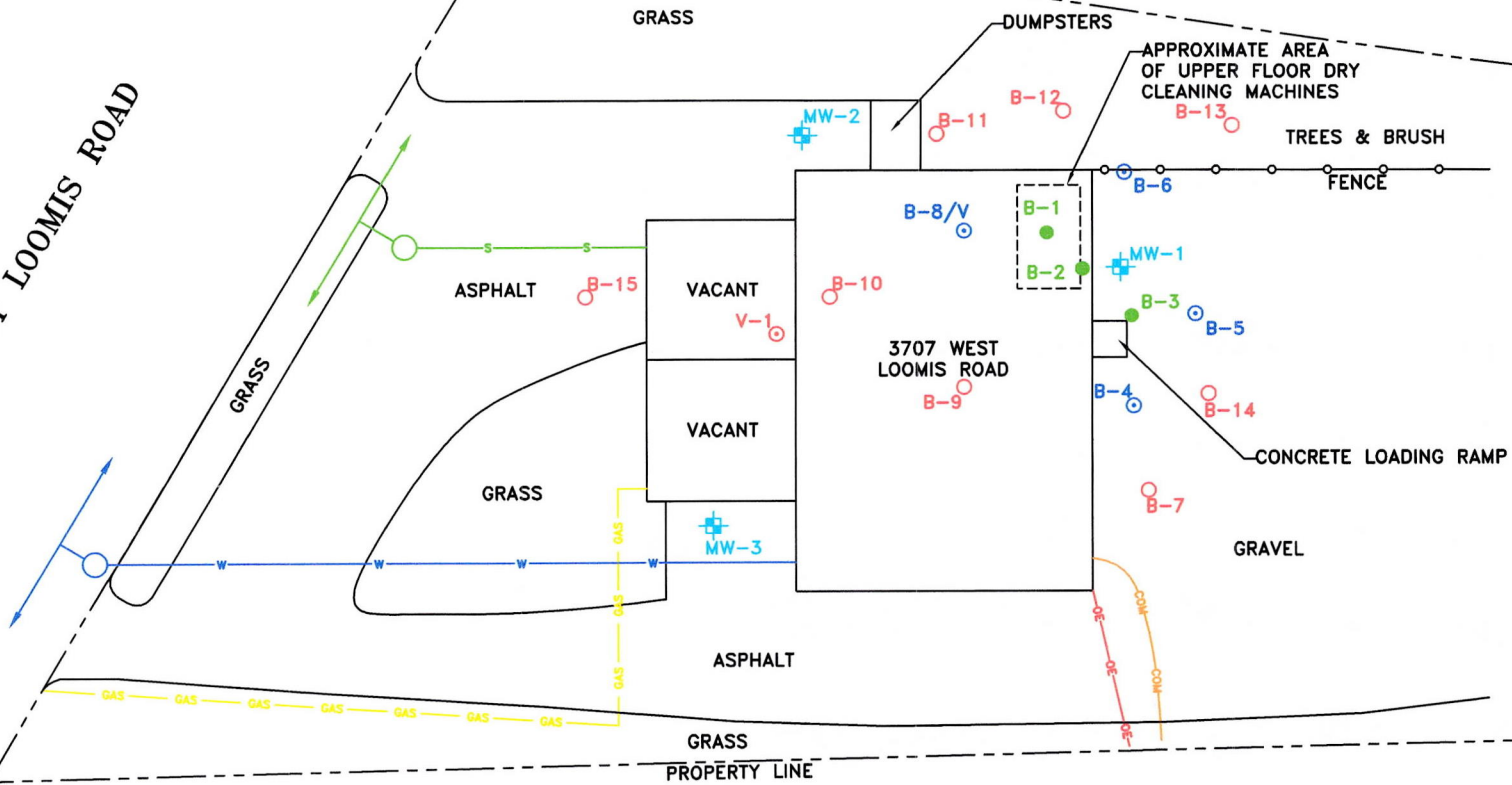

LEGEND

- UNDERGROUND SEWER
- UNDERGROUND GAS LINE
- UNDERGROUND WATER LINE
- UNDERGROUND COMMUNICATIONS
- OVERHEAD ELECTRIC LINE
- BORING LOCATION (8-2008)
- BORING LOCATION "V" DENOTES VAPOR SAMPLE
- MONITORING WELL LOCATION
- LINE OF CROSS SECTION
- PROPOSED BORING LOCATION



ENVIRONMENTAL CONSULTATION & REMEDIATION

K P R G KPRG and Associates, inc.

14655 West Lisbon Road, Suite 2B Brookfield, Wisconsin 53005 Telephone 262-781-0475 Facsimile 262-781-0478
414 Plaza Drive, Suite 106 Westmont, Illinois 60559 Telephone 630-325-1300 Facsimile 630-325-1593

PROPOSED BORING LOCATION MAP

CARRIAGE CLEANERS
GREENFIELD, WISCONSIN

Scale: 1" = 50' Date: July 5, 2011

KPRG Project No. 19008 **FIGURE 1**

C:\p19008\projects\jim butz\properties\carriage 3707 loomis\figures\19008_dte.msp.dwg

ATTACHMENT 1

Detailed Costing Sheets

Table 1. Estimated SI Report Addendum - Carriage Cleaners - Greenfield, WI

Task	KPRG Labor	Expenses	Contractors		Totals
			Analytical	Drilling Contractor	
1) Complete Definition of Soil Impacts	\$986	\$235	\$880	\$1,800	\$3,901
2) Sub-slab Vapor Probe Installation and Sampling	\$714	\$220	\$470	\$0	\$1,404
3) SI Report Addendum	\$1,775	\$25	\$0	\$0	\$1,800
Totals	\$3,475	\$480	\$1,350	\$1,800	\$7,105

KPRG TASK COSTING SHEET

Project: Carriage Cleaners - Greenfield, WI

Task 1 - Complete Definition of Soil Impacts

<u>Professional Labor</u>	<u>Rate (\$/Hr.)</u>		<u>Units</u>	<u>Total</u>
Principal/Proj. Mgr.	\$125		1	\$125.00
Field Eng./Sci.	\$68		12	\$816.00
CADD	\$60		0	\$0.00
Admin. Asst/ Word Proc.	\$45		1	\$45.00
			Total Labor	<u>\$986.00</u>

<u>External Expenses</u>	<u>Rate</u>	<u>Type</u>	<u>Units</u>	<u>Total</u>
Photoionization Detector	\$50	Daily	1	\$50.00
Field Vehicle	\$60	Daily	1	\$60.00
Soil Sampling Supplies	\$20	Daily	1	\$20.00
Soil Gas Samp. Equip	\$110	Daily	0	\$0.00
GW Qual. Meters	\$150	Daily	0	\$0.00
Water Level Meter	\$25	Daily	0	\$0.00
Bailers (Disp.)	\$20	Each	0	\$0.00
Drums	\$55	Each	1	\$55.00
Shipping	\$50	Est.	1	\$50.00
			Total Expenses	<u>\$235.00</u>

<u>Contractors</u>	<u>Rate</u>	<u>Type</u>	<u>Units</u>	<u>Total</u>
Geoprobe Contractor	\$1,800	Estimate	1	\$1,800.00
Analytical	\$55	VOC-Soil	16	\$880.00
			Total Contractors	<u>\$2,680.00</u>

TASK TOTAL:	\$3,901.00
--------------------	-------------------

KPRG TASK COSTING SHEET

Project: Carriage Cleaners - Greenfield, WI

Task 2 - Sub-Slab Vapor Probe Install and Sample

<u>Professional Labor</u>	<u>Rate (\$/Hr.)</u>		<u>Units</u>	<u>Total</u>
Principal/Proj. Mgr.	\$125		1	\$125.00
Field Eng./Sci.	\$68		8	\$544.00
CADD	\$60		0	\$0.00
Admin. Asst/ Word Proc.	\$45		1	\$45.00
			Total Labor	<u>\$714.00</u>

<u>External Expenses</u>	<u>Rate</u>	<u>Type</u>	<u>Units</u>	<u>Total</u>
Reproduction	\$25	Est.	0	\$0.00
Field Vehicle	\$60	Daily	2	\$120.00
Soil Gas Samp. Equip	\$110	Daily	0	\$0.00
Vapor Probe	\$100	Each	1	\$100.00
Drums	\$55	Each	0	\$0.00
PPE - Modified Level D	\$15	Daily	0	\$0.00
PPE - Level C	\$35	Daily	0	\$0.00
			Total Expenses	<u>\$220.00</u>

<u>Contractors</u>	<u>Rate</u>	<u>Type</u>	<u>Units</u>	<u>Total</u>
Analytical	\$235	CVOC-Vapor	2	\$470.00
			Total Contractors	<u>\$470.00</u>

TASK TOTAL: \$1,404.00

KPRG TASK COSTING SHEET

Project: Carriage Cleaners - Greenfield, WI

Task 3 - SI Report Addendum

<u>Professional Labor</u>	<u>Rate (\$/Hr.)</u>	<u>Units</u>	<u>Total</u>
Principal/Proj. Mgr.	\$125	2	\$250.00
Field Eng./Sci.	\$68	20	\$1,360.00
CADD	\$60	2	\$120.00
Admin. Asst/ Word Proc.	\$45	1	\$45.00
		Total Labor	<u>\$1,775.00</u>

<u>External Expenses</u>	<u>Rate</u>	<u>Type</u>	<u>Units</u>	<u>Total</u>
Reproduction	\$25	Est.	1	\$25.00
Field Vehicle	\$60	Daily	0	\$0.00
Sampling Supplies	\$20	Daily	0	\$0.00
Drums	\$55	Each	0	\$0.00
PPE - Modified Level D	\$15	Daily	0	\$0.00
PPE - Level C	\$35	Daily	0	\$0.00
		Total Expenses		<u>\$25.00</u>

<u>Contractors</u>	<u>Rate</u>	<u>Type</u>	<u>Units</u>	<u>Total</u>
none	\$0	Lump Sum	0	\$0.00
		Total Contractors		<u>\$0.00</u>

TASK TOTAL: \$1,800.00

PROJECT TOTAL: \$7,105.00